



THE CITY OF SAN DIEGO



ANNUAL REPORT for Fiscal Year 2018

REMINGTON HILLS MAINTENANCE ASSESSMENT DISTRICT

under the provisions of the

**San Diego Maintenance Assessment District Procedural Ordinance
of the San Diego Municipal Code**

**Prepared For
City of San Diego, California**



**Prepared By
EFS Engineering, Inc.
P.O. Box 22370
San Diego, CA 92192-2370
(858) 752-3490**

June 2017

CITY OF SAN DIEGO

Mayor

Kevin Faulconer

City Council Members

Barbara Bry District 1	Mark Kersey District 5 (Council President Pro Tem)
Lorie Zapf District 2	Chris Cate District 6
Chris Ward District 3	Scott Sherman District 7
Myrtle Cole District 4 (Council President)	David Alvarez District 8
Georgette Gómez District 9	

City Attorney

Mara W. Elliott

Chief Operating Officer

Scott Chadwick

City Clerk

Elizabeth Maland

Independent Budget Analyst

Andrea Tevlin

City Engineer

James Nagelvoort

Table of Contents

Annual Report for Fiscal Year 2018 Remington Hills Maintenance Assessment District

Preamble.....	1
Executive Summary	2
Background	3
District Boundary	3
Project Description.....	3
Separation of General and Special Benefits.....	4
Cost Estimate.....	4
Annual Cost-Indexing	4
Method of Apportionment.....	5
Estimated Benefit of Improvements.....	5
Apportionment Methodology	5
Equivalent Benefit Units (EBUs).....	5
Land Use Factor	5
Benefit Factor	7
Sample Calculations	9
Summary Results.....	10

EXHIBITS

Exhibit A: District Boundary

Exhibit B: Estimated Budget – Revenue & Expense Statement
for Fiscal Year 2018

Exhibit C: Preliminary Assessment Roll for Fiscal Year 2018

Annual Report for Fiscal Year 2018

Remington Hills

Maintenance Assessment District

Preamble

Pursuant to §65.0220 of the “San Diego Maintenance Assessment District Procedural Ordinance” (being Division 2, Article 5, Chapter 6 of the *San Diego Municipal Code*) and City of San Diego Council Resolution No. R-310618 passed on July 22, 2016, authorizing the continued levy of assessments for the life of the REMINGTON HILLS MAINTENANCE ASSESSMENT DISTRICT (hereinafter referred to as “District”), and in accordance with applicable provisions of “Proposition 218” (being Article XIID of the California Constitution), and provisions of the “Proposition 218 Omnibus Implementation Act” (being California Senate Bill 919) (the aforementioned provisions are hereinafter referred to collectively as “applicable law”), and in accordance with Resolution No. _____, adopted by the CITY COUNCIL OF THE CITY OF SAN DIEGO, COUNTY OF SAN DIEGO, STATE OF CALIFORNIA, and in connection with the annual proceedings for the District, EFS Engineering, Inc., as Assessment Engineer to the City of San Diego, submits herewith this annual report for the District as required by §65.0220 of the “San Diego Maintenance Assessment District Procedural Ordinance.”

DATE OF FINAL PASSAGE BY THE CITY OF SAN DIEGO,
COUNTY OF SAN DIEGO, STATE OF CALIFORNIA, ON THE
_____ DAY OF _____, 2017.

Elizabeth Maland, CITY CLERK
CITY OF SAN DIEGO
STATE OF CALIFORNIA

Executive Summary

Project: Remington Hills
Maintenance Assessment District

Apportionment Method: Equivalent Benefit Unit (EBU)

	FY 2017	FY 2018 ⁽¹⁾	Maximum ⁽²⁾ Authorized
Total Parcels Assessed:	501	501	--
Total Estimated Assessment:	\$14,446	\$14,446	--
Total Number of EBUs:	466.00	466.00	--
Assessment per EBU:	\$31.00	\$31.00	\$259.15 ⁽³⁾

⁽¹⁾ FY 2018 is the City's Fiscal Year 2018, which begins July 1, 2017 and ends June 30, 2018. Total Parcels Assessed, Total Estimated Assessment, and assessment apportionment factors may vary from prior fiscal year values due to parcel changes and/or land use re-classifications.

⁽²⁾ Maximum authorized assessment rate subject to cost-indexing as approved by property owners at the time of District formation.

⁽³⁾ Prior fiscal year's maximum authorized annual assessment rate increased by cost-indexing factor of 1.96%.

Annual Cost-Indexing: The maximum authorized assessment rates are cost-indexed and will increase (or decrease) annually based on the annual change in the *San Diego Consumer Price Index for Urban Consumers* (SDCPI-U).

Background

The Remington Hills Maintenance Assessment District (District), originally known as the “Northwest Otay Mesa Maintenance Assessment District, Zone 3,” was established by the City of San Diego (City) on June 22, 1999 by City Council Resolution R-291812. The purpose of the District was, and still is, to fund specifically identified improvements and activities within the boundary of the District.

In conformity with §65.0221 of the “San Diego Maintenance Assessment District Procedural Ordinance,” the City adopted Resolution No. R-310618 on July 22, 2016, approving the annual budget and assessments for Fiscal Year 2017, and authorizing the levy of the assessments for the life of the District, consistent with the benefit findings and assessment apportionment method contained in the approved formational and all subsequently updated Engineer’s Reports (Engineer’s Reports). The Engineer’s Reports are on file with the City Clerk, and incorporated herein by reference.

The District is authorized and administered under the provisions of the “San Diego Maintenance Assessment District Procedural Ordinance.” This annual report has been prepared pursuant to the requirements of §65.0220 of the “San Diego Maintenance Assessment District Procedural Ordinance.”

District Boundary

The District boundary is generally depicted in **Exhibit A**. The District Boundary Map and Assessment Diagram are on file in the Maintenance Assessment Districts section of the Park and Recreation Department of the City, and, by reference, are made a part of this annual report.

Project Description

The authorized assessments will be used to fund specifically identified improvements and activities within the District. The District improvements and activities generally consist of maintenance and servicing of specified landscaped and paved rights-of-way, landscaped slopes, natural open space areas, and gutters in the District. The approximate location of the improvements is generally shown on **Exhibit A**.

For additional detail as to the location, type of improvements, and activities performed by the District, please refer to the maps,

improvement plans, engineering drawings, maintenance specifications, the Engineer's Reports and other associated documents on file with the Maintenance Assessment Districts section of the Park and Recreation Department of the City. These documents, collectively, are incorporated herein by reference and made part of this annual report.

Separation of General and Special Benefits

The identified improvements and activities provide benefits to the parcels located within the District. These benefits are "special benefits" to the extent that they are above and beyond the City's standard level of service, and exclusive of those "general benefits" provided to the public at large or properties located outside the District. By law, only "special benefits" are assessable.

The assessments presented in this annual report are based on the cost of improvements and activities determined to provide "special benefits" in accordance with the Engineer's Reports. For additional detail relative to the separation and quantification of general and special benefits for the District, please refer to the Engineer's Reports, on file with the Maintenance Assessment Districts section of the Park and Recreation Department of the City.

Cost Estimate

The estimated annual budget (Revenue & Expense Statement) for Fiscal Year 2018 (July 1, 2017 to June 30, 2018 period) is included as **Exhibit B**. The "Other Contributions (Non Assessment Source)" revenue contained in the budget includes the value of improvements and activities determined to provide "general benefits." The District budget with full detail is available for public reference in the Maintenance Assessment Districts section of the Park and Recreation Department of the City.

Annual Cost-Indexing

The maximum authorized assessment set forth in the Engineer's Reports is permitted to increase annually based on the published change in the "San Diego Consumer Price Index for Urban Consumers" (SDCPI-U). The annual change in second half SDCPI-U values, as compiled by the *U.S. Bureau of Labor Statistics* (see www.bls.gov), for the prior year period was from 271.526 to 276.837 (a 1.96% increase). In accordance with the approved cost-indexing provisions, the maximum authorized assessment rates have been increased by 1.96%.

Method of Apportionment

Estimated Benefit of Improvements

The Transportation Element of the City's General Plan and the general policy recommendations found in the Otay Mesa Community Plan establish several goals for the community's transportation system. The District improvements and activities are consistent with the plans' goals for safety and pleasing aesthetics. The major and arterial streets within the District are the backbone of the street network within the community. They serve as the primary access routes for inter-community and intra-community trips. The collector/neighborhood streets within the District serve as the primary access routes to and from the major and arterial streets for parcels within a neighborhood.

Apportionment Methodology

The total cost associated with District improvement and activities will be assessed proportionally to the parcels in the District based on Equivalent Benefit Units (EBUs). The total assessment for a given parcel is equal to the parcel's total EBUs multiplied by the Unit Assessment Rate (unique to the zone in which parcel is situated) as shown in the following equation:

$$\text{Total Assessment} = \text{Total EBUs} \times \text{Unit Assessment Rate}$$

Equivalent Benefit Units (EBUs)

EBUs for each parcel have been determined as a function of two factors, a Land Use Factor and a Benefit Factor, related as shown in the following equation:

$$\text{EBUs} = (\text{Acres or Units}) \times \text{Land Use Factor} \times \text{Benefit Factor}$$

Each of these factors is discussed below.

Land Use Factor

Since the District improvements and activities are primarily associated with the Transportation Element of the General and Community Plans, trip generation rates for various land use categories (as previously established by the City's Transportation Planning Section) have been used as the primary basis for the development of Land Use Factors. While these trip generation rates strictly address only vehicular trips, they are also considered

to approximately reflect relative trip generation for other modes of transportation (e.g., pedestrian trips, bicycle trips, etc.), and are considered the best available information for these other transportation modes.

The special benefits of the District improvements and activities are linked to trip generation primarily by the public safety and aesthetic enhancement enjoyed by travelers through the community. Trip generation rates provide the required nexus and basis for assigning ratios of maximum potential benefit to the various land use/zoning classifications as defined by the City’s Municipal Code.

Land use/zoning classifications have been grouped with averaged trip generation rates assigned to establish the Land Use Factors as shown in **Table 1**.

TABLE 1: Land Use Factors

Land Use/Zoning	Code	Land Use Factor
Residential – Single Family (detached)	SFD	1.0 per dwelling unit
Residential – Condominium	CND	0.7 per dwelling unit
Residential – Multi-Family & Apartment	MFR	0.7 per dwelling unit
Commercial – Office & Retail	COM	45.0 per acre
Educational – Primary & Secondary	EPS	5.0 per acre
Fire/Police Station	FPS	15.0 per acre
House of Worship	CRH	2.8 per acre
Industrial	IND	15.0 per acre
Open Space (designated)	OSP	0.0 per acre
Park – Developed	PKD	5.0 per acre
Park – Undeveloped	PKU	0.5 per acre
Undevelopable	UND	0.0 per acre

Designated Open Space serves primarily to preserve natural landscape and habitat. While access for study and passive recreation is sometimes permitted, these activities are usually allowed only to the limited extent consistent with the primary purpose of natural preservation. Since this land is essentially “unused” in the customary terms of land use (which relate to human use, not use by nature), the trip generation rate is zero. Therefore, the designated Open Space receives no benefit from the Transportation Element and has been assigned a Land Use Factor of zero.

Benefit Factor

The Land Use Factor described above reflects the relative intensity of use (or potential use) of the various parcels of land to be assessed. It does not address the relationship of this use to the specific District improvements and activities. This relationship is reflected in the Benefit Factor utilized in the assessment methodology.

In determining the Benefit Factor for each land use category, the subcomponents of the benefits of District improvements and activities considered may include some or all of the following: public safety, view corridors and aesthetics, enhancement of community identity, drainage corridors, and recreational potential. As Benefit Factors and their subcomponents are intended to reflect the particular relationships between specific land uses within a district and the specific District improvements and activities, Benefit Factors will generally vary from one district to another, based on the specific character and nature of the applicable land uses and improvements and activities.

The applicable benefit subcomponents and resultant composite Benefit Factors determined for the various land use/zoning categories within this District are as shown in **Table 2**.

TABLE 2: Benefit Factors by Land Use

Land Use/Zoning	Public Safety (max. 0.4)	Aesthetics (max. 0.6)	Composite Benefit Factor (max. 1.0)
Residential – All	0.4	0.6	1.0
Commercial – Office & Retail	0.4	0.3	0.7
Educational – Primary & Secondary	0.4	0.3	0.7
Fire/Police Station	0.4	0.3	0.7
House of Worship	0.4	0.3	0.7
Industrial	0.4	0.3	0.7
Open Space (designated)	0.4	0.0	0.4
Park – Developed	0.4	0.0	0.4
Park – Undeveloped	0.4	0.0	0.4
Undevelopable	0.4	0.0	0.4

Public Safety. All land uses are considered to receive the maximum available benefit from the public safety element of District improvements and activities. Public safety is essential to all land uses, and even to lands, such as designated Open Space, held in stewardship with only incidental human use.

Aesthetics. The degree of benefit received from the aesthetic qualities of landscaped and hardscaped roadway medians and rights-of-way maintained by the District varies among land use categories. Generally, by nature of their use, residential lands receive the greatest benefit from the reduced traffic congestion, reduced noise levels, greater separation from traffic and generally more tranquil environment provided by landscaped and hardscaped roadway medians and rights-of-way. Commercial, industrial and institutional uses, on the other hand, often thrive on higher densities, greater traffic access, and a higher level of activity in the vicinity of their enterprises. These uses, accordingly, receive a lesser degree of benefit from the general insulation and separation provided by the aesthetic elements of District improvements and activities.

Lands in the Open Space category are considered to receive no significant benefit from the aesthetic elements of District improvements and activities, as enhanced aesthetic quality of other lands in the vicinity does not affect their function, use, or value. Lands in the Park category are considered to receive no significant benefit from the aesthetic elements of District improvements and activities, as the aesthetic values of these lands are themselves so high that they are little enhanced by those of other lands in their vicinity.

Sample Calculations

As described above, the number of Equivalent Benefit Units (EBUs) assigned to each parcel in the District has been calculated based on each parcel's land use and the identified apportionment factors, as shown in the following equation:

$$\text{EBUs} = (\text{Acres or Units}) \times \text{Land Use Factor} \times \text{Benefit Factor}$$

Shown below are sample EBU calculations for several common land uses found in the District.

- **1 Single-Family Residence**
EBUs = 1 unit x 1.00 x 1.00 = 1.00 EBUs
- **1 Condominium**
EBUs = 1 unit x 0.70 x 1.00 = 0.70 EBUs
- **10-unit Apartment Complex**
EBUs = 10 units x 0.70 x 1.00 = 7.00 EBUs
- **½-acre Commercial Property**
EBUs = 0.50 acres x 45.00 x 0.70 = 15.75 EBUs

The total assessment for each parcel in the District is based on the calculated EBUs for the parcel and the applicable unit assessment rate, as shown in the following equation:

$$\text{Total Assessment} = \text{Total EBUs} \times \text{Unit Assessment Rate}$$

Based on the above formula, the EBUs, unit assessment rate, and total assessment calculated for each property, can be found in the Assessment Roll (**Exhibit C**).

Summary Results

The District Boundary is presented in **Exhibit A**.

An estimate of the annual costs of the improvements and activities provided by the District is included as **Exhibit B**.

The assessment methodology utilized is as described in the text of this annual report. Based on this methodology, Fiscal Year 2018 District assessment for each parcel were calculated and are shown in the Preliminary Assessment Roll (**Exhibit C**).

Each lot or parcel of land within the District has been identified by unique County Assessor's Parcel Number in the Preliminary Assessment Roll and on the Boundary Map and Assessment Diagram referenced herein.

This annual report has been prepared and respectfully submitted by:

EFS ENGINEERING, INC.



Eugene F. Shank, PE

C 52792

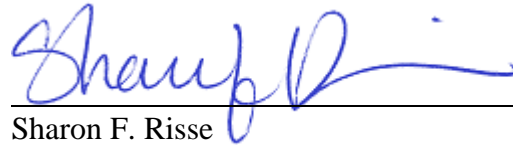

Sharon F. Risse

EXHIBIT A

District Boundary

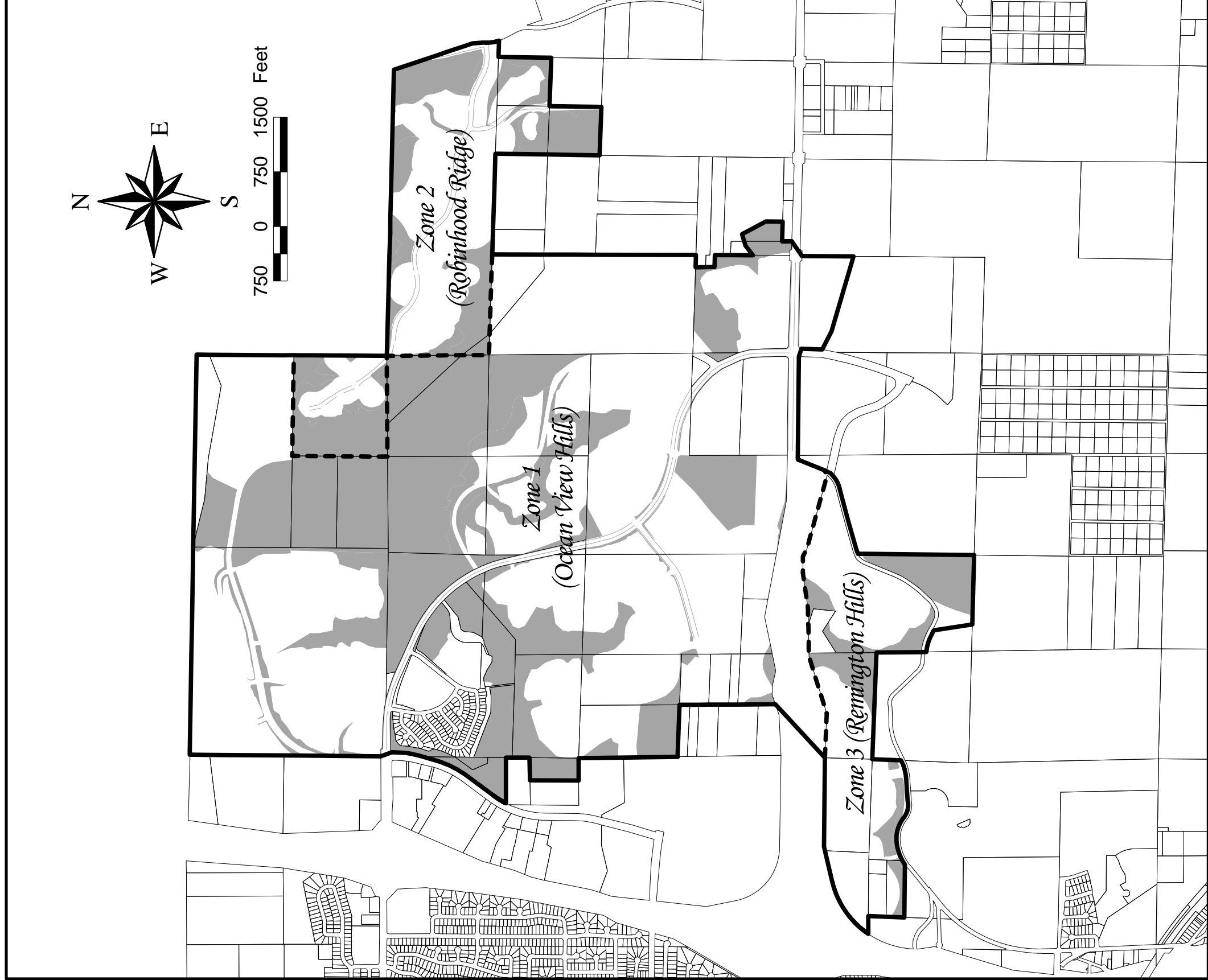

NOTE

1. This map is for exhibit purposes only. Please refer to the Northwest Otay Mesa Maintenance Assessment District Boundary Map on file at the City.
2. Each lot or parcel on this map has been identified by the County Assessor's Parcel Number in the Assessment Roll contained in the Engineer's Report.
3. For a detailed description of the lines and dimensions of lots or parcels shown on this map, refer to the County Assessor's Maps which shall govern with respect to all details concerning the lines and dimensions of such lots or parcels.

LEGEND

- District Boundary
- Zone Boundary
- Parcel Lines
- Improvements

CITY OF SAN DIEGO / NORTHWEST OTAY MESA MAINTENANCE ASSESSMENT DISTRICT

EXHIBIT A - District Boundary, Zones & Improvements

EXHIBIT B

**Estimated Budget – Revenue & Expense Statement
for Fiscal Year 2018**

EXHIBIT B

REVENUE AND EXPENSE STATEMENT

Remington Hills Maintenance Assessment District Fund 200098

	FY 2016 ACTUALS	FY 2017 ESTIMATE	FY 2018 PROPOSED
BEGINNING FUND BALANCE			
Surplus (or Deficit) from Prior Year	\$ 48,523.36	\$ 50,163.09	\$ 35,385.00
TOTAL BEGINNING FUND BALANCE	\$ 48,523.36	\$ 50,163.09	\$ 35,385.00
REVENUE			
Assessment Revenue	\$ 17,094.88	\$ 14,446.00	\$ 14,446.00
Interest	\$ 367.39	\$ 150.00	\$ 50.00
Other Contributions (Non Assessment Source)	\$ 7,167.01	\$ 5,530.00	\$ 7,298.00
TOTAL REVENUE	\$ 24,629.28	\$ 20,126.00	\$ 21,794.00
TOTAL BEGINNING FUND BALANCE & REVENUE	\$ 73,152.64	\$ 70,289.09	\$ 57,179.00
OPERATING EXPENSE			
Landscaping Improvements and Activities ⁽¹⁾	\$ 15,495.55	\$ 24,248.30	\$ 25,273.00
Tree Services	\$ -	\$ 1,000.00	\$ 1,000.00
Misc. Services ⁽²⁾	\$ -	\$ 2,000.00	\$ 2,000.00
Special Districts Administration Cost	\$ 7,494.00	\$ 7,656.00	\$ 7,677.00
Other (Unallocated Reserve)	\$ -	\$ -	\$ 1,500.00
TOTAL OPERATING EXPENSE	\$ 22,989.55	\$ 34,904.30	\$ 37,450.00
TOTAL EXPENSE	\$ 22,989.55	\$ 34,904.30	\$ 37,450.00
TOTAL ENDING FUND BALANCE	\$ 50,163.09	\$ 35,384.79	\$ 19,729.00
NET ANNUAL REVENUE (OR EXPENSE)	\$ 1,639.73	\$ (14,778.30)	\$ (15,656.00)

⁽¹⁾ Includes related supplies and utility cost.

⁽²⁾ Includes services for fence work.

The District budget with full detail is available for public reference in the Maintenance Assessment Districts section of the Park and Recreation Department of the City of San Diego.

EXHIBIT C

**Preliminary Assessment Roll
for Fiscal Year 2018**

EXHIBIT C - Assessment Roll (Fiscal Year 2018)
Remington Hills Maintenance Assessment District

Parcel Number	Acres/ Units ⁽¹⁾	Land Use ⁽²⁾	NW Otay Zone	Apportionment Factors		Total EBUs	FY 2018 ⁽⁴⁾		Owner Name
				Land Use ⁽²⁾	Benefit ⁽³⁾		Unit Cost	Assessment	
638 300 01 00	1.00	SFD	3	1.00	1.00	1.00	\$31.00	\$31.00	Pardini Oscar F&Romelia A
638 300 02 00	1.00	SFD	3	1.00	1.00	1.00	\$31.00	\$31.00	Ortiz Jose A&Maria G
638 300 03 00	1.00	SFD	3	1.00	1.00	1.00	\$31.00	\$31.00	Fonseca German D
638 300 04 00	1.00	SFD	3	1.00	1.00	1.00	\$31.00	\$31.00	Duong Pisith&Thuy Ha
638 300 05 00	1.00	SFD	3	1.00	1.00	1.00	\$31.00	\$31.00	Vega David L&Michelle L
638 300 06 00	1.00	SFD	3	1.00	1.00	1.00	\$31.00	\$31.00	Esplandians Llc
638 300 07 00	1.00	SFD	3	1.00	1.00	1.00	\$31.00	\$31.00	Espino Marco A&Sonia
638 300 08 00	1.00	SFD	3	1.00	1.00	1.00	\$31.00	\$31.00	Balansay Living Trust 09-22-09
638 300 09 00	1.00	SFD	3	1.00	1.00	1.00	\$31.00	\$31.00	Cota Ricardo G&Miriam G
638 300 10 00	1.00	SFD	3	1.00	1.00	1.00	\$31.00	\$31.00	Perez Marco A&Norma
638 300 11 00	1.00	SFD	3	1.00	1.00	1.00	\$31.00	\$31.00	Martinez Jose A
638 300 12 00	1.00	SFD	3	1.00	1.00	1.00	\$31.00	\$31.00	Figueroa Jose R
638 300 13 00	1.00	SFD	3	1.00	1.00	1.00	\$31.00	\$31.00	Perez Pedro G
638 300 14 00	1.00	SFD	3	1.00	1.00	1.00	\$31.00	\$31.00	Murales Laura M Tr
638 300 15 00	1.00	SFD	3	1.00	1.00	1.00	\$31.00	\$31.00	Gonzalez Michael&Cynthia
638 300 16 00	1.00	SFD	3	1.00	1.00	1.00	\$31.00	\$31.00	Javier Renne M
638 300 17 00	1.00	SFD	3	1.00	1.00	1.00	\$31.00	\$31.00	Lopez Axel E&Mabel
638 300 18 00	1.00	SFD	3	1.00	1.00	1.00	\$31.00	\$31.00	Castillejos Estefany A
638 300 19 00	1.00	SFD	3	1.00	1.00	1.00	\$31.00	\$31.00	Rimocal Ulysses L
638 300 20 00	1.00	SFD	3	1.00	1.00	1.00	\$31.00	\$31.00	Ramirez-Plascencia Guadalupe
638 300 21 00	1.00	SFD	3	1.00	1.00	1.00	\$31.00	\$31.00	Tolentino Noemi
638 300 22 00	1.00	SFD	3	1.00	1.00	1.00	\$31.00	\$31.00	Amador Guillermo L&Margaret
638 300 23 00	1.00	SFD	3	1.00	1.00	1.00	\$31.00	\$31.00	Jimenez Blas S
638 300 24 00	1.00	SFD	3	1.00	1.00	1.00	\$31.00	\$31.00	Delaluz Jesus&Maria D R
638 300 25 00	1.00	SFD	3	1.00	1.00	1.00	\$31.00	\$31.00	Price Evelia
638 300 26 00	1.00	SFD	3	1.00	1.00	1.00	\$31.00	\$31.00	Camarena Benjamin E
638 300 27 00	1.00	SFD	3	1.00	1.00	1.00	\$31.00	\$31.00	Buendia Maria D L L B
638 300 28 00	1.00	SFD	3	1.00	1.00	1.00	\$31.00	\$31.00	Llergo Manuel L
638 300 29 00	1.00	SFD	3	1.00	1.00	1.00	\$31.00	\$31.00	Garcia Michael A&Lorena
638 300 30 00	0.49	OSP	3	0.00	0.40	0.00	\$31.00	\$0.00	City Of San Diego
638 300 31 00	1.32	OSP	3	0.00	0.40	0.00	\$31.00	\$0.00	Remington Hills Homeowners Assn
638 301 01 00	1.00	SFD	3	1.00	1.00	1.00	\$31.00	\$31.00	Kramer Oscar J
638 301 02 00	1.00	SFD	3	1.00	1.00	1.00	\$31.00	\$31.00	Ramac Family Trust 11-30-07
638 301 03 00	1.00	SFD	3	1.00	1.00	1.00	\$31.00	\$31.00	Mitchell Huey G Jr
638 301 04 00	1.00	SFD	3	1.00	1.00	1.00	\$31.00	\$31.00	Fieber Arthur
638 301 05 00	1.00	SFD	3	1.00	1.00	1.00	\$31.00	\$31.00	Regala Family Trust 12-18-12
638 301 06 00	1.00	SFD	3	1.00	1.00	1.00	\$31.00	\$31.00	Takahasi Leonel&Gere
638 301 07 00	1.00	SFD	3	1.00	1.00	1.00	\$31.00	\$31.00	Moreno Maria G R D Tr
638 301 08 00	1.00	SFD	3	1.00	1.00	1.00	\$31.00	\$31.00	Gonzalez Armando
638 301 09 00	1.00	SFD	3	1.00	1.00	1.00	\$31.00	\$31.00	Calderon Rosalinda
638 301 10 00	1.00	SFD	3	1.00	1.00	1.00	\$31.00	\$31.00	Apodaca John P
638 301 11 00	1.00	SFD	3	1.00	1.00	1.00	\$31.00	\$31.00	Fertig Edward L Jr
638 301 12 00	1.00	SFD	3	1.00	1.00	1.00	\$31.00	\$31.00	Rivera Rupert&Torres Elisa
638 301 13 00	1.00	SFD	3	1.00	1.00	1.00	\$31.00	\$31.00	Villarreal Placido&Alma Trust 02-03-16
638 301 14 00	1.00	SFD	3	1.00	1.00	1.00	\$31.00	\$31.00	Romero Gustavo A Jr&Yadira
638 301 15 00	1.00	SFD	3	1.00	1.00	1.00	\$31.00	\$31.00	Gobasco Edwina M Revocable Trust 06-13-07
638 301 16 00	1.00	SFD	3	1.00	1.00	1.00	\$31.00	\$31.00	Penilla Arazeli
638 301 17 00	1.00	SFD	3	1.00	1.00	1.00	\$31.00	\$31.00	Zendejas Manuel&Martha I
638 301 18 00	1.00	SFD	3	1.00	1.00	1.00	\$31.00	\$31.00	Guillen Juan A
638 301 19 00	1.00	SFD	3	1.00	1.00	1.00	\$31.00	\$31.00	Villasenor Nicolas&Maria A
638 301 20 00	1.00	SFD	3	1.00	1.00	1.00	\$31.00	\$31.00	Gilponeo Antonio T&Nellie G
638 301 21 00	1.00	SFD	3	1.00	1.00	1.00	\$31.00	\$31.00	Aguilar Lidia
638 301 22 00	1.00	SFD	3	1.00	1.00	1.00	\$31.00	\$31.00	Baig Guillermo Sr
638 301 23 00	1.00	SFD	3	1.00	1.00	1.00	\$31.00	\$31.00	Portilla Saul&Rosalinda
638 301 24 00	1.00	SFD	3	1.00	1.00	1.00	\$31.00	\$31.00	Sepulveda Blanca R
638 301 25 00	0.22	OSP	3	0.00	0.40	0.00	\$31.00	\$0.00	Remington Hills Homeowners Assn
638 301 26 00	2.59	OSP	3	0.00	0.40	0.00	\$31.00	\$0.00	Remington Hills Homeowners Assn
638 301 27 00	1.42	OSP	3	0.00	0.40	0.00	\$31.00	\$0.00	Remington Hills Homeowners Assn
638 301 28 00	0.85	OSP	3	0.00	0.40	0.00	\$31.00	\$0.00	Remington Hills Homeowners Association
638 301 29 00	0.55	OSP	3	0.00	0.40	0.00	\$31.00	\$0.00	Remington Hills Homeowners Assn

EXHIBIT C - Assessment Roll (Fiscal Year 2018)
Remington Hills Maintenance Assessment District

Parcel Number	Acres/ Units ⁽¹⁾	Land Use ⁽²⁾	NW Otay Zone	Apportionment Factors		Total EBUs	FY 2018 ⁽⁴⁾		Owner Name
				Land Use ⁽²⁾	Benefit ⁽³⁾		Unit Cost	Assessment	
638 301 30 00	5.00	SFD	3	1.00	1.00	5.00	\$31.00	\$155.00	Ham Normalinda Separate Property Trust 12-22-15
638 310 01 00	1.00	SFD	3	1.00	1.00	1.00	\$31.00	\$31.00	Rocha-Magana Arminda E
638 310 02 00	1.00	SFD	3	1.00	1.00	1.00	\$31.00	\$31.00	Chavez Jorge F
638 310 03 00	1.00	SFD	3	1.00	1.00	1.00	\$31.00	\$31.00	Castaneda Miguel A&Correa Lydia A
638 310 04 00	1.00	SFD	3	1.00	1.00	1.00	\$31.00	\$31.00	Febres Alnesugi R&Cruz Carily R
638 310 05 00	1.00	SFD	3	1.00	1.00	1.00	\$31.00	\$31.00	Luna Giovanni G Trust 10-29-01
638 310 06 00	1.00	SFD	3	1.00	1.00	1.00	\$31.00	\$31.00	Burgos Jonathan&Go Laurie Y
638 310 07 00	1.00	SFD	3	1.00	1.00	1.00	\$31.00	\$31.00	Gaieck Raymond A&Guadalupe
638 310 08 00	1.00	SFD	3	1.00	1.00	1.00	\$31.00	\$31.00	Bejarano Martin&Garcia Ana S
638 310 09 00	1.00	SFD	3	1.00	1.00	1.00	\$31.00	\$31.00	Gonzalez Angel&Madrigal Jose Living Trust 04-26-02
638 310 10 00	1.00	SFD	3	1.00	1.00	1.00	\$31.00	\$31.00	Angulo Jose A
638 310 11 00	1.00	SFD	3	1.00	1.00	1.00	\$31.00	\$31.00	Lopez Mauricio
638 310 12 00	1.00	SFD	3	1.00	1.00	1.00	\$31.00	\$31.00	Gillett Brenda E
638 310 13 00	1.00	SFD	3	1.00	1.00	1.00	\$31.00	\$31.00	Hernandez Jose G&Martinez Socorro
638 310 14 00	1.00	SFD	3	1.00	1.00	1.00	\$31.00	\$31.00	Rubio Manuel M
638 310 15 00	1.00	SFD	3	1.00	1.00	1.00	\$31.00	\$31.00	Mares Jose&Ines
638 310 16 00	1.00	SFD	3	1.00	1.00	1.00	\$31.00	\$31.00	Sandoval Marcos R
638 310 17 00	1.00	SFD	3	1.00	1.00	1.00	\$31.00	\$31.00	Gillett Brenda E
638 310 18 00	1.00	SFD	3	1.00	1.00	1.00	\$31.00	\$31.00	Esquivies Francisco&Veronica
638 310 19 00	1.00	SFD	3	1.00	1.00	1.00	\$31.00	\$31.00	Chavez Pedro A&Wolto Delfina E
638 310 20 00	1.00	SFD	3	1.00	1.00	1.00	\$31.00	\$31.00	Gutierrez Oscar
638 310 23 00	1.00	SFD	3	1.00	1.00	1.00	\$31.00	\$31.00	Marron Noemi R
638 310 24 00	1.00	SFD	3	1.00	1.00	1.00	\$31.00	\$31.00	Ahumada Jorge O
638 310 25 00	1.00	SFD	3	1.00	1.00	1.00	\$31.00	\$31.00	Galindo Ruben&Natalia
638 310 26 00	1.00	SFD	3	1.00	1.00	1.00	\$31.00	\$31.00	Caguioa Grant A
638 310 27 00	1.00	SFD	3	1.00	1.00	1.00	\$31.00	\$31.00	Galang Ariel G&Roselle E
638 310 28 00	1.00	SFD	3	1.00	1.00	1.00	\$31.00	\$31.00	Martir Josephine P
638 310 29 00	1.00	SFD	3	1.00	1.00	1.00	\$31.00	\$31.00	Garcia Arnulfo H Jr&Linda E
638 310 30 00	1.00	SFD	3	1.00	1.00	1.00	\$31.00	\$31.00	Hickman Aurora
638 310 31 00	1.00	SFD	3	1.00	1.00	1.00	\$31.00	\$31.00	Demaria-Rudy Family Trust 10-02-00
638 310 32 00	1.00	SFD	3	1.00	1.00	1.00	\$31.00	\$31.00	Rains Kristopher B&Arcolia S
638 310 33 00	1.00	SFD	3	1.00	1.00	1.00	\$31.00	\$31.00	Iniguez Sergio A&Lidia J
638 310 34 00	1.00	SFD	3	1.00	1.00	1.00	\$31.00	\$31.00	Vazquez Rodolfo&Diana
638 310 35 00	1.00	SFD	3	1.00	1.00	1.00	\$31.00	\$31.00	Shadoan James A
638 310 36 00	1.00	SFD	3	1.00	1.00	1.00	\$31.00	\$31.00	River Rock Investments Inc
638 310 37 00	1.00	SFD	3	1.00	1.00	1.00	\$31.00	\$31.00	Gutierrez Yazmin M
638 310 38 00	1.00	SFD	3	1.00	1.00	1.00	\$31.00	\$31.00	Sanchez Jorge A&Toscano Maria Magdalena
638 310 39 00	1.00	SFD	3	1.00	1.00	1.00	\$31.00	\$31.00	Aguilar Victor Jr&Eva
638 310 40 00	1.00	SFD	3	1.00	1.00	1.00	\$31.00	\$31.00	Engel/Elliott Trust 11-16-15
638 310 41 00	1.00	SFD	3	1.00	1.00	1.00	\$31.00	\$31.00	Ceniceros Ricardo Jr&Tania J
638 310 42 00	1.00	SFD	3	1.00	1.00	1.00	\$31.00	\$31.00	Romero Hector
638 310 43 00	1.00	SFD	3	1.00	1.00	1.00	\$31.00	\$31.00	Silva Cesar&Sylvia
638 310 44 00	0.40	OSP	3	0.00	0.40	0.00	\$31.00	\$0.00	Remington Hills Homeowners Assn
638 310 45 00	1.00	SFD	3	1.00	1.00	1.00	\$31.00	\$31.00	Barbin Nicholas&Nubia
638 310 46 00	1.00	SFD	3	1.00	1.00	1.00	\$31.00	\$31.00	Ponder Erik
638 320 01 00	1.00	SFD	3	1.00	1.00	1.00	\$31.00	\$31.00	Caudillo Fernando
638 320 02 00	1.00	SFD	3	1.00	1.00	1.00	\$31.00	\$31.00	Escasan-Leal Jorge A&Adriana R
638 320 03 00	1.00	SFD	3	1.00	1.00	1.00	\$31.00	\$31.00	Stephenson Alphonso Jr&Calderon Esther A
638 320 04 00	1.00	SFD	3	1.00	1.00	1.00	\$31.00	\$31.00	Castaneda Wilbert J&Amairany V
638 320 05 00	1.00	SFD	3	1.00	1.00	1.00	\$31.00	\$31.00	Morales Juan A
638 320 06 00	1.00	SFD	3	1.00	1.00	1.00	\$31.00	\$31.00	Rangel Jorge J&Carolina G
638 320 07 00	1.00	SFD	3	1.00	1.00	1.00	\$31.00	\$31.00	Ramos Omar A&Sara V
638 320 08 00	1.00	SFD	3	1.00	1.00	1.00	\$31.00	\$31.00	Preciado M G V Trust 11-23-11
638 320 09 00	1.00	SFD	3	1.00	1.00	1.00	\$31.00	\$31.00	Baldi Pasquale J
638 320 10 00	1.00	SFD	3	1.00	1.00	1.00	\$31.00	\$31.00	Brambila Antonio&Georgina C
638 320 11 00	1.00	SFD	3	1.00	1.00	1.00	\$31.00	\$31.00	Mendoza Gabriela
638 320 12 00	1.00	SFD	3	1.00	1.00	1.00	\$31.00	\$31.00	Garcia Eduardo&Martinez Maria J
638 320 13 00	1.00	SFD	3	1.00	1.00	1.00	\$31.00	\$31.00	Aguilar David
638 320 14 00	1.00	SFD	3	1.00	1.00	1.00	\$31.00	\$31.00	Decaprio Derek A&Wendy A
638 320 15 00	1.00	SFD	3	1.00	1.00	1.00	\$31.00	\$31.00	Cheang Carlos A&Delia N

EXHIBIT C - Assessment Roll (Fiscal Year 2018)
Remington Hills Maintenance Assessment District

Parcel Number	Acres/ Units ⁽¹⁾	Land Use ⁽²⁾	NW Otay Zone	Apportionment Factors		Total EBUs	FY 2018 ⁽⁴⁾		Owner Name
				Land Use ⁽²⁾	Benefit ⁽³⁾		Unit Cost	Assessment	
638 320 16 00	1.00	SFD	3	1.00	1.00	1.00	\$31.00	\$31.00	Vida Ricky J
638 320 17 00	1.00	SFD	3	1.00	1.00	1.00	\$31.00	\$31.00	Osorio Cesar
638 320 18 00	1.00	SFD	3	1.00	1.00	1.00	\$31.00	\$31.00	Briseno-Cabrera Mario
638 320 19 00	1.00	SFD	3	1.00	1.00	1.00	\$31.00	\$31.00	Fielden Howard D Jr&Santa F
638 320 20 00	1.00	SFD	3	1.00	1.00	1.00	\$31.00	\$31.00	Turnquest Bruce
638 320 21 00	1.00	SFD	3	1.00	1.00	1.00	\$31.00	\$31.00	Mendez Victor
638 320 22 00	1.00	SFD	3	1.00	1.00	1.00	\$31.00	\$31.00	Godoy Araceli
638 320 23 00	1.00	SFD	3	1.00	1.00	1.00	\$31.00	\$31.00	Ruesga German
638 320 24 00	1.00	SFD	3	1.00	1.00	1.00	\$31.00	\$31.00	Delafuente Juan
638 320 25 00	1.00	SFD	3	1.00	1.00	1.00	\$31.00	\$31.00	Paglinawan Kaylord P&Donnalyn L
638 320 26 00	1.00	SFD	3	1.00	1.00	1.00	\$31.00	\$31.00	Lasbury Walter T Iii&Ana G B
638 320 27 00	1.00	SFD	3	1.00	1.00	1.00	\$31.00	\$31.00	Delgadillo Gerardo&Blanca
638 320 28 00	1.00	SFD	3	1.00	1.00	1.00	\$31.00	\$31.00	Ho Family Trust 08-02-13
638 320 29 00	1.00	SFD	3	1.00	1.00	1.00	\$31.00	\$31.00	Silverstein Jay E&Shirin
638 320 30 00	1.00	SFD	3	1.00	1.00	1.00	\$31.00	\$31.00	Cazares Brandon
638 320 31 00	1.00	SFD	3	1.00	1.00	1.00	\$31.00	\$31.00	Santiago Reginald
638 320 32 00	1.00	SFD	3	1.00	1.00	1.00	\$31.00	\$31.00	Rudsenske Scott
638 320 33 00	1.00	SFD	3	1.00	1.00	1.00	\$31.00	\$31.00	Leree Ramon A&Soto-Meza Marlin E
638 320 34 00	1.00	SFD	3	1.00	1.00	1.00	\$31.00	\$31.00	Medina Joshua&Ivone
638 320 35 00	1.00	SFD	3	1.00	1.00	1.00	\$31.00	\$31.00	Montes Liliana
638 320 36 00	1.00	SFD	3	1.00	1.00	1.00	\$31.00	\$31.00	Valdez Antonio M&Mariaana L
638 320 37 00	1.00	SFD	3	1.00	1.00	1.00	\$31.00	\$31.00	Melchor Santiago
638 320 38 00	1.00	SFD	3	1.00	1.00	1.00	\$31.00	\$31.00	Castro Octavio&Yadria
638 320 39 00	3.70	OSP	3	0.00	0.40	0.00	\$31.00	\$0.00	Remington Hills Homeowners Assn
638 320 40 00	0.96	OSP	3	0.00	0.40	0.00	\$31.00	\$0.00	Remington Hills Homeowners Assn
638 320 41 00	0.58	OSP	3	0.00	0.40	0.00	\$31.00	\$0.00	Remington Hills Homeowners Assn
638 321 01 00	1.00	SFD	3	1.00	1.00	1.00	\$31.00	\$31.00	Loewy Arthur A&Viridiana
638 321 02 00	1.00	SFD	3	1.00	1.00	1.00	\$31.00	\$31.00	Lopez Byron&Tara
638 321 03 00	1.00	SFD	3	1.00	1.00	1.00	\$31.00	\$31.00	Carcamo Israel
638 321 04 00	1.00	SFD	3	1.00	1.00	1.00	\$31.00	\$31.00	Eizenhoefer Wesley&Jovanna
638 321 05 00	1.00	SFD	3	1.00	1.00	1.00	\$31.00	\$31.00	Scroggins Dennis
638 321 06 00	1.00	SFD	3	1.00	1.00	1.00	\$31.00	\$31.00	Rodriguez Danilo O Jr&Perlita P
638 321 07 00	1.00	SFD	3	1.00	1.00	1.00	\$31.00	\$31.00	Smith Frank L
638 321 08 00	1.00	SFD	3	1.00	1.00	1.00	\$31.00	\$31.00	Fariborz Farshid
638 321 09 00	1.00	SFD	3	1.00	1.00	1.00	\$31.00	\$31.00	Cothorn John A&Caroline L
638 321 10 00	1.00	SFD	3	1.00	1.00	1.00	\$31.00	\$31.00	Sanders Adrienne T
638 321 11 00	1.00	SFD	3	1.00	1.00	1.00	\$31.00	\$31.00	Argueta Armando Sr
638 321 12 00	1.00	SFD	3	1.00	1.00	1.00	\$31.00	\$31.00	Serrano Gabriel&Rios Lillian
638 321 13 00	1.00	SFD	3	1.00	1.00	1.00	\$31.00	\$31.00	Ferguson Drue
638 321 14 00	1.00	SFD	3	1.00	1.00	1.00	\$31.00	\$31.00	Velasquez Paul B&Angelica S
638 321 15 00	1.00	SFD	3	1.00	1.00	1.00	\$31.00	\$31.00	Perez Alejandro&Gomez Roxana
638 321 16 00	1.00	SFD	3	1.00	1.00	1.00	\$31.00	\$31.00	Delrio Victor
638 321 17 00	1.00	SFD	3	1.00	1.00	1.00	\$31.00	\$31.00	Montagne Matthew R
638 321 18 00	1.00	SFD	3	1.00	1.00	1.00	\$31.00	\$31.00	Castro Maria D J
638 321 19 00	1.00	SFD	3	1.00	1.00	1.00	\$31.00	\$31.00	Munoz Jose J&Nora P
638 321 20 00	1.00	SFD	3	1.00	1.00	1.00	\$31.00	\$31.00	Quintero Jose R
638 321 21 00	1.00	SFD	3	1.00	1.00	1.00	\$31.00	\$31.00	Cormier-Watson 2015 Trust 06-17-15
638 321 22 00	1.00	SFD	3	1.00	1.00	1.00	\$31.00	\$31.00	Hawari Rami R
638 321 23 00	1.00	SFD	3	1.00	1.00	1.00	\$31.00	\$31.00	Cunningham Craig K&Cindy E
638 321 24 00	1.00	SFD	3	1.00	1.00	1.00	\$31.00	\$31.00	Velazquez Juan G&Rivera Dania K
638 321 25 00	1.00	SFD	3	1.00	1.00	1.00	\$31.00	\$31.00	Romero-Martinez Luis O&Romero-Garcia Vanesa L
638 321 26 00	1.00	SFD	3	1.00	1.00	1.00	\$31.00	\$31.00	Martinez Miguel
638 321 27 00	1.00	SFD	3	1.00	1.00	1.00	\$31.00	\$31.00	Osuna Martha
638 321 28 00	1.00	SFD	3	1.00	1.00	1.00	\$31.00	\$31.00	Villasenor Nicolas&Maria A
638 321 29 00	1.00	SFD	3	1.00	1.00	1.00	\$31.00	\$31.00	Moriarty Michael A
638 321 30 00	1.00	SFD	3	1.00	1.00	1.00	\$31.00	\$31.00	Diaz Juan R Trust 09-20-01
638 321 31 00	1.00	SFD	3	1.00	1.00	1.00	\$31.00	\$31.00	Aguayo Raymond&Beatrice
638 321 32 00	1.00	SFD	3	1.00	1.00	1.00	\$31.00	\$31.00	Sheikh Nasir&Estela M
638 321 33 00	1.00	SFD	3	1.00	1.00	1.00	\$31.00	\$31.00	Wyatt Court Trust
638 321 34 00	1.00	SFD	3	1.00	1.00	1.00	\$31.00	\$31.00	Quiroga Raziel

EXHIBIT C - Assessment Roll (Fiscal Year 2018)
Remington Hills Maintenance Assessment District

Parcel Number	Acres/ Units ⁽¹⁾	Land Use ⁽²⁾	NW Otay Zone	Apportionment Factors		Total EBUs	FY 2018 ⁽⁴⁾		Owner Name
				Land Use ⁽²⁾	Benefit ⁽³⁾		Unit Cost	Assessment	
638 321 35 00	1.00	SFD	3	1.00	1.00	1.00	\$31.00	\$31.00	Murphy Kelley M&Carmen
638 321 36 00	1.00	SFD	3	1.00	1.00	1.00	\$31.00	\$31.00	Williams Scott A&Rice Debra L
638 321 37 00	1.00	SFD	3	1.00	1.00	1.00	\$31.00	\$31.00	Romo Miguel R&Judith E
638 321 38 00	1.00	SFD	3	1.00	1.00	1.00	\$31.00	\$31.00	Davis Carl D&La-Thea S
638 321 39 00	1.00	SFD	3	1.00	1.00	1.00	\$31.00	\$31.00	Sanchez Javier
638 321 40 00	1.00	SFD	3	1.00	1.00	1.00	\$31.00	\$31.00	Flores David E Jr&Beatriz M
638 321 41 00	1.00	SFD	3	1.00	1.00	1.00	\$31.00	\$31.00	Torres Maria M F Revocable 2006 Trust 01-31-06
638 321 42 00	1.00	SFD	3	1.00	1.00	1.00	\$31.00	\$31.00	Belchez Roberto L&Buena R
638 321 43 00	1.00	SFD	3	1.00	1.00	1.00	\$31.00	\$31.00	Jimenez Salvador
638 321 44 00	1.00	SFD	3	1.00	1.00	1.00	\$31.00	\$31.00	Avila Vicente&Margarita
638 321 45 00	1.00	SFD	3	1.00	1.00	1.00	\$31.00	\$31.00	Navarro Alejandro&Maria
638 321 46 00	1.00	SFD	3	1.00	1.00	1.00	\$31.00	\$31.00	Burks Family Trust 09-13-06
638 321 47 00	1.00	SFD	3	1.00	1.00	1.00	\$31.00	\$31.00	Walters Monica M
638 321 48 00	1.00	SFD	3	1.00	1.00	1.00	\$31.00	\$31.00	Hidalgo Marvelo R&Annabelle M
638 321 49 00	1.00	SFD	3	1.00	1.00	1.00	\$31.00	\$31.00	Mahmood Abdul H&Villarreal Elizabeth H
638 321 50 00	1.00	SFD	3	1.00	1.00	1.00	\$31.00	\$31.00	Miranda Victor&Norma
638 321 51 00	1.53	OSP	3	0.00	0.40	0.00	\$31.00	\$0.00	Remington Hills Homeowners Assn
638 321 52 00	0.62	OSP	3	0.00	0.40	0.00	\$31.00	\$0.00	Remington Hills Homeowners Assn
645 060 20 00	3.12	OSP	3	0.00	0.40	0.00	\$31.00	\$0.00	City Of San Diego
645 060 40 00	9.74	OSP	3	0.00	0.40	0.00	\$31.00	\$0.00	City Of San Diego
645 060 42 00	18.25	OSP	3	0.00	0.40	0.00	\$31.00	\$0.00	City Of San Diego
645 060 43 01	1.00	CND	3	0.70	1.00	0.70	\$31.00	\$21.70	Searight Marcos D&Fallon C
645 060 43 02	1.00	CND	3	0.70	1.00	0.70	\$31.00	\$21.70	Martinez Julian&Bedoya Melissa R
645 060 43 03	1.00	CND	3	0.70	1.00	0.70	\$31.00	\$21.70	Armenta Susan M
645 060 43 04	1.00	CND	3	0.70	1.00	0.70	\$31.00	\$21.70	Salvatierra Valentin B&Brijandez Melitza C H
645 060 43 05	1.00	CND	3	0.70	1.00	0.70	\$31.00	\$21.70	Murguia Oscar D&Claudia I
645 060 43 06	1.00	CND	3	0.70	1.00	0.70	\$31.00	\$21.70	Cadena Juan E&Garibay Alicia
645 060 43 07	1.00	CND	3	0.70	1.00	0.70	\$31.00	\$21.70	Bento Trenell R
645 060 43 08	1.00	CND	3	0.70	1.00	0.70	\$31.00	\$21.70	Riojas Lucas A&Jessica C
645 060 43 09	1.00	CND	3	0.70	1.00	0.70	\$31.00	\$21.70	Nalelia Gilbert P
645 060 43 10	1.00	CND	3	0.70	1.00	0.70	\$31.00	\$21.70	Corral Alfredo G Jr&Ramirez Georgina
645 060 43 11	1.00	CND	3	0.70	1.00	0.70	\$31.00	\$21.70	Sharp Brendan M&Jacqueline D
645 060 43 12	1.00	CND	3	0.70	1.00	0.70	\$31.00	\$21.70	Rojas Francisco
645 060 43 13	1.00	CND	3	0.70	1.00	0.70	\$31.00	\$21.70	Alexander Bernard M&Marion C
645 060 43 14	1.00	CND	3	0.70	1.00	0.70	\$31.00	\$21.70	Lopez Rosamelia
645 060 43 15	1.00	CND	3	0.70	1.00	0.70	\$31.00	\$21.70	West Chasity S
645 060 43 16	1.00	CND	3	0.70	1.00	0.70	\$31.00	\$21.70	Salazar Ruffie D&Arien N Q
645 060 44 01	1.00	CND	3	0.70	1.00	0.70	\$31.00	\$21.70	Steele Laverne
645 060 44 02	1.00	CND	3	0.70	1.00	0.70	\$31.00	\$21.70	Lopez Pedro P
645 060 44 03	1.00	CND	3	0.70	1.00	0.70	\$31.00	\$21.70	Tran Hung D&Sharonda L
645 060 44 04	1.00	CND	3	0.70	1.00	0.70	\$31.00	\$21.70	Villa Beatrice D
645 060 44 05	1.00	CND	3	0.70	1.00	0.70	\$31.00	\$21.70	Johnson Jermaine D
645 060 44 06	1.00	CND	3	0.70	1.00	0.70	\$31.00	\$21.70	Wilson Christopher&Barra Cynthia
645 060 44 07	1.00	CND	3	0.70	1.00	0.70	\$31.00	\$21.70	Guile Ryan&Amanda S
645 060 44 08	1.00	CND	3	0.70	1.00	0.70	\$31.00	\$21.70	Cabrera Fredy O D&Yoko D
645 060 44 09	1.00	CND	3	0.70	1.00	0.70	\$31.00	\$21.70	Perez Benny C&Irene Y
645 060 44 10	1.00	CND	3	0.70	1.00	0.70	\$31.00	\$21.70	Briggs Ethan F&Nancy P
645 060 44 11	1.00	CND	3	0.70	1.00	0.70	\$31.00	\$21.70	Stricklin Kris E Ii
645 060 44 12	1.00	CND	3	0.70	1.00	0.70	\$31.00	\$21.70	Blossom Raymond A Jr
645 060 44 13	1.00	CND	3	0.70	1.00	0.70	\$31.00	\$21.70	Baker Augustus Iv&Tavasz-Baker Adrienn T
645 060 44 14	1.00	CND	3	0.70	1.00	0.70	\$31.00	\$21.70	Bent Zayeir T&Cleopatra M
645 060 45 01	1.00	CND	3	0.70	1.00	0.70	\$31.00	\$21.70	Quintal Juan C
645 060 45 02	1.00	CND	3	0.70	1.00	0.70	\$31.00	\$21.70	Gregory Lenore M
645 060 45 03	1.00	CND	3	0.70	1.00	0.70	\$31.00	\$21.70	Elisea Oscar
645 060 45 04	1.00	CND	3	0.70	1.00	0.70	\$31.00	\$21.70	Pena Silfredo&Liliana V D
645 060 45 05	1.00	CND	3	0.70	1.00	0.70	\$31.00	\$21.70	Mabe Logan M&Brittany B
645 060 45 06	1.00	CND	3	0.70	1.00	0.70	\$31.00	\$21.70	Remigio Angel&Fabiola
645 060 45 07	1.00	CND	3	0.70	1.00	0.70	\$31.00	\$21.70	Valazquez Eleazar&Velazquez Paola A
645 060 45 08	1.00	CND	3	0.70	1.00	0.70	\$31.00	\$21.70	Gandara Paola
645 060 45 09	1.00	CND	3	0.70	1.00	0.70	\$31.00	\$21.70	Wang Wei&Jiang Ping

EXHIBIT C - Assessment Roll (Fiscal Year 2018)
Remington Hills Maintenance Assessment District

Parcel Number	Acres/ Units ⁽¹⁾	Land Use ⁽²⁾	NW Otay Zone	Apportionment Factors		Total EBUs	FY 2018 ⁽⁴⁾		Owner Name
				Land Use ⁽²⁾	Benefit ⁽³⁾		Unit Cost	Assessment	
645 060 45 10	1.00	CND	3	0.70	1.00	0.70	\$31.00	\$21.70	Saeed Nabeel Afzal&Zaidi Quratulann
645 060 46 00	2.90	UND	3	0.00	0.40	0.00	\$31.00	\$0.00	Pardee Homes
645 320 01 00	1.00	SFD	3	1.00	1.00	1.00	\$31.00	\$31.00	Barclay Brian&Gwendolyn
645 320 02 00	1.00	SFD	3	1.00	1.00	1.00	\$31.00	\$31.00	Cannon Matthew W&Chauncey B
645 320 03 00	1.00	SFD	3	1.00	1.00	1.00	\$31.00	\$31.00	Ballesteros Gerardo L Jr&Maria I
645 320 04 00	1.00	SFD	3	1.00	1.00	1.00	\$31.00	\$31.00	Franco Jesus&Aliza
645 320 05 00	1.00	SFD	3	1.00	1.00	1.00	\$31.00	\$31.00	Perez Joe L&Laura
645 320 06 00	1.00	SFD	3	1.00	1.00	1.00	\$31.00	\$31.00	Medina Alex&Jackie
645 320 07 00	1.00	SFD	3	1.00	1.00	1.00	\$31.00	\$31.00	Hernandez Michael A
645 320 08 00	1.00	SFD	3	1.00	1.00	1.00	\$31.00	\$31.00	Sutakul Norranut&Huizar Socorro
645 320 09 00	1.00	SFD	3	1.00	1.00	1.00	\$31.00	\$31.00	Vizcaino Joe A&Maria C
645 320 10 00	1.00	SFD	3	1.00	1.00	1.00	\$31.00	\$31.00	Gutierrez Ismael
645 320 11 00	1.00	SFD	3	1.00	1.00	1.00	\$31.00	\$31.00	Balderas Raul V 2016 Revocable Trust
645 320 12 00	1.00	SFD	3	1.00	1.00	1.00	\$31.00	\$31.00	Delgado Jimmy V
645 320 13 00	1.00	SFD	3	1.00	1.00	1.00	\$31.00	\$31.00	Inocencio Ruben V&Hazel A
645 320 14 00	1.00	SFD	3	1.00	1.00	1.00	\$31.00	\$31.00	Salazar Livier
645 320 15 00	1.00	SFD	3	1.00	1.00	1.00	\$31.00	\$31.00	Lopez Juan&Rebecca
645 320 16 00	1.00	SFD	3	1.00	1.00	1.00	\$31.00	\$31.00	Casillas Jose L
645 320 17 00	1.00	SFD	3	1.00	1.00	1.00	\$31.00	\$31.00	Duarte Andrew J
645 320 18 00	1.00	SFD	3	1.00	1.00	1.00	\$31.00	\$31.00	Gaxiola Juan T
645 320 19 00	1.00	SFD	3	1.00	1.00	1.00	\$31.00	\$31.00	Rangel Cesar&Anna E
645 320 20 00	1.00	SFD	3	1.00	1.00	1.00	\$31.00	\$31.00	Razo Hector
645 320 21 00	1.00	SFD	3	1.00	1.00	1.00	\$31.00	\$31.00	Saracho Joseph C
645 320 22 00	1.00	SFD	3	1.00	1.00	1.00	\$31.00	\$31.00	Spencer Alberto Z
645 320 23 00	1.00	SFD	3	1.00	1.00	1.00	\$31.00	\$31.00	Sanchez Jose A
645 320 24 00	1.00	SFD	3	1.00	1.00	1.00	\$31.00	\$31.00	Castillo-Urquidez Rudy A
645 320 25 00	1.00	SFD	3	1.00	1.00	1.00	\$31.00	\$31.00	Merrick Brandon&Ashley
645 320 26 00	1.00	SFD	3	1.00	1.00	1.00	\$31.00	\$31.00	Huizar Carlos&Rosa M
645 320 27 00	1.00	SFD	3	1.00	1.00	1.00	\$31.00	\$31.00	Murrillo Juan P
645 320 28 00	1.00	SFD	3	1.00	1.00	1.00	\$31.00	\$31.00	Vazquez Vicente&Gisela
645 320 29 00	1.00	SFD	3	1.00	1.00	1.00	\$31.00	\$31.00	Gonzalez Laurentino&Thelma E B
645 320 30 00	1.00	SFD	3	1.00	1.00	1.00	\$31.00	\$31.00	Zelaya Antonio H&Jennifer
645 320 31 00	1.00	SFD	3	1.00	1.00	1.00	\$31.00	\$31.00	Morrow Nathan C
645 320 32 00	1.00	SFD	3	1.00	1.00	1.00	\$31.00	\$31.00	Martinez David A&Lorena
645 320 33 00	1.00	SFD	3	1.00	1.00	1.00	\$31.00	\$31.00	Bautista Ruben D&Bernadette H
645 320 34 00	1.00	SFD	3	1.00	1.00	1.00	\$31.00	\$31.00	Llamas Christian&Claudia
645 320 35 00	1.00	SFD	3	1.00	1.00	1.00	\$31.00	\$31.00	Perea Dennis&Erika
645 320 36 00	1.00	SFD	3	1.00	1.00	1.00	\$31.00	\$31.00	Olave Raul D&Lacasha S
645 320 37 00	1.00	SFD	3	1.00	1.00	1.00	\$31.00	\$31.00	Lorenzana Jaime L&Vivian N
645 320 38 00	1.00	SFD	3	1.00	1.00	1.00	\$31.00	\$31.00	Alvarado Herman R&Marisela
645 320 39 00	1.00	SFD	3	1.00	1.00	1.00	\$31.00	\$31.00	Gutierrez Jorge H
645 320 40 00	1.00	SFD	3	1.00	1.00	1.00	\$31.00	\$31.00	Jepsen William T
645 320 41 00	1.00	SFD	3	1.00	1.00	1.00	\$31.00	\$31.00	Edwards Tina
645 320 42 00	1.00	SFD	3	1.00	1.00	1.00	\$31.00	\$31.00	Mattis Maria&Terrence Family Trust
645 320 43 00	1.00	SFD	3	1.00	1.00	1.00	\$31.00	\$31.00	Frutos Erwin&Gonzalez E
645 320 44 00	1.00	SFD	3	1.00	1.00	1.00	\$31.00	\$31.00	Ramos Alfredo&Elena
645 320 45 00	1.00	SFD	3	1.00	1.00	1.00	\$31.00	\$31.00	Gonzales Augustin&Maria J
645 320 46 00	1.00	SFD	3	1.00	1.00	1.00	\$31.00	\$31.00	Becerra Dagoberto&Maria-Elena
645 320 47 00	1.00	SFD	3	1.00	1.00	1.00	\$31.00	\$31.00	Nunez Joseph
645 320 48 00	1.00	SFD	3	1.00	1.00	1.00	\$31.00	\$31.00	Garcia Daniel&Cualli
645 320 49 00	1.00	SFD	3	1.00	1.00	1.00	\$31.00	\$31.00	Chavez Salvador J&Monique
645 320 50 00	1.00	SFD	3	1.00	1.00	1.00	\$31.00	\$31.00	Gutierrez Alfonso&Samantha L
645 320 51 00	1.00	SFD	3	1.00	1.00	1.00	\$31.00	\$31.00	Messina Pascal E&Ana L
645 320 52 00	1.00	SFD	3	1.00	1.00	1.00	\$31.00	\$31.00	Ramirez Luz
645 320 53 00	1.00	SFD	3	1.00	1.00	1.00	\$31.00	\$31.00	Moreno Yolanda
645 320 54 00	1.00	SFD	3	1.00	1.00	1.00	\$31.00	\$31.00	Gandarilla Carlos M&Nancy J
645 320 55 00	1.00	SFD	3	1.00	1.00	1.00	\$31.00	\$31.00	Landeros Margarito&Laura
645 320 56 00	1.00	SFD	3	1.00	1.00	1.00	\$31.00	\$31.00	Kast Daniel J
645 320 57 00	1.00	SFD	3	1.00	1.00	1.00	\$31.00	\$31.00	Anaya Brenda S
645 320 58 00	1.00	SFD	3	1.00	1.00	1.00	\$31.00	\$31.00	Peach Thomas R

EXHIBIT C - Assessment Roll (Fiscal Year 2018)
Remington Hills Maintenance Assessment District

Parcel Number	Acres/ Units ⁽¹⁾	Land Use ⁽²⁾	NW Otay Zone	Apportionment Factors		Total EBUs	FY 2018 ⁽⁴⁾		Owner Name
				Land Use ⁽²⁾	Benefit ⁽³⁾		Unit Cost	Assessment	
645 320 59 00	1.00	SFD	3	1.00	1.00	1.00	\$31.00	\$31.00	Park Gyu Jang&Susan
645 320 60 00	1.00	SFD	3	1.00	1.00	1.00	\$31.00	\$31.00	Quiambao Ronaldo&Annabelle
645 320 61 00	1.00	SFD	3	1.00	1.00	1.00	\$31.00	\$31.00	Rodriguez Charles S&Andrea M
645 320 62 00	1.00	SFD	3	1.00	1.00	1.00	\$31.00	\$31.00	Hernandez Yolanda M
645 320 63 00	1.00	SFD	3	1.00	1.00	1.00	\$31.00	\$31.00	Mitchell Trevor D&Melissa
645 320 64 00	1.00	SFD	3	1.00	1.00	1.00	\$31.00	\$31.00	Tamoria Gary D&Jonah F
645 320 65 00	1.00	SFD	3	1.00	1.00	1.00	\$31.00	\$31.00	Acosta Jesus S&Norma L
645 320 66 00	1.00	SFD	3	1.00	1.00	1.00	\$31.00	\$31.00	Herrera Jorge E&Adriana
645 320 67 00	1.00	SFD	3	1.00	1.00	1.00	\$31.00	\$31.00	Munoz Juan A&Alfaro Rosa
645 320 68 00	1.00	SFD	3	1.00	1.00	1.00	\$31.00	\$31.00	Mejia Jose L
645 320 69 00	1.00	SFD	3	1.00	1.00	1.00	\$31.00	\$31.00	Zavala Abel Jr&Luz Maritza
645 320 70 00	1.00	SFD	3	1.00	1.00	1.00	\$31.00	\$31.00	Arevalo Guillermo&Eva
645 320 71 00	0.27	OSP	3	0.00	0.40	0.00	\$31.00	\$0.00	Remington Hills Homeowners Assn
645 320 72 00	1.67	OSP	3	0.00	0.40	0.00	\$31.00	\$0.00	Remington Hills Homeowners Assn
645 320 73 00	2.64	OSP	3	0.00	0.40	0.00	\$31.00	\$0.00	Remington Hills Homeowners Assn
645 340 01 00	1.00	SFD	3	1.00	1.00	1.00	\$31.00	\$31.00	Dykstra Paul E&Libby D
645 340 02 00	1.00	SFD	3	1.00	1.00	1.00	\$31.00	\$31.00	Ramirez Evangelina F
645 340 03 00	1.00	SFD	3	1.00	1.00	1.00	\$31.00	\$31.00	Velazco Sergio L Jr&Garcia Leonor E
645 340 04 00	1.00	SFD	3	1.00	1.00	1.00	\$31.00	\$31.00	Valdez German&Edith L
645 340 05 00	1.00	SFD	3	1.00	1.00	1.00	\$31.00	\$31.00	Romano Sergio&Aida
645 340 06 00	1.00	SFD	3	1.00	1.00	1.00	\$31.00	\$31.00	Martinez Manuel&Gomez-Huerta Mariana
645 340 07 00	1.00	SFD	3	1.00	1.00	1.00	\$31.00	\$31.00	Quezada Jose J&Corona Bertha P
645 340 08 00	1.00	SFD	3	1.00	1.00	1.00	\$31.00	\$31.00	Gomez David&Susan
645 340 09 00	1.00	SFD	3	1.00	1.00	1.00	\$31.00	\$31.00	Pecus Edward S&Lisa M
645 340 10 00	1.00	SFD	3	1.00	1.00	1.00	\$31.00	\$31.00	Tamez Jose R&Mendoza Rocio M
645 340 11 00	1.00	SFD	3	1.00	1.00	1.00	\$31.00	\$31.00	Calaycay Ferdinand&Maria L M
645 340 12 00	1.00	SFD	3	1.00	1.00	1.00	\$31.00	\$31.00	Tirey David K
645 340 13 00	1.00	SFD	3	1.00	1.00	1.00	\$31.00	\$31.00	Ortega Alejandro&Anabel
645 340 14 00	1.00	SFD	3	1.00	1.00	1.00	\$31.00	\$31.00	5252 Sandbar Cove Way Llc
645 340 15 00	1.00	SFD	3	1.00	1.00	1.00	\$31.00	\$31.00	Elizarraras Carlos A
645 340 16 00	1.00	SFD	3	1.00	1.00	1.00	\$31.00	\$31.00	Mercado Victor M G
645 340 17 00	1.00	SFD	3	1.00	1.00	1.00	\$31.00	\$31.00	Gonzalez Guadalupe M
645 340 18 00	1.00	SFD	3	1.00	1.00	1.00	\$31.00	\$31.00	Rubio Family Trust 09-13-10
645 340 19 00	1.00	SFD	3	1.00	1.00	1.00	\$31.00	\$31.00	Cardenas Jose R&Martha V
645 340 20 00	1.00	SFD	3	1.00	1.00	1.00	\$31.00	\$31.00	Abdala Richard C&Leticia S
645 340 21 00	1.00	SFD	3	1.00	1.00	1.00	\$31.00	\$31.00	Martinez Leonel J&Baeza Lina P
645 340 22 00	1.00	SFD	3	1.00	1.00	1.00	\$31.00	\$31.00	Sharp Eric&Ruthann
645 340 23 00	1.00	SFD	3	1.00	1.00	1.00	\$31.00	\$31.00	Ortega Jose T&Sandra I
645 340 24 00	1.00	SFD	3	1.00	1.00	1.00	\$31.00	\$31.00	Wallace Peter R&Marygrace M
645 340 25 00	1.00	SFD	3	1.00	1.00	1.00	\$31.00	\$31.00	Enriquez Elizabeth
645 340 26 00	1.00	SFD	3	1.00	1.00	1.00	\$31.00	\$31.00	Aguinaldo Family Trust
645 340 27 00	1.00	SFD	3	1.00	1.00	1.00	\$31.00	\$31.00	Leyva Alfredo D C
645 340 28 00	1.00	SFD	3	1.00	1.00	1.00	\$31.00	\$31.00	Navarro Jason D&Maria L
645 340 29 00	1.00	SFD	3	1.00	1.00	1.00	\$31.00	\$31.00	Goff Jesse M
645 340 30 00	1.00	SFD	3	1.00	1.00	1.00	\$31.00	\$31.00	Muro Family Trust 08-29-12
645 340 31 00	1.00	SFD	3	1.00	1.00	1.00	\$31.00	\$31.00	Rendon Luis A D&Delatorre Gabriela R
645 340 32 00	1.00	SFD	3	1.00	1.00	1.00	\$31.00	\$31.00	Torres Jesus D&Rebecca V
645 340 33 00	1.00	SFD	3	1.00	1.00	1.00	\$31.00	\$31.00	Manuel Francisco B&Elaine C
645 340 34 00	1.00	SFD	3	1.00	1.00	1.00	\$31.00	\$31.00	Arambula Rudy M
645 340 35 00	1.00	SFD	3	1.00	1.00	1.00	\$31.00	\$31.00	Zendejas Daniel&Karla I
645 340 36 00	1.00	SFD	3	1.00	1.00	1.00	\$31.00	\$31.00	Gewaily Emad
645 340 37 00	1.00	SFD	3	1.00	1.00	1.00	\$31.00	\$31.00	Bower Richard M&Jocelyn
645 340 38 00	1.00	SFD	3	1.00	1.00	1.00	\$31.00	\$31.00	Castro Gerardo&Monica
645 340 39 00	1.00	SFD	3	1.00	1.00	1.00	\$31.00	\$31.00	Vazquez Carlos&Maria G
645 340 40 00	1.00	SFD	3	1.00	1.00	1.00	\$31.00	\$31.00	Cuevas Andres&Amanda
645 340 41 00	1.00	SFD	3	1.00	1.00	1.00	\$31.00	\$31.00	Munoz Roberto R&Laura E
645 340 42 00	1.00	SFD	3	1.00	1.00	1.00	\$31.00	\$31.00	Palomino Family Trust 11-17-03
645 340 43 00	1.00	SFD	3	1.00	1.00	1.00	\$31.00	\$31.00	Amio Marcan D&Suzette V
645 340 44 00	1.00	SFD	3	1.00	1.00	1.00	\$31.00	\$31.00	Frederick Russell L Sr&Maria
645 340 45 00	1.00	SFD	3	1.00	1.00	1.00	\$31.00	\$31.00	Mancilla George&Espinoza Bona

EXHIBIT C - Assessment Roll (Fiscal Year 2018)
Remington Hills Maintenance Assessment District

Parcel Number	Acres/ Units ⁽¹⁾	Land Use ⁽²⁾	NW Otay Zone	Apportionment Factors		Total EBUs	FY 2018 ⁽⁴⁾		Owner Name
				Land Use ⁽²⁾	Benefit ⁽³⁾		Unit Cost	Assessment	
645 340 46 00	1.00	SFD	3	1.00	1.00	1.00	\$31.00	\$31.00	Ibarra-Garcia Ana M
645 340 47 00	1.00	SFD	3	1.00	1.00	1.00	\$31.00	\$31.00	Thomas Michael
645 340 48 00	1.00	SFD	3	1.00	1.00	1.00	\$31.00	\$31.00	Borja Noel-Nino&Mary B C
645 340 49 00	1.00	SFD	3	1.00	1.00	1.00	\$31.00	\$31.00	Jaramilloquezada Veronica
645 340 50 00	1.00	SFD	3	1.00	1.00	1.00	\$31.00	\$31.00	Sison Robert C Jr&Merla H
645 340 51 00	0.26	OSP	3	0.00	0.40	0.00	\$31.00	\$0.00	Esmeralda Community Assn
645 341 01 00	1.00	SFD	3	1.00	1.00	1.00	\$31.00	\$31.00	Hundley L L C
645 341 02 00	1.00	SFD	3	1.00	1.00	1.00	\$31.00	\$31.00	Johnson Kenneth&Jewell
645 341 03 00	1.00	SFD	3	1.00	1.00	1.00	\$31.00	\$31.00	Gallardo Arnel C&Erlinda N
645 341 04 00	1.00	SFD	3	1.00	1.00	1.00	\$31.00	\$31.00	Chavez Juan&Maria
645 341 05 00	1.00	SFD	3	1.00	1.00	1.00	\$31.00	\$31.00	Rodriguez Juan J Jr&Jennifer D
645 341 06 00	1.00	SFD	3	1.00	1.00	1.00	\$31.00	\$31.00	Nevarez Julio
645 341 07 00	1.00	SFD	3	1.00	1.00	1.00	\$31.00	\$31.00	Martinez Alvarez Family Trust 07-30-09
645 341 08 00	1.00	SFD	3	1.00	1.00	1.00	\$31.00	\$31.00	Sandoval Martin P&Lopez-Gonzalez Olga L
645 341 09 00	1.00	SFD	3	1.00	1.00	1.00	\$31.00	\$31.00	Eagles Nest Trust 11-22-08
645 341 10 00	1.00	SFD	3	1.00	1.00	1.00	\$31.00	\$31.00	Bronder Bryan K&Zenaida M
645 341 11 00	1.00	SFD	3	1.00	1.00	1.00	\$31.00	\$31.00	Arreola Omar
645 341 12 00	1.00	SFD	3	1.00	1.00	1.00	\$31.00	\$31.00	Upchurch William L&Hortencia
645 341 13 00	1.00	SFD	3	1.00	1.00	1.00	\$31.00	\$31.00	Pena Jose R
645 341 14 00	1.00	SFD	3	1.00	1.00	1.00	\$31.00	\$31.00	Lopez Victor M T
645 341 15 00	1.00	SFD	3	1.00	1.00	1.00	\$31.00	\$31.00	Ruiz Fernando E A&Lopez Nancy C J
645 341 16 00	1.00	SFD	3	1.00	1.00	1.00	\$31.00	\$31.00	Nishimura Nozomu
645 341 17 00	1.00	SFD	3	1.00	1.00	1.00	\$31.00	\$31.00	Gandara Paola
645 341 18 00	1.00	SFD	3	1.00	1.00	1.00	\$31.00	\$31.00	Alfaro Jesus G&Soto Elizabeth
645 341 19 00	1.00	SFD	3	1.00	1.00	1.00	\$31.00	\$31.00	Heard Daniel B&Daisy
645 341 20 00	1.00	SFD	3	1.00	1.00	1.00	\$31.00	\$31.00	Marruenda Manuel Living Trust 04-25-08
645 341 21 00	1.00	SFD	3	1.00	1.00	1.00	\$31.00	\$31.00	Jones Wayne A&Trudy T
645 341 22 00	1.00	SFD	3	1.00	1.00	1.00	\$31.00	\$31.00	Santana Rafael N
645 341 23 00	1.00	SFD	3	1.00	1.00	1.00	\$31.00	\$31.00	Hucko Alice M Trust 05-11-93
645 341 24 00	1.00	SFD	3	1.00	1.00	1.00	\$31.00	\$31.00	Nevarez 2015 Revocable Trust
645 341 25 00	1.00	SFD	3	1.00	1.00	1.00	\$31.00	\$31.00	Castillo Pedro R
645 341 26 00	1.00	SFD	3	1.00	1.00	1.00	\$31.00	\$31.00	Rogers Jeffrey
645 341 27 00	1.00	SFD	3	1.00	1.00	1.00	\$31.00	\$31.00	Hammett James W Jr
645 341 28 00	1.00	SFD	3	1.00	1.00	1.00	\$31.00	\$31.00	C W A B S Inc No 2006-14
645 341 29 00	1.00	SFD	3	1.00	1.00	1.00	\$31.00	\$31.00	Ojeda Sergio&Veronica R
645 341 30 00	1.00	SFD	3	1.00	1.00	1.00	\$31.00	\$31.00	Ramirez Julian F&Flores Maria
645 341 31 00	1.00	SFD	3	1.00	1.00	1.00	\$31.00	\$31.00	Martinez Jose J li&Ruth K
645 341 32 00	1.00	SFD	3	1.00	1.00	1.00	\$31.00	\$31.00	Gillett Brenda E
645 341 33 00	1.00	SFD	3	1.00	1.00	1.00	\$31.00	\$31.00	Weisman Kevin
645 341 34 00	1.00	SFD	3	1.00	1.00	1.00	\$31.00	\$31.00	Carson Quintin&Alisa L 2016 Trust 10-12-16
645 341 35 00	1.00	SFD	3	1.00	1.00	1.00	\$31.00	\$31.00	Villanueva Frank&Arlene M
645 341 36 00	1.00	SFD	3	1.00	1.00	1.00	\$31.00	\$31.00	J R V Enterprises Llc
645 341 37 00	1.00	SFD	3	1.00	1.00	1.00	\$31.00	\$31.00	Moreno Carlos S
645 341 38 00	1.00	SFD	3	1.00	1.00	1.00	\$31.00	\$31.00	Covarrubias Luis&Ayala Erika
645 341 39 00	1.00	SFD	3	1.00	1.00	1.00	\$31.00	\$31.00	Ramirez Roberto S
645 341 40 00	1.00	SFD	3	1.00	1.00	1.00	\$31.00	\$31.00	Like Anthony&Cherie
645 341 41 00	1.00	SFD	3	1.00	1.00	1.00	\$31.00	\$31.00	Delorme-Walker Violaine D
645 341 42 00	1.00	SFD	3	1.00	1.00	1.00	\$31.00	\$31.00	Grant Alfred&Perriette
645 341 43 00	1.00	SFD	3	1.00	1.00	1.00	\$31.00	\$31.00	Favela Arnulfo J
645 341 44 00	1.00	SFD	3	1.00	1.00	1.00	\$31.00	\$31.00	Cai Jun&Yu Shuying
645 341 45 00	1.00	SFD	3	1.00	1.00	1.00	\$31.00	\$31.00	Gutierrez Adolfo S
645 341 46 00	1.00	SFD	3	1.00	1.00	1.00	\$31.00	\$31.00	Neri Eduardo B&Villa-Neri Diana V
645 341 47 00	1.00	SFD	3	1.00	1.00	1.00	\$31.00	\$31.00	Gravador Aldrich C C
645 341 48 00	1.00	SFD	3	1.00	1.00	1.00	\$31.00	\$31.00	Valencia Living Trust 21-01-11
645 341 49 00	1.00	SFD	3	1.00	1.00	1.00	\$31.00	\$31.00	Bornstein Michael L
645 341 50 00	1.00	SFD	3	1.00	1.00	1.00	\$31.00	\$31.00	Martinez Jose L&Luz M
645 341 51 00	1.00	SFD	3	1.00	1.00	1.00	\$31.00	\$31.00	Gillis Willie G Jr&Celestine
645 341 52 00	1.00	SFD	3	1.00	1.00	1.00	\$31.00	\$31.00	Fripp Jamaan D&Brown Marissa
645 341 53 00	1.00	SFD	3	1.00	1.00	1.00	\$31.00	\$31.00	Landeros Eduardo
645 341 54 00	1.00	SFD	3	1.00	1.00	1.00	\$31.00	\$31.00	Pedroza Jose C C

EXHIBIT C - Assessment Roll (Fiscal Year 2018)
Remington Hills Maintenance Assessment District

Parcel Number	Acres/ Units ⁽¹⁾	Land Use ⁽²⁾	NW Otay Zone	Apportionment Factors		Total EBUs	FY 2018 ⁽⁴⁾		Owner Name
				Land Use ⁽²⁾	Benefit ⁽³⁾		Unit Cost	Assessment	
645 341 55 00	1.00	SFD	3	1.00	1.00	1.00	\$31.00	\$31.00	Hernandez Elizabeth
645 341 56 00	1.00	SFD	3	1.00	1.00	1.00	\$31.00	\$31.00	Medina Guillermo&Rivas Rosa A
645 341 57 00	1.00	SFD	3	1.00	1.00	1.00	\$31.00	\$31.00	Lopez Carlos A&Alejandra
645 341 58 00	1.00	SFD	3	1.00	1.00	1.00	\$31.00	\$31.00	Mitchell Family Trust 04-18-13
645 341 59 00	1.00	SFD	3	1.00	1.00	1.00	\$31.00	\$31.00	Rolle Shavergo T&Keshona M
645 341 60 00	1.00	SFD	3	1.00	1.00	1.00	\$31.00	\$31.00	Dizon Roberto V
645 341 61 00	1.00	SFD	3	1.00	1.00	1.00	\$31.00	\$31.00	Strawser Geoffrey R Separate Property Trust 03-08-13
645 341 62 00	1.00	SFD	3	1.00	1.00	1.00	\$31.00	\$31.00	Webb Morgan R
645 341 63 00	1.00	SFD	3	1.00	1.00	1.00	\$31.00	\$31.00	Romo Saul&Deanda Yvette C
645 341 64 00	1.00	SFD	3	1.00	1.00	1.00	\$31.00	\$31.00	Mationg Alex O Jr&Michelle L
645 341 65 00	1.00	SFD	3	1.00	1.00	1.00	\$31.00	\$31.00	Jiles Marcus&Erica
645 341 66 00	1.00	SFD	3	1.00	1.00	1.00	\$31.00	\$31.00	Moya Sergio&Rosa M
645 341 67 00	1.00	SFD	3	1.00	1.00	1.00	\$31.00	\$31.00	Quinonez Jose&Olga
645 341 68 00	1.00	SFD	3	1.00	1.00	1.00	\$31.00	\$31.00	Beltran Aniceto
645 341 69 00	1.00	SFD	3	1.00	1.00	1.00	\$31.00	\$31.00	Jordan Oral&Mary
645 341 70 00	1.00	SFD	3	1.00	1.00	1.00	\$31.00	\$31.00	Perez Simplicio L Jr&Lani C
645 341 71 00	1.00	SFD	3	1.00	1.00	1.00	\$31.00	\$31.00	Raybert Trust
645 341 72 00	1.00	SFD	3	1.00	1.00	1.00	\$31.00	\$31.00	Shankula John S&Consolacion L
645 341 73 00	1.00	SFD	3	1.00	1.00	1.00	\$31.00	\$31.00	Abdala Armando
645 341 74 00	1.00	SFD	3	1.00	1.00	1.00	\$31.00	\$31.00	Ayala-Genel Eybar&Martinez-Hernandez Maria M
645 341 75 00	4.21	OSP	3	0.00	0.40	0.00	\$31.00	\$0.00	Esmeralda Community Assn
645 341 76 00	2.86	OSP	3	0.00	0.40	0.00	\$31.00	\$0.00	City Of San Diego
645 341 77 00	0.09	OSP	3	0.00	0.40	0.00	\$31.00	\$0.00	Esmeralda Community Assn
645 342 01 00	1.00	SFD	3	1.00	1.00	1.00	\$31.00	\$31.00	Nevarez 2015 Revocable Trust
645 342 02 00	1.00	SFD	3	1.00	1.00	1.00	\$31.00	\$31.00	Dominguez Fabian&Norma
645 342 03 00	1.00	SFD	3	1.00	1.00	1.00	\$31.00	\$31.00	Lafond Marty&Katina
645 342 04 00	1.00	SFD	3	1.00	1.00	1.00	\$31.00	\$31.00	Navarro Patricia G
645 342 05 00	1.00	SFD	3	1.00	1.00	1.00	\$31.00	\$31.00	Jara Rosalinda L
645 342 06 00	1.00	SFD	3	1.00	1.00	1.00	\$31.00	\$31.00	Dills Hope H Separate Property Trust 04-22-04
645 342 07 00	1.00	SFD	3	1.00	1.00	1.00	\$31.00	\$31.00	Lozada Ramon Z Jr&Margaret F
645 342 08 00	1.00	SFD	3	1.00	1.00	1.00	\$31.00	\$31.00	Smith Charles P&Ruth A
645 342 09 00	1.00	SFD	3	1.00	1.00	1.00	\$31.00	\$31.00	Rincon Fernando
645 342 10 00	1.00	SFD	3	1.00	1.00	1.00	\$31.00	\$31.00	Chavez Juan R&Monica
645 342 11 00	1.00	SFD	3	1.00	1.00	1.00	\$31.00	\$31.00	Aripez Jorge A
645 342 12 00	1.00	SFD	3	1.00	1.00	1.00	\$31.00	\$31.00	Rodriguez Martin B&Marcela
645 342 13 00	1.00	SFD	3	1.00	1.00	1.00	\$31.00	\$31.00	Jimenez Ventura Jr&Estella
645 342 14 00	1.00	SFD	3	1.00	1.00	1.00	\$31.00	\$31.00	Ramos Cesar&Maribel
645 342 15 00	1.00	SFD	3	1.00	1.00	1.00	\$31.00	\$31.00	Wentt Jason A&Soriano-Wentt Ofelia A
645 342 16 00	1.00	SFD	3	1.00	1.00	1.00	\$31.00	\$31.00	Rogers J
645 342 17 00	1.00	SFD	3	1.00	1.00	1.00	\$31.00	\$31.00	Prieto Deyanara Living Trust 01-04-06
645 342 18 00	1.00	SFD	3	1.00	1.00	1.00	\$31.00	\$31.00	Diaz Patricia A
645 342 19 00	1.00	SFD	3	1.00	1.00	1.00	\$31.00	\$31.00	Fernandez Vanessa
645 342 20 00	1.00	SFD	3	1.00	1.00	1.00	\$31.00	\$31.00	Fennell Paul&Latasha D
645 342 21 00	1.00	SFD	3	1.00	1.00	1.00	\$31.00	\$31.00	Houston Mailvin&Hill Lisa H
645 342 22 00	1.00	SFD	3	1.00	1.00	1.00	\$31.00	\$31.00	Ramirez Eduardo
645 342 23 00	1.00	SFD	3	1.00	1.00	1.00	\$31.00	\$31.00	Guillen Juan
645 342 24 00	1.00	SFD	3	1.00	1.00	1.00	\$31.00	\$31.00	Montano Frank D&Maria E
645 342 25 00	1.00	SFD	3	1.00	1.00	1.00	\$31.00	\$31.00	Ronque Reggie&Mary B
645 342 26 00	1.00	SFD	3	1.00	1.00	1.00	\$31.00	\$31.00	Hagadone Max&Mary
645 342 27 00	1.00	SFD	3	1.00	1.00	1.00	\$31.00	\$31.00	Echeagary Oscar A G
645 342 28 00	1.00	SFD	3	1.00	1.00	1.00	\$31.00	\$31.00	Garcia Francisco&Graciela
645 342 29 00	1.00	SFD	3	1.00	1.00	1.00	\$31.00	\$31.00	Estrada Miguel
645 342 30 00	1.00	SFD	3	1.00	1.00	1.00	\$31.00	\$31.00	Vazquez David J
645 342 31 00	1.00	SFD	3	1.00	1.00	1.00	\$31.00	\$31.00	Quraishi Sarosh A
645 342 32 00	1.00	SFD	3	1.00	1.00	1.00	\$31.00	\$31.00	Valdez Carlos&Ivett
645 342 33 00	1.00	SFD	3	1.00	1.00	1.00	\$31.00	\$31.00	Corotan Crescencio S&Eleanor A
645 342 34 00	1.00	SFD	3	1.00	1.00	1.00	\$31.00	\$31.00	Sotomayor Mark&Contreras Felipe D J G
645 342 35 00	1.00	SFD	3	1.00	1.00	1.00	\$31.00	\$31.00	Joaquin Francisco A&Milagros B
645 342 36 00	1.00	SFD	3	1.00	1.00	1.00	\$31.00	\$31.00	Rocha-Magana Arminda E
645 342 37 00	1.00	SFD	3	1.00	1.00	1.00	\$31.00	\$31.00	Smith Alton Leonard&Irene M

EXHIBIT C - Assessment Roll (Fiscal Year 2018)
Remington Hills Maintenance Assessment District

Parcel Number	Acres/ Units ⁽¹⁾	Land Use ⁽²⁾	NW Otay Zone	Apportionment Factors		Total EBUs	FY 2018 ⁽⁴⁾		Owner Name
				Land Use ⁽²⁾	Benefit ⁽³⁾		Unit Cost	Assessment	
645 342 38 00	1.00	SFD	3	1.00	1.00	1.00	\$31.00	\$31.00	Jungers Kevin C&Andrea C
645 342 39 00	1.00	SFD	3	1.00	1.00	1.00	\$31.00	\$31.00	Rodriguez Magdalena
645 342 40 00	1.00	SFD	3	1.00	1.00	1.00	\$31.00	\$31.00	Alvarado Ricardo&Magdalena S
645 342 41 00	1.00	SFD	3	1.00	1.00	1.00	\$31.00	\$31.00	Barghout Feras K
645 342 42 00	1.00	SFD	3	1.00	1.00	1.00	\$31.00	\$31.00	Ali Maram R
645 342 43 00	1.00	SFD	3	1.00	1.00	1.00	\$31.00	\$31.00	Arce Jesus
645 342 44 00	1.00	SFD	3	1.00	1.00	1.00	\$31.00	\$31.00	King Dion&Cristina R
645 342 45 00	1.00	SFD	3	1.00	1.00	1.00	\$31.00	\$31.00	Garay Joseph
645 342 46 00	1.00	SFD	3	1.00	1.00	1.00	\$31.00	\$31.00	Palma Malyne C S
645 342 47 00	1.00	SFD	3	1.00	1.00	1.00	\$31.00	\$31.00	Leyva Juan A&Maribel
645 342 48 00	1.00	SFD	3	1.00	1.00	1.00	\$31.00	\$31.00	Ayala Juan M&Marissa
645 342 49 00	1.00	SFD	3	1.00	1.00	1.00	\$31.00	\$31.00	Cano Pedro
645 342 50 00	1.00	SFD	3	1.00	1.00	1.00	\$31.00	\$31.00	Vaught Ryan&Yolanda
645 342 51 00	1.00	SFD	3	1.00	1.00	1.00	\$31.00	\$31.00	Carlou Jaime
645 342 52 00	1.00	SFD	3	1.00	1.00	1.00	\$31.00	\$31.00	Benton Alberto S&Maria V M
645 342 53 00	1.00	SFD	3	1.00	1.00	1.00	\$31.00	\$31.00	Mota Family Revocable Trust 04-07-11
645 342 54 00	1.00	SFD	3	1.00	1.00	1.00	\$31.00	\$31.00	Mora Maria D L B
645 342 55 00	1.00	SFD	3	1.00	1.00	1.00	\$31.00	\$31.00	Charines Pedro J&Bertha A
645 342 56 00	7.00	OSP	3	0.00	0.40	0.00	\$31.00	\$0.00	City Of San Diego
645 342 57 00	0.48	OSP	3	0.00	0.40	0.00	\$31.00	\$0.00	Esmeralda Community Assn
645 342 58 00	0.07	OSP	3	0.00	0.40	0.00	\$31.00	\$0.00	Esmeralda Community Assn

TOTAL	-	-	-	-	-	466.00	-	\$14,446	
--------------	---	---	---	---	---	---------------	---	-----------------	--

- ⁽¹⁾ Applicable units (acres or dwelling units) dependent upon Land Use.
- ⁽²⁾ Refer to Assessment Engineer's Report for description of Land Use and applicable Land Use Factor.
- ⁽³⁾ Refer to Assessment Engineer's Report for applicable Benefit Factor.
- ⁽⁴⁾ FY 2018 is the City's Fiscal Year 2018, which begins July 1, 2017 and ends June 30, 2018.