



America's Finest City

THE CITY OF SAN DIEGO



Assessment Engineer's Report

MISSION HILLS HISTORIC STREET LIGHTING MAINTENANCE ASSESSMENT DISTRICT

Annual Update for Fiscal Year 2014

under the provisions of the

**San Diego Maintenance Assessment District Ordinance
of the San Diego Municipal Code**

and

**Landscaping & Lighting Act of 1972
of the California Streets & Highways Code**

Prepared For

City of San Diego, California

Prepared By

EFS Engineering, Inc.

P.O. Box 22370

San Diego, CA 92192-2370

(858) 752-3490

May 2013

CITY OF SAN DIEGO

Mayor

Bob Filner

City Council Members

Sherrí Lightner
District 1 (Council President Pro Tem)

Kevin Faulconer
District 2

Todd Gloria
District 3 (Council President)

Vacant
District 4

Mark Kersey
District 5

Lorie Zapf
District 6

Scott Sherman
District 7

David Alvarez
District 8

Marti Emerald
District 9

City Attorney

Jan Goldsmith

Interim Chief Operating Officer

Scott Chadwick

City Clerk

Elizabeth Maland

Independent Budget Analyst

Andrea Tevlin

City Engineer

James Nagelvoort

Assessment Engineer

EFS Engineering, Inc.

Table of Contents

Assessment Engineer’s Report
Mission Hills Historic Street Lighting Maintenance Assessment District

Preamble	1
Executive Summary	2
Background	3
District Proceedings for Fiscal Year 2014	3
Bond Declaration	4
District Boundary	4
Project Description	4
Separation of General and Special Benefits	4
Cost Estimate	5
Estimated Costs	5
Annual Cost-Indexing	6
Method of Apportionment	6
Estimated Benefit of Improvements	6
Apportionment Methodology	7
Equivalent Benefit Units (EBUs)	8
Land Use Factor	8
Benefit Factor	9
Unit Assessment Rates	11
Sample Calculations	11
Summary Results	13

EXHIBITS

Exhibit A: Boundary Map

Exhibit B: Estimated Annual Expense, Revenues & Reserves

Exhibit C: Assessment Roll

Assessment Engineer's Report

Mission Hills Historic Street Lighting

Maintenance Assessment District

Preamble

Pursuant to the provisions of the "San Diego Maintenance Assessment District Ordinance" (being Division 2, Article 5, Chapter VI beginning at Section 65.0201 of the San Diego Municipal Code), provisions of the "Landscaping and Lighting Act of 1972" (being Part 2 of Division 15 of the California Streets and Highways Code), applicable provisions of "Proposition 218" (being Article XIID of the California Constitution), and provisions of the "Proposition 218 Omnibus Implementation Act" (being California Senate Bill 919) (the aforementioned provisions are hereinafter referred to collectively as "Assessment Law"), in connection with the proceedings for the MISSION HILLS HISTORIC STREET LIGHTING MAINTENANCE ASSESSMENT DISTRICT (hereinafter referred to as "District"), EFS ENGINEERING, INC., as Assessment Engineer to the City of San Diego for these proceedings, submits herewith this report for the District as required by California Streets and Highways Code Section 22565.

FINAL APPROVAL, BY RESOLUTION NO. _____,
ADOPTED BY THE CITY COUNCIL OF THE CITY OF SAN
DIEGO, COUNTY OF SAN DIEGO, CALIFORNIA, ON THE
_____ DAY OF _____, 2013.

Elizabeth Maland, CITY CLERK
CITY OF SAN DIEGO
STATE OF CALIFORNIA



Executive Summary

Project: Mission Hills Historic Street Lighting
 Maintenance Assessment District

Apportionment Method: Equivalent Benefit Unit (EBU)

	FY 2013	FY 2014 ⁽¹⁾	Maximum ⁽²⁾ Authorized
Total Parcels Assessed:	726	726	--
Total Estimated Assessment:	\$20,266	\$20,254	--
Total Number of EBUs:	718.64	718.24	--
Assessment per EBU:	\$28.20	\$28.20	\$29.76 ⁽⁴⁾

⁽¹⁾ FY 2014 is the City's Fiscal Year 2014, which begins July 1, 2013 and ends June 30, 2014. Total Parcels Assessed, Total Estimated Assessment, and Total Number of EBUs may vary from prior fiscal year values due to parcel changes and/or land use re-classifications.

⁽²⁾ Maximum authorized annual amounts subject to cost-indexing provisions as set forth in this Assessment Engineer's Report.

⁽³⁾ Assessments for "Capital Payback Period" used to finance the initial procurement and installation of lighting fixtures, and other incidental costs associated with District formation.

⁽⁴⁾ Maintenance assessment (levied after completion of the "Capital Payback Period") for on-going operations, maintenance and repair of District facilities. Prior fiscal year's maximum authorized annual assessment increased by cost-indexing factor of 1.55%.

Annual Cost-Indexing: The maximum authorized assessment rate has been increased based on the approved annual cost-indexing provisions.

Bonds: No bonds will be issued in connection with this District.



Background

Property owners in the Mission Hills neighborhood of the Uptown community planning area have petitioned the City of San Diego (City) to form a maintenance assessment district to fund the procurement, installation, operations and maintenance of decorative (“acorn” style) lighting in an area currently scheduled for utility undergrounding. The undergrounding project (“Block 2E Utility Undergrounding”) is generally shown in **Figure 1**.

The City retained AECOM USA, Inc. to prepare an Assessment Engineer’s Report for the formation of the Mission Hills Historic Street Lighting Maintenance Assessment District (District). The purpose of the District is to fund the initial construction and on-going operations, maintenance and repair of the identified decorative lighting improvements located within the District. The Assessment Engineer’s Report was approved and assessments confirmed in Fiscal Year 2010.

District Proceedings for Fiscal Year 2014

This District is authorized and administered under the provisions of the “San Diego Maintenance Assessment District Ordinance” (being Division 2, Article 5, Chapter VI beginning at Section 65.0201 of the San Diego Municipal Code), provisions of the “Landscaping and Lighting Act of 1972” (being Part 2 of Division 15 of the California Streets and Highways Code), applicable provisions of “Proposition 218” (being Article XIII D of the California Constitution), and provisions of the “Proposition 218 Omnibus Implementation Act” (being California Senate Bill 919) (the aforementioned provisions are hereinafter referred to collectively as “Assessment Law”). This report has been prepared in compliance with Assessment Law.

The purpose of the proposed proceedings and this Assessment Engineer’s Report is to update the District budget and assessments for Fiscal Year 2014. The Fiscal Year 2014 assessments proposed within this Assessment Engineer’s Report are equal to or less than the maximum authorized assessment. Therefore, the vote requirements of Section 4 of Article XIII D do not apply to these proceedings.

A public hearing will be scheduled where public testimony will be heard by the Council, and the Council may, at its discretion, adopt a resolution ordering the levying of the proposed assessments.



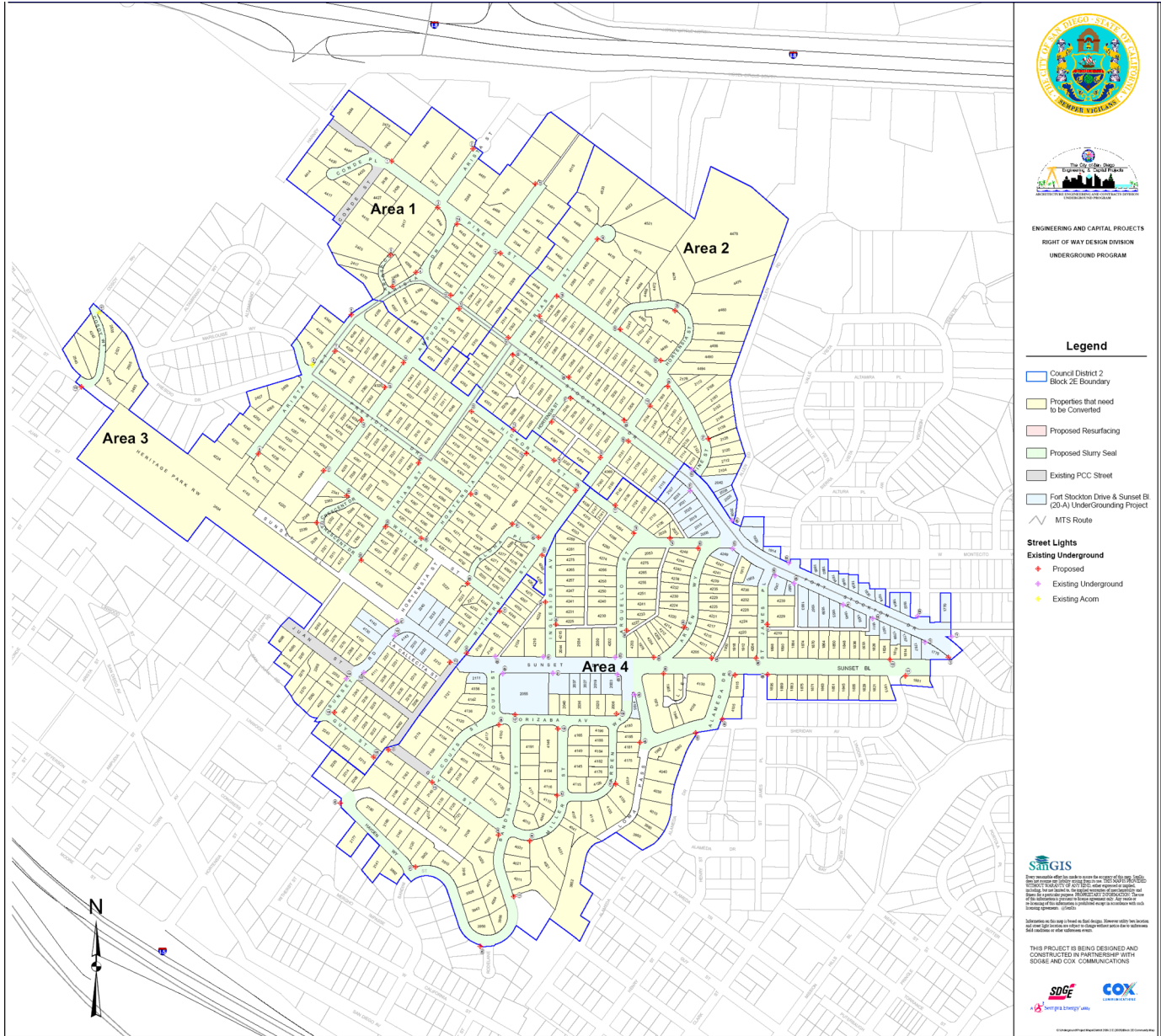

FIGURE 1
Block 2E Utility Undergrounding Project

Bond Declaration

No bonds will be issued in connection with this District.

District Boundary

The District is located in the Mission Hills neighborhood of the Uptown Community, and generally includes those properties which front the improved lighting corridor. The District boundary is different than the utility undergrounding project boundary in that the latter relates specifically to conversion of electrical services to individual properties.

The Boundary Map and Assessment Diagram for the District are on file in the Maintenance Assessment Districts section of the Park and Recreation Department of the City of San Diego, and by reference are made a part of this report. The Boundary Map and Assessment Diagram for the District are available for public inspection during normal business hours. A reduced copy of the Boundary Map is included as **Exhibit A**.

Project Description

The project to be funded by the proposed assessments is the procurement, installation, operations and maintenance of the identified decorative ("acorn" style) lighting located within the District. The District improvements are generally located as shown in **Figure 1**. For additional detail as to location and type of improvements and services, please refer to the engineering plans, maps, sketches, specifications, and other materials on file with the City Park and Recreation Department.

Separation of General and Special Benefits

The proceeds from the assessment will be used to fund enhanced improvements, services and activities within the District that, in absence of the assessment, otherwise would not be provided at an enhanced level or frequency of service. The District will continue to receive the same level of general services provided to the public at large under City-funded and administered programs, as determined annually, for maintenance of public facilities and improvements (e.g., street trees, sidewalks, street lights, etc.), including street sweeping and graffiti removal on public property.



The identified lighting improvements provide benefit to the parcels located within the District. These benefits are “special benefits” (beyond the “general benefits” provided to the public at large) because installation and maintenance of enhanced, decorative (“acorn” style) lighting improvements is not normally provided by the City.

For purposes of capital construction, the City will credit the District an amount equivalent to the cost of standard “cobra” style streetlights which would have been installed as part of the utility undergrounding project. This credit has been included in the District’s estimated multi-year capital budget.

Consistent with City policy for the public at large, the City will contribute for lighting maintenance and energy costs an amount equivalent to that used for City minimum required streetlights (see *City Council Policy 200-18* for lighting standards). These cost allocations, reviewed and adjusted annually by the City, are reflective of the “general benefit” level of service provided by the City to the public at large. All other capital, maintenance, operations, and administration costs associated with the District, in excess of the City’s contribution, are for the “special benefits” funded by the District.

Cost Estimate

Estimated Costs

Estimated budgets for the multi-year “Capital Payback Period” and “Annual Maintenance” period are included as **Exhibit B**, and generally described as follows:

Capital Payback Period: A multi-year period commencing with the City’s Fiscal Year 2010 (July 1, 2009 – June 30, 2010). Assessments levied during this period (estimated at 2 years) will be used to finance the initial procurement and installation of lighting fixtures, and other incidental costs associated with District formation.

Annual Maintenance Period: Subsequent fiscal years following completion of the Capital Payback Period. Assessments levied during this period will be used for on-going operations, maintenance and repair of District facilities. These maintenance assessments are subject to annual increase based on cost-indexing provisions set forth in this Assessment Engineer’s Report.



Assessments authorized and collected as part of these proceedings may be used for future balloting and re-engineering efforts, as may be required from time to time.

Annual Cost-Indexing

With the passage of Proposition 218, any proposed increase in District assessments must be approved by affected property owners via a mail ballot and public hearing process, similar to these proceedings. A weighted simple majority of ballots received (weighted according to each parcel's proportionate assessment) must be affirmative for the City Council to confirm and levy the increased assessments. For small assessment districts or districts with relatively low dollar assessments, the cost of an assessment engineer's report, balloting, and the public hearing process can potentially exceed the total amount of the increase. These incidental costs of the proceedings can be added to the assessments, resulting in even higher assessments.

Indexing assessments annually to a factor not-to-exceed the San Diego Consumer Price Index for Urban Consumers (SDCPI-U) allows for minor increases in normal maintenance and operating costs, without incurring the costs of ballot proceedings required by Proposition 218. Any significant change in the assessment initiated by an increase in service provided or other significant changes to the District would still require Proposition 218 proceedings and property owner approval.

The maximum authorized assessment established in the Fiscal Year 2014 proceedings are authorized to be indexed (increased or decreased) annually by the factor published in the SDCPI-U. The annual change in second half SDCPI-U values, as compiled by the U.S. Bureau of Labor Statistics (see www.bls.gov), for the prior year period was from 253.368 to 257.285 (a 1.55% increase). In accordance with the approved cost-indexing provisions, the maximum authorized assessment rates contained within this Assessment Engineer's Report have been increased by 1.55%.

Method of Apportionment

Estimated Benefit of Improvements

The *Uptown Community Plan* (Community Plan) and the general policy recommendations found in the City's *Progress Guide &*



General Plan (General Plan) establish several goals, objectives, and guidelines for the planned development of the community. The Community Plan makes specific reference to the following noteworthy objectives and recommendations:

- “Preservation of community character and historical, architectural and cultural resources.” (p. 12)
- “Improve the pedestrian and vehicular quality of the streetscape through the design of new development, public improvements, landscaping and coordinated street plantings.” (p. 78)
- “Street furniture, coordinated signage and lighting, planters, kiosks, public art, and plant material should be incorporated whenever possible to add to the vitality of the streetscape.” (p. 82)
- “Street trees, lighting, bollards and/or sidewalk textures should be provided along major streets to create a pleasing pedestrian environment, in addition to providing a separation between pedestrian circulation and vehicular movement.” (p. 82)
- “Enrich the pedestrian quality of all areas by increasing sidewalk widths when appropriate, identifying street tree themes, providing cohesive street furniture, unifying signage, increasing lighting, varying pavement materials and providing nodal points at strategic locations.” (p. 82)

The proposed decorative lighting improvements are consistent with these objectives and recommendations. The City’s General Plan and Community Plan support the establishment of community-based improvement and maintenance districts, such as this District, to fund installation and maintenance of enhanced improvements/services.

The proposed improvements/services are generally located in the public rights-of-way along the various transportation corridors within the District. These transportation corridors serve as the primary access routes for inter-community and intra-community trips. Parcels within the District benefit from the improvements/services in terms of enhanced aesthetics, community image and public safety.

Apportionment Methodology

The total cost for maintenance of the identified improvements/services will be assessed proportionally to the parcels in the District based on Equivalent Benefit Units (EBUs). The total assessment for a given



parcel is equal to the parcel's total EBUs multiplied by the Unit Assessment Rate as shown in the following equation:

$$\text{Total Assessment} = \text{Total EBUs} \times \text{Unit Assessment Rate}$$

Equivalent Benefit Units (EBUs)

EBUs for each parcel have been determined as a function of parcel area (or number of residential units) and two factors – a Land Use Factor and a Benefit Factor – related as shown in the following equation:

$$\text{EBUs} = (\text{Acres or Units}) \times \text{Land Use Factor} \times \text{Benefit Factor}$$

Parcels determined to receive no benefit from the maintenance of District improvements/services have been assigned zero (0) EBUs.

Land Use Factor

Since the proposed District improvements/services are primarily associated with the Transportation Element of City's General Plan and Community Plan, trip generation rates for various land use categories (as previously established by the City's Transportation Planning section) have been used as the primary basis for the development of Land Use Factors. While these trip generation rates address vehicular trips, they are also considered to approximately reflect relative trip generation for other modes of transportation (e.g., pedestrian trips, bicycle trips, etc.), and are considered the best available information for these other transportation modes.

Trip generation rates provide the required nexus and basis for assigning relative proportionality of potential benefit to the various land use/zoning classifications (as defined by the City's Municipal Code) within the District. Land use/zoning classifications have been grouped with averaged trip generation rates assigned to establish the Land Use Factors as shown in **Table 1**.



TABLE 1: Land Use Factors

Land Use/Zoning	Code	Land Use Factor ⁽¹⁾
Residential – Single Family (detached)	SFD	1.0 per dwelling unit
Residential – Duplex	DUP	0.7 per dwelling unit
Residential – Multi-Family & Apartment	MFR	0.7 per dwelling unit
Commercial – Office & Retail	COM	40.0 per acre
Open Space (designated)	OSP	0 per acre
Street/Roadway	STR	0 per acre
Undevelopable	UND	0 per acre
Vacant (developable)	VAC	2.0 per acre

⁽¹⁾ Proportional to trip generation rates contained in the City of San Diego *Trip Generation Manual* (May 2003).

Designated open space serves primarily to preserve natural landscape and habitat. While access for study and passive recreation is often permitted, these activities are allowed only to the extent they are consistent with the primary purpose of natural preservation. Since this land is essentially “unused” in the customary terms of land use (which relate to human use and development), the trip generation rate is zero. Therefore, the designated open space itself receives no benefit from District improvements/services and has been assigned a Land Use Factor of zero.

While those traveling the streets and roadways visually enjoy the enhanced improvements/services being maintained by the District, the actual benefit accrues to the lands at the origins and destinations of their trips, not to the lands of the streets and roadways, themselves. Accordingly, the Streets/Roadways category receives no benefit and has been assigned a Land Use Factor of zero.

Benefit Factor

The Land Use Factor described above establishes a proportionality of relative intensity of use (or potential use) for the various parcels of land within the District. It does not address the relationship of this use to the specific improvements/services to be maintained by the District. This relationship is reflected in the Benefit Factor utilized in the assessment methodology.



In determining the Benefit Factor for each land use category, the subcomponents of the benefits of the improvements/services in a district may include some or all of the following: public safety, view corridors and aesthetics, enhancement of community identity, drainage corridors, and recreational potential. The subcomponents used for this District are: aesthetics/community image and public safety.

As Benefit Factors and their subcomponents are intended to reflect the particular relationships between specific land uses within a district and the specific improvements/services maintained by the district, Benefit Factors will generally vary from one district to another, based on the specific character and nature of the applicable land uses and improvements/services being maintained. For a given land use, the overall Benefit Factor is equal to the sum of the subcomponent values. If a land use category receives no benefit from a subcomponent, then a value of zero is assigned to that subcomponent. A composite Benefit Factor of 1.0 indicates that full benefit is received. A value less than 1.0 indicates that less than full benefit is received.

The applicable benefit subcomponents and resultant composite Benefit Factors determined for the various Land Use/Zoning categories within this District are as shown in **Table 2**.

TABLE 2: Benefit Factors by Land Use

Land Use/Zoning	Aesthetics/ Community Image (Max. 0.8)	Public Safety (Max. 0.2)	Composite Benefit Factor (Max. 1.0)
Residential – All	0.8	0.2	1.0
Commercial – Office & Retail	0.4	0.2	0.6
Open Space (designated)	0.0	0.2	0.0
Street/Roadway	0.0	0.2	0.0
Undevelopable	0.0	0.2	0.0
Vacant (developable)	0.4	0.2	0.6

Aesthetics/Community Image. The District improvements provide enhanced aesthetics/community image. The degree of benefit received from this aspect of the District improvements varies among the land use categories. Generally, by nature of their use, Residential lands receive the greatest benefit from aesthetic



enhancement of the transportation corridors. Lands in the Commercial and Vacant categories are considered to receive a lesser degree of benefit from these enhancements based on the non-continuous or temporal nature of these uses. Lands in the Open Space, Street/Roadway, and Undevelopable categories are considered to receive no significant benefit from the aesthetic elements of the District improvements/services, as enhanced aesthetic quality of other lands in their vicinity does not affect their function, use, or value.

Public Safety. All land uses are considered to receive the maximum available benefit from the public safety aspect of the District improvements/services. Public safety is essential to all land uses, and even to lands, such as designated open space, held in stewardship with only incidental human use.

Unit Assessment Rates

The Unit Assessment Rate (annual assessment per EBU) is based on the Total Annual Program Costs and Total Estimated EBUs, as shown in the following equation:

$$\text{Unit Assessment Rate} = \text{Total Annual Program Costs} / \text{Total Estimated EBUs}$$

Sample Calculations

As described above, the number of Equivalent Benefit Units (EBUs) assigned to each parcel in the District has been calculated based on each parcel's land use and the identified apportionment factors, as shown in the following equation:

$$\text{EBUs} = (\text{Acres or Units}) \times \text{Land Use Factor} \times \text{Benefit Factor}$$



Shown below are sample EBU calculations for several common land uses found in the District.

- **1 Single-Family Residence**
EBUs = 1 unit x 1.00 x 1.00 = 1.00 EBUs
- **10-unit Apartment Complex**
EBUs = 10 units x 0.70 x 1.00 = 7.00 EBUs
- **½-acre Commercial Property**
EBUs = 0.50 acres x 40.00 x 0.60 = 12.00 EBUs

The total assessment for each parcel in the District is based on the calculated EBUs for the parcel and the applicable unit assessment rate, as shown in the following equation:

Total Assessment = Total EBUs x Unit Assessment Rate
--

Based on the above formula, the EBUs, unit assessment rate, and total assessment calculated for each property, can be found in the Assessment Roll (**Exhibit C**).



Summary Results

The District Boundary is presented in **Exhibit A**.

An estimate of the costs of the improvements provided by the District is included as **Exhibit B** to this report.

The assessment methodology utilized is as described in the text of this report. Based on this methodology, the EBUs and Fiscal Year 2014 District assessment for each parcel were calculated and are shown in the Assessment Roll (**Exhibit C**).

Each lot or parcel of land within the District has been identified by unique County Assessor's Parcel Number on the Assessment Roll and the Boundary Map and Assessment Diagram referenced herein. The net assessment for each parcel for Fiscal Year 2014 can be found on the Assessment Roll.

This report has been prepared and respectfully submitted by:

EFS ENGINEERING, INC.

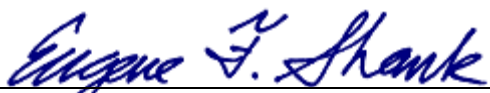

Eugene F. Shank, PE C 52792

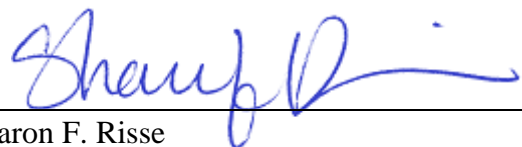
Sharon F. Risse



I, _____, as CITY CLERK of the CITY OF SAN DIEGO, COUNTY OF SAN DIEGO, CALIFORNIA, do hereby certify that the Assessment as shown on the Assessment Roll, together with the Assessment Diagram, both of which are incorporated into this report, were filed in my office on the ____ day of _____, 2013.

Elizabeth Maland, CITY CLERK
CITY OF SAN DIEGO
STATE OF CALIFORNIA

I, _____, as CITY CLERK of the CITY OF SAN DIEGO, COUNTY OF SAN DIEGO, CALIFORNIA, do hereby certify that the foregoing Assessment, together with the Assessment Diagram incorporated into this report, was approved and confirmed by the CITY COUNCIL of said City on the ____ day of _____, 2013.

Elizabeth Maland, CITY CLERK
CITY OF SAN DIEGO
STATE OF CALIFORNIA

EXHIBIT A

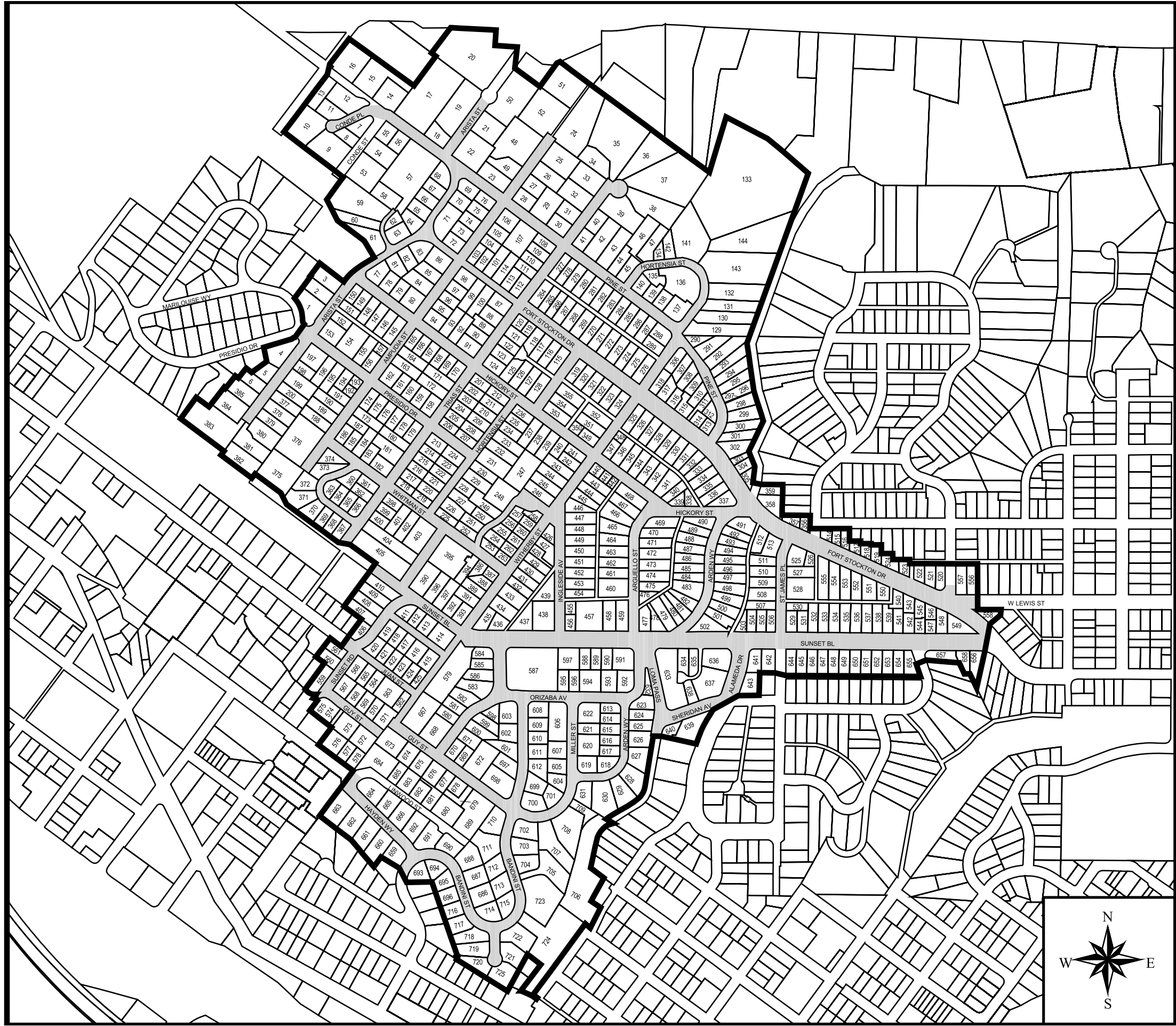

SOURCE: SanGIS, City of San Diego and AECOM.

BOUNDARY MAP & ASSESSMENT DIAGRAM

FILED IN THE OFFICE OF THE CITY CLERK OF THE CITY OF SAN DIEGO, STATE OF CALIFORNIA, THIS _____ DAY OF _____, 2009.

I HEREBY CERTIFY THAT THE WITHIN MAP SHOWING PROPOSED BOUNDARIES OF THE MISSION HILLS HISTORIC STREET LIGHTING MAINTENANCE ASSESSMENT DISTRICT, CITY OF SAN DIEGO, STATE OF CALIFORNIA, WAS APPROVED BY THE CITY COUNCIL AT A REGULAR MEETING THEREOF, HELD ON THE _____ DAY OF _____, 2009, BY ITS RESOLUTION NO. _____.

ELIZABETH MALAND, CITY CLERK
CITY OF SAN DIEGO
STATE OF CALIFORNIA



7807 Conway Court, Suite 200, San Diego, California 92111 (858) 268-8080

ELIZABETH MALAND, CITY CLERK
CITY OF SAN DIEGO
STATE OF CALIFORNIA

AN ASSESSMENT WAS LEVIED BY THE CITY COUNCIL OF THE CITY OF SAN DIEGO ON THE LOTS, PIECES, AND PARCELS OF LAND SHOWN ON THIS ASSESSMENT DIAGRAM. SAID ASSESSMENT WAS LEVIED ON THE _____ DAY OF _____, 2009. SAID ASSESSMENT DIAGRAM AND THE ASSESSMENT ROLL WERE RECORDED IN THE OFFICE OF THE SUPERINTENDENT OF STREETS OF THE CITY OF SAN DIEGO, STATE OF CALIFORNIA ON THE _____ DAY OF _____, 2009. REFERENCE IS MADE TO THE ASSESSMENT ROLL RECORDED IN THE OFFICE OF THE SUPERINTENDENT OF STREETS FOR THE EXACT AMOUNT OF EACH ASSESSMENT LEVIED AGAINST EACH PARCEL OF LAND SHOWN ON THIS ASSESSMENT DIAGRAM.

NOTE:
FOR A DETAILED DESCRIPTION OF THE LINES AND DIMENSIONS OF LOTS OR PARCELS SHOWN ON THIS MAP, REFER TO THE COUNTY ASSESSOR'S MAPS WHICH SHALL GOVERN WITH RESPECT TO ALL DETAILS CONCERNING THE LINES AND DIMENSIONS OF SUCH LOTS OR PARCELS.

- LEGEND:**
- District Boundary
 - Parcel Line
 - Improvement Areas *
 - Diagram Number

* REFER TO THE ENGINEER'S REPORT AND REFERENCED DOCUMENTS FOR DESCRIPTION OF IMPROVEMENTS AND SERVICES.



CITY OF
SAN DIEGO

**MISSION HILLS HISTORIC STREET LIGHTING
MAINTENANCE ASSESSMENT DISTRICT**

EXHIBIT B

EXHIBIT B

**Park and Recreation Department - Open Space Division
Maintenance Assessment Districts Program
Summary of Fiscal Year 2014 (07-01-13 to 06-30-14) Budget**

**Mission Hills Historic Street Lighting Maintenance Assessment District
SAP Fund 200614**

	FY 2012 Unaudited Actuals	FY 2013 Estimate	FY 2014 Proposed
<u>District Personnel Costs</u>			
Total Labor & Fringe (CIP Project Charges)	\$ -	\$ -	\$ -
<u>District Non-Personnel Costs</u>			
Special District Administration	\$ 3,500.00	\$ 3,500.00	\$ 3,500.00
Electric Services / Special Street Lighting	\$ -	\$ -	\$ -
Subtotal Non-Personnel Costs	\$ 3,500.00	\$ 3,500.00	\$ 3,500.00
Capital Improvements Program - WBS #S-11008 - Total Contribution to Date: \$367,486			
Undistributed Budget for pole purchase, construction contract, and staff charge	\$ 45,819.02	\$ 16,303.78 ⁽¹⁾	\$ -
Additional CIP Contribution	\$ -	\$ -	\$ -
	\$ 45,819.02	\$ 16,303.78	\$ -
TOTAL	\$ 49,319.02	\$ 19,803.78	\$ 3,500.00
<u>District Revenues & Reserves</u>			
Special Assessments ⁽²⁾	\$ 21,954.17	\$ 20,265.65	\$ 20,254.48
Interest Earnings	\$ 3,994.91	\$ 4,173.83	\$ 3,500.00
TOTAL	\$ 25,949.08	\$ 24,439.48	\$ 23,754.48
<u>District Reserves</u>			
Beginning Fund Balance	\$ 109,113.38	\$ 102,047.22	\$ 106,682.92
Change in Fund Balance	\$ (23,369.94)	\$ 4,635.70	\$ 20,265.65
Year End Operating Reserves	\$ 85,743.44	\$ 106,682.92	\$ 126,948.57

⁽¹⁾ Capital Improvement Project costs for FY 2013 represent charges accrued year to date as of January 11, 2013.

⁽²⁾ Special assessments revenue adjusted to reflect latest parcel information and applicable cost-indexing provisions.

EXHIBIT C

**ASSESSMENT ENGINEER'S REPORT
ASSESSMENT ROLL**

The undersigned, pursuant to the "Maintenance Assessment Districts Ordinance" (Division 2, Article 5, Chapter VI beginning at Section 65.0201 of the San Diego Municipal Code), the "Landscaping and Lighting Act of 1972" (Part 2, Division 15 of the California Streets and Highways Code), applicable provisions of "Proposition 218" (Article XIID of the California Constitution), and the "Proposition 218 Omnibus Implementation Act" (California Senate Bill 919) (the aforementioned provisions are hereinafter referred to collectively as "Assessment Law"), does hereby submit the following:

1. Pursuant to the provisions of Assessment Law and the Resolution of Intention, we have assessed the costs and expenses of the works of improvement (maintenance) to be performed in the Assessment District upon the parcels of land in the Assessment District benefited thereby in direct proportion and relation to the estimated benefits to be received by each of said parcels. For particulars as to the identification of said parcels, reference is made to the Boundary Map & Assessment Diagram on file in the Maintenance Assessment Districts Section of the Park and Recreation Department of the City of San Diego. A copy of the Boundary Map is included in the Assessment Engineer's Report as **Exhibit A**.
2. The Assessment Diagram included in this report shows the Assessment District, as well as the boundaries and dimensions of the respective parcels and subdivisions of land within the Assessment District, the same as existed at the time of the passage of the Resolution of Intention, each of which subdivisions of land or parcels or lots respectively have been given a separate number upon the Assessment Diagram and in the Assessment Roll (**Exhibit C**).
3. By virtue of the authority contained in said Assessment Law, and by further direction and order of the legislative body, we hereby make the following assessment to cover the costs and expenses of the works of improvement (maintenance) for the Assessment District based on the costs and expenses as set forth in the Assessment Engineer's Report.

For particulars as to the individual assessments and their descriptions, reference is made to the Assessment Roll (**Exhibit C**) attached hereto.

DATED: May 3, 2013

EFS ENGINEERING, INC.



By: Eugene F. Shank
Eugene F. Shank, PE C 52792

By: Sharon F. Risse
Sharon F. Risse

EXHIBIT C - Assessment Roll (Fiscal Year 2014)
Mission Hills Historic Street Lighting Maintenance Assessment District

Parcel Number	Acres/ Units ⁽¹⁾	Land Use Code ⁽²⁾	Apportionment Factors		Total EBUs	FY 2014 ⁽⁴⁾		Owner Name
			Land Use ⁽²⁾	Benefit ⁽³⁾		Unit Cost	Assessment	
442 702 03 00	1.00	SFD	1.00	1.00	1.00	\$28.20	\$28.20	Jackson Family Trust 07-28-10
442 702 04 00	1.00	SFD	1.00	1.00	1.00	\$28.20	\$28.20	Zeigler Paul E Tr (08-25-72 Trust B)
442 702 05 00	1.00	SFD	1.00	1.00	1.00	\$28.20	\$28.20	Weightman Nadine Trust 08-31-12
442 703 01 00	1.00	SFD	1.00	1.00	1.00	\$28.20	\$28.20	Needham Terence&Jeannie Family Trust 08-10-94
442 703 02 00	1.00	SFD	1.00	1.00	1.00	\$28.20	\$28.20	Haberman Aaron R&Victoria E N
442 703 03 00	1.00	SFD	1.00	1.00	1.00	\$28.20	\$28.20	Green Kevin&Tekla
442 710 01 00	1.00	SFD	1.00	1.00	1.00	\$28.20	\$28.20	Hartwell E Franchon
442 710 02 00	1.00	SFD	1.00	1.00	1.00	\$28.20	\$28.20	Mcknight John R Trust 09-02-04
442 710 03 00	1.00	SFD	1.00	1.00	1.00	\$28.20	\$28.20	Rodriguez Family Trust 05-24-90
442 710 04 00	1.00	SFD	1.00	1.00	1.00	\$28.20	\$28.20	Evans William&Susan Family Trust 03-16-00
442 710 05 00	1.00	SFD	1.00	1.00	1.00	\$28.20	\$28.20	Betts Josephine D Tr
442 710 07 00	1.00	SFD	1.00	1.00	1.00	\$28.20	\$28.20	Zakowski Joseph A&Kimberly M
442 710 08 00	0.00	SFD	1.00	1.00	0.00	\$28.20	\$0.00	Jones Ronald H Living Trust 10-26-10
442 720 07 00	1.00	SFD	1.00	1.00	1.00	\$28.20	\$28.20	Slacum Kay Trust 04-22-94
442 720 11 00	1.00	SFD	1.00	1.00	1.00	\$28.20	\$28.20	Flores Ruben G
442 720 12 00	1.00	SFD	1.00	1.00	1.00	\$28.20	\$28.20	Osullivan Edward P&Rose A
443 051 01 00	1.00	SFD	1.00	1.00	1.00	\$28.20	\$28.20	Bohannan Bobbie Living Trust 07-29-98
443 051 02 00	1.00	SFD	1.00	1.00	1.00	\$28.20	\$28.20	Cantoni Elizabeth Tr
443 051 03 00	1.00	SFD	1.00	1.00	1.00	\$28.20	\$28.20	Price Robert E Tr
443 051 04 00	1.58	OSP	0.00	1.00	0.00	\$28.20	\$0.00	City Of San Diego
443 051 07 00	1.00	SFD	1.00	1.00	1.00	\$28.20	\$28.20	Thirkill Eugene J&Patricia C Trs
443 051 08 00	1.00	SFD	1.00	1.00	1.00	\$28.20	\$28.20	Reed Elizabeth M Trust 07-20-95
443 051 09 00	1.00	SFD	1.00	1.00	1.00	\$28.20	\$28.20	Dick William R Jr&Ruth D Trust 01-28-76
443 051 13 00	1.00	SFD	1.00	1.00	1.00	\$28.20	\$28.20	P D B Trust 07-31-97
443 051 14 00	1.00	SFD	1.00	1.00	1.00	\$28.20	\$28.20	Casady Janed G Revocable Trust 06-02-94
443 051 15 00	1.00	SFD	1.00	1.00	1.00	\$28.20	\$28.20	Roth Family Trust 02-07-89
443 051 16 00	1.00	SFD	1.00	1.00	1.00	\$28.20	\$28.20	Omalley J Terence&Colleen K
443 051 17 00	1.00	SFD	1.00	1.00	1.00	\$28.20	\$28.20	Humberson Cora S Revocable Trust No 1
443 051 18 00	1.00	SFD	1.00	1.00	1.00	\$28.20	\$28.20	Beamer Family Trust 06-14-72
443 051 19 00	1.00	SFD	1.00	1.00	1.00	\$28.20	\$28.20	Miller Charles H Iv&Christine B
443 051 20 00	1.00	SFD	1.00	1.00	1.00	\$28.20	\$28.20	Kaffel Garry M (Dp)
443 051 21 00	1.00	SFD	1.00	1.00	1.00	\$28.20	\$28.20	Cianflone David&Margherita
443 051 22 00	1.00	SFD	1.00	1.00	1.00	\$28.20	\$28.20	Rees Dorothy D
443 051 23 00	1.00	SFD	1.00	1.00	1.00	\$28.20	\$28.20	Gillis William J Jr&Frances P
443 051 24 00	1.00	SFD	1.00	1.00	1.00	\$28.20	\$28.20	Swim Family Trust 02-11-93
443 051 25 00	1.00	SFD	1.00	1.00	1.00	\$28.20	\$28.20	Brockett Sheldon I&Helen E Marital Family Trust I 12-18-98
443 051 26 00	1.00	SFD	1.00	1.00	1.00	\$28.20	\$28.20	Borve Eirik Living Trust 08-26-98
443 051 27 00	1.00	SFD	1.00	1.00	1.00	\$28.20	\$28.20	Castagnola Mary L Trust 05-19-92
443 051 28 00	1.00	SFD	1.00	1.00	1.00	\$28.20	\$28.20	Stolsky Michael S Trust 09-13-12
443 051 29 00	1.00	SFD	1.00	1.00	1.00	\$28.20	\$28.20	Rott Family 2005 Trust 12-22-05
443 051 30 00	1.00	SFD	1.00	1.00	1.00	\$28.20	\$28.20	Rott Family 2005 Trust 12-22-05
443 051 31 00	1.00	SFD	1.00	1.00	1.00	\$28.20	\$28.20	Grodner Sharon
443 051 32 00	1.00	SFD	1.00	1.00	1.00	\$28.20	\$28.20	Cullen Norman L Exemption Trust
443 051 33 00	1.00	SFD	1.00	1.00	1.00	\$28.20	\$28.20	Oliver Virginia S Trust 09-10-12
443 051 34 00	1.00	SFD	1.00	1.00	1.00	\$28.20	\$28.20	Brennan William F&Lauri A
443 051 35 00	1.00	SFD	1.00	1.00	1.00	\$28.20	\$28.20	Marckwardt William H&Patricia E Revocable Trust 01-26-90
443 051 36 00	1.00	SFD	1.00	1.00	1.00	\$28.20	\$28.20	Singer Diane V Trust 02-22-10
443 051 38 00	1.00	SFD	1.00	1.00	1.00	\$28.20	\$28.20	Foerster Barrett J&Susan S Revocable Survivors Trust 06-29-99
443 051 39 00	1.00	SFD	1.00	1.00	1.00	\$28.20	\$28.20	Miller Laurence A
443 051 40 00	1.00	SFD	1.00	1.00	1.00	\$28.20	\$28.20	Nevara John B&Barbara A Family Trust 12-07-01
443 051 42 00	0.00	SFD	1.00	1.00	0.00	\$28.20	\$0.00	Nevara John B&Barbara A Family Trust
443 051 43 00	0.00	SFD	1.00	1.00	0.00	\$28.20	\$0.00	Nevara John B&Barbara A Family Trust
443 061 01 00	1.00	SFD	1.00	1.00	1.00	\$28.20	\$28.20	Davis Steven L&Susan M
443 061 02 00	1.00	SFD	1.00	1.00	1.00	\$28.20	\$28.20	Young Sally D Tr

EXHIBIT C - Assessment Roll (Fiscal Year 2014)
Mission Hills Historic Street Lighting Maintenance Assessment District

Parcel Number	Acres/Units ⁽¹⁾	Land Use Code ⁽²⁾	Apportionment Factors		Total EBUs	FY 2014 ⁽⁴⁾		Owner Name
			Land Use ⁽²⁾	Benefit ⁽³⁾		Unit Cost	Assessment	
443 061 03 00	1.00	SFD	1.00	1.00	1.00	\$28.20	\$28.20	Quinn Family Revocable Trust 10-17-97
443 061 04 00	1.00	SFD	1.00	1.00	1.00	\$28.20	\$28.20	Jackson Donald P&Sharon W Trs
443 061 05 00	1.00	SFD	1.00	1.00	1.00	\$28.20	\$28.20	Pecka Helen B Qualified Personal Residence Trust
443 061 06 00	0.00	SFD	1.00	1.00	0.00	\$28.20	\$0.00	Ramirez-Cardenas Family Trust 08-17-95
443 061 07 00	1.00	SFD	1.00	1.00	1.00	\$28.20	\$28.20	Ramirez-Cardenas Family Trust 08-17-95
443 061 08 00	1.00	SFD	1.00	1.00	1.00	\$28.20	\$28.20	Ramirez-Cardenas Family Trust 08-17-95
443 061 09 00	1.00	SFD	1.00	1.00	1.00	\$28.20	\$28.20	Slater Family Exemption 1985 Trust 08-08-85 Et Al
443 061 10 00	0.00	SFD	1.00	1.00	0.00	\$28.20	\$0.00	Ramirez-Cardenas Family Trust 08-17-95
443 061 11 00	1.00	SFD	1.00	1.00	1.00	\$28.20	\$28.20	Davis Greg&Belinda Family Trust 12-08-94
443 061 12 00	1.00	SFD	1.00	1.00	1.00	\$28.20	\$28.20	Marosi John
443 061 13 00	1.00	SFD	1.00	1.00	1.00	\$28.20	\$28.20	Dailard Douglas&Lyons-Dailard Cynthia Family Trust 10-24-05
443 061 14 00	0.00	SFD	1.00	1.00	0.00	\$28.20	\$0.00	Collins Family Trust
443 061 15 00	1.00	SFD	1.00	1.00	1.00	\$28.20	\$28.20	Collins Family Trust
443 061 16 00	1.00	SFD	1.00	1.00	1.00	\$28.20	\$28.20	Jovanovich Survivors Trust 03-20-90 Et Al
443 061 17 00	1.00	SFD	1.00	1.00	1.00	\$28.20	\$28.20	Oconnor Mavourneen F
443 061 18 00	1.00	SFD	1.00	1.00	1.00	\$28.20	\$28.20	Barker James&Margaret Family Trust 02-12-98
443 061 19 00	1.00	SFD	1.00	1.00	1.00	\$28.20	\$28.20	J A C O Trust
443 061 20 00	1.00	SFD	1.00	1.00	1.00	\$28.20	\$28.20	Malpat L L C
443 061 21 00	1.00	SFD	1.00	1.00	1.00	\$28.20	\$28.20	Childs Family Revocable Trust 02-14-03
443 061 22 00	1.00	SFD	1.00	1.00	1.00	\$28.20	\$28.20	Truant/Marino Family Trust 10-31-94
443 061 23 00	1.00	SFD	1.00	1.00	1.00	\$28.20	\$28.20	Corwin Edward&Irma Intervivos Trust 09-10-82 <Dva>
443 061 24 00	1.00	SFD	1.00	1.00	1.00	\$28.20	\$28.20	Weaver David A&Witt Alia S
443 061 25 00	1.00	SFD	1.00	1.00	1.00	\$28.20	\$28.20	Zaatar S A
443 061 26 00	1.00	SFD	1.00	1.00	1.00	\$28.20	\$28.20	Leflang Family Trust 05-07-99
443 061 27 00	1.00	SFD	1.00	1.00	1.00	\$28.20	\$28.20	Mcgrath Family Trust 07-17-90
443 061 28 00	1.00	SFD	1.00	1.00	1.00	\$28.20	\$28.20	Willmann Family Survivos Trust 02-27-96
443 061 29 00	1.00	SFD	1.00	1.00	1.00	\$28.20	\$28.20	Chan Jimmy Tim Fai&Crockett Tanja V
443 061 30 00	1.00	SFD	1.00	1.00	1.00	\$28.20	\$28.20	Willis Family Trust 12-07-05
443 061 31 00	1.00	SFD	1.00	1.00	1.00	\$28.20	\$28.20	Nowell Gregory L&Maryann Trs
443 061 32 00	1.00	SFD	1.00	1.00	1.00	\$28.20	\$28.20	Deddeh Peter C&Aleta
443 061 33 00	1.00	SFD	1.00	1.00	1.00	\$28.20	\$28.20	Ford Living Revocable Trust 06-02-92
443 061 34 00	1.00	SFD	1.00	1.00	1.00	\$28.20	\$28.20	Mcdonald Stephen P&Judith A
443 061 35 00	1.00	SFD	1.00	1.00	1.00	\$28.20	\$28.20	Heatly Joe R&Jane
443 061 36 00	1.00	SFD	1.00	1.00	1.00	\$28.20	\$28.20	Shea Family Trust 10-07-97
443 061 37 00	1.00	SFD	1.00	1.00	1.00	\$28.20	\$28.20	Musoke Lois Trust 06-21-06
443 061 38 00	1.00	SFD	1.00	1.00	1.00	\$28.20	\$28.20	Casper William J&Lynda E Trust 05-15-91
443 061 39 00	1.00	SFD	1.00	1.00	1.00	\$28.20	\$28.20	Schulman Family Trust 04-19-90
443 061 40 00	1.00	SFD	1.00	1.00	1.00	\$28.20	\$28.20	Niewiadomski Slawomir
443 061 41 00	1.00	SFD	1.00	1.00	1.00	\$28.20	\$28.20	Mcadam Nancy&William 2007 Trust 04-19-07
443 061 42 00	1.00	SFD	1.00	1.00	1.00	\$28.20	\$28.20	Plant Frank E Iii&Marcella A Family Trust 09-17-08
443 061 43 00	1.00	SFD	1.00	1.00	1.00	\$28.20	\$28.20	Piton Tatiana Trust 04-13-11
443 061 44 00	1.00	SFD	1.00	1.00	1.00	\$28.20	\$28.20	Brown Erik F&Mary Beth
443 061 45 00	1.00	SFD	1.00	1.00	1.00	\$28.20	\$28.20	Berry Karen L 2010 Trust
443 061 46 00	1.00	SFD	1.00	1.00	1.00	\$28.20	\$28.20	Faiola Vincent G Trust 03-17-78
443 061 47 00	1.00	SFD	1.00	1.00	1.00	\$28.20	\$28.20	Jackson Sharon W Tr
443 061 48 00	1.00	SFD	1.00	1.00	1.00	\$28.20	\$28.20	Welter John A&Theresa F
443 061 49 00	1.00	SFD	1.00	1.00	1.00	\$28.20	\$28.20	Snapp Wesley G&Barbier Briana N
443 061 50 00	1.00	SFD	1.00	1.00	1.00	\$28.20	\$28.20	Svidal Jay D&Gretchen W Revocable Trust 10-17-09
443 061 51 00	1.00	SFD	1.00	1.00	1.00	\$28.20	\$28.20	Fujimoto Family Trust 01-29-97
443 061 52 00	1.00	SFD	1.00	1.00	1.00	\$28.20	\$28.20	Karel Joyce Intervivos Trust 2 06-04-82
443 061 53 00	1.00	SFD	1.00	1.00	1.00	\$28.20	\$28.20	Frachon Didier B&Kathleen M
443 061 54 00	1.00	SFD	1.00	1.00	1.00	\$28.20	\$28.20	Dimsdale Inter Vivos Trust 10-24-95
443 061 55 00	1.00	SFD	1.00	1.00	1.00	\$28.20	\$28.20	Valencia Grace M Et Al
443 061 56 00	1.00	SFD	1.00	1.00	1.00	\$28.20	\$28.20	Giffin Michael G&Karen A Trs

EXHIBIT C - Assessment Roll (Fiscal Year 2014)
Mission Hills Historic Street Lighting Maintenance Assessment District

Parcel Number	Acres/ Units ⁽¹⁾	Land Use Code ⁽²⁾	Apportionment Factors		Total EBUs	FY 2014 ⁽⁴⁾		Owner Name
			Land Use ⁽²⁾	Benefit ⁽³⁾		Unit Cost	Assessment	
443 061 57 00	1.00	SFD	1.00	1.00	1.00	\$28.20	\$28.20	Rix Trust 03-06-09
443 061 58 00	1.00	SFD	1.00	1.00	1.00	\$28.20	\$28.20	Shapiro Warren L&Julie A Family Revocable Trust
443 061 59 00	1.00	SFD	1.00	1.00	1.00	\$28.20	\$28.20	Wingrove Eileen
443 061 60 00	1.00	SFD	1.00	1.00	1.00	\$28.20	\$28.20	Bradbury Eric M&Elaine S Joint Living Trust 04-19-11
443 061 61 00	1.00	SFD	1.00	1.00	1.00	\$28.20	\$28.20	Cain Steven&Champion-Cain Gina
443 061 62 00	1.00	SFD	1.00	1.00	1.00	\$28.20	\$28.20	Wise William H Trust 05-16-07
443 061 63 00	1.00	SFD	1.00	1.00	1.00	\$28.20	\$28.20	Northrup Christopher W&Rosenthal-Northrup Esther H
443 061 64 00	1.00	SFD	1.00	1.00	1.00	\$28.20	\$28.20	Bellows Richard S&Matthews Erin J
443 061 65 00	1.00	SFD	1.00	1.00	1.00	\$28.20	\$28.20	Mccarthy Brian
443 061 66 00	1.00	SFD	1.00	1.00	1.00	\$28.20	\$28.20	Coleman Scott H&Sarah E
443 061 67 00	1.00	SFD	1.00	1.00	1.00	\$28.20	\$28.20	Carlstein Barbara
443 061 68 00	1.00	SFD	1.00	1.00	1.00	\$28.20	\$28.20	Merideth Alexandra L
443 061 69 00	1.00	SFD	1.00	1.00	1.00	\$28.20	\$28.20	Yang Calvin T&Lee Kristeen Y
443 061 70 00	1.00	SFD	1.00	1.00	1.00	\$28.20	\$28.20	Halliday Billie J Trust 12-22-98
443 061 71 00	1.00	SFD	1.00	1.00	1.00	\$28.20	\$28.20	Delsman Mark J Separate Property Trust 04-26-07
443 061 72 00	1.00	SFD	1.00	1.00	1.00	\$28.20	\$28.20	Featherman Family Trust 01-15-01
443 061 73 00	1.00	SFD	1.00	1.00	1.00	\$28.20	\$28.20	Nelkin-Rickless Revocable Trust 11-01-05
443 061 74 00	1.00	SFD	1.00	1.00	1.00	\$28.20	\$28.20	Arena Catherine A
443 061 75 00	1.00	SFD	1.00	1.00	1.00	\$28.20	\$28.20	Hartman Family Trust 04-17-97
443 061 76 00	1.00	SFD	1.00	1.00	1.00	\$28.20	\$28.20	Twining Family Trust 04-18-05
443 121 01 00	1.00	SFD	1.00	1.00	1.00	\$28.20	\$28.20	Rappaport Norton A Tr
443 121 02 00	1.00	SFD	1.00	1.00	1.00	\$28.20	\$28.20	Lauer Trust 06-17-94
443 121 03 00	1.00	SFD	1.00	1.00	1.00	\$28.20	\$28.20	Hingorani Vijay N Family 2008 Trust 09-18-08
443 121 04 00	1.00	SFD	1.00	1.00	1.00	\$28.20	\$28.20	Kocmur Family Trust 05-06-04
443 121 07 00	1.00	SFD	1.00	1.00	1.00	\$28.20	\$28.20	Stevenson John R Tr
443 121 10 00	1.00	SFD	1.00	1.00	1.00	\$28.20	\$28.20	Raddatz Sara A Trust 07-01-75
443 121 11 00	1.00	SFD	1.00	1.00	1.00	\$28.20	\$28.20	Henson Laurie S Trust 01-03-95
443 121 12 00	1.00	SFD	1.00	1.00	1.00	\$28.20	\$28.20	Ansmar Family Trust 07-30-99
443 121 13 00	1.00	SFD	1.00	1.00	1.00	\$28.20	\$28.20	Katz Mark R&Naomi J Trs
443 121 14 00	1.00	SFD	1.00	1.00	1.00	\$28.20	\$28.20	Ansmar Family Trust 07-30-99
443 121 15 00	1.00	SFD	1.00	1.00	1.00	\$28.20	\$28.20	Sefton Donna K Trust 06-14-83
443 121 16 00	1.00	SFD	1.00	1.00	1.00	\$28.20	\$28.20	Dick Gary F Living Trust 10-16-98
443 121 18 00	1.00	SFD	1.00	1.00	1.00	\$28.20	\$28.20	Buckley David W&Ross-Buckley Beth
443 121 19 00	1.00	SFD	1.00	1.00	1.00	\$28.20	\$28.20	Donaldson Family 2002 Trust 02-27-02
443 121 21 00	1.00	SFD	1.00	1.00	1.00	\$28.20	\$28.20	Lynn Family Trust 03-15-85
443 121 22 00	1.00	SFD	1.00	1.00	1.00	\$28.20	\$28.20	Wile Trust 11-02-88
443 210 01 00	1.00	SFD	1.00	1.00	1.00	\$28.20	\$28.20	Rees Gail K Living Trust 05-17-00
443 210 02 00	1.00	SFD	1.00	1.00	1.00	\$28.20	\$28.20	Foelschow James L
443 210 03 00	2.00	DUP	0.70	1.00	1.40	\$28.20	\$39.48	Romeo Bertha C Family Trust 01-01-01
443 210 04 00	1.00	SFD	1.00	1.00	1.00	\$28.20	\$28.20	Momsen Family Trust 05-10-07
443 210 05 00	1.00	SFD	1.00	1.00	1.00	\$28.20	\$28.20	Thrasher Craig S Revocable Living Trust
443 210 06 00	1.00	SFD	1.00	1.00	1.00	\$28.20	\$28.20	Bride Family Trust 09-07-07
443 210 07 00	1.00	SFD	1.00	1.00	1.00	\$28.20	\$28.20	Mosser Dana M Living Trust 03-19-96
443 210 08 00	1.00	SFD	1.00	1.00	1.00	\$28.20	\$28.20	Greenhood Joan Revocable Trust 01-31-08
443 210 09 00	1.00	SFD	1.00	1.00	1.00	\$28.20	\$28.20	Henry Sharon K
443 210 10 00	1.00	SFD	1.00	1.00	1.00	\$28.20	\$28.20	Wells Family Trust 10-17-90
443 210 11 00	1.00	SFD	1.00	1.00	1.00	\$28.20	\$28.20	Houck Family Trust 08-26-91
443 210 12 00	1.00	SFD	1.00	1.00	1.00	\$28.20	\$28.20	Tweit Deborah L
443 210 13 00	1.00	SFD	1.00	1.00	1.00	\$28.20	\$28.20	Katz Family Trust 05-03-99
443 210 14 00	1.00	SFD	1.00	1.00	1.00	\$28.20	\$28.20	Palmer Sonya D Z
443 210 15 00	1.00	SFD	1.00	1.00	1.00	\$28.20	\$28.20	Phillips-Moriarty Family Trust 08-01-91
443 210 16 00	1.00	SFD	1.00	1.00	1.00	\$28.20	\$28.20	Boyer Family Trust 12-16-97
443 210 17 00	1.00	SFD	1.00	1.00	1.00	\$28.20	\$28.20	Surber Family Trust 12-04-08
443 210 18 00	1.00	SFD	1.00	1.00	1.00	\$28.20	\$28.20	Lombardo Domenic

EXHIBIT C - Assessment Roll (Fiscal Year 2014)
Mission Hills Historic Street Lighting Maintenance Assessment District

Parcel Number	Acres/ Units ⁽¹⁾	Land Use Code ⁽²⁾	Apportionment Factors		Total EBUs	FY 2014 ⁽⁴⁾		Owner Name
			Land Use ⁽²⁾	Benefit ⁽³⁾		Unit Cost	Assessment	
443 210 19 00	1.00	SFD	1.00	1.00	1.00	\$28.20	\$28.20	Brennan Marybeth Trust 10-20-94
443 210 20 00	1.00	SFD	1.00	1.00	1.00	\$28.20	\$28.20	Ehlers Family 1986 Trust 08-28-86
443 210 21 00	1.00	SFD	1.00	1.00	1.00	\$28.20	\$28.20	Davis Family Trust 05-22-00
443 210 22 00	1.00	SFD	1.00	1.00	1.00	\$28.20	\$28.20	Lewis Andrew&Anna Family Trust 12-29-09
443 210 23 00	1.00	SFD	1.00	1.00	1.00	\$28.20	\$28.20	Beltz William F&Pludow Julie I
443 210 24 00	1.00	SFD	1.00	1.00	1.00	\$28.20	\$28.20	Golden Louisa A
443 210 25 00	1.00	SFD	1.00	1.00	1.00	\$28.20	\$28.20	Stewart Kimberly A M
443 210 26 00	1.00	SFD	1.00	1.00	1.00	\$28.20	\$28.20	Ellefson Janet I
443 210 27 00	1.00	SFD	1.00	1.00	1.00	\$28.20	\$28.20	Quinn Martha S
443 210 28 00	1.00	SFD	1.00	1.00	1.00	\$28.20	\$28.20	Bayer Family Trust 12-04-03
443 210 29 00	1.00	SFD	1.00	1.00	1.00	\$28.20	\$28.20	Denenberg Allen&Lynn
443 210 30 00	1.00	SFD	1.00	1.00	1.00	\$28.20	\$28.20	Milot Trust 03-23-10
443 210 31 00	1.00	SFD	1.00	1.00	1.00	\$28.20	\$28.20	Schag Family Trust 10-01-93
443 210 32 00	1.00	SFD	1.00	1.00	1.00	\$28.20	\$28.20	Valenzuela Amparo Trust
443 210 33 00	1.00	SFD	1.00	1.00	1.00	\$28.20	\$28.20	Decorso Living Trust 04-26-00
443 210 34 00	1.00	SFD	1.00	1.00	1.00	\$28.20	\$28.20	Kleinke Family Revocable Trust 03-15-96
443 210 35 00	1.00	SFD	1.00	1.00	1.00	\$28.20	\$28.20	Ivanko David T (Dp)
443 210 36 00	1.00	SFD	1.00	1.00	1.00	\$28.20	\$28.20	Gomez&Amuedo-Dorantes Trust 08-29-06
443 210 37 00	1.00	SFD	1.00	1.00	1.00	\$28.20	\$28.20	Lams J Trust 07-20-01
443 210 38 00	1.00	SFD	1.00	1.00	1.00	\$28.20	\$28.20	Brandon Mark L&Susan A
443 210 39 00	1.00	SFD	1.00	1.00	1.00	\$28.20	\$28.20	Ancowitz Stephen J&Patricia S Family Trust 06-08-94
443 210 40 00	1.00	SFD	1.00	1.00	1.00	\$28.20	\$28.20	St Clair Peter&Raydene Living Trust 05-27-10
443 210 41 00	1.00	SFD	1.00	1.00	1.00	\$28.20	\$28.20	Brown Revocable Trust 12-06-05
443 210 42 00	1.00	SFD	1.00	1.00	1.00	\$28.20	\$28.20	Walton-Lanzetta Family Revocable Trust 02-18-08
443 210 43 00	1.00	SFD	1.00	1.00	1.00	\$28.20	\$28.20	Roberts Revocable Trust 03-04-06
443 210 44 00	1.00	SFD	1.00	1.00	1.00	\$28.20	\$28.20	Niewiadomy Carol A Tr
443 210 45 00	1.00	SFD	1.00	1.00	1.00	\$28.20	\$28.20	Budd Joe&Rose Family Trust 11-21-02
443 210 46 00	1.00	SFD	1.00	1.00	1.00	\$28.20	\$28.20	Simmons E M Trust 04-07-98
443 210 47 00	1.00	SFD	1.00	1.00	1.00	\$28.20	\$28.20	Almager Philip S
443 210 48 00	1.00	SFD	1.00	1.00	1.00	\$28.20	\$28.20	Leavenworth Trust 02-04-93
443 210 49 00	1.00	SFD	1.00	1.00	1.00	\$28.20	\$28.20	Watts Lou D
443 210 50 00	1.00	SFD	1.00	1.00	1.00	\$28.20	\$28.20	Ingrande Marie L Separate Property Trust 01-25-12
443 210 51 00	1.00	SFD	1.00	1.00	1.00	\$28.20	\$28.20	Braley Christopher L&Bales Lauren D
443 210 52 00	1.00	SFD	1.00	1.00	1.00	\$28.20	\$28.20	Jovanovich Peter&Robin
443 210 53 00	1.00	SFD	1.00	1.00	1.00	\$28.20	\$28.20	Castro Ramon&Marian Trust 04-29-96
443 210 54 00	1.00	SFD	1.00	1.00	1.00	\$28.20	\$28.20	Krumholz Revocable Trust 10-06-08
443 210 55 00	1.00	SFD	1.00	1.00	1.00	\$28.20	\$28.20	Benedict George&Rainey D Family Trust 05-31-11
443 210 56 00	1.00	SFD	1.00	1.00	1.00	\$28.20	\$28.20	Rivera Flavio&Audrey R
443 211 01 00	1.00	SFD	1.00	1.00	1.00	\$28.20	\$28.20	Brickson Family Revocable Living Trust 01-05-94
443 211 02 00	1.00	SFD	1.00	1.00	1.00	\$28.20	\$28.20	Hawkinson Howard W&Margaret M 1993 Trust 07-21-93
443 211 03 00	1.00	SFD	1.00	1.00	1.00	\$28.20	\$28.20	Mcginty Bonnie K Revocable Trust 12-05-96
443 211 04 00	1.00	SFD	1.00	1.00	1.00	\$28.20	\$28.20	Mills Family Trust 04-13-12
443 211 05 00	1.00	SFD	1.00	1.00	1.00	\$28.20	\$28.20	Roemer Mark P 2007 Trust 01-25-07
443 211 06 00	1.00	SFD	1.00	1.00	1.00	\$28.20	\$28.20	Pomella Jean Trust 01-03-94
443 211 07 00	1.00	SFD	1.00	1.00	1.00	\$28.20	\$28.20	J Lams Trust 07-20-01
443 211 08 00	1.00	SFD	1.00	1.00	1.00	\$28.20	\$28.20	Hillyard Jason&Lang Michele R
443 211 09 00	1.00	SFD	1.00	1.00	1.00	\$28.20	\$28.20	Fern Albert J Jr Trust 10-27-00
443 211 10 00	1.00	SFD	1.00	1.00	1.00	\$28.20	\$28.20	Mcguffey Arlie T Jr&Josefina R
443 211 11 00	1.00	SFD	1.00	1.00	1.00	\$28.20	\$28.20	Stumpf Joan M <Aka Stark Joan M>
443 211 12 00	1.00	SFD	1.00	1.00	1.00	\$28.20	\$28.20	Hill Francis U&Teresa C 1992 Trust
443 211 13 00	1.00	SFD	1.00	1.00	1.00	\$28.20	\$28.20	Sand Josiah&Abbie Trust 05-24-04
443 211 14 00	1.00	SFD	1.00	1.00	1.00	\$28.20	\$28.20	Mclean Kristi A Living Trust 10-29-10
443 211 15 00	1.00	SFD	1.00	1.00	1.00	\$28.20	\$28.20	Schwillinski Roland H
443 211 16 00	1.00	SFD	1.00	1.00	1.00	\$28.20	\$28.20	Cramp Edward&Daniella

EXHIBIT C - Assessment Roll (Fiscal Year 2014)
Mission Hills Historic Street Lighting Maintenance Assessment District

Parcel Number	Acres/ Units ⁽¹⁾	Land Use Code ⁽²⁾	Apportionment Factors		Total EBUs	FY 2014 ⁽⁴⁾		Owner Name
			Land Use ⁽²⁾	Benefit ⁽³⁾		Unit Cost	Assessment	
443 211 17 00	1.00	SFD	1.00	1.00	1.00	\$28.20	\$28.20	Socol Family Trust 07-06-04
443 211 18 00	1.00	SFD	1.00	1.00	1.00	\$28.20	\$28.20	Madden George J&Sandra K
443 211 19 00	1.00	SFD	1.00	1.00	1.00	\$28.20	\$28.20	Spurgin Living Trust 11-05-92
443 211 20 00	1.00	SFD	1.00	1.00	1.00	\$28.20	\$28.20	Stepner Family Trust 05-11-00
443 211 21 00	1.00	SFD	1.00	1.00	1.00	\$28.20	\$28.20	Baker Family Trust 02-23-90
443 211 22 00	1.00	SFD	1.00	1.00	1.00	\$28.20	\$28.20	Haubert Mary J
443 211 23 00	1.00	SFD	1.00	1.00	1.00	\$28.20	\$28.20	Reggev Family Trust 10-23-06
443 211 24 00	1.00	SFD	1.00	1.00	1.00	\$28.20	\$28.20	Burgunder Family Trust 02-10-04
443 211 25 00	1.00	SFD	1.00	1.00	1.00	\$28.20	\$28.20	Hicks Trinidad L Trust 04-12-96
443 211 26 00	1.00	SFD	1.00	1.00	1.00	\$28.20	\$28.20	Watson Family Trust 01-18-90
443 211 27 00	1.00	SFD	1.00	1.00	1.00	\$28.20	\$28.20	Leathers Robert S&Nickel Cheryl A
443 211 28 00	1.00	SFD	1.00	1.00	1.00	\$28.20	\$28.20	Gray Maureen
443 211 29 00	1.00	SFD	1.00	1.00	1.00	\$28.20	\$28.20	Davidson Alan D Est Of
443 211 30 00	1.00	SFD	1.00	1.00	1.00	\$28.20	\$28.20	Oakes Charles C Trust 08-25-08
443 211 31 00	1.00	SFD	1.00	1.00	1.00	\$28.20	\$28.20	Townsend/Ward Trust 06-08-98
443 211 32 00	1.00	SFD	1.00	1.00	1.00	\$28.20	\$28.20	Gerace Larry R
443 211 33 00	1.00	SFD	1.00	1.00	1.00	\$28.20	\$28.20	Butcher Janis L Tr
443 211 34 00	1.00	SFD	1.00	1.00	1.00	\$28.20	\$28.20	Fedderson Falk&Mariana O
443 211 35 00	1.00	SFD	1.00	1.00	1.00	\$28.20	\$28.20	Devlin Family Trust 04-03-06
443 211 36 00	1.00	SFD	1.00	1.00	1.00	\$28.20	\$28.20	Spillane Family Trust 07-30-12
443 211 37 00	1.00	SFD	1.00	1.00	1.00	\$28.20	\$28.20	Henson W R Family Trust 04-08-03
443 211 38 00	1.00	SFD	1.00	1.00	1.00	\$28.20	\$28.20	Hopkins Fonda Trust 11-01-03
443 211 39 00	1.00	SFD	1.00	1.00	1.00	\$28.20	\$28.20	Miceli Robert C&Carmen T
443 211 40 00	1.00	SFD	1.00	1.00	1.00	\$28.20	\$28.20	Buscemi Trust 06-30-00
443 211 41 00	1.00	SFD	1.00	1.00	1.00	\$28.20	\$28.20	Borzuch Robert S (Dp)
443 211 42 00	1.00	SFD	1.00	1.00	1.00	\$28.20	\$28.20	Banta Michelle
443 211 43 00	1.00	SFD	1.00	1.00	1.00	\$28.20	\$28.20	Dutschmann Claudio A R&Rita M R
443 211 44 00	1.00	SFD	1.00	1.00	1.00	\$28.20	\$28.20	Newmark Erik&Cadena
443 211 45 00	1.00	SFD	1.00	1.00	1.00	\$28.20	\$28.20	Ewalt Steve M&Roxanne C
443 211 46 00	1.00	SFD	1.00	1.00	1.00	\$28.20	\$28.20	Lyon Community Property 1999 Trust 12-23-99
443 211 47 00	1.00	SFD	1.00	1.00	1.00	\$28.20	\$28.20	Oconnor Patrick J
443 211 48 00	1.00	SFD	1.00	1.00	1.00	\$28.20	\$28.20	Morago-Flynn Trust 2 06-29-99
443 211 49 00	1.00	SFD	1.00	1.00	1.00	\$28.20	\$28.20	Staab Kent J&Deena E Trust 07-06-95
443 211 50 00	1.00	SFD	1.00	1.00	1.00	\$28.20	\$28.20	Freedman Charles&Beverly A Family Revocable Trust 11-11-0
443 211 51 00	1.00	SFD	1.00	1.00	1.00	\$28.20	\$28.20	Lau Beverly D
443 211 52 00	1.00	SFD	1.00	1.00	1.00	\$28.20	\$28.20	Hearst Family Trust 06-30-09
443 211 53 00	1.00	SFD	1.00	1.00	1.00	\$28.20	\$28.20	Bowers Barbara J Family Trust 04-07-05
443 211 54 00	1.00	SFD	1.00	1.00	1.00	\$28.20	\$28.20	Mendoza Family Trust 02-03-09
443 211 55 00	1.00	SFD	1.00	1.00	1.00	\$28.20	\$28.20	Snyder Joshua A
443 211 56 00	1.00	SFD	1.00	1.00	1.00	\$28.20	\$28.20	Twilegar Family Trust 11-06-07
443 211 57 00	1.00	SFD	1.00	1.00	1.00	\$28.20	\$28.20	Abernathy George E
443 211 58 00	1.00	SFD	1.00	1.00	1.00	\$28.20	\$28.20	Mcnew Michael R&Garcia Diana
443 211 59 00	1.00	SFD	1.00	1.00	1.00	\$28.20	\$28.20	Walter Family Trust 12-08-92
443 211 60 00	1.00	SFD	1.00	1.00	1.00	\$28.20	\$28.20	Wright Doris E Trust 12-30-98
443 211 61 00	1.00	SFD	1.00	1.00	1.00	\$28.20	\$28.20	Singleton Michael L&Sharon A
443 211 62 00	1.00	SFD	1.00	1.00	1.00	\$28.20	\$28.20	Dillon Margaret C Revocable Trust 11-19-98
443 211 63 00	1.00	SFD	1.00	1.00	1.00	\$28.20	\$28.20	Amundson Stanley A&Pamela C Trs
443 250 01 00	1.00	SFD	1.00	1.00	1.00	\$28.20	\$28.20	Reily Family Living 1998 Trust 09-26-98
443 250 02 00	1.00	SFD	1.00	1.00	1.00	\$28.20	\$28.20	Fletcher Family Revocable Trust 01-23-02
443 250 03 00	1.00	SFD	1.00	1.00	1.00	\$28.20	\$28.20	Frase Maria M
443 250 04 00	1.00	SFD	1.00	1.00	1.00	\$28.20	\$28.20	Dantchev Cyril J&Lester-Dantchev Elisabeth F
443 250 05 00	1.00	SFD	1.00	1.00	1.00	\$28.20	\$28.20	Sandel/Marich Trust 02-13-08
443 250 06 00	1.00	SFD	1.00	1.00	1.00	\$28.20	\$28.20	Ingrande Joe&Lucille Family Trust 07-26-97
443 250 07 00	1.00	SFD	1.00	1.00	1.00	\$28.20	\$28.20	Hager Barry E&Hilary A

EXHIBIT C - Assessment Roll (Fiscal Year 2014)
Mission Hills Historic Street Lighting Maintenance Assessment District

Parcel Number	Acres/ Units ⁽¹⁾	Land Use Code ⁽²⁾	Apportionment Factors		Total EBUs	FY 2014 ⁽⁴⁾		Owner Name
			Land Use ⁽²⁾	Benefit ⁽³⁾		Unit Cost	Assessment	
443 250 08 00	1.00	SFD	1.00	1.00	1.00	\$28.20	\$28.20	Mcguire Larry L&Jennifer A
443 250 09 00	1.00	SFD	1.00	1.00	1.00	\$28.20	\$28.20	Keeney Family Trust 05-10-03
443 250 10 00	1.00	SFD	1.00	1.00	1.00	\$28.20	\$28.20	Lasry-Snyder Trust 11-27-06
443 250 11 00	1.00	SFD	1.00	1.00	1.00	\$28.20	\$28.20	Nash James R&Wendy
443 250 12 00	1.00	SFD	1.00	1.00	1.00	\$28.20	\$28.20	Morris Elizabeth C Living Trust 10-31-07
443 250 13 00	1.00	SFD	1.00	1.00	1.00	\$28.20	\$28.20	Cardall Family Trust 11-02-90
443 250 14 00	1.00	SFD	1.00	1.00	1.00	\$28.20	\$28.20	Dewart Beverly J
443 250 15 00	1.00	SFD	1.00	1.00	1.00	\$28.20	\$28.20	Schwab Richard&Kim
443 250 16 00	1.00	SFD	1.00	1.00	1.00	\$28.20	\$28.20	Chermak Michael D&Sandra L
443 250 17 00	1.00	SFD	1.00	1.00	1.00	\$28.20	\$28.20	Maclean Karen V Tr
443 250 18 00	1.00	SFD	1.00	1.00	1.00	\$28.20	\$28.20	Davies Darlene G
443 250 19 00	1.00	SFD	1.00	1.00	1.00	\$28.20	\$28.20	Haase Walter E Trust 01-10-03
443 250 20 00	1.00	SFD	1.00	1.00	1.00	\$28.20	\$28.20	Roetker Family Trust 12-09-05
443 250 21 00	1.00	SFD	1.00	1.00	1.00	\$28.20	\$28.20	Hughes Family Trust 11-05-89
443 250 22 00	1.00	SFD	1.00	1.00	1.00	\$28.20	\$28.20	Kellner Community Property Trust 10-19-01
443 250 23 00	1.00	SFD	1.00	1.00	1.00	\$28.20	\$28.20	Longstreth Family Trust 10-03-01
443 250 24 00	1.00	SFD	1.00	1.00	1.00	\$28.20	\$28.20	Flaherty James H Jr&Patricia A
443 250 25 00	1.00	SFD	1.00	1.00	1.00	\$28.20	\$28.20	Freer Graham R&Diane A
443 250 26 00	1.00	SFD	1.00	1.00	1.00	\$28.20	\$28.20	Mcgee Family Trust 02-28-00
443 250 27 00	1.00	SFD	1.00	1.00	1.00	\$28.20	\$28.20	Gonzales Freeman 2013 Family Trust 01-02-13
443 250 28 00	1.00	SFD	1.00	1.00	1.00	\$28.20	\$28.20	Backer Janet H Family Trust 04-01-93
443 250 29 00	1.00	SFD	1.00	1.00	1.00	\$28.20	\$28.20	Stephens Susan G Separate Property Trust 01-04-01
443 250 30 00	1.00	SFD	1.00	1.00	1.00	\$28.20	\$28.20	Allen Helen
443 250 31 00	1.00	SFD	1.00	1.00	1.00	\$28.20	\$28.20	Wisehart Gary D&Elizabeth A
443 250 32 00	1.00	SFD	1.00	1.00	1.00	\$28.20	\$28.20	Conner Judith Trust 01-02-97
443 250 33 00	1.00	SFD	1.00	1.00	1.00	\$28.20	\$28.20	Lettington Drew T&Randie D
443 250 34 00	0.01	OSP	0.00	1.00	0.00	\$28.20	\$0.00	City Of San Diego
443 250 35 00	1.00	SFD	1.00	1.00	1.00	\$28.20	\$28.20	Fernandes Adrian&Robley A
443 250 36 00	1.00	SFD	1.00	1.00	1.00	\$28.20	\$28.20	Korb Duane P&Jean M
443 250 37 00	1.00	SFD	1.00	1.00	1.00	\$28.20	\$28.20	Douglas Jake B&Becker Amy
443 250 38 00	1.00	SFD	1.00	1.00	1.00	\$28.20	\$28.20	Skwarlo Family Trust 02-13-03
443 250 39 00	1.00	SFD	1.00	1.00	1.00	\$28.20	\$28.20	Claypool Family Living Trust 11-30-99
443 250 40 00	1.00	SFD	1.00	1.00	1.00	\$28.20	\$28.20	Kissling George Trust 01-09-92
443 250 41 00	1.00	SFD	1.00	1.00	1.00	\$28.20	\$28.20	Wustman Brandon A&Aujla Sandeep V
443 250 42 00	1.00	SFD	1.00	1.00	1.00	\$28.20	\$28.20	Parker George A&Lila V Joint Trust 05-31-91
443 250 43 00	1.00	SFD	1.00	1.00	1.00	\$28.20	\$28.20	Kaye Anitra L
443 250 44 00	1.00	SFD	1.00	1.00	1.00	\$28.20	\$28.20	Moceri Salvatore T&Linda M
443 250 45 00	1.00	SFD	1.00	1.00	1.00	\$28.20	\$28.20	Gabhart Robert O&Lawrence Karen
443 250 46 00	1.00	SFD	1.00	1.00	1.00	\$28.20	\$28.20	Thompson Lori A
443 250 47 00	1.00	SFD	1.00	1.00	1.00	\$28.20	\$28.20	Adler Family 2008 Trust 06-17-08
443 250 48 00	1.00	SFD	1.00	1.00	1.00	\$28.20	\$28.20	Andersen Taryl L
443 250 49 00	1.00	SFD	1.00	1.00	1.00	\$28.20	\$28.20	Eastman John W
443 250 50 00	1.00	SFD	1.00	1.00	1.00	\$28.20	\$28.20	Platt Parker F Trust 02-20-03
443 250 51 00	1.00	SFD	1.00	1.00	1.00	\$28.20	\$28.20	Giacalone Karla R Trust 04-23-03
443 250 52 00	1.00	SFD	1.00	1.00	1.00	\$28.20	\$28.20	Tuttle Eric
443 250 53 00	1.00	SFD	1.00	1.00	1.00	\$28.20	\$28.20	Granlee Edith M Est Of
443 250 54 00	1.00	SFD	1.00	1.00	1.00	\$28.20	\$28.20	Mcmahon Merri M Inter Vivos 1990 Trust 12-06-90
443 250 55 00	1.00	SFD	1.00	1.00	1.00	\$28.20	\$28.20	Maginn William E
443 251 01 00	1.00	SFD	1.00	1.00	1.00	\$28.20	\$28.20	Benitez Jessie M Trust 01-30-95
443 251 02 00	1.00	SFD	1.00	1.00	1.00	\$28.20	\$28.20	Reinagel Pamela Trust 09-22-10
443 251 03 00	1.00	SFD	1.00	1.00	1.00	\$28.20	\$28.20	Pulos Michael&Marquardt Stephen
443 251 04 00	1.00	SFD	1.00	1.00	1.00	\$28.20	\$28.20	Johnston Family Trust 09-26-94
443 251 05 00	1.00	SFD	1.00	1.00	1.00	\$28.20	\$28.20	Odoriso Bryan P&Laurenne S
443 251 06 00	1.00	SFD	1.00	1.00	1.00	\$28.20	\$28.20	Pizzinal Jason&Concetta Family Trust 07-25-06

EXHIBIT C - Assessment Roll (Fiscal Year 2014)
Mission Hills Historic Street Lighting Maintenance Assessment District

Parcel Number	Acres/ Units ⁽¹⁾	Land Use Code ⁽²⁾	Apportionment Factors		Total EBUs	FY 2014 ⁽⁴⁾		Owner Name
			Land Use ⁽²⁾	Benefit ⁽³⁾		Unit Cost	Assessment	
443 251 07 00	1.00	SFD	1.00	1.00	1.00	\$28.20	\$28.20	Marquez Moses Living Trust 06-18-07
443 251 08 00	1.00	SFD	1.00	1.00	1.00	\$28.20	\$28.20	Hoffman Revocable Trust 10-05-12
443 251 09 00	1.00	SFD	1.00	1.00	1.00	\$28.20	\$28.20	Johnston Scott L
443 251 10 00	1.00	SFD	1.00	1.00	1.00	\$28.20	\$28.20	Kelner Gregory Trust 03-10-04
443 251 11 00	1.00	SFD	1.00	1.00	1.00	\$28.20	\$28.20	Defrates Family Trust 03-02-05
443 251 12 00	1.00	SFD	1.00	1.00	1.00	\$28.20	\$28.20	Aries Barnard Trust 03-13-01
443 251 13 00	1.00	SFD	1.00	1.00	1.00	\$28.20	\$28.20	White Bill&Loretta Living Trust 09-20-02
443 251 14 00	1.00	SFD	1.00	1.00	1.00	\$28.20	\$28.20	Lidstrom Raymond L&Suzanne S Trust
443 251 15 00	1.00	SFD	1.00	1.00	1.00	\$28.20	\$28.20	Wilson Bruce A&Grace E
443 251 16 00	1.00	SFD	1.00	1.00	1.00	\$28.20	\$28.20	Edwards Family Trust 11-02-99
443 251 17 00	1.00	SFD	1.00	1.00	1.00	\$28.20	\$28.20	Mission Hills Methodist Church
443 251 18 00	1.00	SFD	1.00	1.00	1.00	\$28.20	\$28.20	Sevilla C D Family Trust 01-11-07
443 251 19 00	1.00	SFD	1.00	1.00	1.00	\$28.20	\$28.20	Sparks-Shanks Family Trust 04-25-91
443 251 20 00	1.00	SFD	1.00	1.00	1.00	\$28.20	\$28.20	Shumaker Peter R&Patrice D
443 251 21 00	1.00	SFD	1.00	1.00	1.00	\$28.20	\$28.20	Fisher Bena
443 251 22 00	1.00	SFD	1.00	1.00	1.00	\$28.20	\$28.20	Oconnor Family Trust (Trust B) 02-28-81
443 251 23 00	1.00	SFD	1.00	1.00	1.00	\$28.20	\$28.20	Lavine Family Trust 08-07-08
443 251 24 00	1.00	SFD	1.00	1.00	1.00	\$28.20	\$28.20	Feeley Michael E&Mary B
443 251 25 00	1.00	SFD	1.00	1.00	1.00	\$28.20	\$28.20	Hagen Amy J
443 251 26 00	1.00	SFD	1.00	1.00	1.00	\$28.20	\$28.20	Pastuszko Peter&Abramson Wendy
443 251 27 00	1.00	SFD	1.00	1.00	1.00	\$28.20	\$28.20	Rapp Michael O&Barbara
443 251 28 00	1.00	SFD	1.00	1.00	1.00	\$28.20	\$28.20	Torres Paul
443 251 29 00	1.00	SFD	1.00	1.00	1.00	\$28.20	\$28.20	Selective Holdings L L C
443 251 30 00	1.00	SFD	1.00	1.00	1.00	\$28.20	\$28.20	Quinn Martha S
443 251 31 00	1.00	SFD	1.00	1.00	1.00	\$28.20	\$28.20	Lansing William&Maria Trust 10-19-01
443 251 32 00	1.00	SFD	1.00	1.00	1.00	\$28.20	\$28.20	Lukasky Lois E
443 251 33 00	1.00	SFD	1.00	1.00	1.00	\$28.20	\$28.20	Schmieg-Watters Family Trust 11-30-11
443 251 34 00	1.00	SFD	1.00	1.00	1.00	\$28.20	\$28.20	Camin Marcos G&Russell Patricia L
443 251 35 00	1.00	SFD	1.00	1.00	1.00	\$28.20	\$28.20	Buccigross/Berelowitz Family 1999 Trust 03-29-99
443 251 36 00	1.00	SFD	1.00	1.00	1.00	\$28.20	\$28.20	Blair Jeffrey R&Jane R
443 251 37 00	1.00	SFD	1.00	1.00	1.00	\$28.20	\$28.20	Cane Family Trust 11-23-10
443 270 01 00	1.00	SFD	1.00	1.00	1.00	\$28.20	\$28.20	Zaharopoulos Pat Trust 04-19-93
443 270 02 00	1.00	SFD	1.00	1.00	1.00	\$28.20	\$28.20	Wahlen Patricia P
443 270 23 00	0.20	COM	40.00	0.60	4.80	\$28.20	\$135.36	Porras Revocable Family Bypass Trust 09-18-90
443 270 24 00	0.00	SFD	1.00	1.00	0.00	\$28.20	\$0.00	Porras Revocable Family Survivors Trust 09-18-90
443 340 01 00	1.00	SFD	1.00	1.00	1.00	\$28.20	\$28.20	Rattner Matthew H Trust 07-15-05
443 340 02 00	1.00	SFD	1.00	1.00	1.00	\$28.20	\$28.20	Speas Dennis W&Shelby L
443 340 03 00	1.00	SFD	1.00	1.00	1.00	\$28.20	\$28.20	Mcloughlin Revocable Family Trust 09-17-90
443 340 04 00	1.00	SFD	1.00	1.00	1.00	\$28.20	\$28.20	Hahn Chiriboga Family Trust 05-18-01
443 340 05 00	1.00	SFD	1.00	1.00	1.00	\$28.20	\$28.20	Eriksson Marguerite A Trust 1990
443 340 06 00	1.00	SFD	1.00	1.00	1.00	\$28.20	\$28.20	Hanahan Christopher&Juliet
443 340 07 00	1.00	SFD	1.00	1.00	1.00	\$28.20	\$28.20	Pulido Alberto&Spencer Irene
443 340 08 00	1.00	SFD	1.00	1.00	1.00	\$28.20	\$28.20	Congregation Of The Sisters Of Charity Of The Incarnate Word
443 340 09 00	1.00	SFD	1.00	1.00	1.00	\$28.20	\$28.20	Hartman Brian&Tiefenbacher Claudia
443 340 10 00	1.00	SFD	1.00	1.00	1.00	\$28.20	\$28.20	Merrill Daniel E 2006 Trust
443 340 11 00	1.00	SFD	1.00	1.00	1.00	\$28.20	\$28.20	David-Dimarino Revocable Trust 03-06-08
443 340 12 00	1.00	SFD	1.00	1.00	1.00	\$28.20	\$28.20	Dorsey Hideko Trust 01-10-86
443 340 13 00	1.00	SFD	1.00	1.00	1.00	\$28.20	\$28.20	Wallen Farrelly Trust 12-12-12
443 340 14 00	1.00	SFD	1.00	1.00	1.00	\$28.20	\$28.20	Faucett Family Trust 02-13-89
443 340 15 00	1.00	SFD	1.00	1.00	1.00	\$28.20	\$28.20	St Clair Peter&Raydene Living Trust 05-27-10
443 340 16 00	1.00	SFD	1.00	1.00	1.00	\$28.20	\$28.20	Delavega Family Trust 08-05-03
443 340 17 00	1.00	SFD	1.00	1.00	1.00	\$28.20	\$28.20	Madonian Arthur
443 340 18 00	1.00	SFD	1.00	1.00	1.00	\$28.20	\$28.20	Augustine Barbara S Trust 03-03-92
443 340 19 00	1.00	SFD	1.00	1.00	1.00	\$28.20	\$28.20	Grohman Family Trust 09-23-09

EXHIBIT C - Assessment Roll (Fiscal Year 2014)
Mission Hills Historic Street Lighting Maintenance Assessment District

Parcel Number	Acres/ Units ⁽¹⁾	Land Use Code ⁽²⁾	Apportionment Factors		Total EBUs	FY 2014 ⁽⁴⁾		Owner Name
			Land Use ⁽²⁾	Benefit ⁽³⁾		Unit Cost	Assessment	
443 340 20 00	1.00	SFD	1.00	1.00	1.00	\$28.20	\$28.20	Castiglione-Pollock Trust 12-03-12
443 340 21 00	1.00	SFD	1.00	1.00	1.00	\$28.20	\$28.20	Corbin Stamp W
443 340 22 00	0.00	SFD	1.00	1.00	0.00	\$28.20	\$0.00	E M Trust 06-01-01
443 340 23 00	0.00	SFD	1.00	1.00	0.00	\$28.20	\$0.00	2Mg Trust 07-26-01
443 340 24 00	1.00	SFD	1.00	1.00	1.00	\$28.20	\$28.20	E M Trust 06-01-01
443 340 25 00	1.00	SFD	1.00	1.00	1.00	\$28.20	\$28.20	Stoia Laura K
443 340 26 00	1.00	SFD	1.00	1.00	1.00	\$28.20	\$28.20	Plevin Fred M&Shoenberg Laura J Trust 09-05-96
443 370 02 00	1.00	SFD	1.00	1.00	1.00	\$28.20	\$28.20	Andersen Family Trust 11-08-04
443 370 03 00	1.00	SFD	1.00	1.00	1.00	\$28.20	\$28.20	Vanduyne William F
443 370 04 00	1.00	SFD	1.00	1.00	1.00	\$28.20	\$28.20	Engelhorn Katherine T Tr
443 370 05 00	1.00	SFD	1.00	1.00	1.00	\$28.20	\$28.20	Menczer Jesse
443 370 06 00	1.00	SFD	1.00	1.00	1.00	\$28.20	\$28.20	Hunt Family Trust B 05-30-90
443 370 09 00	1.00	SFD	1.00	1.00	1.00	\$28.20	\$28.20	Loftus/Fernando Trust 02-22-11
443 370 12 00	1.00	SFD	1.00	1.00	1.00	\$28.20	\$28.20	Gilpen Franklin M
443 370 13 00	1.00	SFD	1.00	1.00	1.00	\$28.20	\$28.20	Slaman Norma
443 370 20 00	1.00	SFD	1.00	1.00	1.00	\$28.20	\$28.20	Kaufhold Marilyn J Family Trust 10-29-98
443 370 21 00	1.00	SFD	1.00	1.00	1.00	\$28.20	\$28.20	Anderson Lou Trust 11-06-03
443 370 22 00	1.00	SFD	1.00	1.00	1.00	\$28.20	\$28.20	Cain Family Trust 05-19-92
443 370 23 00	1.00	SFD	1.00	1.00	1.00	\$28.20	\$28.20	Bates Marilyn 2006 Trust 11-07-06
443 370 24 00	1.00	SFD	1.00	1.00	1.00	\$28.20	\$28.20	Welshans David A&Nora E
443 370 25 00	1.00	SFD	1.00	1.00	1.00	\$28.20	\$28.20	Chase Family Trust 07-21-00
443 370 26 00	1.00	SFD	1.00	1.00	1.00	\$28.20	\$28.20	Netzer Gregory
443 370 27 00	1.00	SFD	1.00	1.00	1.00	\$28.20	\$28.20	Lewin Family 2010 Trust 10-28-10
443 370 28 00	1.00	SFD	1.00	1.00	1.00	\$28.20	\$28.20	Lawson Family Trust 11-21-05
443 370 29 00	1.00	SFD	1.00	1.00	1.00	\$28.20	\$28.20	Woodmansee/Kempton Trust 10-31-12
443 370 30 00	2.00	DUP	0.70	1.00	1.40	\$28.20	\$39.48	Mitchell Family Trust B 06-03-81
443 370 31 00	1.00	SFD	1.00	1.00	1.00	\$28.20	\$28.20	Lemke Family Trust 08-21-03
443 370 38 00	1.00	SFD	1.00	1.00	1.00	\$28.20	\$28.20	Seaburg Debra L Trust 06-27-95
443 370 39 00	1.00	SFD	1.00	1.00	1.00	\$28.20	\$28.20	Pekin 1992 Family Trust
443 370 40 00	1.00	SFD	1.00	1.00	1.00	\$28.20	\$28.20	Smith Linda Ruth Revocable 2009 Trust 08-21-09
443 370 41 00	1.00	SFD	1.00	1.00	1.00	\$28.20	\$28.20	Clafy Kimberly C
443 370 42 00	0.20	OSP	0.00	1.00	0.00	\$28.20	\$0.00	City Of San Diego
443 370 43 00	1.00	SFD	1.00	1.00	1.00	\$28.20	\$28.20	Mcdonald Eric C Revocable Trust No 1 12-03-98
443 370 44 00	1.00	SFD	1.00	1.00	1.00	\$28.20	\$28.20	Boles Darin J&Lawrence Sharon M
443 370 45 00	1.00	SFD	1.00	1.00	1.00	\$28.20	\$28.20	Smith Dorothy Toulon Tr
443 370 46 00	1.00	SFD	1.00	1.00	1.00	\$28.20	\$28.20	Robinson Virginia P Family Trust 02-13-09
443 370 47 00	1.00	SFD	1.00	1.00	1.00	\$28.20	\$28.20	Bowie Peter W&Sarah V Trs
443 370 48 00	1.00	SFD	1.00	1.00	1.00	\$28.20	\$28.20	Spelman Robert G
443 370 49 00	0.00	SFD	1.00	1.00	0.00	\$28.20	\$0.00	Spelman Robert G
443 370 50 00	1.00	SFD	1.00	1.00	1.00	\$28.20	\$28.20	Bushman Robert E Trust 01-09-02
443 370 51 00	1.00	SFD	1.00	1.00	1.00	\$28.20	\$28.20	Montgomery Family Trust 02-10-82
443 370 52 00	1.00	SFD	1.00	1.00	1.00	\$28.20	\$28.20	Moll Rodney L&Ann E Family Trust 11-19-96
443 370 53 00	1.00	SFD	1.00	1.00	1.00	\$28.20	\$28.20	Miller Leroy N&Suree G Trs
443 370 54 00	1.00	SFD	1.00	1.00	1.00	\$28.20	\$28.20	Akin Debra A Trust 05-21-12
443 370 55 00	1.00	SFD	1.00	1.00	1.00	\$28.20	\$28.20	Hoefler Iii Family Trust 11-08-02
443 370 56 00	1.00	SFD	1.00	1.00	1.00	\$28.20	\$28.20	Hodges Helen J Revocable Living Trust 12-06-07
443 370 57 00	1.00	SFD	1.00	1.00	1.00	\$28.20	\$28.20	Heidemann Raymond L Trust 07-28-00
443 401 01 00	1.00	SFD	1.00	1.00	1.00	\$28.20	\$28.20	Boland Matthew M
443 401 02 00	1.00	SFD	1.00	1.00	1.00	\$28.20	\$28.20	Phelps Harold R Jr&Fara M
443 401 03 00	1.00	SFD	1.00	1.00	1.00	\$28.20	\$28.20	Saunders John A
443 401 04 00	1.00	SFD	1.00	1.00	1.00	\$28.20	\$28.20	Breslauer Michael D&Levine Stefanie E
443 401 05 00	1.00	SFD	1.00	1.00	1.00	\$28.20	\$28.20	Woods Revocable Family 2005 Trust 07-29-05
443 401 06 00	1.00	SFD	1.00	1.00	1.00	\$28.20	\$28.20	Schindles Bruce&Janis-Schindles Marie
443 401 07 00	1.00	SFD	1.00	1.00	1.00	\$28.20	\$28.20	Acosta Jose A&Grebenc Mary L

EXHIBIT C - Assessment Roll (Fiscal Year 2014)
Mission Hills Historic Street Lighting Maintenance Assessment District

Parcel Number	Acres/ Units ⁽¹⁾	Land Use Code ⁽²⁾	Apportionment Factors		Total EBUs	FY 2014 ⁽⁴⁾		Owner Name
			Land Use ⁽²⁾	Benefit ⁽³⁾		Unit Cost	Assessment	
443 401 08 00	1.00	SFD	1.00	1.00	1.00	\$28.20	\$28.20	Bradshaw Mark Revocable 2012 Trust
443 401 09 00	1.00	SFD	1.00	1.00	1.00	\$28.20	\$28.20	Mithun Robin
443 401 10 00	1.00	SFD	1.00	1.00	1.00	\$28.20	\$28.20	Norton Margareta E Trust 07-08-05
443 401 11 00	1.00	SFD	1.00	1.00	1.00	\$28.20	\$28.20	Preston David L&Jeana M Trs
443 401 12 00	1.00	SFD	1.00	1.00	1.00	\$28.20	\$28.20	Harris Family Trust 08-26-96
443 401 13 00	1.00	SFD	1.00	1.00	1.00	\$28.20	\$28.20	Mitchell Family Trust B 06-03-81
443 401 14 00	2.00	DUP	0.70	1.00	1.40	\$28.20	\$39.48	Savellano Carolyn C
443 402 01 00	1.00	SFD	1.00	1.00	1.00	\$28.20	\$28.20	Blankinship Mary J Family Trust 08-05-99
443 402 02 00	1.00	SFD	1.00	1.00	1.00	\$28.20	\$28.20	Rabin Michael&Katherine
443 402 03 00	1.00	SFD	1.00	1.00	1.00	\$28.20	\$28.20	Worland Hugh A Trust 03-03-03
443 402 04 00	1.00	SFD	1.00	1.00	1.00	\$28.20	\$28.20	Levine Jerry&Karen J
443 402 05 00	1.00	SFD	1.00	1.00	1.00	\$28.20	\$28.20	Bowlus Lee H
443 402 06 00	1.00	SFD	1.00	1.00	1.00	\$28.20	\$28.20	Summers E R Trust 06-01-01
443 402 07 00	1.00	SFD	1.00	1.00	1.00	\$28.20	\$28.20	Dorsey Richard&Cheryl
443 402 08 00	1.00	SFD	1.00	1.00	1.00	\$28.20	\$28.20	Hillman Family Trust 06-17-91
443 402 09 00	1.00	SFD	1.00	1.00	1.00	\$28.20	\$28.20	Bradshaw John B
443 402 10 00	1.00	SFD	1.00	1.00	1.00	\$28.20	\$28.20	Cooke Family Trust 05-01-02
443 402 11 00	1.00	SFD	1.00	1.00	1.00	\$28.20	\$28.20	Morgan Thomas S Irrevocable Family Trust 01-30-98
443 402 12 00	1.00	SFD	1.00	1.00	1.00	\$28.20	\$28.20	Schereschewsky Susan B Tr
443 402 13 00	1.00	SFD	1.00	1.00	1.00	\$28.20	\$28.20	David Lee Trust 09-10-91
443 402 14 00	1.00	SFD	1.00	1.00	1.00	\$28.20	\$28.20	Repp Carmel Tr
443 402 15 00	1.00	SFD	1.00	1.00	1.00	\$28.20	\$28.20	Silveira Douglas S Family Trust 05-11-07
443 402 16 00	1.00	SFD	1.00	1.00	1.00	\$28.20	\$28.20	Gonzalez Kathleen
443 402 17 00	1.00	SFD	1.00	1.00	1.00	\$28.20	\$28.20	Smith Family Trust 08-27-07
443 402 18 00	1.00	SFD	1.00	1.00	1.00	\$28.20	\$28.20	Jacobs Family Revocable Trust 06-02-98
443 402 19 00	1.00	SFD	1.00	1.00	1.00	\$28.20	\$28.20	Charmasson Henri J A&Marcia F
443 402 20 00	1.00	SFD	1.00	1.00	1.00	\$28.20	\$28.20	Benaroya Alan G Family Trust 09-01-05
443 402 21 00	1.00	SFD	1.00	1.00	1.00	\$28.20	\$28.20	Welsh Sean&Martha J
443 402 22 00	1.00	SFD	1.00	1.00	1.00	\$28.20	\$28.20	Goltz Family Trust 05-21-96
443 402 23 00	1.00	SFD	1.00	1.00	1.00	\$28.20	\$28.20	Ingram Family Trust 06-24-98
443 402 24 00	1.00	SFD	1.00	1.00	1.00	\$28.20	\$28.20	Wahl Geoff&Parker Barbara A Trs
443 402 25 00	1.00	SFD	1.00	1.00	1.00	\$28.20	\$28.20	Kelly John L Revocable Trust 10-21-08
443 402 26 00	1.00	SFD	1.00	1.00	1.00	\$28.20	\$28.20	Zamost Barry G&Cynthia L Trs
443 402 27 00	2.00	DUP	0.70	1.00	1.40	\$28.20	\$39.48	Israel Family Trust 07-13-00
443 402 28 00	1.00	SFD	1.00	1.00	1.00	\$28.20	\$28.20	White Family Trust 12-04-09
443 402 29 00	1.00	SFD	1.00	1.00	1.00	\$28.20	\$28.20	Baldwin Frank F&R Michelle
443 421 01 00	1.00	SFD	1.00	1.00	1.00	\$28.20	\$28.20	Hendrickson Kenneth S&Carole A
443 421 02 00	2.00	DUP	0.70	1.00	1.40	\$28.20	\$39.48	White Family Trust 08-23-94
443 421 03 00	2.00	DUP	0.70	1.00	1.40	\$28.20	\$39.48	Garrett Connie L
443 421 04 00	1.00	SFD	1.00	1.00	1.00	\$28.20	\$28.20	Gora Family Trust 05-16-94
443 421 05 00	1.00	SFD	1.00	1.00	1.00	\$28.20	\$28.20	Quillin William H&Deborah L Trust 02-14-80
443 421 06 00	1.00	SFD	1.00	1.00	1.00	\$28.20	\$28.20	Dabbieri Family Trust 05-01-09
443 421 07 00	1.00	SFD	1.00	1.00	1.00	\$28.20	\$28.20	Stryker Family Trust 10-23-00
443 421 08 00	1.00	SFD	1.00	1.00	1.00	\$28.20	\$28.20	Peters Colin M&Celine C
443 421 09 00	1.00	SFD	1.00	1.00	1.00	\$28.20	\$28.20	Limber Jack P&Jill E
443 421 10 00	1.00	SFD	1.00	1.00	1.00	\$28.20	\$28.20	Oswalt Barbara B Revocable Trust 12-29-92
443 421 11 00	1.00	SFD	1.00	1.00	1.00	\$28.20	\$28.20	Canepa Michael J&Traitel Dorothea A
443 421 12 00	1.00	SFD	1.00	1.00	1.00	\$28.20	\$28.20	Leavitt Andrea R Trust 06-29-93
443 421 13 00	1.00	SFD	1.00	1.00	1.00	\$28.20	\$28.20	Kazmer Margaret M
443 421 14 00	1.00	SFD	1.00	1.00	1.00	\$28.20	\$28.20	Watson Rosemary E
443 421 15 00	1.00	SFD	1.00	1.00	1.00	\$28.20	\$28.20	Bullock Andrew&Veece
443 421 16 00	1.00	SFD	1.00	1.00	1.00	\$28.20	\$28.20	Crofton John&Denise Trust 09-28-11
443 421 17 00	1.00	SFD	1.00	1.00	1.00	\$28.20	\$28.20	Stouffer Linda J
443 421 18 00	1.00	SFD	1.00	1.00	1.00	\$28.20	\$28.20	Lee Wesley W 2002 Trust 06-19-02

EXHIBIT C - Assessment Roll (Fiscal Year 2014)
Mission Hills Historic Street Lighting Maintenance Assessment District

Parcel Number	Acres/Units ⁽¹⁾	Land Use Code ⁽²⁾	Apportionment Factors		Total EBUs	FY 2014 ⁽⁴⁾		Owner Name
			Land Use ⁽²⁾	Benefit ⁽³⁾		Unit Cost	Assessment	
443 421 19 00	1.00	SFD	1.00	1.00	1.00	\$28.20	\$28.20	Perilli Kenneth
443 421 20 00	1.00	SFD	1.00	1.00	1.00	\$28.20	\$28.20	Demers Family Trust 07-17-00
443 421 21 00	2.00	DUP	0.70	1.00	1.40	\$28.20	\$39.48	Britton Stuart D&Denise N F
443 421 22 00	1.00	SFD	1.00	1.00	1.00	\$28.20	\$28.20	Mangiameli Joanne G
443 422 01 00	2.00	DUP	0.70	1.00	1.40	\$28.20	\$39.48	Pogue Lonnie&Pamela A
443 422 02 00	1.00	SFD	1.00	1.00	1.00	\$28.20	\$28.20	Riley Mark A&Debra A
443 422 03 00	1.00	SFD	1.00	1.00	1.00	\$28.20	\$28.20	Johnston Family Trust 09-26-94
443 422 04 00	1.00	SFD	1.00	1.00	1.00	\$28.20	\$28.20	Markham Kathleen Tr
443 422 05 00	1.00	SFD	1.00	1.00	1.00	\$28.20	\$28.20	Dilligan Michael A Family Trust 09-24-99
443 422 06 00	1.00	SFD	1.00	1.00	1.00	\$28.20	\$28.20	Bowler Miles L&Patricia S Revocable Trust 01-09-02
443 422 07 00	1.00	SFD	1.00	1.00	1.00	\$28.20	\$28.20	Williams Boyd R D
443 422 08 00	1.00	SFD	1.00	1.00	1.00	\$28.20	\$28.20	Hsieh Living Trust 10-28-98
443 422 09 00	1.00	SFD	1.00	1.00	1.00	\$28.20	\$28.20	Jappchen Emmerick&Gina
443 422 10 00	1.00	SFD	1.00	1.00	1.00	\$28.20	\$28.20	Diamond Philip J Revocable 1999 Trust 09-30-99 Et Al
443 422 11 00	1.00	SFD	1.00	1.00	1.00	\$28.20	\$28.20	Hsieh Living Trust 10-28-98
443 422 12 00	1.00	SFD	1.00	1.00	1.00	\$28.20	\$28.20	Dyson-Guerrero Family Trust 07-06-12
443 422 13 00	1.00	SFD	1.00	1.00	1.00	\$28.20	\$28.20	Holzer Jeffrey P&Amy L
443 422 14 00	1.00	SFD	1.00	1.00	1.00	\$28.20	\$28.20	Mazzola James S&Burkhardt Davide L
443 422 15 00	1.00	SFD	1.00	1.00	1.00	\$28.20	\$28.20	Cavanaugh Francis P
443 422 16 00	1.00	SFD	1.00	1.00	1.00	\$28.20	\$28.20	Owens Nina G Barton Revocable Trust 08-22-89
443 422 17 00	1.00	SFD	1.00	1.00	1.00	\$28.20	\$28.20	Eisenberg Lydwin E
443 422 18 00	1.00	SFD	1.00	1.00	1.00	\$28.20	\$28.20	Snodgrass Family Community Property Trust 04-17-02
443 422 19 00	1.00	SFD	1.00	1.00	1.00	\$28.20	\$28.20	O K Trust 09-29-04
443 422 20 00	2.00	DUP	0.70	1.00	1.40	\$28.20	\$39.48	Avedian Greg
443 422 21 00	1.00	SFD	1.00	1.00	1.00	\$28.20	\$28.20	Olafson Patricia C Revocable Trust 12-23-03
443 422 22 00	1.00	SFD	1.00	1.00	1.00	\$28.20	\$28.20	Bibler Gerald J Trust 11-16-11
443 422 23 00	1.00	SFD	1.00	1.00	1.00	\$28.20	\$28.20	Macbean Edgar C&Kelly Jamie S
443 431 01 00	1.00	SFD	1.00	1.00	1.00	\$28.20	\$28.20	Oregan Family 2010 Trust 11-16-10
443 431 02 00	1.00	SFD	1.00	1.00	1.00	\$28.20	\$28.20	Krimsky Robert C Trust 03-14-00
443 431 03 00	1.00	SFD	1.00	1.00	1.00	\$28.20	\$28.20	Coar/Williams Family Trust 03-20-06
443 431 05 00	1.00	SFD	1.00	1.00	1.00	\$28.20	\$28.20	Thoene Matthew&Christine
443 431 06 00	1.00	SFD	1.00	1.00	1.00	\$28.20	\$28.20	Clipson Family Trust 05-05-95
443 431 09 00	1.00	SFD	1.00	1.00	1.00	\$28.20	\$28.20	Lowenstein Family Trust 10-03-12
443 431 17 00	1.00	SFD	1.00	1.00	1.00	\$28.20	\$28.20	Poor House Trust 03-03-06
443 431 18 00	1.00	SFD	1.00	1.00	1.00	\$28.20	\$28.20	Gonzalez Teresa Trust 08-15-07
443 431 19 00	1.00	SFD	1.00	1.00	1.00	\$28.20	\$28.20	Shoupe Trust 09-29-04
443 431 20 00	1.00	SFD	1.00	1.00	1.00	\$28.20	\$28.20	Persky William&Dorthea N Trust 1990
443 431 21 00	2.00	DUP	0.70	1.00	1.40	\$28.20	\$39.48	Ingrande Family Trust 01-22-01
443 432 01 00	1.00	SFD	1.00	1.00	1.00	\$28.20	\$28.20	Vano George&Allison
443 432 02 00	1.00	SFD	1.00	1.00	1.00	\$28.20	\$28.20	Kirby John H&Ruthann Family Trust 01-10-95
443 432 03 00	1.00	SFD	1.00	1.00	1.00	\$28.20	\$28.20	Stockmeyer Christopher B Ili&Diane M
443 432 04 00	1.00	MFR	0.70	1.00	0.70	\$28.20	\$19.74	Schwartz Valerie L Trust 09-18-90
443 432 04 00	1.00	SFD	1.00	1.00	1.00	\$28.20	\$28.20	Schwartz Valerie L Trust 09-18-90
443 432 05 00	1.00	SFD	1.00	1.00	1.00	\$28.20	\$28.20	Vanstee Peter&Marcy
443 432 06 00	1.00	SFD	1.00	1.00	1.00	\$28.20	\$28.20	Yaksh Tony L&Elizabeth B
443 432 07 00	1.00	SFD	1.00	1.00	1.00	\$28.20	\$28.20	Carter Christopher W&Kline Deidre L
443 432 08 00	1.00	SFD	1.00	1.00	1.00	\$28.20	\$28.20	Johnson Family Trust 03-31-00
443 432 09 00	1.00	SFD	1.00	1.00	1.00	\$28.20	\$28.20	Murdock Gary A&Susan A
443 432 10 00	1.00	SFD	1.00	1.00	1.00	\$28.20	\$28.20	Lehr Terry V&Mary W
443 432 11 00	1.00	SFD	1.00	1.00	1.00	\$28.20	\$28.20	Nunez Maria E Trust 06-05-96
443 432 12 00	1.00	SFD	1.00	1.00	1.00	\$28.20	\$28.20	Brooks Family Trust 08-31-05
443 432 13 00	1.00	SFD	1.00	1.00	1.00	\$28.20	\$28.20	Hofer Lila M
443 432 14 00	1.00	SFD	1.00	1.00	1.00	\$28.20	\$28.20	Graham Lori
443 432 15 00	1.00	SFD	1.00	1.00	1.00	\$28.20	\$28.20	Wilcoxson Anna M

EXHIBIT C - Assessment Roll (Fiscal Year 2014)
Mission Hills Historic Street Lighting Maintenance Assessment District

Parcel Number	Acres/ Units ⁽¹⁾	Land Use Code ⁽²⁾	Apportionment Factors		Total EBUs	FY 2014 ⁽⁴⁾		Owner Name
			Land Use ⁽²⁾	Benefit ⁽³⁾		Unit Cost	Assessment	
443 432 16 00	1.00	SFD	1.00	1.00	1.00	\$28.20	\$28.20	Nares Family Trust 10-08-01
443 432 17 00	1.00	SFD	1.00	1.00	1.00	\$28.20	\$28.20	Jacobs Richard A&LAWLEY Linda G
443 432 18 00	1.00	SFD	1.00	1.00	1.00	\$28.20	\$28.20	Hazard Allen A&Odea Janet M
443 432 19 00	1.00	SFD	1.00	1.00	1.00	\$28.20	\$28.20	Preciado Clara
443 432 20 00	1.00	SFD	1.00	1.00	1.00	\$28.20	\$28.20	Altmann Marjorie P Revocable Trust 09-25-03
443 432 21 00	1.00	SFD	1.00	1.00	1.00	\$28.20	\$28.20	Lams J Trust 07-20-01
443 432 22 00	1.00	SFD	1.00	1.00	1.00	\$28.20	\$28.20	Sparks Robert H Iii&Fitzmaurice Laurie J Living Trust 01-28-11
443 432 23 00	1.00	SFD	1.00	1.00	1.00	\$28.20	\$28.20	Jannone Revocable Trust A 07-31-89
443 432 24 00	1.00	SFD	1.00	1.00	1.00	\$28.20	\$28.20	Neath Sean
443 432 25 00	1.00	SFD	1.00	1.00	1.00	\$28.20	\$28.20	Davis Robert Decedents Trust 01-01-05
443 432 26 00	1.00	SFD	1.00	1.00	1.00	\$28.20	\$28.20	Scott Diane Trust 09-08-97
443 432 27 00	1.00	SFD	1.00	1.00	1.00	\$28.20	\$28.20	Sinkin-Antrim Living Trust 07-02-92
443 432 28 00	1.00	SFD	1.00	1.00	1.00	\$28.20	\$28.20	Kass Aileen
443 432 29 00	1.00	SFD	1.00	1.00	1.00	\$28.20	\$28.20	Johnson Mark
443 432 30 00	1.00	SFD	1.00	1.00	1.00	\$28.20	\$28.20	Oconnor Richard D&Joan K
443 432 31 00	1.00	SFD	1.00	1.00	1.00	\$28.20	\$28.20	Hernandez Maria J
443 461 23 00	1.00	SFD	1.00	1.00	1.00	\$28.20	\$28.20	Bates Richard L&Nancy H
443 461 24 00	2.00	DUP	0.70	1.00	1.40	\$28.20	\$39.48	Hill Mitchell F&Chesnut Genevieve
443 462 01 00	1.00	SFD	1.00	1.00	1.00	\$28.20	\$28.20	Martinez Family Trust 11-08-99
443 520 16 00	1.00	SFD	1.00	1.00	1.00	\$28.20	\$28.20	Kirby Family Revocable Trust 01-27-02
443 520 17 00	1.00	SFD	1.00	1.00	1.00	\$28.20	\$28.20	Manecke Gerard R Jr&Kutner Lisa J
443 520 18 00	1.00	SFD	1.00	1.00	1.00	\$28.20	\$28.20	Mowrey Vincent J
443 520 21 00	1.00	SFD	1.00	1.00	1.00	\$28.20	\$28.20	Gluf Wayne M&Amalie R
443 520 22 00	1.00	SFD	1.00	1.00	1.00	\$28.20	\$28.20	Erreca Charles M&Louise F
443 520 23 00	1.00	SFD	1.00	1.00	1.00	\$28.20	\$28.20	Schwerdtfeger Sally 2010 Trust 06-17-10
443 520 24 00	1.00	SFD	1.00	1.00	1.00	\$28.20	\$28.20	Batdorf Family Trust A 07-02-02
443 520 25 00	1.00	SFD	1.00	1.00	1.00	\$28.20	\$28.20	White Family Subtrust Cp 07-23-96
443 520 26 00	1.00	SFD	1.00	1.00	1.00	\$28.20	\$28.20	Yeilding Andrew C&Sarah D L
443 520 27 00	1.00	SFD	1.00	1.00	1.00	\$28.20	\$28.20	Mcadam Kelly S
443 520 28 00	1.00	SFD	1.00	1.00	1.00	\$28.20	\$28.20	Jessop George&Mary Family Bypass Trust 07-25-80
443 520 29 00	1.00	SFD	1.00	1.00	1.00	\$28.20	\$28.20	Pierce Revocable Trust C 08-07-95
443 520 30 00	1.00	SFD	1.00	1.00	1.00	\$28.20	\$28.20	Tillman Robert F&Elizabeth P Trs
443 520 31 00	1.00	SFD	1.00	1.00	1.00	\$28.20	\$28.20	Arce Joseph P Tr
443 520 32 00	1.00	SFD	1.00	1.00	1.00	\$28.20	\$28.20	Janes Thomas C V&Jennifer I Community Property Trust 05-06
443 520 33 00	0.00	SFD	1.00	1.00	0.00	\$28.20	\$0.00	Spradling Gary J&Joy D Trs
443 520 34 00	1.00	SFD	1.00	1.00	1.00	\$28.20	\$28.20	Spradling Gary J&Joy D Trs
443 520 36 00	1.00	SFD	1.00	1.00	1.00	\$28.20	\$28.20	Offutt Helen C Revocable Inter Vivos Trust 04-16-06
443 520 37 00	1.00	SFD	1.00	1.00	1.00	\$28.20	\$28.20	Balestrieri David A
443 520 38 00	1.00	SFD	1.00	1.00	1.00	\$28.20	\$28.20	Valleau Peter&Arlene
443 551 01 00	1.00	SFD	1.00	1.00	1.00	\$28.20	\$28.20	Ancira Family Trust 04-08-98
443 551 02 00	1.00	SFD	1.00	1.00	1.00	\$28.20	\$28.20	Mcardle T F&S R Family Trust 08-21-01
443 551 03 00	1.00	SFD	1.00	1.00	1.00	\$28.20	\$28.20	Schwartz Lloyd A Revocable 2008 Trust 10-20-08
443 551 04 00	1.00	SFD	1.00	1.00	1.00	\$28.20	\$28.20	Orwig A Family Trust 11-08-99
443 551 05 00	1.00	SFD	1.00	1.00	1.00	\$28.20	\$28.20	Fitz David A&Mary J
443 551 07 00	1.00	SFD	1.00	1.00	1.00	\$28.20	\$28.20	Wroe Family Trust 12-27-95
443 551 08 00	1.00	SFD	1.00	1.00	1.00	\$28.20	\$28.20	Singer/Olesen Living Trust 10-24-00
443 551 09 00	1.00	SFD	1.00	1.00	1.00	\$28.20	\$28.20	Gamboia Family Trust 08-05-96
443 552 01 00	1.00	SFD	1.00	1.00	1.00	\$28.20	\$28.20	Vecchione Thomas R Trust 11-20-97
443 552 04 00	1.00	SFD	1.00	1.00	1.00	\$28.20	\$28.20	Little Daniel&Joyce Family Trust 04-02-93
443 552 05 00	1.00	SFD	1.00	1.00	1.00	\$28.20	\$28.20	Oriol Gil P&Farres Michele R
443 552 06 00	1.00	SFD	1.00	1.00	1.00	\$28.20	\$28.20	Poehlman/Huff Trust 02-10-93
443 552 07 00	1.00	SFD	1.00	1.00	1.00	\$28.20	\$28.20	Horne Keith J
443 552 08 00	1.00	SFD	1.00	1.00	1.00	\$28.20	\$28.20	Wallack Seth T
443 552 09 00	1.00	SFD	1.00	1.00	1.00	\$28.20	\$28.20	Flowers Family 2006 Trust 07-13-06

EXHIBIT C - Assessment Roll (Fiscal Year 2014)
Mission Hills Historic Street Lighting Maintenance Assessment District

Parcel Number	Acres/ Units ⁽¹⁾	Land Use Code ⁽²⁾	Apportionment Factors		Total EBUs	FY 2014 ⁽⁴⁾		Owner Name
			Land Use ⁽²⁾	Benefit ⁽³⁾		Unit Cost	Assessment	
443 552 10 00	1.00	SFD	1.00	1.00	1.00	\$28.20	\$28.20	Paluch&Mehalek Family Trust 04-03-12
443 552 12 00	0.12	VAC	2.00	0.60	0.14	\$28.20	\$4.06	Sefton Jennifer J Trust 09-15-93
443 552 13 00	1.00	SFD	1.00	1.00	1.00	\$28.20	\$28.20	Barksdale W Malcolm&Naomi
443 552 14 00	1.00	SFD	1.00	1.00	1.00	\$28.20	\$28.20	Sefton Jennifer J Trust 09-15-93
443 561 01 00	1.00	SFD	1.00	1.00	1.00	\$28.20	\$28.20	Atkinson Hanley Trust 04-04-03
443 561 02 00	1.00	SFD	1.00	1.00	1.00	\$28.20	\$28.20	Lampe Scott A&Janette T
443 561 03 00	1.00	SFD	1.00	1.00	1.00	\$28.20	\$28.20	Heyneman/Sylvan Family Trust 01-14-99
443 561 04 00	1.00	SFD	1.00	1.00	1.00	\$28.20	\$28.20	Squires Dale&Virginia
443 561 05 00	1.00	SFD	1.00	1.00	1.00	\$28.20	\$28.20	Dean Family Trust 06-07-96
443 561 06 00	1.00	SFD	1.00	1.00	1.00	\$28.20	\$28.20	Ray Lynn&Hiroko Family Trust 07-17-01
443 562 03 00	1.00	SFD	1.00	1.00	1.00	\$28.20	\$28.20	Burgamy Kirk&Sandy
443 562 04 00	1.00	SFD	1.00	1.00	1.00	\$28.20	\$28.20	Montgrain Family Trust 08-15-07
443 562 08 00	1.00	SFD	1.00	1.00	1.00	\$28.20	\$28.20	Canedo Family Trust 11-13-89
443 562 09 00	1.00	SFD	1.00	1.00	1.00	\$28.20	\$28.20	Tortorelli James Tr (Dcsd)
443 562 10 00	1.00	SFD	1.00	1.00	1.00	\$28.20	\$28.20	Meyers William E&Judith A
443 562 11 00	1.00	SFD	1.00	1.00	1.00	\$28.20	\$28.20	Schneider Family Trust 04-20-01
443 562 12 00	1.00	SFD	1.00	1.00	1.00	\$28.20	\$28.20	Tillett 2000 Trust 10-26-00
443 562 13 00	1.00	SFD	1.00	1.00	1.00	\$28.20	\$28.20	Miller Louis&Semblantes Susana H
443 562 14 00	1.00	SFD	1.00	1.00	1.00	\$28.20	\$28.20	Dean Paul&Nelly Family Trust 05-17-80
443 563 01 00	1.00	SFD	1.00	1.00	1.00	\$28.20	\$28.20	Gillard Revocable Trust 05-03-05
443 563 02 00	1.00	SFD	1.00	1.00	1.00	\$28.20	\$28.20	Tuteur Jennifer M Trust 09-16-09
443 563 03 00	1.00	SFD	1.00	1.00	1.00	\$28.20	\$28.20	Marks Marjorie E Revocable Trust 05-28-02
443 563 04 00	1.00	SFD	1.00	1.00	1.00	\$28.20	\$28.20	Ingrande Family Trust 01-22-01
443 563 05 00	1.00	SFD	1.00	1.00	1.00	\$28.20	\$28.20	Woldt Thomas T&Leslie M Trs
443 563 06 00	1.00	SFD	1.00	1.00	1.00	\$28.20	\$28.20	Hernholm Family (Community Property) Trust 09-09-01
443 563 07 00	1.00	SFD	1.00	1.00	1.00	\$28.20	\$28.20	Augustine Barbara S Trust 03-03-92
443 563 08 00	1.00	SFD	1.00	1.00	1.00	\$28.20	\$28.20	Dittamore Family Trust 06-06-91
443 563 09 00	1.00	SFD	1.00	1.00	1.00	\$28.20	\$28.20	Johnson Scott R
443 563 10 00	1.00	SFD	1.00	1.00	1.00	\$28.20	\$28.20	Frederick David L&Melynn B Revocable Trust 06-02-04
443 570 03 00	1.00	SFD	1.00	1.00	1.00	\$28.20	\$28.20	Coates Suzanne B Trust 02-19-03
443 570 04 00	1.00	SFD	1.00	1.00	1.00	\$28.20	\$28.20	Clint Daniel T&Debbie L
443 570 05 00	1.00	SFD	1.00	1.00	1.00	\$28.20	\$28.20	Weber Michael W
443 570 06 00	1.00	SFD	1.00	1.00	1.00	\$28.20	\$28.20	Alsbaugh Eric B&Virginia S
443 570 07 00	1.00	SFD	1.00	1.00	1.00	\$28.20	\$28.20	Nelson William M&Theresa W
443 570 08 00	1.00	SFD	1.00	1.00	1.00	\$28.20	\$28.20	Osborne Trust 09-20-00
443 570 09 00	1.00	SFD	1.00	1.00	1.00	\$28.20	\$28.20	Gimber Douglas A&Norma M Trs
443 570 10 00	1.00	SFD	1.00	1.00	1.00	\$28.20	\$28.20	Lakin Charles M
443 570 11 00	1.00	SFD	1.00	1.00	1.00	\$28.20	\$28.20	Folkman Albert&Gladys Trust 03-28-72
443 570 12 00	1.00	SFD	1.00	1.00	1.00	\$28.20	\$28.20	Ponder Elizabeth A Revocable Trust 03-16-06
443 580 01 00	2.00	DUP	0.70	1.00	1.40	\$28.20	\$39.48	Paul Richard A&Minisi Rena J
443 580 02 00	1.00	SFD	1.00	1.00	1.00	\$28.20	\$28.20	Kondrick H Paul&Linda J
443 580 03 00	1.00	SFD	1.00	1.00	1.00	\$28.20	\$28.20	Schultz Stephen J&Donna E <Aka Schultz Donna D>
443 580 04 00	1.00	SFD	1.00	1.00	1.00	\$28.20	\$28.20	Black Peter J Tr
443 580 07 00	1.00	SFD	1.00	1.00	1.00	\$28.20	\$28.20	Miller Family Trust 05-10-90
443 580 08 00	1.00	SFD	1.00	1.00	1.00	\$28.20	\$28.20	Benrubi Gabriel M&Kine
443 591 01 00	1.00	SFD	1.00	1.00	1.00	\$28.20	\$28.20	Mccoll William&Sandra
443 591 02 00	1.00	SFD	1.00	1.00	1.00	\$28.20	\$28.20	Harms Joel D Trust 10-19-05
443 602 01 00	1.00	SFD	1.00	1.00	1.00	\$28.20	\$28.20	Amezquita Family 1999 Trust 07-29-99
443 602 02 00	1.00	SFD	1.00	1.00	1.00	\$28.20	\$28.20	Sellgren Miriam W Living Trust 02-09-07
443 602 04 00	1.00	SFD	1.00	1.00	1.00	\$28.20	\$28.20	Cage James W&Dori J N Family Trust 10-28-96
443 611 01 00	1.00	SFD	1.00	1.00	1.00	\$28.20	\$28.20	Duckham James P&Sharon K
443 611 02 00	1.00	SFD	1.00	1.00	1.00	\$28.20	\$28.20	Brock Rick K
443 611 03 00	1.00	SFD	1.00	1.00	1.00	\$28.20	\$28.20	Vonbehren Jeffrey B&Alpert Alison D
443 611 04 00	1.00	SFD	1.00	1.00	1.00	\$28.20	\$28.20	Light Robin S

EXHIBIT C - Assessment Roll (Fiscal Year 2014)
Mission Hills Historic Street Lighting Maintenance Assessment District

Parcel Number	Acres/ Units ⁽¹⁾	Land Use Code ⁽²⁾	Apportionment Factors		Total EBUs	FY 2014 ⁽⁴⁾		Owner Name
			Land Use ⁽²⁾	Benefit ⁽³⁾		Unit Cost	Assessment	
443 611 05 00	1.00	SFD	1.00	1.00	1.00	\$28.20	\$28.20	J A A M B R W Family Trust
443 611 06 00	1.00	SFD	1.00	1.00	1.00	\$28.20	\$28.20	Collins Scott R&Heather P
443 611 07 00	1.00	SFD	1.00	1.00	1.00	\$28.20	\$28.20	Halpern Phillip&Marcia Trust 04-20-99
443 611 08 00	1.00	SFD	1.00	1.00	1.00	\$28.20	\$28.20	Chambard Abby L
443 611 09 00	1.00	SFD	1.00	1.00	1.00	\$28.20	\$28.20	Mayfield Family Trust 08-08-97
443 611 10 00	1.00	SFD	1.00	1.00	1.00	\$28.20	\$28.20	Lesser Living Trust 07-16-09
443 611 11 00	1.00	SFD	1.00	1.00	1.00	\$28.20	\$28.20	Omens Eddie&Mary J Trust 10-29-09
443 611 12 00	1.00	SFD	1.00	1.00	1.00	\$28.20	\$28.20	Zollman Ron S&Joellyn W
443 650 12 00	1.00	SFD	1.00	1.00	1.00	\$28.20	\$28.20	Jones Irma C Trust 11-22-05
443 650 13 00	1.00	SFD	1.00	1.00	1.00	\$28.20	\$28.20	Yackly Charles W&Salt Kelly J
443 650 14 00	1.00	SFD	1.00	1.00	1.00	\$28.20	\$28.20	Herman Family Trust 12-17-11
443 751 09 00	1.00	SFD	1.00	1.00	1.00	\$28.20	\$28.20	Daniel G Robert&Weeks-Daniel Phyllis A
443 751 10 00	1.00	SFD	1.00	1.00	1.00	\$28.20	\$28.20	Milford Paula A
443 751 11 00	1.00	SFD	1.00	1.00	1.00	\$28.20	\$28.20	Hood Mark&Cooney Sharon
443 751 12 00	1.00	SFD	1.00	1.00	1.00	\$28.20	\$28.20	Castagnola Peter A Tr
443 751 13 00	1.00	SFD	1.00	1.00	1.00	\$28.20	\$28.20	Owens Barbara J Tr
443 752 01 00	1.00	SFD	1.00	1.00	1.00	\$28.20	\$28.20	Dacquisto Family Trust 03-08-04
443 752 02 00	1.00	SFD	1.00	1.00	1.00	\$28.20	\$28.20	Daleo Joseph P&Joanne R Revocable Inter Vivos Trust 01-27-8
443 752 03 00	1.00	SFD	1.00	1.00	1.00	\$28.20	\$28.20	Pardo Francisco S
443 761 01 00	1.00	SFD	1.00	1.00	1.00	\$28.20	\$28.20	Arabia James R
443 761 02 00	1.00	SFD	1.00	1.00	1.00	\$28.20	\$28.20	Andrews Family Trust 06-09-04
443 762 03 00	1.00	SFD	1.00	1.00	1.00	\$28.20	\$28.20	Altomare Phyllis M 1990 Trust 11-27-90
443 762 04 00	1.00	SFD	1.00	1.00	1.00	\$28.20	\$28.20	Fleming/Solo Trust 05-05-97
443 762 05 00	1.00	SFD	1.00	1.00	1.00	\$28.20	\$28.20	Sandmeyer Revocable Trust 03-13-91
443 762 07 00	1.00	SFD	1.00	1.00	1.00	\$28.20	\$28.20	Tomlin Family Trust 06-01-99
443 763 01 00	1.00	SFD	1.00	1.00	1.00	\$28.20	\$28.20	Navarra Jerome Family Trust 8/31/88
443 763 02 00	1.00	SFD	1.00	1.00	1.00	\$28.20	\$28.20	Navarra Vincent J
443 763 03 00	2.00	DUP	0.70	1.00	1.40	\$28.20	\$39.48	Sheppard Leslie Trust 09-25-95
443 763 04 00	1.00	SFD	1.00	1.00	1.00	\$28.20	\$28.20	Zolezzi Jack Trust 10-28-98
443 763 05 00	1.00	SFD	1.00	1.00	1.00	\$28.20	\$28.20	Tomlin Family Trust 06-01-99
443 763 06 00	1.00	SFD	1.00	1.00	1.00	\$28.20	\$28.20	Wroot Charles H Trust 08-13-03
443 763 07 00	0.00	SFD	1.00	1.00	0.00	\$28.20	\$0.00	Smaha John&Susan
443 763 08 00	2.00	DUP	0.70	1.00	1.40	\$28.20	\$39.48	Smaha John&Susan
443 763 09 00	1.00	SFD	1.00	1.00	1.00	\$28.20	\$28.20	Spector Trust 09-21-07
443 763 10 00	1.00	SFD	1.00	1.00	1.00	\$28.20	\$28.20	Kelley Family Trust 02-12-08
443 763 11 00	1.00	SFD	1.00	1.00	1.00	\$28.20	\$28.20	Jennings Wayne D&Constance B
443 763 13 00	0.00	SFD	1.00	1.00	0.00	\$28.20	\$0.00	Navarra Jerome Family Trust 8/31/88
443 763 14 00	1.00	SFD	1.00	1.00	1.00	\$28.20	\$28.20	Arroyo/Rinaldi Trust 11-09-09
443 771 01 00	1.00	SFD	1.00	1.00	1.00	\$28.20	\$28.20	Binder Lynne B
443 771 02 00	1.00	SFD	1.00	1.00	1.00	\$28.20	\$28.20	3928 Bandini Trust 04-11-12
443 771 03 00	1.00	SFD	1.00	1.00	1.00	\$28.20	\$28.20	Crivello Vincent&Rose M
443 771 04 00	1.00	SFD	1.00	1.00	1.00	\$28.20	\$28.20	Glazener Edwin L Tr
443 771 05 00	1.00	SFD	1.00	1.00	1.00	\$28.20	\$28.20	Porter Luann M Trust 12-20-99
443 771 06 00	1.00	SFD	1.00	1.00	1.00	\$28.20	\$28.20	Montes Ezequiel E&Alford Sharon M
443 771 07 00	1.00	SFD	1.00	1.00	1.00	\$28.20	\$28.20	Lee Jonathan Y&Rockwell Jean M
443 772 05 00	1.00	SFD	1.00	1.00	1.00	\$28.20	\$28.20	Levine Family Trust 07-13-11
443 772 06 00	1.00	SFD	1.00	1.00	1.00	\$28.20	\$28.20	Ruffin Salima
443 772 07 00	1.00	SFD	1.00	1.00	1.00	\$28.20	\$28.20	Pipitone Charles V Family Limited Partnership
443 772 08 00	1.00	SFD	1.00	1.00	1.00	\$28.20	\$28.20	Castagnola Domenico Trust 03-08-94
443 781 01 00	1.00	SFD	1.00	1.00	1.00	\$28.20	\$28.20	Lestrangle John H Jr&Florence M Trs
443 781 02 00	1.00	SFD	1.00	1.00	1.00	\$28.20	\$28.20	Arthur Family 2001 Trust 01-03-01
443 782 01 00	1.00	SFD	1.00	1.00	1.00	\$28.20	\$28.20	Reed Carmen
443 782 02 00	1.00	SFD	1.00	1.00	1.00	\$28.20	\$28.20	Marks Richard A Revocable Trust
443 782 03 00	1.00	SFD	1.00	1.00	1.00	\$28.20	\$28.20	Weber Eckard Living Trust 11-20-07

EXHIBIT C - Assessment Roll (Fiscal Year 2014)
Mission Hills Historic Street Lighting Maintenance Assessment District

Parcel Number	Acres/ Units ⁽¹⁾	Land Use Code ⁽²⁾	Apportionment Factors		Total EBUs	FY 2014 ⁽⁴⁾		Owner Name
			Land Use ⁽²⁾	Benefit ⁽³⁾		Unit Cost	Assessment	
443 783 01 00	1.00	SFD	1.00	1.00	1.00	\$28.20	\$28.20	Matton Clermont P&Stern Alicia
443 783 02 00	1.00	SFD	1.00	1.00	1.00	\$28.20	\$28.20	Gardner Family 2012 Trust 02-17-12
443 783 03 00	1.00	SFD	1.00	1.00	1.00	\$28.20	\$28.20	Ventura Family Trust 08-16-88
443 783 04 00	1.00	SFD	1.00	1.00	1.00	\$28.20	\$28.20	Park Sissela S
443 783 05 00	1.00	SFD	1.00	1.00	1.00	\$28.20	\$28.20	Davenport William&Beth
443 783 06 00	1.00	SFD	1.00	1.00	1.00	\$28.20	\$28.20	Weber Eckard Living Trust 11-20-07
443 783 07 00	1.00	SFD	1.00	1.00	1.00	\$28.20	\$28.20	Addleson Lawrence M&Carolyn
443 783 08 00	1.00	SFD	1.00	1.00	1.00	\$28.20	\$28.20	Lewis Jason A
443 784 01 00	1.00	SFD	1.00	1.00	1.00	\$28.20	\$28.20	Keller Family Trust 06-02-03
443 784 02 00	1.00	SFD	1.00	1.00	1.00	\$28.20	\$28.20	Thomson Steven S&Teague Aileen
443 784 03 00	1.00	SFD	1.00	1.00	1.00	\$28.20	\$28.20	Castruita Rudy&Norma Revocable Trust 07-18-02
443 784 04 00	1.00	SFD	1.00	1.00	1.00	\$28.20	\$28.20	Farres Bryan A Trust 05-13-08
443 791 01 00	1.00	SFD	1.00	1.00	1.00	\$28.20	\$28.20	Farres George S&Marta Trust 06-06-78
443 791 02 00	1.00	SFD	1.00	1.00	1.00	\$28.20	\$28.20	Mcintee Stephen D Revocable 1996 Trust 08-26-96 Et Al
443 792 01 00	1.00	SFD	1.00	1.00	1.00	\$28.20	\$28.20	Disraeli Trust 07-01-91
443 792 02 00	1.00	SFD	1.00	1.00	1.00	\$28.20	\$28.20	Clay Family Trust 03-04-91
443 792 03 00	1.00	SFD	1.00	1.00	1.00	\$28.20	\$28.20	Ciceric Richard&Maria
443 792 04 00	1.00	SFD	1.00	1.00	1.00	\$28.20	\$28.20	Helton William&Joan 2000 Trust 12-20-00
443 792 05 00	1.00	SFD	1.00	1.00	1.00	\$28.20	\$28.20	Dalfio Salvatore A&Alice I Trust 01-23-95
443 792 08 00	1.00	SFD	1.00	1.00	1.00	\$28.20	\$28.20	Friedman Lawrence Trust 04-16-01
443 792 10 00	1.00	SFD	1.00	1.00	1.00	\$28.20	\$28.20	Scott Robert Tr&Scott Barbara A Tr
443 792 11 00	1.00	SFD	1.00	1.00	1.00	\$28.20	\$28.20	Noah Mark R Jr Trust 06-17-11
443 792 14 00	1.00	SFD	1.00	1.00	1.00	\$28.20	\$28.20	Pastula Family Trust 05-23-03
443 792 16 00	1.00	SFD	1.00	1.00	1.00	\$28.20	\$28.20	Wendt Ervin F Tr
TOTAL	-	-	-	-	718.24	-	\$20,254	

⁽¹⁾ Applicable units (acres or dwelling units) dependent upon Land Use Code.
⁽²⁾ Refer to Engineer's Report for description of Land Use Codes and applicable Land Use Factor.
⁽³⁾ Refer to Engineer's Report for applicable Benefit Factors.
⁽⁴⁾ FY 2014 is the City's Fiscal Year 2014, which begins July 1, 2013 and ends June 30, 2014.