



## **LANDSCAPE ANALYSIS**

Analysis of the existing Central Mesa landscape included both physical analysis and historic research of the outdoor spaces.

The historic research included documentation of original landscape features, design themes, spatial configurations and horticulture. Consultations with and reviews by both local and national historic preservationists were conducted during the landscape design development process. Results of this research can be found in the historic context and landscape recommendations sections. Figure 22 summarizes the history of the existing landscape.

The physical analysis included the following:

**Spatial Analysis** - documentation of spatial and topographical relationships between the built environment and outdoor spaces.

**Visual Analysis** - identification of important views and vistas and analysis of the visual hierarchy of buildings and landscape spaces.

**Landscape Use Analysis** - identification of the type and level of use of outdoor spaces including destination oriented spaces, multiple use and outdoor attraction areas, picnic and open play areas, and naturalized areas.

**Safety Analysis** - documentation of opportunities to enhance safety by design modifications, better maintenance, better lighting, clear sightlines, and more direct access.

**Horticultural Analysis** - identification and location of significant Central Mesa plants and trees.

A long range horticultural management plan is currently being developed for Balboa Park. The Park horticulturists are conducting detailed horticultural surveys and evaluations. They are also developing guidelines for tree maintenance and replacement programs. As this information is in progress, the Precise Plan horticultural research concentrated on documenting only the most valuable plants and trees within the proposed development areas.

The documented valuable plants and trees are listed in the plant inventory. Their locations are shown in Figure 23. Of these 139 species, 58 are considered to be significant by the Park horticulturists. These are marked by an asterisk.

### **CENTRAL MESA PLANT INVENTORY**

1. ACACIA MELANOXYLON
2. ACER (OBLONGUM) PAXII \*
3. ACROCARPUS FRAXINFOLIUS \*
4. AGATHIS AUSTRALIS \*



5. AGATHIS ROBUSTA \*
6. AGONIS FLEXUOSA \*
7. ALECTRYON EXCELSUS \*
8. ALEURITES FORDII \*
9. ARBUTUS UNEDO
10. ARCHONTOPHOENIX CUNNINGHAMIANA
11. ARECASTRUM ROMANZOFFIANUM
12. BAUHINIA PUNCTATA
13. BAUHINIA VARIGATA
14. BISCHOFIA JAVANICA \*
15. BOUGAINVILLEA SPECTABILIS
16. BRACHYCHITON HYBRID \*
17. BRACHYCHITON POPULNEUS
18. BRACHYCHITON SP. \*
19. BRAHEA BRANDEGEEI \*
20. BRAHEA BRANDEGEEI X EDULIS \*
21. BRAHEA EDULIS
22. BRASSAIA ACTINOPHYLLA
23. BUTIA CAPITATA
24. CALLISTEMON VIMINALIS
25. CALLISTRIS PREISSII
26. CALODENDRUM CAPENSIS \*
27. CAMELLIA SP.
28. CARYOTA URENS
29. CEDRUS ATLANTICA
30. CEDRUS DEODARA
31. CERATONIA SILIQUA
32. CHAMAEROPS HUMILIS \*
33. CHORISIA SPECIOSA
34. CINNAMOMUM CAMPHORA
35. CORDYLINE AUSTRALIS
36. CRYPTOMERIA JAPONICA \*
37. CUPRESSUS SEMPERVIRENS
38. CYCAS REVOLUTA



39. DOMBEYA WALLICHII
40. DRACAENA DRACO
41. ERIOBOTRYA JAPONICA
42. ERYTHRINA CAFFRA \*
43. ERYTHRINA CRISTA-GALLI \*
44. ERYTHRINA HUMEANA
45. ERYTHRINA PLEBOCARPA \*
46. ERYTHRINA X SYKESII
47. EUCALYPTUS CITRIODORA
48. EUCALYPTUS CLADOCALYX
49. EUCALYPTUS CORNUTA
50. EUCALYPTUS DEGULPTA
51. EUCALYPTUS MELLIODORA
52. EUCALYPTUS GLOBULUS
53. EUCALYPTUS POLYANTHEMOS
54. EUCALYPTUS SIDEROXYLON
55. FICUS BENJAMINA \*
56. FICUS ELASTICA \*
57. FICUS LYRATA \*
58. FICUS MACROPHYLLA \*
59. FICUS MACROPHYLLA 'COLUMNARIS' \*
60. FICUS MYSORENSIS \*
61. FICUS NEKBUDU \*
62. FICUS RACEMOSA \*
63. FICUS RADULINA \*
64. FICUS RELIGIOSA \*
65. FICUS RETUSA (MICROCARPA, NITIDA) \*
66. FICUS RUBIGINOSA
67. FICUS RUBIGINOSA (AUSTRALIS) \*
68. FICUS SYCOMORUS \*
69. FICUS THONNINGII
70. FICUS WATKINSIANA \*
71. GEIJERA PARVIFLORA \*
72. GINKGO BILOBA \*



73. GLEDITSIA TRIACANTHOS 'INERMIS'
74. GLEDITSIA TRIACANTHOS 'SUNBURST'
75. GREVILLEA ROBUSTA
76. HAKEA PETIOLARIS \*
77. HARPULLIA ARBOREA \*
78. HIBISCUS SP.
79. HOWEA FOSTERANA
80. HYDRANGIA HYBRIDS
81. HYMENOSPORUM FLAVUM \*
82. ILEX ALTA CLARENSIS 'WILSONII'
83. ILEX AQUIFOLIUM
84. JACARANDA ACUTIFOLIA
85. JUNIPERUS CHINENSIS TORULUSA
86. KIGELIA PINNATA \*
87. KOELREUTERIA PANICULATA
88. LAGUNARIA PATTERSONI \*
89. LAURUS NOBILIS
90. LEPTOSPERMUM LAEVIGATUM
91. LIQUIDAMBAR STYRACIFLUA
92. LYONOTHAMNUS FLORIBUNDUS \*
93. MAGNOLIA GRANDIFLORA \*
94. MARKHAMIA HILDEBRANDTII \*
95. MELALEUCA ARMILLARIS
96. MELALEUCA NESOPHILA
97. MELALEUCA STYPHELOIDES
98. METROSIDEROS EXCELSOS
99. MICHELIA DOLTSOPA \*
100. OLEA EUROPAEA
101. OLMEDIELLA BETSCHIERANA \*
102. PELTOPHORUM DUBIUM \*
103. PHOENIX CANARIENSIS
104. PHOENIX RECLINATA
105. PHOENIX ROEBELII
106. PHOENIX RUPICOLA \*
107. PINUS CANARIENSIS



108. PINUS PINEA \*
109. PINUS TORREYANA \*
110. PITTOSPORUM UNDULATUM
111. PITTOSPORUM VIRIDIFLORUM \*
112. PLATANUS RACEMOSA
113. PODOCARPUS GRACILIOR
114. PODOCARPUS HENKELLI \*
115. PRUNUS BLIREIANA
116. PRUNUS CAROLINIANA
117. PRUNUS SP.
118. PTEROSPERMUM ACERIFOLIUM \*
119. PYRUS KAWAKAMII
120. QUERCUS AGRIFOLIA \*
121. QUERCUS ILEX \*
122. QUERCUS SUBER
123. SABAL PAMETTO \*
124. SALIX MATSUDANA 'TORTUOSA'
125. SCHINUS MOLLE
126. SCHINUS POLYGAMOUS
127. SCHINUS TEREBENTHIFOLIUS
128. SCLEROCARYA CAFFRA \*
129. SPATHODEA CAMPANULATA \*
130. STENOCARPUS SINUATUS
131. STRELITZIA NICOLAI
132. SYZYGIUM PANICULATUM
133. TABEBUIA AVELLANEDAE
134. TAXODIUM DISTICHUM \*
135. TAXODIUM MUCRONATUM \*
136. TRISTANIA CONFERTA
137. TUPIDANTHUS CALYPTRATUS
138. ULMUS AMERICANA
139. WASHINGTONIA ROBUSTA

The 58 significant plants and trees (\*) were selected on the basis of specific criteria. The following definition of "significant" was provided by the Park horticulturist.



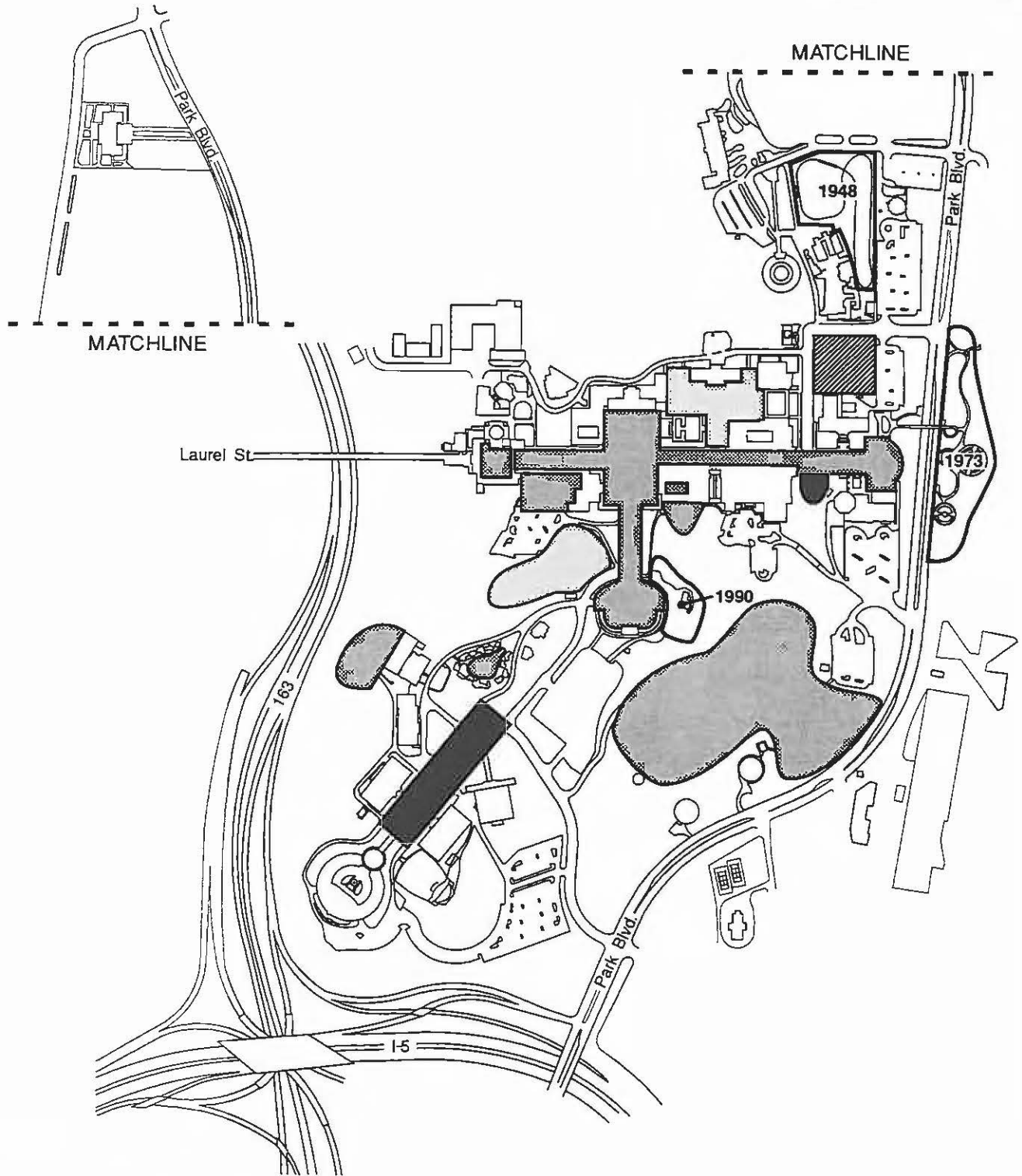





**Existing Landscape History**

13 June 1991

Figure 22

- |   |                                       |   |  |
|---|---------------------------------------|---|--|
|  | 1915 Expo Landscape Feature           |  | Non-Expo Landscape Feature with Date Constructed |
|  | 1935 Expo Landscape Feature           |   |  |
|  | 1915 Expo Landscape Feature - Altered |   |  |
|  | 1935 Expo Landscape Feature - Altered |   |  |







BALBOA PARK - CENTRAL MESA PRECISE PLAN

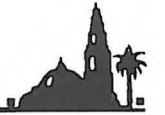

EXISTING PLANT LEGEND

- |                                       |                                     |
|---------------------------------------|-------------------------------------|
| 1 ACACIA MELANOCYLLON                 | 70 FICUS WATKINSIANA*               |
| 2 ACER (OB)LONGUM PAPPI               | 71 GIBBERA PARVIFLORA *             |
| 3 ACROCARPUS FRAXINIFOLIUS*           | 72 GINKGO BILOBA *                  |
| 4 AGATHIS AUSTRALIS *                 | 73 GLEDITSIA TRIACANTHOS 'NERMES'   |
| 5 AGATHIS ROBUSTA *                   | 74 GLEDITSIA TRIACANTHOS 'SUNBURST' |
| 6 ACONIS FLEXUOSA *                   | 75 GREVILLIA ROBUSTA *              |
| 7 ALBICRYON EXCELSUS *                | 76 HAKEA PETIOLARES*                |
| 8 ALBURITIS FORDII*                   | 77 HARPULLIA ARBOREA *              |
| 9 ARBUTUS UNEDO                       | 78 HIBISCUS SP.                     |
| 10 ARCHONTOPHORON CUNNINGHAMIANA      | 79 HOWEA FOSTERIANA                 |
| 11 ARICASTRUM ROMANZOFRANUM           | 80 HYDRANGIA HYBRIDS                |
| 12 BAUHINIA PUNCTATA                  | 81 HYMENOSPORUM FLAVUM*             |
| 13 BAUHINIA VARIATA                   | 82 ILEX ALTAICLARENSIS 'WILSONII'   |
| 14 BESCHOFFIA JAVANICA *              | 83 ILEX AQUIFOLIUM                  |
| 15 BOUGAINVILLEA SPECTABILIS          | 84 JACARANDA ACUTIFOLIA             |
| 16 BRACHYCHITON HYBRID *              | 85 JUNIPERUS CHINENSIS TORULOSA     |
| 17 BRACHYCHITON POPULNEUS             | 86 KIGELIA PINNATA *                |
| 18 BRACHYCHITON SP. *                 | 87 KOLREUTERIA PANICULATA           |
| 19 BRAHEA BRANDBERGII *               | 88 LAGUNARIA PATTERSONI *           |
| 20 BRAHEA BRANDBERGII X EDULE *       | 89 LAURUS NOBILIS                   |
| 21 BRAHEA EDULE                       | 90 LEPTOSPERMUM LAEVIGATUM          |
| 22 BRASSAIA ACTINOPHYLLA              | 91 LIQUIDAMBAR STYRACIFLUA          |
| 23 BUTIA CAPitata                     | 92 LYONOTHAMNUS FLORIBUNDUS *       |
| 24 CALLESTEMON VIMINALIS              | 93 MAGNOLIA GRANDIFLORA *           |
| 25 CALLISTES FRESSII                  | 94 MARRHAMIA HILDEBRANDTII *        |
| 26 CALODENDRUM CAPENSIS*              | 95 MELALEUCA ARMILLARES             |
| 27 CAMELLIA SP.                       | 96 MELALEUCA NESOPHILA              |
| 28 CARYOTA URENS                      | 97 MELALEUCA STYPHELOIDES           |
| 29 CEDRUS ATLANTICA                   | 98 METROSIDEROS EXCELSOS            |
| 30 CEDRUS DEODARA                     | 99 MICHELIA DOTSOPFA*               |
| 31 CERATONIA SILQUA                   | 100 OLEA EUROPAEA                   |
| 32 CHAMAEROPS HUMILIS *               | 101 OLMEDELLA BETSCHERANA *         |
| 33 CHORSIA SPECIOSA                   | 102 PELTOPHORUM DUBIUM *            |
| 34 CINNAMOMUM CAMPHORA                | 103 PHOENIX CANARIENSIS             |
| 35 CORDYLINE AUSTRALIS                | 104 PHOENIX RECLINATA               |
| 36 CRYPTOMERIA JAPONICA*              | 105 PHOENIX ROBELENI                |
| 37 CUPRESSUS SEMPERVIRENS             | 106 PHOENIX RUPICOLA *              |
| 38 CYCAS REVOLUTA                     | 107 PINUS CANARIENSIS               |
| 39 DOMBEYA WALLICHII                  | 108 PINUS PINEA *                   |
| 40 DRACENA DRACO                      | 109 PINUS TORREYANA *               |
| 41 ERIOPHYTIA JAPONICA                | 110 PITTOSPORUM UNDULATUM           |
| 42 ERYTHRINA CAFFRA *                 | 111 PITTOSPORUM VERIDIFLORUM *      |
| 43 ERYTHRINA CRISTA-GALLI*            | 112 PLATANUS RACEMOSA               |
| 44 ERYTHRINA HUMBANA                  | 113 PODOCARPUS GRACILIOR            |
| 45 ERYTHRINA FLEBOCARPA*              | 114 PODOCARPUS HENKELII*            |
| 46 ERYTHRINA X SYKISII                | 115 PRUNUS BURJIANA                 |
| 47 EUCALYPTUS CITRIODORA              | 116 PRUNUS CAROLINIANA              |
| 48 EUCALYPTUS CLADOCALYX              | 117 PRUNUS SP.                      |
| 49 EUCALYPTUS CORNUITA                | 118 PTEROSPERMUM ACERIFOLIUM*       |
| 50 EUCALYPTUS DISJUNCTA               | 119 PRUS KAWAKAIANA *               |
| 51 EUCALYPTUS MELLIODORA              | 120 QUERCUS AGRIFOLIA *             |
| 52 EUCALYPTUS GLOBULUS                | 121 QUERCUS ILEX *                  |
| 53 EUCALYPTUS POLYANTHOSMOS           | 122 QUERCUS SUBER                   |
| 54 EUCALYPTUS SIDEROXYLON             | 123 SABAL PAMETTO *                 |
| 55 FICUS BENJAMINA *                  | 124 SALIX MATSUJANA 'TORTUOSA'      |
| 56 FICUS ELASTICA *                   | 125 SCHINUS MOLLE                   |
| 57 FICUS LYRATA *                     | 126 SCHINUS POLYGAMOUS              |
| 58 FICUS MACROPHYLLA *                | 127 SCHINUS TERREBENTHIFOLIUS       |
| 59 FICUS MACROPHYLLA 'COLUMNARIS' *   | 128 SCLEROCARYA CAFFRA*             |
| 60 FICUS MYSORINENS *                 | 129 SPATHODORA CAMPANULATA*         |
| 61 FICUS NEKBUDU *                    | 130 STENOCCARPUS SINUATUS*          |
| 62 FICUS RACEMOSA *                   | 131 STRELITZIA NICOLAI              |
| 63 FICUS RADULINA *                   | 132 SYZYGIUM PANKICULATUM           |
| 64 FICUS RELIGIOSA                    | 133 TABERBUA AVELLANEDAS            |
| 65 FICUS RETUSA (MACROCARPA NITIDA) * | 134 TAXODIUM DISTICHUM *            |
| 66 FICUS RUBIGINOSA                   | 135 TAXODIUM MICRONATUM*            |
| 67 FICUS RUBIGINOSA (AUSTRALIS) *     | 136 TRESTANIA CONFERTA              |
| 68 FICUS SYCOMORUS*                   | 137 TUPIDANTHUS CALYPTRATUS         |
| 69 FICUS THONNINGII                   | 138 ULMUS AMERICANA                 |
|                                       | 139 WASHINGTONIA ROBUSTA            |

\* DENOTES SIGNIFICANT TREES

PIT  
ROBINSON

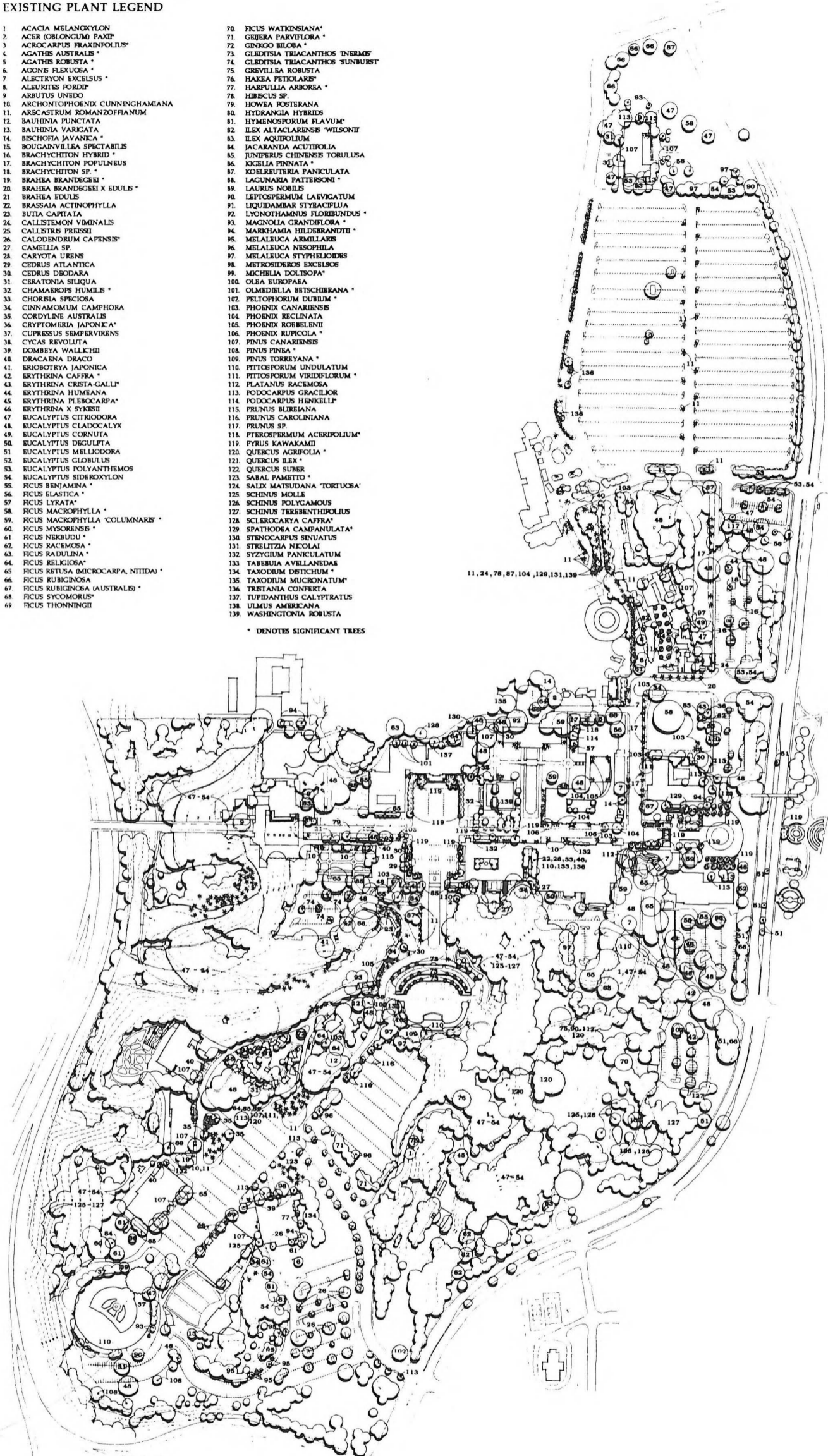

Central Mesa Plant Inventory

13 June 1991

Figure 23

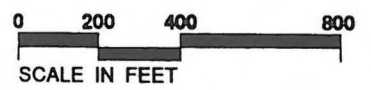





## SIGNIFICANT PLANTS AND TREES

Significant plants and trees in Balboa Park include species which are historically and/or horticulturally valuable. Historically significant plants are valuable because they may be associated with the original landscaping planted during the development of Balboa Park and during the expositions. Some of the older trees may be the original plant introductions into California by Kate Sessions and her associates. Horticulturally significant plants include plants which are valuable because they are:

- A) Rare and/or Endangered: Plant is threatened, rare or endangered in the wild.
- B) Unique or Uncommon: Plant is unique or uncommon to the area.
- C) Special Collection: Plant is part of Balboa Park's special collection.
- D) Popular: Plant is popular with the public.
- E) Educational: Plant is included in interpretive tours or school programs.
- F) Aesthetic: Specimen plant which has aesthetic value.

These plants and trees were given serious consideration in landscape design development. Their locations are shown in Figure 24. The following is the significant tree inventory which includes location number on the plan, preceding the name as well as the number of documented plants which follows the name.

### Significant Tree Inventory

Species Name:	(2)	Acer (oblongum) paxii (1)
Common Name:		Evergreen Maple
Location(s):		SW of House of Hospitality
Comments:		Save
Species Name:	(3)	Acrocarpus fraxinifolius
Common Name:		Pink Cedar
Location(s):		South of House of Pacific Relations
Comments:		Save
Species Name:	(4)	Agathis australis (2)
Common Name:		New Zealand Kauri
Location(s):		Adjacent to arcade on SE corner of House of Charm
Comments:		Save
Species Name:	(5)	Agathis robusta (3)
Common Name:		Queensland Kauri
Location(s):		North wall of Casa Del Prado Theater
Comments:		Save



- Species Name: (6) *Agonis flexuosa*  
Common Name: Peppermint Tree  
Location(s): Lawn SE of Federal Building, (Largest in San Diego)  
Lawn west of Spanish Village  
Comments: Specimen at Federal Building should not be moved.
- Species Name: (7) *Alectryon excelsus*  
Common Name: NCN  
Location(s): Many locations - concession stand / Zoro / Persian rug courtyard  
Comments: Movable / propagates easily
- Species Name: (8) *Aleurites Fordii* (1)  
Common Name: Tung Oil Tree  
Location(s): Behind Botanical Building  
Comments: Single Specimen / Movable
- Species Name: (14) *Bischofia javanica*  
Common Name: Toog Tree  
Location(s): North side of Botanical Building, east side of Casa del Prado  
Comments: Save
- Species Name: (16) *Brachychiton hybrid*  
Common Name: Australian Flame Tree Hybrid  
Location(s): Parking islands - South Carousel Lot  
Comments: Movable
- Species Name: (18) *Brachychiton "sp."*  
Common Name: Australian Flame Tree  
Location(s): South Carousel Lot - planter south of turn-around  
Comments: Movable
- Species Name: (19) *Brahea brandegeei*  
Common Name: San Jose Hesper Palm  
Location(s): West lawn of Palisades Building  
Comments: Movable
- Species Name: (20) *Brahea Brandegeei x edulis*  
Common Name: Brahea Hybrid  
Location(s): Sidewalk south of Spanish Village  
Comments: Movable



Species Name:	(26)	Calodendrum capensis
Common Name:		Cape Chestnut
Location(s):		Federal Building parking lot and east side of Federal Building
Comments:		Save
Species Name:	(32)	Chamaerops humilis
Common Name:		Mediterranean Fan Palm
Location(s):		NW of Timken Gallery
Comments:		Save
Species Name:	(36)	Cryptomeria japonica
Common Name:		Japanese Cedar
Location(s):		North side Moreton Bay Fig Tree Lawn
Comments:		Save
Species Name:	(42)	Erythrina caffra
Common Name:		Kaffirboom Coral Tree
Location(s):		Pepper Grove Parking Lot, Space Theater parking slope
Comments:		Moveable
Species Name:	(43)	Erythrina crista-galli (1)
Common Name:		Cockspur Coral Tree
Location(s):		Moreton Bay Fig Tree Lawn
Comments:		Single Specimen/Moveable
Species Name:	(45)	Erythrina pleiocarpa
Common Name:		NCN
Location(s):		Gold Gulch
Comments:		Single Specimen/Moveable
Species Name:	(55)	Ficus benjamina
Common Name:		Weeping Chinese Banyan
Location(s):		Space Theater parking lot
Comments:		Movable
Species Name:	(56)	Ficus elastica
Common Name:		Rubber Tree
Location(s):		North side of the Casa de Prado Theater
Comments:		Save
Species Name:	(57)	Ficus lyrata (1)
Common Name:		Fiddleleaf Fig
Location(s):		West side (rear) of the Casa Del Prado auditorium
Comments:		Single Specimen/Moveable



- Species Name: (58) *Ficus macrophylla* (1)  
Common Name: Moreton Bay Fig  
Location(s): North side (rear) of Natural History Museum,  
(Landmark)  
Comments: Save
- Species Name: (59) *Ficus macrophylla columnaris* (2)  
Common Name: Columnar Moreton Bay Fig  
Location(s): NE corner of the Botanical Building NW corner  
of the Casa Del Prado  
North side of the Fleet Space Theater  
Comments: Save
- Species Name: (60) *Ficus mysorensis* (1)  
Common Name: Mysore Fig  
Location(s): In lawn west of the Aerospace Museum  
Comments: Save
- Species Name: (61) *Ficus nekbudu*  
Common Name: Zulu Fig  
Location(s): Botanical Building parking lot, SW corner  
Spanish Village lawn, road in rear of Federal  
Building (row), SE corner of Federal Building  
Comments: Movable
- Species Name: (62) *Ficus racemosa* (3)  
Common Name: Cluster Fig  
Location(s): Park Boulevard, south of south tank on canyon  
rim  
Comments: Save
- Species Name: (63) *Ficus radulina* (2)  
Common Name: NCN  
Location(s): North side of Old Globe Way, Park Blvd.  
south of north tank  
Comments: Movable
- Species Name: (64) *Ficus religiosa* (3)  
Common Name: Bo Tree  
Location(s): Rear of Art Museum, in lawn between House  
of Italy and UN Building  
Comments: Movable
- Species Name: (65) *Ficus retusa* (*microcarpa*, *nitida*)  
Common Name: Indian Laurel Fig  
Location(s): Alcazar Garden parking lot, Zoro Garden,  
Casa de Balboa parking lot, Auto Museum  
Comments: Save



Species Name:	(67)	Ficus rubiginosa (australis) (1)
Common Name:		Rusty Leaf Fig
Location(s):		SW corner (front) of Natural History Museum
Comments:		Save
Species Name:	(68)	Ficus Sycomorus (1)
Common Name:		Sycamore Fig
Location(s):		Parking lot rear of the Botanical Bldg.
Comments:		Single Specimen/Not Moveable
Species Name:	(70)	Ficus Watkinsiana
Common Name:		Watkins Fig
Location(s):		Pepper Grove Picnic Area, east slope of Gold Gulch near P.G. restroom
Comments:		Single Specimen
Species Name:	(71)	Geijera parviflora
Common Name:		Australian Willow
Location(s):		South rim of Organ Pavilion parking lot at Presidents Way
Comments:		Movable
Species Name:	(72)	Ginkgo biloba (1)
Common Name:		Maidenhair Tree
Location(s):		House of Pacific Relations
Comments:		Save
Species Name:	(76)	Hakea petiolaris
Common Name:		Broad-leaf Sea Urchin
Location(s):		Gold Gulch
Comments:		Save
Species Name:	(77)	Harpullia arborea (2)
Common Name:		NCN
Location(s):		Adjacent to NE wall of Federal Building
Comments:		Save
Species Name:	(81)	Hymenosporum flavum
Common Name:		Sweetshade
Location(s):		House of Pacific Relations
Comments:		Save
Species Name:	(86)	Kigelia pinnata (1)
Common Name:		Sausage Tree
Location(s):		In lawn west of Aerospace Museum adjacent to rest room
Comments:		Save



- Species Name: (88) *Lagunaria pattersoni* (1)  
Common Name: Primrose Tree  
Location(s): N corner of the Casa Del Prado auditorium  
Comments: Save
- Species Name: (92) *Lyonothamnus floribundus*  
Common Name: Catalina Ironwood  
Location(s): NW of Botanical Building  
Comments: Save
- Species Name: (93) *Magnolia grandiflora* (1)  
Common Name: Southern Magnolia  
Location(s): South side (front) of the Natural History Museum  
Comments: Save
- Species Name: (94) *Markhamia hildebrandtii*  
Common Name: NCN  
Location(s): Front of Zoo Hospital, SE corner (front) of the Natural History Museum, east corner of the Federal Building  
Comments: Save
- Species Name: (99) *Michelia Doltsopa* (1)  
Common Name: NCN  
Location(s): Between Muni-Gym and Federal Building adjacent to Pan American Plaza  
Comments: Single Specimen/Moveable
- Species Name: (101) *Olmediella betschierana*  
Common Name: Guatemalan Holly  
Location(s): Rear of the west wing of the Art Museum  
Comments: Save
- Species Name: (102) *Peltophorum dubium* (2)  
Common Name: NCN  
Location(s): South end of Gold Gulch, Park and Presidents Way, Pepper Grove parking lot  
Comments: Save
- Species Name: (106) *Phoenix rupicola*  
Common Name: Cliff Date Palm  
Location(s): South side of Casa del Prado  
Comments: Movable
- Species Name: (108) *Pinus pinea*  
Common Name: Italian Stone Pine  
Location(s): East side of mall, south of Aerospace parking lot  
Comments: Save mall tree





Species Name:	(109)	<i>Pinus torreyana</i>
Common Name:		Torrey Pine
Location(s):		Rear of Organ Pavilion, House of Pacific Relations north lawn
Comments:		Save/Movable
Species Name:	(111)	<i>Pittosporum viridiflorum</i>
Common Name:		Cape Pittosporum
Location(s):		West side of Natural History Museum, East side of mall
Comments:		Movable
Species Name:	(114)	<i>Podocarpus Henkelli</i> (1)
Common Name:		Long-Leafed Yellowwood
Location(s):		West side (rear) of the Natural History Museum, west of Jr. Theater
Comments:		Movable
Species Name:	(118)	<i>Pterospermum acerifolium</i> (1)
Common Name:		Karnikar
Location(s):		West side (rear) of the Casa Del Prado auditorium
Comments:		Single Specimen/Save
Species Name:	(120)	<i>Quercus agrifolia</i> (25)
Common Name:		Live Oak
Location(s):		Gold Gulch
Comments:		Movable
Species Name:	(121)	<i>Quercus ilex</i> (1)
Common Name:		Holly Oak
Location(s):		In lawn north of House of Italy
Comments:		Movable
Species Name:	(123)	<i>Sabal palmetto</i> (10)
Common Name:		Cabbage Palm
Location(s):		Lawn front of Federal Building
Comments:		Movable
Species Name:	(128)	<i>Sclerocarya caffra</i> (1)
Common Name:		Marula
Location(s):		North side of Old Globe Way, rear of Art Museum
Comments:		Save
Species Name:	(129)	<i>Spathodea campanulata</i> (2)
Common Name:		African Tulip Tree
Location(s):		South side of Natural History Museum at entrance
Comments:		Save



Species Name: (134) Taxodium distichum  
Common Name: Bald Cypress  
Location(s): Lawn adjacent to NE side of Federal Building  
Comments: Save

Species Name: (135) Taxodium mucronatum  
Common Name: Montezuma Cypress  
Location(s): Northside of Old Globe Way west of Botanical Building  
Comments: Save

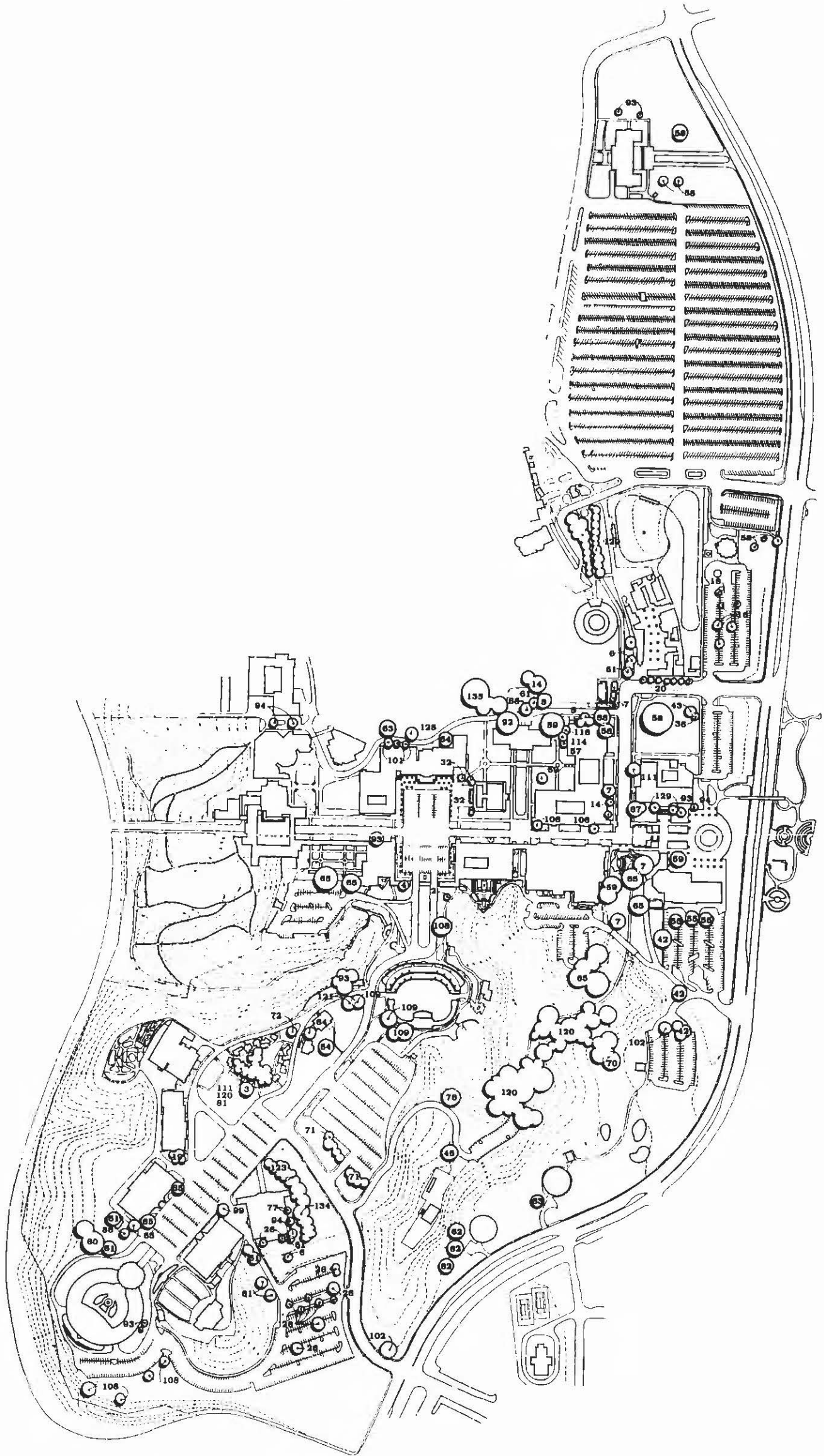

# Central Mesa Significant Plants and Trees

13 June 1991

Figure 24

