



THE CITY OF SAN DIEGO



ANNUAL REPORT

for Fiscal Year 2021

MISSION HILLS HISTORIC STREET LIGHTING MAINTENANCE ASSESSMENT DISTRICT

under the provisions of the

**San Diego Maintenance Assessment District Procedural Ordinance
of the San Diego Municipal Code**

Prepared For
City of San Diego, California



Prepared By
EFS Engineering, Inc.
P.O. Box 22370
San Diego, CA 92192-2370
(858) 752-3490

June 2020

CITY OF SAN DIEGO

Mayor

Kevin Faulconer

City Council Members

Barbara Bry
District 1 (Council President Pro Tem)

Jennifer Campbell
District 2

Chris Ward
District 3

Monica Montgomery
District 4

Mark Kersey
District 5

Chris Cate
District 6

Scott Sherman
District 7

Vivian Moreno
District 8

Georgette Gómez
District 9 (Council President)

City Attorney

Mara W. Elliott

Chief Operating Officer

Kris Michell

City Clerk

Elizabeth Maland

Independent Budget Analyst

Andrea Tevlin

City Engineer

James Nagelvoort

Table of Contents

Annual Report for Fiscal Year 2021
Mission Hills Historic Street Lighting
Maintenance Assessment District

Preamble	1
Executive Summary	2
Background	3
District Boundary	3
Project Description	3
Separation of General and Special Benefits	4
Cost Estimate.....	4
Annual Cost-Indexing	4
Method of Apportionment.....	5
Estimated Benefit of Improvements	5
Apportionment Methodology	6
Equivalent Benefit Units (EBUs)	6
Land Use Factor	6
Benefit Factor	7
Sample Calculations	9
Summary Results.....	10

EXHIBITS

Exhibit A: District Boundary

Exhibit B: Estimated Budget – Revenue & Expense Statement
for Fiscal Year 2021

Exhibit C: Preliminary Assessment Roll for Fiscal Year 2021

Annual Report for Fiscal Year 2021 Mission Hills Historic Street Lighting Maintenance Assessment District

Preamble

Pursuant to §65.0220 of the “San Diego Maintenance Assessment District Procedural Ordinance” (being Division 2, Article 5, Chapter 6 of the *San Diego Municipal Code*) and City of San Diego Council Resolution No. R-310618 passed on July 22, 2016, authorizing the continued levy of assessments for the life of the MISSION HILLS HISTORIC STREET LIGHTING MAINTENANCE ASSESSMENT DISTRICT (hereinafter referred to as “District”), and in accordance with applicable provisions of “Proposition 218” (being Article XIID of the California Constitution), and provisions of the “Proposition 218 Omnibus Implementation Act” (being California Senate Bill 919) (the aforementioned provisions are hereinafter referred to collectively as “applicable law”), and in accordance with Resolution No. _____, adopted by the CITY COUNCIL OF THE CITY OF SAN DIEGO, COUNTY OF SAN DIEGO, STATE OF CALIFORNIA, and in connection with the annual proceedings for the District, EFS Engineering, Inc., as Assessment Engineer to the City of San Diego, submits herewith this annual report for the District as required by §65.0220 of the “San Diego Maintenance Assessment District Procedural Ordinance.”

DATE OF FINAL PASSAGE BY THE CITY OF SAN DIEGO,
COUNTY OF SAN DIEGO, STATE OF CALIFORNIA, ON THE
_____ DAY OF _____, 2020.

Elizabeth Maland, CITY CLERK
CITY OF SAN DIEGO
STATE OF CALIFORNIA

Executive Summary

Project: Mission Hills Historic Street Lighting
Maintenance Assessment District

Apportionment Method: Equivalent Benefit Unit (EBU)

	FY 2020	FY 2021 ⁽¹⁾	Maximum ⁽²⁾ Authorized
Total Parcels Assessed:	726	726	--
Total Estimated Assessment:	\$21,547	\$25,015	--
Total Number of EBUs:	718.24	719.24	--
Assessment per EBU:	\$30.00	\$34.78	\$34.79 ⁽³⁾

⁽¹⁾ FY 2021 is the City's Fiscal Year 2021, which begins July 1, 2020 and ends June 30, 2021. Total Parcels Assessed, Total Estimated Assessment, and assessment apportionment factors may vary from prior fiscal year values due to parcel changes and/or land use re-classifications.

⁽²⁾ Maximum authorized assessment rate subject to cost-indexing as approved by property owners at the time of District formation.

⁽³⁾ Prior fiscal year's maximum authorized annual assessment rate increased by cost-indexing factor of 1.93%.

Annual Cost-Indexing: The maximum authorized assessment rates are cost-indexed and will increase (or decrease) annually based on the annual change in the *San Diego Consumer Price Index for Urban Consumers* (SDCPI-U).

Background

The Mission Hills Historic Street Lighting Maintenance Assessment District (District) was established by the City of San Diego (City) on July 21, 2009 by City Council Resolution R-305099. The purpose of the District was, and still is, to fund specifically identified improvements and activities within the boundary of the District.

In conformity with §65.0221 of the “San Diego Maintenance Assessment District Procedural Ordinance,” the City adopted Resolution No. R-310618 on July 22, 2016, approving the annual budget and assessments for Fiscal Year 2017, and authorizing the levy of the assessments for the life of the District, consistent with the benefit findings and assessment apportionment method contained in the approved formational and all subsequently updated Engineer’s Reports (Engineer’s Reports). The Engineer’s Reports are on file with the City Clerk, and incorporated herein by reference.

The District is authorized and administered under the provisions of the “San Diego Maintenance Assessment District Procedural Ordinance.” This annual report has been prepared pursuant to the requirements of §65.0220 of the “San Diego Maintenance Assessment District Procedural Ordinance.”

District Boundary

The District boundary is generally depicted in **Exhibit A**. The District Boundary Map and Assessment Diagram are on file in the Maintenance Assessment Districts section of the Parks and Recreation Department of the City, and, by reference, are made a part of this annual report.

Project Description

The authorized assessments will be used to fund specifically identified improvements and activities within the District. The District improvements and activities generally consist of procurement, installation, operations and maintenance of the identified decorative (“acorn” style) lighting located within the District. The approximate location of the improvements is generally shown in **Figure 1**.

For additional detail as to the location, type of improvements, and activities performed by the District, please refer to the maps, improvement plans, engineering drawings, maintenance specifications, the Engineer’s Reports and other associated documents on file with the Maintenance Assessment Districts section of the Parks and Recreation

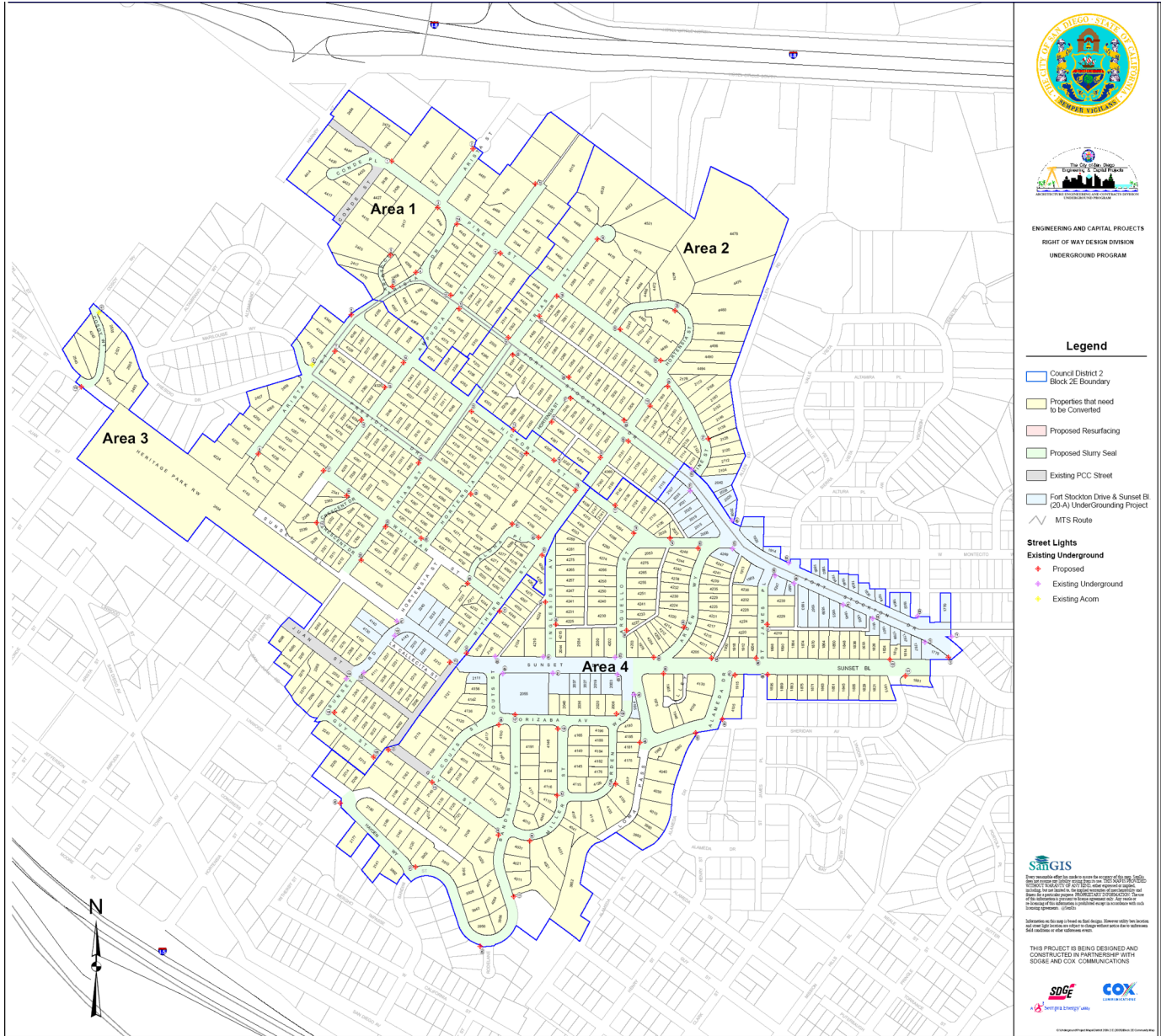

FIGURE 1
Block 2E Utility Undergrounding Project

Department of the City. These documents, collectively, are incorporated herein by reference and made part of this annual report.

Separation of General and Special Benefits

The identified improvements and activities provide benefits to the parcels located within the District. These benefits are “special benefits” to the extent that they are above and beyond the City’s standard level of service, and exclusive of those “general benefits” provided to the public at large or properties located outside the District. By law, only “special benefits” are assessable.

The assessments presented in this annual report are based on the cost of improvements and activities determined to provide “special benefits” in accordance with the Engineer’s Reports. For additional detail relative to the separation and quantification of general and special benefits for the District, please refer to the Engineer’s Reports, on file with the Maintenance Assessment Districts section of the Parks and Recreation Department of the City.

Cost Estimate

The estimated annual budget (Revenue & Expense Statement) is included as **Exhibit B**. The “Other Contributions (Non Assessment Source)” revenue contained in the budget includes the value of improvements and activities determined to provide “general benefits.” The District budget with full detail is available for public reference in the Maintenance Assessment Districts section of the Parks and Recreation Department of the City.

Annual Cost-Indexing

The maximum authorized assessment set forth in the Engineer’s Reports is permitted to increase annually based on the published change in the “San Diego Consumer Price Index for Urban Consumers” (SDCPI-U). The annual change in second half SDCPI-U values, as compiled by the *U.S. Bureau of Labor Statistics* (see www.bls.gov), for the prior year period was from 295.018 to 300.718 (a 1.93% increase). In accordance with the approved cost-indexing provisions, the maximum authorized assessment rate has been increased by 1.93%.

Estimated Benefit of Improvements

The *Uptown Community Plan* (Community Plan) and the general policy recommendations found in the City's *Progress Guide & General Plan* (General Plan) establish several goals, objectives, and guidelines for the planned development of the community. The Community Plan makes specific reference to the following noteworthy objectives and recommendations:

- “Preservation of community character and historical, architectural and cultural resources.” (p. 12)
- “Improve the pedestrian and vehicular quality of the streetscape through the design of new development, public improvements, landscaping and coordinated street plantings.” (p. 78)
- “Street furniture, coordinated signage and lighting, planters, kiosks, public art, and plant material should be incorporated whenever possible to add to the vitality of the streetscape.” (p. 82)
- “Street trees, lighting, bollards and/or sidewalk textures should be provided along major streets to create a pleasing pedestrian environment, in addition to providing a separation between pedestrian circulation and vehicular movement.” (p. 82)
- “Enrich the pedestrian quality of all areas by increasing sidewalk widths when appropriate, identifying street tree themes, providing cohesive street furniture, unifying signage, increasing lighting, varying pavement materials and providing nodal points at strategic locations.” (p. 82)

The proposed decorative lighting improvements and activities are consistent with these objectives and recommendations. The City's General Plan and Community Plan support the establishment of community-based improvement and maintenance districts, such as this District, to fund enhanced improvements and activities.

The proposed improvements and activities are generally located in the public rights-of-way along the various transportation corridors within the District. These transportation corridors serve as the primary access routes for inter-community and intra-community trips. Parcels within the District benefit from the improvements and activities in terms of enhanced aesthetics, community image and public safety.

Apportionment Methodology

The total cost associated with District improvement and activities will be assessed proportionally to the parcels in the District based on Equivalent Benefit Units (EBUs). The total assessment for a given parcel is equal to the parcel's total EBUs multiplied by the Unit Assessment Rate as shown in the following equation:

$$\text{Total Assessment} = \text{Total EBUs} \times \text{Unit Assessment Rate}$$

Equivalent Benefit Units (EBUs)

EBUs for each parcel have been determined as a function of parcel area (or number of residential units) and two factors – a Land Use Factor and a Benefit Factor – related as shown in the following equation:

$$\text{EBUs} = (\text{Acres or Units}) \times \text{Land Use Factor} \times \text{Benefit Factor}$$

Parcels determined to receive no benefit from the maintenance of District improvements and activities have been assigned zero (0) EBUs.

Land Use Factor

Since the proposed District improvements and activities are primarily associated with the Transportation Element of City's General Plan and Community Plan, trip generation rates for various land use categories (as previously established by the City's Transportation Planning section) have been used as the primary basis for the development of Land Use Factors. While these trip generation rates address vehicular trips, they are also considered to approximately reflect relative trip generation for other modes of transportation (e.g., pedestrian trips, bicycle trips, etc.), and are considered the best available information for these other transportation modes.

Trip generation rates provide the required nexus and basis for assigning relative proportionality of potential benefit to the various land use/zoning classifications (as defined by the City's Municipal Code) within the District. Land use/zoning classifications have been grouped with averaged trip generation rates assigned to establish the Land Use Factors as shown in **Table 1**.

TABLE 1: Land Use Factors

Land Use/Zoning	Code	Land Use Factor ⁽¹⁾
Residential – Single Family (detached)	SFD	1.0 per dwelling unit
Residential – Duplex	DUP	0.7 per dwelling unit
Residential – Multi-Family & Apartment	MFR	0.7 per dwelling unit
Commercial – Office & Retail	COM	40.0 per acre
Open Space (designated)	OSP	0 per acre
Street/Roadway	STR	0 per acre
Undevelopable	UND	0 per acre
Vacant (developable)	VAC	2.0 per acre

⁽¹⁾ Proportional to trip generation rates contained in the City of San Diego *Trip Generation Manual* (May 2003).

Designated open space serves primarily to preserve natural landscape and habitat. While access for study and passive recreation is often permitted, these activities are allowed only to the extent they are consistent with the primary purpose of natural preservation. Since this land is essentially “unused” in the customary terms of land use (which relate to human use and development), the trip generation rate is zero. Therefore, the designated open space itself receives no benefit from District improvements and activities and has been assigned a Land Use Factor of zero.

While those traveling the streets and roadways visually enjoy the enhanced improvements and activities being maintained by the District, the actual benefit accrues to the lands at the origins and destinations of their trips, not to the lands of the streets and roadways, themselves. Accordingly, the Streets/Roadways category receives no benefit and has been assigned a Land Use Factor of zero.

Benefit Factor

The Land Use Factor described above establishes a proportionality of relative intensity of use (or potential use) for the various parcels of land within the District. It does not address the relationship of this use to the specific improvements and activities to be maintained by the District. This relationship is reflected in the Benefit Factor utilized in the assessment methodology.

In determining the Benefit Factor for each land use category, the subcomponents of the benefits of the improvements and activities in a district may include some or all of the following: public safety, view corridors and aesthetics, enhancement of community identity,

drainage corridors, and recreational potential. The subcomponents used for this District are: aesthetics/community image and public safety.

As Benefit Factors and their subcomponents are intended to reflect the particular relationships between specific land uses within a district and the specific improvements and activities maintained by the district, Benefit Factors will generally vary from one district to another, based on the specific character and nature of the applicable land uses and improvements and activities being maintained. For a given land use, the overall Benefit Factor is equal to the sum of the subcomponent values. If a land use category receives no benefit from a subcomponent, then a value of zero is assigned to that subcomponent. A composite Benefit Factor of 1.0 indicates that full benefit is received. A value less than 1.0 indicates that less than full benefit is received.

The applicable benefit subcomponents and resultant composite Benefit Factors determined for the various Land Use/Zoning categories within this District are as shown in **Table 2**.

TABLE 2: Benefit Factors by Land Use

Land Use/Zoning	Aesthetics/ Community Image (Max. 0.8)	Public Safety (Max. 0.2)	Composite Benefit Factor (Max. 1.0)
Residential – All	0.8	0.2	1.0
Commercial – Office & Retail	0.4	0.2	0.6
Open Space (designated)	0.0	0.2	0.0
Street/Roadway	0.0	0.2	0.0
Undevelopable	0.0	0.2	0.0
Vacant (developable)	0.4	0.2	0.6

Aesthetics/Community Image. The District improvements and activities provide enhanced aesthetics/community image. The degree of benefit received from this aspect of the District improvements and activities varies among the land use categories. Generally, by nature of their use, Residential lands receive the greatest benefit from aesthetic enhancement of the transportation corridors. Lands in the Commercial and Vacant categories are considered to receive a lesser degree of benefit from these enhancements based on the non-continuous or temporal nature of these uses. Lands in the Open Space, Street/Roadway, and Undevelopable categories are considered to receive no significant benefit from the aesthetic elements of the District improvements and activities, as enhanced aesthetic quality of other lands in their

vicinity does not affect their function, use, or value.

Public Safety. All land uses are considered to receive the maximum available benefit from the public safety aspect of the District improvements and activities. Public safety is essential to all land uses, and even to lands, such as designated open space, held in stewardship with only incidental human use.

Sample Calculations

As described above, the number of Equivalent Benefit Units (EBUs) assigned to each parcel in the District has been calculated based on each parcel's land use and the identified apportionment factors, as shown in the following equation:

$$\text{EBUs} = (\text{Acres or Units}) \times \text{Land Use Factor} \times \text{Benefit Factor}$$

Shown below are sample EBU calculations for several common land uses found in the District.

- **1 Single-Family Residence**
EBUs = 1 unit x 1.00 x 1.00 = 1.00 EBUs
- **10-unit Apartment Complex**
EBUs = 10 units x 0.70 x 1.00 = 7.00 EBUs
- **½-acre Commercial Property**
EBUs = 0.50 acres x 40.00 x 0.60 = 12.00 EBUs

The total assessment for each parcel in the District is based on the calculated EBUs for the parcel and the applicable unit assessment rate, as shown in the following equation:

$$\text{Total Assessment} = \text{Total EBUs} \times \text{Unit Assessment Rate}$$

Based on the above formula, the EBUs, unit assessment rate, and total assessment calculated for each property, can be found in the Assessment Roll (**Exhibit C**).

Summary Results

The District Boundary is presented in **Exhibit A**.

An estimate of the annual costs of the improvements and activities provided by the District is included as **Exhibit B**.

The assessment methodology utilized is as described in the text of this annual report. Based on this methodology, the assessments for each parcel were calculated and are shown in the Preliminary Assessment Roll (**Exhibit C**).

Each lot or parcel of land within the District has been identified by unique County Assessor's Parcel Number in the Preliminary Assessment Roll and on the Boundary Map and Assessment Diagram referenced herein.

This annual report has been prepared and respectfully submitted by:

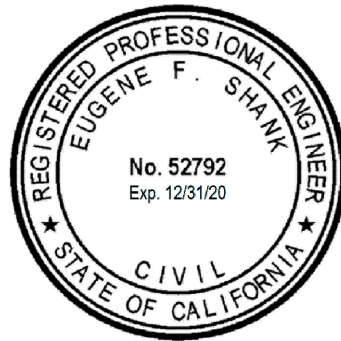

EFS ENGINEERING, INC.

Eugene F. Shank, PE

C 52792

Sharon F. Risse

EXHIBIT A

District Boundary

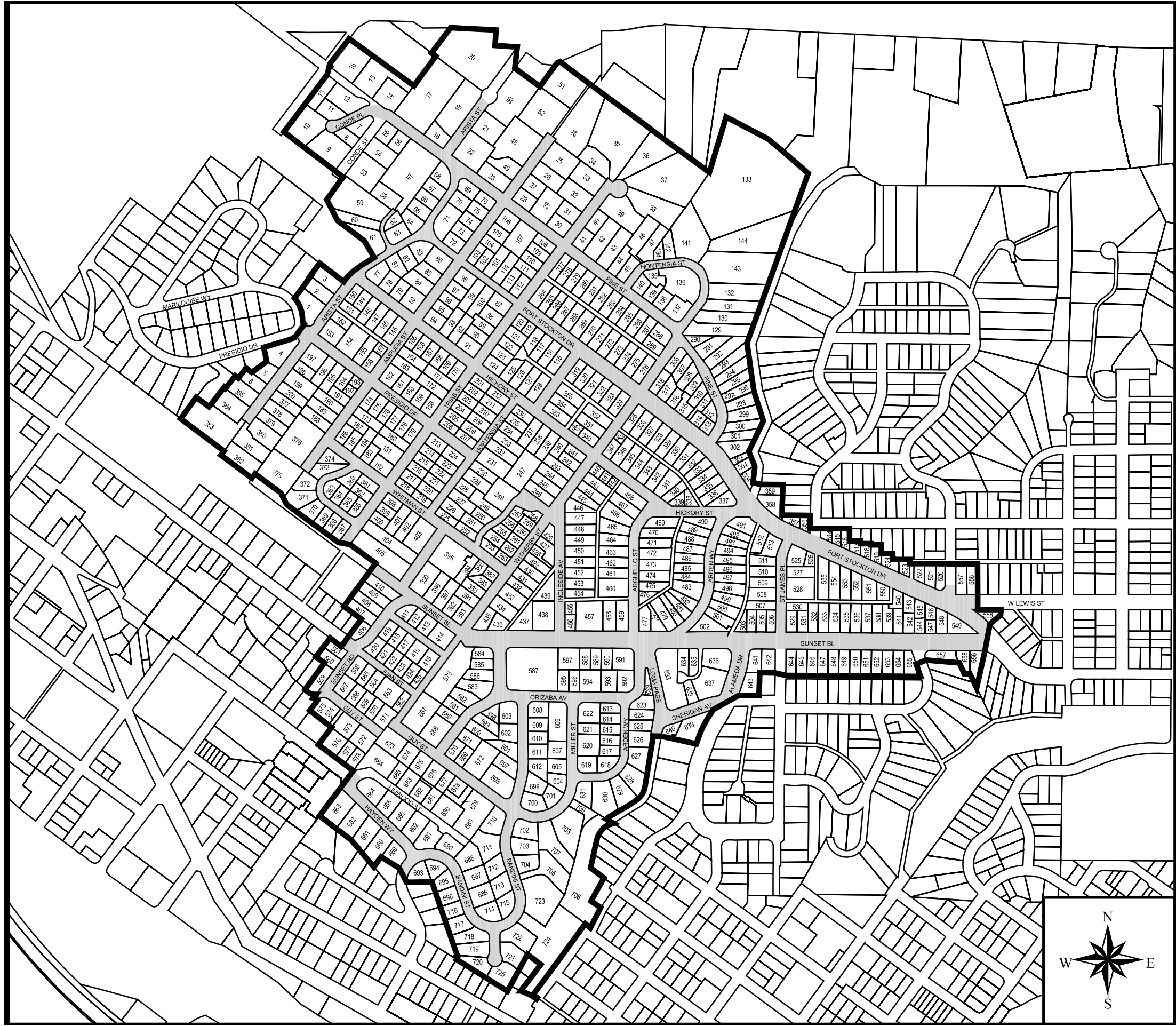

SOURCE: SanGIS, City of San Diego and AECOM.

BOUNDARY MAP & ASSESSMENT DIAGRAM

I HEREBY CERTIFY THAT THE WITHIN MAP SHOWING PROPOSED BOUNDARIES OF THE MISSION HILLS HISTORIC STREET LIGHTING MAINTENANCE ASSESSMENT DISTRICT, CITY OF SAN DIEGO, STATE OF CALIFORNIA, WAS APPROVED BY THE CITY COUNCIL AT A REGULAR MEETING THEREOF, HELD ON THE DAY OF _____, 2009, BY ITS RESOLUTION NO. _____.

ELIZABETH MALAND, CITY CLERK
CITY OF SAN DIEGO
STATE OF CALIFORNIA

PREPARED BY:
AECOM

7807 Conroy Court, Suite 200, San Diego, California 92111 (858) 268-8080

AN ASSESSMENT WAS LEVIED BY THE CITY COUNCIL OF THE CITY OF SAN DIEGO ON THE LOTS, PIECES, AND PARCELS OF LAND SHOWN ON THIS ASSESSMENT DIAGRAM. SAID ASSESSMENT WAS LEVIED ON THE DAY OF _____, 2009. SAID ASSESSMENT DIAGRAM AND THE ASSESSMENT ROLL WERE RECORDED IN THE OFFICE OF THE SUPERINTENDENT OF STREETS OF THE CITY OF SAN DIEGO, STATE OF CALIFORNIA ON THE DAY OF _____, 2009. REFERENCE IS MADE TO THE ASSESSMENT ROLL RECORDED IN THE OFFICE OF THE SUPERINTENDENT OF STREETS FOR THE EXACT AMOUNT OF EACH ASSESSMENT LEVIED AGAINST EACH PARCEL OF LAND SHOWN ON THIS ASSESSMENT DIAGRAM.

ELIZABETH MALAND, CITY CLERK
CITY OF SAN DIEGO
STATE OF CALIFORNIA

PREPARED BY:
AECOM

7807 Conroy Court, Suite 200, San Diego, California 92111 (858) 268-8080

FOR A DETAILED DESCRIPTION OF THE LINES AND DIMENSIONS OF LOTS OR PARCELS SHOWN ON THIS MAP, REFER TO THE COUNTY ASSESSOR'S MAPS WHICH SHALL GOVERN WITH RESPECT TO ALL DETAILS CONCERNING THE LINES AND DIMENSIONS OF SUCH LOTS OR PARCELS.

- LEGEND:**
- District Boundary
 - Parcel Line
 - Improvement Areas *
 - # Diagram Number

* REFER TO THE ENGINEER'S REPORT AND REFERENCED DOCUMENTS FOR DESCRIPTION OF IMPROVEMENTS AND SERVICES.

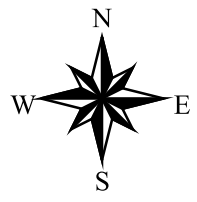

CITY OF
SAN DIEGO

MISSION HILLS HISTORIC STREET LIGHTING MAINTENANCE ASSESSMENT DISTRICT

W.O. DATE: MAY 2009 REVS:

EXHIBIT B

**Estimated Budget – Revenue & Expense Statement
for Fiscal Year 2021**

EXHIBIT B

REVENUE AND EXPENSE STATEMENT

Mission Hills Historic Steet Lighting Maintenance Assessment District Fund 200614

	FY 2019 ACTUALS	FY 2020 ESTIMATE	FY 2021 PROPOSED
BEGINNING FUND BALANCE			
Surplus (or Deficit) from Prior Year	\$ 49,306.07	\$ 25,246.45	\$ 17,128.00
TOTAL BEGINNING FUND BALANCE	\$ 49,306.07	\$ 25,246.45	\$ 17,128.00
REVENUE			
Assessment Revenue	\$ -	\$ 21,547.00	\$ 25,015.12
Interest	\$ 683.38	\$ 303.00	\$ 303.00
Other Contributions (Non Assessment Source)	\$ 241.00	\$ 599.00	\$ 3,132.00
TOTAL REVENUE	\$ 924.38	\$ 22,449.00	\$ 28,450.12
TOTAL BEGINNING FUND BALANCE & REVENUE	\$ 50,230.45	\$ 47,695.45	\$ 45,578.12
OPERATING EXPENSE			
Special Lighting Contracts and Services ⁽¹⁾	\$ 18,746.00	\$ 18,746.00	\$ 18,746.00
Supplies - Lighting Fixtures	\$ -	\$ 5,500.00	\$ 5,500.00
Special Districts Administrative Cost	\$ 6,238.00	\$ 6,321.00	\$ 6,406.00
TOTAL OPERATING EXPENSE	\$ 24,984.00	\$ 30,567.00	\$ 30,652.00
TOTAL EXPENSE	\$ 24,984.00	\$ 30,567.00	\$ 30,652.00
TOTAL ENDING FUND BALANCE	\$ 25,246.45	\$ 17,128.45	\$ 14,926.12
NET ANNUAL REVENUE (OR EXPENSE)	\$ (24,059.62)	\$ (8,118.00)	\$ (2,201.88)

⁽¹⁾ Includes City services billed street light maintenance & electrician costs.

The District budget with full detail is available for public reference in the Maintenance Assessment Districts section of the Parks and Recreation Department of the City of San Diego.

EXHIBIT C

**Preliminary Assessment Roll
for Fiscal Year 2021**

EXHIBIT C - Assessment Roll (Fiscal Year 2021)
Mission Hills Historic Street Lighting Maintenance Assessment District

Parcel Number	Acres/ Units ⁽¹⁾	Land Use Code ⁽²⁾	Apportionment Factors		Total EBUs	Unit Cost (\$/Ebu)	FY 2021 ⁽⁴⁾ Assessment	Owner Name
			Land Use ⁽²⁾	Benefit ⁽³⁾				
442 702 03 00	1.00	SFD	1.00	1.00	1.00	\$34.78	\$34.78	Jackson Family Trust 07-28-10
442 702 04 00	1.00	SFD	1.00	1.00	1.00	\$34.78	\$34.78	Yocom Dena L Trust 11-13-13
442 702 05 00	1.00	SFD	1.00	1.00	1.00	\$34.78	\$34.78	Weightman Nadine Trust 08-31-12
442 703 01 00	1.00	SFD	1.00	1.00	1.00	\$34.78	\$34.78	Needham Terence&Jeannie Family Trust 08-10-94
442 703 02 00	1.00	SFD	1.00	1.00	1.00	\$34.78	\$34.78	Haberman Aaron R&Victoria E N
442 703 03 00	1.00	SFD	1.00	1.00	1.00	\$34.78	\$34.78	Green Kevin&Tekla
442 710 01 00	1.00	SFD	1.00	1.00	1.00	\$34.78	\$34.78	Batule Joel
442 710 02 00	1.00	SFD	1.00	1.00	1.00	\$34.78	\$34.78	Mcknight John R Trust 09-02-04
442 710 03 00	1.00	SFD	1.00	1.00	1.00	\$34.78	\$34.78	Rodriguez Family Trust 05-24-90
442 710 04 00	1.00	SFD	1.00	1.00	1.00	\$34.78	\$34.78	Evans William&Susan Family Trust 03-16-00
442 710 05 00	1.00	SFD	1.00	1.00	1.00	\$34.78	\$34.78	Betts Josephine D Tr
442 710 07 00	1.00	SFD	1.00	1.00	1.00	\$34.78	\$34.78	Zakowski Joseph A&Kimberly M
442 710 08 00	1.00	SFD	1.00	1.00	1.00	\$34.78	\$34.78	Khalaf Family Trust 12-19-17
442 720 07 00	1.00	SFD	1.00	1.00	1.00	\$34.78	\$34.78	Slacum Kay Trust 04-22-94
442 720 11 00	1.00	SFD	1.00	1.00	1.00	\$34.78	\$34.78	Flores Ruben G Revocable Trust 08-11-14
442 720 12 00	1.00	SFD	1.00	1.00	1.00	\$34.78	\$34.78	Osullivan Revocable Trust 07-27-16
443 051 01 00	1.00	SFD	1.00	1.00	1.00	\$34.78	\$34.78	Bohannon Bobbie Living Trust 07-29-98
443 051 02 00	1.00	SFD	1.00	1.00	1.00	\$34.78	\$34.78	Dixon Peter C Living Trust 10-16-98
443 051 03 00	1.00	SFD	1.00	1.00	1.00	\$34.78	\$34.78	Price Robert E Tr
443 051 04 00	1.58	OSP	0.00	1.00	0.00	\$34.78	\$0.00	City Of San Diego
443 051 07 00	1.00	SFD	1.00	1.00	1.00	\$34.78	\$34.78	Houston Sandra J 1992 Trust 12-18-92
443 051 08 00	1.00	SFD	1.00	1.00	1.00	\$34.78	\$34.78	Reed Elizabeth M Trust 07-20-95
443 051 09 00	1.00	SFD	1.00	1.00	1.00	\$34.78	\$34.78	Habig Family Trust 04-03-17
443 051 13 00	1.00	SFD	1.00	1.00	1.00	\$34.78	\$34.78	P D B Trust 07-31-97
443 051 14 00	1.00	SFD	1.00	1.00	1.00	\$34.78	\$34.78	Casady Janed G Revocable Trust 06-02-94
443 051 15 00	1.00	SFD	1.00	1.00	1.00	\$34.78	\$34.78	Scott Michael&Melucci Kerri
443 051 16 00	1.00	SFD	1.00	1.00	1.00	\$34.78	\$34.78	Omalley Family Trust 02-01-18
443 051 17 00	1.00	SFD	1.00	1.00	1.00	\$34.78	\$34.78	Humberson Cora S Revocable Trust No 1
443 051 18 00	1.00	SFD	1.00	1.00	1.00	\$34.78	\$34.78	Canale Theakston Trust 11-10-05
443 051 19 00	1.00	SFD	1.00	1.00	1.00	\$34.78	\$34.78	Miller Family Trust 03-17-17
443 051 20 00	1.00	SFD	1.00	1.00	1.00	\$34.78	\$34.78	Kaffel Botcher Family Trust 07-06-18
443 051 21 00	1.00	SFD	1.00	1.00	1.00	\$34.78	\$34.78	Cianflone David A&Margherita G Trs
443 051 22 00	1.00	SFD	1.00	1.00	1.00	\$34.78	\$34.78	Deeks Claire E 1995 Trust 08-10-95
443 051 23 00	1.00	SFD	1.00	1.00	1.00	\$34.78	\$34.78	Gillis William J Jr&Frances P
443 051 24 00	1.00	SFD	1.00	1.00	1.00	\$34.78	\$34.78	Swim Family Trust 02-11-93
443 051 25 00	1.00	SFD	1.00	1.00	1.00	\$34.78	\$34.78	Deal Christopher J Trust 01-05-18
443 051 26 00	1.00	SFD	1.00	1.00	1.00	\$34.78	\$34.78	Rott Michael I&Elisa
443 051 27 00	1.00	SFD	1.00	1.00	1.00	\$34.78	\$34.78	Castagnola Mary L Trust 05-19-92
443 051 28 00	1.00	SFD	1.00	1.00	1.00	\$34.78	\$34.78	Stotsky Michael S Trust 09-13-12
443 051 29 00	1.00	SFD	1.00	1.00	1.00	\$34.78	\$34.78	Rybak Family Trust 05-17-15
443 051 30 00	1.00	SFD	1.00	1.00	1.00	\$34.78	\$34.78	Peryman Family Trust 05-05-93
443 051 31 00	1.00	SFD	1.00	1.00	1.00	\$34.78	\$34.78	Lewkowicz-Grodner Family Trust 10-09-01
443 051 32 00	1.00	SFD	1.00	1.00	1.00	\$34.78	\$34.78	Cullen Norman L Exemption Trust
443 051 33 00	1.00	SFD	1.00	1.00	1.00	\$34.78	\$34.78	Oliver Virginia S Trust 09-10-12
443 051 34 00	1.00	SFD	1.00	1.00	1.00	\$34.78	\$34.78	Brennan William&Lauri Trust 07-19-13
443 051 35 00	1.00	SFD	1.00	1.00	1.00	\$34.78	\$34.78	Marckwardt William H&Patricia E Revocable Trust 01
443 051 36 00	1.00	SFD	1.00	1.00	1.00	\$34.78	\$34.78	Singer Diane V Trust 02-22-10
443 051 38 00	1.00	SFD	1.00	1.00	1.00	\$34.78	\$34.78	Foerster Barrett J&Susan S Revocable Survivors Tru
443 051 39 00	1.00	SFD	1.00	1.00	1.00	\$34.78	\$34.78	Miller Laurence A
443 051 40 00	1.00	SFD	1.00	1.00	1.00	\$34.78	\$34.78	Nevara John B&Barbara A Family Trust 12-07-01

EXHIBIT C - Assessment Roll (Fiscal Year 2021)
Mission Hills Historic Street Lighting Maintenance Assessment District

Parcel Number	Acres/ Units ⁽¹⁾	Land Use Code ⁽²⁾	Apportionment Factors		Total EBUs	Unit Cost (\$/Ebu)	FY 2021 ⁽⁴⁾ Assessment	Owner Name
			Land Use ⁽²⁾	Benefit ⁽³⁾				
443 051 42 00	0.00	SFD	1.00	1.00	0.00	\$34.78	\$0.00	Nevara John B&Barbara A Family Trust
443 051 43 00	0.00	SFD	1.00	1.00	0.00	\$34.78	\$0.00	Nevara John B&Barbara A Family Trust
443 061 01 00	1.00	SFD	1.00	1.00	1.00	\$34.78	\$34.78	Davis Family 2003 Trust 06-24-03
443 061 02 00	1.00	SFD	1.00	1.00	1.00	\$34.78	\$34.78	Sanchez-Boselli Family Trust 07-29-15
443 061 03 00	1.00	SFD	1.00	1.00	1.00	\$34.78	\$34.78	Coon David
443 061 04 00	1.00	SFD	1.00	1.00	1.00	\$34.78	\$34.78	Jackson Donald P&Sharon W Trs
443 061 05 00	1.00	SFD	1.00	1.00	1.00	\$34.78	\$34.78	Pecka Helen B Qualified Personal Residence Trust
443 061 06 00	0.00	SFD	1.00	1.00	0.00	\$34.78	\$0.00	Ramirez-Cardenas Family Trust 08-17-95
443 061 07 00	1.00	SFD	1.00	1.00	1.00	\$34.78	\$34.78	Ramirez-Cardenas Family Trust 08-17-95
443 061 08 00	1.00	SFD	1.00	1.00	1.00	\$34.78	\$34.78	Ramirez-Cardenas Family Trust 08-17-95
443 061 09 00	1.00	SFD	1.00	1.00	1.00	\$34.78	\$34.78	Slater Family Exemption 1985 Trust 08-08-85 Et Al
443 061 10 00	0.00	SFD	1.00	1.00	0.00	\$34.78	\$0.00	Ramirez-Cardenas Family Trust 08-17-95
443 061 11 00	1.00	SFD	1.00	1.00	1.00	\$34.78	\$34.78	Schiller-Ross Family Trust 07-13-11
443 061 12 00	1.00	SFD	1.00	1.00	1.00	\$34.78	\$34.78	Marosi John
443 061 13 00	1.00	SFD	1.00	1.00	1.00	\$34.78	\$34.78	Dailard Douglas&Lyons-Dailard Cynthia Family Trust
443 061 14 00	0.00	SFD	1.00	1.00	0.00	\$34.78	\$0.00	Collins Family Trust
443 061 15 00	1.00	SFD	1.00	1.00	1.00	\$34.78	\$34.78	Collins Family Trust
443 061 16 00	1.00	SFD	1.00	1.00	1.00	\$34.78	\$34.78	Coppedge Family Trust 06-26-13
443 061 17 00	1.00	SFD	1.00	1.00	1.00	\$34.78	\$34.78	Oconnor Mavourneen F
443 061 18 00	1.00	SFD	1.00	1.00	1.00	\$34.78	\$34.78	Barker James&Margaret Family Trust 02-12-98
443 061 19 00	1.00	SFD	1.00	1.00	1.00	\$34.78	\$34.78	J A C O Trust 06-01-05
443 061 20 00	1.00	SFD	1.00	1.00	1.00	\$34.78	\$34.78	Clapp David P Trust 09-14-17
443 061 21 00	1.00	SFD	1.00	1.00	1.00	\$34.78	\$34.78	Childs Family Revocable Trust 02-14-03
443 061 22 00	1.00	SFD	1.00	1.00	1.00	\$34.78	\$34.78	Kinnaird Patrick B&Sherry C
443 061 23 00	1.00	SFD	1.00	1.00	1.00	\$34.78	\$34.78	Pecoraro Onofrio F Family Trust 09-10-08
443 061 24 00	1.00	SFD	1.00	1.00	1.00	\$34.78	\$34.78	Weaver/Witt Revocable Trust 10-08-02
443 061 25 00	1.00	SFD	1.00	1.00	1.00	\$34.78	\$34.78	Soni Family Trust 05-04-17
443 061 26 00	1.00	SFD	1.00	1.00	1.00	\$34.78	\$34.78	Powers Edward W&Kimberly
443 061 27 00	1.00	SFD	1.00	1.00	1.00	\$34.78	\$34.78	Mcgrath Family Trust 07-17-90
443 061 28 00	1.00	SFD	1.00	1.00	1.00	\$34.78	\$34.78	Willmann Family Survivos Trust 02-27-96
443 061 29 00	1.00	SFD	1.00	1.00	1.00	\$34.78	\$34.78	Crockett Chan Trust 10-01-14
443 061 30 00	1.00	SFD	1.00	1.00	1.00	\$34.78	\$34.78	Willis Family Trust 12-07-05
443 061 31 00	1.00	SFD	1.00	1.00	1.00	\$34.78	\$34.78	Ruesch Family Trust 06-11-14
443 061 32 00	1.00	SFD	1.00	1.00	1.00	\$34.78	\$34.78	Deddeh Peter C&Aleta
443 061 33 00	1.00	SFD	1.00	1.00	1.00	\$34.78	\$34.78	Barsell Richard A Revocable Trust 06-30-14
443 061 34 00	1.00	SFD	1.00	1.00	1.00	\$34.78	\$34.78	Scott Michael A&Melucci Kerri M
443 061 35 00	1.00	SFD	1.00	1.00	1.00	\$34.78	\$34.78	Heatly Joe R&Jane
443 061 36 00	1.00	SFD	1.00	1.00	1.00	\$34.78	\$34.78	Shea Family Trust 10-07-97
443 061 37 00	1.00	SFD	1.00	1.00	1.00	\$34.78	\$34.78	Musoke Lois Trust 06-21-06
443 061 38 00	1.00	SFD	1.00	1.00	1.00	\$34.78	\$34.78	Casper William J&Lynda E Trust 05-15-91
443 061 39 00	1.00	SFD	1.00	1.00	1.00	\$34.78	\$34.78	Schulman Family Trust 04-19-90
443 061 40 00	1.00	SFD	1.00	1.00	1.00	\$34.78	\$34.78	Niewiadomski Slawomir
443 061 41 00	1.00	SFD	1.00	1.00	1.00	\$34.78	\$34.78	Mcadam Nancy&William 2007 Trust 04-19-07
443 061 42 00	1.00	SFD	1.00	1.00	1.00	\$34.78	\$34.78	Plant Frank E Iii&Marcella A Family Trust 09-17-08
443 061 43 00	1.00	SFD	1.00	1.00	1.00	\$34.78	\$34.78	Prantil Natalie
443 061 44 00	1.00	SFD	1.00	1.00	1.00	\$34.78	\$34.78	Finch Jonathan T&Jacqueline S
443 061 45 00	1.00	SFD	1.00	1.00	1.00	\$34.78	\$34.78	Abelsohn Leahna S&Jason P
443 061 46 00	1.00	SFD	1.00	1.00	1.00	\$34.78	\$34.78	Faiola Vincent G Trust 03-17-78
443 061 47 00	1.00	SFD	1.00	1.00	1.00	\$34.78	\$34.78	Jackson Sharon W Tr
443 061 48 00	1.00	SFD	1.00	1.00	1.00	\$34.78	\$34.78	Welter John A&Theresa F

EXHIBIT C - Assessment Roll (Fiscal Year 2021)
Mission Hills Historic Street Lighting Maintenance Assessment District

Parcel Number	Acres/ Units ⁽¹⁾	Land Use Code ⁽²⁾	Apportionment Factors		Total EBUs	Unit Cost (\$/Ebu)	FY 2021 ⁽⁴⁾ Assessment	Owner Name
			Land Use ⁽²⁾	Benefit ⁽³⁾				
443 061 49 00	1.00	SFD	1.00	1.00	1.00	\$34.78	\$34.78	Tobias Irene
443 061 50 00	1.00	SFD	1.00	1.00	1.00	\$34.78	\$34.78	Svidal Jay D&Gretchen W Revocable Trust 10-17-09
443 061 51 00	1.00	SFD	1.00	1.00	1.00	\$34.78	\$34.78	Fujimoto Family Trust 01-29-97
443 061 52 00	1.00	SFD	1.00	1.00	1.00	\$34.78	\$34.78	Karel Joyce Intervivos Trust 2 06-04-82
443 061 53 00	1.00	SFD	1.00	1.00	1.00	\$34.78	\$34.78	Frachon Didier B&Kathleen M
443 061 54 00	1.00	SFD	1.00	1.00	1.00	\$34.78	\$34.78	Dimsdale Inter Vivos Trust 10-24-95
443 061 55 00	1.00	SFD	1.00	1.00	1.00	\$34.78	\$34.78	Valencia Grace M
443 061 56 00	1.00	SFD	1.00	1.00	1.00	\$34.78	\$34.78	Giffin Michael G&Karen A Trs
443 061 57 00	1.00	SFD	1.00	1.00	1.00	\$34.78	\$34.78	Cochrane Pamela L
443 061 58 00	1.00	SFD	1.00	1.00	1.00	\$34.78	\$34.78	Shapiro Warren L&Julie A Family Revocable Trust
443 061 59 00	1.00	SFD	1.00	1.00	1.00	\$34.78	\$34.78	Beamer Family Trust
443 061 60 00	1.00	SFD	1.00	1.00	1.00	\$34.78	\$34.78	Pick-Labourdette Family Trust 09-27-16
443 061 61 00	1.00	SFD	1.00	1.00	1.00	\$34.78	\$34.78	Kline Trust 02-12-03
443 061 62 00	1.00	SFD	1.00	1.00	1.00	\$34.78	\$34.78	Wise Penny S Trust 08-30-05
443 061 63 00	1.00	SFD	1.00	1.00	1.00	\$34.78	\$34.78	Northrup Revocable Trust 11-29-17
443 061 64 00	1.00	SFD	1.00	1.00	1.00	\$34.78	\$34.78	Bellows Richard S&Matthews Erin J
443 061 65 00	1.00	SFD	1.00	1.00	1.00	\$34.78	\$34.78	Mccarthy Brian
443 061 66 00	1.00	SFD	1.00	1.00	1.00	\$34.78	\$34.78	Coleman Scott H&Sarah E
443 061 67 00	1.00	SFD	1.00	1.00	1.00	\$34.78	\$34.78	Carlstein Barbara J Living Trust 08-22-16
443 061 68 00	1.00	SFD	1.00	1.00	1.00	\$34.78	\$34.78	Semar Family Trust 08-19-08
443 061 69 00	1.00	SFD	1.00	1.00	1.00	\$34.78	\$34.78	Yang Calvin T&Lee Kristeen Y
443 061 70 00	1.00	SFD	1.00	1.00	1.00	\$34.78	\$34.78	Jensen Richard&Stephanie Revocable Living Trust 07
443 061 71 00	1.00	SFD	1.00	1.00	1.00	\$34.78	\$34.78	Delsman Mark J Separate Property Trust 04-26-07
443 061 72 00	1.00	SFD	1.00	1.00	1.00	\$34.78	\$34.78	Featherman Family Trust 01-15-01
443 061 73 00	1.00	SFD	1.00	1.00	1.00	\$34.78	\$34.78	Nelkin-Rickless Revocable Trust 11-01-05
443 061 74 00	1.00	SFD	1.00	1.00	1.00	\$34.78	\$34.78	Hamilton Stephen F&Mary A
443 061 75 00	1.00	SFD	1.00	1.00	1.00	\$34.78	\$34.78	Hartman Family Trust 04-17-97
443 061 76 00	1.00	SFD	1.00	1.00	1.00	\$34.78	\$34.78	Twining Family Trust 04-18-05
443 121 01 00	1.00	SFD	1.00	1.00	1.00	\$34.78	\$34.78	Sarita Realty Llc
443 121 02 00	1.00	SFD	1.00	1.00	1.00	\$34.78	\$34.78	Lauer Trust 06-17-94
443 121 03 00	1.00	SFD	1.00	1.00	1.00	\$34.78	\$34.78	Benson Family Living Trust 08-14-18
443 121 04 00	1.00	SFD	1.00	1.00	1.00	\$34.78	\$34.78	Kocmur Family Trust 05-06-04
443 121 07 00	1.00	SFD	1.00	1.00	1.00	\$34.78	\$34.78	Sawyer Matthew A Revocable Living Trust 11-29-06
443 121 10 00	1.00	SFD	1.00	1.00	1.00	\$34.78	\$34.78	Ervin Family Trust 03-09-17
443 121 11 00	1.00	SFD	1.00	1.00	1.00	\$34.78	\$34.78	Henson Laurie S Trust 01-03-95
443 121 12 00	1.00	SFD	1.00	1.00	1.00	\$34.78	\$34.78	Ansmar Family Trust 07-30-99
443 121 13 00	1.00	SFD	1.00	1.00	1.00	\$34.78	\$34.78	Katz Mark R&Naomi J Trs
443 121 14 00	1.00	SFD	1.00	1.00	1.00	\$34.78	\$34.78	Ansmar Family Trust 07-30-99
443 121 15 00	1.00	SFD	1.00	1.00	1.00	\$34.78	\$34.78	Debow Evan M&Allison C
443 121 16 00	1.00	SFD	1.00	1.00	1.00	\$34.78	\$34.78	Brandon Family Trust 10-10-90
443 121 18 00	1.00	SFD	1.00	1.00	1.00	\$34.78	\$34.78	Balsamo 2014 Trust 10-17-14
443 121 19 00	1.00	SFD	1.00	1.00	1.00	\$34.78	\$34.78	Morgan Family Trust 01-18-19
443 121 21 00	1.00	SFD	1.00	1.00	1.00	\$34.78	\$34.78	Lynn Family Trust 03-15-85
443 121 22 00	1.00	SFD	1.00	1.00	1.00	\$34.78	\$34.78	Wile Trust 11-02-88
443 210 01 00	1.00	SFD	1.00	1.00	1.00	\$34.78	\$34.78	Rees Gail K Irrevocable Trust 11-13-13
443 210 02 00	1.00	SFD	1.00	1.00	1.00	\$34.78	\$34.78	Foelschow James L
443 210 03 00	2.00	DUP	0.70	1.00	1.40	\$34.78	\$48.68	Romeo Bertha C Family Trust 01-01-01
443 210 04 00	1.00	SFD	1.00	1.00	1.00	\$34.78	\$34.78	Momsen Family Trust 09-22-93
443 210 05 00	1.00	SFD	1.00	1.00	1.00	\$34.78	\$34.78	Thrasher Craig&Mary
443 210 06 00	1.00	SFD	1.00	1.00	1.00	\$34.78	\$34.78	Bride Family Trust 09-03-99

EXHIBIT C - Assessment Roll (Fiscal Year 2021)
Mission Hills Historic Street Lighting Maintenance Assessment District

Parcel Number	Acres/ Units ⁽¹⁾	Land Use Code ⁽²⁾	Apportionment Factors		Total EBUs	Unit Cost (\$/Ebu)	FY 2021 ⁽⁴⁾ Assessment	Owner Name
			Land Use ⁽²⁾	Benefit ⁽³⁾				
443 210 07 00	1.00	SFD	1.00	1.00	1.00	\$34.78	\$34.78	Mosser Dana M Living Trust 03-19-96
443 210 08 00	1.00	SFD	1.00	1.00	1.00	\$34.78	\$34.78	Greenhood Joan Revocable Trust 01-31-08
443 210 09 00	1.00	SFD	1.00	1.00	1.00	\$34.78	\$34.78	Bush Michael J
443 210 10 00	1.00	SFD	1.00	1.00	1.00	\$34.78	\$34.78	Wells Survivors Family Trust 10-17-90
443 210 11 00	1.00	SFD	1.00	1.00	1.00	\$34.78	\$34.78	Fread James M Living Trust 06-19-09
443 210 12 00	1.00	SFD	1.00	1.00	1.00	\$34.78	\$34.78	Tweit Deborah L
443 210 13 00	1.00	SFD	1.00	1.00	1.00	\$34.78	\$34.78	Katz Family Trust 05-03-99
443 210 14 00	1.00	SFD	1.00	1.00	1.00	\$34.78	\$34.78	Palmer Sonya D Z
443 210 15 00	1.00	SFD	1.00	1.00	1.00	\$34.78	\$34.78	Phillips-Moriarty Family Trust 08-01-91
443 210 16 00	1.00	SFD	1.00	1.00	1.00	\$34.78	\$34.78	Boyer Family Trust 12-16-97
443 210 17 00	1.00	SFD	1.00	1.00	1.00	\$34.78	\$34.78	Butler Dennis M
443 210 18 00	1.00	SFD	1.00	1.00	1.00	\$34.78	\$34.78	Lombardo Domenic
443 210 19 00	1.00	SFD	1.00	1.00	1.00	\$34.78	\$34.78	Brennan Marybeth Trust 10-20-94
443 210 20 00	1.00	SFD	1.00	1.00	1.00	\$34.78	\$34.78	Ehlers Family 1986 Trust 08-28-86
443 210 21 00	1.00	SFD	1.00	1.00	1.00	\$34.78	\$34.78	Davis Family Trust 05-22-00
443 210 22 00	1.00	SFD	1.00	1.00	1.00	\$34.78	\$34.78	Lewis Andrew&Anna Family Trust 12-29-09
443 210 23 00	1.00	SFD	1.00	1.00	1.00	\$34.78	\$34.78	Pludow Beltz Trust 07-26-16
443 210 24 00	1.00	SFD	1.00	1.00	1.00	\$34.78	\$34.78	Golden Louisa A
443 210 25 00	1.00	SFD	1.00	1.00	1.00	\$34.78	\$34.78	Stewart Kimberly A M
443 210 26 00	1.00	SFD	1.00	1.00	1.00	\$34.78	\$34.78	Ellefson Janet I
443 210 27 00	1.00	SFD	1.00	1.00	1.00	\$34.78	\$34.78	Quinn Martha S
443 210 28 00	1.00	SFD	1.00	1.00	1.00	\$34.78	\$34.78	Bayer Family Trust 12-04-03
443 210 29 00	1.00	SFD	1.00	1.00	1.00	\$34.78	\$34.78	Dennenberg Family Trust 01-30-01
443 210 30 00	1.00	SFD	1.00	1.00	1.00	\$34.78	\$34.78	Milot Trust 03-23-10
443 210 31 00	1.00	SFD	1.00	1.00	1.00	\$34.78	\$34.78	Schag Family Trust 10-01-93
443 210 32 00	1.00	SFD	1.00	1.00	1.00	\$34.78	\$34.78	Tenorio Christopher&Anna
443 210 33 00	1.00	SFD	1.00	1.00	1.00	\$34.78	\$34.78	Decorso Living Trust 04-26-00
443 210 34 00	1.00	SFD	1.00	1.00	1.00	\$34.78	\$34.78	Kleinke Family Revocable Trust 03-15-96
443 210 35 00	1.00	SFD	1.00	1.00	1.00	\$34.78	\$34.78	Williams Lauren M D T 2014 Trust 05-28-14
443 210 36 00	1.00	SFD	1.00	1.00	1.00	\$34.78	\$34.78	Gomez&Amuedo-Dorantes Trust 08-29-06
443 210 37 00	1.00	SFD	1.00	1.00	1.00	\$34.78	\$34.78	Lambs J Trust 07-20-01
443 210 38 00	1.00	SFD	1.00	1.00	1.00	\$34.78	\$34.78	Trias Trust 05-05-05
443 210 39 00	1.00	SFD	1.00	1.00	1.00	\$34.78	\$34.78	Chacon-Lopez Quetzalsol F&Lopez Star C
443 210 40 00	1.00	SFD	1.00	1.00	1.00	\$34.78	\$34.78	Dunn Christine M
443 210 41 00	1.00	SFD	1.00	1.00	1.00	\$34.78	\$34.78	Brown Revocable Trust 12-06-05
443 210 42 00	1.00	SFD	1.00	1.00	1.00	\$34.78	\$34.78	Kurzendoerfer Kenneth W 2002 Trust 10-23-02
443 210 43 00	1.00	SFD	1.00	1.00	1.00	\$34.78	\$34.78	Roberts Revocable Trust 03-04-06
443 210 44 00	1.00	SFD	1.00	1.00	1.00	\$34.78	\$34.78	Niewiadomy Carol A Tr
443 210 45 00	1.00	SFD	1.00	1.00	1.00	\$34.78	\$34.78	Samson Family Trust 08-31-04
443 210 46 00	1.00	SFD	1.00	1.00	1.00	\$34.78	\$34.78	4270 Ampudia Llc
443 210 47 00	1.00	SFD	1.00	1.00	1.00	\$34.78	\$34.78	Almaguer Philip S
443 210 48 00	1.00	SFD	1.00	1.00	1.00	\$34.78	\$34.78	Leavenworth Decedents Trust 02-04-93
443 210 49 00	1.00	SFD	1.00	1.00	1.00	\$34.78	\$34.78	Watts Lou D Trust 11-22-16
443 210 50 00	1.00	SFD	1.00	1.00	1.00	\$34.78	\$34.78	Ingrande Marie L Separate Property Trust 01-25-12
443 210 51 00	1.00	SFD	1.00	1.00	1.00	\$34.78	\$34.78	Lyons Mary E 2001 Trust
443 210 52 00	1.00	SFD	1.00	1.00	1.00	\$34.78	\$34.78	Jovanovich Peter&Robin
443 210 53 00	1.00	SFD	1.00	1.00	1.00	\$34.78	\$34.78	Castro Ramon&Marian Trust 04-29-96
443 210 54 00	1.00	SFD	1.00	1.00	1.00	\$34.78	\$34.78	Krumholz Revocable Trust 10-06-08
443 210 55 00	1.00	SFD	1.00	1.00	1.00	\$34.78	\$34.78	Benedict George&Rainey D Family Trust 05-31-11
443 210 56 00	1.00	SFD	1.00	1.00	1.00	\$34.78	\$34.78	Tatari Tony&Gina

EXHIBIT C - Assessment Roll (Fiscal Year 2021)
Mission Hills Historic Street Lighting Maintenance Assessment District

Parcel Number	Acres/ Units ⁽¹⁾	Land Use Code ⁽²⁾	Apportionment Factors		Total EBUs	Unit Cost (\$/EUBU)	FY 2021 ⁽⁴⁾ Assessment	Owner Name
			Land Use ⁽²⁾	Benefit ⁽³⁾				
443 211 01 00	1.00	SFD	1.00	1.00	1.00	\$34.78	\$34.78	Brickson Family Revocable Living Trust 01-05-94
443 211 02 00	1.00	SFD	1.00	1.00	1.00	\$34.78	\$34.78	Hawkinson Howard W&Margaret M 1993 Trust 07-21-93
443 211 03 00	1.00	SFD	1.00	1.00	1.00	\$34.78	\$34.78	Mcginly Bonnie K Revocable Trust 12-05-96
443 211 04 00	1.00	SFD	1.00	1.00	1.00	\$34.78	\$34.78	Mills Family Trust 04-13-12
443 211 05 00	1.00	SFD	1.00	1.00	1.00	\$34.78	\$34.78	Roemer Mark P 2007 Trust 01-25-07
443 211 06 00	1.00	SFD	1.00	1.00	1.00	\$34.78	\$34.78	Pomella Jean Trust 01-03-94
443 211 07 00	1.00	SFD	1.00	1.00	1.00	\$34.78	\$34.78	J Lambs Trust 07-20-01
443 211 08 00	1.00	SFD	1.00	1.00	1.00	\$34.78	\$34.78	Hillyard Jason&Lang Michele R
443 211 09 00	1.00	SFD	1.00	1.00	1.00	\$34.78	\$34.78	Taylor Daniel L
443 211 10 00	1.00	SFD	1.00	1.00	1.00	\$34.78	\$34.78	Mcguffey Family Trust 12-08-16
443 211 11 00	1.00	SFD	1.00	1.00	1.00	\$34.78	\$34.78	Stumpf Joan M -Aka Stark Joan M->
443 211 12 00	1.00	SFD	1.00	1.00	1.00	\$34.78	\$34.78	Hill Francis U&Teresa C 1992 Trust 01-12-92
443 211 13 00	1.00	SFD	1.00	1.00	1.00	\$34.78	\$34.78	Williams Lauren M D T 2014 Trust 05-28-14
443 211 14 00	1.00	SFD	1.00	1.00	1.00	\$34.78	\$34.78	Mclean Kristi A
443 211 15 00	1.00	SFD	1.00	1.00	1.00	\$34.78	\$34.78	Silvia Stephanie&Anthony Revocable Trust 04-06-16
443 211 16 00	1.00	SFD	1.00	1.00	1.00	\$34.78	\$34.78	Cramp Daniella Trust 04-07-16
443 211 17 00	1.00	SFD	1.00	1.00	1.00	\$34.78	\$34.78	Celano Nicholas J&Katz Laura A
443 211 18 00	1.00	SFD	1.00	1.00	1.00	\$34.78	\$34.78	Madden Sandra Revocable Living Trust 04-12-19
443 211 19 00	1.00	SFD	1.00	1.00	1.00	\$34.78	\$34.78	Spurgin Living Trust 11-05-92
443 211 20 00	1.00	SFD	1.00	1.00	1.00	\$34.78	\$34.78	Stepner Family Trust 05-11-00
443 211 21 00	1.00	SFD	1.00	1.00	1.00	\$34.78	\$34.78	Veloz Adrian D&Nicole A S
443 211 22 00	1.00	SFD	1.00	1.00	1.00	\$34.78	\$34.78	Haubert Mary J
443 211 23 00	1.00	SFD	1.00	1.00	1.00	\$34.78	\$34.78	Reggev Family Trust 10-23-06
443 211 24 00	1.00	SFD	1.00	1.00	1.00	\$34.78	\$34.78	Burgunder Family Trust 02-10-04
443 211 25 00	1.00	SFD	1.00	1.00	1.00	\$34.78	\$34.78	Hicks Trinidad L Trust 04-12-96
443 211 26 00	1.00	SFD	1.00	1.00	1.00	\$34.78	\$34.78	Watson Family Trust 01-18-90
443 211 27 00	1.00	SFD	1.00	1.00	1.00	\$34.78	\$34.78	Shirakawa Alexandre A
443 211 28 00	1.00	SFD	1.00	1.00	1.00	\$34.78	\$34.78	Masterson Kanani Living Trust 12-21-18
443 211 29 00	1.00	SFD	1.00	1.00	1.00	\$34.78	\$34.78	Zajac John A
443 211 30 00	1.00	SFD	1.00	1.00	1.00	\$34.78	\$34.78	Oakes Charles C Trust 08-25-08
443 211 31 00	1.00	SFD	1.00	1.00	1.00	\$34.78	\$34.78	Townsend/Ward Trust 06-08-98
443 211 32 00	1.00	SFD	1.00	1.00	1.00	\$34.78	\$34.78	Gerace Larry R Trust 08-05-09
443 211 33 00	1.00	SFD	1.00	1.00	1.00	\$34.78	\$34.78	Norviel Vern&Annie
443 211 34 00	1.00	SFD	1.00	1.00	1.00	\$34.78	\$34.78	Feddersen Falk&Mariana O
443 211 35 00	1.00	SFD	1.00	1.00	1.00	\$34.78	\$34.78	Devlin Family Trust 04-03-06
443 211 36 00	1.00	SFD	1.00	1.00	1.00	\$34.78	\$34.78	Spillane Family Trust 07-30-12
443 211 37 00	1.00	SFD	1.00	1.00	1.00	\$34.78	\$34.78	Henson W R Family Trust 04-08-03
443 211 38 00	1.00	SFD	1.00	1.00	1.00	\$34.78	\$34.78	Hopkins Fonda Trust 11-01-03
443 211 39 00	1.00	SFD	1.00	1.00	1.00	\$34.78	\$34.78	Miceli Family Trust 03-06-15
443 211 40 00	1.00	SFD	1.00	1.00	1.00	\$34.78	\$34.78	Buscemi Trust 06-30-00
443 211 41 00	1.00	SFD	1.00	1.00	1.00	\$34.78	\$34.78	Franks Brett&Kepler Lisa
443 211 42 00	1.00	SFD	1.00	1.00	1.00	\$34.78	\$34.78	Banta Trust 11-06-02
443 211 43 00	1.00	SFD	1.00	1.00	1.00	\$34.78	\$34.78	Dutschmann Claudio A R&Rita M R
443 211 44 00	1.00	SFD	1.00	1.00	1.00	\$34.78	\$34.78	Grossheim Elmer R II Family Trust 02-07-19
443 211 45 00	1.00	SFD	1.00	1.00	1.00	\$34.78	\$34.78	Ewalt Living Trust 07-12-17
443 211 46 00	1.00	SFD	1.00	1.00	1.00	\$34.78	\$34.78	Lyon Community Property 1999 Trust 12-23-99
443 211 47 00	1.00	SFD	1.00	1.00	1.00	\$34.78	\$34.78	Crown Investment Group Inc
443 211 48 00	1.00	SFD	1.00	1.00	1.00	\$34.78	\$34.78	Morago-Flynn Trust A 06-29-99
443 211 49 00	1.00	SFD	1.00	1.00	1.00	\$34.78	\$34.78	Staab Kent J&Deena E Trust 07-06-95
443 211 50 00	1.00	SFD	1.00	1.00	1.00	\$34.78	\$34.78	Mcclintock Peter&Patricia

EXHIBIT C - Assessment Roll (Fiscal Year 2021)
Mission Hills Historic Street Lighting Maintenance Assessment District

Parcel Number	Acres/ Units ⁽¹⁾	Land Use Code ⁽²⁾	Apportionment Factors		Total EBUs	Unit Cost (\$/Ebu)	FY 2021 ⁽⁴⁾ Assessment	Owner Name
			Land Use ⁽²⁾	Benefit ⁽³⁾				
443 211 51 00	1.00	SFD	1.00	1.00	1.00	\$34.78	\$34.78	Lau Robert
443 211 52 00	1.00	SFD	1.00	1.00	1.00	\$34.78	\$34.78	Vermaas Eric H&Baltan Jessica J
443 211 53 00	1.00	SFD	1.00	1.00	1.00	\$34.78	\$34.78	Bowers Barbara J Family Trust 04-07-05
443 211 54 00	1.00	SFD	1.00	1.00	1.00	\$34.78	\$34.78	Mendoza Gerarde Trust 09-22-15
443 211 55 00	1.00	SFD	1.00	1.00	1.00	\$34.78	\$34.78	Snyder Trust 01-24-81
443 211 56 00	1.00	SFD	1.00	1.00	1.00	\$34.78	\$34.78	Twilegar Family Trust 11-06-07
443 211 57 00	1.00	SFD	1.00	1.00	1.00	\$34.78	\$34.78	Ljubovic Family Trust 08-15-18
443 211 58 00	1.00	SFD	1.00	1.00	1.00	\$34.78	\$34.78	Mcnew Michael R&Garcia Diana
443 211 59 00	1.00	SFD	1.00	1.00	1.00	\$34.78	\$34.78	Walter Family Trust 12-08-92
443 211 60 00	1.00	SFD	1.00	1.00	1.00	\$34.78	\$34.78	Wright Doris E Trust 12-30-98
443 211 61 00	1.00	SFD	1.00	1.00	1.00	\$34.78	\$34.78	Wilhelm James W Iii&Gibson Rebecca R
443 211 62 00	1.00	SFD	1.00	1.00	1.00	\$34.78	\$34.78	Dillon Margaret C Revocable Trust 11-19-98
443 211 63 00	1.00	SFD	1.00	1.00	1.00	\$34.78	\$34.78	Amundson Stanley A&Pamela C Trs
443 250 01 00	1.00	SFD	1.00	1.00	1.00	\$34.78	\$34.78	Reily Family Living 1998 Trust 09-26-98
443 250 02 00	1.00	SFD	1.00	1.00	1.00	\$34.78	\$34.78	Fletcher Family Revocable Trust 01-23-02
443 250 03 00	1.00	SFD	1.00	1.00	1.00	\$34.78	\$34.78	Frase Maria M
443 250 04 00	1.00	SFD	1.00	1.00	1.00	\$34.78	\$34.78	Gilman Rhett&Ashley
443 250 05 00	1.00	SFD	1.00	1.00	1.00	\$34.78	\$34.78	Sandel/Marich Trust 02-13-08
443 250 06 00	1.00	SFD	1.00	1.00	1.00	\$34.78	\$34.78	Ingrande Family Trust 04-06-16
443 250 07 00	1.00	SFD	1.00	1.00	1.00	\$34.78	\$34.78	Hager Barry E&Hilary A
443 250 08 00	1.00	SFD	1.00	1.00	1.00	\$34.78	\$34.78	Ruiz John D&Rozlynn A
443 250 09 00	1.00	SFD	1.00	1.00	1.00	\$34.78	\$34.78	Keeney Family Trust 05-10-03
443 250 10 00	1.00	SFD	1.00	1.00	1.00	\$34.78	\$34.78	Lasry-Snyder Trust 11-27-06
443 250 11 00	1.00	SFD	1.00	1.00	1.00	\$34.78	\$34.78	Nash Family Trust 07-20-04
443 250 12 00	1.00	SFD	1.00	1.00	1.00	\$34.78	\$34.78	Sharp Andrew&Harambillet Carine
443 250 13 00	1.00	SFD	1.00	1.00	1.00	\$34.78	\$34.78	Englert Paul Trust 11-16-95
443 250 14 00	1.00	SFD	1.00	1.00	1.00	\$34.78	\$34.78	Thompson Frederick H&Beverly J D
443 250 15 00	1.00	SFD	1.00	1.00	1.00	\$34.78	\$34.78	Schwab Richard&Kim
443 250 16 00	1.00	SFD	1.00	1.00	1.00	\$34.78	\$34.78	Chermak Michael D&Sandra L
443 250 17 00	1.00	SFD	1.00	1.00	1.00	\$34.78	\$34.78	Macleon Karen V Tr
443 250 18 00	1.00	SFD	1.00	1.00	1.00	\$34.78	\$34.78	Davies Darlene G
443 250 19 00	1.00	SFD	1.00	1.00	1.00	\$34.78	\$34.78	Haase Walter E Trust 01-10-03
443 250 20 00	1.00	SFD	1.00	1.00	1.00	\$34.78	\$34.78	Roetker Family Trust 12-09-05
443 250 21 00	1.00	SFD	1.00	1.00	1.00	\$34.78	\$34.78	Hughes Family Trust 11-05-89
443 250 22 00	1.00	SFD	1.00	1.00	1.00	\$34.78	\$34.78	Kellner Community Property Survivors Trust 10-19-0
443 250 23 00	1.00	SFD	1.00	1.00	1.00	\$34.78	\$34.78	Longstreth Family Trust 10-03-01
443 250 24 00	1.00	SFD	1.00	1.00	1.00	\$34.78	\$34.78	Flaherty James H Jr&Patricia A
443 250 25 00	1.00	SFD	1.00	1.00	1.00	\$34.78	\$34.78	Freer Family Trust 05-02-89
443 250 26 00	1.00	SFD	1.00	1.00	1.00	\$34.78	\$34.78	Mcgee Family Trust 02-28-00
443 250 27 00	1.00	SFD	1.00	1.00	1.00	\$34.78	\$34.78	Gonzales Freeman 2013 Family Trust 01-02-13
443 250 28 00	1.00	SFD	1.00	1.00	1.00	\$34.78	\$34.78	Backer Janet H Family Trust 04-01-93
443 250 29 00	1.00	SFD	1.00	1.00	1.00	\$34.78	\$34.78	Manse Tammy
443 250 30 00	1.00	SFD	1.00	1.00	1.00	\$34.78	\$34.78	Allen Helen
443 250 31 00	1.00	SFD	1.00	1.00	1.00	\$34.78	\$34.78	Wisehart Gary D&Elizabeth A
443 250 32 00	1.00	SFD	1.00	1.00	1.00	\$34.78	\$34.78	Conner Judith Trust 01-02-97
443 250 33 00	1.00	SFD	1.00	1.00	1.00	\$34.78	\$34.78	Lettington Drew T&Randie D
443 250 34 00	0.01	OSP	0.00	1.00	0.00	\$34.78	\$0.00	City Of San Diego
443 250 35 00	1.00	SFD	1.00	1.00	1.00	\$34.78	\$34.78	Fernandes Trust 05-14-15
443 250 36 00	1.00	SFD	1.00	1.00	1.00	\$34.78	\$34.78	Korb Duane P&Jean M
443 250 37 00	1.00	SFD	1.00	1.00	1.00	\$34.78	\$34.78	Becker Amy

EXHIBIT C - Assessment Roll (Fiscal Year 2021)
Mission Hills Historic Street Lighting Maintenance Assessment District

Parcel Number	Acres/ Units ⁽¹⁾	Land Use Code ⁽²⁾	Apportionment Factors		Total EBUs	Unit Cost (\$/Ebu)	FY 2021 ⁽⁴⁾ Assessment	Owner Name
			Land Use ⁽²⁾	Benefit ⁽³⁾				
443 250 38 00	1.00	SFD	1.00	1.00	1.00	\$34.78	\$34.78	Ratliffe Gene C&Tamara A
443 250 39 00	1.00	SFD	1.00	1.00	1.00	\$34.78	\$34.78	Claypool Family Living Trust 11-30-99
443 250 40 00	1.00	SFD	1.00	1.00	1.00	\$34.78	\$34.78	Kim Chris Donghyun&Jinyoung
443 250 41 00	1.00	SFD	1.00	1.00	1.00	\$34.78	\$34.78	Wustman Brandon A&Aujla Sandeep V
443 250 42 00	1.00	SFD	1.00	1.00	1.00	\$34.78	\$34.78	Parker George A&Lila V Joint Trust 05-31-91
443 250 43 00	1.00	SFD	1.00	1.00	1.00	\$34.78	\$34.78	Kaye Anitra L
443 250 44 00	1.00	SFD	1.00	1.00	1.00	\$34.78	\$34.78	Golden-King Family Trust 08-13-09
443 250 45 00	1.00	SFD	1.00	1.00	1.00	\$34.78	\$34.78	Gabhart-Lawrence Family Living Trust 05-15-16
443 250 46 00	1.00	SFD	1.00	1.00	1.00	\$34.78	\$34.78	Thompson Lori A
443 250 47 00	1.00	SFD	1.00	1.00	1.00	\$34.78	\$34.78	Neal-Compton Family Trust 04-21-04
443 250 48 00	1.00	SFD	1.00	1.00	1.00	\$34.78	\$34.78	Hoefer Andersen Family Trust 06-30-16
443 250 49 00	1.00	SFD	1.00	1.00	1.00	\$34.78	\$34.78	2123 Pine Street Llc
443 250 50 00	1.00	SFD	1.00	1.00	1.00	\$34.78	\$34.78	Aleksander Thomas&Valeeva Lilia
443 250 51 00	1.00	SFD	1.00	1.00	1.00	\$34.78	\$34.78	Giacalone Karla R Trust 04-23-03
443 250 52 00	1.00	SFD	1.00	1.00	1.00	\$34.78	\$34.78	Gomez Manuel Trust 09-11-15
443 250 53 00	1.00	SFD	1.00	1.00	1.00	\$34.78	\$34.78	Charles Lee Construction Group Llc
443 250 54 00	1.00	SFD	1.00	1.00	1.00	\$34.78	\$34.78	Vitas Christopher Trust 04-29-19
443 250 55 00	1.00	SFD	1.00	1.00	1.00	\$34.78	\$34.78	Maginn 2017 Trust 09-09-17
443 251 01 00	1.00	SFD	1.00	1.00	1.00	\$34.78	\$34.78	Arons Michael&Smitha
443 251 02 00	1.00	SFD	1.00	1.00	1.00	\$34.78	\$34.78	Reinagel Pamela Trust 09-22-10
443 251 03 00	1.00	SFD	1.00	1.00	1.00	\$34.78	\$34.78	Pulos Michael&Marquardt Stephen
443 251 04 00	1.00	SFD	1.00	1.00	1.00	\$34.78	\$34.78	Johnston Family Trust 09-26-94
443 251 05 00	1.00	SFD	1.00	1.00	1.00	\$34.78	\$34.78	Odoriso Bryan P Separate Property Trust 06-21-02
443 251 06 00	1.00	SFD	1.00	1.00	1.00	\$34.78	\$34.78	Evans Timothy Living Trust 01-28-19
443 251 07 00	1.00	SFD	1.00	1.00	1.00	\$34.78	\$34.78	Simonet Moses M Living Trust 06-10-12
443 251 08 00	1.00	SFD	1.00	1.00	1.00	\$34.78	\$34.78	Irani Family Trust 01-22-01
443 251 09 00	1.00	SFD	1.00	1.00	1.00	\$34.78	\$34.78	Johnston Scott L
443 251 10 00	1.00	SFD	1.00	1.00	1.00	\$34.78	\$34.78	Kelner Gregory Trust 03-10-04
443 251 11 00	1.00	SFD	1.00	1.00	1.00	\$34.78	\$34.78	Defrates Family Trust 03-02-05
443 251 12 00	1.00	SFD	1.00	1.00	1.00	\$34.78	\$34.78	Aries Barnard Trust 03-13-01
443 251 13 00	1.00	SFD	1.00	1.00	1.00	\$34.78	\$34.78	White Bill&Loretta Living Trust 09-20-02
443 251 14 00	1.00	SFD	1.00	1.00	1.00	\$34.78	\$34.78	Lidstrom Raymond L&Suzanne S Trust
443 251 15 00	1.00	SFD	1.00	1.00	1.00	\$34.78	\$34.78	Wilson Bruce A
443 251 16 00	1.00	SFD	1.00	1.00	1.00	\$34.78	\$34.78	Espinosa Family Trust 06-04-05
443 251 17 00	1.00	SFD	1.00	1.00	1.00	\$34.78	\$34.78	Mission Hills Methodist Church
443 251 18 00	1.00	SFD	1.00	1.00	1.00	\$34.78	\$34.78	Sevilla C D Family Trust 01-11-07
443 251 19 00	1.00	SFD	1.00	1.00	1.00	\$34.78	\$34.78	Reed Elizabeth M Trust 07-20-95
443 251 20 00	1.00	SFD	1.00	1.00	1.00	\$34.78	\$34.78	Galati Steven&Joanna
443 251 21 00	1.00	SFD	1.00	1.00	1.00	\$34.78	\$34.78	Bena Fisher Trust 05-27-15
443 251 22 00	1.00	SFD	1.00	1.00	1.00	\$34.78	\$34.78	Oconnor Family Trust (Trust B) 02-28-81
443 251 23 00	1.00	SFD	1.00	1.00	1.00	\$34.78	\$34.78	Lavine Family Trust 08-07-08
443 251 24 00	1.00	SFD	1.00	1.00	1.00	\$34.78	\$34.78	Egleson Christopher M&Sohoni Sharmila
443 251 25 00	1.00	SFD	1.00	1.00	1.00	\$34.78	\$34.78	Hagen Amy J
443 251 26 00	1.00	SFD	1.00	1.00	1.00	\$34.78	\$34.78	Waters David N
443 251 27 00	1.00	SFD	1.00	1.00	1.00	\$34.78	\$34.78	Rapp Michael O&Barbara
443 251 28 00	1.00	SFD	1.00	1.00	1.00	\$34.78	\$34.78	Torres Paul M&Kendra L
443 251 29 00	1.00	SFD	1.00	1.00	1.00	\$34.78	\$34.78	Amaya Family Trust 04-02-18
443 251 30 00	1.00	SFD	1.00	1.00	1.00	\$34.78	\$34.78	Kett Joseph P
443 251 31 00	1.00	SFD	1.00	1.00	1.00	\$34.78	\$34.78	Lansing William&Maria Trust 10-19-01
443 251 32 00	1.00	SFD	1.00	1.00	1.00	\$34.78	\$34.78	Swan House Llc

EXHIBIT C - Assessment Roll (Fiscal Year 2021)
Mission Hills Historic Street Lighting Maintenance Assessment District

Parcel Number	Acres/ Units ⁽¹⁾	Land Use Code ⁽²⁾	Apportionment Factors		Total EBUs	Unit Cost (\$/Ebu)	FY 2021 ⁽⁴⁾ Assessment	Owner Name
			Land Use ⁽²⁾	Benefit ⁽³⁾				
443 251 33 00	1.00	SFD	1.00	1.00	1.00	\$34.78	\$34.78	Schmieg-Watters Family Trust 11-30-11
443 251 34 00	1.00	SFD	1.00	1.00	1.00	\$34.78	\$34.78	Camin Marcos G&Russell Patricia L
443 251 35 00	1.00	SFD	1.00	1.00	1.00	\$34.78	\$34.78	Brown Angel
443 251 36 00	1.00	SFD	1.00	1.00	1.00	\$34.78	\$34.78	Blair Jeffrey R&Jane R
443 251 37 00	1.00	SFD	1.00	1.00	1.00	\$34.78	\$34.78	Cane Family Trust 11-23-10
443 270 01 00	1.00	SFD	1.00	1.00	1.00	\$34.78	\$34.78	Zaharopoulos Pat Trust 04-19-93
443 270 02 00	1.00	SFD	1.00	1.00	1.00	\$34.78	\$34.78	Wahlen Patricia P Trust 01-03-06
443 270 23 00	0.20	COM	40.00	0.60	4.80	\$34.78	\$166.94	Porras Revocable Family Bypass Trust 09-18-90
443 270 24 00	0.00	SFD	1.00	1.00	0.00	\$34.78	\$0.00	Porras Revocable Family Survivors Trust 09-18-90
443 340 01 00	1.00	SFD	1.00	1.00	1.00	\$34.78	\$34.78	Rattner Matthew H Trust 07-15-05
443 340 02 00	1.00	SFD	1.00	1.00	1.00	\$34.78	\$34.78	Speas Dennis W&Shelby L
443 340 03 00	1.00	SFD	1.00	1.00	1.00	\$34.78	\$34.78	Mcloughlin Revocable Family Trust 09-17-90
443 340 04 00	1.00	SFD	1.00	1.00	1.00	\$34.78	\$34.78	Hahn Chiriboga Family Trust 05-18-01
443 340 05 00	1.00	SFD	1.00	1.00	1.00	\$34.78	\$34.78	Bergener Brandon P&Danielle E
443 340 06 00	1.00	SFD	1.00	1.00	1.00	\$34.78	\$34.78	Papano/Daum Papano Family Trust
443 340 07 00	1.00	SFD	1.00	1.00	1.00	\$34.78	\$34.78	Pulido Alberto&Spencer Irene Living Trust 02-02-18
443 340 08 00	1.00	SFD	1.00	1.00	1.00	\$34.78	\$34.78	Congregation Of The Sisters Of Charity Of The Inca
443 340 09 00	1.00	SFD	1.00	1.00	1.00	\$34.78	\$34.78	Roberts Joseph M&Ashley G
443 340 10 00	1.00	SFD	1.00	1.00	1.00	\$34.78	\$34.78	Limber Jill E Revocable Trust 05-31-16
443 340 11 00	1.00	SFD	1.00	1.00	1.00	\$34.78	\$34.78	David-Dimarino Revocable Trust 03-06-08
443 340 12 00	1.00	SFD	1.00	1.00	1.00	\$34.78	\$34.78	Dorsey Hideko Trust 01-10-86
443 340 13 00	1.00	SFD	1.00	1.00	1.00	\$34.78	\$34.78	Wallen Farrelly Trust 12-12-12
443 340 14 00	1.00	SFD	1.00	1.00	1.00	\$34.78	\$34.78	Kenna Bernie&Jiraporn
443 340 15 00	1.00	SFD	1.00	1.00	1.00	\$34.78	\$34.78	St Clair Peter&Raydene Living Trust 05-27-10
443 340 16 00	1.00	SFD	1.00	1.00	1.00	\$34.78	\$34.78	Delavega Family Trust 08-05-03
443 340 17 00	1.00	SFD	1.00	1.00	1.00	\$34.78	\$34.78	Pihas Yannis&Denise
443 340 18 00	1.00	SFD	1.00	1.00	1.00	\$34.78	\$34.78	Augustine Barbara S Trust 03-03-92
443 340 19 00	1.00	SFD	1.00	1.00	1.00	\$34.78	\$34.78	Grohman Family Trust 09-23-09
443 340 20 00	1.00	SFD	1.00	1.00	1.00	\$34.78	\$34.78	Castiglione-Pollock Trust 12-03-12
443 340 21 00	1.00	SFD	1.00	1.00	1.00	\$34.78	\$34.78	Salloum Alexander
443 340 22 00	0.00	SFD	1.00	1.00	0.00	\$34.78	\$0.00	E M Trust 06-01-01
443 340 23 00	0.00	SFD	1.00	1.00	0.00	\$34.78	\$0.00	2Mg Trust 07-26-01
443 340 24 00	1.00	SFD	1.00	1.00	1.00	\$34.78	\$34.78	E M Trust 06-01-01
443 340 25 00	1.00	SFD	1.00	1.00	1.00	\$34.78	\$34.78	S D Pacific Holdings Llc
443 340 26 00	1.00	SFD	1.00	1.00	1.00	\$34.78	\$34.78	Plevin Fred M&Schoenberg Laura J Trust 09-05-96
443 370 02 00	1.00	SFD	1.00	1.00	1.00	\$34.78	\$34.78	Baker David L&Tracy B
443 370 03 00	1.00	SFD	1.00	1.00	1.00	\$34.78	\$34.78	Vanduyne William F
443 370 04 00	1.00	SFD	1.00	1.00	1.00	\$34.78	\$34.78	Engelhorn Katherine T Tr
443 370 05 00	1.00	SFD	1.00	1.00	1.00	\$34.78	\$34.78	Menczer Jesse
443 370 06 00	1.00	SFD	1.00	1.00	1.00	\$34.78	\$34.78	Hunt Family Trust B 05-30-90
443 370 09 00	1.00	SFD	1.00	1.00	1.00	\$34.78	\$34.78	Loftus/Fernando Trust 02-22-11
443 370 12 00	1.00	SFD	1.00	1.00	1.00	\$34.78	\$34.78	Gilpen Franklin M Revocable Living Trust 04-04-19
443 370 13 00	1.00	SFD	1.00	1.00	1.00	\$34.78	\$34.78	Slaman Norma
443 370 20 00	1.00	SFD	1.00	1.00	1.00	\$34.78	\$34.78	Kaufhold Marilyn J Family Trust 10-29-98
443 370 21 00	1.00	SFD	1.00	1.00	1.00	\$34.78	\$34.78	Anderson Lou Trust 11-06-03
443 370 22 00	1.00	SFD	1.00	1.00	1.00	\$34.78	\$34.78	Cain Family Trust 05-19-92
443 370 23 00	1.00	SFD	1.00	1.00	1.00	\$34.78	\$34.78	Bates Marilyn 2006 Trust 11-07-06
443 370 24 00	1.00	SFD	1.00	1.00	1.00	\$34.78	\$34.78	Welshans David A&Nora E
443 370 25 00	1.00	SFD	1.00	1.00	1.00	\$34.78	\$34.78	Chase Family Trust 07-21-00
443 370 26 00	1.00	SFD	1.00	1.00	1.00	\$34.78	\$34.78	Netzer Gregory

EXHIBIT C - Assessment Roll (Fiscal Year 2021)
Mission Hills Historic Street Lighting Maintenance Assessment District

Parcel Number	Acres/ Units ⁽¹⁾	Land Use Code ⁽²⁾	Apportionment Factors		Total EBUs	Unit Cost (\$/EUBU)	FY 2021 ⁽⁴⁾ Assessment	Owner Name
			Land Use ⁽²⁾	Benefit ⁽³⁾				
443 370 27 00	1.00	SFD	1.00	1.00	1.00	\$34.78	\$34.78	Lewin Family 2010 Trust 10-28-10
443 370 28 00	1.00	SFD	1.00	1.00	1.00	\$34.78	\$34.78	Lawson Family Trust 11-21-05
443 370 29 00	1.00	SFD	1.00	1.00	1.00	\$34.78	\$34.78	Adams Randolph P
443 370 30 00	2.00	DUP	0.70	1.00	1.40	\$34.78	\$48.68	Mitchell Arthur C
443 370 31 00	1.00	SFD	1.00	1.00	1.00	\$34.78	\$34.78	Lemke Family Trust 08-21-03
443 370 38 00	1.00	SFD	1.00	1.00	1.00	\$34.78	\$34.78	Seaburg Debra L Trust 06-27-95
443 370 39 00	1.00	SFD	1.00	1.00	1.00	\$34.78	\$34.78	Pekin 1992 Family Trust
443 370 40 00	1.00	SFD	1.00	1.00	1.00	\$34.78	\$34.78	Fuchs Jerry M&M Patrice
443 370 41 00	1.00	SFD	1.00	1.00	1.00	\$34.78	\$34.78	Claffy Kimberly Separate Property Trust 06-20-13
443 370 42 00	0.20	OSP	0.00	1.00	0.00	\$34.78	\$0.00	City Of San Diego
443 370 43 00	1.00	SFD	1.00	1.00	1.00	\$34.78	\$34.78	Mcdonald Eric C Revocable Trust No 1 12-03-98
443 370 44 00	1.00	SFD	1.00	1.00	1.00	\$34.78	\$34.78	Boles Darin J&Lawrence Sharon M
443 370 45 00	1.00	SFD	1.00	1.00	1.00	\$34.78	\$34.78	Lecount Alvin E II&Kate S
443 370 46 00	1.00	SFD	1.00	1.00	1.00	\$34.78	\$34.78	Parise Gregory D
443 370 47 00	1.00	SFD	1.00	1.00	1.00	\$34.78	\$34.78	Bowie Peter W&Sarah V Trs
443 370 48 00	1.00	SFD	1.00	1.00	1.00	\$34.78	\$34.78	Spelman Robert G
443 370 49 00	0.00	SFD	1.00	1.00	0.00	\$34.78	\$0.00	Spelman Robert G
443 370 50 00	1.00	SFD	1.00	1.00	1.00	\$34.78	\$34.78	Bushman Robert E Trust 01-09-02
443 370 51 00	1.00	SFD	1.00	1.00	1.00	\$34.78	\$34.78	Montgomery Family Trust 02-10-82
443 370 52 00	1.00	SFD	1.00	1.00	1.00	\$34.78	\$34.78	Moll Rodney L&Ann E Family Trust 11-19-96
443 370 53 00	1.00	SFD	1.00	1.00	1.00	\$34.78	\$34.78	Miller Leroy N&Suree G Trs
443 370 54 00	1.00	SFD	1.00	1.00	1.00	\$34.78	\$34.78	Luchner Karen L Trust 05-24-17
443 370 55 00	1.00	SFD	1.00	1.00	1.00	\$34.78	\$34.78	Hoefler Iii Family Trust 11-08-02
443 370 56 00	1.00	SFD	1.00	1.00	1.00	\$34.78	\$34.78	Hodges Helen J Revocable Living Trust 12-06-07
443 370 57 00	1.00	SFD	1.00	1.00	1.00	\$34.78	\$34.78	Heidemann Raymond L Trust 07-28-00
443 401 01 00	1.00	SFD	1.00	1.00	1.00	\$34.78	\$34.78	Thompson Family Trust 08-31-91
443 401 02 00	1.00	SFD	1.00	1.00	1.00	\$34.78	\$34.78	Phelps Family Trust 10-09-18
443 401 03 00	1.00	SFD	1.00	1.00	1.00	\$34.78	\$34.78	Saunders John A Revocable Living Trust
443 401 04 00	1.00	SFD	1.00	1.00	1.00	\$34.78	\$34.78	Breslauer Family Trust 07-06-95
443 401 05 00	1.00	SFD	1.00	1.00	1.00	\$34.78	\$34.78	Woods Revocable Family 2005 Trust 07-29-05
443 401 06 00	1.00	SFD	1.00	1.00	1.00	\$34.78	\$34.78	Schindles Bruce&Marie Trust 05-16-95
443 401 07 00	1.00	SFD	1.00	1.00	1.00	\$34.78	\$34.78	Gaffney Matthew&Stephanie
443 401 08 00	1.00	SFD	1.00	1.00	1.00	\$34.78	\$34.78	Bradshaw Mark Revocable 2012 Trust
443 401 09 00	1.00	SFD	1.00	1.00	1.00	\$34.78	\$34.78	Mithun Robin
443 401 10 00	1.00	SFD	1.00	1.00	1.00	\$34.78	\$34.78	Loeser Larry M
443 401 11 00	1.00	SFD	1.00	1.00	1.00	\$34.78	\$34.78	Preston Jeana M Revocable Trust 06-08-15
443 401 12 00	1.00	SFD	1.00	1.00	1.00	\$34.78	\$34.78	Harris Family Trust 08-26-96
443 401 13 00	1.00	SFD	1.00	1.00	1.00	\$34.78	\$34.78	Nilsen Victoria I M
443 401 14 00	2.00	DUP	0.70	1.00	1.40	\$34.78	\$48.68	Savellano Carolyn C
443 402 01 00	1.00	SFD	1.00	1.00	1.00	\$34.78	\$34.78	Stoike Jeffrey J Trust 12-02-13
443 402 02 00	1.00	SFD	1.00	1.00	1.00	\$34.78	\$34.78	Rabin Michael&Katherine
443 402 03 00	1.00	SFD	1.00	1.00	1.00	\$34.78	\$34.78	Worland Hugh A Trust 03-03-03
443 402 04 00	1.00	SFD	1.00	1.00	1.00	\$34.78	\$34.78	Levine Jerry&Karen J
443 402 05 00	1.00	SFD	1.00	1.00	1.00	\$34.78	\$34.78	Troeber Claudia
443 402 06 00	1.00	SFD	1.00	1.00	1.00	\$34.78	\$34.78	Valine Eric M&Bethann B
443 402 07 00	1.00	SFD	1.00	1.00	1.00	\$34.78	\$34.78	Dorsey Richard&Cheryl
443 402 08 00	1.00	SFD	1.00	1.00	1.00	\$34.78	\$34.78	Hillman Family Trust 06-17-91
443 402 09 00	1.00	SFD	1.00	1.00	1.00	\$34.78	\$34.78	Bradshaw John B
443 402 10 00	1.00	SFD	1.00	1.00	1.00	\$34.78	\$34.78	Schwarz Kathleen B Trust 11-23-94
443 402 11 00	1.00	SFD	1.00	1.00	1.00	\$34.78	\$34.78	Sanger Frank&Chelsea E

EXHIBIT C - Assessment Roll (Fiscal Year 2021)
Mission Hills Historic Street Lighting Maintenance Assessment District

Parcel Number	Acres/ Units ⁽¹⁾	Land Use Code ⁽²⁾	Apportionment Factors		Total EBUs	Unit Cost (\$/Ebu)	FY 2021 ⁽⁴⁾ Assessment	Owner Name
			Land Use ⁽²⁾	Benefit ⁽³⁾				
443 402 12 00	1.00	SFD	1.00	1.00	1.00	\$34.78	\$34.78	Schereschewsky Susan B Tr
443 402 13 00	1.00	SFD	1.00	1.00	1.00	\$34.78	\$34.78	Arensman Charles A&Gonzalez Socorro P
443 402 14 00	1.00	SFD	1.00	1.00	1.00	\$34.78	\$34.78	Repp Carmel Tr
443 402 15 00	1.00	SFD	1.00	1.00	1.00	\$34.78	\$34.78	Silveira Douglas S Family Trust 05-11-07
443 402 16 00	1.00	SFD	1.00	1.00	1.00	\$34.78	\$34.78	Gonzalez Kathleen Trust 07-24-13
443 402 17 00	1.00	SFD	1.00	1.00	1.00	\$34.78	\$34.78	Smith Family Trust 08-27-07
443 402 18 00	1.00	SFD	1.00	1.00	1.00	\$34.78	\$34.78	Jacobs Family Revocable Trust 06-02-98
443 402 19 00	1.00	SFD	1.00	1.00	1.00	\$34.78	\$34.78	Charmasson Henri&Marcia Family Trust 04-14-16
443 402 20 00	1.00	SFD	1.00	1.00	1.00	\$34.78	\$34.78	Benaroya Alan G Family Trust 09-01-05
443 402 21 00	1.00	SFD	1.00	1.00	1.00	\$34.78	\$34.78	Garcia Family Trust 3 02-28-12
443 402 22 00	1.00	SFD	1.00	1.00	1.00	\$34.78	\$34.78	Goltz Family Trust 05-21-96
443 402 23 00	1.00	SFD	1.00	1.00	1.00	\$34.78	\$34.78	Fitzgerald Family Trust 09-08-04
443 402 24 00	1.00	SFD	1.00	1.00	1.00	\$34.78	\$34.78	Wahl Geoff&Parker Barbara A Trs
443 402 25 00	1.00	SFD	1.00	1.00	1.00	\$34.78	\$34.78	Torcolini Joel C&Christine A
443 402 26 00	1.00	SFD	1.00	1.00	1.00	\$34.78	\$34.78	Zamost Barry G&Cynthia L Trs
443 402 27 00	2.00	DUP	0.70	1.00	1.40	\$34.78	\$48.68	Israel Family Trust 07-13-00
443 402 28 00	1.00	SFD	1.00	1.00	1.00	\$34.78	\$34.78	White Family Trust 12-04-09
443 402 29 00	1.00	SFD	1.00	1.00	1.00	\$34.78	\$34.78	Neumeyer Living Trust 07-15-09
443 421 01 00	1.00	SFD	1.00	1.00	1.00	\$34.78	\$34.78	Quinn Morgan
443 421 02 00	2.00	DUP	0.70	1.00	1.40	\$34.78	\$48.68	White Family Trust 08-23-94
443 421 03 00	2.00	DUP	0.70	1.00	1.40	\$34.78	\$48.68	Garrett Living Trust 03-29-19
443 421 04 00	1.00	SFD	1.00	1.00	1.00	\$34.78	\$34.78	Gora Albert&Eelen Family Trust 08-24-01
443 421 05 00	1.00	SFD	1.00	1.00	1.00	\$34.78	\$34.78	Quillin Family Trust
443 421 06 00	1.00	SFD	1.00	1.00	1.00	\$34.78	\$34.78	Dabbieri Family Trust 05-01-09
443 421 07 00	1.00	SFD	1.00	1.00	1.00	\$34.78	\$34.78	Stryker Family Trust 10-23-00
443 421 08 00	1.00	SFD	1.00	1.00	1.00	\$34.78	\$34.78	Peters Colin M&Celine C
443 421 09 00	1.00	SFD	1.00	1.00	1.00	\$34.78	\$34.78	Derkash Stephen C&Fiore Carola
443 421 10 00	1.00	SFD	1.00	1.00	1.00	\$34.78	\$34.78	Oswalt Barbara B Revocable Trust 12-29-92
443 421 11 00	1.00	SFD	1.00	1.00	1.00	\$34.78	\$34.78	Canepa Family Trust 04-03-14
443 421 12 00	1.00	SFD	1.00	1.00	1.00	\$34.78	\$34.78	Ruyle Family Revocable Trust 05-20-16
443 421 13 00	1.00	SFD	1.00	1.00	1.00	\$34.78	\$34.78	Kazmer Margaret M Tr
443 421 14 00	1.00	SFD	1.00	1.00	1.00	\$34.78	\$34.78	Watson Rosemary E Trust 11-13-14
443 421 15 00	1.00	SFD	1.00	1.00	1.00	\$34.78	\$34.78	Twenty-One October Trust 07-06-17
443 421 16 00	1.00	SFD	1.00	1.00	1.00	\$34.78	\$34.78	Crofton John&Denise Trust 09-28-11
443 421 17 00	1.00	SFD	1.00	1.00	1.00	\$34.78	\$34.78	Wallis Family Trust 12-06-17
443 421 18 00	1.00	SFD	1.00	1.00	1.00	\$34.78	\$34.78	Lee Wesley W 2002 Trust 06-19-02
443 421 19 00	1.00	SFD	1.00	1.00	1.00	\$34.78	\$34.78	Perilli Kenneth
443 421 20 00	1.00	SFD	1.00	1.00	1.00	\$34.78	\$34.78	Demers Family Trust 07-17-00
443 421 21 00	2.00	DUP	0.70	1.00	1.40	\$34.78	\$48.68	Britton Stuart D&Denise N F
443 421 22 00	1.00	SFD	1.00	1.00	1.00	\$34.78	\$34.78	Mangiameli Properties Llc
443 422 01 00	2.00	DUP	0.70	1.00	1.40	\$34.78	\$48.68	Pogue Lonnie&Pamela A
443 422 02 00	1.00	SFD	1.00	1.00	1.00	\$34.78	\$34.78	Riley Debra A Trust 06-14-16
443 422 03 00	1.00	SFD	1.00	1.00	1.00	\$34.78	\$34.78	Johnston Family Trust 09-26-94
443 422 04 00	1.00	SFD	1.00	1.00	1.00	\$34.78	\$34.78	Powers Timothy&Kristina
443 422 05 00	1.00	SFD	1.00	1.00	1.00	\$34.78	\$34.78	Dilligan Michael A Family Trust 09-24-99
443 422 06 00	1.00	SFD	1.00	1.00	1.00	\$34.78	\$34.78	Bowler Family Trust 07-17-19
443 422 07 00	1.00	SFD	1.00	1.00	1.00	\$34.78	\$34.78	Wilson Noah J Trust 10-21-19
443 422 08 00	1.00	SFD	1.00	1.00	1.00	\$34.78	\$34.78	Linea Ventures Llc
443 422 09 00	1.00	SFD	1.00	1.00	1.00	\$34.78	\$34.78	Young Family Trust 12-05-89
443 422 10 00	1.00	SFD	1.00	1.00	1.00	\$34.78	\$34.78	Tilden-Diamond Community Property Trust 08-02-16

EXHIBIT C - Assessment Roll (Fiscal Year 2021)
Mission Hills Historic Street Lighting Maintenance Assessment District

Parcel Number	Acres/ Units ⁽¹⁾	Land Use Code ⁽²⁾	Apportionment Factors		Total EBUs	Unit Cost (\$/Ebu)	FY 2021 ⁽⁴⁾ Assessment	Owner Name
			Land Use ⁽²⁾	Benefit ⁽³⁾				
443 422 11 00	1.00	SFD	1.00	1.00	1.00	\$34.78	\$34.78	Linea Ventures Llc
443 422 12 00	1.00	SFD	1.00	1.00	1.00	\$34.78	\$34.78	Grundy Family Trust 08-22-19
443 422 13 00	1.00	SFD	1.00	1.00	1.00	\$34.78	\$34.78	Peters Family Trust 02-09-18
443 422 14 00	1.00	SFD	1.00	1.00	1.00	\$34.78	\$34.78	Parker Robert C&Gail R Family Trust A 03-08-79
443 422 15 00	1.00	SFD	1.00	1.00	1.00	\$34.78	\$34.78	Cavanaugh Family Trust 08-07-14
443 422 16 00	1.00	SFD	1.00	1.00	1.00	\$34.78	\$34.78	Owens Robert A
443 422 17 00	1.00	SFD	1.00	1.00	1.00	\$34.78	\$34.78	Eisenberg Lydwin E
443 422 18 00	1.00	SFD	1.00	1.00	1.00	\$34.78	\$34.78	Snodgrass Family Community Property Trust 04-17-02
443 422 19 00	1.00	SFD	1.00	1.00	1.00	\$34.78	\$34.78	O K Trust 09-29-04
443 422 20 00	2.00	DUP	0.70	1.00	1.40	\$34.78	\$48.68	Sycamore Cass Investments Llc
443 422 21 00	1.00	SFD	1.00	1.00	1.00	\$34.78	\$34.78	Olafson Patricia Revocable Trust 12-23-03
443 422 22 00	1.00	SFD	1.00	1.00	1.00	\$34.78	\$34.78	Bibler Gerald J Trust 11-16-11
443 422 23 00	1.00	SFD	1.00	1.00	1.00	\$34.78	\$34.78	Macbean-Kelly Family Trust 06-07-17
443 431 01 00	1.00	SFD	1.00	1.00	1.00	\$34.78	\$34.78	Shurin Susan B Trust 02-17-16
443 431 02 00	1.00	SFD	1.00	1.00	1.00	\$34.78	\$34.78	Krimsky Robert C Trust 03-14-00
443 431 03 00	1.00	SFD	1.00	1.00	1.00	\$34.78	\$34.78	Brown Susan H 2002 Trust 12-02-02
443 431 05 00	1.00	SFD	1.00	1.00	1.00	\$34.78	\$34.78	Smith Kyle&Coleen
443 431 06 00	1.00	SFD	1.00	1.00	1.00	\$34.78	\$34.78	Clipson Family Trust 05-05-95
443 431 09 00	1.00	SFD	1.00	1.00	1.00	\$34.78	\$34.78	Lowenstein Family Trust 10-03-12
443 431 17 00	1.00	SFD	1.00	1.00	1.00	\$34.78	\$34.78	Rix Marc N&Jennifer S
443 431 18 00	1.00	SFD	1.00	1.00	1.00	\$34.78	\$34.78	Gonzalez Teresa Trust 08-15-07
443 431 19 00	1.00	SFD	1.00	1.00	1.00	\$34.78	\$34.78	Leschziner Andres&Reck-Peterson Samara
443 431 20 00	1.00	SFD	1.00	1.00	1.00	\$34.78	\$34.78	Persky William&Dorthea N Trust 1990
443 431 21 00	2.00	DUP	0.70	1.00	1.40	\$34.78	\$48.68	Ingrande Family Trust 01-22-01
443 432 01 00	1.00	SFD	1.00	1.00	1.00	\$34.78	\$34.78	Cerda Antonio Trust 06-01-99
443 432 02 00	1.00	SFD	1.00	1.00	1.00	\$34.78	\$34.78	Patkel Inc
443 432 03 00	1.00	SFD	1.00	1.00	1.00	\$34.78	\$34.78	Carter Christopher&Lauren 2012 Trust 11-21-12
443 432 04 00	1.00	MFR	0.70	1.00	0.70	\$34.78	\$24.34	Schwartz Valerie L Trust 09-18-90
443 432 04 00	1.00	SFD	1.00	1.00	1.00	\$34.78	\$34.78	Schwartz Valerie L Trust 09-18-90
443 432 05 00	1.00	SFD	1.00	1.00	1.00	\$34.78	\$34.78	Vanstee Peter&Marcy
443 432 06 00	1.00	SFD	1.00	1.00	1.00	\$34.78	\$34.78	Yaksh Family Trust 03-23-17
443 432 07 00	1.00	SFD	1.00	1.00	1.00	\$34.78	\$34.78	Carter Christopher W&Kline Deidre L
443 432 08 00	1.00	SFD	1.00	1.00	1.00	\$34.78	\$34.78	Johnson Family Trust 03-31-00
443 432 09 00	1.00	SFD	1.00	1.00	1.00	\$34.78	\$34.78	Murdock Susan A Trust 01-24-17
443 432 10 00	1.00	SFD	1.00	1.00	1.00	\$34.78	\$34.78	Lehr Terry V&Mary W
443 432 11 00	1.00	SFD	1.00	1.00	1.00	\$34.78	\$34.78	Nunez Maria E Trust 06-05-96
443 432 12 00	1.00	SFD	1.00	1.00	1.00	\$34.78	\$34.78	Brooks Family Trust 08-31-05
443 432 13 00	1.00	SFD	1.00	1.00	1.00	\$34.78	\$34.78	Johnson Susan R
443 432 14 00	1.00	SFD	1.00	1.00	1.00	\$34.78	\$34.78	Graham Lori
443 432 15 00	1.00	SFD	1.00	1.00	1.00	\$34.78	\$34.78	Wilcoxson Anna M Trust 11-14-18
443 432 16 00	1.00	SFD	1.00	1.00	1.00	\$34.78	\$34.78	Nares Family Trust 10-08-01
443 432 17 00	1.00	SFD	1.00	1.00	1.00	\$34.78	\$34.78	Ocio Nina&Rodolfo Family Trust 10-14-13
443 432 18 00	1.00	SFD	1.00	1.00	1.00	\$34.78	\$34.78	Hazard/Odea Living Trust 12-03-13
443 432 19 00	1.00	SFD	1.00	1.00	1.00	\$34.78	\$34.78	Preciado Clara Est Of
443 432 20 00	1.00	SFD	1.00	1.00	1.00	\$34.78	\$34.78	Altmann Marjorie P Revocable Trust 09-25-03
443 432 21 00	1.00	SFD	1.00	1.00	1.00	\$34.78	\$34.78	Stitt Revocable Family Trust 04-10-85
443 432 22 00	1.00	SFD	1.00	1.00	1.00	\$34.78	\$34.78	Sparks Robert H&Fitzmaurice Laurie J
443 432 23 00	1.00	SFD	1.00	1.00	1.00	\$34.78	\$34.78	Jannone Revocable Trust A 07-31-89
443 432 24 00	1.00	SFD	1.00	1.00	1.00	\$34.78	\$34.78	Neath Sean X
443 432 25 00	1.00	SFD	1.00	1.00	1.00	\$34.78	\$34.78	Davis Robert Decedents Trust 01-01-05

EXHIBIT C - Assessment Roll (Fiscal Year 2021)
Mission Hills Historic Street Lighting Maintenance Assessment District

Parcel Number	Acres/ Units ⁽¹⁾	Land Use Code ⁽²⁾	Apportionment Factors		Total EBUs	Unit Cost (\$/Ebu)	FY 2021 ⁽⁴⁾ Assessment	Owner Name
			Land Use ⁽²⁾	Benefit ⁽³⁾				
443 432 26 00	1.00	SFD	1.00	1.00	1.00	\$34.78	\$34.78	Scott Diane Trust 09-08-97
443 432 27 00	1.00	SFD	1.00	1.00	1.00	\$34.78	\$34.78	Sinkin-Antrim Living Trust 07-02-92
443 432 28 00	1.00	SFD	1.00	1.00	1.00	\$34.78	\$34.78	Moyer Adam R&Meredith
443 432 29 00	1.00	SFD	1.00	1.00	1.00	\$34.78	\$34.78	Johnson Mark&Jennifer Family Trust 10-11-18
443 432 30 00	1.00	SFD	1.00	1.00	1.00	\$34.78	\$34.78	Oconnor Richard D&Joan K
443 432 31 00	1.00	SFD	1.00	1.00	1.00	\$34.78	\$34.78	Hernandez Maria J
443 461 23 00	1.00	SFD	1.00	1.00	1.00	\$34.78	\$34.78	Bates Richard L&Nancy H
443 461 24 00	2.00	DUP	0.70	1.00	1.40	\$34.78	\$48.68	H C H Trust 07-25-97
443 462 01 00	1.00	SFD	1.00	1.00	1.00	\$34.78	\$34.78	Martinez Family Trust 11-08-99
443 520 16 00	1.00	SFD	1.00	1.00	1.00	\$34.78	\$34.78	Lowe Christopher Living Trust 04-07-11
443 520 17 00	1.00	SFD	1.00	1.00	1.00	\$34.78	\$34.78	Manecke Gerard R Jr&Kutner Lisa J
443 520 18 00	1.00	SFD	1.00	1.00	1.00	\$34.78	\$34.78	Casady Kent
443 520 21 00	1.00	SFD	1.00	1.00	1.00	\$34.78	\$34.78	Witherby Street Llc
443 520 22 00	1.00	SFD	1.00	1.00	1.00	\$34.78	\$34.78	Erreca Family Survivors 1985 Trust
443 520 23 00	1.00	SFD	1.00	1.00	1.00	\$34.78	\$34.78	Schwerdtfeger Sally 2010 Trust 06-17-10
443 520 24 00	1.00	SFD	1.00	1.00	1.00	\$34.78	\$34.78	Moll Rodney L&Ann E Family Trust 11-19-96
443 520 25 00	1.00	SFD	1.00	1.00	1.00	\$34.78	\$34.78	White Family Subtrust Cp 07-23-96
443 520 26 00	1.00	SFD	1.00	1.00	1.00	\$34.78	\$34.78	Yeilding Andrew C&Sarah D L
443 520 27 00	1.00	SFD	1.00	1.00	1.00	\$34.78	\$34.78	Mcadam Michael&Kelly S
443 520 28 00	1.00	SFD	1.00	1.00	1.00	\$34.78	\$34.78	Jessop George&Mary Family Bypass Trust 07-25-80
443 520 29 00	1.00	SFD	1.00	1.00	1.00	\$34.78	\$34.78	Seto Clifford M&Mona C
443 520 30 00	1.00	SFD	1.00	1.00	1.00	\$34.78	\$34.78	Tillman Robert F Tr
443 520 31 00	1.00	SFD	1.00	1.00	1.00	\$34.78	\$34.78	B O T S Family Trust 01-07-16
443 520 32 00	1.00	SFD	1.00	1.00	1.00	\$34.78	\$34.78	Janes Thomas C V&Jennifer I Community Property Tru
443 520 33 00	0.00	SFD	1.00	1.00	0.00	\$34.78	\$0.00	Spradling Gary J&Joy D Trs
443 520 34 00	1.00	SFD	1.00	1.00	1.00	\$34.78	\$34.78	Spradling Family Trust 12-24-96
443 520 36 00	1.00	SFD	1.00	1.00	1.00	\$34.78	\$34.78	Younan Family 2007 Trust 09-19-07
443 520 37 00	1.00	SFD	1.00	1.00	1.00	\$34.78	\$34.78	Balestrieri David A
443 520 38 00	1.00	SFD	1.00	1.00	1.00	\$34.78	\$34.78	Valleau Peter&Arlene
443 551 01 00	1.00	SFD	1.00	1.00	1.00	\$34.78	\$34.78	Segal Jonathan S&Wendy L
443 551 02 00	1.00	SFD	1.00	1.00	1.00	\$34.78	\$34.78	Mcardle T F&S R Family Trust 08-21-01
443 551 03 00	1.00	SFD	1.00	1.00	1.00	\$34.78	\$34.78	Schwartz Lloyd A 2008 Revocable Trust 10-20-08
443 551 04 00	1.00	SFD	1.00	1.00	1.00	\$34.78	\$34.78	Orwig A Family Trust 11-08-99
443 551 05 00	1.00	SFD	1.00	1.00	1.00	\$34.78	\$34.78	Fitz Family Trust 09-22-78
443 551 07 00	1.00	SFD	1.00	1.00	1.00	\$34.78	\$34.78	Wroe Family Trust 12-27-95
443 551 08 00	1.00	SFD	1.00	1.00	1.00	\$34.78	\$34.78	Wilson Richard C
443 551 09 00	1.00	SFD	1.00	1.00	1.00	\$34.78	\$34.78	Boyd Stephen&Kristin Family 2006 Trust 04-27-06
443 552 01 00	1.00	SFD	1.00	1.00	1.00	\$34.78	\$34.78	Smith Martin&Jennifer Living Trust 07-02-18
443 552 04 00	1.00	SFD	1.00	1.00	1.00	\$34.78	\$34.78	Little Daniel&Joyce Family Trust 04-02-93
443 552 05 00	1.00	SFD	1.00	1.00	1.00	\$34.78	\$34.78	Farres Oriol Family Trust 08-15-18
443 552 06 00	1.00	SFD	1.00	1.00	1.00	\$34.78	\$34.78	Poehlman/Huff Trust 02-10-93
443 552 07 00	1.00	SFD	1.00	1.00	1.00	\$34.78	\$34.78	Horne Keith J
443 552 08 00	1.00	SFD	1.00	1.00	1.00	\$34.78	\$34.78	Wallack Seth T
443 552 09 00	1.00	SFD	1.00	1.00	1.00	\$34.78	\$34.78	Alexander George&Larroque Lisa C
443 552 10 00	1.00	SFD	1.00	1.00	1.00	\$34.78	\$34.78	Paluch&Mehalek Family Trust 04-03-12
443 552 12 00	0.12	VAC	2.00	0.60	0.14	\$34.78	\$5.00	Justin Paul R&Stemwell Susan A
443 552 13 00	1.00	SFD	1.00	1.00	1.00	\$34.78	\$34.78	Barksdale W Malcolm&Naomi
443 552 14 00	1.00	SFD	1.00	1.00	1.00	\$34.78	\$34.78	Justin Paul R&Stemwell Susan A
443 561 01 00	1.00	SFD	1.00	1.00	1.00	\$34.78	\$34.78	Atkinson Hanley Trust 04-04-03
443 561 02 00	1.00	SFD	1.00	1.00	1.00	\$34.78	\$34.78	Lampe Scott A&Janette T

EXHIBIT C - Assessment Roll (Fiscal Year 2021)
Mission Hills Historic Street Lighting Maintenance Assessment District

Parcel Number	Acres/ Units ⁽¹⁾	Land Use Code ⁽²⁾	Apportionment Factors		Total EBUs	Unit Cost (\$/EUBU)	FY 2021 ⁽⁴⁾ Assessment	Owner Name
			Land Use ⁽²⁾	Benefit ⁽³⁾				
443 561 03 00	1.00	SFD	1.00	1.00	1.00	\$34.78	\$34.78	Gossard 2016 Family Trust 11-07-16
443 561 04 00	1.00	SFD	1.00	1.00	1.00	\$34.78	\$34.78	Squires Dale&Virginia Family Trust 11-21-13
443 561 05 00	1.00	SFD	1.00	1.00	1.00	\$34.78	\$34.78	Dean Family Trust 06-07-96
443 561 06 00	1.00	SFD	1.00	1.00	1.00	\$34.78	\$34.78	Ray Lynn&Hiroko Family Trust 07-17-01
443 562 03 00	1.00	SFD	1.00	1.00	1.00	\$34.78	\$34.78	Burgamy Kirk S&Mary S Revocable Trust
443 562 04 00	1.00	SFD	1.00	1.00	1.00	\$34.78	\$34.78	Montgrain Family Trust 08-15-07
443 562 08 00	1.00	SFD	1.00	1.00	1.00	\$34.78	\$34.78	Canedo Family Trust 11-13-89
443 562 09 00	1.00	SFD	1.00	1.00	1.00	\$34.78	\$34.78	Tortorelli James Tr (Dcsd)
443 562 10 00	1.00	SFD	1.00	1.00	1.00	\$34.78	\$34.78	Meyers Family Trust 05-01-15
443 562 11 00	1.00	SFD	1.00	1.00	1.00	\$34.78	\$34.78	Schneider Family Trust 04-20-01
443 562 12 00	1.00	SFD	1.00	1.00	1.00	\$34.78	\$34.78	Wallace Frank B Living Trust
443 562 13 00	1.00	SFD	1.00	1.00	1.00	\$34.78	\$34.78	Miller Louis&Semblantes Susana H
443 562 14 00	1.00	SFD	1.00	1.00	1.00	\$34.78	\$34.78	Dean Paul&Nelly Family Trust 05-17-80
443 563 01 00	1.00	SFD	1.00	1.00	1.00	\$34.78	\$34.78	Gillard Revocable Trust 05-03-05
443 563 02 00	1.00	SFD	1.00	1.00	1.00	\$34.78	\$34.78	Tuteur Jennifer M Trust 09-16-09
443 563 03 00	1.00	SFD	1.00	1.00	1.00	\$34.78	\$34.78	Marks Marjorie E Revocable Trust 05-28-02
443 563 04 00	1.00	SFD	1.00	1.00	1.00	\$34.78	\$34.78	Ingrande Family Trust 01-22-01
443 563 05 00	1.00	SFD	1.00	1.00	1.00	\$34.78	\$34.78	Woldt Revocable Trust 12-08-86
443 563 06 00	1.00	SFD	1.00	1.00	1.00	\$34.78	\$34.78	Hernholm Family Trust 09-09-01
443 563 07 00	1.00	SFD	1.00	1.00	1.00	\$34.78	\$34.78	Augustine Barbara S Trust 03-03-92
443 563 08 00	1.00	SFD	1.00	1.00	1.00	\$34.78	\$34.78	Dittamore Community Property Trust 08-31-16
443 563 09 00	1.00	SFD	1.00	1.00	1.00	\$34.78	\$34.78	Johnson Scott R
443 563 10 00	1.00	SFD	1.00	1.00	1.00	\$34.78	\$34.78	Hsu Victor&Alison Shirinne
443 570 03 00	1.00	SFD	1.00	1.00	1.00	\$34.78	\$34.78	Coates Suzanne B Trust 02-19-03
443 570 04 00	1.00	SFD	1.00	1.00	1.00	\$34.78	\$34.78	Clint Daniel T&Debbie L
443 570 05 00	1.00	SFD	1.00	1.00	1.00	\$34.78	\$34.78	Weber Michael W
443 570 06 00	1.00	SFD	1.00	1.00	1.00	\$34.78	\$34.78	Kerwin Patrick L
443 570 07 00	1.00	SFD	1.00	1.00	1.00	\$34.78	\$34.78	Nelson Mark&Tess Trust 05-23-19
443 570 08 00	1.00	SFD	1.00	1.00	1.00	\$34.78	\$34.78	Osborne Linda 2015 Revocable Living Trust 09-03-15
443 570 09 00	1.00	SFD	1.00	1.00	1.00	\$34.78	\$34.78	Gimber Douglas&Norma Trust 03-28-17
443 570 10 00	1.00	SFD	1.00	1.00	1.00	\$34.78	\$34.78	Lakin Charles M
443 570 11 00	1.00	SFD	1.00	1.00	1.00	\$34.78	\$34.78	Folkman Albert&Gladys Trust 03-28-72
443 570 12 00	1.00	SFD	1.00	1.00	1.00	\$34.78	\$34.78	Ntambakwa Eric&Bitta
443 580 01 00	2.00	DUP	0.70	1.00	1.40	\$34.78	\$48.68	Paul Family Trust 04-13-16
443 580 02 00	1.00	SFD	1.00	1.00	1.00	\$34.78	\$34.78	Fick-Nguyen Family Trust 05-12-16
443 580 03 00	1.00	SFD	1.00	1.00	1.00	\$34.78	\$34.78	Elliott Corey&Andrea Revocable Trust 10-04-19
443 580 04 00	1.00	SFD	1.00	1.00	1.00	\$34.78	\$34.78	Urso/Montgomery Family Trust 05-13-15
443 580 07 00	1.00	SFD	1.00	1.00	1.00	\$34.78	\$34.78	Miller Family Survivors Trust 05-10-90
443 580 08 00	1.00	SFD	1.00	1.00	1.00	\$34.78	\$34.78	Benrubi Gabriel M&Kine
443 591 01 00	1.00	SFD	1.00	1.00	1.00	\$34.78	\$34.78	Mccoll Family Trust 05-25-18
443 591 02 00	1.00	SFD	1.00	1.00	1.00	\$34.78	\$34.78	Harms Family Trust 11-15-19
443 602 01 00	1.00	SFD	1.00	1.00	1.00	\$34.78	\$34.78	L L H Amez Llc
443 602 02 00	1.00	SFD	1.00	1.00	1.00	\$34.78	\$34.78	Sellgren Miriam W Living Trust 02-09-07
443 602 04 00	1.00	SFD	1.00	1.00	1.00	\$34.78	\$34.78	Cage James W&Dori J N Family Trust 10-28-96
443 611 01 00	1.00	SFD	1.00	1.00	1.00	\$34.78	\$34.78	Duckham James P&Sharon K
443 611 02 00	1.00	SFD	1.00	1.00	1.00	\$34.78	\$34.78	Brock Rick K
443 611 03 00	1.00	SFD	1.00	1.00	1.00	\$34.78	\$34.78	Vonbehren Jeffrey B&Alpert Alison D
443 611 04 00	1.00	SFD	1.00	1.00	1.00	\$34.78	\$34.78	Light Robin S
443 611 05 00	1.00	SFD	1.00	1.00	1.00	\$34.78	\$34.78	J A A M B R W Family Trust
443 611 06 00	1.00	SFD	1.00	1.00	1.00	\$34.78	\$34.78	Telle Todd R&Law Douglas M

EXHIBIT C - Assessment Roll (Fiscal Year 2021)
Mission Hills Historic Street Lighting Maintenance Assessment District

Parcel Number	Acres/ Units ⁽¹⁾	Land Use Code ⁽²⁾	Apportionment Factors		Total EBUs	Unit Cost (\$/EUBU)	FY 2021 ⁽⁴⁾ Assessment	Owner Name
			Land Use ⁽²⁾	Benefit ⁽³⁾				
443 611 07 00	1.00	SFD	1.00	1.00	1.00	\$34.78	\$34.78	Halpern Phillip&Marcia Trust 04-20-99
443 611 08 00	1.00	SFD	1.00	1.00	1.00	\$34.78	\$34.78	Mcgregor George B&Chambard Abby L
443 611 09 00	1.00	SFD	1.00	1.00	1.00	\$34.78	\$34.78	Sparta Family Trust 06-15-05
443 611 10 00	1.00	SFD	1.00	1.00	1.00	\$34.78	\$34.78	Lesser Living Trust 07-16-09
443 611 11 00	1.00	SFD	1.00	1.00	1.00	\$34.78	\$34.78	Omens Eddie&Mary J Trust 10-29-09
443 611 12 00	1.00	SFD	1.00	1.00	1.00	\$34.78	\$34.78	Zollman Ron S&Joellyn W
443 650 12 00	1.00	SFD	1.00	1.00	1.00	\$34.78	\$34.78	Turner William D&Muhstein Carolyn A
443 650 13 00	1.00	SFD	1.00	1.00	1.00	\$34.78	\$34.78	Yackly Charles W&Salt Kelly J
443 650 14 00	1.00	SFD	1.00	1.00	1.00	\$34.78	\$34.78	Herman Family Trust 12-17-11
443 751 09 00	1.00	SFD	1.00	1.00	1.00	\$34.78	\$34.78	Weeks Daniel Family Trust 08-31-15
443 751 10 00	1.00	SFD	1.00	1.00	1.00	\$34.78	\$34.78	Milford Paula A
443 751 11 00	1.00	SFD	1.00	1.00	1.00	\$34.78	\$34.78	Hood Mark&Cooney Sharon
443 751 12 00	1.00	SFD	1.00	1.00	1.00	\$34.78	\$34.78	Castagnola Peter A Tr
443 751 13 00	1.00	SFD	1.00	1.00	1.00	\$34.78	\$34.78	Owens Barbara J Tr
443 752 01 00	1.00	SFD	1.00	1.00	1.00	\$34.78	\$34.78	Dacquisto Family Trust 03-08-04
443 752 02 00	1.00	SFD	1.00	1.00	1.00	\$34.78	\$34.78	Daleo Joseph P&Joanne R Revocable Inter Vivos Trus
443 752 03 00	1.00	SFD	1.00	1.00	1.00	\$34.78	\$34.78	Pardo Francisco S
443 761 01 00	1.00	SFD	1.00	1.00	1.00	\$34.78	\$34.78	Cross Tina L
443 761 02 00	1.00	SFD	1.00	1.00	1.00	\$34.78	\$34.78	Andrews Family Trust 06-09-04
443 762 03 00	1.00	SFD	1.00	1.00	1.00	\$34.78	\$34.78	Altomare Phyllis M 1990 Trust 11-27-90
443 762 04 00	1.00	SFD	1.00	1.00	1.00	\$34.78	\$34.78	Fleming Dale T 2017 Revocable Trust 07-28-17
443 762 05 00	1.00	SFD	1.00	1.00	1.00	\$34.78	\$34.78	Sandmeyer Revocable Trust 03-13-91
443 762 07 00	1.00	SFD	1.00	1.00	1.00	\$34.78	\$34.78	Tomlin Family Trust 06-01-99
443 763 01 00	1.00	SFD	1.00	1.00	1.00	\$34.78	\$34.78	Yoshida Amanda
443 763 02 00	1.00	SFD	1.00	1.00	1.00	\$34.78	\$34.78	Vivoli Michael W
443 763 03 00	2.00	DUP	0.70	1.00	1.40	\$34.78	\$48.68	Sheppard Leslie Revocable Trust 09-25-95
443 763 04 00	1.00	SFD	1.00	1.00	1.00	\$34.78	\$34.78	Zolezzi Jack Trust 10-28-98
443 763 05 00	1.00	SFD	1.00	1.00	1.00	\$34.78	\$34.78	Tomlin Family Trust 06-01-99
443 763 06 00	1.00	SFD	1.00	1.00	1.00	\$34.78	\$34.78	Sheppard Doris Revocable Living 1995 Trust 09-25-9
443 763 07 00	0.00	SFD	1.00	1.00	0.00	\$34.78	\$0.00	Smaha John&Susan
443 763 08 00	2.00	DUP	0.70	1.00	1.40	\$34.78	\$48.68	Smaha John&Susan
443 763 09 00	1.00	SFD	1.00	1.00	1.00	\$34.78	\$34.78	Spector Trust 09-21-07
443 763 10 00	1.00	SFD	1.00	1.00	1.00	\$34.78	\$34.78	Kelley Family Trust 02-12-08
443 763 11 00	1.00	SFD	1.00	1.00	1.00	\$34.78	\$34.78	Jennings Wayne D&Constance B
443 763 13 00	0.00	SFD	1.00	1.00	0.00	\$34.78	\$0.00	Yoshida Amanda
443 763 14 00	1.00	SFD	1.00	1.00	1.00	\$34.78	\$34.78	Arroyo/Rinaldi Trust 11-09-09
443 771 01 00	1.00	SFD	1.00	1.00	1.00	\$34.78	\$34.78	Bignell Terri Trust 10-07-96
443 771 02 00	1.00	SFD	1.00	1.00	1.00	\$34.78	\$34.78	3928 Bandini Trust 04-11-12
443 771 03 00	1.00	SFD	1.00	1.00	1.00	\$34.78	\$34.78	Crivello Vincent&Rose M
443 771 04 00	1.00	SFD	1.00	1.00	1.00	\$34.78	\$34.78	Glazener Family Trust A 08-08-63
443 771 05 00	1.00	SFD	1.00	1.00	1.00	\$34.78	\$34.78	Porter Luann M Trust 12-20-99
443 771 06 00	1.00	SFD	1.00	1.00	1.00	\$34.78	\$34.78	Ziering Robert W&Barbara K
443 771 07 00	1.00	SFD	1.00	1.00	1.00	\$34.78	\$34.78	Patterson Debra M Living Trust 04-30-10
443 772 05 00	1.00	SFD	1.00	1.00	1.00	\$34.78	\$34.78	Levine Family Trust 07-13-11
443 772 06 00	1.00	SFD	1.00	1.00	1.00	\$34.78	\$34.78	Ruffin Salima
443 772 07 00	1.00	SFD	1.00	1.00	1.00	\$34.78	\$34.78	Greene Jonathan D&Gail K
443 772 08 00	1.00	SFD	1.00	1.00	1.00	\$34.78	\$34.78	Castagnola Domenico Trust 03-08-94
443 781 01 00	1.00	SFD	1.00	1.00	1.00	\$34.78	\$34.78	Lestrange John H Jr&Florence M Trs
443 781 02 00	1.00	SFD	1.00	1.00	1.00	\$34.78	\$34.78	Arthur Family 2001 Trust 01-03-01
443 782 01 00	1.00	SFD	1.00	1.00	1.00	\$34.78	\$34.78	Reed Carmen Trust 06-13-12

EXHIBIT C - Assessment Roll (Fiscal Year 2021)
Mission Hills Historic Street Lighting Maintenance Assessment District

Parcel Number	Acres/ Units ⁽¹⁾	Land Use Code ⁽²⁾	Apportionment Factors		Total EBUs	Unit Cost (\$/EUBU)	FY 2021 ⁽⁴⁾ Assessment	Owner Name
			Land Use ⁽²⁾	Benefit ⁽³⁾				
443 782 02 00	1.00	SFD	1.00	1.00	1.00	\$34.78	\$34.78	Marks Richard A Revocable Trust
443 782 03 00	1.00	SFD	1.00	1.00	1.00	\$34.78	\$34.78	Haddad Benjamin A&Ann M Family Trust 06-27-07
443 783 01 00	1.00	SFD	1.00	1.00	1.00	\$34.78	\$34.78	Matton Clermont P&Stern Alicia
443 783 02 00	1.00	SFD	1.00	1.00	1.00	\$34.78	\$34.78	Keflezighi Mebrahtom&Asgedom Yordanos
443 783 03 00	1.00	SFD	1.00	1.00	1.00	\$34.78	\$34.78	Ventura Family Trust 08-16-88
443 783 04 00	1.00	SFD	1.00	1.00	1.00	\$34.78	\$34.78	Smith Jeffrey L
443 783 05 00	1.00	SFD	1.00	1.00	1.00	\$34.78	\$34.78	Davenport William&Beth Revocable Trust 02-10-16
443 783 06 00	1.00	SFD	1.00	1.00	1.00	\$34.78	\$34.78	Powell Merritte
443 783 07 00	1.00	SFD	1.00	1.00	1.00	\$34.78	\$34.78	Addleson Lawrence M&Carolyn
443 783 08 00	1.00	SFD	1.00	1.00	1.00	\$34.78	\$34.78	Holcomb Phillip J&Mdgley Katherine J
443 784 01 00	1.00	SFD	1.00	1.00	1.00	\$34.78	\$34.78	Kovach Kimberly R Trust 05-05-16
443 784 02 00	1.00	SFD	1.00	1.00	1.00	\$34.78	\$34.78	Strauss Diana L Family Trust 06-08-01
443 784 03 00	1.00	SFD	1.00	1.00	1.00	\$34.78	\$34.78	Cain Family Trust 06-26-12
443 784 04 00	1.00	SFD	1.00	1.00	1.00	\$34.78	\$34.78	Farres Bryan A Trust 05-13-08
443 791 01 00	1.00	SFD	1.00	1.00	1.00	\$34.78	\$34.78	Oriol Gil&Farres Michele R
443 791 02 00	1.00	SFD	1.00	1.00	1.00	\$34.78	\$34.78	Mcmeizer Trust 02-07-19
443 792 01 00	1.00	SFD	1.00	1.00	1.00	\$34.78	\$34.78	Vanarsdale Janet C D
443 792 02 00	1.00	SFD	1.00	1.00	1.00	\$34.78	\$34.78	Clay Family Trust 03-04-91
443 792 03 00	1.00	SFD	1.00	1.00	1.00	\$34.78	\$34.78	Ciceric Richard S&Maria E Family Trust 12-29-87
443 792 04 00	1.00	SFD	1.00	1.00	1.00	\$34.78	\$34.78	Helton William&Joan 2000 Trust 12-20-00
443 792 05 00	1.00	SFD	1.00	1.00	1.00	\$34.78	\$34.78	Dalfio Salvatore A&Alice I Trust 01-23-95
443 792 08 00	1.00	SFD	1.00	1.00	1.00	\$34.78	\$34.78	Friedman Lawrence Trust 04-16-01
443 792 10 00	1.00	SFD	1.00	1.00	1.00	\$34.78	\$34.78	Scott Robert Tr&Scott Barbara A Tr
443 792 11 00	1.00	SFD	1.00	1.00	1.00	\$34.78	\$34.78	Noah Mark R Jr Trust 06-17-11
443 792 14 00	1.00	SFD	1.00	1.00	1.00	\$34.78	\$34.78	Contin Robert P Trust 02-14-17
443 792 16 00	1.00	SFD	1.00	1.00	1.00	\$34.78	\$34.78	Wendt Ervin F Tr

TOTAL	-	-	-	-	719.24	-	\$25,015	
--------------	---	---	---	---	---------------	---	-----------------	--

- ⁽¹⁾ Applicable units (acres or dwelling units) dependent upon Land Use Code.
- ⁽²⁾ Refer to Engineer's Report for description of Land Use Codes and applicable Land Use Factor.
- ⁽³⁾ Refer to Engineer's Report for applicable Benefit Factors.
- ⁽⁴⁾ FY 2021 is the City's Fiscal Year 2021, which begins July 1, 2020 and ends June 30, 2021.