

PROPOSED PIPE DATA TABLE

NO.	Δ/BEARING	RADIUS	LENGTH	REMARKS
1	50° 30' 49\"/>			

COORDINATE TABLE

NO.	NORTHING	EASTING	DESCRIPTION
6222	1850882.97	6291304.86	∩ INTERSECTION
6223	1850942.72	6291305.37	∩ INTERSECTION
6224	1850545.37	6291301.32	16\"/>

NOTE:  
3' MINIMUM COVER  
TO TOP OF PIPE

SCALE  
1\"/>

CAUTION: LOCATION AND ELEVATION OF EXISTING UNDERGROUND UTILITY LINES ARE APPROXIMATE AS SHOWN. CONTRACTOR SHALL VERIFY EXACT LOCATION AND ELEVATIONS PRIOR TO CONSTRUCTION AND NOTIFY ENGINEER OF ANY CONFLICTS.

NOTE: THERE IS NEWLY CONSTRUCTED SIDEWALK, CURB, & GUTTER, DRIVEWAYS AND PED RAMPS ON RAY ST. FROM DWIGHT ST. TO MYRTLE AV. CONTRACTOR IS TO REPLACE IN KIND IF THERE IS ANY DAMAGE, TO THE SATISFACTION OF THE PROJECT MANAGER.

REFERENCE:  
BENCH MARK: NEBP PALM ST. & 32ND ST. ELEV. 310.07  
FIELD NOTES: RAMETTA, 206-1728, 9 MAY 94 W.O. 172891, 17 SHEETS  
WATER: 14838-5-D, 5762-L, 6426-L, 7669-W  
SEWER: 18664-4-D  
STORM DRAIN: N/A  
GAS: 11/259, 11/260  
ELECTRIC: 210-1729.5  
CABLE TV: COX 210-1728 (OVHD)  
TELEPHONE: 182011  
IMPROVEMENTS: 984-L, 984-I-L  
WATER FIELD BOOK: H-195  
SEWER FIELD BOOK: H-195  
100' SCALE: 210-1725  
THOMAS BROS.: 1269-E6  
HGL: 536

NOTE: EXISTING SERVICES ARE CONNECTED TO 30\"/>

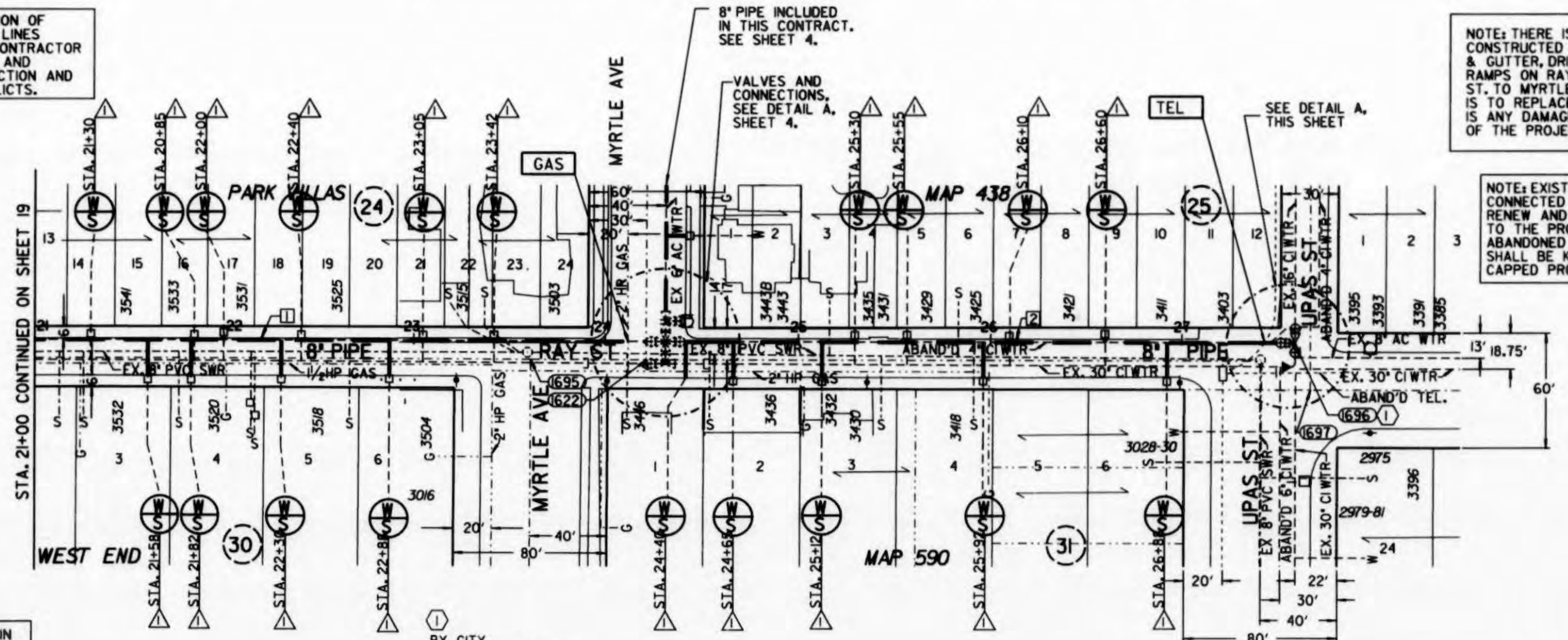

NOTE: ABANDONED 4\"/>

BY CITY  
STA. 27+58.68:  
INSTALL:  
1 - 16\"/>

RETIREMENTS:  
NONE

WATER AND SEWER GROUP 520			
RAY STREET - 8\"/>			
CITY OF SAN DIEGO, CALIFORNIA		WATER S.A. 182631	
ENGINEERING AND CAPITAL PROJECTS DEPARTMENT		SEWER S.A. 172891	
SHEET 20 OF 25 SHEETS			
DATE	03-10-99	DATE	
DESCRIPTION	BY	APPROVED	DATE
ORIGINAL	SS/JP		7-99
CONTRACTOR	DATE STARTED	DATE COMPLETED	
	08-22-01	04-27-01	
CONTROL CERTIFICATION		210-1725	
LAMBERT COORDINATES		27028-20-D	



SCALE  
1\"/>

AS-BUILT

FILMED FROM THE ORIGINAL. BEST QUALITY OBTAINABLE. EXCESSIVE GRAY BACKGROUND MAY CAUSE A POOR QUALITY REPRODUCTION.



RAY STREET