

SCALE
1" = 40' HORIZ
1" = 4' VERT.

NOTE: ALBERT ST SHALL BE HIGH LINED BY CITY FORCES PRIOR TO BEGINNING OF CONSTRUCTION. CITY TO FURNISH HIGH LINGING MATERIAL AND MAKE ALL CONNECTIONS.

- REFERENCES:** THOMAS BROTHER MAP - PG-60
 100' SCALE MAP 210-1722
 GATE BOOK PAGE 6-17
 S.D. GAS & ELECT. CO.
 GAS BOOK-2, PG-199
- IMPROVEMENTS:**
 SEWER :
 WATER : 2414-L, 2415-L
 PAVING :
- BENCH MARKS (MEAN SEA LEVEL DATUM)**
 B.M. + 5 E.B.P. MYRTLE AVE & RICHMOND ST., EL. 283.109
- FIELD NOTES:**
 1. CROSS-SECTION 210-1719 LINE "L", KELLEY, 3-27-86, W.O. 147125, SHT. OF 18
 2. CROSS-SECTION 210-1719 LINE "K", KELLEY, 3-27-86, W.O. 147125, SHT. OF 18
- RETIREMENTS:**
 375 - 6" C.I. - YR. UNK.
 1 - FH - 1928

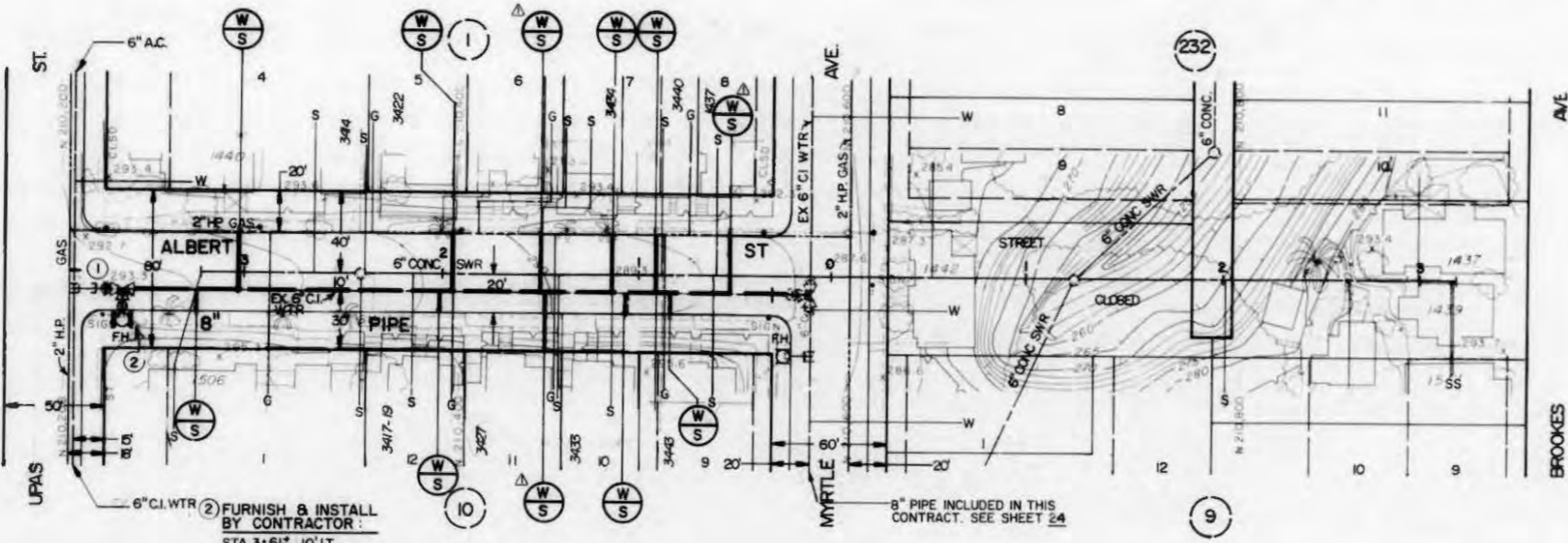

IF ADDITIVE ALTERNATE NO. 1 IS PART OF THE CONTRACT, DELETE THIS NOTE AND SEE 25163-28-D FOR ADDITIVE WORK.
 ADDITIVE ALTERNATE NO. 1

1 BY CITY AHEAD OF CONTRACTOR. STA 3+75, 10' LT. CUT & PLUG AFTER NEW MAIN HAS BEEN ACCEPTED. CONNECT EX 6" CI TO NEW 8" VALVE.

2 FURNISH & INSTALL BY CONTRACTOR:
 STA 3+61.2, 10' LT.
 1 - 8" x 6" TEE (M, J, F)
 1 - 8" VALVE (F, M, J) AHEAD
 1 - 6" FH ASSEMBLY & MARKER

NOTE:
 8" PIPE INCL. IN THIS CONTRACT. SEE SHT. 15

MAP 242



SEWER AND WATER GROUP 55	
ALBERT ST.	
UPAS ST. TO MYRTLE AVE.	
CITY OF SAN DIEGO, CALIFORNIA	E.W.D.
ENGINEERING AND CAPITAL PROJECTS DEPARTMENT	U.W.D. 64911(SEWER)
DATE: 1-30-97	DATE: 1-30-97
DESIGNED BY: RA/RR	CHECKED BY: [Signature]
AS BUILT BY: [Signature]	ASSOCIATE ENGINEER
CONSTRUCTION RECORD	
CONTRACTOR: P. ARTUKOVICH	DATE STARTED: 3/29/97
INSPECTOR: T. PALUSKY	DATE COMPLETED: 7/26/98
CONNECTIONS BY:	25163-27-D

AS-BUILT

ALBERT STREET

