

SPECIAL ENUMERATION AREAS

SAN DIEGO COUNTY, CALIFORNIA

SPECIAL ENUMERATION AREAS

- 37-21 Naval Training and Distribution Center, Fleet Marine Force, Camp Elliott, Naval Operating Base San Diego (Pt.) (In El Cajon Judicial Township)
- 37-25 Naval Training and Distribution Center, Fleet Marine Force, Camp Elliott, Naval Operating Base, San Diego (Pt.) (In El Cajon Judicial Township)
- 37-26 Nazareth House Orphanage (Old Mission) (In El Cajon Judicial Township)
- 37-29 Edgemore Farm (In El Cajon Judicial Township)
- 37-63 Del-Mar Turf and Surf Hotel (In Encinitas Judicial Township)
- 37-65 Marine Corps Air Station, Miramar, California (San Diego) (In Encinitas Judicial Township)
- 37-66 Naval Training and Distribution Center, Fleet Marine Force, Camp Elliott, Naval Operating Base, San Diego (Pt.) (In Encinitas Judicial Township)
- 37-82 Naval Training and Distribution Center, Fleet Marine Force, Camp Elliott, Naval Operating Base, San Diego (Pt.) (In Escondido Judicial Township)
- 37-86 Camp Pendleton, Amphibious Training Base, Naval Ammunition Depot and Naval Hospital, Santa Margarita Ranch (Pt.) Oceanside, California (In Fallbrook Judicial Township)
- 37-96 Chollas Heights Radio Station 11th Naval District, San Diego, California (In Homeland Judicial Township)
- 37-112 Jacumba Hot Springs Hotel and Cottages (In Jacumba Judicial Township)
- 37-193 Coronado Heights Annex, Naval Air Station, San Diego, California (In National Judicial Township)
- 37-195 Naval Supplementary Radio Station Imperial Beach, San Diego, California (In National Judicial Township)
- 37-198 Machine Gun Training Center, Border Field (San Diego, California) (In National Judicial Township)
- 37-200 Auxiliary Air Station, Romo Field (San Diego, California) (In National Judicial Township)
- 37-203 Naval Air Station, San Diego, California (In National Judicial Township)
- 37-225 Camp Pendleton, Amphibious Training Base, Naval Ammunition Depot and Naval Hospital, Santa Margarita Beach, Oceanside, California (In Oceanside Judicial Township)
- 37-227 Academy of the Little Flower St. Therese of the Child Jesus (In Oceanside Judicial Township)

115 - Foodservice area - Chula Vista
 114 - Area surrounding Freshwater House
 152 - Paradise Valley San Marcos

SEE DETAILED MAPS FOR:

- AREA SOUTH OF CHULA VISTA (UNINC.)
- CARLSBAD (UNINC.)
- CHULA VISTA
- CORONADA
- EL CAJON
- ESCONDIDO
- LA MESA
- NATIONAL CITY
- OCEANSIDE
- RAMONA (UNINC.)
- URBANIZED AREA
- FALLBROOK (UNINC.)
- VISTA (UNINC.)

1950 SUPERVISOR'S MAP, SET 1

1950 E.D.'S. 37-1 TO 37-250

- COUNTY AND MCD (JUDICIAL TOWNSHIP) (RED)
- INCORPORATED PLACE (GREEN)
- UNINCORPORATED PLACE (PURPLE)
- ENUMERATION DISTRICT (ORANGE)
- CENSUS TRACT (BROWN)

GENERAL HIGHWAY MAP SAN DIEGO COUNTY CALIFORNIA

PREPARED BY THE
DEPARTMENT OF PUBLIC WORKS
DIVISION OF HIGHWAYS
IN COOPERATION WITH THE
U.S. DEPARTMENT OF AGRICULTURE
BUREAU OF PUBLIC ROADS
DATA OBTAINED FROM
STATE-WIDE HIGHWAY PLANNING SURVEY

1937

LEGEND

- | | | | |
|--|---|---|--|
| <ul style="list-style-type: none"> PRIMITIVE ROADS UNIMPROVED ROADS GRADED & DRAINED RDS SOIL SURFACED RDS METAL SURFACED RDS BITUMINOUS ROADS PAVED ROADS AIR ROUTES TUNNEL FERRY-FR FREIGHT-TOLL HIGHWAY BRIDGE DRAWBRIDGE SUSPENSION BRIDGE ARCH BRIDGE TRUSS BRIDGE | <ul style="list-style-type: none"> U.S. HIGHWAY STATE HIGHWAY ROUTE FEDERAL AID SYSTEM RAILROAD & R.R. STATION ELECTRIC RAILROAD NARROW GAUGE R.R. R.R. TUNNEL GRADE CROSSING R.R. ABOVE-OVERPASS R.R. BELOW-OVERPASS MILITARY AIRPORT DEPT. OF COMMERCE INTERMEDIATE FIELD COMMERCIAL OR MUNICIPAL FIELD MARKED AUXILIARY FIELD EMERGENCY FIELD | <ul style="list-style-type: none"> STATE CAPITAL COUNTY SEAT CITIES OR VILLAGES INCORPORATED CITY CONGESTED AREA CULTURE NOT SHOWN STATE BOUNDARY COUNTY BOUNDARY CORPORATE LIMITS TOWNSHIP LINES SECTION LINES PARK OR RESERVATION BOUNDARY IRRIGATION DITCH INTERMEDIATE FIELD DRAINAGE DITCH CANAL SHIP OR BARGE LINES HEAD OF NAVIGATION DAM | <ul style="list-style-type: none"> SMALL PARKS FAIR GROUNDS, RACE COURSES & SPEEDWAYS GOLF COURSE OR COUNTRY CLUB ATHLETIC FIELD OR AMUSEMENT PARK CEMETERY MINE OR QUARRY OIL OR GAS WELLS TANKS OR REFINERIES POWER PLANT RADIO STATION FIRE LOOKOUT STA. FOREST RANGER STA. IN NOT USE IN USE FARM UNIT DWELLING OR SUMMER COTTAGE ROWS OR GROUPS OF DWELLINGS STORE, GAS STA. OR SMALL BUSINESS TOWNHALL, GRANGE OR COMMUNITY HALL HOTEL OR RESORT CHURCH SCHOOLHOUSE CORRECTIONAL INSTITUTIONS HOSPITALS FACTORY, WAREHOUSE OR INDUSTRIAL PLANT CAMP OR LODGE SAWMILL |
|--|---|---|--|

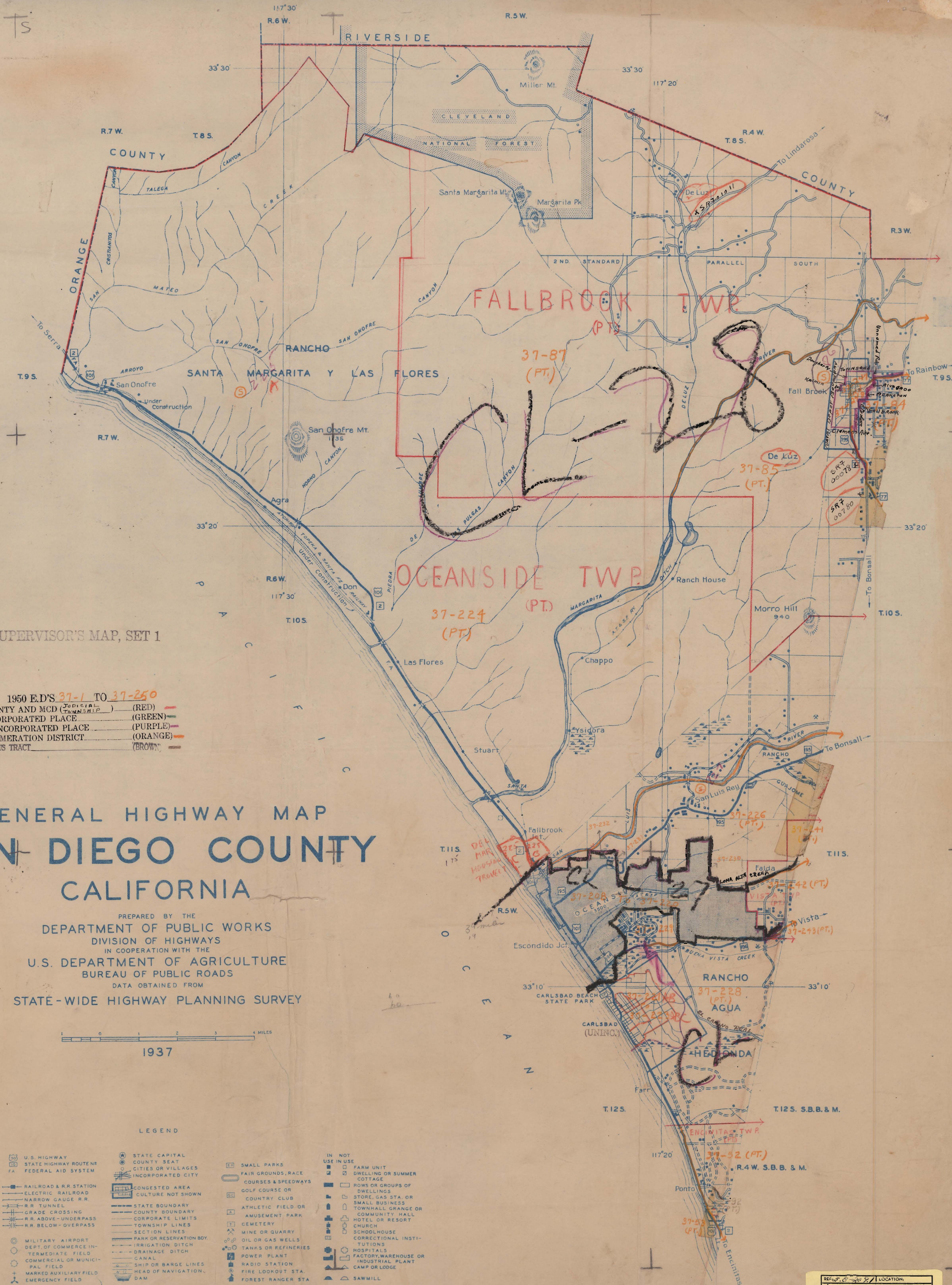
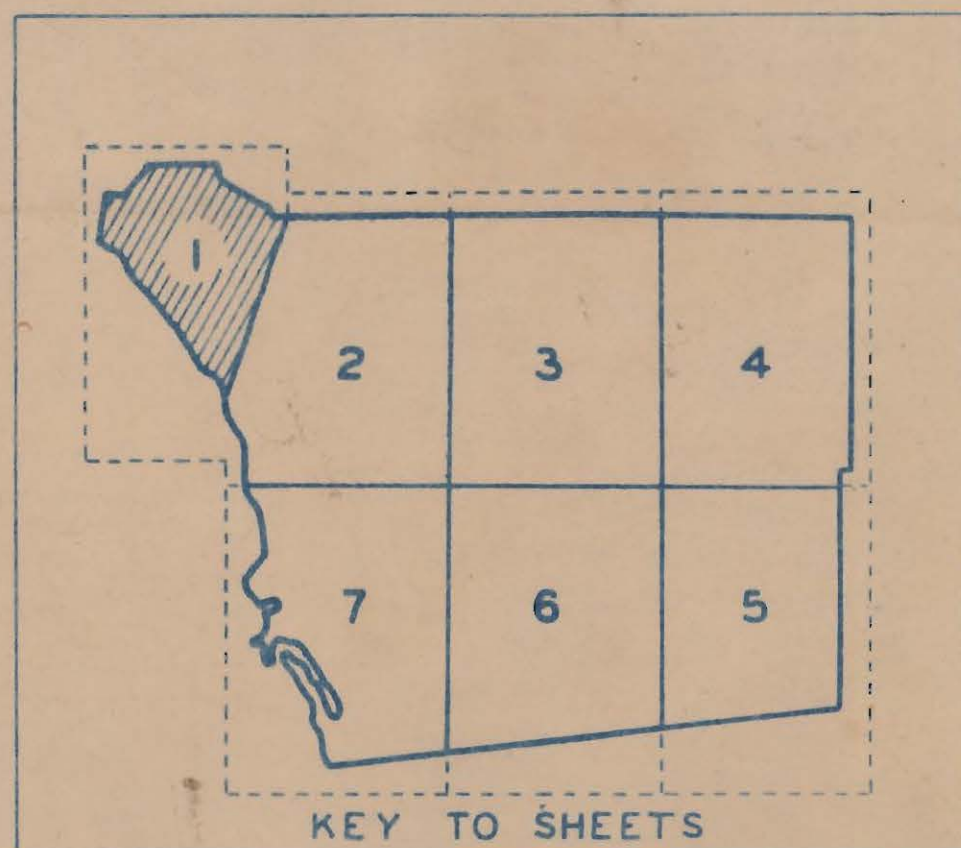

REF. TO SHEET NO. LOCATION
 AREA OF REVISIONS
 INFO. S. D. COUNTY - 17
 7-2-37
 SCALE: DATE: 1937

15

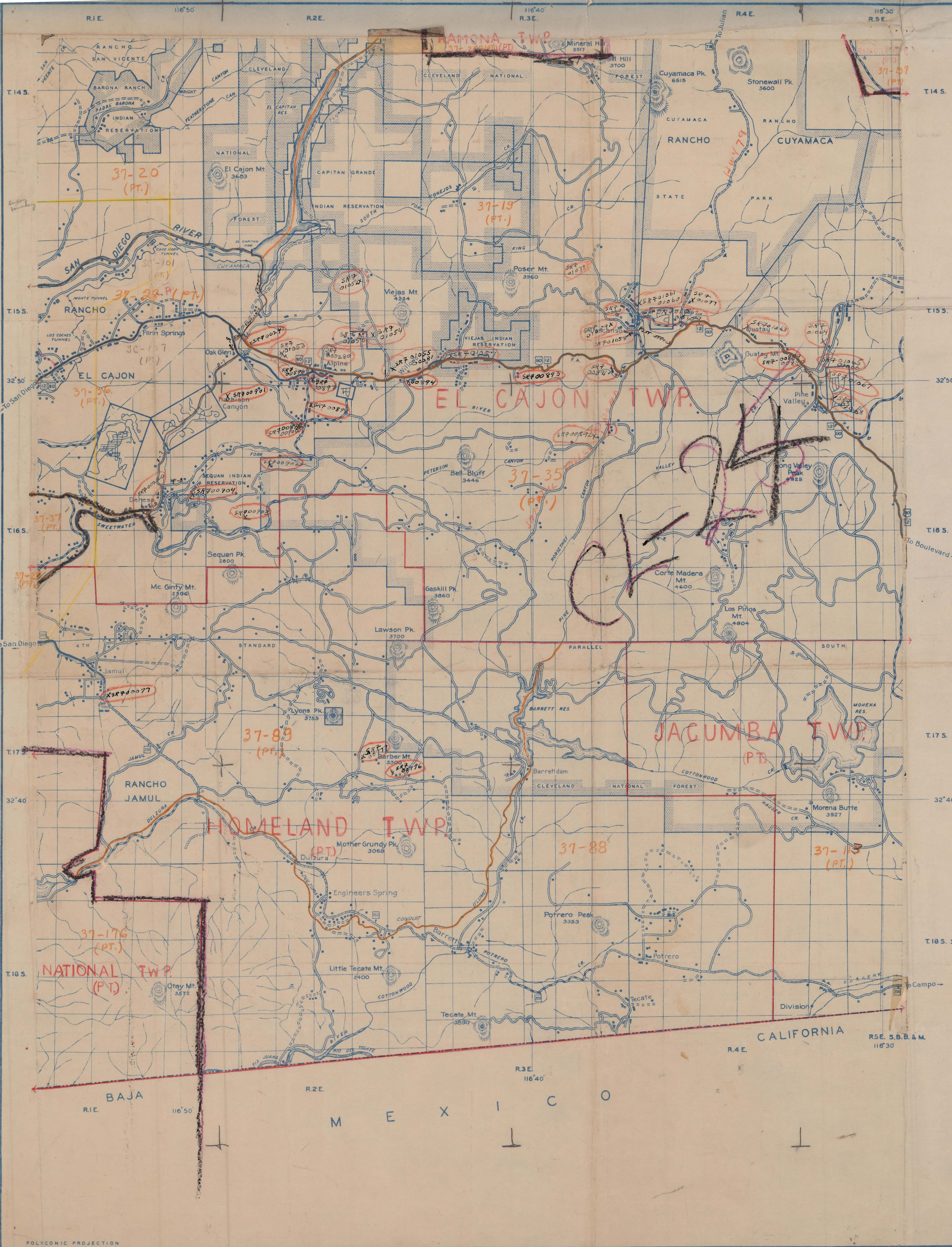

1950 SUPERVISOR'S MAP, SET 2

- LEGEND
- PRIMITIVE ROADS
 - UNIMPROVED ROADS
 - GRADED & DRAINED RDS.
 - SOIL SURFACED RDS.
 - METAL SURFACED RDS.
 - BITUMINOUS ROADS
 - PAVED ROADS
 - AIR ROUTES
 - TUNNEL
 - FORD
 - FERRY-FR FREE-TF-TOLL
 - HIGHWAY BRIDGE
 - DRAWBRIDGE
 - SUSPENSION BRIDGE
 - ARCH BRIDGE
 - TRUSS BRIDGE
 - RAILROAD & R.R. STATION
 - ELECTRIC RAILROAD
 - NARROW GAUGE R.R.
 - R.R. TUNNEL
 - GRADE CROSSING
 - R.R. ABOVE-UNDERPASS
 - R.R. BELOW-OVERPASS
 - MILITARY AIRPORT
 - DEPT. OF COMMERCE INTERMEDIATE FIELD
 - COMMERCIAL OR MUNICIPAL FIELD
 - SHIP OR BARGE LINES
 - MARKED AUXILIARY FIELD
 - EMERGENCY FIELD
 - U.S. HIGHWAY
 - STATE HIGHWAY ROUTEN
 - FEDERAL AID SYSTEM
 - STATE CAPITAL
 - COUNTY SEAT
 - CITIES OR VILLAGES
 - INCORPORATED CITY
 - CONGESTED AREA
 - CULTURE NOT SHOWN
 - STATE BOUNDARY
 - CORPORATE BOUNDARY
 - CORPORATE LIMITS
 - TOWNSHIP LINES
 - SECTION LINES
 - PARK OR RESERVATION BOD
 - IRRIGATION DITCH
 - DRAINAGE DITCH
 - CANAL
 - SHIP OR BARGE LINES
 - HEAD OF NAVIGATION
 - DAM
 - SMALL PARKS
 - FAIR GROUNDS, RACE
 - COURSES & SPEEDWAYS
 - COUNTRY CLUB
 - GOLF COURSE OR
 - ATHLETIC FIELD OR
 - AMUSEMENT PARK
 - CEMETERY
 - MINE OR QUARRY
 - OIL OR GAS WELLS
 - TANKS OR REFINERIES
 - POWER PLANT
 - RADIO STATION
 - FIRE LOOKOUT STA
 - FOREST RANGER STA

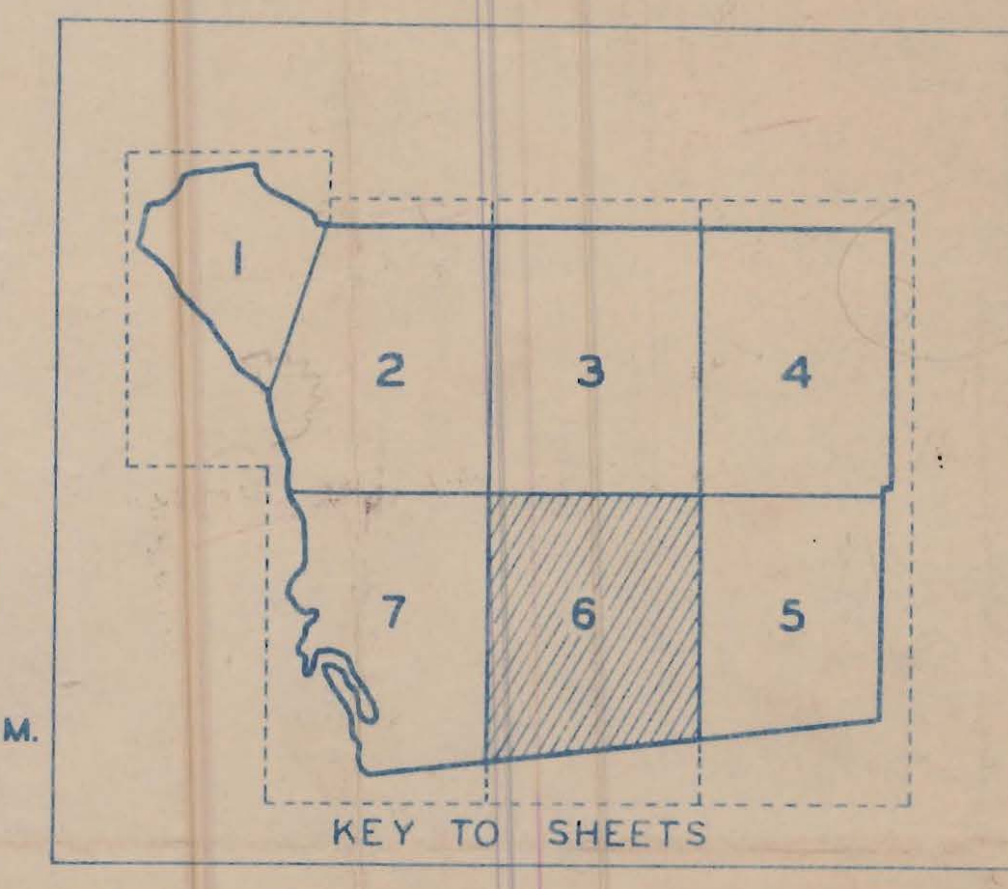

Dec. 12, 1938

LOC. TION
 1. 1
 2. 2
 3. 3
 4. 4
 5. 5
 6. 6
 7. 7
 SCALE: 1" = 1 MILE
 DATE: 1938

POLYCONIC PROJECTION

SHEET 6 OF 7 SHEETS

GENERAL HIGHWAY MAP SAN DIEGO COUNTY CALIFORNIA

R.5E.

R.6E.

R.7E.

R.8E.

116°20'

116°10'

T.14S.

IMPERIAL COUNTY

T.15S.

32°50'

T.16S.

T.17S.

32°40'

T.18S. S.B.B.&M.

1950 SUPERVISOR'S MAP, SET 2

RAMONA TWP. (PT.)

37-237 (PT.)

37-19 (PT.)

EL CAJON TWP. (PT.)

JACUMBA TWP. (PT.)

37-111 (PT.)

CALIFORNIA R.6E. S.B.B.&M.

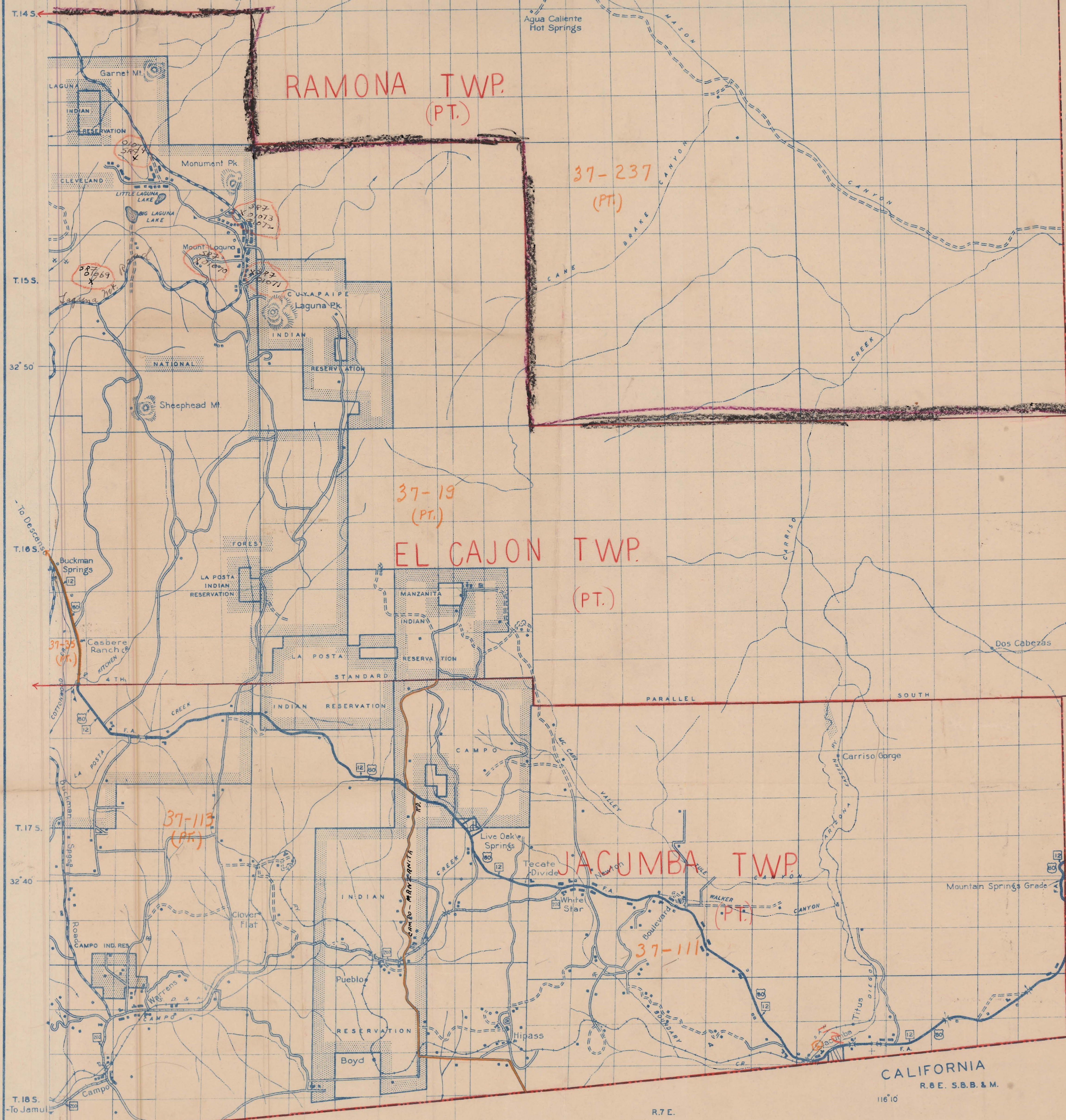

R.5E.

R.6E.

R.7E.

MEXICO

116°20'

116°10'

T.18S. -To Jamul

T.17S.

T.16S.

T.15S.

T.14S.

BAJA

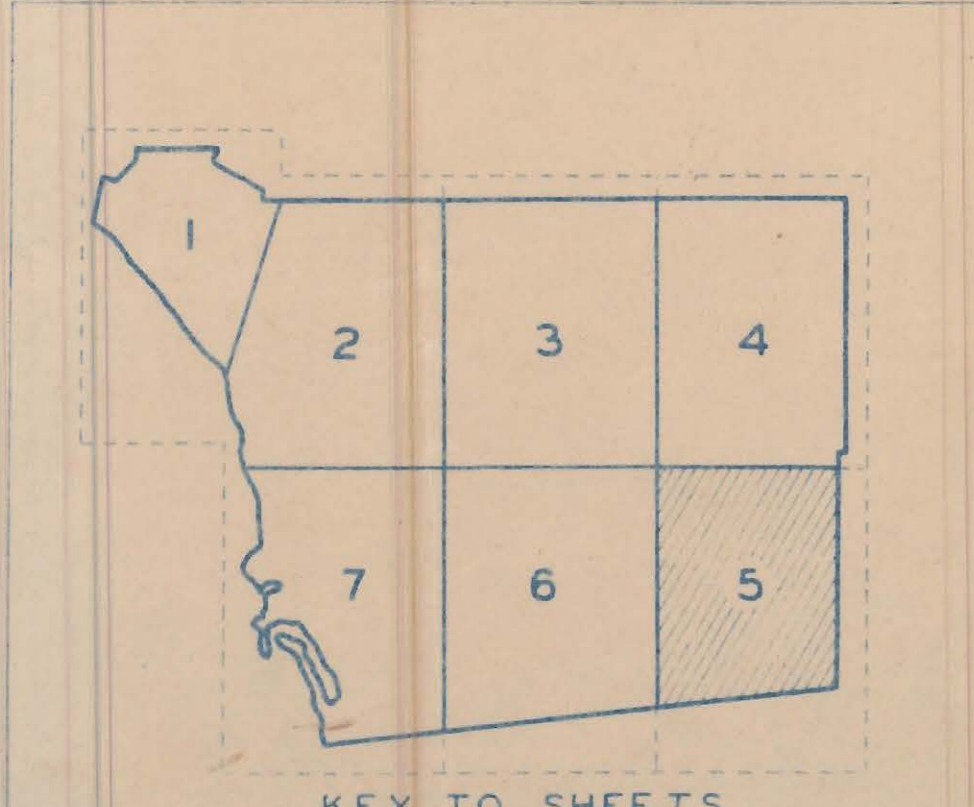

KEY TO SHEETS

- PRIMITIVE ROADS
- UNIMPROVED ROADS
- GRADED & DRAINED RDS.
- SOIL SURFACED RDS.
- METAL SURFACED RDS.
- BITUMINOUS ROADS
- PAVED ROADS
- AIR ROUTES
- TUNNEL
- FERRY-FR FREE-TF-TOLL
- HIGHWAY BRIDGE
- DRAWBRIDGE
- SUSPENSION BRIDGE
- ARCH BRIDGE
- TRUSS BRIDGE
- U.S. HIGHWAY
- STATE HIGHWAY ROUTES
- F.A. FEDERAL AID SYSTEM
- RAILROAD & R.R. STATION
- ELECTRIC RAILROAD
- NARROW GAUGE R.R.
- R.R. TUNNEL
- GRADE CROSSING
- R.R. ABOVE-OVERPASS
- R.R. BELOW-OVERPASS
- MILITARY AIRPORT
- DEPT. OF COMMERCE INTERMEDIATE FIELD
- COMMERCIAL OR MUNICIPAL FIELD
- MARKED AUXILIARY FIELD
- EMERGENCY FIELD
- STATE CAPITAL
- COUNTY SEAT
- CITIES OR VILLAGES
- INCORPORATED CITY
- CONGESTED AREA
- CULTURE NOT SHOWN
- STATE BOUNDARY
- COUNTY BOUNDARY
- CORPORATE LIMITS
- TOWNSHIP LINES
- SECTION LINES
- PARK OR RESERVATION BOX
- IRRIGATION DITCH
- DRAINAGE DITCH
- CANAL
- SHIP OR BARGE LINES
- HEAD OF NAVIGATION
- DAM
- SMALL PARKS
- FAIR GROUNDS, RACE COURSES & SPEEDWAYS
- GOLF COURSE OR COUNTRY CLUB
- ATHLETIC FIELD OR AMUSEMENT PARK
- CEMETERY
- MINE OR QUARRY
- OIL OR GAS WELLS
- TANKS OR REFINERIES
- POWER PLANT
- RADIO STATION
- FIRE LOOKOUT STA.
- FOREST RANGER STA.
- IN NOT USE IN USE
- FARM UNIT
- DWELLING OR SUMMER COTTAGE
- ROWS OR GROUPS OF DWELLINGS
- STORE, GAS STA. OR SMALL BUSINESS
- TOWNHALL GRANGE OR COMMUNITY HALL
- HOTEL OR RESORT
- CHURCH
- SCHOOLHOUSE
- CORRECTIONAL INSTITUTIONS
- HOSPITALS
- FACTORY, WAREHOUSE OR INDUSTRIAL PLANT
- CAMP OR LODGE
- SAWMILL

LEGEND

REVISIONS
 NO. 1
 DATE 1/20/50
 NO. 2
 DATE 1/20/50
 NO. 3
 DATE 1/20/50
 NO. 4
 DATE 1/20/50
 NO. 5
 DATE 1/20/50
 NO. 6
 DATE 1/20/50
 NO. 7
 DATE 1/20/50
 NO. 8
 DATE 1/20/50
 NO. 9
 DATE 1/20/50
 NO. 10
 DATE 1/20/50

SHEET 5 OF 7 SHEETS

5967

Dec. 12, 1938

POLYCONIC PROJECTION

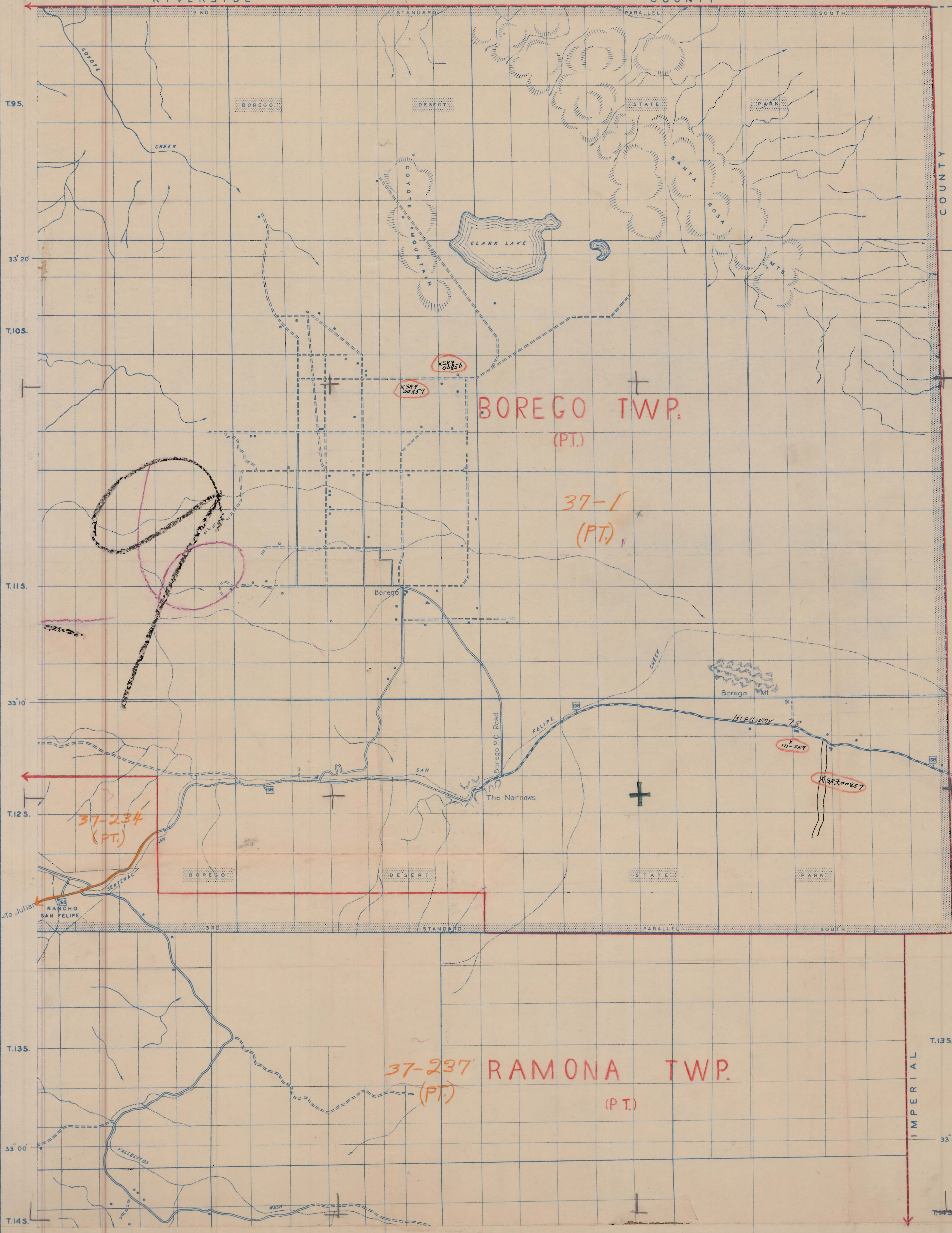

LEGEND

--- PRIMITIVE ROADS	--- AIR ROUTES
--- UNIMPROVED ROADS	--- U.S. HIGHWAY
--- GRADED & DRAINED RDS	--- STATE HIGHWAY ROUTE
--- SOIL SURFACED RDS	--- FEDERAL AID SYSTEM
--- METAL SURFACED RDS	--- STATE CAPITAL
--- BITUMINOUS ROADS	--- COUNTY SEAT
--- PAVED ROADS	--- CITIES OR VILLAGES
--- TUNNEL	--- INCORPORATED CITY
--- FERRY-TF FREE-TF-TOLL	--- CONGESTED AREA
--- HIGHWAY BRIDGE	--- CULTURE NOT SHOWN
--- DRAWBRIDGE	--- STATE BOUNDARY
--- SUSPENSION BRIDGE	--- COUNTY BOUNDARY
--- ARCH BRIDGE	--- CORPORATE LIMITS
--- TRUSS BRIDGE	--- TOWNSHIP LINES
--- RAILROAD & RR STATION	--- SECTION LINES
--- ELECTRIC RAILROAD	--- PARK OR RESERVATION BOD.
--- NARROW GAUGE R.R.	--- IRRIGATION DITCH
--- RR TUNNEL	--- DRAINAGE DITCH
--- GRADE CROSSING	--- CANAL
--- RR ABOVE-UNDERPASS	--- SHIP OR BARGE LINES
--- RR BELOW-OVERPASS	--- HEAD OF NAVIGATION
--- MILITARY AIRPORT	--- DAM
--- DEPT. OF COMMERCE INTERMEDIATE FIELD	
--- COMMERCIAL OR MUNICIPAL FIELD	
--- MARKED AUXILIARY FIELD	
--- EMERGENCY FIELD	
IN NOT USE IN USE	
--- FARM UNIT	--- SMALL PARKS
--- DWELLING OR SUMMER COTTAGE	--- FAIR GROUNDS, RACE COURSES & SPEEDWAYS
--- ROWS OR GROUPS OF DWELLINGS	--- GOLF COURSE OR COUNTRY CLUB
--- STORE, GAS STA. OR SMALL BUSINESS	--- ATHLETIC FIELD OR AMUSEMENT PARK
--- TOWNHALL, GRANGE OR COMMUNITY HALL	--- CEMETERY
--- HOTEL OR RESORT	--- MINE OR QUARRY
--- CHURCH	--- OIL OR GAS WELLS
--- SCHOOLHOUSE	--- TANKS OR REFINERIES
--- CORRECTIONAL INSTITUTIONS	--- POWER PLANT
--- HOSPITALS	--- RADIO STATION
--- FACTORY, WAREHOUSE OR INDUSTRIAL PLANT	--- FIRE LOOKOUT STA.
--- CAMP OR LODGE	--- FOREST RANGER STA.
--- SAWMILL	

BOREGO TWP. (PT)

37-1 (PT)

37-234 (PT)

37-237 RAMONA TWP. (PT)

S.R. 7 Survey Residential Financing Field Central Road Schwabke No. 547 10

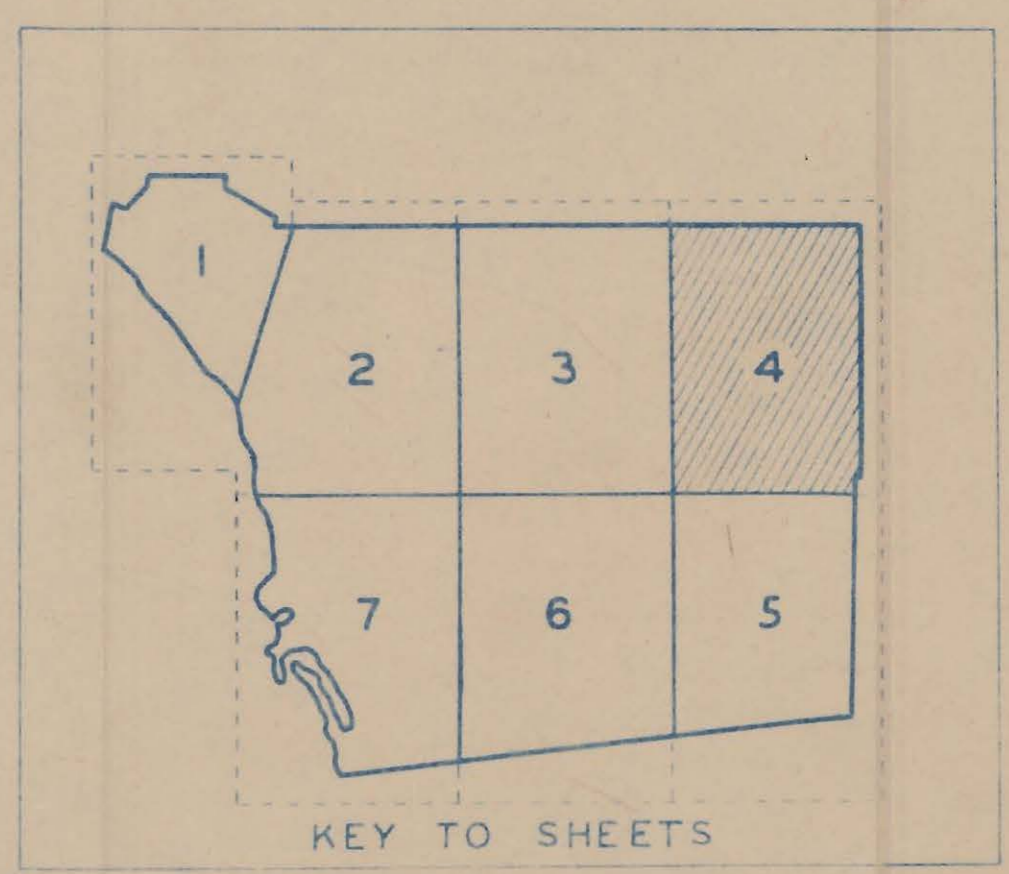

37-237 LOCATION: Ramona Twp. San Diego County 4 of 7 sheets SCALE: DATE: 1/20

T.13S. S.B.B. & M.

RIVERSIDE COUNTY

FALLBROOK TWP (PT.) 37-83 (PT.)

ESCONDIDO TWP (PT.) 37-76 (PT.)

RAMONA TWP (PT.) 37-234 (PT.)

BOREGO TWP (PT.) 37-1 (PT.)

37-71 (PT.)

37-235 (PT.)

37-236 (PT.)

37-237 (PT.)

37-19 (PT.)

37-17 (PT.)

LEGEND

- PRIMITIVE ROADS
- UNIMPROVED ROADS
- GRADED & DRAINED RDS
- SOIL SURFACED RDS
- METAL SURFACED RDS
- BITUMINOUS ROADS
- PAVED ROADS
- AIR ROUTES
- TUNNEL
- FERRY-FREE/TOLL
- HIGHWAY BRIDGE
- DRAWBRIDGE
- SUSPENSION BRIDGE
- ARCH BRIDGE
- TRUSS BRIDGE
- RAILROAD & R.R. STATION
- ELECTRIC RAILROAD
- NARROW GAUGE R.R.
- R.R. TUNNEL
- GRADE CROSSING
- R.R. ABOVE-OVERPASS
- R.R. BELOW-OVERPASS
- MILITARY AIRPORT
- DEPT. OF COMMERCE INTERMEDIATE FIELD
- COMMERCIAL OR MUNICIPAL FIELD
- MARKED AUXILIARY FIELD
- EMERGENCY FIELD
- U.S. HIGHWAY ROUTE
- FEDERAL AID SYSTEM
- STATE CAPITAL
- COUNTY SEAT
- CITIES OR VILLAGES
- INCORPORATED CITY
- CONGESTED AREA
- CULTURE NOT SHOWN
- STATE BOUNDARY
- COUNTY BOUNDARY
- CORPORATE LIMITS
- TOWNSHIP LINES
- SECTION LINES
- PARK OR RESERVATION BDR
- IRRIGATION DITCH
- DRAINAGE DITCH
- CANAL
- SHIP OR BARGE LINES
- HEAD OF NAVIGATION
- DAM
- SMALL PARKS
- FAIR GROUNDS, RACE COURSES & SPEEDWAYS
- GOLF COURSE OR COUNTRY CLUB
- ATHLETIC FIELD OR AMUSEMENT PARK
- CEMETERY
- MINE OR QUARRY
- OIL OR GAS WELLS
- TANKS OR REFINERIES
- POWER PLANT
- RADIO STATION
- FIRE LOOKOUT STA.
- FOREST RANGER STA.

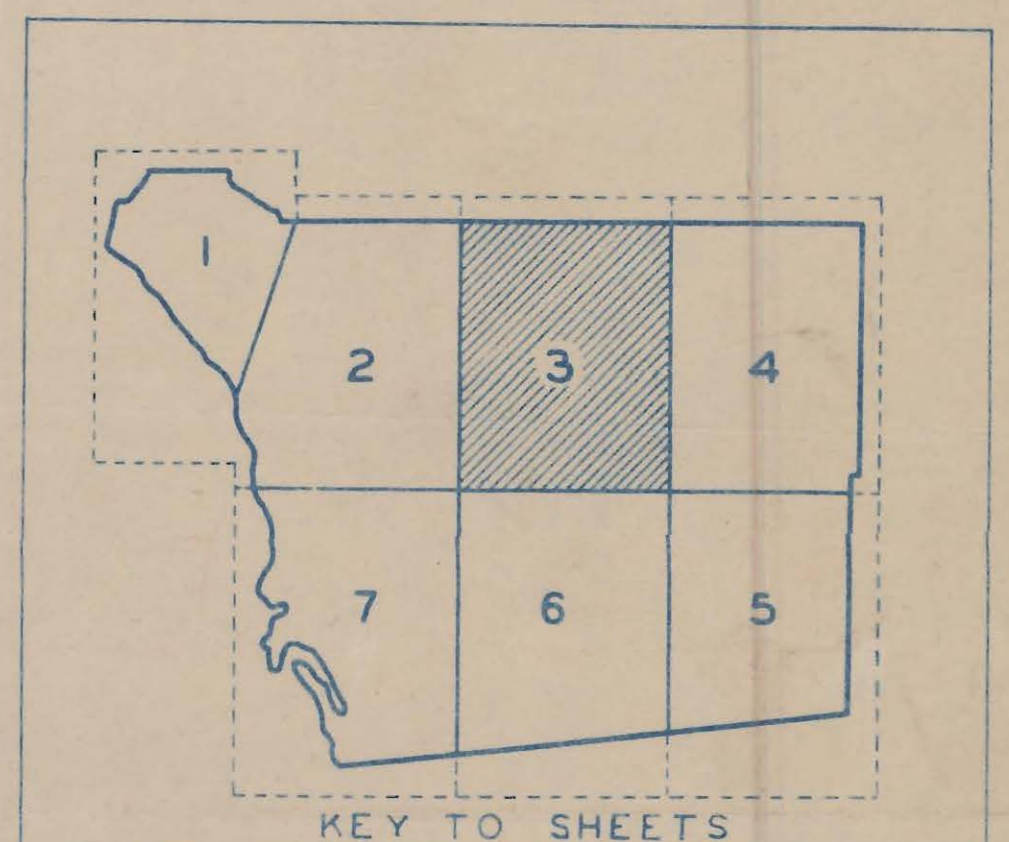

REF. 6-2027 LOCATION:
 AREA: ESCONDIDO
 INFO: D. D. Gentry
 DATE: 7/3/60
 SCALE: 1" = 1 MILE
 DATE: 1960

T.145. S.B.B.&M.

T.135.

T.125.

T.115.

T.105.

T.95.

T.95.

33°20'

T.105.

T.115.

T.125.

T.135.

T.145.

307

6.12, 1938

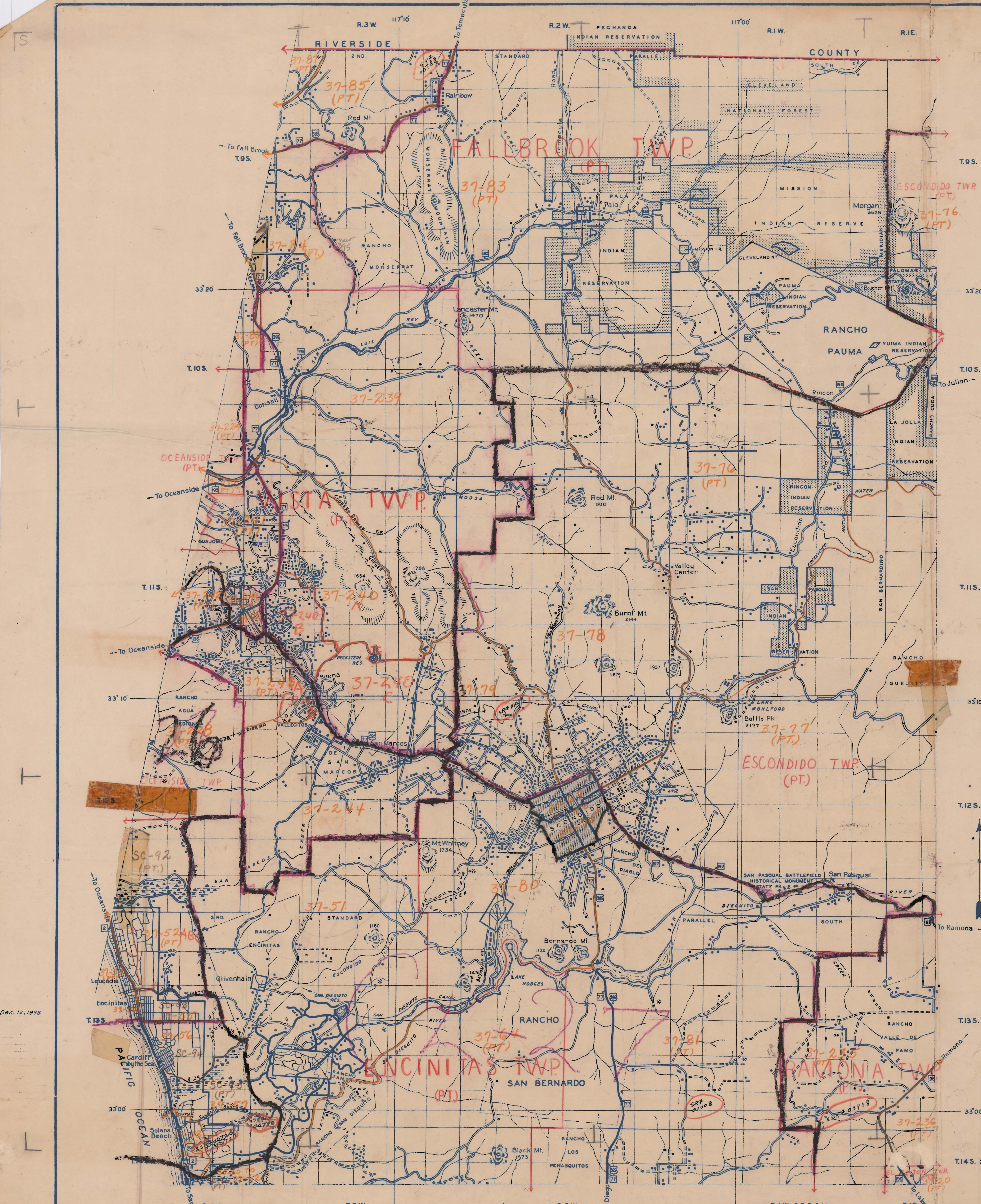

- LEGEND**
- PRIMITIVE ROADS
 - UNIMPROVED ROADS
 - GRADED & DRAINED RDS
 - SOIL SURFACED RDS
 - METAL SURFACED RDS
 - BITUMINOUS ROADS
 - PAVED ROADS
 - AIR ROUTES
 - TUNNEL
 - FORD
 - FERRY-FR FREE;TF-TOLL
 - HIGHWAY BRIDGE
 - DRAWBRIDGE
 - SUSPENSION BRIDGE
 - ARCH BRIDGE
 - TRUSS BRIDGE
 - RAILROAD & R.R. STATION
 - ELECTRIC RAILROAD
 - NARROW GAUGE R.R.
 - R.R. TUNNEL
 - GRADE CROSSING
 - R.R. ABOVE-OVERPASS
 - R.R. BELOW-OVERPASS
 - MILITARY AIRPORT
 - DEPT. OF COMMERCE INTERMEDIATE FIELD
 - COMMERCIAL OR MUNICIPAL FIELD
 - MARKED AUXILIARY FIELD
 - EMERGENCY FIELD
 - U.S. HIGHWAY
 - STATE HIGHWAY ROUTEN
 - FEDERAL AID SYSTEM
 - STATE CAPITAL
 - COUNTY SEAT
 - CITIES OR VILLAGES
 - INCORPORATED CITY
 - CONGESTED AREA
 - CULTURE NOT SHOWN
 - STATE BOUNDARY
 - COUNTY BOUNDARY
 - CORPORATE LIMITS
 - TOWNSHIP LINES
 - SECTION LINES
 - PARK OR RESERVATION BOD.
 - IRRIGATION DITCH
 - DRAINAGE DITCH
 - CANAL
 - SHIP OR BARGE LINES
 - HEAD OF NAVIGATION
 - DAM
 - SMALL PARKS
 - FAIR GROUNDS, RACE COURSES & SPEEDWAYS
 - GOLF COURSE OR COUNTRY CLUB
 - ATHLETIC FIELD OR AMUSEMENT PARK
 - CEMETERY
 - MINE OR QUARRY
 - OIL OR GAS WELLS
 - TANKS OR REFINERIES
 - POWER PLANT
 - RADIO STATION
 - FIRE LOOKOUT STA.
 - FOREST RANGER STA.

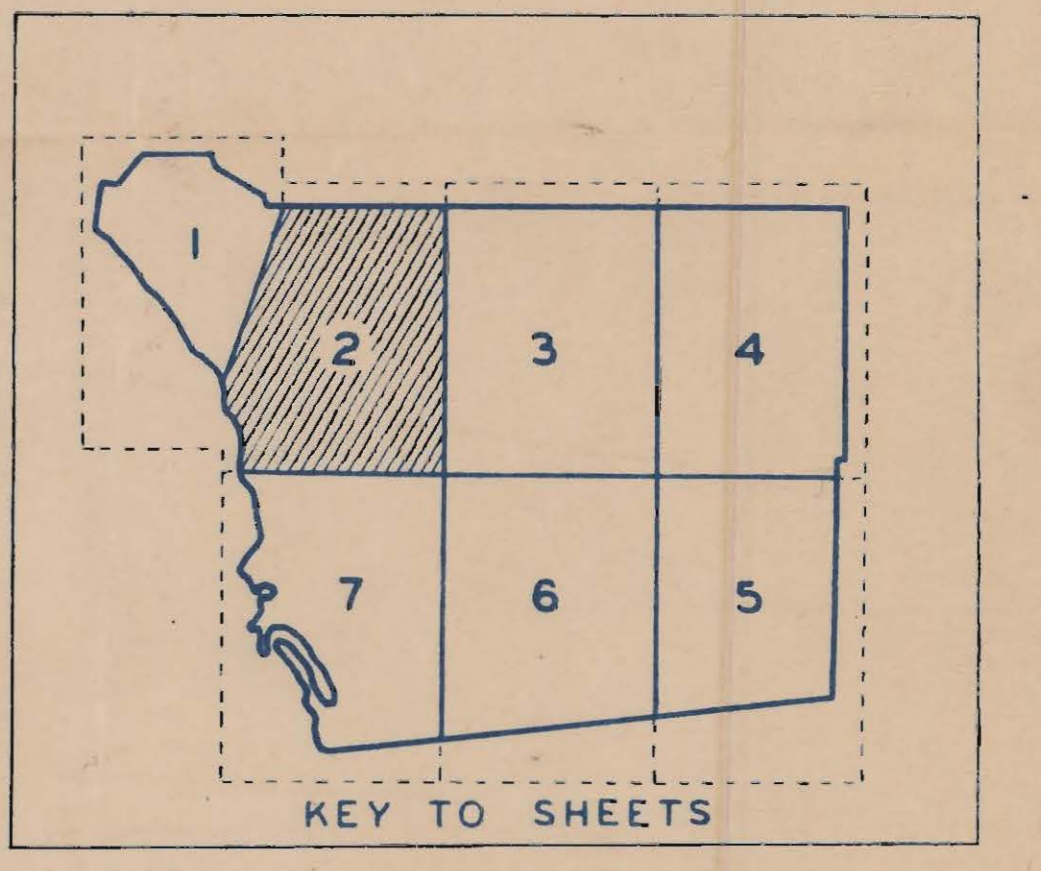

NO. 37-239 LOCATION
 AREA: SAN BERNARDO
 INFO. S.D. COUNTY 2
 OF 7 SHEETS
 SCALE: DATE: 1930

Dec. 12, 1930

Boundary for San Diego Area Origin and Destination Survey

LEGEND

- PRIMITIVE ROADS
- UNIMPROVED ROADS
- GRADED & DRAINED RDS
- SOIL SURFACED RDS
- METAL SURFACED RDS
- BITUMINOUS ROADS
- PAVED ROADS
- AIR ROUTES
- TUNNEL
- FORD
- FERRY-FR FREE-TF-TOLL
- HIGHWAY BRIDGE
- DRAWBRIDGE
- SUSPENSION BRIDGE
- ARCH BRIDGE
- TRUSS BRIDGE
- RAILROAD & R.R. STATION
- ELECTRIC RAILROAD
- NARROW GAUGE R.R.
- R.R. TUNNEL
- GRADE CROSSING
- SUSPENSION UNDERPASS
- R.R. ABOVE-UNDERPASS
- R.R. BELOW-UNDERPASS
- MILITARY AIRPORT
- DEPT. OF COMMERCE INTERMEDIATE FIELD
- COMMERCIAL OR MUNICIPAL FIELD
- MARKED AUXILIARY FIELD
- EMERGENCY FIELD
- U.S. HIGHWAY ROUTE
- FEDERAL AID SYSTEM
- STATE CAPITAL
- COUNTY SEAT
- CITIES OR VILLAGES
- INCORPORATED CITY
- CONGESTED AREA
- CULTURE NOT SHOWN
- STATE BOUNDARY
- COUNTY BOUNDARY
- CORPORATE LIMITS
- TOWNSHIP LINES
- SECTION LINES
- PARK OR RESERVATION
- IRRIGATION DITCH
- DRAINAGE DITCH
- CANAL
- SHIP OR BARGE LINES
- HEAD OF NAVIGATION
- DAM
- SMALL PARKS
- FAIR GROUNDS, RACE COURSES & SPEEDWAYS
- GOLF COURSE OR COUNTRY CLUB
- ATHLETIC FIELD OR AMUSEMENT PARK
- CEMETERY
- MINE OR QUARRY
- OIL OR GAS WELLS
- TANKS OR REFINERIES
- POWER PLANT
- RADIO STATION
- FIRE LOOKOUT STA.
- FOREST RANGER STA.

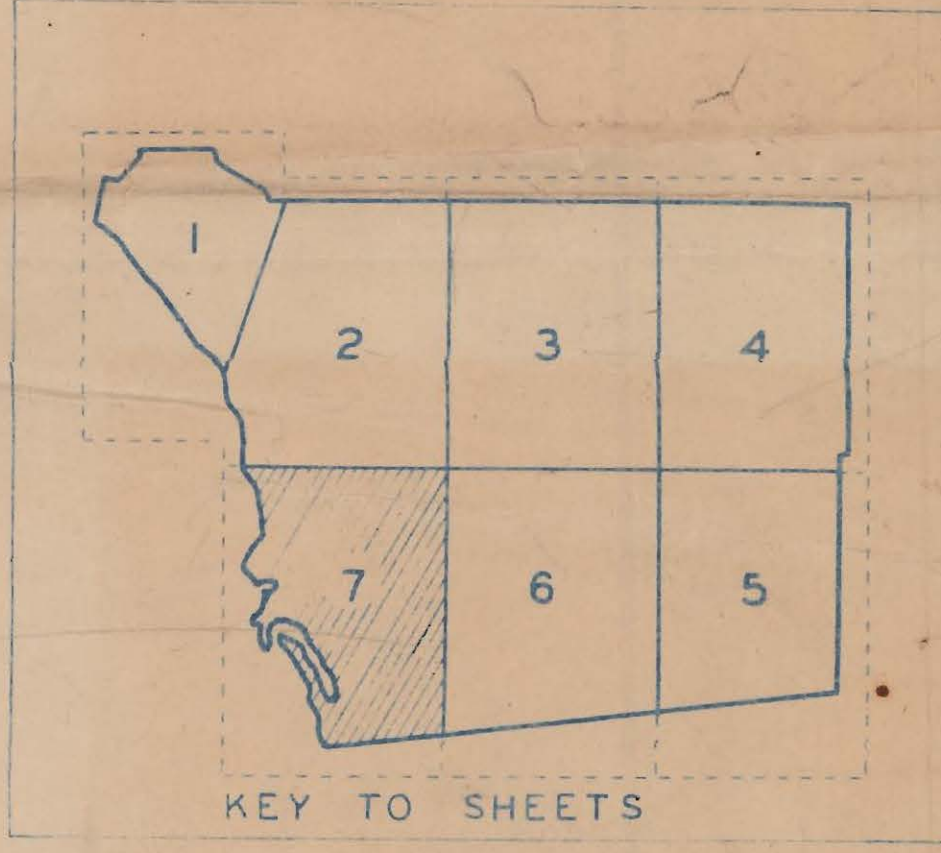

T.185. S.B.B. & M.

Dec. 12, 1938

37-208 Addition
 EDUCATION D
 S. D. COUNTY 7
 OR 7 SHEETS
 SCALE: DATE: 1946