

CITY OF SAN DIEGO
FACILITIES FINANCING PROGRAM

PROJECT: CA-20
COUNCIL DISTRICT: 7
COMMUNITY: COLLEGE AREA

TITLE: EL CAJON BOULEVARD FROM 54TH STREET TO 58TH STREET

DEPARTMENT: ENGINEERING AND DEVELOPMENT - STREETS
COSTS: LAND 200,000
ENGR/CONSTR 925,000

FUNDING:	SOURCE	EXPEN/ENCUM	CONT	APPROP	FY 1994	FY 1995	FY 1996	FY 1997	FY 1998	FY 1999
1,125,000	UNIDENTIFIED									
1,125,000	TOTAL	0	0	0	0	0	0	0	0	0

L=Land Acquisition P=Preliminary Design D=Design C=Construction R=Reimbursement F=Furnishings

DESCRIPTION: THIS PROJECT PROVIDES FOR THE WIDENING OF EL CAJON BOULEVARD TO A MODIFIED FOUR LANE MAJOR STREET (74'/90') FROM 54TH STREET TO 58TH STREET. 50% OF TOTAL PROJECT COSTS OF \$2,250,000 ARE REFLECTED IN THIS COMMUNITY AND 50% IN THE MID-CITY COMMUNITY.

JUSTIFICATION: THIS PROJECT WILL IMPROVE TRAFFIC CIRCULATION IN THE COLLEGE COMMUNITY.

SCHEDULE: DESIGN AND CONSTRUCTION WILL BE SCHEDULED WHEN FUNDING IS IDENTIFIED.

RELATIONSHIP TO GENERAL AND COMMUNITY PLANS: THIS PROJECT IS CONSISTENT WITH THE COLLEGE AREA COMMUNITY PLAN AND THE CITY'S GENERAL PLAN GUIDELINES.

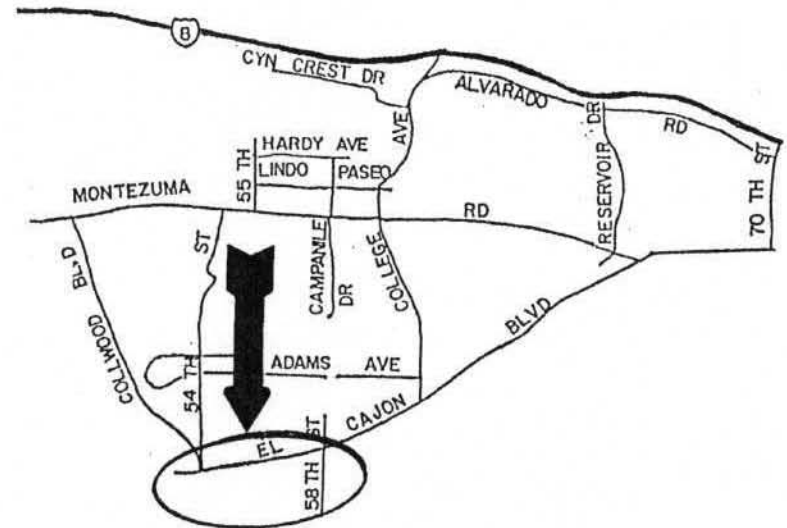

CITY OF SAN DIEGO
FACILITIES FINANCING PROGRAM

PROJECT: CA-21

COUNCIL DISTRICT: 7
COMMUNITY: COLLEGE AREA

TITLE: EL CAJON BOULEVARD; MONTEZUMA ROAD TO 70TH STREET

DEPARTMENT: ENGINEERING AND DEVELOPMENT
COSTS: LAND
ENGR/CONSTR 700,000

FUNDING:	SOURCE	EXPEN/ENCUM	CONT	APPROP	FY 1994	FY 1995	FY 1996	FY 1997	FY 1998	FY 1999
700,000 UNIDENTIFIED										
700,000 TOTAL		0	0	0	0	0	0	0	0	0
L=Land Acquisition		P=Preliminary Design		D=Design	C=Construction		R=Reimbursement	F=Furnishings		

DESCRIPTION: THIS PROJECT PROVIDES FOR THE MODIFICATION OF THE EXISTING RAISED CENTER MEDIAN TO CREATE LEFT-TURN POCKET IN BOTH DIRECTIONS AT INTERVENING INTERSECTIONS.

JUSTIFICATION: THIS PROJECT IS NEEDED TO IMPROVE TRAFFIC FLOW AND ACCOMMODATE HIGH VOLUMES, WITHOUT WIDENING THE STREET SECTION.

SCHEDULE: DESIGN AND CONSTRUCTION WILL BE SCHEDULED WHEN FUNDING IS IDENTIFIED.

RELATIONSHIP TO GENERAL AND COMMUNITY PLANS: THIS PROJECT IS CONSISTENT WITH THE COLLEGE AREA COMMUNITY PLAN AND THE CITY'S GENERAL PLAN GUIDELINES.

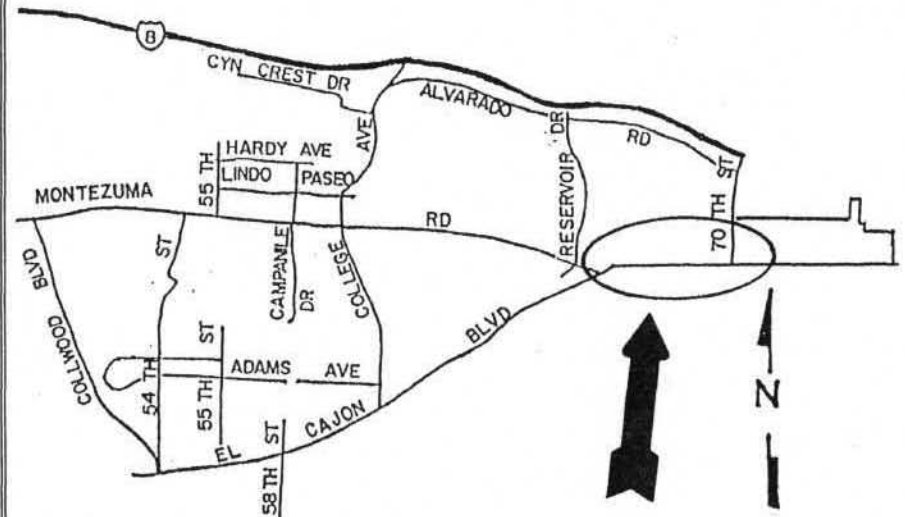

CITY OF SAN DIEGO
FACILITIES FINANCING PROGRAM

PROJECT: CA-22

COUNCIL DISTRICT: 7
COMMUNITY: COLLEGE AREA

TITLE: EL CAJON BOULEVARD AND MONTEZUMA ROAD INTERSECTION

DEPARTMENT: ENGINEERING AND DEVELOPMENT
COSTS: LAND
ENGR/CONSTR 150,000

FUNDING:	SOURCE	EXPEN/ENCUM	CONT APPROP	FY 1994	FY 1995	FY 1996	FY 1997	FY 1998	FY 1999
	150,000 UNIDENTIFIED								
	150,000 TOTAL	0	0	0	0	0	0	0	0
	L=Land Acquisition	P=Preliminary Design	D=Design	C=Construction	R=Reimbursement	F=Furnishings			

DESCRIPTION: THIS PROJECT PROVIDES FOR THE CONSTRUCTION OF A LEFT-TURN LANE FROM EASTBOUND EL CAJON BOULEVARD TO NORTHBOUND MONTEZUMA ROAD WITHIN THE EXISTING RIGHT-OF-WAY. IT ALSO PROVIDES FOR THE MODIFICATION OF THE EXISTING TRAFFIC SIGNAL AT EL CAJON BOULEVARD AND MONTEZUMA ROAD INTERSECTION.

JUSTIFICATION: THIS PROJECT WILL IMPROVE TRAFFIC FLOW AT THIS INTERSECTION.

SCHEDULE: DESIGN AND CONSTRUCTION WILL BE SCHEDULED WHEN FUNDING IS IDENTIFIED.

RELATIONSHIP TO GENERAL AND COMMUNITY PLANS: THIS PROJECT IS CONSISTENT WITH THE COLLEGE AREA COMMUNITY PLAN AND THE CITY'S GENERAL PLAN GUIDELINES.

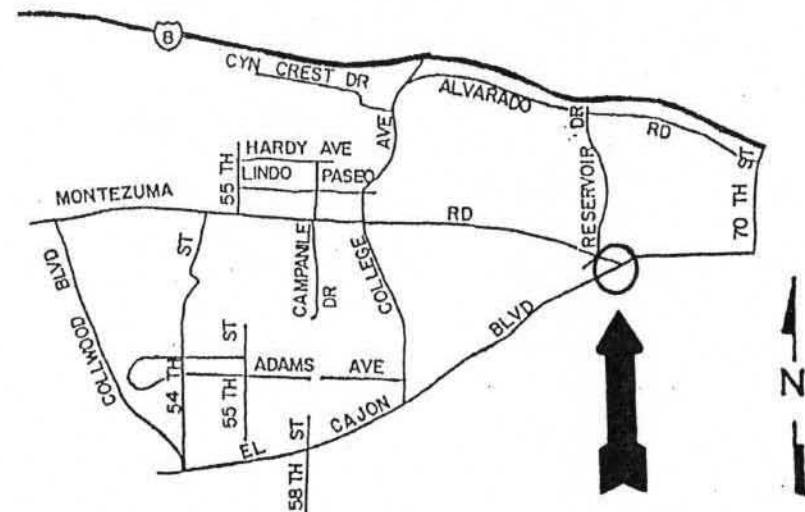

CITY OF SAN DIEGO
FACILITIES FINANCING PROGRAM

PROJECT: CA-23

COUNCIL DISTRICT: 7
COMMUNITY: COLLEGE AREA

TITLE: LINDO PASEO STORM DRAIN

DEPARTMENT: ENGINEERING AND DEVELOPMENT – STORM DRAINS/FLOOD CONTROL

COSTS: LAND
ENGR/CONSTR 57,000

FUNDING:	SOURCE	EXPEN/ENCUM	CONT APPROP	FY 1994	FY 1995	FY 1996	FY 1997	FY 1998	FY 1999	
7,000	DIF C		7,000							
50,000	CAPOUT C		50,000							
57,000	TOTAL	0	DC 57,000							
L=Land Acquisition		P=Preliminary Design		D=Design		C=Construction		R=Reimbursement		F=Furnishings

DESCRIPTION: THIS PROJECT WILL PROVIDE FOR THE DESIGN AND CONSTRUCTION OF CURB, GUTTER AND A STORM DRAIN SYSTEM ON THE NORTH SIDE OF LINDO PASEO DRIVE BETWEEN COLLEGE AVENUE AND CAMPANILE DRIVE.

JUSTIFICATION: THE EXISTING STREET SURFACE DRAINAGE SYSTEM IS INADEQUATE AND TENDS TO POND. THE PROPOSED SYSTEM WILL ALLEVIATE THESE PROBLEMS AND ALLOW FOR IMPROVED RUNOFF.

SCHEDULE: THIS PROJECT WAS SCHEDULED FOR DESIGN IN FY 1993 AND CONSTRUCTION IN FY 1994.

RELATIONSHIP TO GENERAL AND COMMUNITY PLANS: THIS PROJECT IS CONSISTENT WITH THE COLLEGE AREA COMMUNITY PLAN AND THE CITY'S GENERAL PLAN GUIDELINES.

CIP NO: 11-285.0

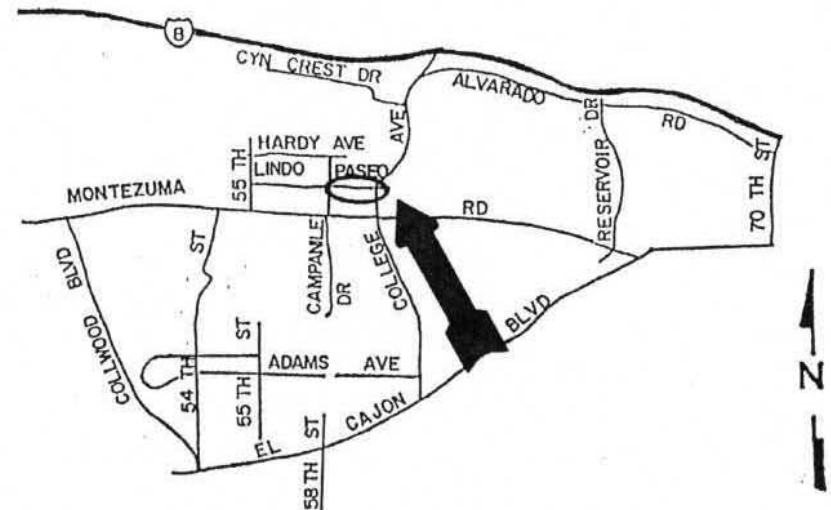

CITY OF SAN DIEGO
FACILITIES FINANCING PROGRAM

PROJECT: CA-24

COUNCIL DISTRICT: 7
COMMUNITY: COLLEGE AREA

TITLE: ADELPHI PLACE DRAIN

DEPARTMENT: ENGINEERING AND DEVELOPMENT - STORM DRAINS/FLOOD CONTROL

COSTS: LAND
ENGR/CONSTR 25,000

FUNDING:	SOURCE	EXPEN/ENCUM	CONT APPROP	FY 1994	FY 1995	FY 1996	FY 1997	FY 1998	FY 1999		
25,000	DIF C	25,000									
		DC									
25,000	TOTAL	25,000	0	0	0	0	0	0	0		
L=Land Acquisition		P=Preliminary Design		D=Design		C=Construction		R=Reimbursement		F=Furnishings	

DESCRIPTION: THIS PROJECT WILL REPLACE THE EXISTING DRAINAGE SYSTEM WITH APPROXIMATELY 100 LINEAR FEET OF 18-INCH DRAIN PIPE AT THE WESTERLY END OF ADELPHI PLACE.

JUSTIFICATION: THE EXISTING DRAINAGE SYSTEM IS NOT ADEQUATE TO MEET EXISTING AND FUTURE COMMUNITY NEEDS. THIS PROJECT WILL REDUCE REQUIRED MAINTENANCE.

SCHEDULE: DESIGN WAS COMPLETED IN FY 1993. CONSTRUCTION IS SCHEDULED FOR FY 1994.

RELATIONSHIP TO GENERAL AND COMMUNITY PLANS: THIS PROJECT IS CONSISTENT WITH THE COLLEGE AREA COMMUNITY PLAN AND THE CITY'S GENERAL PLAN GUIDELINES.

CIP NO: 11-295.0

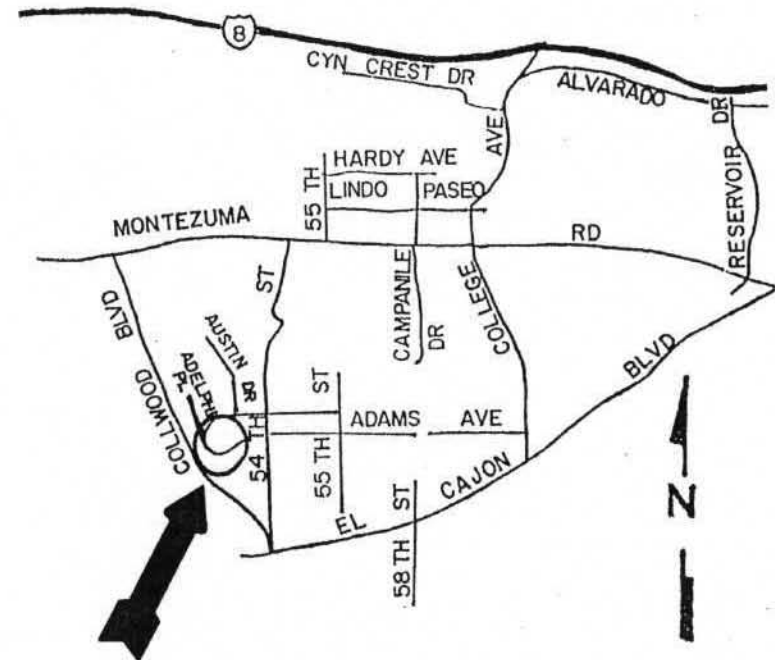

CITY OF SAN DIEGO
FACILITIES FINANCING PROGRAM

PROJECT: CA-25

COUNCIL DISTRICT: 7
COMMUNITY: COLLEGE AREA

TITLE: AUSTIN DRIVE DRAIN

DEPARTMENT: ENGINEERING AND DEVELOPMENT -- STORM DRAINS/FLOOD CONTROL

COSTS: LAND
ENGR/CONSTR 80,000

FUNDING:	SOURCE	EXPEN/ENCUM	CONT APPROP	FY 1994	FY 1995	FY 1996	FY 1997	FY 1998	FY 1999
30,000	DIF C	30,000							
50,000	TRANS C			50,000					
		DC		C					
80,000	TOTAL	30,000	0	50,000	0	0	0	0	0
L=Land Acquisition		P=Preliminary Design		D=Design	C=Construction		R=Reimbursement	F=Furnishings	

DESCRIPTION: THIS PROJECT WILL REPLACE THE EXISTING DRAINAGE SYSTEM WITH APPROXIMATELY 170 LINEAR FEET OF 18-INCH DRAIN PIPE AND ASSOCIATED STRUCTURES ADJACENT TO 4876 AUSTIN DRIVE.

JUSTIFICATION: THIS EXISTING DRAINAGE SYSTEM IS NO LONGER ADEQUATE TO MEET COMMUNITY NEEDS. THIS PROJECT WILL REDUCE REQUIRED MAINTENANCE.

SCHEDULE: DESIGN AND CONSTRUCTION ARE SCHEDULED FOR FY1994.

RELATIONSHIP TO GENERAL AND COMMUNITY PLANS: THIS PROJECT IS CONSISTENT WITH THE COLLEGE AREA COMMUNITY PLAN AND THE CITY'S GENERAL PLAN GUIDELINES.

CIP NO: 11-296.0

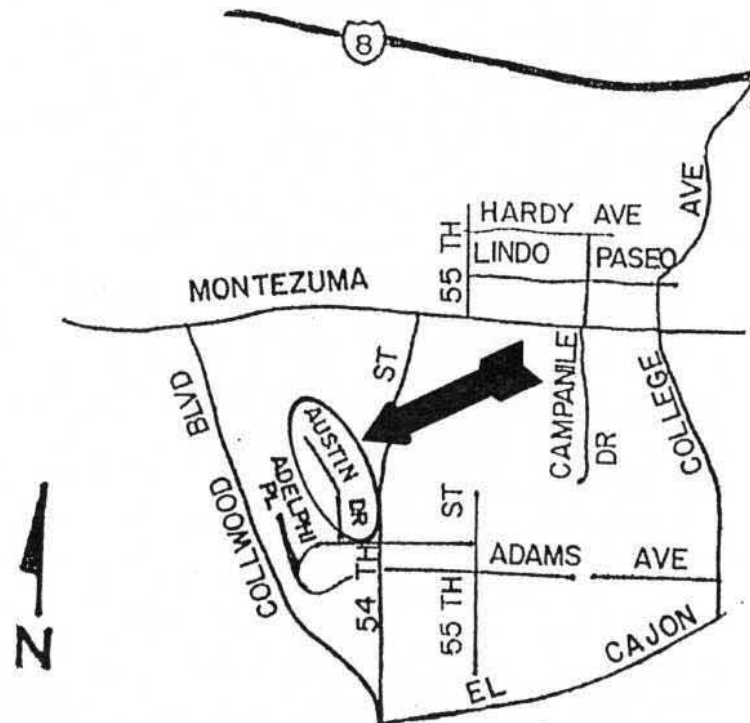

CITY OF SAN DIEGO
FACILITIES FINANCING PROGRAM

PROJECT: CA-26
COUNCIL DISTRICT: 7
COMMUNITY: COLLEGE AREA

TITLE: ARCHITECTURAL BARRIER REMOVAL

DEPARTMENT: ENGINEERING AND DEVELOPMENT
COSTS: LAND
ENGR/CONSTR 1,200,000

FUNDING:	SOURCE	EXPEN/ENCUM	CONT APPROP	FY 1994	FY 1995	FY 1996	FY 1997	FY 1998	FY 1999
	672,000 REDEVELOPMNT								
	528,000 UNIDENTIFIED								
	1,200,000 TOTAL	0	0	0	0	0	0	0	0
		L=Land Acquisition	P=Preliminary Design	D=Design	C=Construction	R=Reimbursement	F=Furnishings		

DESCRIPTION: THIS PROJECT PROVIDES FOR THE CONSTRUCTION OF 900 PEDESTRIAN RAMPS AT VARIOUS LOCATION THROUGHOUT THE COMMUNITY.

JUSTIFICATION: THE PHYSICALLY DISABLED, VISUALLY DISABLED AND MANY SENIOR CITIZENS FIND THEIR MOBILITY RESTRICTED BY CURBS WHICH THEY FIND DIFFICULT OR IMPOSSIBLE TO NEGOTIATE.

SCHEDULE: DESIGN AND CONSTRUCTION WILL BE SCHEDULED AS REDEVELOPMENT OCCURS AND FUNDING IS IDENTIFIED.

RELATIONSHIP TO GENERAL AND COMMUNITY PLANS: THIS PROJECT IS CONSISTENT WITH THE COLLEGE AREA COMMUNITY PLAN AND THE CITY'S GENERAL PLAN GUIDELINES.

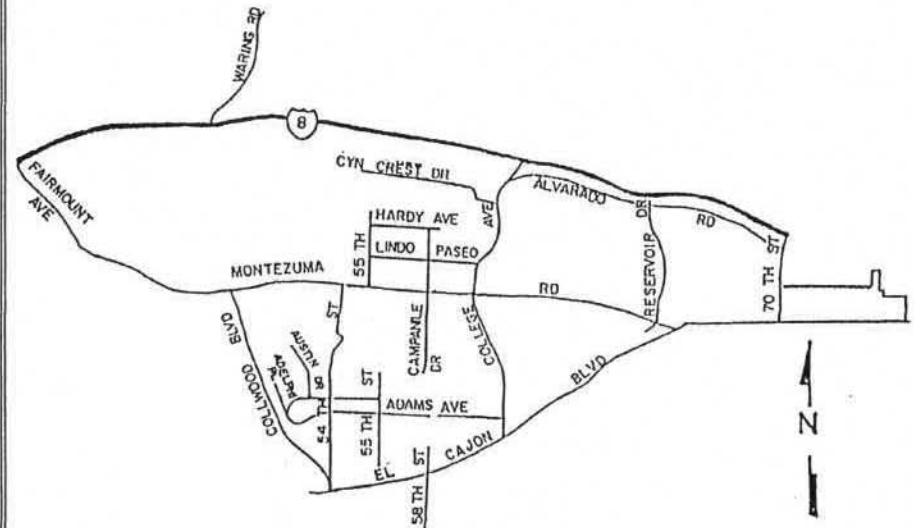

CITY OF SAN DIEGO
FACILITIES FINANCING PROGRAM

PROJECT: CA-27

COUNCIL DISTRICT: 7
COMMUNITY: COLLEGE AREA

TITLE: STORM DRAINS

DEPARTMENT: ENGINEERING AND DEVELOPMENT
COSTS: LAND
ENGR/CONSTR 2,200,000

FUNDING:	SOURCE	EXPEN/ENCUM	CONT APPROP	FY 1994	FY 1995	FY 1996	FY 1997	FY 1998	FY 1999	
2,200,000	UNIDENTIFIED									
2,200,000	TOTAL	0	0	0	0	0	0	0	0	
L=Land Acquisition		P=Preliminary Design		D=Design		C=Construction		R=Reimbursement		F=Furnishings

DESCRIPTION: INSTALL, RECONSTRUCT AND UPGRADE STORM DRAINS AT VARIOUS LOCATIONS THROUGHOUT THE COMMUNITY.

JUSTIFICATION: IMPROVED DRAINAGE AT VARIOUS LOCATIONS IS REQUIRED.

SCHEDULE: DESIGN AND CONSTRUCTION WILL BE SCHEDULED AS REDEVELOPMENT OCCURS AND FUNDING IS IDENTIFIED.

RELATIONSHIP TO GENERAL AND COMMUNITY PLANS: THIS PROJECT IS CONSISTENT WITH THE COLLEGE AREA COMMUNITY PLAN AND THE CITY'S GENERAL PLAN GUIDELINES.

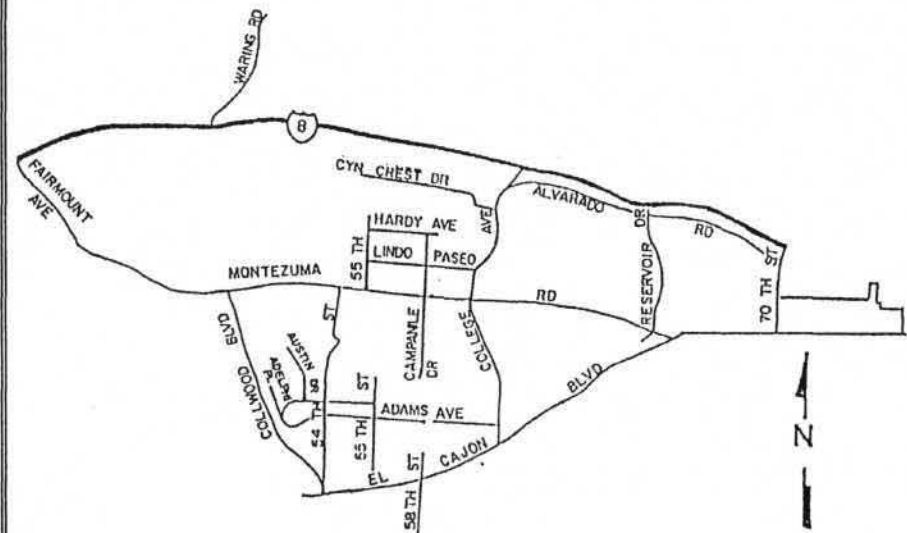

CITY OF SAN DIEGO
FACILITIES FINANCING PROGRAM

PROJECT: CA-28

COUNCIL DISTRICT: 7
COMMUNITY: COLLEGE AREA

TITLE: 55TH STREET – HARDY AVENUE TO REMINGTON ROAD

DEPARTMENT: ENGINEERING AND DEVELOPMENT – STREETS

COSTS: LAND 500,000
ENGR/CONSTR 400,000

FUNDING:	SOURCE	EXPEN/ENCUM	CONT APPROP	FY 1994	FY 1995	FY 1996	FY 1997	FY 1998	FY 1999	
900,000	SDSU									
900,000	TOTAL	0	0	0	0	0	0	0	0	
L=Land Acquisition		P=Preliminary Design		D=Design		C=Construction		R=Reimbursement		F=Furnishings

DESCRIPTION: THIS PROJECT PROVIDES FOR THE WIDENING OF 55TH STREET TO A FOUR-LANE COLLECTOR FROM HARDY AVENUE TO REMINGTON ROAD. THE WIDENING REQUIRES RIGHT-OF-WAY ACQUISITION AND EXISTING STRUCTURE REMOVAL. THE INSTALLATION OF TRAFFIC SIGNALS AT HARDY AVENUE AND REMINGTON ROAD ARE NOT INCLUDED WITH THIS PROJECT.

JUSTIFICATION: THIS PROJECT IS REQUIRED TO MITIGATE THE EFFECTS OF CONSTRUCTING THE STUDENT ACTIVITY CENTER. IT HAS ALSO BEEN IDENTIFIED AS A MITIGATION PROJECT IN THE COLLEGE AREA REDEVELOPMENT PLAN.

SCHEDULE: DESIGN AND CONSTRUCTION WILL BE SCHEDULED TO COINCIDE WITH CONSTRUCTION OF THE STUDENT ACTIVITY CENTER.

RELATIONSHIP TO GENERAL AND COMMUNITY PLANS: THIS PROJECT IS CONSISTENT WITH THE COLLEGE AREA COMMUNITY PLAN AND THE CITY'S GENERAL PLAN GUIDELINES.

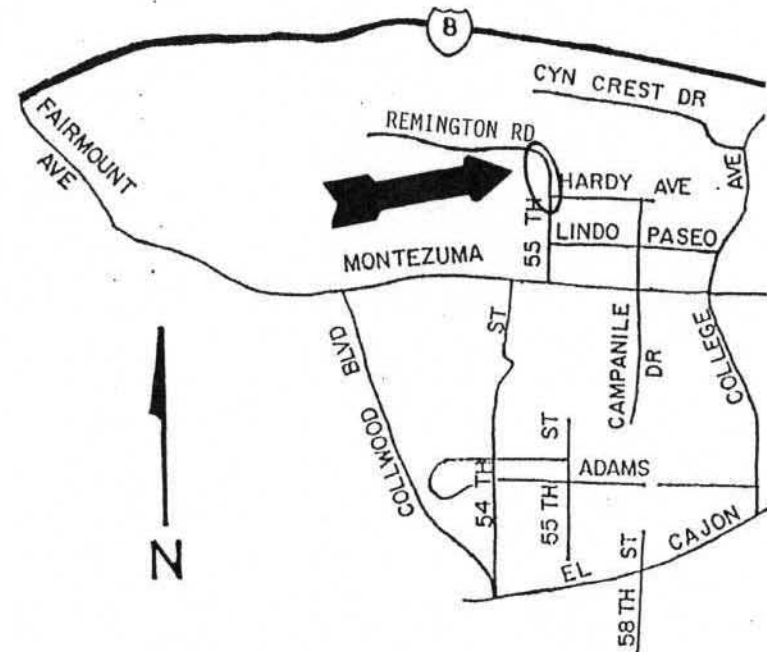

CITY OF SAN DIEGO
FACILITIES FINANCING PROGRAM

PROJECT: CA-29
COUNCIL DISTRICT: 7
COMMUNITY: COLLEGE AREA

TITLE: 55TH STREET AND REMINGTON ROAD: TRAFFIC SIGNAL

DEPARTMENT: ENGINEERING AND DEVELOPMENT - STREETS
COSTS: LAND
ENGR/CONSTR 110,000

FUNDING:	SOURCE	EXPEN/ENCUM	CONT APPROP	FY 1994	FY 1995	FY 1996	FY 1997	FY 1998	FY 1999
110,000	SDSU								
110,000	TOTAL	0	0	0	0	0	0	0	0

L=Land Acquisition P=Preliminary Design D=Design C=Construction R=Reimbursement F=Furnishings

DESCRIPTION: THIS PROJECT WILL PROVIDE FOR THE INSTALLATION OF A NEW TRAFFIC SIGNAL AT 55TH STREET AND REMINGTON ROAD.

JUSTIFICATION: THIS PROJECT IS REQUIRED TO MITIGATE THE EFFECTS OF CONSTRUCTING THE STUDENT ACTIVITY CENTER. IT HAS ALSO BEEN IDENTIFIED AS A MITIGATION PROJECT IN THE COLLEGE AREA REDEVELOPMENT PLAN.

SCHEDULE: DESIGN AND CONSTRUCTION WILL BE SCHEDULED TO COINCIDE WITH CONSTRUCTION OF THE STUDENT ACTIVITY CENTER.

RELATIONSHIP TO GENERAL AND COMMUNITY PLANS: THIS PROJECT IS CONSISTENT WITH THE COLLEGE AREA COMMUNITY PLAN AND THE CITY'S GENERAL PLAN GUIDELINES.

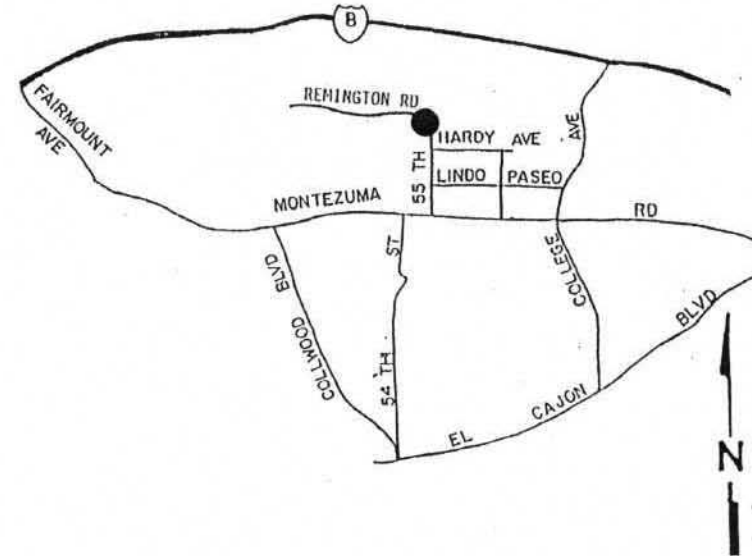

CITY OF SAN DIEGO
FACILITIES FINANCING PROGRAM

PROJECT: CA-30
COUNCIL DISTRICT: 7
COMMUNITY: COLLEGE AREA

TITLE: **CHAPARRAL WAY DRAIN – NORTH OF BAJA DRIVE**

DEPARTMENT: ENGINEERING AND DEVELOPMENT – STREETS

COSTS: LAND
ENGR/CONSTR 120,000

FUNDING:	SOURCE	EXPEN/ENCUM	CONT APPROP	FY 1994	FY 1995	FY 1996	FY 1997	FY 1998	FY 1999
120,000	TRANS C	15,000	105,000						
120,000	TOTAL	DC 15,000	DC 105,000	0	0	0	0	0	0

L=Land Acquisition P=Preliminary Design D=Design C=Construction R=Reimbursement F=Furnishings

DESCRIPTION: THIS PROJECT WILL CONSTRUCT 84 LINEAR FEET OF 18-INCH REINFORCED CONCRETE PIPE AND ASSOCIATED CLEANOUTS AND INLETS ON CHAPARRAL WAY NORTH OF BAJA DRIVE.

JUSTIFICATION: THIS PROJECT WILL UNDERGROUND THE EXISTING STREET SURFACE DRAINAGE SYSTEM, ELIMINATING POTENTIAL STREET FLOODING.

SCHEDULE: DESIGN OF THIS PROJECT WAS COMPLETED IN FY 1993; CONSTRUCTION IS SCHEDULED FOR FY 1994.

RELATIONSHIP TO GENERAL AND COMMUNITY PLANS: THIS PROJECT IS CONSISTENT WITH THE COLLEGE AREA COMMUNITY PLAN AND THE CITY'S GENERAL PLAN GUIDELINES.

CIP NO: 11-251.0

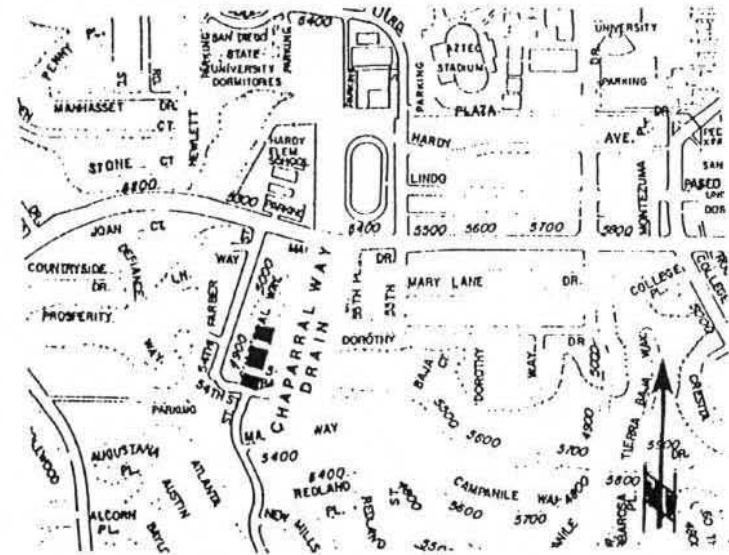

CITY OF SAN DIEGO
FACILITIES FINANCING PROGRAM

PROJECT: CA-A

COUNCIL DISTRICT: 7
COMMUNITY: COLLEGE AREA

TITLE: MISSION VALLEY EAST LRT EXTENSION

DEPARTMENT: ENGINEERING AND DEVELOPMENT - STREETS
COSTS: LAND
ENGR/CONSTR 94,000,000

FUNDING:	SOURCE	EXPEN/ENCUM	CONT APPROP	FY 1995	FY 1996	FY 1997	FY 1998	FY 1999	FY 2000
34,320,000	FEDERAL		227,888	1,974,258	5,410,548	7,275,840	8,923,200	8,923,200	1,585,066
5,060,000	STATE		30,702	266,858	713,822	946,050	1,160,250	1,160,250	782,068
4,620,000	TRANSNET		260,985		428,224	918,490	1,126,450	1,126,450	759,401
50,000,000	UNFUNDED			1,000,000	4,000,000	10,000,000	15,000,000	18,000,000	2,000,000
94,000,000	TOTAL		519,575	3,241,116	10,552,594	19,140,380	26,209,900	29,209,900	5,126,535

L=Land Acquisition P=Preliminary Design D=Design C=Construction R=Reimbursement F=Furnishings

DESCRIPTION: THIS PROJECT PROVIDES FOR THE CONSTRUCTION OF THE MISSION VALLEY EAST LIGHT RAIL TRANSIT LINE AT AN ESTIMATED TOTAL COST OF \$305,000,000. THE SDSU SEGMENT, AT A COST OF \$94,000,000, INCLUDES A LOOP ALIGNMENT THROUGH THE SDSU CAMPUS.

JUSTIFICATION: THIS PROJECT REFLECTS THE SHARE OF COSTS ATTRIBUTABLE TO THE COLLEGE AREA.

SCHEDULE: CONSTRUCTION IS SCHEDULED FOR THE YEARS 1998-2001.

RELATIONSHIP TO GENERAL AND COMMUNITY PLANS: THIS PROJECT IS CONSISTENT WITH THE COLLEGE AREA COMMUNITY PLAN AND THE CITY'S GENERAL PLAN GUIDELINES.

