

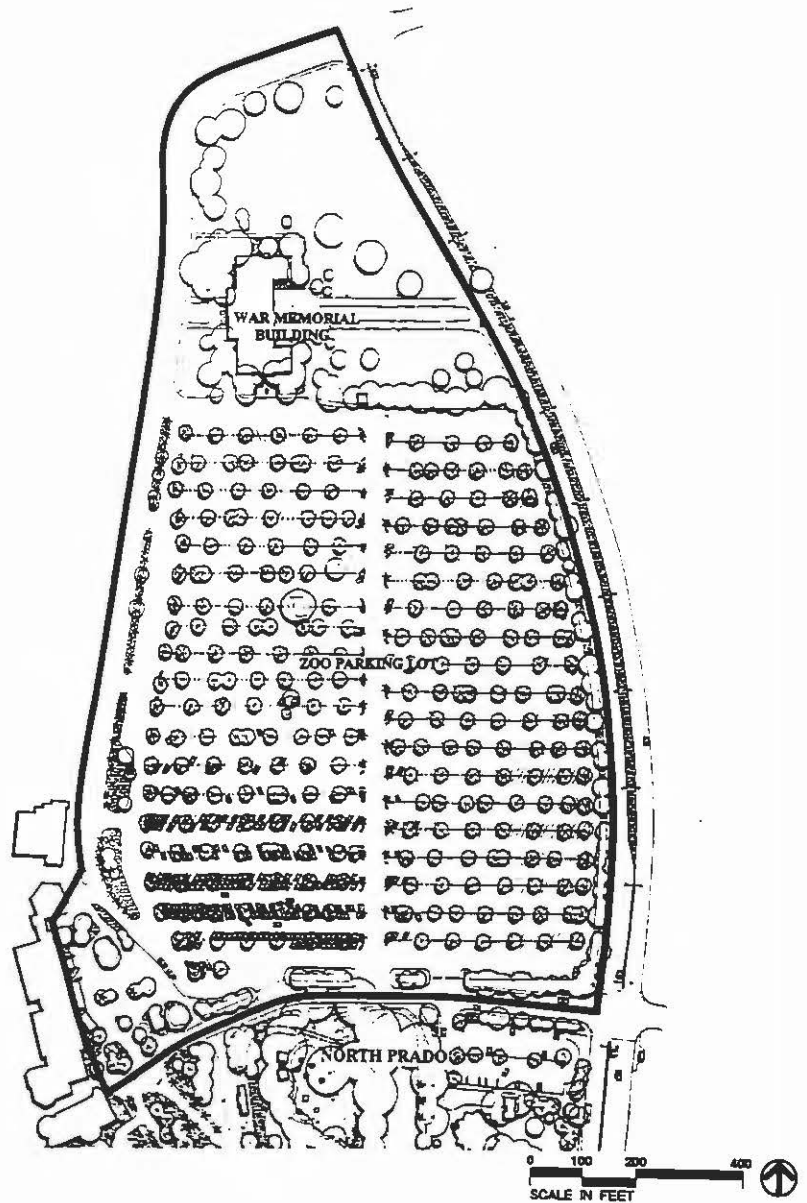

War Memorial and Zoo Parking Lot



Site Amenities:

- Prado Light Standard: Western Lighting Standards Capistrano Series CA10 (or equal). Custom fixture as shown in Appendix. Color shall be Frazee Shutter Green 6125N gloss enamel.
- Park Concrete Trash Receptacle: Dura Art Stone cast stone trash receptacle, D-round, nordic cream color with light sand blast finish, order number: S-TR-D-S-13-LSD (or equal) with 22" diameter, 36" height. Matching Ash Urn (at building entries only) order number: S-AU-D-S-13-LSB (or equal) with 14" diameter, 22" height. See Appendix.



1. Zoo Parking Lot

Design Objective:

Install additional landscaping within the Zoo parking lot to comply with the San Diego City Landscape Ordinance.

The Zoo shall bring the public parking lot within its leasehold into compliance with Chapter X, Division 7, of the Municipal Code, entitled "City-Wide Landscape Regulations," whenever the Zoo:

1. Initiates any project to reconfigure or re-stripe the parking lot which results in an increase in the number of parking spaces within the existing boundaries of the present parking lot; or
2. Is required by virtue of the City's established permitting processes to bring the existing parking lot into compliance with Chapter X, Division 7, of the Municipal Code if any project initiated by the Zoo within its leasehold triggers the requirement to add additional parking to the existing public parking lot.

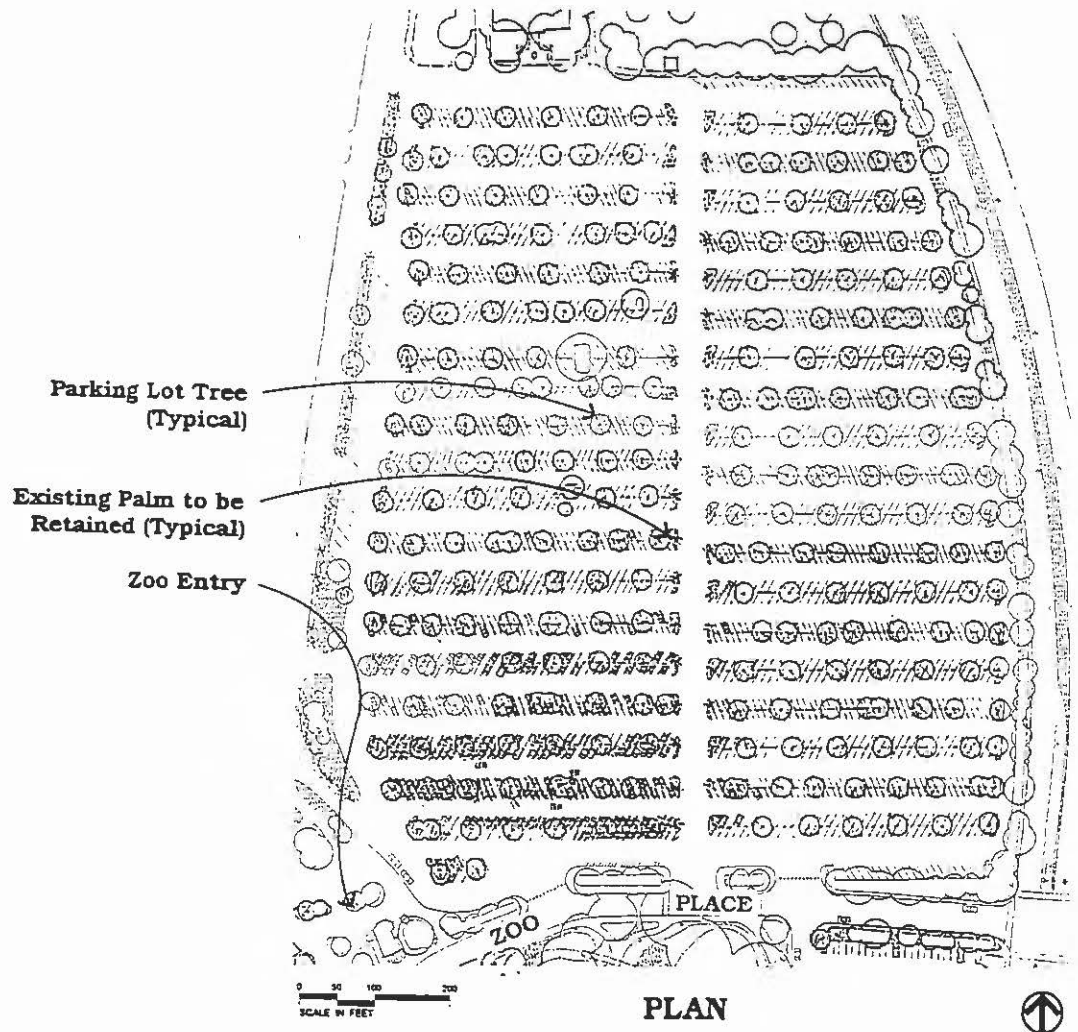



Recommendations:

- Install plant materials that harmonize with existing architectural and landscape themes.
- Plant trees in irregular, informal groupings to continue the effect of existing tree patterns.

Parking Lot Trees:

Tristania conferta - Brisbane Box

Eucalyptus melliodora - Honey Scented Gum



2. War Memorial Building and Lawns

Design Objective:

Reconstruct the south entry walkway to the War Memorial Building.

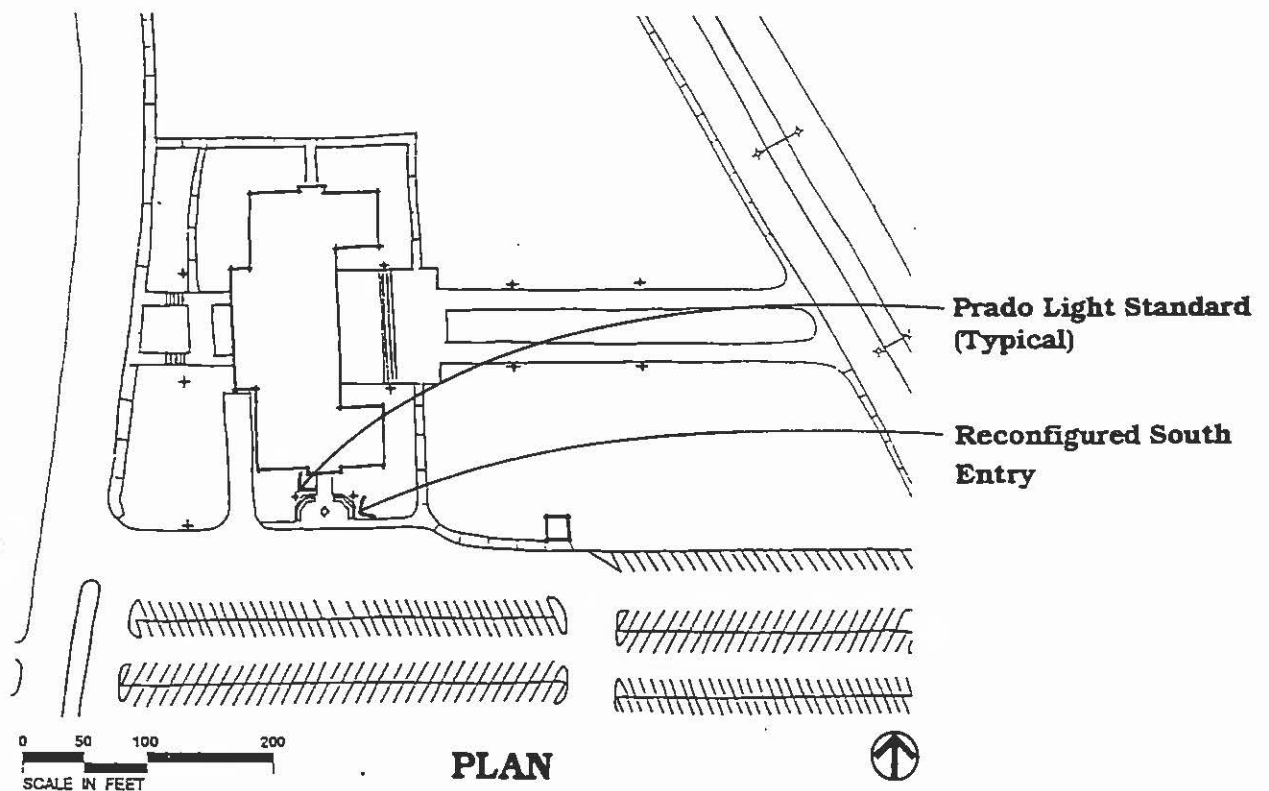

Recommendations:

- Construct a decorative concrete walkway and landscaped pedestrian pooling area on the southern entry to the building.
- Add lights as shown on the plan.



Pepper Grove

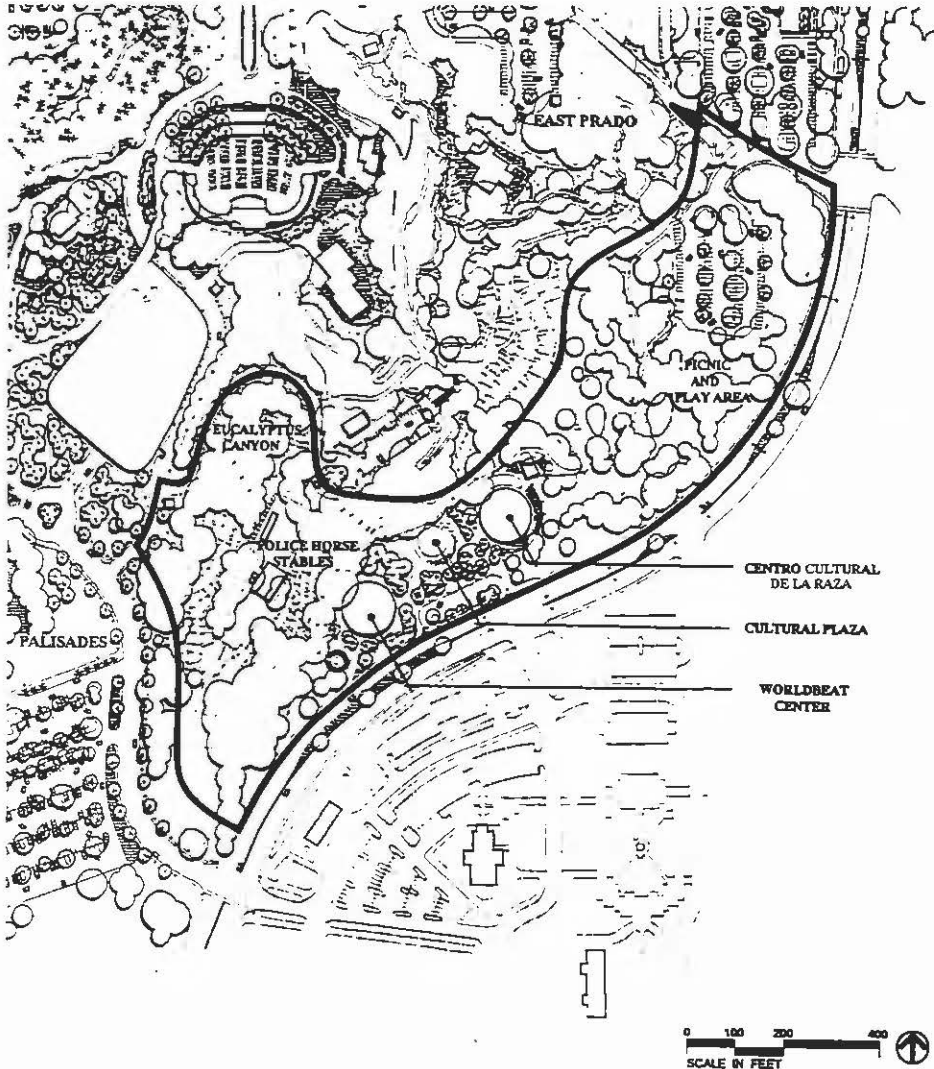

Site Amenities:

Pepper Grove Picnic Area:

- Prado Light Standard: Western Lighting Standards Capistrano Series CA10 (or equal). Custom fixture as shown in Appendix. Color shall be Frazee Shutter Green 6125N gloss enamel.
- Park Concrete Bench: Dura Art Stone cast stone S-6B bench, epoxy adhesive installed, nordic cream color, sacked smooth finish, order number: S-6B-E-S-13-SK (or equal). 24" wide, 17" height, 72" long. See Appendix.



- Park Concrete Trash Receptacle: Dura Art Stone cast stone trash receptacle, D-round, nordic cream color with light sand blast finish, order number: S-TR-D-S-13-LSD (or equal) with 22" diameter, 36" height. Matching Ash Urn (at building entries only) order number: S-AU-D-S-13-LSB (or equal) with 14" diameter, 22" height. See Appendix.

Cultural Plaza:

- Prado Light Standard: Western Lighting Standards Capistrano Series CA10 (or equal). Custom fixture as shown in Appendix. Color shall be Frazee Shutter Green 6125N gloss enamel.
- Palisades Drinking Fountain: Haws Pedestal model #3353 (or equal) with receptor and pedestal in stainless steel with #4 satin finish. Haws Wheelchair accessible pedestal model #3180 (or equal) with outdoor pedestal fountain with built-in sandtrap. See Appendix.
- Palisades Trash Receptacle: Woodcrafters of Florida, Inc.; Heavy Metal Collection trash receptacle model #HTC-2631 (or equal) with 26" diameter, 31" height, 110 lb. weight, color D-70. Lid with lift and swing mechanism and locking device. See Appendix.
- Palisades Tree Grate: Urban Accessories cast iron tree grate model "Standard Flats" (or equal). Round or square shape and size to be determined. See Appendix.

Signage:

Pepper Grove Picnic Area:

- Prado Pedestrian Orientation Sign Standards: Western Lighting Standards Mini Capistrano series as shown in Appendix (or equal). Color shall be Frazee Shutter Green 6125N gloss enamel or equal.

Cultural Plaza:

- Palisades Pedestrian Orientation Sign Standards: Western Lighting Standards custom design as shown in Appendix (or equal). Brushed aluminum finish.



1. Pepper Grove Picnic Area

Design Objective:

Refurbish and improve Pepper Grove picnic area and playgrounds.

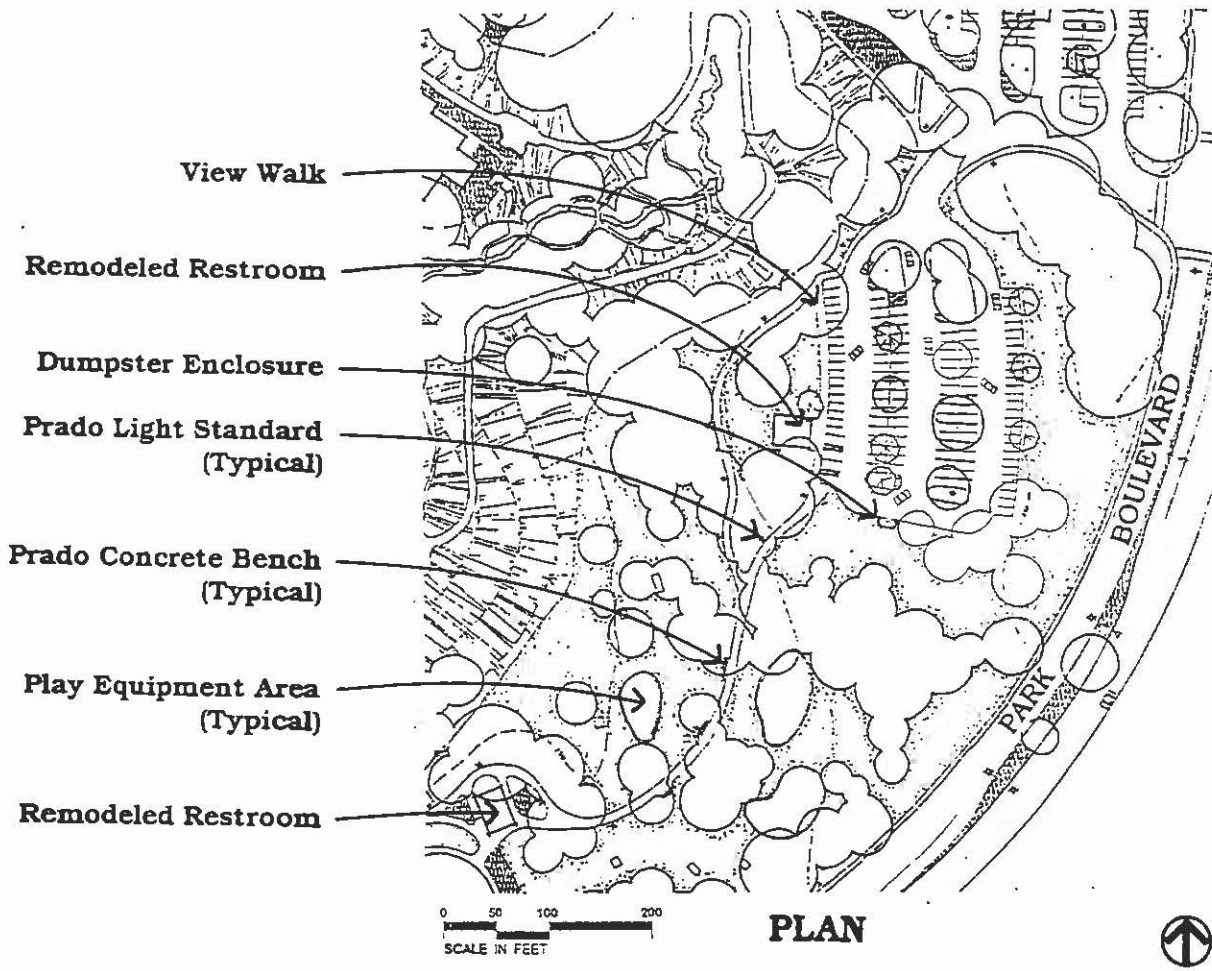

Recommendations:

- Construct a new pedestrian walkway to the west of the restroom structure focusing views into the proposed Japanese Garden.
- Ensure that Japanese Garden fencing is located below the sightline of the walkway.
- Redesign restrooms for increased lighting, ventilation, architectural detailing, and provide visitor amenities as outlined in the building rehabilitation guidelines.
- Screen trash dumpsters with a enclosure that harmonizes with Central Mesa architecture.
- Upgrade children’s play equipment.
- Trim the existing tree canopy to provide more light to the picnic area.



2. Cultural Plaza*

Design Objective:

Create a new multi-use plaza between the Centro Cultural de la Raza and the Worldbeat Center.

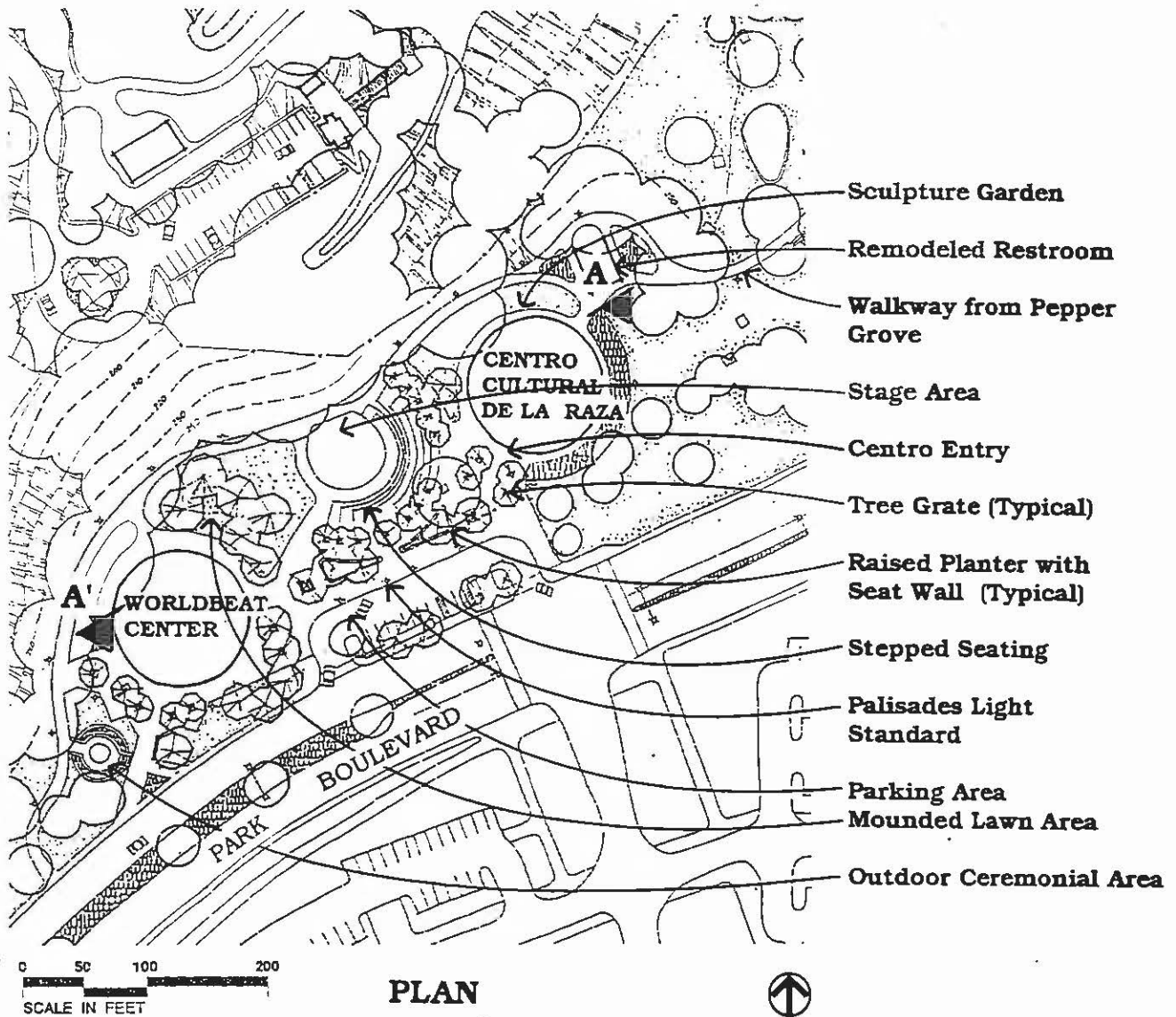

* proposed name for a new feature.



Recommendations:

- Provide a drop-off loading and disabled parking area.
- Provide a pedestrian crossing at Park Boulevard with a traffic signal and enhanced paving to provide safe access to and from the Inspiration Point parking lots.
- Provide a central performance area that incorporates monumental step seating and raised planters that can accommodate seating.
- Maintain views to existing and proposed water tank murals from Park Boulevard.
- Construct a small outdoor ceremonial area southwest of Worldbeat Center.
- Construct a small outdoor sculpture garden area west of Centro Cultural de la Raza.

Plaza Tree: Jacaranda mimosifolia - Jacaranda

Lawn Tree: Eucalyptus citriodora - Lemon Scented Gum

Accent Tree: Erythrina coralloides - Mexican Coral Tree

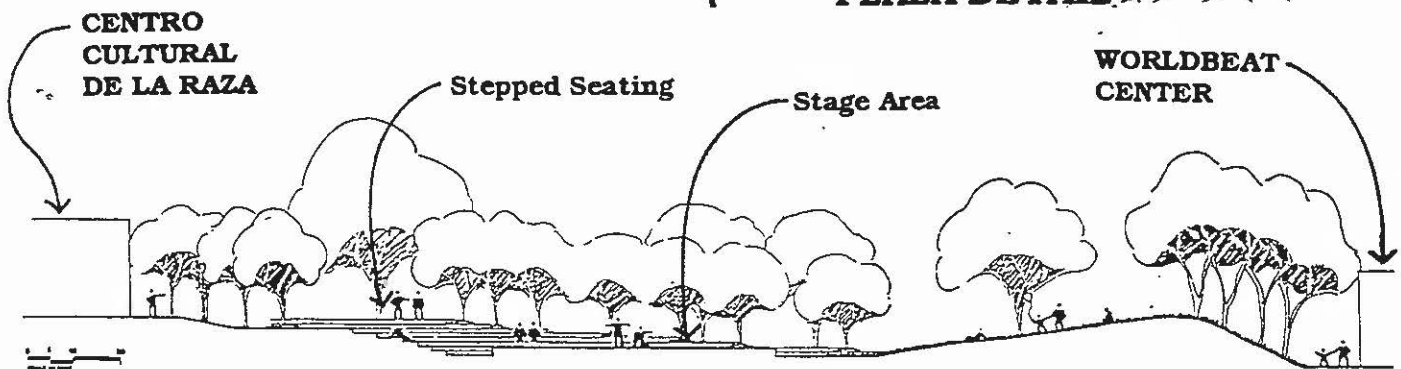
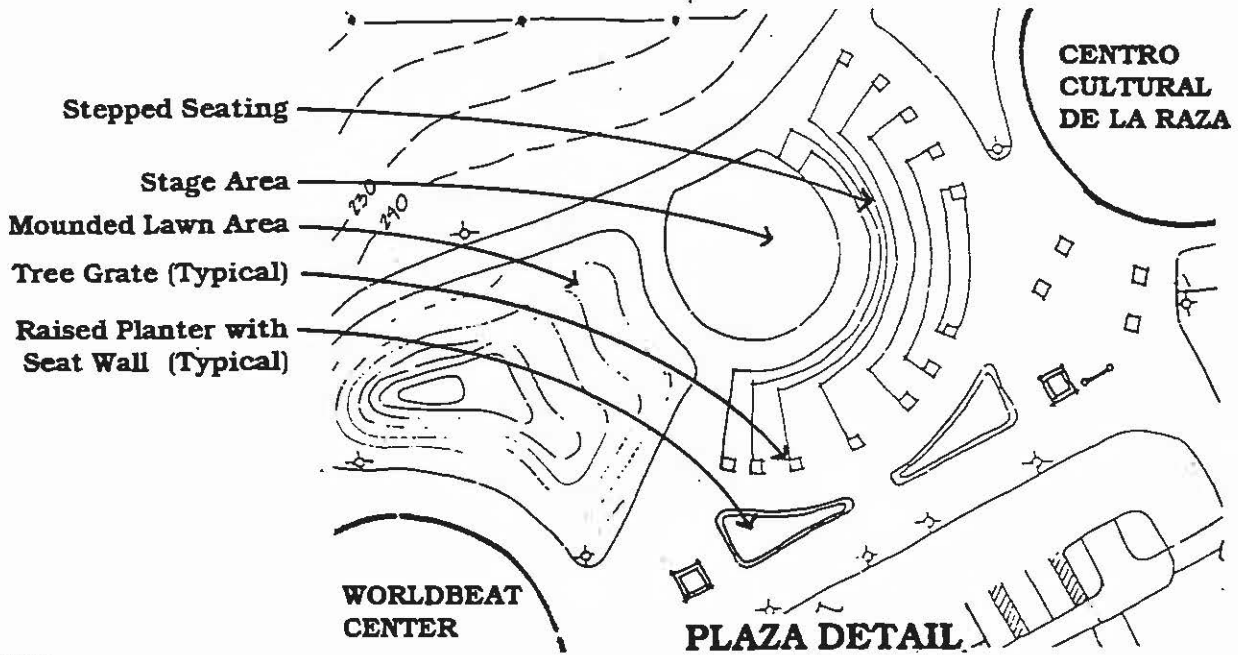

SECTION A-A'



3. Presidents Way Entry

Design Objective:

Create a formal entry experience to the Palisades from Park Boulevard that coordinates with the proposed Inspiration Point design.

Recommendations:

- Conduct a focus study on the Park Boulevard streetscape after the future light rail route from downtown to Mission Valley has been determined.
- Allow for the future installation of a pedestrian overpass crossing Park Boulevard in the vicinity of Presidents Way to connect Inspiration Point with the Central Mesa.



4. Eucalyptus Canyon

Design Objective:

Enhance the existing Australian Garden at the southern portion of Gold Gulch.

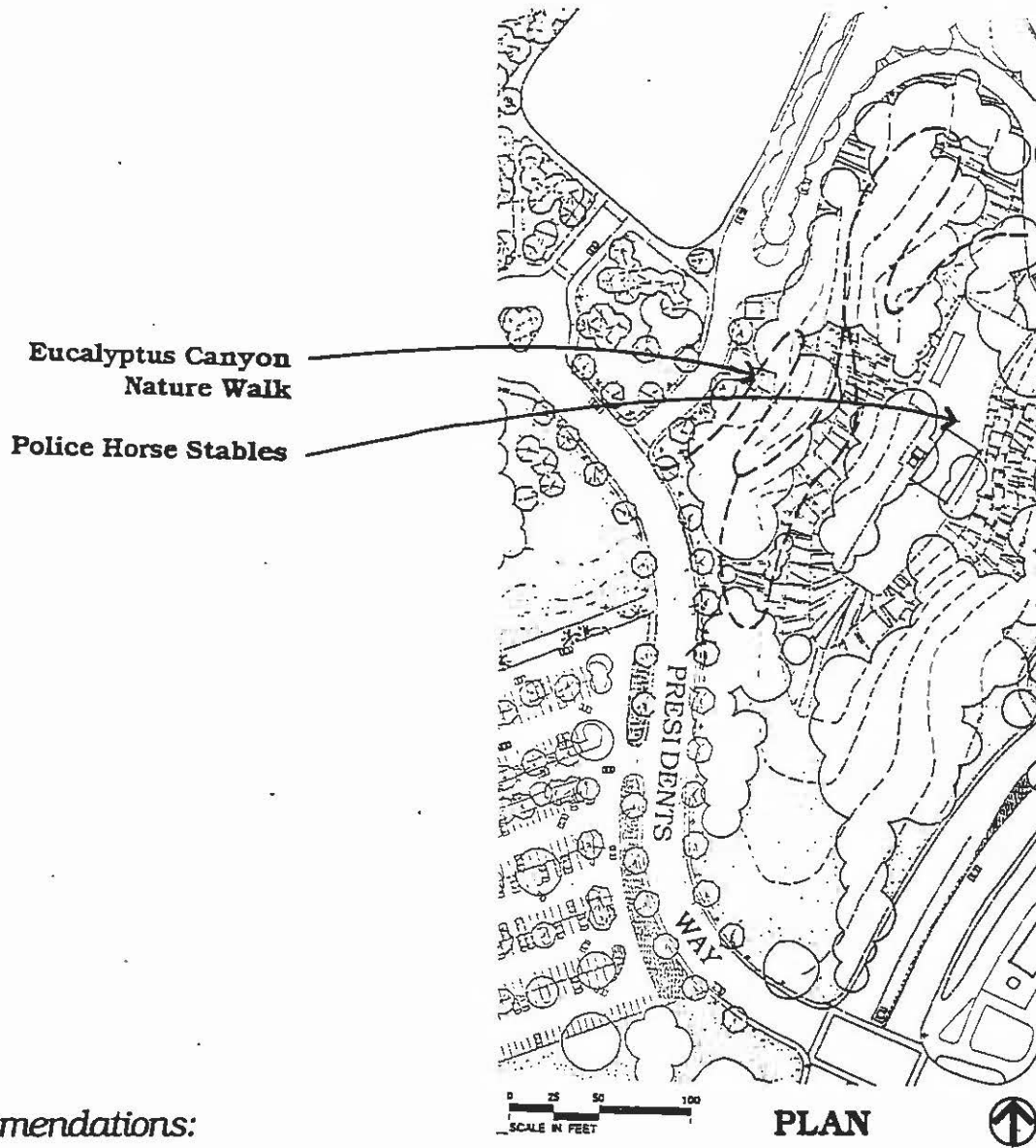

Recommendations:

- Enhance and stabilize the existing path system.
- Introduce new planting under the guidance of the Park horticulturist.
- Provide new interpretive signage and develop self guided interpretive literature.
- Relocate the existing Police Horse Stables if an alternative location can be found. The area should then be revegetated to reflect the surrounding natural environment.



Palisades



Site Amenities:

- Palisades Light Standard: Western Light Standards with custom 10' pole and 17" diameter base fixture (or equal). Brushed aluminum finish. See Appendix.
- Palisades Drinking Fountain: Haws Pedestal model #3353 (or equal) with receptor and pedestal in stainless steel with #4 satin finish. Haws Wheelchair accessible pedestal model #3180 (or equal) with outdoor pedestal fountain with built-in sandtrap. See Appendix.
- Palisades Bench (2): (1) Landscape Forms Gretchen's Bench of Jarrah wood with back and armrest style supports in 72" or 96" length, model #GR3005-BA-length to be determined (or equal). (2) Gretchen's Bench of Jarrah wood freestanding style support in 72" or 96" length, model #GR 3005-FS-length to be determined (or equal). See Appendix.



- Plaza Chair: Wesnic Food Court Furniture, Bentwood III side chairs, with mesh seat and Fan Back, model #302 (or equal). See Appendix.
- Palisades Plaza Table: Falcon Table Base model #4404-UH (or equal) with cast iron base, 18 ga. 3" steel tubing, rubber cushion glides, 15" cast iron spider, 22" diameter base spread, 28.5" overall height. 36" round marble table top available through distributor. California Umbrella with 1-1/4" diameter pole available through Sunstar Bistro. See Appendix.
- Palisades Trash Receptacle: Woodcrafters of Florida, Inc.; Heavy Metal Collection trash receptacle model #HTC-2631 (or equal) with 26" diameter, 31" height, 110 lb. weight, color D-70. Lid with lift and swing mechanism and locking device. See Appendix.
- Palisades Tree Grate: Urban Accessories cast iron tree grate model "Standard Flats" (or equal). Round or square shape and size to be determined. See Appendix.

Signage:

- Palisades Tram Stop Sign Standard: Western Lighting Standards custom design as shown in Appendix (or equal). Brushed aluminum finish.
- Prado Pedestrian Orientation Sign Standards: Western Lighting Standards Mini Capistrano series as shown in Appendix (or equal). Color shall be Frazee Shutter Green 6125N gloss enamel or equal.
- Palisades Pedestrian Orientation Sign Standards: Western Lighting Standards custom design as shown in Appendix (or equal). Brushed aluminum finish.



1. House of Pacific Relations

Design Objective:

Preserve the wooded secluded quality of the village, enhance pedestrian enjoyment of the area and provide pedestrian access to the proposed additional cottages.

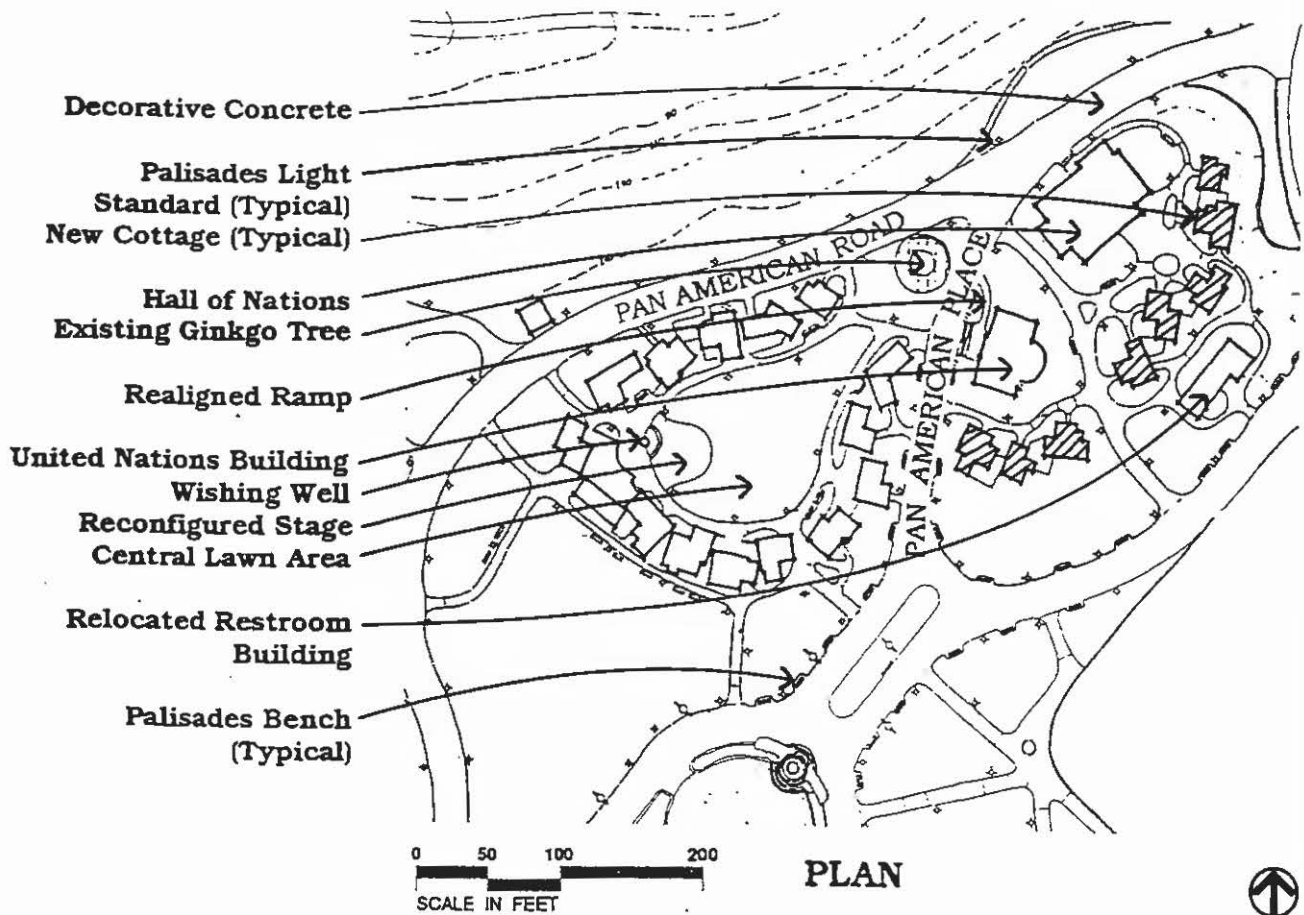

Recommendations:

- Reconfigure the existing concrete performance platform as shown on the plan. Supply the platform with electrical service for sound and lighting equipment. Preserve the wishing well in present location.
- Provide new pedestrian walkways to proposed new cottages as shown on the plan.
- Remove the non-historic House of Japan and relocate the organization in a new cottage within the Village.
- Locate all new cottages and walkways in a way that preserves existing plant material as much as possible.
- Replace asphalt on Pan American Road and Pan American Place with decorative concrete to visually define them as pedestrian walkways.



2. Organ Pavilion Pedestrian Overpass*

Design Objective:

Separate vehicular and pedestrian circulation by constructing a pedestrian overpass which links the Prado and Palisades. Bring the roadway underneath to connect the Prado with Presidents Way through or around the new parking garage.

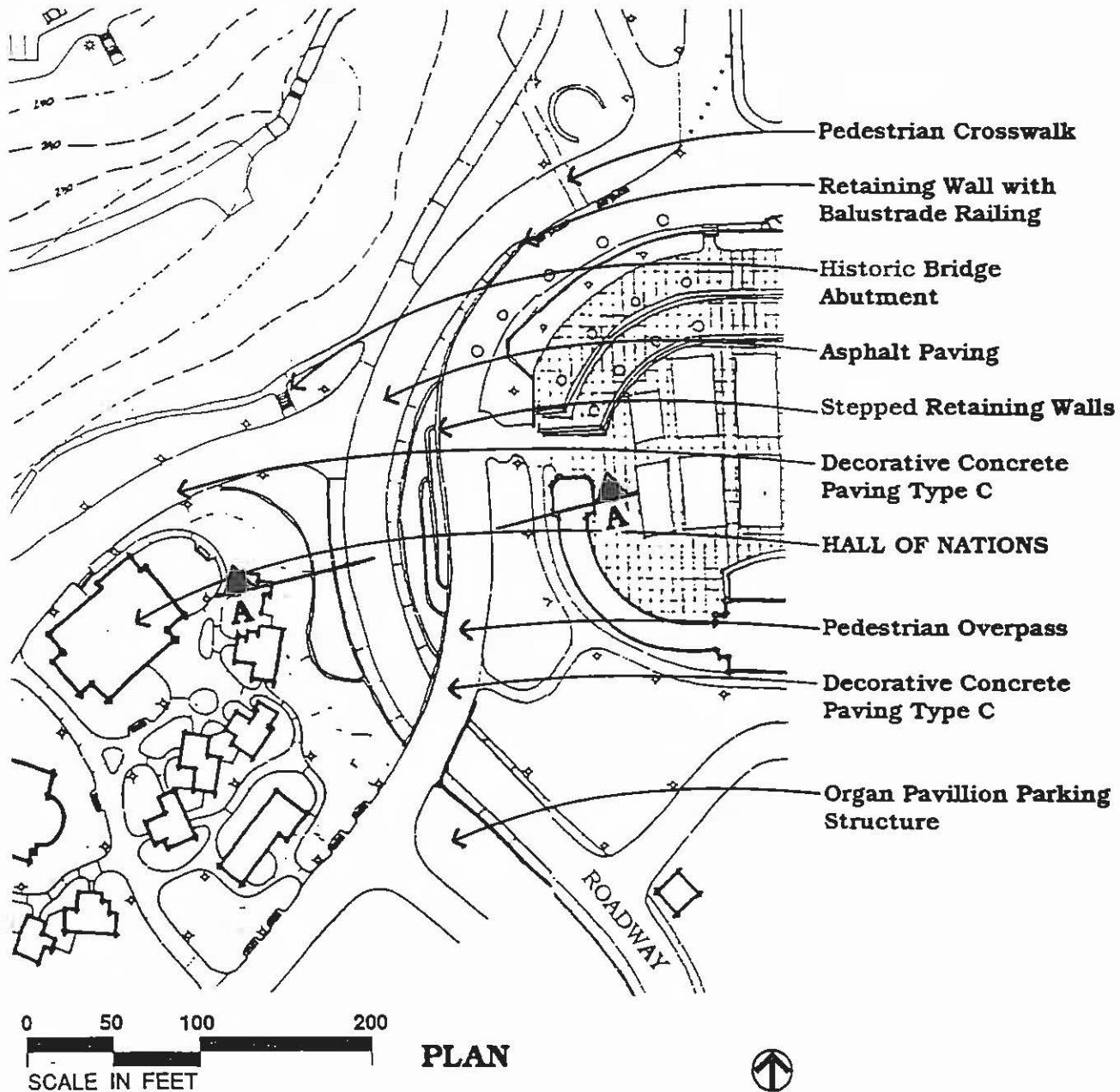

* proposed name for a new feature



Recommendations:

- Create stepped retaining walls and planters on slopes.
- Use an aesthetically pleasing wall treatment to complement existing architecture.
- Use shrubs, trees and vines to soften the retaining walls.
- Provide walkways along road underpass.
- Use architecturally compatible balustrades along the pedestrian bridge.
- Light both the bridge and the underpass area extensively.
- Light fixtures on bridge balustrades should be similar to those on Cabrillo Bridge.
- Preserve the historic palm canyon bridge abutment during relocation of historic restroom and regrading of road.

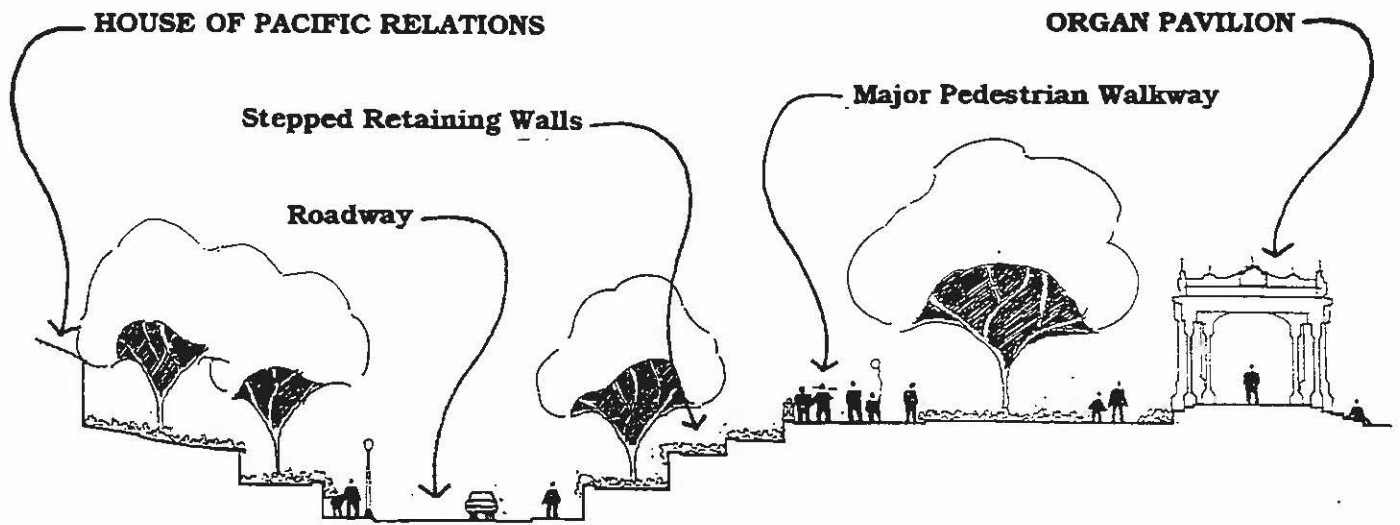

SECTION A-A'



3. *Organ Pavilion Parking Garage Plaza**

Design Objective:

Create a landscaped rooftop plaza on top of the proposed parking structure.

Recommendations:

- Conduct a design competition to determine the shape of the plaza and its underlying parking structure. Some features which should be incorporated into the plaza are:
 - Perimeter viewing areas overlooking the Japanese Garden, the Palisades plazas and the city beyond.
 - An open staging area that could be tented for festivals or be equipped with booths and displays for outdoor exhibits.
 - Special event staging equipment and storage.
 - Appropriate Palisades lighting and site amenities.
 - Slopes graded to meet and cover the northwest edge of the structure.

*proposed name for a new feature.



4. Pan American Promenade*

Design Objective:

Connect the Organ Pavilion pedestrian overpass with the Palisades by creating a new pedestrian walkway.

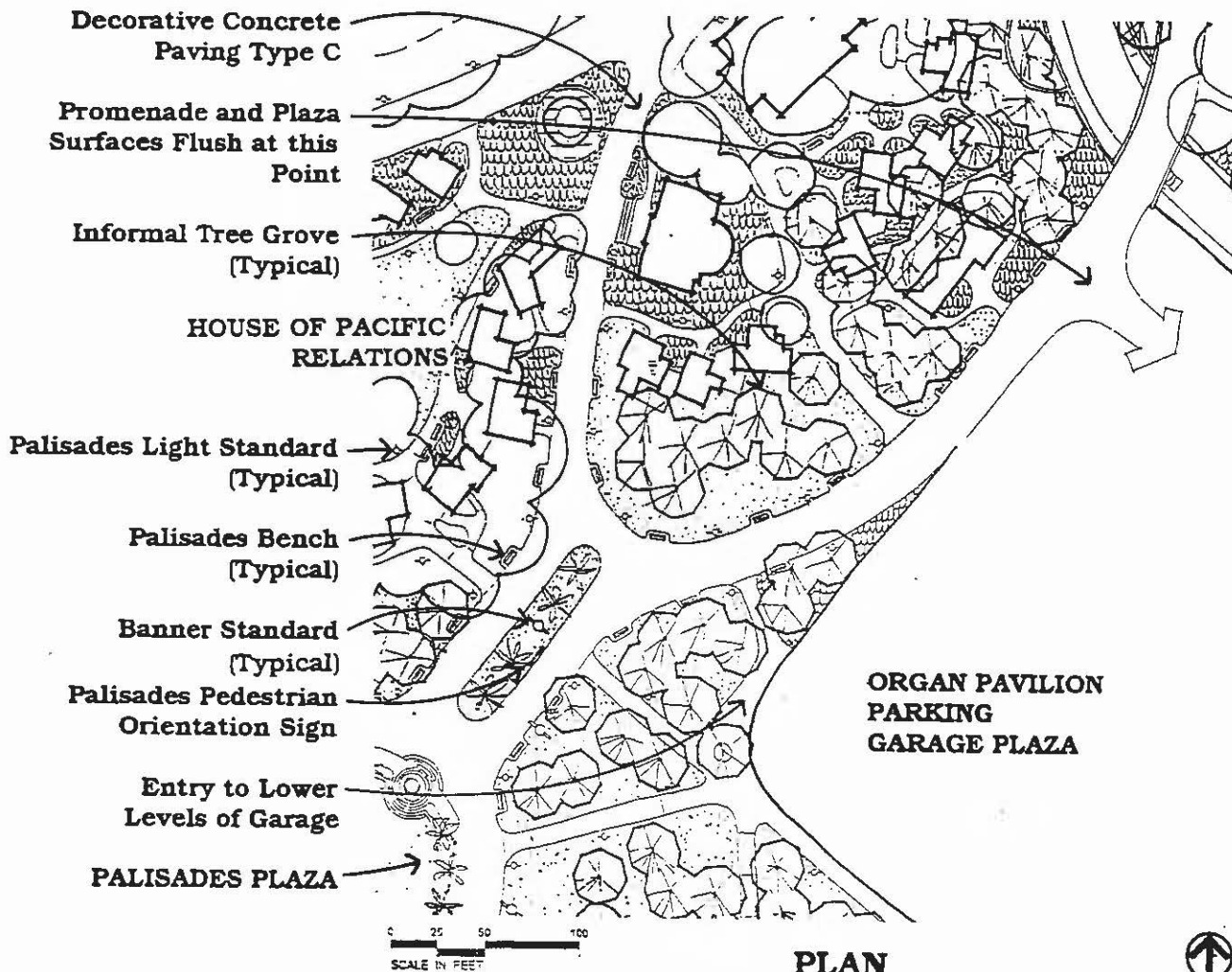

Recommendations:

- Configure the walkway to meet the parking garage plaza at grade, then descend to Palisades Plaza.
- Provide for pedestrian circulation to House of Pacific Relations.
- Plant informal groves of trees with lawns and groundcover underneath to continue the existing landscape theme of the area.
- Pave the walkway with concrete that will be consistent with surrounding paving surfaces in color and texture.

Canopy Trees: Eucalyptus melliodora - Honey Scented Gum

Eucalyptus cornuta - Yate

*proposed name for a new feature.



5. Palisades Plaza and Lawns*

Design Objective:

Create a multiple use open space that will accommodate large public gatherings and exhibitions as well as picnicking and passive recreation.

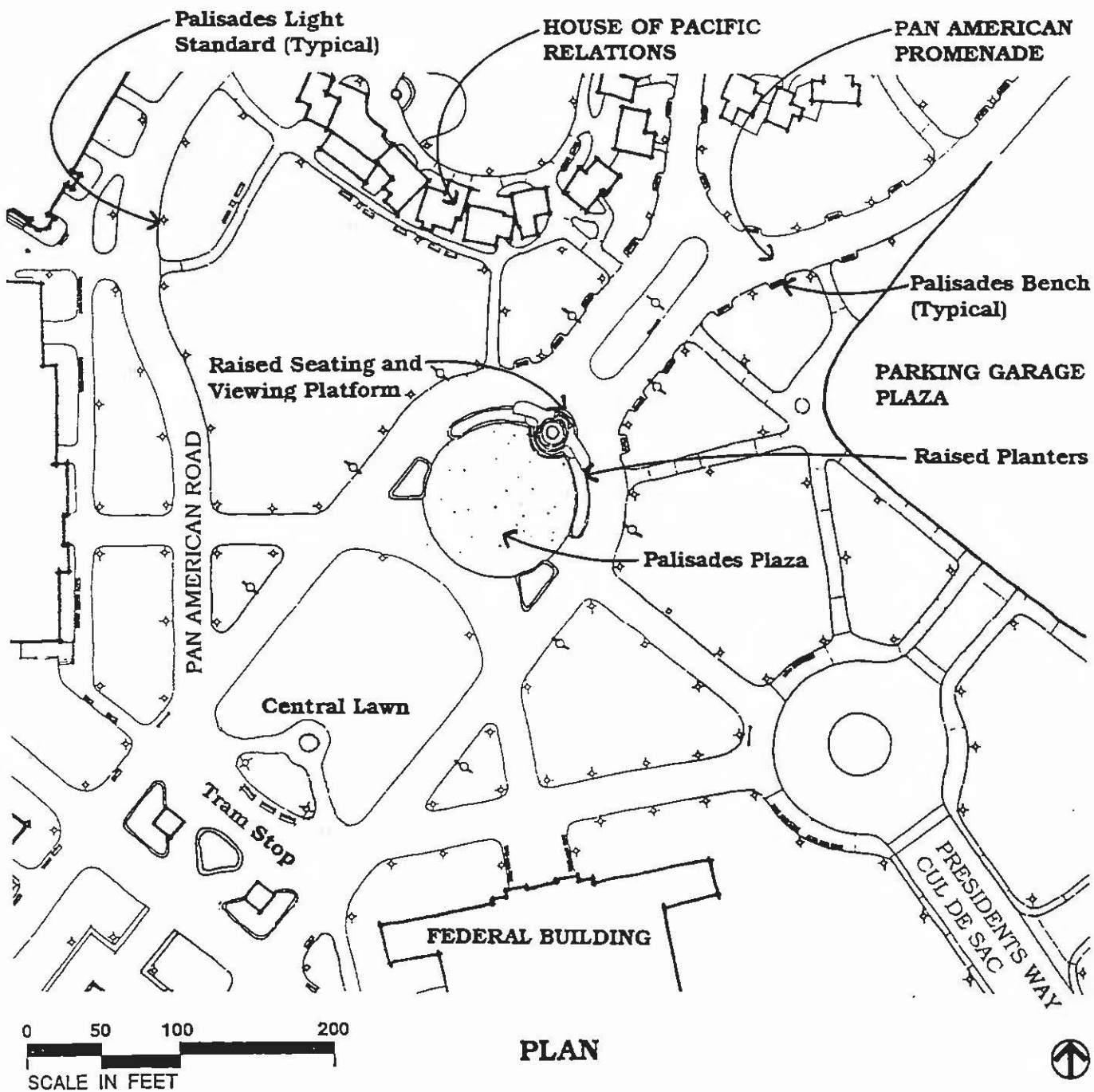

*proposed name for a new feature.



Recommendations:

- Locate a stepped platform at the focal point of the plaza as shown.
- Construct raised planters flanking the platform to provide spatial definition for the plaza. Wall caps should be at least 16 inches wide to provide seating opportunities.
- Plant appropriate low accent shrubs and palm trees in the raised planters.
- Pave the plaza surface with decorative concrete that varies slightly in color and texture from the surrounding walkways and is flush with surrounding paving surfaces.
- Provide secure, weatherproof electrical service for sound and lighting equipment.

Lawn Trees: Archontophoenix cunninghamiana - King Palm
Eucalyptus melliodora - Honey Scented Gum
Podocarpus gracilior - Fern Pine
Tipuana tipu - Tipu Tree
Ficus macrophylla - Moreton Bay Fig
Plaza Palm Tree: Arecastrum romanzofianum - Queen Palm

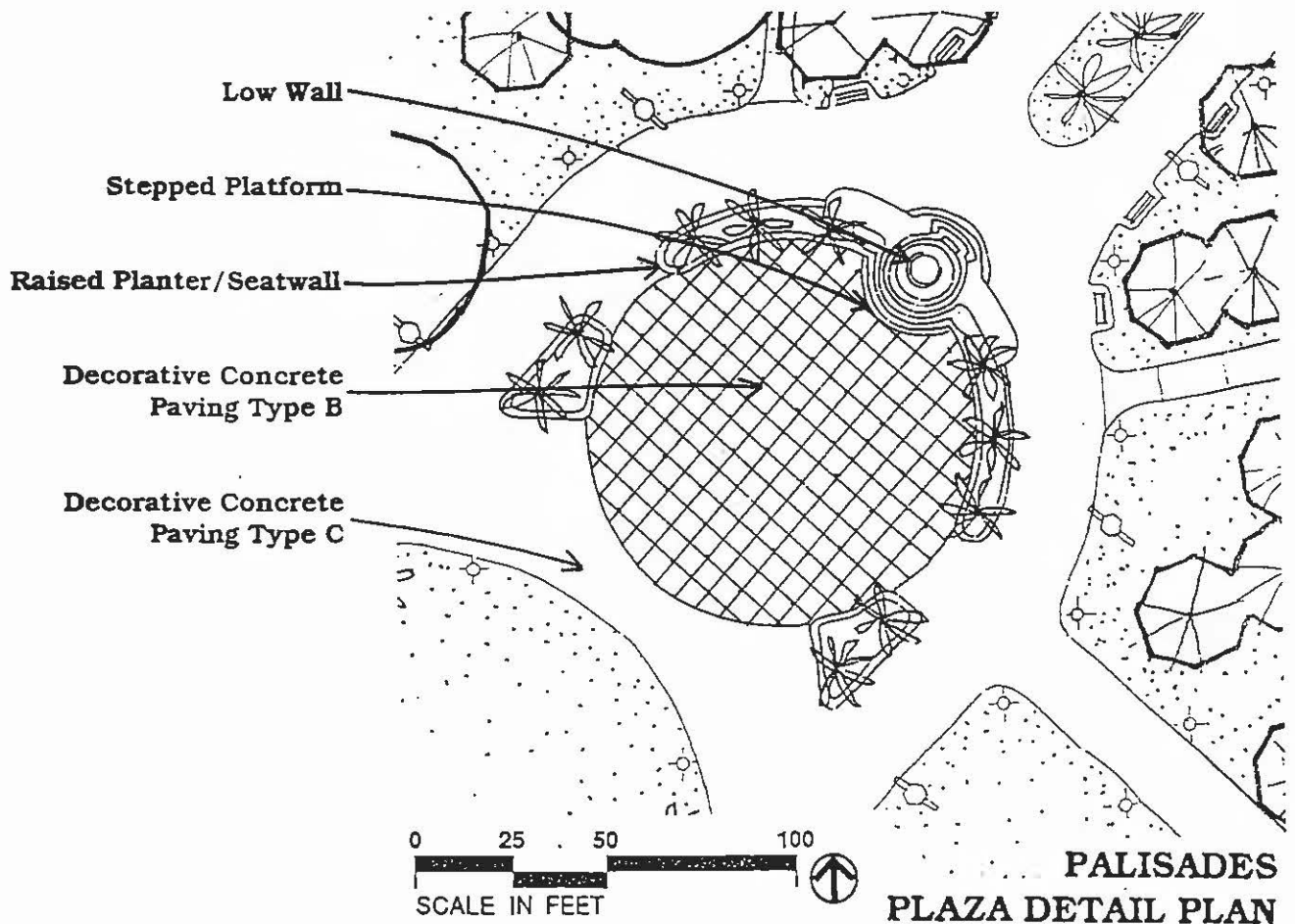

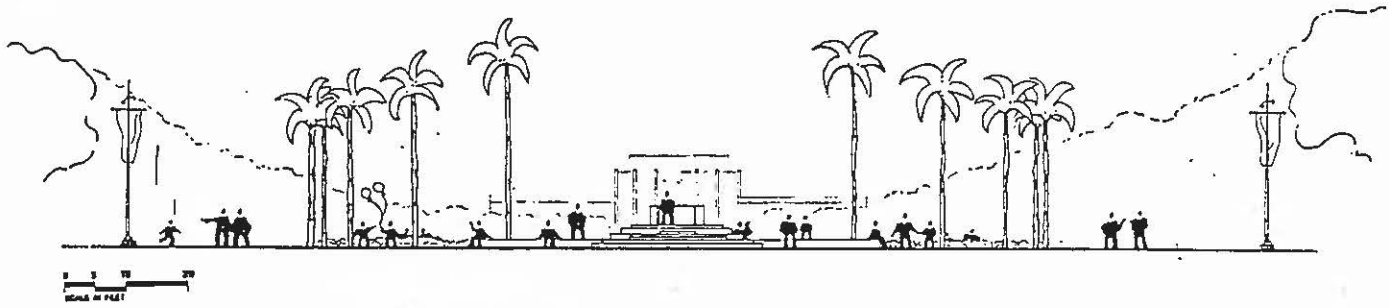

PALISADES PLAZA - LOOKING SOUTH

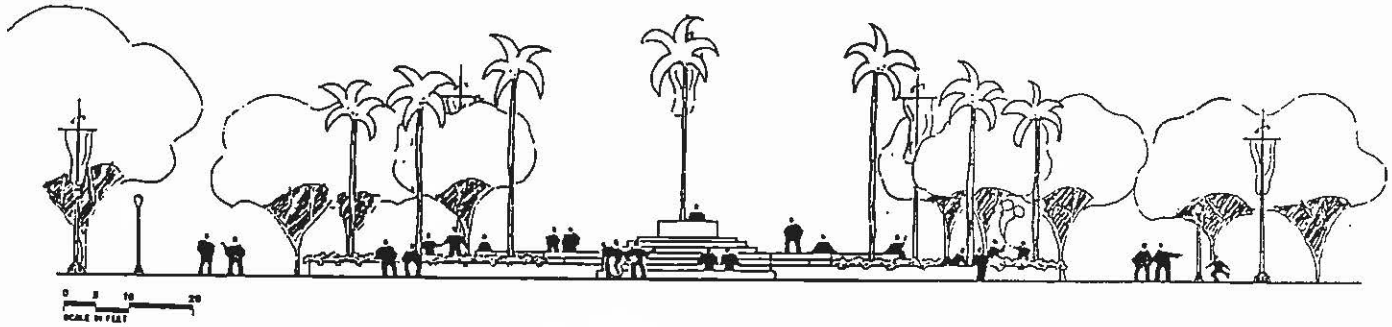

PALISADES PLAZA - LOOKING NORTH

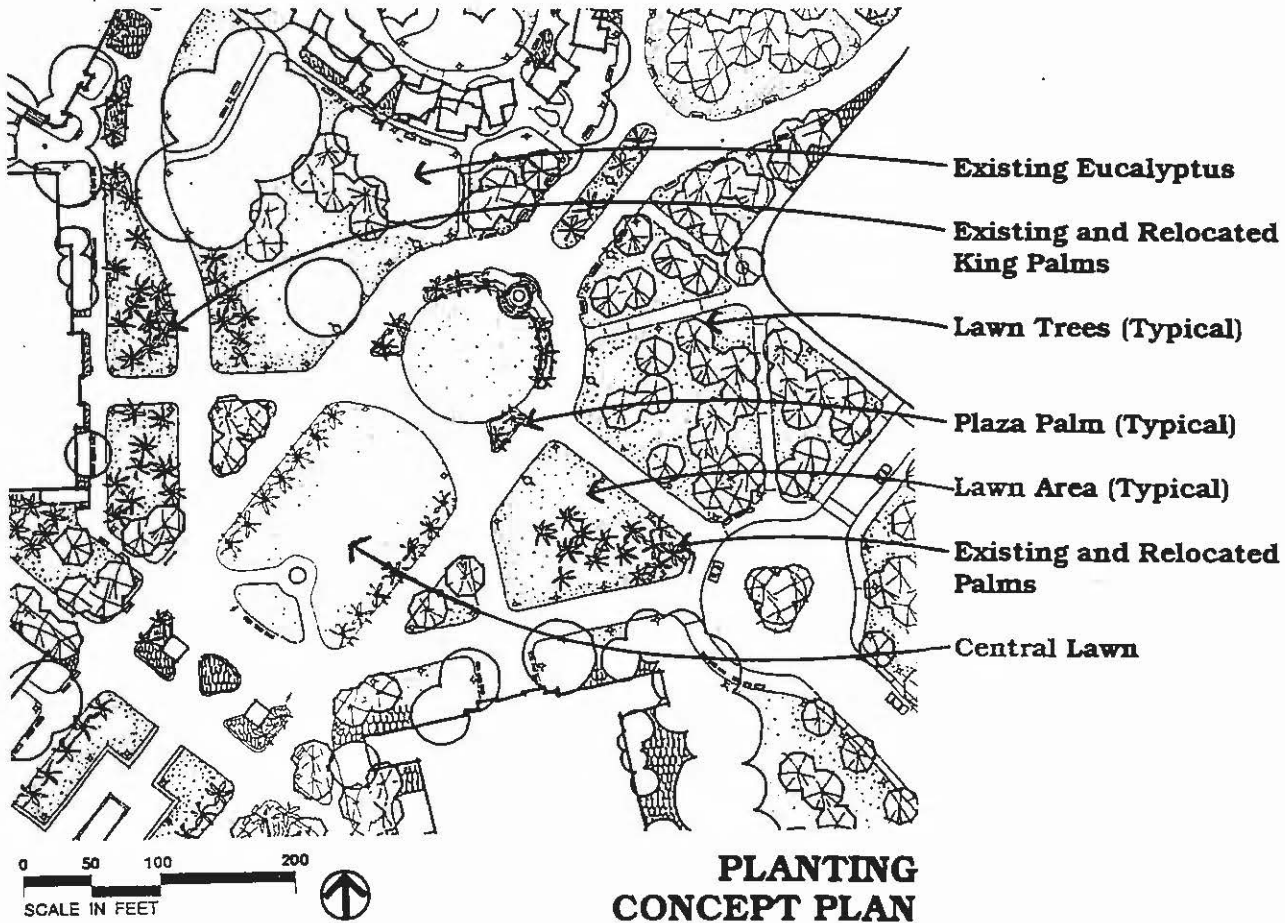



6. Palisades Tram Stop*

Design Objective:

Provide a safe loading and unloading area for the Park Tram and include sheltered seating for Tram patrons.

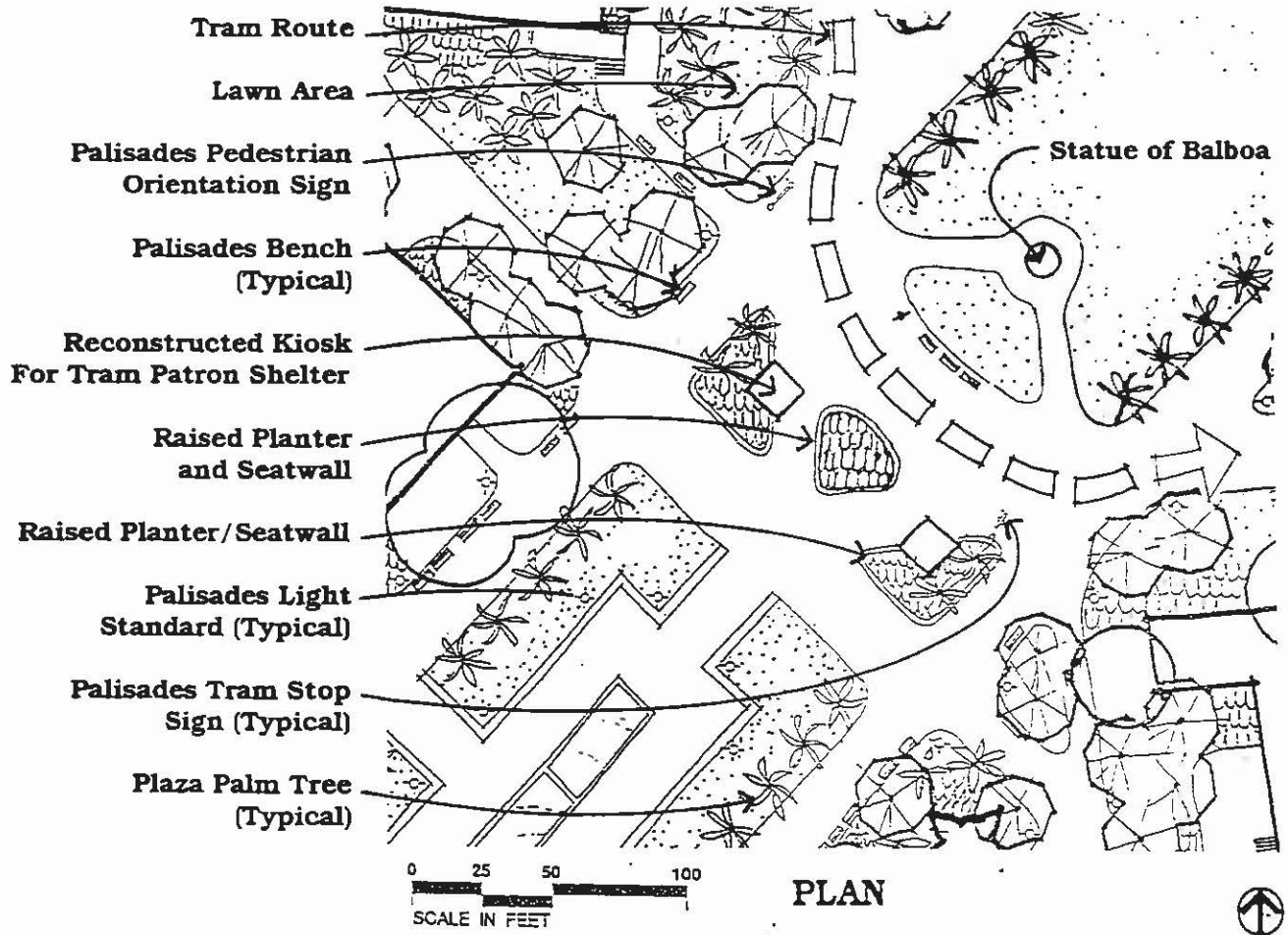

Recommendations:

- Conduct a partial reconstruction of the 1935 speaker kiosks in the location shown on the plan to serve as open air shelters. Adapt the kiosks to be open on two sides facing the tram staging area and provide seating inside.
- Incorporate raised seat walls into the kiosk seating.
- Provide walkways to a statue of Vasco Nunez de Balboa, namesake of Balboa Park.
- Include orientation signage, a public information kiosk, and drinking fountains in the design for this area.

Plaza Palm Tree: *Arecastrum romanzofianum* - Queen Palm

*proposed name for a new feature.

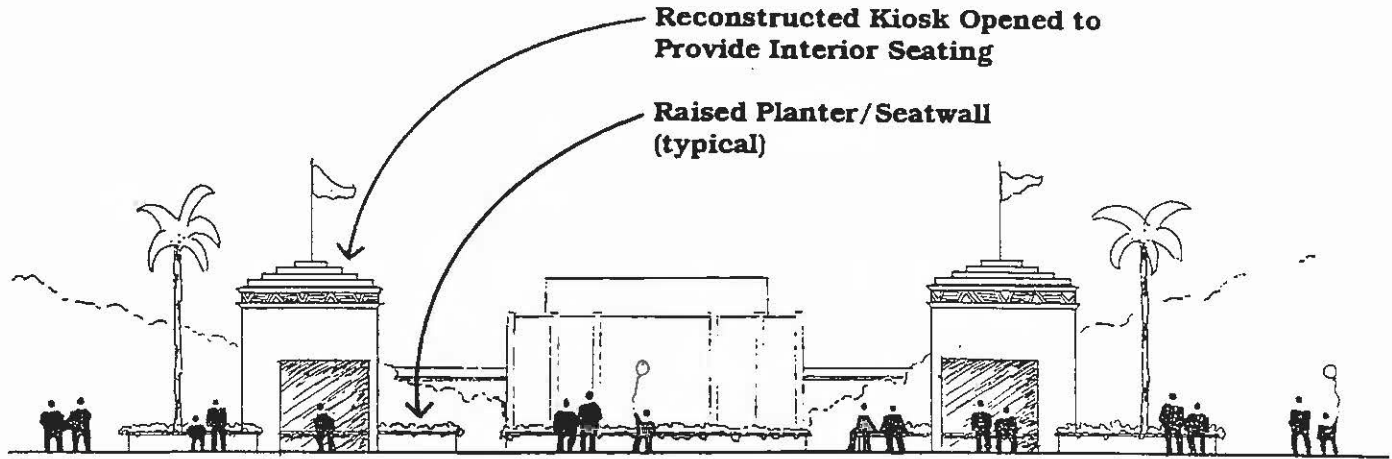

TRAM STOP ELEVATION - LOOKING SOUTH



7. Plaza de las Americas

Design Objective:

Restore the southern portion of the 1935 Plaza area of the Palisades to its original use as a pedestrian plaza. This plaza should function as a pleasant southern destination point for the Central Mesa and offer amenities that will serve the needs of a variety of user groups from nighttime playgoers to museum patrons who might spend half a day in the immediate area. It should provide pooling space for the Starlight Bowl areas for outdoor display, circulation space, food service, visitor information, public restrooms, a variety of seating, and visual interest features that will invite the Park visitor to pause, relax, and enjoy spending time outdoors.

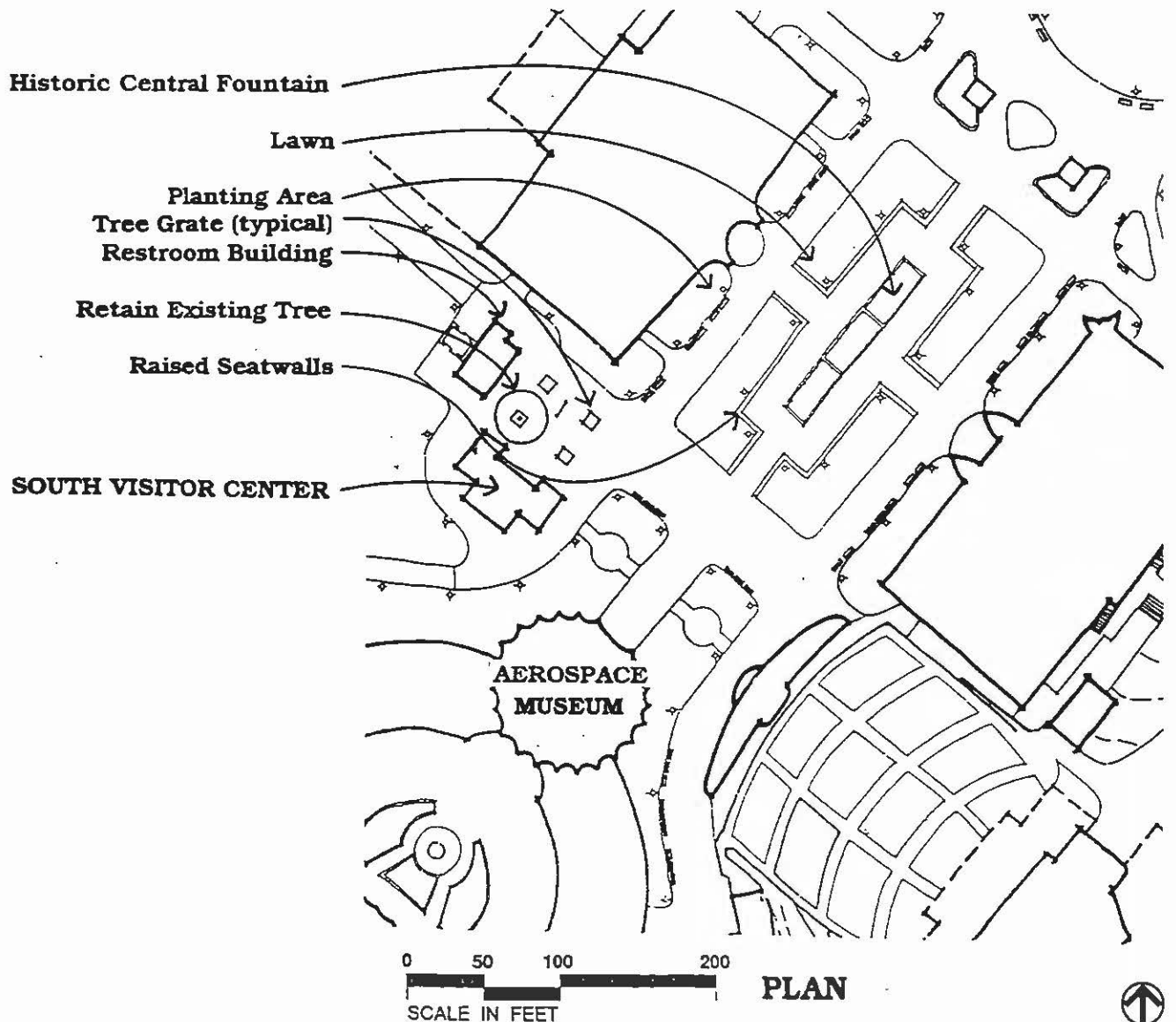



Recommendations:

- Provide a patio area for outdoor dining adjacent to the visitor center. Retain the existing tree (*Kigelia pinnata*) and incorporate it into the design. Also allow for views into the nearby wooded canyon.
- Situate movable seating consisting of chairs, and tables with umbrellas at the concession patio and the adjoining plaza space.
- Utilize a central fountain to serve as the major focus of interest in the plaza. This fountain should recall the Firestone Singing Fountains of the 1935 Exposition which featured colored lighting and special spray effects that synchronized with prerecorded music or live performances in the Bowl.
- Provide seating around the inner portion of the plaza using raised seat walls as shown in plan. Surrounding the walls, lawn areas will slope from wall height down to plaza level.
- Provide bench seating on the outer edge of the pedestrian walkways under the shade of the trees planted near the buildings as shown on the plan.

Plaza Palm Tree: *Arecastrum romanzofianum* - Queen Palm

Building Accent Trees:

Phoenix reclinata - Senegal Date Palm

Chorisa speciosa - Floss Silk Tree

Spathodea campanulata - African Tulip Tree

Ficus microphytta - Indian Laurel Fig (Existing)

Visitor Center Patio Tree:

Podocarpus gracilior - Fern Pine

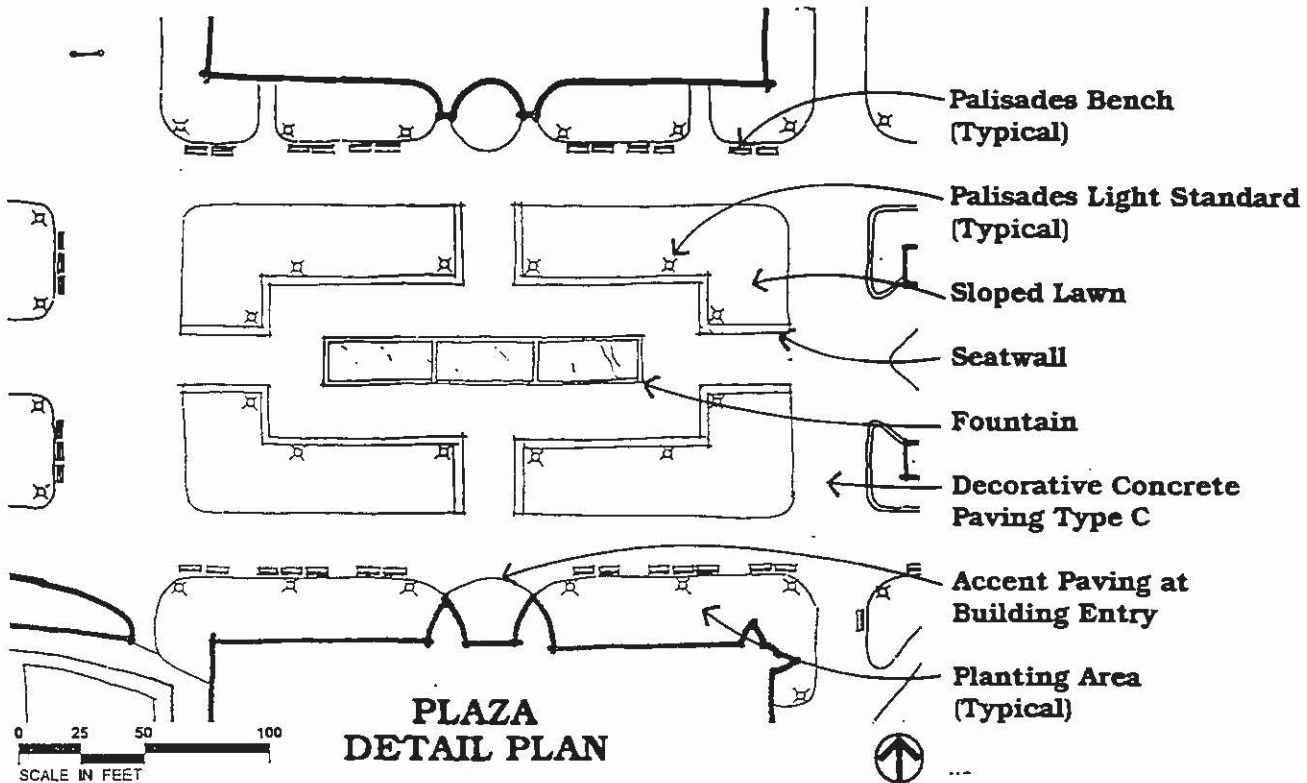

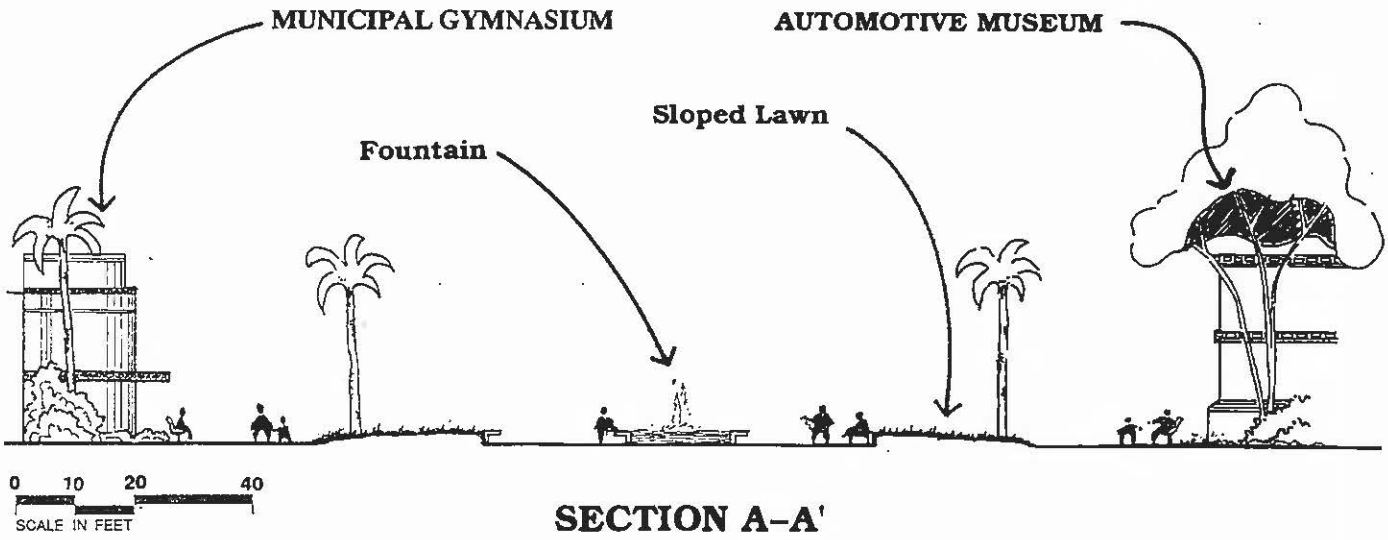
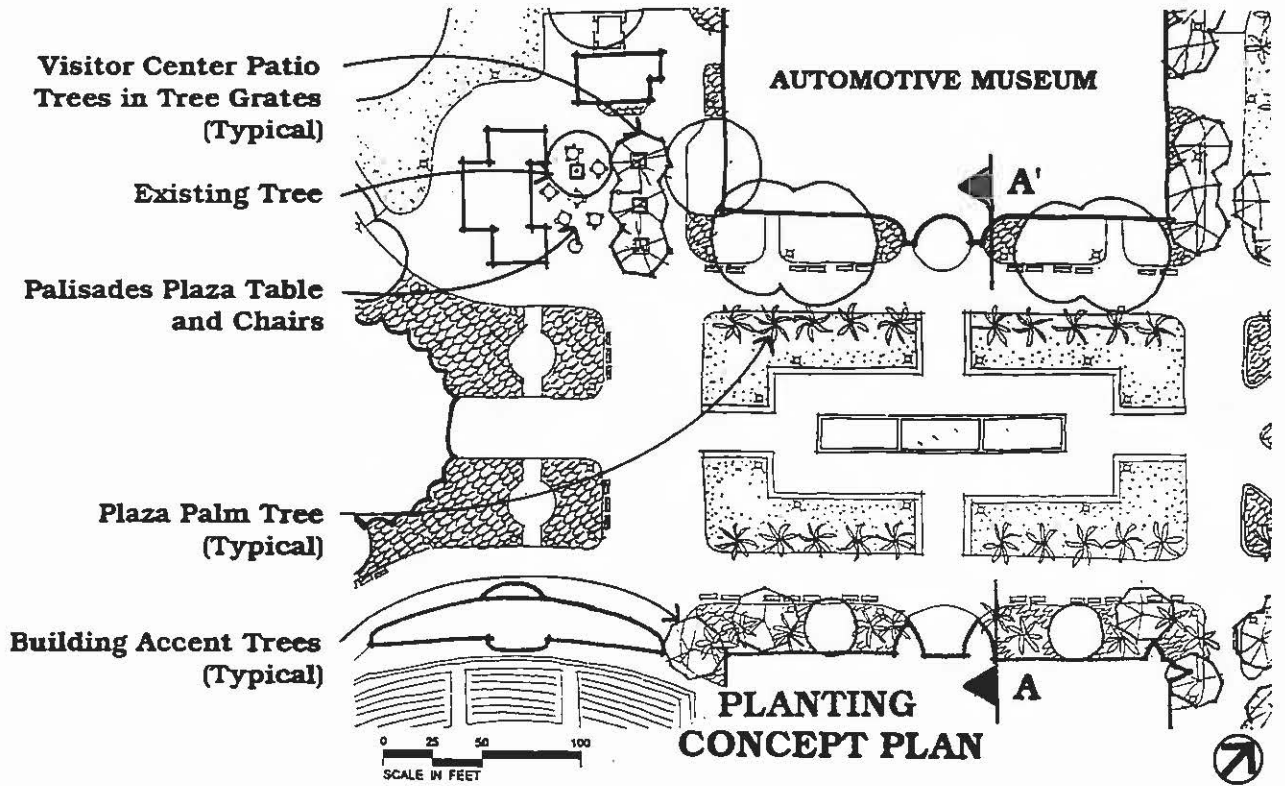



8. Protea Garden*

Design Objectives:

Renovate the plaza area behind the Balboa Park Club and create a new protea garden.

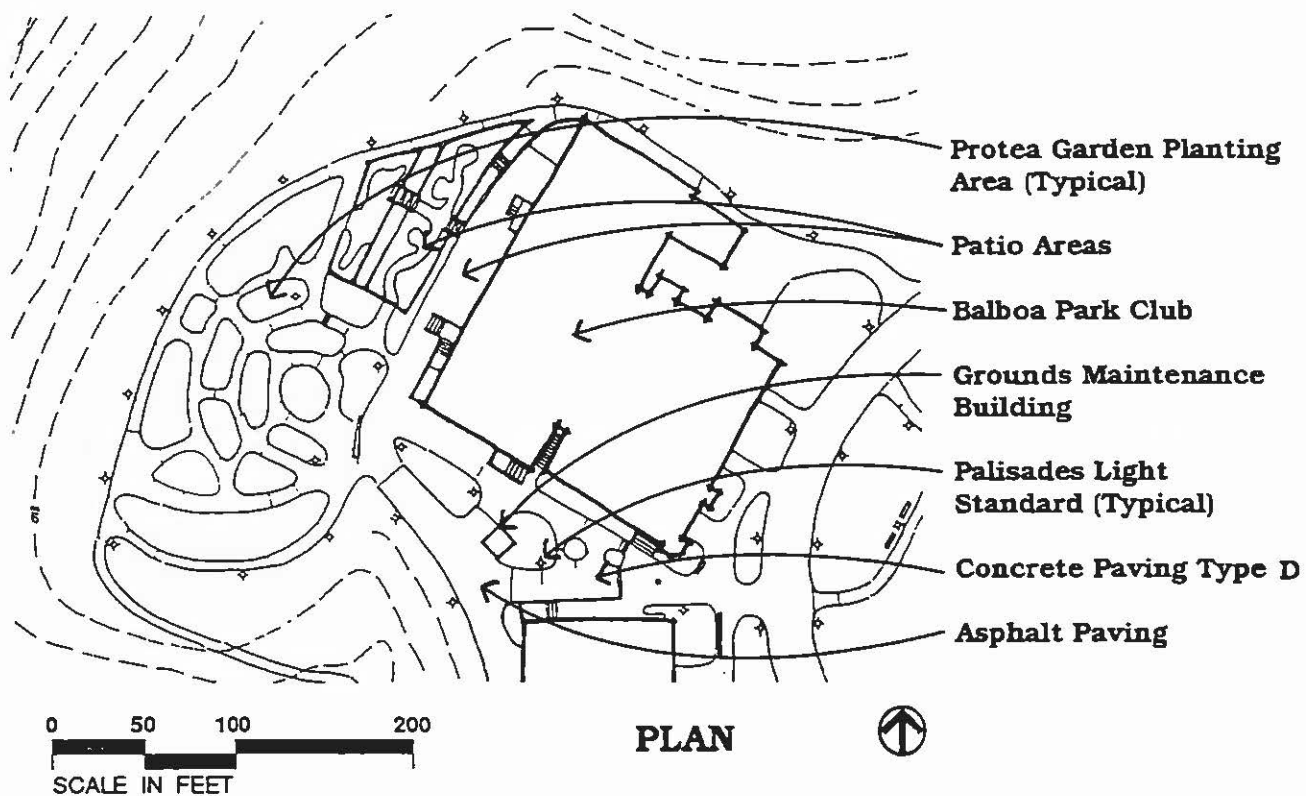

Recommendations:

- Expand and enhance the existing patio area to accommodate outdoor activities such as community organization events and wedding receptions.
- Restore the existing path system and introduce protea plants to the garden. Conduct necessary soil amendments and drainage improvements under the direction of the Park horticulturist.

*proposed name for a new feature.



9. Federal Building Lawn

Design Objective:

Regrade the sloping lawn area southeast of the Federal Building parking lot to form a subtle bowl for use as an informal amphitheater.

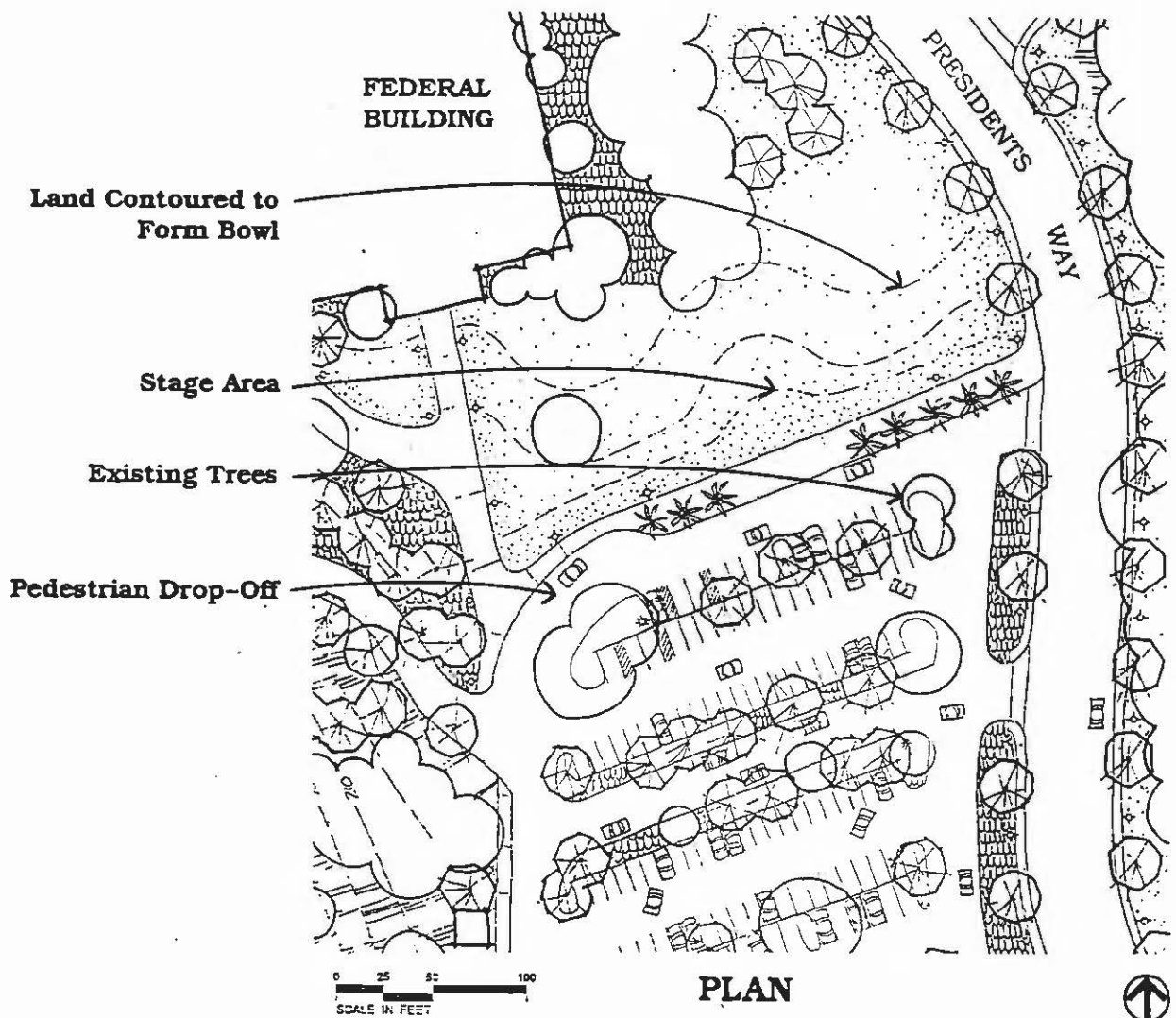

Recommendations:

- Reconfigure the parking lot to accommodate a second access road from Presidents Way. Allow for closure of the north portion of the parking lot to allow for stage set up for special special events.
- Equip the stage area with electrical service for sound and lighting equipment.
- Allow for clear sightlines to the stage area when planting trees in the area.



10. Presidents Way

Design Objective:

Provide vehicular access to the proposed parking structure as well as a cul-de-sac with a large drop-off area to provide pedestrian access to the Palisades.

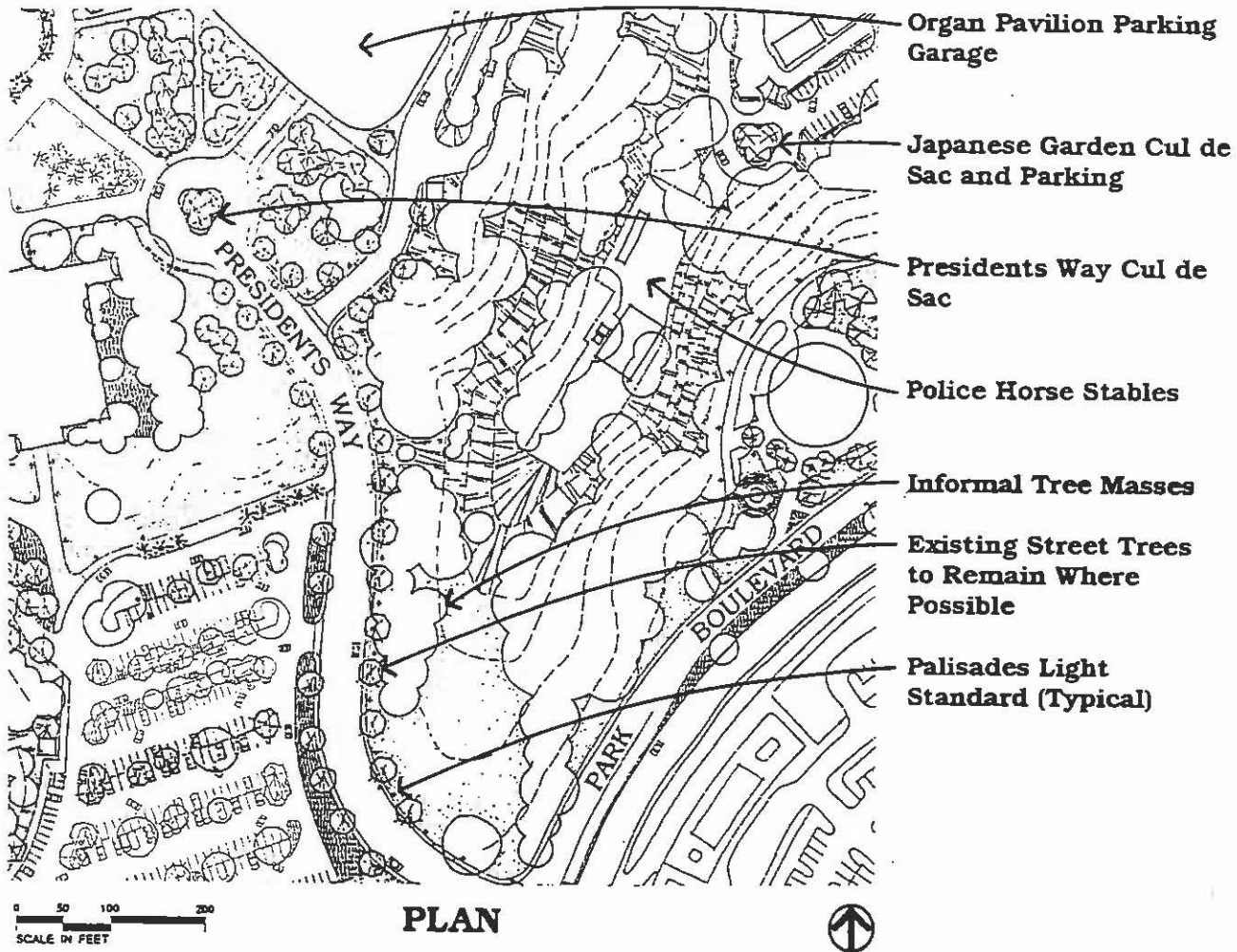

Recommendations:

- Determine vehicular circulation routes when the parking structure design is finalized.
- Widen sidewalks on both sides of Presidents Way to 10 feet in width.
- Provide seating, shade and Park orientation signage at the cul-de-sac.
- Plant large trees in random patterns along the northeast side of Presidents way to harmonize with existing planting in Eucalyptus Canyon.
- Plant specimen accent trees in the center of the cul-de-sac.
- Retain existing street trees wherever possible.

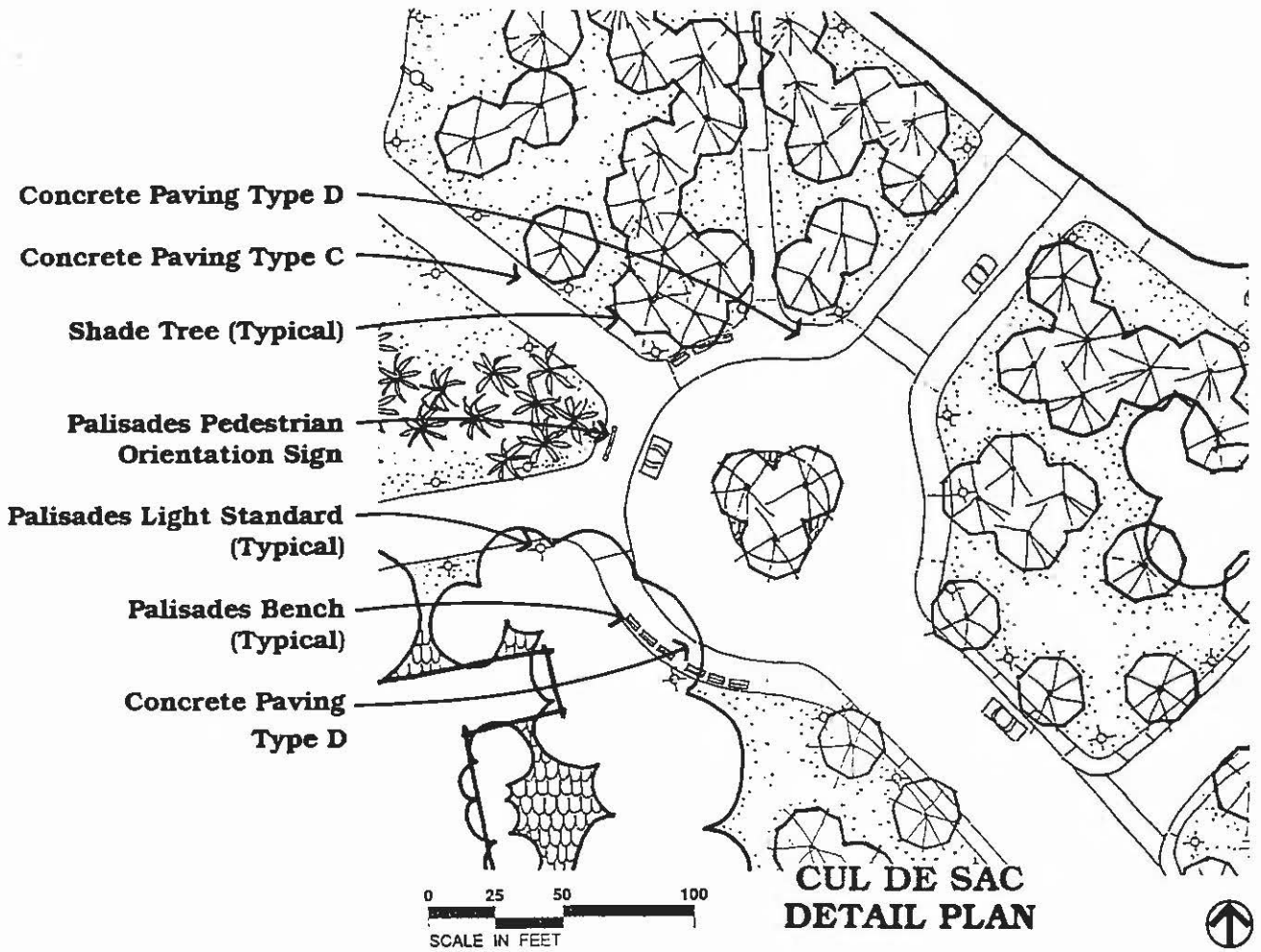



11. Federal Building Parking Area

Design Objectives:

Provide a vehicular circulation route from Presidents Way to a new pedestrian drop-off and cul-de-sac at the Starlight Bowl. Provide a new service access road for Starlight Bowl.

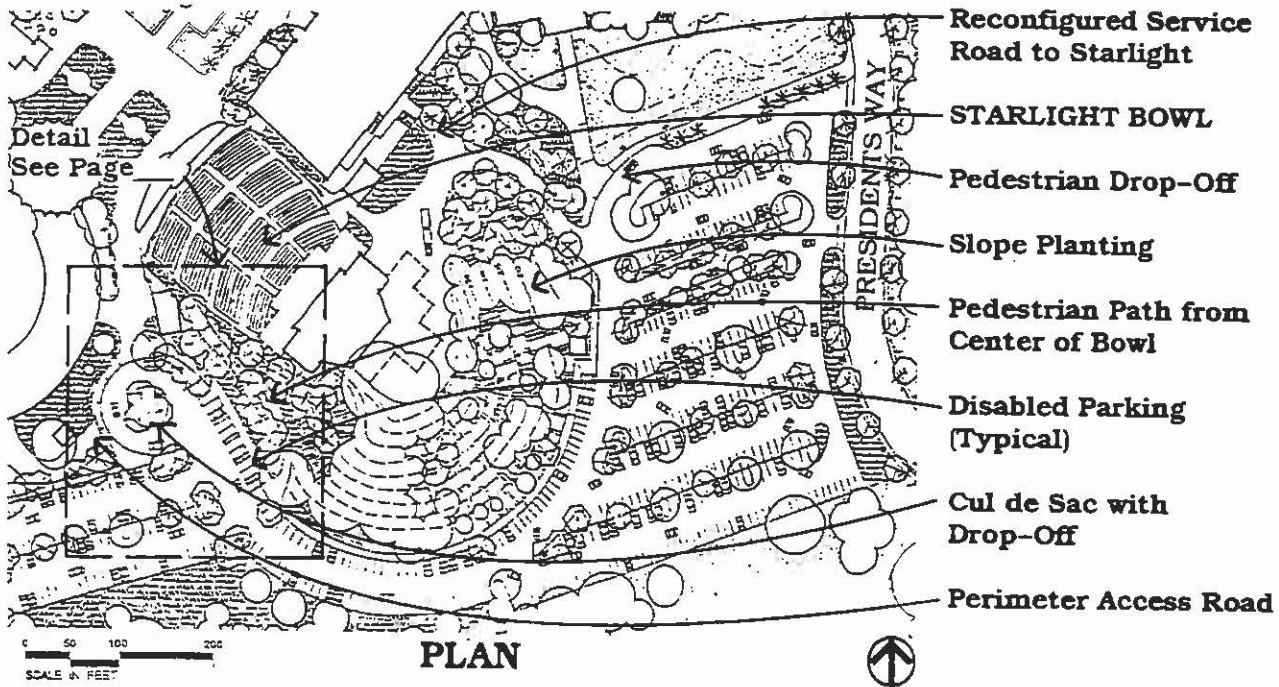

Recommendations:

- Create a vehicular circulation route (Federal Way *) through the Federal Building parking lot as shown on the plan. Terminate the vehicular route with a cul-de-sac at the Starlight Bowl that will allow room for a drop-off lane.
- Provide a generous disabled parking area near the Starlight entrance.
- Connect the Palisades perimeter service access road to the cul-de-sac.
- Supply a pedestrian drop-off area near the south entrance to the Federal building.
- Provide a disabled accessible pedestrian path connecting the central seating area of the Starlight Bowl with the Federal Way lots.
- Relocate the existing Starlight Bowl service road according to plan.
- Provide generous slope planting to screen the Starlight service road and loading areas from public view.

Parking Lot Tree: Calodendrum capense - Cape Chestnut
 Eucalyptus ficifolia - Red Flowered Gum

Accent Tree: Erythrina 'Sykesii' - Sykes' Coral Tree

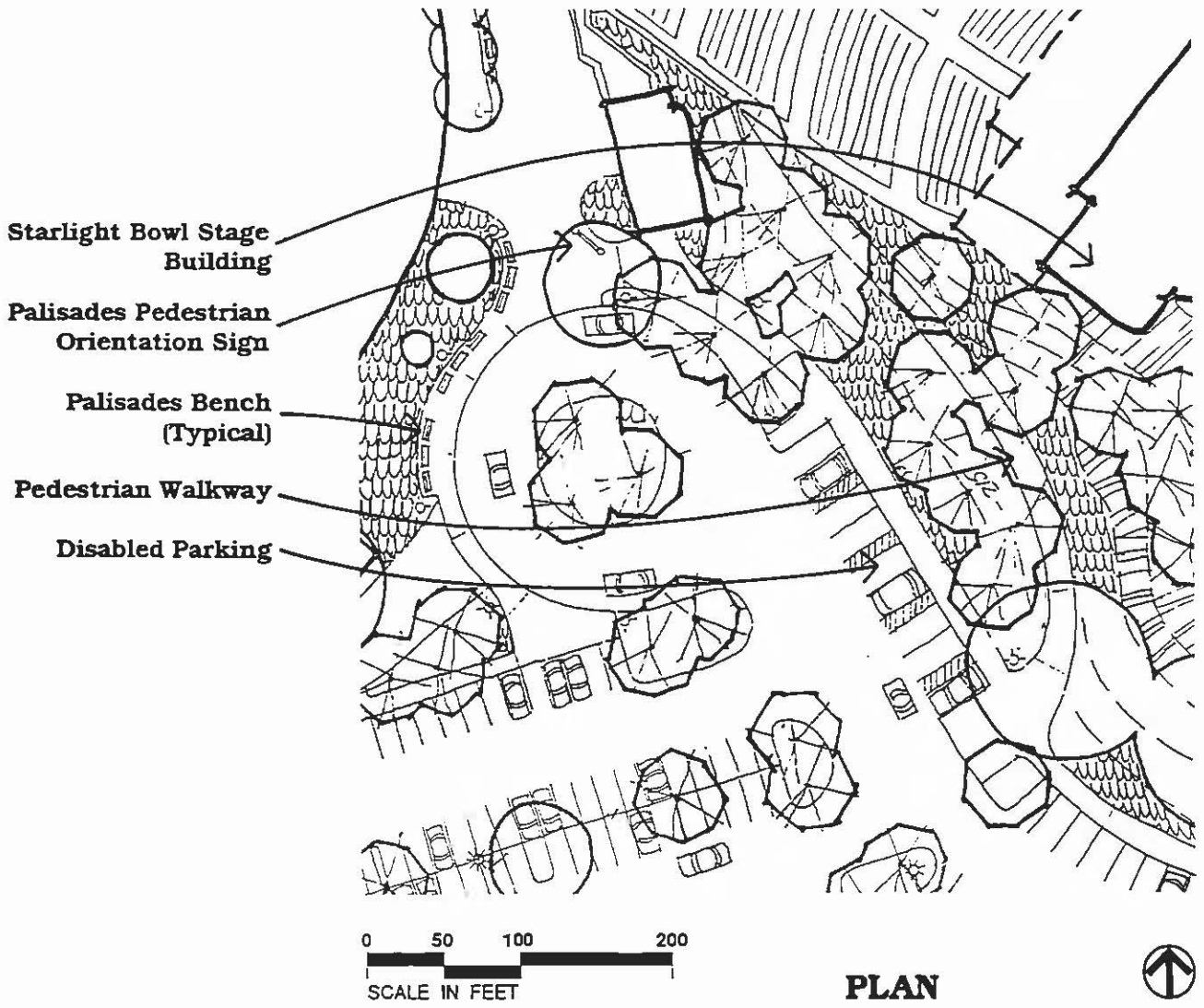

12. Park Boulevard Streetscape

A landscape theme that will communicate the subtropical landscape themes of the Central Mesa should be established. The landscape treatment should also serve as a transition between the Central Mesa and the Florida Canyon/ Inspiration Point areas.

The following design guidelines should be used in developing this theme.

- Views to the east from Plaza de Balboa should be preserved.
- The new east entry to the Prado should be highlighted.
- Emphasis should be given to the entry experience of public transit patrons.