

A New Day for San Diego



The Central Library will be a new civic icon embodying San Diego's commitment to the future. It is the heart of San Diego's 35-branch library system and will serve as a new regional center for learning and literacy.

The Library has space to accommodate 1.2 million items and will feature 400 computing devices, 22 WiFi enabled study rooms and several large public meeting areas. The Library will be a community gathering place where San Diegans

will celebrate reading and culture, hear great music, appreciate art work and discuss critical issues.

The structure reflects San Diego's commitment to the environment with photovoltaic cells and other "green" attributes. Inspired by the classic architecture of Balboa Park, the nine-story landmark building will serve the community's need for information, literacy and knowledge in the 21st century.

Garden Courtyard.

An intimate, outdoor area between the Auditorium and the Main Entrance. Large, folding glass doors open to the Library and Auditorium, connecting the three areas and creating a unique, fluid space. The shaded courtyard will serve as a town square—a large, adaptable space to host large brown-bag concerts, author talks, civic events or more intimate gatherings. The Courtyard features an Outdoor Cafe—a relaxing space where visitors can enjoy a good book, a cup of coffee and a bite to eat.

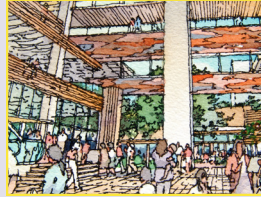

Penthouse Special Events Room.

With open terraces looking down to the Reading Room and floor-to-ceiling windows with views of the Bay, Coronado Bridge and Petco Park, this is a stunning space for public and private events. The flexible room can seat 216 people for sit down meals or 330 for classroom events.

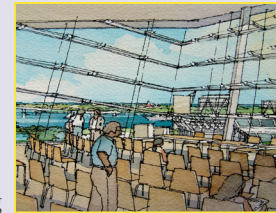

The Reading Room.

The airy, three-story crystalline Reading Room soars above the ninth floor. This inviting public penthouse is nestled in a three-story glass enclosure and covered by the Library's iconic sun-screening protective Dome. Here Library users can read, relax and enjoy panoramic views of the Bay and City skyline.



Auditorium. This state-of-the-art theater, performance space and classroom can host more than 350 for author talks, concerts, films, dance performances, lectures or special City meetings.



Parking. 250 underground parking spaces; additional parking nearby.

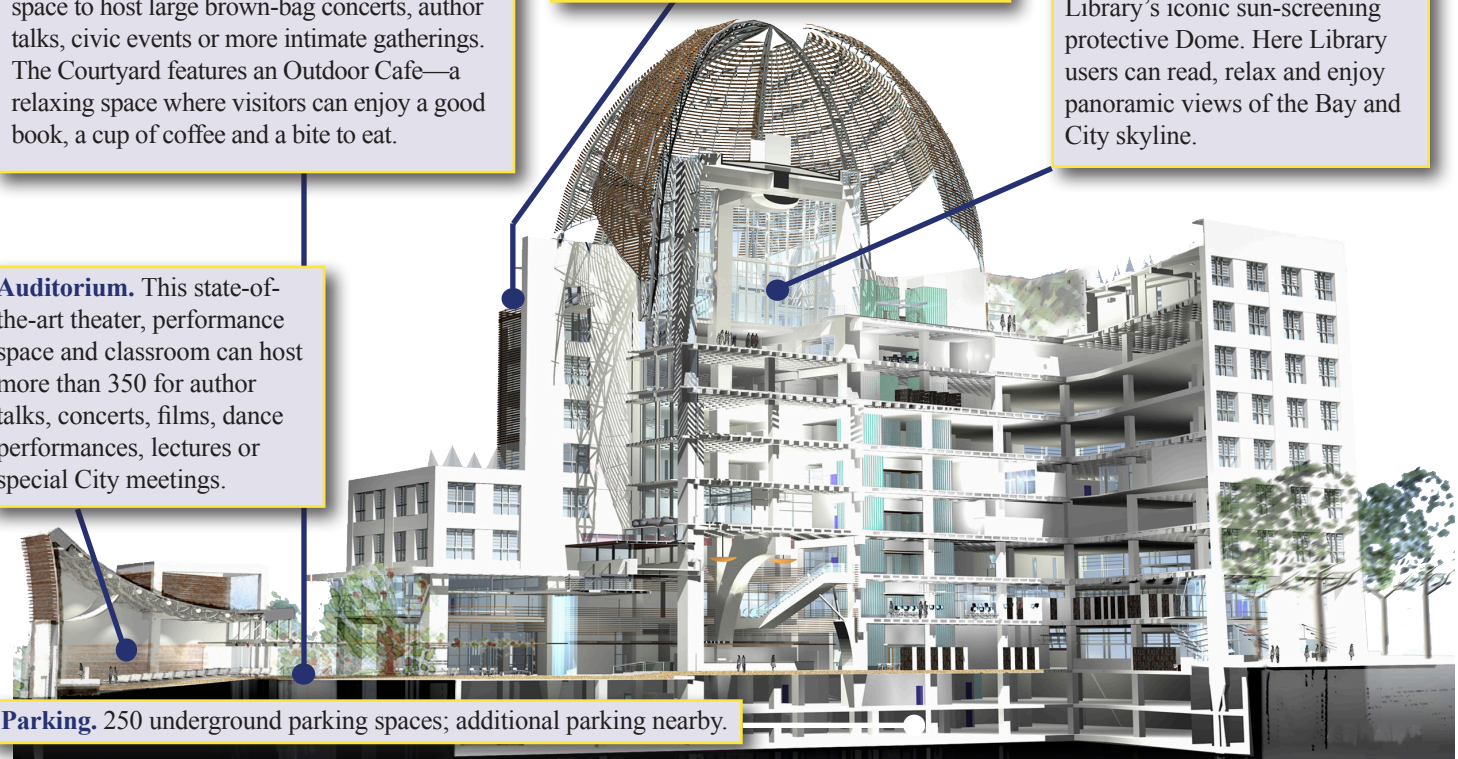

The New Central Library

Construction Begins: July 2010

Construction Scheduled to be Complete: September 28, 2013

Facility Cost: \$184.9 million

Features and Services	Current Central Library	New Central Library
Library Space	144,524 sq. ft.	366,673 sq. ft.
Site	30,000 sq. ft.	69,820 sq. ft.
Parking	None	250 on-site spaces (250 across the street)
Collection Size		
<i>Total (volumes)</i>	780,000	Space for 1,250,598 items
<i>Children's (volumes)</i>	42,749	71,965
Public Computers	84	407
Special Areas		
<i>Children's Library</i>	3,200 sq. ft.	9,141 sq. ft.
<i>Teen Center</i>	1,240 sq. ft.	3,797 sq. ft.
<i>Homework Center</i>	None	926 sq. ft.
Reader Seats	409	1,200
Meeting Spaces		
<i>Auditorium Capacity</i>	180	326
<i># of Meeting Rooms</i>	2	6
<i># of Study Rooms</i>	None	22*
Special Services		
<i>Literacy Services</i>	Off site at branch	4,907 sq. ft.
Gallery/exhibition space	Minimal hallway space	3,010 sq. ft.
<i>Special Event Space</i>	None	3,605 sq. ft. (216 meal; 330+ classroom)

For information about the San Diego Public Library, visit:

sandiegolibrary.org

To contribute to the New Central Library, support the Library System and sign up for New Central Library project email updates, visit:

SupportMyLibrary.org



Penthouse Levels: Public Places

An "L"-shaped terrace with sweeping views of the City looks down into the glass-enclosed Reading Room and provides access to the Special Events Room, sweeping terraces and a 4,200 foot Exhibition Gallery.

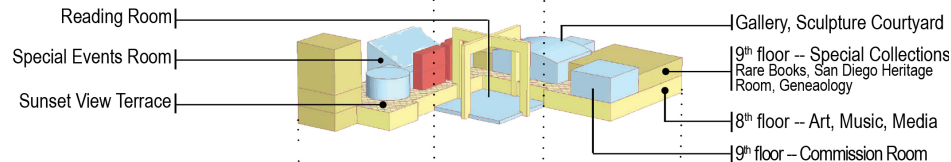

Middle Levels: The Collections

Flexible and practical—the edges of each floor have reading areas.

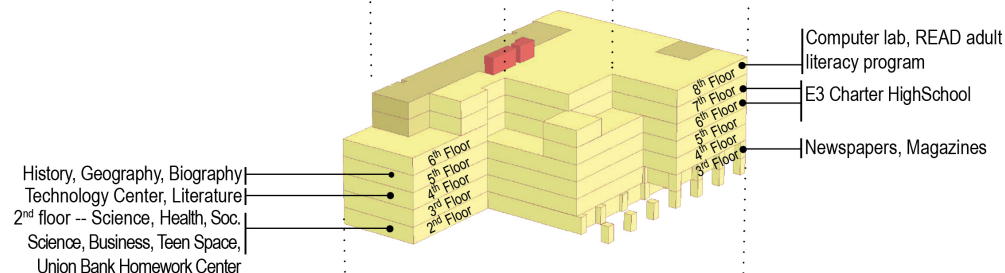

Ground Level: Public Places

The "Library Garden" creates a functional outdoor room—shaded by large trees and surrounded by the Lobby, the Popular Library, a 320+ seat sloped-floor auditorium and a cafe. The Children's Library is nearly 10,000 square feet.

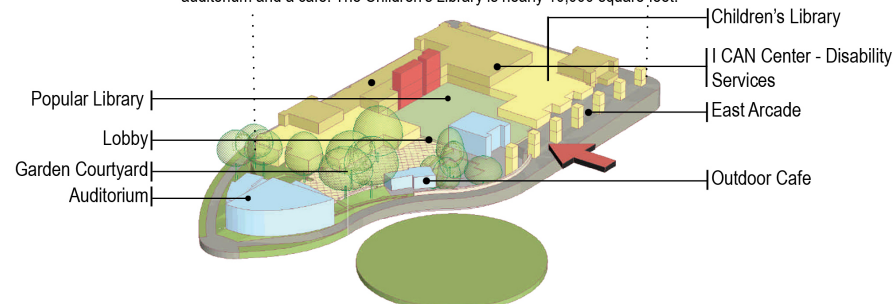

 **San Diego Public Library**
FOUNDATION
Libraries Change Lives
820 E Street / San Diego, CA 92101
(619)238-6638/www.supportmylibrary.org