

DRAWING NUMBER TC-20

**CENTER OF ROAD WORK AREA**  
 MULTILANE TRAFFIC CONTROL WITH CENTERLINE LEFT LANE TRAFFIC LANE CLOSURE - THREE LANES

SAN DIEGO REGIONAL STANDARD  
 APPENDIX "A"

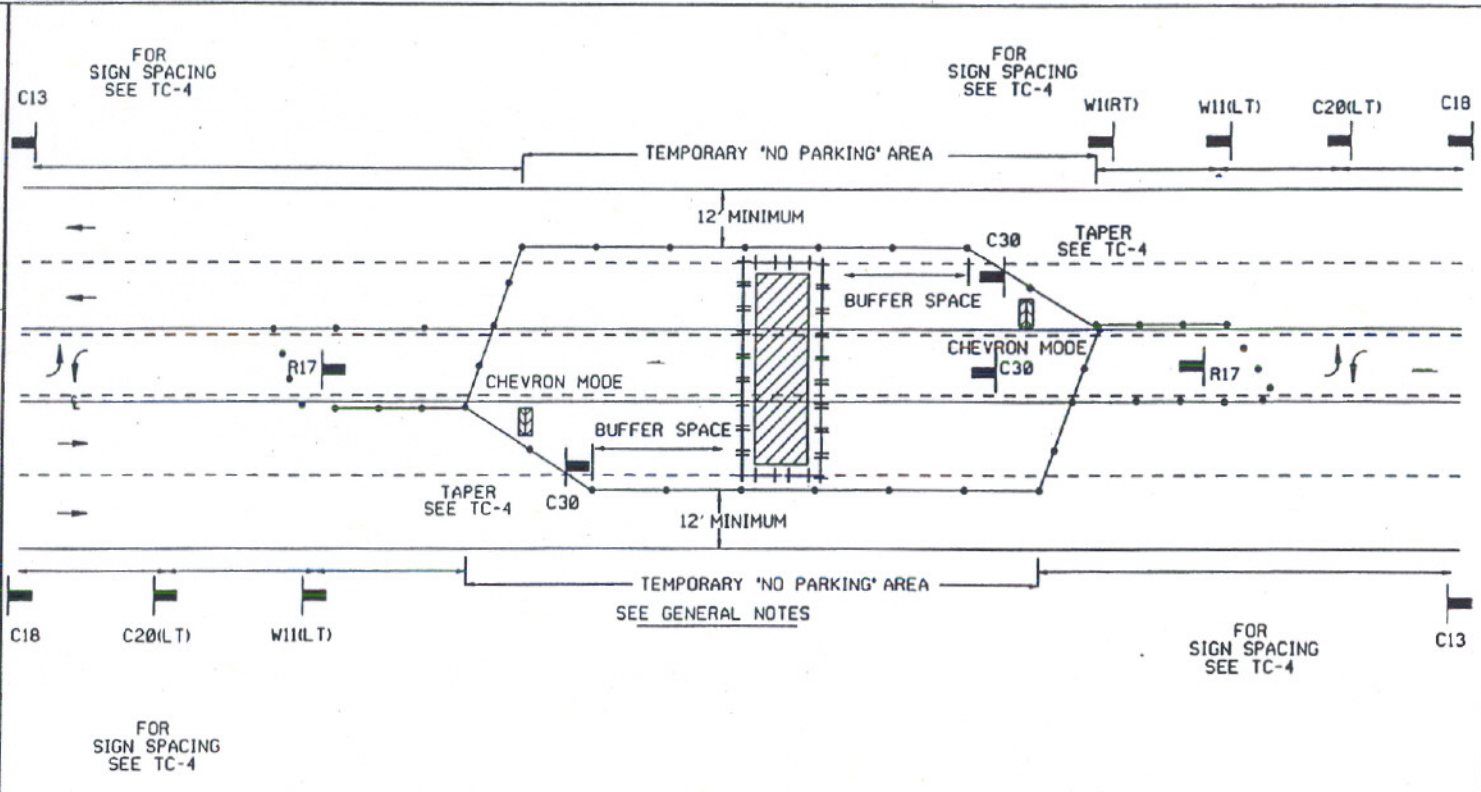

**LEGEND**

- CONE
- ++ BARRICADE
- FLAGGER
- SIGN
- FLASHING ARROW SIGN
- WORK AREA
- TRAFFIC DIRECTION

AGENCY ENGINEER'S COMMENTS

\_\_\_\_\_  
 \_\_\_\_\_  
 \_\_\_\_\_  
 \_\_\_\_\_  
 \_\_\_\_\_

POSTED SPEED LIMIT	APPROACH SPEED	TAPER LENGTH	SPACING OF CONES	SIGN SPACING

SEE TC-4 FOR SIGN, CONE SPACING AND TAPER LENGTH

**GENERAL NOTES**

For hours of darkness, change cones to vertical barricades with steady burn lights.

This plan DOES NOT apply at signalized or multi-way stop intersections. Consult the local jurisdiction when preparing Traffic Control Plans near these intersections.

This plan MAY NOT apply when the work areas affect bike lanes, sidewalks, pedestrian access, and curved or narrow roadways. Consult the approving agency when preparing the Traffic Control Plan for these areas.

Nothing contained on this drawing shall prevent local jurisdictions from modifying, changing, or adopting new specifications deemed necessary. Criteria for position, location, and use of Traffic Control Devices is solely for the purpose of guidance to assist in the set up of the Traffic Control Plans.

TC-5 is required for all Traffic Control Plans.

SUBMITTED BY:  
 NAME \_\_\_\_\_  
 COMPANY \_\_\_\_\_  
 ADDRESS \_\_\_\_\_  
 PHONE \_\_\_\_\_

Revision	By	Approved	Date
DRAWING	PW		4-11-83
ORIG.	PW		8-28-83
	DOB		5-15-85

584

Revision	By	Approved	Date
DRAWING	CMV		4-91
DRAWING	CSB		10-8-91
ORIG.	MAJ		8-23-94
	CSB		1-18-95

APPENDIX "A"  
SAN DIEGO REGIONAL STANDARD

**SIDE OF ROAD WORK AREA**  
MULTILANE TRAFFIC CONTROL WITH RAISED MEDIAN  
RIGHT TRAFFIC LANE CLOSURE - ONE LANE

DRAWING NUMBER  
**TC-21**

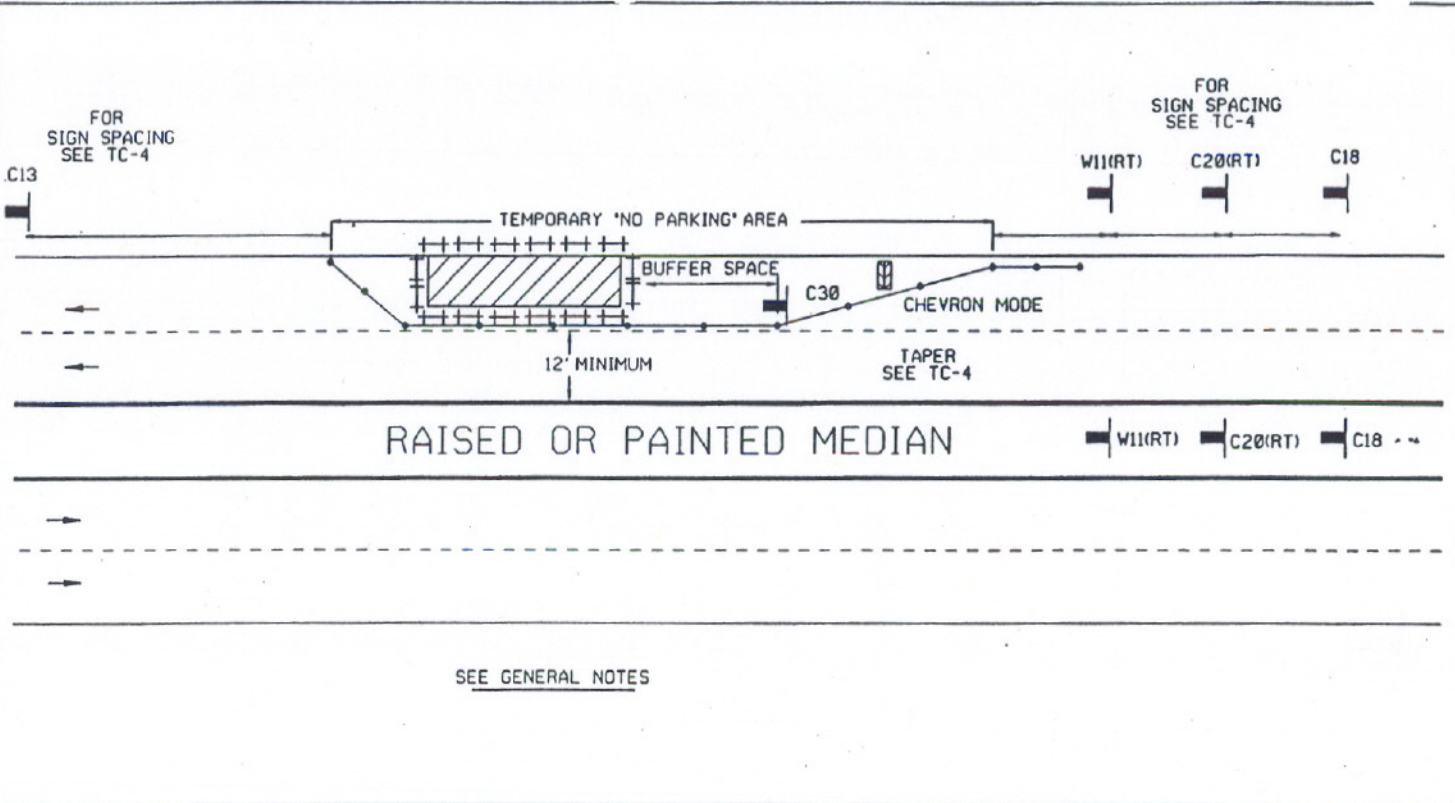

**LEGEND**

• CONE    †† BARRICADE    FLAGGER    SIGN    FLASHING ARROW SIGN    WORK AREA    TRAFFIC DIRECTION

AGENCY ENGINEER'S COMMENTS

---



---



---



---



---

POSTED SPEED LIMIT	APPROACH SPEED	TAPER LENGTH	SPACING OF CONES	SIGN SPACING

SEE TC-4 FOR SIGN, CONE SPACING AND TAPER LENGTH

AGENCY USE

---



---



---



---



---

APPLICANT USE

SUBMITTED BY:

NAME \_\_\_\_\_

COMPANY \_\_\_\_\_

ADDRESS \_\_\_\_\_

PHONE \_\_\_\_\_

**GENERAL NOTES**

For hours of darkness, change cones to vertical barricades with steady burn lights.

This plan DOES NOT apply at signalized or multi-way stop intersections. Consult the local jurisdiction when preparing Traffic Control Plans near these intersections.

This plan MAY NOT apply when the work areas affect bike lanes, sidewalks, pedestrian access, and curved or narrow roadways. Consult the approving agency when preparing the Traffic Control Plan for these areas.

Nothing contained on this drawing shall prevent local jurisdictions from modifying changing, or adopting new specifications deemed necessary. Criteria for position, location, and use of Traffic Control Devices is solely for the purpose of guidance to assist in the set up of the Traffic Control Plans.

TC-5 is required for all Traffic Control Plans.

586

DRAWING NUMBER TC-22

**CENTER OF ROAD WORK AREA**  
 MULTILANE TRAFFIC CONTROL WITH RAISED MEDIAN  
 LEFT TRAFFIC LANE CLOSURE - ONE LANE

APPENDIX "A"  
 SAN DIEGO REGIONAL STANDARD

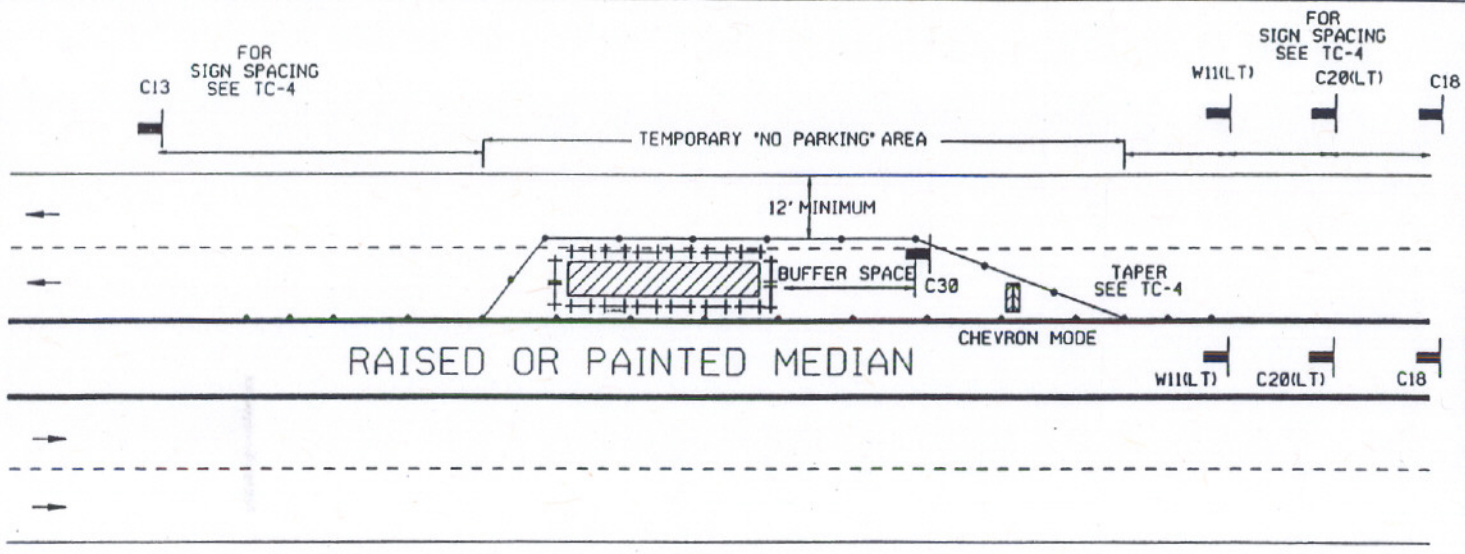

SEE GENERAL NOTES

**LEGEND**

- CONE
- ++ BARRICADE
- FLAGGER
- SIGN
- FLASHING ARROW SIGN
- WORK AREA
- TRAFFIC DIRECTION

AGENCY ENGINEER'S COMMENTS

\_\_\_\_\_  
 \_\_\_\_\_  
 \_\_\_\_\_  
 \_\_\_\_\_  
 \_\_\_\_\_

POSTED SPEED LIMIT	APPROACH SPEED	TAPER LENGTH	SPACING OF CONES	SIGN SPACING

SEE TC-4 FOR SIGN, CONE SPACING AND TAPER LENGTH

**GENERAL NOTES**

- For hours of darkness, change cones to vertical barricades with steady burn lights.
- This plan DOES NOT apply at signalized or multi-way stop intersections. Consult the local jurisdiction when preparing Traffic Control Plans near these intersections.
- This plan MAY NOT apply when the work areas affect bike lanes, sidewalks, pedestrian access, and curved or narrow roadways. Consult the approving agency when preparing the Traffic Control Plan for these areas.
- Nothing contained on this drawing shall prevent local jurisdictions from modifying changing, or adopting new specifications deemed necessary. Criteria for position, location, and use of Traffic Control Devices is solely for the purpose of guidance to assist in the set up of the Traffic Control Plans.
- TC-5 is required for all Traffic Control Plans.

SUBMITTED BY:  
 NAME \_\_\_\_\_  
 COMPANY \_\_\_\_\_  
 ADDRESS \_\_\_\_\_  
 PHONE \_\_\_\_\_

Revision	By	Approved	Date
ORIG.	MM	MM	8-21
	MM	MM	8-21
	MM	MM	8-21
	MM	MM	8-21

586

Revision	By	Approved	Date
DRAWING	DMV		4-1-91
ORIG.	DMV		10-2-91
			4-2-92
			5-30-94
			4-25-95
			9-15-95

APPENDIX "A"  
SAN DIEGO REGIONAL STANDARD  
SIDE OF ROAD WORK AREA  
INTERSECTION TRAFFIC CONTROL

DRAWING NUMBER  
**TC-23**

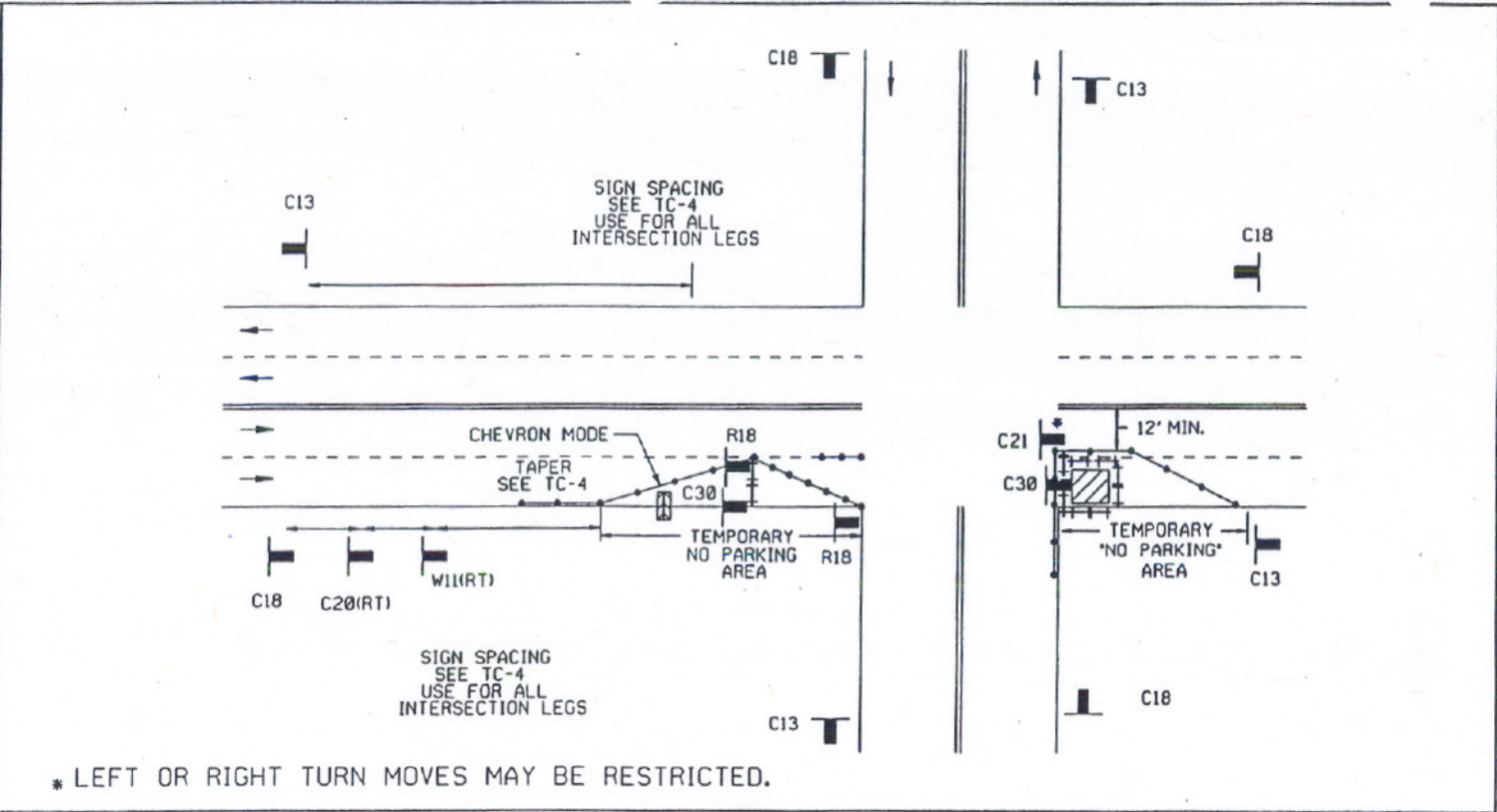

\* LEFT OR RIGHT TURN MOVES MAY BE RESTRICTED.

**LEGEND**

- CONE
- ++ BARRICADE
- FLAGGER
- SIGN
- FLASHING ARROW SIGN
- WORK AREA
- TRAFFIC DIRECTION

AGENCY ENGINEER'S COMMENTS

---



---



---



---

POSTED SPEED LIMIT	APPROACH SPEED	TAPER LENGTH	SPACING OF CONES	SIGN SPACING

SEE TC-4 FOR SIGN, CONE SPACING AND TAPER LENGTH

**GENERAL NOTES**

For hours of darkness, change cones to vertical barricades with steady burn lights.

Consult the local jurisdiction when preparing Traffic Control Plans near these intersections.

This plan MAY NOT apply when the work areas affect bike lanes, sidewalks, pedestrian access, and curved or narrow roadways. Consult the approving agency when preparing the Traffic Control Plan for these areas.

Nothing contained on this drawing shall prevent local jurisdictions from modifying changing, or adopting new specifications deemed necessary. Criteria for position, location, and use of Traffic Control Devices is solely for the purpose of guidance to assist in the set up of the Traffic Control Plans.

TC-5 is required for all Traffic Control Plans.

APPLICANT USE

SUBMITTED BY:

NAME \_\_\_\_\_

COMPANY \_\_\_\_\_

ADDRESS \_\_\_\_\_

PHONE \_\_\_\_\_

581

DRAWING NUMBER TC-24

SIDE OF ROAD WORK AREA  
INTERSECTION TRAFFIC CONTROL

APPENDIX "A"  
SAN DIEGO REGIONAL STANDARD

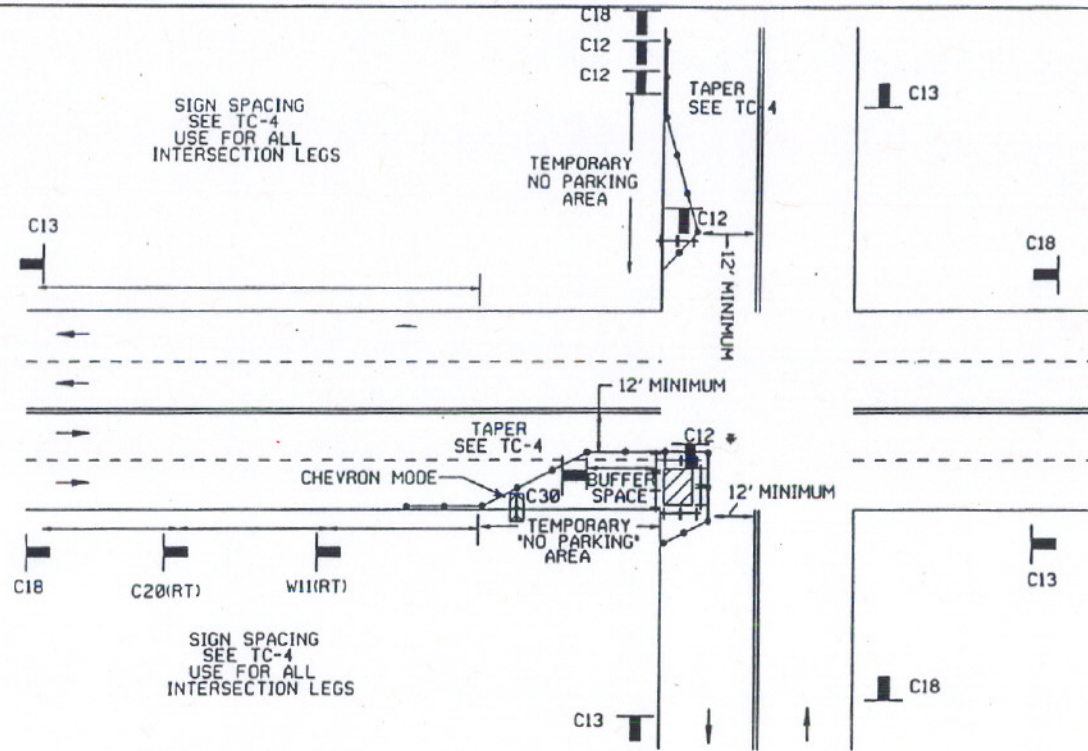

\* RIGHT TURN MOVES MAY BE RESTRICTED.

LEGEND

- CONE
- ++ BARRICADE
- █ FLAGGER
- ▬ SIGN
- ◻ FLASHING ARROW SIGN
- ▨ WORK AREA
- TRAFFIC DIRECTION

AGENCY ENGINEER'S COMMENTS

\_\_\_\_\_  
 \_\_\_\_\_  
 \_\_\_\_\_  
 \_\_\_\_\_  
 \_\_\_\_\_

POSTED SPEED LIMIT	APPROACH SPEED	TAPER LENGTH	SPACING OF CONES	SIGN SPACING

SEE TC-4 FOR SIGN, CONE SPACING AND TAPER LENGTH

GENERAL NOTES

For hours of darkness, change cones to vertical barricades with steady burn lights.

Consult the local jurisdiction when preparing Traffic Control Plans near these intersections.

This plan MAY NOT apply when the work areas affect bike lanes, sidewalks, pedestrian access, and curved or narrow roadways. Consult the approving agency when preparing the Traffic Control Plan for these areas.

Nothing contained on this drawing shall prevent local jurisdictions from modifying, changing, or adopting new specifications deemed necessary. Criteria for position, location, and use of Traffic Control Devices is solely for the purpose of guidance to assist in the set up of the Traffic Control Plans.

TC-5 is required for all Traffic Control Plans.

SUBMITTED BY:

NAME \_\_\_\_\_  
 COMPANY \_\_\_\_\_  
 ADDRESS \_\_\_\_\_  
 PHONE \_\_\_\_\_

Revision	By	Approved	Date
DRAWING	DW	[Signature]	10-28-94
ORIG.	VAL	[Signature]	10-28-94
	DOB	[Signature]	10-28-94

588

Revision	By	Approved	Date
DRAWING FROM	DMV		4-31
ORIG.	WJ		10-21-93
			6-26-94
			4-25-95
			9-15-95

APPENDIX "A"  
SAN DIEGO REGIONAL STANDARD  
**CENTER OF ROAD WORK AREA**  
INTERSECTION TRAFFIC CONTROL

DRAWING NUMBER  
**TC-25**

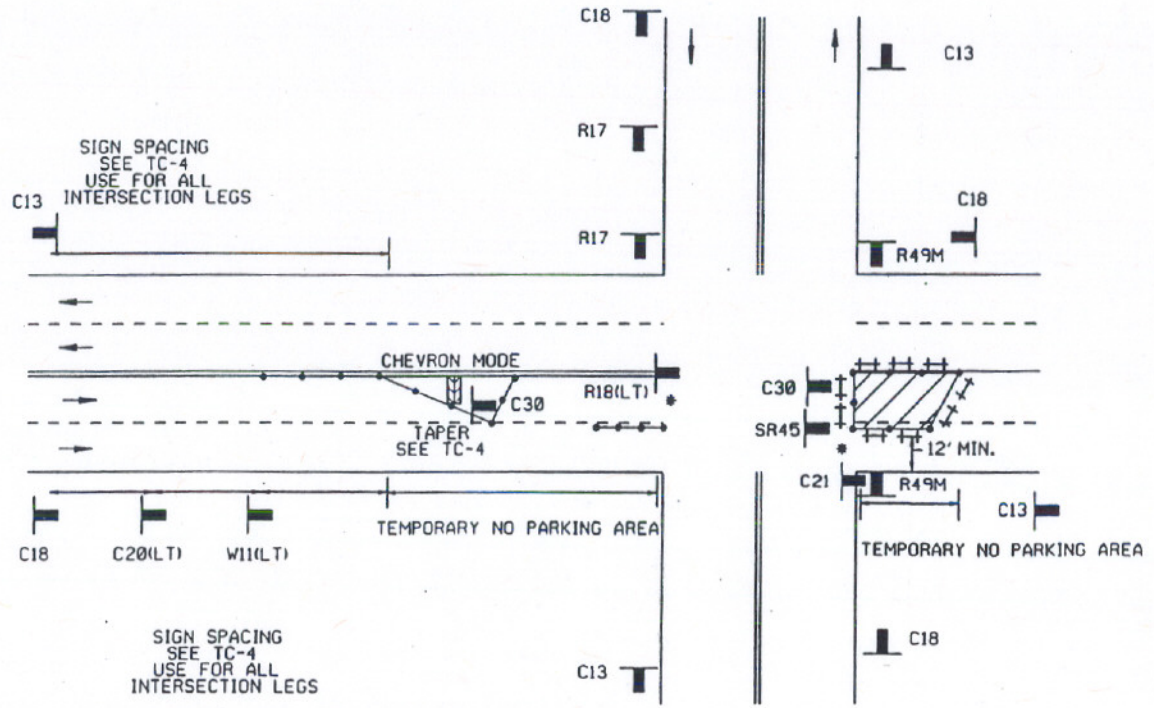

\* LEFT OR RIGHT TURN MOVES MAY BE RESTRICTED.

**LEGEND**

- CONE
- ⇄ BARRICADE
- ▣ FLAGGER
- ▬ SIGN
- ⚡ FLASHING ARROW SIGN
- ▨ WORK AREA
- TRAFFIC DIRECTION

AGENCY ENGINEER'S COMMENTS

\_\_\_\_\_

\_\_\_\_\_

\_\_\_\_\_

\_\_\_\_\_

\_\_\_\_\_

POSTED SPEED LIMIT	APPROACH SPEED	TAPER LENGTH	SPACING OF CONES	SIGN SPACING

SEE TC-4 FOR SIGN, CONE SPACING AND TAPER LENGTH

**GENERAL NOTES**

For hours of darkness, change cones to vertical barricades with steady burn lights.

Consult the local jurisdiction when preparing Traffic Control Plans near these intersections.

This plan MAY NOT apply when the work areas affect bike lanes, sidewalks, pedestrian access, and curved or narrow roadways. Consult the approving agency when preparing the Traffic Control Plan for these areas.

Nothing contained on this drawing shall prevent local jurisdictions from modifying, changing, or adopting new specifications deemed necessary. Criteria for position, location, and use of Traffic Control Devices is solely for the purpose of guidance to assist in the set up of the Traffic Control Plans.

TC-5 is required for all Traffic Control Plans.

**SUBMITTED BY:**

NAME \_\_\_\_\_

COMPANY \_\_\_\_\_

ADDRESS \_\_\_\_\_

PHONE \_\_\_\_\_

584

DRAWING NUMBER TC-26

APPENDIX "A"  
 SAN DIEGO REGIONAL STANDARD  
**CENTER OF ROAD WORK AREA**  
 INTERSECTION TRAFFIC CONTROL

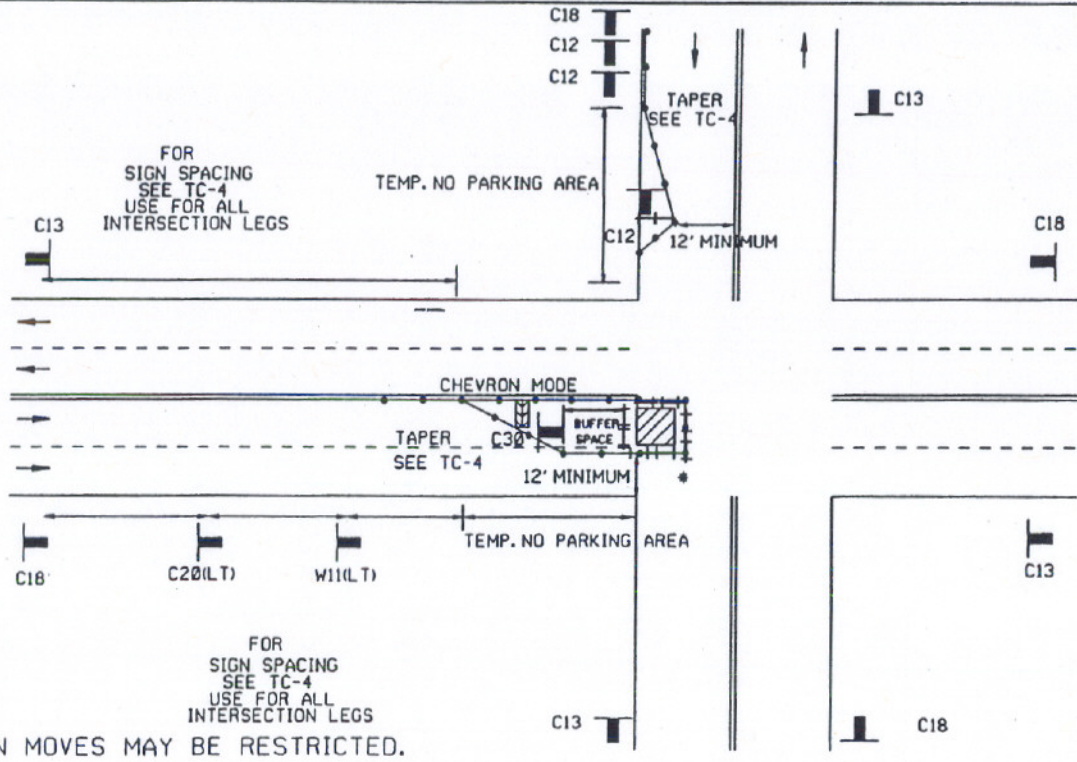

**LEGEND**

- CONE
- ⇄ BARRICADE
- ▬ FLAGGER
- ▬ SIGN
- ◻ FLASHING ARROW SIGN
- ▨ WORK AREA
- ⇄ TRAFFIC DIRECTION

AGENCY ENGINEER'S COMMENTS

\_\_\_\_\_  
 \_\_\_\_\_  
 \_\_\_\_\_  
 \_\_\_\_\_  
 \_\_\_\_\_

POSTED SPEED LIMIT	APPROACH SPEED	TAPER LENGTH	SPACING OF CONES	SIGN SPACING

SEE TC-4 FOR SIGN, CONE SPACING AND TAPER LENGTH

**GENERAL NOTES**

For hours of darkness, change cones to vertical barricades with steady burn lights.

Consult the local jurisdiction when preparing Traffic Control Plans near these intersections.

This plan MAY NOT apply when the work areas affect bike lanes, sidewalks, pedestrian access, and curved or narrow roadways. Consult the approving agency when preparing the Traffic Control Plan for these areas.

Nothing contained on this drawing shall prevent local jurisdictions from modifying, changing, or adopting new specifications deemed necessary. Criteria for position, location, and use of Traffic Control Devices is solely for the purpose of guidance to assist in the set up of the Traffic Control Plans.

TC-5 is required for all Traffic Control Plans.

SUBMITTED BY: NAME \_\_\_\_\_  
 COMPANY \_\_\_\_\_  
 ADDRESS \_\_\_\_\_  
 PHONE \_\_\_\_\_

Revision	By	Approved	Date
ORIG.	DMV	DMV	7-81
001	WAL	[Signature]	10-8-81
002	[Signature]	[Signature]	4-28-85
003	[Signature]	[Signature]	9-15-85

590

Revision	By	Approved	Date
DRAWING	DM		4-21-11
ORIG.	VAL		10-23-14
	008		4-13-15

APPENDIX "A"  
 SAN DIEGO REGIONAL STANDARD  
 CENTER OF ROAD WORK AREA  
 INTERSECTION TRAFFIC CONTROL

DRAWING NUMBER  
 TC-27

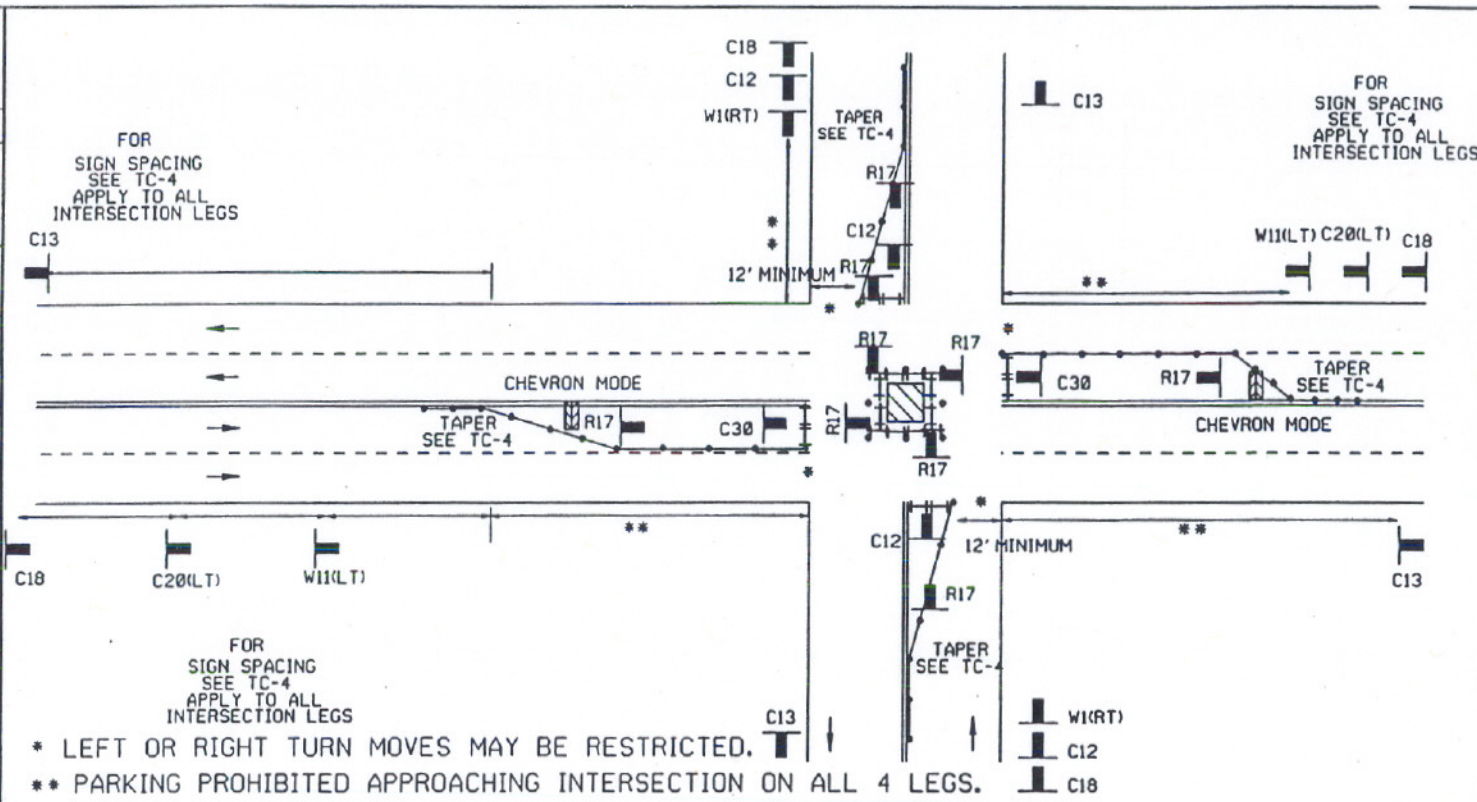

**LEGEND**

- CONE    ++ BARRICADE    [ ] FLAGGER    [ ] SIGN    [ ] FLASHING ARROW SIGN    [ ] WORK AREA    [ ] TRAFFIC DIRECTION

AGENCY ENGINEER'S COMMENTS

---



---



---



---

POSTED SPEED LIMIT	APPROACH SPEED	TAPER LENGTH	SPACING OF CONES	SIGN SPACING

SEE TC-4 FOR SIGN, CONE SPACING AND TAPER LENGTH

**GENERAL NOTES**

For hours of darkness, change cones to vertical barricades with steady burn lights.

Consult the local jurisdiction when preparing Traffic Control Plans near these intersections.

This plan MAY NOT apply when the work areas affect bike lanes, sidewalks, pedestrian access, and curved or narrow roadways. Consult the approving agency when preparing the Traffic Control Plan for these areas.

Nothing contained on this drawing shall prevent local jurisdictions from modifying, changing, or adopting new specifications deemed necessary. Criteria for position, location, and use of Traffic Control Devices is solely for the purpose of guidance to assist in the set up of the Traffic Control Plans.

TC-5 is required for all Traffic Control Plans.

SUBMITTED BY:

NAME \_\_\_\_\_

COMPANY \_\_\_\_\_

ADDRESS \_\_\_\_\_

PHONE \_\_\_\_\_



DRAWING NUMBER TC-28

SIDE OF ROAD WORK AREA  
INTERSECTION TRAFFIC CONTROL

APPENDIX 'A'  
SAN DIEGO REGIONAL STANDARD

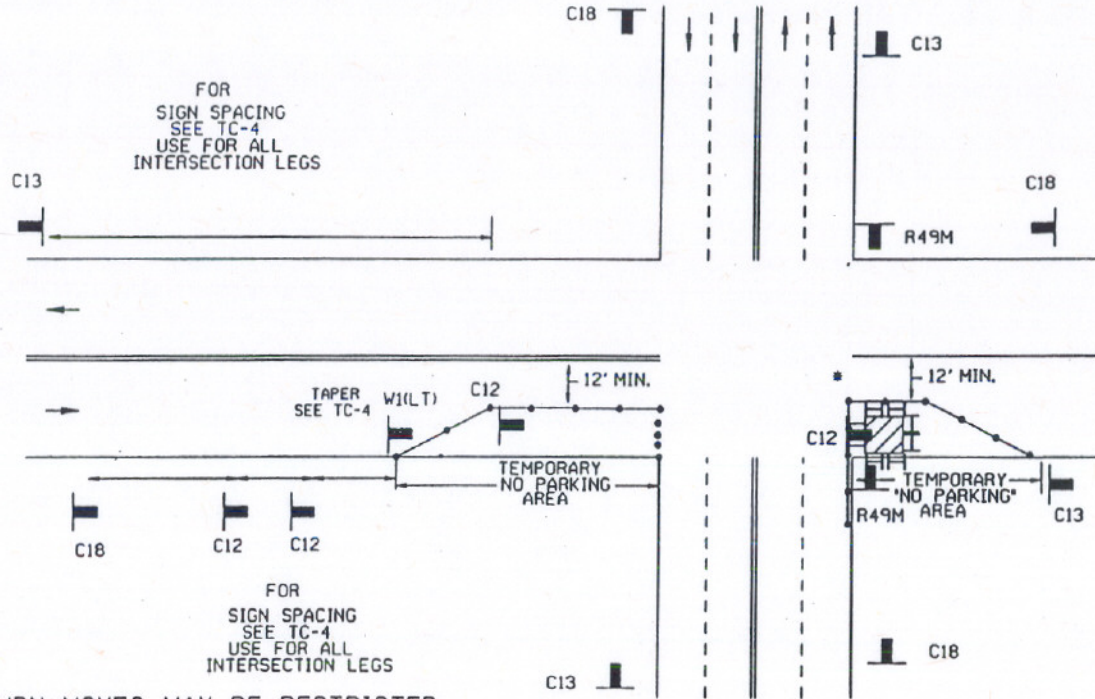

FOR SIGN SPACING SEE TC-4 USE FOR ALL INTERSECTION LEGS

FOR SIGN SPACING SEE TC-4 USE FOR ALL INTERSECTION LEGS

\* RIGHT TURN MOVES MAY BE RESTRICTED.

LEGEND

- CONE
- H BARRICADE
- FLAGGER
- SIGN
- FLASHING ARROW SIGN
- WORK AREA
- TRAFFIC DIRECTION

AGENCY ENGINEER'S COMMENTS

\_\_\_\_\_  
\_\_\_\_\_  
\_\_\_\_\_  
\_\_\_\_\_  
\_\_\_\_\_

POSTED SPEED LIMIT	APPROACH SPEED	TAPER LENGTH	SPACING OF CONES	SIGN SPACING

SEE TC-4 FOR SIGN, CONE SPACING AND TAPER LENGTH

GENERAL NOTES

For hours of darkness, change cones to vertical barricades with steady burn lights.

Consult the local jurisdiction when preparing Traffic Control Plans near these intersections.

This plan MAY NOT apply when the work areas affect bike lanes, sidewalks, pedestrian access, and curved or narrow roadways. Consult the approving agency when preparing the Traffic Control Plan for these areas.

Nothing contained on this drawing shall prevent local jurisdictions from modifying changing, or adopting new specifications deemed necessary. Criteria for position, location, and use of Traffic Control Devices is solely for the purpose of guidance to assist in the set up of the Traffic Control Plans.

TC-5 is required for all Traffic Control Plans.

AGENCY USE

APPLICANT USE

SUBMITTED BY:  
NAME \_\_\_\_\_  
COMPANY \_\_\_\_\_  
ADDRESS \_\_\_\_\_  
PHONE \_\_\_\_\_

Revision	By	Approved	Date
DRAWING	DMV		4-91
ORIG.	ZSM		10-8-91
	VAL		4-23-95
	MMB		5-13-95

592

Revision	By	Approved	Date
DRAWING	DRY		1-11
ORIG.	VAL		4-23-94
	008		4-18-95

APPENDIX "A"  
SAN DIEGO REGIONAL STANDARD  
CENTER OF ROAD WORK AREA  
INTERSECTION TRAFFIC CONTROL

DRAWING NUMBER  
**TC-29**

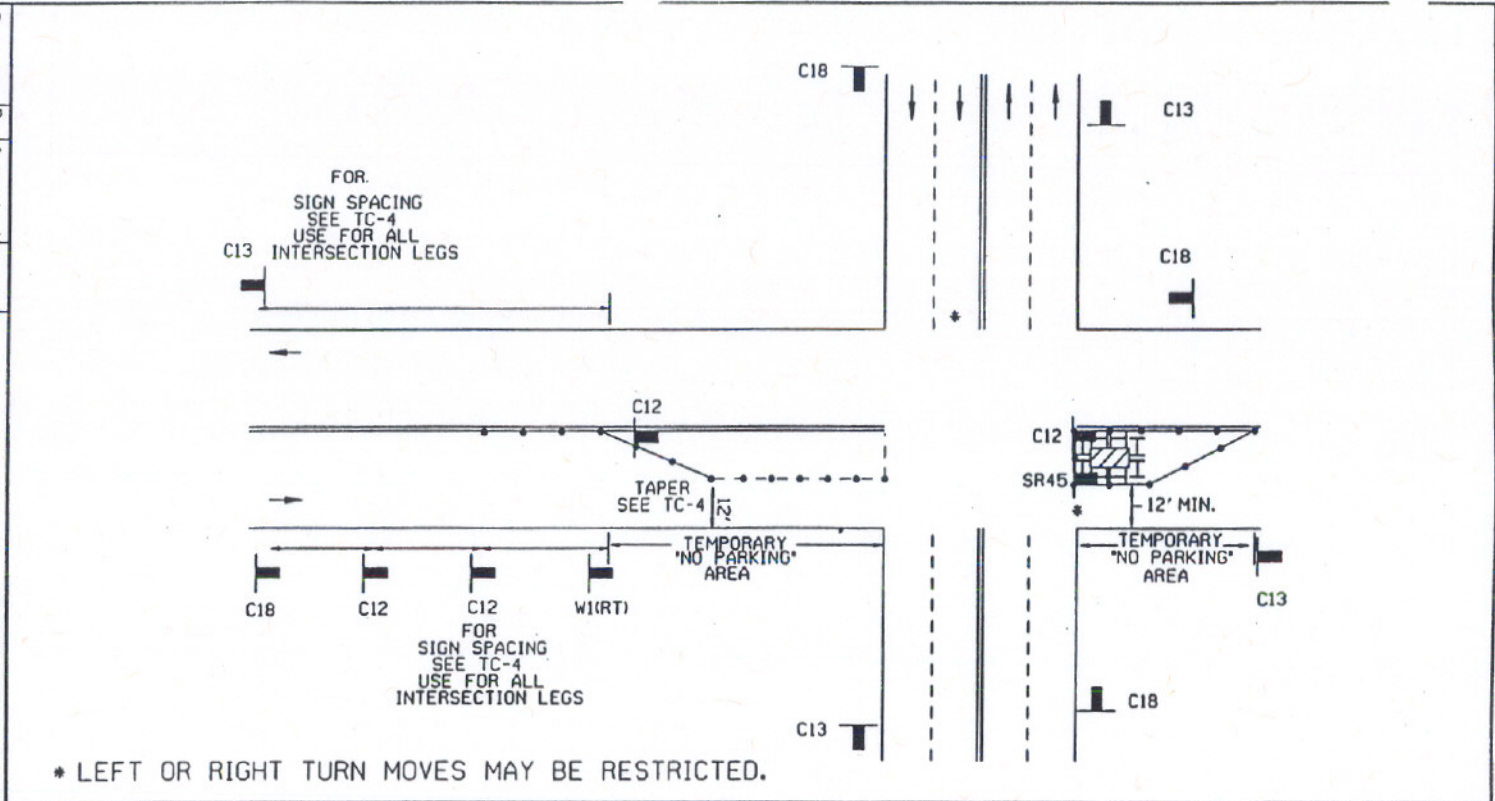

**LEGEND**

• CONE    H BARRICADE    FLAGGER    SIGN    FLASHING ARROW SIGN    WORK AREA    TRAFFIC DIRECTION

AGENCY ENGINEER'S COMMENTS

---



---



---



---



---

AGENCY USE

**SUBMITTED BY:**

NAME \_\_\_\_\_

COMPANY \_\_\_\_\_

ADDRESS \_\_\_\_\_

PHONE \_\_\_\_\_

APPLICANT USE

POSTED SPEED LIMIT	APPROACH SPEED	TAPER LENGTH	SPACING OF CONES	SIGN SPACING

SEE TC-4 FOR SIGN, CONE SPACING AND TAPER LENGTH

**GENERAL NOTES**

For hours of darkness, change cones to vertical barricades with steady burn lights.

Consult the local jurisdiction when preparing Traffic Control Plans near these intersections.

This plan MAY NOT apply when the work areas affect bike lanes, sidewalks, pedestrian access, and curved or narrow roadways. Consult the approving agency when preparing the Traffic Control Plan for these areas.

Nothing contained on this drawing shall prevent local jurisdictions from modifying changing, or adopting new specifications deemed necessary. Criteria for position, location, and use of Traffic Control Devices is solely for the purpose of guidance to assist in the set up of the Traffic Control Plans.

TC-5 is required for all Traffic Control Plans.