

DRAWING NUMBER TC-40

BIKE LANE CLOSURE

APPENDIX "A"
SAN DIEGO REGIONAL STANDARD

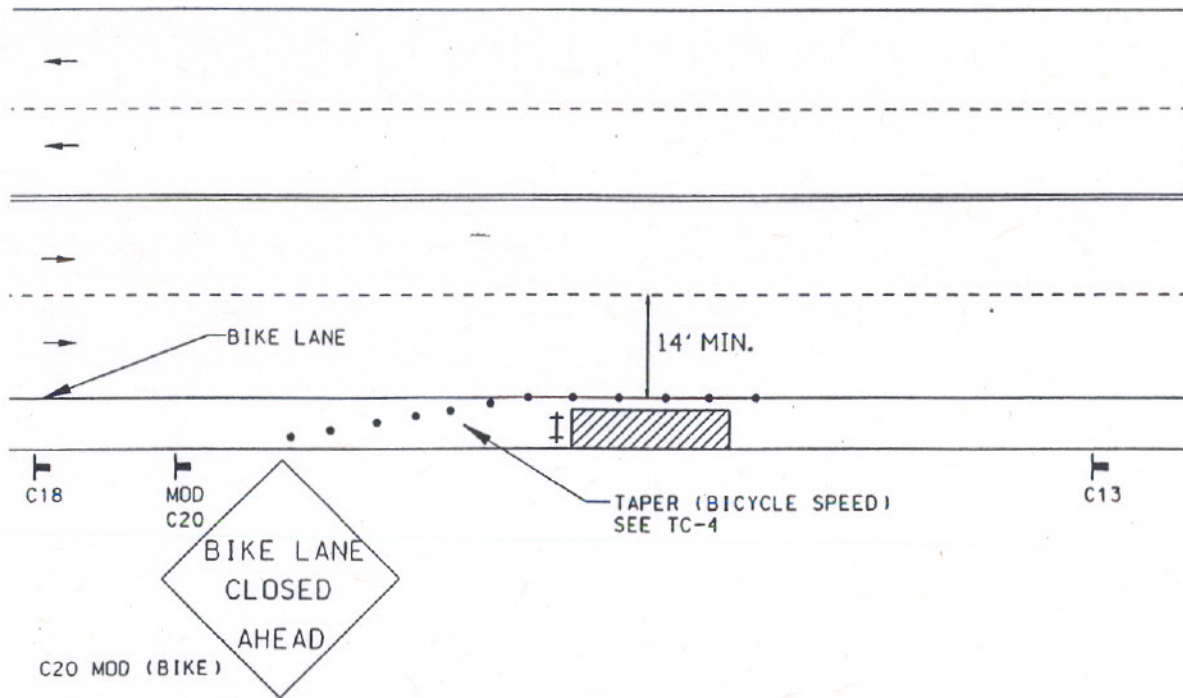

LEGEND

- CONE
- ⊢ BARRICADE
- ▣ FLAGGER
- ⊢ SIGN
- ◻ FLASHING ARROW SIGN
- ▨ WORK AREA
- ↔ TRAFFIC DIRECTION

AGENCY ENGINEER'S COMMENTS

POSTED SPEED LIMIT	APPROACH SPEED	TAPER LENGTH	SPACING OF CONES	SIGN SPACING

SEE TC-4 FOR SIGN AND CONE SPACING AND TAPER LENGTH

GENERAL NOTES

- For hours of darkness, change cones to vertical barricades with steady burn lights.
- Consult the local jurisdiction when preparing Traffic Control Plans near these intersections.
- This plan MAY NOT apply when the work areas affect bike lanes, sidewalks, pedestrian access, and curved or narrow roadways. Consult the approving agency when preparing the Traffic Control Plan for these areas.
- Nothing contained on this drawing shall prevent local jurisdictions from modifying, changing, or adopting new specifications deemed necessary. Criteria for position, location, and use of Traffic Control Devices is solely for the purpose of guidance to assist in the set up of the Traffic Control Plans.
- TC-5 is required for all Traffic Control Plans.

SUBMITTED BY:

NAME _____
 COMPANY _____
 ADDRESS _____
 PHONE _____

Revision	By	Approved	Date
DRAWING	TRD		5-31-94
	MAJ		5-28-94
			4-25-95
	BOB		9-15-95

604

Revision	By	Approved	Date
DRAWING	TRD		5-31-94
	WAD		9-28-94
			4-25-95
	008		9-15-95

APPENDIX "A"
SAN DIEGO REGIONAL STANDARD
SIDE OF ROAD WORK AREA
TYPICAL PEDESTRIAN CONTROL SIGNS

DRAWING NUMBER
TC-41

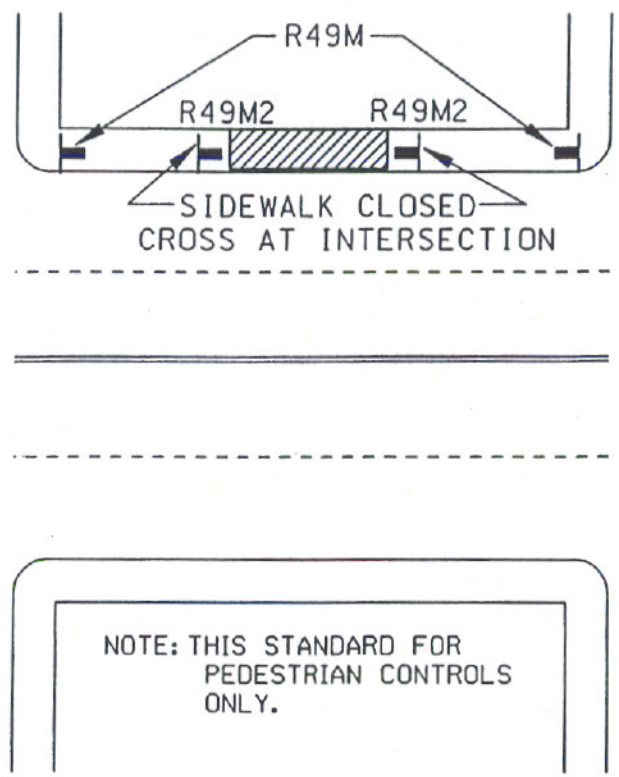
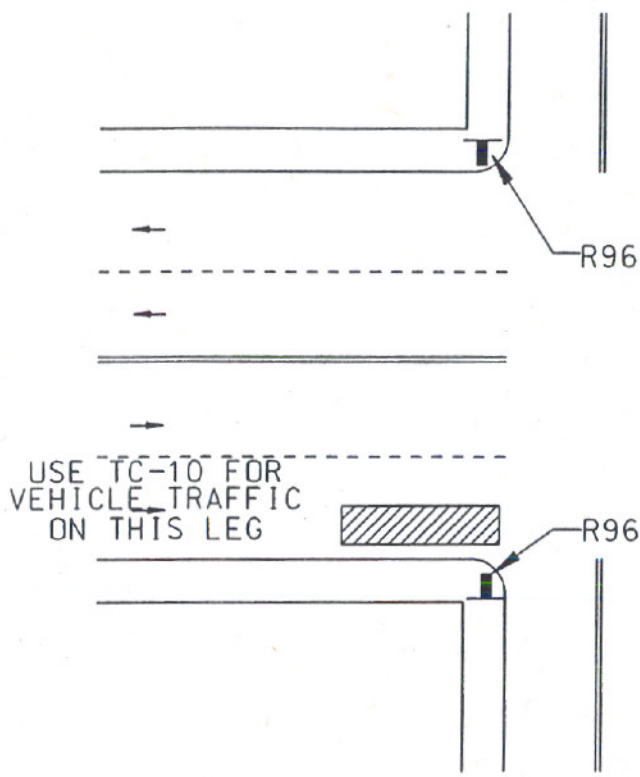

LEGEND

• CONE	⇄ BARRICADE	■ FLAGGER	— SIGN	◻ FLASHING ARROW SIGN	▨ WORK AREA	→ TRAFFIC DIRECTION
--------	-------------	-----------	--------	-----------------------	-------------	---------------------

AGENCY ENGINEER'S COMMENTS

POSTED SPEED LIMIT	APPROACH SPEED	TAPER LENGTH	SPACING OF CONES	SIGN SPACING

SEE TC-4 FOR SIGN, CONE SPACING AND TAPER LENGTH

APPLICANT USE

SUBMITTED BY:

NAME _____

COMPANY _____

ADDRESS _____

PHONE _____

GENERAL NOTES

For hours of darkness, change cones to vertical barricades with steady burn lights.

Consult the local jurisdiction when preparing Traffic Control Plans near these intersections.

This plan MAY NOT apply when the work areas affect bike lanes, sidewalks, pedestrian access, and curved or narrow roadways. Consult the approving agency when preparing the Traffic Control Plan for these areas.

Nothing contained on this drawing shall prevent local jurisdictions from modifying changing, or adopting new specifications deemed necessary. Criteria for position, location, and use of Traffic Control Devices is solely for the purpose of guidance to assist in the set up of the Traffic Control Plans.

TC-5 is required for all Traffic Control Plans.

605

DRAWING NUMBER TC-42

SIDE OF ROAD WORK AREA
MULTILANE ROADWAY W/ RAISED MEDIAN

APPENDIX "A"
SAN DIEGO REGIONAL STANDARD

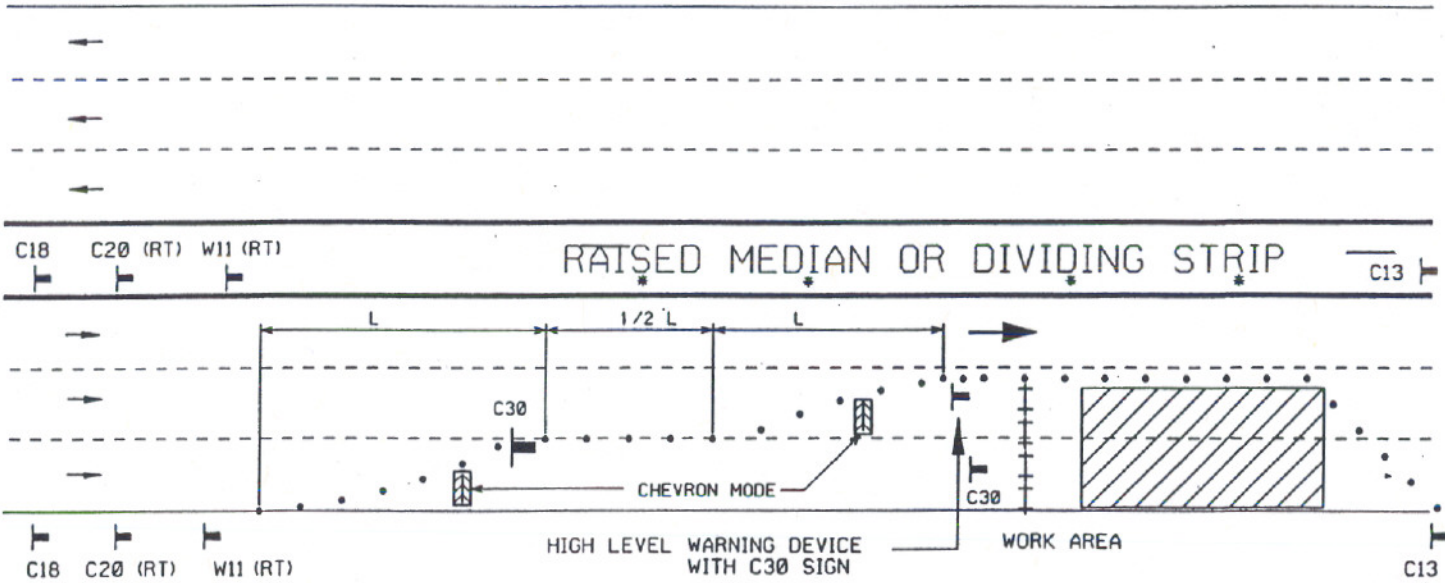

SIGN SPACING SEE TC-4 TABLE 1

TAPER SEE TC-4 TABLE 2

* MEDIAN MAY REQUIRE TEMPORARY PAVEMENT TO CONVEY TRAFFIC VOLUME.

LEGEND

- CONE
- ⇄ BARRICADE
- ⚑ FLAGGER
- ⊥ SIGN
- ⚡ FLASHING ARROW SIGN
- ▨ WORK AREA
- TRAFFIC DIRECTION

AGENCY ENGINEER'S COMMENTS

POSTED SPEED LIMIT	APPROACH SPEED	TAPER LENGTH	SPACING OF CONES	SIGN SPACING

SEE TC-4 FOR SIGN, CONE SPACING AND TAPER LENGTH

GENERAL NOTES

- For hours of darkness, change cones to vertical barricades with steady burn lights.
- This plan DOES NOT apply at signalized or multi-way stop intersections. Consult the local jurisdiction when preparing Traffic Control Plans near these intersections.
- This plan MAY NOT apply when the work areas affect bike lanes, sidewalks, pedestrian access, and curved or narrow roadways. Consult the approving agency when preparing the Traffic Control Plan for these areas.
- Nothing contained on this drawing shall prevent local jurisdictions from modifying, changing, or adopting new specifications deemed necessary. Criteria for position, location, and use of Traffic Control Devices is solely for the purpose of guidance to assist in the set up of the Traffic Control Plans.
- TC-5 is required for all Traffic Control Plans.

SUBMITTED BY:

NAME _____
 COMPANY _____
 ADDRESS _____
 PHONE _____

Revision	By	Approved	Date
1	TRD		6-74
2	VAJ		5-28-75
3	DOB		4-15-76

606

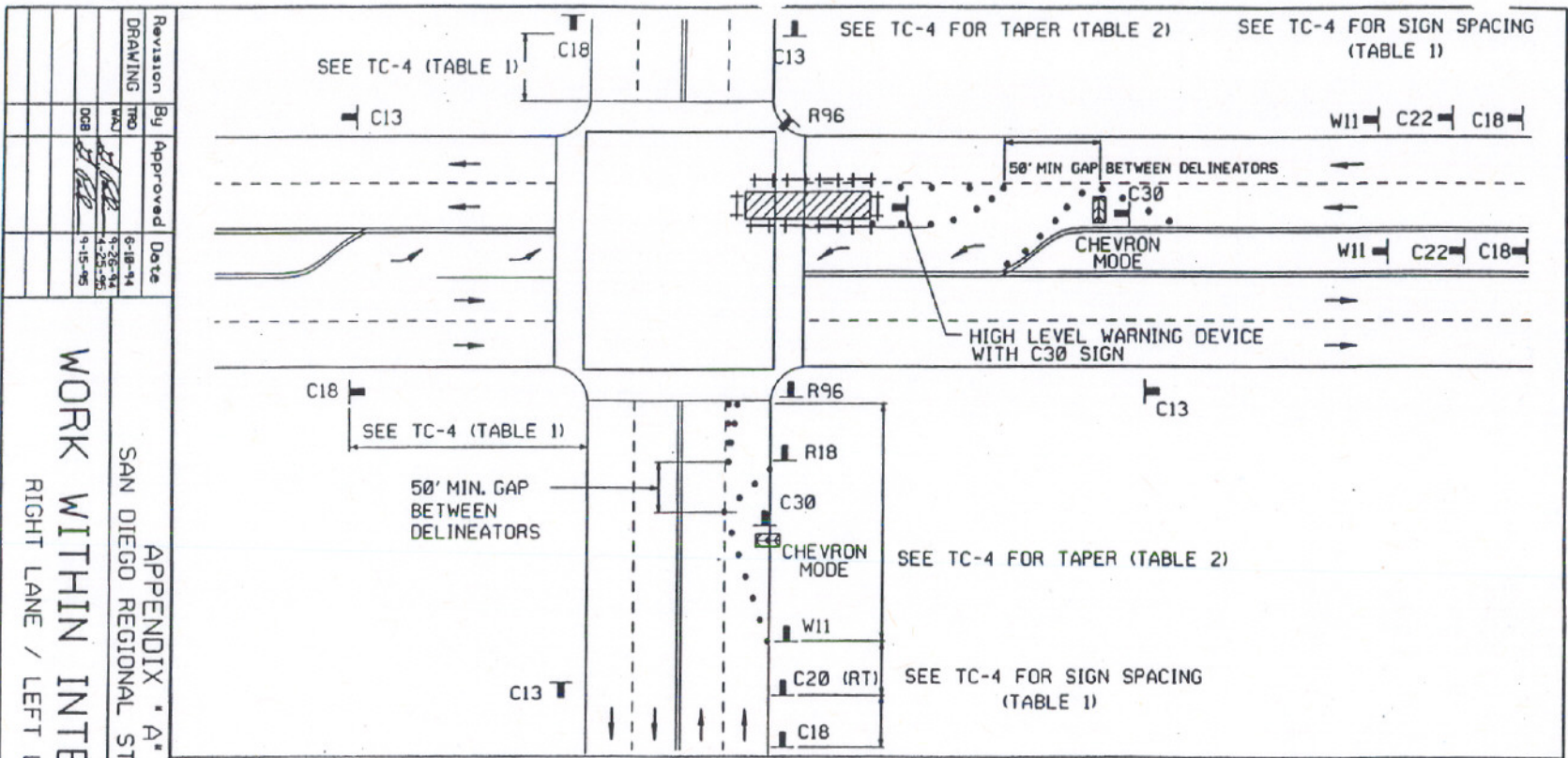

APPENDIX 'A'
 SAN DIEGO REGIONAL STANDARD
WORK WITHIN INTERSECTION
 RIGHT LANE / LEFT LANE

DRAWING NUMBER
TC-43

Revision	By	Approved	Date
DRAWING	TRD		6-18-14
	WAV		9-25-14
			4-25-15
			9-15-15

LEGEND

• CONE † BARRICADE □ FLAGGER T SIGN ◻ FLASHING ARROW SIGN ▨ WORK AREA ⇄ TRAFFIC DIRECTION

AGENCY ENGINEER'S COMMENTS

POSTED SPEED LIMIT	APPROACH SPEED	TAPER LENGTH	SPACING OF CONES	SIGN SPACING

SEE TC-4 FOR SIGN, CONE SPACING AND TAPER LENGTH

SUBMITTED BY:

NAME _____
 COMPANY _____
 ADDRESS _____
 PHONE _____

GENERAL NOTES

For hours of darkness, change cones to vertical barricades with steady burn lights.

Consult the local jurisdiction when preparing Traffic Control Plans near these intersections.

This plan MAY NOT apply when the work areas affect bike lanes, sidewalks, pedestrian access, and curved or narrow roadways. Consult the approving agency when preparing the Traffic Control Plan for these areas.

Nothing contained on this drawing shall prevent local jurisdictions from modifying changing, or adopting new specifications deemed necessary. Criteria for position location, and use of Traffic Control Devices is solely for the purpose of guidance to assist in the set up of the Traffic Control Plans.

TC-5 is required for all Traffic Control Plans.

607

DRAWING NUMBER TC-44

TYPICAL SHOULDER CLOSURE
MULTILANE ROADWAY WITH RAISED MEDIAN

APPENDIX "A"
SAN DIEGO REGIONAL STANDARD

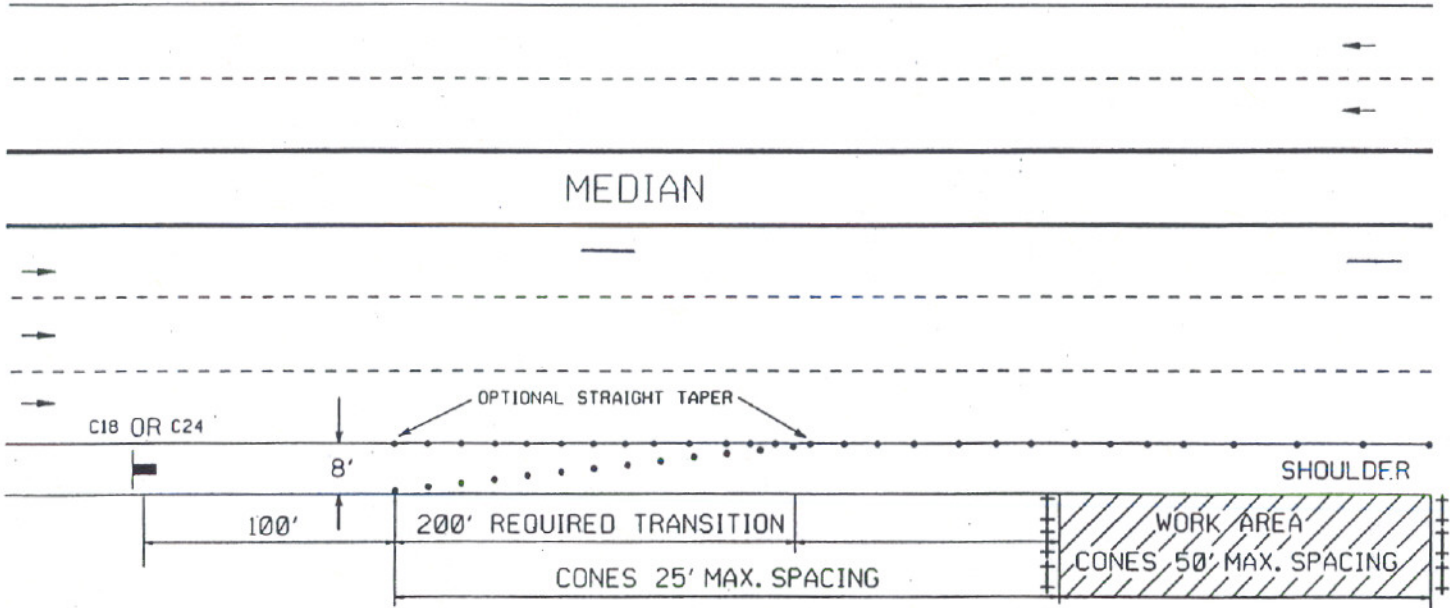

LEGEND

- CONE
- ⇄ BARRICADE
- ▬ FLAGGER
- ▬ SIGN
- ◻ FLASHING ARROW SIGN
- ▨ WORK AREA
- ⇄ TRAFFIC DIRECTION

AGENCY ENGINEER'S COMMENTS

POSTED SPEED LIMIT	APPROACH SPEED	TAPER LENGTH	SPACING OF CONES	SIGN SPACING

SEE TC-4 FOR SIGN, CONE SPACING AND TAPER LENGTH

GENERAL NOTES

- For hours of darkness, change cones to vertical barricades with steady burn lights.
- This plan DOES NOT apply at signalized or multi-way stop intersections. Consult the local jurisdiction when preparing Traffic Control Plans near these intersections.
- This plan MAY NOT apply when the work areas affect bike lanes, sidewalks, pedestrian access, and curved or narrow roadways. Consult the approving agency when preparing the Traffic Control Plan for these areas.
- Nothing contained on this drawing shall prevent local jurisdictions from modifying, changing, or adopting new specifications deemed necessary. Criteria for position, location, and use of Traffic Control Devices is solely for the purpose of guidance to assist in the set up of the Traffic Control Plans.
- TC-5 is required for all Traffic Control Plans.

SUBMITTED BY:

NAME _____
 COMPANY _____
 ADDRESS _____
 PHONE _____

Revision	By	Approved	Date
ORIGINAL	DMV		4-91
1	DMV		10-8-91
2	DMV		4-28-94
3	DMV		4-18-96

608

BLANK PAGE

DRAWING NUMBER
TC-90

APPENDIX "A"
SAN DIEGO REGIONAL STANDARD
SPECIAL CONDITIONS WORK AREA
TWO LANE ROADWAY
WITHOUT CENTERLINE

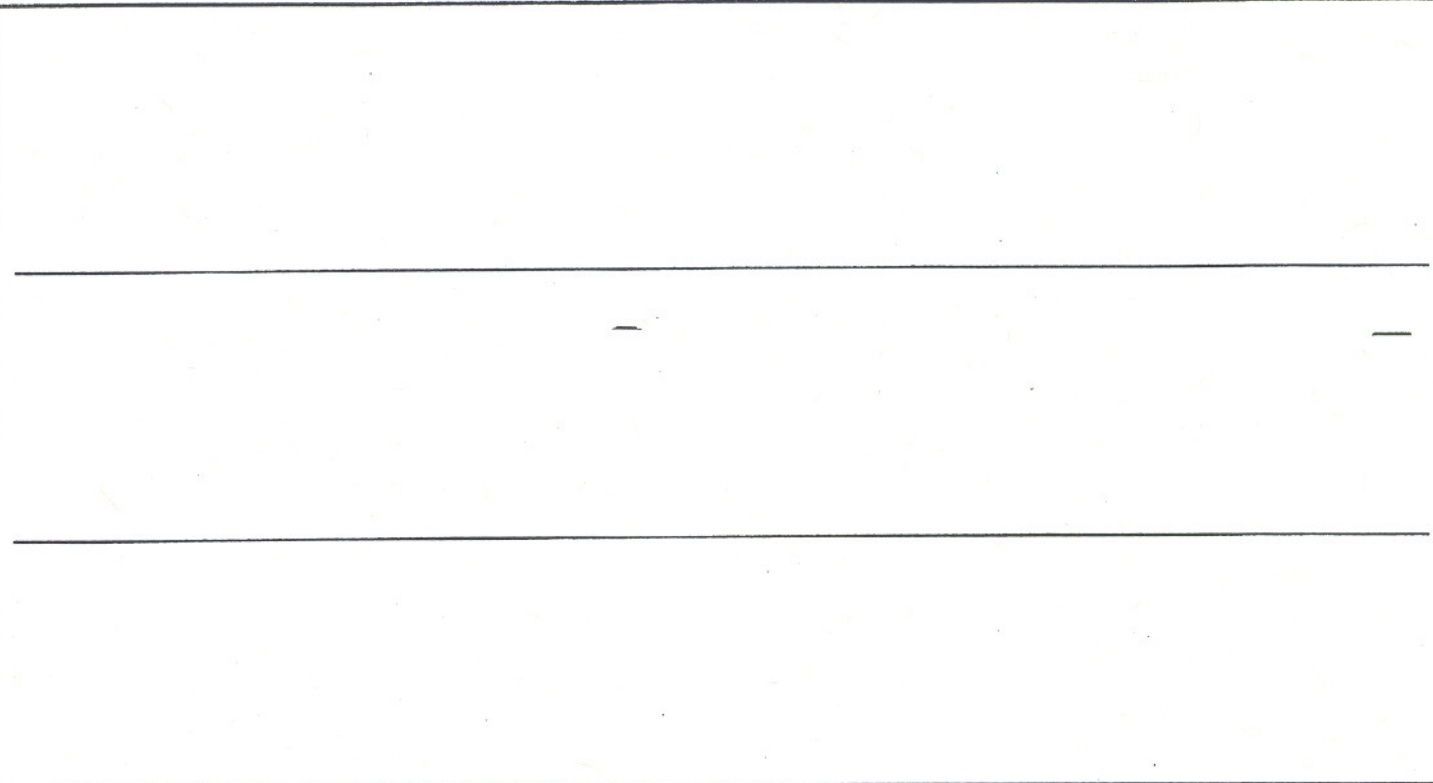

LEGEND

- CONE
- ⚡ BARRICADE
- ▣ FLAGGER
- ▬ SIGN
- ◻ FLASHING ARROW SIGN
- ▨ WORK AREA
- ← → TRAFFIC DIRECTION

TRAFFIC ENGINEERS COMMENTS

POSTED SPEED LIMIT	APPROACH SPEED	TAPER LENGTH	SPACING OF CONES	SIGN SPACING

SEE TC-4 FOR SIGN AND CONE SPACING AND TAPER LENGTH

GENERAL NOTES

For hours of darkness, change cones to vertical barricades with steady burn lights.

This plan DOES NOT apply at signalized or multi-way stop intersections. Consult the local jurisdiction when preparing Traffic Control Plans near these intersections.

This plan MAY NOT apply when the work areas affect bike lanes, sidewalks, pedestrian access, and curved or narrow roadways. Consult the approving agency when preparing the Traffic Control Plan for these areas.

Nothing contained on this drawing shall prevent local jurisdictions from modifying, changing, or adopting new specifications deemed necessary. Criteria for position, location, and use of Traffic Control Devices is solely for the purpose of guidance to assist in the set up of the Traffic Control Plans.

TC-5 is required for all Traffic Control Plans.

SUBMITTED BY:
 NAME _____
 AGENCY _____
 ADDRESS _____
 PHONE _____

Revision	By	Approved	Date
ORIG.	DMV		4-91
	VAL	<i>[Signature]</i>	10-4-94

610

Revision	By	Approved	Date
DRAWING	DRY		4-91
ORIG.	MAL	<i>[Signature]</i>	10-8-91
			10-4-94

APPENDIX "A"
SAN DIEGO REGIONAL STANDARD
SPECIAL CONDITIONS WORK AREA
TWO LANE ROADWAY
WITH CENTERLINE

DRAWING NUMBER
TC-91

LEGEND

- CONE ⇄ BARRICADE 🚧 FLAGGER 📋 SIGN ◻ FLASHING ARROW SIGN ▨ WORK AREA ⇄ TRAFFIC DIRECTION

TRAFFIC ENGINEERS COMMENTS

SUBMITTED BY:

NAME _____

AGENCY _____

ADDRESS _____

PHONE _____

POSTED SPEED LIMIT	APPROACH SPEED	TAPER LENGTH	SPACING OF CONES	SIGN SPACING

SEE TC-4 FOR SIGN AND CONE SPACING AND TAPER LENGTH

GENERAL NOTES

For hours of darkness, change cones to vertical barricades with steady burn lights.

This plan DOES NOT apply at signalized or multi-way stop intersections. Consult the local jurisdiction when preparing Traffic Control Plans near these intersections.

This plan MAY NOT apply when the work areas affect bike lanes, sidewalks, pedestrian access, and curved or narrow roadways. Consult the approving agency when preparing the Traffic Control Plan for these areas.

Nothing contained on this drawing shall prevent local jurisdictions from modifying, changing, or adopting new specifications deemed necessary. Criteria for position, location, and use of Traffic Control Devices is solely for the purpose of guidance to assist in the set up of the Traffic Control Plans.

TC-5 is required for all Traffic Control Plans.

611

DRAWING NUMBER
TC-92

APPENDIX "A"
SAN DIEGO REGIONAL STANDARD
SPECIAL CONDITIONS WORK AREA
MUL TILANE ROADWAY
WITH CENTERLINE

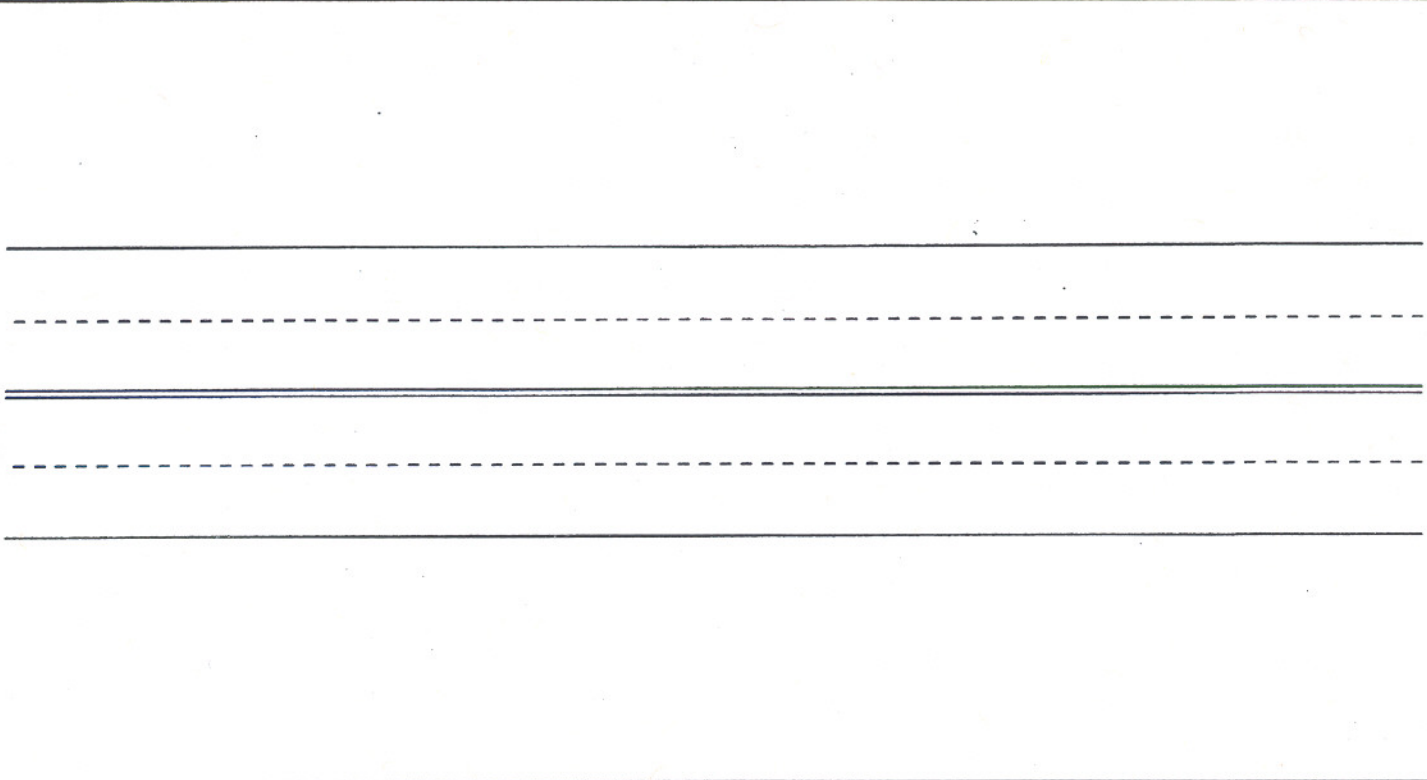

LEGEND

- CONE
- ⇄ BARRICADE
- ▀ FLAGGER
- ▬ SIGN
- ◻ FLASHING ARROW SIGN
- ▨ WORK AREA
- ⇄ TRAFFIC DIRECTION

TRAFFIC ENGINEERS COMMENTS

POSTED SPEED LIMIT	APPROACH SPEED	TAPER LENGTH	SPACING OF CONES	SIGN SPACING

SEE TC-4 FOR SIGN AND CONE SPACING AND TAPER LENGTH

GENERAL NOTES

For hours of darkness, change cones to vertical barricades with steady burn lights.

This plan DOES NOT apply at signalized or multi-way stop intersections. Consult the local jurisdiction when preparing Traffic Control Plans near these intersections.

This plan MAY NOT apply when the work areas affect bike lanes, sidewalks, pedestrian access, and curved or narrow roadways. Consult the approving agency when preparing the Traffic Control Plan for these areas.

Nothing contained on this drawing shall prevent local jurisdictions from modifying, changing, or adopting new specifications deemed necessary. Criteria for position, location, and use of Traffic Control Devices is solely for the purpose of guidance to assist in the set up of the Traffic Control Plans.

TC-5 is required for all Traffic Control Plans.

SUBMITTED BY:
 NAME _____
 AGENCY _____
 ADDRESS _____
 PHONE _____

Revision	By	Approved	Date
DRAWING	DMV		4-91
ORC			10-8-91
			10-4-94

612

Revision	By	Approved	Date
DRAWING	pmv		4-91
ORIG.	MAJ		10-8-91
			10-4-94

APPENDIX -A-
SAN DIEGO REGIONAL STANDARD

SPECIAL CONDITIONS WORK AREA
 TWO LANE ROADWAY
 WITH TWO WAY LEFT TURN LANE

DRAWING NUMBER
TC-93

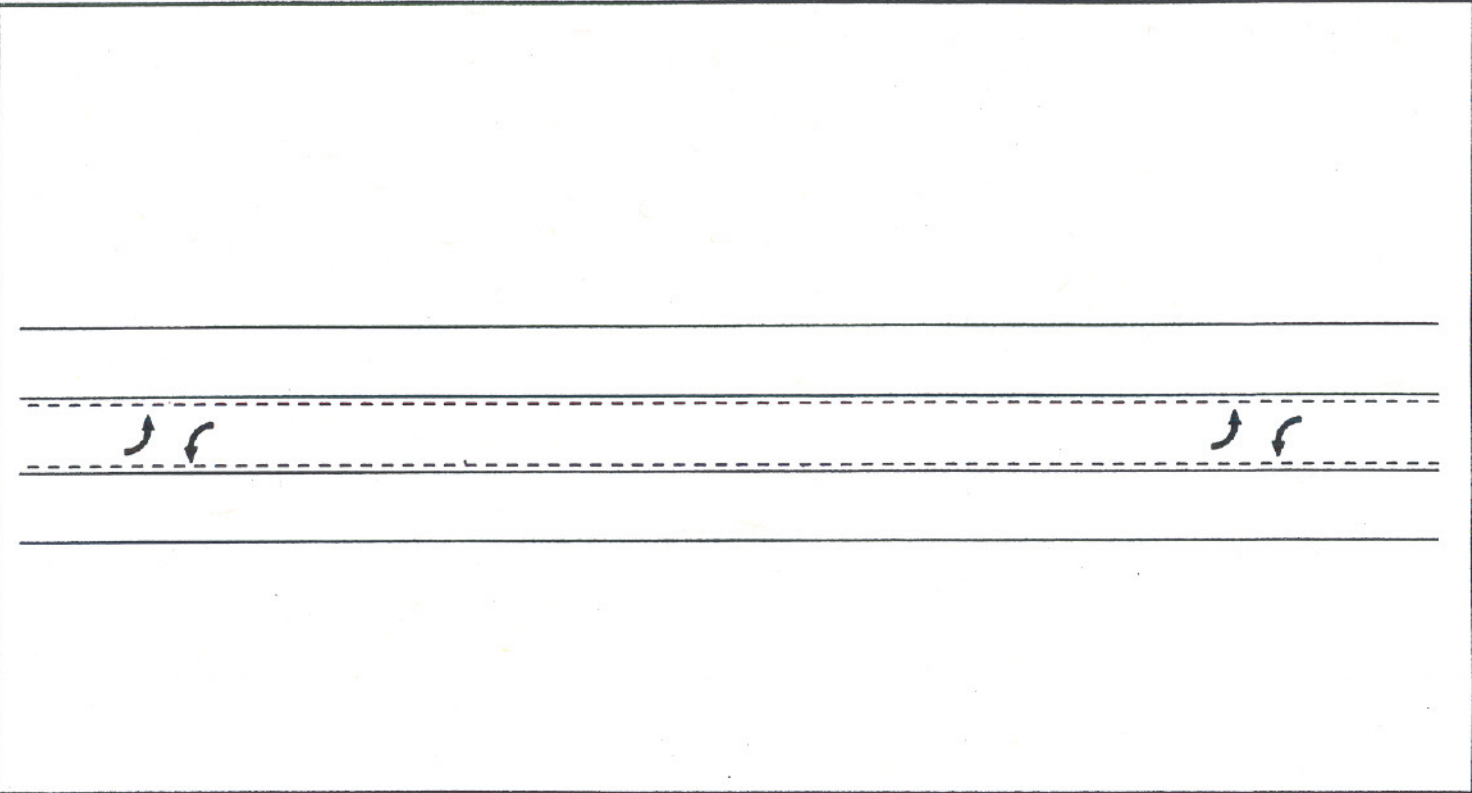

LEGEND

CONE
 BARRICADE
 FLAGGER
 SIGN
 FLASHING ARROW SIGN
 WORK AREA
 TRAFFIC DIRECTION

TRAFFIC ENGINEERS COMMENTS

SUBMITTED BY:
 NAME _____
 AGENCY _____
 ADDRESS _____
 PHONE _____

POSTED SPEED LIMIT	APPROACH SPEED	TAPER LENGTH	SPACING OF CONES	SIGN SPACING

SEE TC-4 FOR SIGN AND CONE SPACING AND TAPER LENGTH

GENERAL NOTES

For hours of darkness, change cones to vertical barricades with steady burn lights.

This plan DOES NOT apply at signalized or multi-way stop intersections. Consult the local jurisdiction when preparing Traffic Control Plans near these intersections.

This plan MAY NOT apply when the work areas affect bike lanes, sidewalks, pedestrian access, and curved or narrow roadways. Consult the approving agency when preparing the Traffic Control Plan for these areas.

Nothing contained on this drawing shall prevent local jurisdictions from modifying, changing, or adopting new specifications deemed necessary. Criteria for position, location, and use of Traffic Control Devices is solely for the purpose of guidance to assist in the set up of the Traffic Control Plans.

TC-5 is required for all Traffic Control Plans.

613