

APPENDIX B

Trip Generation, Project Information
Form, Vehicle Miles Travelled



LOS Engineering, Inc.
Traffic and Transportation

11622 El Camino Real, Suite #100, San Diego, CA 92130
Phone 619-890-1253, Email: Justin@LOSengineering.com

August 7, 2020

Ms. Meghan Cedeno, P.E.
City of San Diego
1222 First Avenue, MS 501
San Diego, CA 92101

Subject: Trip Generation, Project Information Form, and Vehicle Miles Traveled for the Fourth Corner Apartment Redevelopment Project (PTS# 661800)

Dear Ms. Cedeno:

LOS Engineering, Inc. is pleased to present this Trip Generation Analysis, Project Information Form (PIF), and Vehicle Miles Traveled (VMT) analysis for the Fourth Corner Apartment Redevelopment Project. The project is located at 4021, 4035, 4037 and 4061 Fairmount Avenue in the City Heights Neighborhood within the Mid-City Communities Planning Area in San Diego, California.

A PIF that includes the project location/context, site plan, project description, and trip generation and distribution is required by the City of San Diego to determine the types of analysis that will be required, including a Local Mobility Analysis (LMA) and/or a VMT based transportation analysis to evaluate transportation impacts under CEQA. The PIF is included as **Attachment A**.

An Environmental Impact Report (EIR) is being prepared for this project due to the removal of one historical structure.

The following discretionary approvals are required as part of the project:

- 1) Site Development Permit
- 2) Tentative Map

PROJECT DESCRIPTION

The project site includes six contiguous lots located at 4021, 4035, 4037 and 4061 Fairmount Avenue in the City Heights Neighborhood within the Mid-City Communities Planning Area in San Diego, California. The proposed project is a transit-oriented mixed-use/infill development project that includes:

- A total of 75 multi-family apartments (100% affordable housing except for the manager's unit).
- Residential amenities of an outdoor/community recreation open space on a podium deck (approximately 5,000 sf), a 1,530 sf resident's lounge, community kitchen, and technology space.
- A public use community meeting room of approximately 1,818 sf located on the ground floor.

The project site is 0.87 acres, and the proposed dwelling unit density is 86.2 du/acre (75 units/0.87 acres). The project site is shown in **Figure 1**. A site plan is shown in **Figure 2**.

Figure 1: Project Location

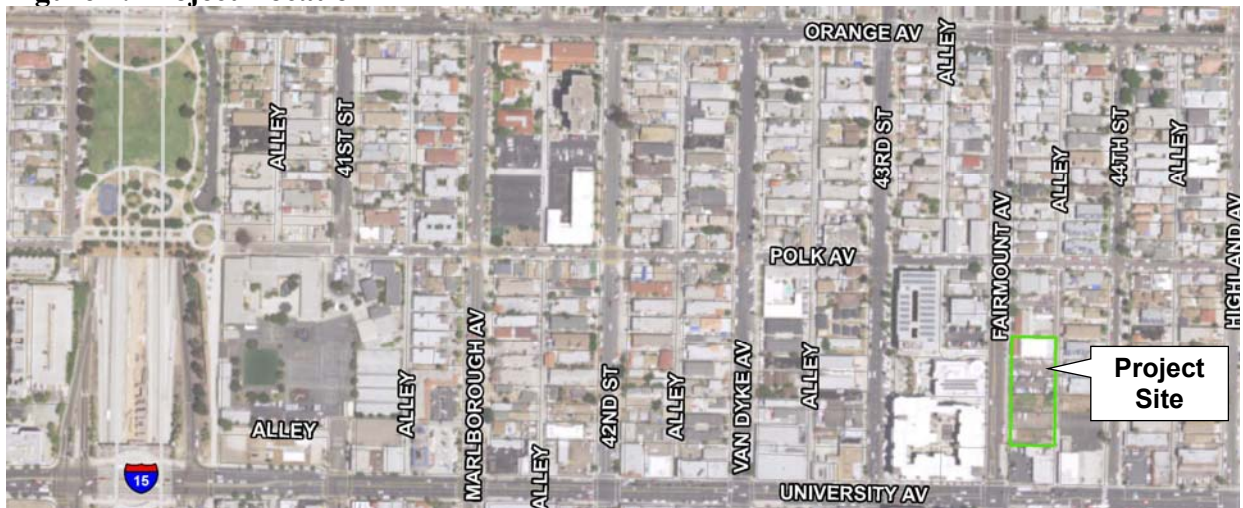

Source: Baranek Consulting Group

Figure 2: Project Site Plan

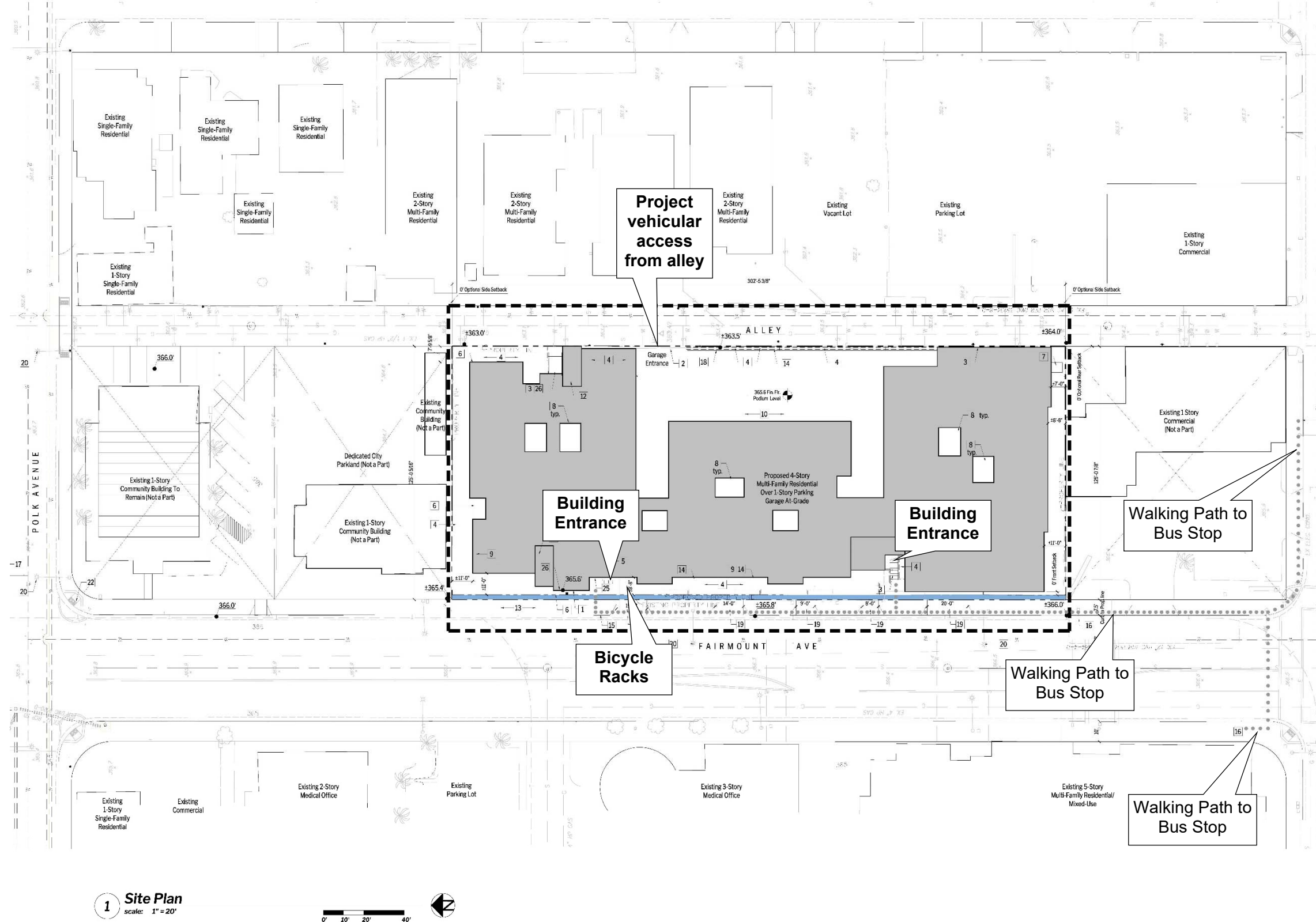

Site Plan Notes

- 1 | Building Entrance
- 2 | Garage Entrance Gate
- 3 | Emergency Egress
- 4 | Landscaped Planter, See Landscape Plans
- 5 | Bicycle Racks
- 6 | Architectural Projection: Balcony, Roof Overhang, Shade Structure, etc.
- 7 | Electrical Transformer Above Grade
- 8 | Light Well
- 9 | Limit of Garage Wall
- 10 | Community Courtyard at Podium Level
- 11 | Elevator Penthouse
- 12 | Stair to Roof
- 13 | Enhanced Paving, See Landscape Plans
- 14 | Architectural Screening of Street and Alley Frontages
- 15 | Street Curb-line
- 16 | Transit Stop
- 17 | Fire Hydrant
- 18 | Edge of Podium Deck
- 19 | Existing Driveway Curb Cut to be Removed/ Closed. All non-utilized curb cuts should also be closed and replaced with curbs, gutters, and sidewalk.
- 20 | Existing Streetlight to Remain
- 21 | Existing Landscape to Remain
- 22 | Existing Curb Ramp to Remain
- 23 | Existing Driveways to Remain
- 24 | Existing Parking to Remain
- 25 | Building Access Numbers to be located on Brick Veneer Wall adjacent to street entrance. See elevations.
- 26 | Knee Box will be mounted per SDMC.

General Notes

See CM Sheet C3.0 for Additional Information

Building Address:
 4089, 4051, 4035 & 4021 Fairmount Avenue San Diego, CA 92105

Off Street Parking:
 See A2.0 Garage Plans and A10.0 Project Data for Parking configuration and calculations

Drainage:
 See Civil Plans for additional information

Refuse & Recycling:
 See A2.0 Garage Plans and A10.0 Project Data for additional information

Fire Hydrants:
 See Site Plan Notes and Civil Plans for additional information

Transit:
 13, 17, 30 Bus Service on Fairmount and University

Easements:
 No Existing Easements on Site

1. Address identification shall be provided for all new & (2) buildings in a location that is plainly visible and legible from the street or road fronting the property. Where access is by way of a private road and building address cannot be viewed from the public way, an approved sign or signs shall be used to identify the structure. addresses identification shall conform to Section 96.0209 of the San Diego Municipal Code and CSR 5612.

Legend

- Key Note
- Property Line
- Project Boundary/Limit of Work
- Path to Transit Stop

DESS ARCHITECTURE
 4516 1/2 30th Street
 San Diego, CA 92118

ARCHITECT:
 LICENSED ARCHITECT

DEBORAH SMITHTON, AIA
 (619) 573-5522

4th Corner Apartmtns
 4021, 4035, 4037, and 4061
 Fairmount Ave
 San Diego, CA 92105

DEVELOPER:
 Wakeland Housing & Development
 1230 Columbia Street
 San Diego CA 92105

phone: (619) 577-3200
 contact: Peter Armstrong

Completeness check 3.17.20
 First Submittal 4.16.20
 Second Submittal 6.22.20
 Third Submittal 7.17.20

PROJECT TRIP GENERATION

The City of San Diego *Trip Generation Manual*, May 2003 and the Institute of Transportation Engineers (ITE) *10th Edition*, September 2017 were used to calculate the trip generation for the project uses. ITE rates were used for the community room as the City does not have a specific rate for community room. Trip generation rates are included in **Attachment B**.

The project site has existing uses that are occupied and generating traffic. The existing uses include a 7,936 sf building at 4061 Fairmount Avenue and 0.27 acres of community gardens at 4021 & 4037 Fairmount Avenue that when combined are calculated to generate 189 ADT with 13 AM peak hour trips (10 inbound and 3 outbound) and 18 PM peak hour trips (7 AM inbound and 11 PM outbound). The remaining parcel at 4035 Fairmount Avenue is a parking lot serving adjacent uses; therefore, it is not included in the trip generation credit calculation.

The proposed project is calculated to 502 ADT with 39 AM peak hour trips (9 inbound and 30 outbound) and 44 PM peak hour trips (30 inbound and 14 outbound) based on 75 multi-family dwelling units and 1,818 sf of community meeting space.

The net change in trip generation (after applying a trip credit noted above for the existing uses to be replaced by the project) is calculated at 313 ADT with 26 AM peak hour trips (-1 inbound and 27 outbound) and 26 PM peak hour trips (23 inbound and 3 outbound). The trip generation for the proposed project, existing uses, and net change are shown in **Table 1**.

Table 1: Project Trip Generation

Proposed and Existing Land Use	Rate	Size & Units	ADT	Pk Hr			AM Pk Hr		Pk Hr		PM Pk Hr		
				Factor	Split	IN	OUT	Factor	Split	IN	OUT		
<u>Proposed Project</u>													
Residential MF (>20 du/acre)	6 /DU	75 DU	450	8%	0.2	0.8	7	29	9%	0.7	0.3	28	12
Rec. Community Center ITE 495	28.82 /KSF	1,818 SF	52	1.76	0.66	0.34	2	1	2.31	0.47	0.53	2	2
		Subtotal	502				9	30				30	14
							AM Total: 39					PM Total: 44	
<u>Credit for existing uses</u>													
Single Tenant Office	10 /KSF	-2,865 SF	-29	15%	0.9	0.1	-4	0	15%	0.1	0.9	0	-4
Rec. Community Center ITE 495	28.82 /KSF	-5,071 SF	-146	1.76	0.66	0.34	-6	-3	2.31	0.47	0.53	-6	-6
Community Garden (Park TG rate)	50 /Acre	-0.27 Acres	-14	4%	0.5	0.5	0	0	8%	0.5	0.5	-1	-1
		Subtotal	-189				-10	-3				-7	-11
							AM Total: -13					PM Total: -18	
Net Change: 313							-1 27					23 3	
							AM Total: 26					PM Total: 26	

Source: City of San Diego *Trip Generation Manual*, May 2003 and ITE 10th Edition 2017. Notes: KSF - 1,000 Square Feet; DU - Dwelling Unit; ADT Average Daily Traffic. Pk Hr (Peak Hour) Factor is either % of ADT for SANDAG or rate of SF for ITE. MF: Multi-Family. Excel rounding may result in ± 1 to above numbers.

VEHICLE MILES TRAVELED (VMT)

A VMT analysis is required to satisfy the California Environmental Quality Act (CEQA) guidelines that utilize VMT as the measure of effectiveness for determining transportation impacts. The California Governor's Office of Planning and Research (OPR) Technical Advisory developed guidance on implementing Senate Bill 743 (SB 743) that shifts the transportation impact measure of effectiveness from Level of Service (LOS) to VMT. In compliance with SB 743 and OPR guidance, the City of San Diego has developed Draft Transportation Study Manual Guidelines (TSM, June 10, 2020) to evaluate impacts under CEQA using a VMT metric.

The screening criteria to determine if a detailed transportation VMT analysis is required is based on the City of San Diego *Draft Transportation Study Manual*, dated June 10, 2020. A project that meets at least one of eight (8) screening criteria would be presumed to have a less than significant transportation impact due to the project characteristics and/or location:

- 1) Residential or Commercial Project Located in a VMT Efficient Area:** The project is a residential or commercial employment project located in a VMT Efficient Area (15% or more below the base year average household VMT/Capita or Employee VMT/Employee) based on the applicable location-based screening map produced by SANDAG.

RESULT: **Satisfied** because the residential project is located in a VMT Efficient Area that has an average 2016 resident VMT/Capita of 53.4% of the regional average VMT/Capita based on the SANDAG screening map (**Appendix C**).

The project does not require a detailed transportation VMT analysis because the primarily residential project satisfies the VMT Efficient Area criteria; therefore, the project would be presumed to have a less than significant transportation impact.

LOCAL MOBILITY ANALYSIS (LMA)

The City of San Diego *Draft Transportation Study Manual guidelines*, dated June 10, 2020, has a Project Information Form (PIF) to summarize the project information to determine if the project generates enough traffic to require a Local Mobility Analysis (LMA) or whether it can be screened out from preparing an LMA. Based on the Draft TSM guidelines, the project is screened out from requiring an LMA because the project is consistent with the Community Plan Zoning and is expected to generate less than 1,000 ADT.

DRIVEWAY ACCESS AND CIRCULATION

Vehicular access is proposed from a full access driveway to the alley on the east side of the project site as previously shown in Figure 2. The alley intersects Polk Ave to the north and University Ave to the south, which are both unsignalized intersections. The alley and surrounding streets are laid out in a grid pattern. As part of the project, the four existing curb cuts along the Fairmount Avenue frontage will be closed and the curb will be designated for

passenger loading, zone for USPS, red curb for fire access, and remainder to be on-street parking to the satisfaction of the City Engineer.

PEDESTRIAN ACCESS AND CIRCULATION

Pedestrian project access would be from existing sidewalks along the project frontage on Fairmount Avenue. The project proposes to dedicate a width of 2.3 ft along the project frontage on Fairmount Avenue and reconstruct the existing sidewalk to include landscaping and a non-contiguous sidewalk. The alley along the back side of the project does not have existing sidewalks and no sidewalks are proposed in the alley per current City standards.

TRANSIT

Metropolitan Transit System (MTS) lists Bus Routes 7, 10, 13, and 965 near the project site. Additionally, Rapid Routes 60 and 235 serve the City Heights Transit Plaza at University Ave and SR-15. Each route has specific start and end times depending on direction of travel; therefore, the latest start time is summarized herein rather than the earliest (i.e. if a NB direction start time is listed as 5AM and the SB direction start time is listed as 6AM). A map of the routes and individual schedules are included in **Attachment D**.

The project building entrance is approximately 450 feet from the intersection of Fairmount Ave and University Ave which has bus stops for Routes 7, 10, 13, and 965. The project building entrance is approximately 2,900 feet (just over ½ mile) from the City Heights Transit Plaza at SR-15/University Ave; however, the routes noted above provide service to this transit plaza. This transit plaza provides access to Routes 60 and 235. A summary of the service times is shown in **Table 2** for weekdays and **Table 3** for weekend days.

Table 2: Weekday Bus Service

Bus Route	Weekday Service Operations (Off-Peak Service Frequency Range)	7-9 AM Peak Hour Service Frequency	4-6 PM Peak Hour Service Frequency
Route 7	≈ 4:30 AM to ≈ 1:30 AM (≈ 12-30 minutes)	10 minutes	10 minutes
Route 10	≈ 5:50 AM to ≈ 11:00 PM (≈ 15-30 minutes)	15 minutes	15 minutes
Route 13	≈ 4:30 AM to ≈ 11:20 PM (≈ 12-30 minutes)	12 minutes	12 minutes
Rapid 60	NB ≈ 5-8 AM. SB ≈ 3:30-7:00 PM (≈ 20-35 minutes)	20* minutes	35** minutes
Rapid 235	≈ 5:00 AM to ≈ 11:45 PM (≈ 15-30 minutes)	15 minutes	15 minutes
Route 965	≈ 5:00 AM to ≈ 9:00 PM (≈ 35 minutes)	35 minutes	35 minutes

Notes: * AM peak hour service is only northbound from 5pm to 7am. ** PM peak hour service is only southbound from 3:30pm to 6pm.

Table 3: Weekend Bus Service

Bus Route	Saturday Service Operations (Service Frequency Range)	Sunday Service Operations (Service Frequency Range)
Route 7	≈ 5:30 AM to ≈ 12:50 PM (≈12-30 min.)	≈ 6:00 AM to ≈ 11:00 PM (≈ 12-30 min.)
Route 10	≈ 6:00 AM to ≈ 11:00 PM (≈20-30 min.)	≈ 6:30 AM to ≈ 8:00 PM (≈ 30-60 min.)
Route 13	≈ 5:30 AM to ≈ 10:50 PM (≈20-30 min.)	≈ 5:45 AM to ≈ 8:50 PM (≈ 30-60 min.)
Rapid 60	No Scheduled Service	No Scheduled Service
Rapid 235	≈ 5:15 AM to ≈ 11:15 PM (≈30 min.)	≈ 5:15 AM to ≈ 11:15 PM (≈30 min.)
Route 965	≈ 7:00 AM to ≈ 7:40 PM (≈ 35 minutes)	No Scheduled Service

A scaled drawing showing the walking paths and bus stops on Fairmount Ave and University Ave are shown in Figure 2. A compressed non-scaled map showing overall nearby bus routes and bus stops in the project area are shown in **Figure 3**.

Figure 3: Nearby Metropolitan Transit System Bus Routes and Bus Stops

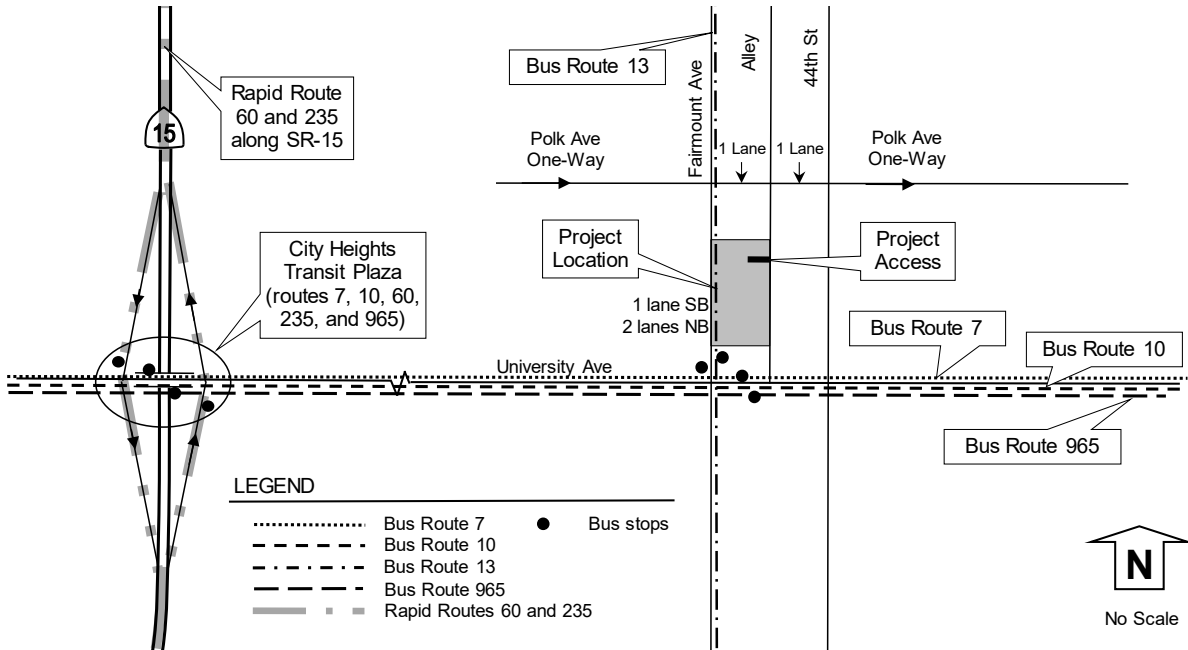

BICYCLE

The *Mid-City Communities Plan* shows a Proposed Class II/III bike lane on Fairmount Avenue along the project frontage. Along the project frontage on Fairmount Ave, there are currently no Class II bike lanes nor Class III bike route signs and the project does not propose to construct bicycle facilities. However, the project will include bicycle parking for residents and visitors to the development. Excerpts from the City of San Diego *Mid-City Communities Plan* are included in **Attachment E**.

TRANSPORTATION DEMAND MANAGEMENT (TDM)

A TDM plan is not required or proposed as part of the project because the project does not include non-residential development that would accommodate over 50 tenant-occupants (employees) as documented in the Project’s Climate Action Plan (CAP) Consistency Checklist.

ON-SITE PARKING (Vehicles, Motorcycles, and Bicycles)

On-site parking for vehicles is provided in a secured street level garage with access from the alley on the back side of the building. On-site parking for bicycles is provided in a secured, enclosed, and dedicated space within the parking structure. Additionally, a bike rack for 6 bicycles is provided in front of the building on Fairmount Avenue. The minimum required vehicle parking is 43 spaces while 67 are proposed (including 64 standard, 3 accessible spaces). Fifty bicycle spaces are proposed within the building while 41 are required (this does not include the 6 bike rack spaces in front of the building), and 10 motorcycle spaces are required and proposed, which meet the City’s minimum requirements. Parking details are included in **Table 2**.

Table 2: Project Parking

Description	Unit Count/ SF	Parking Requirement	Required Spaces ^(a)	Proposed Spaces
Vehicle Spaces				
Dwelling Units ⁽¹⁾	74	0.5 spaces/DU	37	61
Manager’s Unit	1	1.75 spaces/DU	<u>2</u>	<u>2</u>
Non-residential Community Space ⁽²⁾	1,818	2.1 spaces/1,000 SF	<u>4</u>	<u>4</u>
Total Vehicle Spaces			43	67
ADA Accessible Spaces ⁽³⁾		3 per 51 to 75 spaces	3	3
Motorcycle Spaces ⁽⁴⁾				
Residential	75	0.1 spaces/DU	8	8
Non-residential Community Space ⁽⁵⁾	1818 SF	2% of Req’d Auto Spaces or 2 min.	2	2
Total Motorcycle Spaces			10	10
Bicycle Spaces ⁽⁴⁾				
Two-Bedroom Units	55	0.5 spaces /DU	28	28
Three-Bedroom Units	20	0.6 spaces /DU ⁽³⁾	12	12
Non-residential Community Space ⁽²⁾	1,818	0.1 spaces/1,000 SF	1	10
Short-Term Bicycle Racks (Fairmount Ave Frontage)			0	6
Total Bicycle Spaces			41	56

Notes: SF = Square Feet. DU = Dwelling Unit. (a) Rounded to nearest whole number.
 Sources: (1) SDMC Section 143.0740 (Table 143-07D). City of San Diego. (2) SDMC Section 155.0252 (Table 155-02E). City of San Diego. (3) Accessible parking per CBC Table 11B-208.2. (4) SDMC Section 142.0525 (Table 142-05C). (5) SDMC Section 142.0530(g)

CONCLUSION

This analysis was prepared to determine if a detailed transportation VMT or LMA would be required for the proposed transit-oriented mixed-use/infill development project of 75 dwelling units (100% affordable housing except for the manager's unit), with residential amenities and a public use community meeting room of approximately 1,818 sf.

The project does not require a detailed transportation VMT analysis because the primarily residential project satisfies the VMT Efficient Area criteria; therefore, the project would be presumed to have a less than significant transportation impact. The project does not require an LMA because the project's land use is consistent with the Community Plan and is expected to generate less than 1,000 ADT per these same guidelines.

Sincerely,
LOS Engineering, Inc.

Justin Rasas
Justin Rasas, P.E.(RCE 60690), PTOE
Principal and Officer of LOS Engineering, Inc.

Attachments



SEALED ON 8/7/2020

ATTACHMENT A

CITY OF SAN DIEGO PROJECT INFORMATION FORM (PIF)



City of San Diego Project Information Form

Project Information

Project Name:	Fourth Corner Apartments				
Project Applicant					
Name:	Atlantis Group Land Use Consultants				
Address:	2488 Historic Decatur Road, STE 220 SD CA 92106				
Contact Information	Phone Number:	619-523-1930	Email:	jtemple@atlantissd.com	
	Project Location and Context				
Project Address:	4021, 4035, 05, 06, 07, 08, and 09.				
APN:	41-461-04, 05, 06, 07, 08, and 09.				
Driveway Cross Streets:	University Ave/Alley (project access from alley)				
Please attach a Project Location Map that clearly identifies project driveways and access points.					
Community Plan Area:	City Heights	Land Use Designation:	Multiple Use	Zoning Designation:	CU-2-3
Is any portion of the project located in an RTIP Transit Priority Area?: <input checked="" type="checkbox"/> Yes <input type="checkbox"/> No					
Project Description (with Proposed Land Uses and Intensities):					
<p>The project includes 75 multi-family apartments (100% affordable housing except for the managers unit), residential amenities of an outdoor/community recreation open space on a podium deck (approximately 5,300 sf), a 1,530 sf resident's lounge, community kitchen, and technology space, and a public use community meeting room of approximately 1,818 sf located on the ground floor. The project site is 0.87 acres, and the proposed dwelling unit density is 86.2 du/acre (75 units/0.87 acres).</p>					
Number of Parking Spaces:	Vehicle Spaces	Accessible Spaces	Bicycle Spaces <i>(racks and secure Storage)</i>	Motorcycle Spaces	
	67	3	56	10	
<p>Identify any project features related to TDM and Identify any transportation amenities or travel demand management measures that are required based on the San Diego Municipal Code Section 142.0528 (transportation amenities) or the Climate Action Plan Consistency Checklist. For example: transit pass subsidies, unbundled parking, shuttle services, car share, bicycle supportive features (bike repair station, bike lockers, etc.).</p>					
Please attach a project site plan that clearly identifies the following:					
<ul style="list-style-type: none"> • Land use types and quantities, and number of parking spaces provided (vehicle and bicycle) clearly identified. • Driveway locations and type (full access, partial access, right in/out only) identified. • Pedestrian access, bicycle access and on-site pedestrian circulation clearly identified. • Location/distance of closest existing transit stop and proposed transit stops identified in RTIP (measured as walking distance to project entrance/or middle of parcel). 					



City of San Diego Project Information Form

Trip Generation Estimates (calculated using the process described in the TSM):	Unadjusted Driveway Trips		Total Net New Trips	
	Daily:	502	Daily:	313
	AM Peak Hour:	39	AM Peak Hour:	26
	PM Peak Hour:	44	PM Peak Hour:	26

Preliminary Screening Criteria

CEQA Transportation Analysis Screening		Screened Out	Not Screened Out
1) Select the Land Uses that apply to your project 2) Answer the questions for each Land Use that applies to your project <i>(if "Yes" in any land use category below then that land use (or a portion of the land use) is screened from CEQA Transportation Analysis)</i>		Yes	No
<input checked="" type="checkbox"/>	1. Redevelopment Project:		
	a. Does the project result in a net decrease in total Project VMT?	<input type="radio"/>	<input checked="" type="radio"/>
	b. Answer if yes to 1a. If the project replaces affordable housing with market rate housing, are there more market rate units planned than existing affordable units being replaced.	<input type="radio"/>	<input type="radio"/>
<input checked="" type="checkbox"/>	2. Residential Project:		
	a. Is the project in a VMT/Capita Efficient Area (per SANDAG screening maps)?	<input checked="" type="radio"/>	<input type="radio"/>
	b. Does the project include Affordable Housing? $\frac{74}{\text{Affordable Units}} + \frac{1 \text{ manager's unit}}{\text{Market Rate Units}} = \frac{75}{\text{Total Units}}$ All affordable units are screened out.	<input checked="" type="radio"/>	<input type="radio"/>
<input type="checkbox"/>	3. Commercial Employment Project:		
	• Is the project in a VMT/Employee Efficient Area? (per SANDAG screening maps?)	<input type="radio"/>	<input type="radio"/>
<input type="checkbox"/>	4. Industrial Employment Project		
	• Is the project in a VMT/Industrial Employee Efficient Area?	<input type="radio"/>	<input type="radio"/>
<input type="checkbox"/>	5. Retail/Public Facility/Recreational		
	• Is the project locally serving: - Retail OR Public Facility OR Recreational	<input type="radio"/>	<input type="radio"/>
<input checked="" type="checkbox"/>	6. Small Project		
	• For all components of a project that are not screened out above (all 'Yes' in a land use category), what is the daily unadjusted driveway trip generation? _____	<input type="radio"/>	<input checked="" type="radio"/>
	Is it less than 300 daily trips?		

Local Mobility Analysis		
Is your project's land use consistent with the Community Plan zoning?	<input checked="" type="radio"/> Consistent <input checked="" type="checkbox"/> Generates less than 1,000 daily trips (unadjusted driveway trips)	<input type="radio"/> Inconsistent <input type="checkbox"/> Generates less than 500 daily trips (unadjusted driveway trips)
Will project development be phased?	No	In what month are traffic counts planned to be conducted?



City of San Diego Project Information Form

If a project generates 1,000 or more daily trips (consistent with Community Plan Zoning) or 500 or more daily trips (inconsistent with Community Plan zoning), attach an exhibit showing the project's trip distribution percentages and project trip assignment using the process described in the TSM.

ATTACHMENT B

Trip Generation Rates



Trip Generation Manual

10th Edition • Volume 2: Data

Recreational (Land Uses 400–499)



SEPTEMBER 2017
INSTITUTE OF TRANSPORTATION ENGINEERS

Land Use: 495

Recreational Community Center

Description

A recreational community center is a stand-alone public facility similar to and including YMCAs. These facilities often include classes and clubs for adults and children; a day care or nursery school; meeting rooms; swimming pools and whirlpools; saunas; tennis, racquetball, handball, basketball and volleyball courts; outdoor athletic fields/courts; exercise classes; weightlifting and gymnastics equipment; locker rooms; and a restaurant or snack bar. Public access is typically allowed but a fee may be charged. Racquet/tennis club (Land Use 491), health/fitness club (Land Use 492), and athletic club (Land Use 493) are related land uses.

Additional Data

Time-of-day distribution data for this land use are presented in Appendix A. For the one general urban/suburban site with data, the overall highest vehicle volumes during the AM and PM on a weekday were counted between 7:30 and 8:30 a.m. and 5:00 and 6:00 p.m., respectively.

The average numbers of person trips per vehicle trip at the four general urban/suburban sites at which both person trip and vehicle trip data were collected, were as follows:

- 1.86 during Weekday, Peak Hour of Adjacent Street Traffic, one hour between 7 and 9 a.m.
- 1.69 during Weekday, AM Peak Hour of Generator
- 1.82 during Weekday, Peak Hour of Adjacent Street Traffic, one hour between 4 and 6 p.m.
- 1.82 during Weekday, PM Peak Hour of Generator

The sites were surveyed in the 1980s, the 1990s, the 2000s, and the 2010s in Alberta (CAN), Arizona, Indiana, Minnesota, New Hampshire, New York, Oregon, Pennsylvania, and Utah.

Source Numbers

281, 410, 443, 571, 618, 705, 719, 850, 866, 971

Recreational Community Center (495)

Vehicle Trip Ends vs: 1000 Sq. Ft. GFA
On a: Weekday

Setting/Location: General Urban/Suburban
Number of Studies: 4
1000 Sq. Ft. GFA: 78
Directional Distribution: 50% entering, 50% exiting

Vehicle Trip Generation per 1000 Sq. Ft. GFA

Average Rate	Range of Rates	Standard Deviation
28.82	21.49 - 36.71	8.56

Data Plot and Equation

Caution – Small Sample Size

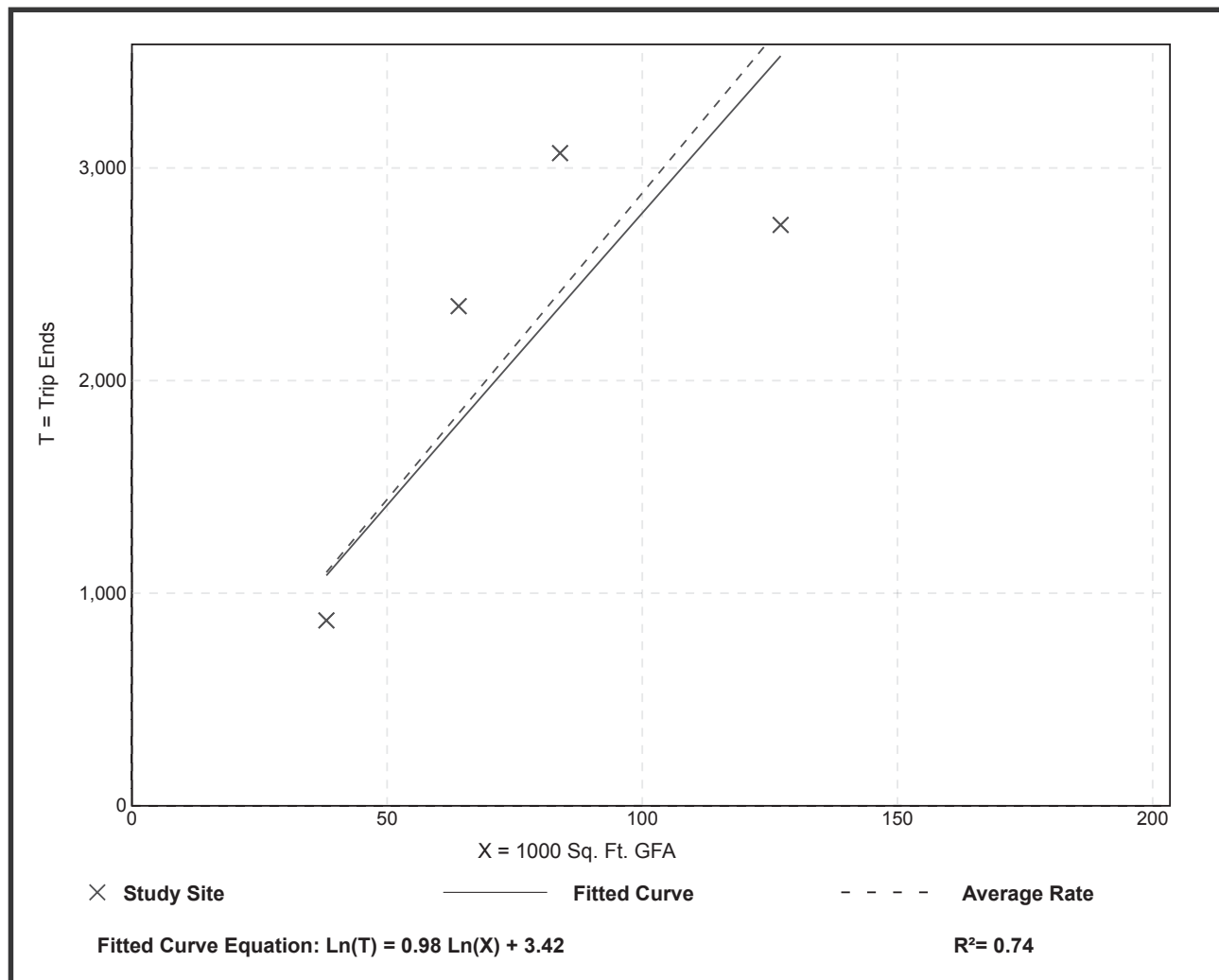

Recreational Community Center (495)

Vehicle Trip Ends vs: 1000 Sq. Ft. GFA
On a: Weekday,
Peak Hour of Adjacent Street Traffic,
One Hour Between 7 and 9 a.m.
Setting/Location: General Urban/Suburban
 Number of Studies: 10
 1000 Sq. Ft. GFA: 113
 Directional Distribution: 66% entering, 34% exiting

Vehicle Trip Generation per 1000 Sq. Ft. GFA

Average Rate	Range of Rates	Standard Deviation
1.76	1.08 - 3.18	0.74

Data Plot and Equation

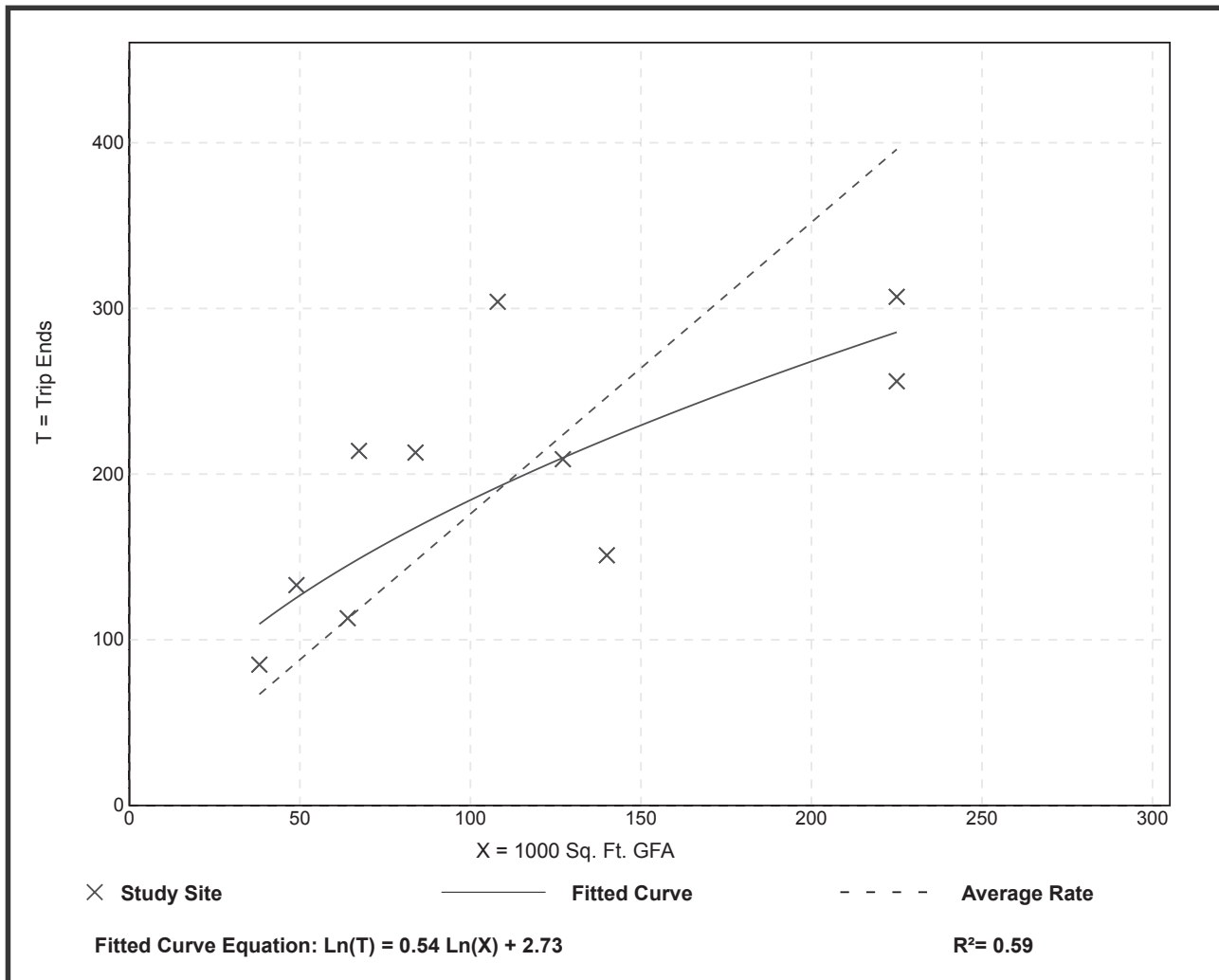

Recreational Community Center (495)

Vehicle Trip Ends vs: 1000 Sq. Ft. GFA
On a: Weekday,
Peak Hour of Adjacent Street Traffic,
One Hour Between 4 and 6 p.m.
Setting/Location: General Urban/Suburban
 Number of Studies: 13
 1000 Sq. Ft. GFA: 132
 Directional Distribution: 47% entering, 53% exiting

Vehicle Trip Generation per 1000 Sq. Ft. GFA

Average Rate	Range of Rates	Standard Deviation
2.31	1.05 - 5.37	1.14

Data Plot and Equation

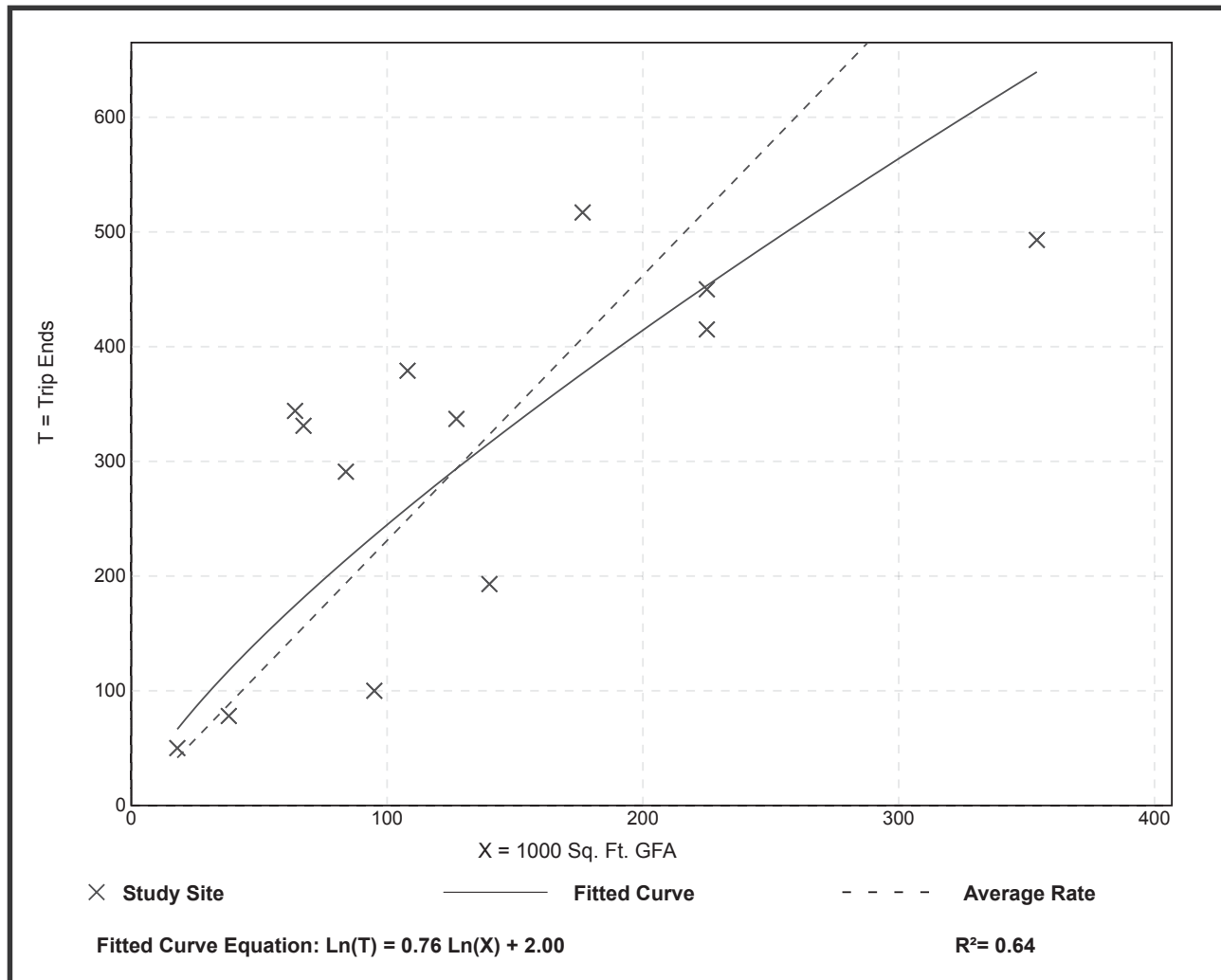



San Diego Municipal Code

Land Development Code

Trip Generation Manual

Revised May 2003



Printed on recycled paper

This information, document, or portions thereof, will be made available in alternative formats upon request.

TABLE 1

May 2003

TRIP GENERATION RATE SUMMARY
(WEEKDAY)

LAND USE	DRIVEWAY ^{(1) (2)}	CUMULATIVE ⁽⁸⁾	PEAK HOUR AND IN/OUT RATIO	
	VEHICLE TRIP RATE	VEHICLE TRIP RATE	AM (IN:OUT)	PM IN:OUT
AGRICULTURE (OPEN SPACE) ⁽³⁾	2 trips/acre	2 trips/acre	--	--
AIRPORT ⁽³⁾				
Commercial	100 trips/flight; 60 trips/acre	100 trips/flight; 60 trips/acre	6% (6:4)	7% (5:5)
General Aviation	2 trips/flight; 6 trips/acre	2 trips/flight; 6 trips/acre	--	--
CEMETERY	5 trips/acre	5 trips/acre	--	--
COMMERCIAL-RETAIL ^{(4) (5)}				
Automobile Services:				
Car Dealer	50 trips/1,000 sq. ft.; 300 trips/acre	45 trips/1,000 sq. ft.; 297 trips/acre	5% (7:3)	8% (4:6)
Carwash:				
Full service	900 trips/site; 600 trips/acre	450 trips/site; 300 trips/acre	4% (5:5)	9% (5:5)
Self service	100 trips/wash stall	50 trips/wash stall	4% (5:5)	8% (5:5)
Gasoline Stations:				
130 trips/vehicle fueling space; 750 trips/station	130 trips/vehicle fueling space; 750 trips/station	26 trips/vehicle fueling space; 150 trips/station	7% (5:5)	11% (5:5)
With food mart	150 trips/vehicle fueling space	30 trips/vehicle fueling space	8% (5:5)	8% (5:5)
With fully automated carwash	135 trips/vehicle fueling space	27 trips/vehicle fueling space	--	--
With food mart & fully automated carwash	155 trips/vehicle fueling space	31 trips/vehicle fueling space	8% (5:5)	9% (5:5)
Parts Sale	62 trips/1,000 sq. ft.	56 trips/1,000 sq. ft.	4% (5:5)	10% (5:5)
Repair Shop	20 trips/1,000 sq. ft.; 20 trips/service stall; 400 trips acre	18 trips/1,000 sq. ft.; 19 trips/service stall	8% (7:3)	11% (4:6)
Tire Store	25 trips/1,000 sq. ft.; 30 trips/service stall	23 trips/1,000 sq. ft.; 27 trips/service stall	7% (6:4)	11% (5:5)
Convenience Market Chain:				
Open Up to 16 Hours Per Day	500 trips/1,000 sq. ft.	250 trips/1,000 sq. ft.	8% (5:5)	8% (5:5)
Open 24 Hours	700 trips/1,000 sq. ft.	350 trips/1,000 sq. ft.	9% (5:5)	7% (5:5)
Discount Store/Discount Club	70 trips/1,000 sq. ft.	49 trips/1,000 sq. ft.	2% (6:4)	10% (5:5)
Drugstore	90 trips/1,000 sq. ft.	40 trips/1,000 sq. ft.	4% (6:4)	10% (5:5)
Furniture Store	6 trips/1,000 sq. ft.; 100 trips/acre	5.4 trips/1,000 sq. ft.	4% (7:3)	9% (5:5)
Lumber/Home Improvement Store	30 trips/1,000 sq. ft.; 150 trips/acre	27 trips/1,000 sq. ft.; 135 trips/acre	7% (6:4)	9% (5:5)
Nursery	40 trips/1,000 sq. ft.; 90 trips/acre	36 trips/1,000 sq. ft.; 81 trips/acre	3% (6:4)	10% (5:5)
Restaurant:				
Quality	100 trips/1,000 sq. ft.; 3 trips/seat; 500 trips/acre	90 trips/1,000 sq. ft.; 2.7 trips/seat; 450 trips/acre	1% (6:4)	8% (7:3)
High Turnover (sit-down)	130 trips/1,000 sq. ft.; 7 trips/seat; 1,200 trips/acre	104 trips/1,000 sq. ft.; 5.6 trips/seat; 460 trips/acre	8% (5:5)	8% (6:4)
Fast Food (with or without drive-through)	700 trips/1,000 sq. ft.; 22 trips/seat; 3,000 trips/acre	420 trips/1,000 sq. ft.; 13.2 trips/seat; 1,800 trips/acre	4% (6:4)	8% (5:5)
Shopping Center:				
Neighborhood (30,000 sq. ft. or more GLA on 4 or more acres)	120 trips/1,000 sq. ft. GLA; 1,200 trips/acre	72 trips/1,000 sq. ft.; 720 trips/acre	4% (6:4)	11% (5:5)
Community (100,000 sq. ft. or more GLA on 10 or more acres)	70 trips/1,000 sq. ft. GLA; 700 trips/acre	49 trips/1,000 sq. ft.; 490 trips/acre	3% (6:4)	10% (5:5)
Regional (300,000 sq. ft. or more GLA) (6)	$\text{Ln}(T) = 0.756 \text{Ln}(x) + 5.25$ *	$0.8 [\text{Ln}(T) = 0.756 \text{Ln}(x) + 5.25]$ *	2% (7:3)	9% (5:5)
Specialty Retail Center/Strip Commercial	40 trips/1,000 sq. ft.; 400 trips/acre	36 trips/1,000 sq. ft.; 360 trips/acre	3% (6:4)	9% (5:5)
Supermarket	150 trips/1,000 sq. ft.; 2,000 trips/acre	90 trips/1,000 sq. ft.; 2,000 trips/acre	4% (7:3)	10% (5:5)

* See Table 2

TABLE 1 (Continued)

May 2003

TRIP GENERATION RATE SUMMARY
(WEEKDAY)

LAND USE	DRIVEWAY ^{(1) (2)} VEHICLE TRIP RATE	CUMULATIVE ⁽⁸⁾ VEHICLE TRIP RATE	PEAK HOUR AND IN/OUT RATIO	
			AM (IN:OUT)	PM (IN:OUT)
EDUCATION ⁽³⁾				
University (4 years or higher)	2.5 trips/student; 100 trips/acre	2.5 trips/student; 100 trips/acre	10% (9:1)	9% (3:7)
Community College (2 years)	1.6 trips/student; 18 trips/1,000 sq. ft.; 80 trips/acre	1.6 trips/student; 18 trips/1,000 sq. ft.; 80 trips/acre	12% (9:1)	8% (3:7)
High School	1.8 trips/student; 50 trips/acre; 11 trips/1,000 sq. ft.	1.8 trips/student; 50 trips/acre; 11 trips/1,000 sq. ft.	20% (8:2)	14% (3:7)
Junior High/Middle School	1.4 trip/student; 12 trips/1,000 sq. ft.; 40 trips/acre	1.4 trips/student; 12 trips/1,000 sq. ft.; 40 trips/acre	24% (7:3)	7% (3:7)
Elementary School	2.9 trips/student; 39 trips/1,000 sq. ft.; 136 trips/acre	2.9 trips/student; 39 trips/1,000 sq. ft.; 136 trips/acre	31% (6:4)	19% (4:6)
Day Care Center	5 trips/child; 80 trips/1,000 sq. ft.	5 trips/child; 80 trips/1,000 sq. ft.	19% (5:5)	18% (5:5)
FINANCIAL INSTITUTION (Bank or Credit Union) ⁽⁵⁾				
Excluding drive-through	150 trips/1,000 sq. ft.; 1,000 trips/acre	112.5 trips/1,000 sq. ft.; 750 trips/acre	4% (7:3)	8% (4:6)
With drive-through	200 trips/1,000 sq. ft.; 1,500 trips/acre	150 trips/1,000 sq. ft.; 1,125 trips/acre	5% (6:4)	10% (5:5)
Drive-through only	250 trips/lane	187.5 trips/lane	3% (5:5)	13% (5:5)
HOSPITAL ⁽³⁾				
Convalescent/Nursing	3 trips/bed	3 trips/bed	7% (6:4)	7% (4:6)
General	20 trips/bed; 20 trips/1,000 sq. ft.; 300 trips/acre	20 trips/bed; 20 trips/1,000 sq. ft.; 300 trips/acre	9% (7:3)	10% (3:7)
HOUSE OF WORSHIP ⁽⁴⁾				
General	15 trips/1,000 sq. ft.; quadruple rates for days of	9 trips/1,000 sq. ft.; quadruple rate for days of	4% (8:2)	8% (5:5)
Without School or Day Care	5 trips/1,000 sq. ft.; quadruple rates for days of assembly	5 trips/1,000 sq. ft.; quadruple rate for days of	4% (8:2)	8% (5:5)
INDUSTRIAL				
Industrial/Business Park (some commercial included) ⁽³⁾	16 trips/1,000 sq. ft.; 200 trips/acre	16 trips/1,000 sq. ft.; 200 trips/acre	12% (8:2)	12% (2:8)
Small Industrial Park ^{(7) *}	15 trips/1,000 sq. ft.; 120 trips/acre	15 trips/1,000 sq. ft.; 120 trips/acre	11% (9:1)	12% (2:8)
Large Industrial Park *	8 trips/1,000 sq. ft.; 100 trips/acre	8 trips/1,000 sq. ft.; 100 trips/acre	11% (9:1)	12% (2:8)
Manufacturing/Assembly	4 trips/1,000 sq. ft.; 50 trips/acre	4 trips/1,000 sq. ft.; 50 trips/acre	20% (9:1)	20% (2:8)
Rental Storage	2 trips/1,000 sq. ft.; 30 trips/acre	2 trips/1,000 sq. ft.; 30 trips/acre	6% (5:5)	9% (5:5)
Scientific Research and Development	8 trips/1,000 sq. ft.; 80 trips/acre	8 trips/1,000 sq. ft.; 80 trips/acre	16% (9:1)	14% (1:9)
Truck Terminal	10 trips/1,000 sq. ft.; 7 trips/bay; 80 trips/acre	10 trips/1,000 sq. ft.; 7 trips/bay; 80 trips/acre	9% (4:6)	8% (5:5)
Warehousing	5 trips/1,000 sq. ft.; 60 trips/acre	5 trips/1,000 sq. ft.; 60 trips/acre	15% (7:3)	16% (4:6)
LIBRARY ⁽³⁾				
Less than 100,000 sq. ft.	50 trips/1,000 sq. ft.; 400 trips/acre	20 trips/1,000 sq. ft.	2% (7:3)	10% (5:5)
100,000 sq. ft. or more		16 trips/1,000 sq. ft.	2% (7:3)	10% (5:5)

* Small amount of local serving commercial included. May have multiple shifts.

TABLE 1 (Continued)

May 2003

**TRIP GENERATION RATE SUMMARY
(WEEKDAY)**

LAND USE	DRIVEWAY ^{(1) (2)} VEHICLE TRIP RATE	CUMULATIVE ⁽⁸⁾ VEHICLE TRIP RATE	PEAK HOUR AND IN/OUT RATIO	
			AM (IN:OUT)	PM (IN:OUT)
LODGING ⁽³⁾				
Hotel (w/convention facilities/restaurant)	10 trips/room; 300 trips/acre	10 trips/room; 300 trips/acre	6% (6:4)	8% (6:4)
Motel	9 trips/room; 200 trips/acre	9 trips/room; 200 trips/acre	8% (4:6)	9% (4:6)
Resort Hotel	8 trips/room; 100 trips/acre	8 trips/room; 100 trips/acre	5% (6:4)	7% (6:4)
MILITARY BASE ⁽³⁾				
	2.5 trips/employee (military or civilian)	2.5 trips/employee (military or civilian)	9% (9:1)	10% (6:4)
OFFICE				
Commercial Office ⁽⁶⁾	$\text{Ln}(T) = 0.756 \text{Ln}(x) + 3.95$; 450 trips/acre	$\text{Ln}(T) = 0.756 \text{Ln}(x) + 3.95$; 450 trips/acre	13% (9:1)	14% (2:8)
Corporate Headquarters/Single Tenant Office	10 trips/1,000 sq. ft.	10 trips/1,000 sq. ft.	15% (9:1)	15% (1:9)
Department of Motor Vehicles	180 trips/1,000 sq. ft.; 900 trips/acre	18 trips/1,000 sq. ft.	6% (6:4)	11% (4:6)
Government Office (Civic Center):	30 trips/1,000 sq. ft.		9% (9:1)	12% (3:7)
Less than 100,000 sq. ft.		20 trips/1,000 sq. ft.	9% (9:1)	12% (3:7)
100,000 sq. ft. or more		16 trips/1,000 sq. ft.	9% (9:1)	12% (3:7)
Medical Office:	50 trips/1,000 sq. ft.; 500 trips/acre		6% (8:2)	10% (3:7)
Less than 100,000 sq. ft.		20 trips/1,000 sq. ft.	6% (8:2)	10% (3:7)
100,000 sq. ft. or more		16 trips/1,000 sq. ft.	6% (8:2)	10% (3:7)
Post Office:				
Distribution (central/walk-in only)	90 trips/1,000 sq. ft.	76 trips/1,000 sq. ft.	5%	7%
Community (without mail drop lane)	200 trips/1,000 sq. ft.; 1,300 trips/acre	168 trips/1,000 sq. ft.; 1,092 trips/acre	6% (6:4)	9% (5:5)
Community (with mail drop lane)	300 trips/1,000 sq. ft.; 2,000 trips/acre		7% (5:5)	9% (3:7)
Less than 100,000 sq. ft.		168 trips/1,000 sq. ft.; 1,092 trips/acre	7% (5:5)	7% (6:4)
100,000 sq. ft. or more		252 trips/1,000 sq. ft.; 1,680 trips/acre	7% (5:5)	8% (7:3)
RECREATION				
Bowling Center	30 trips/lane; 300 trips/acre	30 trips/lane; 300 trips/acre	7% (7:3)	10% (4:6)
Golf Course	600 trips/course; 40 trips/hole; 8 trips/acre	600 trips/course; 40 trips/hole; 8 trips/acre	6% (8:2)	9% (3:7)
Marina	4 trips/berth; 20 trips/acre	4 trips/berth; 20 trips/acre	3% (3:7)	7% (6:4)
Movie Theater	80 trips/1,000 sq. ft.; 1.8 trips/seat	80 trips/1,000 sq. ft.; 1.8 trips/seat	0.3%	8% (7:3)
Park:				
Beach, Ocean or Bay	600 trips/1,000 ft. shoreline; 60 trips/acre	600 trips/1,000 ft. shoreline; 60 trips/acre	--	11% (4:6)
Developed	50 trips/acre	50 trips/acre	4%	8%
Undeveloped	5 trips/acre	5 trips/acre	4%	8%
Racquetball/Tennis/Health Club	40 trips/1,000 sq. ft.; 40 trips/court; 300 trips/acre	40 trips/1,000 sq. ft.; 40 trips/court; 300 trips/acre	4% (6:4)	9% (6:4)
San Diego Zoo	115 trips/acre	115 trips/acre	--	--
Sea World	80 trips/acre	80 trips/acre	--	--
Sport Facility:				
Indoor	30 trips/acre	30 trips/acre	--	--
Outdoor	50 trips/acre	50 trips/acre	--	--

TABLE 1 (Continued)

May 2003

**TRIP GENERATION RATE SUMMARY
(WEEKDAY)**

LAND USE	DRIVEWAY ^{(1) (2)} VEHICLE TRIP RATE	CUMULATIVE ⁽⁸⁾ VEHICLE TRIP RATE	PEAK HOUR AND IN/OUT RATIO	
			AM (IN:OUT)	PM (IN:OUT)
RESIDENTIAL ⁽³⁾				
Congregate Care Facility	2 trips/dwelling unit	2 trips/dwelling unit	3% (6:4)	8% (5:5)
Estate Housing	12 trips/dwelling unit	12 trips/dwelling unit	--	--
Mobile Home	5 trips/dwelling unit; 40 trips/acre	5 trips/dwelling unit; 40 trips/acre	9% (3:7)	12% (6:4)
Multiple Dwelling Unit:				
Under 20 dwelling units/acre	8 trips/dwelling unit	8 trips/dwelling unit	8% (2:8)	10% (7:3)
Over 20 dwelling units/acre	6 trips/dwelling unit	6 trips/dwelling unit	8% (2:8)	9% (7:3)
Retirement/Senior Citizen Housing	4 trips/dwelling unit	4 trips/dwelling unit	--	--
Single Family Detached:				
Urbanized Area ⁽¹⁾	9 trips/dwelling unit	9 trips/dwelling unit	8% (2:8)	10% (7:3)
Urbanizing Area ⁽¹⁾	10 trips/dwelling unit	10 trips/dwelling unit	8% (2:8)	10% (7:3)
TRANSPORTATION FACILITIES ⁽³⁾				
Bus Depot	25 trips/1,000 sq. ft.	25 trips/1,000 sq. ft.		
Park & Ride Lots	400 trips/acre; 600 trips/paved acre	400 trips/acre; 600 trips/paved acre	14% (7:3)	15% (3:7)
Transit Station (rail)	300 trips/acre	300 trips/acre	14% (7:3)	15% (3:7)

Notes:

- (1) From the 1990 Trip Generation Manual. Driveway rates reflect trips that are generated by a site. These rates are used to calculate the total number of trips that impact the project and its immediate vicinity.
- (2) Does not include trip rates for Centre City area. See Table 5.
- (3) San Diego Association of Governments (SANDAG), "Traffic Generators," San Diego, California, December 1996, and July 1998.
- (4) City of San Diego memo, "Trip Generation Rate for Churches," December 9, 1992.
- (5) Refer to Cumulative Vehicle Trip Rate column for reduced trip rates.
- (6) Ln = Natural logarithm; fitted curve logarithmic equation is used for Commercial Office and Regional Shopping Center. For example, the trip generation of an Office Building with 100,000 sq. ft. of GLA is: $\text{Ln}(T) = 0.756 \text{Ln}(100) + 3.95$, or $\text{Ln}(T) = 0.756 (4.60517) + 3.95$, or $\text{Ln}(T) = 3.481509 + 3.95$, or $\text{Ln}(T) = 7.431509$, which is 1,688 trips. The trip generation of a Regional Shopping Center with 1,000,000 sq. ft. of GLA is: $\text{Ln}(T) = 0.756 \text{Ln}(1,000) + 5.25$, or $\text{Ln}(T) = 0.756 (6.907755) + 5.25$, or $\text{Ln}(T) = 5.222263 + 5.25$, or $\text{Ln}(T) = 10.47226$, which is 35,322 trips. See Table 2 for calculated trip generation for selected sizes of Regional Shopping Centers, and Table 3 for calculated trip generation for selected sizes of Commercial Offices. GLA = Gross Leasable Area; T = trips; x = GLA in 1,000 square feet.
- (7) Institute of Transportation Engineers, "Trip Generation," 5th and 6th Editions, Washington, District of Columbia, 1991 and 1998.
- (8) Trips made to a site are Pass-By and Cumulative trips. See Appendix A for definitions of these trips. Cumulative rates are used to determine the community-wide impact of a new project.

ATTACHMENT C

SANDAG Screen-line Map

SANDAG Screen-Line VMT Map

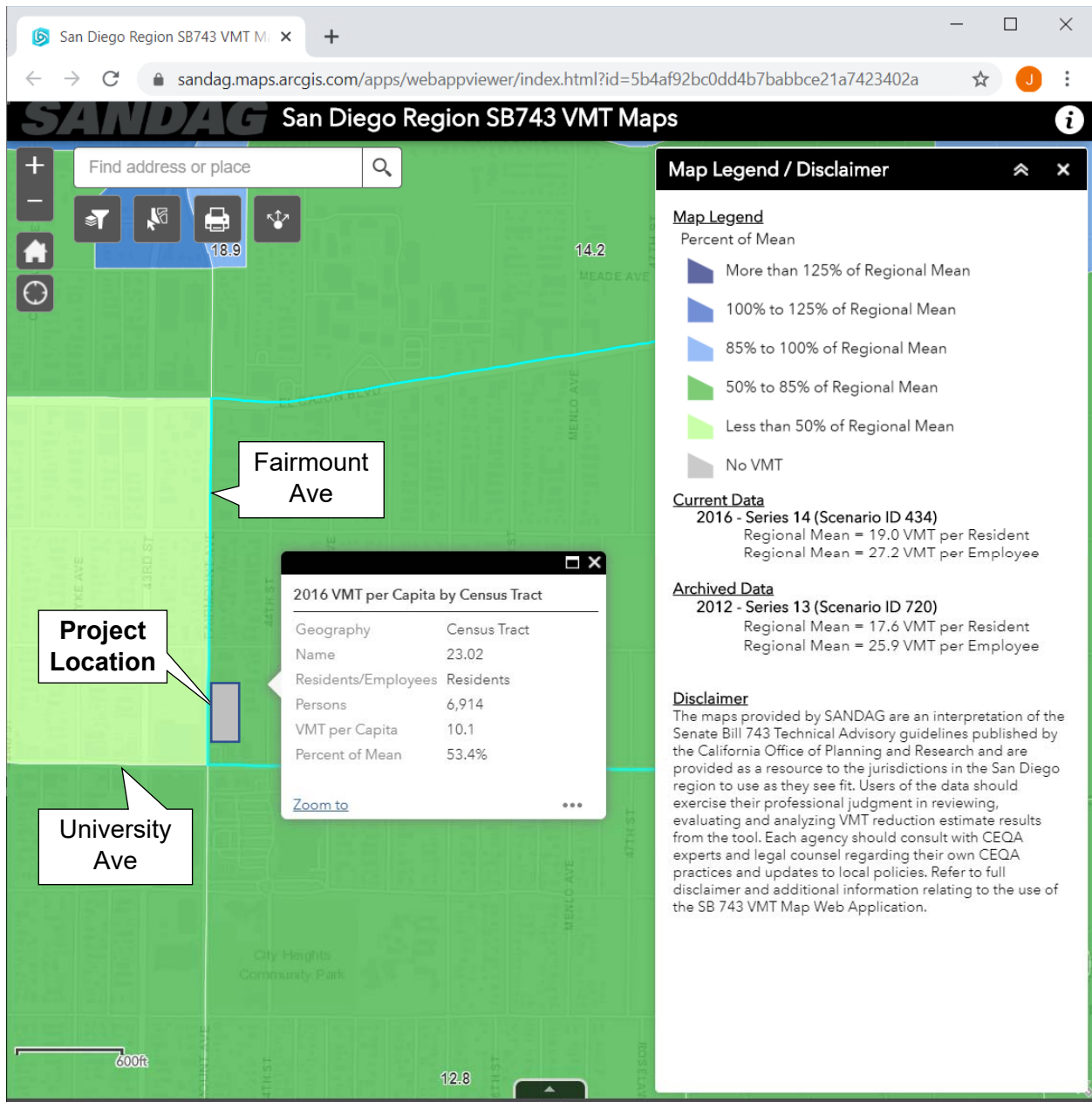

ATTACHMENT D

Bus Route Map and Timetables

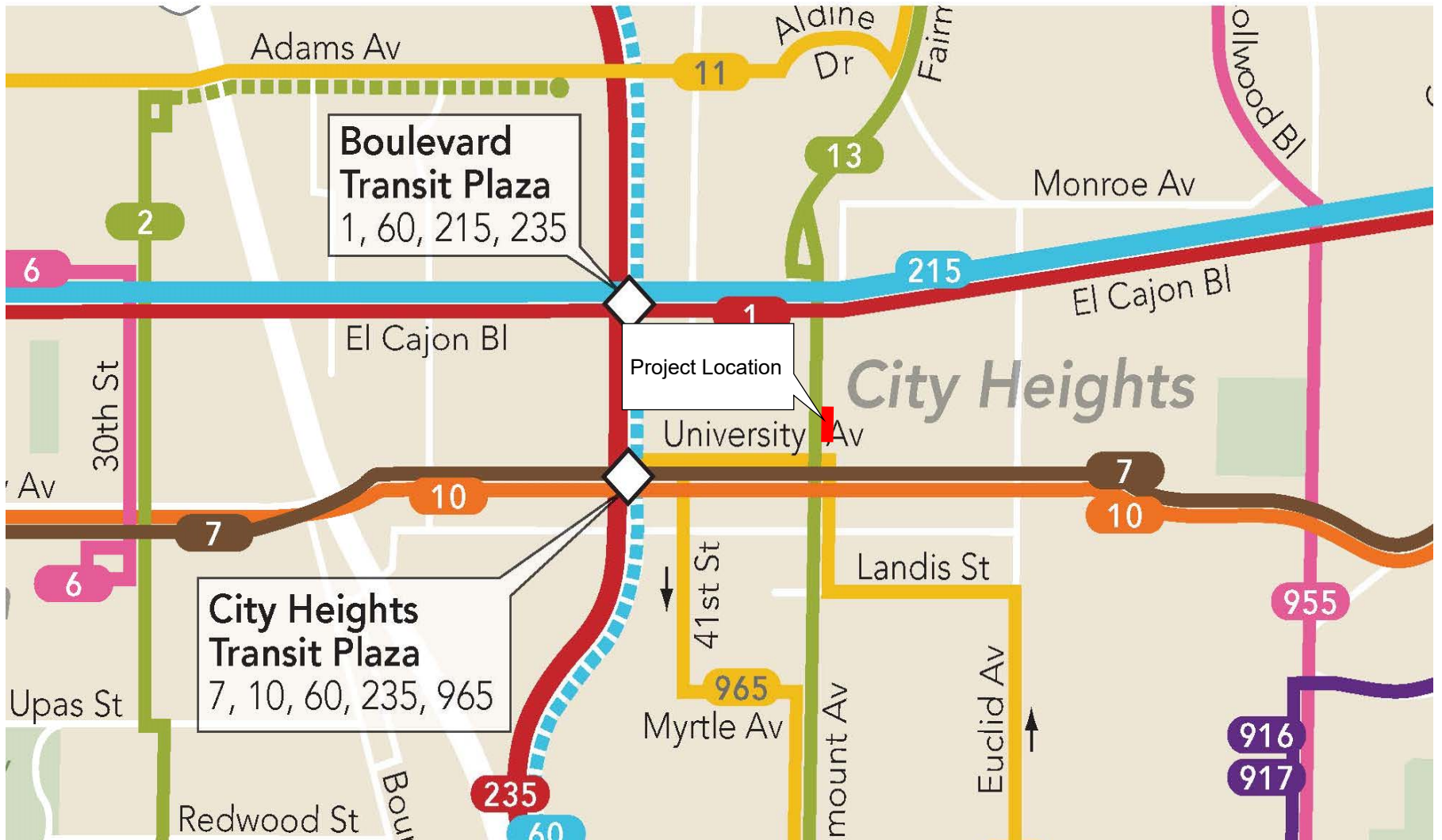

ONE-WAY FARES / Tarifas Sencillas

Exact fare, please / Favor de pagar la cantidad exacta	
Adult / Adulto	\$2.50
Senior/Disabled/Medicare* / Personas Mayores/Con Discapacidades/Medicare*	\$1.25
Youth (ages 6-18)* / Jóvenes (edades 6-18)*	\$2.50
DAY PASS (Regional) / Pase diario (Regional)	
Adult / Adulto	\$6.00
Senior/Disabled/Medicare* / Personas Mayores/Con Discapacidades/Medicare*	\$3.00
Youth (ages 6-18)* / Jóvenes (edades 6-18)*	\$3.00
MONTHLY PASSES / Pases mensual	
Adult / Adulto	\$72.00
Senior/Disabled/Medicare* / Personas Mayores/Con Discapacidades/Medicare*	\$23.00
Youth (ages 6-18)* / Jóvenes (edades 6-18)*	\$23.00

*Proof of eligibility required. Senior Eligibility: Age 65+ or born on or before September 1, 1950. *Se requiere certificación de elegibilidad. Elegibilidad para Personas Mayores: Edad 65+ o nacido en o antes del 1 de septiembre, 1950.

COMPASS CARDS / Tarjetas Compass
There is a \$2 charge for Compass Cards, which can be reloaded for future use. Hay un costo de \$2 por la tarjeta Compass Card, la cual puede ser recargada para usos futuros.

COMPASS CLOUD
Download the free Compass Cloud app on your Apple or Android phone. Descarga la aplicación gratis Compass Cloud en su teléfono Apple o Android.

Visit sdmts.com/fares for more info. Visite sdmts.com/fares para más información.

DIRECTORY / Directorio

MTS Information & Trip Planning / MTS Información y planeo de viaje	511 or/ó (619) 233-3004
TTY/TDD (teletype for hearing impaired) / Teletipo para sordos	(619) 234-5005 or/ó (888) 722-4889
InfoExpress (24-hour info via Touch-Tone phone) / Información las 24 horas (vía teléfono de teclas)	(619) 685-4900
Customer Service / Suggestions / Servicio al cliente / Sugerencias	(619) 557-4555
MTS Security / MTS Seguridad	(619) 595-4960
Lost & Found / Objetos extraviados	(619) 557-4555
Transit Store / 12th & Imperial Transit Center M-F 8am-5pm	(619) 234-1060
For MTS online trip planning / Planificación de viajes por Internet	sdmts.com

For more information on riding MTS services, pick up a Rider's Guide on a bus or at the Transit Store, or visit sdmts.com. Para obtener más información sobre el uso de los servicios de MTS, recoja un 'Rider's Guide' en un autobús o en la Transit Store, o visita a sdmts.com.

Thank you for riding MTS! ¡Gracias por viajar con MTS!



DESTINATIONS

- Balboa Park
- City College
- City Heights Retail Village
- City Heights Transit Plaza
- San Diego Zoo

TROLLEY CONNECTIONS

- City College

sdmts.com
Route Alerts, Updated Schedules, Connections & More



Alternative formats available upon request. Please call: (619) 557-4555 / Formato alternativo disponible al preguntar. Favor de llamar: (619) 557-4555

The schedules and other information shown in this timetable are subject to change. MTS does not assume responsibility for errors in timetables nor for any inconvenience caused by delayed buses. Los horarios e información que se indican en este itinerario están sujetos a cambios. MTS no asume responsabilidad por errores en los itinerarios, ni por ningún perjuicio que se origine por los autobuses demorados.

A Saturday or Sunday schedule will be operated on the following holidays and observed holidays >>> New Year's Day, Presidents' Day, Memorial Day, Independence Day, Labor Day, Thanksgiving, Christmas
Se operará con horario de sábado o domingo durante los siguientes días festivos y feriados observados

Route 7 - Monday through Friday / lunes a viernes

Downtown		North Park		City Heights		College Av.	
A	C	D	E	F	G	H	I
From St. & 3rd Av. DEPART	Broadway & 30th St. DEPART	City College (11th Av.) & University Av. DEPART	Park Bl. & University Av. DEPART	University Av. & 15th St. DEPART	City Heights Transit Plaza & 15th St. DEPART	Fairmount Av. & University Av. DEPART	University Av. & 5th Av. DEPART
4:25a	4:34a	4:34a	4:34a	4:39a	4:45a	4:48a	4:57a
4:58a	5:00a	5:05a	5:14a	5:19a	5:25a	5:28a	5:37a
5:18	5:20	5:25	5:34	5:39	5:45	5:48	5:57
5:35	5:37	5:42	5:51	5:56	6:03	6:06	6:16
5:52	5:54	5:59	6:08	6:13	6:20	6:23	6:33
6:08	6:11	6:16	6:26	6:31	6:38	6:41	6:51
6:20	6:23	6:28	6:38	6:43	6:50	6:53	7:03
6:30	6:33	6:38	6:49	6:55	7:02	7:05	7:16
6:40	6:43	6:48	6:59	7:05	7:12	7:15	7:26
6:50	6:53	6:58	7:09	7:15	7:22	7:25	7:36
7:02	7:05	7:10	7:21	7:27	7:34	7:37	7:49
7:13	7:16	7:21	7:32	7:38	7:46	7:50	8:02
7:23	7:26	7:31	7:42	7:48	7:56	8:00	8:12
7:33	7:36	7:41	7:52	7:58	8:06	8:10	8:22
7:43	7:46	7:51	8:02	8:08	8:16	8:20	8:32
7:53	7:56	8:01	8:12	8:18	8:26	8:30	8:42
8:03	8:06	8:11	8:22	8:28	8:36	8:40	8:52
8:13	8:16	8:21	8:32	8:38	8:46	8:50	9:02
8:24	8:27	8:32	8:43	8:49	8:57	9:01	9:13
8:35	8:38	8:43	8:54	9:00	9:08	9:12	9:24
8:46	8:49	8:54	9:05	9:11	9:19	9:23	9:35
8:57	9:00	9:05	9:16	9:22	9:30	9:34	9:46
9:07	9:10	9:15	9:26	9:32	9:40	9:44	9:56
9:17	9:20	9:25	9:36	9:42	9:50	9:54	10:06
9:26	9:29	9:34	9:45	9:51	9:59	10:03	10:15
9:36	9:39	9:44	9:55	10:01	10:10	10:14	10:27
9:46	9:49	9:54	10:05	10:11	10:20	10:24	10:37
9:56	9:59	10:04	10:15	10:21	10:30	10:34	10:47
10:05	10:08	10:13	10:24	10:31	10:40	10:44	10:58
10:15	10:18	10:23	10:34	10:41	10:50	10:54	11:08
10:25	10:28	10:33	10:44	10:51	11:00	11:04	11:18
10:35	10:38	10:43	10:54	11:01	11:10	11:14	11:28
10:45	10:48	10:53	11:04	11:11	11:20	11:24	11:38
10:56	10:59	11:04	11:15	11:22	11:31	11:35	11:49
11:07	11:10	11:15	11:26	11:33	11:42	11:46	12:00p
11:17	11:20	11:25	11:36	11:43	11:52	11:56	12:10
11:27	11:30	11:35	11:46	11:53	12:02p	12:06p	12:20
11:36	11:39	11:44	11:55	12:02p	12:11	12:15	12:29
11:46	11:49	11:54	12:05p	12:12	12:21	12:25	12:39
11:56	11:59	12:04p	12:15	12:22	12:31	12:35	12:49
12:07	12:10p	12:15p	12:26	12:33	12:42	12:47	13:01
12:17	12:20	12:26	12:37	12:44	12:53	12:57	1:11
12:27	12:30	12:36	12:47	12:54	1:03	1:07	1:21
12:37	12:40	12:46	12:57	1:04	1:13	1:17	1:31
12:47	12:50	12:56	1:07	1:14	1:23	1:27	1:41
12:57	1:00	1:06	1:17	1:24	1:33	1:37	1:51
1:05	1:08	1:14	1:25	1:32	1:41	1:45	2:00
1:14	1:18	1:24	1:35	1:42	1:52	1:57	2:11
1:23	1:27	1:33	1:44	1:51	2:01	2:06	2:20
1:32	1:36	1:42	1:53	2:00	2:10	2:15	2:29
1:42	1:46	1:52	2:03	2:10	2:20	2:25	2:39
1:51	1:55	2:01	2:12	2:19	2:29	2:34	2:48
2:01	2:05	2:11	2:23	2:30	2:40	2:45	3:00
2:11	2:15	2:21	2:33	2:40	2:50	2:55	3:10
2:21	2:25	2:31	2:43	2:50	3:00	3:05	3:20
2:31	2:35	2:41	2:53	3:00	3:10	3:15	3:30
2:41	2:45	2:51	3:03	3:10	3:20	3:25	3:40
2:51	2:55	3:01	3:13	3:20	3:30	3:35	3:50
3:01	3:05	3:11	3:23	3:30	3:40	3:45	4:00
3:11	3:15	3:21	3:33	3:40	3:50	3:55	4:10
3:20	3:24	3:30	3:42	3:49	3:59	4:04	4:19
3:30	3:34	3:40	3:52	3:59	4:09	4:14	4:29
3:40	3:44	3:50	4:02	4:09	4:19	4:24	4:39
3:50	3:54	4:00	4:12	4:19	4:29	4:34	4:49
3:59	4:03	4:09	4:21	4:28	4:38	4:43	4:58
4:09	4:13	4:19	4:31	4:38	4:48	4:53	5:08
4:19	4:23	4:29	4:41	4:48	4:58	5:03	5:18
4:29	4:33	4:39	4:51	4:58	5:08	5:13	5:28
4:39	4:43	4:49	5:01	5:08	5:18	5:23	5:38
4:49	4:53	4:59	5:11	5:18	5:28	5:33	5:48
4:59	5:03	5:09	5:21	5:28	5:38	5:43	5:58
5:09	5:13	5:19	5:31	5:38	5:48	5:53	6:08
5:19	5:23	5:29	5:41	5:48	5:58	6:03	6:18
5:28	5:32	5:38	5:50	5:57	6:07	6:12	6:27
5:38	5:42	5:48	6:00	6:07	6:17	6:22	6:37
5:49	5:53	5:59	6:10	6:17	6:27	6:31	6:45
5:59	6:03	6:09	6:20	6:27	6:37	6:41	6:55
6:09	6:13	6:19	6:31	6:38	6:48	6:53	7:07
6:19	6:23	6:29	6:39	6:46	6:55	6:59	7:12
6:31	6:34	6:39	6:49	6:56	7:05	7:09	7:22
6:41	6:44	6:49	6:59	7:06	7:15	7:19	7:32
6:52	6:55	7:00	7:10	7:16	7:24	7:28	7:40
7:02	7:05	7:10	7:20	7:26	7:34	7:38	7:50
7:12	7:15	7:20	7:30	7:36	7:44	7:48	8:00
7:24	7:27	7:32	7:41	7:47	7:55	7:59	8:10
7:39	7:42	7:47	7:56	8:02	8:10	8:14	8:25
7:54	7:57	8:02	8:11	8:17	8:25	8:29	8:40
8:09	8:12	8:17	8:26	8:32	8:40	8:44	8:55
8:24	8:27	8:32	8:41	8:47	8:55	8:59	9:10
8:39	8:42	8:47	8:56	9:02	9:09	9:13	9:23
8:54	8:57	9:02	9:11	9:17	9:24	9:28	9:38
9:07	9:10	9:15	9:24	9:30	9:37	9:41	9:51
9:20	9:23	9:28	9:37	9:43	9:50	9:53	10:03
9:35	9:38	9:43	9:52	9:58	10:05	10:08	10:18
9:50	9:53	9:58	10:07	10:13	10:20	10:23	10:33
10:05	10:08	10:13	10:22	10:28	10:35	10:38	10:48
10:20	10:23	10:28	10:37	10:43	10:50	10:53	11:03
10:35	10:38	10:43	10:52	10:58	11:05	11:08	11:18
10:50	10:53	10:58	11:07	11:13	11:20	11:23	11:33
11:08	11:11	11:16	11:24	11:29	11:35	11:38	11:48
11:37	11:40	11:45	11:53	11:58	12:04a	12:07a	12:17a
12:06a	12:09a	12:14a	12:22a	12:27a	12:33	12:36	12:46a
12:36	12:39	12:44	12:52	12:57	1:03	1:06	1:16
1:06	1:09	1:14	1:22	1:27	1:33	1:36	1:46
1:36	1:39	1:44	1:52	1:57	2:03	2:06	2:16

College Av.		North Park		Downtown	
I	H	G	F	E	D
University Av. & 5th Av. DEPART	Fairmount Av. & University Av. DEPART	City Heights Transit Plaza & 15th St. DEPART	University Av. & 30th St. DEPART	Park Bl. & University Av. DEPART	City College (11th Av.) & University Av. DEPART
4:25a	4:35a	4:39	4:45	4:50	5:00
4:51	5:01	5:06	5:13	5:16	5:24
4:59	5:09	5:13	5:19	5:24	5:34
5:15	5:25	5:29	5:35	5:40	5:50
5:30	5:41	5:45	5:52	5:57	6:07
5:41	5:52	5:56	6:03	6:08	6:18
5:51	6:02	6:06	6:14	6:19	6:30
6:01	6:12	6:16	6:24	6:29	6:40
6:10	6:21	6:25	6:33	6:39	6:51
6:18	6:30	6:34	6:42	6:48	7:01
6:26	6:39	6:43	6:52	6:58	7:11
6:35	6:48	6:52	7:01	7:07	7:20
6:44	6:57	7:01	7:10	7:16	7:30
6:52	7:06	7:11	7:20	7:26	7:40
7:01	7:16	7:21	7:30	7:36	7:50
7:09	7:25	7:31	7:40	7:47	8:01
7:18	7:34	7:40	7:49	7:56	8:10
7:28	7:44	7:50	7:59	8:06	8:20
7:37	7:53	7:59	8:08	8:15	8:29
7:46	8:02	8			

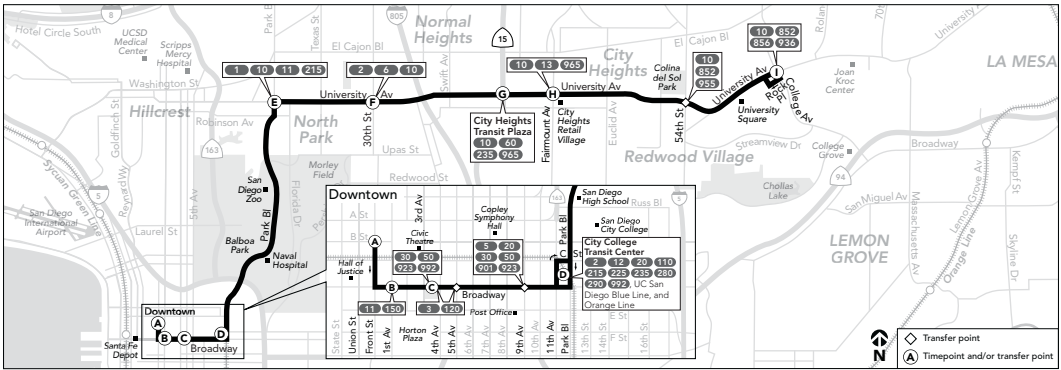

Route 7 - Saturday / sábado

Downtown → North Park → City Heights → College Av.

A	B	C	D	E	F	G	H	I
From St. & 8th DEPART	Broadway & 3rd St.	City College & Trolley Plaza (11th Av.)	Park Bl. & University Av.	University Av. & 30th St.	City Heights Transit Plaza @ 15 Hwy.	University Av. & Fairmount Av.	University Av. & College Av. ARRIVE	College Av. & 16th Av. ARRIVE
5:37a	5:39a	5:44a	5:53a	5:58a	6:04a	6:07a	6:16a	
6:06	6:09	6:14	6:24	6:29	6:35	6:38	6:47	
6:37	6:40	6:45	6:55	7:00	7:05	7:07	7:20	
6:51	6:54	6:59	7:09	7:14	7:21	7:24	7:34	
7:05	7:08	7:13	7:24	7:30	7:37	7:40	7:51	
7:19	7:22	7:27	7:34	7:40	7:51	7:55	8:07	
7:34	7:37	7:42	7:53	7:59	8:06	8:10	8:21	
7:51	7:54	7:59	8:07	8:13	8:21	8:25	8:37	
8:01	8:04	8:09	8:20	8:26	8:34	8:38	8:50	
8:13	8:16	8:21	8:32	8:38	8:46	8:50	9:02	
8:25	8:28	8:33	8:44	8:50	9:02	9:06	9:17	
8:37	8:40	8:45	8:56	9:02	9:10	9:14	9:26	
8:49	8:52	8:57	9:08	9:14	9:22	9:26	9:38	
9:01	9:04	9:09	9:20	9:26	9:34	9:38	9:50	
9:12	9:15	9:20	9:31	9:37	9:45	9:49	10:01	
9:23	9:26	9:31	9:42	9:48	9:56	10:00	10:12	
9:34	9:37	9:42	9:53	9:59	10:07	10:11	10:23	
9:45	9:48	9:53	10:04	10:10	10:18	10:22	10:34	
9:57	10:00	10:10	10:20	10:26	10:34	10:38	10:50	
10:09	10:12	10:17	10:28	10:35	10:44	10:48	11:01	
10:20	10:23	10:28	10:39	10:46	10:55	10:59	11:12	
10:32	10:35	10:40	10:51	10:58	11:07	11:11	11:24	
10:44	10:47	10:52	11:03	11:10	11:19	11:23	11:36	
10:57	11:00	11:05	11:16	11:23	11:32	11:36	11:49	
11:10	11:13	11:18	11:30	11:45	11:55	11:59	12:09p	
11:22	11:25	11:30	11:41	11:48	11:57	12:01p	12:14	
11:33	11:36	11:41	11:52	12:00	12:09	12:13	12:25	
11:45	11:48	11:53	12:04p	12:11p	12:20	12:24	12:37	
11:57	12:00p	12:05p	12:16	12:23	12:32	12:36	12:49	
12:09p	12:12	12:18	12:29	12:36	12:45	12:49	13:02	
12:22	12:25	12:31	12:42	12:49	12:58	1:02	1:16	
12:33	12:36	12:42	12:53	1:00	1:09	1:13	1:27	
12:45	12:48	12:54	1:05	1:12	1:21	1:25	1:39	
12:59	1:02	1:08	1:19	1:26	1:35	1:39	1:53	
1:13	1:17	1:23	1:34	1:41	1:51	1:54	2:09	
1:26	1:30	1:36	1:47	1:54	2:04	2:09	2:23	
1:38	1:42	1:48	1:59	2:06	2:16	2:21	2:35	
1:50	1:54	2:00	2:11	2:18	2:28	2:33	2:47	
2:02	2:06	2:12	2:24	2:31	2:41	2:46	3:01	
2:14	2:18	2:24	2:36	2:43	2:53	2:58	3:13	
2:27	2:31	2:37	2:50	2:56	3:06	3:11	3:26	
2:39	2:43	2:49	3:01	3:08	3:18	3:23	3:38	
2:51	2:55	3:01	3:13	3:20	3:30	3:35	3:50	
3:02	3:06	3:12	3:24	3:31	3:41	3:46	4:01	
3:12	3:16	3:22	3:34	3:41	3:51	3:56	4:11	
3:24	3:28	3:34	3:46	3:53	4:03	4:08	4:23	
3:36	3:40	3:46	3:58	4:05	4:15	4:20	4:35	
3:50	3:54	4:00	4:12	4:19	4:29	4:34	4:49	
4:03	4:07	4:13	4:25	4:32	4:42	4:47	4:62	
4:17	4:21	4:27	4:39	4:46	4:56	5:01	5:16	
4:30	4:34	4:40	4:52	4:59	5:09	5:14	5:29	
4:41	4:45	4:50	5:01	5:10	5:20	5:25	5:40	
4:51	4:55	5:01	5:13	5:20	5:30	5:35	5:50	
5:02	5:06	5:12	5:24	5:31	5:41	5:46	6:01	
5:14	5:18	5:24	5:36	5:43	5:53	5:58	6:13	
5:28	5:32	5:38	5:50	5:57	6:07	6:12	6:27	
5:40	5:44	5:50	6:02	6:10	6:20	6:25	6:40	
5:52	5:56	6:02	6:13	6:20	6:29	6:33	6:47	
6:04	6:08	6:14	6:24	6:31	6:40	6:44	6:57	
6:16	6:20	6:26	6:36	6:43	6:52	6:56	7:09	
6:31	6:34	6:39	6:49	6:56	7:05	7:09	7:22	
6:45	6:48	6:53	7:03	7:10	7:19	7:23	7:36	
7:02	7:05	7:10	7:20	7:26	7:34	7:38	7:50	
7:17	7:20	7:25	7:34	7:40	7:48	7:52	8:03	
7:35	7:38	7:43	7:52	7:58	8:06	8:10	8:21	
7:48	7:51	7:56	8:05	8:11	8:19	8:23	8:34	
8:02	8:05	8:10	8:19	8:25	8:33	8:37	8:48	
8:17	8:20	8:25	8:34	8:40	8:48	8:52	9:03	
8:33	8:36	8:41	8:50	8:56	9:03	9:07	9:17	
8:48	8:51	8:56	9:05	9:11	9:18	9:22	9:33	
9:06	9:09	9:14	9:23	9:29	9:36	9:40	9:50	
9:36	9:39	9:44	9:53	9:59	10:06	10:09	10:19	
10:08	10:11	10:16	10:25	10:31	10:38	10:41	10:51	
10:38	10:41	10:46	10:55	11:01	11:08	11:11	11:21	
11:08	11:11	11:16	11:24	11:29	11:36	11:38	11:47	
11:37	11:40	11:45	11:54	12:00	12:08	12:11	12:21	
12:06a	12:09a	12:14a	12:22a	12:27a	12:33	12:36	12:45	
12:36	12:39	12:44	12:52	12:57	1:03	1:06	1:15	
1:06	1:09	1:14	1:22	1:27	1:33	1:36	1:45	

College Av. → City Heights → North Park → Downtown

A	B	C	D	E	F	G	H	I
University Av. & College Av. DEPART	University Av. & Fairmount Av.	City Heights Transit Plaza @ 15 Hwy.	University Av. & 30th St.	Park Bl. & University Av.	City College & Trolley Plaza (11th Av.)	Broadway & 3rd St.	University Av. & 8th Av. ARRIVE	College Av. & 16th Av. ARRIVE
5:02a	5:12a	5:15a	5:21a	5:25a	5:33a	5:38a	5:47a	
5:32	5:43	5:47	5:52	5:58	6:00	6:05	6:17	
5:47	5:58	6:00	6:05	6:12	6:14	6:19	6:31	
6:02	6:13	6:17	6:23	6:28	6:30	6:35	6:47	
6:17	6:29	6:33	6:40	6:45	6:50	6:55	7:07	
6:32	6:44	6:48	6:55	7:00	7:11	7:15	7:27	
6:47	6:59	7:03	7:10	7:15	7:26	7:30	7:42	
7:02	7:15	7:20	7:27	7:32	7:44	7:48	7:59	
7:17	7:30	7:35	7:42	7:47	7:59	8:03	8:14	
7:32	7:45	7:50	7:57	8:03	8:15	8:19	8:29	
7:47	8:00	8:05	8:12	8:18	8:30	8:34	8:44	
8:02	8:15	8:20	8:27	8:33	8:45	8:49	8:59	
8:19	8:32	8:37	8:44	8:50	9:02	9:06	9:16	
8:34	8:47	8:52	9:00	9:06	9:18	9:22	9:32	
8:47	9:01	9:06	9:14	9:20	9:32	9:36	9:46	
9:02	9:16	9:21	9:29	9:35	9:47	9:51	10:01	
9:17	9:31	9:36	9:44	9:50	10:02	10:06	10:16	
9:32	9:46	9:51	9:59	10:05	10:17	10:21	10:31	
9:47	10:01	10:06	10:14	10:20	10:32	10:36	10:46	
10:02	10:16	10:21	10:29	10:35	10:47	10:51	11:01	
10:17	10:31	10:36	10:44	10:50	11:02	11:06	11:16	
10:32	10:46	10:51	11:00	11:06	11:18	11:22	11:32	
10:44	10:47	10:52	11:03	11:10	11:19	11:23	11:36	
10:57	11:00	11:05	11:16	11:23	11:32	11:36	11:49	
11:10	11:13	11:18	11:29	11:36	11:45	11:49	12:09p	
11:22	11:25	11:30	11:41	11:48	11:57	12:01p	12:14	
11:33	11:36	11:41	11:52	11:59	12:08p	12:12	12:25	
11:45	11:48	11:53	12:04p	12:11p	12:20	12:24	12:37	
11:57	12:00p	12:05p	12:16	12:23	12:32	12:36	12:49	
12:09p	12:12	12:18	12:29	12:36	12:45	12:49	13:02	
12:22	12:25	12:31	12:42	12:49	12:58	1:02	1:16	
12:33	12:36	12:42	12:53	1:00	1:09	1:13	1:27	
12:45	12:48	12:54	1:05	1:12	1:21	1:25	1:39	
12:59	1:02	1:08	1:19	1:26	1:35	1:39	1:53	
1:13	1:17	1:23	1:34	1:41	1:51	1:54	2:09	
1:26	1:30	1:36	1:47	1:54	2:04	2:09	2:23	
1:38	1:42	1:48	1:59	2:06	2:16	2:21	2:35	
1:50	1:54	2:00	2:11	2:18	2:28	2:33	2:47	
2:02	2:06	2:12	2:24	2:31	2:41	2:46	3:01	
2:14	2:18	2:24	2:36	2:43	2:53	2:58	3:13	
2:27	2:31	2:37	2:49	2:56	3:06	3:11	3:26	
2:39	2:43	2:49	3:01	3:08	3:18	3:23	3:38	
2:51	2:55	3:01	3:13	3:20	3:30	3:35	3:50	
3:02	3:06	3:12	3:24	3:31	3:41	3:46	4:01	
3:12	3:16	3:22	3:34	3:41	3:51	3:56	4:11	
3:24	3:28	3:34	3:46	3:53	4:03	4:08	4:23	
3:36	3:40	3:46	3:58	4:05	4:15	4:20	4:35	
3:50	3:54	4:00	4:12	4:19	4:29	4:34	4:49	
4:03	4:07	4:13	4:25	4:32	4:42	4:47	4:62	
4:17	4:21	4:27	4:39	4:46	4:56	5:01	5:16	
4:30	4:34	4:40	4:52	4:59	5:09	5:14	5:29	
4:41	4:45	4:50	5:01	5:10	5:20	5:25	5:40	
4:51	4:55	5:01	5:13	5:20	5:30	5:35	5:50	
5:02	5:06	5:12	5:24	5:31	5:41	5:46	6:01	
5:14	5:18	5:24	5:36	5:43	5:53	5:58	6:13	
5:28	5:32	5:38	5:50	5:57	6:07	6:12	6:27	
5:40	5:44	5:50	6:02	6:10	6:20	6:25	6:40	
5:52	5:56	6:02	6:13	6:20	6:29	6:33	6:47	
6:04	6:08	6:14	6:24	6:31	6:40	6:44	6:57	
6:16	6:20	6:26	6:36	6:43	6:52	6:56	7:0	

ONE-WAY FARES / Tarifas Sencillos

Exact fare, please / Favor de pagar la cantidad exacta	
Adult / Adulto	\$2.50
Senior/Disabled/Medicare* Personas Mayores/Con Discapacidades/Medicare*	\$1.25
Youth (ages 6-18)* Jóvenes (edades 6-18)*	\$2.50
DAY PASS (Regional) / Pase diario (Regional)	
Adult / Adulto	\$6.00
Senior/Disabled/Medicare* Personas Mayores/Con Discapacidades/Medicare*	\$3.00
Youth (ages 6-18)* Jóvenes (edades 6-18)*	\$3.00
MONTHLY PASSES / Pases mensual	
Adult / Adulto	\$72.00
Senior/Disabled/Medicare* Personas Mayores/Con Discapacidades/Medicare*	\$23.00
Youth (ages 6-18)* Jóvenes (edades 6-18)*	\$23.00

*Proof of eligibility required. Senior Eligibility: Age 65+ or born on or before September 1, 1959.
*Se requiere verificación de elegibilidad. Elegibilidad para Personas Mayores: Edad 65+ o nacido o antes del 1 de septiembre, 1959.

COMPASS CARDS / Tarjeta Compass

There is a \$2 charge for Compass Cards, which can be relaxed for future use.
Hay un costo de \$2 por la tarjeta Compass Card, la cual puede ser recargada para usos futuros.

COMPASS CLOUD

Download the free Compass Cloud app on your Apple or Android phone.
Descargue la aplicación gratis Compass Cloud en su teléfono Apple o Android.

Visit sdmts.com/fares for more info. Visite sdmts.com/fares para más información.

DIRECTORY / Directorio

MTS Information & Trip Planning MTS Información y planeo de viaje	511 or/ó (619) 233-3004
TTY/TDD (teletype for hearing impaired) Teletipo para sordos	(619) 234-5005 or/ó (888) 722-4889
InfoExpress (24-hour info via Touch-Tone phone) Información las 24 horas (vía teléfono de teclas)	(619) 685-4900
Customer Service / Suggestions Servicio al cliente / Sugerencias	(619) 557-4555
MTS Security MTS Seguridad	(619) 595-4960
Lost & Found Objetos extraviados	(619) 557-4555
Transit Store	(619) 234-1060 12th & Imperial Transit Center M-F 8am-5pm

For MTS online trip planning
Planificación de viajes por Internet sdmts.com

For more information on riding MTS services, pick up a Rider's Guide on a bus or at the Transit Store, or visit sdmts.com.

Para obtener más información sobre el uso de los servicios de MTS, recija un "Rider's Guide" en un autobús o en la Transit Store, o visita a sdmts.com.

Thank you for riding MTS! ¡Gracias por viajar con MTS!

10

Old Town – University & College Limited Stops
via University Av.

DESTINATIONS

- City Heights Retail Village
- City Heights Transit Plaza
- Hillcrest DMV
- The HUB Hillcrest Market
- Scripps Mercy Hospital
- Village Hillcrest

TROLLEY CONNECTIONS

- Old Town
- Washington St.



09/19

sdmts.com

Route Alerts, Updated Schedules, Connections & More



Alternative formats available upon request. Please call: (619) 557-4555 / Formato alternativo disponible al preguntar. Favor de llamar: (619) 557-4555

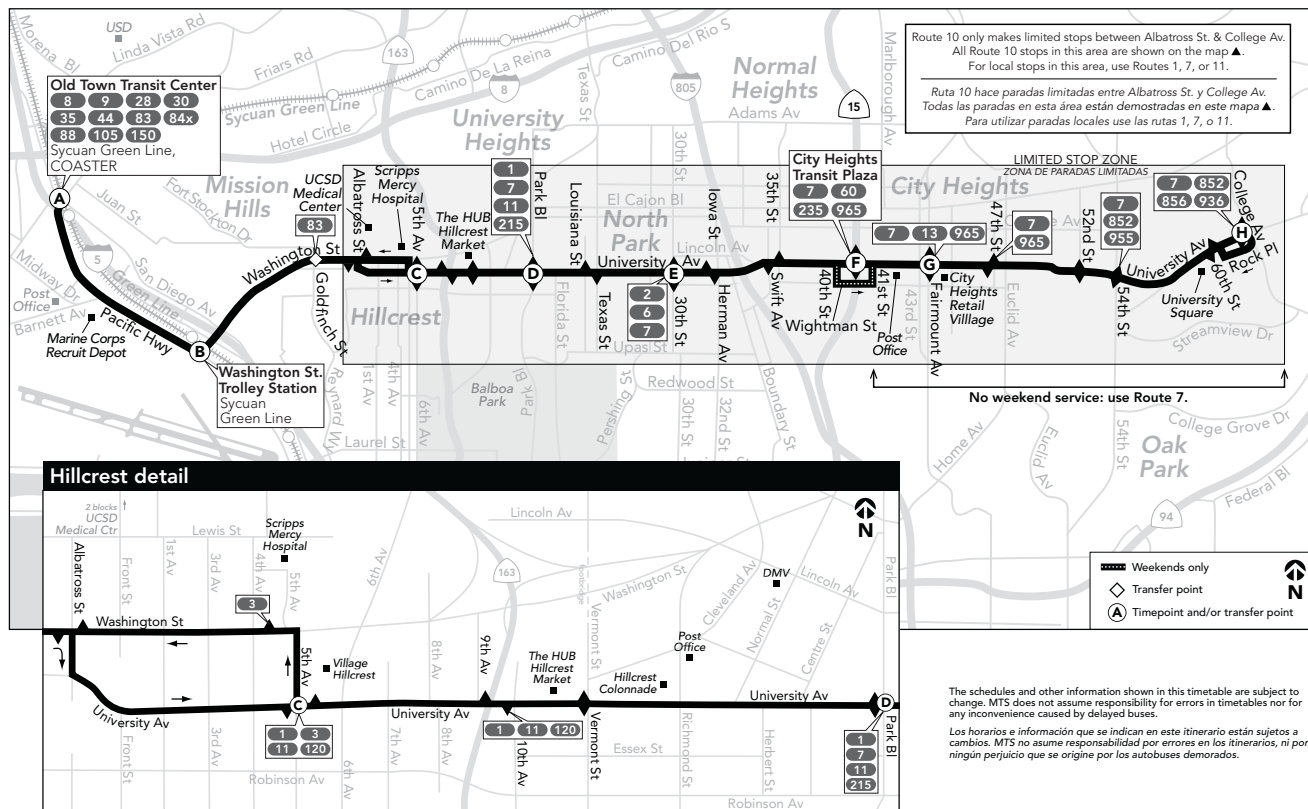

The schedules and other information shown in this timetable are subject to change. MTS does not assume responsibility for errors in timetables nor for any inconvenience caused by delayed buses.
Los horarios e información que se indican en este itinerario están sujetos a cambios. MTS no asume responsabilidad por errores en los itinerarios, ni por ningún perjuicio que se origine por los autobuses demorados.

A Saturday or Sunday schedule will be operated on the following holidays and observed holidays
Se operará con horario de sábado o domingo durante los siguientes días festivos y feriados observados >>> New Year's Day, Presidents' Day, Memorial Day, Independence Day, Labor Day, Thanksgiving, Christmas

Route 10 – Sunday / domingo

Old Town ➔ Hillcrest ➔ North Park ➔ City Heights							
(A)	(B)	(C)	(D)	(E)	(F)	(G)	(H)
Old Town Transit Center	Washington St. & Pacific Hwy.	University Av. & 5th Av.	University Av. & Park Bl.	University Av. & 30th St.	City Heights Transit Plaza @ 15-Fwy.	University Av. & Fairmount Av.	University Av. & College Av. ARRIVE
6:32a	6:37a	6:44a	6:48a	6:52a	7:00a	—	—
7:32	7:37	7:45	7:49	7:54	8:03	—	—
8:29	8:34	8:43	8:48	8:53	9:02	—	—
8:59	9:04	9:13	9:18	9:23	9:32	—	—
9:29	9:34	9:44	9:50	9:55	10:04	—	—
9:59	10:04	10:14	10:20	10:25	10:34	—	—
10:29	10:34	10:44	10:50	10:55	11:04	—	—
10:59	11:04	11:14	11:20	11:25	11:34	—	—
11:29	11:34	11:44	11:51	11:57	12:06p	—	—
11:59	12:04p	12:14p	12:21p	12:27p	12:36	—	—
12:29p	12:34	12:44	12:51	12:57	1:06	—	—
12:59	1:04	1:14	1:21	1:27	1:36	—	—
1:28	1:33	1:43	1:50	1:56	2:06	—	—
1:58	2:03	2:13	2:20	2:26	2:36	—	—
2:28	2:33	2:43	2:50	2:56	3:06	—	—
2:58	3:03	3:13	3:20	3:26	3:36	—	—
3:29	3:34	3:44	3:51	3:57	4:07	—	—
3:59	4:04	4:14	4:21	4:27	4:37	—	—
4:29	4:34	4:44	4:51	4:57	5:07	—	—
4:59	5:04	5:14	5:21	5:27	5:37	—	—
5:29	5:34	5:44	5:51	5:57	6:07	—	—
5:59	6:04	6:14	6:21	6:27	6:37	—	—
6:29	6:34	6:43	6:49	6:55	7:05	—	—
6:59	7:04	7:13	7:19	7:25	7:35	—	—
7:29	7:34	7:43	7:49	7:55	8:05	—	—
7:56	8:01	8:10	8:16	8:22	8:32	—	—
8:26	8:31	8:40	8:46	8:51	9:00	—	—
8:56	9:01	9:10	9:16	9:21	9:30	—	—
9:56	10:01	10:10	10:16	10:20	10:29	—	—

City Heights ➔ North Park ➔ Hillcrest ➔ Old Town							
(H)	(G)	(F)	(E)	(D)	(C)	(B)	(A)
University Av. & College Av. DEPART	University Av. & Fairmount Av.	City Heights Transit Plaza @ 15-Fwy.	University Av. & 30th St.	University Av. & Park Bl.	University Av. & 5th Av.	Washington St. & Pacific Hwy.	Old Town Transit Center ARRIVE
—	—	5:23a	5:28a	5:32a	5:37a	5:46a	5:50a
—	—	5:53	5:58	6:02	6:07	6:16	6:20
—	—	6:23	6:28	6:32	6:37	6:46	6:50
—	—	6:50	6:56	7:01	7:06	7:15	7:20
—	—	7:20	7:26	7:31	7:36	7:45	7:50
—	—	7:50	7:56	8:01	8:06	8:15	8:20
—	—	8:20	8:26	8:31	8:36	8:45	8:50
—	—	8:47	8:54	9:00	9:06	9:15	9:20
—	—	9:17	9:24	9:30	9:36	9:45	9:50
—	—	9:47	9:54	10:00	10:06	10:15	10:20
—	—	10:17	10:24	10:30	10:36	10:45	10:50
—	—	10:47	10:54	11:00	11:06	11:15	11:20
—	—	11:15	11:22	11:28	11:35	11:45	11:50
—	—	11:45	11:52	11:58	12:05p	12:15p	12:20p
—	—	12:15p	12:22p	12:28p	12:35	12:45	12:50
—	—	12:45	12:52	12:58	1:05	1:15	1:20
—	—	1:15	1:22	1:28	1:35	1:45	1:50
—	—	1:45	1:52	1:58	2:05	2:15	2:20
—	—	2:15	2:22	2:28	2:35	2:45	2:50
—	—	2:45	2:52	2:58	3:05	3:15	3:20
—	—	3:15	3:22	3:28	3:35	3:45	3:50
—	—	3:45	3:52	3:58	4:05	4:15	4:20
—	—	4:17	4:24	4:30	4:36	4:45	4:50
—	—	4:47	4:54	5:00	5:06	5:15	5:20
—	—	5:17	5:24	5:30	5:36	5:45	5:50
—	—	5:47	5:54	5:59	6:05	6:14	6:19
—	—	6:17	6:24	6:29	6:35	6:44	6:49
—	—	6:47	6:54	6:59	7:05	7:14	7:19
—	—	7:45	7:52	7:57	8:03	8:12	8:17

Route 10 – Monday through Friday / lunes a viernes

Old Town ➔ Hillcrest ➔ North Park ➔ City Heights

(A) Old Town Transit Center DEPART	(B) Washington St. & Pacific Hwy.	(C) University Av. & 5th Av.	(D) University Av. & Park Bl.	(E) University Av. & 30th St.	(F) City Heights Transit Plaza @ 15-Fwy.	(G) University Av. & Fairmount Av.	(H) University Av. & College Av. ARRIVE
5:51a	5:56a	6:04a	6:09a	6:12a	6:17a	6:20a	6:27a
6:06	6:11	6:19	6:24	6:27	6:32	6:35	6:42
6:21	6:26	6:34	6:39	6:43	6:49	6:52	6:59
6:36	6:41	6:49	6:54	6:58	7:04	7:07	7:14
6:51	6:56	7:04	7:10	7:14	7:20	7:23	7:31
7:06	7:11	7:20	7:26	7:31	7:38	7:41	7:49
7:21	7:26	7:35	7:41	7:46	7:53	7:56	8:04
7:38	7:43	7:52	7:58	8:03	8:10	8:13	8:21
7:53	7:58	8:07	8:13	8:18	8:25	8:28	8:36
8:08	8:13	8:22	8:28	8:30	8:40	8:43	8:51
8:23	8:28	8:37	8:43	8:48	8:55	8:58	9:06
8:38	8:43	8:52	8:58	9:03	9:10	9:13	9:21
8:53	8:58	9:07	9:13	9:18	9:25	9:28	9:36
9:08	9:13	9:22	9:28	9:33	9:40	9:43	9:51
9:23	9:28	9:37	9:43	9:48	9:55	9:58	10:06
9:38	9:43	9:52	9:58	10:03	10:10	10:13	10:21
9:51	9:56	10:05	10:12	10:17	10:24	10:28	10:36
10:06	10:11	10:21	10:28	10:34	10:42	10:46	10:54
10:21	10:26	10:36	10:43	10:49	10:57	11:01	11:09
10:36	10:41	10:51	10:58	11:04	11:12	11:16	11:24
10:51	10:56	11:06	11:13	11:19	11:27	11:31	11:39
11:06	11:11	11:21	11:28	11:34	11:42	11:46	11:54
11:21	11:26	11:36	11:43	11:49	11:57	12:01p	12:09p
11:35	11:40	11:50	11:57	12:03p	12:11p	12:15	12:23
11:50	11:55	12:05p	12:12p	12:18	12:26	12:30	12:38
12:05p	12:10p	12:20	12:27	12:33	12:41	12:45	12:53
12:20	12:25	12:35	12:42	12:48	1:00	1:08	1:16
12:35	12:40	12:50	12:57	1:03	1:11	1:15	1:23
12:50	12:55	1:05	1:12	1:18	1:26	1:30	1:38
1:05	1:10	1:20	1:27	1:33	1:41	1:45	1:53
1:20	1:25	1:35	1:42	1:48	1:56	2:00	2:08
1:35	1:40	1:51	1:58	2:04	2:12	2:16	2:25
1:50	1:55	2:06	2:13	2:19	2:27	2:31	2:40
2:05	2:10	2:21	2:28	2:34	2:42	2:46	2:55
2:20	2:25	2:36	2:43	2:49	2:57	3:01	3:10
2:34	2:40	2:52	2:59	3:05	3:13	3:17	3:26
2:46	2:52	3:04	3:11	3:17	3:25	3:29	3:38
2:58	3:04	3:16	3:23	3:29	3:37	3:41	3:50
3:11	3:17	3:29	3:36	3:42	3:50	3:54	4:03
3:24	3:30	3:42	3:49	3:55	4:03	4:07	4:16
3:36	3:42	3:55	4:02	4:09	4:17	4:21	4:30
3:48	3:54	4:07	4:14	4:21	4:29	4:33	4:42
4:00	4:06	4:19	4:26	4:33	4:41	4:45	4:54
4:12	4:18	4:31	4:38	4:45	4:53	4:57	5:06
4:24	4:30	4:43	4:50	4:57	5:05	5:09	5:18
4:36	4:42	4:55	5:02	5:09	5:17	5:21	5:30
4:48	4:54	5:07	5:14	5:21	5:29	5:33	5:42
5:00	5:06	5:19	5:26	5:33	5:41	5:45	5:54
5:12	5:18	5:31	5:38	5:45	5:53	5:57	6:06
5:24	5:30	5:43	5:50	5:57	6:05	6:09	6:18
5:37	5:43	5:56	6:03	6:10	6:18	6:22	6:31
5:51	5:57	6:10	6:17	6:24	6:32	6:36	6:45
6:06	6:11	6:24	6:31	6:37	6:45	6:49	6:58
6:21	6:26	6:38	6:45	6:52	7:00	7:04	7:13
6:36	6:41	6:53	7:00	7:06	7:13	7:17	7:26
6:51	6:56	7:08	7:15	7:21	7:28	7:32	7:41
7:07	7:12	7:24	7:31	7:37	7:44	7:48	7:57
7:22	7:27	7:38	7:44	7:49	7:56	7:59	8:07
7:37	7:42	7:52	7:58	8:03	8:09	8:12	8:20
7:52	7:57	8:07	8:13	8:18	8:24	8:27	8:35
8:07	8:12	8:22	8:28	8:33	8:39	8:42	8:50
8:22	8:27	8:37	8:43	8:48	8:54	8:57	9:05
8:39	8:44	8:54	9:00	9:05	9:11	9:14	9:22
9:09	9:14	9:23	9:29	9:33	9:39	9:42	9:50
9:39	9:44	9:53	9:58	10:02	10:08	10:11	10:18
10:09	10:14	10:23	10:28	10:32	10:38	10:41	10:48
10:45	10:50	10:59	11:04	11:08	11:14	11:17	11:24
11:15	11:20	11:28	11:33	11:37	11:42	11:45	11:52
11:45	11:50	11:58	12:03a	12:07a	12:12a	12:15a	12:22a

LIMITED STOP ZONE / ZONA DE PARADAS LIMITADAS

City Heights ➔ North Park ➔ Hillcrest ➔ Old Town

(H) University Av. & College Av. DEPART	(G) University Av. & Fairmount Av.	(F) City Heights Transit Plaza @ 15-Fwy.	(E) University Av. & 30th St.	(D) University Av. & Park Bl.	(C) University Av. & 5th Av.	(B) Washington St. & Pacific Hwy.	(A) Old Town Transit Center ARRIVE
4:45a	4:54a	4:57a	5:02a	5:06a	5:11a	5:20a	5:24a
5:15	5:24	5:27	5:32	5:36	5:41	5:50	5:54
5:30	5:39	5:42	5:47	5:51	5:56	6:05	6:09
5:45	5:54	5:57	6:02	6:06	6:11	6:20	6:24
5:57	6:07	6:10	6:15	6:20	6:25	6:34	6:39
6:09	6:19	6:22	6:27	6:32	6:37	6:46	6:51
6:21	6:31	6:34	6:39	6:44	6:49	6:58	7:03
6:29	6:40	6:44	6:50	6:55	7:00	7:10	7:15
6:41	6:52	6:56	7:02	7:07	7:12	7:22	7:27
6:50	7:02	7:06	7:13	7:19	7:24	7:34	7:39
7:02	7:14	7:18	7:25	7:31	7:36	7:46	7:51
7:14	7:26	7:30	7:37	7:43	7:48	7:58	8:03
7:23	7:35	7:39	7:46	7:52	7:58	8:09	8:15
7:35	7:47	7:51	7:58	8:04	8:10	8:21	8:27
7:47	7:59	8:03	8:10	8:16	8:22	8:33	8:39
7:59	8:11	8:15	8:22	8:28	8:34	8:45	8:51
8:11	8:23	8:27	8:34	8:40	8:46	8:57	9:03
8:25	8:36	8:39	8:46	8:52	8:59	9:10	9:16
8:35	8:46	8:49	8:56	9:02	9:09	9:20	9:25
8:47	8:58	9:01	9:08	9:14	9:21	9:32	9:37
9:05	9:16	9:19	9:26	9:32	9:39	9:50	9:55
9:20	9:31	9:34	9:41	9:47	9:54	10:05	10:10
9:35	9:46	9:49	9:56	10:02	10:09	10:20	10:25
9:50	10:01	10:04	10:11	10:17	10:24	10:35	10:40
10:05	10:16	10:19	10:26	10:32	10:39	10:50	10:55
10:20	10:31	10:34	10:41	10:47	10:54	11:05	11:10
10:35	10:46	10:49	10:56	11:02	11:09	11:20	11:25
10:50	11:01	11:04	11:11	11:17	11:24	11:35	11:40
11:05	11:16	11:19	11:26	11:32	11:39	11:50	11:55
11:20	11:31	11:34	11:41	11:47	11:54	12:05p	12:10p
11:35	11:46	11:49	11:56	12:02p	12:09p	12:20	12:25
11:50	12:01p	12:04p	12:11p	12:17	12:24	12:35	12:40
12:05p	12:16	12:19	12:26	12:32	12:39	12:50	12:55
12:20	12:31	12:34	12:41	12:47	12:54	1:05	1:10
12:35	12:46	12:49	12:56	1:02	1:09	1:20	1:25
12:50	1:01	1:04	1:11	1:17	1:24	1:35	1:40
1:05	1:16	1:19	1:26	1:32	1:39	1:50	1:55
1:20	1:31	1:34	1:41	1:47	1:54	2:05	2:10
1:35	1:46	1:49	1:56	2:02	2:09	2:20	2:25
1:49	2:00	2:03	2:10	2:16	2:23	2:34	2:39
2:02	2:13	2:17	2:24	2:30	2:37	2:48	2:54
2:17	2:28	2:32	2:39	2:45	2:52	3:03	3:09
2:33	2:44	2:48	2:55	3:01	3:08	3:19	3:25
2:48	2:59	3:03	3:10	3:16	3:23	3:34	3:40
3:03	3:14	3:18	3:25	3:31	3:38	3:49	3:55
3:18	3:29	3:33	3:40	3:46	3:53	4:04	4:10
3:33	3:44	3:48	3:55	4:01	4:08	4:19	4:25
3:48	3:59	4:03	4:10	4:16	4:23	4:34	4:40
4:03	4:14	4:18	4:25	4:31	4:38	4:49	4:55
4:18	4:29	4:33	4:40	4:46	4:53	5:04	5:10
4:33	4:44	4:48	4:55	5:01	5:08	5:19	5:25
4:48	4:59	5:03	5:10	5:16	5:23	5:34	5:40
5:03	5:14	5:18	5:25	5:31	5:38	5:49	5:55
5:18	5:29	5:33	5:40	5:46	5:53	6:04	6:10
5:35	5:46	5:49	5:56	6:02	6:09	6:20	6:25
5:50	6:01	6:04	6:11	6:17	6:24	6:35	6:40
6:05	6:16	6:19	6:26	6:32	6:39	6:50	6:55
6:20	6:31	6:34	6:41	6:47	6:54	7:05	7:10
6:35	6:46	6:49	6:56	7:02	7:09	7:20	7:25
7:08	7:18	7:21	7:28	7:34	7:40	7:50	7:55
7:38	7:48	7:51	7:58	8:04	8:10	8:20	8:25
8:16	8:25	8:28	8:34	8:39	8:45	8:55	9:00
8:46	8:55	8:58	9:04	9:09	9:15	9:25	9:30
9:16	9:25	9:28	9:34	9:39	9:45	9:55	10:00
9:57	10:06	10:09	10:15	10:19	10:24	10:33	10:38
10:29	10:38	10:41	10:46	10:50	10:55	11:04	11:08

LIMITED STOP ZONE / ZONA DE PARADAS LIMITADAS

Route 10 – Saturday / sábado

Old Town ➔ Hillcrest ➔ North Park ➔ City Heights

(A) Old Town Transit Center DEPART	(B) Washington St. & Pacific Hwy.	(C) University Av. & 5th Av.	(D) University Av. & Park Bl.	(E) University Av. & 30th St.	(F) City Heights Transit Plaza @ 15-Fwy.	(G) University Av. & Fairmount Av.	(H) University Av. & College Av. ARRIVE
5:51a	5:56a	6:03a	6:07a	6:10a	6:18a	—	—
6:21	6:26	6:33	6:37	6:41	6:49	—	—
6:51	6:56	7:03	7:07	7:11	7:19	—	—
7:21	7:26	7:34	7:38	7:43	7:52	—	—
7:51	7:56	8:04	8:08	8:13	8:22	—	—
8:21	8:26	8:35	8:40	8:45	8:54	—	—
8:46	8:51	9:00	9:05	9:10	9:19	—	—
9:10	9:15	9:25	9:31	9:36	9:45	—	—
9:34	9:39	9:49	9:55	10:00	10:09	—	—
9:55	10:00	10:10	10:16	10:21	10:30	—	—
10:15	10:20	10:30	10:36	10:			

ONE-WAY FARES / Tarifas Sencillos

Exact fare, please / Favor de pagar la cantidad exacta	
Adult / Adulto	\$2.50
Senior/Disabled/Medicare* Personas Mayores/con Discapacidades/Medicare*	\$1.25
Youth (ages 6-18)* Jóvenes (edades 6-18)*	\$2.50
DAY PASS (Regional) / Pase diario (Regional)	
Adult / Adulto	\$6.00
Senior/Disabled/Medicare* Personas Mayores/con Discapacidades/Medicare*	\$3.00
Youth (ages 6-18)* Jóvenes (edades 6-18)*	\$3.00
MONTHLY PASSES / Pases mensual	
Adult / Adulto	\$72.00
Senior/Disabled/Medicare* Personas Mayores/con Discapacidades/Medicare*	\$23.00
Youth (ages 6-18)* Jóvenes (edades 6-18)*	\$23.00

*Proof of eligibility required. Senior Eligibility: Age 65+ or born on or before September 1, 1959. *Se requiere verificación de elegibilidad. Elegibilidad para Personas Mayores: Edad 65+ o nacido o antes del 1 de septiembre, 1959.

COMPASS CARDS / Tarjeta Compass
There is a \$2 charge for Compass Cards, which can be reloaded for future use. Hay un costo de \$2 por la tarjeta Compass Card, la cual puede ser recargada para usos futuros.

COMPASS CLOUD
Download the free Compass Cloud app on your Apple or Android phone. Descargue la aplicación gratis Compass Cloud en su teléfono Apple o Android.

Visit sdmts.com/fares for more info. Visite sdmts.com/fares para más información.

DIRECTORY / Directorio

MTS Information & Trip Planning MTS Información y planeo de viaje	511 or/ó (619) 233-3004
TTY/TDD (teletype for hearing impaired) Teletipo para sordos	(619) 234-5005 or/ó (888) 722-4889
InfoExpress (24-hour info via Touch-Tone phone) Información las 24 horas (vía teléfono de teclas)	(619) 685-4900
Customer Service / Suggestions Servicio al cliente / Sugerencias	(619) 557-4555
MTS Security MTS Seguridad	(619) 595-4960
Lost & Found Objetos extraviados	(619) 557-4555
Transit Store	(619) 234-1060 12th & Imperial Transit Center M-F 8am-5pm

For MTS online trip planning
Planificación de viajes por Internet sdmts.com

For more information on riding MTS services, pick up a Rider's Guide on a bus or at the Transit Store, or visit sdmts.com.

Para obtener más información sobre el uso de los servicios de MTS, recoja un "Rider's Guide" en un autobús o en la Transit Store, o visita a sdmts.com.

Thank you for riding MTS! ¡Gracias por viajar con MTS!

Effective SEPTEMBER 1, 2019



24th St. Transit Center – Kaiser Hospital
via Euclid Transit Center / Grantville Trolley

DESTINATIONS

- City Heights Community Park
- Euclid Avenue
- Fairmount Avenue
- Gompers Prep Academy
- Mission Gorge Center
- Paradise Valley Hospital

TROLLEY CONNECTIONS

- 24th St.
- Euclid Av.
- Grantville



sdmts.com

Route Alerts, Updated Schedules, Connections & More



Alternative formats available upon request. Please call: (619) 557-4555 / Formato alternativo disponible al preguntar. Favor de llamar: (619) 557-4555

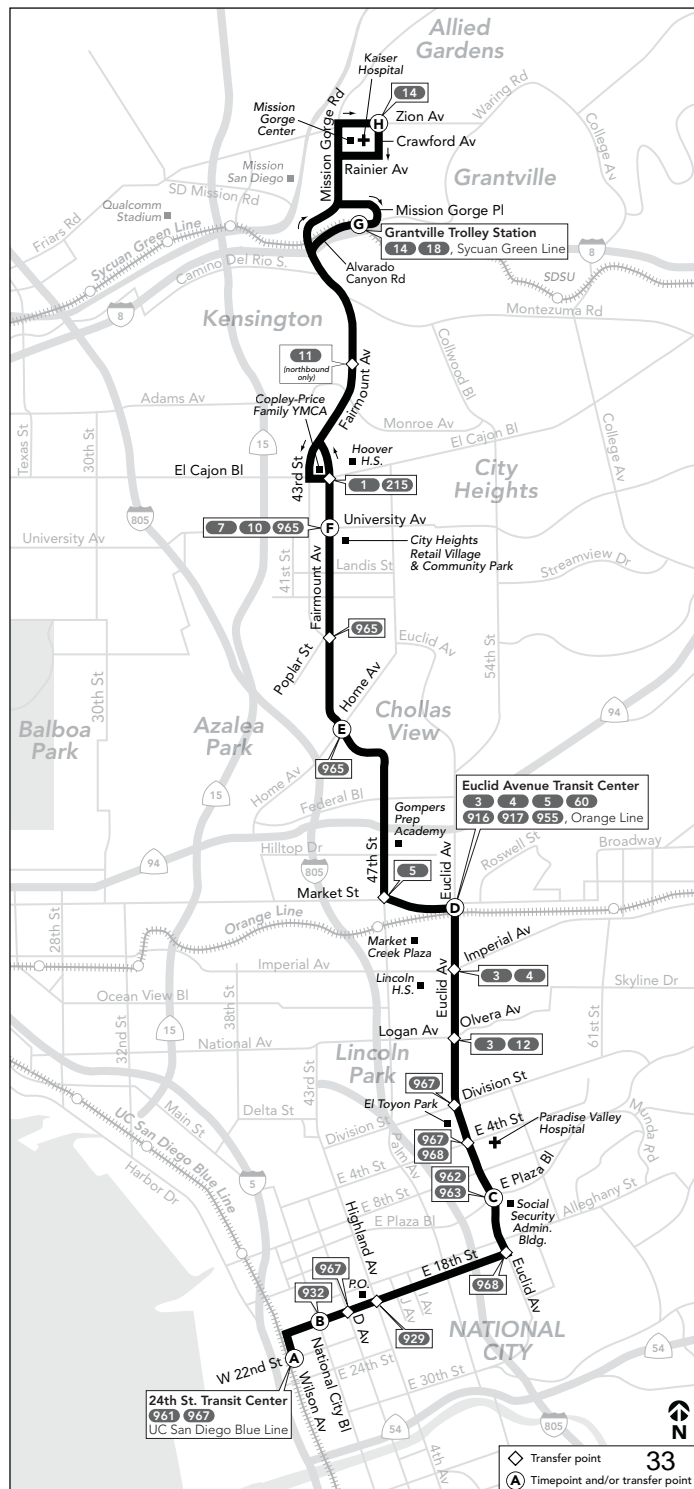

A Saturday or Sunday schedule will be operated on the following holidays and observed holidays
Se operará con horario de sábado o domingo durante los siguientes días festivos y feriados observados

>>> New Year's Day, Presidents' Day, Memorial Day, Independence Day, Labor Day, Thanksgiving, Christmas

Route 13 – Sunday / domingo

National City → City Heights → Grantville

(A) 24th St. Transit Center DEPART	(B) 18th St. & National City Bl.	(C) Euclid Av. & E. Plaza Bl.	(D) Euclid Av. Transit Center	(E) Fairmount Av. & Home Av.	(F) Fairmount Av. & University Av.	(G) Grantville Trolley Station	(H) Kaiser Hospital ARRIVE
5:52a	5:54a	6:02a	5:47a	5:53a	6:01a	6:10a	6:16a
6:52	6:54	7:02	7:17	7:23	7:31	7:40	7:46
7:50	7:52	8:01	8:16	8:23	8:32	8:41	8:47
8:49	8:51	9:00	9:16	9:23	9:32	9:41	9:48
9:17	9:19	9:29	9:45	9:53	10:02	10:11	10:18
9:47	9:49	9:59	10:15	10:23	10:32	10:41	10:48
10:17	10:19	10:29	10:45	10:53	11:02	11:11	11:18
10:45	10:47	10:57	11:14	11:22	11:32	11:41	11:48
11:15	11:17	11:27	11:44	11:52	12:02p	12:11p	12:18p
11:45	11:47	11:57	12:14p	12:22p	12:32	12:41	12:48
12:15p	12:17p	12:27p	12:44	12:52	1:02	1:11	1:18
12:45	12:47	12:57	1:14	1:22	1:32	1:41	1:48
1:15	1:17	1:27	1:44	1:52	2:02	2:11	2:18
1:45	1:47	1:57	2:14	2:22	2:32	2:41	2:48
2:15	2:17	2:27	2:44	2:52	3:02	3:11	3:18
2:45	2:47	2:57	3:14	3:22	3:32	3:41	3:48
3:15	3:17	3:27	3:44	3:52	4:02	4:11	4:18
3:45	3:47	3:57	4:14	4:22	4:32	4:41	4:48
4:15	4:17	4:27	4:44	4:52	5:02	5:11	5:18
4:45	4:47	4:57	5:14	5:22	5:32	5:41	5:48
5:22	5:24	5:33	5:49	5:56	6:06	6:15	6:22
5:52	5:54	6:03	6:19	6:26	6:36	6:45	6:52
6:22	6:24	6:33	6:49	6:56	7:06	7:14	7:20
6:52	6:54	7:03	7:19	7:26	7:35	7:44	7:50
7:22	7:24	7:33	7:49	7:56	8:05	8:13	8:19
7:53	7:55	8:04	8:19	8:26	8:35	8:43	8:49
8:23	8:25	8:34	8:49	—	—	—	—

Route 13 – Sunday / domingo

Grantville → City Heights → National City

(H) Kaiser Hospital DEPART	(G) Grantville Trolley Station	(F) Fairmount Av. & University Av.	(E) Fairmount Av. & Home Av.	(D) Euclid Av. Transit Center	(C) Euclid Av. & E. Plaza Bl.	(B) 18th St. & National City Bl.	(A) 24th St. Transit Center ARRIVE
—	—	—	—	5:26a	5:36a	5:43a	5:46a
6:28a	6:36a	6:44a	6:51a	7:00	7:10	7:17	7:20
6:58	7:06	7:14	7:21	7:30	7:40	7:47	7:50
7:28	7:36	7:45	7:53	8:02	8:13	8:21	8:24
7:58	8:06	8:15	8:23	8:32	8:43	8:51	8:54
8:28	8:36	8:45	8:53	9:02	9:13	9:21	9:24
8:57	9:06	9:16	9:24	9:33	9:45	9:53	9:56
9:29	9:38	9:48	9:56	10:05	10:17	10:25	10:28
9:59	10:08	10:18	10:26	10:35	10:47	10:55	10:58
10:29	10:38	10:48	10:56	11:05	11:17	11:25	11:28
10:59	11:08	11:18	11:26	11:35	11:48	11:56	11:59
11:29	11:38	11:48	11:56	12:05p	12:18p	12:26p	12:29p
11:59	12:08p	12:19p	12:27p	12:37	12:50	12:58	1:01
12:29p	12:38	12:49	12:57	1:07	1:20	1:28	1:31
12:59	1:08	1:19	1:27	1:37	1:50	1:58	2:01
1:29	1:38	1:49	1:57	2:07	2:20	2:28	2:31
1:59	2:08	2:19	2:27	2:37	2:50	2:58	3:01
2:29	2:38	2:49	2:57	3:07	3:20	3:28	3:31
2:59	3:08	3:19	3:27	3:37	3:50	3:58	4:01
3:29	3:38	3:49	3:57	4:07	4:20	4:28	4:31
3:59	4:08	4:19	4:27	4:37	4:50	4:58	5:01
4:29	4:38	4:49	4:57	5:07	5:20	5:28	5:31
4:59	5:08	5:19	5:27	5:37	5:50	5:58	6:01
5:29	5:38	5:49	5:57	6:07	6:20	6:28	6:31
6:05	6:14	6:24	6:32	6:41	6:53	7:01	7:04
6:35	6:44	6:54	7:02	7:11	7:23	7:31	7:34
7:05	7:14	7:24	7:32	7:41	7:53	8:01	8:04
7:37	7:45	7:54	8:02	8:10	8:22	8:30	8:33
8:07	8:15	8:24	8:31	8:39	8:50	8:57	9:00
8:37	8:45	8:54	9:01	9:09	9:20	9:27	9:30

The schedules and other information shown in this timetable are subject to change. MTS does not assume responsibility for errors in timetables nor for any inconvenience caused by delayed buses.
Los horarios e información que se indican en este itinerario están sujetos a cambios. MTS no asume responsabilidad por errores en los itinerarios, ni por ningún perjuicio que se origine por los autobuses demorados.

Route 13 – Monday through Friday / lunes a viernes

National City ➔ City Heights ➔ Grantville

(A)	(B)	(C)	(D)	(E)	(F)	(G)	(H)
24th St. Transit Center DEPART	18th St. & National City Bl.	Euclid Av. & E. Plaza Bl.	Euclid Av. Transit Center	Fairmount Av. & Home Av.	Fairmount Av. & University Av.	Grantville Trolley Station	Kaiser Hospital ARRIVE
4:34a	4:36a	4:44a	4:59a	5:06a	5:15a	5:24a	5:30a
4:49	4:51	4:59	5:14	5:21	5:30	5:39	5:45
5:04	5:06	5:14	5:29	5:36	5:45	5:54	6:00
5:19	5:21	5:29	5:44	5:51	6:00	6:09	6:15
5:34	5:36	5:44	5:59	6:06	6:15	6:24	6:30
5:47	5:49	5:57	6:12	6:19	6:28	6:37	6:43
5:59	6:01	6:09	6:24	6:31	6:40	6:49	6:55
6:09	6:12	6:20	6:36	6:43	6:52	7:01	7:07
6:21	6:24	6:32	6:48	6:55	7:04	7:13	7:19
6:31	6:34	6:42	6:58	7:05	7:14	7:23	7:29
6:42	6:45	6:54	7:11	7:19	7:29	7:38	7:45
6:54	6:57	7:06	7:23	7:31	7:42	7:52	7:59
7:04	7:07	7:17	7:35	7:43	7:54	8:04	8:11
7:16	7:19	7:29	7:47	7:55	8:06	8:16	8:23
7:28	7:31	7:41	7:59	8:07	8:18	8:28	8:35
7:40	7:43	7:53	8:11	8:19	8:30	8:40	8:47
7:53	7:56	8:06	8:24	8:32	8:43	8:53	9:00
8:05	8:08	8:18	8:36	8:44	8:55	9:05	9:12
8:17	8:20	8:30	8:47	8:55	9:05	9:14	9:21
8:29	8:32	8:42	8:59	9:07	9:17	9:26	9:33
8:41	8:44	8:54	9:11	9:19	9:29	9:38	9:45
8:53	8:56	9:06	9:23	9:31	9:41	9:50	9:57
9:05	9:08	9:18	9:35	9:43	9:53	10:02	10:09
9:17	9:20	9:30	9:47	9:55	10:05	10:14	10:21
9:29	9:32	9:42	9:59	10:07	10:17	10:26	10:33
9:41	9:44	9:54	10:11	10:19	10:29	10:38	10:45
9:53	9:56	10:06	10:23	10:31	10:41	10:50	10:57
10:05	10:08	10:18	10:35	10:43	10:53	11:02	11:09
10:17	10:20	10:30	10:47	10:55	11:05	11:14	11:21
10:29	10:32	10:42	10:59	11:07	11:17	11:26	11:33
10:41	10:44	10:54	11:11	11:19	11:29	11:38	11:45
10:53	10:56	11:06	11:23	11:31	11:41	11:50	11:57
11:05	11:08	11:18	11:35	11:43	11:53	12:02p	12:09p
11:17	11:20	11:30	11:47	11:55	12:05p	12:14	12:21p
11:29	11:32	11:42	11:59	12:07p	12:17	12:26	12:33
11:41	11:44	11:54	12:11p	12:19	12:29	12:38	12:45
11:53	11:56	12:06	12:23	12:31	12:41	12:50	12:57
12:05p	12:08p	12:18	12:35	12:43	12:53	1:02	1:09
12:17	12:20	12:30	12:47	12:55	1:05	1:14	1:21
12:29	12:32	12:42	12:59	1:07	1:17	1:26	1:33
12:41	12:44	12:54	1:11	1:19	1:29	1:38	1:45
12:52	12:55	1:05	1:22	1:30	1:40	1:49	1:56
1:04	1:07	1:17	1:34	1:42	1:52	2:01	2:08
1:16	1:19	1:29	1:46	1:54	2:04	2:13	2:20
1:28	1:31	1:41	1:58	2:06	2:16	2:25	2:32
1:39	1:42	1:53	2:10	2:19	2:29	2:39	2:46
1:51	1:54	2:05	2:22	2:31	2:41	2:51	2:58
2:03	2:06	2:17	2:34	2:43	2:53	3:03	3:10
2:15	2:18	2:29	2:46	2:55	3:05	3:15	3:22
2:28	2:31	2:42	2:59	3:08	3:18	3:28	3:35
2:40	2:43	2:54	3:11	3:20	3:30	3:40	3:47
2:52	2:55	3:06	3:23	3:32	3:42	3:52	3:59
3:04	3:07	3:18	3:35	3:44	3:54	4:04	4:11
3:16	3:19	3:30	3:47	3:56	4:06	4:16	4:23
3:28	3:31	3:42	3:59	4:08	4:18	4:28	4:35
3:40	3:43	3:54	4:11	4:20	4:30	4:40	4:47
3:52	3:55	4:06	4:23	4:32	4:42	4:52	4:59
4:06	4:09	4:19	4:36	4:44	4:54	5:04	5:11
4:19	4:22	4:32	4:49	4:57	5:07	5:17	5:24
4:31	4:34	4:44	5:01	5:09	5:19	5:29	5:36
4:42	4:45	4:55	5:12	5:20	5:30	5:40	5:47
4:54	4:57	5:07	5:24	5:32	5:42	5:52	5:59
5:06	5:09	5:19	5:36	5:44	5:54	6:04	6:11
5:18	5:21	5:31	5:48	5:56	6:05	6:14	6:21
5:31	5:34	5:43	5:59	6:07	6:16	6:25	6:32
5:43	5:46	5:55	6:11	6:19	6:28	6:37	6:44
5:55	5:58	6:07	6:23	6:31	6:40	6:49	6:56
6:06	6:09	6:18	6:34	6:42	6:51	7:00	7:07
6:19	6:22	6:31	6:47	6:55	7:04	7:13	7:20
6:34	6:37	6:46	7:02	7:10	7:19	7:28	7:35
6:52	6:54	7:03	7:19	7:27	7:36	7:45	7:52
7:11	7:15	7:24	7:40	7:48	7:57	8:06	8:13
7:33	7:35	7:44	8:19	8:26	8:35	8:43	8:49
8:23	8:25	8:34	8:49	8:56	9:05	9:13	9:19
8:33	8:35	8:44	9:19	9:26	9:35	9:43	9:49
9:23	9:25	9:34	9:49	9:56	10:05	10:13	10:19
9:55	9:57	10:05	10:19	10:26	10:35	10:43	10:49
10:27	10:29	10:37	10:51	10:57	11:05	11:13	11:19

Grantville ➔ City Heights ➔ National City

(H)	(G)	(F)	(E)	(D)	(C)	(B)	(A)
Kaiser Hospital DEPART	Grantville Trolley Station	Fairmount Av. & University Av.	Fairmount Av. & Home Av.	Euclid Av. Transit Center	Euclid Av. & E. Plaza Bl.	18th St. & National City Bl.	24th St. Transit Center ARRIVE
4:35a	4:35a	4:44a	4:52a	5:01a	5:13a	5:22a	5:25a
4:50	4:50	4:59	5:07	5:16	5:28	5:37	5:40
5:06	5:06	5:15	5:23	5:32	5:44	5:53	5:56
5:13a	5:21	5:30	5:38	5:47	5:59	6:08	6:11
5:29	5:37	5:46	5:54	6:03	6:15	6:24	6:27
5:44	5:52	6:01	6:09	6:18	6:30	6:39	6:42
5:56	6:04	6:13	6:22	6:31	6:42	6:51	6:54
6:07	6:15	6:24	6:32	6:41	6:53	7:02	7:05
6:18	6:25	6:35	6:43	6:53	7:05	7:14	7:17
6:28	6:37	6:47	6:55	7:05	7:17	7:26	7:29
6:40	6:49	6:59	7:07	7:17	7:30	7:40	7:43
6:49	6:59	7:10	7:19	7:29	7:42	7:52	7:55
6:59	7:09	7:20	7:29	7:39	7:52	8:02	8:05
7:10	7:20	7:31	7:40	7:50	8:03	8:13	8:16
7:22	7:32	7:43	7:52	8:02	8:15	8:25	8:28
7:34	7:44	7:55	8:04	8:14	8:27	8:37	8:40
7:46	7:56	8:07	8:16	8:26	8:39	8:49	8:52
8:00	8:10	8:20	8:28	8:38	8:51	9:00	9:03
8:12	8:22	8:32	8:40	8:50	9:03	9:12	9:15
8:24	8:34	8:44	8:52	9:02	9:15	9:24	9:27
8:36	8:46	8:56	9:04	9:14	9:27	9:36	9:39
8:48	8:58	9:08	9:16	9:26	9:39	9:48	9:51
9:01	9:11	9:21	9:29	9:38	9:51	9:59	10:02
9:13	9:23	9:33	9:41	9:50	10:03	10:11	10:14
9:25	9:35	9:45	9:53	10:02	10:15	10:23	10:26
9:37	9:47	9:57	10:05	10:14	10:27	10:35	10:38
9:49	10:00	10:10	10:18	10:26	10:39	10:47	10:50
10:01	10:11	10:21	10:29	10:38	10:51	10:59	11:02
10:13	10:23	10:33	10:41	10:50	11:03	11:11	11:14
10:25	10:35	10:45	10:53	11:02	11:15	11:23	11:26
10:37	10:47	10:57	11:05	11:14	11:27	11:35	11:38
10:49	10:59	11:09	11:17	11:26	11:39	11:47	11:50
11:01	11:11	11:21	11:29	11:38	11:51	11:59	12:02p
11:13	11:23	11:33	11:41	11:50	12:03p	12:11p	12:14
11:25	11:35	11:45	11:53	12:02p	12:15	12:23	12:26
11:37	11:47	11:57	12:05p	12:14	12:27	12:35	12:38
11:47	11:57	12:06p	12:15	12:28	12:39	12:48	12:51
11:59	12:09p	12:20	12:28	12:38	12:51	1:00	1:03
12:11p	12:21	12:32	12:40	12:50	1:03	1:12	1:15
12:23	12:33	12:44	12:52	1:02	1:15	1:24	1:27
12:34	12:44	12:55	1:03	1:13	1:26	1:35	1:38
12:46	12:56	1:07	1:15	1:25	1:38	1:47	1:50
12:58	1:08	1:19	1:27	1:37	1:50	1:59	2:02
1:10	1:20	1:31	1:39	1:50	2:04	2:13	2:16
1:22	1:32	1:43	1:51	2:02	2:16	2:25	2:28
1:34	1:44	1:55	2:03	2:14	2:28	2:37	2:40
1:46	1:56	2:07	2:15	2:26	2:40	2:49	2:52
1:57	2:07	2:18	2:26	2:37	2:51	3:00	3:03
2:07	2:18	2:30	2:39	2:50	3:04	3:13	3:16
2:19	2:30	2:42	2:51	3:02	3:16	3:25	3:28
2:31	2:42	2:54	3:03	3:14	3:28	3:37	3:40
2:43	2:54	3:06	3:15	3:26	3:40	3:49	3:52
2:55	3:06	3:20	3:29	3:40	3:54	4:03	4:06
3:09	3:20	3:32	3:41	3:52	4:06	4:15	4:18
3:21	3:32	3:44	3:53	4:04	4:18	4:27	4:30
3:33	3:44	3:56	4:05	4:16	4:30	4:42	4:42
3:45	3:56	4:08	4:17	4:28	4:42	4:51	4:54
3:57	4:08	4:20	4:29	4:40	4:54	5:03	5:06
4:10	4:21	4:33	4:42	4:53	5:07	5:16	5:19
4:22	4:33	4:45	4:54	5:05	5:19	5:28	5:31
4:34	4:45	4:57	5:06	5:17	5:31	5:40	5:43
4:45	4:56	5:08	5:17	5:28	5:42	5:51	5:54
4:58	5:09	5:21	5:30	5:41	5:55	6:04	6:07
5:11	5:22	5:34	5:43	5:54	6:08	6:17	6:20
5:23	5:34	5:46	5:57	6:08	6:22	6:31	6:34
5:40	5:51	6:03	6:12	6:23	6:36	6:45	6:48
5:57	6:07	6:18	6:27	6:37	6:50	6:59	7:02
6:12	6:22	6:33	6:42	6:52	7:05	7:14	7:17
6:27	6:37	6:48	6:56	7:06	7:19	7:27	7:30
6:42	6:52	7:03	7:11	7:21	7:34	7:42	7:45
6:59	7:09	7:20	7:28	7:38	7:50	7:58	8:01

ONE-WAY FARES / Tarifas Sencillas

Exact fare, please / Favor de pagar la cantidad exacta	
Adult / Adulto	\$2.50
Senior/Disabled/Medicare* <i>Personas Mayores/con Discapacidades/Medicare*</i>	\$1.25
Youth (ages 6-18)* <i>Jóvenes (edades 6-18)*</i>	\$2.50

DAY PASS (Regional) / Pase diario (Regional)

Adult / Adulto	\$6.00
Senior/Disabled/Medicare* <i>Personas Mayores/con Discapacidades/Medicare*</i>	\$3.00
Youth (ages 6-18)* <i>Jóvenes (edades 6-18)*</i>	\$3.00

MONTHLY PASSES / Pases mensual

Adult / Adulto	\$72.00
Senior/Disabled/Medicare* <i>Personas Mayores/con Discapacidades/Medicare*</i>	\$23.00
Youth (ages 6-18)* <i>Jóvenes (edades 6-18)*</i>	\$23.00

*Proof of eligibility required. Senior Eligibility: Age 65+ or born on or before September 1, 1959.
*Se requiere verificación de elegibilidad. Elegibilidad para Personas Mayores: Edad 65+ o nacido en o antes del 1 de septiembre, 1959.

COMPASS CARDS / Tarjeta Compass
There is a \$2 charge for Compass Cards, which can be reloaded for future use.
Hay un costo de \$2 por la tarjeta Compass Card, la cual puede ser recargada para usos futuros.

COMPASS CLOUD
Download the free Compass Cloud app on your Apple or Android phone.
Descargue la aplicación gratis Compass Cloud en su teléfono Apple o Android.

Visit sdmts.com/fares for more info. Visite sdmts.com/fares para más información.

DIRECTORY / Directorio

MTS Information & Trip Planning <i>MTS Información y planeo de viaje</i>	511 <i>or/ó</i> (619) 233-3004
TTY/TDD (teletype for hearing impaired) <i>Teletipo para sordos</i>	(619) 234-5005 <i>or/ó</i> (888) 722-4889
InfoExpress (24-hour info via Touch-Tone phone) <i>Información las 24 horas (via teléfono de teclas)</i>	(619) 685-4900
Customer Service / Suggestions <i>Servicio al cliente / Sugerencias</i>	(619) 557-4555
MTS Security <i>MTS Seguridad</i>	(619) 595-4960
Lost & Found <i>Objetos extraviados</i>	(619) 557-4555
Transit Store	(619) 234-1060 12th & Imperial Transit Center M-F 8am-5pm

For MTS online trip planning
Planificación de viajes por Internet **sdmts.com**

For more information on riding MTS services, pick up a Rider's Guide on a bus or at the Transit Store, or visit sdmts.com.
Para obtener más información sobre el uso de los servicios de MTS, recoja un 'Rider's Guide' en un autobús o en la Transit Store, o visita a sdmts.com.

Thank you for riding MTS! ¡Gracias por viajar con MTS!



Euclid Transit Center – UTC
via I-15 Mid City / Kearny Mesa

DESTINATIONS

- Boulevard Transit Plaza
- City Heights Transit Plaza
- Market Creek Plaza
- Westfield UTC

TROLLEY CONNECTIONS
• Euclid Av.



09/19

sdmts.com

Route Alerts, Updated Schedules,
Connections & More



Alternative formats available upon request. Please call: (619) 557-4555 / Formato alternativo disponible al preguntar. Favor de llamar: (619) 557-4555

Route 60 – Monday through Friday / lunes a viernes

Euclid Transit Center ➔ City Heights ➔ Kearny Mesa ➔ University City

(A) Euclid Ave. Transit Center DEPART	(B) City Heights Transit Plaza (University Av.) *	(C) The Boulevard Transit Plaza (El Cajon Bl.) *	(D) Balboa Av. & Ruffin Rd.	(E) Clairemont Mesa Bl. & Shawline St.	(F) UTC Transit Center ARRIVE
5:04a	5:11a	5:13a	5:21a	5:31a	5:42a
5:34	5:42	5:44	5:52	6:02	6:15
5:49	5:57	5:59	6:07	6:17	6:30
6:04	6:13	6:15	6:24	6:35	6:50
6:19	6:29	6:31	6:41	6:52	7:09
6:34	6:45	6:47	6:58	7:09	7:26
7:04	7:15	7:17	7:30	7:42	7:59

University City ➔ Kearny Mesa ➔ City Heights ➔ Euclid Transit Center

(F) UTC Transit Center DEPART	(E) Clairemont Mesa Bl. & Shawline St.	(D) Balboa Av. & Ruffin Rd.	(C) The Boulevard Transit Plaza (El Cajon Bl.) *	(B) City Heights Transit Plaza (University Av.) *	(A) Euclid Ave. Transit Center ARRIVE
3:25p	3:42p	3:56p	4:06p	4:08p	4:21p
3:55	4:14	4:30	4:41	4:43	4:56
4:25	4:44	5:00	5:11	5:13	5:26
5:00	5:19	5:35	5:46	5:48	6:01
5:35	5:54	6:09	6:20	6:22	6:34
6:05	6:23	6:37	6:47	6:49	7:01

* Board Route 60 at off-ramp bus stops up at street level. / Tome la Ruta 60 en las paradas de autobús ubicadas en las rampas de salida a nivel de calle.

Route 60 does not operate on weekends or on the following holidays and observed holidays
La ruta 60 no ofrece servicio durante el fin de semana ó durante los siguientes días festivos y feriados observados



New Year's Day, Presidents' Day, Memorial Day, Independence Day,
Labor Day, Thanksgiving, Christmas

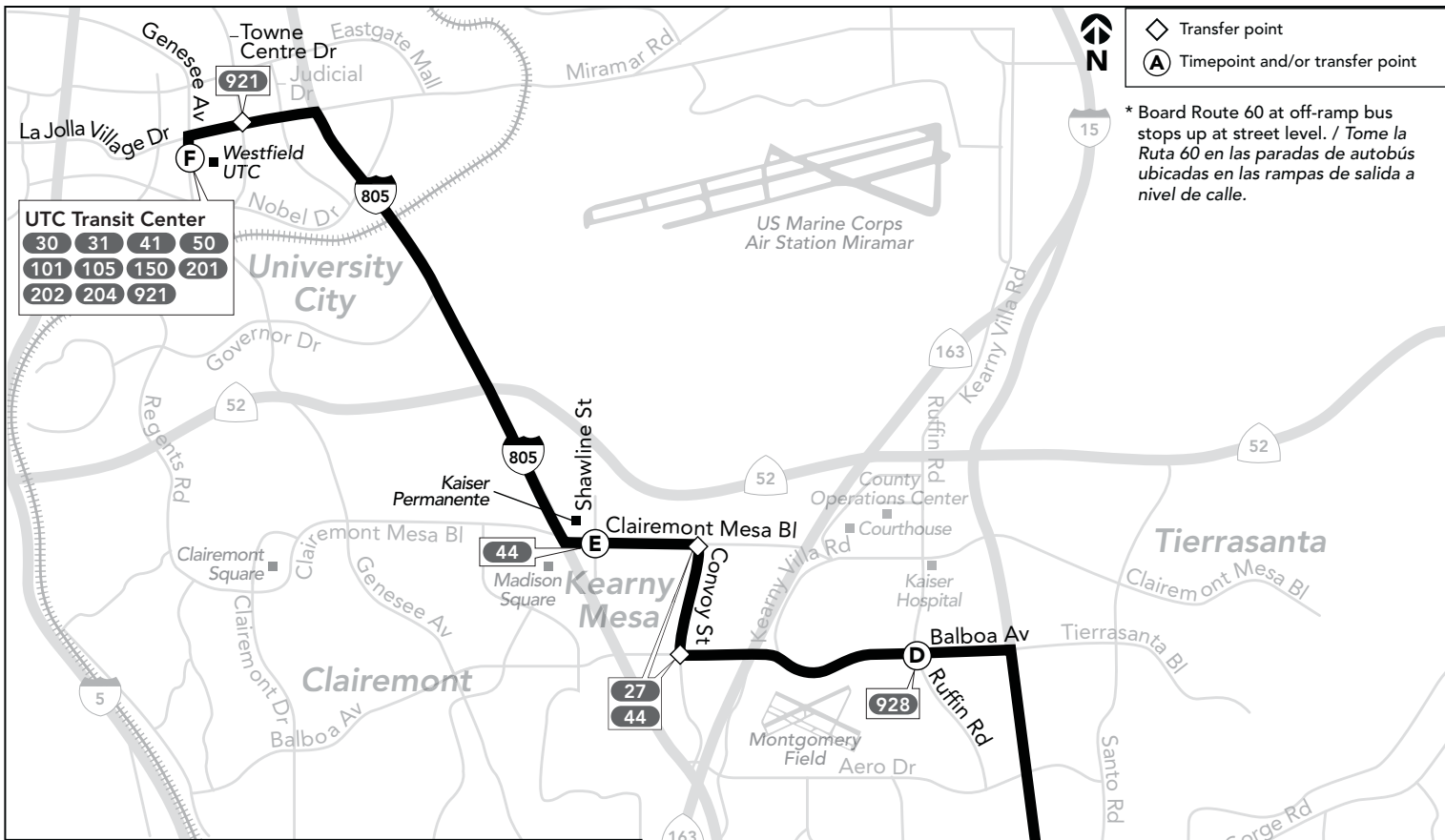

compass card

S/D/M and Youth Compass Card

All riders using reduced fares must comply with one of the following options:

Option 1 (Recommended by MTS) MTS offers a picture ID on a Compass Card to eliminate the need to carry multiple identifications for proof of eligibility.

Option 2
 Riders using a standard S/D/M or Youth Compass Card or a one-way ticket must carry supporting identification to prove eligibility.

For additional benefits of **Option 1** and or list of valid forms of ID for **Option 2** go to: sdmts.com/reduced-fares

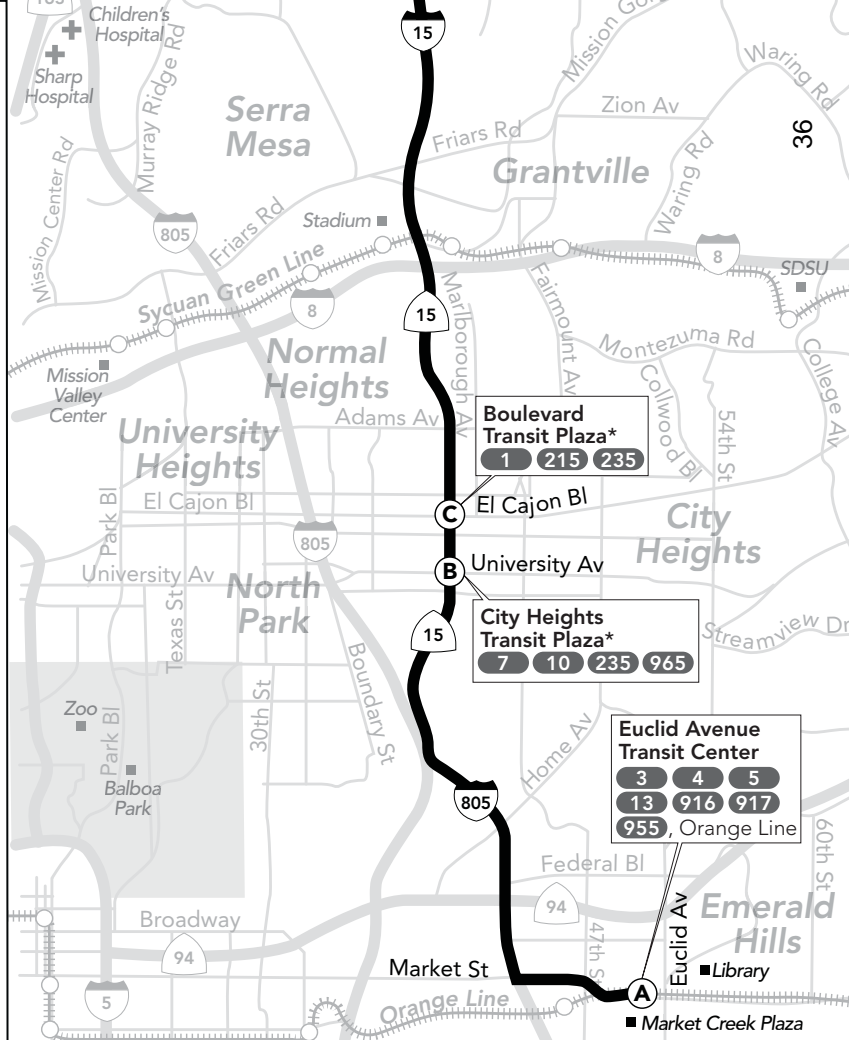

The schedules and other information shown in this timetable are subject to change. MTS does not assume responsibility for errors in timetables nor for any inconvenience caused by delayed buses. Los horarios e información que se indican en este itinerario están sujetos a cambios. MTS no asume responsabilidad por errores en los itinerarios, ni por ningún perjuicio que se origine por los autobuses demorados.

ONE-WAY FARES / Tarifas Simples

Exact fare, please / Favor de pagar la cantidad exacta	
Adult / Adulto	\$2.50
Senior/Disabled/Medicare* Personas Mayores/con Discapacidades/Medicare*	\$1.25
Youth (ages 6-18)* Jóvenes (edades 6-18)*	\$2.50

DAY PASS (Regional) / Pase diario (Regional)

Adult / Adulto	\$6.00
Senior/Disabled/Medicare* Personas Mayores/con Discapacidades/Medicare*	\$3.00
Youth (ages 6-18)* Jóvenes (edades 6-18)*	\$3.00

MONTHLY PASSES / Pases mensual

Adult / Adulto	\$72.00
Senior/Disabled/Medicare* Personas Mayores/con Discapacidades/Medicare*	\$23.00
Youth (ages 6-18)* Jóvenes (edades 6-18)*	\$23.00

*Proof of eligibility required. Senior Eligibility: Age 65+ or born on or before September 1, 1959.
*Se requiere verificación de elegibilidad. Elegibilidad para Personas Mayores: Edad 65+ o nacido o antes del 1 de septiembre, 1959.

COMPASS CARDS / Tarjeta Compass
There is a \$2 charge for Compass Cards, which can be reloaded for future use. Hay un costo de \$2 por la tarjeta Compass Card, la cual puede ser recargada para usos futuros.

COMPASS CLOUD
Download the free Compass Cloud app on your Apple or Android phone. Descargue la aplicación gratis Compass Cloud en su teléfono Apple o Android.

Visit sdmts.com/fares for more info. Visite sdmts.com/fares para más información.

DIRECTORY / Directorio

MTS Information & Trip Planning MTS Información y planeo de viaje	511 or/ó (619) 233-3004
TTY/TDD (teletype for hearing impaired) Teletipo para sordos	(619) 234-5005 or/ó (888) 722-4889
InfoExpress (24-hour info via Touch-Tone phone) Información las 24 horas (vía teléfono de teclas)	(619) 685-4900
Customer Service / Suggestions Servicio al cliente / Sugerencias	(619) 557-4555
MTS Security MTS Seguridad	(619) 595-4960
Lost & Found Objetos extraviados	(619) 557-4555
Transit Store 12th & Imperial Transit Center M-F 8am-5pm	(619) 234-1060

For MTS online trip planning
Planificación de viajes por Internet sdmts.com

For more information on riding MTS services, pick up a Rider's Guide on a bus or at the Transit Store, or visit sdmts.com.
Para obtener más información sobre el uso de los servicios de MTS, recoja un "Rider's Guide" en un autobús o en la Transit Store, o visita a sdmts.com.

Thank you for riding MTS! ¡Gracias por viajar con MTS!

Effective SEPTEMBER 1, 2019

Rapid
235

Escondido – Downtown San Diego
via I-15

DESTINATIONS

- Boulevard Transit Plaza
- City Heights Transit Plaza
- Del Lago Transit Station
- Kearny Mesa Transit Center
- Miramar College Transit Station
- Rancho Bernardo Transit Station
- Sabre Springs/Peñasquitos Transit Station

TROLLEY CONNECTIONS

- City College
- America Plaza
- Santa Fe Depot



sdmts.com

Route Alerts, Updated Schedules, Connections & More



Alternative formats available upon request. Please call: (619) 557-4555 / Formato alternativo disponible al preguntar. Favor de llamar: (619) 557-4555

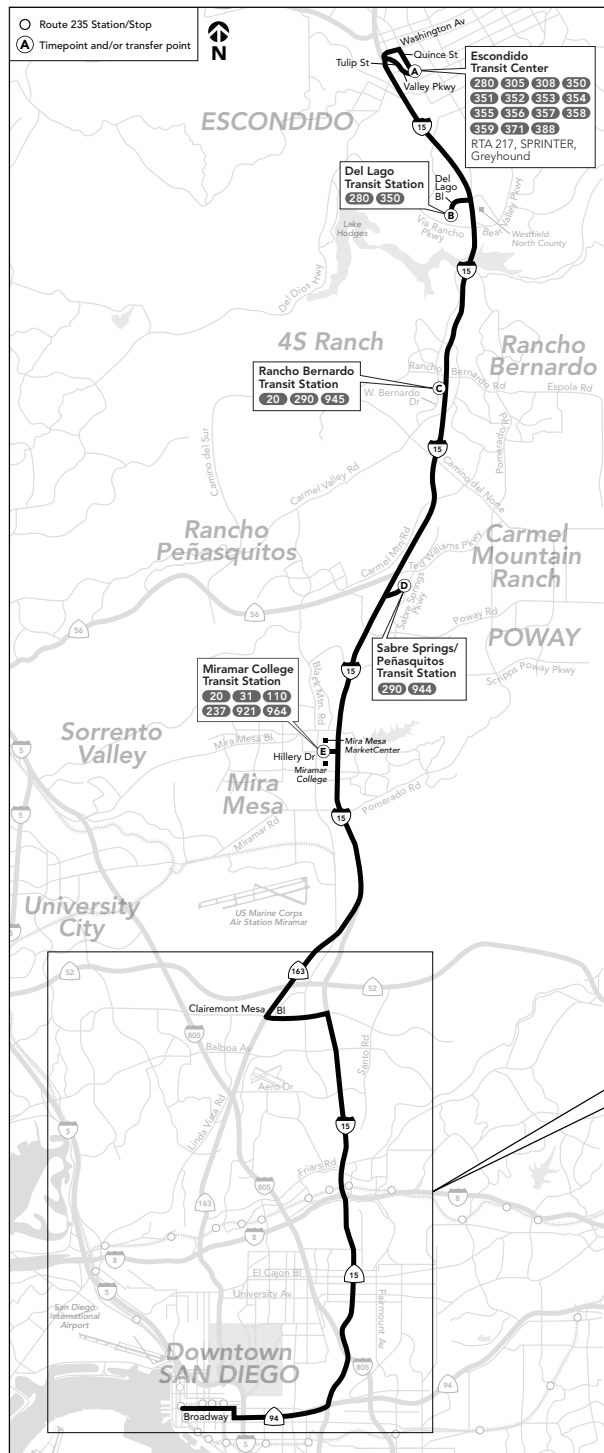

Your Transit Fare. Anytime. Anywhere.

COMPASS CLOUD
Free mobile ticketing app

- Day Passes; 30-day Passes
- Buy for your entire group on one phone.
- Your phone is your ticket.

sdmts.com/compass-cloud

Download on the App Store | GET IT ON Google Play

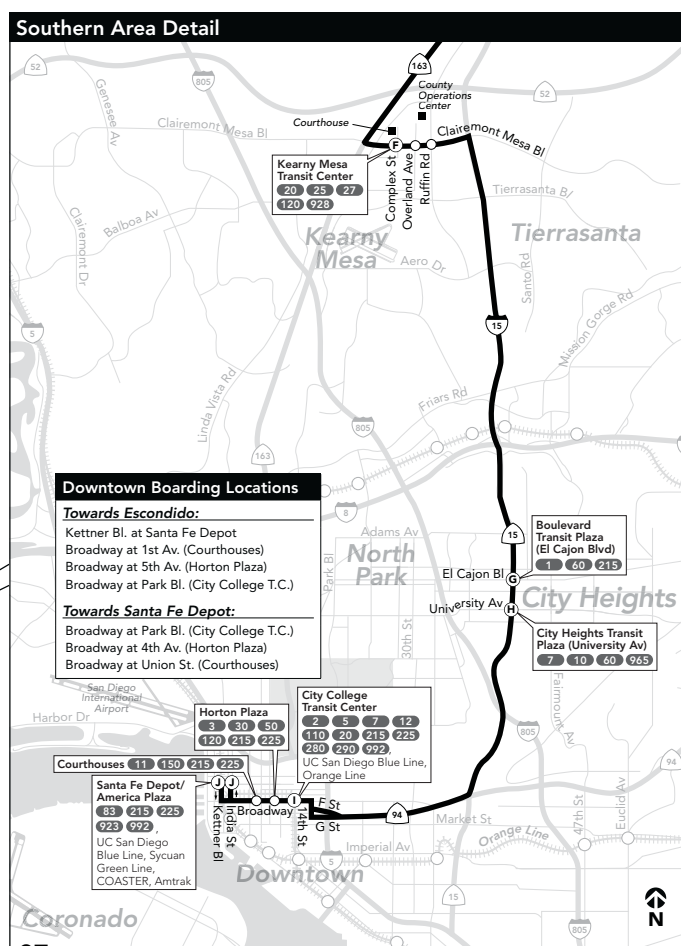

The schedules and other information shown in this timetable are subject to change. MTS does not assume responsibility for errors in timetables nor for any inconvenience caused by delayed buses.
Los horarios e información que se indican en este itinerario están sujetos a cambios. MTS no asume responsabilidad por errores en los itinerarios, ni por ningún perjuicio que se origine por los autobuses demorados.

Route 235 – Monday through Friday / lunes a viernes

Escondido ➡ Downtown San Diego

(A) Escondido Transit Center DEPART	(B) Del Lago Transit Station	(C) Rancho Bernardo Transit Station	(D) Sabre Springs/Peñasquitos T.S.	(E) Miramar College Transit Station	(F) Kearny Mesa Transit Center	(G) Boulevard Transit Plaza (El Cajon Bl.)	(H) City Heights Transit Plaza (Univ. Av.)	(I) City College Transit Station (Broadway)	(J) America Plaza Trolley Station ARRIVE
—	—	—	—	—	4:58a	5:08a	5:10a	5:19a	5:26a
—	—	—	—	—	5:13	5:23	5:25	5:34	5:41
5:00a	5:09a	5:17a	5:24a	5:18a	5:28	5:38	5:40	5:49	5:56
—	—	—	—	5:48	5:59	6:09	6:11	6:21	6:28
5:33	5:42	5:50	5:57	6:06	6:17	6:27	6:29	6:40	6:47
—	—	—	—	6:21	6:32	6:43	6:45	6:57	7:05
6:03	6:12	6:20	6:27	6:36	6:47	6:58	7:00	7:12	7:20
6:18	6:27	6:35	6:42	6:51	7:02	7:13	7:15	7:27	7:35
6:30	6:40	6:48	6:55	7:04	7:15	7:26	7:28	7:41	7:50
6:46	6:56	7:04	7:11	7:20	7:31	7:42	7:44	7:57	8:06
7:01	7:11	7:19	7:26	7:35	7:46	7:57	7:59	8:12	8:21
7:16	7:26	7:34	7:41	7:50	8:01	8:12	8:14	8:27	8:36
7:31	7:41	7:49	7:56	8:05	8:16	8:27	8:29	8:42	8:51
7:46	7:56	8:04	8:11	8:20	8:31	8:42	8:44	8:57	9:06
8:01	8:11	8:19	8:26	8:35	8:46	8:57	8:59	9:11	9:20
8:17	8:26	8:34	8:41	8:50	9:01	9:12	9:14	9:26	9:35
8:33	8:42	8:50	8:57	9:06	9:17	9:28	9:30	9:41	9:50
8:48	8:57	9:05	9:12	9:21	9:32	9:43	9:45	9:56	10:05
9:03	9:12	9:20	9:27	9:36	9:47	9:58	10:00	10:11	10:20
9:18	9:27	9:35	9:42	9:51	10:02	10:13	10:15	10:26	10:35
9:33	9:42	9:50	9:57	10:06	10:17	10:28	10:30	10:41	10:50
9:48	9:57	10:05	10:12	10:21	10:32	10:43	10:45	10:56	11:05
10:03	10:12	10:20	10:27	10:36	10:47	10:58	11:00	11:11	11:20
10:18	10:27	10:35	10:42	10:51	11:02	11:13	11:15	11:26	11:35
10:33	10:42	10:50	10:57	11:06	11:17	11:28	11:31	11:42	11:51
10:48	10:57	11:05	11:12	11:21	11:32	11:44	11:46	11:57	12:06p
11:03	11:12	11:20	11:27	11:36	11:47	11:59	12:01p	12:12p	12:21p
11:18	11:27	11:35	11:42	11:51	12:02p	12:14p	12:16	12:27	12:36
11:33	11:42	11:50	11:57	12:06p	12:17p	12:29p	12:31	12:42	12:51
11:48	11:57	12:05p	12:12p	12:21	12:32	12:44	12:46	12:57	1:06
12:03p	12:12p	12:20	12:27	12:36	12:47	12:59	1:01	1:12	1:21
12:19	12:28	12:36	12:43	12:52	1:03	1:15	1:17	1:28	1:37
12:34	12:43	12:51	12:58	1:07	1:18	1:30	1:32	1:43	1:52
12:49	12:58	1:06	1:13	1:22	1:33	1:45	1:47	1:58	2:07
1:03	1:12	1:20	1:27	1:36	1:47	1:59	2:01	2:12	2:21
1:18	1:27	1:35	1:42	1:51	2:02	2:14	2:16	2:27	2:36
1:33	1:42	1:50	1:57	2:06	2:17	2:29	2:31	2:42	2:51
1:47	1:56	2:04	2:11	2:20	2:31	2:43	2:45	2:56	3:05
2:00	2:09	2:17	2:24	2:33	2:44	2:56	2:58	3:09	3:18
2:13	2:22	2:30	2:37	2:46	2:57	3:09	3:11	3:22	3:31
2:28	2:37	2:45	2:52	3:01	3:12	3:25	3:27	3:39	3:48
2:42	2:52	3:00	3:07	3:16	3:28	3:42	3:44	3:57	4:06
2:55	3:05	3:13	3:20	3:29	3:41	3:56	3:58	4:12	4:21
3:10	3:20	3:28	3:35	3:44	3:56	4:11	4:13	4:27	4:36
3:23	3:33	3:41	3:48	3:57	4:10	4:26	4:28	4:43	4:52
3:39	3:49	3:57	4:04	4:13	4:26	4:42	4:44	4:59	5:08
3:54	4:04	4:12	4:19	4:28	4:41	4:58	5:00	5:15	5:24
4:09	4:19	4:27	4:34	4:43	4:56	5:13	5:15	5:30	5:39
4:24	4:34	4:42	4:49	4:58	5:11	5:28	5:30	5:45	5:54
4:39	4:49	4:57	5:04	5:13	5:26	5:43	5:45	6:00	6:09
4:54	5:04	5:12	5:19	5:28	5:41	5:58	6:00	6:15	6:23
5:10	5:20	5:28	5:35	5:44	5:57	6:12	6:14	6:29	6:37
5:27	5:37	5:45	5:52	6:01	6:13	6:27	6:29	6:43	6:51
5:45	5:54	6:02	6:09	6:18	6:29	6:42	6:44	6:57	7:05
6:02	6:11	6:19	6:26	6:35	6:46	6:58	7:00	7:11	7:19
6:17	6:26	6:34	6:41	6:50	7:01	7:13	7:15	7:26	7:34
6:32	6:41	6:49	6:56	7:05	7:16	7:28	7:30	7:41	7:49
6:47	6:56	7:04	7:11	7:20	7:31	7:43	7:45	7:56	8:04
7:06	7:15	7:23	7:30	7:39	7:49	8:00	8:02	8:12	8:20
7:36	7:45	7:53	8:00	8:09	8:19	8:30	8:32	8:42	8:50
8:05	8:14	8:22	8:29	8:38	8:48	8:59	9:01	9:11	9:19
8:35	8:44	8:52	8:59	9:08	9:18	9:29	9:31	9:40	9:47
9:05	9:14	9:22	9:29	9:38	9:48	9:59	10:01	10:10	10:17
9:35	9:44	9:52	9:59	10:08	10:18	10:29	10:31	10:40	10:47
10:05	10:14	10:22	10:29	10:38	10:48	10:58	11:00	11:09	11:16
10:35	10:44	10:52	10:59	11:08	11:18	11:28	11:30	11:39	11:46

Downtown San Diego ➡ Escondido

(J) Santa Fe Depot Transit Ctr. DEPART	(I) City College Transit Station (Broadway)	(H) City Heights Transit Plaza (Univ. Av.)	(G) Boulevard Transit Plaza (El Cajon Bl.)	(F) Kearny Mesa Transit Center	(E) Miramar College Transit Station	(D) Sabre Springs/Peñasquitos T.S.	(C) Rancho Bernardo Transit Station	(B) Del Lago Transit Station	(A) Escondido Transit Center ARRIVE
4:43a	4:50a	5:00a	5:02a	5:13a	5:24a	5:31a	5:39a	5:46a	5:57a
5:03	5:10	5:20	5:22	5:33	5:44	5:51	5:59	6:06	6:17
5:18	5:25	5:35	5:37	5:49	6:00	6:07	6:15	6:22	6:34
5:33	5:40	5:50	5:52	6:04	6:15	6:22	6:30	6:37	6:49
5:46	5:53	6:03	6:05	6:17	6:28	6:35	6:43	6:50	7:02
5:59	6:06	6:16	6:18	6:30	6:41	6:48	6:56	7:03	7:15
6:12	6:19	6:29	6:31	6:44	6:55	7:02	7:10	7:17	7:29
6:26	6:34	6:44	6:46	7:00	7:12	7:19	7:27	7:34	7:46
6:41	6:49	6:59	7:01	7:15	7:27	7:34	7:42	7:49	8:01
6:55	7:03	7:14	7:16	7:32	7:44	7:51	7:59	8:06	8:18
7:10	7:18	7:29	7:31	7:47	7:59	8:06	8:14	8:21	8:33
7:25	7:33	7:44	7:46	8:02	8:14	8:21	8:29	8:36	8:48
7:40	7:48	7:59	8:01	8:17	8:29	8:36	8:44	8:51	9:03
7:55	8:03	8:14	8:16	8:32	8:44	8:51	8:59	9:06	9:18
8:10	8:18	8:29	8:31	8:47	8:59	9:06	9:14	9:21	9:33
8:25	8:33	8:43	8:45	9:00	9:12	9:19	9:27	9:34	9:46
8:40	8:48	8:58	9:00	9:14	9:26	9:33	9:41	9:48	10:00
8:55	9:03	9:13	9:15	9:28	9:39	9:46	9:54	10:01	10:13
9:10	9:18	9:28	9:30	9:43	9:54	10:01	10:09	10:16	10:28
9:23	9:31	9:41	9:43	9:56	10:07	10:14	10:22	10:29	10:41
9:38	9:46	9:56	9:58	10:11	10:22	10:29	10:37	10:44	10:56
9:53	10:01	10:11	10:13	10:26	10:37	10:44	10:52	10:59	11:11
10:08	10:16	10:26	10:28	10:41	10:52	10:59	11:07	11:14	11:26
10:23	10:31	10:41	10:43	10:56	11:07	11:14	11:22	11:29	11:41
10:38	10:46	10:56	10:58	11:11	11:22	11:29	11:37	11:44	11:56
10:53	11:01	11:11	11:13	11:26	11:37	11:44	11:52	11:59	12:11p
11:08	11:16	11:26	11:28	11:41	11:52	11:59	12:07p	12:14p	12:26
11:23	11:31	11:41	11:43	11:56	12:07p	12:14p	12:22	12:29	12:41
11:38	11:46	11:56	11:58	12:11p	12:22	12:29	12:37	12:44	12:56
11:53	12:02p	12:12p	12:14p	12:27	12:38	12:45	12:53	1:00	1:12
12:08p	12:17	12:27	12:29	12:42	12:53	1:00	1:08	1:15	1:27
12:23	12:32	12:42	12:44	12:57	1:08	1:15	1:23	1:30	1:42
12:38	12:47	12:57	12:59	1:12	1:23	1:30	1:38	1:45	1:57
12:53	1:02	1:12	1:14	1:27	1:38	1:45	1:53	2:00	2:12
1:07	1:16	1:26	1:28	1:41	1:52	1:59	2:07	2:14	2:26
1:24	1:33	1:43	1:45	1:58	2:09	2:16	2:24	2:31	2:43
1:39	1:48	1:58	2:00	2:13	2:24	2:31	2:39	2:46	2:58
1:55	2:04	2:14	2:16	2:29	2:40	2:47	2:55	3:02	3:14
2:11	2:20	2:30	2:32	2:45	2:57	3:04	3:12	3:19	3:32
2:26	2:35	2:45	2:47	3:00	3:12	3:19	3:27	3:34	3:47
2:41	2:50	3:00	3:02	3:15	3:27	3:34	3:42	3:49	4:02
2:56	3:05	3:16	3:18	3:31	3:43	3:50	3:58	4:05	4:18
3:10	3:19	3:31	3:33	3:46	3:59	4:06	4:14	4:21	4:34
3:24	3:34	3:47	3:49	4:02	4:15	4:22	4:30	4:37	4:50
3:39	3:49	4:02	4:04	4:17	4:30	4:37	4:45	4:52	5:05
3:54	4:04	4:17	4:19	4:32	4:45	4:52	5:00	5:07	5:20
4:09	4:19	4:32	4:34	4:47	5:00	5:07	5:15	5:22	5:35
4:25	4:35	4:48	4:50	5:03	5:16	5:23	5:31	5:38	5:51
4:40	4:50	5:03	5:05	5:17	5:30	5:37	5:45	5:52	6:05
4:55	5:05	5:18	5:20	5:32	5:45	5:52	6:00	6:07	6:20
5:10	5:20	5:33	5:35	5:47	6:00	6:07	6:15	6:22	6:35
5:26	5:35	5:48	5:50	6:02	6:15	6:22	6:30	6:37	6:50
5:41	5:50	6:02	6:04	6:16	6:28	6:35	6:43	6:50	7:02
5:56	6:05	6:17	6:19	6:31	6:43	6:50	6:58	7:05	7:17
6:12	6:20	6:31	6:33	6:45	6:57	7:04	7:12	7:19	7:30
6:27	6:35	6:46	6:48	7:00	7:12	7:19			

965

City Heights Circulator

via I-15 & University / Azalea Pk. / Home Ave.

DESTINATIONS

- Azalea Park & Rec. Center
- City Heights Retail Village
- City Heights Transit Plaza



sdmts.com

Route Alerts, Updated Schedules,
Connections & More



COMPASS CASH

Load money onto your Compass Card.

Great for One-Ways.

Follow prompts on
machine to load value.

Just tap and ride!



Compass Service Center
(619) 595-5636
sdmts.com



CHANGING THE WAY
SAN DIEGO MOVES

The schedules and other information shown in this timetable are subject to change. MTS does not assume responsibility for errors in timetables nor for any inconvenience caused by delayed buses.
Los horarios e información que se indican en este itinerario están sujetos a cambios. MTS no asume responsabilidad por errores en los itinerarios, ni por ningún perjuicio que se origine por los autobuses demorados.

DIRECTORY / Directorio

MTS Information & Trip Planning MTS Información y planeo de viaje	511 or/ó (619) 233-3004
TTY/TDD (teletype for hearing impaired) Teletipo para sordos	(619) 234-5005 or/ó (888) 722-4889
InfoExpress (24-hour info via Touch-Tone phone) Información las 24 horas (via teléfono de teclas)	(619) 685-4900
Customer Service / Suggestions Servicio al cliente / Sugerencias	(619) 557-4555
MTS Security MTS Seguridad	(619) 595-4960
Lost & Found Objetos extraviados	(619) 557-4555
Transit Store	(619) 234-1060 12th & Imperial Transit Center M-F 8am-5pm

For MTS online trip planning
Planificación de viajes por Internet **sdmts.com**

For more information on riding MTS services, pick up a Rider's Guide on a bus or at the Transit Store, or visit **sdmts.com**.

*Para obtener más información sobre el uso de los servicios de MTS, recoja un 'Rider's Guide' en un autobús o en la Transit Store, o visita a **sdmts.com**.*

Thank you for riding MTS! ¡Gracias por viajar con MTS!

ONE-WAY FARES / Tarifas Sencillas

Exact fare, please / Favor de pagar la cantidad exacta

Adult / Adulto	\$2.50
Senior/Disabled/Medicare* Personas Mayores/con Discapacidades/Medicare*	\$1.25
Youth (ages 6-18)* Jóvenes (edades 6-18)*	\$2.50

DAY PASS (Regional) / Pase diario (Regional)

Adult / Adulto	\$6.00
Senior/Disabled/Medicare* Personas Mayores/con Discapacidades/Medicare*	\$3.00
Youth (ages 6-18)* Jóvenes (edades 6-18)*	\$3.00

MONTHLY PASSES / Pases mensual

Adult / Adulto	\$72.00
Senior/Disabled/Medicare* Personas Mayores/con Discapacidades/Medicare*	\$23.00
Youth (ages 6-18)* Jóvenes (edades 6-18)*	\$23.00

*Proof of eligibility required. Senior Eligibility: Age 65+ or born on or before September 1, 1959.
**Se requiere verificación de elegibilidad. Elegibilidad para Personas Mayores: Edad 65+ o nacido en o antes del 1 de septiembre, 1959.*

COMPASS CARDS / Tarjeta Compass

There is a \$2 charge for Compass Cards, which can be reloaded for future use.
Hay un costo de \$2 por la tarjeta Compass Card, la cual puede ser recargada para usos futuros.

COMPASS CLOUD

Download the free Compass Cloud app on your Apple or Android phone.
Descargue la aplicación gratis Compass Cloud en su teléfono Apple o Android.

Visit **sdmts.com/fares** for more info. *Visite **sdmts.com/fares** para más información.*

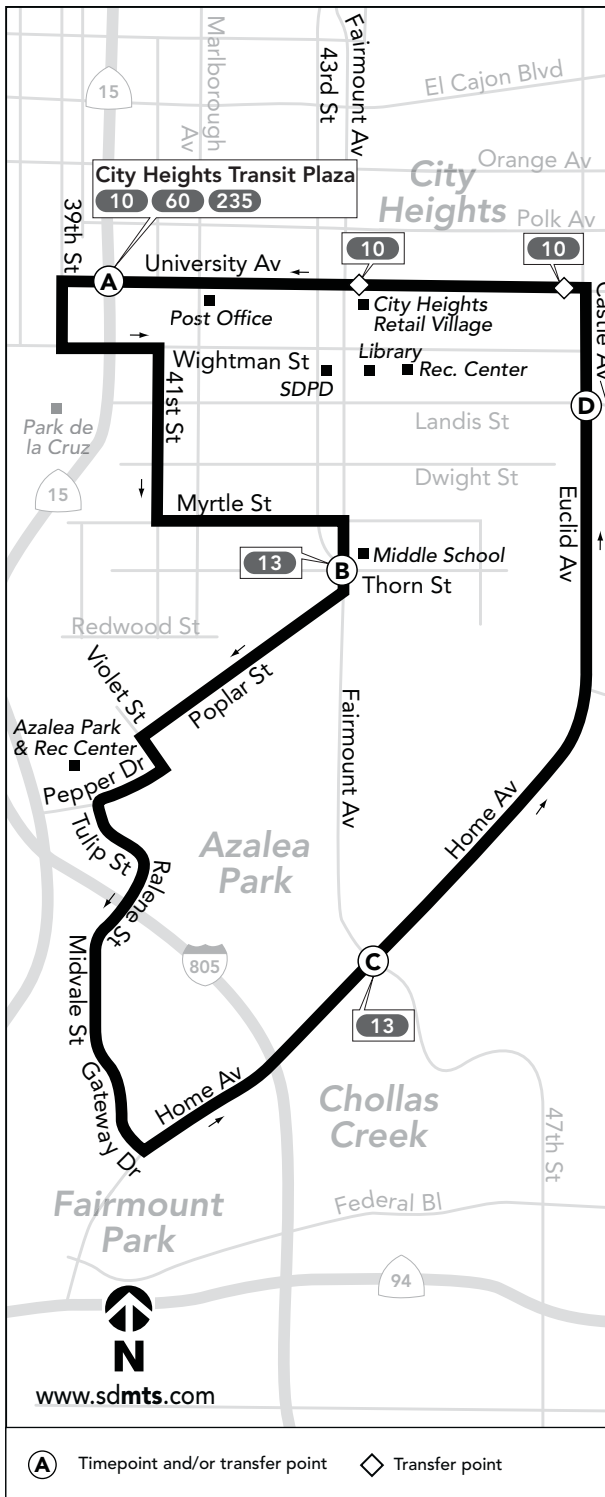

www.sdmts.com

(A) Timepoint and/or transfer point ◊ Transfer point

Route 965 Monday through Friday / lunes a viernes

Transit Plaza ➔ Azalea Park ➔ Home Avenue ➔ Transit Plaza

(A) City Heights Transit Plaza (Univ. Avenue westbound) DEPART	(B) Fairmount Avenue & Thorn Street	(C) Home Avenue & Fairmount Avenue	(D) Euclid Avenue & Castle Avenue	(A) City Heights Transit Plaza (Univ. Avenue westbound) ARRIVE
5:00a	5:06a	5:13a	5:17a	5:25a
5:35	5:41	5:48	5:52	6:00
6:10	6:16	6:24	6:28	6:37
6:45	6:52	7:00	7:05	7:14
7:20	7:27	7:35	7:40	7:49
7:55	8:02	8:10	8:14	8:22
8:30	8:37	8:45	8:49	8:57
9:05	9:12	9:20	9:24	9:32
9:40	9:47	9:55	9:59	10:07
10:15	10:22	10:30	10:34	10:42
10:50	10:57	11:05	11:09	11:17
11:25	11:32	11:40	11:44	11:52
12:00p	12:07p	12:15p	12:19p	12:27p
12:35	12:42	12:50	12:54	1:02
1:10	1:17	1:25	1:29	1:37
1:45	1:52	2:00	2:04	2:12
2:20	2:27	2:35	2:39	2:47
2:55	3:02	3:11	3:16	3:25
3:35	3:42	3:51	3:56	4:05
4:15	4:22	4:31	4:36	4:45
4:55	5:02	5:11	5:16	5:25
5:35	5:42	5:51	5:55	6:03
6:10	6:17	6:26	6:30	6:38
6:45	6:52	7:01	7:05	7:13
7:20	7:26	7:34	7:38	7:46
7:55	8:01	8:09	8:13	8:21
8:30	8:36	8:44	8:48	8:56

Route 965 Saturday* / sábado*

Transit Plaza ➔ Azalea Park ➔ Home Avenue ➔ Transit Plaza

(A) City Heights Transit Plaza (Univ. Avenue westbound) DEPART	(B) Fairmount Avenue & Thorn Street	(C) Home Avenue & Fairmount Avenue	(D) Euclid Avenue & Castle Avenue	(A) City Heights Transit Plaza (Univ. Avenue westbound) ARRIVE
7:00a	7:06a	7:13a	7:17a	7:25a
7:35	7:41	7:48	7:52	8:00
8:10	8:17	8:25	8:29	8:37
8:45	8:52	9:00	9:04	9:12
9:20	9:27	9:35	9:39	9:47
9:55	10:02	10:10	10:14	10:22
10:30	10:37	10:45	10:49	10:57
11:05	11:12	11:20	11:24	11:32
11:40	11:47	11:55	11:59	12:07p
12:15p	12:22p	12:30p	12:34p	12:42
12:50	12:57	1:05	1:09	1:17
1:25	1:32	1:40	1:44	1:52
2:00	2:07	2:15	2:19	2:27
2:35	2:42	2:50	2:54	3:02
3:10	3:17	3:25	3:29	3:37
3:45	3:52	4:00	4:04	4:12
4:20	4:27	4:35	4:39	4:47
4:55	5:02	5:10	5:14	5:22
5:30	5:37	5:45	5:49	5:57
6:05	6:12	6:20	6:24	6:32
6:40	6:46	6:53	6:57	7:05
7:15	7:21	7:28	7:32	7:40

Route 965 Sunday* / domingo*

Route 965 does not operate on Sunday. Alternative Sunday service may include Route 13.
Ruta 965 no opera los domingos. Servicio alternativo de domingo puede incluir la ruta 13.

A Saturday or Sunday schedule will be operated on the following holidays and observed holidays
Se operará con horario de sábado o domingo durante los siguientes días festivos y feriados observados

>>>

New Year's Day, Presidents' Day, Memorial Day, Independence Day, Labor Day, Thanksgiving, Christmas

S/D/M and Youth Compass Card

All riders using reduced fares must comply with one of the following options:

Option 1 (Recommended by MTS)

MTS offers a picture ID on a Compass Card to eliminate the need to carry multiple identifications for proof of eligibility.

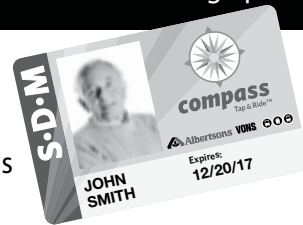

compass card

Option 2

Riders using a standard S/D/M or Youth Compass Card or a one-way ticket must carry supporting identification to prove eligibility.

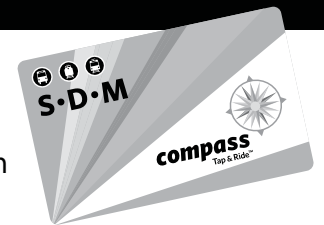

For additional benefits of **Option 1** and/or list of valid forms of ID for **Option 2** go to: sdmts.com/reduced-fares

ATTACHMENT E

Excerpt from City of San Diego Mid-City Community Plan



Mid-City Communities Plan

FINAL

AUGUST 4, 1998

- Provide direct pedestrian access from sidewalks to storefronts and residential units where feasible.
- Provide a pedestrian orientation in commercial areas with storefronts and display windows close to sidewalk.
- To the extent possible, encourage implementation of traffic calming programs to reduce vehicle speeds through residential neighborhoods.
- Systematically upgrade deteriorating sidewalks, curbs, and gutters.
- Historic scoring patterns and ID stamps should be retained or duplicated when sidewalks are replaced.

BICYCLE SYSTEM

The existing and proposed bicycle system within the Mid-City Community Plan area is shown in **Figure 29**.

The City has three classifications of bikeways.

The bikeway types and bicycle facilities classifications are shown in **Appendix B**. The pedestrian/bikeway bridge over SR-15 at Monroe Avenue should be a minimum of 12 feet wide.

**Figure 29
Bikeways**

