

Planning Department
**King-Chavez Primary Charter
School Joint Use Facility General
Development Plan**

Park and Recreation Board
July 18, 2019

Action Item 101

Introduction

Play All Day Parks Program

- New initiative put forth by Mayor Kevin Faulconer and Superintendent Cindy Marten in 2016
- Over 45 new joint use facilities in the next 5-10 years.

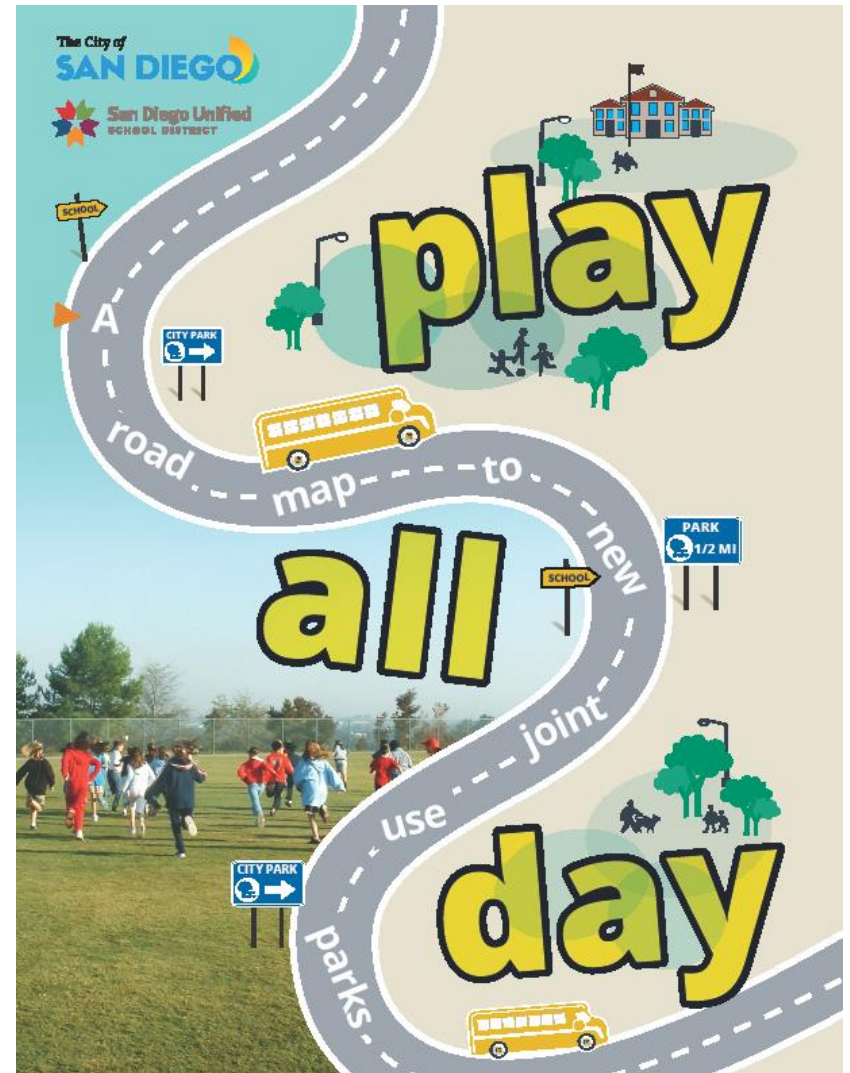

Background

King-Chavez Primary Charter School

This project provides for the design and construction of an upgraded joint use facility at King-Chavez Primary Charter School.

Located at 415 31st Street within the Southeastern Community, Council District 8.

Will provide approx. 2.5 acres of population based park land.

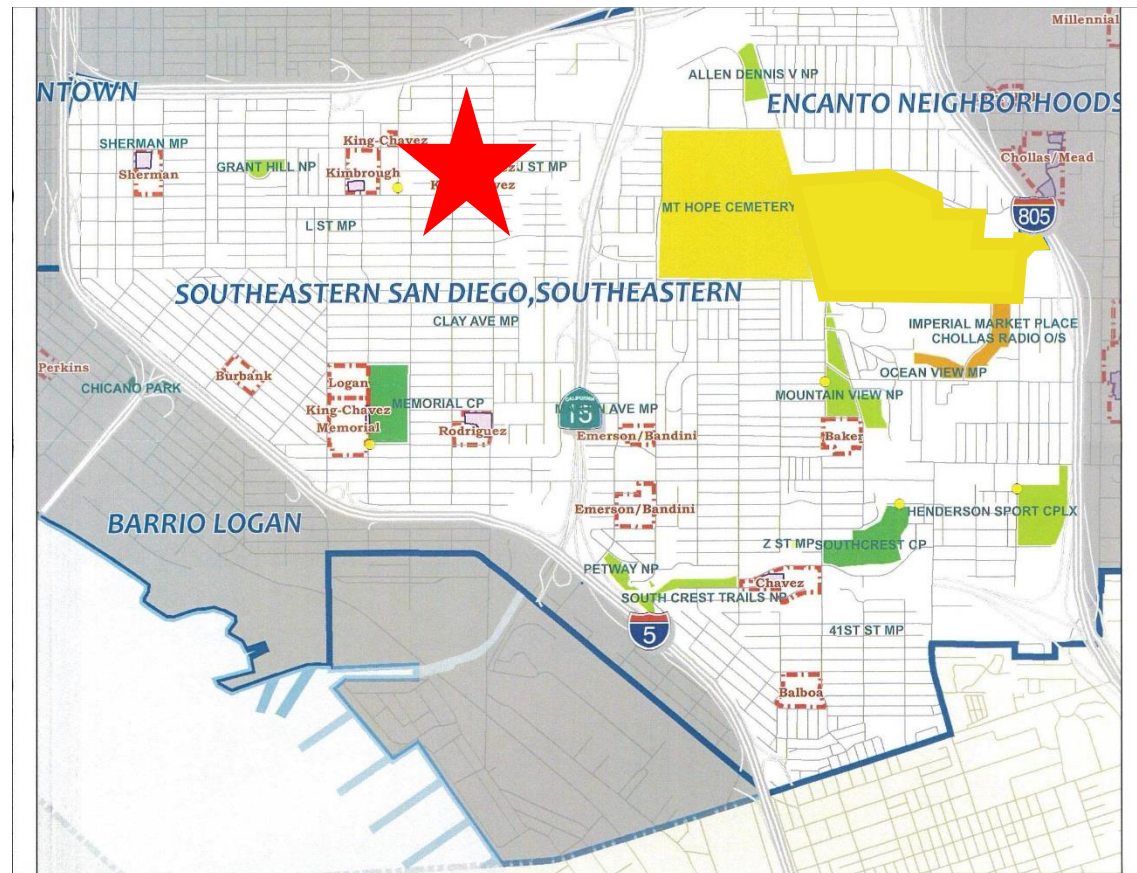

Project Scope

Design and construction of a multi-purpose synthetic turf field, walking track, play equipment, hardcourts, drinking fountain, fencing and trees.

Funding for Design and Construction:

San Diego Unified School District various Capital Improvement Bond Program measures.

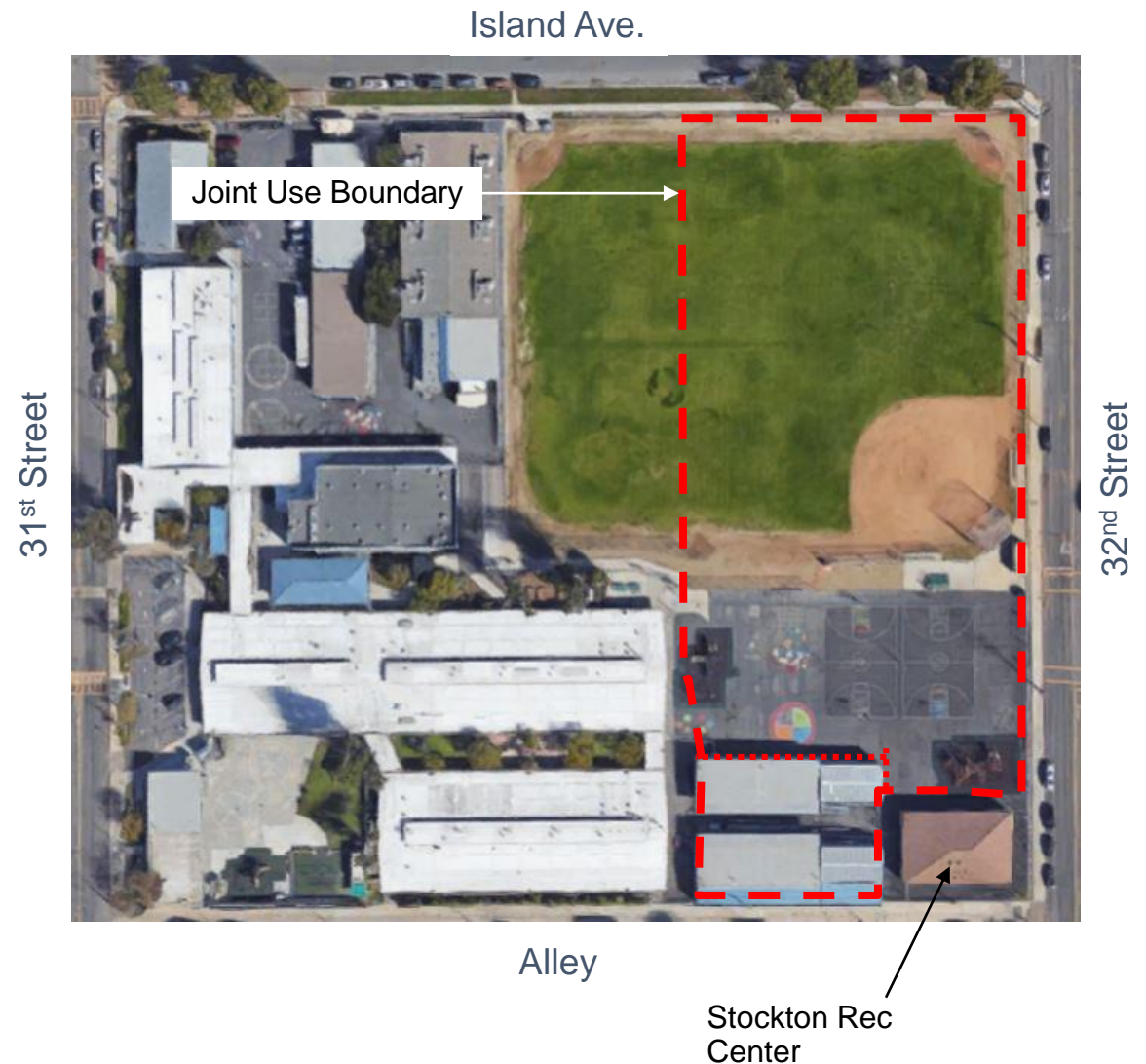

Site Location, Aerial Map

Discussion

Community Concerns

- Field closures
- Stockton Recreation Center operations
- Maintenance of street frontage landscaping
- Fencing between the field and play area
- Synthetic turf

Recreation Council Recommendation

On May 28, 2019 the Stockton Recreation Advisory Group voted (4-0-0) to recommend approval of the General Development Plan for King-Chavez Primary Charter School Joint Use Facility.

General Development Plan



LEGEND

- 1. Synthetic Turf Soccer Field
- 2. Synthetic Track
- 3. Pedestrian Access Gate, Typ.
- 4. Access Gate to School Campus
- 5. Pedestrian Access Gate to Recreation Center
- 6. 10' High Fence, Typ. at perimeter of Joint Use Area
- 7. 10' Ball Stop Fence between field and Play area
- 8. Shade Tree, Typ.
- 9. Bench, Typ.
- 10. 5-12 Playground
- 11. Hardcourt Striping, Colored Asphalt
- 12. Basketball Courts
- 13. Existing Recreation Center
- 14. Existing Drinking Fountains
- 15. Street Parking
- 16. Existing 24' Wide Gate

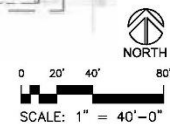



Draft Joint Use Tree List



DRAFT TREE LIST FOR SD UNIFIED JOINT USE PARKS Updated 3/1/19

Arbutus unedo 'Marina'	Strawberry Tree
Brachychiton species	Flame Tree
Cercidium x 'Desert Museum'	Thornless Palo Verde
Chilopsis linearis	Desert Willow
Corymbia ficifolia (Eucalyptus ficifolia)	Red Flowering Gum
Geijera parviflora	Australian Willow
Koelreuteria bipinnata	Chinese Flame Tree
Lagerstroemia indica x fauriei	Crape Myrtle (mildew resistant varieties)
Lophostemon confertus (Tristania conferta)	Brisbane Box
Magnolia grandiflora 'Little Gem' or 'St. Mary'	Dwarf Southern Magnolia
Metrosideros excelsa	New Zealand Christmas Tree
Olea europaea (fruitless varieties)	Fruitless Olive
Pinus canariensis	Canary Island Pine
Pistacia chinensis	Pistache
Podocarpus gracilior	Fern Pine
Quercus agrifolia	Coast Live Oak
Quercus engelmannii	Engelmann Oak
Tipuana tipu	Tipuana
Ulmus parvifolia	Chinese Evergreen Elm
Umbellularia californica	California Bay



Recommendation

Recommend approval of the proposed General Development Plan (GDP) for the King-Chavez Primary Charter School Joint Use Facility

Field Closures

Island Ave.

31st Street



Portion of Field Closed
September 2019

Remainder of
Field and
Hardcourts
Closed June
2021

32nd Street

New field will be
open to the public
Spring 2022