

Planning Department

Lafayette Elementary School Joint Use Facility General Development Plan

Park and Recreation Board

July 18, 2019

Action Item 105

Introduction

Play All Day Parks Program

- New initiative put forth by Mayor Kevin Faulconer and Superintendent Cindy Marten in 2016
- Over 45 new joint use facilities in the next 5-10 years.

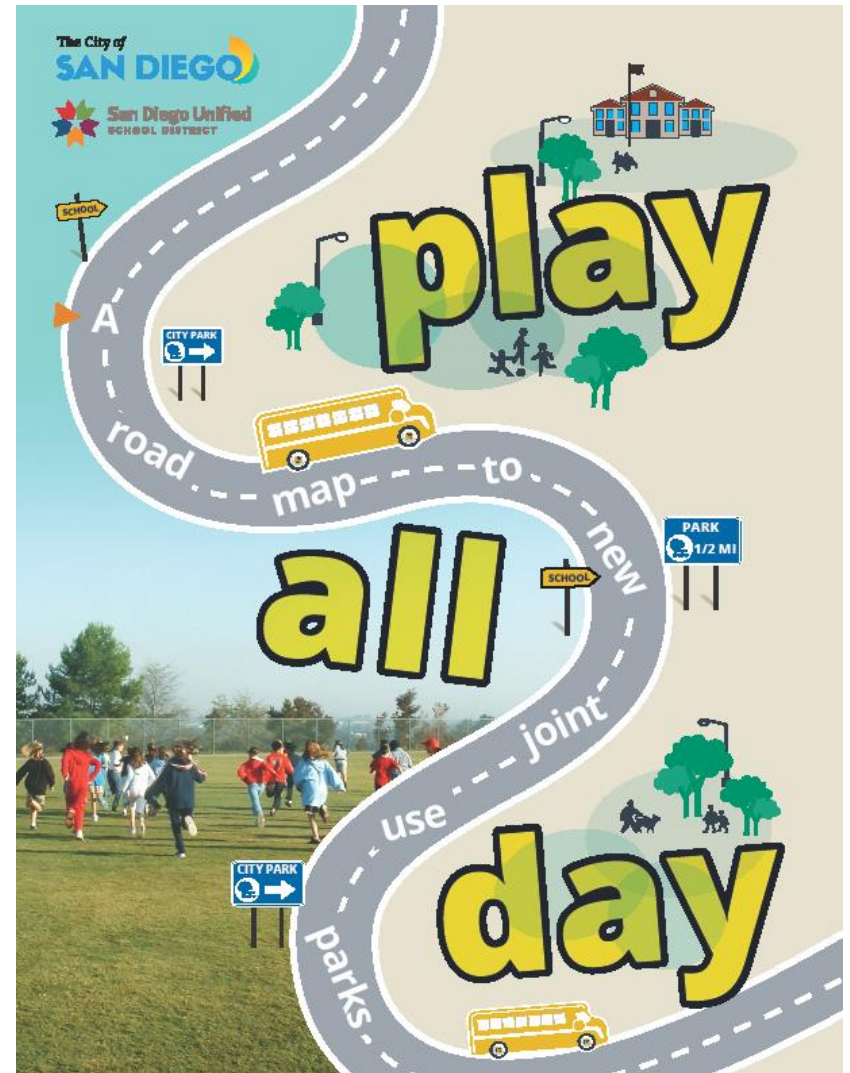



Background

Lafayette Elementary School

This project provides for the design and construction of a new joint use facility at Lafayette Elementary School.

Located at 6125 Printwood Way within the Clairemont Community, Council District 6.

Will provide approx. 4.95 acres of population based park land.

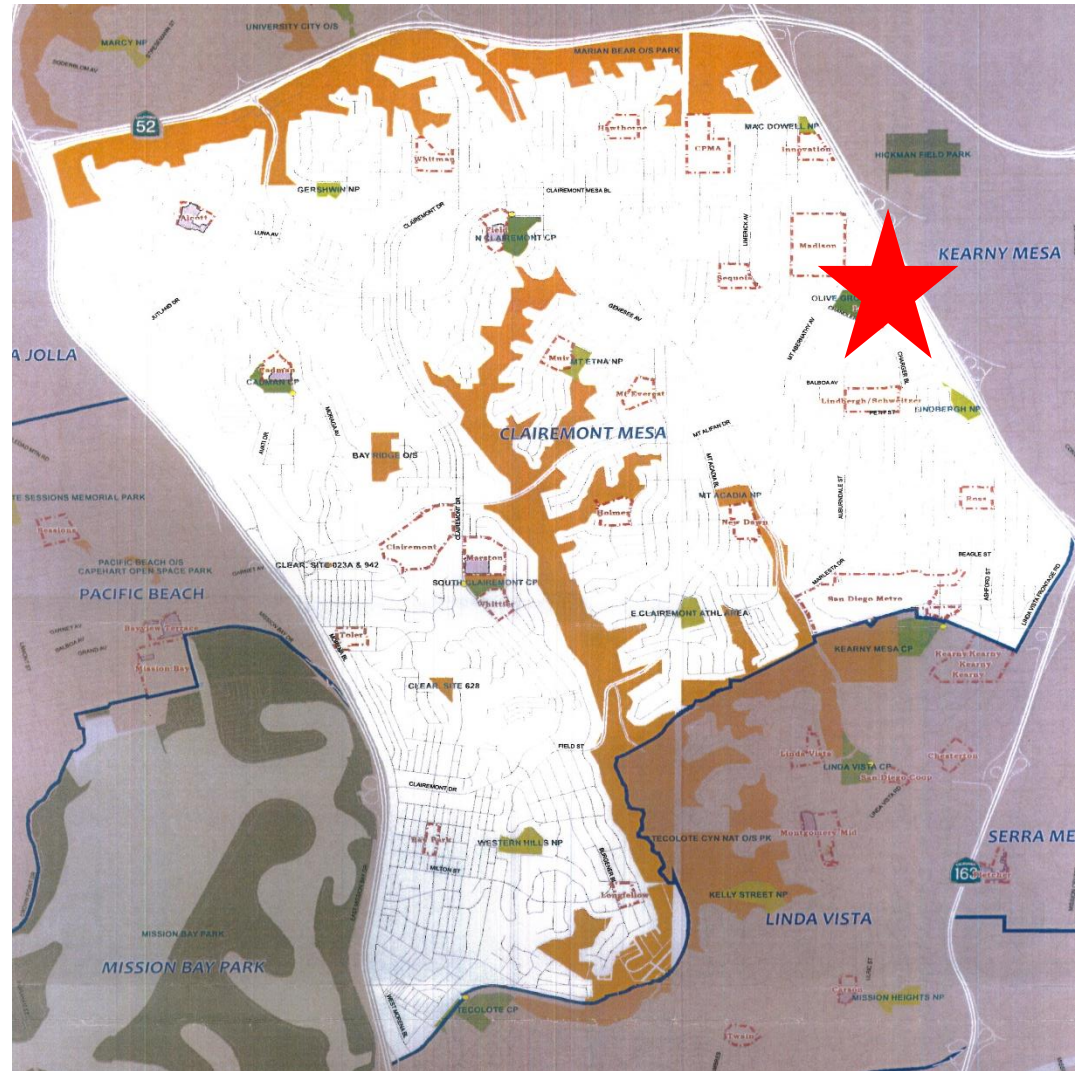

Project Scope

Design and construction of a multi-purpose natural turf field, walking track, drinking fountain, fencing and trees.

Funding for Design and Construction:

San Diego Unified School District various Capital Improvement Bond Program measures.





Discussion

Community Concerns

- Security and surveillance
- Access to Olive Grove Community Park
- Off-leash dogs

Recreation Council Recommendation

On May 15, 2019 the North Clairemont Recreation Advisory Group voted (3-0-1) to recommend approval of the General Development Plan for Lafayette Elementary School Joint Use Facility.

General Development Plan

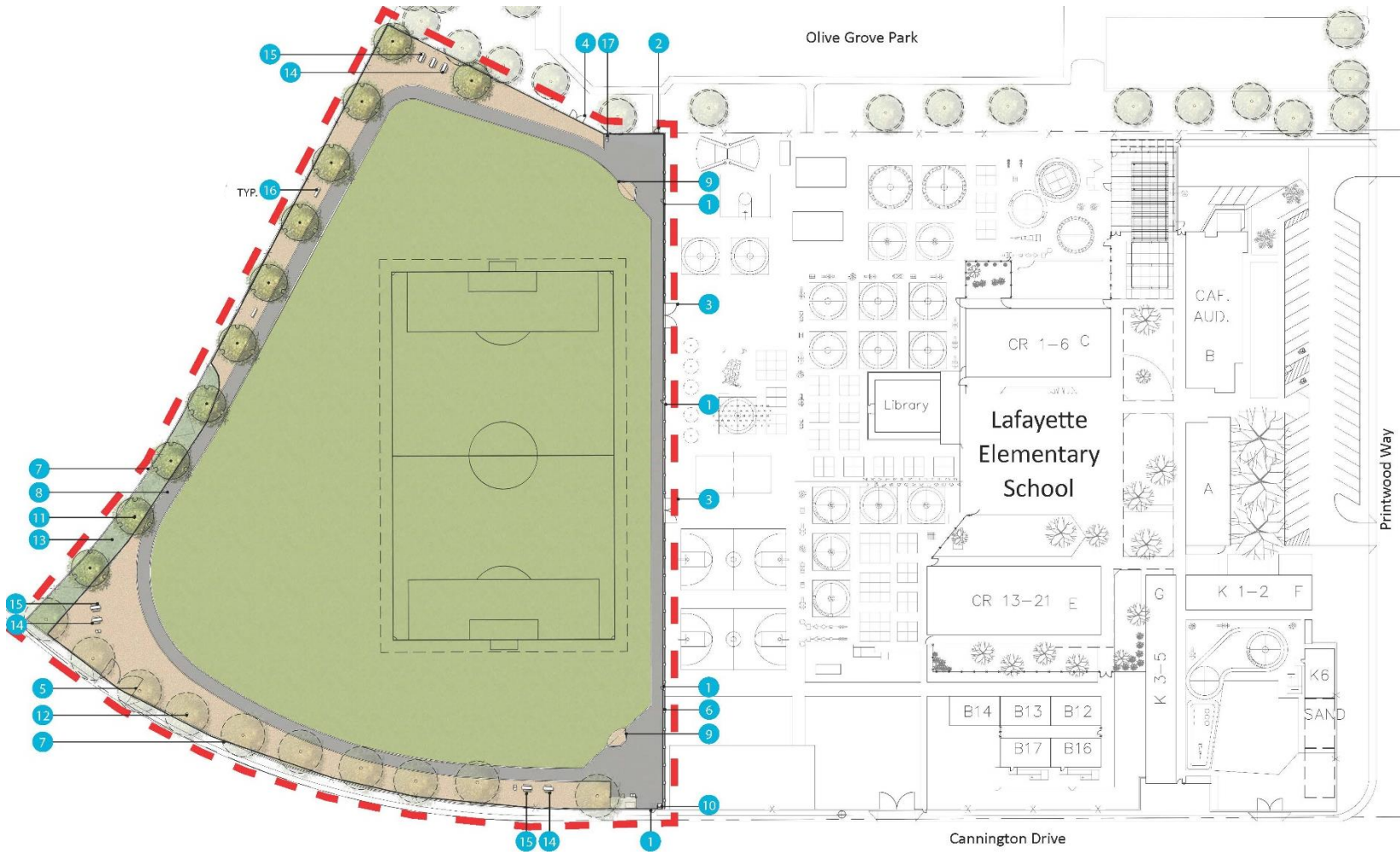

Concept Plant Schedule:



Legend:

- 1 Pedestrian Access Gate
- 2 4' Wide Pedestrian Gate
- 3 20'-0" Pedestrian Security Gate
- 4 12' Wide Double Maintenance Gate
- 5 Existing Maintenance Gate
- 6 10'-0" Chainlink Security Fence
- 7 Existing 10'-0" Chainlink Fence to Remain
- 8 10'-0" Asphalt Track
- 9 Backstop
- 10 Accessible Drinking Fountain with Guardrails
- 11 Shade Tree
- 12 Existing *Pinus Canariensis*
- 13 Planted Slope for Erosion
- 14 ADA Picnic Table
- 15 Picnic Table
- 16 Bench
- 17 Trash & Recycling Receptacles

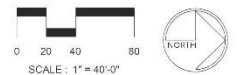



Recommendation

Recommend approval of the proposed General Development Plan (GDP) for the Lafayette Elementary School Joint Use Facility