

# University Avenue Mobility Study

prepared for



October 11, 2011



DAVID EVANS  
AND ASSOCIATES, INC.

**Darnell & ASSOCIATES, INC.**  
TRANSPORTATION PLANNING & TRAFFIC ENGINEERING





# Outline



- Introduction
- Working Group
- Project Process
- Design Criteria
- Review of Preferred Option
- Landscape Concepts
- Conclusion



# Project Goals

## Improve Mobility within the Corridor

- Pedestrians
- Bicycles
- Transit
- Vehicles





# Working Group Introduction



- Laura Riebau – EACPC
- Jody Talbott – CNF
- Betty White – RPCC
- Lee Rittiner – RPCC/EAPAC
- Jeannette Maxwell – Crossroads PAC BOD
- Jim Stone – Walk San Diego
- Jennifer Finnegan – College Area BID
- Anna Orzei-Arnita – Redwood Village CC
- Jim Bartell – Northgate Markets
- Mario Ingrassi – Crossroads PAC
- Randy VanVleck - CHCDC
- Samantha Ollinger – San Diego County Bicycle Coalition



# Overview



- **Working Group – March 2011 to June 2011**
- **Walk Audits – March 10 and March 12, 2011**
- **Community Workshop #1 – April 2011**
- **Community Workshop #2 - May 2011**
- **Community Workshop #3 – July 2011**
- **Eastern Area Planning Group – October 2011**



# Community Workshop #3



- Wider Sidewalks
- Complete Sidewalks
- Raised Medians
- Street Parking
- Bike Lanes
- Landscaping (Improvement District)



# Community Workshop #3



- Raised Medians vs Center Turn Lanes
- Curb PopOuts vs Raised Medians
- Landscaping and other Custom Improvements (Improvement District to fund)



# Engineering Study



- Traffic forecasts for 2030
- Capacity Analysis
- 4 Lane Major Street
- Inventory of Existing Conditions
- ADA Upgrades
- Traffic Signal Upgrades
- Preliminary Designs





# 54<sup>th</sup> Street to 58<sup>th</sup> Street

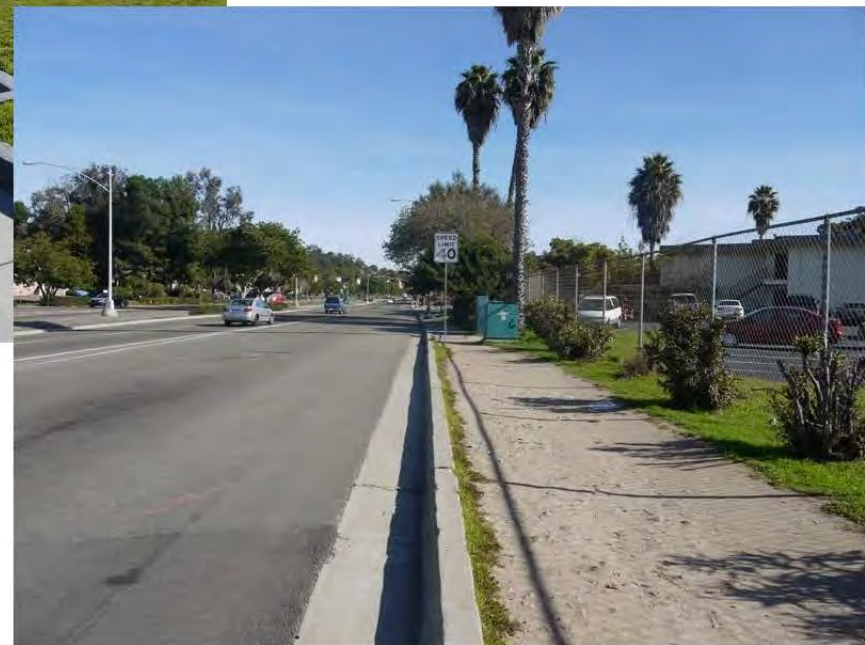
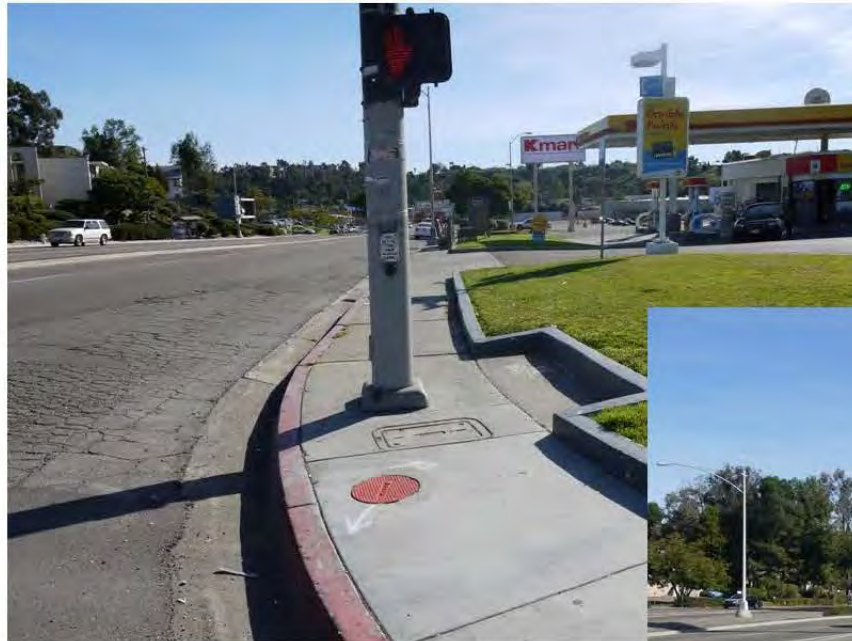



# 54<sup>th</sup> Street to 58<sup>th</sup> Street

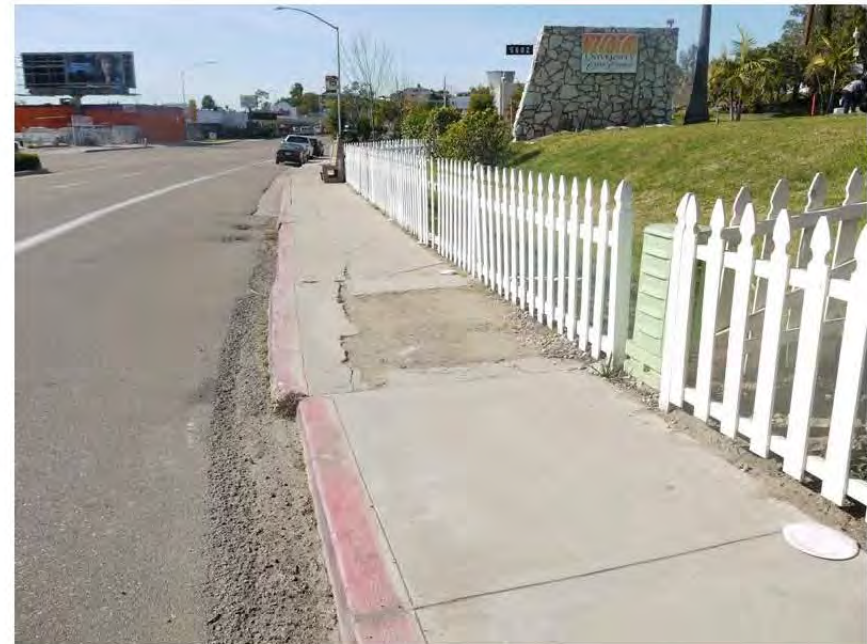



# 58<sup>th</sup> Street to 60<sup>th</sup> Street

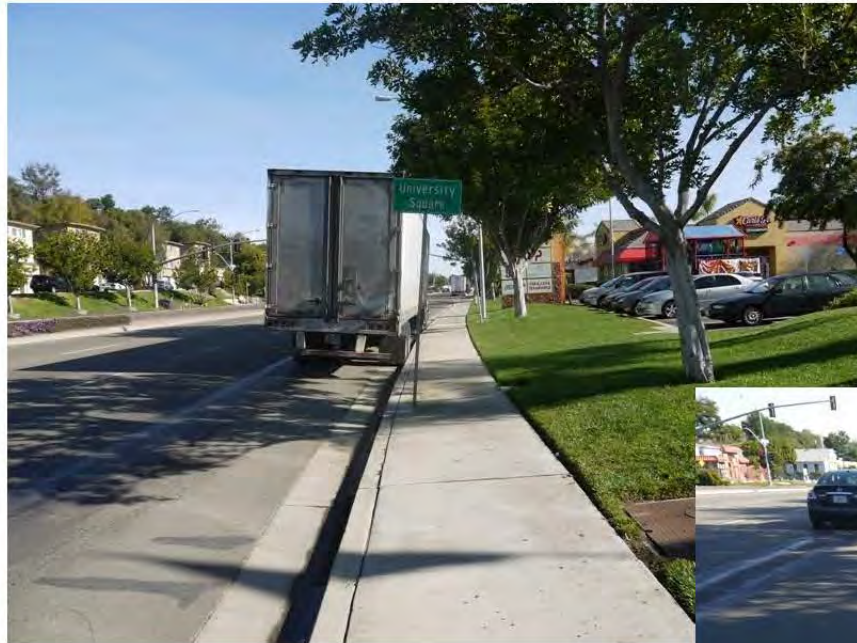



# College Avenue to Aragon Drive





# Aragon Drive to 68<sup>th</sup> Street





# 54<sup>th</sup> Street – Free Right Turns





# 54<sup>th</sup> and University Avenue

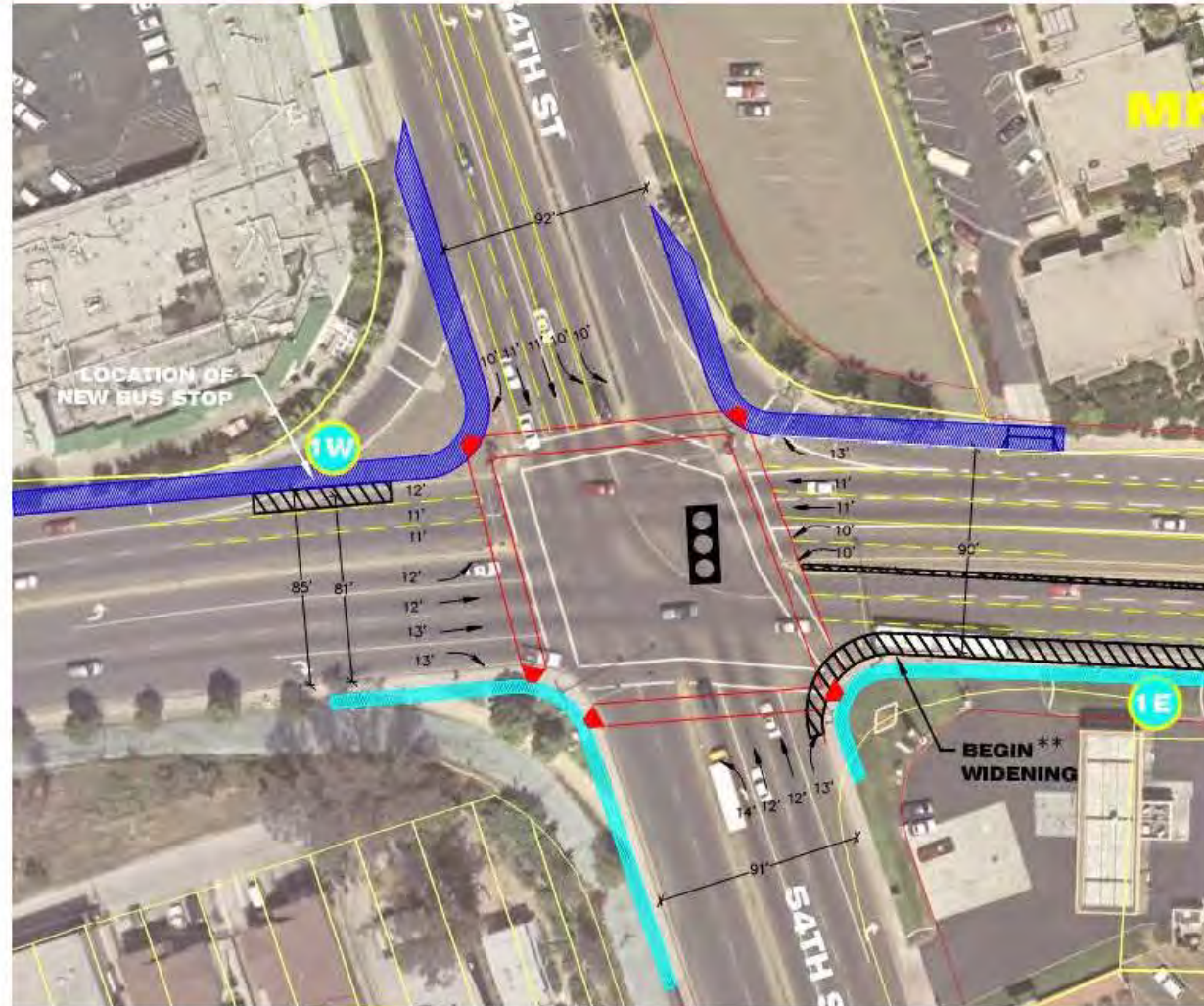



# Realign Chollas Parkway Intersection

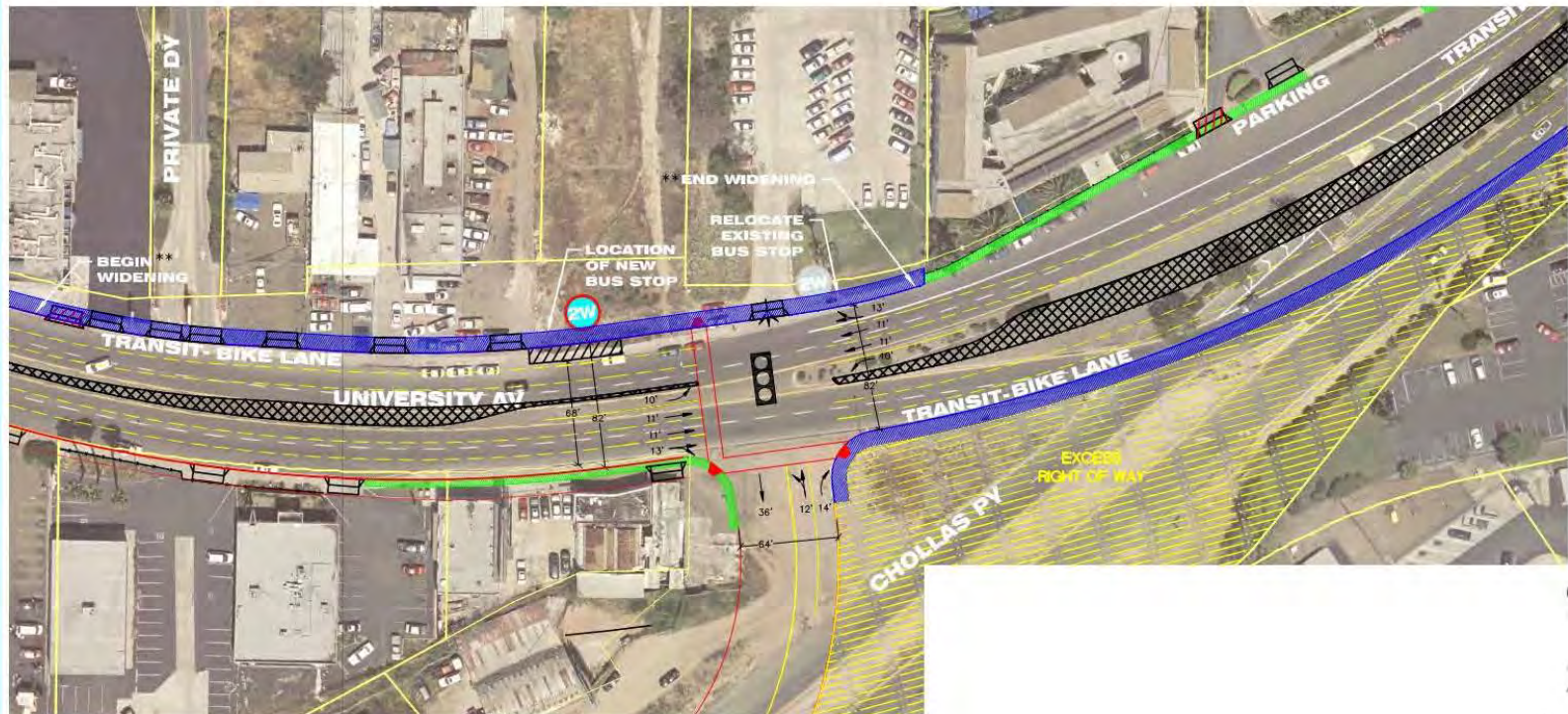





# 54<sup>th</sup> Street to 58<sup>th</sup> Street





# 54<sup>th</sup> Street to 58<sup>th</sup> Street

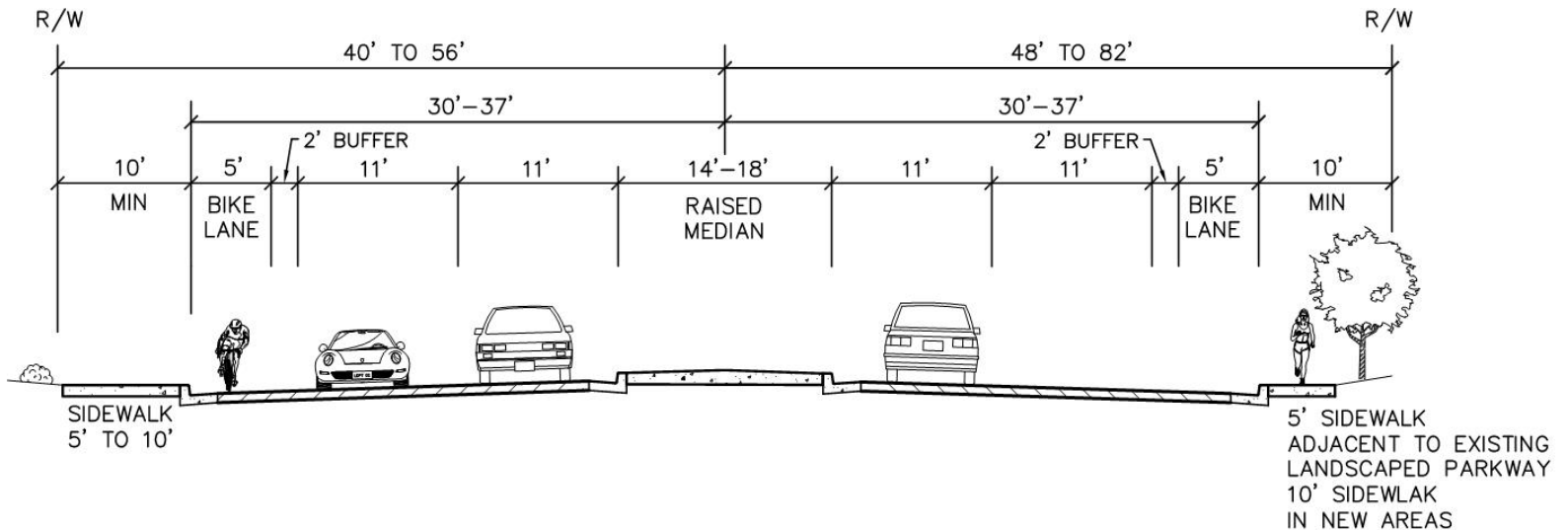

## Preferred Option



# Buffered Bike Lane





# 58<sup>th</sup> Street to College Avenue

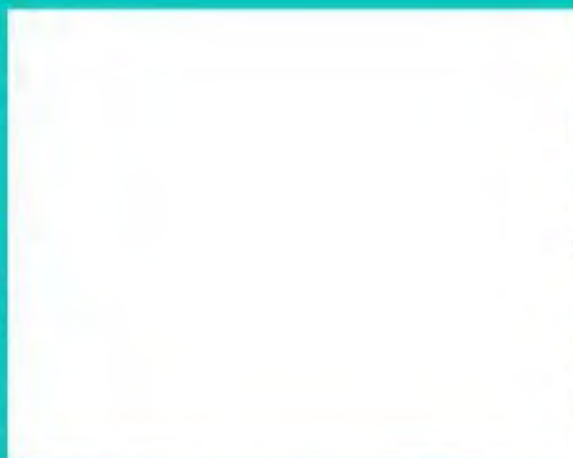



# 58<sup>th</sup> Street to College Avenue

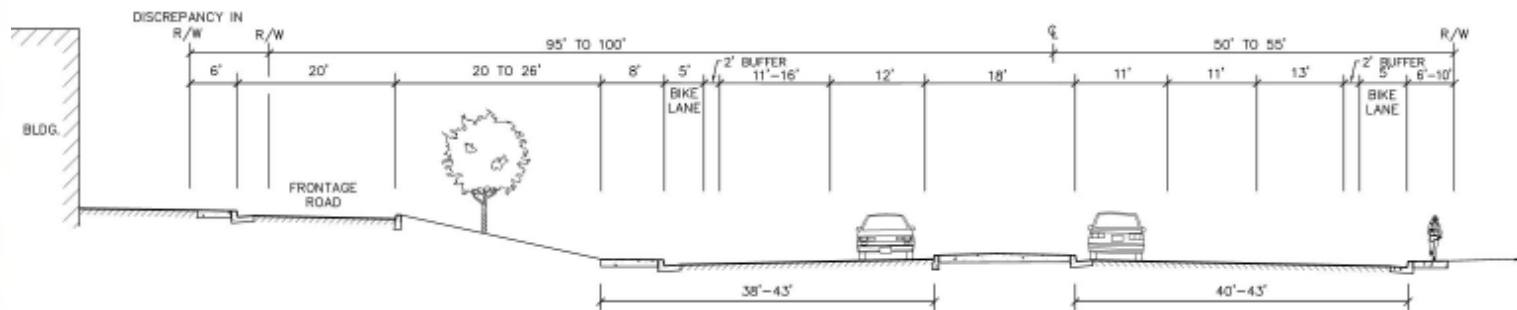

## Preferred Option



# University Square – Preferred Option





# College Avenue to Aragon





# College Avenue to Aragon Drive

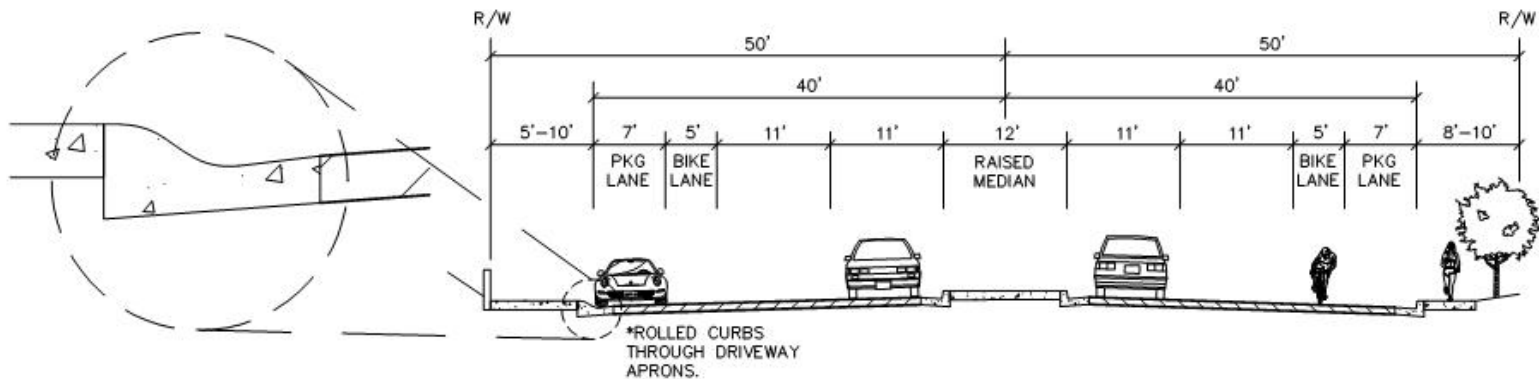

## Preferred Option





# Rolando





# Rolando - Other Considerations

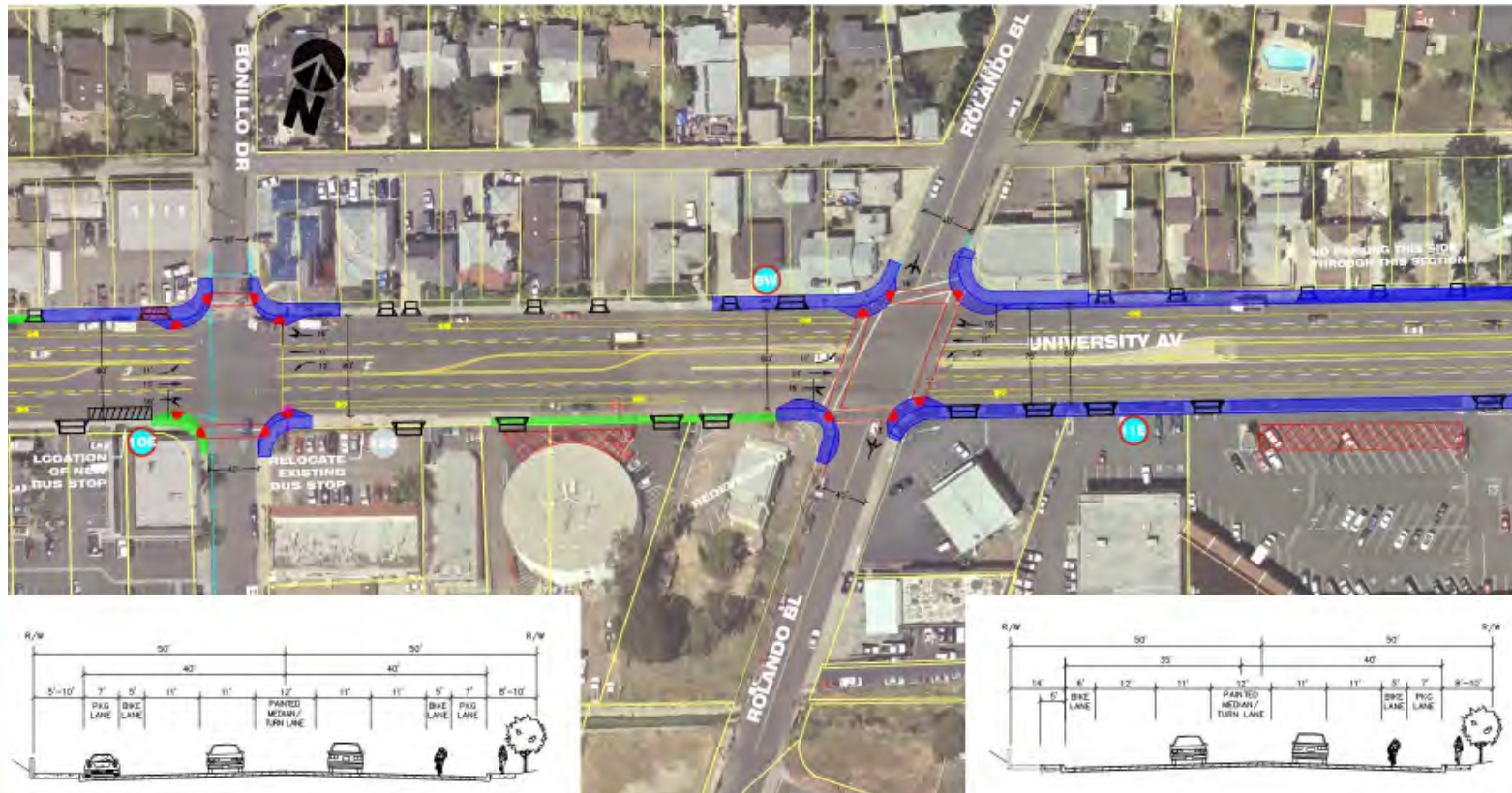



# College Avenue to Aragon Drive

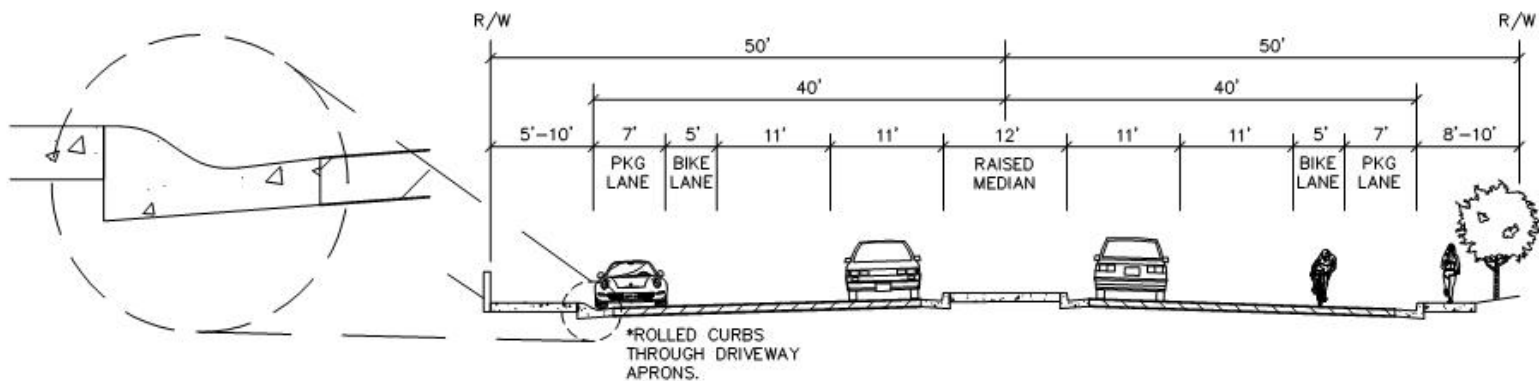

## Preferred Option



# Aragon Drive to 69<sup>th</sup> Street

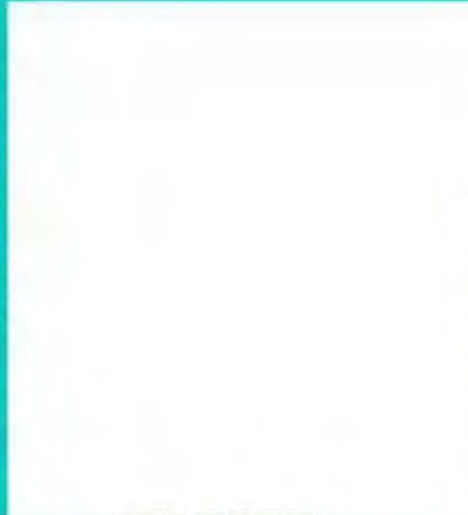



# Aragon Drive to 68<sup>th</sup> Street

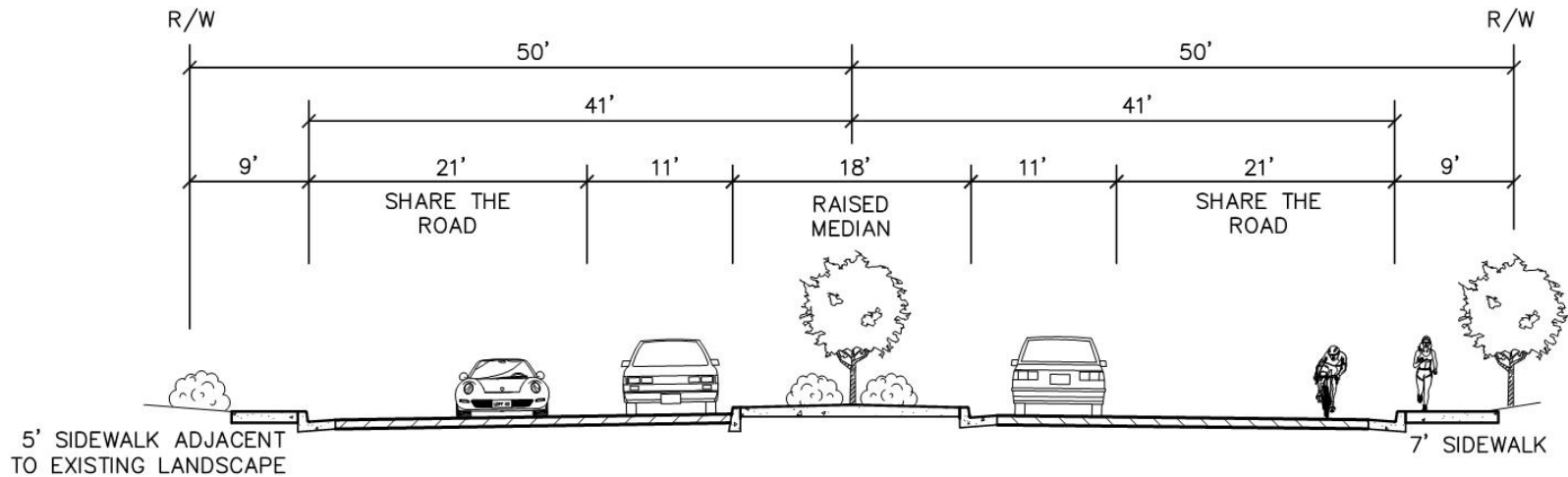

## Preferred Option



# Sharrow





# Aragon Drive to 68<sup>th</sup> Street

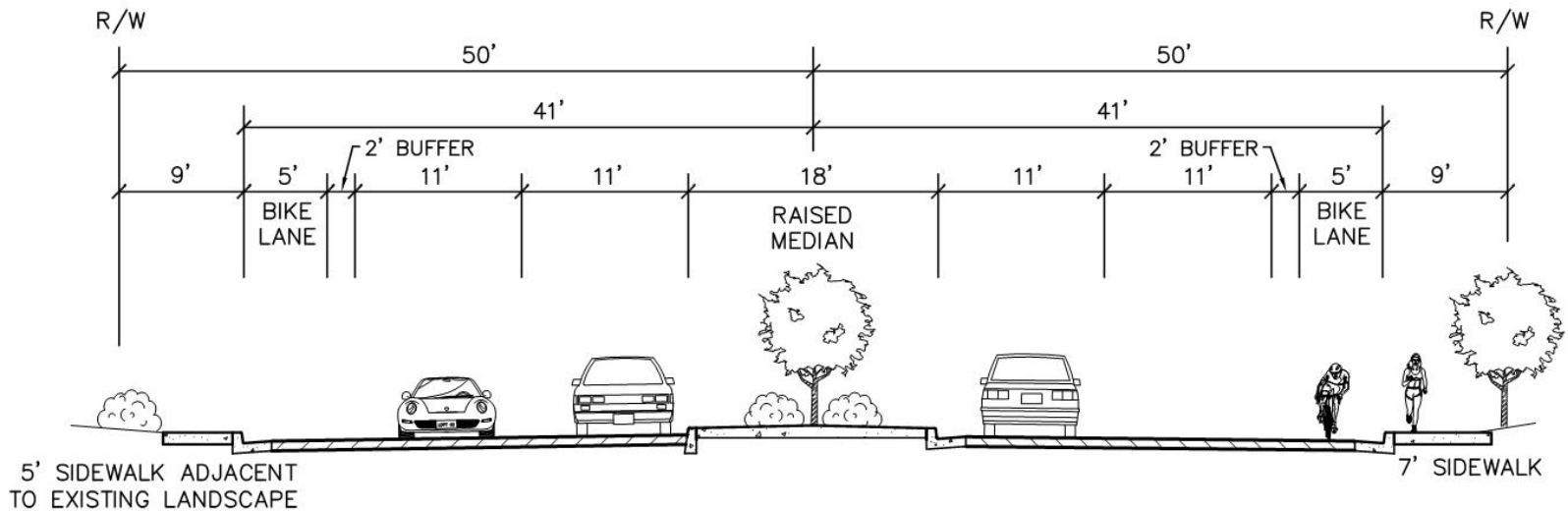

## No Parking Option



# Aragon Drive to 68<sup>th</sup> Street

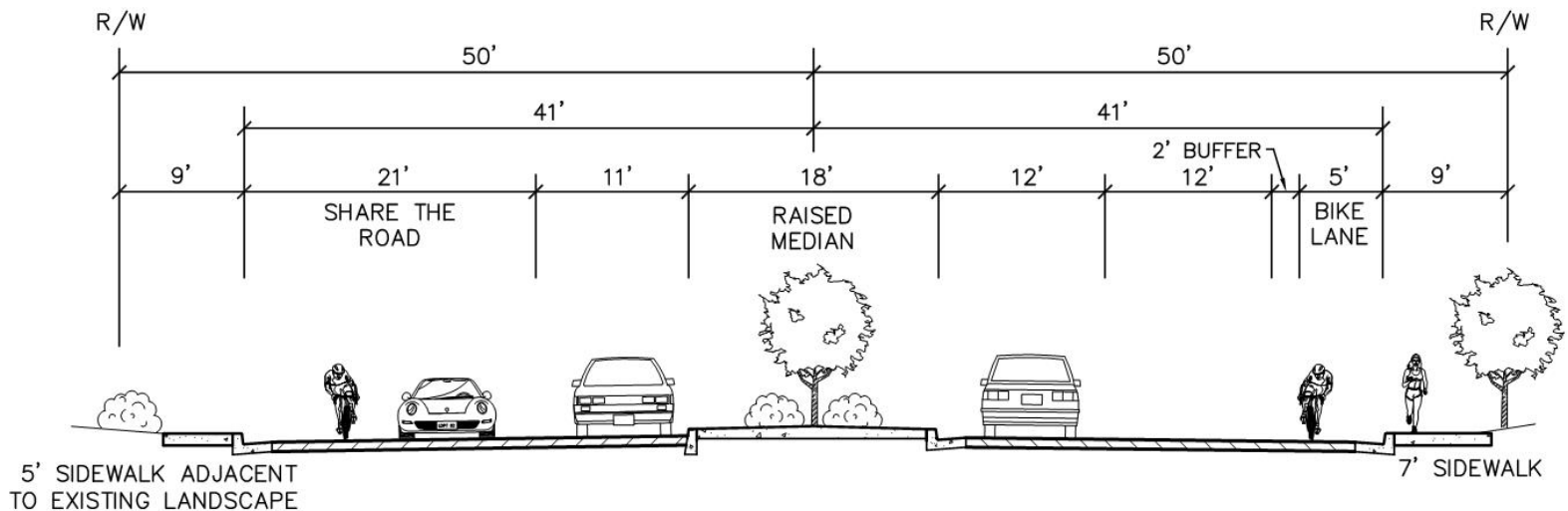

## Limited Parking Option





# Aragon Drive to 68<sup>th</sup> Street



# 54<sup>th</sup> and University Crossroads and Median

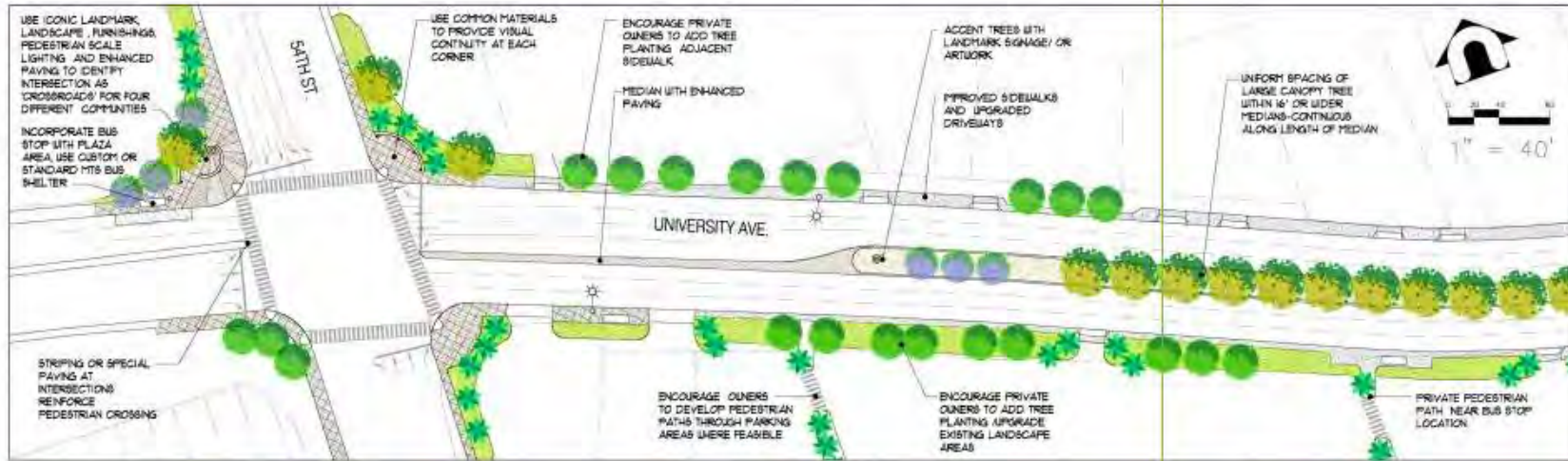

**Darnell**  
 & ASSOCIATES, INC.  
(A VARIOUS PARTNERSHIP)  
A FORTY SEVEN YEAR

PARTERRE  
 SITE PLANNING  
 URBAN DESIGN  
 LANDSCAPE ARCHITECTURE

## UNIVERSITY AVENUE MOBILITY STUDY LANDSCAPE CONCEPTS

54<sup>th</sup> STREET 'CROSSROAD' /  
 UNIVERSITY AVENUE MEDIAN

# 54<sup>th</sup> to Chollas Parkway-Option 1

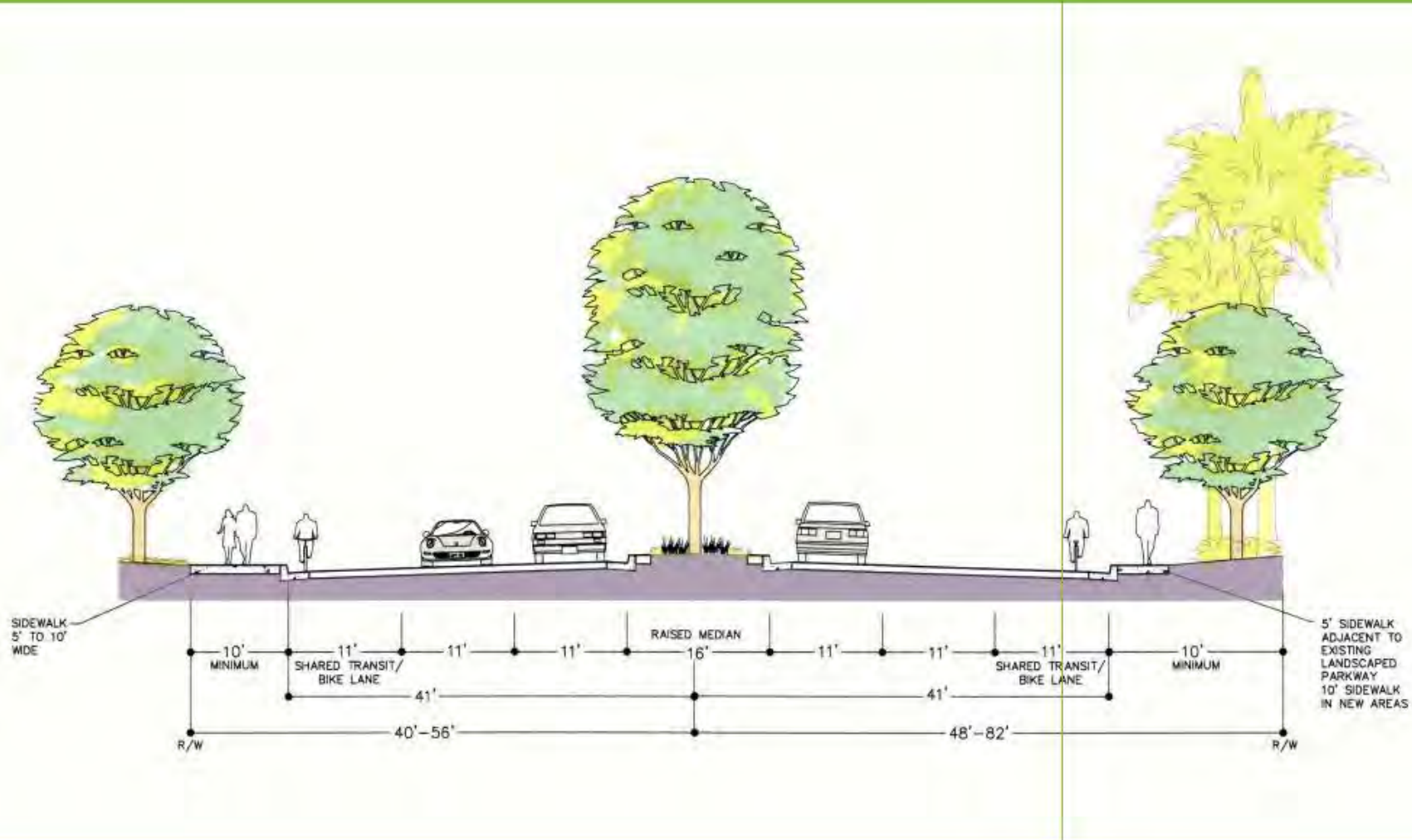



# Chollas Parkway Re-alignment



# Chollas Parkway Open Space

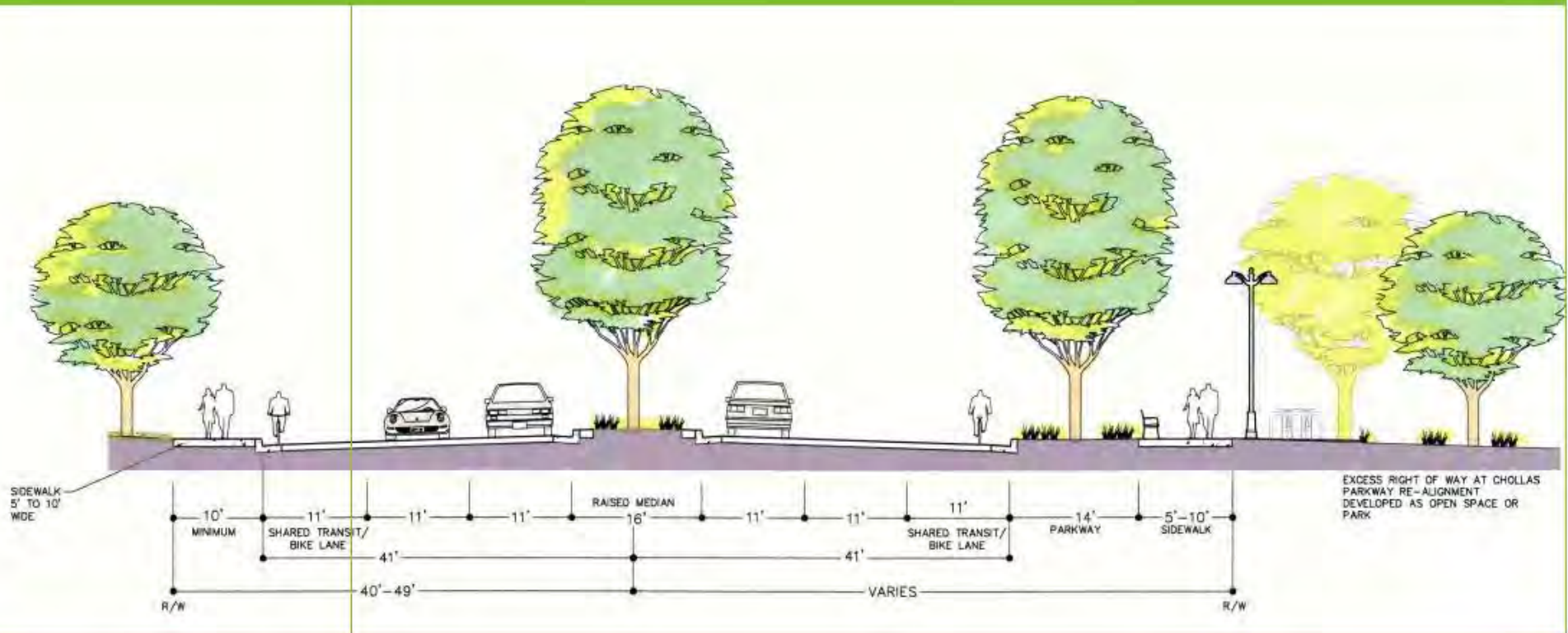







# Bus Stop at University Square

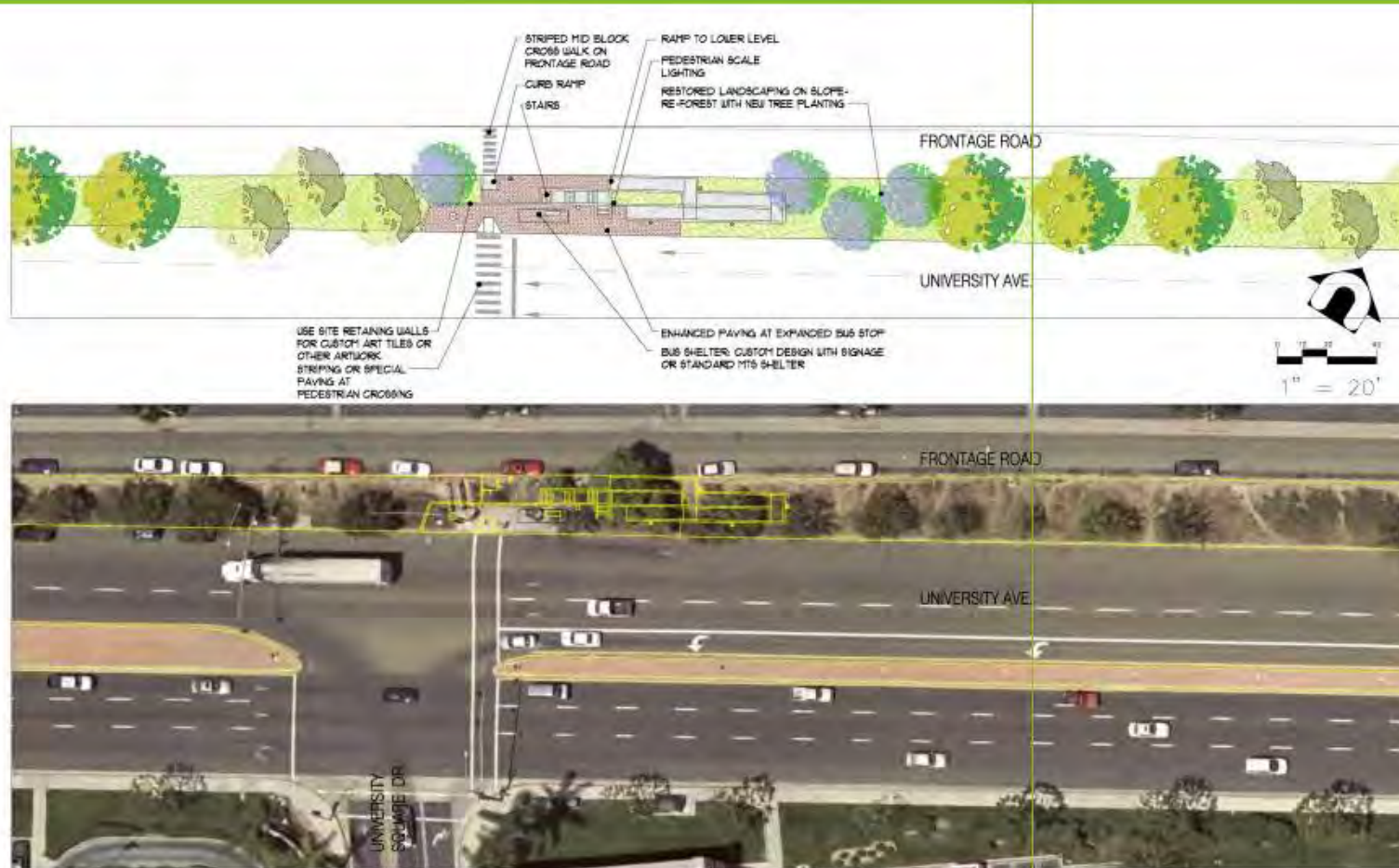

**Darnell**  
& ASSOCIATES, INC.  
TRADING AND INVESTMENT  
ADVISORS

PARTERRE  
DESIGN  
LANDSCAPE ARCHITECTS

**UNIVERSITY AVENUE  
MOBILITY STUDY  
LANDSCAPE CONCEPTS**

BUS STOP AT UNIVERSITY SQUARE

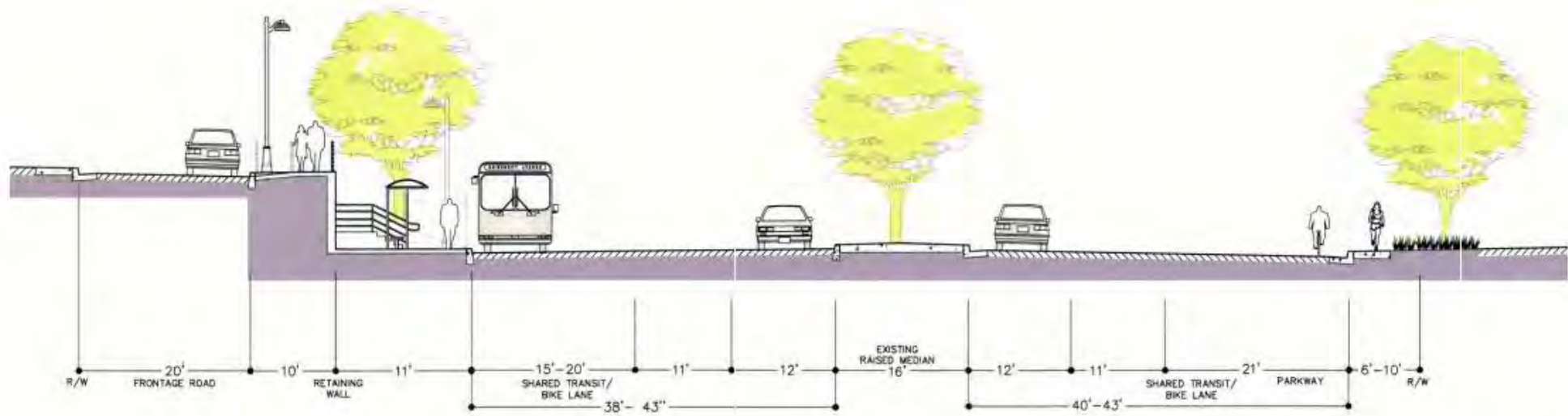

# Fletcher Cove Mosaic

Design by: Betsy Kopshina Schulz











# University Avenue Mobility



- The End