

CONTRACTOR SHALL CONSTRUCT THE NEW WATER MAIN ALONG THE ALIGNMENT OF THE EXISTING WATER MAIN, IF THE EXISTING MAIN VARIES MORE THAN ONE FOOT FROM THE ALIGNMENT SHOWN ON THE PLANS, THE CONTRACTOR SHALL PROCEED ONLY AFTER APPROVAL OF THE ENGINEER. CONTRACTOR SHALL SUPPLY THE CITY ON HIS MARKED UP PLANS WITH THE LOCATION OF THE NEW MAIN.

MIDDLETOWN MAP 4134-R

CONTRACTOR: ELEVATION OF ELECTRIC AND TELEPHONE DUCTS IS UNKNOWN. POT HOLE PRIOR TO TRENCHING

CONTRACTOR: EXISTING SEWER AND MANHOLES LIE 4'± E'LY, C TO C, OF PROPOSED WATER MAIN

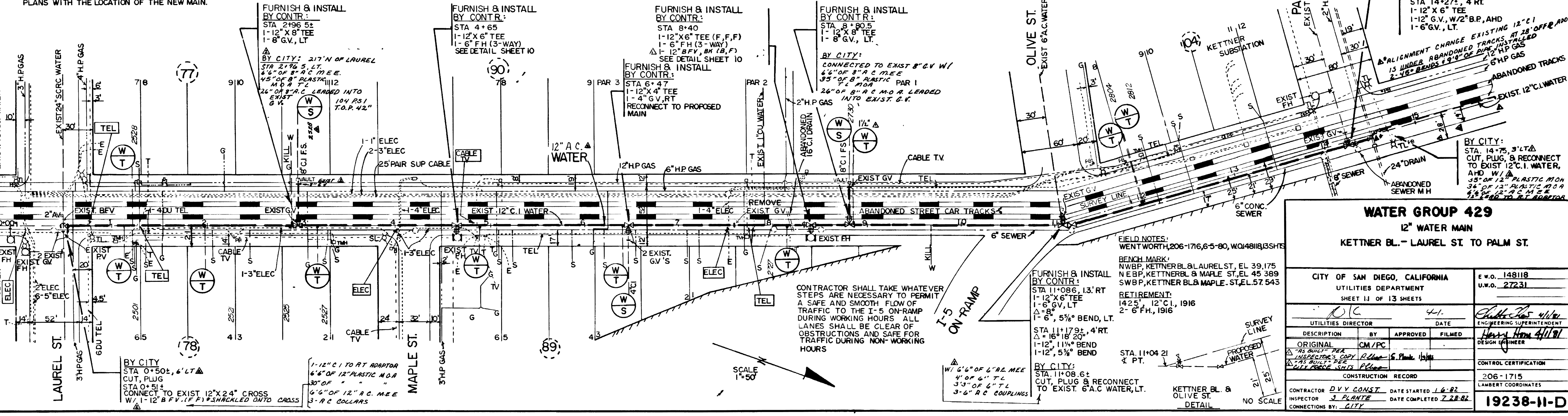

SCALE 1" = 50'

CONTRACTOR SHALL TAKE WHATEVER STEPS ARE NECESSARY TO PERMIT A SAFE AND SMOOTH FLOW OF TRAFFIC TO THE I-5 ON-RAMP DURING WORKING HOURS. ALL LANES SHALL BE CLEAR OF OBSTRUCTIONS AND SAFE FOR TRAFFIC DURING NON-WORKING HOURS.

**WATER GROUP 429**  
12" WATER MAIN  
KETTNER BL. - LAUREL ST. TO PALM ST.

CITY OF SAN DIEGO, CALIFORNIA UTILITIES DEPARTMENT SHEET 11 OF 13 SHEETS		E.W.O. 149118 U.W.O. 27231
UTILITIES DIRECTOR	DATE	ENGINEERING SUPERINTENDENT
DESCRIPTION	BY	APPROVED
ORIGINAL	CM/PC	FILMED
CONSTRUCTION RECORD		CONTROL CERTIFICATION
CONTRACTOR: D.V. CONST.		DATE STARTED: 1.6.92
INSPECTOR: J. PLANT		DATE COMPLETED: 2.28.92
CONNECTIONS BY: CITY		LAMBERT COORDINATES

19238-11-D