

Contractor: Harry L. Foster
 Constructed: March to September, 1941
 Pipe: U. S. P. & F. Co. Super De Lavaud, D & S
 and U. S. Joint as noted; cement lined
 and seal coated; 18' lengths; 16' & 18'
 Class 200 & 250 as noted.
 Class D cement lined specials
 Cement joints
 Pipe & Specials furnished by City
 Sta. 379+50.38 to 387+06.7 installed by City
 Valves furnished by City
 Test Pressure: 200* to 230* p.s.i.

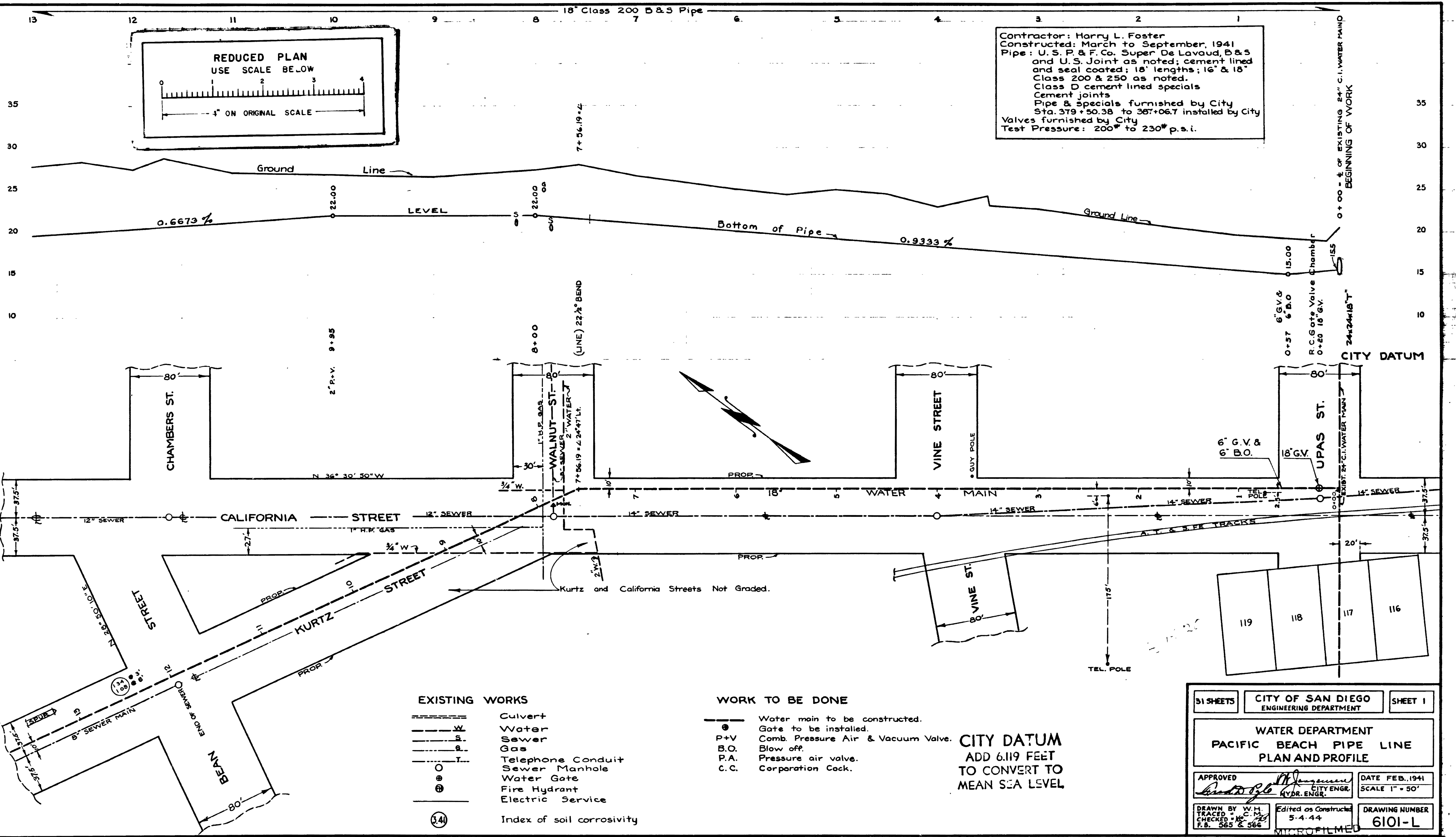

EXISTING WORKS

---	Culvert
W	Water
S	Sewer
G	Gas
T	Telephone Conduit
O	Sewer Manhole
⊙	Water Gate
⊕	Fire Hydrant
⊖	Electric Service
(3.4)	Index of soil corrosivity

WORK TO BE DONE

---	Water main to be constructed.
⊙	Gate to be installed.
P+V	Comb. Pressure Air & Vacuum Valve.
B.O.	Blow off.
P.A.	Pressure air valve.
C.C.	Corporation Cock.

CITY DATUM
 ADD 6.119 FEET
 TO CONVERT TO
 MEAN SEA LEVEL

51 SHEETS	CITY OF SAN DIEGO ENGINEERING DEPARTMENT	SHEET 1
WATER DEPARTMENT PACIFIC BEACH PIPE LINE PLAN AND PROFILE		
APPROVED <i>[Signature]</i> CITY ENGR. HYDR. ENGR.	DATE FEB., 1941 SCALE 1" = 50'	
DRAWN BY W.H. TRACED BY C.M. CHECKED BY F.B. F.B. 565 & 566	Edited as Constructed 5-4-44	DRAWING NUMBER 6101-L

JUN 10 1963