

UPAS STREET

MYRTLE STREET

CAFFS STREET

DAUGHT STREET

DANGER  
8" H.P. GAS

DANGER  
3 GAS LINES

DANGER  
8" L.P. GAS

Grade of Exist. Improvement  
2" A.C. over 8" Sewer  
Pavement

Bottom of Pipe

Exist. 6" C.I.  
El. 332.4

Exist. 8" A.C.  
El. 331.8

Exist. 6" C.I.  
El. 332.4

Exist. 8" A.C.  
El. 331.8

Scale: 1"=60' Horizontal  
1"=6' Vertical

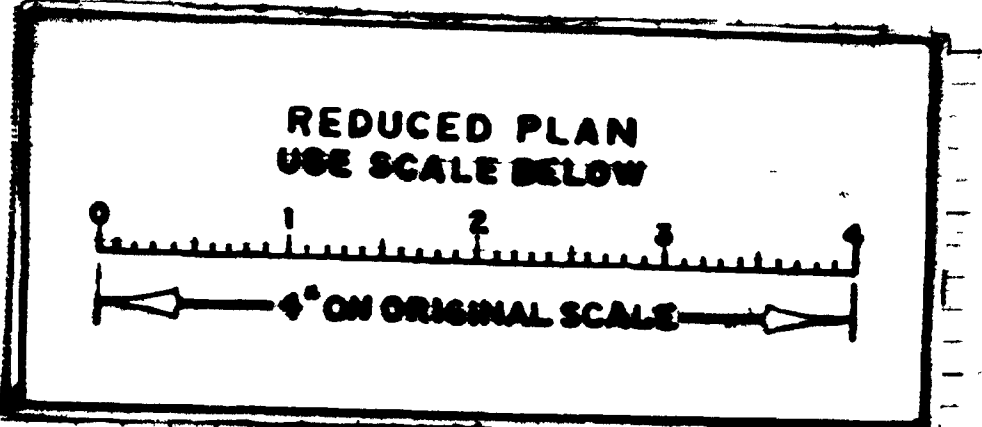

0-30± BEGIN WORK  
0-10± BEGIN CONTRACT  
0-20

11400± END CONTRACT  
11700± END WORK

**AS BUILT DATA**

CONSTRUCTED BY: R.M.A.S. ENGR. CONTR.  
 W.O. 21124 (CONSTR.) W.O. 48288 (Engr.)  
 PIPE: K. & M. FLUID-TITE  
 (Line)  
 GATE VALVES: MUELLER  
 (Line)  
 SOIL: (Line) ADobe + ROCK  
 STAKED: (Date) 10-31-62  
 TESTED: (Date) 12-17-62  
 BACKFILL: (Line) IMPORT SAND  
 NOTE: Include "CONSTRUCTION RECORD"  
 CONNECTIONS BY: CITY FORCE  
 W.O. 21125  
 PIPE: 8" A.C.  
 GATE VALVES: MUELLER

BENCH MARK: (City Datum)  
 B.M. N.E.S.P. Myrtle St. &  
 Granada Ave.  
 El. 308.97'

REFERENCES:  
 Meter Rk. 13 300. 8-10-C  
 G.S. A-26  
 Sewer Rk. 4 301. 254-5  
 Gas Rk. 3 301. 282.3  
 Gas Rk. 11 301. 291-2-3-4, & 317  
 Eng. 670-L (Improv't.)  
 Eng. 9047-10-0 (Water)

RETINMENT:  
 1190' 6" C.I. 1821  
 2-6" G.V. 1821  
 2-6" F.J. Serv. 1821

GROUP 128  
 GRANADA AVENUE 8" A.C. MAIN  
 Upas Street to Daught Street

Engineering  
W.O. 48288

CITY OF SAN DIEGO ENGINEERING DEPARTMENT		SHEET 10 OF 11 SHEETS	
PLAN REVISION			
NO.	CHANGE	BY DATE	APPROVAL
1	As Built: Per Insp. Plans 5-28-62	Elizab. Farra	DATE
APPROVALS FOR			
WATER DEPT.	SEWERAGE	PLANNING DEPT.	DRAINAGE
ELECTRICAL	HIGHWAY	STRUCTURAL	GRADES
TRAFFIC	CONTROL		
CONSTRUCTION RECORD			
1-30-62	12-27-62	DATE COMPLETED	
CONTR. R.M.A.S. Engr. Contr. Insp. M. Martell			
FIELD BOOK N-19-C			

W-19-C  
MICROFILMED

AS BUILT

INLXFB

GRANADA AVENUE

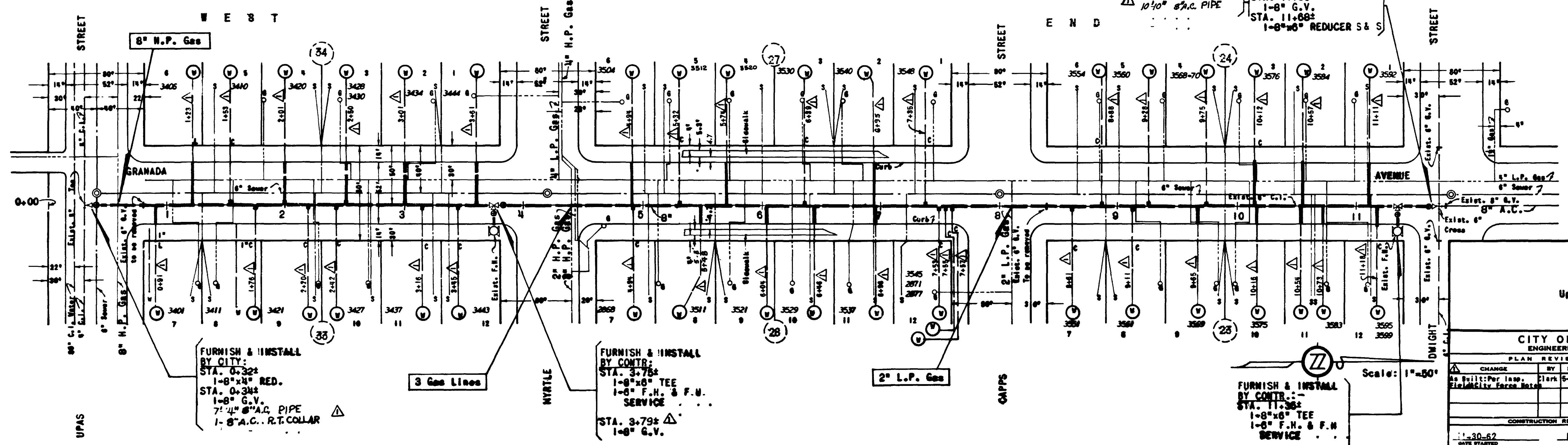

UPAS STREET MYRTLE STREET CAFFS STREET DAUGHT STREET

0+00 1+00 2+00 3+00 4+00 5+00 6+00 7+00 8+00 9+00 10+00 11+00 12+00

UPAS MYRTLE CAFFS DAUGHT

MAP N.O. 590