

B.M. Brass plug in Southwest return  
Park Blvd. and Upas Street.  
City Datum. Elev. 295.80

UNIVERSITY HEIGHTS MAP NO. 525

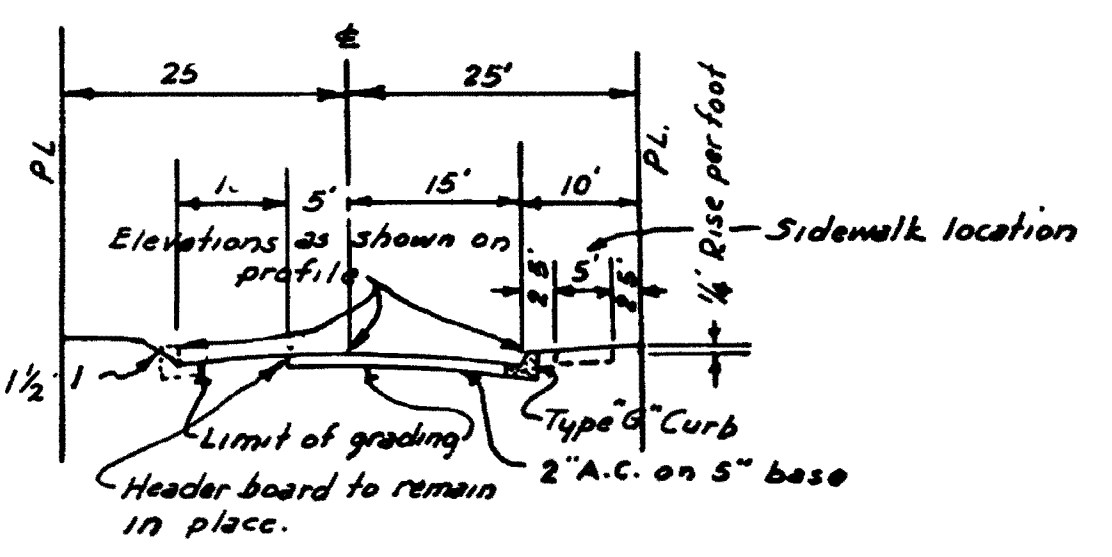
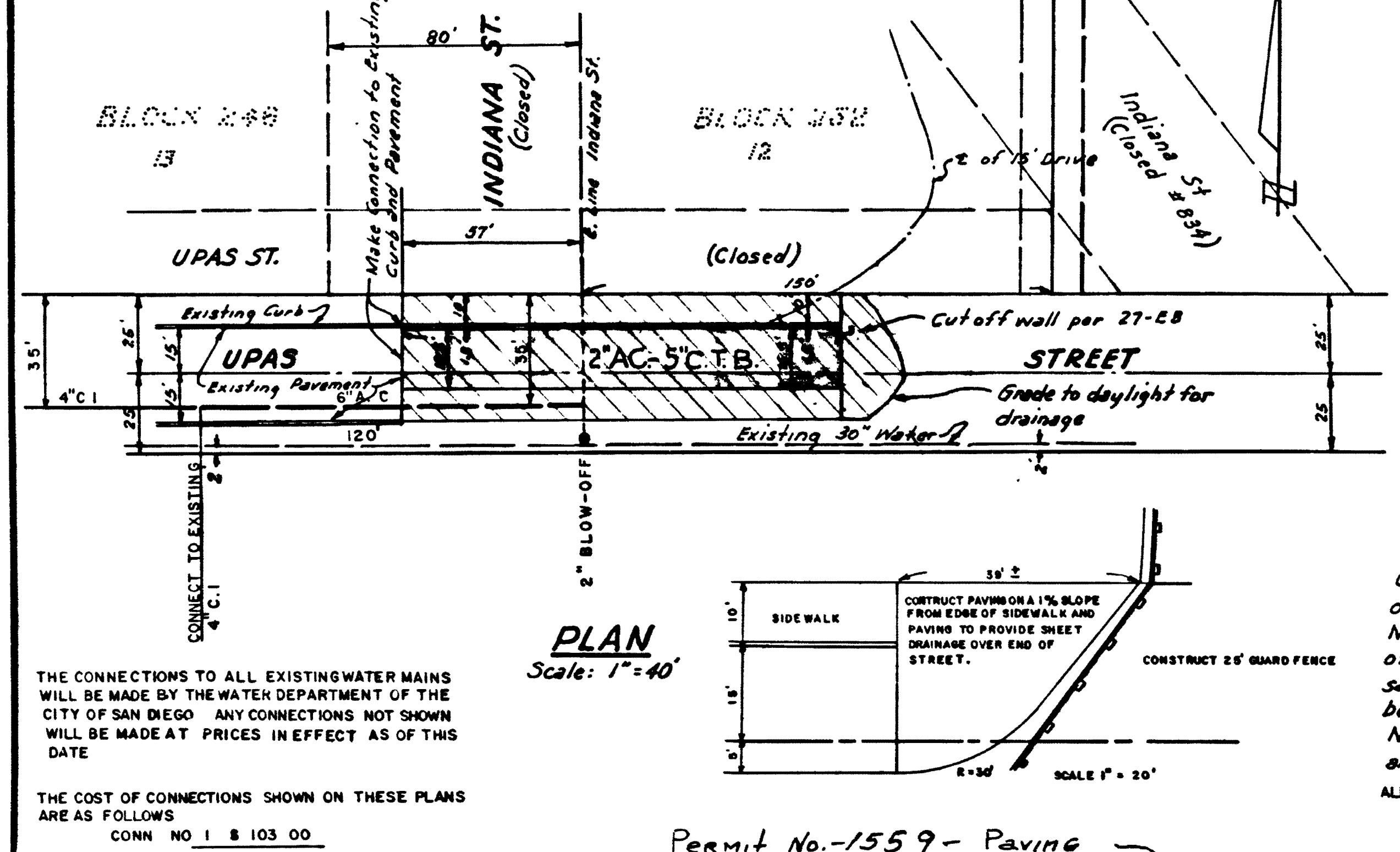

**CITY DATUM**  
ADD 6.119 FEET  
TO CONVERT TO  
MEAN SEA LEVEL

**NOTES**  
Cut and fill slopes in which the vertical height of slope is greater than 12' shall be planted with Mesembryanthemum plants; plants shall consist of 10" tip cuttings, planted 5 inches in thoroughly saturated soil, and spaced 18" apart; and shall be kept moist for 30 days after planting.  
No pavement shall be placed before gas mains and house services are installed.  
ALL WATER MAINS SHALL HAVE A 3' MIN. COVER ABOVE TOP OF PIPE.

**WORK TO BE DONE**

The improvement consists of the following work to be done according to these plans and the specifications of the City of San Diego:

- The grading of the portion of the street shown hatched thus:
- The construction of cutoff wall shown thus:
- The grading, preparation of subgrade and paving per Schedule "B" of the portion of the street shown shaded thus:
- The construction of guard fence as shown thus:
- The construction of type "G" curb as shown thus:
- THE CONSTRUCTION OF ASBESTOS CEMENT PIPE WATER MAIN AS SHOWN THUS:

CONSTRUCTION APPROVAL  
Date Recd. 5/8/58  
Permit No. 1609  
F.L.A.

**STANDARD DRAWINGS**  
9-EB, 24-EB, 27-EB  
40-EB, 509-EB, 200-WB  
204-WB, 206-WB, 208-WB

**SPECIFICATIONS**  
Standard Specifications filed July 7, 1954  
Special Conditions P-1 and General Conditions for Private Contract Work

**REFERENCE DRAWING**  
2414-L  
5765-L

**ENGINEER OF WORK**  
LAWRENCE, FOGG, FLORER & SMITH  
CIVIL ENGINEERS  
Robert S. Florer  
Robert S. Florer C.E. 6335

**PRIVATE CONTRACT**

SHEET 1	CITY OF SAN DIEGO ENGINEERING DEPARTMENT	1 SHEET
<b>PLANS FOR THE IMPROVEMENT OF UPAS STREET</b>		
APPROVED	<i>Lawrence Fogg</i> CITY MANAGER	DATE 3/4/58 SCALE As Shown
DRAWN BY	CHANGED	DATE
CHECKED BY	DATE	DRAWING NUMBER
FIELD BOOK	DATE	13897-L

THE CONNECTIONS TO ALL EXISTING WATER MAINS WILL BE MADE BY THE WATER DEPARTMENT OF THE CITY OF SAN DIEGO. ANY CONNECTIONS NOT SHOWN WILL BE MADE AT PRICES IN EFFECT AS OF THIS DATE.

THE COST OF CONNECTIONS SHOWN ON THESE PLANS ARE AS FOLLOWS:  
CONN NO 1 103 00

Permit No. 1559 - Paving

Permit No. 1609 - Water Main only

CONSTRUCTION RECORD	W. O. No. 20020
Contractor Sapp Const. Co.	Inspector Coombe
Date started 4-1-58	Revisions As Built Date 7/19/59
Time com. date 8-14-58	

CONSTRUCTION RECORD	W. O. No. 20020
Contractor Sapp Const. Co.	Inspector Coombe
Date started 5-8-58	Revisions As Built Date 7/19/59
Date completed 6-7-58	

CONSTRUCTION RECORD	W. O. No. 20020
CONTRACTOR	INSPECTOR
DATE STARTED	REVISIONS
DATE COMPLETED	DATE