

CONTRACTOR'S NOTE:
CONTRACTOR TO MAINTAIN MINIMUM 3'
TO 5' COVER OVER TOP OF WATER MAIN.

CONTRACTOR'S NOTE:
EXISTING UTILITY CROSSINGS ARE NOT
REPRESENTATIVE OF ACTUAL LENGTH
OF CONFLICT AREA (SEE PLAN VIEW).

CONTRACTOR'S NOTE:
CONTRACTOR SHALL MAINTAIN A MINIMUM
1 FOOT VERTICAL SEPARATION (FROM
OUTSIDE PIPE WALL TO OUTSIDE PIPE WALL)
BETWEEN WATER AND OTHER UTILITIES.

SCALE
1"=40' HORIZ.
1"=8' VERT.

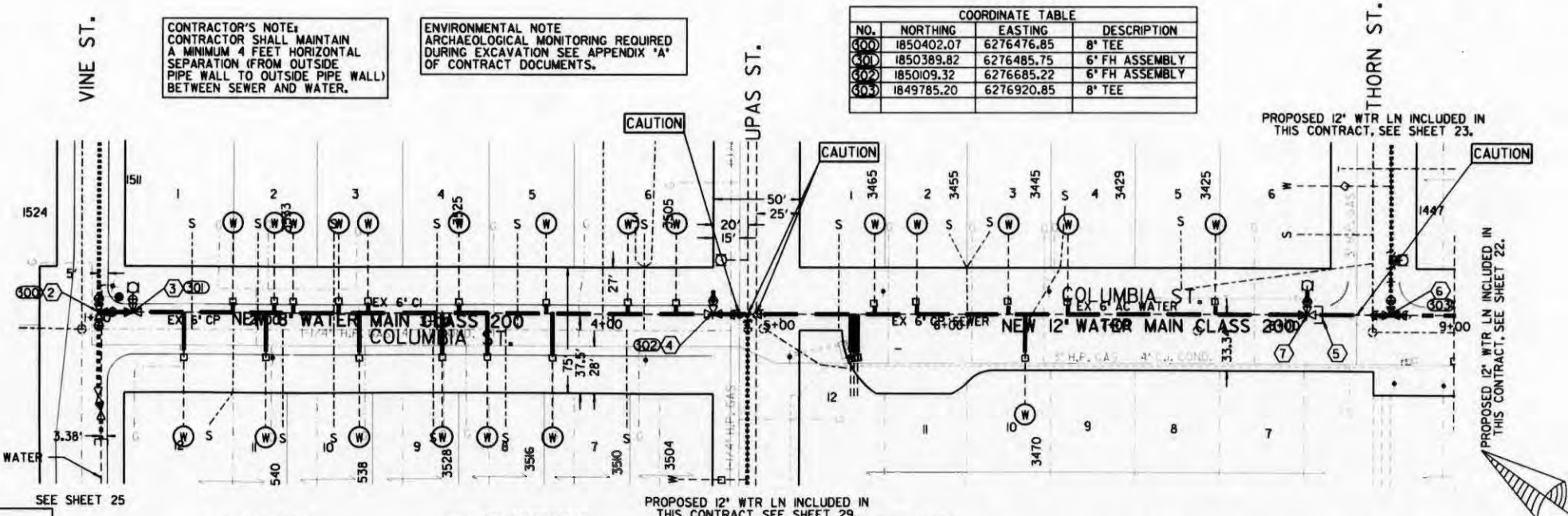

COORDINATE TABLE			
NO.	NORTHING	EASTING	DESCRIPTION
000	1850402.07	6276476.85	8" TEE
001	1850389.82	6276485.75	6" FH ASSEMBLY
002	1850109.32	6276685.22	6" FH ASSEMBLY
003	1849785.20	6276920.85	8" TEE

REFERENCE:
BENCH MARK: SWBP REDWOOD ST AND COLUMBIA ST.
EL. -147.24 MSL NGVD29 (FEET)
FIELD NOTES: HACKNEY/McCORMICK, 206-1713, II-12-97/
9-1-2000 WO183791(W), WO174061(S) 6 THRU 77.
WATER: 513-D, 24450-19-D
SEWER: 3081-L, 3081-2-L, 1466-9-L
STORM DRAIN: 3237-B, 4887-B
GAS:
ELECTRIC:
CABLE TV:
TELEPHONE:
IMPROVEMENTS:
WATER FIELD BOOK: F20S
SEWER FIELD BOOK: F20S
100' SCALE: F20SA
THOMAS BROS.: I268

RETIREMENTS:

LENGTH	SIZE	TYPE	YEAR INSTALLED
359.28'	6"	CI PIPE	1963
400.76'	6"	AC PIPE	1963

SEWER and WATER GROUP 673
COLUMBIA STREET
BTWN VINE ST. & THORN ST.

CITY OF SAN DIEGO, CALIFORNIA ENGINEERING AND CAPITAL PROJECTS DEPARTMENT		183791 174061
<i>Para-fay</i> CITY ENGINEER	03-05-01 DATE	<i>Para-fay</i> REGISTERED ENGINEER
ORIGINAL	CHECK	FILED
206-1713 LABORER EXEMPT		28898-28-D

CAUTION!!!
LOW OVERHEAD POWER LINES
IN ENTIRE PROJECT AREA.

NOTE:
COLUMBIA ST. SHALL BE HIGHLIGHTED BY
CITY FORCES PRIOR TO THE BEGINNING OF
CONSTRUCTION. CITY FORCES TO PROVIDE
THE CONSTRUCTION MATERIALS. CITY WILL
TRANSFER SERVICES.

2 BY CONTRACTOR
FURNISH & INSTALL
STA. 1+10
1- 8" TEE (F,F,F) BK, RT, LT
1- 8" VALVE (F,MJ) AHD, BK
1- 8" VALVE (F,MJ) LT, RT
1- 8" VALVE (F,MJ) RT, LT

3 BY CONTRACTOR
FURNISH & INSTALL
STA. 1+15.23, 4+59.32
1- 8" X 8" X 6" TEE (F,F,F) BK, AHD, LT
1- 6" FH ASSEMBLY RT (W - 10)

5 BY CITY FORCES
AHEAD OF CONTRACTOR
STA. 8+19.98
CUT & PLUG AS INDICATED
PRIOR TO PHASE I
BY CONTRACTOR
AFTER NEW MAINS HAVE BEEN
ACCEPTED CONNECT NEW 12"
MAIN TO 12" TEE PRIOR
TO PHASE III

6 BY CONTRACTOR
FURNISH & INSTALL
STA. 8+60.03
1- 12" TEE (F,F,F) BK, AHD, LT
1- 12" VALVE (F,MJ) LT, RT
1- 12" VALVE (F,MJ) BK, AHD
1- 12" VALVE (F,MJ) AHD, BK

7 BY CONTRACTOR
REMOVE
STA. 8+12.77
1- 6" FH ASSEMBLY
1- 12" X 12" X 6" TEE

HIGHLINING PHASE II

FILMED FROM THE ORIGINAL. BEST QUALITY
OBTAINABLE. EXCESSIVE GRAY BACKGROUNDING
MAY CAUSE A POOR QUALITY REPRODUCTION.

