



UPLAND HABITAT EXPANSION AND PRESERVATION

Preliminary Engineering Report (PER)

The islands within Mission Bay were created when the City dredged False Bay to create Mission Bay. That process changed the ecosystem and made it more difficult for sensitive and endangered species to thrive there.

The Upland Habitat PER addresses all of Fiesta Island and three areas along the San Diego River and Sea World Drive.

This PER provides a preliminary plan to modify the sand berms around the sites and establish coastal strand and southern foredune habitats. The proposal would support continuous habitat corridors that can add space and improve stability for sensitive species like the California Least Tern and Nuttall's lotus.

Project Goals

- Establish native plant communities that provide habitats for sensitive and endangered species
- Establish self-sustaining habitat areas adapted to current and future climate conditions
- Limit access to protect areas from accidental damage by pedestrians
- Improve soils to support native wildlife and vegetation
- Control weeds

Other Improvements

In addition to the recommendations on page 1, the PER includes specific recommendations to support establishment and long-term health of the habitat in each area.

Area	Additional Recommendations
Fiesta Island South	<ul style="list-style-type: none"> • Add sand and perform grading on existing berm to preserve optimal conditions • Add a temporary irrigation system
Fiesta Island Near Youth Camping	<ul style="list-style-type: none"> • Consider moving access roads and trails that currently cross the preserve away from improved habitat • Create low-profile dune features
Fiesta Island North Central	<ul style="list-style-type: none"> • Consider adding a formal trail around the perimeter of the restoration area • Add fencing to prevent accidental damage by pedestrians
Fiesta Island Least Tern Preserve Area	<ul style="list-style-type: none"> • Add sand with shell fragments throughout the preserve to improve natural conditions for Least Tern nesting • Grade area to provide better terrain for nesting and avoid tidal flooding of nests
Sea World Drive Site #5a	<ul style="list-style-type: none"> • Replant areas around and within fencing • Remove non-native species
Sea World Drive Site #5b	<ul style="list-style-type: none"> • Eradicate non-native species and enhance native species
Sea World Drive Site #5c	<ul style="list-style-type: none"> • Protect Nuttall's Lotus from disturbance at center of site • Add soil and grade other areas to support new native plants



Fiesta Island Concept Areas

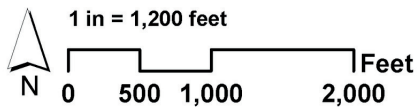
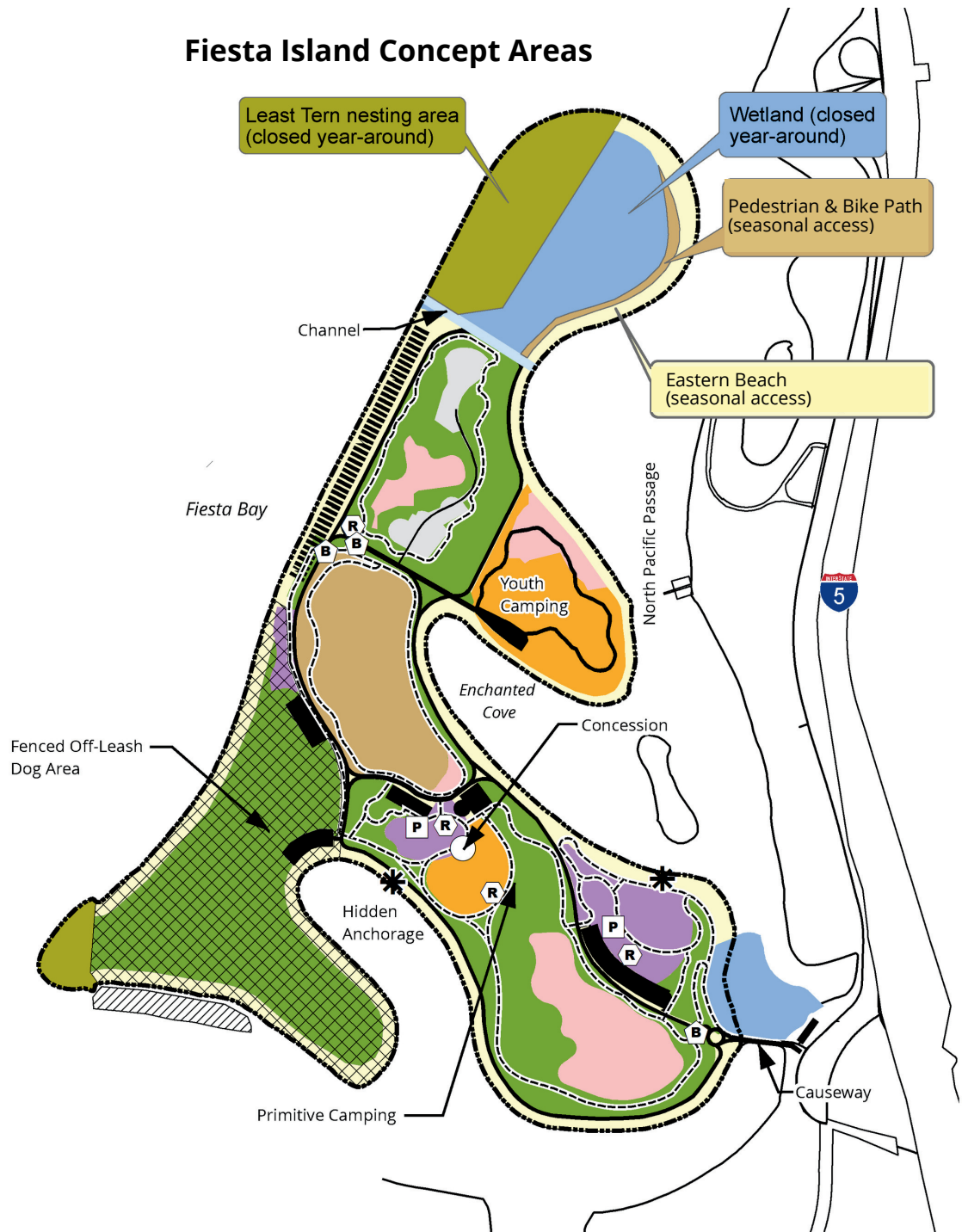

LEGEND

- | | | |
|---------------------------------|--|-----------------------------|
| Special Event RV Parking | Coastal Landscape (Natural Recreation) | ⊞ Fenced Off-Leash Dog Area |
| * ADA Shore Access | Habitat Preserves | □ Sand Management |
| P Playground | Least Tern Preserves | ■ Sand Arena (Parkland) |
| B Pedestrian and Bicycle Bridge | Active Recreation (Parkland) | □ Beach |
| R Restrooms | Wetlands | — Road |
| ■ Lease Areas | Proposed Eelgrass Expansion | - - - Multi-Use Path |
| ■ Parking Lots | | |

Existing Plant Communities in the Project Areas

The PER improves and expands areas of Diegan Coastal Sage Scrub, Coastal Salt Marsh and Southern Foredune. It also adds Coastal Strand habitats on Fiesta Island. The areas of opportunity include several existing plant communities and sensitive plant species.

- Sensitive species in or adjacent to the areas include:
 - Nuttall's Lotus
 - Coast Woolly-Heads
 - Robinson's Pepper-grass
 - Oil Netstraw



- Existing habitats include:
 - Diegan Coastal Sage Scrub
 - Coastal Salt Marsh
 - Southern Foredune
 - Salt Pan/Mud Flats
 - Non-native grasslands and Rudderall



Other Topics Covered in the Program EIR:

The Mission Bay Park Improvements Program EIR includes Preliminary Engineering Reports on each of the Report topics listed below. To obtain fact sheets for the other reports, please visit www.sandiego.gov/mbpeir.

- **Bicycle and Pedestrian Paths**
- **Deferred Maintenance**
- **Seawall Restoration**
- **Shoreline Restoration**
- **Wayfinding Improvements**
- **Wetland and Water Quality Improvements**
 - Cudahy Creek
 - North Fiesta Island
 - Tecolote Creek
- **Upland Habitat Expansion**