

# San Diego Planning Commission Meeting

## **PHONE-IN TESTIMONY PERIOD NOW OPEN FOR** Kearny Mesa Community Plan Update

To call in and make your one minute of public comment on this item:

 **Dial 619-541-6310**

  **Enter Access Code 877861 then press #**

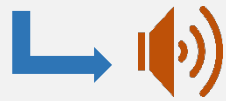

**Listen and wait until you hear,  
"Your phone has been unmuted."**



**When it's your turn, state your name and make your comments. When finished, hang up.**

# Kearny Mesa Community Plan Update

Planning Commission  
July 30, 2020

# Kearny Mesa Planning Area

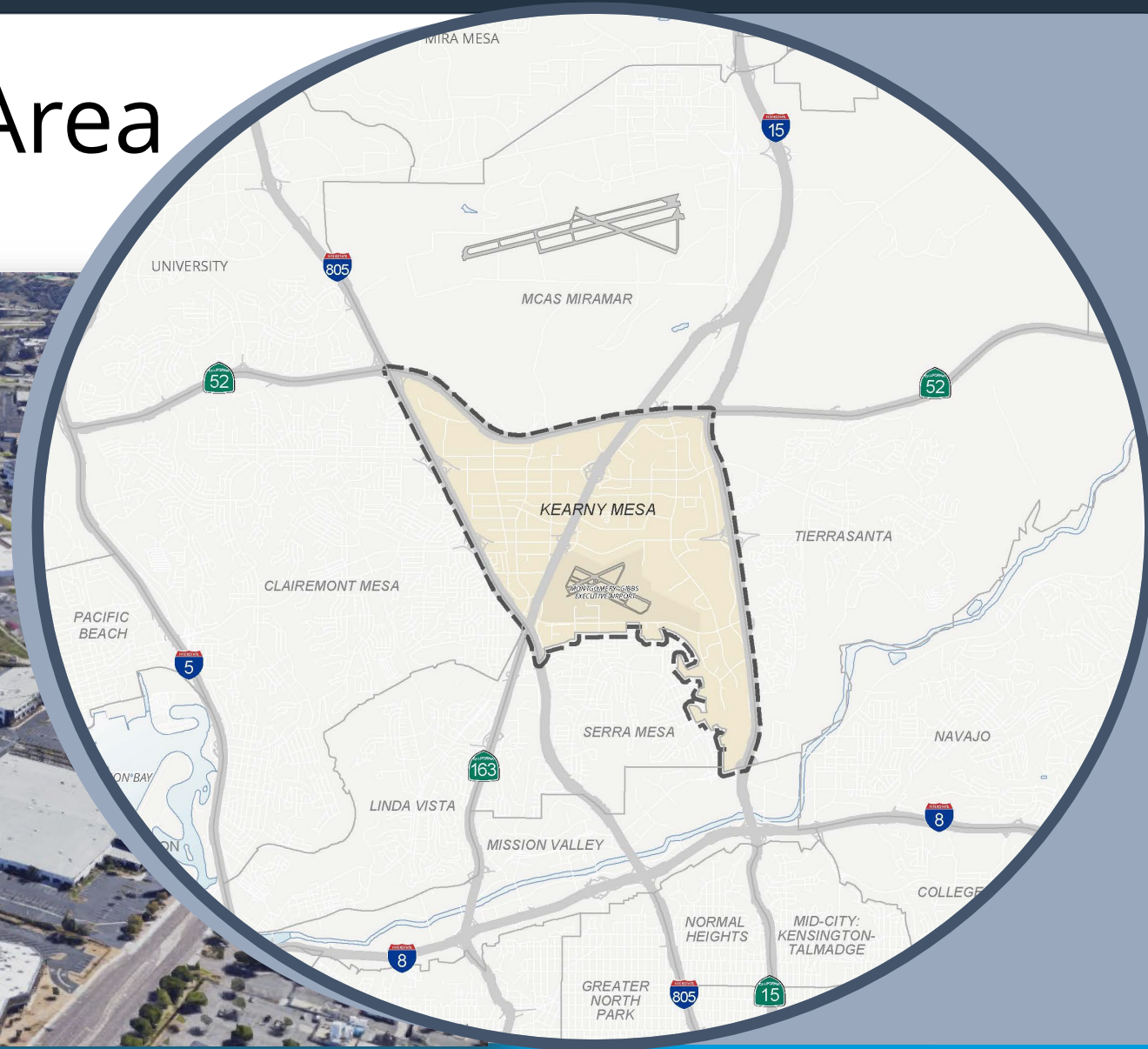

# Timeline

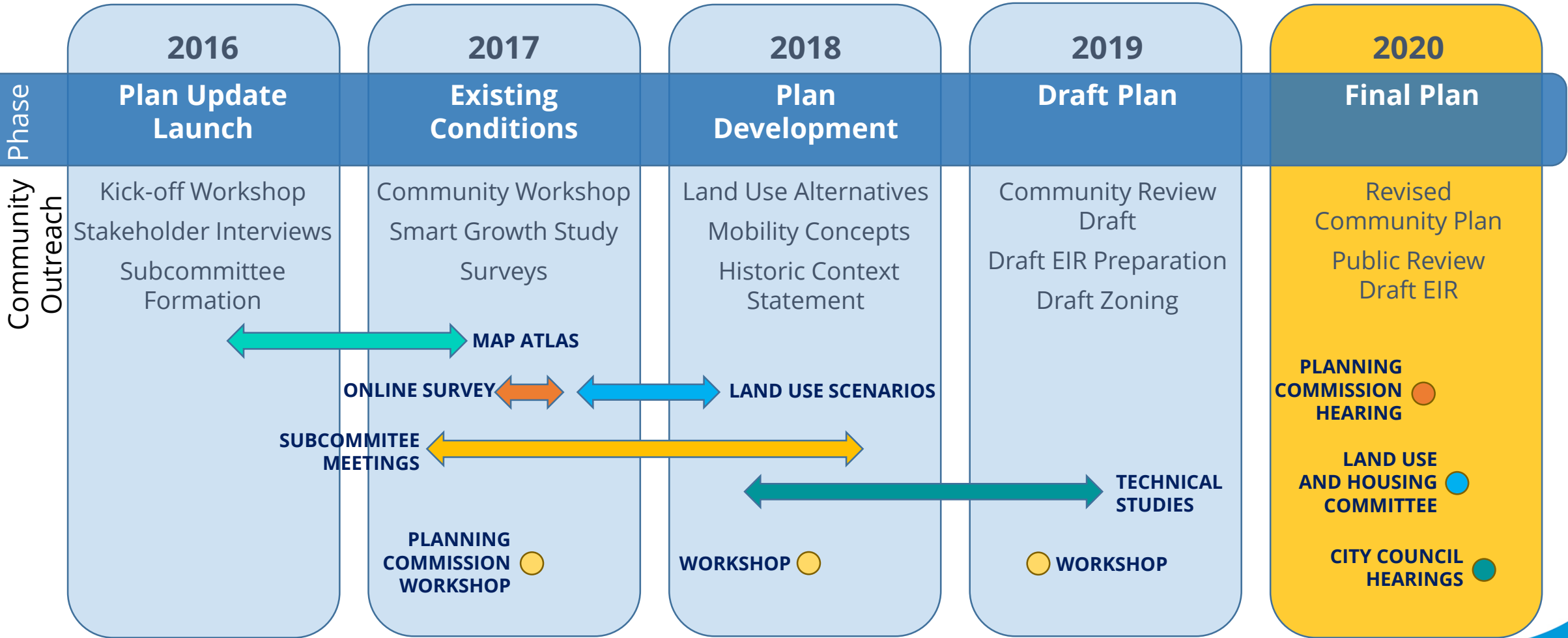

# Workshops and Input



Existing Conditions & Opportunities



Land Use Options



Community Review Draft



Hearing Process

# Village Areas



Urban Pathways



Pedestrian-oriented environment



Incentives for parks

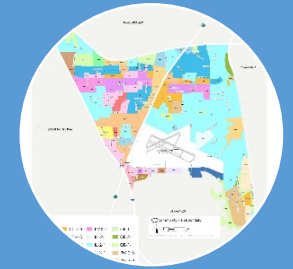

Area specific buffers



# Buildout Comparison

Category	Base Year (2012)	Adopted Community Plan or ACP (2050)	Community Plan Update or CPU (2050)	Increase over Adopted Community Plan
Commercial (Office, Industrial, Retail) Square Feet (rounded to the nearest hundred thousand)	35.4M	45.1M	57.8M	<b>&gt;25%</b>
Residential Dwelling Units (estimated)	2,388	5,882	25,826	<b>&gt;330%</b>

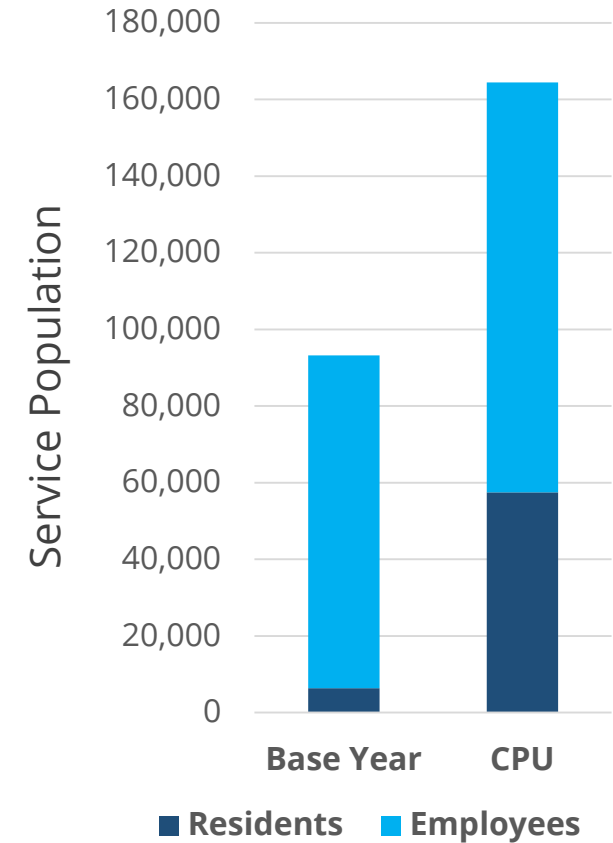

# Mobility

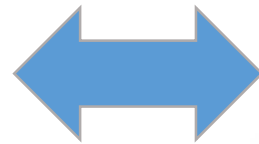
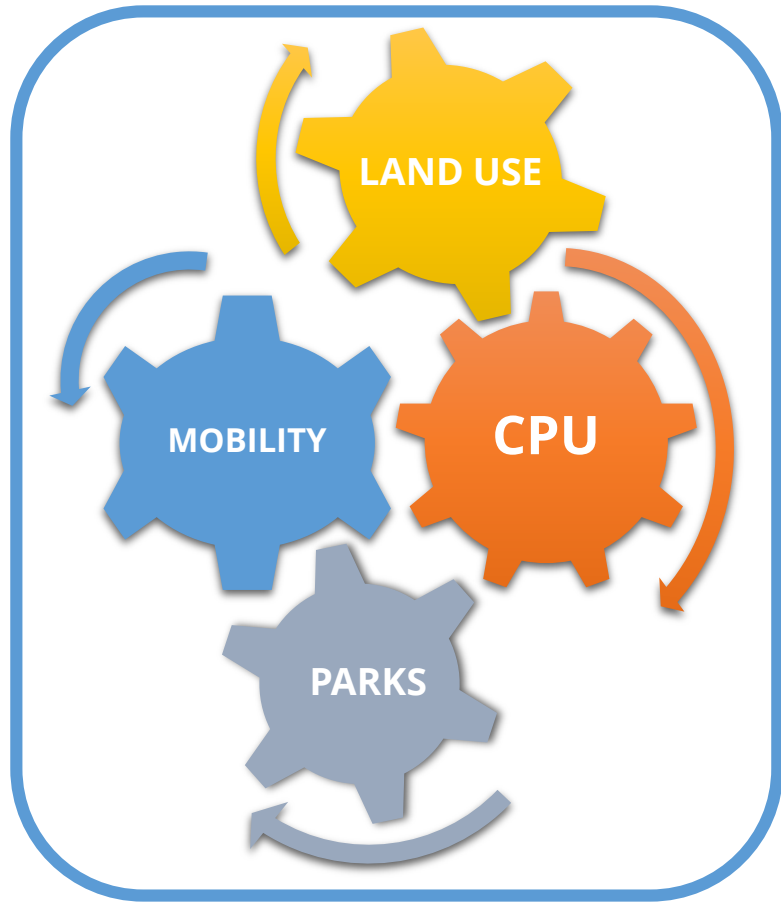

# Enhanced Bicycle Facilities

**Bike Lane**



**Bike Route**

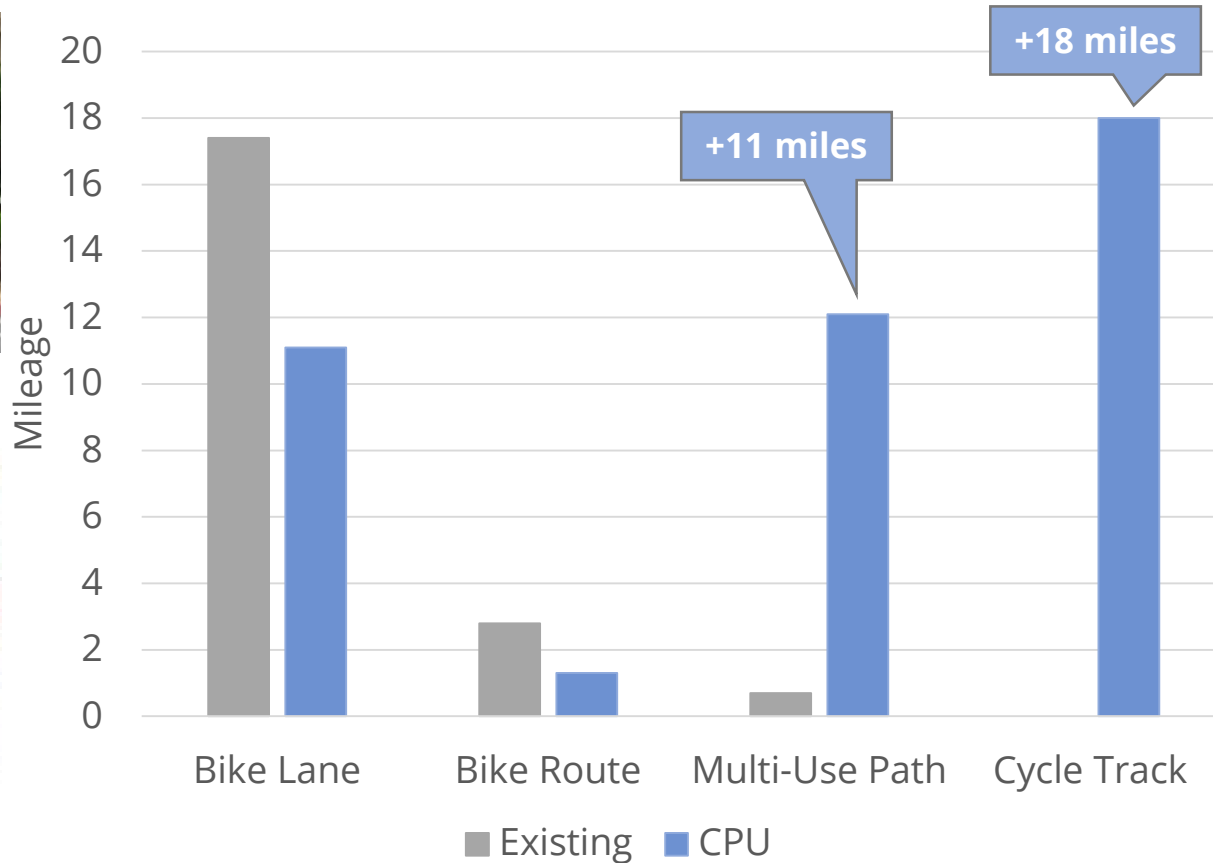

**Multi-Use**



**Cycle Track**

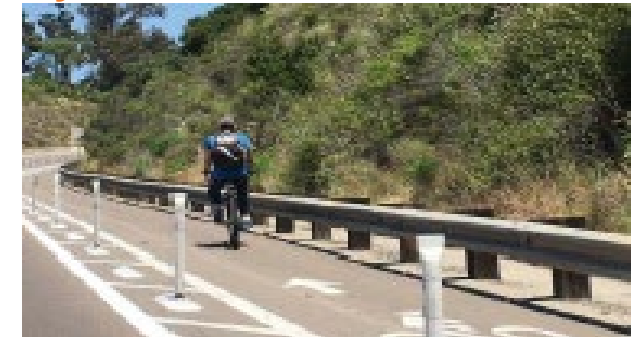

# Improve Transit





# Modernize Mobility



Source: SANDAG



# Climate Action Plan (CAP)

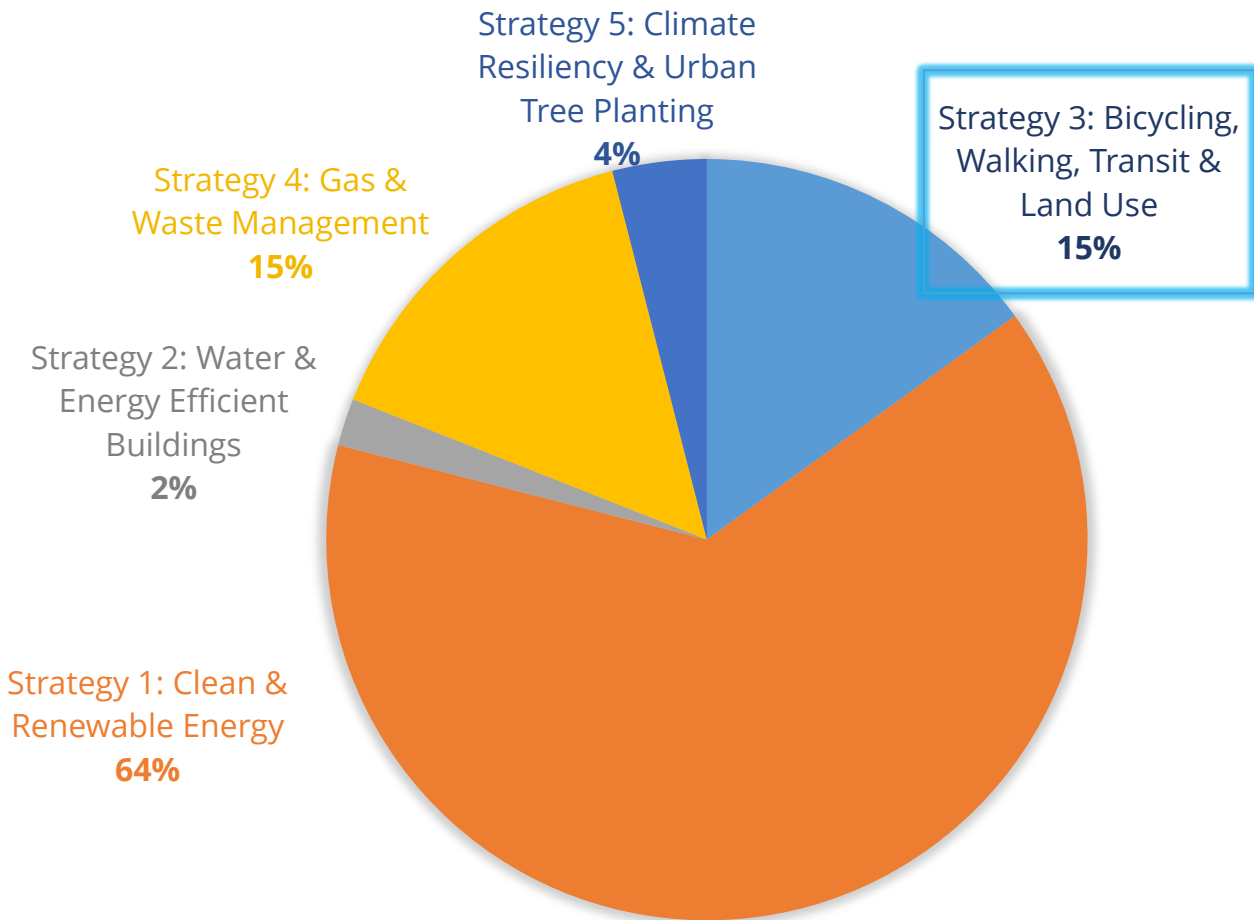

Percent contribution to local greenhouse gas reduction targets

- Action 3.1** Implement the General Plan’s Mobility Element and the City of Villages Strategy in TPAs to increase the use of transit
- Action 3.2** Implement pedestrian improvements in TPAs to increase commuter walking opportunities
- Action 3.3** Implement the City of San Diego’s Bicycle Master Plan to increase commuter bicycling opportunities
- Action 3.6** Implement transit-oriented development within Transit Priority Areas (TPAs)

# Mode Share

Daily\*

Peak Commute\*

■ Vehicle ■ Transit ■ Active Transportation ■ Other

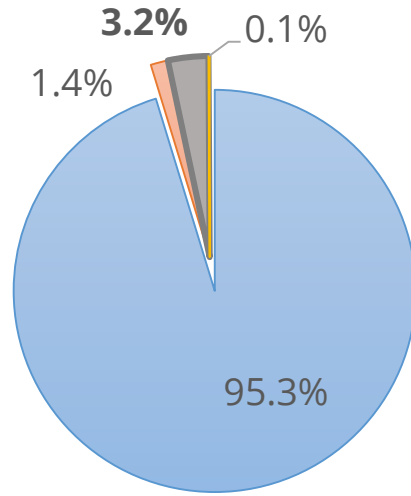

Base Year (2012)

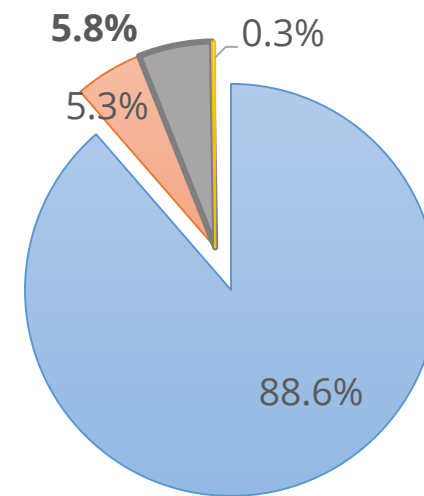

Adopted (2050)

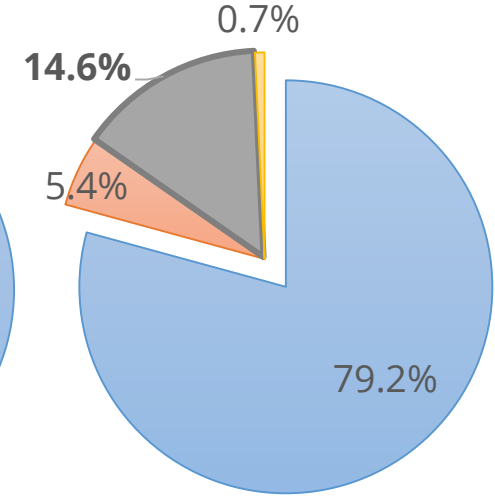

CPU (2050)

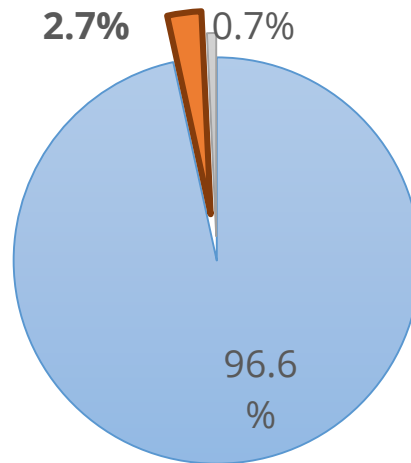

Base Year (2012)

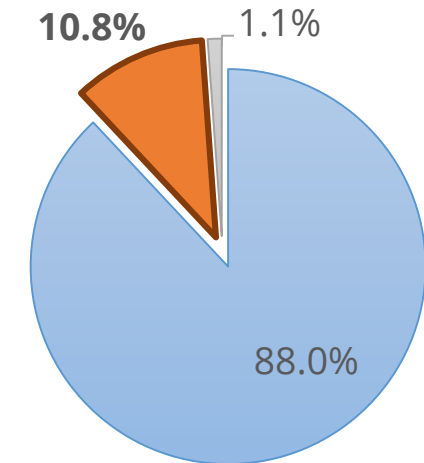

Adopted (2050)

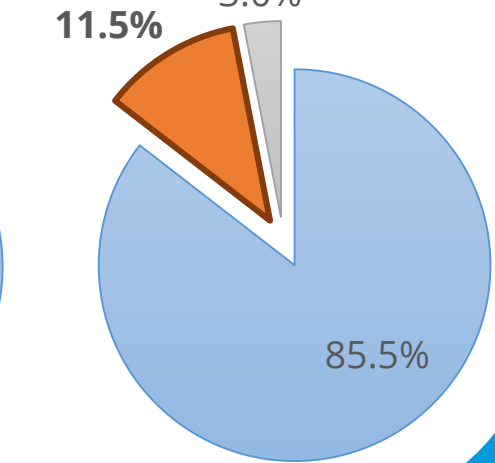

CPU (2050)

\* Data represents only Kearny Mesa Community

# Commute Trip Length

Base Year vs. CPU	Change in Average Commute Trip Length*
Citywide	5.3-mile reduction
Community	4.7-mile reduction



**Target:** Reduce average vehicle commute distance by 2 miles

\* Data represents comparison with City's Base Year VMT per Employee

# Vehicle Miles Traveled (VMT)

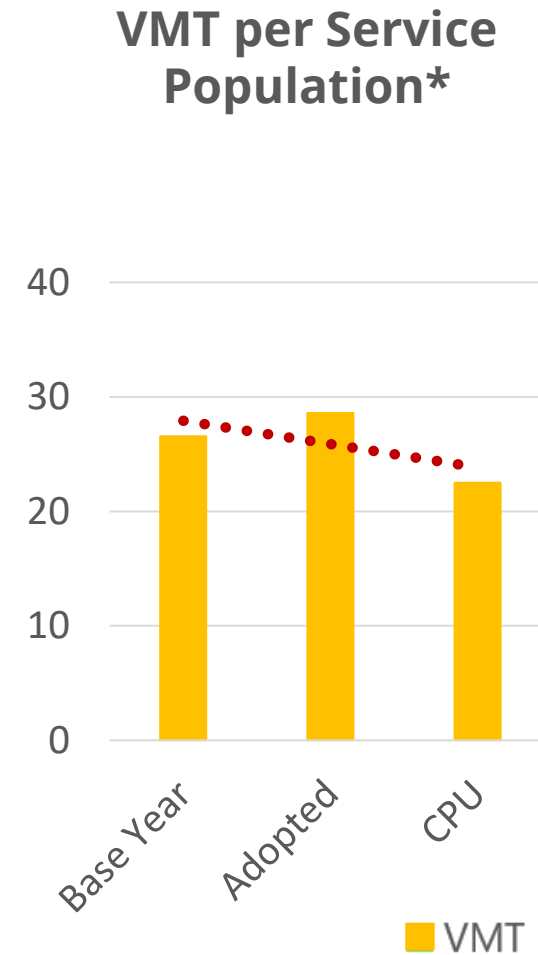
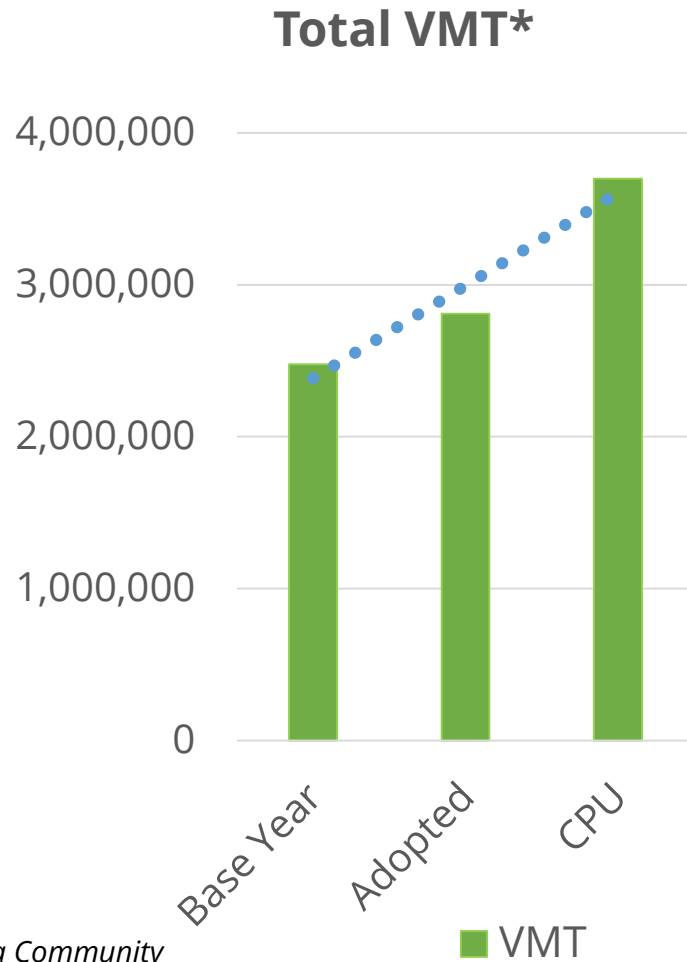

\* Data represents only Kearny Mesa Community

# VMT Efficiency Metrics\*

### Resident VMT per Capita

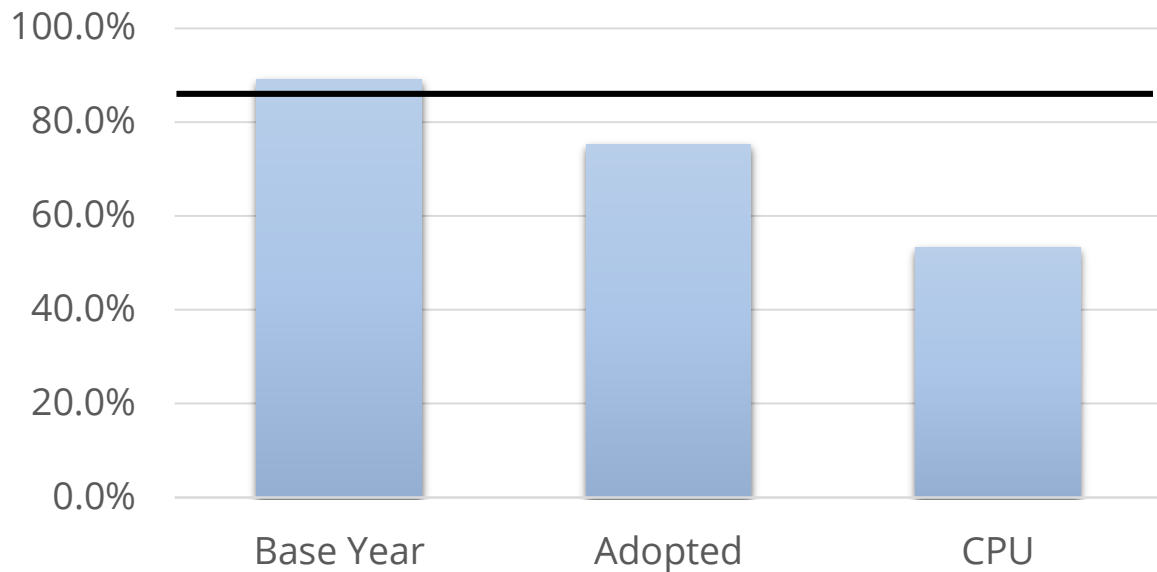

### Employee VMT per Employee

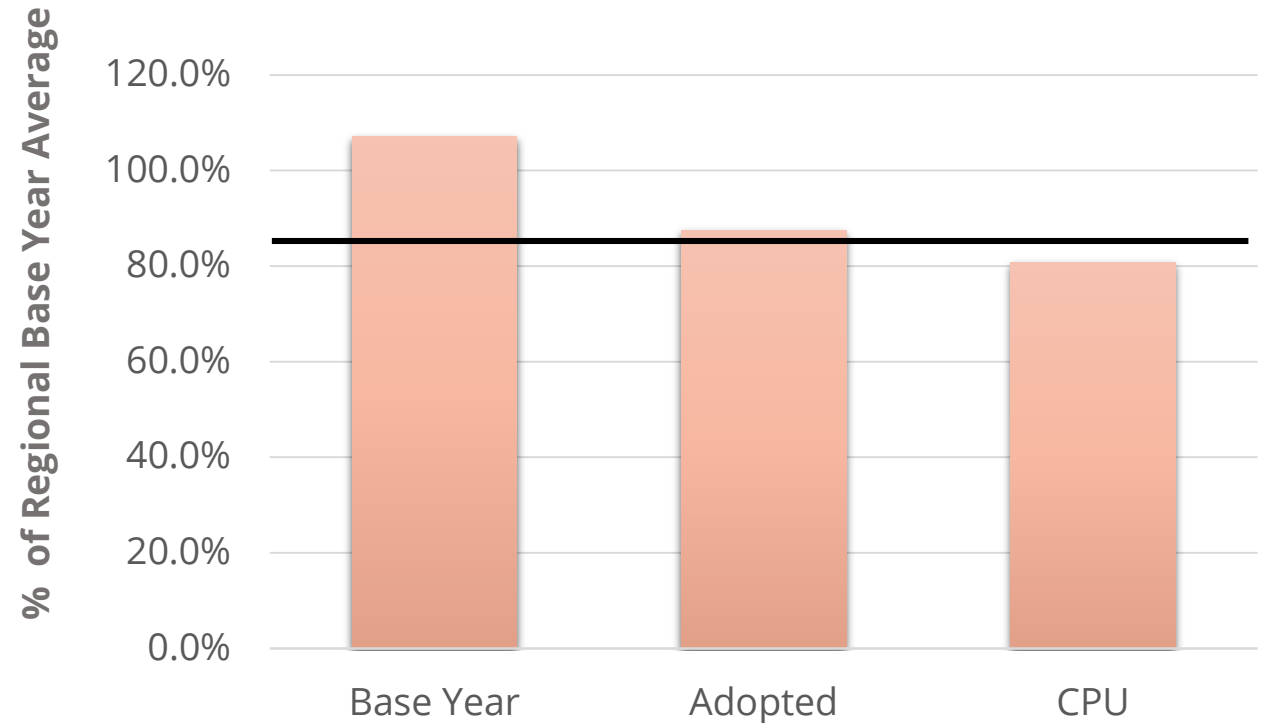

— 85% Threshold

\* Data represents only Kearny Mesa Community

# Spotlight on: Convoy Corridor



Clairemont Mesa Blvd



## Pan-Asian cultural celebration through identity, placemaking and design

Celebrate the Pan-Asian cultural identity of the Convoy Corridor through a unique design that enhances placemaking with culturally-referencing or complimentary themes, colors, and branding. Incorporate modern design techniques that take cues from Pan-Asian cultures can further energize the area as a destination unto itself.

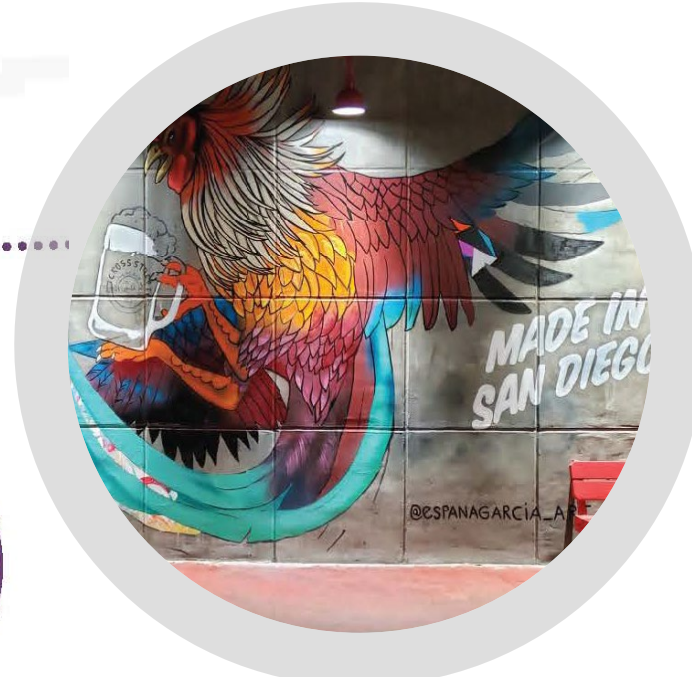
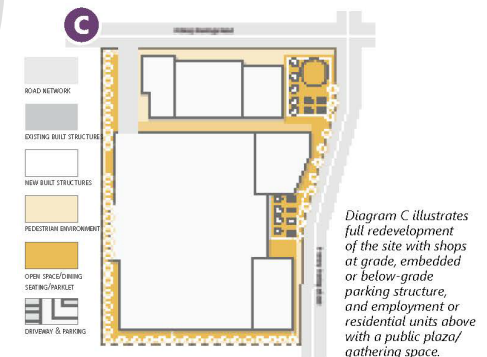
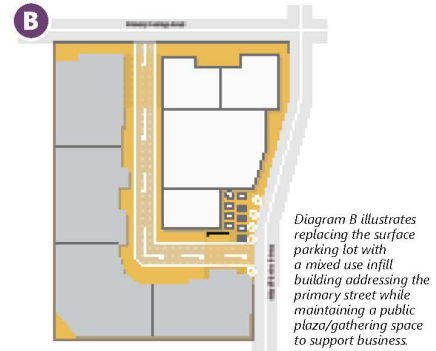
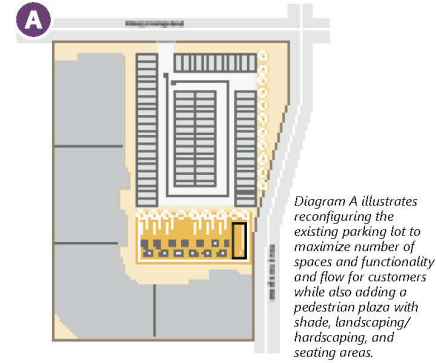

Figure 19: Adaptable Development



- ROAD NETWORK
- EXISTING BUILT STRUCTURES
- NEW BUILT STRUCTURES
- PEDESTRIAN ENVIRONMENT
- OPEN SPACE/BIKING SURFING/WALKLET
- DRIVEWAY & PARKING

# Parks, Recreation, and Open Space

*A parks and open space network that combines the best qualities of urban and natural spaces, connects community assets, and encourages people to engage with their surrounding community and environment.*

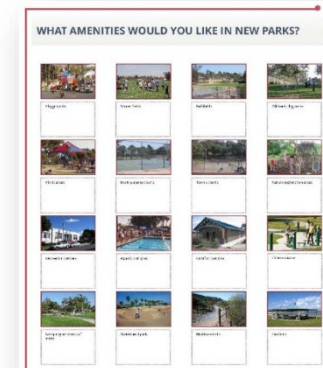



**Park Needs  
for  
Population**

**Opportunity  
Sites**

Proposed Parks,  
Recreation Centers,  
and Aquatic  
Complexes  
*Figure 27*

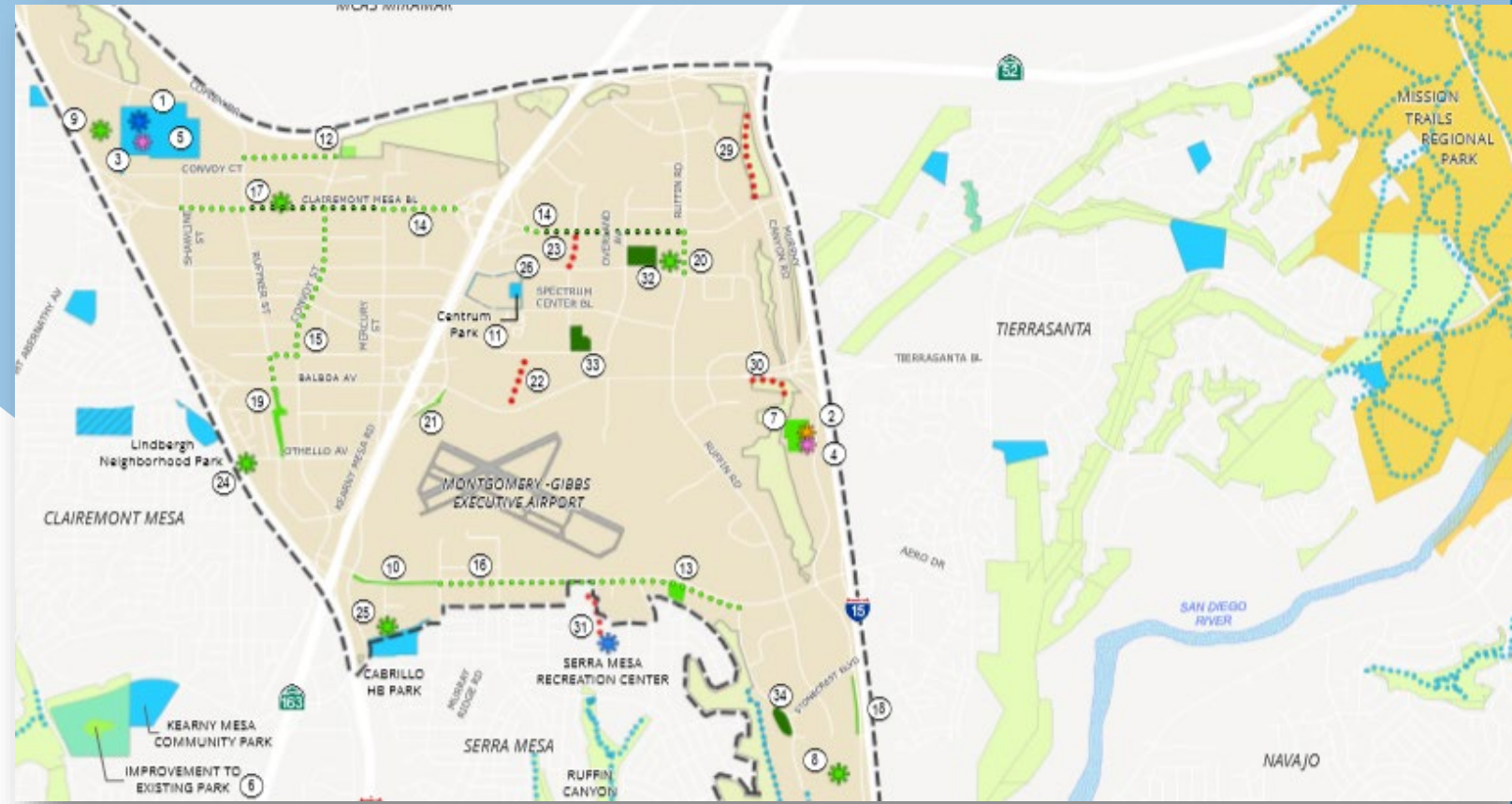

Planned  
Facilities

Recreational  
Value



## North and West

- Hickman Field approved General Development Plan
- Connections to Clairemont with Othello Bridge Park and improvements to Kearny Mesa Community Park
- New recreation facilities within developments in the Convoy and Clairemont Mesa Corridors

## South

- Aero Promenade linear park
- Aero Park
- Murphy Canyon Bike Path/Trailhead



# Aero Promenade Neighborhood Linear Park on City Right-of-way

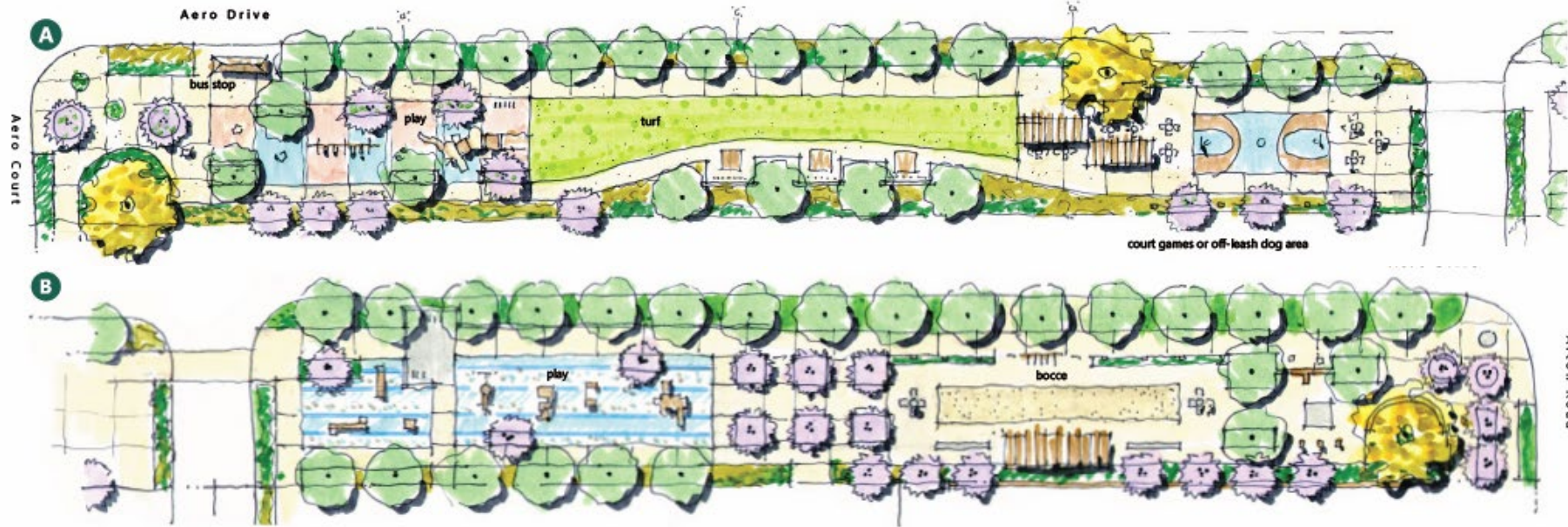

# Draft Community Plan

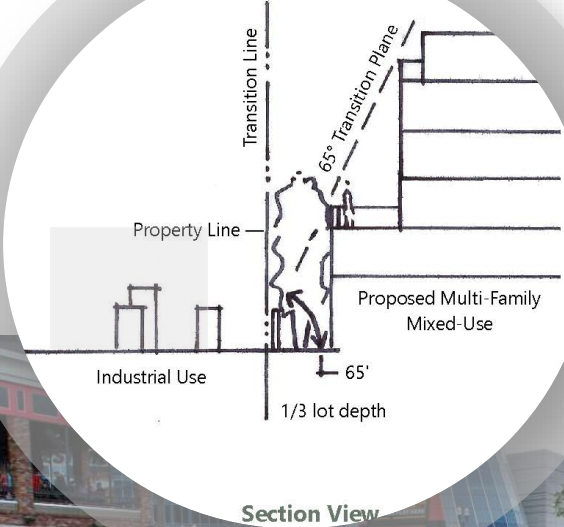

- Revisions for July 2020 Draft Community Plan
- Coordination with Transportation and Storm Water, Park and Recreation, and Development Services Departments; San Diego County Regional Airport Authority; and Caltrans



# Environmental Impact Report

- A Notice of Preparation (NOP) for the PEIR was issued on November 9, 2018
- The Draft PEIR was made available for a 45-day public review beginning March 17, 2020
- Final PEIR includes responses to comments

# Community Planning Group Recommendation

- The Kearny Mesa Community Planning Group voted 11-2-0 to support the Kearny Mesa Community Plan Update

# Advisory Board Recommendations

- The Mobility Board voted 9-1-0 to support the Kearny Mesa Community Plan Update
- The Park and Recreation Board voted 6-1-0 to support the Parks, Recreation, and Open Space section of the Kearny Mesa Community Plan Update
- The Historical Resources Board voted 9-0-0 to recommend the Kearny Mesa Cultural Resources Constraints Analysis, Historic Context Statement, the Historic Preservation section of the Kearny Mesa Community Plan, and the Program Environmental Impact Report related to Cultural/Historical Resources

# Recommendation to the City Council

1. CERTIFICATION of Program Environmental Impact Report No. 607857/Sch. No. 2018111024
2. APPROVAL of a resolution adopting the Kearny Mesa Community Plan and amending the General Plan
3. APPROVAL of resolution repealing the StoneCrest Specific Plan
4. APPROVAL of an ordinance amending the Land Development Code Chapter 13, Article 1, Division 5; Chapter 13, Article 1, Division 6; and Chapter 13, Article 2, Division 14 and amending the City's certified Local Coastal Program
5. APPROVAL of an ordinance rezoning land within the Kearny Mesa Community Planning Area consistent with the Kearny Mesa Community Plan

# San Diego Planning Commission Meeting

## **PHONE-IN TESTIMONY PERIOD NOW OPEN FOR** Kearny Mesa Community Plan Update

To call in and make your one minute of public comment on this item:

 **Dial 619-541-6310**

  **Enter Access Code 877861 then press #**

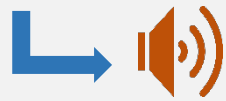

**Listen and wait until you hear,  
"Your phone has been unmuted."**



**When it's your turn, state your name and make your comments. When finished, hang up.**