



THE CITY OF SAN DIEGO



# **ANNUAL REPORT**

## **for Fiscal Year 2027**

# **CAMINO SANTA FE MAINTENANCE ASSESSMENT DISTRICT**

under the provisions of the

**San Diego Maintenance Assessment District Procedural Ordinance  
of the San Diego Municipal Code**

**Prepared For**  
**City of San Diego, California**



**Prepared By**  
**EFS Engineering, Inc.**  
P.O. Box 22370  
San Diego, CA 92192-2370

**May 2026**

# **CITY OF SAN DIEGO**

## **Mayor**

Todd Gloria

## **City Council Members**

Joe LaCava  
District 1 (Council President)

Jennifer Campbell  
District 2

Stephen Whitburn  
District 3

Henry L. Foster III  
District 4

Marni von Wilpert  
District 5

Kent Lee  
District 6 (Council President Pro Tem)

Raul Campillo  
District 7

Vivian Moreno  
District 8

Sean Elo-Rivera  
District 9

## **City Attorney**

Heather Ferbert

## **City Clerk**

Diana J.S. Fuentes

## **Independent Budget Analyst**

Charles Modica

## **Chief Community Services Officer & City Engineer**

Rania Amen

## **Director, Parks & Recreation Department**

Andy Field

# Table of Contents

---

## Annual Report for Fiscal Year 2027

### Camino Santa Fe Maintenance Assessment District

Preamble.....	1
Executive Summary .....	2
Background .....	3
District Boundary .....	3
Project Description .....	3
Separation of General and Special Benefits .....	4
Cost Estimate.....	4
Annual Cost-Indexing .....	4
Method of Apportionment.....	5
Estimated Benefit of the Improvements .....	5
Apportionment Methodology .....	5
Land Use Factor .....	6
Benefit Factor .....	7
Location Factor.....	8
Sample Calculations .....	9
Summary Results.....	10

## EXHIBITS

**Exhibit A:** District Boundary

**Exhibit B:** Estimated Budget – Revenue & Expense Statement  
for Fiscal Year 2027

**Exhibit C:** Preliminary Assessment Roll for Fiscal Year 2027

# Annual Report for Fiscal Year 2027

## Camino Santa Fe

### Maintenance Assessment District

---

#### Preamble

Pursuant to §65.0220 of the “San Diego Maintenance Assessment District Procedural Ordinance” (being Division 2, Article 5, Chapter 6 of the *San Diego Municipal Code*) and City of San Diego Council Resolution No. R-310618 passed on July 22, 2016, authorizing the continued levy of assessments for the life of the CAMINO SANTA FE MAINTENANCE ASSESSMENT DISTRICT (hereinafter referred to as “District”), and in accordance with applicable provisions of “Proposition 218” (being Article XIID of the California Constitution), and provisions of the “Proposition 218 Omnibus Implementation Act” (being California Senate Bill 919) (the aforementioned provisions are hereinafter referred to collectively as “applicable law”), and in accordance with Resolution No. \_\_\_\_\_, adopted by the CITY COUNCIL OF THE CITY OF SAN DIEGO, COUNTY OF SAN DIEGO, STATE OF CALIFORNIA, and in connection with the annual proceedings for the District, EFS Engineering, Inc., as Assessment Engineer to the City of San Diego, submits herewith this annual report for the District as required by §65.0220 of the “San Diego Maintenance Assessment District Procedural Ordinance.”

DATE OF FINAL PASSAGE BY THE CITY OF SAN DIEGO,  
COUNTY OF SAN DIEGO, STATE OF CALIFORNIA, ON THE  
\_\_\_\_\_ DAY OF \_\_\_\_\_, 2026.

---

Diana J.S. Fuentes, CITY CLERK  
CITY OF SAN DIEGO  
STATE OF CALIFORNIA

## Executive Summary

**Project:** Camino Santa Fe  
Maintenance Assessment District

**Apportionment Method:** Equivalent Benefit Unit (EBU)

	<b>FY 2026</b>	<b>FY 2027 <sup>(1)</sup></b>	<b>Maximum <sup>(2)</sup> Authorized</b>
<b>Total Parcels Assessed:</b>	1,044	1,214	--
<b>Total Estimated Assessment:</b>	\$132,734	\$147,851	--
<b>Total Number of EBUs:</b>	1,508.35	1,508.70	--
<i>Zone 1</i>	988.00	988.00	--
<i>Zone 2</i>	520.35	520.70	--
<b>Assessment per EBU: <sup>(3)</sup></b>			
<i>Zone 1</i>	\$88.00	\$98.00	\$895.29 <sup>(4)</sup>
<i>Zone 2</i>	\$88.00	\$98.00	\$895.29 <sup>(4)</sup>

<sup>(1)</sup> FY 2027 is the City's Fiscal Year 2027, which begins July 1, 2026 and ends June 30, 2027. Total Parcels Assessed, Total Estimated Assessment, and assessment apportionment factors may vary from prior fiscal year values due to parcel changes and/or land use re-classifications.

<sup>(2)</sup> Maximum authorized assessment rate subject to cost-indexing as approved by property owners at the time of District formation.

<sup>(3)</sup> Although the Unit Assessment per EBU is the same for Zones 1 and 2, the difference in the Location Factor for each zone results in a tenfold difference in total assessment for equivalent parcels in Zone 1 versus Zone 2.

<sup>(4)</sup> Prior fiscal year's maximum authorized annual assessment rate increased by cost-indexing factor of 6.86%.

**Annual Cost-Indexing:** The maximum authorized assessment rates are cost-indexed and will increase (or decrease) annually based on the annual change in the *San Diego Consumer Price Index for Urban Consumers* (SDCPI-U) plus 3%.

---

## Background

The Camino Santa Fe Maintenance Assessment District (District) was established by the City of San Diego (City) on April 27, 2006 by City Council Resolution R-301615. The purpose of the District was, and still is, to fund specifically identified improvements and activities within the boundary of the District.

In conformity with §65.0221 of the “San Diego Maintenance Assessment District Procedural Ordinance,” the City adopted Resolution No. R-310618 on July 22, 2016, approving the annual budget and assessments for Fiscal Year 2017, and authorizing the levy of the assessments for the life of the District, consistent with the benefit findings and assessment apportionment method contained in the approved formational and all subsequently updated Engineer’s Reports (Engineer’s Reports). The Engineer’s Reports are on file with the City Clerk, and incorporated herein by reference.

The District is authorized and administered under the provisions of the “San Diego Maintenance Assessment District Procedural Ordinance.” This annual report has been prepared pursuant to the requirements of §65.0220 of the “San Diego Maintenance Assessment District Procedural Ordinance.”

---

## District Boundary

The District boundary is generally depicted in **Exhibit A**. The District Boundary Map and Assessment Diagram are on file in the Maintenance Assessment Districts section of the Parks and Recreation Department of the City, and, by reference, are made a part of this annual report.

---

## Project Description

The authorized assessments will be used to fund specifically identified improvements and activities within the District. The District improvements and activities generally consist of maintenance and servicing of landscaped and hardscaped medians, streetscapes, slopes adjacent to rights-of-way, sidewalks, curb and gutter, and brow ditches in the District. The approximate location of the improvements is generally shown in **Exhibit A**.

For additional detail as to the location, type of improvements, and activities performed by the District, please refer to the maps, improvement plans, engineering drawings, maintenance specifications, the Engineer’s Reports and other associated documents on file with the Maintenance Assessment Districts section of the Parks and Recreation

Department of the City. These documents, collectively, are incorporated herein by reference and made part of this annual report.

---

## Separation of General and Special Benefits

The identified improvements and activities provide benefits to the parcels located within the District. These benefits are “special benefits” to the extent that they are above and beyond the City’s standard level of service, and exclusive of those “general benefits” provided to the public at large or properties located outside the District. By law, only “special benefits” are assessable.

The assessments presented in this annual report are based on the cost of improvements and activities determined to provide “special benefits” in accordance with the Engineer’s Reports. For additional detail relative to the separation and quantification of general and special benefits for the District, please refer to the Engineer’s Reports, on file with the Maintenance Assessment Districts section of the Parks and Recreation Department of the City.

---

## Cost Estimate

The estimated annual budget (Revenue & Expense Statement) is included as **Exhibit B**. The “Other Contributions (Non Assessment Source)” revenue contained in the budget includes the value of improvements and activities determined to provide “general benefits.” The District budget with full detail is available for public reference in the Maintenance Assessment Districts section of the Parks and Recreation Department of the City.

### Annual Cost-Indexing

The maximum authorized assessment set forth in the Engineer’s Reports is permitted to increase annually based on the published change in the “San Diego Consumer Price Index for Urban Consumers” (SDCPI-U) plus 3%. The annual change in second half SDCPI-U values, as compiled by the *U.S. Bureau of Labor Statistics* (see [www.bls.gov](http://www.bls.gov)), for the prior year period was from 375.656 to 390.166 (a 3.86% increase). In accordance with the approved cost-indexing provisions, the maximum authorized assessment rate has been increased by 6.86%.

---

## Method of Apportionment

### Estimated Benefit of the Improvements

The District improvements and activities are primarily located along the major north-south arterial transportation corridor in the area. The Transportation Element and the Carroll Canyon Master Plan Element of the Mira Mesa Community Plan, and the general policy recommendations found in the City's General Plan establish several goals and guidelines for the planned development of the community. The District improvements and activities are consistent with these goals.

The major and arterial streets within the District are the backbone of the street network within the community. These streets serve as the primary access routes for inter-community and intra-community trips and thus serve all parcels within the District. All parcels within the District benefit from the enhanced Camino Santa Fe transit corridor through increased community aesthetics and greater public safety.

As indicated on **Exhibit A**, the District has been divided into two zones for benefit apportionment purposes. The two zones are generally described as follows:

- ◆ **Zone 1** includes that portion of the District immediately adjacent to the recently improved section of Camino Santa Fe as well as those parcels along Miratech Drive and Summers Ridge Road.
- ◆ **Zone 2** includes all of the remaining parcels within the District boundaries.

### Apportionment Methodology

The total cost associated with District improvement and activities will be assessed to the various parcels in the District in proportion to the estimated Equivalent Benefit Units (EBUs) assigned to a parcel in relationship to the total EBUs of all the parcels in the District.

EBUs for each parcel have been determined as a function of three factors – a Land Use Factor, a Benefit Factor and a Location Factor – related as shown in the following equation:

$$\text{EBUs} = (\text{Acres or Units}) \times \text{Land Use Factor} \times \text{Benefit Factor} \times \text{Location Factor}$$

Each of these factors is discussed below. Parcels determined to receive no benefit from the District improvements and activities have been assigned zero EBUs.

## Land Use Factor

Since the proposed District improvements and activities are primarily associated with the Transportation Element of the General and Community Plans, trip generation rates for various land use categories (as previously established by the City’s Transportation Planning Section) have been used as the primary basis for the development of Land Use Factors. While these trip generation rates address vehicular trips, they are also considered to approximately reflect relative trip generation for other modes of transportation (e.g., pedestrian trips, bicycle trips, etc.), and are considered the best available information for these other transportation modes.

Trip generation rates provide the required nexus and basis for assigning relative proportionality of potential benefit to the various land use/zoning classifications (as defined by the City’s Municipal Code) within the District. Land use/zoning classifications have been grouped with averaged trip generation rates assigned to establish the Land Use Factors as shown in **Table 1**.

**TABLE 1: Land Use Factors**

Land Use/Zoning	Code	Land Use Factor <sup>(1)</sup>
Residential – Single Family (detached)	SFD	1.0 per dwelling unit
Residential – Condominium	CND	0.7 per dwelling unit
Residential – Multi-Family & Apartment	MFR	0.7 per dwelling unit
Commercial – Office & Retail	COM	45.0 per acre
Small Commercial	SCOM	30.0 per acre
Mining	MIN	7.5 per acre
Open Space (designated)	OSP	0 per acre
Street/Roadway	STR	0.0 per acre
Vacant	VAC	0 per acre

<sup>(1)</sup> Proportional to trip generation rates contained in the City of San Diego *Trip Generation Manual* dated May 2003.

Designated Open Space serves primarily to preserve natural landscape and habitat. While access for study and passive recreation is often permitted, these activities are allowed only to the extent they are consistent with the primary purpose of natural preservation. Since this land is essentially “unused” in the customary terms of land use (which relate to human use and development), the trip generation rate is zero. Therefore, the designated Open Space itself receives no benefit from the District improvements and activities and has been assigned a Land Use Factor of zero.

## **Benefit Factor**

The Land Use Factor described above establishes a proportionality of relative intensity of use (or potential use) for the various parcels of land within the District. It does not address the relationship of this use to the specific District improvements and activities. This relationship is reflected in the Benefit Factor utilized in the assessment methodology.

In determining the Benefit Factor for each land use category, the subcomponents of the benefits of District improvements and activities may include some or all of the following: public safety, view corridors and aesthetics, enhancement of commercial identity, drainage corridors, and recreational potential. The components used for this District are public safety and aesthetics.

As Benefit Factors and their subcomponents are intended to reflect the particular relationships between specific land uses within a district and the specific District improvements and activities, Benefit Factors will generally vary from one district to another, based on the specific character and nature of the applicable land uses and District improvements and activities.

For a given land use, the overall Benefit Factor is equal to the sum of the subcomponent values. If a land use category receives no benefit from a subcomponent, then a value of zero is assigned to that subcomponent. A composite Benefit Factor of 1.0 indicates that full benefit is received. A value less than 1.0 indicates that less than full benefit is received. The applicable benefit subcomponents and resultant composite Benefit Factors determined for the various Land Use/Zoning categories within this District are as shown in **Table 2**.

**TABLE 2: Benefit Factors by Land Use**

<b>Land Use/Zoning</b>	<b>Public Safety (Max. 0.3)</b>	<b>Aesthetics (Max. 0.7)</b>	<b>Benefit Factor (Max. 1.0)</b>
Residential – All	0.3	0.7	1.0
Commercial – Office & Retail	0.3	0.3	0.6
Small Commercial	0.3	0.3	0.6
Mining	0.3	0	0.3
Open Space (designated)	0.3	0	0.3
Street/Roadway	0.3	0	0.3
Vacant	0.3	0	0.3

**Public Safety.** All land uses are considered to receive the maximum available benefit from the public safety aspect of the District improvements and activities. Public safety is essential to all land uses, and even to lands, such as designated Open Space, held in stewardship with only incidental human use.

**Aesthetics.** The degree of benefit received from the aesthetic qualities of landscaped and hardscaped roadway medians, rights-of-ways, vegetated sloped, and open space maintained by the District varies among land use categories. Generally, by nature of their use, residential lands receives the greatest benefit from the reduced traffic congestion, reduced noise levels, greater separation from traffic and generally more tranquil environment provided by landscaped and hardscaped roadway medians and rights-of-way. Commercial and institutional uses, on the other hand, often thrive on higher densities, greater traffic access, and a higher level of activity within the vicinity of their enterprises. These uses, accordingly, receive a lesser degree of benefit from the general insulation and separation provided by the aesthetic elements of District improvements and activities.

Lands in the Open Space, Vacant, and Mining categories are considered to receive no significant benefit from the aesthetic elements of District improvements and activities, as enhanced aesthetic quality of other lands in their vicinity does not affect their function, use, or value.

**Location Factor**

The Location Factor accounts for the fact that not all parcels within the District receive the same benefit due to the location of the improvements and activities. Location Factors may vary between zero (no benefit) and one (full benefit) as shown in **Table 3**.

**TABLE 3: Location Factor by Zone**

Land Use/Zoning	Location Factor
Zone 1	1.0
Zone 2	0.1

Zone 1 is established as the base zone and is assigned a Location Factor of 1.0. Zone 2 parcels receive a lesser degree of benefit in proportion to the parcels in Zone 1. Accordingly, Zone 2 has been assigned a Location Factor of 0.1.

## Sample Calculations

As described above, the number of Equivalent Benefit Units (EBUs) assigned to each parcel in the District has been calculated based on each parcel's land use and the identified apportionment factors, as shown in the following equation:

$$\text{EBUs} = (\text{Acres or Units}) \times \text{Land Use Factor} \times \text{Benefit Factor} \times \text{Location Factor}$$

Shown below are sample EBU calculations for several common land uses found in the District.

- **10-acre Mining Property in Zone 1**

$$\text{EBUs} = 10.00 \text{ acres} \times 7.50 \times 0.30 \times 1.00 = 22.50 \text{ EBUs}$$

- **5-acre Commercial Property in Zone 2**

$$\text{EBUs} = 5.00 \text{ acres} \times 45.00 \times 0.60 \times 0.10 = 13.50 \text{ EBUs}$$

The total assessment for each parcel in the District is based on the calculated EBUs for the parcel and the applicable unit assessment rate, as shown in the following equation:

$$\text{Total Assessment} = \text{Total EBUs} \times \text{Unit Assessment Rate}$$

Based on the above formula, the EBUs calculated for each property, can be found in the Assessment Roll (**Exhibit C**).

---

## Summary Results

The District Boundary is presented in **Exhibit A**.

An estimate of the annual costs of the improvements and activities provided by the District is included as **Exhibit B**.

The assessment methodology utilized is as described in the text of this annual report. Based on this methodology, the assessments for each parcel were calculated and are shown in the Preliminary Assessment Roll (**Exhibit C**).

Each lot or parcel of land within the District has been identified by unique County Assessor's Parcel Number in the Preliminary Assessment Roll and on the Boundary Map and Assessment Diagram referenced herein.

This annual report has been prepared and respectfully submitted by:

EFS ENGINEERING, INC.



*Eugene F. Shank*

Eugene F. Shank, PE

C 52792

*Sharon F. Risse*

Sharon F. Risse

# **EXHIBIT A**

**District Boundary**

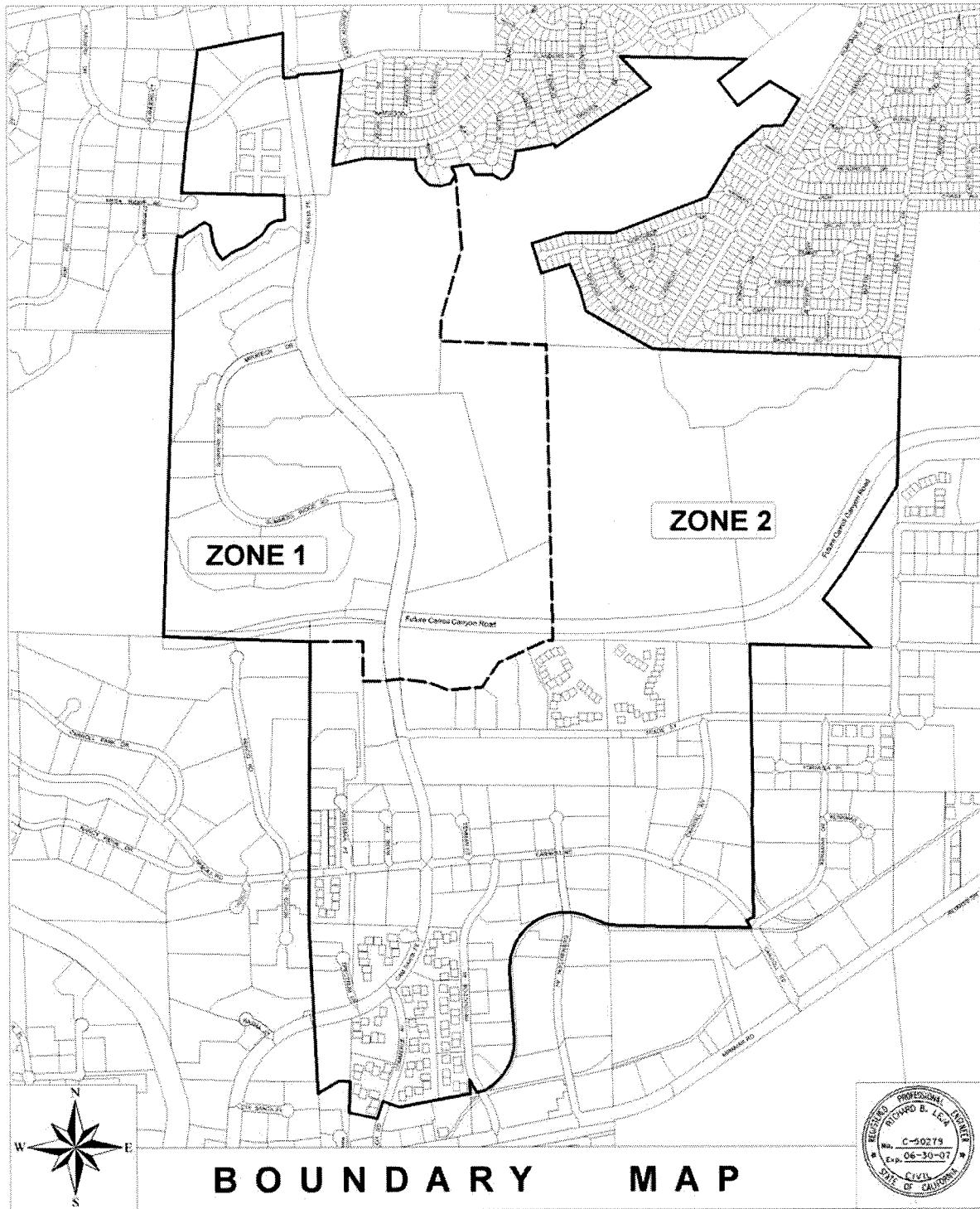

# BOUNDARY MAP

FILED IN THE OFFICE OF THE CITY CLERK OF THE CITY OF SAN DIEGO, STATE OF CALIFORNIA, THIS \_\_\_\_\_ DAY OF \_\_\_\_\_, 2006.

ELIZABETH MALAND, CITY CLERK  
CITY OF SAN DIEGO  
STATE OF CALIFORNIA

PREPARED BY:  
ENGINEERING & CAPITAL PROJECTS  
1000 Camino del Rio North, Suite 1000, San Diego, CA 92108

I HEREBY CERTIFY THAT THE WITHIN MAP SHOWING PROPOSED BOUNDARIES OF CAMINO SANTA FE MAINTENANCE ASSESSMENT DISTRICT, CITY OF SAN DIEGO, STATE OF CALIFORNIA, WAS APPROVED BY THE CITY COUNCIL AT A REGULAR MEETING THEREOF, HELD ON THE \_\_\_\_\_ DAY OF \_\_\_\_\_, 2006, BY ITS RESOLUTION NO. \_\_\_\_\_

NOTE:  
FOR A DETAILED DESCRIPTION OF THE LINES AND DIMENSIONS OF LOTS OR PARCELS SHOWN ON THIS MAP, REFER TO THE COUNTY ASSESSOR'S MAP WHICH SHALL GOVERN WITH RESPECT TO ALL DETAILS CONCERNING THE LINES AND DIMENSIONS OF SUCH LOTS OR PARCELS.

AN ASSESSMENT WAS LEVIED BY THE CITY COUNCIL OF THE CITY OF SAN DIEGO ON THE LOTS, PIECES, AND PARCELS OF LAND SHOWN ON THIS ASSESSMENT DIAGRAM SAID ASSESSMENT WAS LEVIED ON THE \_\_\_\_\_ DAY OF \_\_\_\_\_, 2006. SAID ASSESSMENT DIAGRAM AND THE OFFICE OF THE SUPERINTENDENT OF STREETS OF THE CITY OF SAN DIEGO, STATE OF CALIFORNIA ON THE \_\_\_\_\_ DAY OF \_\_\_\_\_, 2006. REFERENCE IS MADE TO THE ASSESSMENT ROLL RECORDER IN THE OFFICE OF THE SUPERINTENDENT OF STREETS FOR THE EXACT AMOUNT OF EACH ASSESSMENT LEVIED AGAINST EACH PARCEL OF LAND SHOWN ON THIS ASSESSMENT DIAGRAM.

NOTE:  
REFER TO THE ENGINEER'S REPORT & REFERENCED DOCUMENTS FOR EXACT LOCATIONS OF IMPROVEMENTS.

**Legend**

- Future Camino Canyon Rd
- Zone 1
- Zone 2



**CITY OF  
SAN DIEGO**

ING	_____
DATE	_____
REVS	_____

**CAMINO SANTA FE  
MAINTENANCE ASSESSMENT DISTRICT**

**EXHIBIT A**

# **EXHIBIT B**

**Estimated Budget – Revenue & Expense Statement  
for Fiscal Year 2027**

**EXHIBIT B****REVENUE AND EXPENSE STATEMENT****Camino Santa Fe Maintenance Assessment District  
Fund 200081**

	<b>FY 2025 ACTUALS</b>	<b>FY 2026 ESTIMATE</b>	<b>FY 2027 PROPOSED</b>
<b>BEGINNING FUND BALANCE</b>			
Surplus (or Deficit from Prior Year)	\$ 191,528.48	\$ 162,231.24	\$ 111,214.62
<b>TOTAL BEGINNING FUND BALANCE</b>	<b>\$ 191,528.48</b>	<b>\$ 162,231.24</b>	<b>\$ 111,214.62</b>
<b>REVENUE</b>			
Assessment Revenue	\$ 91,052.62	\$ 105,959.00	\$ 147,851.00
Interest	\$ 7,583.30	\$ 800.00	\$ 800.00
Other Contributions (Non Assessment Source)	\$ 57,386.00	\$ 59,432.38	\$ 66,326.00
<b>TOTAL REVENUE</b>	<b>\$ 156,021.92</b>	<b>\$ 166,191.38</b>	<b>\$ 214,977.00</b>
<b>TOTAL BEGINNING FUND BALANCE &amp; REVENUE</b>	<b>\$ 347,550.40</b>	<b>\$ 328,422.62</b>	<b>\$ 326,191.62</b>
<b>OPERATING EXPENSE</b>			
Landscaping Improvements and Activities <sup>(1)</sup>	\$ 130,707.80	\$ 140,115.00	\$ 167,290.00
Tree Services	\$ 27,025.36	\$ 30,000.00	\$ 30,000.00
Special Districts Administrative Cost	\$ 27,586.00	\$ 47,093.00	\$ 48,606.00
<b>TOTAL OPERATING EXPENSE</b>	<b>\$ 185,319.16</b>	<b>\$ 217,208.00</b>	<b>\$ 245,896.00</b>
<b>TOTAL EXPENSE</b>	<b>\$ 185,319.16</b>	<b>\$ 217,208.00</b>	<b>\$ 245,896.00</b>
<b>TOTAL ENDING FUND BALANCE</b>	<b>\$ 162,231.24</b>	<b>\$ 111,214.62</b>	<b>\$ 80,295.62</b>
<b>NET ANNUAL REVENUE (OR EXPENSE)</b>	<b>\$ (29,297.24)</b>	<b>\$ (51,016.62)</b>	<b>\$ (30,919.00)</b>

<sup>(1)</sup> Includes related supplies and utility costs.

*The District budget with full detail is available for public reference in the Maintenance Assessment Districts section of the Parks and Recreation Department of the City of San Diego.*

# **EXHIBIT C**

**Preliminary Assessment Roll  
for Fiscal Year 2027**

**EXHIBIT C - Assessment Roll (Fiscal Year 2027)**  
**Camino Santa Fe Maintenance Assessment District**

Parcel Number	Acres/ Units <sup>(1)</sup>	Zone Number	Land Use <sup>(2)</sup>	Apportionment Factors			Total EBU's	Unit Cost (\$/EBU)	FY 2027 <sup>(5)</sup> Assessment	Owner Name
				Land Use <sup>(2)</sup>	Benefit <sup>(3)</sup>	Location <sup>(4)</sup>				
341 040 40 00	2.36	1	VAC	0.00	0.30	1.00	0.00	\$98.00	\$0.00	
341 041 18 00	1.53	2	COM	45.00	0.60	0.10	4.13	\$98.00	\$404.84	
341 041 27 00	3.89	2	COM	45.00	0.60	0.10	10.50	\$98.00	\$1,029.28	
341 041 37 00	3.78	1	OSP	0.00	0.30	1.00	0.00	\$98.00	\$0.00	
341 050 32 00	19.10	2	VAC	0.00	0.30	0.10	0.00	\$98.00	\$0.00	
341 050 43 00	4.95	1	VAC	0.00	0.30	1.00	0.00	\$98.00	\$0.00	
341 050 46 00	2.85	2	VAC	0.00	0.30	0.10	0.00	\$98.00	\$0.00	
341 050 51 00	0.06	2	VAC	0.00	0.30	0.10	0.00	\$98.00	\$0.00	
341 050 52 00	12.69	2	OSP	0.00	0.30	0.10	0.00	\$98.00	\$0.00	
341 050 53 00	5.00	2	OSP	0.00	0.30	0.10	0.00	\$98.00	\$0.00	
341 050 54 00	0.92	2	OSP	0.00	0.30	0.10	0.00	\$98.00	\$0.00	
341 050 56 00	23.18	2	OSP	0.00	0.30	0.10	0.00	\$98.00	\$0.00	
341 050 57 00	10.46	2	VAC	0.00	0.30	0.10	0.00	\$98.00	\$0.00	
341 050 58 00	12.95	2	VAC	0.00	0.30	0.10	0.00	\$98.00	\$0.00	
341 050 59 00	0.04	2	OSP	0.00	0.30	0.10	0.00	\$98.00	\$0.00	
341 051 24 00	0.28	1	OSP	0.00	0.30	1.00	0.00	\$98.00	\$0.00	
341 051 25 00	0.15	1	OSP	0.00	0.30	1.00	0.00	\$98.00	\$0.00	
341 051 26 00	5.57	2	OSP	0.00	0.30	0.10	0.00	\$98.00	\$0.00	
341 051 27 00	0.96	2	OSP	0.00	0.30	0.10	0.00	\$98.00	\$0.00	
341 051 28 00	11.00	1	OSP	0.00	0.30	1.00	0.00	\$98.00	\$0.00	
341 051 28 00	57.86	2	OSP	0.00	0.30	0.10	0.00	\$98.00	\$0.00	
341 051 29 00	7.75	1	OSP	0.00	0.30	1.00	0.00	\$98.00	\$0.00	
341 051 30 00	7.19	2	OSP	0.00	0.30	0.10	0.00	\$98.00	\$0.00	
341 052 01 00	9.02	1	VAC	0.00	0.30	1.00	0.00	\$98.00	\$0.00	
341 052 02 00	1.24	1	STR	0.00	0.30	1.00	0.00	\$98.00	\$0.00	
341 052 03 00	1.72	1	OSP	0.00	0.30	1.00	0.00	\$98.00	\$0.00	
341 052 04 00	0.85	1	OSP	0.00	0.30	1.00	0.00	\$98.00	\$0.00	
341 052 05 00	0.41	1	OSP	0.00	0.30	1.00	0.00	\$98.00	\$0.00	
341 052 06 00	0.15	2	OSP	0.00	0.30	0.10	0.00	\$98.00	\$0.00	
341 052 07 00	0.53	2	OSP	0.00	0.30	0.10	0.00	\$98.00	\$0.00	
341 052 08 00	0.71	2	OSP	0.00	0.30	0.10	0.00	\$98.00	\$0.00	
341 052 09 00	0.28	2	STR	0.00	0.30	0.10	0.00	\$98.00	\$0.00	
341 052 10 00	2.44	2	OSP	0.00	0.30	0.10	0.00	\$98.00	\$0.00	
341 052 11 00	3.45	2	OSP	0.00	0.30	0.10	0.00	\$98.00	\$0.00	
341 052 12 00	0.64	2	OSP	0.00	0.30	0.10	0.00	\$98.00	\$0.00	
341 052 13 00	0.71	2	OSP	0.00	0.30	0.10	0.00	\$98.00	\$0.00	
341 052 14 00	0.98	2	VAC	0.00	0.30	0.10	0.00	\$98.00	\$0.00	
341 052 15 00	1.97	2	MIN	7.50	0.30	0.10	0.44	\$98.00	\$43.44	
341 052 16 00	0.17	2	STR	0.00	0.30	0.10	0.00	\$98.00	\$0.00	
341 052 17 00	0.42	1	OSP	0.00	0.30	1.00	0.00	\$98.00	\$0.00	
341 052 18 00	0.06	1	MIN	7.50	0.30	1.00	0.14	\$98.00	\$13.22	
341 052 19 00	5.79	1	OSP	0.00	0.30	1.00	0.00	\$98.00	\$0.00	
341 052 20 00	0.29	1	MIN	7.50	0.30	1.00	0.65	\$98.00	\$63.94	
341 052 21 00	1.03	1	OSP	0.00	0.30	1.00	0.00	\$98.00	\$0.00	
341 052 22 00	7.02	1	MIN	7.50	0.30	1.00	15.80	\$98.00	\$1,547.90	
341 052 23 00	0.05	1	MIN	7.50	0.30	1.00	0.11	\$98.00	\$11.02	
341 053 01 01	1.00	2	CND	0.70	1.00	0.10	0.07	\$98.00	\$6.86	
341 053 01 02	1.00	2	CND	0.70	1.00	0.10	0.07	\$98.00	\$6.86	
341 053 01 03	1.00	2	CND	0.70	1.00	0.10	0.07	\$98.00	\$6.86	
341 053 01 04	1.00	2	CND	0.70	1.00	0.10	0.07	\$98.00	\$6.86	
341 053 01 05	1.00	2	CND	0.70	1.00	0.10	0.07	\$98.00	\$6.86	
341 053 01 06	1.00	2	CND	0.70	1.00	0.10	0.07	\$98.00	\$6.86	
341 053 01 07	1.00	2	CND	0.70	1.00	0.10	0.07	\$98.00	\$6.86	
341 053 01 08	1.00	2	CND	0.70	1.00	0.10	0.07	\$98.00	\$6.86	
341 053 01 09	1.00	2	CND	0.70	1.00	0.10	0.07	\$98.00	\$6.86	
341 053 01 10	1.00	2	CND	0.70	1.00	0.10	0.07	\$98.00	\$6.86	
341 053 01 11	1.00	2	CND	0.70	1.00	0.10	0.07	\$98.00	\$6.86	
341 053 01 12	1.00	2	CND	0.70	1.00	0.10	0.07	\$98.00	\$6.86	
341 053 01 13	1.00	2	CND	0.70	1.00	0.10	0.07	\$98.00	\$6.86	
341 053 01 14	1.00	2	CND	0.70	1.00	0.10	0.07	\$98.00	\$6.86	
341 053 01 15	1.00	2	CND	0.70	1.00	0.10	0.07	\$98.00	\$6.86	
341 053 01 16	1.00	2	CND	0.70	1.00	0.10	0.07	\$98.00	\$6.86	
341 053 01 17	1.00	2	CND	0.70	1.00	0.10	0.07	\$98.00	\$6.86	
341 053 01 18	1.00	2	CND	0.70	1.00	0.10	0.07	\$98.00	\$6.86	
341 053 01 19	1.00	2	CND	0.70	1.00	0.10	0.07	\$98.00	\$6.86	
341 053 01 20	1.00	2	CND	0.70	1.00	0.10	0.07	\$98.00	\$6.86	

**EXHIBIT C - Assessment Roll (Fiscal Year 2027)**  
**Camino Santa Fe Maintenance Assessment District**

Parcel Number	Acres/ Units <sup>(1)</sup>	Zone Number	Land Use <sup>(2)</sup>	Apportionment Factors			Total EBU's	Unit Cost (\$/EBU)	FY 2027 <sup>(5)</sup> Assessment	Owner Name
				Land Use <sup>(2)</sup>	Benefit <sup>(3)</sup>	Location <sup>(4)</sup>				
341 053 01 21	1.00	2	CND	0.70	1.00	0.10	0.07	\$98.00	\$6.86	
341 053 01 22	1.00	2	CND	0.70	1.00	0.10	0.07	\$98.00	\$6.86	
341 053 01 23	1.00	2	CND	0.70	1.00	0.10	0.07	\$98.00	\$6.86	
341 053 01 24	1.00	2	CND	0.70	1.00	0.10	0.07	\$98.00	\$6.86	
341 053 01 25	1.00	2	CND	0.70	1.00	0.10	0.07	\$98.00	\$6.86	
341 053 01 26	1.00	2	CND	0.70	1.00	0.10	0.07	\$98.00	\$6.86	
341 053 01 27	1.00	2	CND	0.70	1.00	0.10	0.07	\$98.00	\$6.86	
341 053 01 28	1.00	2	CND	0.70	1.00	0.10	0.07	\$98.00	\$6.86	
341 053 01 29	1.00	2	CND	0.70	1.00	0.10	0.07	\$98.00	\$6.86	
341 053 01 30	1.00	2	CND	0.70	1.00	0.10	0.07	\$98.00	\$6.86	
341 053 01 31	1.00	2	CND	0.70	1.00	0.10	0.07	\$98.00	\$6.86	
341 053 01 32	1.00	2	CND	0.70	1.00	0.10	0.07	\$98.00	\$6.86	
341 053 01 33	1.00	2	CND	0.70	1.00	0.10	0.07	\$98.00	\$6.86	
341 053 01 34	1.00	2	CND	0.70	1.00	0.10	0.07	\$98.00	\$6.86	
341 053 01 35	1.00	2	CND	0.70	1.00	0.10	0.07	\$98.00	\$6.86	
341 053 01 36	1.00	2	CND	0.70	1.00	0.10	0.07	\$98.00	\$6.86	
341 053 01 37	1.00	2	CND	0.70	1.00	0.10	0.07	\$98.00	\$6.86	
341 053 01 38	1.00	2	CND	0.70	1.00	0.10	0.07	\$98.00	\$6.86	
341 053 01 39	1.00	2	CND	0.70	1.00	0.10	0.07	\$98.00	\$6.86	
341 053 01 40	1.00	2	CND	0.70	1.00	0.10	0.07	\$98.00	\$6.86	
341 053 01 41	1.00	2	CND	0.70	1.00	0.10	0.07	\$98.00	\$6.86	
341 053 01 42	1.00	2	CND	0.70	1.00	0.10	0.07	\$98.00	\$6.86	
341 053 01 43	1.00	2	CND	0.70	1.00	0.10	0.07	\$98.00	\$6.86	
341 053 01 44	1.00	2	CND	0.70	1.00	0.10	0.07	\$98.00	\$6.86	
341 053 01 45	1.00	2	CND	0.70	1.00	0.10	0.07	\$98.00	\$6.86	
341 053 01 46	1.00	2	CND	0.70	1.00	0.10	0.07	\$98.00	\$6.86	
341 053 01 47	1.00	2	CND	0.70	1.00	0.10	0.07	\$98.00	\$6.86	
341 053 01 48	1.00	2	CND	0.70	1.00	0.10	0.07	\$98.00	\$6.86	
341 053 01 49	1.00	2	CND	0.70	1.00	0.10	0.07	\$98.00	\$6.86	
341 053 01 50	1.00	2	CND	0.70	1.00	0.10	0.07	\$98.00	\$6.86	
341 053 01 51	1.00	2	CND	0.70	1.00	0.10	0.07	\$98.00	\$6.86	
341 053 01 52	1.00	2	CND	0.70	1.00	0.10	0.07	\$98.00	\$6.86	
341 053 01 53	1.00	2	CND	0.70	1.00	0.10	0.07	\$98.00	\$6.86	
341 053 01 54	1.00	2	CND	0.70	1.00	0.10	0.07	\$98.00	\$6.86	
341 053 01 55	1.00	2	CND	0.70	1.00	0.10	0.07	\$98.00	\$6.86	
341 053 01 56	1.00	2	CND	0.70	1.00	0.10	0.07	\$98.00	\$6.86	
341 053 01 57	1.00	2	CND	0.70	1.00	0.10	0.07	\$98.00	\$6.86	
341 053 01 58	1.00	2	CND	0.70	1.00	0.10	0.07	\$98.00	\$6.86	
341 053 01 59	1.00	2	CND	0.70	1.00	0.10	0.07	\$98.00	\$6.86	
341 053 01 60	1.00	2	CND	0.70	1.00	0.10	0.07	\$98.00	\$6.86	
341 053 01 61	1.00	2	CND	0.70	1.00	0.10	0.07	\$98.00	\$6.86	
341 053 01 62	1.00	2	CND	0.70	1.00	0.10	0.07	\$98.00	\$6.86	
341 053 01 63	1.00	2	CND	0.70	1.00	0.10	0.07	\$98.00	\$6.86	
341 053 01 64	1.00	2	CND	0.70	1.00	0.10	0.07	\$98.00	\$6.86	
341 053 01 65	1.00	2	CND	0.70	1.00	0.10	0.07	\$98.00	\$6.86	
341 053 01 66	1.00	2	CND	0.70	1.00	0.10	0.07	\$98.00	\$6.86	
341 053 01 67	1.00	2	CND	0.70	1.00	0.10	0.07	\$98.00	\$6.86	
341 053 01 68	1.00	2	CND	0.70	1.00	0.10	0.07	\$98.00	\$6.86	
341 053 01 69	1.00	2	CND	0.70	1.00	0.10	0.07	\$98.00	\$6.86	
341 053 01 70	1.00	2	CND	0.70	1.00	0.10	0.07	\$98.00	\$6.86	
341 053 01 71	1.00	2	CND	0.70	1.00	0.10	0.07	\$98.00	\$6.86	
341 053 01 72	1.00	2	CND	0.70	1.00	0.10	0.07	\$98.00	\$6.86	
341 053 01 73	1.00	2	CND	0.70	1.00	0.10	0.07	\$98.00	\$6.86	
341 053 01 74	1.00	2	CND	0.70	1.00	0.10	0.07	\$98.00	\$6.86	
341 053 01 75	1.00	2	CND	0.70	1.00	0.10	0.07	\$98.00	\$6.86	
341 053 01 76	1.00	2	CND	0.70	1.00	0.10	0.07	\$98.00	\$6.86	
341 053 02 01	1.00	2	CND	0.70	1.00	0.10	0.07	\$98.00	\$6.86	
341 053 02 02	1.00	2	CND	0.70	1.00	0.10	0.07	\$98.00	\$6.86	
341 053 02 03	1.00	2	CND	0.70	1.00	0.10	0.07	\$98.00	\$6.86	
341 053 02 04	1.00	2	CND	0.70	1.00	0.10	0.07	\$98.00	\$6.86	
341 053 02 05	1.00	2	CND	0.70	1.00	0.10	0.07	\$98.00	\$6.86	
341 053 02 06	1.00	2	CND	0.70	1.00	0.10	0.07	\$98.00	\$6.86	
341 053 02 07	1.00	2	CND	0.70	1.00	0.10	0.07	\$98.00	\$6.86	
341 053 02 08	1.00	2	CND	0.70	1.00	0.10	0.07	\$98.00	\$6.86	
341 053 02 09	1.00	2	CND	0.70	1.00	0.10	0.07	\$98.00	\$6.86	
341 053 02 10	1.00	2	CND	0.70	1.00	0.10	0.07	\$98.00	\$6.86	

**EXHIBIT C - Assessment Roll (Fiscal Year 2027)**  
**Camino Santa Fe Maintenance Assessment District**

Parcel Number	Acres/ Units <sup>(1)</sup>	Zone Number	Land Use <sup>(2)</sup>	Apportionment Factors			Total EBU's	Unit Cost (\$/EBU)	FY 2027 <sup>(5)</sup> Assessment	Owner Name
				Land Use <sup>(2)</sup>	Benefit <sup>(3)</sup>	Location <sup>(4)</sup>				
341 053 02 11	1.00	2	CND	0.70	1.00	0.10	0.07	\$98.00	\$6.86	
341 053 02 12	1.00	2	CND	0.70	1.00	0.10	0.07	\$98.00	\$6.86	
341 053 02 13	1.00	2	CND	0.70	1.00	0.10	0.07	\$98.00	\$6.86	
341 053 02 14	1.00	2	CND	0.70	1.00	0.10	0.07	\$98.00	\$6.86	
341 053 02 15	1.00	2	CND	0.70	1.00	0.10	0.07	\$98.00	\$6.86	
341 053 02 16	1.00	2	CND	0.70	1.00	0.10	0.07	\$98.00	\$6.86	
341 053 02 17	1.00	2	CND	0.70	1.00	0.10	0.07	\$98.00	\$6.86	
341 053 02 18	1.00	2	CND	0.70	1.00	0.10	0.07	\$98.00	\$6.86	
341 053 02 19	1.00	2	CND	0.70	1.00	0.10	0.07	\$98.00	\$6.86	
341 053 02 20	1.00	2	CND	0.70	1.00	0.10	0.07	\$98.00	\$6.86	
341 053 02 21	1.00	2	CND	0.70	1.00	0.10	0.07	\$98.00	\$6.86	
341 053 02 22	1.00	2	CND	0.70	1.00	0.10	0.07	\$98.00	\$6.86	
341 053 02 23	1.00	2	CND	0.70	1.00	0.10	0.07	\$98.00	\$6.86	
341 053 02 24	1.00	2	CND	0.70	1.00	0.10	0.07	\$98.00	\$6.86	
341 053 02 25	1.00	2	CND	0.70	1.00	0.10	0.07	\$98.00	\$6.86	
341 053 02 26	1.00	2	CND	0.70	1.00	0.10	0.07	\$98.00	\$6.86	
341 053 02 27	1.00	2	CND	0.70	1.00	0.10	0.07	\$98.00	\$6.86	
341 053 02 28	1.00	2	CND	0.70	1.00	0.10	0.07	\$98.00	\$6.86	
341 053 02 29	1.00	2	CND	0.70	1.00	0.10	0.07	\$98.00	\$6.86	
341 053 02 30	1.00	2	CND	0.70	1.00	0.10	0.07	\$98.00	\$6.86	
341 053 02 31	1.00	2	CND	0.70	1.00	0.10	0.07	\$98.00	\$6.86	
341 053 02 32	1.00	2	CND	0.70	1.00	0.10	0.07	\$98.00	\$6.86	
341 053 02 33	1.00	2	CND	0.70	1.00	0.10	0.07	\$98.00	\$6.86	
341 053 02 34	1.00	2	CND	0.70	1.00	0.10	0.07	\$98.00	\$6.86	
341 053 02 35	1.00	2	CND	0.70	1.00	0.10	0.07	\$98.00	\$6.86	
341 053 02 36	1.00	2	CND	0.70	1.00	0.10	0.07	\$98.00	\$6.86	
341 053 02 37	1.00	2	CND	0.70	1.00	0.10	0.07	\$98.00	\$6.86	
341 053 02 38	1.00	2	CND	0.70	1.00	0.10	0.07	\$98.00	\$6.86	
341 053 02 39	1.00	2	CND	0.70	1.00	0.10	0.07	\$98.00	\$6.86	
341 053 02 40	1.00	2	CND	0.70	1.00	0.10	0.07	\$98.00	\$6.86	
341 053 02 41	1.00	2	CND	0.70	1.00	0.10	0.07	\$98.00	\$6.86	
341 053 02 42	1.00	2	CND	0.70	1.00	0.10	0.07	\$98.00	\$6.86	
341 053 02 43	1.00	2	CND	0.70	1.00	0.10	0.07	\$98.00	\$6.86	
341 053 02 44	1.00	2	CND	0.70	1.00	0.10	0.07	\$98.00	\$6.86	
341 053 02 45	1.00	2	CND	0.70	1.00	0.10	0.07	\$98.00	\$6.86	
341 053 02 46	1.00	2	CND	0.70	1.00	0.10	0.07	\$98.00	\$6.86	
341 053 02 47	1.00	2	CND	0.70	1.00	0.10	0.07	\$98.00	\$6.86	
341 053 02 48	1.00	2	CND	0.70	1.00	0.10	0.07	\$98.00	\$6.86	
341 053 02 49	1.00	2	CND	0.70	1.00	0.10	0.07	\$98.00	\$6.86	
341 053 02 50	1.00	2	CND	0.70	1.00	0.10	0.07	\$98.00	\$6.86	
341 053 02 51	1.00	2	CND	0.70	1.00	0.10	0.07	\$98.00	\$6.86	
341 053 02 52	1.00	2	CND	0.70	1.00	0.10	0.07	\$98.00	\$6.86	
341 053 02 53	1.00	2	CND	0.70	1.00	0.10	0.07	\$98.00	\$6.86	
341 053 02 54	1.00	2	CND	0.70	1.00	0.10	0.07	\$98.00	\$6.86	
341 053 02 55	1.00	2	CND	0.70	1.00	0.10	0.07	\$98.00	\$6.86	
341 053 02 56	1.00	2	CND	0.70	1.00	0.10	0.07	\$98.00	\$6.86	
341 053 02 57	1.00	2	CND	0.70	1.00	0.10	0.07	\$98.00	\$6.86	
341 053 02 58	1.00	2	CND	0.70	1.00	0.10	0.07	\$98.00	\$6.86	
341 053 02 59	1.00	2	CND	0.70	1.00	0.10	0.07	\$98.00	\$6.86	
341 053 02 60	1.00	2	CND	0.70	1.00	0.10	0.07	\$98.00	\$6.86	
341 053 02 61	1.00	2	CND	0.70	1.00	0.10	0.07	\$98.00	\$6.86	
341 053 02 62	1.00	2	CND	0.70	1.00	0.10	0.07	\$98.00	\$6.86	
341 053 02 63	1.00	2	CND	0.70	1.00	0.10	0.07	\$98.00	\$6.86	
341 053 02 64	1.00	2	CND	0.70	1.00	0.10	0.07	\$98.00	\$6.86	
341 053 02 65	1.00	2	CND	0.70	1.00	0.10	0.07	\$98.00	\$6.86	
341 053 02 66	1.00	2	CND	0.70	1.00	0.10	0.07	\$98.00	\$6.86	
341 053 02 67	1.00	2	CND	0.70	1.00	0.10	0.07	\$98.00	\$6.86	
341 053 02 68	1.00	2	CND	0.70	1.00	0.10	0.07	\$98.00	\$6.86	
341 053 02 69	1.00	2	CND	0.70	1.00	0.10	0.07	\$98.00	\$6.86	
341 053 02 70	1.00	2	CND	0.70	1.00	0.10	0.07	\$98.00	\$6.86	
341 053 02 71	1.00	2	CND	0.70	1.00	0.10	0.07	\$98.00	\$6.86	
341 053 02 72	1.00	2	CND	0.70	1.00	0.10	0.07	\$98.00	\$6.86	
341 053 02 73	1.00	2	CND	0.70	1.00	0.10	0.07	\$98.00	\$6.86	
341 053 02 74	1.00	2	CND	0.70	1.00	0.10	0.07	\$98.00	\$6.86	
341 053 02 75	1.00	2	CND	0.70	1.00	0.10	0.07	\$98.00	\$6.86	
341 053 02 76	1.00	2	CND	0.70	1.00	0.10	0.07	\$98.00	\$6.86	

**EXHIBIT C - Assessment Roll (Fiscal Year 2027)**  
**Camino Santa Fe Maintenance Assessment District**

Parcel Number	Acres/ Units <sup>(1)</sup>	Zone Number	Land Use <sup>(2)</sup>	Apportionment Factors			Total EBU's	Unit Cost (\$/EBU)	FY 2027 <sup>(5)</sup> Assessment	Owner Name
				Land Use <sup>(2)</sup>	Benefit <sup>(3)</sup>	Location <sup>(4)</sup>				
341 053 02 77	1.00	2	CND	0.70	1.00	0.10	0.07	\$98.00	\$6.86	
341 053 02 78	1.00	2	CND	0.70	1.00	0.10	0.07	\$98.00	\$6.86	
341 053 02 79	1.00	2	CND	0.70	1.00	0.10	0.07	\$98.00	\$6.86	
341 053 02 80	1.00	2	CND	0.70	1.00	0.10	0.07	\$98.00	\$6.86	
341 053 03 01	1.00	2	CND	0.70	1.00	0.10	0.07	\$98.00	\$6.86	
341 053 03 02	1.00	2	CND	0.70	1.00	0.10	0.07	\$98.00	\$6.86	
341 053 03 03	1.00	2	CND	0.70	1.00	0.10	0.07	\$98.00	\$6.86	
341 053 03 04	1.00	2	CND	0.70	1.00	0.10	0.07	\$98.00	\$6.86	
341 053 03 05	1.00	2	CND	0.70	1.00	0.10	0.07	\$98.00	\$6.86	
341 053 03 06	1.00	2	CND	0.70	1.00	0.10	0.07	\$98.00	\$6.86	
341 053 03 07	1.00	2	CND	0.70	1.00	0.10	0.07	\$98.00	\$6.86	
341 053 03 08	1.00	2	CND	0.70	1.00	0.10	0.07	\$98.00	\$6.86	
341 053 03 09	1.00	2	CND	0.70	1.00	0.10	0.07	\$98.00	\$6.86	
341 053 03 10	1.00	2	CND	0.70	1.00	0.10	0.07	\$98.00	\$6.86	
341 053 03 11	1.00	2	CND	0.70	1.00	0.10	0.07	\$98.00	\$6.86	
341 053 03 12	1.00	2	CND	0.70	1.00	0.10	0.07	\$98.00	\$6.86	
341 053 03 13	1.00	2	CND	0.70	1.00	0.10	0.07	\$98.00	\$6.86	
341 053 03 14	1.00	2	CND	0.70	1.00	0.10	0.07	\$98.00	\$6.86	
341 053 03 15	1.00	2	CND	0.70	1.00	0.10	0.07	\$98.00	\$6.86	
341 053 03 16	1.00	2	CND	0.70	1.00	0.10	0.07	\$98.00	\$6.86	
341 053 03 17	1.00	2	CND	0.70	1.00	0.10	0.07	\$98.00	\$6.86	
341 053 03 18	1.00	2	CND	0.70	1.00	0.10	0.07	\$98.00	\$6.86	
341 053 03 19	1.00	2	CND	0.70	1.00	0.10	0.07	\$98.00	\$6.86	
341 053 03 20	1.00	2	CND	0.70	1.00	0.10	0.07	\$98.00	\$6.86	
341 053 03 21	1.00	2	CND	0.70	1.00	0.10	0.07	\$98.00	\$6.86	
341 053 03 22	1.00	2	CND	0.70	1.00	0.10	0.07	\$98.00	\$6.86	
341 053 03 23	1.00	2	CND	0.70	1.00	0.10	0.07	\$98.00	\$6.86	
341 053 03 24	1.00	2	CND	0.70	1.00	0.10	0.07	\$98.00	\$6.86	
341 053 03 25	1.00	2	CND	0.70	1.00	0.10	0.07	\$98.00	\$6.86	
341 053 03 26	1.00	2	CND	0.70	1.00	0.10	0.07	\$98.00	\$6.86	
341 053 03 27	1.00	2	CND	0.70	1.00	0.10	0.07	\$98.00	\$6.86	
341 053 03 28	1.00	2	CND	0.70	1.00	0.10	0.07	\$98.00	\$6.86	
341 053 03 29	1.00	2	CND	0.70	1.00	0.10	0.07	\$98.00	\$6.86	
341 053 03 30	1.00	2	CND	0.70	1.00	0.10	0.07	\$98.00	\$6.86	
341 053 03 31	1.00	2	CND	0.70	1.00	0.10	0.07	\$98.00	\$6.86	
341 053 03 32	1.00	2	CND	0.70	1.00	0.10	0.07	\$98.00	\$6.86	
341 053 03 33	1.00	2	CND	0.70	1.00	0.10	0.07	\$98.00	\$6.86	
341 053 03 34	1.00	2	CND	0.70	1.00	0.10	0.07	\$98.00	\$6.86	
341 053 03 35	1.00	2	CND	0.70	1.00	0.10	0.07	\$98.00	\$6.86	
341 053 03 36	1.00	2	CND	0.70	1.00	0.10	0.07	\$98.00	\$6.86	
341 053 03 37	1.00	2	CND	0.70	1.00	0.10	0.07	\$98.00	\$6.86	
341 053 03 38	1.00	2	CND	0.70	1.00	0.10	0.07	\$98.00	\$6.86	
341 053 03 39	1.00	2	CND	0.70	1.00	0.10	0.07	\$98.00	\$6.86	
341 053 03 40	1.00	2	CND	0.70	1.00	0.10	0.07	\$98.00	\$6.86	
341 053 03 41	1.00	2	CND	0.70	1.00	0.10	0.07	\$98.00	\$6.86	
341 053 03 42	1.00	2	CND	0.70	1.00	0.10	0.07	\$98.00	\$6.86	
341 053 03 43	1.00	2	CND	0.70	1.00	0.10	0.07	\$98.00	\$6.86	
341 053 03 44	1.00	2	CND	0.70	1.00	0.10	0.07	\$98.00	\$6.86	
341 053 03 45	1.00	2	CND	0.70	1.00	0.10	0.07	\$98.00	\$6.86	
341 053 04 01	1.00	2	CND	0.70	1.00	0.10	0.07	\$98.00	\$6.86	
341 053 04 02	1.00	2	CND	0.70	1.00	0.10	0.07	\$98.00	\$6.86	
341 053 04 03	1.00	2	CND	0.70	1.00	0.10	0.07	\$98.00	\$6.86	
341 053 04 04	1.00	2	CND	0.70	1.00	0.10	0.07	\$98.00	\$6.86	
341 053 04 05	1.00	2	CND	0.70	1.00	0.10	0.07	\$98.00	\$6.86	
341 053 04 06	1.00	2	CND	0.70	1.00	0.10	0.07	\$98.00	\$6.86	
341 053 04 07	1.00	2	CND	0.70	1.00	0.10	0.07	\$98.00	\$6.86	
341 053 04 08	1.00	2	CND	0.70	1.00	0.10	0.07	\$98.00	\$6.86	
341 053 04 09	1.00	2	CND	0.70	1.00	0.10	0.07	\$98.00	\$6.86	
341 053 04 10	1.00	2	CND	0.70	1.00	0.10	0.07	\$98.00	\$6.86	
341 053 04 11	1.00	2	CND	0.70	1.00	0.10	0.07	\$98.00	\$6.86	
341 053 04 12	1.00	2	CND	0.70	1.00	0.10	0.07	\$98.00	\$6.86	
341 053 04 13	1.00	2	CND	0.70	1.00	0.10	0.07	\$98.00	\$6.86	
341 053 04 14	1.00	2	CND	0.70	1.00	0.10	0.07	\$98.00	\$6.86	
341 053 04 15	1.00	2	CND	0.70	1.00	0.10	0.07	\$98.00	\$6.86	
341 053 04 16	1.00	2	CND	0.70	1.00	0.10	0.07	\$98.00	\$6.86	
341 053 04 17	1.00	2	CND	0.70	1.00	0.10	0.07	\$98.00	\$6.86	

**EXHIBIT C - Assessment Roll (Fiscal Year 2027)**  
**Camino Santa Fe Maintenance Assessment District**

Parcel Number	Acres/ Units <sup>(1)</sup>	Zone Number	Land Use <sup>(2)</sup>	Apportionment Factors			Total EBU's	Unit Cost (\$/EBU)	FY 2027 <sup>(5)</sup> Assessment	Owner Name
				Land Use <sup>(2)</sup>	Benefit <sup>(3)</sup>	Location <sup>(4)</sup>				
341 053 04 18	1.00	2	CND	0.70	1.00	0.10	0.07	\$98.00	\$6.86	
341 053 04 19	1.00	2	CND	0.70	1.00	0.10	0.07	\$98.00	\$6.86	
341 053 04 20	1.00	2	CND	0.70	1.00	0.10	0.07	\$98.00	\$6.86	
341 053 04 21	1.00	2	CND	0.70	1.00	0.10	0.07	\$98.00	\$6.86	
341 053 04 22	1.00	2	CND	0.70	1.00	0.10	0.07	\$98.00	\$6.86	
341 053 04 23	1.00	2	CND	0.70	1.00	0.10	0.07	\$98.00	\$6.86	
341 053 04 24	1.00	2	CND	0.70	1.00	0.10	0.07	\$98.00	\$6.86	
341 053 04 25	1.00	2	CND	0.70	1.00	0.10	0.07	\$98.00	\$6.86	
341 053 04 26	1.00	2	CND	0.70	1.00	0.10	0.07	\$98.00	\$6.86	
341 053 04 27	1.00	2	CND	0.70	1.00	0.10	0.07	\$98.00	\$6.86	
341 053 05 00	2.68	2	OSP	0.00	0.30	0.10	0.00	\$98.00	\$0.00	
341 053 06 00	11.28	2	OSP	0.00	0.30	0.10	0.00	\$98.00	\$0.00	
341 053 07 00	0.61	2	OSP	0.00	0.30	0.10	0.00	\$98.00	\$0.00	
341 053 08 00	2.39	2	OSP	0.00	0.30	0.10	0.00	\$98.00	\$0.00	
341 053 09 00	0.08	2	OSP	0.00	0.30	0.10	0.00	\$98.00	\$0.00	
341 053 10 00	0.07	2	OSP	0.00	0.30	0.10	0.00	\$98.00	\$0.00	
341 053 11 00	0.08	2	OSP	0.00	0.30	0.10	0.00	\$98.00	\$0.00	
341 053 12 00	0.11	2	OSP	0.00	0.30	0.10	0.00	\$98.00	\$0.00	
341 053 13 00	1.04	2	OSP	0.00	0.30	0.10	0.00	\$98.00	\$0.00	
341 053 14 00	0.04	2	OSP	0.00	0.30	0.10	0.00	\$98.00	\$0.00	
341 053 15 00	0.06	2	OSP	0.00	0.30	0.10	0.00	\$98.00	\$0.00	
341 053 16 00	0.36	2	STR	0.00	0.30	0.10	0.00	\$98.00	\$0.00	
341 053 17 00	1.94	2	STR	0.00	0.30	0.10	0.00	\$98.00	\$0.00	
341 053 18 00	5.87	2	STR	0.00	0.30	0.10	0.00	\$98.00	\$0.00	
341 053 19 00	2.37	2	STR	0.00	0.30	0.10	0.00	\$98.00	\$0.00	
341 053 20 00	4.18	2	STR	0.00	0.30	0.10	0.00	\$98.00	\$0.00	
341 054 01 01	1.00	2	CND	0.70	1.00	0.10	0.07	\$98.00	\$6.86	
341 054 01 02	1.00	2	CND	0.70	1.00	0.10	0.07	\$98.00	\$6.86	
341 054 01 03	1.00	2	CND	0.70	1.00	0.10	0.07	\$98.00	\$6.86	
341 054 01 04	1.00	2	CND	0.70	1.00	0.10	0.07	\$98.00	\$6.86	
341 054 01 05	1.00	2	CND	0.70	1.00	0.10	0.07	\$98.00	\$6.86	
341 054 01 06	1.00	2	CND	0.70	1.00	0.10	0.07	\$98.00	\$6.86	
341 054 01 07	1.00	2	CND	0.70	1.00	0.10	0.07	\$98.00	\$6.86	
341 054 01 08	1.00	2	CND	0.70	1.00	0.10	0.07	\$98.00	\$6.86	
341 054 01 09	1.00	2	CND	0.70	1.00	0.10	0.07	\$98.00	\$6.86	
341 054 01 10	1.00	2	CND	0.70	1.00	0.10	0.07	\$98.00	\$6.86	
341 054 01 11	1.00	2	CND	0.70	1.00	0.10	0.07	\$98.00	\$6.86	
341 054 01 12	1.00	2	CND	0.70	1.00	0.10	0.07	\$98.00	\$6.86	
341 054 01 13	1.00	2	CND	0.70	1.00	0.10	0.07	\$98.00	\$6.86	
341 054 01 14	1.00	2	CND	0.70	1.00	0.10	0.07	\$98.00	\$6.86	
341 054 01 15	1.00	2	CND	0.70	1.00	0.10	0.07	\$98.00	\$6.86	
341 054 01 16	1.00	2	CND	0.70	1.00	0.10	0.07	\$98.00	\$6.86	
341 054 01 17	1.00	2	CND	0.70	1.00	0.10	0.07	\$98.00	\$6.86	
341 054 01 18	1.00	2	CND	0.70	1.00	0.10	0.07	\$98.00	\$6.86	
341 054 01 19	1.00	2	CND	0.70	1.00	0.10	0.07	\$98.00	\$6.86	
341 054 01 20	1.00	2	CND	0.70	1.00	0.10	0.07	\$98.00	\$6.86	
341 054 01 21	1.00	2	CND	0.70	1.00	0.10	0.07	\$98.00	\$6.86	
341 054 01 22	1.00	2	CND	0.70	1.00	0.10	0.07	\$98.00	\$6.86	
341 054 01 23	1.00	2	CND	0.70	1.00	0.10	0.07	\$98.00	\$6.86	
341 054 01 24	1.00	2	CND	0.70	1.00	0.10	0.07	\$98.00	\$6.86	
341 054 01 25	1.00	2	CND	0.70	1.00	0.10	0.07	\$98.00	\$6.86	
341 054 01 26	1.00	2	CND	0.70	1.00	0.10	0.07	\$98.00	\$6.86	
341 054 01 27	1.00	2	CND	0.70	1.00	0.10	0.07	\$98.00	\$6.86	
341 054 01 28	1.00	2	CND	0.70	1.00	0.10	0.07	\$98.00	\$6.86	
341 054 01 29	1.00	2	CND	0.70	1.00	0.10	0.07	\$98.00	\$6.86	
341 054 01 30	1.00	2	CND	0.70	1.00	0.10	0.07	\$98.00	\$6.86	
341 054 01 31	1.00	2	CND	0.70	1.00	0.10	0.07	\$98.00	\$6.86	
341 054 01 32	1.00	2	CND	0.70	1.00	0.10	0.07	\$98.00	\$6.86	
341 054 01 33	1.00	2	CND	0.70	1.00	0.10	0.07	\$98.00	\$6.86	
341 054 01 34	1.00	2	CND	0.70	1.00	0.10	0.07	\$98.00	\$6.86	
341 054 01 35	1.00	2	CND	0.70	1.00	0.10	0.07	\$98.00	\$6.86	
341 054 01 36	1.00	2	CND	0.70	1.00	0.10	0.07	\$98.00	\$6.86	
341 054 01 37	1.00	2	CND	0.70	1.00	0.10	0.07	\$98.00	\$6.86	
341 054 01 38	1.00	2	CND	0.70	1.00	0.10	0.07	\$98.00	\$6.86	
341 054 01 39	1.00	2	CND	0.70	1.00	0.10	0.07	\$98.00	\$6.86	
341 054 01 40	1.00	2	CND	0.70	1.00	0.10	0.07	\$98.00	\$6.86	

**EXHIBIT C - Assessment Roll (Fiscal Year 2027)**  
**Camino Santa Fe Maintenance Assessment District**

Parcel Number	Acres/ Units <sup>(1)</sup>	Zone Number	Land Use <sup>(2)</sup>	Apportionment Factors			Total EBU's	Unit Cost (\$/EBU)	FY 2027 <sup>(5)</sup> Assessment	Owner Name
				Land Use <sup>(2)</sup>	Benefit <sup>(3)</sup>	Location <sup>(4)</sup>				
341 054 01 41	1.00	2	CND	0.70	1.00	0.10	0.07	\$98.00	\$6.86	
341 054 01 42	1.00	2	CND	0.70	1.00	0.10	0.07	\$98.00	\$6.86	
341 054 01 43	1.00	2	CND	0.70	1.00	0.10	0.07	\$98.00	\$6.86	
341 054 01 44	1.00	2	CND	0.70	1.00	0.10	0.07	\$98.00	\$6.86	
341 054 01 45	1.00	2	CND	0.70	1.00	0.10	0.07	\$98.00	\$6.86	
341 054 01 46	1.00	2	CND	0.70	1.00	0.10	0.07	\$98.00	\$6.86	
341 054 01 47	1.00	2	CND	0.70	1.00	0.10	0.07	\$98.00	\$6.86	
341 054 01 48	1.00	2	CND	0.70	1.00	0.10	0.07	\$98.00	\$6.86	
341 054 01 49	1.00	2	CND	0.70	1.00	0.10	0.07	\$98.00	\$6.86	
341 054 04 00	0.67	2	OSP	0.00	0.30	0.10	0.00	\$98.00	\$0.00	
341 054 05 00	1.03	2	OSP	0.00	0.30	0.10	0.00	\$98.00	\$0.00	
341 054 06 00	0.57	2	OSP	0.00	0.30	0.10	0.00	\$98.00	\$0.00	
341 054 08 00	2.81	2	OSP	0.00	0.30	0.10	0.00	\$98.00	\$0.00	
341 054 13 00	2.23	2	STR	0.00	0.30	0.10	0.00	\$98.00	\$0.00	
341 440 01 00	4.01	2	COM	45.00	0.60	0.10	10.83	\$98.00	\$1,061.04	
341 440 02 00	0.71	2	COM	45.00	0.60	0.10	1.92	\$98.00	\$187.86	
341 440 03 00	0.51	2	COM	45.00	0.60	0.10	1.38	\$98.00	\$134.94	
341 440 04 00	0.78	2	COM	45.00	0.60	0.10	2.11	\$98.00	\$206.38	
341 440 05 00	0.39	2	COM	45.00	0.60	0.10	1.05	\$98.00	\$103.18	
341 440 06 00	0.38	2	COM	45.00	0.60	0.10	1.03	\$98.00	\$100.54	
341 440 07 00	0.59	2	COM	45.00	0.60	0.10	1.59	\$98.00	\$156.10	
341 440 08 00	4.00	2	OSP	0.00	0.30	0.10	0.00	\$98.00	\$0.00	
341 440 09 00	6.43	2	COM	45.00	0.60	0.10	17.36	\$98.00	\$1,701.38	
341 470 01 00	4.16	1	VAC	0.00	0.30	1.00	0.00	\$98.00	\$0.00	
341 470 02 00	3.09	1	VAC	0.00	0.30	1.00	0.00	\$98.00	\$0.00	
341 470 03 00	2.98	1	SCOM	30.00	0.60	1.00	53.64	\$98.00	\$5,256.72	
341 470 04 00	3.11	1	SCOM	30.00	0.60	1.00	55.98	\$98.00	\$5,486.04	
341 470 07 00	10.79	1	SCOM	30.00	0.60	1.00	194.22	\$98.00	\$19,033.56	
341 470 10 00	23.25	1	OSP	0.00	0.30	1.00	0.00	\$98.00	\$0.00	
341 470 11 00	2.76	1	VAC	0.00	0.30	1.00	0.00	\$98.00	\$0.00	
341 470 12 00	2.50	1	VAC	0.00	0.30	1.00	0.00	\$98.00	\$0.00	
341 470 14 00	12.68	1	VAC	0.00	0.30	1.00	0.00	\$98.00	\$0.00	
341 470 15 00	9.36	1	COM	45.00	0.60	1.00	252.72	\$98.00	\$24,766.56	
341 470 16 00	8.03	1	SCOM	30.00	0.60	1.00	144.54	\$98.00	\$14,164.92	
341 470 18 00	15.71	1	VAC	0.00	0.30	1.00	0.00	\$98.00	\$0.00	
341 490 01 01	1.00	1	CND	0.70	1.00	1.00	0.70	\$98.00	\$68.60	
341 490 01 02	1.00	1	CND	0.70	1.00	1.00	0.70	\$98.00	\$68.60	
341 490 01 03	1.00	1	CND	0.70	1.00	1.00	0.70	\$98.00	\$68.60	
341 490 01 04	1.00	1	CND	0.70	1.00	1.00	0.70	\$98.00	\$68.60	
341 490 01 05	1.00	1	CND	0.70	1.00	1.00	0.70	\$98.00	\$68.60	
341 490 01 06	1.00	1	CND	0.70	1.00	1.00	0.70	\$98.00	\$68.60	
341 490 01 07	1.00	1	CND	0.70	1.00	1.00	0.70	\$98.00	\$68.60	
341 490 01 08	1.00	1	CND	0.70	1.00	1.00	0.70	\$98.00	\$68.60	
341 490 01 09	1.00	1	CND	0.70	1.00	1.00	0.70	\$98.00	\$68.60	
341 490 01 10	1.00	1	CND	0.70	1.00	1.00	0.70	\$98.00	\$68.60	
341 490 01 11	1.00	1	CND	0.70	1.00	1.00	0.70	\$98.00	\$68.60	
341 490 01 12	1.00	1	CND	0.70	1.00	1.00	0.70	\$98.00	\$68.60	
341 490 01 13	1.00	1	CND	0.70	1.00	1.00	0.70	\$98.00	\$68.60	
341 490 01 14	1.00	1	CND	0.70	1.00	1.00	0.70	\$98.00	\$68.60	
341 490 01 15	1.00	1	CND	0.70	1.00	1.00	0.70	\$98.00	\$68.60	
341 490 01 16	1.00	1	CND	0.70	1.00	1.00	0.70	\$98.00	\$68.60	
341 490 01 17	1.00	1	CND	0.70	1.00	1.00	0.70	\$98.00	\$68.60	
341 490 01 18	1.00	1	CND	0.70	1.00	1.00	0.70	\$98.00	\$68.60	
341 490 01 19	1.00	1	CND	0.70	1.00	1.00	0.70	\$98.00	\$68.60	
341 490 01 20	1.00	1	CND	0.70	1.00	1.00	0.70	\$98.00	\$68.60	
341 490 01 21	1.00	1	CND	0.70	1.00	1.00	0.70	\$98.00	\$68.60	
341 490 01 22	1.00	1	CND	0.70	1.00	1.00	0.70	\$98.00	\$68.60	
341 490 01 23	1.00	1	CND	0.70	1.00	1.00	0.70	\$98.00	\$68.60	
341 490 01 24	1.00	1	CND	0.70	1.00	1.00	0.70	\$98.00	\$68.60	
341 490 01 25	1.00	1	CND	0.70	1.00	1.00	0.70	\$98.00	\$68.60	
341 490 01 26	1.00	1	CND	0.70	1.00	1.00	0.70	\$98.00	\$68.60	
341 490 01 27	1.00	1	CND	0.70	1.00	1.00	0.70	\$98.00	\$68.60	
341 490 01 28	1.00	1	CND	0.70	1.00	1.00	0.70	\$98.00	\$68.60	
341 490 01 29	1.00	1	CND	0.70	1.00	1.00	0.70	\$98.00	\$68.60	
341 490 01 30	1.00	1	CND	0.70	1.00	1.00	0.70	\$98.00	\$68.60	
341 490 01 31	1.00	1	CND	0.70	1.00	1.00	0.70	\$98.00	\$68.60	

**EXHIBIT C - Assessment Roll (Fiscal Year 2027)**  
**Camino Santa Fe Maintenance Assessment District**

Parcel Number	Acres/ Units <sup>(1)</sup>	Zone Number	Land Use <sup>(2)</sup>	Apportionment Factors			Total EBU	Unit Cost (\$/EBU)	FY 2027 <sup>(5)</sup> Assessment	Owner Name
				Land Use <sup>(2)</sup>	Benefit <sup>(3)</sup>	Location <sup>(4)</sup>				
341 490 01 32	1.00	1	CND	0.70	1.00	1.00	0.70	\$98.00	\$68.60	
341 490 01 33	1.00	1	CND	0.70	1.00	1.00	0.70	\$98.00	\$68.60	
341 490 01 34	1.00	1	CND	0.70	1.00	1.00	0.70	\$98.00	\$68.60	
341 490 01 35	1.00	1	CND	0.70	1.00	1.00	0.70	\$98.00	\$68.60	
341 490 01 36	1.00	1	CND	0.70	1.00	1.00	0.70	\$98.00	\$68.60	
341 490 01 37	1.00	1	CND	0.70	1.00	1.00	0.70	\$98.00	\$68.60	
341 490 01 38	1.00	1	CND	0.70	1.00	1.00	0.70	\$98.00	\$68.60	
341 490 01 39	1.00	1	CND	0.70	1.00	1.00	0.70	\$98.00	\$68.60	
341 490 01 40	1.00	1	CND	0.70	1.00	1.00	0.70	\$98.00	\$68.60	
341 490 01 41	1.00	1	CND	0.70	1.00	1.00	0.70	\$98.00	\$68.60	
341 490 01 42	1.00	1	CND	0.70	1.00	1.00	0.70	\$98.00	\$68.60	
341 490 01 43	1.00	1	CND	0.70	1.00	1.00	0.70	\$98.00	\$68.60	
341 490 01 44	1.00	1	CND	0.70	1.00	1.00	0.70	\$98.00	\$68.60	
341 490 01 45	1.00	1	CND	0.70	1.00	1.00	0.70	\$98.00	\$68.60	
341 490 01 46	1.00	1	CND	0.70	1.00	1.00	0.70	\$98.00	\$68.60	
341 490 01 47	1.00	1	CND	0.70	1.00	1.00	0.70	\$98.00	\$68.60	
341 490 01 48	1.00	1	CND	0.70	1.00	1.00	0.70	\$98.00	\$68.60	
341 490 01 49	1.00	1	CND	0.70	1.00	1.00	0.70	\$98.00	\$68.60	
341 490 01 50	1.00	1	CND	0.70	1.00	1.00	0.70	\$98.00	\$68.60	
341 490 01 51	1.00	1	CND	0.70	1.00	1.00	0.70	\$98.00	\$68.60	
341 490 01 52	1.00	1	CND	0.70	1.00	1.00	0.70	\$98.00	\$68.60	
341 490 01 53	1.00	1	CND	0.70	1.00	1.00	0.70	\$98.00	\$68.60	
341 490 01 54	1.00	1	CND	0.70	1.00	1.00	0.70	\$98.00	\$68.60	
341 490 01 55	1.00	1	CND	0.70	1.00	1.00	0.70	\$98.00	\$68.60	
341 490 01 56	1.00	1	CND	0.70	1.00	1.00	0.70	\$98.00	\$68.60	
341 490 02 01	1.00	1	CND	0.70	1.00	1.00	0.70	\$98.00	\$68.60	
341 490 02 02	1.00	1	CND	0.70	1.00	1.00	0.70	\$98.00	\$68.60	
341 490 02 03	1.00	1	CND	0.70	1.00	1.00	0.70	\$98.00	\$68.60	
341 490 02 04	1.00	1	CND	0.70	1.00	1.00	0.70	\$98.00	\$68.60	
341 490 02 05	1.00	1	CND	0.70	1.00	1.00	0.70	\$98.00	\$68.60	
341 490 02 06	1.00	1	CND	0.70	1.00	1.00	0.70	\$98.00	\$68.60	
341 490 02 07	1.00	1	CND	0.70	1.00	1.00	0.70	\$98.00	\$68.60	
341 490 02 08	1.00	1	CND	0.70	1.00	1.00	0.70	\$98.00	\$68.60	
341 490 02 09	1.00	1	CND	0.70	1.00	1.00	0.70	\$98.00	\$68.60	
341 490 02 10	1.00	1	CND	0.70	1.00	1.00	0.70	\$98.00	\$68.60	
341 490 02 11	1.00	1	CND	0.70	1.00	1.00	0.70	\$98.00	\$68.60	
341 490 02 12	1.00	1	CND	0.70	1.00	1.00	0.70	\$98.00	\$68.60	
341 490 02 13	1.00	1	CND	0.70	1.00	1.00	0.70	\$98.00	\$68.60	
341 490 02 14	1.00	1	CND	0.70	1.00	1.00	0.70	\$98.00	\$68.60	
341 490 02 15	1.00	1	CND	0.70	1.00	1.00	0.70	\$98.00	\$68.60	
341 490 02 16	1.00	1	CND	0.70	1.00	1.00	0.70	\$98.00	\$68.60	
341 490 02 17	1.00	1	CND	0.70	1.00	1.00	0.70	\$98.00	\$68.60	
341 490 02 18	1.00	1	CND	0.70	1.00	1.00	0.70	\$98.00	\$68.60	
341 490 02 19	1.00	1	CND	0.70	1.00	1.00	0.70	\$98.00	\$68.60	
341 490 02 20	1.00	1	CND	0.70	1.00	1.00	0.70	\$98.00	\$68.60	
341 490 02 21	1.00	1	CND	0.70	1.00	1.00	0.70	\$98.00	\$68.60	
341 490 02 22	1.00	1	CND	0.70	1.00	1.00	0.70	\$98.00	\$68.60	
341 490 02 23	1.00	1	CND	0.70	1.00	1.00	0.70	\$98.00	\$68.60	
341 490 02 24	1.00	1	CND	0.70	1.00	1.00	0.70	\$98.00	\$68.60	
341 490 02 25	1.00	1	CND	0.70	1.00	1.00	0.70	\$98.00	\$68.60	
341 490 02 26	1.00	1	CND	0.70	1.00	1.00	0.70	\$98.00	\$68.60	
341 490 02 27	1.00	1	CND	0.70	1.00	1.00	0.70	\$98.00	\$68.60	
341 490 02 28	1.00	1	CND	0.70	1.00	1.00	0.70	\$98.00	\$68.60	
341 490 02 29	1.00	1	CND	0.70	1.00	1.00	0.70	\$98.00	\$68.60	
341 490 02 30	1.00	1	CND	0.70	1.00	1.00	0.70	\$98.00	\$68.60	
341 490 02 31	1.00	1	CND	0.70	1.00	1.00	0.70	\$98.00	\$68.60	
341 490 02 32	1.00	1	CND	0.70	1.00	1.00	0.70	\$98.00	\$68.60	
341 490 02 33	1.00	1	CND	0.70	1.00	1.00	0.70	\$98.00	\$68.60	
341 490 02 34	1.00	1	CND	0.70	1.00	1.00	0.70	\$98.00	\$68.60	
341 490 02 35	1.00	1	CND	0.70	1.00	1.00	0.70	\$98.00	\$68.60	
341 490 02 36	1.00	1	CND	0.70	1.00	1.00	0.70	\$98.00	\$68.60	
341 490 02 37	1.00	1	CND	0.70	1.00	1.00	0.70	\$98.00	\$68.60	
341 490 02 38	1.00	1	CND	0.70	1.00	1.00	0.70	\$98.00	\$68.60	
341 490 02 39	1.00	1	CND	0.70	1.00	1.00	0.70	\$98.00	\$68.60	
341 490 02 40	1.00	1	CND	0.70	1.00	1.00	0.70	\$98.00	\$68.60	
341 490 02 41	1.00	1	CND	0.70	1.00	1.00	0.70	\$98.00	\$68.60	

**EXHIBIT C - Assessment Roll (Fiscal Year 2027)**  
**Camino Santa Fe Maintenance Assessment District**

Parcel Number	Acres/ Units <sup>(1)</sup>	Zone Number	Land Use <sup>(2)</sup>	Apportionment Factors			Total EBU	Unit Cost (\$/EBU)	FY 2027 <sup>(5)</sup> Assessment	Owner Name
				Land Use <sup>(2)</sup>	Benefit <sup>(3)</sup>	Location <sup>(4)</sup>				
341 490 02 42	1.00	1	CND	0.70	1.00	1.00	0.70	\$98.00	\$68.60	
341 490 02 43	1.00	1	CND	0.70	1.00	1.00	0.70	\$98.00	\$68.60	
341 490 02 44	1.00	1	CND	0.70	1.00	1.00	0.70	\$98.00	\$68.60	
341 490 02 45	1.00	1	CND	0.70	1.00	1.00	0.70	\$98.00	\$68.60	
341 490 02 46	1.00	1	CND	0.70	1.00	1.00	0.70	\$98.00	\$68.60	
341 490 02 47	1.00	1	CND	0.70	1.00	1.00	0.70	\$98.00	\$68.60	
341 490 02 48	1.00	1	CND	0.70	1.00	1.00	0.70	\$98.00	\$68.60	
341 490 02 49	1.00	1	CND	0.70	1.00	1.00	0.70	\$98.00	\$68.60	
341 490 02 50	1.00	1	CND	0.70	1.00	1.00	0.70	\$98.00	\$68.60	
341 490 02 51	1.00	1	CND	0.70	1.00	1.00	0.70	\$98.00	\$68.60	
341 490 02 52	1.00	1	CND	0.70	1.00	1.00	0.70	\$98.00	\$68.60	
341 490 02 53	1.00	1	CND	0.70	1.00	1.00	0.70	\$98.00	\$68.60	
341 490 02 54	1.00	1	CND	0.70	1.00	1.00	0.70	\$98.00	\$68.60	
341 490 02 55	1.00	1	CND	0.70	1.00	1.00	0.70	\$98.00	\$68.60	
341 490 02 56	1.00	1	CND	0.70	1.00	1.00	0.70	\$98.00	\$68.60	
341 490 02 57	1.00	1	CND	0.70	1.00	1.00	0.70	\$98.00	\$68.60	
341 490 02 58	1.00	1	CND	0.70	1.00	1.00	0.70	\$98.00	\$68.60	
341 490 02 59	1.00	1	CND	0.70	1.00	1.00	0.70	\$98.00	\$68.60	
341 490 02 60	1.00	1	CND	0.70	1.00	1.00	0.70	\$98.00	\$68.60	
341 490 02 61	1.00	1	CND	0.70	1.00	1.00	0.70	\$98.00	\$68.60	
341 490 02 62	1.00	1	CND	0.70	1.00	1.00	0.70	\$98.00	\$68.60	
341 490 02 63	1.00	1	CND	0.70	1.00	1.00	0.70	\$98.00	\$68.60	
341 490 02 64	1.00	1	CND	0.70	1.00	1.00	0.70	\$98.00	\$68.60	
341 490 02 65	1.00	1	CND	0.70	1.00	1.00	0.70	\$98.00	\$68.60	
341 490 02 66	1.00	1	CND	0.70	1.00	1.00	0.70	\$98.00	\$68.60	
341 490 02 67	1.00	1	CND	0.70	1.00	1.00	0.70	\$98.00	\$68.60	
341 490 02 68	1.00	1	CND	0.70	1.00	1.00	0.70	\$98.00	\$68.60	
341 490 02 69	1.00	1	CND	0.70	1.00	1.00	0.70	\$98.00	\$68.60	
341 490 02 70	1.00	1	CND	0.70	1.00	1.00	0.70	\$98.00	\$68.60	
341 490 02 71	1.00	1	CND	0.70	1.00	1.00	0.70	\$98.00	\$68.60	
341 490 02 72	1.00	1	CND	0.70	1.00	1.00	0.70	\$98.00	\$68.60	
341 490 02 73	1.00	1	CND	0.70	1.00	1.00	0.70	\$98.00	\$68.60	
341 490 02 74	1.00	1	CND	0.70	1.00	1.00	0.70	\$98.00	\$68.60	
341 490 02 75	1.00	1	CND	0.70	1.00	1.00	0.70	\$98.00	\$68.60	
341 490 02 76	1.00	1	CND	0.70	1.00	1.00	0.70	\$98.00	\$68.60	
341 490 02 77	1.00	1	CND	0.70	1.00	1.00	0.70	\$98.00	\$68.60	
341 490 02 78	1.00	1	CND	0.70	1.00	1.00	0.70	\$98.00	\$68.60	
341 490 03 00	1.17	1	OSP	0.00	0.30	1.00	0.00	\$98.00	\$0.00	
341 490 04 00	2.22	1	VAC	0.00	0.30	1.00	0.00	\$98.00	\$0.00	
341 490 05 00	1.04	1	OSP	0.00	0.30	1.00	0.00	\$98.00	\$0.00	
341 490 06 00	0.81	1	VAC	0.00	0.30	1.00	0.00	\$98.00	\$0.00	
341 490 07 00	0.13	1	STR	0.00	0.30	1.00	0.00	\$98.00	\$0.00	
341 490 08 00	0.16	1	OSP	0.00	0.30	1.00	0.00	\$98.00	\$0.00	
341 490 09 00	0.61	1	OSP	0.00	0.30	1.00	0.00	\$98.00	\$0.00	
341 490 11 00	3.50	1	OSP	0.00	0.30	1.00	0.00	\$98.00	\$0.00	
341 491 01 01	1.00	1	CND	0.70	1.00	1.00	0.70	\$98.00	\$68.60	
341 491 01 02	1.00	1	CND	0.70	1.00	1.00	0.70	\$98.00	\$68.60	
341 491 01 03	1.00	1	CND	0.70	1.00	1.00	0.70	\$98.00	\$68.60	
341 491 01 04	1.00	1	CND	0.70	1.00	1.00	0.70	\$98.00	\$68.60	
341 491 01 05	1.00	1	CND	0.70	1.00	1.00	0.70	\$98.00	\$68.60	
341 491 01 06	1.00	1	CND	0.70	1.00	1.00	0.70	\$98.00	\$68.60	
341 491 01 07	1.00	1	CND	0.70	1.00	1.00	0.70	\$98.00	\$68.60	
341 491 01 08	1.00	1	CND	0.70	1.00	1.00	0.70	\$98.00	\$68.60	
341 491 01 09	1.00	1	CND	0.70	1.00	1.00	0.70	\$98.00	\$68.60	
341 491 01 10	1.00	1	CND	0.70	1.00	1.00	0.70	\$98.00	\$68.60	
341 491 01 11	1.00	1	CND	0.70	1.00	1.00	0.70	\$98.00	\$68.60	
341 491 01 12	1.00	1	CND	0.70	1.00	1.00	0.70	\$98.00	\$68.60	
341 491 01 13	1.00	1	CND	0.70	1.00	1.00	0.70	\$98.00	\$68.60	
341 491 01 14	1.00	1	CND	0.70	1.00	1.00	0.70	\$98.00	\$68.60	
341 491 01 15	1.00	1	CND	0.70	1.00	1.00	0.70	\$98.00	\$68.60	
341 491 01 16	1.00	1	CND	0.70	1.00	1.00	0.70	\$98.00	\$68.60	
341 491 01 17	1.00	1	CND	0.70	1.00	1.00	0.70	\$98.00	\$68.60	
341 491 01 18	1.00	1	CND	0.70	1.00	1.00	0.70	\$98.00	\$68.60	
341 491 01 19	1.00	1	CND	0.70	1.00	1.00	0.70	\$98.00	\$68.60	
341 491 01 20	1.00	1	CND	0.70	1.00	1.00	0.70	\$98.00	\$68.60	
341 491 01 21	1.00	1	CND	0.70	1.00	1.00	0.70	\$98.00	\$68.60	

**EXHIBIT C - Assessment Roll (Fiscal Year 2027)**  
**Camino Santa Fe Maintenance Assessment District**

Parcel Number	Acres/ Units <sup>(1)</sup>	Zone Number	Land Use <sup>(2)</sup>	Apportionment Factors			Total EBU's	Unit Cost (\$/EBU)	FY 2027 <sup>(5)</sup> Assessment	Owner Name
				Land Use <sup>(2)</sup>	Benefit <sup>(3)</sup>	Location <sup>(4)</sup>				
341 491 01 22	1.00	1	CND	0.70	1.00	1.00	0.70	\$98.00	\$68.60	
341 491 01 23	1.00	1	CND	0.70	1.00	1.00	0.70	\$98.00	\$68.60	
341 491 01 24	1.00	1	CND	0.70	1.00	1.00	0.70	\$98.00	\$68.60	
341 491 01 25	1.00	1	CND	0.70	1.00	1.00	0.70	\$98.00	\$68.60	
341 491 01 26	1.00	1	CND	0.70	1.00	1.00	0.70	\$98.00	\$68.60	
341 491 01 27	1.00	1	CND	0.70	1.00	1.00	0.70	\$98.00	\$68.60	
341 491 01 28	1.00	1	CND	0.70	1.00	1.00	0.70	\$98.00	\$68.60	
341 491 01 29	1.00	1	CND	0.70	1.00	1.00	0.70	\$98.00	\$68.60	
341 491 01 30	1.00	1	CND	0.70	1.00	1.00	0.70	\$98.00	\$68.60	
341 491 01 31	1.00	1	CND	0.70	1.00	1.00	0.70	\$98.00	\$68.60	
341 491 01 32	1.00	1	CND	0.70	1.00	1.00	0.70	\$98.00	\$68.60	
341 491 01 33	1.00	1	CND	0.70	1.00	1.00	0.70	\$98.00	\$68.60	
341 491 01 34	1.00	1	CND	0.70	1.00	1.00	0.70	\$98.00	\$68.60	
341 491 01 35	1.00	1	CND	0.70	1.00	1.00	0.70	\$98.00	\$68.60	
341 491 01 36	1.00	1	CND	0.70	1.00	1.00	0.70	\$98.00	\$68.60	
341 491 01 37	1.00	1	CND	0.70	1.00	1.00	0.70	\$98.00	\$68.60	
341 491 01 38	1.00	1	CND	0.70	1.00	1.00	0.70	\$98.00	\$68.60	
341 491 01 39	1.00	1	CND	0.70	1.00	1.00	0.70	\$98.00	\$68.60	
341 491 01 40	1.00	1	CND	0.70	1.00	1.00	0.70	\$98.00	\$68.60	
341 491 01 41	1.00	1	CND	0.70	1.00	1.00	0.70	\$98.00	\$68.60	
341 491 01 42	1.00	1	CND	0.70	1.00	1.00	0.70	\$98.00	\$68.60	
341 491 01 43	1.00	1	CND	0.70	1.00	1.00	0.70	\$98.00	\$68.60	
341 491 01 44	1.00	1	CND	0.70	1.00	1.00	0.70	\$98.00	\$68.60	
341 491 01 45	1.00	1	CND	0.70	1.00	1.00	0.70	\$98.00	\$68.60	
341 491 01 46	1.00	1	CND	0.70	1.00	1.00	0.70	\$98.00	\$68.60	
341 491 01 47	1.00	1	CND	0.70	1.00	1.00	0.70	\$98.00	\$68.60	
341 491 01 48	1.00	1	CND	0.70	1.00	1.00	0.70	\$98.00	\$68.60	
341 491 01 49	1.00	1	CND	0.70	1.00	1.00	0.70	\$98.00	\$68.60	
341 491 01 50	1.00	1	CND	0.70	1.00	1.00	0.70	\$98.00	\$68.60	
341 491 01 51	1.00	1	CND	0.70	1.00	1.00	0.70	\$98.00	\$68.60	
341 491 01 52	1.00	1	CND	0.70	1.00	1.00	0.70	\$98.00	\$68.60	
341 491 01 53	1.00	1	CND	0.70	1.00	1.00	0.70	\$98.00	\$68.60	
341 491 01 54	1.00	1	CND	0.70	1.00	1.00	0.70	\$98.00	\$68.60	
341 491 01 55	1.00	1	CND	0.70	1.00	1.00	0.70	\$98.00	\$68.60	
341 491 01 56	1.00	1	CND	0.70	1.00	1.00	0.70	\$98.00	\$68.60	
341 491 01 57	1.00	1	CND	0.70	1.00	1.00	0.70	\$98.00	\$68.60	
341 491 01 58	1.00	1	CND	0.70	1.00	1.00	0.70	\$98.00	\$68.60	
341 491 01 59	1.00	1	CND	0.70	1.00	1.00	0.70	\$98.00	\$68.60	
341 491 01 60	1.00	1	CND	0.70	1.00	1.00	0.70	\$98.00	\$68.60	
341 491 01 61	1.00	1	CND	0.70	1.00	1.00	0.70	\$98.00	\$68.60	
341 491 01 62	1.00	1	CND	0.70	1.00	1.00	0.70	\$98.00	\$68.60	
341 491 01 63	1.00	1	CND	0.70	1.00	1.00	0.70	\$98.00	\$68.60	
341 491 01 64	1.00	1	CND	0.70	1.00	1.00	0.70	\$98.00	\$68.60	
341 491 01 65	1.00	1	CND	0.70	1.00	1.00	0.70	\$98.00	\$68.60	
341 491 01 66	1.00	1	CND	0.70	1.00	1.00	0.70	\$98.00	\$68.60	
341 491 02 01	1.00	1	CND	0.70	1.00	1.00	0.70	\$98.00	\$68.60	
341 491 02 02	1.00	1	CND	0.70	1.00	1.00	0.70	\$98.00	\$68.60	
341 491 02 03	1.00	1	CND	0.70	1.00	1.00	0.70	\$98.00	\$68.60	
341 491 02 04	1.00	1	CND	0.70	1.00	1.00	0.70	\$98.00	\$68.60	
341 491 02 05	1.00	1	CND	0.70	1.00	1.00	0.70	\$98.00	\$68.60	
341 491 02 06	1.00	1	CND	0.70	1.00	1.00	0.70	\$98.00	\$68.60	
341 491 02 07	1.00	1	CND	0.70	1.00	1.00	0.70	\$98.00	\$68.60	
341 491 02 08	1.00	1	CND	0.70	1.00	1.00	0.70	\$98.00	\$68.60	
341 491 02 09	1.00	1	CND	0.70	1.00	1.00	0.70	\$98.00	\$68.60	
341 491 02 10	1.00	1	CND	0.70	1.00	1.00	0.70	\$98.00	\$68.60	
341 491 02 11	1.00	1	CND	0.70	1.00	1.00	0.70	\$98.00	\$68.60	
341 491 02 12	1.00	1	CND	0.70	1.00	1.00	0.70	\$98.00	\$68.60	
341 491 02 13	1.00	1	CND	0.70	1.00	1.00	0.70	\$98.00	\$68.60	
341 491 02 14	1.00	1	CND	0.70	1.00	1.00	0.70	\$98.00	\$68.60	
341 491 02 15	1.00	1	CND	0.70	1.00	1.00	0.70	\$98.00	\$68.60	
341 491 02 16	1.00	1	CND	0.70	1.00	1.00	0.70	\$98.00	\$68.60	
341 491 02 17	1.00	1	CND	0.70	1.00	1.00	0.70	\$98.00	\$68.60	
341 491 02 18	1.00	1	CND	0.70	1.00	1.00	0.70	\$98.00	\$68.60	
341 491 02 19	1.00	1	CND	0.70	1.00	1.00	0.70	\$98.00	\$68.60	
341 491 02 20	1.00	1	CND	0.70	1.00	1.00	0.70	\$98.00	\$68.60	
341 491 02 21	1.00	1	CND	0.70	1.00	1.00	0.70	\$98.00	\$68.60	

**EXHIBIT C - Assessment Roll (Fiscal Year 2027)**  
**Camino Santa Fe Maintenance Assessment District**

Parcel Number	Acres/ Units <sup>(1)</sup>	Zone Number	Land Use <sup>(2)</sup>	Apportionment Factors			Total EBU's	Unit Cost (\$/EBU)	FY 2027 <sup>(5)</sup> Assessment	Owner Name
				Land Use <sup>(2)</sup>	Benefit <sup>(3)</sup>	Location <sup>(4)</sup>				
341 491 02 22	1.00	1	CND	0.70	1.00	1.00	0.70	\$98.00	\$68.60	
341 491 02 23	1.00	1	CND	0.70	1.00	1.00	0.70	\$98.00	\$68.60	
341 491 02 24	1.00	1	CND	0.70	1.00	1.00	0.70	\$98.00	\$68.60	
341 491 02 25	1.00	1	CND	0.70	1.00	1.00	0.70	\$98.00	\$68.60	
341 491 02 26	1.00	1	CND	0.70	1.00	1.00	0.70	\$98.00	\$68.60	
341 491 02 27	1.00	1	CND	0.70	1.00	1.00	0.70	\$98.00	\$68.60	
341 491 02 28	1.00	1	CND	0.70	1.00	1.00	0.70	\$98.00	\$68.60	
341 491 02 29	1.00	1	CND	0.70	1.00	1.00	0.70	\$98.00	\$68.60	
341 491 02 30	1.00	1	CND	0.70	1.00	1.00	0.70	\$98.00	\$68.60	
341 491 02 31	1.00	1	CND	0.70	1.00	1.00	0.70	\$98.00	\$68.60	
341 491 02 32	1.00	1	CND	0.70	1.00	1.00	0.70	\$98.00	\$68.60	
341 491 02 33	1.00	1	CND	0.70	1.00	1.00	0.70	\$98.00	\$68.60	
341 491 02 34	1.00	1	CND	0.70	1.00	1.00	0.70	\$98.00	\$68.60	
341 491 02 35	1.00	1	CND	0.70	1.00	1.00	0.70	\$98.00	\$68.60	
341 491 02 36	1.00	1	CND	0.70	1.00	1.00	0.70	\$98.00	\$68.60	
341 491 02 37	1.00	1	CND	0.70	1.00	1.00	0.70	\$98.00	\$68.60	
341 491 02 38	1.00	1	CND	0.70	1.00	1.00	0.70	\$98.00	\$68.60	
341 491 02 39	1.00	1	CND	0.70	1.00	1.00	0.70	\$98.00	\$68.60	
341 491 02 40	1.00	1	CND	0.70	1.00	1.00	0.70	\$98.00	\$68.60	
341 491 02 41	1.00	1	CND	0.70	1.00	1.00	0.70	\$98.00	\$68.60	
341 491 02 42	1.00	1	CND	0.70	1.00	1.00	0.70	\$98.00	\$68.60	
341 491 02 43	1.00	1	CND	0.70	1.00	1.00	0.70	\$98.00	\$68.60	
341 491 02 44	1.00	1	CND	0.70	1.00	1.00	0.70	\$98.00	\$68.60	
341 491 02 45	1.00	1	CND	0.70	1.00	1.00	0.70	\$98.00	\$68.60	
341 491 02 46	1.00	1	CND	0.70	1.00	1.00	0.70	\$98.00	\$68.60	
341 491 02 47	1.00	1	CND	0.70	1.00	1.00	0.70	\$98.00	\$68.60	
341 491 02 48	1.00	1	CND	0.70	1.00	1.00	0.70	\$98.00	\$68.60	
341 491 02 49	1.00	1	CND	0.70	1.00	1.00	0.70	\$98.00	\$68.60	
341 491 02 50	1.00	1	CND	0.70	1.00	1.00	0.70	\$98.00	\$68.60	
341 491 02 51	1.00	1	CND	0.70	1.00	1.00	0.70	\$98.00	\$68.60	
341 491 02 52	1.00	1	CND	0.70	1.00	1.00	0.70	\$98.00	\$68.60	
341 491 02 53	1.00	1	CND	0.70	1.00	1.00	0.70	\$98.00	\$68.60	
341 491 02 54	1.00	1	CND	0.70	1.00	1.00	0.70	\$98.00	\$68.60	
341 491 02 55	1.00	1	CND	0.70	1.00	1.00	0.70	\$98.00	\$68.60	
341 491 02 56	1.00	1	CND	0.70	1.00	1.00	0.70	\$98.00	\$68.60	
341 491 02 57	1.00	1	CND	0.70	1.00	1.00	0.70	\$98.00	\$68.60	
341 491 02 58	1.00	1	CND	0.70	1.00	1.00	0.70	\$98.00	\$68.60	
341 491 02 59	1.00	1	CND	0.70	1.00	1.00	0.70	\$98.00	\$68.60	
341 491 02 60	1.00	1	CND	0.70	1.00	1.00	0.70	\$98.00	\$68.60	
341 491 02 61	1.00	1	CND	0.70	1.00	1.00	0.70	\$98.00	\$68.60	
341 491 02 62	1.00	1	CND	0.70	1.00	1.00	0.70	\$98.00	\$68.60	
341 491 03 01	1.00	1	CND	0.70	1.00	1.00	0.70	\$98.00	\$68.60	
341 491 03 02	1.00	1	CND	0.70	1.00	1.00	0.70	\$98.00	\$68.60	
341 491 03 03	1.00	1	CND	0.70	1.00	1.00	0.70	\$98.00	\$68.60	
341 491 03 04	1.00	1	CND	0.70	1.00	1.00	0.70	\$98.00	\$68.60	
341 491 03 05	1.00	1	CND	0.70	1.00	1.00	0.70	\$98.00	\$68.60	
341 491 03 06	1.00	1	CND	0.70	1.00	1.00	0.70	\$98.00	\$68.60	
341 491 03 07	1.00	1	CND	0.70	1.00	1.00	0.70	\$98.00	\$68.60	
341 491 03 08	1.00	1	CND	0.70	1.00	1.00	0.70	\$98.00	\$68.60	
341 491 03 09	1.00	1	CND	0.70	1.00	1.00	0.70	\$98.00	\$68.60	
341 491 03 10	1.00	1	CND	0.70	1.00	1.00	0.70	\$98.00	\$68.60	
341 491 03 11	1.00	1	CND	0.70	1.00	1.00	0.70	\$98.00	\$68.60	
341 491 03 12	1.00	1	CND	0.70	1.00	1.00	0.70	\$98.00	\$68.60	
341 491 03 13	1.00	1	CND	0.70	1.00	1.00	0.70	\$98.00	\$68.60	
341 491 03 14	1.00	1	CND	0.70	1.00	1.00	0.70	\$98.00	\$68.60	
341 491 03 15	1.00	1	CND	0.70	1.00	1.00	0.70	\$98.00	\$68.60	
341 491 03 16	1.00	1	CND	0.70	1.00	1.00	0.70	\$98.00	\$68.60	
341 491 03 17	1.00	1	CND	0.70	1.00	1.00	0.70	\$98.00	\$68.60	
341 491 03 18	1.00	1	CND	0.70	1.00	1.00	0.70	\$98.00	\$68.60	
341 491 03 19	1.00	1	CND	0.70	1.00	1.00	0.70	\$98.00	\$68.60	
341 491 03 20	1.00	1	CND	0.70	1.00	1.00	0.70	\$98.00	\$68.60	
341 491 03 21	1.00	1	CND	0.70	1.00	1.00	0.70	\$98.00	\$68.60	
341 491 03 22	1.00	1	CND	0.70	1.00	1.00	0.70	\$98.00	\$68.60	
341 491 03 23	1.00	1	CND	0.70	1.00	1.00	0.70	\$98.00	\$68.60	
341 491 03 24	1.00	1	CND	0.70	1.00	1.00	0.70	\$98.00	\$68.60	
341 491 03 25	1.00	1	CND	0.70	1.00	1.00	0.70	\$98.00	\$68.60	

**EXHIBIT C - Assessment Roll (Fiscal Year 2027)**  
**Camino Santa Fe Maintenance Assessment District**

Parcel Number	Acres/ Units <sup>(1)</sup>	Zone Number	Land Use <sup>(2)</sup>	Apportionment Factors			Total EBU's	Unit Cost (\$/EBU)	FY 2027 <sup>(5)</sup> Assessment	Owner Name
				Land Use <sup>(2)</sup>	Benefit <sup>(3)</sup>	Location <sup>(4)</sup>				
341 491 03 26	1.00	1	CND	0.70	1.00	1.00	0.70	\$98.00	\$68.60	
341 491 03 27	1.00	1	CND	0.70	1.00	1.00	0.70	\$98.00	\$68.60	
341 491 03 28	1.00	1	CND	0.70	1.00	1.00	0.70	\$98.00	\$68.60	
341 491 03 29	1.00	1	CND	0.70	1.00	1.00	0.70	\$98.00	\$68.60	
341 491 03 30	1.00	1	CND	0.70	1.00	1.00	0.70	\$98.00	\$68.60	
341 491 03 31	1.00	1	CND	0.70	1.00	1.00	0.70	\$98.00	\$68.60	
341 491 03 32	1.00	1	CND	0.70	1.00	1.00	0.70	\$98.00	\$68.60	
341 491 03 33	1.00	1	CND	0.70	1.00	1.00	0.70	\$98.00	\$68.60	
341 491 03 34	1.00	1	CND	0.70	1.00	1.00	0.70	\$98.00	\$68.60	
341 491 03 35	1.00	1	CND	0.70	1.00	1.00	0.70	\$98.00	\$68.60	
341 491 03 36	1.00	1	CND	0.70	1.00	1.00	0.70	\$98.00	\$68.60	
341 491 03 37	1.00	1	CND	0.70	1.00	1.00	0.70	\$98.00	\$68.60	
341 491 03 38	1.00	1	CND	0.70	1.00	1.00	0.70	\$98.00	\$68.60	
341 491 03 39	1.00	1	CND	0.70	1.00	1.00	0.70	\$98.00	\$68.60	
341 491 03 40	1.00	1	CND	0.70	1.00	1.00	0.70	\$98.00	\$68.60	
341 491 03 41	1.00	1	CND	0.70	1.00	1.00	0.70	\$98.00	\$68.60	
341 491 03 42	1.00	1	CND	0.70	1.00	1.00	0.70	\$98.00	\$68.60	
341 491 03 43	1.00	1	CND	0.70	1.00	1.00	0.70	\$98.00	\$68.60	
341 491 03 44	1.00	1	CND	0.70	1.00	1.00	0.70	\$98.00	\$68.60	
341 491 03 45	1.00	1	CND	0.70	1.00	1.00	0.70	\$98.00	\$68.60	
341 491 03 46	1.00	1	CND	0.70	1.00	1.00	0.70	\$98.00	\$68.60	
341 491 03 47	1.00	1	CND	0.70	1.00	1.00	0.70	\$98.00	\$68.60	
341 491 03 48	1.00	1	CND	0.70	1.00	1.00	0.70	\$98.00	\$68.60	
341 491 03 49	1.00	1	CND	0.70	1.00	1.00	0.70	\$98.00	\$68.60	
341 491 03 50	1.00	1	CND	0.70	1.00	1.00	0.70	\$98.00	\$68.60	
341 491 03 51	1.00	1	CND	0.70	1.00	1.00	0.70	\$98.00	\$68.60	
341 491 03 52	1.00	1	CND	0.70	1.00	1.00	0.70	\$98.00	\$68.60	
341 491 03 53	1.00	1	CND	0.70	1.00	1.00	0.70	\$98.00	\$68.60	
341 491 03 54	1.00	1	CND	0.70	1.00	1.00	0.70	\$98.00	\$68.60	
341 491 03 55	1.00	1	CND	0.70	1.00	1.00	0.70	\$98.00	\$68.60	
341 491 03 56	1.00	1	CND	0.70	1.00	1.00	0.70	\$98.00	\$68.60	
341 491 03 57	1.00	1	CND	0.70	1.00	1.00	0.70	\$98.00	\$68.60	
341 491 03 58	1.00	1	CND	0.70	1.00	1.00	0.70	\$98.00	\$68.60	
341 491 03 59	1.00	1	CND	0.70	1.00	1.00	0.70	\$98.00	\$68.60	
341 491 03 60	1.00	1	CND	0.70	1.00	1.00	0.70	\$98.00	\$68.60	
341 491 03 61	1.00	1	CND	0.70	1.00	1.00	0.70	\$98.00	\$68.60	
341 491 03 62	1.00	1	CND	0.70	1.00	1.00	0.70	\$98.00	\$68.60	
341 491 03 63	1.00	1	CND	0.70	1.00	1.00	0.70	\$98.00	\$68.60	
341 491 03 64	1.00	1	CND	0.70	1.00	1.00	0.70	\$98.00	\$68.60	
341 491 03 65	1.00	1	CND	0.70	1.00	1.00	0.70	\$98.00	\$68.60	
341 491 03 66	1.00	1	CND	0.70	1.00	1.00	0.70	\$98.00	\$68.60	
341 491 03 67	1.00	1	CND	0.70	1.00	1.00	0.70	\$98.00	\$68.60	
341 491 03 68	1.00	1	CND	0.70	1.00	1.00	0.70	\$98.00	\$68.60	
341 491 04 00	5.55	1	VAC	0.00	0.30	1.00	0.00	\$98.00	\$0.00	
341 491 05 00	0.06	1	VAC	0.00	0.30	1.00	0.00	\$98.00	\$0.00	
341 491 06 00	0.18	1	VAC	0.00	0.30	1.00	0.00	\$98.00	\$0.00	
341 491 07 00	0.48	1	OSP	0.00	0.30	1.00	0.00	\$98.00	\$0.00	
341 491 08 00	0.85	1	VAC	0.00	0.30	1.00	0.00	\$98.00	\$0.00	
341 491 09 00	0.17	1	VAC	0.00	0.30	1.00	0.00	\$98.00	\$0.00	
341 491 10 00	0.01	1	VAC	0.00	0.30	1.00	0.00	\$98.00	\$0.00	
341 491 11 00	0.01	1	VAC	0.00	0.30	1.00	0.00	\$98.00	\$0.00	
341 491 12 00	0.05	1	VAC	0.00	0.30	1.00	0.00	\$98.00	\$0.00	
341 491 13 00	4.51	1	OSP	0.00	0.30	1.00	0.00	\$98.00	\$0.00	
341 491 14 01	1.00	1	CND	0.70	1.00	1.00	0.70	\$98.00	\$68.60	
341 491 14 02	1.00	1	CND	0.70	1.00	1.00	0.70	\$98.00	\$68.60	
341 491 14 03	1.00	1	CND	0.70	1.00	1.00	0.70	\$98.00	\$68.60	
341 491 14 04	1.00	1	CND	0.70	1.00	1.00	0.70	\$98.00	\$68.60	
341 491 14 05	1.00	1	CND	0.70	1.00	1.00	0.70	\$98.00	\$68.60	
341 491 14 06	1.00	1	CND	0.70	1.00	1.00	0.70	\$98.00	\$68.60	
341 491 14 07	1.00	1	CND	0.70	1.00	1.00	0.70	\$98.00	\$68.60	
341 491 14 08	1.00	1	CND	0.70	1.00	1.00	0.70	\$98.00	\$68.60	
341 491 14 09	1.00	1	CND	0.70	1.00	1.00	0.70	\$98.00	\$68.60	
341 491 14 10	1.00	1	CND	0.70	1.00	1.00	0.70	\$98.00	\$68.60	
341 491 14 11	1.00	1	CND	0.70	1.00	1.00	0.70	\$98.00	\$68.60	
341 491 14 12	1.00	1	CND	0.70	1.00	1.00	0.70	\$98.00	\$68.60	
341 491 14 13	1.00	1	CND	0.70	1.00	1.00	0.70	\$98.00	\$68.60	

**EXHIBIT C - Assessment Roll (Fiscal Year 2027)**  
**Camino Santa Fe Maintenance Assessment District**

Parcel Number	Acres/ Units <sup>(1)</sup>	Zone Number	Land Use <sup>(2)</sup>	Apportionment Factors			Total EBU's	Unit Cost (\$/EBU)	FY 2027 <sup>(5)</sup> Assessment	Owner Name
				Land Use <sup>(2)</sup>	Benefit <sup>(3)</sup>	Location <sup>(4)</sup>				
341 491 14 14	1.00	1	CND	0.70	1.00	1.00	0.70	\$98.00	\$68.60	
341 491 14 15	1.00	1	CND	0.70	1.00	1.00	0.70	\$98.00	\$68.60	
341 491 14 16	1.00	1	CND	0.70	1.00	1.00	0.70	\$98.00	\$68.60	
341 491 14 17	1.00	1	CND	0.70	1.00	1.00	0.70	\$98.00	\$68.60	
341 491 14 18	1.00	1	CND	0.70	1.00	1.00	0.70	\$98.00	\$68.60	
341 491 14 19	1.00	1	CND	0.70	1.00	1.00	0.70	\$98.00	\$68.60	
341 491 14 20	1.00	1	CND	0.70	1.00	1.00	0.70	\$98.00	\$68.60	
341 491 14 21	1.00	1	CND	0.70	1.00	1.00	0.70	\$98.00	\$68.60	
341 491 14 22	1.00	1	CND	0.70	1.00	1.00	0.70	\$98.00	\$68.60	
341 491 14 23	1.00	1	CND	0.70	1.00	1.00	0.70	\$98.00	\$68.60	
341 491 14 24	1.00	1	CND	0.70	1.00	1.00	0.70	\$98.00	\$68.60	
341 491 14 25	1.00	1	CND	0.70	1.00	1.00	0.70	\$98.00	\$68.60	
341 491 14 26	1.00	1	CND	0.70	1.00	1.00	0.70	\$98.00	\$68.60	
341 491 14 27	1.00	1	CND	0.70	1.00	1.00	0.70	\$98.00	\$68.60	
341 491 14 28	1.00	1	CND	0.70	1.00	1.00	0.70	\$98.00	\$68.60	
341 491 14 29	1.00	1	CND	0.70	1.00	1.00	0.70	\$98.00	\$68.60	
341 491 14 30	1.00	1	CND	0.70	1.00	1.00	0.70	\$98.00	\$68.60	
341 491 14 31	1.00	1	CND	0.70	1.00	1.00	0.70	\$98.00	\$68.60	
341 491 14 32	1.00	1	CND	0.70	1.00	1.00	0.70	\$98.00	\$68.60	
341 491 14 33	1.00	1	CND	0.70	1.00	1.00	0.70	\$98.00	\$68.60	
341 491 14 34	1.00	1	CND	0.70	1.00	1.00	0.70	\$98.00	\$68.60	
341 491 14 35	1.00	1	CND	0.70	1.00	1.00	0.70	\$98.00	\$68.60	
341 491 14 36	1.00	1	CND	0.70	1.00	1.00	0.70	\$98.00	\$68.60	
341 491 14 37	1.00	1	CND	0.70	1.00	1.00	0.70	\$98.00	\$68.60	
341 491 14 38	1.00	1	CND	0.70	1.00	1.00	0.70	\$98.00	\$68.60	
341 491 14 39	1.00	1	CND	0.70	1.00	1.00	0.70	\$98.00	\$68.60	
341 491 14 40	1.00	1	CND	0.70	1.00	1.00	0.70	\$98.00	\$68.60	
341 491 14 41	1.00	1	CND	0.70	1.00	1.00	0.70	\$98.00	\$68.60	
341 491 14 42	1.00	1	CND	0.70	1.00	1.00	0.70	\$98.00	\$68.60	
341 491 14 43	1.00	1	CND	0.70	1.00	1.00	0.70	\$98.00	\$68.60	
341 491 14 44	1.00	1	CND	0.70	1.00	1.00	0.70	\$98.00	\$68.60	
341 491 14 45	1.00	1	CND	0.70	1.00	1.00	0.70	\$98.00	\$68.60	
341 491 14 46	1.00	1	CND	0.70	1.00	1.00	0.70	\$98.00	\$68.60	
341 491 14 47	1.00	1	CND	0.70	1.00	1.00	0.70	\$98.00	\$68.60	
341 491 14 48	1.00	1	CND	0.70	1.00	1.00	0.70	\$98.00	\$68.60	
341 491 14 49	1.00	1	CND	0.70	1.00	1.00	0.70	\$98.00	\$68.60	
341 491 14 50	1.00	1	CND	0.70	1.00	1.00	0.70	\$98.00	\$68.60	
341 491 14 51	1.00	1	CND	0.70	1.00	1.00	0.70	\$98.00	\$68.60	
341 491 14 52	1.00	1	CND	0.70	1.00	1.00	0.70	\$98.00	\$68.60	
341 491 14 53	1.00	1	CND	0.70	1.00	1.00	0.70	\$98.00	\$68.60	
341 491 14 54	1.00	1	CND	0.70	1.00	1.00	0.70	\$98.00	\$68.60	
341 491 14 55	1.00	1	CND	0.70	1.00	1.00	0.70	\$98.00	\$68.60	
341 491 14 56	1.00	1	CND	0.70	1.00	1.00	0.70	\$98.00	\$68.60	
341 491 15 00	4.94	1	OSP	0.00	0.30	1.00	0.00	\$98.00	\$0.00	
341 491 16 00	4.03	1	OSP	0.00	0.30	1.00	0.00	\$98.00	\$0.00	
341 520 01 00	0.08	2	OSP	0.00	0.30	0.10	0.00	\$98.00	\$0.00	
341 520 02 00	1.00	2	SFD	1.00	1.00	0.10	0.10	\$98.00	\$9.80	
341 520 03 00	1.00	2	SFD	1.00	1.00	0.10	0.10	\$98.00	\$9.80	
341 520 04 00	1.00	2	SFD	1.00	1.00	0.10	0.10	\$98.00	\$9.80	
341 520 05 00	1.00	2	SFD	1.00	1.00	0.10	0.10	\$98.00	\$9.80	
341 520 06 00	1.00	2	SFD	1.00	1.00	0.10	0.10	\$98.00	\$9.80	
341 520 07 00	1.00	2	SFD	1.00	1.00	0.10	0.10	\$98.00	\$9.80	
341 520 08 00	1.00	2	SFD	1.00	1.00	0.10	0.10	\$98.00	\$9.80	
341 520 09 00	1.00	2	SFD	1.00	1.00	0.10	0.10	\$98.00	\$9.80	
341 520 10 00	1.00	2	SFD	1.00	1.00	0.10	0.10	\$98.00	\$9.80	
341 520 11 00	1.00	2	SFD	1.00	1.00	0.10	0.10	\$98.00	\$9.80	
341 520 12 00	1.00	2	SFD	1.00	1.00	0.10	0.10	\$98.00	\$9.80	
341 520 13 00	1.00	2	SFD	1.00	1.00	0.10	0.10	\$98.00	\$9.80	
341 520 14 00	1.00	2	SFD	1.00	1.00	0.10	0.10	\$98.00	\$9.80	
341 520 15 00	1.00	2	SFD	1.00	1.00	0.10	0.10	\$98.00	\$9.80	
341 520 16 00	1.00	2	SFD	1.00	1.00	0.10	0.10	\$98.00	\$9.80	
341 520 17 00	1.00	2	SFD	1.00	1.00	0.10	0.10	\$98.00	\$9.80	
341 520 18 00	1.00	2	SFD	1.00	1.00	0.10	0.10	\$98.00	\$9.80	
341 520 19 00	1.00	2	SFD	1.00	1.00	0.10	0.10	\$98.00	\$9.80	
341 520 20 00	1.00	2	SFD	1.00	1.00	0.10	0.10	\$98.00	\$9.80	
341 520 21 00	1.00	2	SFD	1.00	1.00	0.10	0.10	\$98.00	\$9.80	

**EXHIBIT C - Assessment Roll (Fiscal Year 2027)**  
**Camino Santa Fe Maintenance Assessment District**

Parcel Number	Acres/ Units <sup>(1)</sup>	Zone Number	Land Use <sup>(2)</sup>	Apportionment Factors			Total EBU	Unit Cost (\$/EBU)	FY 2027 <sup>(5)</sup> Assessment	Owner Name
				Land Use <sup>(2)</sup>	Benefit <sup>(3)</sup>	Location <sup>(4)</sup>				
341 520 22 00	1.00	2	SFD	1.00	1.00	0.10	0.10	\$98.00	\$9.80	
341 520 23 00	1.00	2	SFD	1.00	1.00	0.10	0.10	\$98.00	\$9.80	
341 520 24 00	1.00	2	SFD	1.00	1.00	0.10	0.10	\$98.00	\$9.80	
341 520 25 00	1.00	2	SFD	1.00	1.00	0.10	0.10	\$98.00	\$9.80	
341 520 26 00	1.00	2	SFD	1.00	1.00	0.10	0.10	\$98.00	\$9.80	
341 520 27 00	1.00	2	SFD	1.00	1.00	0.10	0.10	\$98.00	\$9.80	
341 520 28 00	1.00	2	SFD	1.00	1.00	0.10	0.10	\$98.00	\$9.80	
341 520 29 00	1.00	2	SFD	1.00	1.00	0.10	0.10	\$98.00	\$9.80	
341 520 30 00	1.00	2	SFD	1.00	1.00	0.10	0.10	\$98.00	\$9.80	
341 520 31 00	1.00	2	SFD	1.00	1.00	0.10	0.10	\$98.00	\$9.80	
341 520 32 00	1.00	2	SFD	1.00	1.00	0.10	0.10	\$98.00	\$9.80	
341 520 33 00	1.00	2	SFD	1.00	1.00	0.10	0.10	\$98.00	\$9.80	
341 520 34 00	1.00	2	SFD	1.00	1.00	0.10	0.10	\$98.00	\$9.80	
341 520 35 00	1.00	2	SFD	1.00	1.00	0.10	0.10	\$98.00	\$9.80	
341 520 36 00	1.00	2	SFD	1.00	1.00	0.10	0.10	\$98.00	\$9.80	
341 520 37 00	1.00	2	SFD	1.00	1.00	0.10	0.10	\$98.00	\$9.80	
341 520 38 00	1.00	2	SFD	1.00	1.00	0.10	0.10	\$98.00	\$9.80	
341 520 39 00	1.00	2	SFD	1.00	1.00	0.10	0.10	\$98.00	\$9.80	
341 520 40 00	1.00	2	SFD	1.00	1.00	0.10	0.10	\$98.00	\$9.80	
341 520 41 00	1.00	2	SFD	1.00	1.00	0.10	0.10	\$98.00	\$9.80	
341 520 42 00	1.00	2	SFD	1.00	1.00	0.10	0.10	\$98.00	\$9.80	
341 520 43 00	1.00	2	SFD	1.00	1.00	0.10	0.10	\$98.00	\$9.80	
341 520 44 00	1.00	2	SFD	1.00	1.00	0.10	0.10	\$98.00	\$9.80	
341 520 45 00	1.00	2	SFD	1.00	1.00	0.10	0.10	\$98.00	\$9.80	
341 520 46 00	1.00	2	SFD	1.00	1.00	0.10	0.10	\$98.00	\$9.80	
341 520 47 00	1.00	2	SFD	1.00	1.00	0.10	0.10	\$98.00	\$9.80	
341 520 48 00	1.00	2	SFD	1.00	1.00	0.10	0.10	\$98.00	\$9.80	
341 520 49 00	1.00	2	SFD	1.00	1.00	0.10	0.10	\$98.00	\$9.80	
341 520 50 00	1.00	2	SFD	1.00	1.00	0.10	0.10	\$98.00	\$9.80	
341 520 51 00	1.00	2	SFD	1.00	1.00	0.10	0.10	\$98.00	\$9.80	
341 520 52 00	1.00	2	SFD	1.00	1.00	0.10	0.10	\$98.00	\$9.80	
341 520 53 00	1.00	2	SFD	1.00	1.00	0.10	0.10	\$98.00	\$9.80	
341 520 54 00	1.00	2	SFD	1.00	1.00	0.10	0.10	\$98.00	\$9.80	
341 520 55 00	1.00	2	SFD	1.00	1.00	0.10	0.10	\$98.00	\$9.80	
341 520 56 00	1.00	2	SFD	1.00	1.00	0.10	0.10	\$98.00	\$9.80	
341 520 57 00	0.85	2	OSP	0.00	0.30	0.10	0.00	\$98.00	\$0.00	
341 520 57 00	1.01	2	VAC	0.00	0.30	0.10	0.00	\$98.00	\$0.00	
341 520 58 00	0.12	2	OSP	0.00	0.30	0.10	0.00	\$98.00	\$0.00	
341 521 01 00	0.05	2	OSP	0.00	0.30	0.10	0.00	\$98.00	\$0.00	
341 521 02 00	1.00	2	SFD	1.00	1.00	0.10	0.10	\$98.00	\$9.80	
341 521 03 00	1.00	2	SFD	1.00	1.00	0.10	0.10	\$98.00	\$9.80	
341 521 04 00	1.00	2	SFD	1.00	1.00	0.10	0.10	\$98.00	\$9.80	
341 521 05 00	1.00	2	SFD	1.00	1.00	0.10	0.10	\$98.00	\$9.80	
341 521 06 00	1.00	2	SFD	1.00	1.00	0.10	0.10	\$98.00	\$9.80	
341 521 07 00	1.00	2	SFD	1.00	1.00	0.10	0.10	\$98.00	\$9.80	
341 521 08 00	1.00	2	SFD	1.00	1.00	0.10	0.10	\$98.00	\$9.80	
341 521 09 00	1.00	2	SFD	1.00	1.00	0.10	0.10	\$98.00	\$9.80	
341 521 10 00	1.00	2	SFD	1.00	1.00	0.10	0.10	\$98.00	\$9.80	
341 521 11 00	1.00	2	SFD	1.00	1.00	0.10	0.10	\$98.00	\$9.80	
341 521 12 00	1.00	2	SFD	1.00	1.00	0.10	0.10	\$98.00	\$9.80	
341 521 13 00	1.00	2	SFD	1.00	1.00	0.10	0.10	\$98.00	\$9.80	
341 521 14 00	1.00	2	SFD	1.00	1.00	0.10	0.10	\$98.00	\$9.80	
341 521 15 00	1.00	2	SFD	1.00	1.00	0.10	0.10	\$98.00	\$9.80	
341 521 16 00	1.00	2	SFD	1.00	1.00	0.10	0.10	\$98.00	\$9.80	
341 521 17 00	1.00	2	SFD	1.00	1.00	0.10	0.10	\$98.00	\$9.80	
341 521 18 00	1.00	2	SFD	1.00	1.00	0.10	0.10	\$98.00	\$9.80	
341 521 19 00	1.00	2	SFD	1.00	1.00	0.10	0.10	\$98.00	\$9.80	
341 521 20 00	1.00	2	SFD	1.00	1.00	0.10	0.10	\$98.00	\$9.80	
341 521 21 00	1.00	2	SFD	1.00	1.00	0.10	0.10	\$98.00	\$9.80	
341 521 22 00	1.00	2	SFD	1.00	1.00	0.10	0.10	\$98.00	\$9.80	
341 521 23 00	1.00	2	SFD	1.00	1.00	0.10	0.10	\$98.00	\$9.80	
341 521 24 00	1.00	2	SFD	1.00	1.00	0.10	0.10	\$98.00	\$9.80	
341 521 25 00	0.94	2	OSP	0.00	0.30	0.10	0.00	\$98.00	\$0.00	
341 522 01 00	0.04	2	OSP	0.00	0.30	0.10	0.00	\$98.00	\$0.00	
341 522 02 00	0.40	2	STR	0.00	0.30	0.10	0.00	\$98.00	\$0.00	
341 522 03 00	0.01	2	OSP	0.00	0.30	0.10	0.00	\$98.00	\$0.00	

**EXHIBIT C - Assessment Roll (Fiscal Year 2027)**  
**Camino Santa Fe Maintenance Assessment District**

Parcel Number	Acres/ Units <sup>(1)</sup>	Zone Number	Land Use <sup>(2)</sup>	Apportionment Factors			Total EBU	Unit Cost (\$/EBU)	FY 2027 <sup>(5)</sup> Assessment	Owner Name
				Land Use <sup>(2)</sup>	Benefit <sup>(3)</sup>	Location <sup>(4)</sup>				
341 522 04 00	1.00	2	SFD	1.00	1.00	0.10	0.10	\$98.00	\$9.80	
341 522 05 00	1.00	2	SFD	1.00	1.00	0.10	0.10	\$98.00	\$9.80	
341 522 06 00	1.00	2	SFD	1.00	1.00	0.10	0.10	\$98.00	\$9.80	
341 522 07 00	1.00	2	SFD	1.00	1.00	0.10	0.10	\$98.00	\$9.80	
341 522 08 00	1.00	2	SFD	1.00	1.00	0.10	0.10	\$98.00	\$9.80	
341 522 09 00	1.00	2	SFD	1.00	1.00	0.10	0.10	\$98.00	\$9.80	
341 522 10 00	1.00	2	SFD	1.00	1.00	0.10	0.10	\$98.00	\$9.80	
341 522 11 00	1.00	2	SFD	1.00	1.00	0.10	0.10	\$98.00	\$9.80	
341 522 12 00	1.00	2	SFD	1.00	1.00	0.10	0.10	\$98.00	\$9.80	
341 522 13 00	1.00	2	SFD	1.00	1.00	0.10	0.10	\$98.00	\$9.80	
341 522 14 00	1.00	2	SFD	1.00	1.00	0.10	0.10	\$98.00	\$9.80	
341 522 15 00	1.00	2	SFD	1.00	1.00	0.10	0.10	\$98.00	\$9.80	
341 522 16 00	1.00	2	SFD	1.00	1.00	0.10	0.10	\$98.00	\$9.80	
341 522 17 00	1.00	2	SFD	1.00	1.00	0.10	0.10	\$98.00	\$9.80	
341 522 18 00	1.00	2	SFD	1.00	1.00	0.10	0.10	\$98.00	\$9.80	
341 522 19 00	1.00	2	SFD	1.00	1.00	0.10	0.10	\$98.00	\$9.80	
341 522 20 00	1.00	2	SFD	1.00	1.00	0.10	0.10	\$98.00	\$9.80	
341 522 21 00	1.00	2	SFD	1.00	1.00	0.10	0.10	\$98.00	\$9.80	
341 522 22 00	1.00	2	SFD	1.00	1.00	0.10	0.10	\$98.00	\$9.80	
341 522 23 00	1.00	2	SFD	1.00	1.00	0.10	0.10	\$98.00	\$9.80	
341 522 24 00	1.00	2	SFD	1.00	1.00	0.10	0.10	\$98.00	\$9.80	
341 522 25 00	1.00	2	SFD	1.00	1.00	0.10	0.10	\$98.00	\$9.80	
341 522 26 00	1.00	2	SFD	1.00	1.00	0.10	0.10	\$98.00	\$9.80	
341 522 27 00	1.00	2	SFD	1.00	1.00	0.10	0.10	\$98.00	\$9.80	
341 522 28 00	1.00	2	SFD	1.00	1.00	0.10	0.10	\$98.00	\$9.80	
341 522 29 00	1.00	2	SFD	1.00	1.00	0.10	0.10	\$98.00	\$9.80	
341 522 30 00	1.00	2	SFD	1.00	1.00	0.10	0.10	\$98.00	\$9.80	
341 522 31 00	1.00	2	SFD	1.00	1.00	0.10	0.10	\$98.00	\$9.80	
341 522 32 00	1.00	2	SFD	1.00	1.00	0.10	0.10	\$98.00	\$9.80	
341 522 33 00	1.00	2	SFD	1.00	1.00	0.10	0.10	\$98.00	\$9.80	
341 522 34 00	1.00	2	SFD	1.00	1.00	0.10	0.10	\$98.00	\$9.80	
341 522 35 00	1.00	2	SFD	1.00	1.00	0.10	0.10	\$98.00	\$9.80	
341 522 36 00	1.00	2	SFD	1.00	1.00	0.10	0.10	\$98.00	\$9.80	
341 522 37 00	1.00	2	SFD	1.00	1.00	0.10	0.10	\$98.00	\$9.80	
341 522 38 00	1.00	2	SFD	1.00	1.00	0.10	0.10	\$98.00	\$9.80	
341 522 39 00	1.00	2	SFD	1.00	1.00	0.10	0.10	\$98.00	\$9.80	
341 522 40 00	1.00	2	SFD	1.00	1.00	0.10	0.10	\$98.00	\$9.80	
341 522 41 00	1.00	2	SFD	1.00	1.00	0.10	0.10	\$98.00	\$9.80	
341 522 42 00	1.00	2	SFD	1.00	1.00	0.10	0.10	\$98.00	\$9.80	
341 522 43 00	1.00	2	SFD	1.00	1.00	0.10	0.10	\$98.00	\$9.80	
341 522 44 00	1.00	2	SFD	1.00	1.00	0.10	0.10	\$98.00	\$9.80	
341 522 45 00	1.00	2	SFD	1.00	1.00	0.10	0.10	\$98.00	\$9.80	
341 522 46 00	1.00	2	SFD	1.00	1.00	0.10	0.10	\$98.00	\$9.80	
341 522 47 00	1.00	2	SFD	1.00	1.00	0.10	0.10	\$98.00	\$9.80	
341 522 48 00	1.00	2	SFD	1.00	1.00	0.10	0.10	\$98.00	\$9.80	
341 522 49 00	1.00	2	SFD	1.00	1.00	0.10	0.10	\$98.00	\$9.80	
341 522 50 00	1.00	2	SFD	1.00	1.00	0.10	0.10	\$98.00	\$9.80	
341 522 51 00	1.00	2	SFD	1.00	1.00	0.10	0.10	\$98.00	\$9.80	
341 522 52 00	1.00	2	SFD	1.00	1.00	0.10	0.10	\$98.00	\$9.80	
341 522 53 00	1.00	2	SFD	1.00	1.00	0.10	0.10	\$98.00	\$9.80	
341 522 54 00	1.00	2	SFD	1.00	1.00	0.10	0.10	\$98.00	\$9.80	
341 522 55 00	1.00	2	SFD	1.00	1.00	0.10	0.10	\$98.00	\$9.80	
341 522 56 00	1.00	2	SFD	1.00	1.00	0.10	0.10	\$98.00	\$9.80	
341 522 57 00	1.00	2	SFD	1.00	1.00	0.10	0.10	\$98.00	\$9.80	
341 522 58 00	0.18	2	OSP	0.00	0.30	0.10	0.00	\$98.00	\$0.00	
341 522 59 00	0.36	2	OSP	0.00	0.30	0.10	0.00	\$98.00	\$0.00	
341 523 01 00	1.56	2	STR	0.00	0.30	0.10	0.00	\$98.00	\$0.00	
341 523 02 00	0.06	2	OSP	0.00	0.30	0.10	0.00	\$98.00	\$0.00	
341 523 03 00	1.00	2	SFD	1.00	1.00	0.10	0.10	\$98.00	\$9.80	
341 523 04 00	1.00	2	SFD	1.00	1.00	0.10	0.10	\$98.00	\$9.80	
341 523 05 00	1.00	2	SFD	1.00	1.00	0.10	0.10	\$98.00	\$9.80	
341 523 06 00	1.00	2	SFD	1.00	1.00	0.10	0.10	\$98.00	\$9.80	
341 523 07 00	1.00	2	SFD	1.00	1.00	0.10	0.10	\$98.00	\$9.80	
341 523 08 00	1.00	2	SFD	1.00	1.00	0.10	0.10	\$98.00	\$9.80	
341 523 09 00	1.00	2	SFD	1.00	1.00	0.10	0.10	\$98.00	\$9.80	
341 523 10 00	1.00	2	SFD	1.00	1.00	0.10	0.10	\$98.00	\$9.80	

**EXHIBIT C - Assessment Roll (Fiscal Year 2027)**  
**Camino Santa Fe Maintenance Assessment District**

Parcel Number	Acres/ Units <sup>(1)</sup>	Zone Number	Land Use <sup>(2)</sup>	Apportionment Factors			Total EBU	Unit Cost (\$/EBU)	FY 2027 <sup>(5)</sup> Assessment	Owner Name
				Land Use <sup>(2)</sup>	Benefit <sup>(3)</sup>	Location <sup>(4)</sup>				
341 523 11 00	1.00	2	SFD	1.00	1.00	0.10	0.10	\$98.00	\$9.80	
341 523 12 00	1.00	2	SFD	1.00	1.00	0.10	0.10	\$98.00	\$9.80	
341 523 13 00	1.00	2	SFD	1.00	1.00	0.10	0.10	\$98.00	\$9.80	
341 523 14 00	1.00	2	SFD	1.00	1.00	0.10	0.10	\$98.00	\$9.80	
341 523 15 00	1.00	2	SFD	1.00	1.00	0.10	0.10	\$98.00	\$9.80	
341 523 16 00	1.00	2	SFD	1.00	1.00	0.10	0.10	\$98.00	\$9.80	
341 523 17 00	1.00	2	SFD	1.00	1.00	0.10	0.10	\$98.00	\$9.80	
341 523 18 00	1.00	2	SFD	1.00	1.00	0.10	0.10	\$98.00	\$9.80	
341 523 19 00	1.00	2	SFD	1.00	1.00	0.10	0.10	\$98.00	\$9.80	
341 523 20 00	1.00	2	SFD	1.00	1.00	0.10	0.10	\$98.00	\$9.80	
341 523 21 00	1.00	2	SFD	1.00	1.00	0.10	0.10	\$98.00	\$9.80	
341 523 22 00	1.00	2	SFD	1.00	1.00	0.10	0.10	\$98.00	\$9.80	
341 523 23 00	1.00	2	SFD	1.00	1.00	0.10	0.10	\$98.00	\$9.80	
341 523 24 00	1.00	2	SFD	1.00	1.00	0.10	0.10	\$98.00	\$9.80	
341 523 25 00	1.00	2	SFD	1.00	1.00	0.10	0.10	\$98.00	\$9.80	
341 523 26 00	1.00	2	SFD	1.00	1.00	0.10	0.10	\$98.00	\$9.80	
341 523 27 00	1.00	2	SFD	1.00	1.00	0.10	0.10	\$98.00	\$9.80	
341 523 28 00	1.00	2	SFD	1.00	1.00	0.10	0.10	\$98.00	\$9.80	
341 523 29 00	1.00	2	SFD	1.00	1.00	0.10	0.10	\$98.00	\$9.80	
341 523 30 00	1.00	2	SFD	1.00	1.00	0.10	0.10	\$98.00	\$9.80	
341 523 31 00	1.00	2	SFD	1.00	1.00	0.10	0.10	\$98.00	\$9.80	
341 523 32 00	1.00	2	SFD	1.00	1.00	0.10	0.10	\$98.00	\$9.80	
341 523 33 00	1.00	2	SFD	1.00	1.00	0.10	0.10	\$98.00	\$9.80	
341 523 34 00	1.00	2	SFD	1.00	1.00	0.10	0.10	\$98.00	\$9.80	
341 523 35 00	1.00	2	SFD	1.00	1.00	0.10	0.10	\$98.00	\$9.80	
341 523 36 00	1.00	2	SFD	1.00	1.00	0.10	0.10	\$98.00	\$9.80	
341 523 37 00	1.00	2	SFD	1.00	1.00	0.10	0.10	\$98.00	\$9.80	
341 523 38 00	1.00	2	SFD	1.00	1.00	0.10	0.10	\$98.00	\$9.80	
341 523 39 00	1.00	2	SFD	1.00	1.00	0.10	0.10	\$98.00	\$9.80	
341 523 40 00	1.00	2	SFD	1.00	1.00	0.10	0.10	\$98.00	\$9.80	
341 523 41 00	1.00	2	SFD	1.00	1.00	0.10	0.10	\$98.00	\$9.80	
341 523 42 00	1.00	2	SFD	1.00	1.00	0.10	0.10	\$98.00	\$9.80	
341 523 43 00	1.00	2	SFD	1.00	1.00	0.10	0.10	\$98.00	\$9.80	
341 523 44 00	1.00	2	SFD	1.00	1.00	0.10	0.10	\$98.00	\$9.80	
341 523 45 00	1.00	2	SFD	1.00	1.00	0.10	0.10	\$98.00	\$9.80	
341 523 46 00	1.00	2	SFD	1.00	1.00	0.10	0.10	\$98.00	\$9.80	
341 523 47 00	1.00	2	SFD	1.00	1.00	0.10	0.10	\$98.00	\$9.80	
341 523 48 00	1.00	2	SFD	1.00	1.00	0.10	0.10	\$98.00	\$9.80	
341 523 49 00	1.00	2	SFD	1.00	1.00	0.10	0.10	\$98.00	\$9.80	
341 523 50 00	1.00	2	SFD	1.00	1.00	0.10	0.10	\$98.00	\$9.80	
341 523 51 00	1.00	2	SFD	1.00	1.00	0.10	0.10	\$98.00	\$9.80	
341 523 52 00	1.00	2	SFD	1.00	1.00	0.10	0.10	\$98.00	\$9.80	
341 523 53 00	1.00	2	SFD	1.00	1.00	0.10	0.10	\$98.00	\$9.80	
341 523 54 00	1.00	2	SFD	1.00	1.00	0.10	0.10	\$98.00	\$9.80	
341 523 55 00	1.00	2	SFD	1.00	1.00	0.10	0.10	\$98.00	\$9.80	
341 523 56 00	1.71	2	VAC	0.00	0.30	0.10	0.00	\$98.00	\$0.00	
343 061 01 00	0.08	2	SCOM	30.00	0.60	0.10	0.14	\$98.00	\$14.10	
343 061 02 00	0.07	2	SCOM	30.00	0.60	0.10	0.13	\$98.00	\$12.34	
343 061 03 00	0.07	2	SCOM	30.00	0.60	0.10	0.13	\$98.00	\$12.34	
343 061 04 00	0.08	2	SCOM	30.00	0.60	0.10	0.14	\$98.00	\$14.10	
343 061 05 00	0.08	2	SCOM	30.00	0.60	0.10	0.14	\$98.00	\$14.10	
343 061 06 00	0.09	2	SCOM	30.00	0.60	0.10	0.16	\$98.00	\$15.88	
343 061 07 00	0.09	2	SCOM	30.00	0.60	0.10	0.16	\$98.00	\$15.88	
343 061 08 00	0.08	2	SCOM	30.00	0.60	0.10	0.14	\$98.00	\$14.10	
343 061 09 00	0.08	2	SCOM	30.00	0.60	0.10	0.14	\$98.00	\$14.10	
343 061 10 00	0.08	2	SCOM	30.00	0.60	0.10	0.14	\$98.00	\$14.10	
343 061 11 00	0.08	2	SCOM	30.00	0.60	0.10	0.14	\$98.00	\$14.10	
343 061 12 00	0.08	2	SCOM	30.00	0.60	0.10	0.14	\$98.00	\$14.10	
343 061 13 00	0.08	2	SCOM	30.00	0.60	0.10	0.14	\$98.00	\$14.10	
343 061 14 00	0.08	2	SCOM	30.00	0.60	0.10	0.14	\$98.00	\$14.10	
343 061 15 00	0.09	2	SCOM	30.00	0.60	0.10	0.16	\$98.00	\$15.88	
343 061 16 00	0.08	2	SCOM	30.00	0.60	0.10	0.14	\$98.00	\$14.10	
343 061 17 00	0.08	2	SCOM	30.00	0.60	0.10	0.14	\$98.00	\$14.10	
343 061 18 00	0.09	2	SCOM	30.00	0.60	0.10	0.16	\$98.00	\$15.88	
343 061 19 00	0.10	2	SCOM	30.00	0.60	0.10	0.18	\$98.00	\$17.64	
343 061 20 00	0.09	2	SCOM	30.00	0.60	0.10	0.16	\$98.00	\$15.88	

**EXHIBIT C - Assessment Roll (Fiscal Year 2027)**  
**Camino Santa Fe Maintenance Assessment District**

Parcel Number	Acres/ Units <sup>(1)</sup>	Zone Number	Land Use <sup>(2)</sup>	Apportionment Factors			Total EBU's	Unit Cost (\$/EBU)	FY 2027 <sup>(5)</sup> Assessment	Owner Name
				Land Use <sup>(2)</sup>	Benefit <sup>(3)</sup>	Location <sup>(4)</sup>				
343 061 21 00	0.10	2	SCOM	30.00	0.60	0.10	0.18	\$98.00	\$17.64	
343 061 22 00	0.08	2	SCOM	30.00	0.60	0.10	0.14	\$98.00	\$14.10	
343 061 23 00	0.08	2	SCOM	30.00	0.60	0.10	0.14	\$98.00	\$14.10	
343 061 24 00	0.10	2	SCOM	30.00	0.60	0.10	0.18	\$98.00	\$17.64	
343 061 25 00	0.09	2	SCOM	30.00	0.60	0.10	0.16	\$98.00	\$15.88	
343 061 26 00	0.08	2	SCOM	30.00	0.60	0.10	0.14	\$98.00	\$14.10	
343 061 27 00	9.28	2	OSP	0.00	0.30	0.10	0.00	\$98.00	\$0.00	
343 061 28 00	0.08	2	SCOM	30.00	0.60	0.10	0.14	\$98.00	\$14.10	
343 061 29 00	0.08	2	SCOM	30.00	0.60	0.10	0.14	\$98.00	\$14.10	
343 061 30 00	0.08	2	SCOM	30.00	0.60	0.10	0.14	\$98.00	\$14.10	
343 061 31 00	0.09	2	SCOM	30.00	0.60	0.10	0.16	\$98.00	\$15.88	
343 061 32 00	0.09	2	SCOM	30.00	0.60	0.10	0.16	\$98.00	\$15.88	
343 061 33 00	0.07	2	COM	45.00	0.60	0.10	0.19	\$98.00	\$18.52	
343 061 34 00	0.08	2	SCOM	30.00	0.60	0.10	0.14	\$98.00	\$14.10	
343 061 35 00	0.07	2	SCOM	30.00	0.60	0.10	0.13	\$98.00	\$12.34	
343 061 36 00	0.11	2	SCOM	30.00	0.60	0.10	0.20	\$98.00	\$19.40	
343 061 37 00	0.11	2	COM	45.00	0.60	0.10	0.30	\$98.00	\$29.10	
343 061 38 00	0.11	2	COM	45.00	0.60	0.10	0.30	\$98.00	\$29.10	
343 061 39 00	0.09	2	COM	45.00	0.60	0.10	0.24	\$98.00	\$23.80	
343 061 40 00	0.07	2	SCOM	30.00	0.60	0.10	0.13	\$98.00	\$12.34	
343 061 41 00	0.11	2	SCOM	30.00	0.60	0.10	0.20	\$98.00	\$19.40	
343 061 42 00	0.10	2	SCOM	30.00	0.60	0.10	0.18	\$98.00	\$17.64	
343 061 43 00	0.10	2	SCOM	30.00	0.60	0.10	0.18	\$98.00	\$17.64	
343 061 44 00	0.10	2	SCOM	30.00	0.60	0.10	0.18	\$98.00	\$17.64	
343 061 45 00	0.11	2	COM	45.00	0.60	0.10	0.30	\$98.00	\$29.10	
343 061 46 00	0.12	2	COM	45.00	0.60	0.10	0.32	\$98.00	\$31.74	
343 061 47 00	0.11	2	SCOM	30.00	0.60	0.10	0.20	\$98.00	\$19.40	
343 061 48 00	0.11	2	COM	45.00	0.60	0.10	0.30	\$98.00	\$29.10	
343 061 49 00	0.12	2	COM	45.00	0.60	0.10	0.32	\$98.00	\$31.74	
343 061 50 00	0.11	2	COM	45.00	0.60	0.10	0.30	\$98.00	\$29.10	
343 061 51 00	0.10	2	SCOM	30.00	0.60	0.10	0.18	\$98.00	\$17.64	
343 061 52 00	0.07	2	COM	45.00	0.60	0.10	0.19	\$98.00	\$18.52	
343 061 53 00	0.08	2	SCOM	30.00	0.60	0.10	0.14	\$98.00	\$14.10	
343 061 54 00	0.08	2	SCOM	30.00	0.60	0.10	0.14	\$98.00	\$14.10	
343 061 55 00	0.07	2	SCOM	30.00	0.60	0.10	0.13	\$98.00	\$12.34	
343 061 56 00	0.08	2	SCOM	30.00	0.60	0.10	0.14	\$98.00	\$14.10	
343 061 57 00	8.05	2	OSP	0.00	0.30	0.10	0.00	\$98.00	\$0.00	
343 062 03 00	1.31	2	VAC	0.00	0.30	0.10	0.00	\$98.00	\$0.00	
343 062 04 00	3.09	2	SCOM	30.00	0.60	0.10	5.56	\$98.00	\$545.08	
343 062 05 00	3.09	2	COM	45.00	0.60	0.10	8.34	\$98.00	\$817.60	
343 062 07 00	4.38	2	COM	45.00	0.60	0.10	11.83	\$98.00	\$1,158.94	
343 062 09 00	16.86	2	COM	45.00	0.60	0.10	45.52	\$98.00	\$4,461.16	
343 062 19 00	4.33	2	COM	45.00	0.60	0.10	11.69	\$98.00	\$1,145.72	
343 062 20 00	3.08	2	COM	45.00	0.60	0.10	8.32	\$98.00	\$814.96	
343 062 21 00	2.44	2	COM	45.00	0.60	0.10	6.59	\$98.00	\$645.62	
343 062 22 00	1.15	2	COM	45.00	0.60	0.10	3.11	\$98.00	\$304.28	
343 062 23 00	2.72	2	COM	45.00	0.60	0.10	7.34	\$98.00	\$719.70	
343 062 41 00	3.42	2	SCOM	30.00	0.60	0.10	6.16	\$98.00	\$603.28	
343 062 44 00	1.27	2	SCOM	30.00	0.60	0.10	2.29	\$98.00	\$224.02	
343 062 45 00	1.11	2	SCOM	30.00	0.60	0.10	2.00	\$98.00	\$195.80	
343 062 47 00	3.94	2	VAC	0.00	0.30	0.10	0.00	\$98.00	\$0.00	
343 062 48 00	5.83	2	VAC	0.00	0.30	0.10	0.00	\$98.00	\$0.00	
343 062 49 00	1.47	2	SCOM	30.00	0.60	0.10	2.65	\$98.00	\$259.30	
343 062 50 00	1.50	2	COM	45.00	0.60	0.10	4.05	\$98.00	\$396.90	
343 062 53 00	4.65	2	SCOM	30.00	0.60	0.10	8.37	\$98.00	\$820.26	
343 062 54 00	3.52	2	SCOM	30.00	0.60	0.10	6.34	\$98.00	\$620.92	
343 062 55 00	5.51	2	SCOM	30.00	0.60	0.10	9.92	\$98.00	\$971.96	
343 062 56 00	1.21	2	SCOM	30.00	0.60	0.10	2.18	\$98.00	\$213.44	
343 100 26 00	2.12	2	COM	45.00	0.60	0.10	5.72	\$98.00	\$560.94	
343 100 27 00	2.60	2	COM	45.00	0.60	0.10	7.02	\$98.00	\$687.96	
343 100 33 00	4.25	2	COM	45.00	0.60	0.10	11.48	\$98.00	\$1,124.54	
343 100 34 00	2.84	2	SCOM	30.00	0.60	0.10	5.11	\$98.00	\$500.98	
343 100 35 00	1.29	2	COM	45.00	0.60	0.10	3.48	\$98.00	\$341.32	
343 100 36 00	4.59	2	SCOM	30.00	0.60	0.10	8.26	\$98.00	\$809.68	
343 100 38 00	3.10	2	SCOM	30.00	0.60	0.10	5.58	\$98.00	\$546.84	
343 100 39 00	2.21	2	SCOM	30.00	0.60	0.10	3.98	\$98.00	\$389.84	

**EXHIBIT C - Assessment Roll (Fiscal Year 2027)**  
**Camino Santa Fe Maintenance Assessment District**

Parcel Number	Acres/ Units <sup>(1)</sup>	Zone Number	Land Use <sup>(2)</sup>	Apportionment Factors			Total EBU's	Unit Cost (\$/EBU)	FY 2027 <sup>(5)</sup> Assessment	Owner Name
				Land Use <sup>(2)</sup>	Benefit <sup>(3)</sup>	Location <sup>(4)</sup>				
343 111 01 00	1.02	2	COM	45.00	0.60	0.10	2.75	\$98.00	\$269.88	
343 111 02 00	0.96	2	COM	45.00	0.60	0.10	2.59	\$98.00	\$254.02	
343 111 03 00	0.70	2	COM	45.00	0.60	0.10	1.89	\$98.00	\$185.22	
343 111 04 00	2.76	2	COM	45.00	0.60	0.10	7.45	\$98.00	\$730.30	
343 111 05 00	2.00	2	COM	45.00	0.60	0.10	5.40	\$98.00	\$529.20	
343 111 06 00	2.85	2	COM	45.00	0.60	0.10	7.70	\$98.00	\$754.10	
343 111 07 00	0.86	2	COM	45.00	0.60	0.10	2.32	\$98.00	\$227.56	
343 111 11 00	1.84	2	COM	45.00	0.60	0.10	4.97	\$98.00	\$486.86	
343 111 12 00	1.45	2	COM	45.00	0.60	0.10	3.92	\$98.00	\$383.66	
343 111 13 00	1.11	2	COM	45.00	0.60	0.10	3.00	\$98.00	\$293.70	
343 111 28 00	1.61	2	COM	45.00	0.60	0.10	4.35	\$98.00	\$426.00	
343 111 30 00	1.56	2	COM	45.00	0.60	0.10	4.21	\$98.00	\$412.78	
343 111 31 00	0.78	2	COM	45.00	0.60	0.10	2.11	\$98.00	\$206.38	
343 111 37 00	0.78	2	COM	45.00	0.60	0.10	2.11	\$98.00	\$206.38	
343 170 17 00	0.11	2	SCOM	30.00	0.60	0.10	0.20	\$98.00	\$19.40	
343 170 18 00	0.12	2	SCOM	30.00	0.60	0.10	0.22	\$98.00	\$21.16	
343 170 19 00	0.12	2	SCOM	30.00	0.60	0.10	0.22	\$98.00	\$21.16	
343 170 20 00	0.12	2	SCOM	30.00	0.60	0.10	0.22	\$98.00	\$21.16	
343 170 21 00	0.11	2	SCOM	30.00	0.60	0.10	0.20	\$98.00	\$19.40	
343 170 22 00	0.10	2	SCOM	30.00	0.60	0.10	0.18	\$98.00	\$17.64	
343 170 23 00	0.13	2	SCOM	30.00	0.60	0.10	0.23	\$98.00	\$22.92	
343 170 24 00	0.12	2	SCOM	30.00	0.60	0.10	0.22	\$98.00	\$21.16	
343 170 25 00	0.13	2	SCOM	30.00	0.60	0.10	0.23	\$98.00	\$22.92	
343 170 26 00	0.13	2	SCOM	30.00	0.60	0.10	0.23	\$98.00	\$22.92	
343 170 27 00	0.13	2	SCOM	30.00	0.60	0.10	0.23	\$98.00	\$22.92	
343 170 28 00	2.85	2	OSP	0.00	0.30	0.10	0.00	\$98.00	\$0.00	
343 180 01 00	0.12	2	COM	45.00	0.60	0.10	0.32	\$98.00	\$31.74	
343 180 02 00	0.11	2	COM	45.00	0.60	0.10	0.30	\$98.00	\$29.10	
343 180 03 00	0.11	2	SCOM	30.00	0.60	0.10	0.20	\$98.00	\$19.40	
343 180 04 00	0.13	2	COM	45.00	0.60	0.10	0.35	\$98.00	\$34.40	
343 180 05 00	0.11	2	COM	45.00	0.60	0.10	0.30	\$98.00	\$29.10	
343 180 06 00	0.12	2	COM	45.00	0.60	0.10	0.32	\$98.00	\$31.74	
343 180 07 00	0.13	2	COM	45.00	0.60	0.10	0.35	\$98.00	\$34.40	
343 180 08 00	0.12	2	COM	45.00	0.60	0.10	0.32	\$98.00	\$31.74	
343 180 09 00	0.12	2	COM	45.00	0.60	0.10	0.32	\$98.00	\$31.74	
343 180 10 00	0.12	2	COM	45.00	0.60	0.10	0.32	\$98.00	\$31.74	
343 180 11 00	0.10	2	SCOM	30.00	0.60	0.10	0.18	\$98.00	\$17.64	
343 180 12 00	0.11	2	COM	45.00	0.60	0.10	0.30	\$98.00	\$29.10	
343 180 13 00	0.12	2	COM	45.00	0.60	0.10	0.32	\$98.00	\$31.74	
343 180 14 00	0.12	2	COM	45.00	0.60	0.10	0.32	\$98.00	\$31.74	
343 180 15 00	0.11	2	SCOM	30.00	0.60	0.10	0.20	\$98.00	\$19.40	
343 180 16 00	0.12	2	SCOM	30.00	0.60	0.10	0.22	\$98.00	\$21.16	
343 180 17 00	0.12	2	SCOM	30.00	0.60	0.10	0.22	\$98.00	\$21.16	
343 180 18 00	0.12	2	SCOM	30.00	0.60	0.10	0.22	\$98.00	\$21.16	
343 180 19 00	0.11	2	COM	45.00	0.60	0.10	0.30	\$98.00	\$29.10	
343 180 20 00	2.32	2	OSP	0.00	0.30	0.10	0.00	\$98.00	\$0.00	
343 180 21 00	1.67	2	OSP	0.00	0.30	0.10	0.00	\$98.00	\$0.00	
343 180 22 00	0.10	2	SCOM	30.00	0.60	0.10	0.18	\$98.00	\$17.64	
343 180 23 00	0.11	2	COM	45.00	0.60	0.10	0.30	\$98.00	\$29.10	
343 180 24 00	0.11	2	SCOM	30.00	0.60	0.10	0.20	\$98.00	\$19.40	
343 180 25 00	0.10	2	SCOM	30.00	0.60	0.10	0.18	\$98.00	\$17.64	
343 180 26 00	0.11	2	COM	45.00	0.60	0.10	0.30	\$98.00	\$29.10	
343 180 27 00	0.11	2	SCOM	30.00	0.60	0.10	0.20	\$98.00	\$19.40	
343 180 28 00	0.11	2	SCOM	30.00	0.60	0.10	0.20	\$98.00	\$19.40	
343 180 29 00	0.12	2	SCOM	30.00	0.60	0.10	0.22	\$98.00	\$21.16	
343 180 30 00	0.11	2	COM	45.00	0.60	0.10	0.30	\$98.00	\$29.10	
343 180 31 00	0.11	2	SCOM	30.00	0.60	0.10	0.20	\$98.00	\$19.40	
343 180 32 00	0.11	2	COM	45.00	0.60	0.10	0.30	\$98.00	\$29.10	
343 180 33 00	2.60	2	OSP	0.00	0.30	0.10	0.00	\$98.00	\$0.00	
343 190 01 00	0.12	2	SCOM	30.00	0.60	0.10	0.22	\$98.00	\$21.16	
343 190 02 00	0.10	2	COM	45.00	0.60	0.10	0.27	\$98.00	\$26.46	
343 190 03 00	0.11	2	COM	45.00	0.60	0.10	0.30	\$98.00	\$29.10	
343 190 04 00	0.11	2	COM	45.00	0.60	0.10	0.30	\$98.00	\$29.10	
343 190 05 00	0.11	2	COM	45.00	0.60	0.10	0.30	\$98.00	\$29.10	
343 190 06 00	0.12	2	SCOM	30.00	0.60	0.10	0.22	\$98.00	\$21.16	
343 190 07 00	0.12	2	SCOM	30.00	0.60	0.10	0.22	\$98.00	\$21.16	

**EXHIBIT C - Assessment Roll (Fiscal Year 2027)**  
**Camino Santa Fe Maintenance Assessment District**

Parcel Number	Acres/ Units <sup>(1)</sup>	Zone Number	Land Use <sup>(2)</sup>	Apportionment Factors			Total EBU	Unit Cost (\$/EBU)	FY 2027 <sup>(5)</sup> Assessment	Owner Name
				Land Use <sup>(2)</sup>	Benefit <sup>(3)</sup>	Location <sup>(4)</sup>				
343 190 08 00	0.11	2	COM	45.00	0.60	0.10	0.30	\$98.00	\$29.10	
343 190 09 00	0.12	2	SCOM	30.00	0.60	0.10	0.22	\$98.00	\$21.16	
343 190 10 00	0.12	2	SCOM	30.00	0.60	0.10	0.22	\$98.00	\$21.16	
343 190 11 00	0.11	2	SCOM	30.00	0.60	0.10	0.20	\$98.00	\$19.40	
343 190 12 00	0.11	2	SCOM	30.00	0.60	0.10	0.20	\$98.00	\$19.40	
343 190 13 00	0.12	2	COM	45.00	0.60	0.10	0.32	\$98.00	\$31.74	
343 190 14 00	0.11	2	SCOM	30.00	0.60	0.10	0.20	\$98.00	\$19.40	
343 190 15 00	0.10	2	SCOM	30.00	0.60	0.10	0.18	\$98.00	\$17.64	
343 190 16 00	3.88	2	OSP	0.00	0.30	0.10	0.00	\$98.00	\$0.00	
343 190 17 00	0.12	2	SCOM	30.00	0.60	0.10	0.22	\$98.00	\$21.16	
343 190 18 00	0.11	2	COM	45.00	0.60	0.10	0.30	\$98.00	\$29.10	
343 190 19 00	0.11	2	SCOM	30.00	0.60	0.10	0.20	\$98.00	\$19.40	
343 190 20 00	0.11	2	SCOM	30.00	0.60	0.10	0.20	\$98.00	\$19.40	
343 190 21 00	0.11	2	COM	45.00	0.60	0.10	0.30	\$98.00	\$29.10	
343 190 22 00	0.11	2	SCOM	30.00	0.60	0.10	0.20	\$98.00	\$19.40	
343 190 23 00	1.82	2	OSP	0.00	0.30	0.10	0.00	\$98.00	\$0.00	
343 200 01 00	0.13	2	SCOM	30.00	0.60	0.10	0.23	\$98.00	\$22.92	
343 200 02 00	0.11	2	SCOM	30.00	0.60	0.10	0.20	\$98.00	\$19.40	
343 200 03 00	0.12	2	SCOM	30.00	0.60	0.10	0.22	\$98.00	\$21.16	
343 200 04 00	0.10	2	SCOM	30.00	0.60	0.10	0.18	\$98.00	\$17.64	
343 200 05 00	0.13	2	SCOM	30.00	0.60	0.10	0.23	\$98.00	\$22.92	
343 200 06 00	0.11	2	SCOM	30.00	0.60	0.10	0.20	\$98.00	\$19.40	
343 200 07 00	0.11	2	SCOM	30.00	0.60	0.10	0.20	\$98.00	\$19.40	
343 200 08 00	0.11	2	SCOM	30.00	0.60	0.10	0.20	\$98.00	\$19.40	
343 200 09 00	0.12	2	SCOM	30.00	0.60	0.10	0.22	\$98.00	\$21.16	
343 200 10 00	0.12	2	SCOM	30.00	0.60	0.10	0.22	\$98.00	\$21.16	
343 200 11 00	0.12	2	SCOM	30.00	0.60	0.10	0.22	\$98.00	\$21.16	
343 200 12 00	0.11	2	SCOM	30.00	0.60	0.10	0.20	\$98.00	\$19.40	
343 200 13 00	4.52	2	VAC	0.00	0.30	0.10	0.00	\$98.00	\$0.00	
343 200 14 00	0.11	2	SCOM	30.00	0.60	0.10	0.20	\$98.00	\$19.40	
343 200 15 00	0.12	2	SCOM	30.00	0.60	0.10	0.22	\$98.00	\$21.16	
343 200 16 00	0.11	2	SCOM	30.00	0.60	0.10	0.20	\$98.00	\$19.40	
343 200 17 00	0.11	2	SCOM	30.00	0.60	0.10	0.20	\$98.00	\$19.40	
343 200 18 00	0.12	2	SCOM	30.00	0.60	0.10	0.22	\$98.00	\$21.16	
343 200 19 00	0.10	2	SCOM	30.00	0.60	0.10	0.18	\$98.00	\$17.64	
343 200 20 00	0.12	2	SCOM	30.00	0.60	0.10	0.22	\$98.00	\$21.16	
343 200 21 00	0.11	2	SCOM	30.00	0.60	0.10	0.20	\$98.00	\$19.40	
343 200 22 00	3.48	2	OSP	0.00	0.30	0.10	0.00	\$98.00	\$0.00	
343 220 01 00	0.12	2	SCOM	30.00	0.60	0.10	0.22	\$98.00	\$21.16	
343 220 02 00	0.11	2	SCOM	30.00	0.60	0.10	0.20	\$98.00	\$19.40	
343 220 03 00	0.11	2	SCOM	30.00	0.60	0.10	0.20	\$98.00	\$19.40	
343 220 04 00	0.10	2	SCOM	30.00	0.60	0.10	0.18	\$98.00	\$17.64	
343 220 05 00	0.11	2	SCOM	30.00	0.60	0.10	0.20	\$98.00	\$19.40	
343 220 06 00	0.10	2	SCOM	30.00	0.60	0.10	0.18	\$98.00	\$17.64	
343 220 07 00	0.11	2	SCOM	30.00	0.60	0.10	0.20	\$98.00	\$19.40	
343 220 08 00	0.11	2	SCOM	30.00	0.60	0.10	0.20	\$98.00	\$19.40	
343 220 09 00	0.11	2	SCOM	30.00	0.60	0.10	0.20	\$98.00	\$19.40	
343 220 10 00	2.44	2	OSP	0.00	0.30	0.10	0.00	\$98.00	\$0.00	
343 220 11 00	0.48	2	VAC	0.00	0.30	0.10	0.00	\$98.00	\$0.00	
343 220 12 00	3.10	2	COM	45.00	0.60	0.10	8.37	\$98.00	\$820.26	
343 220 13 00	3.50	2	COM	45.00	0.60	0.10	9.45	\$98.00	\$926.10	
343 220 14 00	2.74	2	COM	45.00	0.60	0.10	7.40	\$98.00	\$725.00	
343 220 15 00	0.94	2	COM	45.00	0.60	0.10	2.54	\$98.00	\$248.72	
343 220 16 00	0.94	2	COM	45.00	0.60	0.10	2.54	\$98.00	\$248.72	
343 220 17 00	0.94	2	SCOM	30.00	0.60	0.10	1.69	\$98.00	\$165.82	
343 270 01 00	1.01	2	OSP	0.00	0.30	0.10	0.00	\$98.00	\$0.00	
343 270 02 00	0.26	2	SCOM	30.00	0.60	0.10	0.47	\$98.00	\$45.86	
343 270 03 00	0.26	2	SCOM	30.00	0.60	0.10	0.47	\$98.00	\$45.86	
343 270 04 00	0.26	2	SCOM	30.00	0.60	0.10	0.47	\$98.00	\$45.86	
343 270 05 00	0.26	2	SCOM	30.00	0.60	0.10	0.47	\$98.00	\$45.86	
343 270 06 00	0.69	2	OSP	0.00	0.30	0.10	0.00	\$98.00	\$0.00	
343 270 07 00	0.11	2	SCOM	30.00	0.60	0.10	0.20	\$98.00	\$19.40	
343 270 08 00	0.11	2	SCOM	30.00	0.60	0.10	0.20	\$98.00	\$19.40	
343 270 09 00	0.11	2	SCOM	30.00	0.60	0.10	0.20	\$98.00	\$19.40	
343 270 10 00	0.10	2	SCOM	30.00	0.60	0.10	0.18	\$98.00	\$17.64	
343 270 11 00	0.10	2	SCOM	30.00	0.60	0.10	0.18	\$98.00	\$17.64	

**EXHIBIT C - Assessment Roll (Fiscal Year 2027)**  
**Camino Santa Fe Maintenance Assessment District**

Parcel Number	Acres/ Units <sup>(1)</sup>	Zone Number	Land Use <sup>(2)</sup>	Apportionment Factors			Total EBUs	Unit Cost (\$/Ebu)	FY 2027 <sup>(5)</sup> Assessment	Owner Name
				Land Use <sup>(2)</sup>	Benefit <sup>(3)</sup>	Location <sup>(4)</sup>				
343 270 12 00	0.10	2	SCOM	30.00	0.60	0.10	0.18	\$98.00	\$17.64	
343 270 13 00	1.06	2	SCOM	30.00	0.60	0.10	1.91	\$98.00	\$186.98	
343 270 14 00	1.53	2	SCOM	30.00	0.60	0.10	2.75	\$98.00	\$269.88	
343 270 15 00	1.55	2	VAC	0.00	0.30	0.10	0.00	\$98.00	\$0.00	
343 270 16 00	1.12	2	VAC	0.00	0.30	0.10	0.00	\$98.00	\$0.00	
343 270 17 00	1.55	2	SCOM	30.00	0.60	0.10	2.79	\$98.00	\$273.42	
343 270 18 00	0.70	2	SCOM	30.00	0.60	0.10	1.26	\$98.00	\$123.48	
343 270 19 00	0.57	2	SCOM	30.00	0.60	0.10	1.03	\$98.00	\$100.54	
343 330 21 00	3.74	2	SCOM	30.00	0.60	0.10	6.73	\$98.00	\$659.74	
343 330 22 00	2.26	2	SCOM	30.00	0.60	0.10	4.07	\$98.00	\$398.66	
343 330 23 00	0.69	2	SCOM	30.00	0.60	0.10	1.24	\$98.00	\$121.72	
343 330 24 00	0.77	2	VAC	0.00	0.30	0.10	0.00	\$98.00	\$0.00	
343 330 25 00	1.70	2	SCOM	30.00	0.60	0.10	3.06	\$98.00	\$299.88	
343 360 01 00	4.41	2	SCOM	30.00	0.60	0.10	7.94	\$98.00	\$777.92	
343 360 02 00	5.17	2	COM	45.00	0.60	0.10	13.96	\$98.00	\$1,367.98	
343 360 09 00	5.99	2	SCOM	30.00	0.60	0.10	10.78	\$98.00	\$1,056.64	
343 360 10 00	4.20	2	SCOM	30.00	0.60	0.10	7.56	\$98.00	\$740.88	
343 360 11 00	1.99	2	SCOM	30.00	0.60	0.10	3.58	\$98.00	\$351.04	
343 360 12 00	2.88	2	COM	45.00	0.60	0.10	7.78	\$98.00	\$762.04	
343 360 13 00	2.59	2	COM	45.00	0.60	0.10	6.99	\$98.00	\$685.30	
343 360 14 00	0.65	2	COM	45.00	0.60	0.10	1.76	\$98.00	\$171.98	
343 360 15 00	0.64	2	COM	45.00	0.60	0.10	1.73	\$98.00	\$169.34	
343 360 16 00	0.83	2	COM	45.00	0.60	0.10	2.24	\$98.00	\$219.62	
343 360 17 00	2.06	2	MIN	7.50	0.30	0.10	0.46	\$98.00	\$45.42	
343 360 18 00	2.23	2	SCOM	30.00	0.60	0.10	4.01	\$98.00	\$393.36	
343 360 19 00	4.92	2	COM	45.00	0.60	0.10	13.28	\$98.00	\$1,301.82	

<b>TOTAL</b>	-	-	-	-	-	-	<b>1,508.70</b>	-	<b>\$147,851.00</b>	
--------------	---	---	---	---	---	---	-----------------	---	---------------------	--

<sup>(1)</sup> Applicable units (acres or dwelling units) dependent upon Land Use Code  
<sup>(2)</sup> Refer to Assessment Engineer's Report for descriptions of Land Use Code and Land Use Factor  
<sup>(3)</sup> Refer to Assessment Engineer's Report for applicable Benefit Factor  
<sup>(4)</sup> Refer to Assessment Engineer's Report for applicable Location Factor  
<sup>(5)</sup> FY 2027 is the City's Fiscal Year 2027, which begins July 1, 2026 and ends June 30, 2027