



# Commission for Arts and Culture

CITY OF SAN DIEGO | COMMISSION FOR ARTS AND CULTURE  
AGENDA

Hyperlink to view meeting is forthcoming and will be available [here](#)

**Friday, May 28, 2021**

**11:30 a.m. – 1:30 p.m.**

---

11:30 a.m.	I.	Call to Order & Statement of Purpose+Vision	Janet Poutré, Chair
11:32 a.m.	II.	Non-agenda Public Comment	
11:42 a.m.	III.	Chair's Reports	Janet Poutré, Chair
		A. <b>ACTION</b> – April 23, 2021 Commission Meeting Minutes	
		B. <b>ACTION</b> – Adjust the Agenda and Recommend Hybrid Model for Future Meetings	
		C. Other Reports	
12:05 p.m.	IV.	Committee Reports	Ann Bossler, Committee Chair
		A. Policy & Funding Committee	
		B. Public Art Committee	Ben Meza, Committee Chair
		1. <b>ACTION</b> – Artwork Acquisition Proposal: Donation of Artwork by Rob Tobin from the Pacific Beach Town Council	
		2. <b>ACTION</b> – Incoming Loan of Artwork Proposal from Mingei International Museum: <i>Nikigator</i>	
		3. <b>ACTION</b> – Final Artwork Proposal for Fairmount Avenue Fire Station by Susan Logoreci	
		C. Advocacy & Outreach Committee	Tyler Hewes, Committee Chair
		D. Commissioner Engagement Ad Hoc Committee	Udoka Nwanna, Ad Hoc Committee Chair

Page 1 of 2

*VISION: Expanding our world by celebrating creativity in San Diego*

*PURPOSE: The City of San Diego Commission for Arts and Culture serves in an advisory capacity to the Mayor and City Council on promoting, encouraging and increasing support for the region's artistic and cultural assets, integrating arts and culture into community life and showcasing San Diego as an international tourist destination.*

Meeting will be live and recorded. PUBLIC COMMENT: Any member of the public may address the Commission on any subject in its area of responsibility on any matter not presently pending or previously discussed at the Commission. Pursuant to the provisions California Executive Order 29-20, Commission meetings will be held via teleconference until further notice. In lieu of in-person attendance, members of the public may submit their comments via a public comment [webform](#), or they may join the meeting as a "webinar attendee" at the link provided in the [Commission or Committee meeting website](#). For members of the public wishing to address the Commission under Public Comment via the [webform](#) prior to the meeting, instructions for word limitations and deadlines will be noted on the [webform](#). Pursuant to open meeting laws, no discussion or action, other than a referral, shall be taken by the Committee on any issue brought forth under non-agenda public comment. As required by the Americans with Disabilities Act (ADA), requests for agenda information to be made available in alternative formats, and any requests for disability-related modifications or accommodations required to facilitate meeting participation, including requests for alternatives to observing meetings and offering public comment as noted above, may be made by contacting the City Clerk at (619) 533-4000 or <mailto:cityclerk@sandiego.gov>. The City is committed to resolving accessibility requests swiftly in order to maximize accessibility.

12:35 p.m.	V.	Presentations A. Kent Lee, Executive Director, Pacific Arts Movement, and Co-Chair, San Diego API Coalition B. Proposed County Arts Agency Update	Janet Poutré, Chair
1:05 p.m.	VI.	Director's Reports	Jonathon Glus, Executive Director
1:15 p.m.	VII.	New Business for Future Agendas	Janet Poutré, Chair
1:20 p.m.	VIII.	Commissioner Speed-Round – What arts, culture and creative experiences have you had this month (who, what, when, where)? Adjourn	Janet Poutré, Chair
1:30 p.m.	IX.	Adjourn	Janet Poutré, Chair



# Commission for Arts and Culture

City of San Diego Commission for Arts and Culture | Microsoft Teams Online Meeting

## MINUTES

Friday, April 23, 2021

Hyperlink to view full meeting available [here](#)

closed caption available at bottom right of screen

### Commissioners Present

Janet Poutré, Chair  
Vernon Franck, Vice Chair  
Ann Bossler  
Rebecca Smith  
Tyler Hewes  
Tracy Dezenzo  
Keith Opstad  
Michael Brown  
Ben Meza  
Jason Whooper

### Commissioners Absent

Udoka Nwanna  
Doreen Schonbrun  
Gina M. Jackson  
Dajahn Blevins

### Staff Present

Jonathon Glus  
Christine E. Jones  
Charles Miller  
Bell Reza  
Karla Centeno  
Lara Bullock  
Diana Agostini

- 
- I. **Call to Order & Statement of Purpose Vision | [View Here](#)** –Chair Janet Poutré called the City of San Diego Commission for Arts and Culture online meeting to order at 8:32a.m. Chair Poutré introduced herself, took roll call to confirm Commissioner attendance and read the Commission’s statement of purpose and vision. Chair Poutré called on Project Manager Bell Reza to review the guidelines for the meeting.
- II. **Non-agenda Public Comment | [View Here](#)**
- III. **Chair’s Reports | [View Here](#)**
- A. **ACTION** – March 26, 2021 Commission Meeting Minutes  
**Commissioner Michael Brown made a motion to approve, Commissioner Ann Bossler seconded the motion. The vote was unanimous; the motion passed.**
- B. **ACTION** – Fiscal Year 2022 Arts and Culture Programmatic Budget Distribution  
**Commissioner Ann Bossler made a motion to approve, Commissioner Tyler Hewes seconded the motion. The vote was unanimous; the motion passed.**

- IV. **Presentations:** | [View Here](#)
- A. Poetry Out Loud Winner Kate Linggi
  - B. Jean Issacs, Former Artistic Director, San Diego Dance Theater
  - C. Reopening Update: D. Candis Paule, Member, Statewide Task Force for Reopening in the Arts Safely
- V. **Committee Reports** | [View Here](#)
- A. **Policy and Funding Committee**, Chair Ann Bossler | [View Here](#)
    - 1. Diversity, Equity, Inclusion (DEI) Update
    - 2. **ACTION** – Fiscal Year 2022 Organizational Support Program/Creative Communities San Diego Request for Proposal Ranks  
Commissioner Ann Bossler made a motion to approve, Commissioner Rebecca Smith seconded the motion. Commissioner Michael Brown recused himself, Commissioner Tyler Hewes voted yay with the understanding that he was recusing himself from the vote for Jacobs Center for Neighborhood Innovation, Commissioner Keith Opstad voted yay with the understanding that he was recusing himself from the vote for The New Children’s Museum; the motion passed.
  - B. **Public Art Committee**, Chair Ben Meza | [View Here](#)  
**ACTION** – Intersection Mural Proposal from Downtown San Diego Partnership: *We Are Cortez* by Phoebe Cornog and Roxy Prima  
Commissioner Tyler Hewes made a motion to approve, Commissioner Ann Bossler seconded the motion. Commissioner Vernon Franck Abstained; the motion passed.
  - C. **Advocacy and Outreach Committee** | [View Here](#)  
Committee Chair Tyler Hewes
  - D. **Commissioner Engagement Ad Hoc Committee**  
Committee Chair Udoka Nwanna was not present
- VI. **Director’s Report** | [View Here](#)  
Executive Director Jonathon Glus
- VII. **Adjourn** – Commissioner Janet Poutr  adjourned the meeting at 10:04 a.m.



# Commission for Arts and Culture

## COMMITTEE REPORT

DATE ISSUED: May 24, 2021

ATTENTION: Commission for Arts and Culture

SUBJECT: Artwork Acquisition Proposal: Donation of Artwork by Rob Tobin from the Pacific Beach Town Council

REFERENCES: 1) Application from the Pacific Beach Town Council for Donation of Artwork by Rob Tobin  
2) [San Diego Municipal Code Section 26.0722 – Control of Artworks](#)  
3) [Administrative Regulation 95.00 – Management of the Civic Art Collection](#)  
4) [Commission for Arts and Culture Department Instruction 1.00 – Collection Management Policy for the Civic Art Collection](#)

STAFF CONTACT: Charles G. Miller, Senior Public Art Manager

---

### PUBLIC ART COMMITTEE RECOMMENDATION:

Recommend that the Executive Director of the Commission for Arts and Culture (Commission) accept the proposed donation of an artwork for inclusion into the Civic Art Collection and for installation on the north and south facades of the Pacific Beach Recreation Center building at 1405 Diamond Street in Pacific Beach upon the fulfillment of eight conditions:

1. All other City Departments that are stakeholders (i.e. Parks and Recreation, Development Services Department, etc.) indicate support/approvals for the installation and exhibition of the artwork on the north and south facades of the Pacific Beach Recreation Center building at 1405 Diamond Street in Pacific Beach.
2. The donor and artist, Pacific Beach Town Council and Rob Tobin, respectively, agree to donate the artwork as an unrestricted gift to the City.
3. The Pacific Beach Town Council and Rob Tobin agree to modify transportation and installation plans, if requested by the City, to address any safety, liability, environmental and accessibility issues.
4. Rob Tobin supplies the City with a maintenance instruction manual in a format to be determined by Commission staff.
5. The Pacific Beach Town Council agrees to conduct and fund ordinary

artwork maintenance, if required by the City, for the period during which the artwork is exhibited on the Pacific Beach Recreation Center at 1405 Diamond Street in Pacific Beach.

6. The Pacific Beach Town Council agrees to fund extraordinary artwork maintenance, if required by the City, for the period during which the artwork is an object in the Civic Art Collection.
7. The artist/copyright holder agrees to grant the City a nonexclusive irrevocable and royalty-free license to reproduce the artwork for all standard City educational, public relations, tourism and arts promotional purposes.
8. The artist agrees to the City's standard Visual Artists Rights Act (VARA) and California Art Preservation Act (CAPA) waivers.

#### SUMMARY:

In March 2021, City staff received a donation application from the Pacific Beach Town Council (Donor). The Donor is proposing a gift to the City of San Diego (City) that includes two mosaic murals by Rob Tobin to be sited on the north and south facades of the Pacific Beach Recreation Center building at 1405 Diamond Street in Pacific Beach. Commission staff evaluated the application utilizing the artwork accession criteria and site selection criteria contained in the *City of San Diego Commission for Arts and Culture Department Instruction - Collection Management Policy for the Civic Art Collection*. The results of staff's analysis include:

#### RE: ARTWORK CRITERIA

Public Safety: If the mosaic murals are installed properly on the recreation center facades (i.e. methods and materials safe for the public), it is unlikely to pose hazards or threats to public safety or public health and/or is unlikely to pose a potential liability for the City in any other way. The mosaic elements will be fabricated off-site and mechanically fastened to façade in manner allowing for de-installation if necessary. The Donor and artist may be required to submit construction plans/drawings to Development Services Department for review and approval.

Cost: If the donation is accepted, the Donor will be responsible for the costs of initial transportation and installation of the artwork. The Donor has indicated that they are willing to assist the City with ordinary and extraordinary maintenance of the artwork.

Availability of Resources: Commission staff is available to provide administrative services to the Donor in order to execute a deed of gift and/or agreement. However, resources for funding future artwork transportation, installation, conservation are limited.

Relevance: *To the Collecting Mission:* The mosaic murals demonstrate an acceptable level of creativity of the artist, thus providing an aesthetic and cultural experience for San Diego's residents and visitors. The artist lives and

works in San Diego County (see bio for more information). Due to the placement of the mosaic murals and their relatively large size, the artwork may serve to balance urbanization and development with humanizing elements. *To the Scope of the Collection:* The artwork falls within the scope of the collection in object type as well as chronological and geographical origin. The artist is not currently represented in the Civic Art Collection.

Excellence: The artwork exemplifies a satisfactory level of aesthetic quality and workmanship. The artist's process typically enlists a significant degree of community involvement and collaboration in conceptual content development.

Significance: The application does not indicate that the artwork is of special significance in the artist's body of work. The artist's work is held in several public collections across San Diego County.

Condition: The Donor reported that the artwork will be newly constructed and is therefore in excellent condition.

Maintenance: Upon acceptance, the City will be responsible for determining methods of and overseeing ordinary maintenance and conducting extraordinary maintenance and conservation. The Donor has indicated that they are willing to assist the City with maintenance of the artwork.

Security: The Donor has indicated that they will form an artwork inspection and maintenance subcommittee and protocol to regularly monitor the artwork for graffiti, vandalism, and maintenance requirements.

Relationship to Site: The artwork is proposed to be sited on the north and south facades of the Pacific Beach Recreation Center building at 1405 Diamond Street in Pacific Beach. The artwork will serve to beautify the recreation center and the surrounding community. The Donor indicated that they believe the artwork's placement will beautify the recreation center in complement to the new YMCA and middle school in the vicinity. The Donor and artist have indicated an intention to involve the community in the production of the mosaic murals by, among other means, incorporating donated surfboards as components of the mosaic murals that are iconic of the Pacific Beach community.

Legal and Ethical Considerations: If the donation of artwork is approved, it will be formalized in a deed of gift and/or agreement between the Donor and the City. The Donor has indicated that the artist will provide a royalty-free license to reproduce images of the artwork for noncommercial purposes. The artist will be required to agree to the terms of the City's standard Visual Artists Rights Act (VARA) and California Art Preservation Act (CAPA) waivers.

Timing: The timeframe is dependent upon the contracting/permitting process and availability of the artist and/or vendor to transport and install the artwork.

Selection Process for the Artist: The artist was selected by the Donor through the criteria of identifying a local artist with experience producing mosaic murals.

Community Feedback: The Donor has provided letters of support from the Beach and Bay YMCA, Beautiful PB, Discover Pacific Beach Business Improvement District, Mission Bay Cluster Schools Committee, Pacific Beach Planning Committee, and Councilmember Jennifer Campbell.

Restrictions: While not a restriction of the donation, the Donor's preference is for the artwork is to be sited on the north and south facades of the Pacific Beach Recreation Center building at 1405 Diamond Street in Pacific Beach. If it is deemed necessary for the artwork to be installed elsewhere, the Donor has designed it so that it may be easily de-installed and re-installed elsewhere.

Commemorative Significance: Not applicable.

Fair Exchange: Not applicable.

Fair Purchase Price: Not applicable.

#### RE: SITE SELECTION CRITERIA

Ownership: The City owns the Pacific Beach Recreation Center, which is recommended for siting the mosaic murals.

Public Safety: If the mosaic murals are installed properly on the recreation center facades (i.e. methods and materials safe for the public), it is unlikely to pose hazards or threats to public safety or public health and/or is unlikely to pose a potential liability for the City in any other way. The mosaic elements will be fabricated off-site and mechanically fastened to façade in manner allowing for de-installation if necessary. The Donor and artist may be required to submit construction plans/drawings to Development Services Department for review and approval.

Security: The City is patrolled by the San Diego Police Department. However, theft and vandalism in the form of tagging still occurs from time to time.

Maintenance: Recreation centers are managed by the Parks & Recreation Department of the City of San Diego.

Accessibility: The City complies with the Americans with Disabilities Act of 1990 and Council Policy 100-04 Americans with Disabilities Act/City Contractors. Prior to installation, City staff will review the placement of the artwork for ADA compliance.

Context: The artwork is proposed to be sited on the north and south facades of the Pacific Beach Recreation Center building at 1405 Diamond Street in



Pacific Beach. The installation will serve to further beautify the recreation center and the surrounding community.

Support of City Departments: Commission staff will route the donation application with the analysis and recommendation from the Commission for Arts and Culture to relevant City departments for feedback and recommendations about the proposal.

Community Support: The Donor has provided letters of support from the Beach and Bay YMCA, Beautiful PB, Discover Pacific Beach Business Improvement District, Mission Bay Cluster Schools Committee, Pacific Beach Planning Committee, and Councilmember Jennifer Campbell.

Adherence to Relevant Plans: The City adheres to existing community plans and land use plans, such as the City's General Plan.

On May 7, 2021, the Public Art Committee evaluated the application utilizing the artwork and site selection criteria contained in the *City of San Diego Commission for Arts and Culture Department Instruction - Collection Management Policy for the Civic Art Collection* and voted (6-0-0) to recommend to the City of San Diego Commission for Arts and Culture that the Executive Director of the Commission accept the proposed donation of an artwork for inclusion into the Civic Art Collection and for installation on the north and south facades of the Pacific Beach Recreation Center building at 1405 Diamond Street in Pacific Beach upon the fulfillment of eight conditions.

The Executive Director of the Commission will consider the recommendation from staff, other relevant City staff, the Public Art Committee, the Commission, and any other pertinent stakeholders before making the final decision on whether to accept the proposed donation.

FISCAL CONSIDERATIONS:

If the City accepts the proposed donation, the artwork will be accessioned into the Civic Art Collection after its installed and inspected at the site. The Donor is responsible for all costs, including design, fabrication, transportation, and installation and, if required by the City, ongoing ordinary and extraordinary maintenance costs.



THE CITY OF SAN DIEGO

## APPLICATION FOR DONATIONS OF ARTWORK TO THE CITY OF SAN DIEGO

Thank you for your interest in donating artwork to the City of San Diego. Please complete and submit this application to the City of San Diego Commission for Arts and Culture, ATTN: Civic Art Collection, 1200 Third Avenue, Suite 924, San Diego, CA 92101. Contact City staff at (619) 236-6800 for assistance. Additional sheets may be attached as needed. The City reserves the right to request additional information in order to process a donation proposal.

### DONOR

Name(s)

Pacific Beach Town Council (PBTC)

Address

[REDACTED]

City  
San Diego

State  
CA

Zip Code

[REDACTED]

Country  
USA

Phone

[REDACTED]

Fax

Email

[REDACTED]

**Credit Line - Provide the donor's name as it should appear in labels, publications and publicity.**

Pacific Beach Town Council

**If this application is for a partial interest donation, explain the proposed terms.** (Unless otherwise indicated by the donor, the City will assume that donation proposals are absolute.)

n/a

**If this application is for a restricted donation, explain the proposed terms.** (Unless otherwise indicated by the donor, the City will assume that donation proposals are unrestricted.)

n/a

**Conflict of Interest - Disclose whether the donor has any active contracts with the City or is involved in any stage of negotiations for a City contract.**

None

### ARTIST

Name

Rob Tobin

Alias (If applicable)

Nationality

Birth Date

[REDACTED]

Death Date (If applicable)

n/a

Address

[REDACTED]

City  
San Diego

State

Zip Code

[REDACTED]

Country  
USA

Phone

[REDACTED]

Fax

Email

[REDACTED]

Website

artistrobtobin.com

**Artist Representation/Gallery Name** (If applicable)

n/a

**Artist Representation/Gallery Address**

City

State

Zip Code

Country

Phone

Fax

Email

**For donations of commissioned artwork, please explain the method for the selection of the artist.**

PBTC identified the need to beautify the Pacific Beach Recreation Center while also integrating public art into the community. The concept of exterior mural/mosaics required identifying an artist with experience in similar projects. The selected artist, Rob Tobin, is a local artist specializing in community participatory art. He works in a variety of mediums including mosaics, ceramics, sculpture, furniture, and upcycled art. As Director of Creativity for the nonprofit A Reason To Survive (ARTS) for ten years, Rob worked with schools and communities facilitating largescale mosaic murals and as a mentor to many young artists. Rob is also deeply involved in creating ambiance at music festivals. He guides groups of volunteers, turning lackluster tents and venues into exciting magical spaces to suit the great music created within. Rob calls his new passion Interactivational Art, activating underutilized spaces through the installation of a framework that calls upon the public to jump in and add their own special creative touch. Rob rejoices using reclaimed and repurposed materials in all his creations, giving a second life to objects heading for the landfill.

**Artwork title:** Pacific Beach CommuniTree

**Artwork type:** Paint and Tile Mosaic Mural(s)

**Medium:** Paint, Ceramic, Decorative Stone, Surfboards

**Description:**

The proposed Pacific Beach CommuniTree mural project is located at the PB Rec Center at the northeast corner of Diamond and Gresham Streets in Pacific Beach. Artists on team will work with the community to create two, one-of-a-kind, large-scale mosaic art installations on top of a fresh, bright paint job that will transform the rec center building and make a positive impact on the neighborhood. The mural(s) will be paint and mixed media mosaics depicting natural beauty. Surfboards donated by the community will be mosaicked and used to create giant colorful flowers and foliage on the north wall. The south wall will also be a mixed media paint and mosaicked surfboard mural but depicting a colorful sunset mandala.

**For donations of commissioned artwork, please outline the installation plan.**

**Surface Preparation Plan:** Preparation will involve power washing, primer and new paint. The current plan is to paint not only the mural wall locations but the entire Recreation Center given the City is now scheduled to repaint the center in the near-term. Paint colors for non-mural walls are to include City Blue, Forest Green, and/or Oxford Brown (City Tan). Similar colors will likely be incorporated into the mural walls.

**List of materials / equipment:** Paint, glass tile, ceramic tile, natural stone, flagstone, decorative stone, surfboards, thin set mortar, grout, buckets, brushes, tarps, drop cloths, ladders, trowels, scaffolding, sponges, masks, goggles, hammers, glass cutters, nippers, gloves, bucket lift, cement or hardiebacker board, screws, drill, bolts, and water.

**Installation Process:** The walls will be colorfully painted. Surfboards and hardiebacker board artwork will be mosaicked and securely bolted to the walls. Other use of glass ceramics and decorative stone on

hardiebacker board will be similarly secured to the walls and incorporated into the design. The mechanical installation will be designed for long-term public benefit while allowing for any repairs/maintenance if necessary (e.g. surf board removal and replacement, etc.).

Repairs/Maintenance: The PBTC will form a mural inspection and maintenance subcommittee and protocol. The President of the PBTC will assign on to two individuals to coordinate. The PBTC will address any graffiti clean-up and abatement as needed. The PBTC will conduct ongoing inspections to address and fund any necessary repairs and/or maintenance. The PBTC has extensive experience in graffiti clean-up and conducts annual graffiti removal campaigns in Pacific Beach. In the event of graffiti, the background wall can be painted over with color-matching paint. Ceramics and decorative stone can be cleaned with standard graffiti removal protocol.

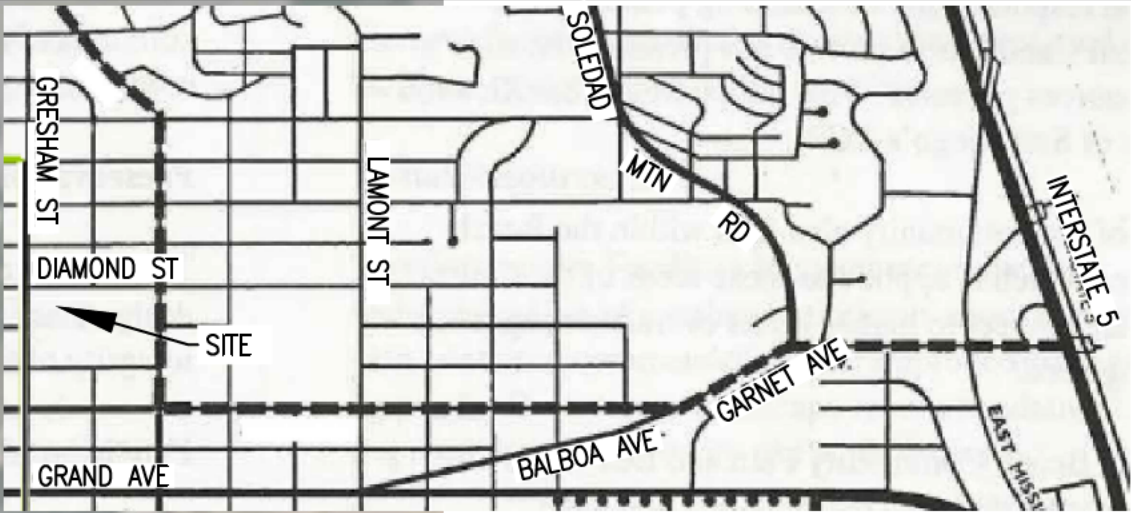

VICINITY MAP



SUNBURST MURAL

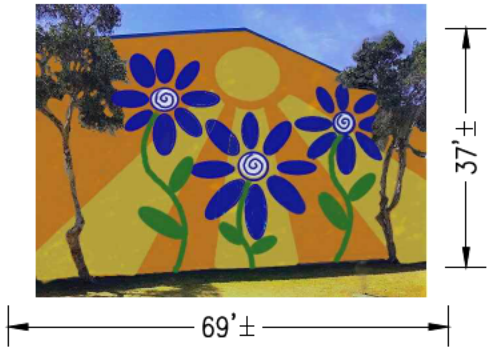

FLOWER MURAL



SYM	DESCRIPTION	DATE	APPR

ISSUE DATE:	
DRAWN BY:	
CHECKED BY:	
BWE JOB NUMBER:	
CLIENT JOB NUMBER:	

PROJECT

PACIFIC BEACH  
RECREATION  
CENTER MURALS

SHEET TITLE

SITE PLAN

SHEET OF

C-101

























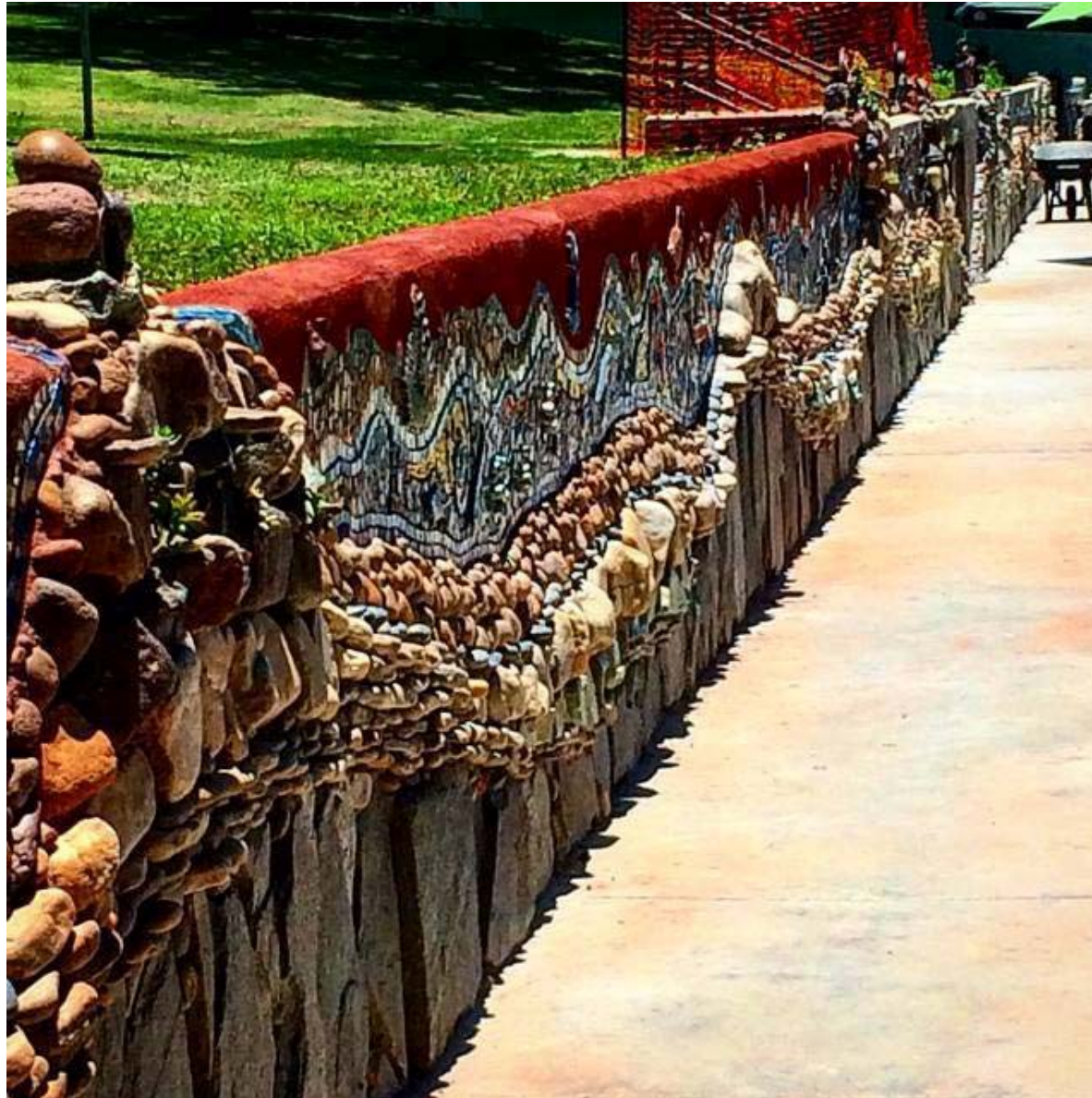











## ABOUT ROB

Rob Tobin is a California artist specializing in community participatory art. He works in a variety of mediums including mosaics, ceramics, sculpture, furniture, and upcycled art.

As Director of Creativity for the nonprofit A Reason To Survive (ARTS) for ten years, Rob worked with schools and communities facilitating large-scale mosaic murals and as a mentor to many young artists.

Rob is also deeply involved in creating ambiance at music festivals. He guides groups of volunteers, turning lackluster tents and venues into exciting magical spaces to suit the great music created within.

Rob calls his new passion Interactivational Art, activating underutilized spaces through the installation of a framework that calls upon the public to jump in and add their own special creative touch.

Rob rejoices using reclaimed and repurposed materials in all his creations, giving a second life to objects heading for the landfill.

## CONTACT



WEBSITE:  
ArtistRobTobin.com



# ROB TOBIN

## INTERACTIVATIONALIST. ARTIST. EDUCATOR

### WORK EXPERIENCE

#### Professional Artist

2006 - Present

Community Art/Murals/Mosaic Installations/Art Education/Fine Art/Festival and Stage Art/Furniture/Commissions

Design, drawing, painting, mosaics, murals, ceramics, sculpture, repurposed and upcycled art, furniture, community art, public art, interior and exterior design, sign painting and storefront makeovers, leading workshops, facilitating group projects, and partnering with teachers, schools and community groups.

#### A Reason To Survive (ARTS) Director of Creativity

2007-20017

Worked with thousands of children and young adults in varied projects including the following:

- o Design, coordination and facilitation of community art projects
- o Facilitation of ARTS Expression Sessions/Oversee "Van-Gol" transportation program, transporting kids to and from the ARTS Center and community art events
- o Supervision of youth employment opportunities
- o Curation of gallery exhibitions and events
- o Oversight of production in the frame shop
- o Responsible for facility improvements and upkeep

### COMMUNITY PROJECTS

- o Chaparral High School "ChapCares" mixed media mosaic, 2019
- o SD County Office of Edu "Celebrating Education" mixed media mosaic, 2019
- o Longfellow Spanish Emersion "Dia De Los Muertos" mixed media mosaic, 2019
- o Honda Commercial "Always Sunny" painted mural, 2018
- o Paradise Creek Educational Park "Egret Benches" mixed media mosaic, 2017
- o Roosevelt Middle "Our National Parks" mixed media mosaic, 2017
- o National City "Veterans Roundabout" mixed media mosaic, 2016
- o National City "Veterans Memorial Benches" mixed media mosaic, 2015



- National City "A Ave Educational Wall" mixed media mosaic, 2015
- National City "Senior Center Benches" mixed media mosaic, 2015
- Boarderfield State Park "Elderberry Communitree" mixed media mosaic, 2014
- Lafayette Elementary "Yusra's Memorial" mixed media mosaic, 2014
- Nativity Prep Academy "Legacy Project," 2014
- McKinley Elementary "Butterfly Communitree" mosaic mural, 2014
- Butterfly Park "Butterfly Steps" mosaic staircase, 2013
- San Diego Center for Children "Coastal Cottage" painted mural, 2012
- Howard Pence Elementary "College Bound" mixed media mural, 2012
- Fey Elementary "Keep it Clean" painted mural, 2012
- Junior League "Above and Below" painted mural, 2011
- Balboa Elementary "Piensa Azul" painted mural, 2011
- YMCA Balboa Community Center "Our Community" acrylic mural, 2011
- McKinley Elementary "Octopus' Garden" mixed media mosaic, 2009
- Ross Elementary "Kennedy's Dream" mixed media mosaic, 2009
- Alice Birney Elementary "Commune-A-Tree" mixed media mosaic, 2008
- Mission Bay High "Rose Creek" painted mural, 2008
- East Mesa Detention Center "Visitors Welcome" acrylic mural, 2008
- Ross Elementary "Water Cycle" & "Four Elements" mixed media, 2008
- San Diego Jewish Academy "Tree of Life" red wood & mixed media mosaic, 2007
- MCAS Miramar "Friendship Benches II" mixed media mosaic, 2007

## **REFERENCES AVAILABLE UPON REQUEST**

---



# Commission for Arts and Culture

## COMMITTEE REPORT

DATE ISSUED: May 24, 2021

ATTENTION: Commission for Arts and Culture

SUBJECT: Artwork Loan Proposal from Mingei International Museum:  
*Nikigator*

REFERENCES: 1) Application from Mingei International Museum for Incoming  
Loan of Artwork by Niki de Saint Phalle  
2) [San Diego Municipal Code Section 26.0722 – Control of Artworks](#)  
3) [Administrative Regulation 95.00 – Management of the Civic Art  
Collection](#)  
4) [Commission for Arts and Culture Department Instruction 1.00 –  
Collection Management Policy for the Civic Art Collection](#)

STAFF CONTACT: Lara Bullock, Civic Art Project Manager

---

### PUBLIC ART COMMITTEE RECOMMENDATION:

Recommend that the Executive Director of the City of San Diego Commission for Arts and Culture (Commission) approve the incoming loan of artwork by Niki de Saint Phalle for exhibition outside the Mingei International Museum in the Plaza de Panama, Balboa Park.

### SUMMARY:

The City has received an application for an incoming loan of artwork from the Mingei International Museum (Lender). City staff evaluated the application utilizing the artwork criteria contained in the *City of San Diego Commission for Arts and Culture Department Instruction – Collection Management Policy for the Civic Art Collection*. The results of the Commission staff's analysis include:

### RE: ARTWORK CRITERIA

Public Safety: If the sculpture is installed properly within the proposed location in Balboa Park's Plaza de Panama (i.e. approved methods and materials safe for the public), it is unlikely to pose hazards or threats to public safety or public health and/or is unlikely to pose a potential liability for the City in any other way.

Cost: The Lender will be solely responsible for funding the loan of artwork. This includes but is not limited to: costs for site preparation, handling, transportation, installation, signage, maintenance and conservation, deinstallation, and site restoration.

Availability of Resources: Commission staff is available to provide administrative

services to the Applicant in order to execute an incoming loan of artwork agreement. The Parks and Recreation Department staff is available to provide guidance and to coordination on site preparation.

Relevance: This incoming loan of artwork outside the Mingei International Museum in the Plaza de Panama would provide a meaningful aesthetic and cultural experience for San Diego's residents and visitors, particularly children and their parents and caregivers. The incoming loan of *Nikigator* pays homage to the relationship that artist Miki de Saint Phalle, who lived and worked in San Diego, had with the Mingei International Museum's founding director, with whom de Saint Phalle worked closely to realize this artwork as a gift for the children of San Diego. The sculpture would likely stimulate discussion and the exchange of ideas about art. Due to its relatively large size, the artwork would serve to balance urbanization and development with humanizing elements. While the sculpture will not specifically reflect the heritage, character and diversity of San Diego, it will be viewed by a cross-cultural section of the public. The sculpture demonstrates an acceptable level of creativity and innovation.

Excellence: The sculpture exemplifies an acceptable level of aesthetic quality, workmanship and conceptual content.

Significance: The large mosaic sculpture, *Nikigator*, is exemplary of the style that Niki de Saint Phalle was known for. De Saint Phalle spent her final eight years living and working in La Jolla. During this time, she became good friends with Martha Longenecker, the founding director of the Mingei International Museum. *Nikigator* was installed from 2001, to 2018 in front of the Museum, when it was removed from the site due to the Museum undergoing a major renovation. The installation will present a unique opportunity for viewers of all ages to engage with de Saint Phalle's sculpture in San Diego, up close in the public realm.

Condition: The Lender reported that the sculpture is in excellent condition.

Maintenance: The Lender will be responsible for maintenance and conservation of the sculpture and any accessories such as pad and plaque for the duration of the loan period.

Security: The Lender indicated that during the display the staff of the Mingei International Museum would monitor the sculpture.

Relationship to Site: The artwork is to be sited on the paved area near the Plaza de Panama and close to the Applicant's main entrance in Balboa Park.

Legal and Ethical Considerations: If the incoming loan of artwork is authorized, it will be formalized in a loan of artwork agreement between the Lender and the City.

Timing: The Lender is proposing a loan period of five-years. If the incoming loan of artwork is authorized, the specific dates for the loan may need to be adjusted and will be specified in the loan of artwork agreement between the Lender and the City.

Selection Process for the Artist: The Mingei International Museum owns the artwork. The Lender's Director of Exhibitions and Chief Curator selected the

proposed artwork for the loan.

Community Feedback: The Applicant has communicated with and garnered support from their peer institutions in Balboa Park for their application.

Restrictions: No restrictions were noted in the application.

Commemorative Significance: Not applicable.

Fair Exchange: Not applicable.

Fair Purchase Price: Not applicable.

#### RE: SITE SELECTION CRITERIA

Ownership: The City owns Balboa Park, which is recommended for siting the sculpture.

Public Safety: If the sculpture is installed properly within the proposed location outside of the Mingie International Museum in the Plaza de Panama in Balboa Park (i.e. methods and materials safe for the public), it is unlikely to pose hazards or threats to public safety or public health and/or is unlikely to pose a potential liability for the City in any other way.

Security: The Parks and Recreation Department and San Diego Police Department provide patrols of the park, as needed. In addition, many of the museums in the park, including the Lender have security guards. However, theft and vandalism still occur from time to time.

Maintenance: Balboa Park is managed and maintained by the Developed Regional Parks Division of the City of San Diego Parks and Recreation Department.

Accessibility: The City's parks are accessible to the general public during set hours of operation. All City parks comply with the Americans with Disabilities Act of 1990 and Council Policy 100-04 Americans with Disabilities Act/City Contractors. Prior to installation, City staff will review the placement of the artwork for ADA compliance.

Context: The artwork is to be sited on a poured-in-place rubber pad in the Plaza de Panama outside of the Lender's main entrance in Balboa Park. The loan of artwork will serve to further activate the area in front of the Lender's main entrance and surrounding Plaza de Panama in Balboa Park and create continuity from the plaza to the Lender's main entrance.

Support of City Departments: Commission staff will route the incoming loan of artwork proposal with the analysis and recommendation to the Parks and Recreation Department and other relevant City departments for feedback and recommendations about the proposal.

Community Support: City staff will determine with the Parks and Recreation Department and other relevant City departments, a process for gathering input and feedback from community, if necessary, on the recommended siting of the

proposed incoming loan of artwork in Balboa Park's Plaza de Panama.

Adherence to Relevant Plans: The City's parks adhere to existing community plans and land use plans, such as the City's General Plan.

Evaluation criteria the Commission will use to decide whether to recommend to that the City's Executive Director of the Commission authorize the incoming loan of artwork may include all or some of those given in the *City of San Diego Commission for Arts and Culture Department Instruction - Collection Management Policy for the Civic Art Collection*.

On May 7, 2021, the proposed incoming loan of artwork was presented to the Public Art Committee (PAC). At the meeting, PAC voted (6-0-0) to recommend to the Commission that the Executive Director of the Commission approve the incoming loan of artwork by Niki de Saint Phalle for exhibition outside the Mingei International Museum in the Plaza de Panama, Balboa Park.

The City's Executive Director of the Commission will consider the recommendation from staff, the Parks and Recreation Department and other relevant City departments, the PAC, the Commission, and any other pertinent stakeholders before making the final decision on whether to authorize the incoming loan of artwork.

FISCAL CONSIDERATIONS:

Should this incoming loan of artwork be authorized, the Lender will be responsible for all costs.

## **Nikigator Proposal:**

### **Proposed Location:**

Outside the entrance to the Mingei International Museum: Balboa Park, Plaza de Panama, 1439 El Prado, San Diego, CA 92101

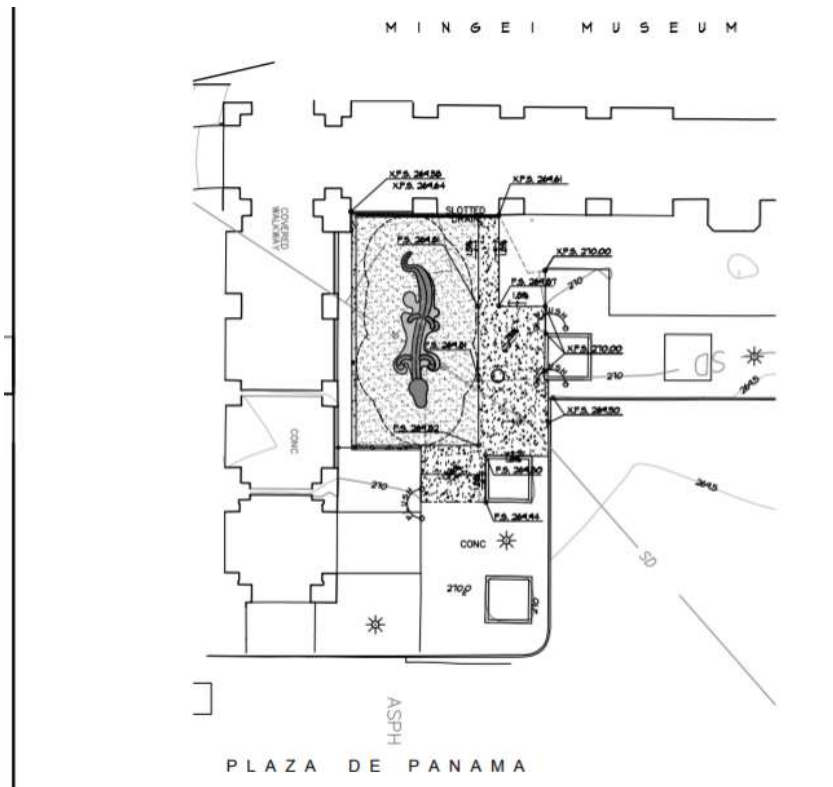

### **Proposed Artwork:**

*Nikigator* by Niki de Saint Phalle





# Commission for Arts and Culture

## COMMITTEE REPORT

DATE ISSUED: May 24, 2021

ATTENTION: Commission for Arts and Culture

SUBJECT: Final Artwork Proposal by Susan Logoreci: Fairmount Avenue Fire Station

REFERENCES: 1) [Commission for Arts and Culture Department Instruction 1.00 – Collection Management Policy for the Civic Art Collection](#)  
2) Final Artwork Proposal Package

STAFF CONTACT: Lara Bullock, Ph.D., Civic Art Project Manager

---

### PUBLIC ART COMMITTEE RECOMMENDATION:

Recommend that the Executive Director of the City of San Diego Commission for Arts and Culture (Commission) accept the final artwork proposal by Susan Logoreci in fulfillment of the City of San Diego's (City) collecting mission, collection scope and accession criteria as established in Section 5 – Collecting Mission, Section 6 – Scope of the Collection and Section 8.2 – Accession Criteria of the Commission for Arts and Culture Department Instruction 1.00 – *Collection Management Policy for the Civic Art Collection*.

### SUMMARY:

Artist Susan Logoreci was commissioned to design, fabricate and transport permanent, site-specific artwork for Fairmount Avenue Fire Station and consult during installation of artwork at the site by the City. The Fairmount Avenue Fire Station project involves the design and construction of a new fire station straddling the City Heights and Ridgeview neighborhoods in southeastern San Diego. RRM Design Group is the lead designer for the fire station to be located at the intersection of 47<sup>th</sup> and Fairmount Avenue. The artist has collaborated with RRM Design Group.

On November 6, 2021, Logoreci presented her preliminary artwork idea to the Public Art Committee (PAC) for feedback. PAC also provided feedback on the artist's schematic artwork proposal on February 5, 2021. On May 7, 2021, the artist's final artwork proposal was presented to PAC. At the meeting, PAC voted (6-0-0) to recommend to the Commission that the Executive Director of the Commission accept the final artwork proposal by the artist in the fulfillment of the City's collecting mission, collection scope, and accession criteria. In addition to PAC's feedback, the final artwork proposal is informed by suggestions from the public, the City's Fire-Rescue Department, and other various City departments.

### FISCAL CONSIDERATIONS:

This project is funded by the City as set forth in *City of San Diego Council Policy 900-11 – Inclusion of Public Art in Selected Capital Improvements program Projects*. After project completion, which is anticipated in spring 2024, the City will accession the artwork into the Civic Art Collection and be responsible for its stewardship.



## **Susan Logoreci Final Artwork Proposal**

### **Location:**

The fire station will be located on Fairmount Avenue and 47th Street, within the boundaries of City Heights and near the Webster and Ridgeview neighborhoods.



### **Concept:**

The artwork proposal for the Fairmount Avenue Fire Station consists of three, two-dimensional pieces made with porcelain enamel on a steel substrate. All three artworks will be created from original paintings. One will be installed on the façade on the 47<sup>th</sup> street side of the building. The second will be in the entryway, facing the parking lot, perpendicular to the front door. The third will be installed on the Fairmount Ave. side of the building. Artist will additionally transfer the original paintings used in the development of the exterior artworks for display within the fire station.

The concept behind all three pieces is simple. The ladder, symbolizing the fire service, and



the community symbolized by the homes and the natural beauty of the creek, are intertwined. They rely on each other for support. The artwork reflects that the community and the natural setting are what the people in these neighborhoods value most.

**Proposed Artwork:**

- 1) The 47<sup>th</sup> St piece will be a horizontal piece on the facade of the building to the right of fire station garage doors above the front door. It will be visible from the street and by people approaching the station. Like the piece on the Fairmount Avenue side it will be made up of a series of rectangles where the negative space forms the shape of a ladder. The artwork will depict the beautiful greenery of the Chollas Creek area with surrounding homes. The palette for this piece will be similar to the first; pinks, greens, yellows and grays.



- 2) The entryway piece will be located below the driveway in the entryway. This piece will measure 35" tall by 214" long (or 17' 10"). This piece will depict homes in the Ridgeview, City Heights, Azalea/ Hollywood Park and Broadway Heights neighborhoods from an aerial perspective. The receding streets form the shape of ladder. The palette for this piece will be similar to the others, pinks, greens, yellows and grays. Lighting will be installed. The suggested lighting is strip lighting with dimmers and the current recommendation is that it is installed around the inside of the metal frame that will frame the artwork.





- 3) The Fairmount Ave. piece will depict houses from the surrounding area (Ridgeview, City Heights, Azalea/ Hollywood Park and Broadway Heights neighborhoods specifically) from an aerial perspective. Each rectangle contains a house surrounded by a color depicting it's landscaping. The negative spaces around the rectangles are linked together to form the shape of a ladder. The colors of the landscaping transition from umber at the bottom to green at the top. The rooftops will be beige at the bottom and will metamorphose into warm pinks at the top. These color shifts create a harmonious rhythm with in the design.



### **Community Input:**

In early October 2020, a community event was held through Zoom. Passionate and informed people described the community as mostly single-family homes. I learned through several long time and newer residents the history of the area and the history of conservation as well as the importance of the natural setting.

Many residents described the most important aspects of the community as caring for neighbors and protecting and enjoying the natural setting. I also spoke with a community organizer of San Diego Canyonlands. She described her work as a conservationist and community organizer. She sent me several informative maps as well as images of existing public artworks.

In early November 2020, I met with the Public Art Committee to present my designs and receive feedback. There was support for the ladder design as well as the entryway and 47<sup>th</sup> Street designs. Feedback included consideration of the level of detail to include in Fairmount Avenue design to ensure readability from the street and additional aerial imagery to better reflect surrounding neighborhoods. I continued my research and altered the design based on the feedback.

In February 2021, I met again with the Public Art Committee and the community. Feedback from these events related to changing the palette on the Fairmount Ave. piece to reflect more sustainable greenery (i.e. less green lawns. Also, the entryway piece and 47<sup>th</sup> Street pieces were perhaps too similar and the 47<sup>th</sup> piece could utilize more color. With these comments and suggestions in mind, I reimagined the palette on the Fairmount Avenue side and moved the more colorful entryway piece to the 47<sup>th</sup> Street side of the building. I also re-designed the entryway piece to include density homes while maintaining the ladder motif by highlighting it in the form of receding streets.

### **ADA Plan:**

There are no known ADA requirements for these two-dimensional artworks.

### **Artwork Maintenance:**

Porcelain enamel is very durable material often used in outdoor environments for longevity. Because the majority of panels are well out of reach of human contact they should be structurally and visually stable with regular annual cleaning and inspection.