



Development and  
Environmental  
Planning Division  
(619) 236-6460

Binder

## Negative Declaration

DEP No. 94-0641

SUBJECT: Chevron at Washington: AMENDMENT to CONDITIONAL USE PERMIT and MID-CITY DEVELOPMENT PERMIT NO. 88-0072 (DEP NO. 94-0641) to increase the hours of operations of an existing gas station to 24 hours a day, and update the existing signage to reflect the new hours of operation. The project is located at 1832 West Washington Street (Lot 1, Block 178, Fayman Subdivision, Map 5787), Uptown Community Plan Area. Applicant: Robert Fiscus & Associates

I. PROJECT DESCRIPTION: See attached Initial Study.

II. ENVIRONMENTAL SETTING: See attached Initial Study.

III. DETERMINATION:

The City of San Diego has conducted an Initial Study and determined that the proposed project will not have a significant environmental effect and the preparation of an Environmental Impact Report will not be required.

IV. DOCUMENTATION:

The attached Initial Study documents the reasons to support the above Determination.

V. MITIGATION, MONITORING AND REPORTING PROGRAM: None required

VI. PUBLIC REVIEW DISTRIBUTION:

Draft copies or notice of this Negative Declaration were distributed to:

Robert Fiscus & Associates, Angela Smith, Applicant  
Uptown Planners  
Hillcrest Association  
City of San Diego:  
Council District 2 Office  
Engineering Department  
Development Services Department

VII. RESULTS OF PUBLIC REVIEW:

(X) No comments were received during the public input period.

( ) Comments were received but did not address the draft Negative Declaration finding or the accuracy/completeness of the Initial

Study. No response is necessary. The letters are attached.

- ( ) Comments addressing the findings of the draft Negative Declaration and/or accuracy or completeness of the Initial Study were received during the public input period. The letters and responses follow.

Copies of the draft Negative Declaration and any Initial Study material are available in the office of the Development and Environmental Planning Division for review, or for purchase at the cost of reproduction.

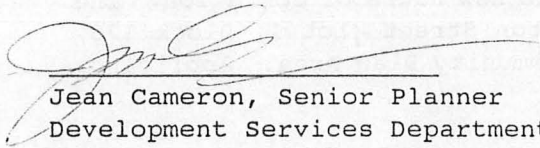
  
Jean Cameron, Senior Planner  
Development Services Department

January 9, 1995  
Date of Draft Report

February 2, 1995  
Date of Final Report

Analyst: Teasley

City of San Diego  
Development Services Department  
DEVELOPMENT AND ENVIRONMENTAL PLANNING DIVISION  
1222 First Avenue, Mail Station 501  
San Diego, CA 92101  
(619) 236-6460

INITIAL STUDY  
DEP No. 94-0641

SUBJECT: Chevron at Washington: AMENDMENT to CONDITIONAL USE PERMIT and MID-CITY DEVELOPMENT PERMIT NO. 88-0072 (DEP NO. 94-0641) to increase the hours of operation of an existing gas station to 24 hours a day, and update existing signage to reflect the new hours of operation. The site is located at 1832 West Washington Street (Lot 1, Block 178, Fayman Subdivision, Map 5787), Uptown Community Plan Area. Applicant: Robert Fiscus & Associates

I. PURPOSE AND MAIN FEATURES:

The proposed Amendment to the Conditional Use Permit and Mid-City Development Permit would allow an existing gas station to operate on a 24-hour basis. The site is fully developed and no additional changes are requested other than to update the existing signage to reflect the new hours of operations.

II. ENVIRONMENTAL SETTING:

The 20,642 square foot site is located on the northeast corner of the intersection of West Washington Street and San Diego Avenue. The site is zoned CN-4, Mid-City Planned District, and designated for commercial uses in the community Plan. The site is in the Mid-City Community Plan Area.

The site is surrounded by an office building to the north, a gas station to the south, a mix of commercial and residential development to the east, and Interstate 5 to the west.

III. ENVIRONMENTAL ANALYSIS: See attached Initial Study checklist.

IV. DISCUSSION:

Lighting and Glare:

The increase in the hours of operation to 24 hours a day has the potential to create a lighting impact on adjacent properties, especially the residential development immediately to the east of the site. To offset this potential impact, a condition shall be added to the permit to require that all artificial lighting shall be shaded or directed so as not to fall onto adjacent properties. The lighting shall also comply with the City of San Diego's Light Pollution ordinance (Section 101.1300).

V. RECOMMENDATION:

On the basis of this initial evaluation:

- ☒ The proposed project would not have a significant effect on the environment, and a NEGATIVE DECLARATION should be prepared.
- ☐ Although the proposed project could have a significant effect on the environment, there will not be a significant effect in this case because the mitigation measures described in Section IV above have been added to the project. A MITIGATED NEGATIVE DECLARATION should be prepared.
- ☐ The proposed project MAY have a significant effect on the environment, and an ENVIRONMENTAL IMPACT REPORT should be required.

PROJECT ANALYST: Teasley

Attachments: Location Map  
Initial Study



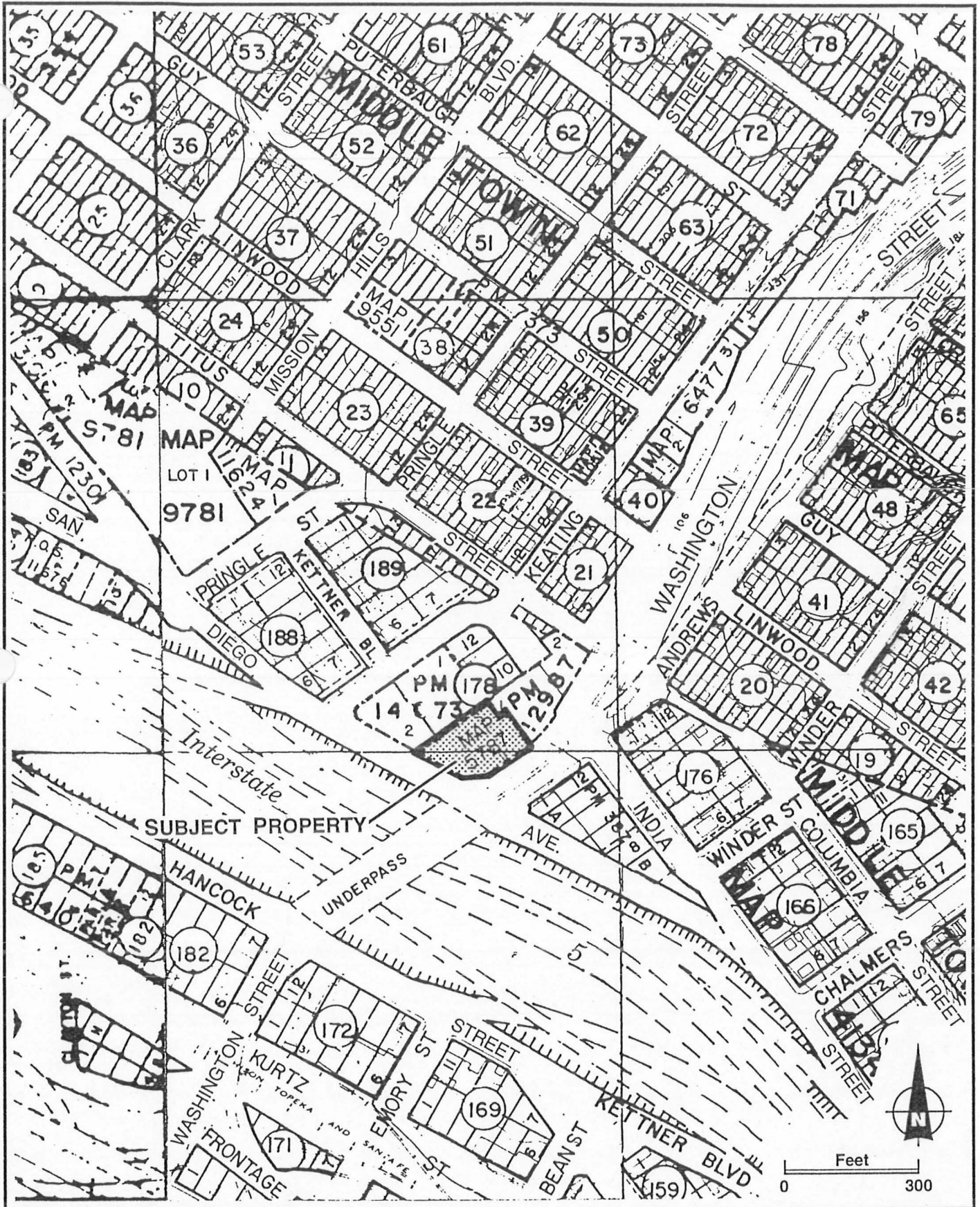

94-0641

(210-1713) 11-29-94 bf.



# LOCATION MAP

Environmental Analysis Section

CITY OF SAN DIEGO • DEVELOPMENT SERVICES DEPARTMENT

Figure

1

III. ENVIRONMENTAL ANALYSIS:

This Initial Study checklist is designed to identify the potential for significant environmental impacts which could be associated with a project. All answers of "yes" and "maybe" indicate that there is a potential for significant environmental impacts and these determinations are explained in Section IV.

	<u>Yes</u>	<u>Maybe</u>	<u>No</u>
A. <u>Geology/Soils</u> . Will the proposal result in:			
1. Exposure of people or property to geologic hazards such as earthquakes, landslides, mudslides, ground failure, or similar hazards? <u>No such geologic hazards on site</u>	___	___	<u>X</u>
2. Any increase in wind or water erosion of soils, either on or off the site? <u>No increase would occur</u>	___	___	<u>X</u>
B. <u>Air</u> . Will the proposal result in:			
1. Air emissions which would substantially deteriorate ambient air quality? <u>No substantial air emissions</u>	___	___	<u>X</u>
2. The exposure of sensitive receptors to substantial pollutant concentrations? <u>No such concentrations on or near site</u>	___	___	<u>X</u>
3. The creation of objectionable odors? <u>The project is an existing gas station</u>	___	___	<u>X</u>
4. The creation of dust? <u>No dust is associated with this project</u>	___	___	<u>X</u>
5. Any alteration of air movement in the area of the project? <u>Air movement would not be altered</u>	___	___	<u>X</u>
6. A substantial alteration in moisture, or temperature, or any change in climate, either locally or regionally? <u>No climate changes would result from this project</u>	___	___	<u>X</u>

- |    |                                                                                                                                                                                                     |     |     |          |
|----|-----------------------------------------------------------------------------------------------------------------------------------------------------------------------------------------------------|-----|-----|----------|
| 1. | Changes in currents, or the course or direction of water movements, in either marine or fresh waters?                                                                                               | ___ | ___ | <u>X</u> |
|    | <u>Project not adjacent to movement of water or near floodway area</u>                                                                                                                              |     |     |          |
| 2. | Changes in absorption rates, drainage patterns, or the rate and amount of surface runoff?                                                                                                           | ___ | ___ | <u>X</u> |
|    | <u>Drainage and runoff would remain unchanged</u>                                                                                                                                                   |     |     |          |
| 3. | Alterations to the course or flow of flood waters?                                                                                                                                                  | ___ | ___ | <u>X</u> |
|    | <u>Area not subject to flooding</u>                                                                                                                                                                 |     |     |          |
| 4. | Discharge into surface or ground waters, or in any alteration of surface or ground water quality, including, but not limited to temperature, dissolved oxygen or turbidity?                         | ___ | ___ | <u>X</u> |
|    | <u>No drainage into surface or ground water is proposed</u>                                                                                                                                         |     |     |          |
| 5. | Discharge into surface or ground waters, significant amounts of pesticides, herbicides, fertilizers, gas, oil, or other noxious chemicals?                                                          | ___ | ___ | <u>X</u> |
|    | <u>Such substances would not be discharged into surface or ground waters</u>                                                                                                                        |     |     |          |
| 6. | Change in deposition or erosion of beach sands, or changes in siltation, deposition or erosion which may modify the channel of a river or stream or the bed of the ocean or any bay, inlet or lake? | ___ | ___ | <u>X</u> |
|    | <u>No such changes would occur</u>                                                                                                                                                                  |     |     |          |
| 7. | Exposure of people or property to water related hazards such as flooding?                                                                                                                           | ___ | ___ | <u>X</u> |
|    | <u>Site not subject to flooding</u>                                                                                                                                                                 |     |     |          |
| 8. | Change in the amount of surface water in any water body?                                                                                                                                            | ___ | ___ | <u>X</u> |
|    | <u>Not applicable</u>                                                                                                                                                                               |     |     |          |

Yes    Maybe    No

D. Biology. Will the proposal result in:

1. A reduction in the number of any unique, rare, endangered, sensitive, or fully protected species of plants or animals?                          X    
No such species on site
2. A substantial change in the diversity of any species of animals or plants?                          X    
The site is an existing gas station
3. Introduction of invasive species of plants into the area?                          X    
No invasive plant species would be used
4. Interference with the movement of any resident or migratory fish or wildlife species?                          X    
No interference with wildlife species would result
5. An impact on a sensitive habitat, including, but not limited to streamside vegetation, oak woodland, vernal pools, coastal salt marsh, lagoon, wetland, or coastal sage scrub or chaparral?                          X    
No such habitat on site
6. Deterioration of existing fish or wildlife habitat?                          X    
No such habitat on site

E. Noise. Will the proposal result in:

1. A significant increase in the existing ambient noise levels?                          X    
No increase in the ambient noise levels would occur
2. Exposure of people to noise levels which exceed the City's adopted noise ordinance?                          X    
No exposure of people to excessive noise levels would occur



Yes    Maybe    No

3. Exposure of people to current or future transportation noise levels which exceed standards established in the Transportation Element of the General Plan?                          X    
No exposure to excessive traffic noise would occur

F. Light, Glare and Shading. Will the proposal result in:

1. Substantial light or glare?                X              
Potential glare from lights on adjacent residential development if open all night.
2. Substantial shading of other properties?                          X    
Project would not shade other properties

G. Land Use. Will the proposal result in:

1. A land use which is inconsistent with the adopted community plan land use designation for the site?                          X    
Land use currently exists within a commercial zone
2. A conflict with the goals, objectives and recommendations of the community plan in which it is located?                          X    
Gas stations not addressed in plan
3. A conflict with adopted environmental plans for the area?                          X    
Project is consistent with plans
4. Land uses which are not compatible with aircraft accident potential as defined by a SANDAG Airport Land Use Plan (ALUP)?                          X    
Site not subject to an ALUP

H. Natural Resources. Will the proposal result in:

1. The prevention of future extraction of sand and gravel resources?                          X    
Site not suitable for extraction

- |    |                                                                                                                                                                                                               | <u>Yes</u> | <u>Maybe</u> | <u>No</u> |
|----|---------------------------------------------------------------------------------------------------------------------------------------------------------------------------------------------------------------|------------|--------------|-----------|
| 2. | The conversion of agricultural land to nonagricultural use or impairment of the agricultural productivity of agricultural land?<br><u>Site not suitable for agriculture</u>                                   | —          | —            | <u>X</u>  |
| I. | <u>Recreational Resources</u> : Will the proposal result in an impact upon the quality or quantity of existing recreational opportunities?<br><u>Existing recreational opportunities will not be impacted</u> | —          | —            | <u>X</u>  |
| J. | <u>Population</u> . Will the proposal alter the planned location, distribution, density, or growth rate of the population of an area?<br><u>Project will have no impact on the surrounding population</u>     | —          | —            | <u>X</u>  |
| K. | <u>Housing</u> . Will the proposal affect existing housing in the community, or create a demand for additional housing?<br><u>No impact on current or future housing</u>                                      | —          | —            | <u>X</u>  |
| L. | <u>Transportation/Circulation</u> . Will the proposal result in:                                                                                                                                              |            |              |           |
| 1. | Traffic generation in excess of specific/community plan allocation?<br><u>Traffic not in excess of allocation</u>                                                                                             | —          | —            | <u>X</u>  |
| 2. | An increase in projected traffic which is substantial in relation to the capacity of the street system?<br><u>Project consistent with allocation</u>                                                          | —          | —            | <u>X</u>  |
| 3. | An increased demand for off-site parking?<br><u>No increased demand for off-site parking would occur</u>                                                                                                      | —          | —            | <u>X</u>  |
| 4. | Effects on existing parking?<br><u>No impact to existing parking would occur</u>                                                                                                                              | —          | —            | <u>X</u>  |
| 5. | Substantial impact upon existing or planned transportation systems?<br><u>No impact on transportation system</u>                                                                                              | —          | —            | <u>X</u>  |

Yes    Maybe    No

6. Alterations to present circulation movements including effects on existing public access to beaches, parks, or other open space areas? —    —    X  
No alteration to present circulation system
7. Increase in traffic hazards to motor vehicles, bicyclists or pedestrians? —    —    X  
No such increased hazards
- M. Public Services. Will the proposal have an effect upon, or result in a need for new or altered governmental services in any of the following areas:
- a. Fire protection? —    —    X  
Area services are adequate
- b. Police protection? —    —    X  
Area services are adequate
- c. Schools? —    —    X  
Area services are adequate
- d. Parks or other recreational facilities? —    —    X  
Area services are adequate
- e. Maintenance of public facilities, including roads? —    —    X  
Area services are adequate
- f. Other governmental services? —    —    X  
Area services are adequate
- N. Utilities. Will the proposal result in a need for new systems, or require substantial alterations to existing utilities, including:
- a. Power? —    —    X  
All utilities available
- b. Natural gas? —    —    X  
All utilities available
- c. Communications systems? —    —    X  
All utilities available

	<u>Yes</u>	<u>Maybe</u>	<u>No</u>
d. Water? <u>All utilities available</u>	—	—	<u>X</u>
e. Sewer? <u>All utilities available</u>	—	—	<u>X</u>
f. Storm water drainage? <u>All utilities available</u>	—	—	<u>X</u>
g. Solid waste disposal? <u>All utilities available</u>	—	—	<u>X</u>
O. <u>Energy</u> . Will the proposal result in the use of excessive amounts of fuel or energy? <u>No excessive energy would be required</u>	—	—	<u>X</u>
P. <u>Water Conservation</u> . Will the proposal result in:			
1. Use of excessive amounts of water? <u>No excessive water use would be required</u>	—	—	<u>X</u>
2. Landscaping which is predominantly non-drought resistant vegetation? <u>Landscape in compliance with technical manual</u>	—	—	<u>X</u>
Q. <u>Neighborhood Character/Aesthetics</u> . Will the proposal result in:			
1. The obstruction of any vista or scenic view from a public viewing area? <u>No such existing views</u>	—	—	<u>X</u>
2. The creation of a negative aesthetic site or project? <u>Project is an existing gas station</u>	—	—	<u>X</u>
3. Project bulk, scale, materials, or style which will be incompatible with surrounding development? <u>Bulk, scale, materials and style compatible with surrounding area</u>	—	—	<u>X</u>
4. Substantial alteration to the existing character of the area? <u>Project compatible with existing character of the area</u>	—	—	<u>X</u>



- |    |                                                                                                                                                                                                                              | <u>Yes</u> | <u>Maybe</u> | <u>No</u> |
|----|------------------------------------------------------------------------------------------------------------------------------------------------------------------------------------------------------------------------------|------------|--------------|-----------|
| 5. | The loss of any distinctive or landmark tree(s), or a stand of mature trees?<br><u>No such trees on site</u>                                                                                                                 | —          | —            | <u>X</u>  |
| 6. | Substantial change in topography or ground surface relief features?<br><u>No change to the topography or ground surface would occur</u>                                                                                      | —          | —            | <u>X</u>  |
| 7. | The loss, covering or modification of any unique geologic or physical features such as a natural canyon, sandstone bluff, rock outcrop, or hillside with a slope in excess of 25 percent?<br><u>No such features on site</u> | —          | —            | <u>X</u>  |
| R. | <u>Cultural Resources.</u> Will the proposal result in:                                                                                                                                                                      |            |              |           |
| 1. | Alteration of or the destruction of a prehistoric or historic archaeological site?<br><u>No such resources on site</u>                                                                                                       | —          | —            | <u>X</u>  |
| 2. | Adverse physical or aesthetic effects to a prehistoric or historic building, structure, object, or site?<br><u>No such resources on site</u>                                                                                 | —          | —            | <u>X</u>  |
| 3. | Adverse physical or aesthetic effects to an architecturally significant building, structure, or object?<br><u>No such structures on site</u>                                                                                 | —          | —            | <u>X</u>  |
| 4. | Any impact to existing religious or sacred uses within the potential impact area?<br><u>No such uses on site</u>                                                                                                             | —          | —            | <u>X</u>  |
| S. | <u>Paleontological Resources.</u> Will the proposal result in the loss of paleontological resources?<br><u>Site previously graded/disturbed</u>                                                                              | —          | —            | <u>X</u>  |

Yes      Maybe      No

T. Human Health/Public Safety. Will the proposal result in:

- |    |                                                                                                                                                                |       |       |          |
|----|----------------------------------------------------------------------------------------------------------------------------------------------------------------|-------|-------|----------|
| 1. | Creation of any health hazard or potential health hazard (excluding mental health)?                                                                            | _____ | _____ | <u>X</u> |
|    | <u>No such health hazards would be created.</u>                                                                                                                |       |       |          |
| 2. | Exposure of people to potential health hazards?                                                                                                                | _____ | _____ | <u>X</u> |
|    | <u>Same as above</u>                                                                                                                                           |       |       |          |
| 3. | A future risk of an explosion or the release of hazardous substances (including but not limited to gas, oil, pesticides, chemicals, radiation, or explosives)? | _____ | _____ | <u>X</u> |
|    | <u>Same as above</u>                                                                                                                                           |       |       |          |

U. Mandatory Findings of Significance.

1. Does the project have the potential to degrade the quality of the environment, substantially reduce the habitat of a fish or wildlife species, cause a fish or wildlife population to drop below self sustaining levels, threaten to eliminate a plant or animal community, reduce the number or restrict the range of a rare or endangered plant or animal, or eliminate important examples of the major periods of California history or prehistory? \_\_\_\_\_ X  
The project will not degrade the quality of the environment
2. Does the project have the potential to achieve short-term, to the disadvantage of long-term, environmental goals (A short-term impact on the environment is one which occurs in a relatively brief, definitive period of time while long-term impacts will endure well into the future.)? \_\_\_\_\_ X  
No such long term impacts

Yes   Maybe   No

3. Does the project have impacts which are individually limited, but cumulatively considerable (A project may impact on two or more separate resources where the impact on each resource is relatively small, but where the effect of the total of those impacts on the environment is significant.)?                          X    
No such short term or cumulative impacts would occur
4. Does the project have environmental effects which will cause substantial adverse effects on human beings, either directly or indirectly?                          X    
No long term impacts to humans would occur

## INITIAL STUDY CHECKLIST

### REFERENCES

#### A. Geology/Soils

- ☒ City of San Diego Seismic Safety Study, Updated June 1983.
- ☐ USGS San Diego County Soils Interpretation Study -- Shrink-Swell Behavior, 1969.
- ☐ Geology of the San Diego Metropolitan Area, California.
- ☒ U.S. Department of Agriculture Soil Survey - San Diego Area, California, Part I and II, December 1973.
- ☐ Site Specific Report: \_\_\_\_\_

#### B. Air

- ☒ Regional Air Quality Strategies (RAQS) - APCD.
- ☐ State Implementation Plan.
- ☐ Site Specific Report: \_\_\_\_\_

#### C. Hydrology/Water Quality

- ☐ Flood Insurance Rate Map (FIRM), September 29, 1989.
- ☒ Federal Emergency Management Agency (FEMA), National Flood Insurance Program - Flood Boundary and Floodway Map, September 29, 1989.
- ☐ Site Specific Report: \_\_\_\_\_

#### D. Biology

- ☒ Community Plan - Resource Element
- ☐ City of San Diego Vernal Pool Maps
- ☐ California Department of Fish and Game Endangered Plant Program - Vegetation of San Diego, March 1985.
- ☐ Sunset Magazine, New Western Garden Book - Rev. ed. Menlo Park, CA - Sunset Magazine.
- ☐ Robinson, David L., San Diego's Endangered Species, 1988.
- ☐ California Department of Fish and Game, "San Diego Vegetation", March 1985.
- ☐ California Department of Fish and Game, "Bird Species of Special Concern in California", June 1978.
- ☐ State of California Department of Fish and Game, "Mammalian Species of Special Concern in California", 1986.
- ☐ State of California Department of Fish and Game, "California's State Listed Threatened and Endangered Plants and Animals", January 1, 1989.
- ☐ Code of Federal Regulations, Title 50, Part 10, "List of Migratory Birds."



\_\_\_\_\_ Code of Federal Regulations, Title 50, Part 17, "Endangered and Threatened Wildlife and Plants", January 1, 1989.

\_\_\_\_\_ Site Specific Report: \_\_\_\_\_  
\_\_\_\_\_.

#### E. Noise

- ☒ Community Plan
- \_\_\_\_\_ San Diego International Airport - Lindbergh Field CNEL Maps, January 1987 - December 1987.
- \_\_\_\_\_ Brown Field Airport Master Plan CNEL Maps.
- \_\_\_\_\_ Montgomery Field CNEL Maps.
- \_\_\_\_\_ NAS Miramar CNEL Maps, 1976.
- \_\_\_\_\_ San Diego Association of Governments - San Diego Regional Average Weekday Traffic Volumes 1984-88.
- \_\_\_\_\_ San Diego Association of Governments - Average Daily Traffic Map, 1989.
- \_\_\_\_\_ San Diego Metropolitan Area Average Weekday Traffic Volume Maps, SANDAG, 1989.
- \_\_\_\_\_ Lindbergh Field Airport Influence Area, SANDAG Airport Land Use Commission.
- ☒ City of San Diego Progress Guide and General Plan.

\_\_\_\_\_ Site Specific Report: \_\_\_\_\_  
\_\_\_\_\_.

#### F. Light, Glare and Shading

☐ Site Specific Report: \_\_\_\_\_  
\_\_\_\_\_.

#### G. Land Use

- \_\_\_\_\_ City of San Diego Progress Guide and General Plan.
- ☒ Community Plan. (Gas stations not addressed in Community Plan)
- \_\_\_\_\_ Airport Land Use Plan.
- ☒ City of San Diego Zoning Maps
- \_\_\_\_\_ FAA Determination

#### H. Natural Resources

- ☒ City of San Diego Progress Guide and General Plan.
- ☒ U.S. Department of Agriculture, Soil Survey - San Diego Area, California, Part I and II, December 1973.
- \_\_\_\_\_ California Department of Conservation - Division of Mines and Geology, Mineral Land Classification.
- \_\_\_\_\_ Division of Mines and Geology, Special Report 153 - Significant Resources Maps.

**I. Recreational Resources**

- ☐ City of San Diego Progress Guide and General Plan.
- ☒ Community Plan.
- ☐ Department of Park and Recreation
- ☐ City of San Diego - A Plan for Equestrian Trails and Facilities, February 6, 1975.
- ☐ City of San Diego - San Diego Regional Bicycling Map
- ☐ City of San Diego - Open Space and Sensitive Area Preservation Study, July 1984.
- ☐ Additional Resources: \_\_\_\_\_

**J. Population**

- ☒ City of San Diego Progress Guide and General Plan.
- ☒ Community Plan.
- ☐ Series VII Population Forecasts, SANDAG.

**K. Housing**

- ☐ NA \_\_\_\_\_

**L. Transportation/Circulation**

- ☐ City of San Diego Progress Guide and General Plan.
- ☒ Community Plan.
- ☐ San Diego Metropolitan Area Average Weekday Traffic Volume Maps, SANDAG, 1989.
- ☐ San Diego Region Weekday Traffic Volumes 1984-88, SANDAG.
- ☐ Site Specific Report: \_\_\_\_\_

**M. Public Services**

- ☐ City of San Diego Progress Guide and General Plan.
- ☒ Community Plan.

**N. Utilities**

- ☐ NA \_\_\_\_\_

**O. Energy**

- ☐ NA \_\_\_\_\_

**P. Water Conservation**

- ☐ NA Sunset Magazine, New Western Garden Book. Rev. ed. Menlo Park, CA: Sunset Magazine.

**Q. Neighborhood Character/Aesthetics**

\_\_\_\_\_ City of San Diego Progress Guide and General Plan.

☒ Community Plan.

\_\_\_\_\_ Local Coastal Plan.

**R. Cultural Resources**

☒ City of San Diego Archaeology Library.

\_\_\_\_\_ Historical Site Board List.

\_\_\_\_\_ Community Historical Survey: \_\_\_\_\_.

\_\_\_\_\_ Site Specific Report: \_\_\_\_\_.

**S. Paleontological Resources**

☒ Kennedy, Michael P., and Gary L. Peterson, "Geology of the San Diego Metropolitan Area, California. Del Mar, La Jolla, Point Loma, La Mesa, Poway, and SW 1/4 Escondido 7 1/2 Minute Quadrangles," California Division of Mines and Geology Bulletin 200, Sacramento, 1975.

\_\_\_\_\_ Kennedy, Michael P., and Siang S. Tan, "Geology of National City, Imperial Beach and Otay Mesa Quadrangles, Southern San Diego Metropolitan Area, California," Map Sheet 29, 1977.

\_\_\_\_\_ Site Specific Report: \_\_\_\_\_.

**T. Human Health/Public Safety**

☒ San Diego County Hazardous Materials Management Division

\_\_\_\_\_ FAA Determination

\_\_\_\_\_ State Assessment and Mitigation, Unauthorized Release Listing, Public Use Authorized July 13, 1989.