

CAÑON STREET POCKET PARK PUBLIC ART

ARTWORK DESIGN

BY NATE PAGE



Commission for
Arts and Culture

Artist Nate Page is creating a permanent public artwork for the new Cañon Street Pocket Park in Point Loma. The artist spent several months learning about the site and working with the park's design team to develop his artwork proposal.

The artwork will consist of a sculpture resembling a boat dock integrated into a landscaped area of the park. The artwork will be constructed of durable materials such as Accoya wood and acrylic enamel paint. Extending approximately twenty feet into the landscape, the sculpture is described by the artist as a "horizontal mural" that reflects the cultural history of the surrounding neighborhood.



Example of boat dock that inspired the artist's design

Inspired by the neighborhood's relationship to the sea and the local history of Portuguese shipping culture, the artwork engages with the tradition of Portuguese Azulejos tiles and the collective community memory of looking out at the horizon, awaiting the first glimpse of ships returning home. This artwork aims to reconfigure historical experiences and phenomena in an experiential sculpture that brings the horizon directly to the viewer's feet.



Example of Portuguese Azulejos tile

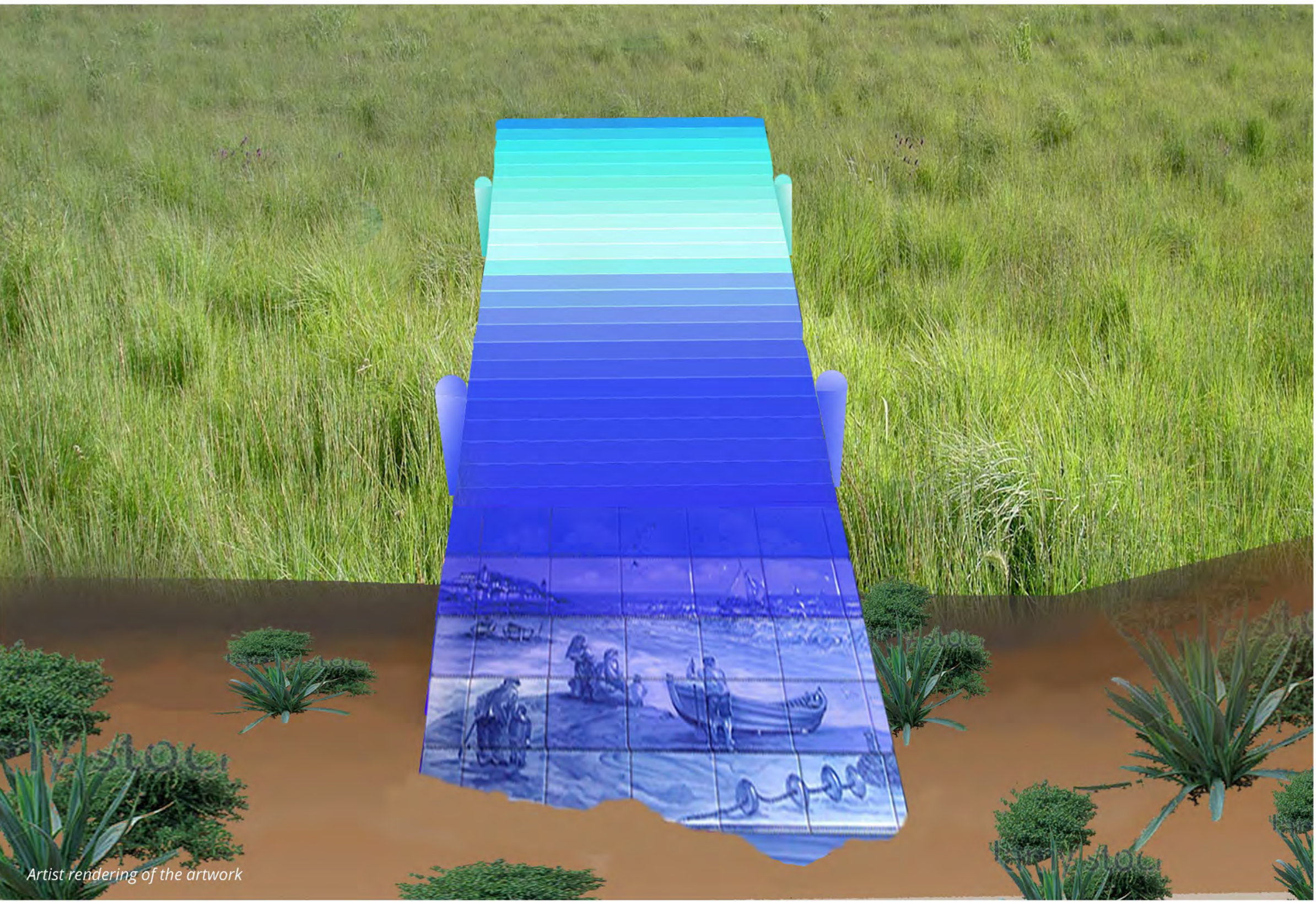

Artist rendering of the artwork

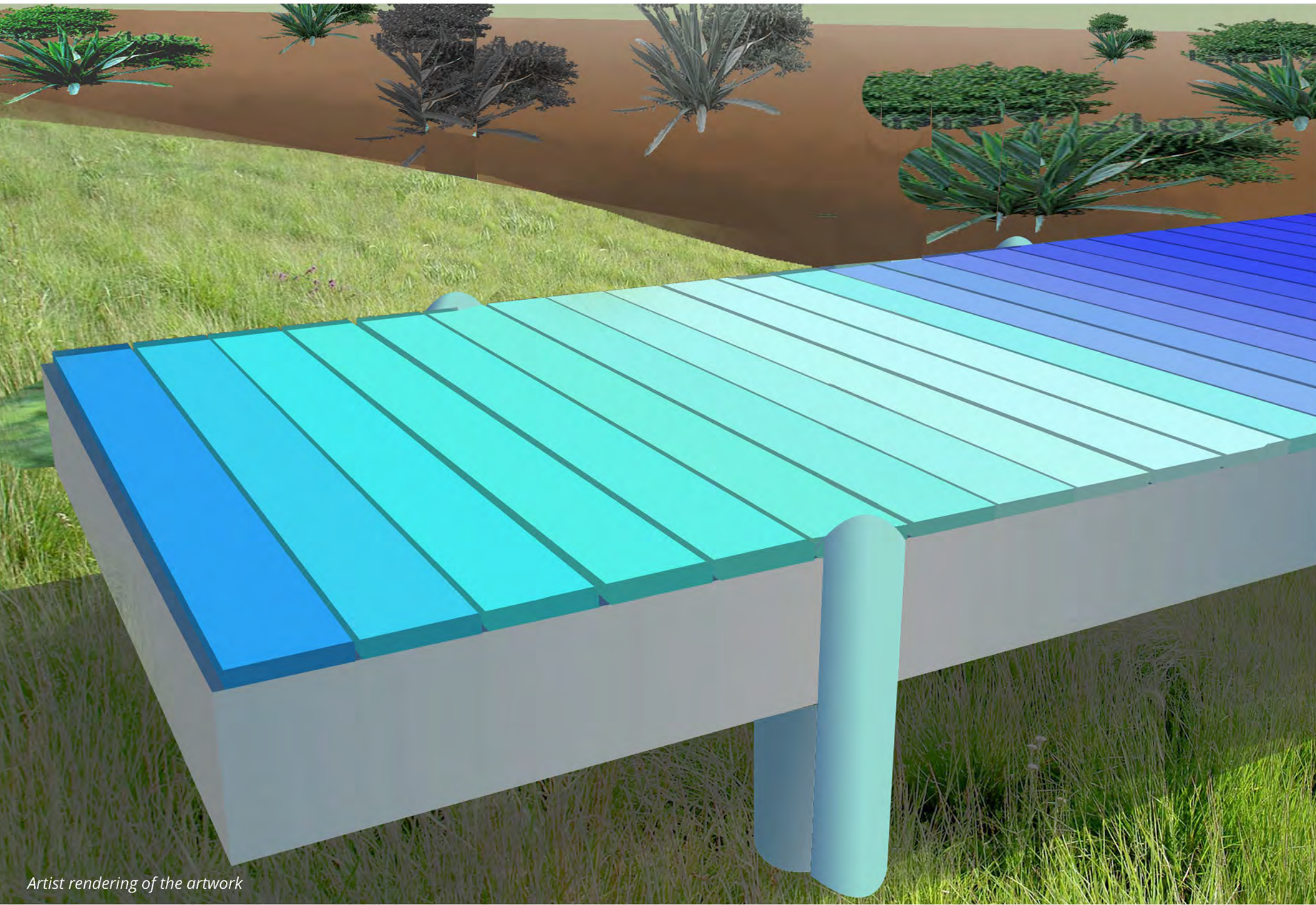

Artist rendering of the artwork

The artwork will be integrated into the landscape of the park. When viewers stand at the foot of the sculpture, they will see a vibrantly colored mural that suggests the horizon line where the sea meets the sky. Viewed from elsewhere, the site-specific sculpture evokes the park as a microcosm of the sea itself. The artwork will encourage a sense of discovery and contemplation in visitors as they study its colorful design and imagine themselves looking out to the horizon.

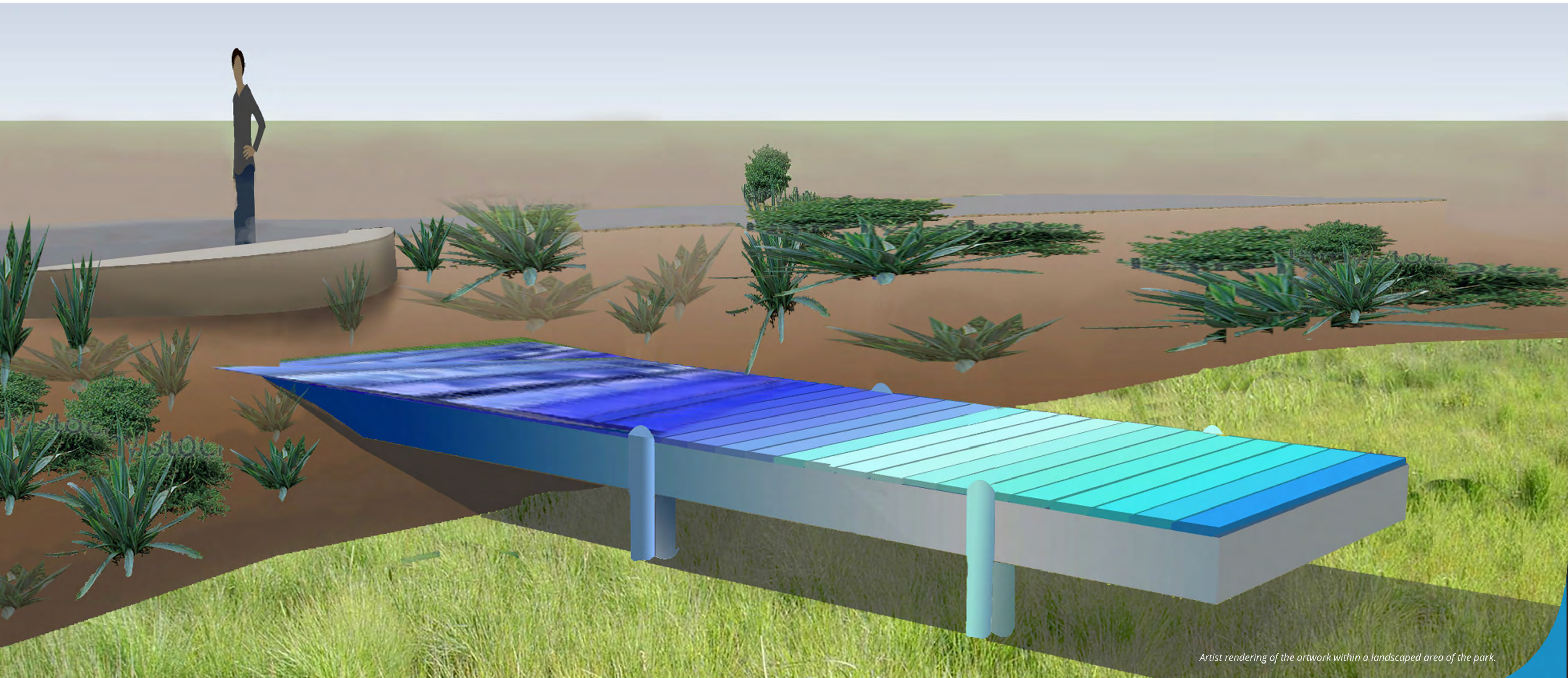

Artist rendering of the artwork within a landscaped area of the park.