



THE CITY OF SAN DIEGO

M E M O R A N D U M

DATE: February 27, 2018

TO: The Balboa Park Committee
Agenda of March 1, 2018

FROM Herman D. Parker, Parks and Recreation Director

SUBJECT: Statue and Informational Plaque of Vasco Nunez de Balboa

SUMMARY

Issues – Should the Balboa Park Committee:

1. Advise that the proposed statue of Vasco Nunez de Balboa (Balboa) in the Plaza de Balboa is consistent with the Balboa Park Master Plan and Central Mesa Precise Plan (CMPP); and
2. Recommend approval of the proposed statue and plaque of Balboa?

Department Recommendations:

1. Advise staff the proposed statue of Balboa in the Plaza de Balboa is consistent with the Balboa Park Master Plan and Central Mesa Precise Plan; and
2. Do not recommend approval of the proposed statue and plaque of Balboa at this time.

Fiscal Impact – The cost of design, fabrication and installation of the proposed statue and informative plaque will be borne by the House of Spain, a member nation of the House of Pacific Relations in Balboa Park. The cost of long term maintenance will be borne by the City of San Diego Parks and Recreation Department.

Environmental – The City of San Diego, as lead agency, will review the Project and prepare any required CEQA documentation per State CEQA guidelines.

BACKGROUND

The Plaza de Balboa is located at the east end of El Prado in the East Prado area of Balboa Park. The Natural History Museum is located to the north, the Ruben H. Fleet Science Theater to the south, and Park Boulevard to the east. Buildings to the west along El Prado include the Casa de Balboa and the Casa del Prado.

The area currently occupied by the Plaza de Balboa was the original entrance to the exposition grounds from Park Boulevard. Park Boulevard was originally aligned through the current Plaza de Balboa but was realigned to the east in 1967. The Plaza de Balboa as seen today was first developed in 1972.

A San Diego Union article from 1913 indicated there was an intent to erect a statue of Balboa on the east end of El Prado, to be surrounded by a semicircle of columns. The cost was to be \$15,000; however this vision was never implemented.

The Central Mesa Precise Plan includes an enlarged graphic of the Plaza de Balboa. The graphic includes enhanced access to the Plaza from Park Boulevard as well as a new pedestrian bridge to connect to the Rose Garden on the east side of Park Boulevard. A statue of Vasco Nunez de Balboa is not indicated in the graphic.

The Central Mesa Precise Plan does include a provision for a statue of Vasco Nunez de Balboa to be located in the Palisades area of Balboa Park. This area is currently occupied by parking and, while the Precise Plan shows reclamation of this area, funding has not been identified for implementation.

DISCUSSION

The House of Spain is proposing to install a statue of Balboa in the Plaza de Balboa area of Balboa Park. The statue would be made of bronze and would be approximately 9 feet tall. The statue would be placed on a concrete pedestal abutting an existing seat wall immediately east of the Bea Evanson Fountain. The pedestal would be the same height as the seat wall (approximately two feet tall) and would match the seat wall in color and texture. A small informative plaque would be placed on the concrete pedestal.

Park and Recreation Board Policy No. 1002 addresses "Gifts of Architectural Features, Works of Art and Commemorative Plaques for Public Parks or Other City-owned Land." A copy of this policy is attached. The policy provides criteria for the evaluation of proposals. The following are the criteria as well as staff's evaluation of how the proposal meets the criteria.

- a. *Does it add to the attractiveness and/or usefulness of the park?*

Staff Response: Staff believes a well-designed statue can add to the attractiveness of the park much as the statue of El Cid at the south end of the Plaza de Panama adds to the attractiveness of the park. There is historic precedence for anchoring a major plaza with a sculpture of a renowned figure.

- b. *Does it commemorate an individual, group or event of general interest to citizens and tourists?*

Staff Response: Staff believes a statue of Balboa could be of general interest to citizens and tourists as he is the namesake of Balboa Park. Balboa is credited with

being the first European to see the Pacific Ocean, and he did so in the country of Panama. His name was chosen for the park because of his association with Panama and the opening of the Panama Canal. These events lead to the 1915 Panama-California International Exposition.

However, the history of Vasco Nunez de Balboa is in question. There are allegations of atrocities against the indigenous peoples of Central America. Staff has also received considerable feedback in opposition to a statue of Balboa.

- c. *Is the individual, group or event worthy of commemoration to future citizens?*

Staff Response: Please see Section b.

- d. *Does a proposal for a tribute to a living person meet all criteria, and will "time" substantiate the memorial?*

Staff Response: This criterion is not applicable.

- e. *If the "feature" provides a service, are City funds needed for installation, and are they available?*

Staff Response: The proposed statue would not provide a service other than as public information. Cost for the installation would be borne by the House of Spain, and would be gifted to the City. Maintenance would be the responsibility of the City of San Diego Parks and Recreation Department.

- f. *Will proper maintenance be feasible?*

Staff Response: Proper maintenance may not always be feasible. The Commission for Arts and Culture has opined that the proposed statue would not be considered artwork; therefore, Parks and Recreation would be responsible for maintenance. In contrast, the statue of El Cid is considered artwork and is maintained by the Commission for Arts and Culture as public art.

- g. *Will the feature withstand vandalism and can its design be altered either to deter vandalism or make cleanup of vandalism easier?*

Staff Response: The feature will be made of high quality bronze, which is a durable and maintainable material.

- h. *To what extent has the person, group or event been commemorated in other locations in the metropolitan area?*

Staff Response: Balboa Park is named after Vasco Nunez de Balboa, as is the Casa de Balboa and the Plaza de Balboa. There are eight streets in the city named after Balboa, including Balboa Drive in Balboa Park. There are many buildings in San Diego that bear the name "Balboa." Staff, however, is not aware of any other statues of Balboa in the San Diego region.

- i. *Does the location proposed add significance to the memorial?*

Staff Response: The statue is proposed to be in Balboa Park, more specifically in the Plaza de Balboa. The location adds significance to the memorial. As noted previously, the Central Mesa Precise Plan identifies a location for a statue of Balboa in the

Palisades area of the park. However, this area has not been redeveloped per the Precise Plan; it is currently occupied by an asphalt parking lot. The statue could be relocated to the Palisades if the area is ever redeveloped per the Precise Plan. The Plaza de Balboa does not include a statue of Balboa. If the Plaza de Balboa is ever redeveloped per the Precise Plan, the proposed statue may be in conflict with the proposed pedestrian bridge to the Rose Garden; adjustment in its location may be required in the future or the statue could be incorporated into the final design.

ALTERNATIVES

1. Advise that the statue of Balboa in the proposed location is NOT consistent with the Balboa Park Master Plan Central Mesa Precise Plan (requiring a plan amendment).
2. Recommend approval of the proposed statue and plaque of Balboa.

Respectfully submitted,

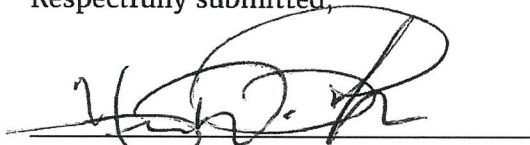

Herman D. Parker
Parks and Recreation Director

HDP

Attachments: A. Central Mesa Precise Plan Excerpts
B. Park and Recreation Board Policy No. 1002
C. House of Spain Proposal

cc: Council District 3 Office





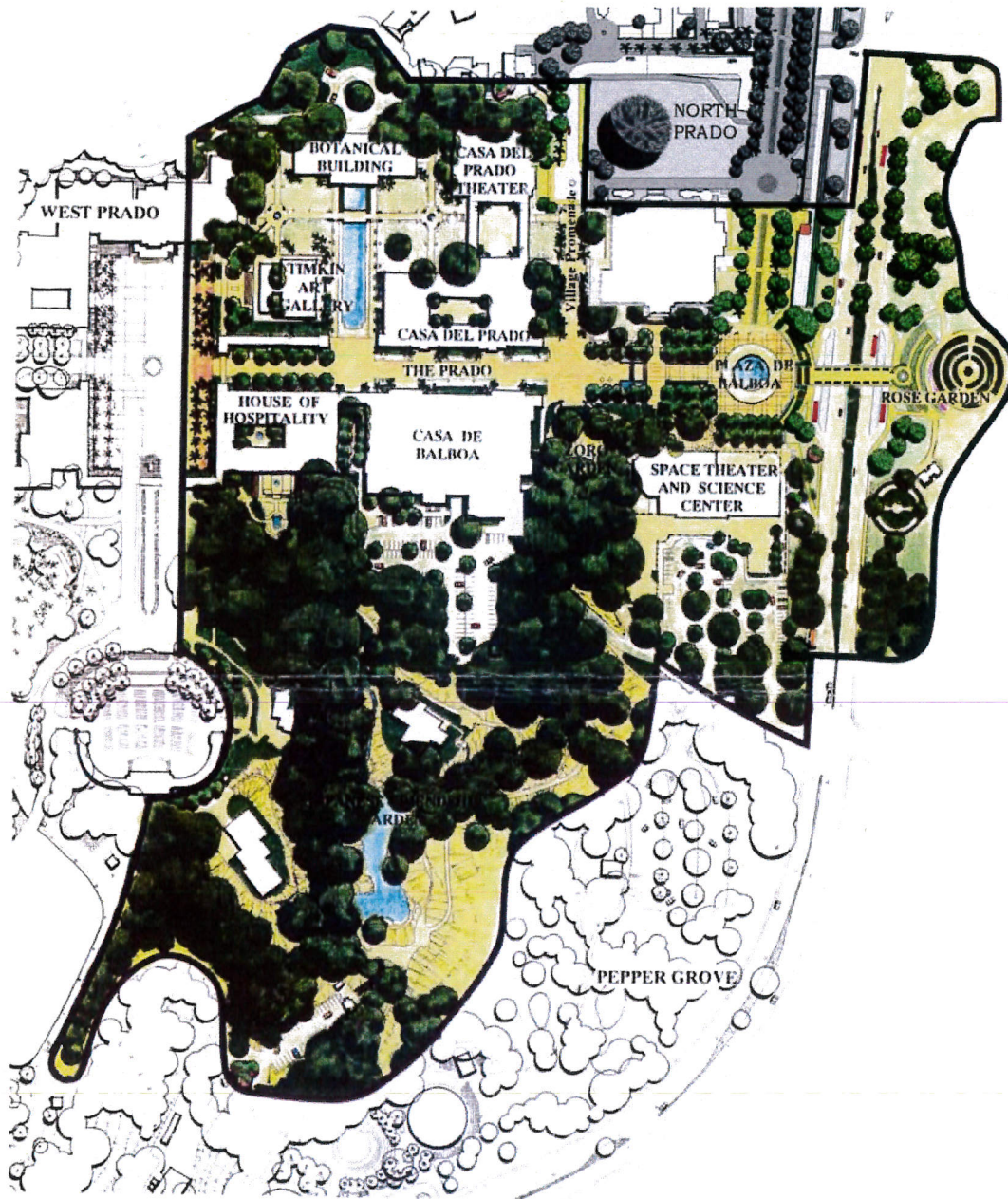

East Prado

The House of Hospitality will benefit from a complete reconstruction and will accommodate a new full spectrum visitor center and other visitor oriented services. The Natural History Museum and the Fleet Space Center will expand their facilities. ~~Stairways from the Plaza de Balboa to Park Boulevard will descend to a pedestrian drop-off area on Park Boulevard and reinstate the traditional east entry to the Prado.~~ The traditional east entry to the Prado will be reinstated. The Plaza de Balboa will be connected to the Rose Garden across Park Boulevard by a pedestrian bridge. A public transit station will be located at the bridge. Pedestrian circulation will be restored to Village Place creating a north connection of the Prado promenade with Spanish Village. Other landscape improvements include a regrading and reconfiguration of Casa de Balboa parking lot to improve drainage and vehicular access, improvements to the south entry to the Prado located between the House of Hospitality and Casa de Balboa, and improvements to Zoro Garden.



East Prado

revised May 2003 Figure 30

	Trees		Lawn
	Groundcovers		Paved Pedestrian Areas

0 100 200 400
SCALE IN FEET 

ESTRADA Land Planning



BALBOA PARK - CENTRAL MESA PRECISE PLAN

Precise Plan - Specific Recommendations

8. Plaza de Balboa

Design Objective:

Enhance Plaza de Balboa to serve the future needs of Park visitors. Create a pedestrian bridge that will connect Plaza de Balboa with the Rose Garden and provide enhanced views of the Rose Garden and mountains to the east. Integrate the design of the new pedestrian bridge with a public transit station on Park Boulevard.

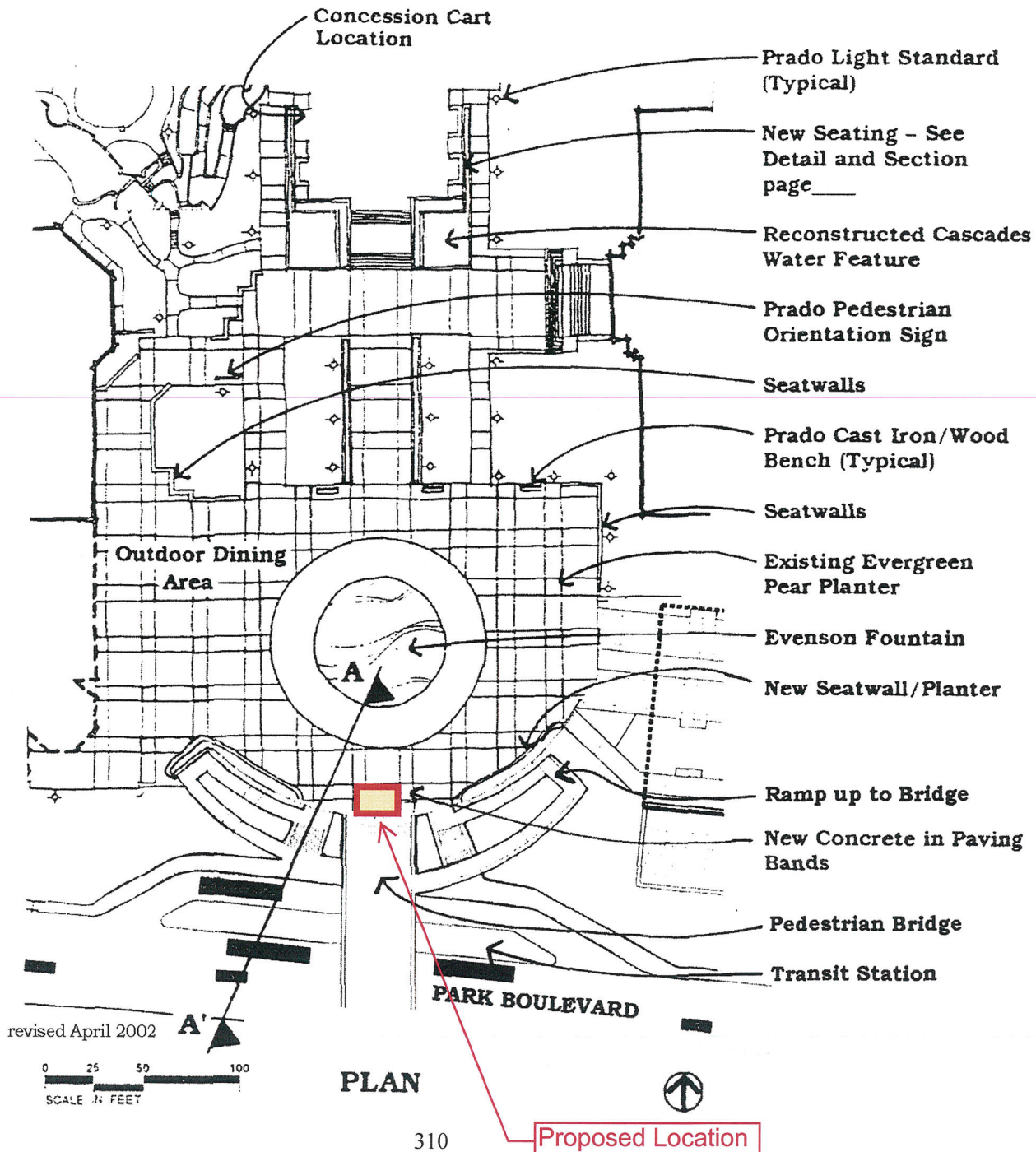



6. Palisades Tram Stop*

Design Objective:

Provide a safe loading and unloading area for the Park Tram and include sheltered seating for Tram patrons.

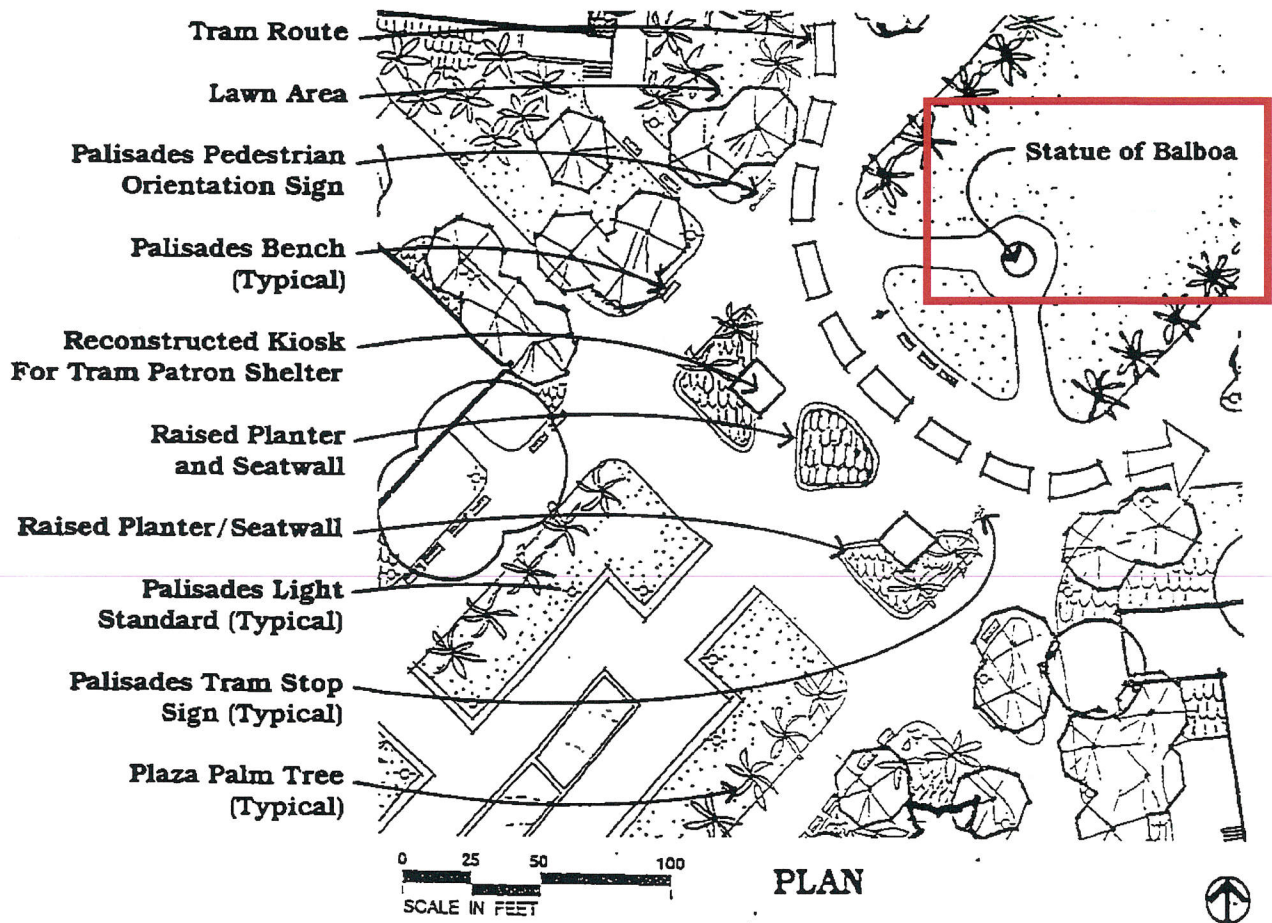

Recommendations:

- Conduct a partial reconstruction of the 1935 speaker kiosks in the location shown on the plan to serve as open air shelters. Adapt the kiosks to be open on two sides facing the tram staging area and provide seating inside.
- Incorporate raised seat walls into the kiosk seating.
- Provide walkways to a statue of Vasco Nunez de Balboa, namesake of Balboa Park.
- Include orientation signage, a public information kiosk, and drinking fountains in the design for this area.

Plaza Palm Tree: *Arecastrum romanzofianum* - Queen Palm

*proposed name for a new feature.

PARK AND RECREATION BOARD POLICY

SUBJECT: Gifts of Architectural Features, Works of Art and Commemorative Plaques for Public Parks or Other City-owned Land

BACKGROUND: Public parks have as a primary function, the provision of outdoor recreation in spacious, landscaped surroundings. Special architectural features, such as water elements, sculpture, and other works of art add significantly to the parks by the enjoyment derived from experiencing the beauty of the feature. All features must be consistent with applicable Park Master Plans and General Development Plans.

PURPOSE: The purpose of this policy is to establish criteria for design, placement and acceptance of architectural, artistic and commemorative features within parks or other City-owned land, and to maintain same.

- POLICY:**
1. The City of San Diego shall encourage community groups and individuals to donate "special features" which will add to the interest and attractiveness of the parks, or be of service to patrons of the parks, i.e., drinking fountains, benches.
 2. Proposals for "special features" and their locations shall be reviewed by the Park and Recreation Board and submitted by them to the City Council with recommendations in accordance with Council Policy 100-2 (City Receipt of Donations).
 3. Proposals for special features shall be coordinated for review with the City of San Diego Commission for Arts and Culture.
 4. A "special feature" may serve as a recognition to an individual or group; living or dead, who have made a significant contribution to a specific park or community; commemorate an historic occasion; or acknowledge interest of a group or individual in a park.
 5. All "special features" proposed as memorials shall add to the attractiveness or usefulness of the park area or be of unusually significant historical value.

POLICY: (Continued)

No. 1002

6. The initial costs of development and placement of a decorative memorial or commemorative feature shall be borne totally by private funds. Costs may be shared by the City if the "feature" provides a service to park patrons. The City will assume ownership and maintenance, if accepted, and place in a public park. The City will not assume responsibility for replacement of "features" removed due to vandalism or lost to theft. Proposed "special features" which pose an unusual risk of vandalism, theft or extraordinary maintenance due to design or location, shall not be approved unless the private sponsors make financial arrangements, satisfactory to the City, for replacement, repair or removal of the "feature" due to vandalism, theft or extraordinary maintenance.

7. "Living Memorials," features or facilities which (in addition to their inherent beauty) provide an opportunity for active recreation, shall be encouraged.

8. The Park and Recreation Board shall evaluate each individual memorial feature on the following basis:

a. Does it add to the attractiveness and/or usefulness of the park?

b. Does it commemorate an individual group or event of general interest to citizens and tourists?

c. Is the individual, group, or event worthy of commemoration to future citizens?

d. Does a proposal for a tribute to a living person meet all criteria, and will "time" substantiate the memorial?

e. If the "feature" provides a service, are City funds needed for installation, and are they available?

f. Will proper maintenance be feasible?

g. Will the feature withstand vandalism and can its design be altered either to deter vandalism or make the cleanup of vandalism easier?

POLICY: (Continued)

No. 1002

h. To what extent has the person, group, or event been commemorated in other locations in the metropolitan area?

i. Does the location proposed add significance to the memorial?

SUBSTANTIATION:

Park and Recreation Board Minutes of 5/12/65

Park and Recreation Board Minutes of 3/15/77

Park and Recreation Board Minutes of 5/19/94

Public Facilities and Recreation Committee Minutes of 6/22/94

CITY OF SAN DIEGO, CALIFORNIA
COUNCIL POLICY

CURRENT

SUBJECT: CITY RECEIPT OF DONATIONS
POLICY NO.: 100-02
EFFECTIVE DATE: August 1, 1994

BACKGROUND:

From time to time, private individuals and agencies make donations to the City for general or specific purposes. General unwritten procedures exist for receiving gifts, but specific policies and procedures have not heretofore been written. The program of seeking community contributions for the Community Concourse highlighted the desirability of written policies and procedures.

PURPOSE:

To formalize the conditions and procedures to be followed by the City in accepting donations.

DEFINITIONS:

Donation - A contribution to the City which may consist of a cash grant, real property (land), or an in-kind contribution (any item or object other than cash or real property which would serve a useful purpose in the provision of City Services).

Unrestricted Donation - A donation to the City without any limitation being placed upon its use.

Restricted Donation - A donation to the City for a specified purpose.

Works of Art - Includes, but is not limited to, physical art that may be an integral part of a public site or building, or that may be integrated with the work of other design professionals. Public works of art may be permanent, fixed, temporary or portable. Examples of public works of art include:

1. Sculpture which may be made of any material or combination of materials: may be free standing, wall-supported or suspended, kinetic, electronic, or mechanical.
2. Murals and paintings which may be made of any material or variety of materials with or without collage and which may be made with traditional or non-traditional means.
3. Earthworks, neon, glass, organic materials (for example fiber, clay, or wood), mosaics, photographs, prints, literary arts, calligraphy, any combination of media forms (for example sound, film, holographic, video, or computer systems), or hybrids of any media.

POLICY:

1. Real property donations shall be reviewed and a legal opinion rendered thereto by the City Attorney before acceptance by the City. The City Council shall be responsible for the acceptance of all real property donations.
2. Unrestricted personal property donations, except for works of art, do not require City Council approval for acceptance. Cash donations are a revenue to the General Fund and may be made

CITY OF SAN DIEGO, CALIFORNIA
COUNCIL POLICY

CURRENT

directly to the City Treasurer. In-kind donations may be made directly to the using department. All donations of \$250 or greater are to be reported to the Endowment Officer. It will be the Endowment Officer's responsibility to insure that proper City officials are informed of the donations; that the donation is acknowledged; that timely reports are made; and that suitable recognition is afforded the donor.

3. Single restricted personal property donations may be made to the City for specific purposes. Such donations may be restricted for city-wide projects such as: Centre City, Mission Bay recreation facilities, Balboa Park development, or the San Diego-Yokohama Friendship Commission. They may also be restricted to projects on City property which would benefit only limited groups, such as a community park or recreation center facility, improvements and landscaping in median strips, or shuffleboard courts. These donations may be cash or in-kind contributions. The City will review the conditions of the restrictive donations and determine if the benefits to be derived warrant the acceptance of the donations. Responsibility for such review and acceptance is as follows:
 - a. The City Council shall be responsible for accepting all restricted donations which:
 - (1) Create an immediate or initial City expenditure of \$5,000 or more which has not been included in the approved City budget. This pertains both to a direct outlay of City funds or to the use of City forces and materials.
 - (2) Create an annual City maintenance obligation of \$5,000 or more which has not been included in the approved City budget.
 - (3) Materially affect or change any aspect of City operations.
 - b. City departments or their appointed agents such as Community Recreation Councils, shall be responsible for accepting those restricted donations not covered by item 3a.

Accepted cash donations will be deposited in the appropriate fund for future expenditure on the restricted purpose. Unaccepted donations will be returned to the donor.
 - c. Restricted donations of works of art are addressed under item 5 of this policy.
4. Multiple restricted donations are cash donations made to the City for a special purpose or project by more than one individual or agency. The City Council shall be responsible for accepting all such donations. All accepted multiple donations restricted to the same purpose or project will be limited by the following:
 - a. Uniform conditions will apply to all donations.
 - b. A limited time will be established for accepting these donations.
 - c. A complete release must be granted upon acceptance by the City if the donor desires benefit of Federal income tax deduction.

CITY OF SAN DIEGO, CALIFORNIA
COUNCIL POLICY

CURRENT

- d. The City will maintain detailed trust records.

Upon acceptance of multiple restricted cash donations by the City, the donations will be deposited in the appropriate fund for future expenditures on the specified project.

5. Donations of works of art

- a. Any time a donation of a work of art is proposed for the City of San Diego, the City agency or department (if applicable) that operates or maintains the site of the proposed work of art shall consult the Commission for Arts and Culture regarding the procedures for its review and acceptance by the City. Upon learning of the prospective donation of a work of art, the Commission shall also meet with the donor.
- b. Under the guidance of the Commission for Arts and Culture, prospective donors and the department head of the particular City department or agency that operates and maintains the proposed site of the work of art (if applicable) shall meet and prepare written and visual documents for review by the Commission. The required documents are listed and described in "Guidelines for the Donation of Works of Art to the City of San Diego" available from the Commission. The Commission shall be responsible for assisting in the process of obtaining these guidelines, assembling materials, and submitting them for review.
- c. If a City department or agency has jurisdiction over the proposed site of the work of art, the department or agency head shall:
- (1) Inform the Commission of the relationship of any advisory boards to the department or agency.
 - (2) Refer proposals for donations of works of art to the advisory board which shall in turn make recommendations to the department or agency head.
 - (3) Convey the department or advisory board's recommendations to the Commission in writing.
- d. The Commission, with the aid of an advisory board made up of practicing artists and other professionals associated with the arts, shall review donation proposals and determine whether they will recommend to accept or reject the donation. The Commission may attach conditions to its recommendations for acceptance or rejection of donations. Proposals shall be reviewed according to criteria outlined in "Guidelines for the Donation of Works of Art to the City of San Diego," which are on file with the City Clerk's Office as document RR-284389-2.
- e. If a specific site is recommended for placement of the donated work of art, either by donor or the department or agency under whose management the site belongs, the Commission shall review the site recommendation according to the criteria outlined in "Guidelines for the Donation of Works of Art to the City of San Diego." If the proposed property falls under the jurisdiction of a specific City department or agency,

CITY OF SAN DIEGO, CALIFORNIA
COUNCIL POLICY

CURRENT

- the Commission and the department or agency must reach an agreement regarding the installation and placement of the work of art on the specific site.
- f. Upon reviewing the donation proposal, the Commission shall recommend either acceptance, with or without conditions, or rejection of donations of works of art to the City Council.
 - g. If the City chooses to accept donations of works of art, the donation shall be accompanied by a legal instrument of conveyance of title. Any conditions the City or donor places on a donation of a work of art shall be stated in writing and attached to the legal conveyance of title.
 - h. Once the City accepts the donation of a work of art and becomes its legal owner, the Commission shall coordinate all processes relating to the installation, maintenance, removal, or relocation of works of art in City-owned public places. If a specific City department or agency operates and maintains the site of the work of art, the Commission shall consult with the department or agency head to discuss the financial and practical responsibilities of its upkeep.
 - i. Works of art loaned to the City for temporary exhibition (up to one year) and gifts of state shall not be subject to the review process outlined above.
6. All donations shall become City property upon formal acceptance by the City Council or appropriate City department.

HISTORY:

Adopted by Resolution R-178999 02/18/1964
Amended by Resolution R-216051 05/26/1976
Amended by Resolution R-223033 03/12/1979
Amended by Resolution R-283002 11/15/1993
Amended by Resolution R-284389 08/01/1994

BPC Presentation
March 1, 2018
(November 2, 2017)
Balboa Statue

Balboa Park History by Richard Amero

- <http://www.balboaparkhistory.net/>
- On July 9, 1909, G. Aubrey Davidson, founder of the Southern Trust and Commerce Bank and president of the San Diego Chamber of Commerce, said San Diego should stage an exposition in 1915 to celebrate the completion of the Panama Canal.

Balboa Park History by Richard Amero

- Davidson told his fellow Chamber of Commerce members that San Diego would be the first American port-of-call north of the Panama Canal on the Pacific coast. An exposition would call attention to the city and bolster an economy still shaky from the Wall Street Panic of 1907. The Chamber of Commerce authorized Davidson to appoint a committee to look into his idea.(1)

Balboa Park History by Richard Amero

- On September 3, 1909, a special Chamber of Commerce committee formed the Panama-California Exposition Company and sent articles of incorporation to the Secretary of State in Sacramento.(3)

Balboa Park History by Richard Amero

- In 1910 San Diego had a population of 39,578, San Diego County 81,665. San Diego's scant population, the smallest of any city ever to attempt holding an international exposition, testified to the city's pluck and vitality.(4)

Balboa Park History by Richard Amero

- The name City Park was too lackluster to serve as the name for the site of the Panama-California Exposition. Accordingly, on October 27, 1910, park commissioners Thomas O'Hallaran, Moses A. Luce and Leroy A. Wright, at a meeting with exposition representatives George W. Marston, Howard M. Kutchin and D. C. Collier chose the name "Balboa Park" for San Diego's pleasure ground.(40)

Balboa Park History by Richard Amero

- On November 1, the Park Commissioners adopted the name.(41) The California State Legislature ratified their decision, March 24, 1911, in the same piece of legislation which authorized the use of the park for an exposition.(42)

Balboa Park History by Richard Amero

- The name Balboa seemed appropriate since Vasco Nuñez de Balboa was the first European in the New World to see the Pacific Ocean, whose waters would soon be joined with the Atlantic's upon the completion of the Panama Canal, an event the Exposition was to commemorate

The third day of the celebration (of Carnival Cabrillo from September 24 to 27, 1913) was named "Balboa" in honor of Vasco Nuñez de Balboa, the first European to see the Pacific Ocean, and as an acknowledgment of the Panama-California Exposition which was to be held in Balboa Park, San Diego, beginning January 1, 1915. Citizens were to erect a monument to Balboa costing \$15,000 at the east end of El Prado that would be surrounded by a semicircle of columns. Believing that mentioning the sum needed would produce the reality, promoters of the monument considered it unnecessary to specify a source.(79)

The San Diego Union, September 26, 1913.

Original Park Planners' Intention:

- “Citizens were to erect a monument to Balboa costing \$15,000 at the East end of El Prado that would be surrounded by a semicircle of columns.”

House of Spain

- House of Spain is asking for your support on this project so that the original intent of the early founders of Balboa Park can be completed. To have a statue of the person that carries his name and for whom the Park was renamed in 1910 is finally implemented.
-



Bea Evenson Fountain







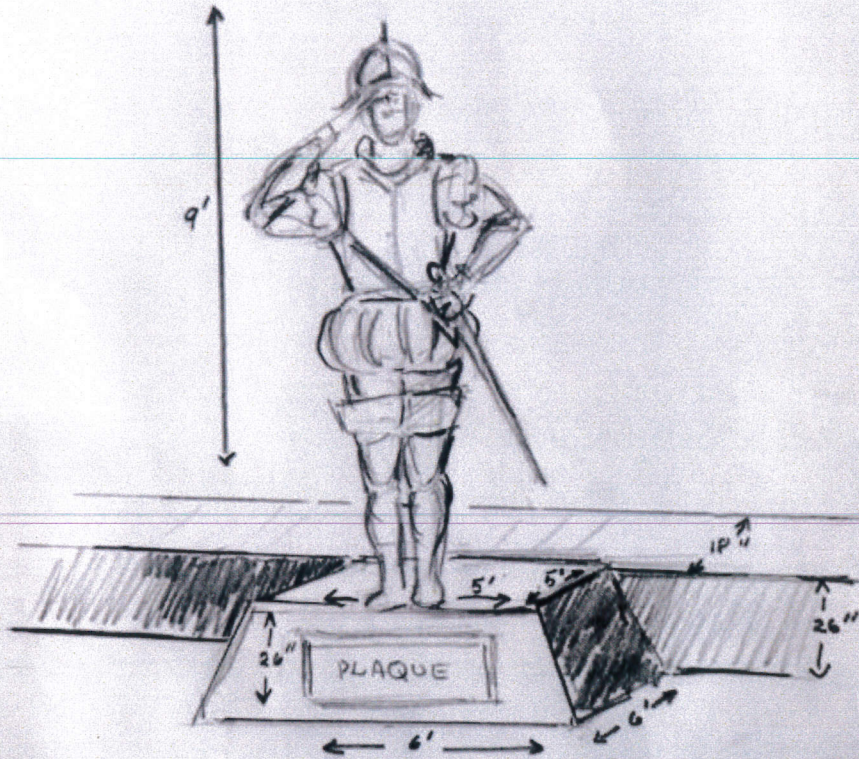

Galban
Historical
Sculpture
2016

AJ

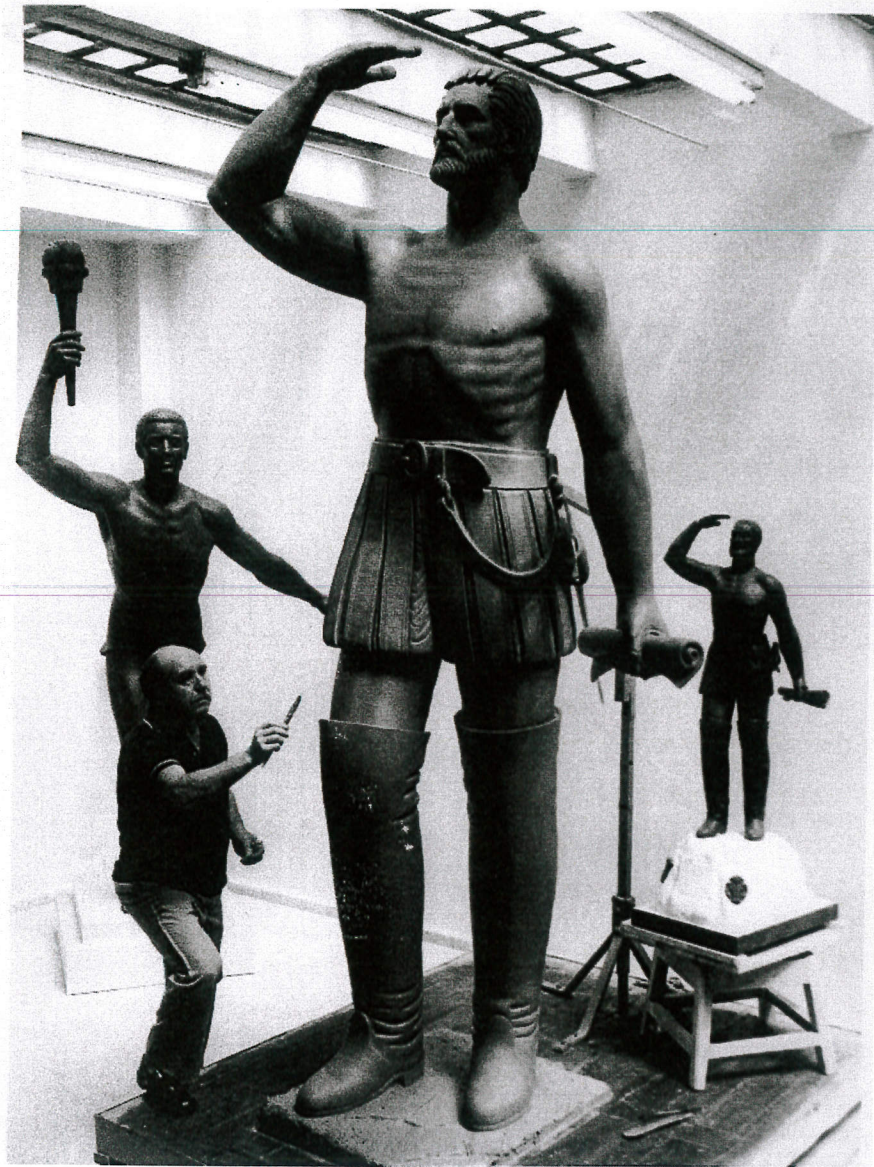











Plaza de Balboa



Plaza de Balboa



Vasco Nuñez de Balboa – 1475 – 1519

First European to discover the Pacific Ocean on September 29, 1513. City Park was renamed Balboa Park in his honor in 1910.

Balboa led 190 Spaniards and 1,000 native porters and guides, along with his dog Leoncico, through the jungles and mountains of Panama to plant the flag of Spain on the shore of the Pacific Ocean.

Pedestal

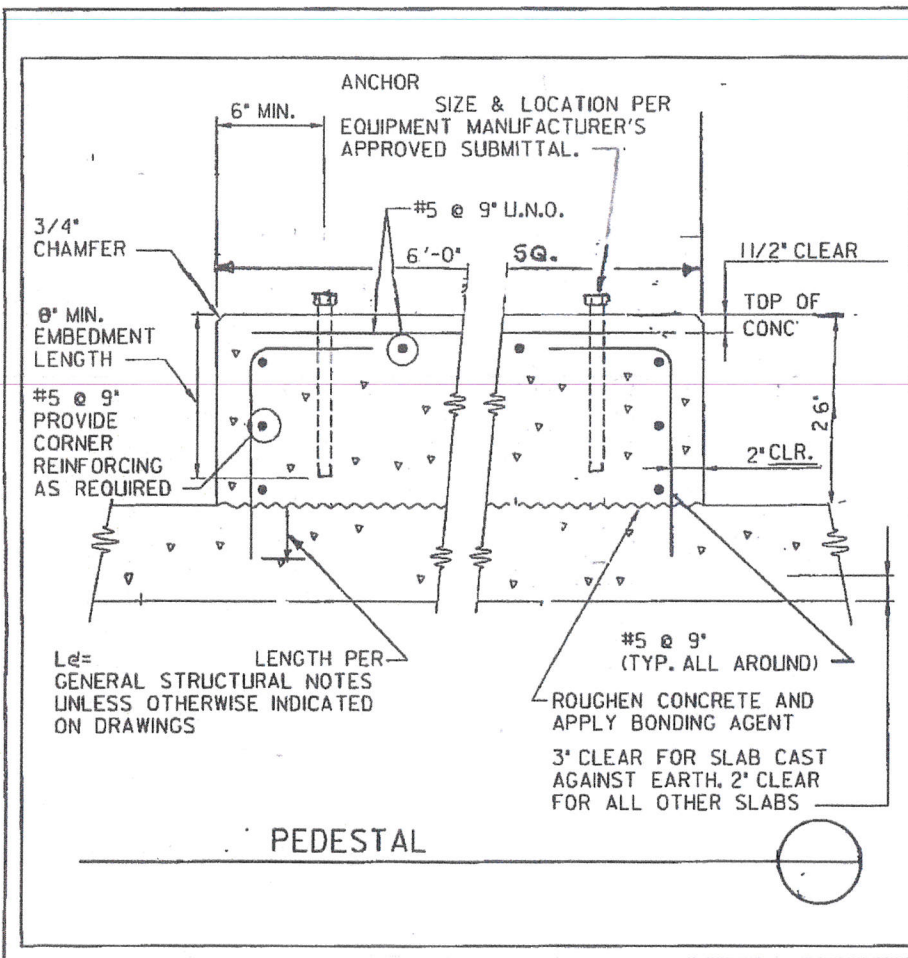

REGISTERED CIVIL ENGINEER DATE

PLANS APPROVAL DATE

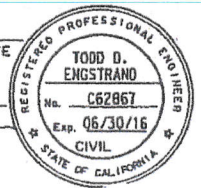

Balboa Park		
Vasco Nunez de Balboa Statue PEDESTAL		
DRWN BY: TE	APPROVED	DWG. NO.
DATE: 3/23/16		

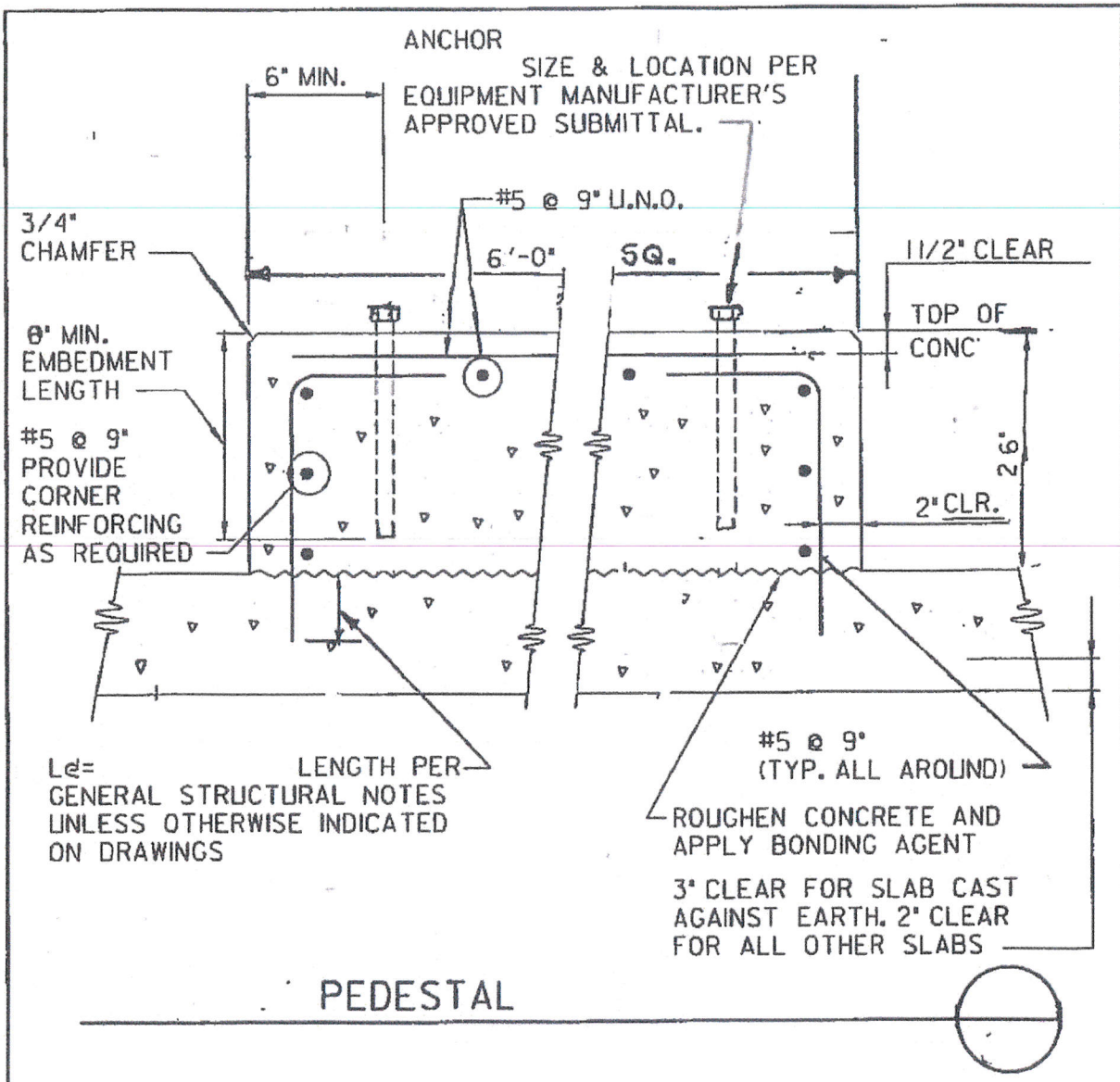

Quote from Armando Hinojosa

- Balboa/dog statue 1 1/2 life size.
- Approximately 8.5 to 9 feet tall.
- Approximately 2.5 to 3.5 feet wide.
- Approximately 1.5 to 2.5 feet in depth.
- Includes 3 X 2 feet plaque
- Total cost of around \$325K
- The approximate weight will be around 1000lbs.
- Highest quality bronze (95% copper, 4% silicon, 1% manganese)

Questions?
