

# CHILDREN'S PARK PUBLIC ART

## ARTWORK DESIGN

### BY MIKI IWASAKI



# Commission for Arts and Culture

Artist Miki Iwasaki has been commissioned by the City of San Diego to create a site-specific artwork for Children's Park, a project to improve and redevelop the existing park in downtown San Diego. The artist spent several months learning about the site, engaging with the public, and working with the park's design team to develop his artwork proposal.

The proposed artwork, titled *Petrichor*, is a sculptural installation consisting of multiple three-dimensional, interlocking abstract forms that 'float' above the ground in a cloud-like shape. The artwork, which will extend approximately 16 feet wide and 28 feet across, will be constructed with steel tubes that form faceted geometric shapes. The steel will be painted white which will allow ambient light conditions to vividly interact with the artwork.

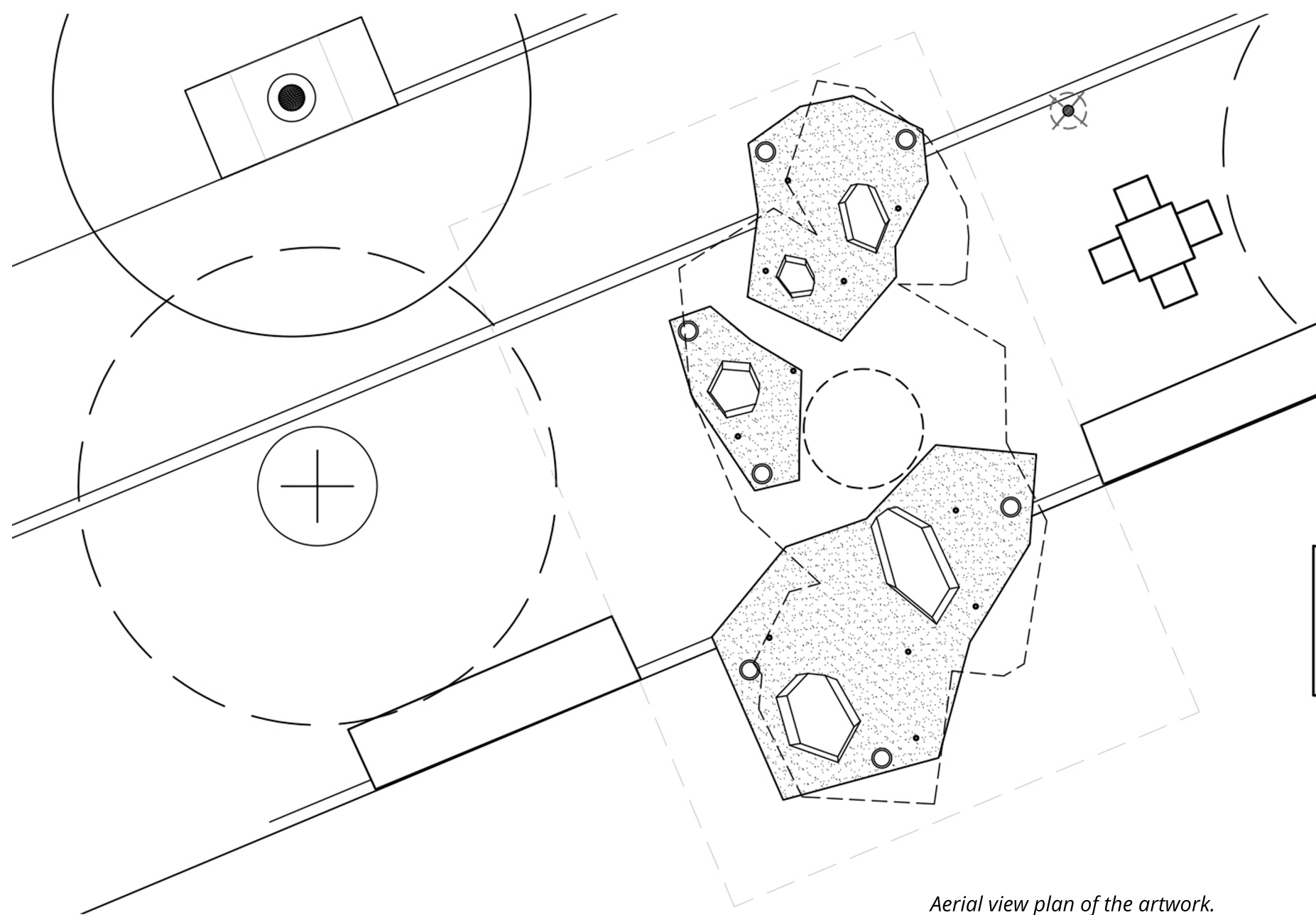

*Aerial view plan of the artwork.*

The viewer's perception of the artwork will shift based on lighting conditions, proximity, and perspective, offering a different experience with the artwork upon each visit. The geometric forms may alternately appear as solid objects or translucent screens, in addition to creating lively shadow play on adjacent surfaces.

The vertical steel supports holding up the cloud-like form will direct the viewer's gaze upward into the artwork. The surrounding groundcover and hardscape will be designed as a continuation of the cloud and can be interpreted as landforms or bodies of water.

Lighting will illuminate the artwork, creating a strong evening presence. This will allow the artwork to be visible from multiple vantage points within and beyond the park boundaries, serving as a symbolic beacon in the park.

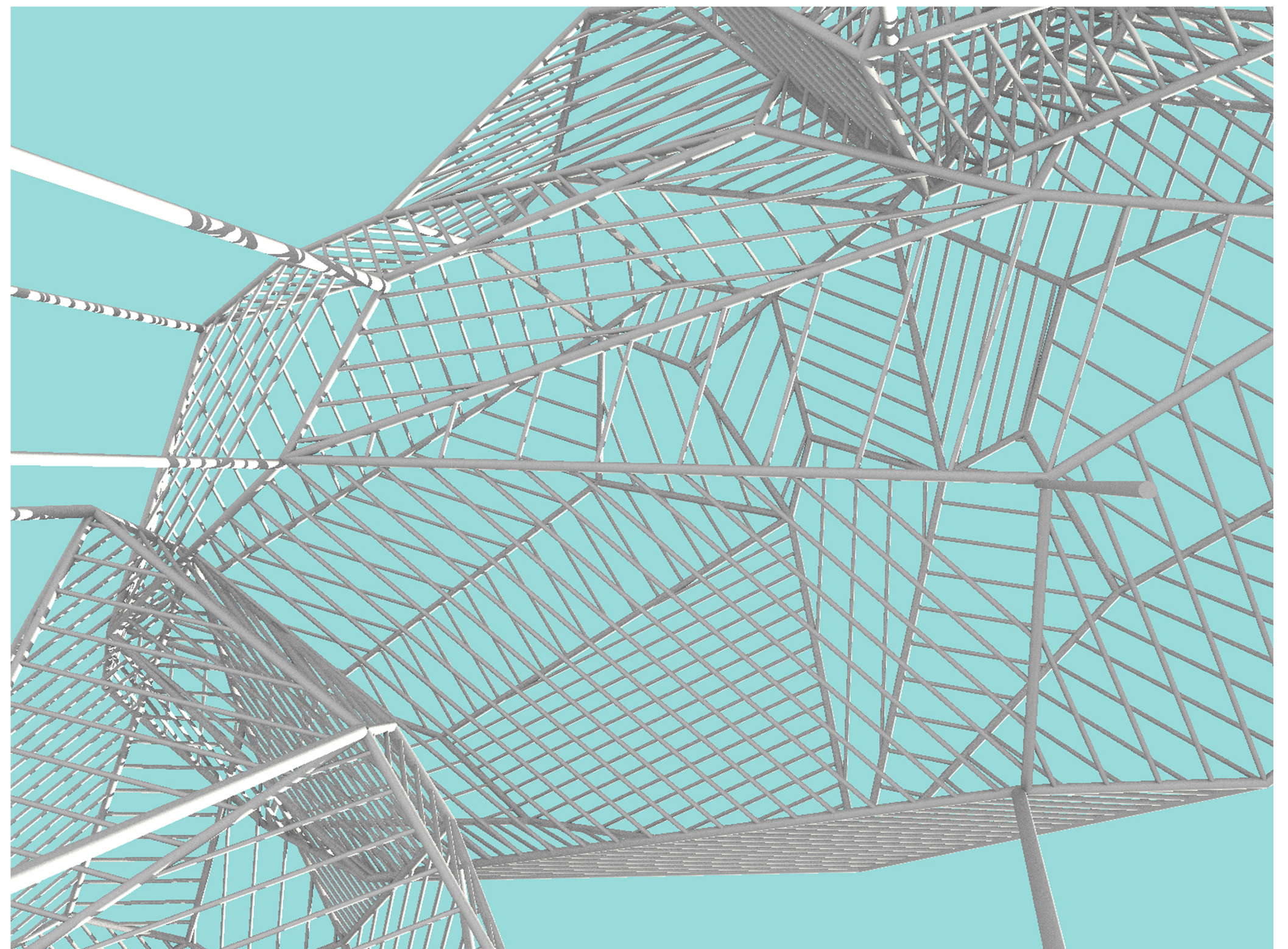

*Artist rendering of the artwork as seen from below.*

The artwork will be positioned centrally within the park to allow for individual experiences and will be integrated into the overall park design.

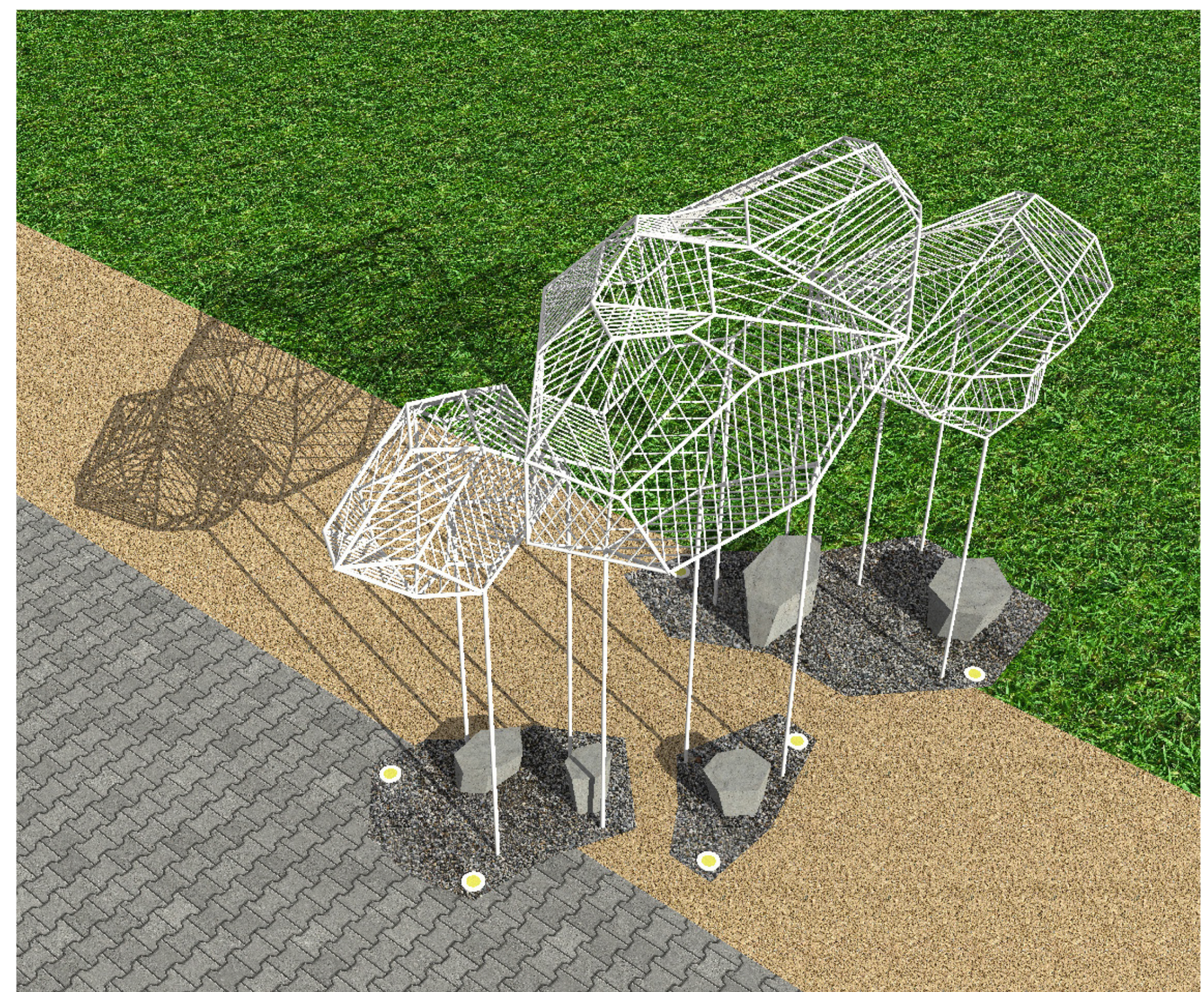

*Artist rendering of the artwork.*

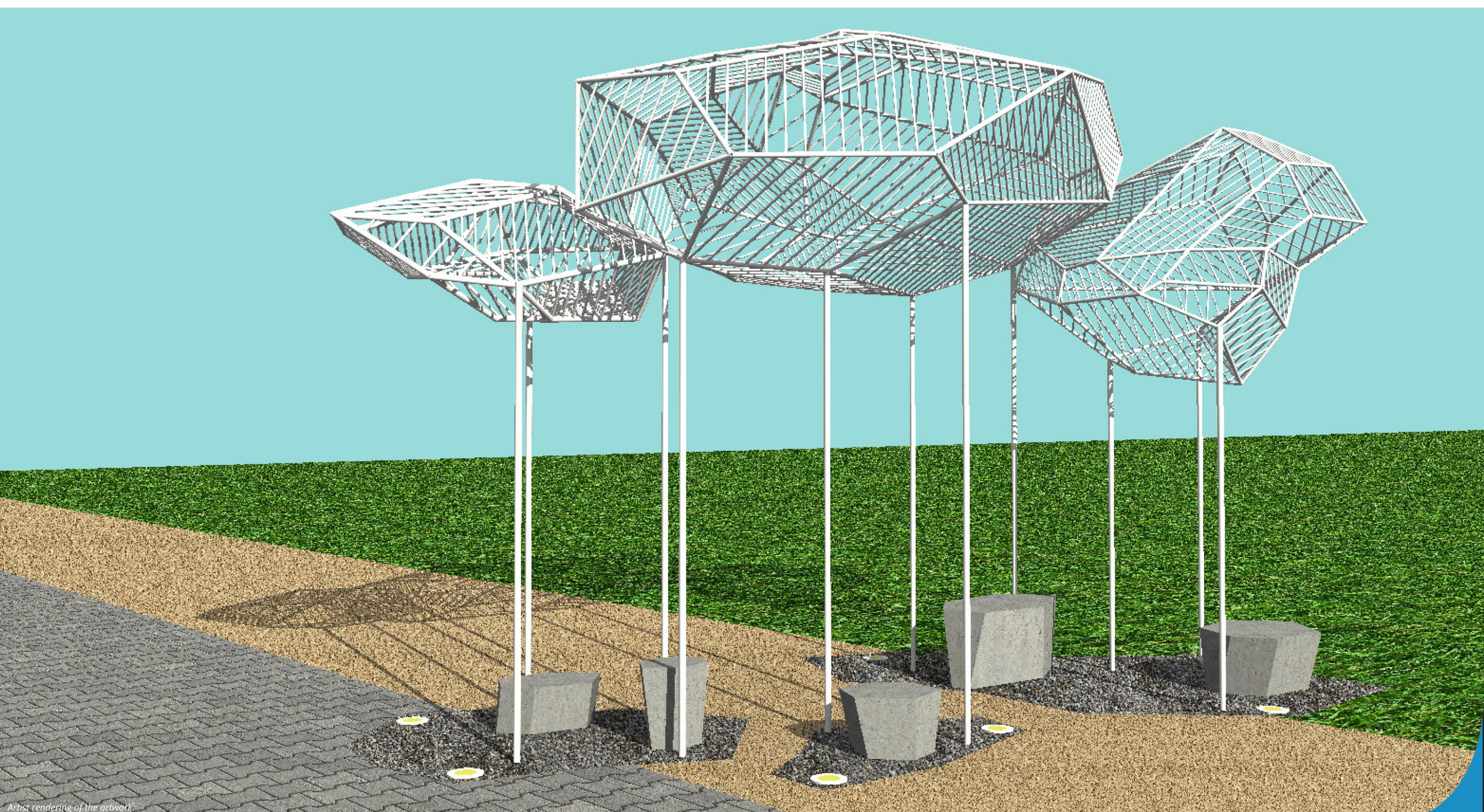

*Artist rendering of the artwork.*