



THE CITY OF SAN DIEGO



# ANNUAL REPORT for Fiscal Year 2019

## CORAL GATE MAINTENANCE ASSESSMENT DISTRICT

under the provisions of the

**San Diego Maintenance Assessment District Procedural Ordinance  
of the San Diego Municipal Code**

**Prepared For  
City of San Diego, California**



**Prepared By**  
**EFS Engineering, Inc.**  
P.O. Box 22370  
San Diego, CA 92192-2370  
(858) 752-3490

**May 2018**

# **CITY OF SAN DIEGO**

## **Mayor**

Kevin Faulconer

## **City Council Members**

Barbara Bry  
District 1 (Council President Pro Tem)

Lorie Zapf  
District 2

Chris Ward  
District 3

Myrtle Cole  
District 4 (Council President)

Mark Kersey  
District 5

Chris Cate  
District 6

Scott Sherman  
District 7

David Alvarez  
District 8

Georgette Gómez  
District 9

## **City Attorney**

Mara W. Elliott

## **Chief Operating Officer**

Kris Michell

## **City Clerk**

Elizabeth Maland

## **Independent Budget Analyst**

Andrea Tevlin

## **City Engineer**

James Nagelvoort

# Table of Contents

---

Annual Report for Fiscal Year 2019  
Coral Gate Maintenance Assessment District

Preamble.....	1
Executive Summary .....	2
Background .....	3
District Boundary .....	3
Project Description.....	4
Separation of General and Special Benefits.....	4
Cost Estimate.....	4
Annual Cost-Indexing .....	5
Method of Apportionment.....	5
Estimated Benefit of Improvements.....	5
Apportionment Methodology .....	5
Land Use Factor .....	6
Benefit Factor .....	7
Sample Calculations .....	9
Summary Results.....	10

## **EXHIBITS**

**Exhibit A:** District Boundary

**Exhibit B:** Estimated Budget – Revenue & Expense Statement  
for Fiscal Year 2019

**Exhibit C:** Preliminary Assessment Roll for Fiscal Year 2019

# Annual Report for Fiscal Year 2019

## Coral Gate

### Maintenance Assessment District

---

#### Preamble

Pursuant to §65.0220 of the “San Diego Maintenance Assessment District Procedural Ordinance” (being Division 2, Article 5, Chapter 6 of the *San Diego Municipal Code*) and City of San Diego Council Resolution No. R-310618 passed on July 22, 2016, authorizing the continued levy of assessments for the life of the CORAL GATE MAINTENANCE ASSESSMENT DISTRICT (hereinafter referred to as “District”), and in accordance with applicable provisions of “Proposition 218” (being Article XIID of the California Constitution), and provisions of the “Proposition 218 Omnibus Implementation Act” (being California Senate Bill 919) (the aforementioned provisions are hereinafter referred to collectively as “applicable law”), and in accordance with Resolution No. \_\_\_\_\_, adopted by the CITY COUNCIL OF THE CITY OF SAN DIEGO, COUNTY OF SAN DIEGO, STATE OF CALIFORNIA, and in connection with the annual proceedings for the District, EFS Engineering, Inc., as Assessment Engineer to the City of San Diego, submits herewith this annual report for the District as required by §65.0220 of the “San Diego Maintenance Assessment District Procedural Ordinance.”

DATE OF FINAL PASSAGE BY THE CITY OF SAN DIEGO,  
COUNTY OF SAN DIEGO, STATE OF CALIFORNIA, ON THE  
\_\_\_\_\_ DAY OF \_\_\_\_\_, 2018.

---

Elizabeth Maland, CITY CLERK  
CITY OF SAN DIEGO  
STATE OF CALIFORNIA

## Executive Summary

**Project:** Coral Gate  
Maintenance Assessment District

**Apportionment Method:** Equivalent Benefit Unit (EBU)

	<b>FY 2018</b>	<b>FY 2019 <sup>(1)</sup></b>	<b>Maximum <sup>(2)</sup> Authorized</b>
<b>Total Parcels Assessed:</b>	506	506	--
<b>Total Estimated Assessment:</b>	\$89,547	\$92,016	--
<b>Total Number of EBUs:</b>	501.89	501.89	--
<b>Assessment per EBU:</b>	\$178.42	\$183.34	\$245.86 <sup>(3)</sup>

<sup>(1)</sup> FY 2019 is the City's Fiscal Year 2019, which begins July 1, 2018 and ends June 30, 2019. Total Parcels Assessed, Total Estimated Assessment, and assessment apportionment factors may vary from prior fiscal year values due to parcel changes and/or land use re-classifications.

<sup>(2)</sup> Maximum authorized assessment rate subject to cost-indexing as approved by property owners at the time of District formation.

<sup>(3)</sup> Prior fiscal year's maximum authorized annual assessment rate increased by cost-indexing factor of 2.76%.

**Annual Cost-Indexing:** The maximum authorized assessment rates are cost-indexed and will increase (or decrease) annually based on the annual change in the *San Diego Consumer Price Index for Urban Consumers* (SDCPI-U).

---

## Background

The Coral Gate Maintenance Assessment District (District), originally known as the “Coral Gate Landscape Maintenance District,” was established by the City of San Diego (City) on May 2, 1995 by City Council Resolution R-285686. The District was subsequently re-formed on March 31, 1998 by City Council Resolution R-289917 primarily for purposes of compliance with Proposition 218 and to permit future cost-indexing. The purpose of the District was, and still is, to fund specifically identified improvements and activities within the boundary of the District.

In conformity with §65.0221 of the “San Diego Maintenance Assessment District Procedural Ordinance,” the City adopted Resolution No. R-310618 on July 22, 2016, approving the annual budget and assessments for Fiscal Year 2017, and authorizing the levy of the assessments for the life of the District, consistent with the benefit findings and assessment apportionment method contained in the approved formational and all subsequently updated Engineer’s Reports (Engineer’s Reports). The Engineer’s Reports are on file with the City Clerk, and incorporated herein by reference.

The District is authorized and administered under the provisions of the “San Diego Maintenance Assessment District Procedural Ordinance.” This annual report has been prepared pursuant to the requirements of §65.0220 of the “San Diego Maintenance Assessment District Procedural Ordinance.”

---

## District Boundary

The District boundary is generally depicted in **Exhibit A**. The District Boundary Map and Assessment Diagram are on file in the Maintenance Assessment Districts section of the Parks and Recreation Department of the City, and, by reference, are made a part of this annual report.

---

## Project Description

The authorized assessments will be used to fund specifically identified improvements and activities within the District. The District improvements and activities generally consist of maintenance and servicing of parkway and slope landscaping along Camino de la Plaza, Sipes Lane and Bibler Drive; fences and walls along Camino de la Plaza; and re-vegetation and cowbird trapping stations in the open space areas in the District. The approximate location of the improvements is generally shown on **Exhibit A**.

For additional detail as to the location, type of improvements, and activities performed by the District, please refer to the maps, improvement plans, engineering drawings, maintenance specifications, the Engineer's Reports and other associated documents on file with the Maintenance Assessment Districts section of the Parks and Recreation Department of the City. These documents, collectively, are incorporated herein by reference and made part of this annual report.

---

## Separation of General and Special Benefits

The identified improvements and activities provide benefits to the parcels located within the District. These benefits are "special benefits" to the extent that they are above and beyond the City's standard level of service, and exclusive of those "general benefits" provided to the public at large or properties located outside the District. By law, only "special benefits" are assessable.

The assessments presented in this annual report are based on the cost of improvements and activities determined to provide "special benefits" in accordance with the Engineer's Reports. For additional detail relative to the separation and quantification of general and special benefits for the District, please refer to the Engineer's Reports, on file with the Maintenance Assessment Districts section of the Parks and Recreation Department of the City.

---

## Cost Estimate

The estimated annual budget (Revenue & Expense Statement) for Fiscal Year 2019 (July 1, 2018 to June 30, 2019 period) is included as **Exhibit B**. The "Other Contributions (Non Assessment Source)" revenue contained in the budget includes the value of improvements and activities determined to provide "general benefits." The District budget with full detail is available for public reference in the Maintenance Assessment Districts section of the Parks and Recreation Department of the City.

## Annual Cost-Indexing

The maximum authorized assessment set forth in the Engineer's Reports is permitted to increase annually based on the published change in the "San Diego Consumer Price Index for Urban Consumers" (SDCPI-U). The annual change in second half SDCPI-U values, as compiled by the *U.S. Bureau of Labor Statistics* (see [www.bls.gov](http://www.bls.gov)), for the prior year period was from 276.837 to 284.464 (a 2.76% increase). In accordance with the approved cost-indexing provisions, the maximum authorized assessment rates have been increased by 2.76%.

---

## Method of Apportionment

### Estimated Benefit of Improvements

The improvements and activities provided by this District are associated with the maintenance of parkway and slope landscaping along Camino de la Plaza, Sipes Lane and Bibler Drive; fences and walls along Camino de la Plaza; and revegetation and cowbird trapping stations in the open space areas within the District.

Camino de la Plaza, Sipes Lane and Bibler Drive are the only arterial streets within the District. They serve as the primary access routes for inter-community and intra-community trips and thus serve all parcels within the community. All parcels benefit from the enhancement of these streets and the enhanced community image provided by the District improvements and activities.

### Apportionment Methodology

The total cost associated with District improvement and activities will be assessed to the various parcels in the District in proportion to the estimated Equivalent Benefit Units (EBUs) assigned to each parcel in relationship to the total EBUs assigned to all the parcels in the District.

EBUs are a function of two factors, a Land Use Factor and a Benefit Factor, related as shown in the following equation.

$$\text{EBUs} = (\text{Acres or Units}) \times \text{Land Use Factor} \times \text{Benefit Factor}$$

Each of these factors is discussed below.



## Land Use Factor

Since the District improvements and activities are primarily associated with the Transportation Element of the General and Community Plans, trip generation rates for various land use categories (as previously established by the City’s Transportation Planning Section) have been used as the primary basis for the development of Land Use Factors. While these trip generation rates strictly address only vehicular trips, they are also considered to approximately reflect trip generation for other modes of transportation (e.g., pedestrian trips, bicycle trips, etc.) and are considered the best available information for these other transportation modes.

The special benefits of landscape improvements and activities are linked to trip generation primarily by the public safety and aesthetic enhancement enjoyed by travelers through the community. Thus trip generation rates provide the required nexus and basis for assigning ratios of maximum potential benefit to the various land use/zoning classifications as defined by the City’s Municipal Code.

Land use/zoning classifications have been grouped with averaged trip generation rates assigned to establish the Land Use Factors. Land Use Factors are summarized as shown in **Table 1**.

**TABLE 1: Land Use Factors**

<b>Land Use/Zoning</b>	<b>Code</b>	<b>Land Use Factor</b>
Residential – Single Family (detached)	SFD	1.0 per dwelling unit
Educational – Primary & Secondary	EPS	5.0 per acre
Open Space (designated)	OSP	0.0 per acre
Park – Developed	PKD	5.0 per acre
Street/Roadway	STR	0.0 per acre

Designated Open Space serves primarily to preserve natural landscape and habitat. While access for study and passive recreation is sometimes permitted, these activities are usually allowed only to the limited extent consistent with the primary purpose of natural preservation. Since this land is essentially “unused” in the customary terms of land use (which relate to human use, not use by nature), the trip generation rate is zero, therefore, the designated Open Space receives no benefit from the Transportation Element and has been assigned a Land Use Factor of zero.

While those traveling streets and roadways enjoy the District improvements and activities during their travel, the actual benefit of

this enjoyment accrues to the lands at the origins and destinations of their trips, not to the lands of the streets and roadways, themselves. Accordingly, Streets/Roadways receive no benefit and have been assigned a Land Use Factor of zero.

### Benefit Factor

The Land Use Factor described above reflects the relative intensity of use (or potential use) of the various parcels of land to be assessed. It does not address the relationship of this use to the specific District improvements and activities. This relationship is reflected in the Benefit Factor utilized in the assessment methodology.

In determining the Benefit Factor for each land use category, the sub-components of the benefits of District improvements and activities considered may include some or all of the following: public safety, view corridors and aesthetics, enhancement of community identity, drainage corridors, and recreational potential. As Benefit Factors and their sub-components are intended to reflect the particular relationships between specific land uses within a district and the specific District improvements and activities, Benefit Factors will generally vary from one district to another, based on the specific details of the applicable land uses and improvements and activities provided.

The applicable benefit sub-components and resultant composite Benefit Factors determined for the various land use/zoning categories within this District are summarized as shown in **Table 2**.

**TABLE 2: Benefit Factors by Land Use**

<b>Land Use/Zoning</b>	<b>Public Safety (max. 0.2)</b>	<b>Aesthetics (max. 0.8)</b>	<b>Composite Benefit Factor (max. 1.0)</b>
Residential – All	0.2	0.8	1.0
Educational – Primary & Secondary	0.2	0.4	0.6
Open Space (designated)	0.2	0.0	0.2
Park – Developed	0.2	0.0	0.2
Street/Roadway	0.2	0.0	0.2

### **Public Safety**

All land uses are considered to receive the maximum available benefit from the public safety element of District improvements and activities. Public safety is essential to all land uses, even to lands such as designated Open Space, held in stewardship with only incidental human use.

### **Aesthetics**

The degree of benefit received from the aesthetic qualities of landscaped roadway medians and rights-of-way maintained or provided by the District varies among land use categories. Generally, by nature of their use, residential lands receive the greatest benefit from the reduced traffic congestion, reduced noise levels, greater separation from traffic and generally more tranquil environment provided by landscaped roadway medians and rights-of-way. Commercial and institutional uses, on the other hand, often thrive on higher densities, greater traffic access, and a higher level of activity in the vicinity of their enterprises. These uses, accordingly, receive a lesser degree of benefit from the general insulation and separation provided by the aesthetic elements of District improvements and activities.

Lands in the Open Space and Street/Roadway categories are considered to receive no significant benefit from the aesthetic elements of District improvements and activities, as enhanced aesthetic quality of other lands in their vicinity does not affect their function, use, or value. Lands in the Park category are considered to receive no significant benefit from the aesthetic elements of District improvements and activities as the aesthetic values of these lands are themselves so high that they are little enhanced by those of other lands in their vicinity.

## Sample Calculations

As described above, the number of Equivalent Benefit Units (EBUs) assigned to each parcel in the District has been calculated based on each parcel's land use and the identified apportionment factors, as shown in the following equation:

$$\text{EBUs} = (\text{Acres or Units}) \times \text{Land Use Factor} \times \text{Benefit Factor}$$

Shown below are sample EBU calculations for several common land uses found in the District.

- **1 Single-Family Residence**

$$\text{EBUs} = 1 \text{ unit} \times 1.00 \times 1.00 = 1.00 \text{ EBUs}$$

- **5-acre Park with Recreation Center**

$$\text{EBUs} = 5.00 \text{ acres} \times 5.00 \times 0.20 = 5.00 \text{ EBUs}$$

The total assessment for each parcel in the District is based on the calculated EBUs for the parcel and the applicable unit assessment rate, as shown in the following equation:

$$\text{Total Assessment} = \text{Total EBUs} \times \text{Unit Assessment Rate}$$

Based on the above formula, the EBUs calculated for each property, can be found in the Assessment Roll (**Exhibit C**).

---

## Summary Results

The District Boundary is presented in **Exhibit A**.

An estimate of the annual costs of the improvements and activities provided by the District is included as **Exhibit B**.

The assessment methodology utilized is as described in the text of this annual report. Based on this methodology, Fiscal Year 2019 District assessment for each parcel were calculated and are shown in the Preliminary Assessment Roll (**Exhibit C**).

Each lot or parcel of land within the District has been identified by unique County Assessor's Parcel Number in the Preliminary Assessment Roll and on the Boundary Map and Assessment Diagram referenced herein.

This annual report has been prepared and respectfully submitted by:

EFS ENGINEERING, INC.



Eugene F. Shank, PE

C 52792

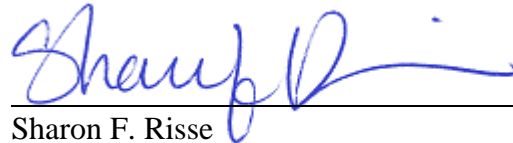

Sharon F. Risse

# EXHIBIT A



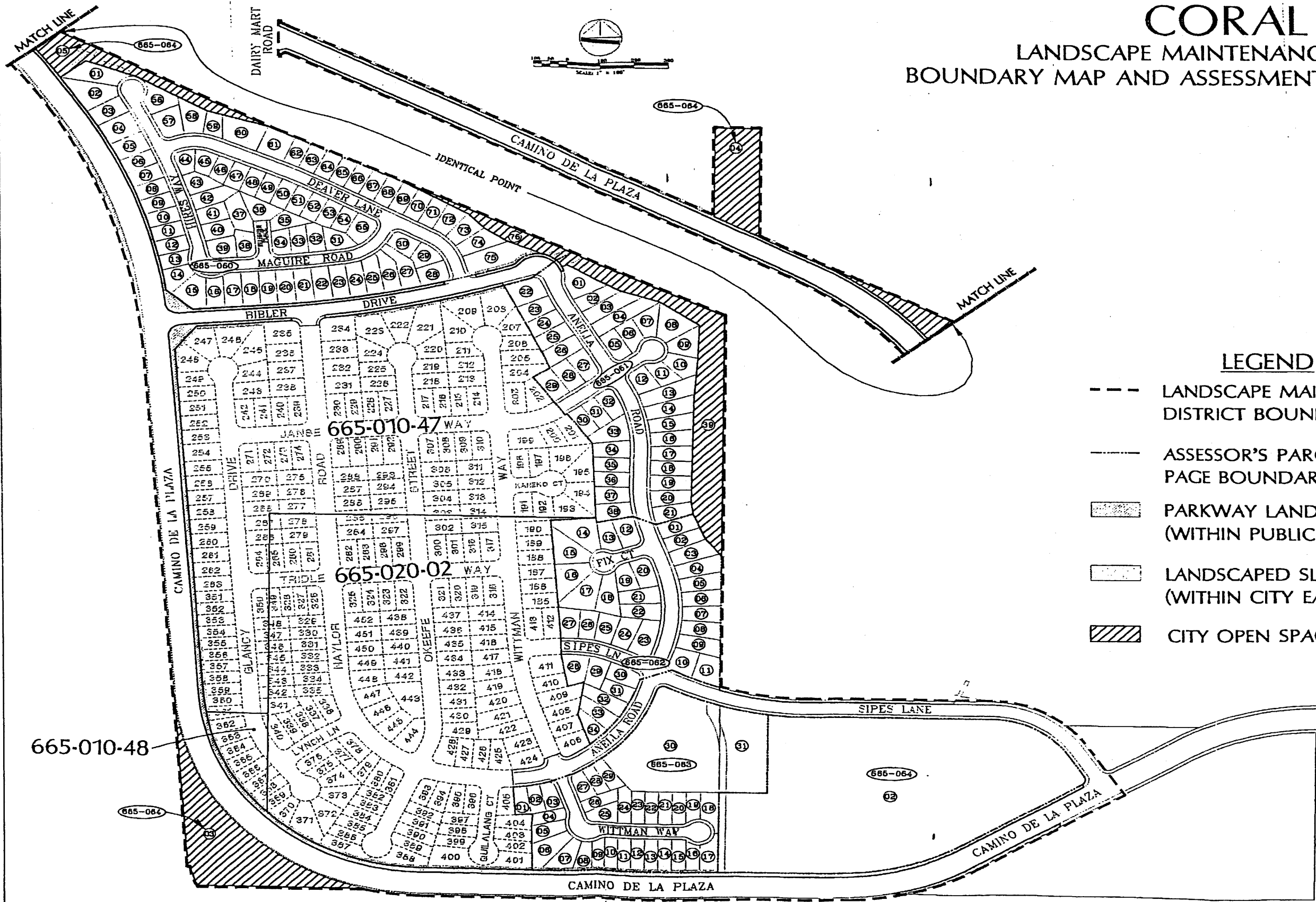

**District Boundary**

# CORAL GATE

LANDSCAPE MAINTENANCE DISTRICT  
BOUNDARY MAP AND ASSESSMENT DIAGRAM

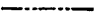

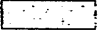
### LEGEND

-  LANDSCAPE MAINTENANCE DISTRICT BOUNDARY
-  ASSESSOR'S PARCEL MAP PAGE BOUNDARY
-  PARKWAY LANDSCAPE (WITHIN PUBLIC R.O.W.)
-  LANDSCAPED SLOPES (WITHIN CITY EASEMENTS)
-  CITY OPEN SPACE EASEMENT

665-010-48

665-010-47 WAY

665-020-02 WAY

665-064

665-064

665-063

665-064

CAMINO DE LA PLAZA

WILLOW ROAD

# EXHIBIT B

**Estimated Budget – Revenue & Expense Statement  
for Fiscal Year 2019**



# EXHIBIT B

## REVENUE AND EXPENSE STATEMENT

### Coral Gate Maintenance Assessment District Fund 200071

	<u>FY 2017 ACTUALS</u>	<u>FY 2018 ESTIMATE</u>	<u>FY 2019 PROPOSED</u>
<b>BEGINNING FUND BALANCE</b>			
Surplus (or Deficit) from Prior Year	\$ 139,953.51	\$ 127,591.00	\$ 116,697.00
<b>TOTAL BEGINNING FUND BALANCE</b>	<b>\$ 139,953.51</b>	<b>\$ 127,591.00</b>	<b>\$ 116,697.00</b>
<b>REVENUE</b>			
Assessment Revenue	\$ 87,842.81	\$ 89,547.00	\$ 92,016.50
Interest	\$ 1,215.99	\$ 1,100.00	\$ 700.00
Other Contributions (Non Assessment Source)	\$ 13,371.27	\$ 17,373.00	\$ 20,052.00
<b>TOTAL REVENUE</b>	<b>\$ 102,430.07</b>	<b>\$ 108,020.00</b>	<b>\$ 112,768.50</b>
<b>TOTAL BEGINNING FUND BALANCE &amp; REVENUE</b>	<b>\$ 242,383.58</b>	<b>\$ 235,611.00</b>	<b>\$ 229,465.50</b>
<b>OPERATING EXPENSE</b>			
Landscaping Improvements and Activities <sup>(1)</sup>	\$ 81,891.46	\$ 81,334.00	\$ 105,619.00
Tree Services	\$ 10,363.70	\$ 15,000.00	\$ 15,000.00
Special Districts Administration Cost	\$ 22,537.00	\$ 22,580.00	\$ 23,774.00
<b>TOTAL OPERATING EXPENSE</b>	<b>\$ 114,792.16</b>	<b>\$ 118,914.00</b>	<b>\$ 144,393.00</b>
<b>TOTAL EXPENSE</b>	<b>\$ 114,792.16</b>	<b>\$ 118,914.00</b>	<b>\$ 144,393.00</b>
<b>TOTAL ENDING FUND BALANCE</b>	<b>\$ 127,591.42</b>	<b>\$ 116,697.00</b>	<b>\$ 85,072.50</b>
<b>NET ANNUAL REVENUE (OR EXPENSE)</b>	<b>\$ (12,362.09)</b>	<b>\$ (10,894.00)</b>	<b>\$ (31,624.50)</b>

<sup>(1)</sup> Includes related supplies and utility costs.

*The District budget with full detail is available for public reference in the Maintenance Assessment Districts section of the Parks and Recreation Department of the City of San Diego.*

# EXHIBIT C

**Preliminary Assessment Roll  
for Fiscal Year 2019**

# EXHIBIT C - Assessment Roll (Fiscal Year 2019)

## Coral Gate Maintenance Assessment District

Parcel Number	Acres/ Units <sup>(1)</sup>	Land Use <sup>(2)</sup>	Assessment Factors		Total EBU's	Unit Cost (\$/EBU)	FY 2019 <sup>(4)</sup> Assessment	Owner Name
			Land Use <sup>(2)</sup>	Benefit <sup>(3)</sup>				
665 060 01 00	1.00	SFD	1.00	1.00	1.00	\$183.34	\$183.34	Landa Aldegundo&Valdez Adriana
665 060 02 00	1.00	SFD	1.00	1.00	1.00	\$183.34	\$183.34	Alvarado Francisco A&Arevalo Yadira
665 060 03 00	1.00	SFD	1.00	1.00	1.00	\$183.34	\$183.34	Mosqueda Victor A
665 060 04 00	1.00	SFD	1.00	1.00	1.00	\$183.34	\$183.34	Tuazon Regino Y&Marilou G Revocable 2013 Trust
665 060 05 00	1.00	SFD	1.00	1.00	1.00	\$183.34	\$183.34	Lane Gary L
665 060 06 00	1.00	SFD	1.00	1.00	1.00	\$183.34	\$183.34	Mcinnis Rogelio A Jr&Lisette D
665 060 07 00	1.00	SFD	1.00	1.00	1.00	\$183.34	\$183.34	Ochoa Ramona
665 060 08 00	1.00	SFD	1.00	1.00	1.00	\$183.34	\$183.34	Salinas Hector E
665 060 09 00	1.00	SFD	1.00	1.00	1.00	\$183.34	\$183.34	Silva Martha L
665 060 10 00	1.00	SFD	1.00	1.00	1.00	\$183.34	\$183.34	Lopez Violeta G
665 060 11 00	1.00	SFD	1.00	1.00	1.00	\$183.34	\$183.34	Martinez Fredy F&Luz M
665 060 12 00	1.00	SFD	1.00	1.00	1.00	\$183.34	\$183.34	Burrola Waldo O&Basilisa M
665 060 13 00	1.00	SFD	1.00	1.00	1.00	\$183.34	\$183.34	Godoy Claudia C
665 060 14 00	1.00	SFD	1.00	1.00	1.00	\$183.34	\$183.34	Delacruz Maria G G
665 060 15 00	1.00	SFD	1.00	1.00	1.00	\$183.34	\$183.34	Nobleza Arlyn J Living Trust 09-21-11
665 060 16 00	1.00	SFD	1.00	1.00	1.00	\$183.34	\$183.34	Garcia Carlos&Jessica A
665 060 17 00	1.00	SFD	1.00	1.00	1.00	\$183.34	\$183.34	Pena Ignacio Jr
665 060 18 00	1.00	SFD	1.00	1.00	1.00	\$183.34	\$183.34	Lair Donald B&Victoria M
665 060 19 00	1.00	SFD	1.00	1.00	1.00	\$183.34	\$183.34	Villasenor Jorge A&Leticia
665 060 20 00	1.00	SFD	1.00	1.00	1.00	\$183.34	\$183.34	Partida Salvador H&Ramirez Griselda
665 060 21 00	1.00	SFD	1.00	1.00	1.00	\$183.34	\$183.34	Campos Roberto&Armida N Family Living Trust 05-
665 060 22 00	1.00	SFD	1.00	1.00	1.00	\$183.34	\$183.34	Mehta Rajesh P
665 060 23 00	1.00	SFD	1.00	1.00	1.00	\$183.34	\$183.34	Morales Jonathan&Maria G
665 060 24 00	1.00	SFD	1.00	1.00	1.00	\$183.34	\$183.34	Armenta Corina
665 060 25 00	1.00	SFD	1.00	1.00	1.00	\$183.34	\$183.34	Aceves Bonifacio&Irma
665 060 26 00	1.00	SFD	1.00	1.00	1.00	\$183.34	\$183.34	Andrade Esteban E&Margarita C
665 060 27 00	1.00	SFD	1.00	1.00	1.00	\$183.34	\$183.34	Boeger Richard S&Gundler Tiffany R
665 060 28 00	1.00	SFD	1.00	1.00	1.00	\$183.34	\$183.34	Delcampo Alejandro E M&Josefina M
665 060 29 00	1.00	SFD	1.00	1.00	1.00	\$183.34	\$183.34	Sanchez Jesus H&Alma D
665 060 30 00	1.00	SFD	1.00	1.00	1.00	\$183.34	\$183.34	Fitch Randy A&Rivera Rebeca L
665 060 31 00	1.00	SFD	1.00	1.00	1.00	\$183.34	\$183.34	Ruvalcaba Mario G&Edith Family Trust 11-14-93
665 060 32 00	1.00	SFD	1.00	1.00	1.00	\$183.34	\$183.34	Cisneros Jesus&Sandra
665 060 33 00	1.00	SFD	1.00	1.00	1.00	\$183.34	\$183.34	Ibarra Angel T&Laura
665 060 34 00	1.00	SFD	1.00	1.00	1.00	\$183.34	\$183.34	Melendez Luis A&Leon Blanca E C
665 060 35 00	1.00	SFD	1.00	1.00	1.00	\$183.34	\$183.34	Reid Harold W&Vanessa T
665 060 36 00	1.00	SFD	1.00	1.00	1.00	\$183.34	\$183.34	Bobadilla Teresita
665 060 37 00	1.00	SFD	1.00	1.00	1.00	\$183.34	\$183.34	Lopez Jose L&Carmen Y
665 060 38 00	1.00	SFD	1.00	1.00	1.00	\$183.34	\$183.34	Aragon James P&Susie A
665 060 39 00	1.00	SFD	1.00	1.00	1.00	\$183.34	\$183.34	Perez Jesus
665 060 40 00	1.00	SFD	1.00	1.00	1.00	\$183.34	\$183.34	Llamas Jose L
665 060 41 00	1.00	SFD	1.00	1.00	1.00	\$183.34	\$183.34	Baquedano Carlos E
665 060 42 00	1.00	SFD	1.00	1.00	1.00	\$183.34	\$183.34	Baez Gabriel M&Mayorquin Rosa
665 060 43 00	1.00	SFD	1.00	1.00	1.00	\$183.34	\$183.34	Casillas Miguel&Virginia R
665 060 44 00	1.00	SFD	1.00	1.00	1.00	\$183.34	\$183.34	Concha Luis A R&Gomez Maria C
665 060 45 00	1.00	SFD	1.00	1.00	1.00	\$183.34	\$183.34	Arevalo Jose&Lilia
665 060 46 00	1.00	SFD	1.00	1.00	1.00	\$183.34	\$183.34	Sanchez Javier C&Carmen V
665 060 47 00	1.00	SFD	1.00	1.00	1.00	\$183.34	\$183.34	Babadilla Joselito S&Susan T
665 060 48 00	1.00	SFD	1.00	1.00	1.00	\$183.34	\$183.34	Paez Luis A
665 060 49 00	1.00	SFD	1.00	1.00	1.00	\$183.34	\$183.34	Fulgencio Jose L&Clara
665 060 50 00	1.00	SFD	1.00	1.00	1.00	\$183.34	\$183.34	Gutierrez Gerardo&Elizabeth
665 060 51 00	1.00	SFD	1.00	1.00	1.00	\$183.34	\$183.34	Raygoza Luis
665 060 52 00	1.00	SFD	1.00	1.00	1.00	\$183.34	\$183.34	Perez Alfredo&Concepcion H
665 060 53 00	1.00	SFD	1.00	1.00	1.00	\$183.34	\$183.34	Montano Tony&Elvia Trust 12-05-17

# EXHIBIT C - Assessment Roll (Fiscal Year 2019)

## Coral Gate Maintenance Assessment District

Parcel Number	Acres/ Units <sup>(1)</sup>	Land Use <sup>(2)</sup>	Assessment Factors		Total EBU's	Unit Cost (\$/EBU)	FY 2019 <sup>(4)</sup> Assessment	Owner Name
			Land Use <sup>(2)</sup>	Benefit <sup>(3)</sup>				
665 060 54 00	1.00	SFD	1.00	1.00	1.00	\$183.34	\$183.34	Ortiz Arturo&Velia
665 060 55 00	1.00	SFD	1.00	1.00	1.00	\$183.34	\$183.34	Aguirre Ricardo&Patricia
665 060 56 00	1.00	SFD	1.00	1.00	1.00	\$183.34	\$183.34	Sanchez Luis G&Bibiana
665 060 57 00	1.00	SFD	1.00	1.00	1.00	\$183.34	\$183.34	Ron Alicia
665 060 58 00	1.00	SFD	1.00	1.00	1.00	\$183.34	\$183.34	Lafarga Alma R
665 060 59 00	1.00	SFD	1.00	1.00	1.00	\$183.34	\$183.34	Soto Marc A&Ascencio Carolina
665 060 60 00	1.00	SFD	1.00	1.00	1.00	\$183.34	\$183.34	K 9 Trust 09-05-16
665 060 61 00	1.00	SFD	1.00	1.00	1.00	\$183.34	\$183.34	Mccarville James K&Johnson Tamara N
665 060 62 00	1.00	SFD	1.00	1.00	1.00	\$183.34	\$183.34	Sanchez Rafael&Alvarez Susana Living Trust 04-29
665 060 63 00	1.00	SFD	1.00	1.00	1.00	\$183.34	\$183.34	Sosa Guadalupe
665 060 64 00	1.00	SFD	1.00	1.00	1.00	\$183.34	\$183.34	Garcia Hector M&Altigracia V
665 060 65 00	1.00	SFD	1.00	1.00	1.00	\$183.34	\$183.34	Lee Coi S
665 060 66 00	1.00	SFD	1.00	1.00	1.00	\$183.34	\$183.34	Mckinney Norma L
665 060 67 00	1.00	SFD	1.00	1.00	1.00	\$183.34	\$183.34	Limon Richard A&Monica C
665 060 68 00	1.00	SFD	1.00	1.00	1.00	\$183.34	\$183.34	Perez Hugo
665 060 69 00	1.00	SFD	1.00	1.00	1.00	\$183.34	\$183.34	Valvekens Frank J&Audrey O
665 060 70 00	1.00	SFD	1.00	1.00	1.00	\$183.34	\$183.34	Aguirre Ricardo
665 060 71 00	1.00	SFD	1.00	1.00	1.00	\$183.34	\$183.34	Rosales Alejandro
665 060 72 00	1.00	SFD	1.00	1.00	1.00	\$183.34	\$183.34	Perez Frances E
665 060 73 00	1.00	SFD	1.00	1.00	1.00	\$183.34	\$183.34	Rios Sergio&Gonzalez Irma
665 060 74 00	1.00	SFD	1.00	1.00	1.00	\$183.34	\$183.34	Lira Francisco
665 060 75 00	1.00	SFD	1.00	1.00	1.00	\$183.34	\$183.34	Syarto Alma B
665 060 76 00	0.33	OSP	0.00	0.20	0.00	\$183.34	\$0.00	C G S D Associates L P
665 061 01 00	1.00	SFD	1.00	1.00	1.00	\$183.34	\$183.34	Ramos Carlos&Maria
665 061 02 00	1.00	SFD	1.00	1.00	1.00	\$183.34	\$183.34	Arrona Barbara E
665 061 03 00	1.00	SFD	1.00	1.00	1.00	\$183.34	\$183.34	Pena Salvador Jr&Lourdes A
665 061 04 00	1.00	SFD	1.00	1.00	1.00	\$183.34	\$183.34	Sandoval Eliseo R&Lourdes L
665 061 05 00	1.00	SFD	1.00	1.00	1.00	\$183.34	\$183.34	Aguilar Hector L
665 061 06 00	1.00	SFD	1.00	1.00	1.00	\$183.34	\$183.34	Ventura Adriana
665 061 07 00	1.00	SFD	1.00	1.00	1.00	\$183.34	\$183.34	Hogan Kevin J&Maila M
665 061 08 00	1.00	SFD	1.00	1.00	1.00	\$183.34	\$183.34	Tovar Gerardo R
665 061 09 00	1.00	SFD	1.00	1.00	1.00	\$183.34	\$183.34	Macklem Ricardo
665 061 10 00	1.00	SFD	1.00	1.00	1.00	\$183.34	\$183.34	Vazquez Arturo&Elizabeth S
665 061 11 00	1.00	SFD	1.00	1.00	1.00	\$183.34	\$183.34	Espinoza Rafael&Meinert Amy M
665 061 12 00	1.00	SFD	1.00	1.00	1.00	\$183.34	\$183.34	Silva Fernando A&Pena-Silva Grace
665 061 13 00	1.00	SFD	1.00	1.00	1.00	\$183.34	\$183.34	Francisco Sam
665 061 14 00	1.00	SFD	1.00	1.00	1.00	\$183.34	\$183.34	Perez Javier C Jr
665 061 15 00	1.00	SFD	1.00	1.00	1.00	\$183.34	\$183.34	Aranda Ulysses&Angelica
665 061 16 00	1.00	SFD	1.00	1.00	1.00	\$183.34	\$183.34	Santos Mario A&Sandra L
665 061 17 00	1.00	SFD	1.00	1.00	1.00	\$183.34	\$183.34	Ramirezsepulveda Raul&Vargas-Ramirez Belinda
665 061 18 00	1.00	SFD	1.00	1.00	1.00	\$183.34	\$183.34	Pena Felipe D&Virginia C 2012 Revocable Trust
665 061 19 00	1.00	SFD	1.00	1.00	1.00	\$183.34	\$183.34	Reyes Maria E
665 061 20 00	1.00	SFD	1.00	1.00	1.00	\$183.34	\$183.34	Lemos Robert A&Leticia
665 061 21 00	1.00	SFD	1.00	1.00	1.00	\$183.34	\$183.34	Morales Jorge L&Martha
665 061 22 00	1.00	SFD	1.00	1.00	1.00	\$183.34	\$183.34	Romero George&Hortencia
665 061 23 00	1.00	SFD	1.00	1.00	1.00	\$183.34	\$183.34	Enciso Cynthia M Living Trust
665 061 24 00	1.00	SFD	1.00	1.00	1.00	\$183.34	\$183.34	Thomas Carl M&Maria A
665 061 25 00	1.00	SFD	1.00	1.00	1.00	\$183.34	\$183.34	Rojo Samson P&Divinagracia D
665 061 26 00	1.00	SFD	1.00	1.00	1.00	\$183.34	\$183.34	Guardado Pedro Jr&Lucia D C S
665 061 27 00	1.00	SFD	1.00	1.00	1.00	\$183.34	\$183.34	Soltero Gerardo&Michel Olga M
665 061 28 00	1.00	SFD	1.00	1.00	1.00	\$183.34	\$183.34	Beltran Manuel T&Torres Marie D C
665 061 29 00	1.00	SFD	1.00	1.00	1.00	\$183.34	\$183.34	Becerra Humberto A
665 061 30 00	1.00	SFD	1.00	1.00	1.00	\$183.34	\$183.34	Rodriguez Jorge L&Maria R

# EXHIBIT C - Assessment Roll (Fiscal Year 2019)

## Coral Gate Maintenance Assessment District

Parcel Number	Acres/ Units <sup>(1)</sup>	Land Use <sup>(2)</sup>	Assessment Factors		Total EBU's	Unit Cost (\$/EBU)	FY 2019 <sup>(4)</sup> Assessment	Owner Name
			Land Use <sup>(2)</sup>	Benefit <sup>(3)</sup>				
665 061 31 00	1.00	SFD	1.00	1.00	1.00	\$183.34	\$183.34	Kelley Posadas Family 2002 Trust 01-24-02
665 061 32 00	1.00	SFD	1.00	1.00	1.00	\$183.34	\$183.34	Gamez Rene A
665 061 33 00	1.00	SFD	1.00	1.00	1.00	\$183.34	\$183.34	Klarich John&Virginia
665 061 34 00	1.00	SFD	1.00	1.00	1.00	\$183.34	\$183.34	Hernandez Jose&Karla D
665 061 35 00	1.00	SFD	1.00	1.00	1.00	\$183.34	\$183.34	Duenas Lucio D&Margarita
665 061 36 00	1.00	SFD	1.00	1.00	1.00	\$183.34	\$183.34	Lim Jose M&Lolita D Living Trust 04-12-11
665 061 37 00	1.00	SFD	1.00	1.00	1.00	\$183.34	\$183.34	Sivick Sara V
665 061 38 00	1.00	SFD	1.00	1.00	1.00	\$183.34	\$183.34	Cota Guillermo&Gabriela
665 061 39 00	2.03	OSP	0.00	0.20	0.00	\$183.34	\$0.00	C G S D Associates L P
665 062 01 00	1.00	SFD	1.00	1.00	1.00	\$183.34	\$183.34	Schmidt Jeffrey D&Lorraine C
665 062 02 00	1.00	SFD	1.00	1.00	1.00	\$183.34	\$183.34	Alvarez Miguel M
665 062 03 00	1.00	SFD	1.00	1.00	1.00	\$183.34	\$183.34	Welker Kim A&Maria G Living Trust 06-19-14
665 062 04 00	1.00	SFD	1.00	1.00	1.00	\$183.34	\$183.34	Atfield Dennis W&Wendy E
665 062 05 00	1.00	SFD	1.00	1.00	1.00	\$183.34	\$183.34	Gonzalez Salvador Jr&Elsa
665 062 06 00	1.00	SFD	1.00	1.00	1.00	\$183.34	\$183.34	Suarez Arturo&Rosario
665 062 07 00	1.00	SFD	1.00	1.00	1.00	\$183.34	\$183.34	Aviles Romel A C&Bautista Marcela C
665 062 08 00	1.00	SFD	1.00	1.00	1.00	\$183.34	\$183.34	Avalos Eliseo R&Elizabeth G
665 062 09 00	1.00	SFD	1.00	1.00	1.00	\$183.34	\$183.34	Amezcuca Jorge L&Elena
665 062 10 00	1.00	SFD	1.00	1.00	1.00	\$183.34	\$183.34	Delapaz Luis G D
665 062 11 00	1.00	SFD	1.00	1.00	1.00	\$183.34	\$183.34	Gutierrez Sergio
665 062 12 00	1.00	SFD	1.00	1.00	1.00	\$183.34	\$183.34	Ramos Jorge A&Minerva G
665 062 13 00	1.00	SFD	1.00	1.00	1.00	\$183.34	\$183.34	Martin Roger R&Soledad A
665 062 14 00	1.00	SFD	1.00	1.00	1.00	\$183.34	\$183.34	Angeli Juan D&Sandra M
665 062 15 00	1.00	SFD	1.00	1.00	1.00	\$183.34	\$183.34	Sarandi Marina M
665 062 16 00	1.00	SFD	1.00	1.00	1.00	\$183.34	\$183.34	Pacheco Oscar&Sylvia M
665 062 17 00	1.00	SFD	1.00	1.00	1.00	\$183.34	\$183.34	Garcia Misael
665 062 18 00	1.00	SFD	1.00	1.00	1.00	\$183.34	\$183.34	Horton Edward P&Gisel L
665 062 19 00	1.00	SFD	1.00	1.00	1.00	\$183.34	\$183.34	Carpenter Family Trust 08-25-10
665 062 20 00	1.00	SFD	1.00	1.00	1.00	\$183.34	\$183.34	Gaxiola Adolfo&Maria
665 062 21 00	1.00	SFD	1.00	1.00	1.00	\$183.34	\$183.34	Contreras Juana
665 062 22 00	1.00	SFD	1.00	1.00	1.00	\$183.34	\$183.34	Estrada Ricardo R&Maria A
665 062 23 00	1.00	SFD	1.00	1.00	1.00	\$183.34	\$183.34	Nuno Rosio
665 062 24 00	1.00	SFD	1.00	1.00	1.00	\$183.34	\$183.34	Waybell Orfil&Figueroa Sandra
665 062 25 00	1.00	SFD	1.00	1.00	1.00	\$183.34	\$183.34	Villagrana Jose R&Nunez Nydia G
665 062 26 00	1.00	SFD	1.00	1.00	1.00	\$183.34	\$183.34	Montanez Jeremiah J&Catherine A
665 062 27 00	1.00	SFD	1.00	1.00	1.00	\$183.34	\$183.34	Austria Fabio O Jr&Gloryjoy A
665 062 28 00	1.00	SFD	1.00	1.00	1.00	\$183.34	\$183.34	Gonzalez Andres G&Leonarda M
665 062 29 00	1.00	SFD	1.00	1.00	1.00	\$183.34	\$183.34	Garcia Ruben T&Hermelinda L
665 062 30 00	1.00	SFD	1.00	1.00	1.00	\$183.34	\$183.34	Morales Ricardo&Ruvalcaba Mayra
665 062 31 00	1.00	SFD	1.00	1.00	1.00	\$183.34	\$183.34	Painter Timothy J&Martha
665 062 32 00	1.00	SFD	1.00	1.00	1.00	\$183.34	\$183.34	Duran Azucena
665 062 33 00	1.00	SFD	1.00	1.00	1.00	\$183.34	\$183.34	Herrera Jaime
665 062 34 00	1.00	SFD	1.00	1.00	1.00	\$183.34	\$183.34	Torres Erik H&Noriega Elvia I
665 063 01 00	1.00	SFD	1.00	1.00	1.00	\$183.34	\$183.34	Gonzalez Guadalupe
665 063 02 00	1.00	SFD	1.00	1.00	1.00	\$183.34	\$183.34	Ramirez Miriam
665 063 03 00	1.00	SFD	1.00	1.00	1.00	\$183.34	\$183.34	Veloria Rolando R&Patricia
665 063 04 00	1.00	SFD	1.00	1.00	1.00	\$183.34	\$183.34	Timson Lincoln
665 063 05 00	1.00	SFD	1.00	1.00	1.00	\$183.34	\$183.34	Cancino Manuel&Alyma J
665 063 06 00	1.00	SFD	1.00	1.00	1.00	\$183.34	\$183.34	Okada Daniel T&Koning Carmen J
665 063 07 00	1.00	SFD	1.00	1.00	1.00	\$183.34	\$183.34	Sanchez Ruben&Delarosa Veronica
665 063 08 00	1.00	SFD	1.00	1.00	1.00	\$183.34	\$183.34	Velasquez Fernando&Yvette
665 063 09 00	1.00	SFD	1.00	1.00	1.00	\$183.34	\$183.34	Mendez Maura A
665 063 10 00	1.00	SFD	1.00	1.00	1.00	\$183.34	\$183.34	Martinez Lonnie D&Angelina M

# EXHIBIT C - Assessment Roll (Fiscal Year 2019)

## Coral Gate Maintenance Assessment District

Parcel Number	Acres/ Units <sup>(1)</sup>	Land Use <sup>(2)</sup>	Assessment Factors		Total EBUs	Unit Cost (\$/Ebu)	FY 2019 <sup>(4)</sup> Assessment	Owner Name
			Land Use <sup>(2)</sup>	Benefit <sup>(3)</sup>				
665 063 11 00	1.00	SFD	1.00	1.00	1.00	\$183.34	\$183.34	C A H 2015-1 Borrower Llc
665 063 12 00	1.00	SFD	1.00	1.00	1.00	\$183.34	\$183.34	Castellanos Robert G&Connie E
665 063 13 00	1.00	SFD	1.00	1.00	1.00	\$183.34	\$183.34	Bolden Timothy&Lilia R
665 063 14 00	1.00	SFD	1.00	1.00	1.00	\$183.34	\$183.34	Alvarado Jose R&Sandra
665 063 15 00	1.00	SFD	1.00	1.00	1.00	\$183.34	\$183.34	Meza Richard&Liliana
665 063 16 00	1.00	SFD	1.00	1.00	1.00	\$183.34	\$183.34	Mireles Jose R
665 063 17 00	1.00	SFD	1.00	1.00	1.00	\$183.34	\$183.34	Bongolan Wilson B&Erna C Revocable Trust 04-21
665 063 18 00	1.00	SFD	1.00	1.00	1.00	\$183.34	\$183.34	Alcantar Jose L
665 063 19 00	1.00	SFD	1.00	1.00	1.00	\$183.34	\$183.34	Baldi Pasquale J
665 063 20 00	1.00	SFD	1.00	1.00	1.00	\$183.34	\$183.34	Benavides Alfonso S&Servin Marie A
665 063 21 00	1.00	SFD	1.00	1.00	1.00	\$183.34	\$183.34	Santos Lorena E Trust 09-14-17
665 063 22 00	1.00	SFD	1.00	1.00	1.00	\$183.34	\$183.34	Lorenzana Jose M&Nohemi
665 063 23 00	1.00	SFD	1.00	1.00	1.00	\$183.34	\$183.34	Arnold Gary P&Marlen O
665 063 30 00	1.95	PKD	5.00	0.20	1.95	\$183.34	\$357.50	City Of San Diego
665 063 31 00	0.94	PKD	5.00	0.20	0.94	\$183.34	\$172.34	City Of San Diego
665 063 32 00	1.00	SFD	1.00	1.00	1.00	\$183.34	\$183.34	Pohribnak Joshua M&Natasha
665 063 33 00	1.00	SFD	1.00	1.00	1.00	\$183.34	\$183.34	Carrillo Rafael&Maria S
665 063 34 00	1.00	SFD	1.00	1.00	1.00	\$183.34	\$183.34	Ramirez Alfredo
665 063 35 00	1.00	SFD	1.00	1.00	1.00	\$183.34	\$183.34	Le Linus Nghi&Pham Mina M
665 063 36 00	1.00	SFD	1.00	1.00	1.00	\$183.34	\$183.34	Roman Samuel&Toni
665 063 37 00	1.00	SFD	1.00	1.00	1.00	\$183.34	\$183.34	Ceballos Jose M&Catalina
665 064 03 00	2.59	OSP	0.00	0.20	0.00	\$183.34	\$0.00	C G S D Associates L P
665 064 04 00	1.03	OSP	0.00	0.20	0.00	\$183.34	\$0.00	C G S D Associates L P
665 064 05 00	1.06	OSP	0.00	0.20	0.00	\$183.34	\$0.00	C G S D Associates L P
665 070 01 00	1.00	SFD	1.00	1.00	1.00	\$183.34	\$183.34	Delano Dean R&Nora C
665 070 02 00	1.00	SFD	1.00	1.00	1.00	\$183.34	\$183.34	Pichardo Ernesto&Rosa N
665 070 03 00	1.00	SFD	1.00	1.00	1.00	\$183.34	\$183.34	Barragan Federico
665 070 04 00	1.00	SFD	1.00	1.00	1.00	\$183.34	\$183.34	Zepeda Antonio&Ibarra Anita
665 070 05 00	1.00	SFD	1.00	1.00	1.00	\$183.34	\$183.34	Perez Salvador&Christine M
665 070 06 00	1.00	SFD	1.00	1.00	1.00	\$183.34	\$183.34	Anaya Bernardo
665 070 07 00	1.00	SFD	1.00	1.00	1.00	\$183.34	\$183.34	Williams Wilma J Trust 05-02-01
665 070 08 00	1.00	SFD	1.00	1.00	1.00	\$183.34	\$183.34	Orozco Ruben C
665 070 09 00	1.00	SFD	1.00	1.00	1.00	\$183.34	\$183.34	Galang Rogelio T&Dalia G
665 070 10 00	1.00	SFD	1.00	1.00	1.00	\$183.34	\$183.34	Barba Benjamin&Lorena
665 070 11 00	1.00	SFD	1.00	1.00	1.00	\$183.34	\$183.34	Rodriguez Jose A&Maribel
665 070 12 00	1.00	SFD	1.00	1.00	1.00	\$183.34	\$183.34	Aguilar Reyglenn&Annabell P
665 070 13 00	1.00	SFD	1.00	1.00	1.00	\$183.34	\$183.34	Perez Rodolfo
665 070 14 00	1.00	SFD	1.00	1.00	1.00	\$183.34	\$183.34	Garcia Juan E&Josefa B
665 070 15 00	1.00	SFD	1.00	1.00	1.00	\$183.34	\$183.34	Herrera Hector
665 070 16 00	1.00	SFD	1.00	1.00	1.00	\$183.34	\$183.34	Corona Angel&Yanira D C
665 070 17 00	1.00	SFD	1.00	1.00	1.00	\$183.34	\$183.34	Millan Guillermo H&Olivia M
665 070 18 00	1.00	SFD	1.00	1.00	1.00	\$183.34	\$183.34	Valdez Josefina
665 070 19 00	1.00	SFD	1.00	1.00	1.00	\$183.34	\$183.34	Dominguez Frank G&Margaret T
665 070 20 00	1.00	SFD	1.00	1.00	1.00	\$183.34	\$183.34	Arcos Andres&Maria D
665 070 21 00	1.00	SFD	1.00	1.00	1.00	\$183.34	\$183.34	Moody Gregory&Alycia
665 070 22 00	1.00	SFD	1.00	1.00	1.00	\$183.34	\$183.34	Jaime Juan H&Gabriela
665 070 23 00	1.00	SFD	1.00	1.00	1.00	\$183.34	\$183.34	Ibarra Jorge N&Rosalba R
665 070 24 00	1.00	SFD	1.00	1.00	1.00	\$183.34	\$183.34	Baker Jonathan R&Melinda K
665 070 25 00	1.00	SFD	1.00	1.00	1.00	\$183.34	\$183.34	Arboleda Sabino R&Rutila L
665 070 26 00	1.00	SFD	1.00	1.00	1.00	\$183.34	\$183.34	Rodriguez Victor&Veronica L
665 070 27 00	1.00	SFD	1.00	1.00	1.00	\$183.34	\$183.34	Ibanez Berenice
665 070 28 00	1.00	SFD	1.00	1.00	1.00	\$183.34	\$183.34	Romero Juan R&Aguayo Juanita C
665 070 29 00	1.00	SFD	1.00	1.00	1.00	\$183.34	\$183.34	Medina Alfredo

# EXHIBIT C - Assessment Roll (Fiscal Year 2019)

## Coral Gate Maintenance Assessment District

Parcel Number	Acres/ Units <sup>(1)</sup>	Land Use <sup>(2)</sup>	Assessment Factors		Total EBUs	Unit Cost (\$/Ebu)	FY 2019 <sup>(4)</sup> Assessment	Owner Name
			Land Use <sup>(2)</sup>	Benefit <sup>(3)</sup>				
665 070 30 00	1.00	SFD	1.00	1.00	1.00	\$183.34	\$183.34	Franco Francisco&Hilda
665 070 31 00	1.00	SFD	1.00	1.00	1.00	\$183.34	\$183.34	Ortega Samuel H&Maria Luisa
665 070 32 00	1.00	SFD	1.00	1.00	1.00	\$183.34	\$183.34	Gomez Miguel A&Clarisa
665 070 33 00	1.00	SFD	1.00	1.00	1.00	\$183.34	\$183.34	Rubalcaba Eduardo
665 070 34 00	1.00	SFD	1.00	1.00	1.00	\$183.34	\$183.34	Yu William D&Paloma E V
665 070 35 00	1.00	SFD	1.00	1.00	1.00	\$183.34	\$183.34	Topacio Angel A 2017 Trust 12-07-17
665 070 36 00	1.00	SFD	1.00	1.00	1.00	\$183.34	\$183.34	Mexia Juan C
665 070 37 00	1.00	SFD	1.00	1.00	1.00	\$183.34	\$183.34	Marin Javier&America
665 070 38 00	1.00	SFD	1.00	1.00	1.00	\$183.34	\$183.34	Ascencio Maximiano
665 070 39 00	1.00	SFD	1.00	1.00	1.00	\$183.34	\$183.34	Kuang Sheng Hua
665 070 40 00	1.00	SFD	1.00	1.00	1.00	\$183.34	\$183.34	Acosta Jesus&Griselda
665 070 41 00	1.00	SFD	1.00	1.00	1.00	\$183.34	\$183.34	Delcampo Maria E M
665 070 42 00	1.00	SFD	1.00	1.00	1.00	\$183.34	\$183.34	Ceniceros Sergio&Gloria
665 070 43 00	1.00	SFD	1.00	1.00	1.00	\$183.34	\$183.34	Aguirre Librado&Blanca E
665 070 44 00	1.00	SFD	1.00	1.00	1.00	\$183.34	\$183.34	Negron Raul A&Rojas Mary A
665 070 45 00	1.00	SFD	1.00	1.00	1.00	\$183.34	\$183.34	Diaz Leonardo Jr
665 070 46 00	1.00	SFD	1.00	1.00	1.00	\$183.34	\$183.34	Medina Samuel
665 070 47 00	1.00	SFD	1.00	1.00	1.00	\$183.34	\$183.34	Sanchez Jesus
665 070 48 00	1.00	SFD	1.00	1.00	1.00	\$183.34	\$183.34	Correa Jose R
665 070 49 00	1.00	SFD	1.00	1.00	1.00	\$183.34	\$183.34	Rodriguez Ruben&Rocio A
665 070 50 00	1.00	SFD	1.00	1.00	1.00	\$183.34	\$183.34	Jarvis Joshua D&Rialyn R
665 070 51 00	1.00	SFD	1.00	1.00	1.00	\$183.34	\$183.34	Villa Miguel A&Felix
665 070 52 00	1.00	SFD	1.00	1.00	1.00	\$183.34	\$183.34	Irwin Adrian
665 070 53 00	1.00	SFD	1.00	1.00	1.00	\$183.34	\$183.34	Liberato Miguel A&Concepcion
665 070 54 00	1.00	SFD	1.00	1.00	1.00	\$183.34	\$183.34	Leon Antonio R&Ramos Corina H D
665 070 55 00	1.00	SFD	1.00	1.00	1.00	\$183.34	\$183.34	Servin Irma E A
665 070 56 00	1.00	SFD	1.00	1.00	1.00	\$183.34	\$183.34	Villegas Jesus H&Triny G
665 070 57 00	1.00	SFD	1.00	1.00	1.00	\$183.34	\$183.34	Resto Erick
665 070 58 00	1.00	SFD	1.00	1.00	1.00	\$183.34	\$183.34	Romo Revocable Trust 06-10-03
665 070 59 00	1.00	SFD	1.00	1.00	1.00	\$183.34	\$183.34	Limon Ruben G&Felipa V
665 070 60 00	1.00	SFD	1.00	1.00	1.00	\$183.34	\$183.34	Tellez Daniel&Karolina
665 070 61 00	1.00	SFD	1.00	1.00	1.00	\$183.34	\$183.34	Tjallas Bradley A&Elizabeth
665 070 62 00	1.00	SFD	1.00	1.00	1.00	\$183.34	\$183.34	Enriquez Nicolas L&Gonzalez Juana H
665 070 63 00	1.00	SFD	1.00	1.00	1.00	\$183.34	\$183.34	Santoyo Jorge R Jr
665 070 64 00	1.00	SFD	1.00	1.00	1.00	\$183.34	\$183.34	Lazcano Rafael&Hilda
665 070 65 00	1.00	SFD	1.00	1.00	1.00	\$183.34	\$183.34	Rivera Juan P&Olga
665 070 66 00	1.00	SFD	1.00	1.00	1.00	\$183.34	\$183.34	Najera Jorge A S
665 070 67 00	1.00	SFD	1.00	1.00	1.00	\$183.34	\$183.34	Contreras Jaime A&Munoz Cruz M
665 070 68 00	1.00	SFD	1.00	1.00	1.00	\$183.34	\$183.34	Lopez Raquel P
665 070 69 00	1.00	SFD	1.00	1.00	1.00	\$183.34	\$183.34	Coward Tommy K&Maria C
665 070 70 00	1.00	SFD	1.00	1.00	1.00	\$183.34	\$183.34	Bancod Michael&Regina
665 070 71 00	1.00	SFD	1.00	1.00	1.00	\$183.34	\$183.34	Salvador Eduardo C&Juanita C
665 070 72 00	1.00	SFD	1.00	1.00	1.00	\$183.34	\$183.34	Sepulveda Marco A&Judylee
665 071 01 00	1.00	SFD	1.00	1.00	1.00	\$183.34	\$183.34	Lechuga Fred&Claudia
665 071 02 00	1.00	SFD	1.00	1.00	1.00	\$183.34	\$183.34	Franco Jorge C
665 071 03 00	1.00	SFD	1.00	1.00	1.00	\$183.34	\$183.34	Hernandez Ivan
665 071 04 00	1.00	SFD	1.00	1.00	1.00	\$183.34	\$183.34	David Robert P&Estrella C
665 071 05 00	1.00	SFD	1.00	1.00	1.00	\$183.34	\$183.34	Perez Flavio Jr
665 071 06 00	1.00	SFD	1.00	1.00	1.00	\$183.34	\$183.34	Castro Joel&Elsa M
665 071 07 00	1.00	SFD	1.00	1.00	1.00	\$183.34	\$183.34	Arriaga Jose D
665 071 08 00	1.00	SFD	1.00	1.00	1.00	\$183.34	\$183.34	Thibodeaux Eric R&Raquel
665 071 09 00	1.00	SFD	1.00	1.00	1.00	\$183.34	\$183.34	Navarro Martha G
665 071 10 00	1.00	SFD	1.00	1.00	1.00	\$183.34	\$183.34	Cisneros Joseph C

# EXHIBIT C - Assessment Roll (Fiscal Year 2019)

## Coral Gate Maintenance Assessment District

Parcel Number	Acres/ Units <sup>(1)</sup>	Land Use <sup>(2)</sup>	Assessment Factors		Total EBU's	Unit Cost (\$/EBU)	FY 2019 <sup>(4)</sup> Assessment	Owner Name
			Land Use <sup>(2)</sup>	Benefit <sup>(3)</sup>				
665 071 11 00	1.00	SFD	1.00	1.00	1.00	\$183.34	\$183.34	Nuno Jorge&Aida
665 071 12 00	1.00	SFD	1.00	1.00	1.00	\$183.34	\$183.34	Garcia-Machado Omar
665 071 13 00	1.00	SFD	1.00	1.00	1.00	\$183.34	\$183.34	Garcia Rafael
665 071 14 00	1.00	SFD	1.00	1.00	1.00	\$183.34	\$183.34	Cather Michael&Cruz Amelia
665 071 15 00	1.00	SFD	1.00	1.00	1.00	\$183.34	\$183.34	Alatorre Steve S
665 071 16 00	1.00	SFD	1.00	1.00	1.00	\$183.34	\$183.34	Flores Juan R&Quintero Blanca L Revocable 2008
665 071 17 00	1.00	SFD	1.00	1.00	1.00	\$183.34	\$183.34	Velazco Luis E&Neyra Y
665 071 18 00	1.00	SFD	1.00	1.00	1.00	\$183.34	\$183.34	Galindo Adela P
665 071 19 00	1.00	SFD	1.00	1.00	1.00	\$183.34	\$183.34	Vega Sergio L&Galvez Carmen A V
665 071 20 00	1.00	SFD	1.00	1.00	1.00	\$183.34	\$183.34	Lavenant-Villegas Living Trust 10-10-05
665 071 21 00	1.00	SFD	1.00	1.00	1.00	\$183.34	\$183.34	Delavega Victor M&Gama Olivia
665 071 22 00	1.00	SFD	1.00	1.00	1.00	\$183.34	\$183.34	Moreno Martha L
665 071 23 00	1.00	SFD	1.00	1.00	1.00	\$183.34	\$183.34	Cowan Richard L&Carlotta J
665 071 24 00	1.00	SFD	1.00	1.00	1.00	\$183.34	\$183.34	Alvarez Marco A&Karina L
665 071 25 00	1.00	SFD	1.00	1.00	1.00	\$183.34	\$183.34	Lopez Daniel&Minerva
665 071 26 00	1.00	SFD	1.00	1.00	1.00	\$183.34	\$183.34	Gutierrez Raquel L
665 071 27 00	1.00	SFD	1.00	1.00	1.00	\$183.34	\$183.34	Chavez Jose R
665 071 28 00	1.00	SFD	1.00	1.00	1.00	\$183.34	\$183.34	Campos Maria D
665 071 29 00	1.00	SFD	1.00	1.00	1.00	\$183.34	\$183.34	Rivera Juan C&Calderon Yadira
665 071 30 00	1.00	SFD	1.00	1.00	1.00	\$183.34	\$183.34	Melendez Maria D L L
665 071 31 00	1.00	SFD	1.00	1.00	1.00	\$183.34	\$183.34	Enriquez Thomas F&Martha M I
665 071 32 00	1.00	SFD	1.00	1.00	1.00	\$183.34	\$183.34	Murillo Sergio&Estrella Gloria
665 071 33 00	1.00	SFD	1.00	1.00	1.00	\$183.34	\$183.34	Martinez Patricia L
665 071 34 00	1.00	SFD	1.00	1.00	1.00	\$183.34	\$183.34	Mendoza Noel A&Erlinda S
665 071 35 00	1.00	SFD	1.00	1.00	1.00	\$183.34	\$183.34	Kelley Posadas 2002 Family Trust 01-24-02
665 071 36 00	1.00	SFD	1.00	1.00	1.00	\$183.34	\$183.34	Felix Bryan J
665 071 37 00	1.00	SFD	1.00	1.00	1.00	\$183.34	\$183.34	Tovar Amador Jr&Yanet
665 071 38 00	1.00	SFD	1.00	1.00	1.00	\$183.34	\$183.34	Padilla Family Trust 11-06-17
665 071 39 00	1.00	SFD	1.00	1.00	1.00	\$183.34	\$183.34	Dobles Juan&Sara
665 071 40 00	1.00	SFD	1.00	1.00	1.00	\$183.34	\$183.34	Cardenas Guillermo&Marilyne M
665 071 41 00	1.00	SFD	1.00	1.00	1.00	\$183.34	\$183.34	Villa-Robles Miguel A&Villa Veronica C
665 071 42 00	1.00	SFD	1.00	1.00	1.00	\$183.34	\$183.34	Quinones Living Trust 12-27-07
665 071 43 00	1.00	SFD	1.00	1.00	1.00	\$183.34	\$183.34	Quinones Mario O&Maria D L A
665 071 44 00	1.00	SFD	1.00	1.00	1.00	\$183.34	\$183.34	Padilla Edith S
665 071 45 00	1.00	SFD	1.00	1.00	1.00	\$183.34	\$183.34	Cabrales Osbaldo&Betancourt Tania
665 071 46 00	1.00	SFD	1.00	1.00	1.00	\$183.34	\$183.34	Schubert Orrin A Jr&Chona P
665 071 47 00	1.00	SFD	1.00	1.00	1.00	\$183.34	\$183.34	Pimentel Jesus&Patricia
665 071 48 00	1.00	SFD	1.00	1.00	1.00	\$183.34	\$183.34	Melendrez Rigoberto&Maria E
665 071 49 00	1.00	SFD	1.00	1.00	1.00	\$183.34	\$183.34	Gomez Azucena G
665 071 50 00	1.00	SFD	1.00	1.00	1.00	\$183.34	\$183.34	Tan Joseph D&Godofreda S
665 071 51 00	1.00	SFD	1.00	1.00	1.00	\$183.34	\$183.34	Vizcarra Carlos L
665 071 52 00	1.00	SFD	1.00	1.00	1.00	\$183.34	\$183.34	Winston Nigel L&Starr L
665 071 53 00	1.00	SFD	1.00	1.00	1.00	\$183.34	\$183.34	Clements Clair L
665 071 54 00	1.00	SFD	1.00	1.00	1.00	\$183.34	\$183.34	Perez Family 2010 Trust 03-09-10
665 071 55 00	1.00	SFD	1.00	1.00	1.00	\$183.34	\$183.34	Negrete Larry&Lorena
665 071 56 00	1.00	SFD	1.00	1.00	1.00	\$183.34	\$183.34	Echauri Family Trust 06-17-02
665 071 57 00	1.00	SFD	1.00	1.00	1.00	\$183.34	\$183.34	Mehr-Assa Ebrahim
665 071 58 00	1.00	SFD	1.00	1.00	1.00	\$183.34	\$183.34	Rhoads Sergio O
665 071 59 00	1.00	SFD	1.00	1.00	1.00	\$183.34	\$183.34	Lara George L
665 071 60 00	1.00	SFD	1.00	1.00	1.00	\$183.34	\$183.34	Delcampo Luis A M
665 071 61 00	1.00	SFD	1.00	1.00	1.00	\$183.34	\$183.34	Enriquez Porfirio&Rodriguez Viviana
665 071 62 00	1.00	SFD	1.00	1.00	1.00	\$183.34	\$183.34	Velasquez Eduardo&Maria
665 071 63 00	1.00	SFD	1.00	1.00	1.00	\$183.34	\$183.34	Charles Mercedes



# EXHIBIT C - Assessment Roll (Fiscal Year 2019)

## Coral Gate Maintenance Assessment District

Parcel Number	Acres/ Units <sup>(1)</sup>	Land Use <sup>(2)</sup>	Assessment Factors		Total EBU's	Unit Cost (\$/EBU)	FY 2019 <sup>(4)</sup> Assessment	Owner Name
			Land Use <sup>(2)</sup>	Benefit <sup>(3)</sup>				
665 071 64 00	1.00	SFD	1.00	1.00	1.00	\$183.34	\$183.34	Duarte Gustavo G&Siara A R D
665 071 65 00	1.00	SFD	1.00	1.00	1.00	\$183.34	\$183.34	Sandoval Jose J&Yolanda
665 071 66 00	1.00	SFD	1.00	1.00	1.00	\$183.34	\$183.34	Santiago G N Trust 12-30-08
665 071 67 00	1.00	SFD	1.00	1.00	1.00	\$183.34	\$183.34	Ocegueda Juan J&Martha L
665 071 68 00	1.00	SFD	1.00	1.00	1.00	\$183.34	\$183.34	Duran J Isabel V&Ramirez Perla M
665 071 69 00	1.00	SFD	1.00	1.00	1.00	\$183.34	\$183.34	Cavazos Arturo J&Mareni
665 080 01 00	1.00	SFD	1.00	1.00	1.00	\$183.34	\$183.34	Solano Victor&Sandra M
665 080 02 00	1.00	SFD	1.00	1.00	1.00	\$183.34	\$183.34	Walker Keith E&Raquel
665 080 03 00	1.00	SFD	1.00	1.00	1.00	\$183.34	\$183.34	Zamarripa Guadalupe H&Alejandra
665 080 04 00	1.00	SFD	1.00	1.00	1.00	\$183.34	\$183.34	Aguirre Juan A
665 080 05 00	1.00	SFD	1.00	1.00	1.00	\$183.34	\$183.34	Peterson Andrew J
665 080 06 00	1.00	SFD	1.00	1.00	1.00	\$183.34	\$183.34	Talamantes Gerardo&Maricela
665 080 07 00	1.00	SFD	1.00	1.00	1.00	\$183.34	\$183.34	Diaz Lucio
665 080 08 00	1.00	SFD	1.00	1.00	1.00	\$183.34	\$183.34	Beilke Matthew A&Jean
665 080 09 00	1.00	SFD	1.00	1.00	1.00	\$183.34	\$183.34	Rojas Agustin&Maria E
665 080 10 00	1.00	SFD	1.00	1.00	1.00	\$183.34	\$183.34	Zuniga Jose L&Rosa I
665 080 11 00	1.00	SFD	1.00	1.00	1.00	\$183.34	\$183.34	Cuevas Guillermo
665 080 12 00	1.00	SFD	1.00	1.00	1.00	\$183.34	\$183.34	Zamudio Maria S
665 080 13 00	1.00	SFD	1.00	1.00	1.00	\$183.34	\$183.34	Dairymart Real Estate Investments Llc
665 080 14 00	1.00	SFD	1.00	1.00	1.00	\$183.34	\$183.34	Martinez Peter&Celedon Elena
665 080 15 00	1.00	SFD	1.00	1.00	1.00	\$183.34	\$183.34	Ibarra Emilio&Veronica
665 080 16 00	1.00	SFD	1.00	1.00	1.00	\$183.34	\$183.34	Ranon Jesus&Martha A
665 080 17 00	1.00	SFD	1.00	1.00	1.00	\$183.34	\$183.34	Loaiza Gilberto&Teyssier Yvonne
665 080 18 00	1.00	SFD	1.00	1.00	1.00	\$183.34	\$183.34	S H Westpoint Group Llc
665 080 19 00	1.00	SFD	1.00	1.00	1.00	\$183.34	\$183.34	Herrera Arturo F&Lilian
665 080 20 00	1.00	SFD	1.00	1.00	1.00	\$183.34	\$183.34	Huerta Jose
665 080 21 00	1.00	SFD	1.00	1.00	1.00	\$183.34	\$183.34	Dunn Joseph R&Barron Michelle
665 080 22 00	1.00	SFD	1.00	1.00	1.00	\$183.34	\$183.34	Kelley Posadas Family 2002 Trust 01-24-02
665 080 23 00	1.00	SFD	1.00	1.00	1.00	\$183.34	\$183.34	Ramirez Samuel&Maria C
665 080 24 00	1.00	SFD	1.00	1.00	1.00	\$183.34	\$183.34	Geonzon Byron&Vashti R
665 080 25 00	1.00	SFD	1.00	1.00	1.00	\$183.34	\$183.34	Zepeda Jose M
665 080 26 00	1.00	SFD	1.00	1.00	1.00	\$183.34	\$183.34	Hernandez David F&Aurora T
665 080 27 00	1.00	SFD	1.00	1.00	1.00	\$183.34	\$183.34	Aguilar Melquis U&Umana Diana
665 080 28 00	1.00	SFD	1.00	1.00	1.00	\$183.34	\$183.34	Cuevas Richard&Corona Tania I
665 080 29 00	1.00	SFD	1.00	1.00	1.00	\$183.34	\$183.34	Villarreal Michael G
665 080 30 00	1.00	SFD	1.00	1.00	1.00	\$183.34	\$183.34	Lozano Lorena
665 080 31 00	1.00	SFD	1.00	1.00	1.00	\$183.34	\$183.34	Marquez Francisco J&Maria D
665 080 32 00	1.00	SFD	1.00	1.00	1.00	\$183.34	\$183.34	Saldivar Maria E
665 080 33 00	1.00	SFD	1.00	1.00	1.00	\$183.34	\$183.34	Ly Thai
665 080 34 00	1.00	SFD	1.00	1.00	1.00	\$183.34	\$183.34	Alfaro Oscar
665 080 35 00	1.00	SFD	1.00	1.00	1.00	\$183.34	\$183.34	Alvarez Miguel A&Azucena
665 080 36 00	1.00	SFD	1.00	1.00	1.00	\$183.34	\$183.34	Mendoza-Lizarraga Octavio&Ibarra Cecilia
665 080 37 00	1.00	SFD	1.00	1.00	1.00	\$183.34	\$183.34	Alba Teresa
665 080 38 00	1.00	SFD	1.00	1.00	1.00	\$183.34	\$183.34	Vasquez Victor&Sandra M
665 080 39 00	1.00	SFD	1.00	1.00	1.00	\$183.34	\$183.34	Ratliff Timothy E&Merrilee C
665 080 40 00	1.00	SFD	1.00	1.00	1.00	\$183.34	\$183.34	Lopez Juventino&Arechiga Georgina
665 080 41 00	1.00	SFD	1.00	1.00	1.00	\$183.34	\$183.34	Vazquez Lorenzo N&Leonor
665 080 42 00	1.00	SFD	1.00	1.00	1.00	\$183.34	\$183.34	Bagnas Bryan B&Elizabeth T Revocable 2009 Trus
665 080 43 00	1.00	SFD	1.00	1.00	1.00	\$183.34	\$183.34	Stephens Juana
665 080 44 00	1.00	SFD	1.00	1.00	1.00	\$183.34	\$183.34	Gonzalez Jose F&Irma M
665 080 45 00	1.00	SFD	1.00	1.00	1.00	\$183.34	\$183.34	Valadez Luis A
665 080 46 00	1.00	SFD	1.00	1.00	1.00	\$183.34	\$183.34	Ponce Jaime P
665 080 47 00	1.00	SFD	1.00	1.00	1.00	\$183.34	\$183.34	Hernandez Daniel&Virginia

# EXHIBIT C - Assessment Roll (Fiscal Year 2019)

## Coral Gate Maintenance Assessment District

Parcel Number	Acres/ Units <sup>(1)</sup>	Land Use <sup>(2)</sup>	Assessment Factors		Total EBU's	Unit Cost (\$/EBU)	FY 2019 <sup>(4)</sup> Assessment	Owner Name
			Land Use <sup>(2)</sup>	Benefit <sup>(3)</sup>				
665 080 48 00	1.00	SFD	1.00	1.00	1.00	\$183.34	\$183.34	Bermudez Jaime A
665 080 49 00	1.00	SFD	1.00	1.00	1.00	\$183.34	\$183.34	Munoz Luis A&Veronica
665 080 50 00	1.00	SFD	1.00	1.00	1.00	\$183.34	\$183.34	Gonzalez Jose D&Maria G
665 080 51 00	1.00	SFD	1.00	1.00	1.00	\$183.34	\$183.34	Gonzalez Omar R&Noguez Dafne
665 080 52 00	1.00	SFD	1.00	1.00	1.00	\$183.34	\$183.34	Davis Czemar R Tr
665 080 53 00	1.00	SFD	1.00	1.00	1.00	\$183.34	\$183.34	Gifford Kent Z&Cynthia
665 080 54 00	1.00	SFD	1.00	1.00	1.00	\$183.34	\$183.34	Valenzuela Jorge M&Alcazar Silvia G
665 080 55 00	1.00	SFD	1.00	1.00	1.00	\$183.34	\$183.34	Turner Jeffery D&Maria R
665 080 56 00	1.00	SFD	1.00	1.00	1.00	\$183.34	\$183.34	Huber Heath J&Beatriz A
665 080 57 00	1.00	SFD	1.00	1.00	1.00	\$183.34	\$183.34	Mendoza Juan
665 080 58 00	1.00	SFD	1.00	1.00	1.00	\$183.34	\$183.34	Hernandez Fernando A
665 080 59 00	1.00	SFD	1.00	1.00	1.00	\$183.34	\$183.34	Badagbor Raphael K&Joana E
665 080 60 00	1.00	SFD	1.00	1.00	1.00	\$183.34	\$183.34	Rodriguez Wendy
665 080 61 00	1.00	SFD	1.00	1.00	1.00	\$183.34	\$183.34	Arellano Francisco J&Lesbia M
665 080 62 00	1.00	SFD	1.00	1.00	1.00	\$183.34	\$183.34	Castro Gerardo&Monica
665 080 63 00	1.00	SFD	1.00	1.00	1.00	\$183.34	\$183.34	Sahagun Jose A&Maria D
665 080 64 00	1.00	SFD	1.00	1.00	1.00	\$183.34	\$183.34	Rosas Alejandro R&Rubio Jaqueline B
665 080 65 00	1.00	SFD	1.00	1.00	1.00	\$183.34	\$183.34	Lopez Omar&Renteria Zulemy H
665 080 66 00	1.00	SFD	1.00	1.00	1.00	\$183.34	\$183.34	Perez Juan&Noelia
665 080 67 00	1.00	SFD	1.00	1.00	1.00	\$183.34	\$183.34	Capuyan Albert G&Richel A
665 080 68 00	1.00	SFD	1.00	1.00	1.00	\$183.34	\$183.34	Galaz Jorge E&Liliana
665 080 69 00	1.00	SFD	1.00	1.00	1.00	\$183.34	\$183.34	Malfavon Miguel A E
665 080 70 00	1.00	SFD	1.00	1.00	1.00	\$183.34	\$183.34	Rivers Kenneth R Sr&Roxane K
665 080 71 00	1.00	SFD	1.00	1.00	1.00	\$183.34	\$183.34	Salinas Orlando&Maria R
665 080 72 00	1.00	SFD	1.00	1.00	1.00	\$183.34	\$183.34	Habtewold Mulu G S
665 080 73 00	1.00	SFD	1.00	1.00	1.00	\$183.34	\$183.34	Hidalgo Krystian&Contreras Karina
665 080 74 00	1.00	SFD	1.00	1.00	1.00	\$183.34	\$183.34	Johnson Bethzaida
665 080 75 00	1.00	SFD	1.00	1.00	1.00	\$183.34	\$183.34	Rios Angel
665 080 76 00	1.00	SFD	1.00	1.00	1.00	\$183.34	\$183.34	Urrea Robert M&Aguinaga Maria D S L
665 080 77 00	1.00	SFD	1.00	1.00	1.00	\$183.34	\$183.34	Hernandez Christian Special Needs Trust 03-27-09
665 080 78 00	1.00	SFD	1.00	1.00	1.00	\$183.34	\$183.34	Ferrel Wilfred M&Maria G
665 080 79 00	1.00	SFD	1.00	1.00	1.00	\$183.34	\$183.34	Couoh Francisco J
665 080 80 00	1.00	SFD	1.00	1.00	1.00	\$183.34	\$183.34	Rios Edward H&Maria G
665 081 01 00	1.00	SFD	1.00	1.00	1.00	\$183.34	\$183.34	Huerta Johnny M&Irma V
665 081 02 00	1.00	SFD	1.00	1.00	1.00	\$183.34	\$183.34	Rubio Fernando
665 081 03 00	1.00	SFD	1.00	1.00	1.00	\$183.34	\$183.34	Munoz Hector N&Sylvia S
665 081 04 00	1.00	SFD	1.00	1.00	1.00	\$183.34	\$183.34	Flores Jose L
665 081 05 00	1.00	SFD	1.00	1.00	1.00	\$183.34	\$183.34	Arellano Francisco J
665 081 06 00	1.00	SFD	1.00	1.00	1.00	\$183.34	\$183.34	C S H 2016-1 Borrower Llc
665 081 07 00	1.00	SFD	1.00	1.00	1.00	\$183.34	\$183.34	Mendoza Manuel B&Maria C
665 081 08 00	1.00	SFD	1.00	1.00	1.00	\$183.34	\$183.34	Gutierrez Guillermo&Lilian 2017 Revocable Trust
665 081 09 00	1.00	SFD	1.00	1.00	1.00	\$183.34	\$183.34	Barragan Martha
665 081 10 00	1.00	SFD	1.00	1.00	1.00	\$183.34	\$183.34	Zatarain Samir
665 081 11 00	1.00	SFD	1.00	1.00	1.00	\$183.34	\$183.34	Litan Reynaldo L
665 081 12 00	1.00	SFD	1.00	1.00	1.00	\$183.34	\$183.34	Urrea Luis O&Rosario
665 081 13 00	1.00	SFD	1.00	1.00	1.00	\$183.34	\$183.34	Romero Jesus J&Magdalena
665 081 14 00	1.00	SFD	1.00	1.00	1.00	\$183.34	\$183.34	Roman Efen Jr&Grisel
665 081 15 00	1.00	SFD	1.00	1.00	1.00	\$183.34	\$183.34	Lozano Edgar C&Rojas Linda
665 081 16 00	1.00	SFD	1.00	1.00	1.00	\$183.34	\$183.34	Castro Maria D J
665 081 17 00	1.00	SFD	1.00	1.00	1.00	\$183.34	\$183.34	Magana Soveida
665 081 18 00	1.00	SFD	1.00	1.00	1.00	\$183.34	\$183.34	Vidrio Judith O
665 081 19 00	1.00	SFD	1.00	1.00	1.00	\$183.34	\$183.34	Toves Magnum J&Kristina R
665 081 20 00	1.00	SFD	1.00	1.00	1.00	\$183.34	\$183.34	Haro Luis Sr&Maria

# EXHIBIT C - Assessment Roll (Fiscal Year 2019)

## Coral Gate Maintenance Assessment District

Parcel Number	Acres/ Units <sup>(1)</sup>	Land Use <sup>(2)</sup>	Assessment Factors		Total EBU's	Unit Cost (\$/EBU)	FY 2019 <sup>(4)</sup> Assessment	Owner Name
			Land Use <sup>(2)</sup>	Benefit <sup>(3)</sup>				
665 081 21 00	1.00	SFD	1.00	1.00	1.00	\$183.34	\$183.34	Deguzman Teodoro D Jr&Enriqueta M
665 081 22 00	1.00	SFD	1.00	1.00	1.00	\$183.34	\$183.34	Dominguez Roberto&Angelica
665 081 23 00	1.00	SFD	1.00	1.00	1.00	\$183.34	\$183.34	Amador Abdel U&Margarita
665 081 24 00	1.00	SFD	1.00	1.00	1.00	\$183.34	\$183.34	Romero Arturo&Rosalba
665 081 25 00	1.00	SFD	1.00	1.00	1.00	\$183.34	\$183.34	Buffaloe Michael W&Carmen A
665 081 26 00	1.00	SFD	1.00	1.00	1.00	\$183.34	\$183.34	Deleon Jose M Diaz&Roxana D
665 081 27 00	1.00	SFD	1.00	1.00	1.00	\$183.34	\$183.34	Beilesen Aaron
665 081 28 00	1.00	SFD	1.00	1.00	1.00	\$183.34	\$183.34	Carrillo Antonio&Amador Juana R
665 081 29 00	1.00	SFD	1.00	1.00	1.00	\$183.34	\$183.34	Balarezo Tyrone H&Reyes Manuela
665 081 30 00	1.00	SFD	1.00	1.00	1.00	\$183.34	\$183.34	Simental Carlos M&Moreno Marilyn
665 081 31 00	1.00	SFD	1.00	1.00	1.00	\$183.34	\$183.34	Cuevas Miguel A Sr&Sandra L
665 081 32 00	1.00	SFD	1.00	1.00	1.00	\$183.34	\$183.34	C S H 2016-1 Borrower Llc
665 081 33 00	1.00	SFD	1.00	1.00	1.00	\$183.34	\$183.34	Cariman Jose&Rosario
665 081 34 00	1.00	SFD	1.00	1.00	1.00	\$183.34	\$183.34	Ramos Victor M
665 081 35 00	1.00	SFD	1.00	1.00	1.00	\$183.34	\$183.34	Casas Jose A F&Franco Nohemi
665 081 36 00	1.00	SFD	1.00	1.00	1.00	\$183.34	\$183.34	Lucio Darriel
665 081 37 00	1.00	SFD	1.00	1.00	1.00	\$183.34	\$183.34	Sherrill Larry W&Teisha N
665 081 38 00	1.00	SFD	1.00	1.00	1.00	\$183.34	\$183.34	Alcaraz Jose L Jr
665 081 39 00	1.00	SFD	1.00	1.00	1.00	\$183.34	\$183.34	Martinez Francisco&Elizabeth
665 081 40 00	1.00	SFD	1.00	1.00	1.00	\$183.34	\$183.34	Days Vincent J&Charleena A
665 081 41 00	1.00	SFD	1.00	1.00	1.00	\$183.34	\$183.34	Brambila Angelica R
665 081 42 00	1.00	SFD	1.00	1.00	1.00	\$183.34	\$183.34	Nino Homero&Laura
665 081 43 00	1.00	SFD	1.00	1.00	1.00	\$183.34	\$183.34	Pacheco Alicia
665 081 44 00	1.00	SFD	1.00	1.00	1.00	\$183.34	\$183.34	Kinuthia James N
665 081 45 00	1.00	SFD	1.00	1.00	1.00	\$183.34	\$183.34	Lopez Josue Est Of
665 081 46 00	1.00	SFD	1.00	1.00	1.00	\$183.34	\$183.34	Miranda Alfred&Blanca P
665 081 47 00	1.00	SFD	1.00	1.00	1.00	\$183.34	\$183.34	Casillas Javier G&Garcia Daisy G
665 090 01 00	1.00	SFD	1.00	1.00	1.00	\$183.34	\$183.34	Vazquez Juan C&Cecilia M
665 090 02 00	1.00	SFD	1.00	1.00	1.00	\$183.34	\$183.34	Murray Maria G
665 090 03 00	1.00	SFD	1.00	1.00	1.00	\$183.34	\$183.34	Haro Luis A
665 090 04 00	1.00	SFD	1.00	1.00	1.00	\$183.34	\$183.34	Hagen Justin D&Clarisa
665 090 05 00	1.00	SFD	1.00	1.00	1.00	\$183.34	\$183.34	Cantu Reynaldo&Celia
665 090 06 00	1.00	SFD	1.00	1.00	1.00	\$183.34	\$183.34	Arguello Carlos Iii
665 090 07 00	1.00	SFD	1.00	1.00	1.00	\$183.34	\$183.34	Cerpa Gerardo
665 090 08 00	1.00	SFD	1.00	1.00	1.00	\$183.34	\$183.34	Adame Ed
665 090 09 00	1.00	SFD	1.00	1.00	1.00	\$183.34	\$183.34	Calderon Jose M&Ramos M N
665 090 10 00	1.00	SFD	1.00	1.00	1.00	\$183.34	\$183.34	Ortiz Dora S
665 090 11 00	1.00	SFD	1.00	1.00	1.00	\$183.34	\$183.34	Aragona Stephen&Margaret K
665 090 12 00	1.00	SFD	1.00	1.00	1.00	\$183.34	\$183.34	Jabbari Jalil&Georgina
665 090 13 00	1.00	SFD	1.00	1.00	1.00	\$183.34	\$183.34	Martinez Juan J&Caudillo Adela
665 090 14 00	1.00	SFD	1.00	1.00	1.00	\$183.34	\$183.34	Hilton John W&Maria T B
665 090 15 00	1.00	SFD	1.00	1.00	1.00	\$183.34	\$183.34	Contreras Ricardo
665 090 16 00	1.00	SFD	1.00	1.00	1.00	\$183.34	\$183.34	Gallegos Jesus P&Rosa M
665 090 17 00	1.00	SFD	1.00	1.00	1.00	\$183.34	\$183.34	Frias Gabriela Trust
665 090 18 00	1.00	SFD	1.00	1.00	1.00	\$183.34	\$183.34	Stonebraker Jake A&Maria F
665 090 19 00	1.00	SFD	1.00	1.00	1.00	\$183.34	\$183.34	Martinez William A
665 090 20 00	1.00	SFD	1.00	1.00	1.00	\$183.34	\$183.34	Spiegelberg Kurt&Antoinette J
665 090 21 00	1.00	SFD	1.00	1.00	1.00	\$183.34	\$183.34	Uribe Enrique R&Contreras Alma P
665 090 22 00	1.00	SFD	1.00	1.00	1.00	\$183.34	\$183.34	Solsaa Guy M&Patricia E Revocable 2005 Trust
665 090 23 00	1.00	SFD	1.00	1.00	1.00	\$183.34	\$183.34	Guillen Dioselina
665 090 24 00	1.00	SFD	1.00	1.00	1.00	\$183.34	\$183.34	Alejo Manuel
665 090 25 00	1.00	SFD	1.00	1.00	1.00	\$183.34	\$183.34	Herrera Bibi
665 090 26 00	1.00	SFD	1.00	1.00	1.00	\$183.34	\$183.34	Bobroff Family Trust 03-10-17

## EXHIBIT C - Assessment Roll (Fiscal Year 2019)

### Coral Gate Maintenance Assessment District

Parcel Number	Acres/ Units <sup>(1)</sup>	Land Use <sup>(2)</sup>	Assessment Factors		Total EBU	Unit Cost (\$/EBU)	FY 2019 <sup>(4)</sup> Assessment	Owner Name
			Land Use <sup>(2)</sup>	Benefit <sup>(3)</sup>				
665 090 27 00	1.00	SFD	1.00	1.00	1.00	\$183.34	\$183.34	Saenz Jorge A
665 090 28 00	1.00	SFD	1.00	1.00	1.00	\$183.34	\$183.34	Jimenez Jose&Sandra
665 090 29 00	1.00	SFD	1.00	1.00	1.00	\$183.34	\$183.34	Kinney Steven B&Shirley S
665 090 30 00	1.00	SFD	1.00	1.00	1.00	\$183.34	\$183.34	Castro Miguel A
665 090 31 00	1.00	SFD	1.00	1.00	1.00	\$183.34	\$183.34	Zareh Akbar J
665 090 32 00	1.00	SFD	1.00	1.00	1.00	\$183.34	\$183.34	Navarrete Eliseo&Marisela
665 090 33 00	1.00	SFD	1.00	1.00	1.00	\$183.34	\$183.34	Truong Tien Minh&Tu Ven Thi
665 090 34 00	1.00	SFD	1.00	1.00	1.00	\$183.34	\$183.34	Coral Crest Way Trust
665 090 35 00	1.00	SFD	1.00	1.00	1.00	\$183.34	\$183.34	Whorton Mitchell A&Petra
665 090 36 00	1.00	SFD	1.00	1.00	1.00	\$183.34	\$183.34	Aceves Griselda
665 090 37 00	1.00	SFD	1.00	1.00	1.00	\$183.34	\$183.34	Santillano Antonio
665 090 38 00	1.00	SFD	1.00	1.00	1.00	\$183.34	\$183.34	Jimenez Oscar&Elizabeth V
665 090 39 00	1.00	SFD	1.00	1.00	1.00	\$183.34	\$183.34	Islas Luis&Patricia Family Trust 01-09-13
665 090 40 00	1.00	SFD	1.00	1.00	1.00	\$183.34	\$183.34	Clark Cinnamon
665 090 41 00	1.00	SFD	1.00	1.00	1.00	\$183.34	\$183.34	Leonard Beverly S
665 090 42 00	1.00	SFD	1.00	1.00	1.00	\$183.34	\$183.34	Morales Cesar L&Aguilasoch Matilde
665 090 43 00	1.00	SFD	1.00	1.00	1.00	\$183.34	\$183.34	Garcia Francisco J&Abigail
665 090 44 00	1.00	SFD	1.00	1.00	1.00	\$183.34	\$183.34	Rodriguez Juan J&Bertha
665 090 45 00	1.00	SFD	1.00	1.00	1.00	\$183.34	\$183.34	Gomez Rafael
665 090 46 00	1.00	SFD	1.00	1.00	1.00	\$183.34	\$183.34	Perez Juan C&Deperez Lorena R
665 090 47 00	1.00	SFD	1.00	1.00	1.00	\$183.34	\$183.34	Bolanos Juan G&Sonia G
665 090 48 00	1.00	SFD	1.00	1.00	1.00	\$183.34	\$183.34	Garcia Arnulfo&Linda E
665 090 49 00	1.00	SFD	1.00	1.00	1.00	\$183.34	\$183.34	Cancino Manuel S&Blanca M 2017 Revocable Trus
665 090 50 00	1.00	SFD	1.00	1.00	1.00	\$183.34	\$183.34	Avila Roberto A&Ivonne L
665 090 51 00	1.00	SFD	1.00	1.00	1.00	\$183.34	\$183.34	Cabrera Edgar O&Gloria E
665 090 52 00	1.00	SFD	1.00	1.00	1.00	\$183.34	\$183.34	Rodriguez Yaneth F&Villarreal Victor J
665 090 53 00	1.00	SFD	1.00	1.00	1.00	\$183.34	\$183.34	Suase Joselito M&Melva M
665 090 54 00	1.00	SFD	1.00	1.00	1.00	\$183.34	\$183.34	Lwin Hemar T
665 090 55 00	1.00	SFD	1.00	1.00	1.00	\$183.34	\$183.34	Perez Victor&Herrera Angela
<b>TOTAL</b>	-	-	-	-	<b>501.89</b>	-	<b>\$92,016</b>	

<sup>(1)</sup> Applicable units (acres or dwelling units) dependent upon Land Use Code.  
<sup>(2)</sup> Refer to Assessment Engineer's Report for descriptions of Land Use Code and Land Use Factor.  
<sup>(3)</sup> Refer to Assessment Engineer's Report for applicable Benefit Factor.  
<sup>(4)</sup> FY 2019 is the City's Fiscal Year 2019, which begins July 1, 2018 and ends June 30, 2019.