



THE CITY OF SAN DIEGO

CONSOLIDATED PLAN ADVISORY BOARD MEETING AGENDA

for

WEDNESDAY JUNE 6, 2012, 9:00 A.M. – 10:00 A.M.

SAN DIEGO CIVIC CONCOURSE
ROOM 202 (GLASS ROOM)
202 'C' STREET
SAN DIEGO, CA 92101
(See attached map and directions.)

1. Call to Order

2. Approval of May 3, 2012 Meeting Minutes

3. Non-Agenda Public Comment

Non-Agenda Public comment may be made on any subject pertaining to the Consolidated Plan Advisory Board. Presenters have three (3) minutes.

4. Discussion and Action Items:

A. Presentation: Overview of the HOME Investment Partnerships Program

*Bill Luksic, HOME Program Coordinator
San Diego Housing Commission*

*Mirta Schloss, Director of Special Programs
San Diego Housing Commission*

B. Review and confirm regular meeting time/dates for remainder of 2012

5. Agenda Public Comment

Public comment may be made on any discussion item. Presenters have three (3) minutes.

6. Adjournment – 10:00 A.M.

Unfinished business shall be tabled and placed on the agenda of the following meeting.

THIS INFORMATION IS AVAILABLE IN ALTERNATIVE FORMATS UPON REQUEST.

To request an alternative format, or to request a sign language or oral interpreter for the meeting, please contact the Meeting Coordinator in the Economic Development Division at least five (5) working days before the meeting at (619) 236-6700 to ensure availability. Assistive Listening Devices (ALDs) are available for the meeting upon request.

SAN DIEGO CONCOURSE

202 C Street MS57C, San Diego Ca. 92101 / 619-236-7029 / 619-236-7016

South on Interstate 5

- 5 south to Front St./Civic Center off ramp
- Take left fork on off ramp to 2nd Ave.
- Turn right onto 2nd Ave.
- Travel 3 blocks to where 2nd Ave. intersects A St.
- Enter Concourse Parkade structure

North on Interstate 5

- 5 north to 6th Ave off ramp
- Turn left onto 6th Ave.
- Turn right onto Ash St.
- Turn left on 2nd Ave., travel one block to where 2nd Ave. intersects A St.
- Enter Concourse Parkade structure

Driving Directions to the San Diego Concourse

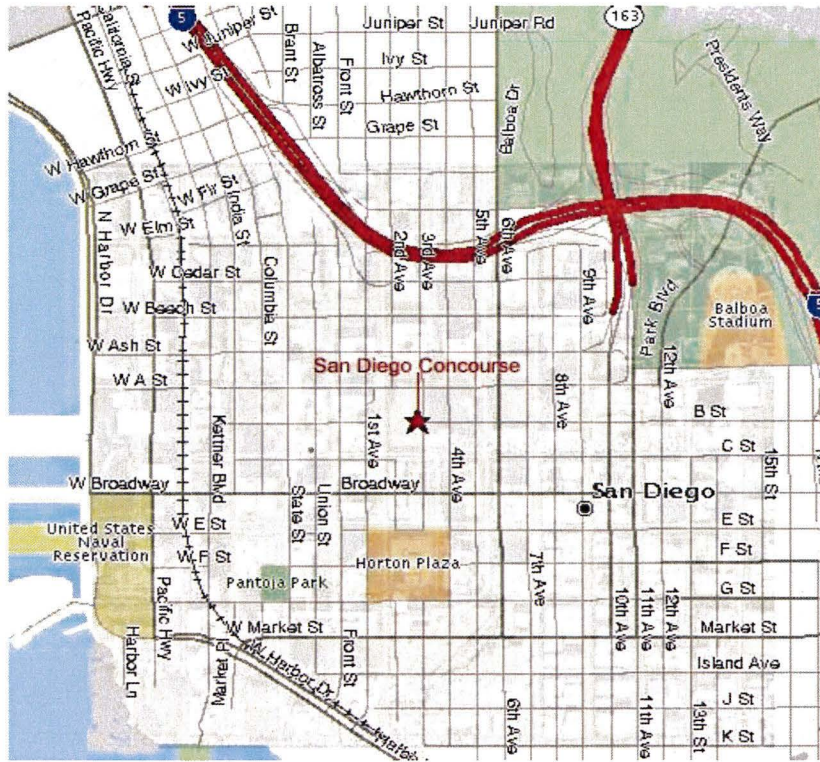

South on Interstate 15

- 15 south to 163 south
- 163 becomes 10th Ave.
- Right on B St.
- Right on 3rd Ave.
- Concourse Parkade entrance is first driveway on left.

West on 94 Freeway

- 94 west into Downtown
- 94 becomes F St.
- Right on 5th Ave.
- Left on B St.
- Right on 3rd Ave.
- Concourse Parkade entrance is first driveway on left.

PARKING

*Entrances

CONCOURSE PARKADE ENTRANCES:
1st and B Street
2nd and A Street
3rd and B Street

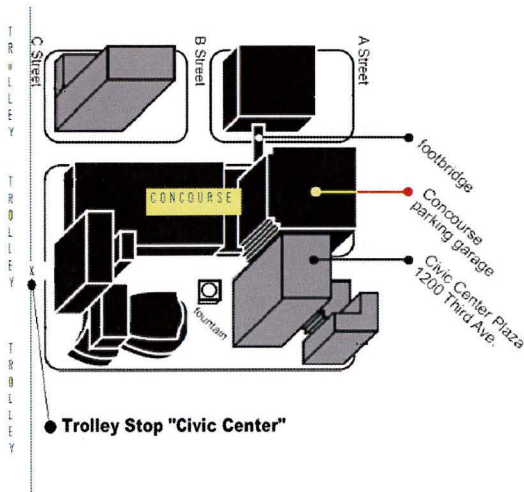

TROLLEY LINE

*Trolley stop is "Civic Center", location on 2nd and C Street.



SAN DIEGO CONOURSE BROCHURE

202 C Street MS57C, San Diego Ca. 92101 / 619-615-4100 / Fax 619-236-5994

Street Level

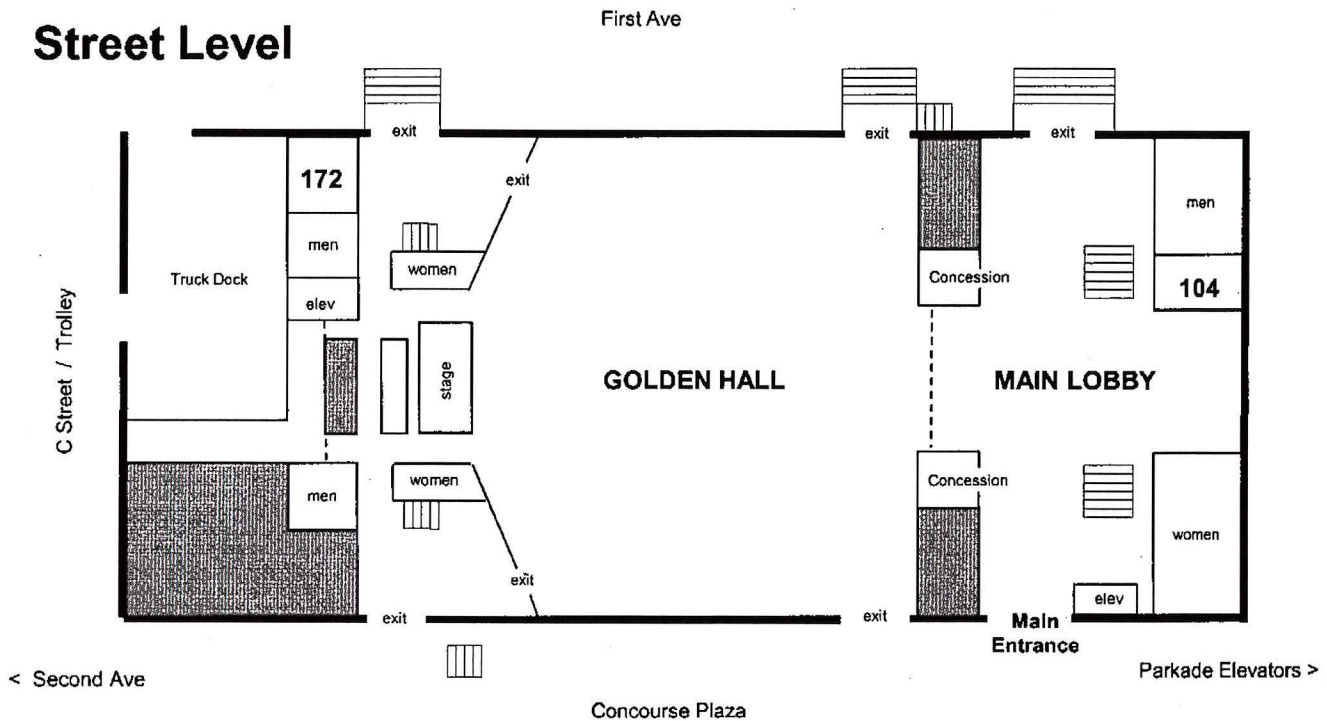

Second Level

