

CP22

CP22

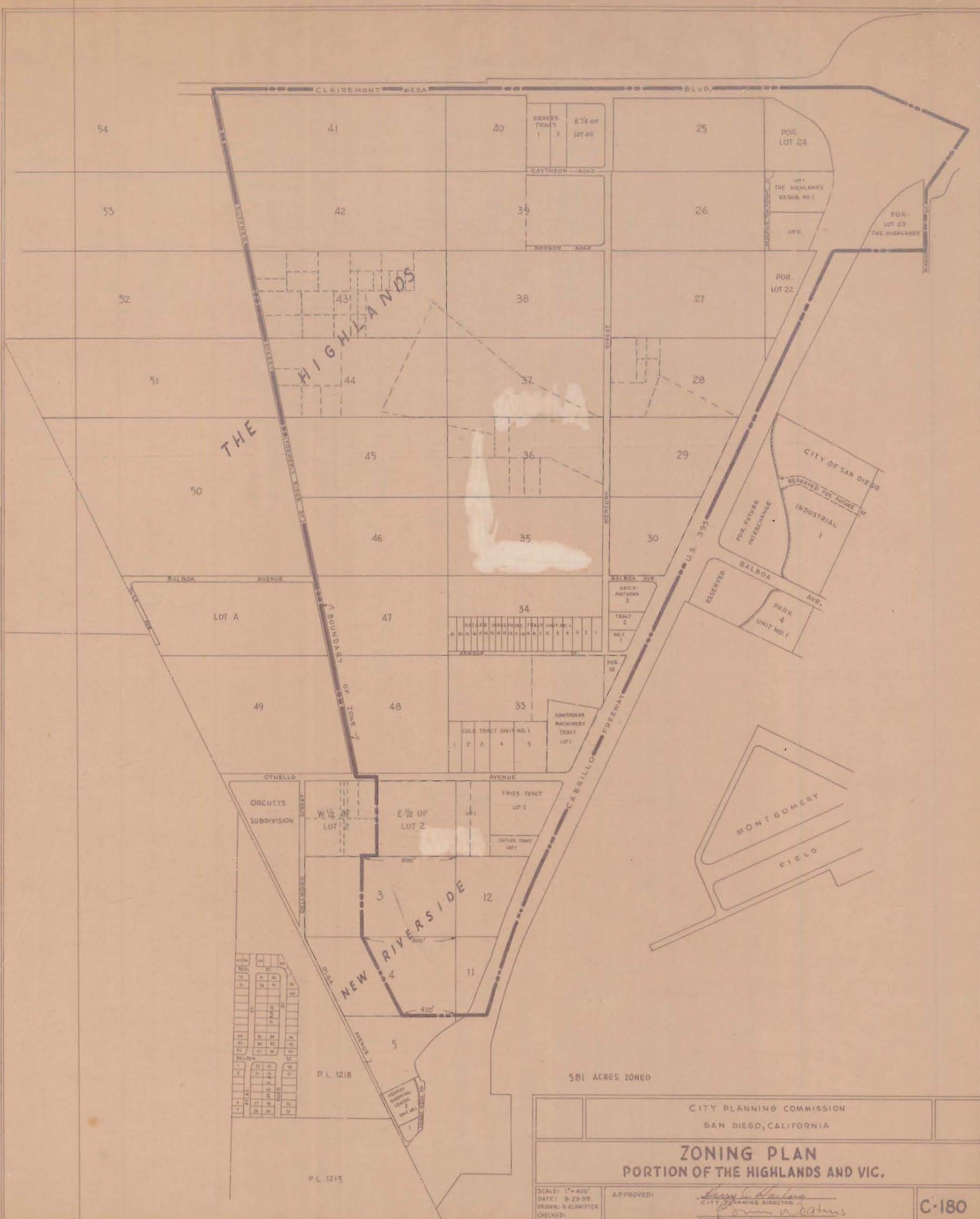

581 ACRES ZONED

CITY PLANNING COMMISSION
SAN DIEGO, CALIFORNIA

ZONING PLAN PORTION OF THE HIGHLANDS AND VIC.

SCALE: 1"=400'
DATE: 9-23-58
DRAWN: H. HANLWITZER
CHECKED:

APPROVED: *Henry L. Hartley*
CITY PLANNING DIRECTOR
William A. Matney
SECRETARY OF COMMISSION

C-180

CP22

CP22