

TOTAL ACREAGE OF ZONED AREA = 1051.42 ±

LEGEND

- | | |
|-------------------|---------------------|
| ⊙ NORTH, 500' | ⊙ S36°00'E, 835' |
| ⊙ S60°30'E, 370' | ⊙ S26°00'E, 785' |
| ⊙ SOUTH, 400' | ⊙ WEST, 400' |
| ⊙ S50°30'E, 1500' | ⊙ S0°51'44"E, 430'E |
| ⊙ S45°30'W, 170' | ⊙ S66°55'W, 410' |
| ⊙ S30°30'E, 350' | ⊙ SOUTH, 465' |
| ⊙ N48°00'E, 250' | ⊙ S21°17'E, 567' |
| ⊙ S34°30'E, 380' | ⊙ S34°43'E, 655' |
| ⊙ N28°30'E, 350' | ⊙ S20°00'E, 468' |
| ⊙ EAST, 330' | ⊙ N 82°3'E, 1770' |
| | ⊙ NORTH, 525' |

CITY PLANNING COMMISSION SAN DIEGO, CALIFORNIA		
ZONING PLAN POR'S. OF PL'S 1352-1362 & VIC.		
DATE: 6-14-60	CITY PLANNING DIRECTOR	C-189
SCALE: 1000'	SECRETARY OF COMMISSION	
DRAWN: JER.		
CHECKED:		

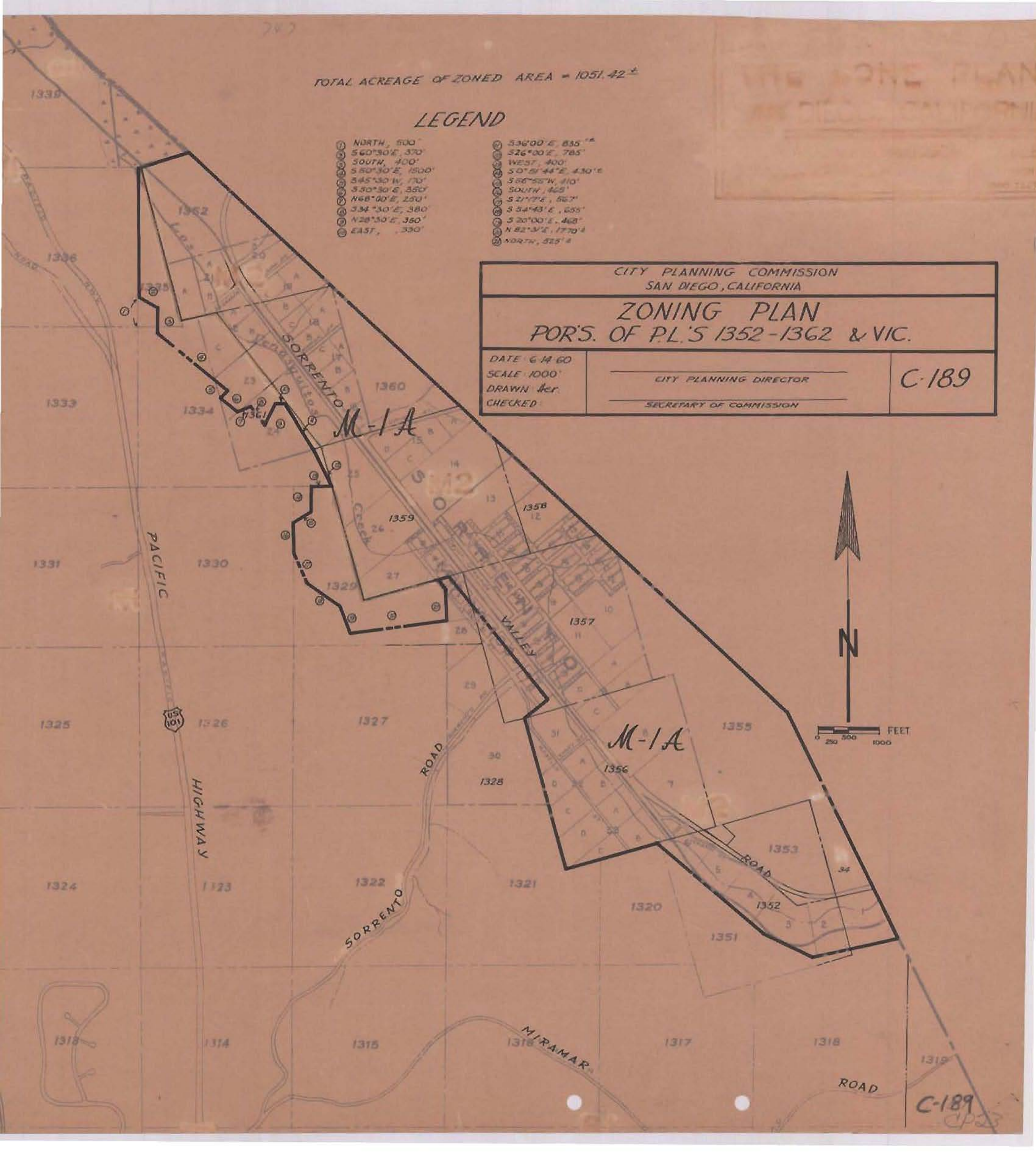

C-189
CP2