

CP7
c

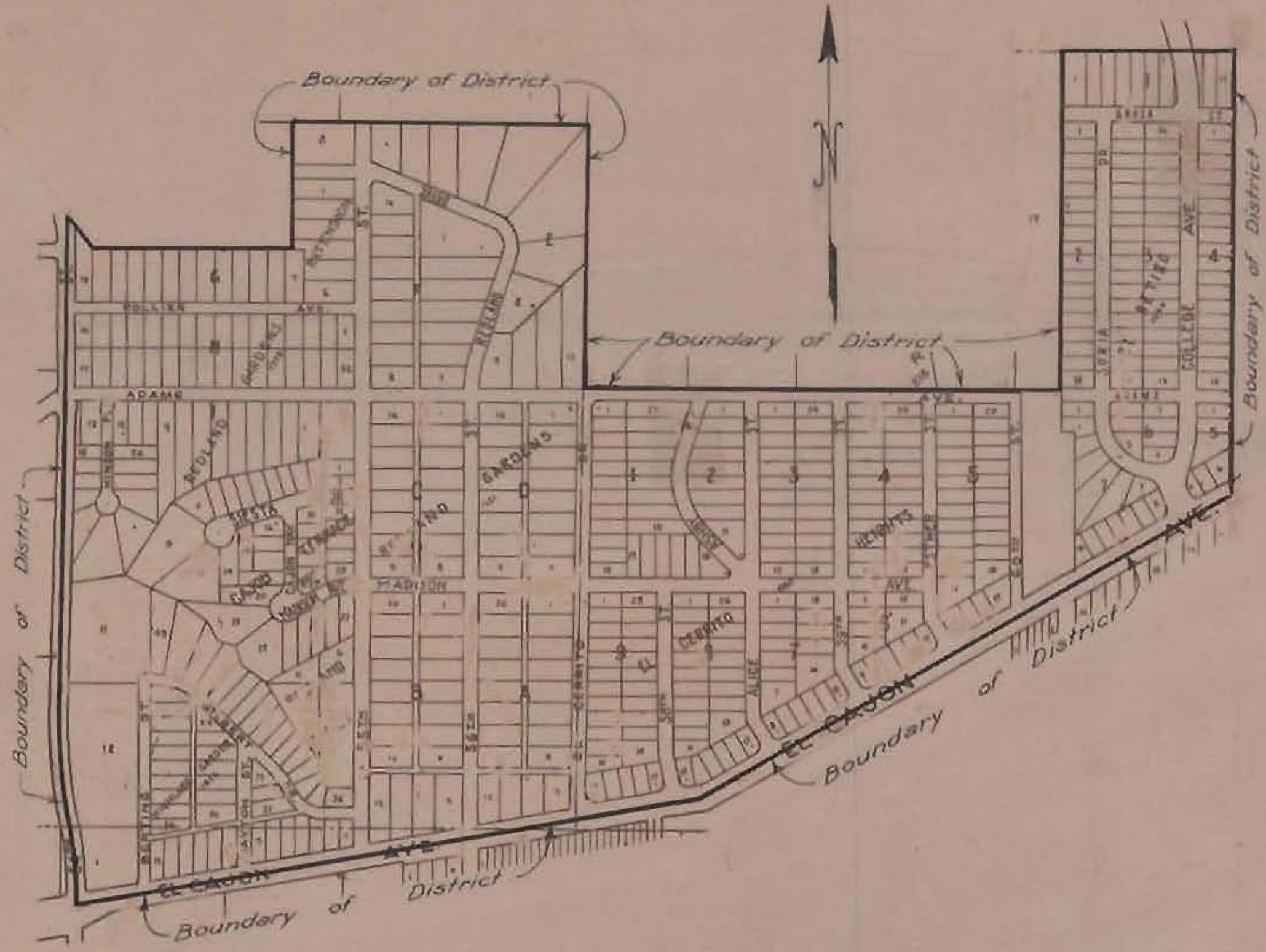

6
 ORD. # 935 (MS.)
 RES. # 64580
 EFFECTIVE
 DATE 8/8/36

CITY PLANNING COMMISSION SAN DIEGO, CALIFORNIA	
MAP OF A PORTION OF CITY OF SAN DIEGO to be placed under ARCHITECTURAL CONTROL	
APPROVED <i>Glen A. Rick</i> CITY PLANNING ENGINEER	SCALE IN FEET 0 100 200 400

CP7 C-29