

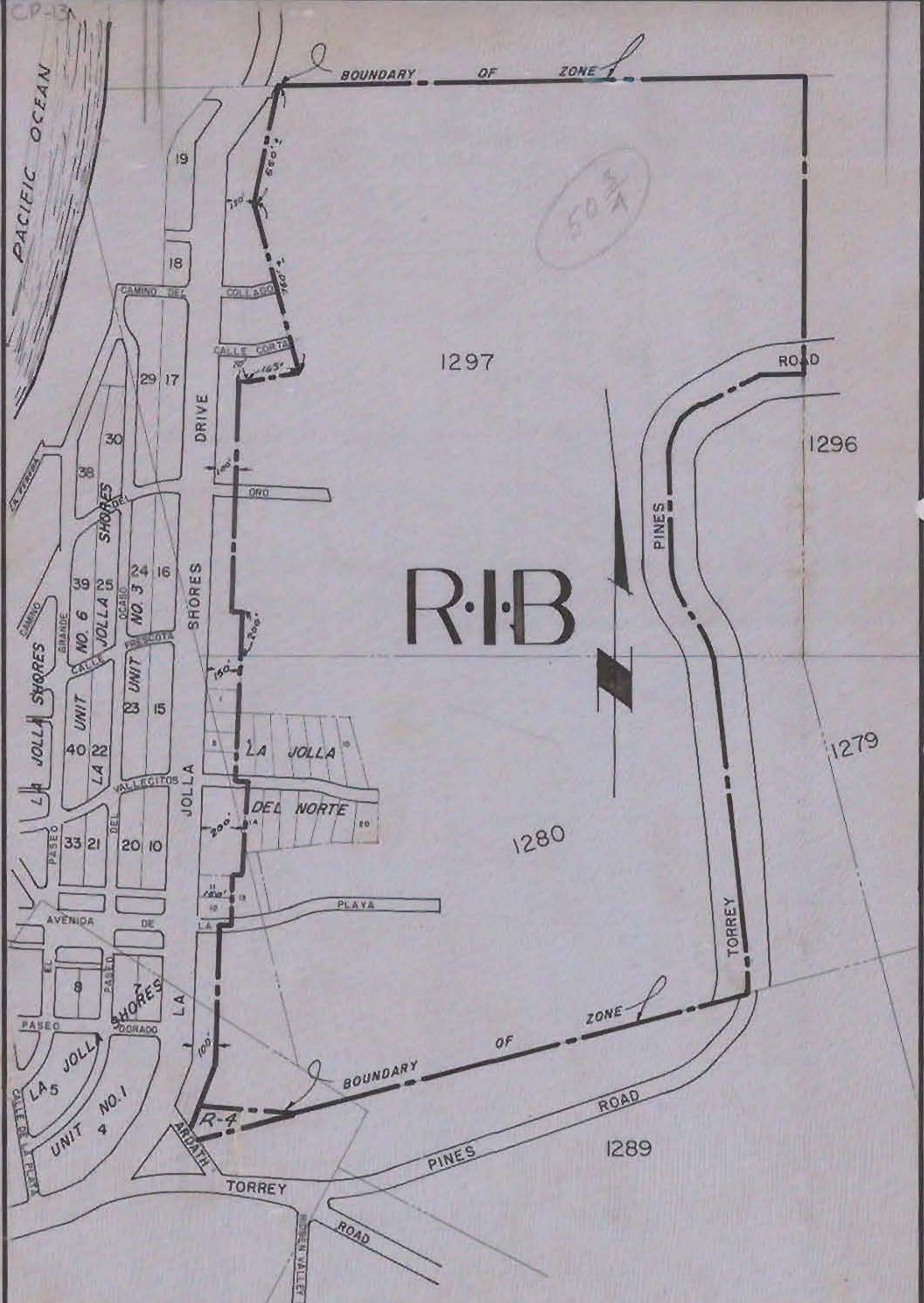
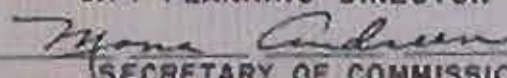

CP-3



231.55 Acres 0.00 0.00 0.00 10-26-52	CITY PLANNING COMMISSION SAN DIEGO CALIFORNIA	
ZONING PLAN PORTION P.L. 1297 & P.L. 1280		
SCALE 1" = 400' DATE 7-24-52 DRAWN J.J.S. CHECKED	APPROVED  CITY PLANNING DIRECTOR  SECRETARY OF COMMISSION	DRAWING NO. C-62