

MAKE 6 1/2" x 9" KATALITH NEG & 2 DULL PRINTS

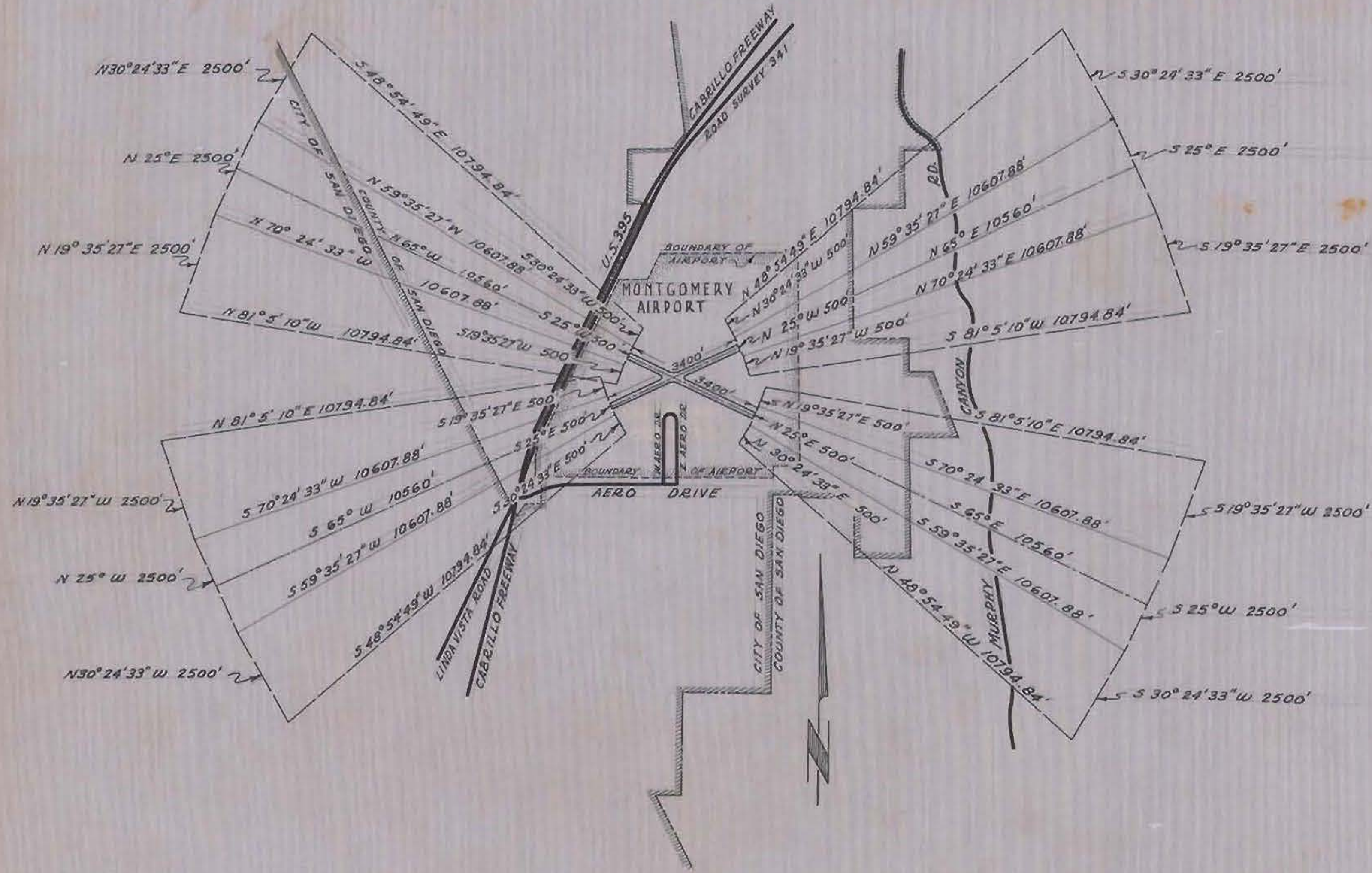

CITY PLANNING COMMISSION SAN DIEGO CALIFORNIA	
MONTGOMERY AIRPORT APPROACH AND TURNING ZONES	
SCALE 1"=2000' DATE 2-9-53 DRAWN L. MILNE CHECKED	APPROVED: <i>Harold A. Rick</i> CITY PLANNING DIRECTOR <i>Myron H. Anderson</i> SECRETARY OF COMMISSION
	DRAWING NO. C-87

400' 2 1/2"