



America's Finest City

THE CITY OF SAN DIEGO



# **Assessment Engineer's Report**

## **ROBINHOOD RIDGE MAINTENANCE ASSESSMENT DISTRICT**

**Annual Update for Fiscal Year 2015**

**under the provisions of the**

**San Diego Maintenance Assessment District Ordinance  
of the San Diego Municipal Code**

**and**

**Landscaping & Lighting Act of 1972  
of the California Streets & Highways Code**

**Prepared For**

**City of San Diego, California**

**Prepared By**

**EFS Engineering, Inc.**

**P.O. Box 22370**

**San Diego, CA 92192-2370**

**(858) 752-3490**

**June 2014**

# **CITY OF SAN DIEGO**

## **Mayor**

Kevin Faulconer

## **City Council Members**

Sherrí Lightner  
District 1 (Council President Pro Tem)

Ed Harris  
District 2

Todd Gloria  
District 3 (Council President)

Myrtle Cole  
District 4

Mark Kersey  
District 5

Lorie Zapf  
District 6

Scott Sherman  
District 7

David Alvarez  
District 8

Marti Emerald  
District 9

## **City Attorney**

Jan Goldsmith

## **Chief Operating Officer**

Scott Chadwick

## **City Clerk**

Elizabeth Maland

## **Independent Budget Analyst**

Andrea Tevlin

## **City Engineer**

James Nagelvoort

## **Assessment Engineer**

EFS Engineering, Inc.

# Table of Contents

---

Assessment Engineer's Report Robinhood Ridge Maintenance Assessment District	
Preamble .....	1
Executive Summary .....	2
Background .....	3
District Proceedings for Fiscal Year 2015 .....	3
Bond Declaration .....	4
District Boundary .....	4
Project Description .....	4
Separation of General and Special Benefits .....	5
City Standard .....	5
External Benefits.....	6
Cost Estimate .....	6
Estimated Costs.....	6
Annual Cost-Indexing.....	6
Method of Apportionment .....	7
Estimated Benefit of Improvements .....	7
Apportionment Methodology .....	8
Equivalent Benefit Units (EBUs) .....	8
Land Use Factor .....	8
Benefit Factor .....	9
Unit Assessment Rate .....	11
Sample Calculations .....	12
Summary Results .....	13

## EXHIBITS

Exhibit A: District Boundary, Zones & Improvements

Exhibit B: Estimated Annual Expenses, Revenues & Reserves

Exhibit C: Assessment Roll

# Assessment Engineer's Report

## Robinhood Ridge

### Maintenance Assessment District

---

#### Preamble

Pursuant to the provisions of the "San Diego Maintenance Assessment District Ordinance" (being Division 2, Article 5, Chapter VI beginning at Section 65.0201 of the San Diego Municipal Code), provisions of the "Landscaping and Lighting Act of 1972" (being Part 2 of Division 15 of the California Streets and Highways Code), applicable provisions of "Proposition 218" (being Article XIID of the California Constitution), and provisions of the "Proposition 218 Omnibus Implementation Act" (being California Senate Bill 919) (the aforementioned provisions are hereinafter referred to collectively as "Assessment Law"), in connection with the proceedings for the ROBINHOOD RIDGE MAINTENANCE ASSESSMENT DISTRICT (hereinafter referred to as "District"), EFS ENGINEERING, INC., as Assessment Engineer to the City of San Diego for these proceedings, submits herewith this report for the District as required by California Streets and Highways Code Section 22565.

FINAL APPROVAL, BY RESOLUTION NO. \_\_\_\_\_ ,  
ADOPTED BY THE CITY COUNCIL OF THE CITY OF SAN  
DIEGO, COUNTY OF SAN DIEGO, CALIFORNIA, ON THE  
\_\_\_\_\_ DAY OF \_\_\_\_\_, 2014.

---

Elizabeth Maland, CITY CLERK  
CITY OF SAN DIEGO  
STATE OF CALIFORNIA



## Executive Summary

**Project:** Robinhood Ridge  
 Maintenance Assessment District

**Apportionment Method:** Equivalent Benefit Unit (EBU)

	<b>FY 2014</b>	<b>FY 2015 <sup>(1)</sup></b>	<b>Maximum <sup>(2)</sup> Authorized</b>
<b>Total Parcels Assessed:</b>	620	620	--
<b>Total Estimated Assessment:</b>	\$103,445	\$105,215	--
<b>Total Number of EBUs:</b>	574.57	574.57	--
<b>Assessment per EBU:</b>	\$180.04	\$183.12	\$183.13 <sup>(3)</sup>

<sup>(1)</sup> FY 2015 is the City's Fiscal Year 2015, which begins July 1, 2014 and ends June 30, 2015. Total Parcels Assessed, Total Estimated Assessment, and Total Number of EBUs may vary from prior fiscal year values due to parcel changes and/or land use re-classifications.

<sup>(2)</sup> Maximum authorized annual amounts subject to cost-indexing provisions as set forth in this Assessment Engineer's Report.

<sup>(3)</sup> Prior fiscal year's maximum authorized annual assessment increased by cost-indexing factor of 1.71%.

**Proposition 218 Compliance:** The District was engineered in 1999 in compliance with Proposition 218. By a ballot proceeding, majority property owners approved Fiscal Year 2000 assessments, maximum authorized assessments for subsequent years, and provisions for annual cost-indexing.

**Annual Cost-Indexing:** The maximum authorized assessment rate has been increased based on the approved annual cost-indexing provisions.

**Bonds:** No bonds will be issued in connection with this District.



---

## Background

The Otay Mesa Planning Area is located between the City of Chula Vista and the United States-Mexico border, east of Interstate 805. The Ocean View Hills, Hidden Trails, Remington Hills and Robinhood Ridge developments comprise the majority of the developable land in the northwestern portion of the Otay Mesa Planning Area. In 1999, the City of San Diego (City) retained Boyle Engineering Corporation to prepare an Assessment Engineer's Report for the formation of the Northwest Otay Mesa Maintenance Assessment District (Northwest Otay Mesa District). By a mail ballot proceeding, property owners approved the formation of the Northwest Otay Mesa District. The Assessment Engineer's Report proposed Fiscal Year 2000 assessments, maximum authorized assessments for subsequent years, and provisions for annual cost-indexing of the maximum authorized assessments.

The improvements comprising the Northwest Otay Mesa District generally consist of landscaped and paved medians, native and revegetated open spaces, parks, hardscape features (sidewalks, curbs, gutters, etc.), and landscaped parkways. The purpose of the Northwest Otay Mesa District is to provide for the maintenance of these improvements. This annual Assessment Engineer's Report is for the Robinhood Ridge Maintenance Assessment District (District), formerly known as Zone 2 of the Northwest Otay Mesa District.

---

## District Proceedings for Fiscal Year 2015

This District is authorized and administered under the provisions of the "San Diego Maintenance Assessment District Ordinance" (being Division 2, Article 5, Chapter VI beginning at Section 65.0201 of the San Diego Municipal Code), provisions of the "Landscaping and Lighting Act of 1972" (being Part 2 of Division 15 of the California Streets and Highways Code), applicable provisions of "Proposition 218" (being Article XIID of the California Constitution), and provisions of the "Proposition 218 Omnibus Implementation Act" (being California Senate Bill 919) (the aforementioned provisions are hereinafter referred to collectively as "Assessment Law"). This report has been prepared in compliance with Assessment Law.



The purpose of the proposed proceedings and this Assessment Engineer's Report is to update the District budget and assessments for Fiscal Year 2015. The Fiscal Year 2015 assessments proposed within this Assessment Engineer's Report are equal to or less than the maximum authorized assessment. Therefore, the vote requirements of Section 4 of Article XIID do not apply to these proceedings.

A public hearing will be scheduled where public testimony will be heard by the Council, and the Council may, at its discretion, adopt a resolution ordering the levying of the proposed assessments.

### **Bond Declaration**

No bonds will be issued in connection with this District.

---

## **District Boundary**

The Boundary Map and Assessment Diagram for the District are on file in the Maintenance Assessment Districts section of the Park and Recreation Department of the City of San Diego and by reference are made a part of this report. The Boundary Map and Assessment Diagram for the District are available for public inspection during normal business hours. The District boundary, zone boundaries, and improvements are depicted in **Exhibit A**.

---

## **Project Description**

The project to be funded by the proposed assessments is the maintenance of landscaped rights-of-way and natural open space areas. The approximate locations of the improvements to be maintained by the District are depicted in **Exhibit A**.

Maintenance activities include, but are not limited to, turf mowing and edging, irrigation, collection and disposal of fallen branches and trees, revegetation and replacement of damaged plant material, tree and bush trimming, fertilizing, weeding, ongoing inspection, and repairs. Brush management of City-owned open space in accordance with the Municipal Code §142.0412 is performed by the City's General Fund.

The engineering drawings for the improvements to be maintained by the District are on file at Maps and Records in the Development Services Department and are incorporated herein by reference. The



improvements and services provided by the District will be maintained in accordance with specifications and contracts on file with the Park and Recreation Department. These documents are available for public inspection during normal business hours.

---

## Separation of General and Special Benefits

The identified improvements/services provide benefits to the parcels located within the District. Some of these benefits are “special benefits,” benefits that are above and beyond the City’s standard level of service, and exclusive of those “general benefits” provided to the public at large or properties located outside the District. Under Assessment Law, only “special benefits” are assessable. As such, isolation and quantification of the “special benefits” associated with the improvements/services are paramount, and illustrated in the following equations:

$$\text{Special Benefits} = \text{Total Benefits} - \text{General Benefits}$$

$$\text{General Benefits} = \text{City Standard} + \text{External Benefits}$$

$$\text{Special Benefits} = \text{Total Benefits} - [\text{City Standard} + \text{External Benefits}]$$

In these equations, “Total Benefits” refers to the cost of providing the total benefits of the improvements/services; “City Standard” represents the cost of providing the City’s standard level of service; and “External Benefits” refers to the cost of those additional benefits accruing to the public at large or properties located outside the District. In order to isolate the “Special Benefits,” it is necessary to quantify the amount of “General Benefits” associated with the improvements/services.

### City Standard

As a “general benefit” (not funded by assessments), the District will continue to receive the standard level of service provided to the public at large under City-funded and administered programs for maintenance and servicing of public facilities and improvements (e.g., medians, open space, street lights, street trees, sidewalks, parks, etc.), including street sweeping and graffiti removal on public property. Consistent





with City policy for the public at large, the City will provide the District with standard service levels and annual contributions from the Environmental Growth Fund for open space maintenance (\$68.32 per acre for Fiscal Year 2015). These levels of service and cost allocations, reviewed and adjusted annually by the City, are “general benefits” administered by the District.

### External Benefits

Assessment Law prohibits levying assessments to pay for “general benefits” conferred to the public at large or properties located outside the District. Based on a review of the spatial limits of the District and the proposed improvements/services, it has been determined that the maintenance and servicing of the improvements has the potential to confer benefits to others outside the District.

It is estimated as much as 0.9% of the total benefit (in excess of the City standard) may accrue to the public at large or properties located outside the District (with an estimated 0.0% accruing directly to properties located outside the District, and the remaining 0.9% accruing to the general public as indirect/incidental beneficiaries passing through the District or utilizing District-provided amenities). The estimated costs associated with these “general benefits” have been quantified and will not be funded by assessments.

---

## Cost Estimate

### Estimated Costs

Estimated Fiscal Year 2015 annual expenses, revenues, reserves, and assessments (provided by the City) are included as **Exhibit B** hereto.

### Annual Cost-Indexing

With the passage of Proposition 218, any proposed increase in assessments must be placed for approval before the property owners by a mail ballot and a public hearing process, similar to these proceedings. A majority of ballots received must be affirmative for the City Council to confirm and levy the increased assessments. For small assessment districts or districts with relatively low dollar assessments,



the cost of an engineer's report, balloting, and the public hearing process can potentially exceed the total cost of the increase. These incidental costs of the proceedings can be added to the assessments, resulting in even higher assessments.

Indexing assessments annually to the San Diego Consumer Price Index for Urban Consumers (SDCPI-U), as approved by the District property owners in Fiscal Year 2000, allows for minor increases for normal maintenance and operating cost escalation without incurring the costs of the Proposition 218 ballot proceedings. Any significant change in the assessment initiated by an increase in service provided or other significant changes to the District would still require the Proposition 218 proceedings and property owner approval.

The maximum authorized assessment established in the Fiscal Year 2000 proceedings are authorized to be indexed (increased or decreased) annually by the factor published in the SDCPI-U. The annual change in second half SDCPI-U values, as compiled by the U.S. Bureau of Labor Statistics (see [www.bls.gov](http://www.bls.gov)), for the prior year period was from 257.285 to 261.679 (a 1.71% increase). In accordance with the approved cost-indexing provisions, the maximum authorized assessment rates contained within this Assessment Engineer's Report have been increased by 1.71%.

---

## Method of Apportionment

### Estimated Benefit of Improvements

The Transportation Element of the City's General Plan and the general policy recommendations found in the Otay Mesa Community Plan establish several goals for the community's transportation system. The improvements being maintained by this District are consistent with the plans' goals for safety and pleasing aesthetics.

The major and arterial streets within the District are the backbone of the street network within the community. They serve as the primary access routes for inter-community and intra-community trips. The collector/neighborhood streets within the District serve as the primary access routes to and from the major and arterial streets for parcels within a neighborhood.

The Northwest Otay Mesa District is been sub-divided into three (3)



zones as shown in **Exhibit A**. Parcels within each zone have been assessed for the maintenance of the improvements on the streets, open space and public landscape maintenance easement areas located within the zone.

### Apportionment Methodology

The total assessment for a given parcel is equal to the parcel's total EBUs multiplied by the Unit Assessment Rate (unique to the zone in which parcel is situated) as shown in the following equation:

$$\text{Total Assessment} = \text{Total EBUs} \times \text{Unit Assessment Rate}$$

### Equivalent Benefit Units (EBUs)

EBUs for each parcel have been determined as a function of two factors, a Land Use Factor and a Benefit Factor, related as shown in the following equation:

$$\text{EBUs} = (\text{Acres or Units}) \times \text{Land Use Factor} \times \text{Benefit Factor}$$

Each of these factors is discussed below.

#### **Land Use Factor**

Since the improvements to be maintained by the District are primarily associated with the Transportation Element of the General and Community Plans, trip generation rates for various land use categories (as previously established by the City's Transportation Planning Section) have been used as the primary basis for the development of Land Use Factors. While these trip generation rates strictly address only vehicular trips, they are also considered to approximately reflect relative trip generation for other modes of transportation (e.g., pedestrian trips, bicycle trips, etc.), and are considered the best available information for these other transportation modes.

The special benefits of the improvements maintained by the District are linked to trip generation primarily by the public safety and aesthetic enhancement enjoyed by travelers through the community. Trip generation rates provide the required nexus and



basis for assigning ratios of maximum potential benefit to the various land use/zoning classifications as defined by the City's Municipal Code.

Land use/zoning classifications have been grouped with averaged trip generation rates assigned to establish the Land Use Factors as shown in **Table 1**.

**TABLE 1: Land Use Factors**

Land Use/Zoning	Code	Land Use Factor
Residential – Single Family (detached)	SFD	1.0 per dwelling unit
Residential – Condominium	CND	0.7 per dwelling unit
Residential – Multi-Family & Apartment	MFR	0.7 per dwelling unit
Commercial – Office & Retail	COM	45.0 per acre
Educational – Primary & Secondary	EPS	5.0 per acre
House of Worship	CRH	2.8 per acre
Industrial	IND	15.0 per acre
Open Space (designated)	OSP	0.0 per acre
Park – Developed	PKD	5.0 per acre
Park – Undeveloped	PKU	0.5 per acre
Undevelopable	UND	0.0 per acre

Designated Open Space serves primarily to preserve natural landscape and habitat. While access for study and passive recreation is sometimes permitted, these activities are usually allowed only to the limited extent consistent with the primary purpose of natural preservation. Since this land is essentially “unused” in the customary terms of land use (which relate to human use, not use by nature), the trip generation rate is zero. Therefore, the designated Open Space receives no benefit from the Transportation Element and has been assigned a Land Use Factor of zero.

***Benefit Factor***

The Land Use Factor described above reflects the relative intensity of use (or potential use) of the various parcels of land to be assessed. It does not address the relationship of this use to the specific improvements to be maintained by the District. This



relationship is reflected in the Benefit Factor utilized in the assessment methodology.

In determining the Benefit Factor for each land use category, the subcomponents of the benefits of District improvements considered may include some or all of the following: public safety, view corridors and aesthetics, enhancement of community identity, drainage corridors, and recreational potential. As Benefit Factors and their subcomponents are intended to reflect the particular relationships between specific land uses within a district and the specific improvements maintained by the district, Benefit Factors will generally vary from one district to another, based on the specific character and nature of the applicable land uses and improvements maintained.

The applicable benefit subcomponents and resultant composite Benefit Factors determined for the various land use/zoning categories within this District are as shown in **Table 2**.

**TABLE 2: Benefit Factors by Land Use**

<b>Land Use/Zoning</b>	<b>Public Safety (max. 0.4)</b>	<b>Aesthetics (max. 0.6)</b>	<b>Composite Benefit Factor (max. 1.0)</b>
Residential – All	0.4	0.6	1.0
Commercial – Office & Retail	0.4	0.3	0.7
Educational – Primary & Secondary	0.4	0.3	0.7
House of Worship	0.4	0.3	0.7
Industrial	0.4	0.3	0.7
Open Space (designated)	0.4	0.0	0.4
Park – Developed	0.4	0.0	0.4
Park – Undeveloped	0.4	0.0	0.4
Undevelopable	0.4	0.0	0.4

**Public Safety.** All land uses are considered to receive the maximum available benefit from the public safety element of District improvements. Public safety is essential to all land uses, and even to lands, such as designated Open Space, held in stewardship with only incidental human use.

**Aesthetics.** The degree of benefit received from the aesthetic



qualities of landscaped and hardscaped roadway medians and rights-of-way maintained by the District varies among land use categories. Generally, by nature of their use, residential lands receive the greatest benefit from the reduced traffic congestion, reduced noise levels, greater separation from traffic and generally more tranquil environment provided by landscaped and hardscaped roadway medians and rights-of-way. Commercial, industrial and institutional uses, on the other hand, often thrive on higher densities, greater traffic access, and a higher level of activity in the vicinity of their enterprises. These uses, accordingly, receive a lesser degree of benefit from the general insulation and separation provided by the aesthetic elements of District improvements.

Lands in the Open Space category are considered to receive no significant benefit from the aesthetic elements of District improvements, as enhanced aesthetic quality of other lands in the vicinity does not affect their function, use, or value. Lands in the Park category are considered to receive no significant benefit from the aesthetic elements of District improvements, as the aesthetic values of these lands are themselves so high that they are little enhanced by those of other lands in their vicinity.

### **Unit Assessment Rate**

As previously mentioned, all parcels have been assessed for the maintenance of improvements located within their respective zone. The Unit Assessment Rate (rate per EBU) for a given zone is equal to the total zone maintenance cost divided by the total zone EBUs:

$\text{Unit Assessment Rate} = \text{Total Zone Maintenance Cost} / \text{Total Zone EBUs}$
---



### Sample Calculations

As described above, the number of Equivalent Benefit Units (EBUs) assigned to each parcel in the District has been calculated based on each parcel's land use and the identified apportionment factors, as shown in the following equation:

$\text{EBUs} = (\text{Acres or Units}) \times \text{Land Use Factor} \times \text{Benefit Factor}$
--

Shown below are sample EBU calculations for several common land uses found in the District.

- **1 Single-Family Residence**  
EBUs = 1 unit x 1.00 x 1.00 = 1.00 EBUs
- **1 Condominium**  
EBUs = 1 unit x 0.70 x 1.00 = 0.70 EBUs
- **5-acre Park without Recreation Center**  
EBUs = 5.00 acres x 0.50 x 0.40 = 1.00 EBUs

The total assessment for each parcel in the District is based on the calculated EBUs for the parcel and the applicable unit assessment rate, as shown in the following equation:

$\text{Total Assessment} = \text{Total EBUs} \times \text{Unit Assessment Rate}$
--

Based on the above formula, the EBUs, unit assessment rate, and total assessment calculated for each property, can be found in the Assessment Roll (**Exhibit C**).



---

## Summary Results

The District boundary, zone boundaries, and improvements are shown in **Exhibit A**.

An estimate of the costs of the improvements provided by the District is included as **Exhibit B** to this report.

The assessment methodology utilized is as described in the text of this report. Based on this methodology, the EBUs and Fiscal Year 2015 District assessment for each parcel were calculated and are shown in the Assessment Roll (**Exhibit C**).

Each lot or parcel of land within the District has been identified by unique County Assessor's Parcel Number on the Assessment Roll and the Boundary Map and Assessment Diagram referenced herein. The net assessment for each parcel for Fiscal Year 2015 can be found on the Assessment Roll.

This report has been prepared and respectfully submitted by:

EFS ENGINEERING, INC.

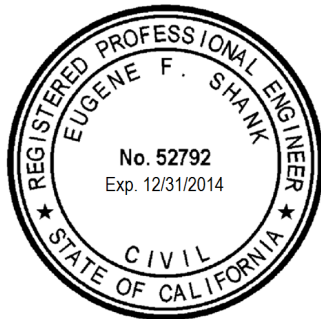

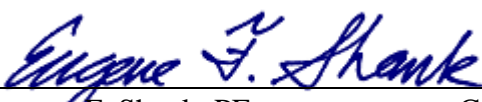
  
Eugene F. Shank, PE C 52792

  
Sharon F. Risse





I, \_\_\_\_\_, as CITY CLERK of the CITY OF SAN DIEGO, COUNTY OF SAN DIEGO, CALIFORNIA, do hereby certify that the Assessment as shown on the Assessment Roll, together with the Assessment Diagram, both of which are incorporated into this report, were filed in my office on the \_\_\_\_ day of \_\_\_\_\_, 2014.

---

Elizabeth Maland, CITY CLERK  
CITY OF SAN DIEGO  
STATE OF CALIFORNIA

I, \_\_\_\_\_, as CITY CLERK of the CITY OF SAN DIEGO, COUNTY OF SAN DIEGO, CALIFORNIA, do hereby certify that the foregoing Assessment, together with the Assessment Diagram incorporated into this report, was approved and confirmed by the CITY COUNCIL of said City on the \_\_\_\_ day of \_\_\_\_\_, 2014.

---

Elizabeth Maland, CITY CLERK  
CITY OF SAN DIEGO  
STATE OF CALIFORNIA

---

# **EXHIBIT A**

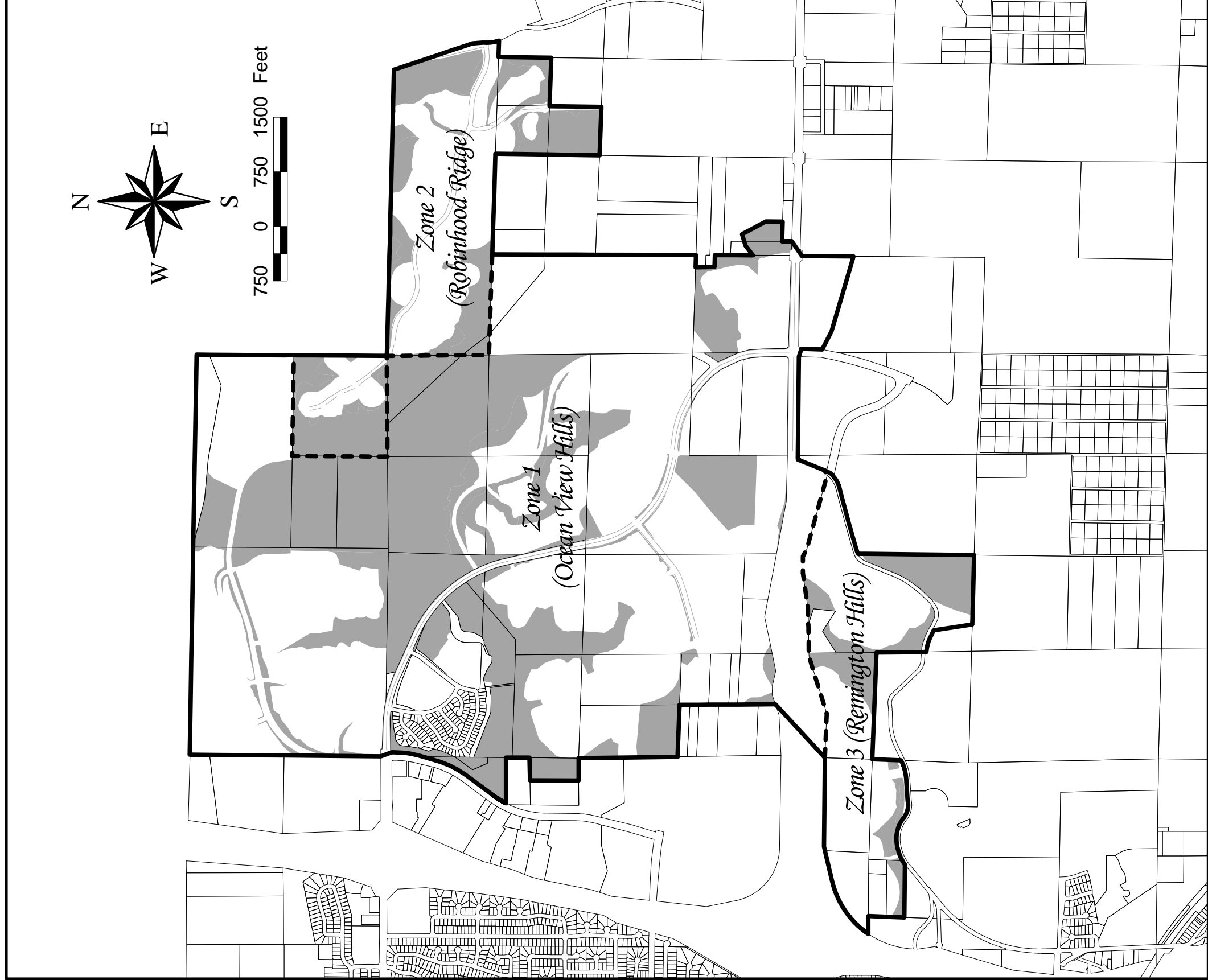

**NOTE**

1. This map is for exhibit purposes only. Please refer to the Northwest Otay Mesa Maintenance Assessment District Boundary Map on file at the City.
2. Each lot or parcel on this map has been identified by the County Assessor's Parcel Number in the Assessment Roll contained in the Engineer's Report.
3. For a detailed description of the lines and dimensions of lots or parcels shown on this map, refer to the County Assessor's Maps which shall govern with respect to all details concerning the lines and dimensions of such lots or parcels.

**LEGEND**

- District Boundary
- Zone Boundary
- Parcel Lines
- Improvements

CITY OF SAN DIEGO / NORTHWEST OTAY MESA MAINTENANCE ASSESSMENT DISTRICT

**EXHIBIT A - District Boundary, Zones & Improvements**

# **EXHIBIT B**

# EXHIBIT B

**Park and Recreation Department - Open Space Division  
Maintenance Assessment Districts Program  
Summary of Fiscal Year 2015 (07-01-14 to 06-30-15) Budget**

**Robinhood Ridge Maintenance Assessment District  
Fund 200097**

	FY 2013	FY 2014	FY 2015
	Unaudited Actuals	Estimate	Proposed
<b>Full-Time Equivalent/Grounds Maintenance Manager</b>	<b>0.10</b>	<b>0.10</b>	<b>0.20</b>
<b><u>District Personnel Costs</u></b>			
<b>Total Labor &amp; Fringe</b>	<b>\$ 10,353.00</b>	<b>\$ 10,736.00</b>	<b>\$ 23,153.00</b>
<b><u>District Non-Personnel Costs</u></b>			
Contract Services			
Landscaping Service - Brewer Lawn Maintenance <u>Contract Expires: 08/31/17</u> (512134)	\$ 67,174.09	\$ 66,399.00	\$ 60,000.00
Tree Trimming (512197)	\$ -	\$ 5,000.00	\$ 2,000.00
City Services - Developed Regional Parks (Arborist Services) (512114)	\$ -	\$ 500.00	\$ 500.00
Supplies - Garden Nursery Stock and Small Tools (511028, 511069)	\$ 10.00	\$ 200.00	\$ 200.00
Special Districts Administration (516024A)	\$ 6,551.00	\$ 6,551.00	\$ 8,447.00
Vehicle Usage & Assignment (516024B)	\$ 741.00	\$ 741.00	\$ 1,555.00
Water / Storm Drain / Electrical	\$ 27,061.46	\$ 24,817.00	\$ 36,356.00
<b>Subtotal Non-Personnel Costs</b>	<b>\$ 101,537.55</b>	<b>\$ 104,208.00</b>	<b>\$ 109,058.00</b>
<b>TOTAL EXPENSE</b>	<b>\$ 111,890.55</b>	<b>\$ 114,944.00</b>	<b>\$ 132,211.00</b>
<b><u>District Revenues</u></b>			
Special Assessments	\$ 86,475.03	\$ 103,451.00	\$ 105,215.48 <sup>(1)</sup>
Interest Earnings	\$ 361.24	\$ 330.00	\$ 300.00
City Contributions <sup>(2)</sup>			
Environmental Growth Fund	\$ 4,337.00	\$ 5,790.00	\$ 6,206.00
General Fund – General Benefit Offset	\$ -	\$ -	\$ 1,189.90
Miscellaneous			
Tree Damage Recovery (422217)	\$ -	\$ 3,109.00	\$ -
<b>TOTAL REVENUE</b>	<b>\$ 91,173.27</b>	<b>\$ 112,680.00</b>	<b>\$ 112,911.38</b>
<b><u>District Reserves</u></b>			
Beginning Fund Balance	\$ 77,308.00	\$ 56,590.00	\$ 54,326.00
Change in Fund Balance	\$ (20,718.00)	\$ (2,264.00)	\$ (19,299.62)
<b>Year End Operating Reserves</b>	<b>\$ 56,590.00</b>	<b>\$ 54,326.00</b>	<b>\$ 35,026.38</b>

<sup>(1)</sup> Special assessments revenue adjusted to reflect latest parcel information and applicable cost-indexing provisions.

<sup>(2)</sup> City Contributions each Fiscal Year are subject to change pending Council approval of new rate per square foot/acreage.

# **EXHIBIT C**

**ASSESSMENT ENGINEER'S REPORT**  
**ASSESSMENT ROLL**

The undersigned, pursuant to the "Maintenance Assessment Districts Ordinance" (Division 2, Article 5, Chapter VI beginning at Section 65.0201 of the San Diego Municipal Code), the "Landscaping and Lighting Act of 1972" (Part 2, Division 15 of the California Streets and Highways Code), applicable provisions of "Proposition 218" (Article XIID of the California Constitution), and the "Proposition 218 Omnibus Implementation Act" (California Senate Bill 919) (the aforementioned provisions are hereinafter referred to collectively as "Assessment Law"), does hereby submit the following:

1. Pursuant to the provisions of Assessment Law and the Resolution of Intention, we have assessed the costs and expenses of the works of improvement (maintenance) to be performed in the Assessment District upon the parcels of land in the Assessment District benefited thereby in direct proportion and relation to the estimated benefits to be received by each of said parcels. For particulars as to the identification of said parcels, reference is made to the Assessment Diagram and Boundary Map on file in the Maintenance Assessment Districts section of the Park and Recreation Department of the City of San Diego. The District boundary, zones boundaries, and improvements are depicted in the Assessment Engineer's Report as **Exhibit A**.
2. The Assessment Diagram included in this report shows the Assessment District, as well as the boundaries and dimensions of the respective parcels and subdivisions of land within the Assessment District, the same as existed at the time of the passage of the Resolution of Intention, each of which subdivisions of land or parcels or lots respectively have been given a separate number upon the Assessment Diagram and in the Assessment Roll (**Exhibit C**).
3. By virtue of the authority contained in said Assessment Law, and by further direction and order of the legislative body, we hereby make the following assessment to cover the costs and expenses of the works of improvement (maintenance) for the Assessment District based on the costs and expenses as set forth in the Assessment Engineer's Report.

For particulars as to the individual assessments and their descriptions, reference is made to the Assessment Roll (**Exhibit C**) attached hereto.

DATED: June 13, 2014

EFS ENGINEERING, INC.



By: Eugene F. Shank  
Eugene F. Shank, PE C 52792

By: Sharon F. Risse  
Sharon F. Risse

**EXHIBIT C - Assessment Roll (Fiscal Year 2015)**  
**Robinhood Ridge Maintenance Assessment District**

Parcel Number	Acres/ Units <sup>(1)</sup>	Land Use <sup>(2)</sup>	NW Otay Zone	Apportionment Factors		Total EBU's	FY 2015 <sup>(4)</sup>		Owner Name
				Land Use <sup>(2)</sup>	Benefit <sup>(3)</sup>		Unit Cost	Assessment	
645 051 04 00	14.45	OSP	2	0.00	0.40	0.00	\$183.12	\$0.00	City Of San Diego
645 051 05 00	1.12	OSP	2	0.00	0.40	0.00	\$183.12	\$0.00	Greystone Homes Inc
645 230 01 00	1.00	SFD	2	1.00	1.00	1.00	\$183.12	\$183.12	Rosales David J
645 230 02 00	1.00	SFD	2	1.00	1.00	1.00	\$183.12	\$183.12	Keema John M Jr&Maria T <Dva>
645 230 03 00	1.00	SFD	2	1.00	1.00	1.00	\$183.12	\$183.12	Canlas Dennis C&Joy B
645 230 04 00	1.00	SFD	2	1.00	1.00	1.00	\$183.12	\$183.12	Salazar Erasmo A
645 230 05 00	1.00	SFD	2	1.00	1.00	1.00	\$183.12	\$183.12	Hembera Trevor Jon&Griselda
645 230 06 00	1.00	SFD	2	1.00	1.00	1.00	\$183.12	\$183.12	Rodriguez Sylvia E
645 230 07 00	1.00	SFD	2	1.00	1.00	1.00	\$183.12	\$183.12	Rodriguez Rigoberto&Ronda L
645 230 08 00	1.00	SFD	2	1.00	1.00	1.00	\$183.12	\$183.12	Enriquez Alfredo R&Yolanda
645 230 09 00	1.00	SFD	2	1.00	1.00	1.00	\$183.12	\$183.12	Ramos Shawn S&Lennie E
645 230 10 00	1.00	SFD	2	1.00	1.00	1.00	\$183.12	\$183.12	Perez Guillermina
645 230 11 00	1.00	SFD	2	1.00	1.00	1.00	\$183.12	\$183.12	Gaza Family Trust 02-09-06
645 230 12 00	1.00	SFD	2	1.00	1.00	1.00	\$183.12	\$183.12	Valaskantjis Margitsa M
645 230 13 00	1.00	SFD	2	1.00	1.00	1.00	\$183.12	\$183.12	Agundez Robert
645 230 14 00	1.00	SFD	2	1.00	1.00	1.00	\$183.12	\$183.12	Torres Emery S&Maria C
645 230 15 00	1.00	SFD	2	1.00	1.00	1.00	\$183.12	\$183.12	Washington Julius C&Terry D
645 230 16 00	1.00	SFD	2	1.00	1.00	1.00	\$183.12	\$183.12	Nguyen Tuan H&Phuong T
645 230 17 00	1.00	SFD	2	1.00	1.00	1.00	\$183.12	\$183.12	Hawkins Daniel W
645 230 18 00	1.00	SFD	2	1.00	1.00	1.00	\$183.12	\$183.12	Ruvalcaba Pedro
645 230 19 00	1.00	SFD	2	1.00	1.00	1.00	\$183.12	\$183.12	Sortdesanz Eduardo H&Patricia G
645 230 20 00	1.00	SFD	2	1.00	1.00	1.00	\$183.12	\$183.12	Villanueva Emilia
645 230 21 00	1.00	SFD	2	1.00	1.00	1.00	\$183.12	\$183.12	Chee Adriana
645 230 22 00	1.00	SFD	2	1.00	1.00	1.00	\$183.12	\$183.12	Lozano Jose A&Cynthia
645 230 23 00	1.00	SFD	2	1.00	1.00	1.00	\$183.12	\$183.12	Ware Mark A&Lynda R
645 230 24 00	1.00	SFD	2	1.00	1.00	1.00	\$183.12	\$183.12	Zapanta Edward M&Joan U
645 230 25 00	1.00	SFD	2	1.00	1.00	1.00	\$183.12	\$183.12	Araujo Elvia M
645 230 32 00	1.00	SFD	2	1.00	1.00	1.00	\$183.12	\$183.12	Bass Shamar&Carla
645 230 33 00	1.00	SFD	2	1.00	1.00	1.00	\$183.12	\$183.12	Mcgaughy Marilyn M
645 230 37 00	1.00	SFD	2	1.00	1.00	1.00	\$183.12	\$183.12	Macias Martin
645 230 38 00	1.00	SFD	2	1.00	1.00	1.00	\$183.12	\$183.12	Zambrano Mario&Edna M
645 230 39 00	1.00	SFD	2	1.00	1.00	1.00	\$183.12	\$183.12	Gelacio Romel R
645 230 40 00	1.00	SFD	2	1.00	1.00	1.00	\$183.12	\$183.12	Hipolito Family Trust 05-27-05
645 230 41 00	1.00	SFD	2	1.00	1.00	1.00	\$183.12	\$183.12	Dominguez Juan O Jr&Marisela
645 230 42 00	1.00	SFD	2	1.00	1.00	1.00	\$183.12	\$183.12	Riley Jose&Ramona
645 230 43 00	1.00	SFD	2	1.00	1.00	1.00	\$183.12	\$183.12	Torres David V&Guadalupe P
645 230 44 00	1.00	SFD	2	1.00	1.00	1.00	\$183.12	\$183.12	Ramirez Fernando&Christina R
645 230 45 00	1.00	SFD	2	1.00	1.00	1.00	\$183.12	\$183.12	Leon Joseph Jr&Erika J
645 230 46 00	1.00	SFD	2	1.00	1.00	1.00	\$183.12	\$183.12	Romero Nancy
645 230 47 00	1.00	SFD	2	1.00	1.00	1.00	\$183.12	\$183.12	Ahumada William C Sr&Vicky
645 230 48 00	1.00	SFD	2	1.00	1.00	1.00	\$183.12	\$183.12	Card Michael L
645 230 51 00	1.00	SFD	2	1.00	1.00	1.00	\$183.12	\$183.12	Preciado Alberto
645 230 52 00	1.00	SFD	2	1.00	1.00	1.00	\$183.12	\$183.12	Salvania Benjamin V&Virginia F
645 230 53 00	1.00	SFD	2	1.00	1.00	1.00	\$183.12	\$183.12	Pacheco Rodolfo&Rausch Rene
645 230 54 00	1.00	SFD	2	1.00	1.00	1.00	\$183.12	\$183.12	Wascher Scott B
645 230 55 00	1.00	SFD	2	1.00	1.00	1.00	\$183.12	\$183.12	Lacsina Joseph A&Rea F
645 230 56 00	1.00	SFD	2	1.00	1.00	1.00	\$183.12	\$183.12	Nicolaus Scott A&Cynthia A
645 230 57 00	1.00	SFD	2	1.00	1.00	1.00	\$183.12	\$183.12	Brandon Frank E&Maritza Revocable Trust 09-21-05
645 230 58 00	1.00	SFD	2	1.00	1.00	1.00	\$183.12	\$183.12	Salazar Florencio R
645 230 59 00	1.00	SFD	2	1.00	1.00	1.00	\$183.12	\$183.12	Sotos John V&Melda
645 231 01 00	1.00	SFD	2	1.00	1.00	1.00	\$183.12	\$183.12	Ramirez Miguel
645 231 02 00	1.00	SFD	2	1.00	1.00	1.00	\$183.12	\$183.12	Fuentes Antonio
645 231 03 00	1.00	SFD	2	1.00	1.00	1.00	\$183.12	\$183.12	Nguyen Victoria
645 231 04 00	1.00	SFD	2	1.00	1.00	1.00	\$183.12	\$183.12	Chappius Family Trust 10-24-13
645 231 05 00	1.00	SFD	2	1.00	1.00	1.00	\$183.12	\$183.12	Santos Wilson T
645 231 06 00	1.00	SFD	2	1.00	1.00	1.00	\$183.12	\$183.12	Jones Michael E
645 231 07 00	1.00	SFD	2	1.00	1.00	1.00	\$183.12	\$183.12	Loke Cheong Kar&Mow Lok Hee
645 231 08 00	1.00	SFD	2	1.00	1.00	1.00	\$183.12	\$183.12	Velasco Francisco J&Sandra
645 231 09 00	1.00	SFD	2	1.00	1.00	1.00	\$183.12	\$183.12	Chavarin Roberto&Leticia
645 231 10 00	1.00	SFD	2	1.00	1.00	1.00	\$183.12	\$183.12	Kerns Scott T C&Gina



**EXHIBIT C - Assessment Roll (Fiscal Year 2015)**  
**Robinhood Ridge Maintenance Assessment District**

Parcel Number	Acres/ Units <sup>(1)</sup>	Land Use <sup>(2)</sup>	NW Otay Zone	Apportionment Factors		Total EBUs	FY 2015 <sup>(4)</sup>		Owner Name
				Land Use <sup>(2)</sup>	Benefit <sup>(3)</sup>		Unit Cost	Assessment	
645 231 11 00	1.00	SFD	2	1.00	1.00	1.00	\$183.12	\$183.12	Williams Harold R&Detra C
645 231 12 00	1.00	SFD	2	1.00	1.00	1.00	\$183.12	\$183.12	Valentine Norman M&Margaret A
645 231 13 00	1.00	SFD	2	1.00	1.00	1.00	\$183.12	\$183.12	Meyers Mark E&Corey A
645 231 14 00	1.00	SFD	2	1.00	1.00	1.00	\$183.12	\$183.12	Wacht Jesse L
645 231 15 00	1.00	SFD	2	1.00	1.00	1.00	\$183.12	\$183.12	Carrillo Jose F Est Of
645 231 16 00	1.00	SFD	2	1.00	1.00	1.00	\$183.12	\$183.12	Magalso Myrick J
645 231 17 00	1.00	SFD	2	1.00	1.00	1.00	\$183.12	\$183.12	Viramontes Fidencio&Raquel
645 231 18 00	1.00	SFD	2	1.00	1.00	1.00	\$183.12	\$183.12	Amezcu Rafael&Jimenez-Amezcu Celina M
645 231 19 00	1.00	SFD	2	1.00	1.00	1.00	\$183.12	\$183.12	Rodriguez Alexandro M
645 231 20 00	1.00	SFD	2	1.00	1.00	1.00	\$183.12	\$183.12	Nona Kamal H
645 231 21 00	1.00	SFD	2	1.00	1.00	1.00	\$183.12	\$183.12	Lee Richard N&Finkral Amanda
645 231 22 00	1.00	SFD	2	1.00	1.00	1.00	\$183.12	\$183.12	Boone William L Jr&Lucy A
645 231 23 00	1.00	SFD	2	1.00	1.00	1.00	\$183.12	\$183.12	Gonzalez Angel&Madrigal Jose Living Trust 04-26-02
645 231 24 00	1.00	SFD	2	1.00	1.00	1.00	\$183.12	\$183.12	Arellano Ruben
645 231 25 00	1.00	SFD	2	1.00	1.00	1.00	\$183.12	\$183.12	Lloyd Michael&Dina
645 231 26 00	1.00	SFD	2	1.00	1.00	1.00	\$183.12	\$183.12	Sloop Thomas R&Hye Suk
645 231 27 00	1.00	SFD	2	1.00	1.00	1.00	\$183.12	\$183.12	Factoran Danilo D Separate Property Trust 02-05-05
645 231 28 00	1.00	SFD	2	1.00	1.00	1.00	\$183.12	\$183.12	Libed Ruben N&Jacqueline M
645 231 29 00	24.91	OSP	2	0.00	0.40	0.00	\$183.12	\$0.00	City Of San Diego
645 240 01 00	1.00	SFD	2	1.00	1.00	1.00	\$183.12	\$183.12	Publico Ryan D&Charmaine L
645 240 02 00	1.00	SFD	2	1.00	1.00	1.00	\$183.12	\$183.12	Arreola Menchie R
645 240 03 00	1.00	SFD	2	1.00	1.00	1.00	\$183.12	\$183.12	Cortez Family Trust 07-31-03
645 240 04 00	1.00	SFD	2	1.00	1.00	1.00	\$183.12	\$183.12	Gomez Telesforo
645 240 05 00	1.00	SFD	2	1.00	1.00	1.00	\$183.12	\$183.12	Herrera Abelardo L&Susan C Revocable Living Trust 05-05-00
645 240 06 00	1.00	SFD	2	1.00	1.00	1.00	\$183.12	\$183.12	Alphin James&Roxanne
645 240 07 00	1.00	SFD	2	1.00	1.00	1.00	\$183.12	\$183.12	Maldonado Jason&Guadalupe A
645 240 08 00	1.00	SFD	2	1.00	1.00	1.00	\$183.12	\$183.12	Castillo Edith
645 240 09 00	1.00	SFD	2	1.00	1.00	1.00	\$183.12	\$183.12	Pena Miguel
645 240 10 00	1.00	SFD	2	1.00	1.00	1.00	\$183.12	\$183.12	Fortin Raymundo&Thuyvi
645 240 11 00	1.00	SFD	2	1.00	1.00	1.00	\$183.12	\$183.12	Lopez Juan C
645 240 12 00	1.00	SFD	2	1.00	1.00	1.00	\$183.12	\$183.12	Durdock Matthew
645 240 13 00	1.00	SFD	2	1.00	1.00	1.00	\$183.12	\$183.12	Gonzalez Juan C
645 240 14 00	1.00	SFD	2	1.00	1.00	1.00	\$183.12	\$183.12	Payabyab Jose A Jr&Ligaya D Trs
645 240 15 00	1.00	SFD	2	1.00	1.00	1.00	\$183.12	\$183.12	Valles Jose J&Maria E
645 240 16 00	1.00	SFD	2	1.00	1.00	1.00	\$183.12	\$183.12	Raymundo Ernel D&Estela B
645 240 17 00	1.00	SFD	2	1.00	1.00	1.00	\$183.12	\$183.12	Mauhay Eustaquio A Jr
645 240 18 00	1.00	SFD	2	1.00	1.00	1.00	\$183.12	\$183.12	Garcia Gerardo L&Lozano Allison A
645 240 19 00	1.00	SFD	2	1.00	1.00	1.00	\$183.12	\$183.12	Irving Carlton C&Lambert Johnnie M
645 240 20 00	1.00	SFD	2	1.00	1.00	1.00	\$183.12	\$183.12	North Richard R&Martina A Living Trust A B 09-07-11
645 240 21 00	1.00	SFD	2	1.00	1.00	1.00	\$183.12	\$183.12	Martinez Elizabeth A
645 240 22 00	1.00	SFD	2	1.00	1.00	1.00	\$183.12	\$183.12	Ventura Geoffrey&Divina M
645 240 23 00	1.00	SFD	2	1.00	1.00	1.00	\$183.12	\$183.12	Celestino Alex D&Editha A
645 240 24 00	1.00	SFD	2	1.00	1.00	1.00	\$183.12	\$183.12	Serrano George M&Caroline L
645 240 25 00	1.00	SFD	2	1.00	1.00	1.00	\$183.12	\$183.12	Gonzalez Marco A&Cecilia
645 240 26 00	1.00	SFD	2	1.00	1.00	1.00	\$183.12	\$183.12	Desmond Sean
645 240 27 00	1.00	SFD	2	1.00	1.00	1.00	\$183.12	\$183.12	Wold Thomas A&Karin L
645 240 28 00	1.00	SFD	2	1.00	1.00	1.00	\$183.12	\$183.12	Ottinger Joseph B Jr&Pakhlevanyan A
645 240 29 00	1.00	SFD	2	1.00	1.00	1.00	\$183.12	\$183.12	Rangel Jose&Veronica
645 240 30 00	1.00	SFD	2	1.00	1.00	1.00	\$183.12	\$183.12	Lewis Waldiemar&Una
645 240 31 00	1.00	SFD	2	1.00	1.00	1.00	\$183.12	\$183.12	Mollner Brian C&Susana A
645 240 32 00	1.00	SFD	2	1.00	1.00	1.00	\$183.12	\$183.12	Martinez Sergio&Cadena Veronica
645 240 33 00	1.00	SFD	2	1.00	1.00	1.00	\$183.12	\$183.12	Luat Peter&Ursula <Dva>
645 240 34 00	1.00	SFD	2	1.00	1.00	1.00	\$183.12	\$183.12	Carrasco Martin&Lucia A
645 240 35 00	1.00	SFD	2	1.00	1.00	1.00	\$183.12	\$183.12	Lov Matthew&Truong Trang T
645 240 36 00	1.00	SFD	2	1.00	1.00	1.00	\$183.12	\$183.12	Ortega Gustavo&Martha C
645 240 37 00	1.00	SFD	2	1.00	1.00	1.00	\$183.12	\$183.12	Montero Alberto&Montero-Solis Mercedes V
645 240 38 00	1.00	SFD	2	1.00	1.00	1.00	\$183.12	\$183.12	Penn Elise D
645 240 39 00	1.00	SFD	2	1.00	1.00	1.00	\$183.12	\$183.12	Lopez Carlos A
645 240 40 00	1.00	SFD	2	1.00	1.00	1.00	\$183.12	\$183.12	Labaro James A&Abigail M
645 240 41 00	1.00	SFD	2	1.00	1.00	1.00	\$183.12	\$183.12	Resto Nadine L

**EXHIBIT C - Assessment Roll (Fiscal Year 2015)**  
**Robinhood Ridge Maintenance Assessment District**

Parcel Number	Acres/ Units <sup>(1)</sup>	Land Use <sup>(2)</sup>	NW Otay Zone	Apportionment Factors		Total EBUs	FY 2015 <sup>(4)</sup>		Owner Name
				Land Use <sup>(2)</sup>	Benefit <sup>(3)</sup>		Unit Cost	Assessment	
645 240 42 00	1.00	SFD	2	1.00	1.00	1.00	\$183.12	\$183.12	Petty Dustin E&Imler Melissa O
645 240 43 00	1.00	SFD	2	1.00	1.00	1.00	\$183.12	\$183.12	Tan Edwin P&Annelyn G Revocable 2013 Trust 05-28-13
645 240 44 00	1.00	SFD	2	1.00	1.00	1.00	\$183.12	\$183.12	Ferreira Adrian A&Jo A
645 240 45 00	1.00	SFD	2	1.00	1.00	1.00	\$183.12	\$183.12	Valles Jose L&Irene G
645 240 46 00	1.00	SFD	2	1.00	1.00	1.00	\$183.12	\$183.12	Vadakkumcherry Family Trust 02-10-12
645 240 47 00	1.00	SFD	2	1.00	1.00	1.00	\$183.12	\$183.12	Cruz Monica M
645 240 48 00	1.00	SFD	2	1.00	1.00	1.00	\$183.12	\$183.12	Barbosa Javier P&Maria E
645 240 49 00	1.00	SFD	2	1.00	1.00	1.00	\$183.12	\$183.12	Labor Lerida M
645 240 50 00	1.00	SFD	2	1.00	1.00	1.00	\$183.12	\$183.12	Pasion Lauro P
645 240 51 00	1.00	SFD	2	1.00	1.00	1.00	\$183.12	\$183.12	Conklin Terry Sr&Carley-Conklin Terri L
645 240 52 00	1.00	SFD	2	1.00	1.00	1.00	\$183.12	\$183.12	Rivera Abram&Rodriguez Paola J
645 240 53 00	1.00	SFD	2	1.00	1.00	1.00	\$183.12	\$183.12	Vo Dan A&Nhon T
645 240 54 00	1.00	SFD	2	1.00	1.00	1.00	\$183.12	\$183.12	Holdren Aaron&Shawnadee
645 240 55 00	1.00	SFD	2	1.00	1.00	1.00	\$183.12	\$183.12	Torres Rafael&Perla E
645 240 56 00	1.00	SFD	2	1.00	1.00	1.00	\$183.12	\$183.12	Urbina Angelita T
645 240 57 00	1.00	SFD	2	1.00	1.00	1.00	\$183.12	\$183.12	Diaz-Curiel Alicia
645 240 58 00	1.00	SFD	2	1.00	1.00	1.00	\$183.12	\$183.12	Frausto Margarita Revocable Trust 05-19-08
645 241 01 00	1.00	SFD	2	1.00	1.00	1.00	\$183.12	\$183.12	Binkowski Family Trust 05-10-06
645 241 02 00	1.00	SFD	2	1.00	1.00	1.00	\$183.12	\$183.12	Rodriguez Rodrigo&Maria C
645 241 03 00	1.00	SFD	2	1.00	1.00	1.00	\$183.12	\$183.12	Garduno Maria G
645 241 04 00	1.00	SFD	2	1.00	1.00	1.00	\$183.12	\$183.12	Migliaccio Sean M&Myrna B
645 241 05 00	1.00	SFD	2	1.00	1.00	1.00	\$183.12	\$183.12	Miller Nicole M
645 241 06 00	1.00	SFD	2	1.00	1.00	1.00	\$183.12	\$183.12	Baskerville Vanessa
645 241 07 00	1.00	SFD	2	1.00	1.00	1.00	\$183.12	\$183.12	Pre Geoffrey G&Linda O
645 241 08 00	1.00	SFD	2	1.00	1.00	1.00	\$183.12	\$183.12	Estrada Elias G&Myrna A
645 241 09 00	1.00	SFD	2	1.00	1.00	1.00	\$183.12	\$183.12	Alonzo Eddie T&Mariette G
645 241 10 00	1.00	SFD	2	1.00	1.00	1.00	\$183.12	\$183.12	Rodriguez John D
645 241 11 00	1.00	SFD	2	1.00	1.00	1.00	\$183.12	\$183.12	Wise Gary&Gordon Emilyn
645 241 12 00	1.00	SFD	2	1.00	1.00	1.00	\$183.12	\$183.12	Serrano Family Trust 08-16-04
645 241 13 00	1.00	SFD	2	1.00	1.00	1.00	\$183.12	\$183.12	Estrella David R&Ruth G
645 241 14 00	1.00	SFD	2	1.00	1.00	1.00	\$183.12	\$183.12	Szerlip Alexander&Crescentia
645 241 15 00	1.00	SFD	2	1.00	1.00	1.00	\$183.12	\$183.12	Aguilar Haydee R
645 241 16 00	1.00	SFD	2	1.00	1.00	1.00	\$183.12	\$183.12	Paniagua Cesar&Ana
645 241 17 00	1.00	SFD	2	1.00	1.00	1.00	\$183.12	\$183.12	Kong Candace Meewah
645 241 18 00	1.00	SFD	2	1.00	1.00	1.00	\$183.12	\$183.12	Biggs Guy&Ella Living Trust 01-29-11
645 241 19 00	1.00	SFD	2	1.00	1.00	1.00	\$183.12	\$183.12	Campbell Anthony E
645 241 20 00	1.00	SFD	2	1.00	1.00	1.00	\$183.12	\$183.12	Velarde Lucy E
645 241 21 00	1.00	SFD	2	1.00	1.00	1.00	\$183.12	\$183.12	Valdes Angel&Tesis-teco Lourdes
645 241 22 00	1.00	SFD	2	1.00	1.00	1.00	\$183.12	\$183.12	Valles Christian A
645 241 23 00	1.00	SFD	2	1.00	1.00	1.00	\$183.12	\$183.12	Richardson Vanier C&Amber J
645 241 24 00	1.00	SFD	2	1.00	1.00	1.00	\$183.12	\$183.12	Lopez Miguel Jr&Vanessa M
645 241 25 00	1.00	SFD	2	1.00	1.00	1.00	\$183.12	\$183.12	Loe Alma R&Daniel A
645 241 26 00	1.00	SFD	2	1.00	1.00	1.00	\$183.12	\$183.12	Steinkamp Matthew
645 241 27 00	1.00	SFD	2	1.00	1.00	1.00	\$183.12	\$183.12	Garcia Aaron O&Guadalupe
645 241 28 00	1.00	SFD	2	1.00	1.00	1.00	\$183.12	\$183.12	Ramos Ronnie&Nilanie
645 241 29 00	1.00	SFD	2	1.00	1.00	1.00	\$183.12	\$183.12	Carrillo Felipe&Olga Revocable 2011 Trust
645 241 30 00	1.00	SFD	2	1.00	1.00	1.00	\$183.12	\$183.12	Ruacho Brena L
645 241 31 00	1.00	SFD	2	1.00	1.00	1.00	\$183.12	\$183.12	Dickerson Stephen Jr&Staci L Revocable 2006 Trust03-30
645 241 32 00	1.00	SFD	2	1.00	1.00	1.00	\$183.12	\$183.12	Sanchez Griselda V Separate Property Trust 04-13-06
645 241 33 00	1.00	SFD	2	1.00	1.00	1.00	\$183.12	\$183.12	Anderson Justin J&Leticia L
645 241 34 00	1.00	SFD	2	1.00	1.00	1.00	\$183.12	\$183.12	Hustedt Anthony&Danielle
645 241 35 00	1.00	SFD	2	1.00	1.00	1.00	\$183.12	\$183.12	Valle Elmer
645 241 36 00	1.00	SFD	2	1.00	1.00	1.00	\$183.12	\$183.12	Emperador Florencio M Jr&Rosa C
645 241 37 00	1.00	SFD	2	1.00	1.00	1.00	\$183.12	\$183.12	Moreno Marco A N
645 241 38 00	1.00	SFD	2	1.00	1.00	1.00	\$183.12	\$183.12	Hernandez Gilberto
645 241 39 00	1.00	SFD	2	1.00	1.00	1.00	\$183.12	\$183.12	Hernandez Fernando J&Maria L
645 241 40 00	1.00	SFD	2	1.00	1.00	1.00	\$183.12	\$183.12	Byrum Gregory D Revocable 2007 Trust 05-17-07
645 242 01 00	6.87	PKU	2	0.50	0.40	1.37	\$183.12	\$251.60	City Of San Diego
645 242 03 00	16.47	OSP	2	0.00	0.40	0.00	\$183.12	\$0.00	City Of San Diego
645 242 05 00	20.27	OSP	2	0.00	0.40	0.00	\$183.12	\$0.00	City Of San Diego

**EXHIBIT C - Assessment Roll (Fiscal Year 2015)**  
**Robinhood Ridge Maintenance Assessment District**

Parcel Number	Acres/ Units <sup>(1)</sup>	Land Use <sup>(2)</sup>	NW Otay Zone	Apportionment Factors		Total EBUs	FY 2015 <sup>(4)</sup>		Owner Name
				Land Use <sup>(2)</sup>	Benefit <sup>(3)</sup>		Unit Cost	Assessment	
645 242 08 00	7.06	OSP	2	0.00	0.40	0.00	\$183.12	\$0.00	Edgewater At Vista Pacifica Homeowners Assn
645 242 09 01	1.00	CND	2	0.70	1.00	0.70	\$183.12	\$128.18	Oropeza Donato C&Natalia
645 242 09 02	1.00	CND	2	0.70	1.00	0.70	\$183.12	\$128.18	Barba Armando E Jr&Adan-Barba Sandra
645 242 09 03	1.00	CND	2	0.70	1.00	0.70	\$183.12	\$128.18	Oropeza Jose C
645 242 09 04	1.00	CND	2	0.70	1.00	0.70	\$183.12	\$128.18	Sakkab Bassel H&Mervat
645 242 09 05	1.00	CND	2	0.70	1.00	0.70	\$183.12	\$128.18	Jackson Alexander L
645 242 09 06	1.00	CND	2	0.70	1.00	0.70	\$183.12	\$128.18	Bresser Douglas&Judith
645 242 11 01	1.00	CND	2	0.70	1.00	0.70	\$183.12	\$128.18	Newman Timothy W
645 242 11 02	1.00	CND	2	0.70	1.00	0.70	\$183.12	\$128.18	Riveros Juan J
645 242 11 03	1.00	CND	2	0.70	1.00	0.70	\$183.12	\$128.18	Ibarra Rigoberto L
645 242 11 04	1.00	CND	2	0.70	1.00	0.70	\$183.12	\$128.18	Villagrana Leon M M
645 242 11 05	1.00	CND	2	0.70	1.00	0.70	\$183.12	\$128.18	Davis Siebie&Horne Dara A
645 242 11 06	1.00	CND	2	0.70	1.00	0.70	\$183.12	\$128.18	Gabryelski Brian
645 242 11 07	1.00	CND	2	0.70	1.00	0.70	\$183.12	\$128.18	Lazo Mae M C
645 242 11 08	1.00	CND	2	0.70	1.00	0.70	\$183.12	\$128.18	Padilla Andres
645 242 11 09	1.00	CND	2	0.70	1.00	0.70	\$183.12	\$128.18	Chiquete Juan A
645 242 11 10	1.00	CND	2	0.70	1.00	0.70	\$183.12	\$128.18	Cancino Miguel&Georgalaz Blanca I
645 242 11 11	1.00	CND	2	0.70	1.00	0.70	\$183.12	\$128.18	Acosta Edmundo C&Hazel C
645 242 11 12	1.00	CND	2	0.70	1.00	0.70	\$183.12	\$128.18	Robinson Lillian P
645 242 11 13	1.00	CND	2	0.70	1.00	0.70	\$183.12	\$128.18	Estrella Guillermina T
645 242 11 14	1.00	CND	2	0.70	1.00	0.70	\$183.12	\$128.18	Coreas Edwin
645 242 11 15	1.00	CND	2	0.70	1.00	0.70	\$183.12	\$128.18	Barbosa Javier&Maria E
645 242 11 16	1.00	CND	2	0.70	1.00	0.70	\$183.12	\$128.18	Montiel Armando F&Joy M
645 242 11 17	1.00	CND	2	0.70	1.00	0.70	\$183.12	\$128.18	Gonzali Gerardo&Janeth
645 242 11 18	1.00	CND	2	0.70	1.00	0.70	\$183.12	\$128.18	Gallardo-Esparza Carlos R&Gallardo Lilia M R
645 242 12 01	1.00	CND	2	0.70	1.00	0.70	\$183.12	\$128.18	Williams Schuyler A
645 242 12 02	1.00	CND	2	0.70	1.00	0.70	\$183.12	\$128.18	Stewart Daniel P&Carmen L
645 242 12 03	1.00	CND	2	0.70	1.00	0.70	\$183.12	\$128.18	Camacho Maria D C
645 242 12 04	1.00	CND	2	0.70	1.00	0.70	\$183.12	\$128.18	Perales Arturo B
645 242 12 05	1.00	CND	2	0.70	1.00	0.70	\$183.12	\$128.18	Vizcarra Noe G
645 242 12 06	1.00	CND	2	0.70	1.00	0.70	\$183.12	\$128.18	D Staff L L C
645 242 12 07	1.00	CND	2	0.70	1.00	0.70	\$183.12	\$128.18	Escamilla Fernando M
645 242 12 08	1.00	CND	2	0.70	1.00	0.70	\$183.12	\$128.18	House Michael J Trust 02-08-12
645 242 12 09	1.00	CND	2	0.70	1.00	0.70	\$183.12	\$128.18	Miranda Jesus H&Monica
645 242 12 10	1.00	CND	2	0.70	1.00	0.70	\$183.12	\$128.18	Ordonez-Sanz Alicia
645 242 12 11	1.00	CND	2	0.70	1.00	0.70	\$183.12	\$128.18	G M A C Mortgage L L C
645 242 12 12	1.00	CND	2	0.70	1.00	0.70	\$183.12	\$128.18	Ruiz Gerardo
645 242 12 13	1.00	CND	2	0.70	1.00	0.70	\$183.12	\$128.18	Arias Eduardo&Hernandez Sonia L
645 242 12 14	1.00	CND	2	0.70	1.00	0.70	\$183.12	\$128.18	Segura Family Trust 01-26-09
645 242 12 15	1.00	CND	2	0.70	1.00	0.70	\$183.12	\$128.18	Ybarra Marcos A&Briebesca Cynthia G
645 242 12 16	1.00	CND	2	0.70	1.00	0.70	\$183.12	\$128.18	Campbell Juan E
645 242 12 17	1.00	CND	2	0.70	1.00	0.70	\$183.12	\$128.18	Andrews Megan M
645 242 12 18	1.00	CND	2	0.70	1.00	0.70	\$183.12	\$128.18	Rochelle Family Trust 05-01-01
645 242 12 19	1.00	CND	2	0.70	1.00	0.70	\$183.12	\$128.18	Gutierrez Victor A
645 242 12 20	1.00	CND	2	0.70	1.00	0.70	\$183.12	\$128.18	Snyder Deborah
645 242 12 21	1.00	CND	2	0.70	1.00	0.70	\$183.12	\$128.18	Kim Kyungmin
645 242 12 22	1.00	CND	2	0.70	1.00	0.70	\$183.12	\$128.18	Bales Christine
645 242 12 23	1.00	CND	2	0.70	1.00	0.70	\$183.12	\$128.18	Castellanos Alejandro
645 242 12 24	1.00	CND	2	0.70	1.00	0.70	\$183.12	\$128.18	Tagalog Jasmine
645 242 13 01	1.00	CND	2	0.70	1.00	0.70	\$183.12	\$128.18	Tiznado Bertha
645 242 13 02	1.00	CND	2	0.70	1.00	0.70	\$183.12	\$128.18	Aramburo Fidel C&Gonzalez Laura R
645 242 13 03	1.00	CND	2	0.70	1.00	0.70	\$183.12	\$128.18	Rodriguez Hector M
645 242 13 04	1.00	CND	2	0.70	1.00	0.70	\$183.12	\$128.18	Stell Brianna
645 242 13 05	1.00	CND	2	0.70	1.00	0.70	\$183.12	\$128.18	Bins Thomas E&Carvajal Shirley E
645 242 13 06	1.00	CND	2	0.70	1.00	0.70	\$183.12	\$128.18	Ayala Conchita
645 242 13 07	1.00	CND	2	0.70	1.00	0.70	\$183.12	\$128.18	Luque Alfredo L
645 242 13 08	1.00	CND	2	0.70	1.00	0.70	\$183.12	\$128.18	Diaz Cynthia
645 242 13 09	1.00	CND	2	0.70	1.00	0.70	\$183.12	\$128.18	Flores Omar&Yolanda
645 242 13 10	1.00	CND	2	0.70	1.00	0.70	\$183.12	\$128.18	Robles Erica
645 242 13 11	1.00	CND	2	0.70	1.00	0.70	\$183.12	\$128.18	Ascencio Roberto

**EXHIBIT C - Assessment Roll (Fiscal Year 2015)**  
**Robinhood Ridge Maintenance Assessment District**

Parcel Number	Acres/ Units <sup>(1)</sup>	Land Use <sup>(2)</sup>	NW Otay Zone	Apportionment Factors		Total EBUs	FY 2015 <sup>(4)</sup>		Owner Name
				Land Use <sup>(2)</sup>	Benefit <sup>(3)</sup>		Unit Cost	Assessment	
645 242 13 12	1.00	CND	2	0.70	1.00	0.70	\$183.12	\$128.18	Kilpatrick Nicholas C&Amanda L
645 242 13 13	1.00	CND	2	0.70	1.00	0.70	\$183.12	\$128.18	Romero Ernesto A
645 242 13 14	1.00	CND	2	0.70	1.00	0.70	\$183.12	\$128.18	Garcia Daniel&Cualli F
645 242 13 15	1.00	CND	2	0.70	1.00	0.70	\$183.12	\$128.18	Kinchion Araceli
645 242 13 16	1.00	CND	2	0.70	1.00	0.70	\$183.12	\$128.18	Bull Parris A
645 242 13 17	1.00	CND	2	0.70	1.00	0.70	\$183.12	\$128.18	Silva Daniel
645 242 13 18	1.00	CND	2	0.70	1.00	0.70	\$183.12	\$128.18	Lyle Steve
645 242 14 01	1.00	CND	2	0.70	1.00	0.70	\$183.12	\$128.18	Montoya Gladys G
645 242 14 02	1.00	CND	2	0.70	1.00	0.70	\$183.12	\$128.18	Mcloughlin Daniel&Blanca
645 242 14 03	1.00	CND	2	0.70	1.00	0.70	\$183.12	\$128.18	Camarena Benjamin
645 242 14 04	1.00	CND	2	0.70	1.00	0.70	\$183.12	\$128.18	Auyeung Gilbert Kam Wah&Lisa
645 242 14 05	1.00	CND	2	0.70	1.00	0.70	\$183.12	\$128.18	Cluck Jeffrey&Gabrielle
645 242 14 06	1.00	CND	2	0.70	1.00	0.70	\$183.12	\$128.18	Arevalo Alejandro
645 242 14 07	1.00	CND	2	0.70	1.00	0.70	\$183.12	\$128.18	Laguna Yvonne
645 242 14 08	1.00	CND	2	0.70	1.00	0.70	\$183.12	\$128.18	Ruvalcaba Lizbeth
645 242 14 09	1.00	CND	2	0.70	1.00	0.70	\$183.12	\$128.18	Pinzone Victor A&Jovana I
645 242 14 10	1.00	CND	2	0.70	1.00	0.70	\$183.12	\$128.18	Cruz-Medina Jorge
645 242 14 11	1.00	CND	2	0.70	1.00	0.70	\$183.12	\$128.18	Holland Cody
645 242 14 12	1.00	CND	2	0.70	1.00	0.70	\$183.12	\$128.18	Yi Milun Trust 03-03-11
645 242 14 13	1.00	CND	2	0.70	1.00	0.70	\$183.12	\$128.18	Munoz Margarita
645 242 14 14	1.00	CND	2	0.70	1.00	0.70	\$183.12	\$128.18	Talley Donald J Ii
645 242 14 15	1.00	CND	2	0.70	1.00	0.70	\$183.12	\$128.18	Smith Justin A&Kathryn R
645 242 14 16	1.00	CND	2	0.70	1.00	0.70	\$183.12	\$128.18	Astiazaran Mauricio&Esmerelda
645 242 14 17	1.00	CND	2	0.70	1.00	0.70	\$183.12	\$128.18	Tacardon Galen L B
645 242 14 18	1.00	CND	2	0.70	1.00	0.70	\$183.12	\$128.18	Lopez Sadi
645 242 15 01	1.00	CND	2	0.70	1.00	0.70	\$183.12	\$128.18	Beltran Alejandro
645 242 15 02	1.00	CND	2	0.70	1.00	0.70	\$183.12	\$128.18	Velasco David Z&Zepeda Charlene
645 242 15 03	1.00	CND	2	0.70	1.00	0.70	\$183.12	\$128.18	Marsh Maria
645 242 15 04	1.00	CND	2	0.70	1.00	0.70	\$183.12	\$128.18	Florendo Abel C
645 242 15 05	1.00	CND	2	0.70	1.00	0.70	\$183.12	\$128.18	Lovato Marc L
645 242 15 06	1.00	CND	2	0.70	1.00	0.70	\$183.12	\$128.18	Guerrero Juan R&Rosalba
645 242 15 07	1.00	CND	2	0.70	1.00	0.70	\$183.12	\$128.18	Chaisongram Family Trust 10-15-05
645 242 15 08	1.00	CND	2	0.70	1.00	0.70	\$183.12	\$128.18	Fejarang Earl
645 242 15 09	1.00	CND	2	0.70	1.00	0.70	\$183.12	\$128.18	Frey Matthew C
645 242 15 10	1.00	CND	2	0.70	1.00	0.70	\$183.12	\$128.18	Ciaccio Kenneth G
645 242 15 11	1.00	CND	2	0.70	1.00	0.70	\$183.12	\$128.18	Villegas Jose F&Gonzalez Laura E
645 242 15 12	1.00	CND	2	0.70	1.00	0.70	\$183.12	\$128.18	Sifflet David N
645 242 15 13	1.00	CND	2	0.70	1.00	0.70	\$183.12	\$128.18	Casillas Miguel A&Muro-Casillas Cristina Y
645 242 15 14	1.00	CND	2	0.70	1.00	0.70	\$183.12	\$128.18	Camarena Reyes Jr
645 242 15 15	1.00	CND	2	0.70	1.00	0.70	\$183.12	\$128.18	Stevens James C&Ortiz-Stevens Yanira
645 242 15 16	1.00	CND	2	0.70	1.00	0.70	\$183.12	\$128.18	Zepeda Mariluz A
645 242 15 17	1.00	CND	2	0.70	1.00	0.70	\$183.12	\$128.18	Livesay Dain A&Rebecca L
645 242 15 18	1.00	CND	2	0.70	1.00	0.70	\$183.12	\$128.18	Batenga Corazon C
645 242 16 01	1.00	CND	2	0.70	1.00	0.70	\$183.12	\$128.18	Mason Mark A&Daniela P
645 242 16 02	1.00	CND	2	0.70	1.00	0.70	\$183.12	\$128.18	Christiansen Robert N Revocable 2007 Trust 11-16-07
645 242 16 03	1.00	CND	2	0.70	1.00	0.70	\$183.12	\$128.18	Mancilla Sergio&Belinda D
645 242 16 04	1.00	CND	2	0.70	1.00	0.70	\$183.12	\$128.18	Morgan Pamela R
645 242 16 05	1.00	CND	2	0.70	1.00	0.70	\$183.12	\$128.18	Rodriguez Lourdes K
645 242 16 06	1.00	CND	2	0.70	1.00	0.70	\$183.12	\$128.18	Mclean Alistair S&Katy
645 242 16 07	1.00	CND	2	0.70	1.00	0.70	\$183.12	\$128.18	Maltman Scott E&Miriam C
645 242 16 08	1.00	CND	2	0.70	1.00	0.70	\$183.12	\$128.18	Saenz Samuel Jr&Kim
645 242 16 09	1.00	CND	2	0.70	1.00	0.70	\$183.12	\$128.18	Friestad Tyson J
645 242 16 10	1.00	CND	2	0.70	1.00	0.70	\$183.12	\$128.18	Gutierrez Hector A
645 242 16 11	1.00	CND	2	0.70	1.00	0.70	\$183.12	\$128.18	Metcalf Karlo S&Soria Perla
645 242 16 12	1.00	CND	2	0.70	1.00	0.70	\$183.12	\$128.18	Camargo Salvador Jr
645 242 16 13	1.00	CND	2	0.70	1.00	0.70	\$183.12	\$128.18	Juarez Jeanette
645 242 16 14	1.00	CND	2	0.70	1.00	0.70	\$183.12	\$128.18	Griffis Valerie R
645 242 16 15	1.00	CND	2	0.70	1.00	0.70	\$183.12	\$128.18	Bihouet Rafael&Delbosque Ariana J
645 242 16 16	1.00	CND	2	0.70	1.00	0.70	\$183.12	\$128.18	Batenga Kathleen
645 242 16 17	1.00	CND	2	0.70	1.00	0.70	\$183.12	\$128.18	Watson Larry C&Mamie M

**EXHIBIT C - Assessment Roll (Fiscal Year 2015)**  
**Robinhood Ridge Maintenance Assessment District**

Parcel Number	Acres/ Units <sup>(1)</sup>	Land Use <sup>(2)</sup>	NW Otay Zone	Apportionment Factors		Total EBUs	FY 2015 <sup>(4)</sup>		Owner Name
				Land Use <sup>(2)</sup>	Benefit <sup>(3)</sup>		Unit Cost	Assessment	
645 242 16 18	1.00	CND	2	0.70	1.00	0.70	\$183.12	\$128.18	Ho Johnny K&Nguyen Jennifer N D
645 242 16 19	1.00	CND	2	0.70	1.00	0.70	\$183.12	\$128.18	Thomas Nolan
645 242 16 20	1.00	CND	2	0.70	1.00	0.70	\$183.12	\$128.18	Abencerraje Julio L Jr&Mar N
645 242 16 21	1.00	CND	2	0.70	1.00	0.70	\$183.12	\$128.18	Schaar Manuel E&Ema B Q
645 242 16 22	1.00	CND	2	0.70	1.00	0.70	\$183.12	\$128.18	Gorman Douglas M&Borga Charlene
645 242 16 23	1.00	CND	2	0.70	1.00	0.70	\$183.12	\$128.18	Rodriguez Veronica F
645 242 16 24	1.00	CND	2	0.70	1.00	0.70	\$183.12	\$128.18	Basauri Maria L
645 250 01 00	1.00	SFD	2	1.00	1.00	1.00	\$183.12	\$183.12	Switzer Erick G&Karen S
645 250 02 00	1.00	SFD	2	1.00	1.00	1.00	\$183.12	\$183.12	Goodwin Tracy A&Rosanne
645 250 03 00	1.00	SFD	2	1.00	1.00	1.00	\$183.12	\$183.12	Lopez Lisa Revocable 2012 Trust
645 250 04 00	1.00	SFD	2	1.00	1.00	1.00	\$183.12	\$183.12	Lopez Ismael&Michel Serena N
645 250 05 00	1.00	SFD	2	1.00	1.00	1.00	\$183.12	\$183.12	Maheda Juan M&Dora L
645 250 06 00	1.00	SFD	2	1.00	1.00	1.00	\$183.12	\$183.12	Rodriguez German&Angelica
645 250 07 00	1.00	SFD	2	1.00	1.00	1.00	\$183.12	\$183.12	Dieterle Joseph A&Monica Revocable 2005 Trust
645 250 08 00	1.00	SFD	2	1.00	1.00	1.00	\$183.12	\$183.12	Rodriguez Moises
645 250 09 00	1.00	SFD	2	1.00	1.00	1.00	\$183.12	\$183.12	Diaz Joel&Vargas Brenda
645 250 10 00	1.00	SFD	2	1.00	1.00	1.00	\$183.12	\$183.12	Burciaga Carlos H&Dora L
645 250 11 00	1.00	SFD	2	1.00	1.00	1.00	\$183.12	\$183.12	Gadon Renante L&Ellen A
645 250 12 00	1.00	SFD	2	1.00	1.00	1.00	\$183.12	\$183.12	Rivera Francisco&Delfina
645 250 13 00	1.00	SFD	2	1.00	1.00	1.00	\$183.12	\$183.12	Valdez Efen&Gloria
645 250 14 00	1.00	SFD	2	1.00	1.00	1.00	\$183.12	\$183.12	Johnson Douglas W&Xu
645 250 15 00	1.00	SFD	2	1.00	1.00	1.00	\$183.12	\$183.12	Velazquez Carlos
645 250 16 00	1.00	SFD	2	1.00	1.00	1.00	\$183.12	\$183.12	Garcia Marco A&Claudia
645 250 17 00	1.00	SFD	2	1.00	1.00	1.00	\$183.12	\$183.12	Hendricks William L
645 250 18 00	1.00	SFD	2	1.00	1.00	1.00	\$183.12	\$183.12	Acevedo Octavio&Elvira
645 250 19 00	1.00	SFD	2	1.00	1.00	1.00	\$183.12	\$183.12	Romo Family Trust 09-09-03
645 250 20 00	1.00	SFD	2	1.00	1.00	1.00	\$183.12	\$183.12	Zacofsky Walter J Jr&Madelyn G
645 250 21 00	1.00	SFD	2	1.00	1.00	1.00	\$183.12	\$183.12	Lopez David
645 250 22 00	1.00	SFD	2	1.00	1.00	1.00	\$183.12	\$183.12	Hamawandi Bakir&Graciela
645 250 23 00	1.00	SFD	2	1.00	1.00	1.00	\$183.12	\$183.12	Bloom John B Iii
645 250 24 00	1.00	SFD	2	1.00	1.00	1.00	\$183.12	\$183.12	Plunkett Antwan&Jen
645 250 25 00	1.00	SFD	2	1.00	1.00	1.00	\$183.12	\$183.12	Vasquez Jorge C
645 250 26 00	1.00	SFD	2	1.00	1.00	1.00	\$183.12	\$183.12	Ortega Ricardo H&Monica
645 250 27 00	1.00	SFD	2	1.00	1.00	1.00	\$183.12	\$183.12	Miclat Annarita
645 250 28 00	1.00	SFD	2	1.00	1.00	1.00	\$183.12	\$183.12	Renick Carolyn J
645 250 29 00	1.00	SFD	2	1.00	1.00	1.00	\$183.12	\$183.12	Gage Robert&Quintana-Gage Liliana
645 250 30 00	1.00	SFD	2	1.00	1.00	1.00	\$183.12	\$183.12	Corea German E
645 250 31 00	1.00	SFD	2	1.00	1.00	1.00	\$183.12	\$183.12	Mookini Christopher D&Dina J
645 250 32 00	1.00	SFD	2	1.00	1.00	1.00	\$183.12	\$183.12	Rotondo Eric R
645 250 33 00	1.00	SFD	2	1.00	1.00	1.00	\$183.12	\$183.12	Mercado Alonso&Teresa
645 250 34 00	1.00	SFD	2	1.00	1.00	1.00	\$183.12	\$183.12	Ibarra Francisco J&Irma E
645 250 35 00	1.00	SFD	2	1.00	1.00	1.00	\$183.12	\$183.12	Wootton Family Trust 10-27-03
645 250 36 00	1.00	SFD	2	1.00	1.00	1.00	\$183.12	\$183.12	Perkins Detra L
645 250 37 00	1.00	SFD	2	1.00	1.00	1.00	\$183.12	\$183.12	Hudson Wilbur&Croquette Revocable Living Trust 05-30-0
645 250 38 00	1.00	SFD	2	1.00	1.00	1.00	\$183.12	\$183.12	Marsinko George J Jr&Jan
645 250 39 00	1.00	SFD	2	1.00	1.00	1.00	\$183.12	\$183.12	Lopez Lawrence M&Elaine
645 250 40 00	1.00	SFD	2	1.00	1.00	1.00	\$183.12	\$183.12	Ronquillo Antonio P Jr&Carina C
645 250 41 00	1.00	SFD	2	1.00	1.00	1.00	\$183.12	\$183.12	Becerra Jesus L&Maria E
645 250 42 00	1.00	SFD	2	1.00	1.00	1.00	\$183.12	\$183.12	Rioveros Roderick Q Trust 06-14-07
645 250 43 00	1.00	SFD	2	1.00	1.00	1.00	\$183.12	\$183.12	Hernandez Hector S&Lorena
645 250 44 00	1.00	SFD	2	1.00	1.00	1.00	\$183.12	\$183.12	Ferrer Albert B C&Jacquelin R
645 250 45 00	1.00	SFD	2	1.00	1.00	1.00	\$183.12	\$183.12	Morales Javier&Sandra I
645 250 46 00	1.00	SFD	2	1.00	1.00	1.00	\$183.12	\$183.12	Ballazar Juan F G
645 250 47 00	1.00	SFD	2	1.00	1.00	1.00	\$183.12	\$183.12	Gonzalez Ruperto F
645 250 48 00	1.00	SFD	2	1.00	1.00	1.00	\$183.12	\$183.12	Garrison Steven&Phan
645 250 49 00	1.00	SFD	2	1.00	1.00	1.00	\$183.12	\$183.12	Perez Junel M&Argeline B
645 250 50 00	1.00	SFD	2	1.00	1.00	1.00	\$183.12	\$183.12	Allen Family Trust 10-05-11
645 250 51 00	1.00	SFD	2	1.00	1.00	1.00	\$183.12	\$183.12	Redding Robert M Jr&Katherine M
645 250 52 00	1.00	SFD	2	1.00	1.00	1.00	\$183.12	\$183.12	Ruelas Edgar&Angel Mayra
645 250 53 00	1.00	SFD	2	1.00	1.00	1.00	\$183.12	\$183.12	Perez Gustavo&Claudia

**EXHIBIT C - Assessment Roll (Fiscal Year 2015)**  
**Robinhood Ridge Maintenance Assessment District**

Parcel Number	Acres/ Units <sup>(1)</sup>	Land Use <sup>(2)</sup>	NW Otay Zone	Apportionment Factors		Total EBU's	FY 2015 <sup>(4)</sup>		Owner Name
				Land Use <sup>(2)</sup>	Benefit <sup>(3)</sup>		Unit Cost	Assessment	
645 250 54 00	1.00	SFD	2	1.00	1.00	1.00	\$183.12	\$183.12	Hernandez Ruben R&Wendy C
645 250 55 00	1.00	SFD	2	1.00	1.00	1.00	\$183.12	\$183.12	Gates Chad D
645 250 56 00	1.00	SFD	2	1.00	1.00	1.00	\$183.12	\$183.12	Inciong Tristan C&Michelle S
645 250 57 00	1.00	SFD	2	1.00	1.00	1.00	\$183.12	\$183.12	Balingit Giovanni D&Carmencita F
645 250 58 00	1.00	SFD	2	1.00	1.00	1.00	\$183.12	\$183.12	Rimorin Ronald L
645 250 59 00	1.00	SFD	2	1.00	1.00	1.00	\$183.12	\$183.12	Valdez Gerald li&Devaldez Milagros A L
645 250 60 00	1.00	SFD	2	1.00	1.00	1.00	\$183.12	\$183.12	Fabela Dora P
645 250 61 00	1.00	SFD	2	1.00	1.00	1.00	\$183.12	\$183.12	Krokell Charles P Jr&Josephine
645 250 62 00	1.00	SFD	2	1.00	1.00	1.00	\$183.12	\$183.12	Lazarus Zachary T
645 250 63 00	1.00	SFD	2	1.00	1.00	1.00	\$183.12	\$183.12	Santana Maria
645 250 64 00	1.00	SFD	2	1.00	1.00	1.00	\$183.12	\$183.12	Monge Ricky V&Maricar D
645 250 65 00	1.00	SFD	2	1.00	1.00	1.00	\$183.12	\$183.12	Barizo Jerry C Jr&Evangeline
645 250 66 00	1.00	SFD	2	1.00	1.00	1.00	\$183.12	\$183.12	Manriquez Hector&Mayte W
645 250 67 00	1.00	SFD	2	1.00	1.00	1.00	\$183.12	\$183.12	Enano Alfredo C Jr&Sherry T
645 250 68 00	1.00	SFD	2	1.00	1.00	1.00	\$183.12	\$183.12	Godsey Dean C&Della B
645 250 69 00	1.00	SFD	2	1.00	1.00	1.00	\$183.12	\$183.12	Cerda Joe&Myrna M
645 250 70 00	1.00	SFD	2	1.00	1.00	1.00	\$183.12	\$183.12	Ceballos Janette C
645 250 71 00	1.00	SFD	2	1.00	1.00	1.00	\$183.12	\$183.12	Fuentecilla Merlina Living Trust 04-28-06
645 250 72 00	1.00	SFD	2	1.00	1.00	1.00	\$183.12	\$183.12	Paniagua Saul&Laura R
645 250 73 00	1.00	SFD	2	1.00	1.00	1.00	\$183.12	\$183.12	Villegas Jorge L&Christina G
645 250 74 00	1.00	SFD	2	1.00	1.00	1.00	\$183.12	\$183.12	Green Robert Jr&Jennifer
645 250 75 00	1.00	SFD	2	1.00	1.00	1.00	\$183.12	\$183.12	Montayre Philippe&Hanna
645 250 76 00	1.00	SFD	2	1.00	1.00	1.00	\$183.12	\$183.12	Pauley David R&Shirley A
645 250 77 00	1.00	SFD	2	1.00	1.00	1.00	\$183.12	\$183.12	Miranda Eduardo V
645 250 78 00	1.00	SFD	2	1.00	1.00	1.00	\$183.12	\$183.12	Quintanilla Elva G
645 250 79 00	1.00	SFD	2	1.00	1.00	1.00	\$183.12	\$183.12	Taylor Wesley
645 250 80 00	1.00	SFD	2	1.00	1.00	1.00	\$183.12	\$183.12	Arredondo Salomon C
645 250 81 00	1.00	SFD	2	1.00	1.00	1.00	\$183.12	\$183.12	Bosset Steven S&Amelia R Trs
645 250 82 00	1.00	SFD	2	1.00	1.00	1.00	\$183.12	\$183.12	Lopez Enrique
645 250 83 00	1.00	SFD	2	1.00	1.00	1.00	\$183.12	\$183.12	Tisdale Jason&Kimble-Tisdale Twila M
645 251 01 00	1.00	SFD	2	1.00	1.00	1.00	\$183.12	\$183.12	Martinez Javier
645 251 02 00	1.00	SFD	2	1.00	1.00	1.00	\$183.12	\$183.12	Santos Marise C
645 251 03 00	1.00	SFD	2	1.00	1.00	1.00	\$183.12	\$183.12	Livingston Brett&Benko-Livingston Dody
645 251 04 00	1.00	SFD	2	1.00	1.00	1.00	\$183.12	\$183.12	Araos Ricardo A
645 251 05 00	1.00	SFD	2	1.00	1.00	1.00	\$183.12	\$183.12	Jackson Laurie A
645 251 06 00	1.00	SFD	2	1.00	1.00	1.00	\$183.12	\$183.12	Shimbori Takao&Truong Phaly My
645 251 07 00	1.00	SFD	2	1.00	1.00	1.00	\$183.12	\$183.12	Williams Victor A
645 251 08 00	1.00	SFD	2	1.00	1.00	1.00	\$183.12	\$183.12	Munoz Juan&Alba-Munoz Karla
645 251 09 00	1.00	SFD	2	1.00	1.00	1.00	\$183.12	\$183.12	Cunanan Gener P&Gilda B
645 251 10 00	1.00	SFD	2	1.00	1.00	1.00	\$183.12	\$183.12	Camacho Adrian
645 251 11 00	1.00	SFD	2	1.00	1.00	1.00	\$183.12	\$183.12	Cruz Cole
645 251 12 00	1.00	SFD	2	1.00	1.00	1.00	\$183.12	\$183.12	Arguelles David
645 251 13 00	1.00	SFD	2	1.00	1.00	1.00	\$183.12	\$183.12	Yao William&Wang Zhenling
645 251 14 00	1.00	SFD	2	1.00	1.00	1.00	\$183.12	\$183.12	Mercer Ottley W&Delma F
645 251 15 00	1.00	SFD	2	1.00	1.00	1.00	\$183.12	\$183.12	Rivera Henry E&Reyna C G
645 251 16 00	1.00	SFD	2	1.00	1.00	1.00	\$183.12	\$183.12	Harper James B&Sulie G
645 252 01 00	1.00	SFD	2	1.00	1.00	1.00	\$183.12	\$183.12	Schnopp Sarah
645 252 02 00	1.00	SFD	2	1.00	1.00	1.00	\$183.12	\$183.12	Vargas Fernando
645 252 03 00	1.00	SFD	2	1.00	1.00	1.00	\$183.12	\$183.12	Murillo Juan P
645 252 04 00	1.00	SFD	2	1.00	1.00	1.00	\$183.12	\$183.12	Salcedo Bertha
645 252 05 00	1.00	SFD	2	1.00	1.00	1.00	\$183.12	\$183.12	David Pabito P&Bonita L
645 252 06 00	1.00	SFD	2	1.00	1.00	1.00	\$183.12	\$183.12	Leal Jesus A V&Valenzuela Maria D R S D
645 252 07 00	1.00	SFD	2	1.00	1.00	1.00	\$183.12	\$183.12	Bustillos Omar&Renova Jeanette
645 252 08 00	1.00	SFD	2	1.00	1.00	1.00	\$183.12	\$183.12	Sansano Janet T
645 252 09 00	1.00	SFD	2	1.00	1.00	1.00	\$183.12	\$183.12	Montenegro Jesus R&Consolacion M
645 252 10 00	1.00	SFD	2	1.00	1.00	1.00	\$183.12	\$183.12	Edwards David
645 252 11 00	1.00	SFD	2	1.00	1.00	1.00	\$183.12	\$183.12	Montiel Ismael&Patricia
645 252 12 00	1.00	SFD	2	1.00	1.00	1.00	\$183.12	\$183.12	Gallegos Luis E G&Cano Shaarabel
645 252 13 00	1.00	SFD	2	1.00	1.00	1.00	\$183.12	\$183.12	Frazao Louis F
645 252 14 00	1.00	SFD	2	1.00	1.00	1.00	\$183.12	\$183.12	Avila J Jesus O&Orendain Josefina C D

**EXHIBIT C - Assessment Roll (Fiscal Year 2015)**  
**Robinhood Ridge Maintenance Assessment District**

Parcel Number	Acres/ Units <sup>(1)</sup>	Land Use <sup>(2)</sup>	NW Otay Zone	Apportionment Factors		Total EBUs	FY 2015 <sup>(4)</sup>		Owner Name
				Land Use <sup>(2)</sup>	Benefit <sup>(3)</sup>		Unit Cost	Assessment	
645 252 15 00	1.00	SFD	2	1.00	1.00	1.00	\$183.12	\$183.12	Chavira Jose P&Silvia G Revocable Family 2001 Trust
645 252 16 00	1.00	SFD	2	1.00	1.00	1.00	\$183.12	\$183.12	Gonzalez Jeffrey
645 252 17 00	1.00	SFD	2	1.00	1.00	1.00	\$183.12	\$183.12	Grockowski Family Trust 07-28-10
645 252 18 00	1.00	SFD	2	1.00	1.00	1.00	\$183.12	\$183.12	Broadnax Mecca A
645 252 19 00	1.00	SFD	2	1.00	1.00	1.00	\$183.12	\$183.12	Hernandez Francisco&Soledad
645 252 20 00	1.00	SFD	2	1.00	1.00	1.00	\$183.12	\$183.12	Conner Charles E&Jessi
645 252 21 00	1.00	SFD	2	1.00	1.00	1.00	\$183.12	\$183.12	Quezada Johnny&Claudia
645 252 22 00	1.00	SFD	2	1.00	1.00	1.00	\$183.12	\$183.12	Uribe Javier F
645 252 23 00	1.00	SFD	2	1.00	1.00	1.00	\$183.12	\$183.12	Lehpamer Hrvoj
645 252 24 00	1.00	SFD	2	1.00	1.00	1.00	\$183.12	\$183.12	Riley Jason P&Clarissa E
645 252 25 00	1.00	SFD	2	1.00	1.00	1.00	\$183.12	\$183.12	Jackson Marcus A Jr&Deatrice R
645 252 26 00	1.00	SFD	2	1.00	1.00	1.00	\$183.12	\$183.12	Pina Eduardo&Melina
645 252 27 00	1.00	SFD	2	1.00	1.00	1.00	\$183.12	\$183.12	Bernal Gilberto&Sara
645 252 28 00	1.00	SFD	2	1.00	1.00	1.00	\$183.12	\$183.12	Kennerly Traci L
645 252 29 00	1.00	SFD	2	1.00	1.00	1.00	\$183.12	\$183.12	Vinuya Joseph V&Dotimas Magdalena B
645 252 30 00	1.00	SFD	2	1.00	1.00	1.00	\$183.12	\$183.12	Idosor Rhodora
645 252 31 00	1.00	SFD	2	1.00	1.00	1.00	\$183.12	\$183.12	Marienes Reiginaid V&Alisa A
645 252 32 00	1.00	SFD	2	1.00	1.00	1.00	\$183.12	\$183.12	Zafico Adelfo P&Gina T
645 252 33 00	1.00	SFD	2	1.00	1.00	1.00	\$183.12	\$183.12	Angeles Frolan&Sheila
645 252 34 00	1.00	SFD	2	1.00	1.00	1.00	\$183.12	\$183.12	Gonzalez John M&Maria L
645 252 35 00	1.00	SFD	2	1.00	1.00	1.00	\$183.12	\$183.12	Juarez Alberto J&Norma
645 252 36 00	1.00	SFD	2	1.00	1.00	1.00	\$183.12	\$183.12	Licea Rodolfo Jr&Julia
645 252 37 00	1.00	SFD	2	1.00	1.00	1.00	\$183.12	\$183.12	Dizon Januario T&Laura T
645 252 38 00	1.00	SFD	2	1.00	1.00	1.00	\$183.12	\$183.12	Yamamoto Julieann S
645 252 39 00	1.00	SFD	2	1.00	1.00	1.00	\$183.12	\$183.12	Sheppard Rodney P
645 252 40 00	1.00	SFD	2	1.00	1.00	1.00	\$183.12	\$183.12	Delacruz Danilo&Ermelinda
645 252 41 00	1.00	SFD	2	1.00	1.00	1.00	\$183.12	\$183.12	Barnes Erick&Monique
645 252 42 00	1.00	SFD	2	1.00	1.00	1.00	\$183.12	\$183.12	Barajas Onasis&Veronica
645 252 43 00	1.00	SFD	2	1.00	1.00	1.00	\$183.12	\$183.12	Ibarra Guillermo L&Teresa
645 252 44 00	1.00	SFD	2	1.00	1.00	1.00	\$183.12	\$183.12	Mallett George A&Soralla
645 252 45 00	1.00	SFD	2	1.00	1.00	1.00	\$183.12	\$183.12	Porras Enrique M Iii&Martha
645 252 46 00	1.00	SFD	2	1.00	1.00	1.00	\$183.12	\$183.12	Bock John A&Viola T
645 252 47 00	1.00	SFD	2	1.00	1.00	1.00	\$183.12	\$183.12	Perez Living Trust 07-14-09
645 252 48 00	1.00	SFD	2	1.00	1.00	1.00	\$183.12	\$183.12	Noriega Maria D L A
645 252 49 00	1.00	SFD	2	1.00	1.00	1.00	\$183.12	\$183.12	Armenta Jose A&Blanca E
645 252 50 00	1.00	SFD	2	1.00	1.00	1.00	\$183.12	\$183.12	Tames Luciano&Julie I G
645 252 51 00	1.00	SFD	2	1.00	1.00	1.00	\$183.12	\$183.12	Barrett Mark W
645 252 52 00	1.00	SFD	2	1.00	1.00	1.00	\$183.12	\$183.12	Arndt Christopher&Hennessey Hang N
645 252 53 00	1.00	SFD	2	1.00	1.00	1.00	\$183.12	\$183.12	Bautista Ferdinand&Michelin D R
645 252 54 00	1.00	SFD	2	1.00	1.00	1.00	\$183.12	\$183.12	Jurado Francisco
645 252 55 00	1.00	SFD	2	1.00	1.00	1.00	\$183.12	\$183.12	Banares Arlene B&Larry D
645 252 56 00	1.00	SFD	2	1.00	1.00	1.00	\$183.12	\$183.12	Korchnoy Yuliya
645 252 57 00	1.00	SFD	2	1.00	1.00	1.00	\$183.12	\$183.12	Valencia Carlos Jr
645 252 58 00	1.00	SFD	2	1.00	1.00	1.00	\$183.12	\$183.12	Salazar Lourdes M
645 252 59 00	1.00	SFD	2	1.00	1.00	1.00	\$183.12	\$183.12	Santos Raymond&Wilma
645 252 60 00	1.00	SFD	2	1.00	1.00	1.00	\$183.12	\$183.12	Apostol Family Trust 02-26-01
645 252 61 00	1.00	SFD	2	1.00	1.00	1.00	\$183.12	\$183.12	Fialkowski Edward&Aida A L Family Trust 02-06-04
645 252 62 00	1.00	SFD	2	1.00	1.00	1.00	\$183.12	\$183.12	Chalupnik Jerry M
645 252 63 00	1.00	SFD	2	1.00	1.00	1.00	\$183.12	\$183.12	Bray Brian P&Eunice T
645 252 64 00	1.00	SFD	2	1.00	1.00	1.00	\$183.12	\$183.12	Vanmartin Reginald&Ahlin Pia T
645 252 65 00	1.00	SFD	2	1.00	1.00	1.00	\$183.12	\$183.12	Mathis Joseph S&Tracy J
645 252 66 00	1.00	SFD	2	1.00	1.00	1.00	\$183.12	\$183.12	Morris Family Trust 06-04-09
645 252 67 00	1.00	SFD	2	1.00	1.00	1.00	\$183.12	\$183.12	Holt John&Eryn
645 252 68 00	1.00	SFD	2	1.00	1.00	1.00	\$183.12	\$183.12	Schlais Kyle
645 252 69 00	1.06	OSP	2	0.00	0.40	0.00	\$183.12	\$0.00	City Of San Diego
645 253 01 00	1.00	SFD	2	1.00	1.00	1.00	\$183.12	\$183.12	Gutierrez Juan C&Delene
645 253 02 00	1.00	SFD	2	1.00	1.00	1.00	\$183.12	\$183.12	Swier Robert J&Diane
645 253 03 00	1.00	SFD	2	1.00	1.00	1.00	\$183.12	\$183.12	Bush Nerolee
645 253 04 00	1.00	SFD	2	1.00	1.00	1.00	\$183.12	\$183.12	Gavino Manuel Sr&Nora R
645 253 05 00	1.00	SFD	2	1.00	1.00	1.00	\$183.12	\$183.12	Apostol Family Trust 02-26-01

**EXHIBIT C - Assessment Roll (Fiscal Year 2015)**  
**Robinhood Ridge Maintenance Assessment District**

Parcel Number	Acres/ Units <sup>(1)</sup>	Land Use <sup>(2)</sup>	NW Otay Zone	Apportionment Factors		Total EBUs	FY 2015 <sup>(4)</sup>		Owner Name
				Land Use <sup>(2)</sup>	Benefit <sup>(3)</sup>		Unit Cost	Assessment	
645 253 06 00	1.00	SFD	2	1.00	1.00	1.00	\$183.12	\$183.12	Diaz Jodonn P
645 253 07 00	1.00	SFD	2	1.00	1.00	1.00	\$183.12	\$183.12	Castro Gabriel J&Ofelia
645 253 08 00	1.00	SFD	2	1.00	1.00	1.00	\$183.12	\$183.12	Smith David B
645 253 09 00	1.00	SFD	2	1.00	1.00	1.00	\$183.12	\$183.12	Sandoval Gloria
645 253 10 00	1.00	SFD	2	1.00	1.00	1.00	\$183.12	\$183.12	Dolcini Thomas A
645 253 11 00	1.00	SFD	2	1.00	1.00	1.00	\$183.12	\$183.12	Hauer John G
645 253 12 00	1.00	SFD	2	1.00	1.00	1.00	\$183.12	\$183.12	Wootton Family Trust 10-27-03
645 253 13 00	1.00	SFD	2	1.00	1.00	1.00	\$183.12	\$183.12	Parra David M
645 253 14 00	1.00	SFD	2	1.00	1.00	1.00	\$183.12	\$183.12	Mangayat Oscar D&Maryludy D
645 253 15 00	1.00	SFD	2	1.00	1.00	1.00	\$183.12	\$183.12	Pansacula Doroteo C&Teresita L
645 253 16 00	1.00	SFD	2	1.00	1.00	1.00	\$183.12	\$183.12	Kinsey Daniel S&Russell-Kinsey Amy J
645 253 17 00	1.00	SFD	2	1.00	1.00	1.00	\$183.12	\$183.12	Young Hector R&Ginna A
645 253 18 00	6.61	OSP	2	0.00	0.40	0.00	\$183.12	\$0.00	City Of San Diego
645 260 01 00	1.00	SFD	2	1.00	1.00	1.00	\$183.12	\$183.12	Tomma Magid E&Laura
645 260 02 00	1.00	SFD	2	1.00	1.00	1.00	\$183.12	\$183.12	Arguilez Dion&Alethea M
645 260 03 00	1.00	SFD	2	1.00	1.00	1.00	\$183.12	\$183.12	Maynard Matthew J
645 260 04 00	1.00	SFD	2	1.00	1.00	1.00	\$183.12	\$183.12	Mercado Henry&Denise M
645 260 05 00	1.00	SFD	2	1.00	1.00	1.00	\$183.12	\$183.12	Steele Jacob&Mendez Cynthia
645 260 06 00	1.00	SFD	2	1.00	1.00	1.00	\$183.12	\$183.12	Babida Michael&Sietske C
645 260 07 00	1.00	SFD	2	1.00	1.00	1.00	\$183.12	\$183.12	Bernal Jose A&Anakaren
645 260 08 00	1.00	SFD	2	1.00	1.00	1.00	\$183.12	\$183.12	Lutu Faamalo
645 260 09 00	1.00	SFD	2	1.00	1.00	1.00	\$183.12	\$183.12	Newman Dulcisimo M&Virna V
645 260 10 00	1.00	SFD	2	1.00	1.00	1.00	\$183.12	\$183.12	Luna Carlos R
645 260 11 00	1.00	SFD	2	1.00	1.00	1.00	\$183.12	\$183.12	Wen Cheng Pin&Wang Yu Ping
645 260 12 00	1.00	SFD	2	1.00	1.00	1.00	\$183.12	\$183.12	Mcgregor Michael
645 260 13 00	1.00	SFD	2	1.00	1.00	1.00	\$183.12	\$183.12	Songvilay Eric
645 260 14 00	1.00	SFD	2	1.00	1.00	1.00	\$183.12	\$183.12	Barrios Diana Y
645 260 15 00	1.00	SFD	2	1.00	1.00	1.00	\$183.12	\$183.12	Gergurich Edward J&Michelle C
645 260 16 00	1.00	SFD	2	1.00	1.00	1.00	\$183.12	\$183.12	Incera Jose O G
645 260 17 00	1.00	SFD	2	1.00	1.00	1.00	\$183.12	\$183.12	Rodolfa Jacqueline E
645 260 18 00	1.00	SFD	2	1.00	1.00	1.00	\$183.12	\$183.12	Sanchez Hector&Lottie I W
645 260 19 00	1.00	SFD	2	1.00	1.00	1.00	\$183.12	\$183.12	Garrido Miguel A&Louisa J
645 260 20 00	1.00	SFD	2	1.00	1.00	1.00	\$183.12	\$183.12	Bender Matthew J
645 260 21 00	1.00	SFD	2	1.00	1.00	1.00	\$183.12	\$183.12	Tunay Zenaida Q
645 260 22 00	1.00	SFD	2	1.00	1.00	1.00	\$183.12	\$183.12	Andino Ricardo J&Marianne S
645 260 23 00	1.00	SFD	2	1.00	1.00	1.00	\$183.12	\$183.12	Nunez Jack R
645 260 24 00	1.00	SFD	2	1.00	1.00	1.00	\$183.12	\$183.12	Gannon Mark S Living Trust 06-12-10
645 260 25 00	1.00	SFD	2	1.00	1.00	1.00	\$183.12	\$183.12	Dennis Ronald M&Lesley D
645 260 26 00	1.00	SFD	2	1.00	1.00	1.00	\$183.12	\$183.12	Barajas Andres A&Mellinda H
645 260 27 00	1.00	SFD	2	1.00	1.00	1.00	\$183.12	\$183.12	Pizarro Family Trust 09-07-10
645 260 28 00	1.00	SFD	2	1.00	1.00	1.00	\$183.12	\$183.12	Versoza Evelio Jr
645 260 29 00	1.00	SFD	2	1.00	1.00	1.00	\$183.12	\$183.12	Michel Abraham M&Martha S
645 260 30 00	1.00	SFD	2	1.00	1.00	1.00	\$183.12	\$183.12	Escano Arnold T&Jenniffer S
645 260 31 00	1.00	SFD	2	1.00	1.00	1.00	\$183.12	\$183.12	Mendez Refugio&Veronica
645 260 32 00	1.00	SFD	2	1.00	1.00	1.00	\$183.12	\$183.12	Gonzalez Silvia
645 260 33 00	1.00	SFD	2	1.00	1.00	1.00	\$183.12	\$183.12	Navarro Ramon&Angelica
645 260 34 00	1.00	SFD	2	1.00	1.00	1.00	\$183.12	\$183.12	Mcgann Family Trust 06-06-11
645 260 35 00	1.00	SFD	2	1.00	1.00	1.00	\$183.12	\$183.12	Sitson Nestor Y&Gloria M
645 260 36 00	1.00	SFD	2	1.00	1.00	1.00	\$183.12	\$183.12	Gentle Andrew R&Any S
645 260 37 00	1.00	SFD	2	1.00	1.00	1.00	\$183.12	\$183.12	Rasmussen Susan L
645 260 38 00	1.00	SFD	2	1.00	1.00	1.00	\$183.12	\$183.12	Lopez Hugo S
645 260 39 00	1.00	SFD	2	1.00	1.00	1.00	\$183.12	\$183.12	Bonifacio Michelle D
645 260 40 00	1.00	SFD	2	1.00	1.00	1.00	\$183.12	\$183.12	Manglicmot Dennis&Amalia
645 260 41 00	1.00	SFD	2	1.00	1.00	1.00	\$183.12	\$183.12	Domingo Amy C
645 260 42 00	1.00	SFD	2	1.00	1.00	1.00	\$183.12	\$183.12	Campos Victorino&Marissa
645 260 43 00	1.00	SFD	2	1.00	1.00	1.00	\$183.12	\$183.12	Gomez Roberto R&Ofelia V
645 260 44 00	1.00	SFD	2	1.00	1.00	1.00	\$183.12	\$183.12	Love Donald&Jocelyn V
645 260 46 00	1.00	SFD	2	1.00	1.00	1.00	\$183.12	\$183.12	Barron Juan J&Eunise A
645 260 47 00	1.00	SFD	2	1.00	1.00	1.00	\$183.12	\$183.12	Nakamura Nick&Leigh A
645 260 48 00	1.00	SFD	2	1.00	1.00	1.00	\$183.12	\$183.12	Hindman Donald J&Eileen C



**EXHIBIT C - Assessment Roll (Fiscal Year 2015)**  
**Robinhood Ridge Maintenance Assessment District**

Parcel Number	Acres/ Units <sup>(1)</sup>	Land Use <sup>(2)</sup>	NW Otay Zone	Apportionment Factors		Total EBUs	FY 2015 <sup>(4)</sup>		Owner Name
				Land Use <sup>(2)</sup>	Benefit <sup>(3)</sup>		Unit Cost	Assessment	
645 260 49 00	1.00	SFD	2	1.00	1.00	1.00	\$183.12	\$183.12	Brathwaite Darrell R&Karla B
645 260 50 00	1.00	SFD	2	1.00	1.00	1.00	\$183.12	\$183.12	Thomas Donn H
645 260 51 00	1.00	SFD	2	1.00	1.00	1.00	\$183.12	\$183.12	Chua Daniel B&Eleanor E
645 260 52 00	1.00	SFD	2	1.00	1.00	1.00	\$183.12	\$183.12	Harbin Levi&Melissa
645 260 53 00	1.00	SFD	2	1.00	1.00	1.00	\$183.12	\$183.12	Cole O Stanley
645 260 54 00	1.00	SFD	2	1.00	1.00	1.00	\$183.12	\$183.12	Moon Dan
645 260 55 00	1.00	SFD	2	1.00	1.00	1.00	\$183.12	\$183.12	Talbott Richard A&Dianna S
645 260 56 00	1.00	SFD	2	1.00	1.00	1.00	\$183.12	\$183.12	Phan Christian&Diana
645 260 57 00	1.00	SFD	2	1.00	1.00	1.00	\$183.12	\$183.12	Aliping Delia L
645 260 58 00	1.00	SFD	2	1.00	1.00	1.00	\$183.12	\$183.12	Coronado Ernesto
645 260 59 00	1.00	SFD	2	1.00	1.00	1.00	\$183.12	\$183.12	Satrom Scott T
645 261 01 00	1.00	SFD	2	1.00	1.00	1.00	\$183.12	\$183.12	Prian Marisela
645 261 02 00	1.00	SFD	2	1.00	1.00	1.00	\$183.12	\$183.12	Schmidt Brian D&Melanie B
645 261 03 00	1.00	SFD	2	1.00	1.00	1.00	\$183.12	\$183.12	Navarro Ivan&Marbella
645 261 04 00	1.00	SFD	2	1.00	1.00	1.00	\$183.12	\$183.12	Valverde Nydia M Revocable 2008 Trust
645 261 05 00	1.00	SFD	2	1.00	1.00	1.00	\$183.12	\$183.12	Zuniga David
645 261 06 00	1.00	SFD	2	1.00	1.00	1.00	\$183.12	\$183.12	Gutierrez Fabian
645 261 07 00	1.00	SFD	2	1.00	1.00	1.00	\$183.12	\$183.12	Perez Matthew&Simone
645 261 08 00	1.00	SFD	2	1.00	1.00	1.00	\$183.12	\$183.12	Mangat Lamberto A&Lolita S
645 261 09 00	1.00	SFD	2	1.00	1.00	1.00	\$183.12	\$183.12	Aaron Alan P&Felicia K
645 261 10 00	1.00	SFD	2	1.00	1.00	1.00	\$183.12	\$183.12	Guerrero Jose H&Yvonne
645 261 11 00	1.00	SFD	2	1.00	1.00	1.00	\$183.12	\$183.12	Swanson Michael
645 261 12 00	1.00	SFD	2	1.00	1.00	1.00	\$183.12	\$183.12	Delgado Angel L Jr&Daisey P
645 261 13 00	1.00	SFD	2	1.00	1.00	1.00	\$183.12	\$183.12	Navarro Andrei M&Javier Aileen R
645 261 14 00	1.00	SFD	2	1.00	1.00	1.00	\$183.12	\$183.12	Mendiara Chris&Scolari Rosana
645 261 15 00	1.00	SFD	2	1.00	1.00	1.00	\$183.12	\$183.12	Montiel Ramon B&Concepcion J
645 261 16 00	1.00	SFD	2	1.00	1.00	1.00	\$183.12	\$183.12	Liwanag Rafael G&Lorina M
645 261 17 00	1.00	SFD	2	1.00	1.00	1.00	\$183.12	\$183.12	Phillips Kenneth J&Laiti Amal
645 261 18 00	1.00	SFD	2	1.00	1.00	1.00	\$183.12	\$183.12	Casillas Carlos G&Marroquin Diala
645 261 19 00	1.00	SFD	2	1.00	1.00	1.00	\$183.12	\$183.12	Anchondo Fernando
645 261 20 00	1.00	SFD	2	1.00	1.00	1.00	\$183.12	\$183.12	Perry Christopher&Diana
645 261 21 00	1.00	SFD	2	1.00	1.00	1.00	\$183.12	\$183.12	Pecjo Roberto M&Carlota P
645 261 22 00	1.00	SFD	2	1.00	1.00	1.00	\$183.12	\$183.12	Mendoza Geoffrey N&Maria C G
645 261 25 00	1.00	SFD	2	1.00	1.00	1.00	\$183.12	\$183.12	Derby David P&Antoinette M
645 261 26 00	1.00	SFD	2	1.00	1.00	1.00	\$183.12	\$183.12	Ling Jeanne Y
645 261 27 00	1.00	SFD	2	1.00	1.00	1.00	\$183.12	\$183.12	Rodriguez Alexa
645 261 28 00	1.00	SFD	2	1.00	1.00	1.00	\$183.12	\$183.12	Rangel Jaime E&Delia
645 261 29 00	1.00	SFD	2	1.00	1.00	1.00	\$183.12	\$183.12	Romero Ricardo E&Danielle E
645 261 30 00	1.00	SFD	2	1.00	1.00	1.00	\$183.12	\$183.12	Vu Family Trust 01-16-06
645 261 31 00	1.00	SFD	2	1.00	1.00	1.00	\$183.12	\$183.12	Taisacan Christopher C&Nadine R A
645 261 32 00	1.00	SFD	2	1.00	1.00	1.00	\$183.12	\$183.12	Brown Vance G
645 261 33 00	1.00	SFD	2	1.00	1.00	1.00	\$183.12	\$183.12	Villarreal Jose L&Adrianna
645 261 34 00	1.00	SFD	2	1.00	1.00	1.00	\$183.12	\$183.12	Silva Jesus M&Guadalupe
645 261 35 00	1.00	SFD	2	1.00	1.00	1.00	\$183.12	\$183.12	Neese Donald R&Maria E
645 261 36 00	1.00	SFD	2	1.00	1.00	1.00	\$183.12	\$183.12	Alvarez Luis&Zavala Miroslava
645 261 37 00	1.00	SFD	2	1.00	1.00	1.00	\$183.12	\$183.12	Valdez Efen&Gloria M
645 261 38 00	1.00	SFD	2	1.00	1.00	1.00	\$183.12	\$183.12	Scott Jeffery F&Guadalupe G
645 261 39 00	1.00	SFD	2	1.00	1.00	1.00	\$183.12	\$183.12	Bartolome Jayzen S
645 261 40 00	1.00	SFD	2	1.00	1.00	1.00	\$183.12	\$183.12	Toubia Jamil
645 261 41 00	1.00	SFD	2	1.00	1.00	1.00	\$183.12	\$183.12	Nichols Derrick Jr Trust 02-19-03
645 261 42 00	1.00	SFD	2	1.00	1.00	1.00	\$183.12	\$183.12	Diaz Danny&Leutangkana
645 261 43 00	1.00	SFD	2	1.00	1.00	1.00	\$183.12	\$183.12	Coco Anthony
645 261 44 00	1.00	SFD	2	1.00	1.00	1.00	\$183.12	\$183.12	Rojas Juan&Blanca A
645 261 45 00	1.00	SFD	2	1.00	1.00	1.00	\$183.12	\$183.12	Robinhood Ridge Master L L C
645 261 46 00	1.00	SFD	2	1.00	1.00	1.00	\$183.12	\$183.12	Mansibang Kristine M F
645 261 47 00	1.00	SFD	2	1.00	1.00	1.00	\$183.12	\$183.12	Obispo John M&Mayflor M
645 261 48 00	1.00	SFD	2	1.00	1.00	1.00	\$183.12	\$183.12	Castro Eduardo&Alicia
645 261 49 00	1.00	SFD	2	1.00	1.00	1.00	\$183.12	\$183.12	Morales Herman P&Teresa E
645 261 50 00	1.00	SFD	2	1.00	1.00	1.00	\$183.12	\$183.12	Pkrichter Revocable Trust 11-17-11
645 261 51 00	1.00	SFD	2	1.00	1.00	1.00	\$183.12	\$183.12	Golston Ellen

**EXHIBIT C - Assessment Roll (Fiscal Year 2015)**  
**Robinhood Ridge Maintenance Assessment District**

Parcel Number	Acres/ Units <sup>(1)</sup>	Land Use <sup>(2)</sup>	NW Otay Zone	Apportionment Factors		Total EBUs	FY 2015 <sup>(4)</sup>		Owner Name
				Land Use <sup>(2)</sup>	Benefit <sup>(3)</sup>		Unit Cost	Assessment	
645 261 52 00	1.00	SFD	2	1.00	1.00	1.00	\$183.12	\$183.12	Sepulveda Gladys A
645 261 53 00	1.00	SFD	2	1.00	1.00	1.00	\$183.12	\$183.12	Quicho Ariel&Astred Family Trust 04-16-07
645 261 54 00	1.00	SFD	2	1.00	1.00	1.00	\$183.12	\$183.12	Galang Charles B&Kuusela C
645 261 55 00	1.00	SFD	2	1.00	1.00	1.00	\$183.12	\$183.12	Amezcuca Gerardo&Rossana
645 261 56 00	1.00	SFD	2	1.00	1.00	1.00	\$183.12	\$183.12	Jaeger Matthew T
645 261 57 00	1.00	SFD	2	1.00	1.00	1.00	\$183.12	\$183.12	Medina Samantha R
645 261 58 00	1.00	SFD	2	1.00	1.00	1.00	\$183.12	\$183.12	Abille Rosalie D
645 261 59 00	1.00	SFD	2	1.00	1.00	1.00	\$183.12	\$183.12	Adams Robert E&Cynthia T
645 261 60 00	1.00	SFD	2	1.00	1.00	1.00	\$183.12	\$183.12	Garcia Jesse
645 261 61 00	1.00	SFD	2	1.00	1.00	1.00	\$183.12	\$183.12	Martinez Manuel J
645 261 62 00	1.00	SFD	2	1.00	1.00	1.00	\$183.12	\$183.12	Arias Marco A
645 261 63 00	1.00	SFD	2	1.00	1.00	1.00	\$183.12	\$183.12	Asencio Yvonne Revocable Trust 12-03-08
645 261 64 00	1.00	SFD	2	1.00	1.00	1.00	\$183.12	\$183.12	Fox Patrick J&Monica G
645 261 65 00	1.00	SFD	2	1.00	1.00	1.00	\$183.12	\$183.12	Dang Vinh Q&Elizabeth Revocable 2009 Trust
645 261 66 00	1.00	SFD	2	1.00	1.00	1.00	\$183.12	\$183.12	Aguilar Adrian A&Avila Claudia
645 261 67 00	1.00	SFD	2	1.00	1.00	1.00	\$183.12	\$183.12	Trevino Jaime A&Diana L
645 261 68 00	1.00	SFD	2	1.00	1.00	1.00	\$183.12	\$183.12	Guzman Marco A&Reyna J
645 261 69 00	1.00	SFD	2	1.00	1.00	1.00	\$183.12	\$183.12	Meaux Kyle R
645 261 75 00	1.00	SFD	2	1.00	1.00	1.00	\$183.12	\$183.12	Montenegro Anthony C&Kimberly A
645 261 78 00	1.00	SFD	2	1.00	1.00	1.00	\$183.12	\$183.12	W W W L B Investments L L C
<b>TOTAL</b>	-	-	-	-	-	<b>574.57</b>	-	<b>\$105,215</b>	

<sup>(1)</sup> Applicable units (acres or dwelling units) dependent upon Land Use.  
<sup>(2)</sup> Refer to Assessment Engineer's Report for description of Land Use and applicable Land Use Factor.  
<sup>(3)</sup> Refer to Assessment Engineer's Report for applicable Benefit Factor.  
<sup>(4)</sup> FY 2015 is the City's Fiscal Year 2015, which begins July 1, 2014 and ends June 30, 2015.