

Levels for Pipe Line, Old Town  
to N. line Military Reservation  
Page 1 to 16

Levels for Pipe Line, El Cajon Ave.  
E. line of Arizona to center of  
Louisiana Sts. Page 17 to 18

Levels on 3<sup>rd</sup> St. Laurel to Maple  
Sts. Page 20 to 21

Levels on Maple St. bet. 2<sup>nd</sup> & 3<sup>rd</sup>  
Sts. Page 23 to 24

Elevations on "H" St. from 18<sup>th</sup>  
to 20<sup>th</sup> Sts. (on curb lines)  
Page 24 to 25

Levels on W. side 3<sup>rd</sup> St. between  
D & E Streets. Page 27 to 28

Plans for Improvement of  
El Cajon Ave. Page 29 to

Cross Section 6<sup>th</sup> St. bet. Harrison  
and University Ave. Page 30 to

Cross section Potrero Ave. from E  
6<sup>th</sup> to E line of 8<sup>th</sup> St. Page 31 to 32

Sidewalk elevations on 6<sup>th</sup> St. Page 35 to 36

Levels on ...  
Page 37 to 38

...

F. B. 120



Return to City Engineers Office

TRAVERSE TABLE FOR TRANSIT BOOK.

From 1° to 90° for a distance of 100.

Degrees	DEGREES.		¼ DEGREE.		½ DEGREE.		¾ DEGREE.		Degrees
	Lat.	Dep.	Lat.	Dep.	Lat.	Dep.	Lat.	Dep.	
0			100.00	0.44	100.00	0.87	99.99	1.31	89
1	99.98	1.75	99.98	2.18	99.97	2.62	99.95	3.05	88
2	99.94	3.49	99.92	3.93	99.91	4.36	99.88	4.80	87
3	99.86	5.23	99.84	5.67	99.81	6.10	99.79	6.54	86
4	99.76	6.98	99.73	7.41	99.69	7.85	99.66	8.28	85
5	99.62	8.72	99.58	9.15	99.54	9.58	99.50	10.02	84
6	99.45	10.45	99.41	10.89	99.36	11.32	99.31	11.75	83
7	99.25	12.19	99.20	12.62	99.14	13.05	99.09	13.49	82
8	99.03	13.92	98.97	14.35	98.90	14.78	98.84	15.21	81
9	98.77	15.64	98.70	16.07	98.63	16.50	98.56	16.93	80
10	98.48	17.36	98.40	17.79	98.33	18.22	98.25	18.65	79
11	98.16	19.08	98.09	19.51	97.99	19.94	97.90	20.36	78
12	97.81	20.79	97.73	21.22	97.63	21.64	97.53	22.07	77
13	97.44	22.50	97.34	22.92	97.24	23.34	97.13	23.77	76
14	97.03	24.19	96.92	24.62	96.81	25.04	96.70	25.46	75
15	96.57	25.88	96.46	26.30	96.36	26.72	96.25	27.14	74
16	96.08	27.56	95.98	27.98	95.88	28.40	95.76	28.82	73
17	95.63	29.24	95.50	29.65	95.37	30.07	95.24	30.49	72
18	95.11	30.90	94.97	31.32	94.83	31.73	94.69	32.14	71
19	94.55	32.56	94.41	32.97	94.26	33.38	94.12	33.79	70
20	93.97	34.20	93.82	34.61	93.67	35.02	93.51	35.43	69
21	93.36	35.84	93.20	36.24	93.04	36.65	92.88	37.06	68
22	92.72	37.46	92.55	37.86	92.39	38.27	92.22	38.67	67
23	92.05	39.07	91.88	39.47	91.71	39.87	91.53	40.27	66
24	91.35	40.67	91.18	41.07	91.00	41.47	90.81	41.87	65
25	90.63	42.26	90.45	42.66	90.26	43.05	90.07	43.44	64
26	89.88	43.84	89.69	44.23	89.49	44.62	89.30	45.01	63
27	89.10	45.40	88.90	45.79	88.70	46.17	88.50	46.56	62
28	88.29	46.95	88.09	47.33	87.88	47.72	87.67	48.10	61
29	87.46	48.48	87.25	48.86	87.04	49.24	86.82	49.62	60
30	86.60	50.00	86.38	50.38	86.16	50.75	85.94	51.13	59
31	85.72	51.50	85.49	51.88	85.26	52.25	85.04	52.62	58
32	84.80	52.99	84.57	53.36	84.34	53.73	84.10	54.10	57
33	83.87	54.46	83.63	54.83	83.39	55.19	83.15	55.56	56
34	82.90	55.92	82.66	56.28	82.41	56.64	82.16	57.00	55
35	81.92	57.36	81.66	57.71	81.41	58.07	81.16	58.42	54
36	80.90	58.78	80.64	59.13	80.39	59.48	80.13	59.83	53
37	79.86	60.18	79.60	60.53	79.34	60.88	79.07	61.22	52
38	78.80	61.57	78.53	61.91	78.26	62.25	77.99	62.59	51
39	77.71	62.93	77.44	63.27	77.16	63.61	76.88	63.94	50
40	76.60	64.28	76.32	64.61	76.04	64.94	75.76	65.28	49
41	75.47	65.61	75.18	65.93	74.90	66.26	74.61	66.59	48
42	74.31	66.91	74.02	67.24	73.73	67.56	73.43	67.88	47
43	73.14	68.20	72.84	68.52	72.54	68.84	72.24	69.15	46
44	71.93	69.47	71.63	69.78	71.33	70.09	71.02	70.40	45
45	70.71	70.71							
Degrees.	Dep.	Lat.	Dep.	Lat.	Dep.	Lat.	Dep.	Lat.	Degrees.
	DEGREES.		¼ DEGREE.		½ DEGREE.		¾ DEGREE.		

Published by H. S. CROCKER COMPANY, Stationers, Drawing Materials, Mathematical Instruments, etc., San Francisco.

120

Return to City Engineers Office  
City Hall, San Diego, Cal.

50.00 - 50 - 50

45.00 - 45

40.00 - 40







5/10/02

C. Small  
Lans

Levels for Paper Lines

Old

Lawn

to the line Military Reservation

2

Sta.	+	-	D.H.	Rod	Elev.	Sta.	+	-	D.H.	Rod	Elev.
	3.55		7.99		444 = B.M.	0	4.50	5.78	6.71		2.21
-10				4.16	3.83	+50				5.15	1.56
+50				4.5	3.49	-2				4.78	1.93
-9				4.98	3.01	+50				4.60	2.11
+50				4.9	3.09	-1				4.80	1.91
-8				5.15	2.84	+50				5.22	1.49
+50				5.40	2.59	0				5.25	1.46
-7				5.75	2.24	+50				5.30	1.41
+50				5.40	2.59	1				7.05	.34
-6				5.60	2.39	+50				2.07	4.64
+50				5.75	2.24	+50				5.28	1.43
-5				6.10	1.89	2				5.88	.83
+50				5.70	2.29	+50				5.74	.97
-4				5.65	2.34	3				5.75	.96
+50				5.65	2.34	+50				5.92	.79
-3				5.80	2.19	4				5.80	.91



Sta.	+	-	O.H.	Rod	Elev.	Sta.	+	-	O.H.	Rod	Elev.
+50			6.71	5.90	.81	+50			4.46	4.92	-.46
5				6.20	.51	13				5.12	-.66
+50				6.30	.41	+50				5.10	-.64
6				6.35	.36	14				5.12	-.66
+50				6.25	.46	+50				5.08	-.62
7				6.25	.46	15				5.15	-.69
0	4.00	6.25	4.46		0.46	+50				5.05	-.59
+50				3.98	.48	16				4.85	-.39
8				4.25	.21	+50				5.20	-.74
+50				4.05	.41	0	4.05	5.20	3.31		-0.74
9				4.50	-.04	17				4.20	-.89
+50				4.58	-.12	+50				4.30	-.99
10				4.65	-.19	18				4.30	-.99
+50				4.75	-.29	+50				4.28	-.97
11				4.62	-.16	19				4.30	-.99
+50				4.78	-.32	+50				4.56	-1.25
12				4.58	-.12	20				4.70	-1.39



Sta.	+	-	S.H.	Rod	Elev	Sta.	+	-	S.H.	Rod	Elev.
+50			3.31	4.71	- 1.40	+50			24.79	8.50	16.29
B.M.		3.71	3.71		- 0.40	28				9.14	15.65
21				4.86	- 1.15	+50				11.70	13.09
+50				4.85	- 1.14	29				10.78	14.01
22				4.88	- 1.17	+50				5.90	18.89
+50				4.85	- 1.14	30				3.32	21.47
23				5.02	- 2.71	+50				0.91	23.88
+50				4.95	- 1.24	31	9.68	0.91	33.56		23.88
24				4.33	- .62	31				7.90	25.66
3	11.51	0.58	14.24		2.73	+50				6.55	27.01
+50				8.20	6.04	32				6.08	26.44
25				4.50	9.74	+50				5.50	28.06
+50				3.38	10.86	33				4.30	29.26
26				2.65	11.59	+50				3.72	29.84
+50				0.37	13.87	34				2.89	30.67
3	10.92	0.37	24.79		13.57	+37.4	out				
27				9.30	15.49	+50				4.95	30.61

Sta.	+	-	I.H.	Rod	Elev.	Sta.	+	-	I.H.	Rod	Elev.
35			33.56	2.62	30.94	+50				10.79	39.91
+50				2.20	31.36	0	3.69	10.92	43.47		39.78
36				1.31	32.25	43				11.70	31.77
0	9.95	1.31	42.20		32.25	+50				11.92	31.55
+50				9.65	32.55	44				3.20	40.27
37				9.18	33.02	0	11.85	1.09	54.23 <del>42.38</del>		42.38
+50				8.40	33.80	+50				9.60	44.73
38				5.80	36.40	45				7.53	46.70
+50				4.12	38.08	+50				4.28	49.95
39				1.80	40.40	0	11.62	0.48	65.37		53.75
0	10.30	1.80	50.70		40.40	46				7.74	57.63
+50				7.82	42.88	+50				4.53	60.84
40				6.80	44.20	47				1.94	63.43
+50				5.68	45.02	0	7.77	1.93	71.21		63.44
41				3.71	46.99	+50				5.12	66.09
+50				2.40	48.30	48 B.M.				4.22	66.99
42				4.02	46.68	+50				3.92	67.29



Sta.	+	-	B.H.	Red	Elev.	Sta.	+	-	B.H.	Red	Elev.
49				5.38	65.83	+50			52.24	1.38	50.86
+50				8.35	62.86	57				1.28	50.96
50				11.61	59.60	+50				2.80	49.44
51	2.17	11.61	61.77		59.60	58				3.12	49.12
+50				4.62	57.15	+50				1.50	50.74
51				6.66	55.11	59	5.00	1.49	55.75		50.75
+50				12.20	49.57	59				2.45	53.30
52	2.14	11.67	52.24		50.10	+50				0.82	54.93
52				11.78	40.46	60				3.12	52.63
+50				8.81	43.43	+50				8.71	47.04
53				8.12	44.12	61	0.62	11.72	44.65		44.03
+50				6.75	45.49	61				2.82	41.83
54				4.89	47.35	+50				10.09	34.63
+50				4.20	48.04	62				14.70	29.95
55				4.40	47.84	+50				4.73	39.92
+50				4.38	47.86	63				0.15	44.50
56				3.22	49.02	63	1.89	0.15	46.39		44.50

Sta.	+	-	O.H.	Rod	Elev.
+50				2.95	43.44
64				4.62	41.77
+50				5.70	40.69
65				7.12	39.27
+50				8.55	37.84
66				11.15	35.24
+	2.23	11.15	37.47		35.24
+56	out				
67				7.55	29.92
+50				10.82	26.65
68				12.70	24.77
+50				12.76	24.77
69				10.88	26.59
+50				9.54	27.93
70				9.02	28.45
+50	out				
71				11.05	26.42

Sta.	+	-	O.H.	Rod	Elev.
+50				11.48	25.99
72				11.65	25.82
+	0.42	11.65	26.24		25.82
+50				1.15	25.09
73				2.08	24.16
+50				3.15	23.09
74				4.20	22.04
+50				4.55	21.69
75				3.92	22.32
+50				4.81	21.43
76				5.28	20.96
+50				5.65	20.59
77				7.43	18.81
+50				9.58	16.66
78				11.90	14.34
+	1.55	11.90	15.89		14.34
+50				3.60	
				5.02	12.29



Sta.	+	-	D.H.	Rod	Elev.	Sta.	+	-	D.H.	Rod	Elev.
79				<del>5.02</del> 6.35	10.87	87				3.80	1.91
+50				6.35 <del>7.95</del>	9.54	+50				4.92	.79
80				7.95 <del>7.80</del>	7.94	88				6.80	- 1.11
+50				9.80 <del>8.80</del>	6.59	+50				7.95	- 2.24
81				8.50	17.39	89				6.70	- 1.01
+50				6.97	8.94	+50				7.62	- 1.91
82				5.30	9.59	90				8.46	- 2.79
+50				4.40	11.49	+50				5.44	.27
83				3.11	12.78	91				5.00	.71
+50	out					+50				4.38	1.43
84				2.18	13.71	92				3.50	2.21
+50				2.74	13.15	+50				3.15	2.66
85				4.75	11.14	93				3.23	2.48
+50				7.68	8.21	+50				2.88	2.83
86				9.58	6.31	94				3.00	2.71
+50				11.52	4.37	+50				2.22	3.49
87	1.35	11.53	5.71		4.36	95				2.00	3.71

Sta.	+	-	I.H.	Rod	Elev.	Sta.	+	-	I.H.	Rod	Elev.
±	5.07	1.98	8.80		3.73	+50				2.22	6.58
+50				5.45	3.35	104				1.60	7.20
96				5.55	3.25	±	6.35	1.59	13.56		7.21
+50				5.40	3.40	+50				5.35	8.21
97				4.90	3.90	105				7.73	5.83
+50				5.40	3.40	+50				8.10	5.46
98				6.15	4.65	106				6.64	6.92
+50				5.95	4.85	+50				6.55	7.01
99				5.52	3.28	107				5.68	7.88
+50				5.45	3.35	+50				6.20	7.36
100				4.85	3.95	108				5.80	7.76
+50				4.48	4.32	+50				5.35	8.21
101				4.23	4.57	109				6.90	6.66
+50				3.52	5.28	+50					
102				3.08	5.72	110				5.62	7.94
+50				2.90	5.90	+50				6.32	7.24
103				2.45	6.32	111				6.65	6.91

covered



Sta	+	-	I.H.	Rod	Elev	Sta	+	-	I.H.	Rod	Elev
+50				7.00	6.56	119				7.62	0.56
112				8.00	5.56	+50				7.80	0.38
+50						120				7.75	0.43
113				8.50	5.06	+50				7.60	0.58
0	8.12	8.50	8.18		5.06	0	6.10	7.59	6.69		0.59
+50				3.28	4.90	121				6.08	.61
114				2.65	5.53	+50				6.05	.64
+50				2.82	5.36	122				6.20	.49
115				3.60	4.58	+50				6.50	.19
+50				4.65	3.53	123				6.42	.27
116				5.78	4.40	+50				6.90	.21
+50				5.78	4.40	124				7.20	.51
B.M	Spk. in tel. Pole op. 116+50			4.75	3.43	+50				7.15	.46
117				6.20	1.98	125				6.80	.11
+50				6.70	1.48	+50				6.70	.01
118				6.98	1.20	126				6.60	.09
+50				7.32	0.86	+50				5.62	1.07

5/15/02

Cumwell  
Foster  
Davis

W  
10

Sta.	+	-	B.H.	Rod	Elev.	Sta.	+	-	B.H.	Rod	Elev.
127				4.72	1.97						
+50				4.60	2.09	11.21			24.27	10.00	13.06
128				4.00	2.69					8.80	14.27
+50				3.25	3.44					8.15	15.47
0	10.58	3.25	13.98		3.44	+50				8.70	16.12
129				9.70	4.28	136				7.25	16.07
+50				8.93	5.05	+50				6.65	17.02
130				8.30	5.68	137				6.85	17.62
+50				7.30	6.68	+50				6.95	17.42
131				6.10	7.88	138				6.95	17.32
+50				5.20	8.78	+50				5.95	18.32
132				4.40	9.58	139				5.45	18.82
+50				3.32	10.66	+50				5.25	19.02
133				2.80	11.18	140				4.55	19.72
+50				1.75	12.23	+50				4.45	19.82
134	B.M. Top of Plug			0.92	13.06	141				4.90	19.37
						+50				4.90	19.37
						142				5.78	18.49



Sta.	+	-	I.H.	Rod	Elev	Sta.	+	-	O.H.	Rod	Elev.
+50				5.38	18.89	+50				5.42	20.40
143				5.10	19.17	151				5.55	23.27
+50				5.30	18.97	+50				6.10	22.72
144				4.90	19.37	152				7.15	21.67
+50				5.05	19.12	+50				8.10	20.72
145				4.80	19.47	153				8.90	19.92
+50				4.45	19.82	+50				8.90	19.92
146				4.02	20.25	0	11.50	8.88	32.44		20.94
0	8.60	4.05	28.82		20.22	154				9.12	23.32
+50				7.68	21.14	+50				4.65	29.79
147				6.90	21.87	155				0.75	31.69
+50				5.86	22.90	0	11.71	0.75	43.40		31.69
148				5.82	23.00	+50				9.00	34.40
+50				6.06	22.76	156				9.10	34.30
149				5.48	23.34	+50				8.60	34.80
+50				5.81	23.51	157				0.92	42.48
150				5.32	23.50	0	11.91	0.92	54.39		42.48

Sta.	+	-	I.H.	Rod	Elev.
+50				8.45	45.94
158				6.07	48.32
+50				2.70	51.69
159				1.10	53.29
+50				2.57	51.82
160				4.22	50.17
+50				6.90	47.49
161				8.88	45.51
+50				11.20	43.19
8	2.05	11.20	45.24		43.19
162				6.68	38.56
+50				8.36	36.89
163				11.22	34.02
8	1.12	11.26	35.10		33.98
+50				5.92	29.18
164				10.82	24.28

Sta	+	-	I.H.	Rod	Elev
8	0.58	11.72	23.96		23.38
+50				4.72	19.24
165				7.98	15.98
+50				8.48	15.48
166				7.40	16.56
+50				5.53	18.13
167				4.50	19.46
+50				5.36	18.60
168				5.25	18.71
+50				6.50	17.46
169				5.13	18.83
+50				7.20	16.76
170				9.50	14.46
+50				12.30	11.66
8	3.49	10.38	17.13		13.64
171	ant				
+50				9.41	7.72



Sta.	+	-	I.H.	Red	Elev	Sta.	+	-	I.H.	Red	Elev
172				12.60	4.53	179				2.58	14.59
+50				5.52	11.61	0	10.73	2.58	25.32		14.59
173				3.10	14.03	+50				9.52	15.80
B.M. Post opp. 173+50				3.25	13.88	150				8.03	17.29
+50				5.18	11.95	+50				6.74	18.58
174				2.35	14.78	B.M.			<del>8.31</del>	8.31	17.01
+20.7				1.78	15.35	181			5.	5.98	19.34
	3.29		17.17	R.M. 13.88		+50				8.20	17.12
+50				3.42	13.75	182				5.75	19.57
175				8.82	8.35	+50				6.41	18.91
+50				10.50	6.67	183				7.72	17.60
176				10.53	6.64	+50				9.35	15.97
+50				11.37	5.80	184				9.15	16.17
177				10.80	6.37	+50				8.55	16.77
+50				8.72	8.45	0	0.33	11.17	14.48		14.15
178				6.00	11.17	185				11.85	2.63
+50				4.25	12.92	+50				12.00	2.48

Sta.	+	-	O.H.	Red	Elev.
186				11.32	3.16
+50				14.40	0.08
187				14.80	-0.32
+50				15.60	-1.12
188				14.20	0.28
+50				6.95	7.53
189				10.58	3.90
+50				5.62	8.86
190				4.45	10.03
+50	out				
191				4.95	9.53
+50				4.48	10.00
⊖	8.11	4.48	18.11		10.00
192				8.47	9.64
+50				8.20	9.91
193				7.55	10.56
+50				6.60	11.51

Sta.	+	-	O.H.	Red	Elev.
194				6.00	12.11
+50				5.72	12.39
195				4.92	13.19
+50				3.88	14.23
196				4.92	13.19
+50				4.59	13.52
B.M.				<del>5.60</del>	5.60
197				5.78	12.39
+50				5.90	12.21
198				6.18	11.93
+50				5.92	12.19
199				6.22	11.89
+50				6.55	11.56
200				8.18	9.93
⊖	8.41	8.18	18.34		9.93
+50				8.88	9.46
201				9.22	9.12



Sta.	+	-	O.H.	Rod	Elev.	Sta.	+	-	O.H.	Rod	Elev.
+50				8.03	10.31	+50				3.88	22.45
202				6.70	11.64	210				1.98	24.35
+50				5.75	12.59	+50				3.35	22.98
203				5.50	12.84	211				2.45	23.88
+50				5.78	12.56	⊖	6.58	2.44	30.47		23.59
204				6.05	12.29	+50				5.82	24.65
+50				5.42	12.92	212				4.51	25.96
205				5.22	13.12	+50				4.65	25.82
+50				3.82	14.52	213				5.65	24.82
206				2.06	16.28	+50				5.95	24.49
⊖	8.41	0.42	26.33		17.92	214				5.85	24.62
+50				8.23	18.10	+50				5.52	25.15
207				6.25	20.08	215				5.40	25.07
+50				6.12	20.21	+50				5.70	25.27
508				5.52	20.81	216				6.73	23.74
+50				5.80	20.53	+50				8.15	22.32
209				5.12	21.21	217				9.54	20.93

Sta.	+	-	O.H.	Rod	Elev
0	2.99	9.54	23.92		20.93
+50				3.83	20.09
218				5.70	18.22
+50				7.15	16.77
219				7.71	16.21
+50				8.92	15.70
220				8.18	15.74
+50				8.78	15.14
221				11.12	12.80
0	7.90	11.11	20.71		12.81
+50				8.65	12.06
222	out-				
+50				10.10	10.61
223				9.30	11.41
+50				4.70	16.01
224				2.35	18.36
+50				0.73	19.98

Sta.	+	-	O.H.	Rod	Elev.
0	11.14	0.73	31.12		19.98
225				7.03	24.09
+50				4.70	26.92
226				2.11	29.01
+50					
0	5.57	2.11	34.58		29.01
+50				4.10	30.48
+83				3.78	30.80



6/5/12

18

Sinks for Pipe line on El Cajon Ave

Sta	+	-	O.H.	Rod	Elev.	Sta	+	-	O.H.	Rod	Elev
						+50					9.71
	3.58		350.80		377.25 BM !	6					7.62
0	1.64	11.40	371.07			+50					7.67
0	9.12	11.09	360.10			7					6.68
0				10.72	349.38	+50					4.82
0	10.72	0.32	349.70		349.38	8					1.70
+50					4.36						
1					7.40						
+50					9.37						
2					10.95						
+50					12.20						
0	4.71	11.68	340.73		338.02						
3					3.96						
+50					5.30						
4					5.78						
+50					7.93						
5					9.13						

Hand

6/5/02

Levels for Paper  
E. line of Arizona St. to

Sta	+	-	O.H.	Red	Elw.
	7.81		330.91		323.10-10m
8				1.82	329.59
+50				4.95	325.96
7				6.70	324.21
+50				7.78	323.13
6				7.75	323.16
+50				9.87	321.04
5				9.30	321.61
+50				8.08	322.83
4				5.88	325.03
+50				5.40	325.51
3				4.03	326.88
+50				3.20	327.71
2				2.11	328.80
0	12.10	2.11	340.90		328.80
+50				10.46	330.45
1				8.56	332.34

Area on El Cajon Ave -  
Center of Louisiana St-19

Sta	+	-	O.H.	Red	Elw
					5.52 335.38
+50					1.50 339.40

Sta 0, - E. line of Arizona.



3rd St. Laurel to Maple-

6/7/02

Cowell  
Furber  
Downie257.21 = R.M. +  
5.78

-

O.H.

Red

Elw

Curb

5.07 247.68

1/4

4.56 248.20

251.21 5.78

256.99

50' South Maple

0 3.71

7.96

252.75

249.04

1/4

5.75 247.50

South Line Maple

Curb

5.30 247.45

1/4 side

4.10

248.65

1/4

5.40 247.35

Curb

4.3

248.45

C

5.1 247.65

1/4

4.25

248.50

1/4

5.78 246.97

C

4.0

248.75

cuttin

6.03 246.72

1/4

4.5

248.25

E

Walk

cuttin

4.2

248.55

75' South of Maple

E side

current curb + walk

E

Walk

25' S. of Maple

cuttin

7.0 245.75

E side

Walk

1/4

6.45 246.30

cuttin

5.17

247.58

C

5.52 247.23

1/4

4.95

247.80

1/4

5.62 247.13

C

4.70

248.05

Curb

5.68 247.07

1/4

4.75

248.00

1/4

5.62 247.13

## 100' South Maple

W	6.22	246.53
curb	6.30	246.45
1/4	6.30	246.45
C	6.05	246.70
1/4	7.10	245.65
Gutter	7.78	244.97

Walk

## 125' S. of Maple

E Walk		
Gutter	8.68	244.07
1/4	7.78	244.97
C	6.63	246.12
1/4	7.30	245.45
curb	6.92	245.83
W	7.10	245.65

## 150' S. Maple

W	7.70	245.55
curb	7.95	244.80
1/4	8.15	244.60
C	7.50	244.95
1/4	8.35	244.40
Gutter	9.1	243.65
E	8.40	244.35

## 175' S. Maple

E	9.00	243.75
curb	9.40	243.35
1/4	9.0	243.75
C	9.03	243.72
1/4	9.40	243.35
curb	9.25	243.50
W	9.42	243.33



200' S. Maple

W	11.6	241.15
curb	11.2	241.55
1/4	11.0	241.75
C	10.8	241.95
1/4	10.6	242.15
curb	10.15	242.60
E	9.82	242.93

2150 9.58 248.67 243.17

225' S. Maple

E	3.60	242.07
curb	4.18	241.49
1/4	4.62	241.05
C	4.80	240.87
1/4	5.02	240.65
curb	5.15	240.52
W	5.53	240.14

250' S. Maple

W	6.28	239.39
curb	6.0	239.67
1/4	5.98	239.69
C	5.80	239.87
1/4	5.70	240.47
curb	4.80	240.87
E	3.85	241.82

275' S. Maple

E	4.30	241.37
curb	5.40	240.27
1/4	6.10	239.57
C	6.52	239.15
1/4	6.68	238.99
curb	6.80	238.87
W	6.90	238.77

North line Laurel

W	7.72	237.95
curb	8.20	237.47
1/4	8.08	237.59
C	7.95	237.72
1/4	7.68	237.99
curb	7.88	237.82
E	6.80	238.87

6/7/02

curb  
fashion  
leaves

Maple St bet 2nd & 3rd

23

5.12	Hil 254.16	249.04
------	---------------	--------

West line 3rd St

S	5.48	248.68
curb	5.88	248.28
1/4	5.38	248.78
C	4.92	249.24

25' W of 3rd

C	5.02	248.84
1/4	5.45	248.71
curb	6.15	248.01
S	5.93	248.23

50' W. of 3rd

S	6.10	248.06
curb	6.40	247.74
1/4	5.28	248.88
C	5.15	249.01



75' w. of 3<sup>rd</sup>

C	4.92	249.24
1/4	5.48	248.68
curb	6.55	247.61
S	6.22	247.94

100' w. of 3<sup>rd</sup>

S	5.80	248.36
curb	6.35	247.81
1/4	5.58	248.58
C	5.42	248.74

Maple 3<sup>rd</sup> to 2<sup>nd</sup>  
North side

24

4.57      253.61      249.64

N	w of 3 <sup>rd</sup>	3.32	250.29
curb		4.28	249.33
1/4		4.22	249.39

50' w of 3<sup>rd</sup>

N		3.80	250.31
curb		3.80	249.81
1/4		4.35	249.26

100' w. of 3<sup>rd</sup>

1/4		4.62	248.99
curb		4.82	249.29
N		3.50	250.11

150' w of 3<sup>rd</sup>

N		3.73	249.88
curb		4.70	248.91
1/4		4.65	248.96
C		4.70	248.91
1/4		4.20	249.41

see page 28

6/13/02 Elevations on H St.  
from 18<sup>th</sup> to 20<sup>th</sup> St.  
(on curb lines)

(Cornell  
Davis)

25

Sta	+	-	O.H.	Rod	Elw.
	11.42		60.48		49.06 = R.H.

E. side 18<sup>th</sup> St.

S			9.08		51.40
---	--	--	------	--	-------

N			7.60		52.88
---	--	--	------	--	-------

25' E. of 18<sup>th</sup>

N			6.13		54.35
---	--	--	------	--	-------

S			7.59		52.89
---	--	--	------	--	-------

50' E. of 18<sup>th</sup>

S			5.88		54.60
---	--	--	------	--	-------

N			4.62		55.86
---	--	--	------	--	-------

75' E. of 18<sup>th</sup>

N			3.03		57.45
---	--	--	------	--	-------

S			4.10		56.38
---	--	--	------	--	-------

100' E. of 18<sup>th</sup>

S			2.40		58.08
---	--	--	------	--	-------

N			1.41		59.07
---	--	--	------	--	-------

O	11.18	1.03		70.63	59.45
---	-------	------	--	-------	-------

125' E. of 18<sup>th</sup>

N			9.62		61.01
---	--	--	------	--	-------

S			10.70		59.93
---	--	--	-------	--	-------

150' E. of 18<sup>th</sup>

S			9.15		61.48
---	--	--	------	--	-------

N			7.61		63.04
---	--	--	------	--	-------

175' E. of 18<sup>th</sup>

N			5.40		65.23
---	--	--	------	--	-------

S			7.15		63.48
---	--	--	------	--	-------

11. line 19<sup>th</sup>

S			5.45		65.18
---	--	--	------	--	-------

N			3.40		67.23
---	--	--	------	--	-------



0 11.66 0.78 81.51 69.85

E. line 19<sup>th</sup>

S 12.40 69.11

N 10.45 71.06

25' E of 19<sup>th</sup>

N 8.69 72.82

S 11.20 70.31

50' E of 19<sup>th</sup>

S 9.13 72.38

N 6.84 74.67

75' E of 19<sup>th</sup>

N 4.90 76.61

S 7.20 74.31

100' E of 19<sup>th</sup>

S 5.30 76.21

N 2.92 78.59

125' E of 19<sup>th</sup>

N 0.99 80.52

S 3.38 78.13

0 8.80 0.88 89.43 80.63

150' E of 19<sup>th</sup>

S 9.38 80.05

N 6.83 82.60

175' E of 19<sup>th</sup>

N 4.83 84.60

S 7.39 82.04

71. line 20<sup>th</sup>

S 5.61 83.82

N 3.00 86.43

chk on 18.12 3.38

86.05

86.06

6/17/02

Levels on that side  
of 3<sup>rd</sup> St. Int. dl + E.  
canceled  
down

27

Sta	+	-	I.H.	Red	Elv =	Grads
	8.06		42.62		34.56 = R.M.	
S. line dl				3.08	39.54	39.50
50' S "				4.05	38.57	38.33
100' S "				5.01	37.61	37.17
135' " "				5.66	36.96	36.36
150' " "				6.88	35.74	36.20
185' " "				7.63	34.99	35.19
0	4.42	3.08	43.96		39.54	

 Engine  
House



curb		4.15	
S		4.25	249.46
	E. line 2 <sup>nd</sup>		
S		5.50	248.11
curb		5.30	248.31
1/4		5.35	248.26
C		5.70	247.91
1/4		7.50	246.11
curb		7.00	246.61
N		4.70	248.91

6/26/02

El Cajon Avenue

T.P.	1.80	101.80	100.00
0	1.22	12.03	90.99
	1.24	12.15	86.08
	2.92	8.55	74.25

Grades for Improvement  
of  
El Cajon Ave

29

0	98.00
1	92.00
2	86.00
3	80.00
4	74.00
5	70.02
6	66.66
7	63.00



7/28/02

Cowell  
Hobbs  
Lewis

30

Cross sections of 6<sup>th</sup> St

+	-	B.H.	Rod.	287.17
		291.96		287.17

North line Robinson ave

W. line	4.79	287.17
curb	5.58	286.38
1/4	5.62	286.34
C	6.32	285.64
1/4	6.55	285.41
curb	7.00	284.96
E. line	7.76	284.20

25' N. of Rob. ave.

E. line	8.58	283.38
curb	7.15	284.81
1/4	7.24	284.72
C	6.72	285.24
1/4	6.00	285.96
curb	5.72	286.24

East Robinson Ave. + Univ. Ave.

W. line	5.10	287.17
		4.79
		291.96
		286.86

50ft N. Rob. Ave

W. line	5.10	286.86
curb	5.62	286.34
1/4	6.75	285.21
C	6.90	285.06
1/4	7.10	284.86
curb	7.00	284.96
E. line	7.60	284.36

75' N. Rob. Ave.

E. line	8.15	283.81
curb	7.52	284.44
1/4	7.40	284.56
C	6.82	285.14
1/4	6.15	285.81
curb	5.65	286.31
W. line	5.32	286.64

100 ft. N. of Rob. Ave

N. line	5.40	286.56
curb	6.22	285.74
1/4	6.52	285.44
C	6.78	285.18
1/4	7.00	284.96
curb	6.98	284.98
E. line	6.92	285.04

Cross-sections Robinson Ave  
from E. line 6<sup>th</sup> to E. line of 31  
5<sup>th</sup> St

291.96

E. line	E. line of 6 <sup>th</sup> St.		
N. line		7.70	284.26
curb		7.15	284.81
1/4		7.55	284.41
C		7.55	284.41
1/4		7.70	284.26
curb		7.70	284.26
S. line		7.70	284.26

Centre of 6<sup>th</sup> St

S. line	6.88	285.08
1/4	6.50	285.46
C	6.32	285.64
1/4	6.45	285.51
N. line	5.92	286.04



West line of 6<sup>th</sup>

N. side	4.79	287.17
curb	5.20	286.76
1/4	5.40	286.56
C	5.40	286.56
1/4	4.30	287.66
curb	3.30	288.66
S. line	6.00	285.96

175 ft. E. of 5<sup>th</sup>

S. line	3.92	288.04
curb	3.42	288.54
1/4	3.22	288.74
C	3.88	288.08
1/4	3.15	288.81
curb	3.48	288.48
N. line	4.18	287.78

150 ft. E. of 5<sup>th</sup>

N. line	3.71	288.25
curb	3.58	288.38
1/4	3.52	288.44
C	3.78	288.18
1/4	3.73	288.23
curb	3.68	288.28
S. line	3.18	288.78

125 ft. E. of 5<sup>th</sup>

S. line	2.22	289.74
curb	2.92	289.04
1/4	3.35	288.61
C	3.30	288.66
1/4	3.12	288.84
curb	3.40	288.56
N. line	3.40	288.56

100 ft. E. of 5<sup>th</sup> St.

N. line	2.98	288.98
curb	2.92	289.04
1/4	3.08	288.88
C	2.98	288.98
1/4	1.88	290.08
curb	2.28	289.68
S. line	3.20	288.76

75 ft. E. of 5<sup>th</sup> St.

S. line	2.85	289.11
curb	2.90	289.06
1/4	2.85	289.11
C	2.90	289.06
1/4	2.80	289.16
curb	2.70	289.26
N. line	2.52	289.44

50 ft. E. of 5<sup>th</sup> St.

N. line	2.35	289.61
curb	2.35	289.61
1/4	2.60	289.36
C	2.08	289.88
1/4	2.18	289.78
curb	2.52	289.44
S. line	2.25	289.71

25 ft. E. of 5<sup>th</sup> St.

S. line	2.45	288.51
curb	2.45	289.51
1/4	2.30	289.66
C	2.05	289.81
1/4	2.80	289.16
curb	2.80	289.16
N. line	2.65	289.31



E. line of 5<sup>th</sup> M.

N. line	3.70	288.26
carb	3.90	288.06
1/4	3.95	288.01
C	3.72	288.24
1/4	3.80	288.16
carb	2.82	289.14
E. line	3.20	288.76

(Justin  
Davis)

September 2nd. 1907

- ✓ 5" St. ✓ B to F. Sidewalk and curb Both sides R
- ✓ F to ash " " " " R
- ✓ F to Beach " " " " R
- ✓ except 50' with return at N.W. cor of ash
- ✓ (Wooden walk and return in)
- ✓ Beech to Cedar Side walk, curb and R.
- ✓ in on West side except 50'-50' from
- ✓ cor of Cedar.
- ✓ Beech to Cedar Sidewalk, curb and R.
- ✓ in on East side except Return and 75'
- ✓ at cedar St. South.
- ✓ Cedar to Date, Sidewalk, curb and R.
- ✓ in on West side of street.
- ✓ Cedar to Oak. Sidewalk, curb and R
- ✓ in on East side of street except Return
- ✓ and 100' North from cor of Cedar
- ✓ and 50' from 150 to 200' north
- ✓ of Cedar

35

- ✓ Oak to Elm. Sidewalk, curb and
- ✓ Returns in Both sides of Street.
- ✓ Elm to Fir. Sidewalk, curb and
- ✓ Returns in Both sides of Street.
- ✓ Fir to Grape: Sidewalk, curb and
- ✓ Returns in Both sides of street
- ✓ Grape to Hawthorne: Sidewalk, curb and
- ✓ Returns in Both sides of street.
- ✓ Hawthorne to Ivy. Sidewalk, curb and
- ✓ Returns in Both sides of street except
- ✓ Return at N.W. cor 5" + Hawthorne and
- ✓ Return S.E. cor 5" + Ivy st
- ✓ Ivy to Juniper Sidewalk, curb and
- ✓ Returns in both sides of street except
- ✓ 50' from 150 to 200' N. of Ivy. on
- ✓ West side of St.
- ✓ Juniper to Kalmia: Sidewalk, curb and
- ✓ Returns in both sides of street.



- ✓ Kalmia to Laurel: Sidewalk, curb and
- ✓ Returns in both sides of street.
- ✓ Laurel to Maple: Sidewalk, curb and
- ✓ Returns in both sides of street
- ✓ Maple to Nutmeg: sidewalk, curb and
- ✓ Returns in both sides of street.
- ✓ Nutmeg to Olive: sidewalk, curb and
- ✓ Returns in both sides of street.
- ✓ Olive to Palm: Sidewalk, curb and
- ✓ Returns in both sides of street.
- ✓ Palm to Quince: Sidewalk, curb and
- ✓ Returns in both sides of street
- ✓ Quince to Redwood: Sidewalk, curb and
- ✓ Returns in both sides of street.
- ✓ Redwood to Spruce: Sidewalk, curb
- ✓ and Returns in both sides of street.
- ✓ Spruce to Thorn: Sidewalk, curb and
- ✓ Returns in both sides of street.

- ✓ Thorn to Upas: Sidewalk, curb and
- ✓ Returns in West side of street. No
- ✓ walks, curb or returns on East side.
- ✓ Upas to Walnut: Sidewalk, curb and
- ✓ Returns in on West side except 39' and
- ✓ Returns at N.W. cor 5th & Upas.
- ✓ Upas to Walnut: Sidewalk, curb
- ✓ in on East side from Hutton's Division
- ✓ Line to South line of Walnut.
- ✓ N.W. cor 5th & Walnut St. Return,
- ✓ Sidewalk and Curb in for 150'
- ✓ North.
- ✓ N.W. cor 5th & Brooks Ave. Return.
- ✓ Sidewalk and curb in from
- ✓ Cor Brooks 150' North.
- ✓ Lot 4 Block 6 Brooks
- ✓ Addition 50' sidewalk and Curb
- ✓ in.

5' from 5th & Walnut St. (one side)  
50' from curb in

- ✓ Lot 1 Block 5 Berwick addition
- ✓ 50' and Return in (Wooden curb.)
- ✓ N.W. cor 5th and Robinson Streets,
- ✓ Return, sidewalk (cement) in for 200'
- ✓ Wash and (Wooden curb for same)



Levelling over Main Line 9/11/02  
in Pound Canyon

Sta.	+	-	I.H.	Red.	Elev.
	2.80	10.18	92.17		89.57 = 10.11
	6.64		88.63		81.99
501.35				5.80	82.83
0	10.37	5.80	93.20		82.83
8				5.03	85.17
11				4.08	89.12
2	11.37	4.08	100.49		89.12
14				3.88	96.61
			100.49		
	5.09	10.51	95.07		89.98

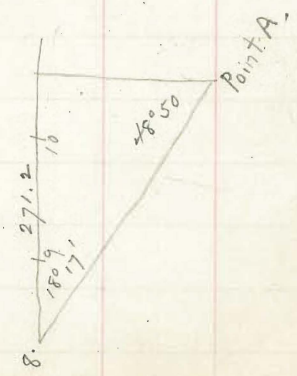

100.49		95.07		271.2
97.56		87.56		
97.5	2.99	87.5 = 7.57		18° 17'
	2.50			
95.0	5.49	85.0 = 10.07		48° 50'
	2.50			
92.5 =	7.99	82.5 = 12.57		
	2.50			
90. =	10.49			

38

14 =	96.61	100. =	197.07		123.17
+	10.46		106.07		17.5
J.H.	107.07	102.5	7.07 = 2.50		115. = 8.17
	0.96		4.57 =		2.50
F.P. =	107.81		114.77		117.5 = 5.67
T.P.	106.11	105. =	105.00		2.50
	8.66		9.77 = 2.50		120.0 = 3.15
J.H.	114.77	107.5 =	7.27		129.47
	2.42		7.27 = 2.50		125. =
T.P.	112.35	110. =	4.77		120 = 9.47
	10.82		2.50		12.50
J.H.	123.17	112.50	2.27		122.5 = 6.97
	0.90				2.50
T.P.	122.27				125 = 4.47
	7.26				
	129.47				

B.M.	93.20	93.27	103.62	8.62
	4.05		92.50	2.50
	89.12	82.50		6.12
	4.15	82.5 = 10.77	92.50 =	11.12
	2.97		2.50	
	4.15	85. = 8.27	95.00 =	8.62
		2.50	2.50	
J.H.	93.27	87.50 = 5.77	97.5 =	5.12
	1.32		2.50	
T.P.	91.95	90. = 3.27	100.0	3.62
	11.67		2.50	
I.H.	103.62		102.50	1.12
	0.75			
T.P.	102.87	105. =	113.87	
	11.00		10.5	
J.H.	113.87	107.50	6.37	
			2.50	
		110. =	3.87	
			2.50	
		112.5	1.37	

on W. side commence at 110 - from Down Hill

J.H. = 111.00		121.64
- 1.00		115.00
T.P. = 110.00 B.M.	115 = 6.64	
+ 11.64	5,	
J.H. = 121.64	120 = 1.64	
- 11.85		127.86
T.P. = 119.79	125 = 2.86	
+ 8.07	5,	
J.H. = 127.86	120 = 7.86	
- 11.67		126.54
T.P. = 116.19	125 = 1.54	
+ 4.46	5,	
120.65	120 = 6.54	
- 0.11		
T.P. = 120.54		
6.4.0		
J.H. = 126.54		

110.00	110 = 9.84
9.84	5,
J.H. = 119.84	115 = 6.84
0.38	
T.P. = 119.46	120 = 28.54
9.08	120,
J.H. = 128.54	8.54
	5,
	3.54

110.	
0.99	
110.99	
105 = 10.99	
5.99	
5,	
100 = 10.99	

J.H. = 113.87	115 = 6.99
1.75	2.50
J.H. = 112.12	117.5 = 4.49
+ 9.87	
J.H. = 121.99	129.24
- 3.43	120,
T.P. = 118.56	120 = 9.24
10.68	2.50
J.H. = 129.24	122.5 = 6.74
- 2.21	2.50
T.P. = 127.03	125.0 = 4.24
+ 3.73	
J.H. = 130.76	89.91
85.17	82.5 = 7.41
+ 4.74	2.50
J.H. = 89.91	80 = 9.91 +
2.92	82.5 = 7.41 ✓
T.P. = 86.98	2.50
6.32	85 = 4.91 ✓
J.H. = 93.30	2.50
	87.5 = 2.41
	115.12
	105 = 10.12
	2.50
	82.83
	+ 82.78
	85.61
	80,
	80 = 5.61
	2.50
	82.5 = 3.11

J.H. = 100.80
+ 1.58
102.38

J.H. = 100.80
1.58
T.P. = 99.22
11.78
111.00
5,
6

130.76	El. = 82.83
120 = 10.76	4.05
2.50	86.88
122.5 = 8.26	82.83
2.50	86.83
125 = 5.76	82.83
	+ 11.33
	J.H. = 94.16
	87.5 = 6.66
	2.50
	90 = 3.16
	2.50
	J.H. = 94.16
	+ 0.25
	4.41
	J.H. = 94.16
	0.25
	T.P. = 93.91
	+ 10.92
	J.H. = 104.83
	5.86
	T.P. = 103.97
	+ 11.15
	J.H. = 115.12
	0.32
	T.P. = 114.80
	12.50
	127.30
	115 = 115
	12.30
	2.50
	117.5 = 9.80
	2.50
	114 = 96.61
	+ 4.19
	J.H. = 100.80
	90
	90 = 10.80
	85 = 5.80
	111.00
	100.
	100 = 11.00
	5
	105 = 6.00
	5
	110 = 1



B.M. = 110.00  
 + 1.84  
 J.H. = 111.84  
 - 11.43  
 T.P. = 100.41  
 + 7.86  
 108.27  
 - 1.90  
 T.P. = 106.37  
 + 9.43  
 J.H. = 115.80  
 - 1.06  
 T.P. = 114.74  
 + 11.78  
 J.H. = 126.47  
 - 11.82  
 T.P. = 114.65  
 + 1.96  
 J.H. = 116.61  
 - 11.83  
 28.44  
 T.P. = 104.78  
 + 8.25  
 J.H. = 113.03  
 - 1.64  
 T.P. = 111.39  
 + 10.04  
 J.H. = 121.43  
 - 1.14  
 T.P. = 120.29  
 + 10.55  
 J.H. = 130.84  
 - 9.95  
 T.P. = 120.89  
 + 4.02  
 124.91  
 J.H. = 124.91  
 - 12.04  
 T.P. = 112.87

108.27  
 95.06  
 13.27  
 100 = 8.27  
 105 = 3.27  
 110 = 5.80  
 115 = 11.47  
 120 = 6.47  
 125 = 11.47  
 100 = 13.03  
 105 = 8.03  
 110 = 3.03  
 115 = 6.43  
 120 = 1.43  
 125 = 5.84  
 120 = 10.84  
 124.91  
 110.8  
 115 = 9.91

T.P. = 112.87  
 + 4.95  
 J.H. = 117.82  
 - 0.93  
 T.P. = 116.89  
 + 11.24  
 J.H. = 128.13  
 - 0.83  
 T.P. = 127.30  
 + 1.63  
 J.H. = 128.93  
 - 4.15  
 B.M. = 124.78 =  
 5.07

33+85

129.85  
 11.92  
 117.93 on ~~long~~ within state

110 = 7.82 *finis*  
 115 = 02.82  
 120 = 8.13  
 125 = 3.13  
 120 = 8.93  
 125 = 3.93  
 125 = 4.85  
 127.5 = 7.35  
 120 = 9.85  
 2.10  
 127.5 = 12.35  
 117.93  
 117.50  
 12.3

Sep 24-1902

Sta	B.S.	In	F.S.	El.
	3.82			117.93
		121.25	3.75	117.50
		"	6.25	115.00
		"	8.75	112.50
		"	1.25	120.00
J.P.	10.53	"	0.92	120.33
		130.86	8.36	122.50
		"	5.86	125.00
		"	3.36	127.50
J.P.	9.96	"	.86	130.00
		139.96	7.46	132.50
		"	4.96	135.00
		"	2.46	137.50
		"	-0.04	140.00
J.P.	11.53	"	0.78	139.18
		150.71	8.21	142.50
		"	5.71	145.00
		"	3.21	147.50
		"	0.71	150.00
J.P.	10.84	"	1.64	149.07
		159.91	7.41	152.50
		"	4.91	155.00
		"		160.00
J.P.	11.68	"		117.93
		129.61	7.14	122.50
		"	4.64	125.00
		"	2.14	127.50
J.P.	9.86	"	0.76	128.85
		138.71	8.71	130.00
		"	6.21	132.50
		"	3.71	135.00
		"	1.21	137.50

Wallace

115.0  
2.5  
117.5  
2.5  
**120.0**

Sta	B.S.	In	F.S.	El.
J.P.	10.97		1.66	137.11
		148.08	8.08	140.00
		"	5.58	142.50
		"	3.08	145.00
		"	0.58	147.50
J.P.	11.45	"	0.34	147.74
		159.19	9.19	150.00
		"	6.69	152.50
		"	4.19	155.00
J.P.	11.49			117.93
		10.63	129.42	0.27
			139.77	7.27
				132.50
				129.15
				140.74
			8.24	132.50
			5.74	135.00
			3.24	137.50
			0.74	140.00
			1.42	139.32
			7.72	142.50
			5.22	145.00
			2.72	147.50
J.P.	10.07	"	0.48	149.74
		159.81	9.81	150.00
		"	7.31	152.50
		"	4.81	155.00
				117.93
				127.56
			.06	127.50
			2.33	130.00
				125.23
				136.53



C. Fortner  
H. David

42

	136.58	6.53	130.00	
	"	4.03	132.50	
	"	1.53	135.00	
		.53	140.00	
J.P.	8.57	1.82	134.71	
	143.28	3.28	140.00	
11.28		1.25	142.03	
	153.41	8.41	145.00	
		3.41	150.00	
J.P.	6.90	2.98	150.43	
	157.33	2.33	155.00	
12.M.	11.32	<del>4.33</del>	117.93	
	129.25	9.25	120.00	
		4.25	125.00	
13.M.	11.20	<del>1.75</del>	<del>128.98</del>	13.M.
	140.18	10.18	130.00	
		5.18	135.00	
		0.18	140.00	
J.P.	9.55	1.36	138.82	
	148.37	3.37	145.00	
J.P.	11.12	1.36	147.01	
	158.11	8.11	150.00	
		3.11	155.00	
	4.68	4.68	155.00	
		9.68	150.00	
3.48	151.26	11.90	147.78	
		6.26	145.00	
		11.26	140.00	
0.72	140.11	11.47	139.39	
		5.11	135.00	
	"	10.11	120.00	
	"	7.15	132.96	

B.M.  
upper plug  
X-41.

West Side

No. side of a  
25' No. of a.









50' North of Date	132.58	0.6 131.98	0.5 131.78	0.3 132.28
75' " " "	133.37	0.7 132.60	0.9 132.47	0.2 133.17
100' " " "	134.16	0.8 133.36	1.0 133.16	0.4 133.70
125' " " "	134.96	0.9 134.06	1.1 133.86	0.6 134.36
150' " " "	135.75	0.8 134.95	1.1 134.65	0.8 134.95
175' " " "	136.54	1.1 135.44	1.1 135.44	0.4 136.14
200' " " "	137.33	0.9 136.43	1.1 136.23	0.3 137.03
225' " " "	138.12	0.7 137.42	0.5 137.62	0.2 137.92
250' " " "	138.92	0.6 138.32	0.3 138.62	0.3 138.62
275' " " "	139.71	0.3 139.41	0.3 139.41	0.3 139.41
South Side Elm	140.5	0.5 140.00	0.6 139.90	0.3 140.20

## East Side

North Side Date	131.0	0.0 131.0	0.0 131.0	0.0 131.0
25' North Date	131.79	0.3 131.49	0.3 131.49	0.2 131.59
50' " " "	132.58	0.6 131.98	0.5 132.08	0.4 132.18
75' " " "	133.37	1.0 132.37	0.9 132.47	0.3 133.07
100' " " "	134.16	0.7 133.46	0.9 133.26	0.2 133.96
125' " " "	134.96	0.7 134.26	1.0 133.96	0.2 134.76

150' North Date	135.75	0.6 135.15	0.7 135.05	0.1 135.65
175' " " "	136.54	0.6 135.94	0.8 135.74	0.1 136.44
200' " " "	137.33	0.4 136.93	0.7 136.63	0.2 137.13
225' " " "	138.12	0.7 137.42	0.9 137.22	0.2 137.92
250' " " "	138.92	0.7 138.22	0.9 138.02	0.4 138.52
275' " " "	139.71	0.8 138.91	0.7 139.01	0.0 139.71

## South Side Elm

140.5	0.8 139.70	0.9 139.60	0.3 140.20
-------	---------------	---------------	---------------

## West Side

North Side Elm	142.0	0.1 141.90	0.2 141.80	0.0 142.0
25' North Elm	143.21	0.4 142.81	0.5 142.71	0.2 143.01
50' " " "	144.42	0.7 143.72	0.2 144.22	0.0 144.42
75' " " "	145.62	0.6 145.02	0.0 145.62	0.0 145.62
100' " " "	146.83	0.6 146.23	0.2 146.63	0.2 146.63
125' " " "	148.04	0.8 147.24	0.5 147.54	0.6 147.44
150' " " "	149.25	0.8 148.45	0.5 148.75	0.5 148.75
175' " " "	150.46	0.5 149.96	0.7 149.76	0.4 150.06
200' " " "	151.67	0.7 150.97	0.9 150.97	0.4 151.27
225' " " "	152.87	0.6 152.27	0.6 152.27	0.6 152.27

250' North Elm	154.08	0.6	0.5	0.3
		153.48	153.28	153.78
275' " "	155.29	0.8	1.0	0.2
		154.49	154.29	155.09
South Side Fir	156.5	0.3	0.5	0.0
		156.20	156.00	156.5
East Side				
North Side Elm	142.0	0.7	0.6	0.2
		141.30	141.40	141.80
25' North Elm	143.21	0.7	0.8	0.1
		142.51	142.41	143.11
50'	144.42	0.8	0.6	0.1
		143.62	143.82	144.32
75'	145.62	0.7	0.7	0.2
		144.92	144.92	145.42
100'	146.83	0.5	0.7	0.2
		145.33	146.13	146.63
125'	148.04	0.6	0.4	0.0
		147.44	147.64	148.04
150'	149.25	0.4	0.3	0.4
		148.85	148.95	148.85
175'	150.46	0.6	0.9	0.3
		149.86	149.56	150.16
200'	151.67	0.8	0.8	0.7
		150.87	150.87	150.97
225'	152.87	0.8	0.9	0.5
		152.07	151.97	152.87
250'	154.08	1.0	0.9	0.6
		153.08	153.18	153.48
275'	155.29	0.7	0.9	0.5
		154.59	154.39	154.79
South Side Fir	156.5	0.8	0.9	0.7
		155.70	155.60	155.80

West Side				
North Side Fir	158.0	0.0	0.0	0.0
		158.0	158.0	158.0
25' North Fir	159.54	0.6	0.6	0.2
		158.94	158.94	159.34
50' " "	161.08	0.6	0.7	0.3
		160.48	160.38	160.78
75' " "	162.62	0.6	0.7	0.4
		162.02	161.92	162.22
100' " "	164.17	0.6	0.8	0.6
		163.57	163.37	163.57
125' " "	165.71	0.6	0.8	0.4
		165.11	164.91	165.31
150' " "	167.25	0.7	0.8	0.4
		166.55	166.45	166.85
175' " "	168.79	0.7	0.8	0.5
		168.09	167.99	168.29
200' " "	170.33	0.6	0.7	0.4
		169.73	169.63	169.93
225' " "	171.87	0.6	0.7	0.2
		171.27	171.17	171.67
250' " "	173.42	0.6	0.8	0.5
		172.82	172.62	172.92
275' " "	174.96	0.6	0.7	0.4
		174.36	174.26	174.56
South Side Grape	176.5	0.6	0.8	0.8
		175.90	175.75	175.75
East Side				
North Side Fir	158.0	0.6	0.6	0.2
		157.40	157.40	157.80
25' North Fir	159.54	0.6	0.4	0.1
		158.94	159.14	159.44
50' " "	161.08	1.2	0.9	0.4
		159.88	160.18	160.68



75' North Fir	162.62	1.0	0.7	0.2
		161.62	161.92	162.42
100' "	164.17	0.7	1.0	0.2
		163.47	163.17	163.97
125' "	165.71	0.8	0.8	0.2
		164.91	164.91	165.51
150' "	167.25	0.6	0.5	0.0
		166.65	166.75	167.25
175' "	168.79	0.8	0.6	0.2
		167.99	168.19	168.59
200' "	170.33	0.8	0.6	0.2
		169.53	169.73	170.13
225' "	171.87	0.6	0.7	0.0
		171.27	171.17	171.87
250' "	173.42	0.7	0.5	0.0
		172.72	172.92	173.42
275' "	174.96	0.5	0.9	0.0
		174.46	174.06	174.96
South Side Grape	176.5	0.6	0.4	0.3
		175.90	176.10	176.20
West Side				
North Side Grape	178.5	0.3	0.4	0.0
		178.20	178.10	178.5
25' North Grape	179.96	0.8	0.5	0.0
		179.16	179.46	179.96
50' "	181.42	0.8	0.7	0.1
		180.62	180.72	181.32
75' "	182.87	0.7	0.6	0.0
		182.17	182.27	182.87
100' "	184.33	0.7	0.7	0.1
		183.63	183.63	184.23
125' "	185.79	0.5	0.4	0.4
		185.29	185.39	185.39
150' "	187.25	0.6	0.6	0.4
		186.65	186.65	186.84

175' North Grape	188.71	0.2	0.4	0.2
		188.51	188.31	188.51
200' "	190.16	0.6	0.6	0.2
		189.56	189.56	189.96
225' "	191.62	0.8	0.6	0.3
		190.82	191.02	191.32
250' "	193.08	0.9	0.6	0.1
		192.18	192.48	192.98
275' "	194.54	0.6	0.7	0.3
		193.94	193.84	194.24
South Side Hawthorne	196.0	0.5	0.9	0.3
		195.50	195.10	195.70
East Side				
North Side Grape	178.5	0.5	0.4	0.0
		178.00	178.10	178.50
25' North Grape	179.96	0.5	0.3	0.3
		179.46	179.66	179.66
50' "	181.42	0.7	0.4	0.5
		180.72	181.02	180.92
75' "	182.87	0.3	0.5	0.0
		182.57	182.37	182.87
100' "	184.33	0.7	0.8	0.3
		183.63	183.53	184.03
125' "	185.79	0.8	0.5	0.3
		184.99	185.29	185.49
150' "	187.25	0.8	0.6	0.0
		186.45	186.65	186.95
175' "	188.71	0.5	0.8	0.0
		188.21	188.41	188.71
200' "	190.16	0.6	1.0	0.3
		189.56	189.16	189.86
225' "	191.62	0.5	0.4	0.0
		191.12	191.22	191.62
250' "	193.08	0.3	0.0	0.5
		192.78	193.08	192.58

275' North Grape	194.54	0.6 193.94	0.4 194.14	0.3 194.84
South Side Hawthorne	196.0	0.7 195.30	0.5 195.50	0.0 196.0
West Side				
North Side Hawthorne	198.5	0.5 198.00	0.5 198.00	0.2 198.30
25' North "	199.71	0.9 198.81	0.8 198.91	0.4 199.31
50' " "	200.92	0.9 200.02	0.8 200.12	0.5 200.42
75' " "	202.12	0.9 201.22	0.8 201.32	0.3 201.82
100' " "	203.33	0.8 202.53	0.9 202.43	0.3 203.03
125' " "	204.54	0.6 203.94	0.8 203.74	0.3 204.24
150' " "	205.75	0.7 205.05	0.8 204.95	0.4 205.35
175' " "	206.96	0.6 206.36	0.9 206.06	0.3 206.66
200' " "	208.17	0.9 207.27	0.8 207.37	0.2 207.97
225' " "	209.37	0.5 208.87	0.5 208.87	0.0 209.37
250' " "	210.58	0.5 210.08	0.5 210.08	0.2 210.38
275' " "	211.79	0.7 211.09	0.5 211.29	0.1 211.69
South Side 1ry	213.0	0.7 212.30	0.8 212.20	0.4 212.60
East Side				
North Side Hawthorne	198.5	0.6 197.90	0.3 198.20	0.0 198.5

25' North Hawthorne	199.71	0.8 198.91	0.5 199.21	0.0 199.71
50' " "	200.92	0.2 200.72	0.2 200.72	0.0 200.92
75' " "	202.12	0.4 201.72	0.6 201.52	0.0 202.12
100' " "	203.33	0.6 202.73	0.6 202.73	0.2 203.10
125' " "	204.54	0.7 203.84	1.0 203.54	0.4 204.14
150' " "	205.75	0.7 205.05	1.0 204.75	0.5 205.25
175' " "	206.96	0.7 206.26	1.0 205.96	0.5 206.46
200' " "	208.17	0.8 207.37	1.0 207.17	0.4 207.77
225' " "	209.37	0.7 208.67	1.0 208.37	0.4 208.97
250' " "	210.58	0.7 209.88	0.9 209.68	0.3 210.28
275' " "	211.79	1.0 210.79	1.1 210.69	0.4 211.39
South Side 1ry	213.0	0.7 212.30	1.1 211.90	0.2 212.80
50' out west side between 1ry and Juniper				
West Side				
North Side Juniper	230.0	0.4 229.60	0.7 229.30	0.6 229.40
25' North Juniper	230.83	0.4 230.43	0.8 230.03	0.5 230.33
50' " "	231.67	0.3 231.37	0.5 231.17	0.3 231.37
75' " "	232.50	0.5 232.00	0.7 231.80	0.5 232.00



100' North Juniper	233.33	0.6 232.73	0.7 232.63	0.3 233.03
125' " "	234.17	0.6 233.57	0.6 233.57	0.5 233.57
150' " "	235.00	0.5 234.50	0.9 234.10	0.4 234.60
175' " "	235.83	0.4 235.43	0.4 235.43	0.2 235.63
200' " "	236.67	0.5 236.17	0.5 236.17	0.2 236.47
225' " "	237.56	0.5 237.06	0.8 236.76	0.2 237.36
250' " "	238.33	0.6 237.73	0.9 237.43	0.4 237.93
275' " "	239.17	0.3 238.87	0.4 238.77	0.7 238.47
South Side Kalmia	240.0	0.5 235.50	0.6 239.40	0.3 239.70
East Side				
North Side Juniper	230.0	0.4 229.60	0.4 229.60	0.2 229.80
25' North	230.92	0.6 230.32	0.7 230.22	0.3 230.62
50' " "	231.83	0.8 231.03	0.7 231.13	0.3 231.53
75' " "	232.75	0.8 231.95	0.7 232.05	0.3 232.45
100' " "	233.67	0.6 233.07	0.4 233.27	0.2 233.47
125' " "	234.58	0.4 234.18	0.4 234.18	0.1 234.48
150' " "	235.50	0.7 234.80	0.7 234.80	0.5 235.00
175' " "	236.42	0.6 235.82	0.6 235.82	0.3 236.12

200' North Juniper	237.33	0.5 236.83	0.5 236.83	0.4 236.93
225' " "	238.25	0.6 237.65	0.8 237.45	0.5 237.75
250' " "	239.17	0.4 238.77	0.8 238.37	0.5 238.37
275' " "	240.08	0.5 239.58	0.7 239.38	1.0 239.08
South Side Kalmia	241.0	0.8 240.20	0.9 240.10	1.0 240.00

9-30-02

## West Side

North Side Kalmia	241.0	0.1 240.90	0.2 240.80	0.3 240.70
25' North " "	241.67	0.1 241.57	0.5 241.17	0.3 241.37
50' " "	242.33	0.1 242.23	0.4 241.93	0.5 241.83
75' " "	243.00	0.0 243.00	0.2 242.80	0.4 242.60
100' " "	243.67	0.1 243.57	0.2 243.47	0.7 242.97
125' " "	244.33	0.1 244.23	0.4 243.93	0.6 243.73
150' " "	245.00	0.1 244.90	0.4 244.60	0.5 244.50
175' " "	245.67	0.5 245.17	0.5 245.17	0.7 244.97
200' " "	246.33	0.6 245.73	0.6 245.73	0.4 245.93
225' " "	247.00	0.7 246.30	0.5 246.50	0.2 246.80



250' North Kalmia	247.67	0.5	0.5	0.4
		247.17	247.17	247.27
275' " "	248.33	0.5	0.5	0.4
		247.83	247.83	247.93
South Side Laurel	249.0	0.5	0.7	0.3
		248.50	248.30	248.70

## East Side

North Side Kalmia	242.0	0.4	0.5	0.5
		241.60	241.50	241.50
25' North "	242.67	0.3	0.4	0.4
		242.37	242.27	242.27
50' " "	243.33	0.5	0.4	0.4
		242.83	242.93	242.93
75' " "	244.00	0.5	0.3	0.3
		243.50	243.70	243.70
100' " "	244.67	0.4	0.3	0.3
		244.27	244.37	244.37
125' " "	245.33	0.6	0.5	0.4
		244.73	244.83	244.93
150' " "	246.00	0.5	0.6	0.6
		245.50	245.40	245.40
175' " "	246.67	0.3	0.5	0.6
		246.37	246.17	246.07
200' " "	247.33	0.5	0.7	0.5
		246.83	246.63	246.83
225' " "	248.00	0.5	0.6	0.5
		247.50	247.40	247.50
250' " "	248.67	0.6	0.8	0.5
		248.07	247.87	248.17
275' " "	249.33	0.5	0.7	0.6
		248.83	248.63	248.73
South Side Laurel	250.0	0.7	0.8	0.6
		249.30	249.20	249.40

## West Side

North Side Laurel	250.0	0.5	0.4	0.0
		249.50	249.60	250.00
25' North "	250.63	0.6	0.4	0.0
		250.03	250.23	250.63
50' " "	251.25	0.6	0.5	0.2
		250.65	250.75	251.05
75' " "	251.88	0.6	0.4	0.3
		251.28	251.48	251.58
100' " "	252.50	0.4	0.6	0.5
		252.10	251.90	252.00
125' " "	253.13	1.0	0.4	0.5
		252.13	252.73	252.63
150' " "	253.75	0.5	0.5	0.3
		253.25	253.25	252.45
175' " "	254.38	0.7	0.5	0.2
		253.68	253.88	254.18
200' " "	255.00	0.6	0.5	0.1
		254.40	254.50	254.90
225' " "	255.63	0.5	0.5	0.1
		255.13	255.13	255.53
250' " "	256.25	0.6	0.6	0.1
		255.65	255.65	256.15
275' " "	256.88	0.5	0.3	0.2
		256.38	256.58	256.68
South Side Maple	257.5	0.5	0.5	0.4
		257.00	257.00	257.10

## East Side

North Side Laurel	251.0	0.3	0.2	0.2
		250.70	250.80	250.80
25' North "	251.63	0.5	0.5	0.4
		251.13	251.13	251.23
50' " "	252.25	0.7	0.5	0.6
		252.55	251.75	251.65



75' North Laurel	252.88	0.8	0.7	0.6
	252.08	252.18	252.28	
100' " "	253.50	0.7	0.7	0.6
	252.80	252.80	252.90	
125' " "	254.13	0.6	0.6	0.6
	253.53	253.53	253.53	
150' " "	254.75	0.5	0.6	0.5
	254.25	254.15	254.25	
175' " "	255.38	0.8	0.7	0.6
	254.58	254.68	254.78	
200' " "	256.00	0.5	0.8	0.5
	255.50	255.20	255.50	
225' " "	256.63	0.6	0.7	0.6
	256.03	255.93	256.03	
250' " "	257.25	0.6	0.8	0.6
	256.65	256.45	256.65	
275' " "	257.88	0.7	0.6	0.6
	257.18	257.28	257.28	
South Side Maple	258.5	0.7	0.8	0.8
	257.80	257.70	257.70	
West Side				
North Side Maple	258.0	0.1	0.3	0.3
	257.90	257.70	257.70	
25' North	258.41	0.3	0.5	0.3
	258.11	257.91	258.11	
50' " "	258.83	0.5	0.5	0.6
	258.33	258.33	258.23	
75' " "	259.24	0.5	0.7	0.4
	258.74	258.54	258.84	
100' " "	259.66	0.4	0.5	0.3
	259.26	259.16	259.36	
125' " "	260.08	0.4	0.6	0.3
	259.68	259.48	259.78	
150' " "	260.49	0.5	0.6	0.4
	259.99	259.89	260.09	

175' North Maple	260.91	0.5	0.7	0.6
	260.41	260.21	260.31	
200' " "	261.33	0.8	0.8	0.6
	260.53	260.53	260.73	
225' " "	261.74	0.6	0.9	0.6
	261.14	260.84	261.14	
250' " "	262.16	0.5	0.5	0.7
	261.66	261.66	261.46	
275' " "	262.58	0.2	0.4	0.3
	262.38	262.18	262.28	
South Side Nutmeg	263.0	0.1	0.4	0.4
	262.90	262.60	262.60	
East Side				
	259.0	0.5	0.5	0.5
	258.50	258.50	258.50	
North Side Maple	259.37	0.6	0.5	0.3
	258.77	258.87	259.07	
25' North	259.75	0.7	0.6	0.5
	259.05	259.15	259.25	
50' " "	260.12	0.7	0.7	0.6
	259.52	259.52	259.62	
75' " "	260.50	0.7	0.6	0.5
	259.80	259.90	260.00	
100' " "	260.87	0.5	0.5	0.5
	260.37	260.37	260.37	
125' " "	261.25	0.6	0.6	0.5
	260.65	260.65	260.75	
150' " "	261.62	0.4	0.4	0.4
	261.22	261.22	261.22	
175' " "	262.00	0.3	0.3	0.3
	261.70	261.70	261.70	
200' " "	262.37	0.3	0.3	0.4
	262.07	262.07	261.97	
225' " "	262.75	0.3	0.4	0.4
	262.45	262.35	262.35	
250' " "	263.12	0.2	0.2	0.4
	262.92	262.92	262.72	
275' " "	263.5	0.1	0.3	0.4
	263.40	263.20	263.10	
South Side Nutmeg	263.5	0.1	0.3	0.4
	263.40	263.20	263.10	



## West Side

North Side Nutmeg	265.0	0.8	0.8	0.6
		264.20	264.20	264.40
25' North	265.46	0.8	0.7	0.4
		264.66	264.76	265.06
50'	265.92	0.4	0.5	0.3
		265.52	265.42	265.62
75'	266.37	0.4	0.5	0.2
		265.97	265.87	266.17
100'	266.83	0.5	0.7	0.2
		266.33	266.13	266.63
125'	267.29	0.5	0.6	0.3
		266.79	266.69	266.99
150'	267.75	0.6	0.7	0.4
		267.15	267.05	267.35
175'	268.21	0.6	0.8	0.1
		267.61	267.41	268.11
200'	268.67	0.9	1.1	0.2
		267.77	267.57	268.47
225'	269.12	0.5	0.7	0.2
		268.62	268.42	268.92
250'	269.58	0.6	0.8	0.4
		268.98	268.78	269.18
275'	270.04	0.7	0.7	0.3
		269.34	269.34	269.74
South Side Olive	270.5	0.8	0.9	0.4
		269.70	269.60	270.10

## East Side

North Side Nutmeg	265.50	0.4	0.5	0.7
		265.10	265.00	264.80
25' North	266.00	0.3	0.4	0.5
		265.70	265.60	265.50
50' "	266.50	0.4	0.5	0.6
		266.10	266.00	265.90

75' North Nutmeg	267.00	0.3	0.4	0.5
		266.70	266.60	266.50
100' "	267.50	0.3	0.5	0.6
		267.20	267.00	266.90
125' "	268.00	0.3	0.5	0.6
		267.70	267.50	267.40
150' "	268.50	0.2	0.4	0.5
		268.30	268.10	268.00
175' "	269.00	0.5	0.5	0.6
		268.50	268.50	268.40
200'	269.50	0.3	0.5	0.6
		269.20	269.00	268.90
225'	270.00	0.1	0.5	0.7
		269.90	269.50	269.30
250'	270.50	0.3	0.5	0.6
		270.20	270.00	269.90
275'	271.00	0.6	0.6	0.8
		270.40	270.40	270.20
South Side Olive	271.50	0.6	0.7	0.7
		270.90	270.80	270.80
West Side				
North Side Olive	271.0	0.5	0.7	0.4
		270.50	270.30	270.60
25' North	271.37	0.6	0.5	0.8
		270.77	270.87	270.57
50' "	271.75	0.5	0.6	0.8
		271.25	271.15	270.95
75' "	272.12	0.2	0.3	0.5
		271.92	271.82	271.62
100' "	272.50	0.2	0.3	0.4
		272.30	272.20	272.10
125' "	272.87	0.6	0.4	0.5
		272.27	272.47	272.37
150' "	273.25	0.4	0.5	0.5
		272.85	272.75	272.75



175' North Olive	273.62	0.4 273.22	0.6 273.02	0.3 273.32
200' " "	274.00	0.7 273.30	0.7 273.30	0.3 273.70
225' " "	274.37	0.8 273.57	1.0 273.37	0.2 274.17
250' " "	274.75	0.6 274.15	0.8 273.95	0.5 274.25
275' " "	275.12	0.5 274.62	0.5 274.62	0.6 274.52
South Side Palm	275.5	0.4 275.10	0.6 274.90	0.2 275.30
East Side				
North Side Olive	272.0	0.3 271.70	0.3 271.70	0.5 271.50
25' North "	272.33	0.5 271.83	0.4 271.93	0.6 271.73
50' " "	272.66	0.6 272.06	0.6 272.06	0.6 272.06
75' " "	273.99	0.6 273.39	0.6 273.39	0.4 273.59
100' " "	273.33	0.7 272.63	0.6 272.73	0.4 272.93
125' " "	273.66	0.5 273.16	0.5 273.66	0.4 273.26
150' " "	273.99	0.7 273.29	0.6 273.39	0.5 273.49
175' " "	274.33	0.6 273.73	0.5 273.83	0.5 273.83
200' " "	274.66	0.6 274.06	0.6 274.06	0.5 274.16
225' " "	274.99	0.6 274.39	0.6 274.39	0.6 274.39
250' " "	275.33	0.7 274.63	0.7 274.63	0.5 274.83

275' North Olive	275.66	0.6 275.06	0.5 275.16	0.7 274.96
South Side Palm	276.00	0.6 275.40	0.6 275.40	0.5 275.50
West Side				
North Side Palm	276.5	0.4 276.10	0.6 275.90	0.4 276.10
25' North Palm	276.63	0.3 276.33	0.6 276.03	0.4 276.23
50' " "	276.75	0.5 276.25	0.5 276.25	0.4 276.35
75' " "	276.88	0.7 276.18	0.6 276.28	0.5 276.38
100' " "	277.00	0.5 276.50	0.6 276.40	0.4 276.60
125' " "	277.13	0.4 276.73	0.6 276.53	0.3 276.83
150' " "	277.25	0.3 276.95	0.5 276.75	0.5 276.75
175' " "	277.38	0.3 277.08	0.5 276.88	0.4 276.98
200' " "	277.50	0.6 276.90	0.6 276.90	0.5 277.00
225' " "	277.63	0.6 277.03	0.6 277.03	0.3 277.33
250' " "	277.75	0.5 277.25	0.5 277.25	0.3 277.45
275' " "	277.88	0.4 277.48	0.5 277.38	0.3 277.58
South Side Quince	278.0	0.4 277.60	0.4 277.60	0.1 277.90
East Side				
North Side Palm	277.0	0.4 276.60	0.5 276.50	0.5 276.50

25' North Palm	277.17	0.4	0.5	0.5
		276.77	276.67	276.67
50' " "	277.33	0.4	0.5	0.6
		276.93	276.83	276.73
75' " "	277.50	0.3	0.5	0.5
		277.20	277.00	277.00
100' " "	277.67	0.3	0.4	0.5
		277.37	277.27	277.17
125' " "	277.83	0.4	0.5	0.4
		277.43	277.33	277.43
150' " "	278.00	0.3	0.4	0.4
		277.70	277.60	277.60
175' " "	278.17	0.3	0.3	0.5
		277.87	277.87	277.67
200' " "	278.33	0.5	0.4	0.5
		277.83	277.93	277.83
225' " "	278.50	0.5	0.3	0.4
		278.00	278.20	278.10
250' " "	278.67	0.5	0.5	0.4
		278.17	278.17	278.27
275' " "	278.83	0.5	0.5	0.6
		278.33	278.33	278.23
South Side Quince	279.00	0.5	0.6	0.6
		278.50	278.40	278.40
West Side				
North Side Quince	278.0	0.4	0.4	0.2
		277.60	277.60	277.80
25' North Quince	278.08	0.5	0.3	0.1
		277.58	277.78	277.98
50' " "	278.16	0.3	0.3	0.2
		277.86	277.86	277.96
75' " "	278.24	0.3	0.3	0.2
		277.94	277.94	278.04
100' " "	278.33	0.4	0.4	0.1
		277.93	277.93	278.23

125' North Quince	278.41	0.2	0.3	0.0
		278.21	278.11	278.41
150' " "	278.49	0.2	0.2	0.0
		278.29	278.29	278.49
175' " "	278.58	0.3	0.3	0.0
		278.28	278.28	278.58
200' " "	278.66	0.3	0.2	0.2
		278.36	278.46	278.46
225' " "	278.74	0.3	0.3	0.2
		278.44	278.44	278.54
250' " "	278.83	0.4	0.3	0.3
		278.43	278.53	278.53
275' " "	278.91	0.1	0.3	0.2
		278.81	278.61	278.71
South Side Redwood	279.00	0.3	0.4	0.4
		278.70	278.60	278.60
East Side				
North Side Quince	279.0	0.4	0.5	0.6
		278.60	278.50	278.40
25' North Quince	279.08	0.6	0.4	0.4
		278.48	278.68	278.68
50' " "	279.16	0.4	0.4	0.4
		278.76	278.76	278.76
75' " "	279.24	0.5	0.4	0.4
		278.74	278.84	278.84
100' " "	279.33	0.4	0.5	0.4
		278.93	278.83	278.93
125' " "	279.41	0.4	0.3	0.3
		279.01	279.11	279.11
150' " "	279.49	0.5	0.4	0.4
		278.99	279.09	279.09
175' " "	279.58	0.5	0.4	0.4
		279.08	279.18	279.18
200' " "	279.66	0.5	0.3	0.4
		279.16	279.36	279.26



225' North Quince	279.74	0.4	0.5	0.5
		279.34	279.24	279.24
250' " "	279.83	0.5	0.4	0.4
		279.33	279.43	279.43
275' " "	279.91	0.5	0.3	0.4
		279.41	279.61	279.51
South Side Redwood	280.00	0.4	0.4	0.4
	↘	279.60	279.60	279.60

West Side

North Side Redwood

25' North "

50' " "

75' " "

100' " "

125' " "

150' " "

175' " "

200' " "

225' " "

250' " "

275' " "

South Side Spruce

East Side

North Side Redwood

25' North "

50' " "

75' " "

100' " "

125' " "

150' " "

175' " "

200' " "

225' " "

250' " "

275' " "

South Side Spruce

10/23/02 -

d'Heurecourt  
Tutmer  
Daves,

Fifth St, guttering.

"a" st, Intersection.

B.M. 7.28 " 74.94 67.66

East line of 5th.

Bent. So. side.	9.7	65.24
2'	9.8	65.14
5'	9.3	65.64

1/4 - So. side. a.

bent	9.3	65.64
2'	9.2	65.74
5'	8.7	66.24

Center a.

bent.	8.6	66.34
2'	8.5	66.44
5'	8.2	66.74

1/4 No. side a.

bent.	8.2	74.94	66.74
2'	8.0		66.94
5'	7.8		67.14

Bent No. side.

bent.	8.0	66.94
2'	7.9	67.04
5'	7.7	67.24

West side 5th,

bent So. side.

bent	9.5	65.44
2'	9.5	65.44
5'	9.5	65.44

1/4 So. side a.

bent	8.9	66.04
------	-----	-------



2'	8.9	74.94	66.04	T.P.	11.37	0.89	85.42 ✓	74.05 ✓
----	-----	-------	-------	------	-------	------	---------	---------

5'	8.9		66.04					
----	-----	--	-------	--	--	--	--	--

Center "A" No.

bunt	8.7		66.24					
------	-----	--	-------	--	--	--	--	--

2'	8.6		66.34					
----	-----	--	-------	--	--	--	--	--

5'	8.5		66.44					
----	-----	--	-------	--	--	--	--	--

1/4 No. side a.

bunt	8.3		66.64					
------	-----	--	-------	--	--	--	--	--

2'	8.3		66.64					
----	-----	--	-------	--	--	--	--	--

5'	8.2		66.74					
----	-----	--	-------	--	--	--	--	--

bunt No. side a.

bunt	8.4		66.54					
------	-----	--	-------	--	--	--	--	--

2'	8.0		66.94					
----	-----	--	-------	--	--	--	--	--

5'	7.8		67.14					
----	-----	--	-------	--	--	--	--	--

bunt So. side ash (W. side.)

bunt	8.8	85.42					76.62
------	-----	-------	--	--	--	--	-------

2'	8.6						76.82
----	-----	--	--	--	--	--	-------

5'	8.2						77.22
----	-----	--	--	--	--	--	-------

1/4 So. side ash (W. side.)

b.	8.1						77.32
----	-----	--	--	--	--	--	-------

2'	8.2						77.22
----	-----	--	--	--	--	--	-------

5'	8.0						77.42
----	-----	--	--	--	--	--	-------

Center ash (W. side.)

b.	7.7						77.72
----	-----	--	--	--	--	--	-------

2'	7.6						77.82
----	-----	--	--	--	--	--	-------

5'	7.4						78.02
----	-----	--	--	--	--	--	-------

$\frac{1}{4}$  No. side Ash, (W. side)

b.	7.0	85.42	78.42
2'	6.9		78.52
5'	6.8		78.62

## Curb No. side Ash, (W. side)

b.	7.0		78.42
2'	6.8		78.62
5'	6.5		78.92

## Curb So. side Ash, (E. side)

b.	7.9		77.52
2'	7.5		77.92
5'	7.3		78.12

 $\frac{1}{4}$  So. side Ash, (E. side)

b.	7.3		78.12
----	-----	--	-------

2'	7.3	85.42	78.12
5'	7.1		78.32

## Center Ash, (E. side)

b.	7.0		78.42
2'	7.1		78.32
5'	6.7		78.72

 $\frac{1}{4}$  No. side Ash, (E. side)

b.	6.9		78.52
2'	6.6		78.82
5'	6.2		79.22

## Curb No. side Ash, (E. side)

b.	5.9		79.52
2'	6.3		79.12
5'	5.9		79.52



## No. line ash (W. 5th.)

b.	6.7	85.42	78.72
2'	6.7		78.72
5'	6.3		79.12

## 25' No. of ash, (W. 5th.)

b.	5.3		80.12
2'	5.4		80.02
5'	4.8		80.62

## 50' No. of ash, (W. 5th.)

b.	3.9		81.52
2'	4.1		81.32
5'	3.5		81.92

## 75' No. of ash (W. 5th.)

b.	2.9		82.52
2'	2.9		82.52

5' 2.3 85.42 83.12

## 100' No. of ash (W. 5th.)

b.	1.2		84.22
2'	1.4		84.02
5'	1.0		84.42

## No. side of ash (E. 5th.)

b.	5.3		80.12
2'	5.6		79.82
5'	5.1		80.32

## 250' No. of ash (E. 5th.)

b.	4.2		81.22
2'	4.3		81.12
5'	3.7		81.72

## 50' No. of ash, (E. 5th)

b.	2.7		82.72
----	-----	--	-------

2'		3.0	85.42	82.42
5'		2.6		82.82
	75' No. of Ash. (E. side)			
b.		1.7		83.72
2'		1.7		83.72
5'		1.4		84.02
	100' No. of Ash. (E. side)			
b.		0.2		85.02
2'		0.4		85.02
5'		0.3		85.12
T.P.	8.58	93.27	0.73	84.69 ✓
	125' No. of Ash. (E. side)			
b.		7.1		86.17
2'		7.3		85.97
5'		6.6		86.67
	150' No. of Ash. (E. side)			
b.		5.5		87.77
2'		5.7		87.57

5'	5.1	93.27		88.17
	175' No. of Ash. (E. side)			
b.		4.0		89.27
2'		4.4		88.87
5'		3.9		89.37
	200' No. of Ash. (E. side)			
b.		2.8		90.47
2'		2.9		90.37
5'		2.1		91.17
	225' No. of Ash. (E. side)			
b.		1.6		91.67
2'		1.3		91.97
5'		0.9		92.37
	125' No. of Ash. (W. side)			
b.		7.4		85.87
2'		7.6		85.67
5'		7.2		86.07



150' No. of Ash, (W. 5th.)

b.	5.9	93.27	87.37
2'	6.2		87.07
5'	5.8		87.47

~~150~~ 175' No. of Ash, (W. 5th.)

b.	4.7		88.57
2'	4.7		88.57
5'	4.4		88.87

200' No. of Ash (W. 5th.)

b.	3.4		89.87
2'	3.4		89.87
5'	3.1		90.17

225' No. of Ash, (W. 5th.)

b.	1.8		91.47
2'	1.9		91.37
5'	1.4		91.87

250' No. of Ash, (W. 5.)

T.P.	11.90	1.92	103.25 ✓	91.35 ✓
------	-------	------	----------	---------

b. 10.6 103.25

2'	10.6		92.65
5'	10.2		93.05

275' No. of Ash, (W. 5th.)

b.	9.2		94.05
2'	9.2		94.05
5'	8.9		94.35

So. line of Beech (W. 5th.)

b.	7.9		95.35
2'	8.1		95.15
5'	7.9		95.35

250' No. of Ash, (E. side.)

b.	10.1		93.15
2'	10.0		93.25
5'	9.7		93.55

275' No. of Ash (E. side.)

b.	8.8		94.45
2'	8.8		94.45

5'	8.3	103.25	94.95
So. line Beech. (E. side)			
b, 1	7.1		96.15
2'	7.5		95.75
5'	7.3		95.95
Upper So. side Beech. (E. side)			
b, 1	7.2		96.05
2'	7.2		96.05
5'	6.8		96.45
1/4 So. side Beech. (E. side)			
b, 1	7.1		96.15
2'	6.9		96.35
5'	6.5		96.75
Center Beech. (E. side)			
b, 1	6.7		96.55
2'	6.7		96.55
5'	6.2		97.05

1/4 No. side Beech. (E. side)			
b, 1	6.2	103.25	97.05
2'	6.0		97.25
5'	5.6		97.65
Upper No. side Beech. (E. side)			
b, 1	5.8		97.45
2'	5.7		97.55
5'	5.3		97.95
Upper No. side Beech. (W. side)			
b, 1	7.7		95.55
2'	7.5		95.75
5'	7.1		96.15
1/4 So. side Beech. (W. side)			
b, 1	7.3		95.95
2'	7.0		96.25
5'	6.8		96.45
Center line Beech. (W. side)			
b, 1	6.9		96.35



2'	6.7	103.25	96.55
5'	6.5		96.75
1/4 - No. side Beech (W. 5th.)			
b,	6.4		96.85
2'	6.4		96.85
5'	6.4		96.85
Gutter No. side Beech (W. 5th.)			
b,	6.2		97.05
2'	6.1		97.15
5'	5.8		97.45
No. line Beech. (W. 5th.)			
b,	5.6		97.65
2'	5.6		97.65
5'	5.3		97.95
25' No. of Beech (W. 5th.)			
b,	4.2		99.05
2'	4.3		98.95
5'	4.0		99.25

50' No. of Beech (W. 5th.)			
b,	2.8	103.25	100.45
2'	2.9		100.35
5'	2.6		100.65
75' No. of Beech (W. 5th.)			
b,	1.4		101.85
2'	1.4		101.85
5'	1.1		102.15
No. line of Beech (E. side.)			
b,	5.1		98.15
2'	5.4		97.85
5'	4.8		98.45
25' No. of Beech (E. side.)			
b,	3.6		99.65
2'	4.0		99.25
5'	3.7		99.55
50' No. of Beech (E. 5th.)			
b,	1.6		101.65

2'	2.1	103.25	101.15
5'	1.8		101.45
75' No. of Beech (E. 5th)			
b.	0.5		102.75
2'	0.8		102.45
5'	0.6		102.65
T.P.	9.53	0.44	112.34 102.81 ✓
100' No. of Beech (E. 5th)			
b.	8.5		103.84
2'	8.9		103.44
5'	8.7		103.64
125' No. of Beech (E. 5th)			
b.	7.0		105.34
2'	7.4		104.94
5'	7.0		105.34
150' No. of Beech (E. 5th)			
b.	5.9		106.44
2'	6.1		106.24

5'	5.7	112.34	106.64
175' No. of Beech (E. 5th)			
b.	4.8		} 2
2'	4.6		
5'	4.4		
200' No. of Beech (E. 5th)			
b.	2.6		109.74
2'	2.9		109.44
5'	2.7		109.64
225' No. of Beech (E. 5th)			
b.	1.1		111.24
2'	1.3		111.04
5'	1.4		110.94
100' No. of Beech (W. 5th)			
b.	8.9		103.44
2'	9.2		103.14
5'	8.7		103.64



	125'	No. of Beech (W. 5th)	
b.	7.3	112.34	105.04
2'	7.5		104.84
3'	7.1		105.24
	150'	No. of Beech (W. 5th)	
b.	5.7		106.64
2'	6.1		106.24
5'	5.6		106.74
	200'	No. of Beech (W. 5th)	
b.	4.2		108.14
2'	4.5		107.84
5'	4.2		108.14
	200'	No. of Beech (W. 5th)	
b.	2.7		109.64
2'	3.1		109.24
5'	2.7		109.64
	225'	No. of Beech (W. 5th)	
b.	0.9		111.44

2'	1.5	112.34	110.84
5'	1.3		111.04
T.P.	9.87	0.84	121.37
			111.50 ✓
	250'	No. of Beech (W. 5th)	
b.	8.8		112.57
2'	8.9		112.77
5'	8.8		112.57
	275'	No. of Beech (W. 5th)	
b.	7.3		114.57
2'	7.6		113.77
5'	6.9		114.47
	So. line of Cedar (W. 5th)		
b.	5.9		115.47
2'	6.3		115.07
5'	6.0		115.37
	250'	No. of Beech (E. side)	
b.	8.5		112.87
2'	9.0		112.37

5'	8.6	121.37	112.77
275' No. of Beach (E. side 5th)			
b.	6.8		114.57
2'	7.5		113.87
5'	7.0		114.37
So. line of bedan (E. 5th)			
b.	5.6		115.77
2'	6.1		115.27
5'	5.6		115.77
Curb So. side bedan (E. 5th)			
b.	5.5		115.87
2'	5.5		115.87
5'	5.3		116.07
1/4 So. side bedan (E. 5th)			
b.	5.0		116.37
2'	4.8		116.57
5'	4.5		116.87

Center of bedan (E. 5th)			
b.	4.7	121.37	116.67
2'	4.3		117.07
5'	4.2		117.57
1/4 No. side bedan (E. 5th)			
b.	4.4		116.97
2'	4.3		117.07
5'	4.0		117.37
Curb No. side bedan (E. 5th)			
b.	4.1		117.27
2'	4.1		117.27
5'	3.7		117.67
No. line bedan (E. 5th)			
b.	3.2		118.17
2'	3.6		117.77
5'	3.2		118.17
Curb So. side bedan (W. 5th)			
b.	5.8		115.67



2'	6.1	121.37	115.27
5'	5.6		115.77
b.	1/4 S. side bedan (W. side)		
	5.2		116.17
2'	5.3		116.07
5'	5.2		116.17
b.	center of bedan (W. side)		
	4.8		116.57
2'	4.9		116.47
5'	4.7		116.67
b.	1/4 No. side bedan (W. side)		
	4.6		116.77
2'	4.5		116.87
5'	4.0		117.37
b.	Cent. No. side bedan (W. side)		
	4.2		117.17
2'	4.0		117.37
5'	3.7		117.67

No. line of bedan (W. side)			
b.	3.3	121.37	118.07
2'	3.6		117.77
5'	3.2		118.17
T.P.	8.15	2.40	1127.12 ✓ 118.97 ✓
25' No. of Cedar (E. side)			
b.	8.0		119.12
2'	8.3		118.82
5'	7.7		119.42
50' No. of bedan (E. side)			
b.	6.8		120.32
2'	7.3		119.82
5'	7.1		120.02
75' No. of bedan (E. side)			
b.	6.2		120.92
2'	6.3		120.82
5'	6.4		120.92

100' No. of bedan. (E. 5th)

b. 5.1 127.12 122.02

2' 5.4 121.72

5' 5.0 122.12

125' No. of bedan (E. 5th)

b. 4.6 122.52

2' 4.6 122.52

5' 4.1 123.02

150' No. of bedan (E. 5th)

b. 3.4 123.72

2' 3.5 123.62

5' 3.0 124.12

175' No. of bedan (E. 5th)

b. 2.0 125.12

2' 2.5 124.62

5' 2.2 124.92

200' No. of bedan (E. 5th)

b. 1.1 126.02

2' 1.3 127.12 125.82

5' 1.1 126.02

225' No. of bedan (E. side.)

b. 0.6 126.52

2' 0.7 126.42

5' 0.4 126.72

25' No. of bedan (W. side.)

b. 8.2 118.92

2' 8.5 118.62

5' 7.9 119.22

50' No. of bedan (W. side.)

b. 7.2 119.92

2' 7.5 119.62

5' 6.9 120.22

75' No. of bedan (W. side.)

b. 6.1 121.02

2' 6.5 120.62

5' 6.0 121.12



100' No. of bedan (W. side)

b.	5.2	127.12	121.92
2'	5.4		121.72
5'	5.2		121.92

125' No. of bedan (W. side)

b.	4.3		122.82
2'	4.3		122.82
5'	3.9		123.22

150' No. of bedan (W. side)

b.	3.2		123.92
2'	3.4		123.72
5'	2.9		124.22

175' No. of bedan (W. side)

b.	2.5		124.62
2'	2.6		124.52
5'	2.1		125.02

200' No. of bedan (W. side)

b.	1.4		125.72
----	-----	--	--------

2'		1.6	127.12	125.52
5'		1.2		125.72

T.P. 7.48 0.88 133.72 126.24 ✓

225' No. of bedan (W. side)

b.	7.0		126.72
2'	7.3		126.42
5'	7.2		126.52

250' No. of bedan (W. side)

b.	6.1		127.62
2'	6.3		127.42
5'	5.8		127.72

275' No. of bedan (W. side)

b.	4.9		128.82
2'	5.1		128.62
5'	5.0		128.72

So. line of Date (W. side)

b.	4.2		129.52
2'	4.3		129.42

5'	H. 1	133.72	129.62
	250'	No. of bedan (E. 5th.)	
b,		6.8	127.42
2'		6.8	127.42
5'		6.1	127.62
	275'	No. of bedan (E. 5th.)	
b,		5.8	128.42
2'		5.1	128.32
5'		5.0	128.72
		So. side of <sup>Date</sup> bedan (E. 5th.)	
b,		4.2	129.52
2'		4.3	129.42
5'		4.1	129.62
		Spitter So. side Date (E. 5th.)	
b,		4.0	129.72
2'		3.9	129.82
5'		3.7	130.02

	1/4	So. side of Date (E. 5th.)	
b,		3.6	133.72
2'		3.7	130.02
5'		3.6	130.12
		Center of Date (E. 5th.)	
b,		3.5	130.22
2'		3.5	130.22
5'		3.3	130.42
	1/4	No. side Date (E. 5th.)	
b,		3.1	130.62
2'		3.1	130.62
5'		3.0	130.72
		Spitter No. side of Date (E. 5th.)	
b,		3.0	130.72
2'		3.0	130.72
5'		2.8	130.92
		Spitter So. side of Date (W. 5th.)	
b,		4.0	129.72



2'	4.0	133.72	129.72
5'	3.8		129.92
1/4 So. side Date (W. 5th)			
b.	3.8		129.92
2'	3.7		130.02
5'	3.7		130.02
Center Date (W. 5th)			
b.	3.5		130.22
2'	3.5		130.22
5'	3.4		130.32
1/4 No. side of Date (W. 5th)			
b.	3.1		130.62
2'	3.0		130.72
5'	3.0		130.72
Quarter No. side Date (W. 5th)			
b.	3.1		130.62
2'	3.0		130.72
5'	2.9		130.82

B.M.	0.02		133.70 ✓
<hr/>			
B.M.	4.93	138.61 ✓	133.68
T.P.	8.69	0.86	146.44 ✓ 137.75 ✓
Quarter So. side Elm (E. 5th)			
b.	6.6	146.44	139.84
2'	6.6		139.84
3'	5.8		140.64
1/4 So. side Elm (E. 5th)			
b.	6.3		140.14
2'	6.3		140.14
3'	5.5		140.94
Center Elm (E. 5th)			
b.	6.0		140.44
2'	6.0		140.44
3'	5.6		140.84
1/4 No. side Elm (E. 5th)			
b.	5.7		140.74

2'	5.8	<del>146.44</del>	140.64
5'	5.2		141.24
	Gutter No. side Elm (E, 5th)		
b.	5.4		141.04
2'	5.4		141.04
5'	4.8		141.64
	Gutter So. side Elm (W, 5th)		
b.	6.5		139.94
2'	6.3		140.14
5'	5.9		141.54
	1/4 So. side of Elm (W, 5th)		
b.	6.0		140.44
2'	6.0		140.44
5'	6.0		140.44
	Center of Elm (W, 5th)		
b.	5.6		140.84
2'	5.6		140.84
5'	5.6		140.84

	1/4 No. side Elm (W, 5th)		
b.	5.4	<del>146.44</del>	141.04
2'	5.4		141.04
5'	5.4		141.04
	Gutter No. side Elm (W, 5th)		
b.	5.1		141.34
2'	5.1		141.34
5'	4.8		141.64
<hr/>			
	8.7M	4.19	164.46 ✓ 160.27 ✓
	Gutter So. side Fir (E, 5th)		
b.	8.7	<del>164.46</del>	155.76
2'	8.6		155.86
5'	8.0		156.46
	1/4 So. side Fir (E, side)		
b.	8.2		156.26
2'	8.2		156.26
5'	7.8		156.66



## Center of Fin (E. side)

b.	7.9	164.46	156.56
2'	7.9		156.56
5'	7.6		156.96

## 1/4 No. side Fin (E. side)

b.	7.7		156.76
2'	7.6		156.86
5'	7.4		157.06

## Gutter No. side Fin (E. side)

b.	7.4		157.06
2'	7.3		157.16
5'	7.0		157.46

## Gutter So. side Fin (W. side)

b.	8.1		156.36
2'	8.0		156.46
5'	7.7		156.76

## 1/4 So. side Fin (W. side)

b.	7.5		156.96
----	-----	--	--------

2' 7.4 164.46 157.06

5' 7.2 157.26

## Center Fin (W. side)

b. 7.2 157.26

2' 7.3 157.16

5' 6.9 157.56

## 1/4 No. side of Fin (W. side)

b. 6.9 157.56

2' 6.8 157.66

5' 6.6 157.86

## Gutter No. side Fin (W. side)

b. 6.6 157.86

2' 6.6 157.86

5' 6.5 157.96

T.P. 11.39 1.16 174.69 ✓ 163.30 ✓

T.P. 10.07 0.29 184.47 ✓ 174.40 ✓

## Gutter So. side Lpape (W. side)

b. 8.4 176.07

2'	8.4	184.47	176.07
5'	8.1		176.37
	1/4 So. side grape (W. 5th.)		
b.	8.0		176.47
2'	8.1		176.37
5'	7.7		176.77
	Center of grape (W. 5th.)		
b.	7.6		176.87
2'	7.8		176.67
5'	7.4		177.07
	1/4 No. side grape (W. 5th.)		
b.	7.3		177.17
2'	7.2		177.27
5'	6.9		177.57
	Quarter No. side grape (W. side)		
b.	6.7		177.77
2'	6.8		177.67
5'	6.5		177.97

75

	Quarter So. side grape E. 5th.		
b.	7.9	184.47	176.57
2'	8.0		176.47
5'	8.1		176.37
	1/4 So. side grape E. 5th.		
b.	7.5		176.97
2'	7.7		176.77
5'	7.8		176.67
	Center of grape E. 5th.		
b.	7.2		177.27
2'	7.5		176.97
5'	7.5		176.97
	1/4 No. side grape (E. 5th.)		
b.	6.7		177.77
2'	7.3		177.17
5'	7.0		177.47
	Quarter No. side grape (E. 5th.)		
b.	6.3		178.17



2'	6.8	184.47	177.67
5'	6.4		178.07
T.P.	8.81	0.75	192.52 ✓ 183.72 ✓
T.P.	7.46	0.51	199.48 ✓ 192.02 ✓
Gutter So. side Hawthorne (W. 5th)			
b.	3.8	199.48	195.68
2'	3.9		195.58
5'	3.5		195.98
1/4 So. side Hawthorne (W. 5th)			
b.	3.4		196.08
2'	3.5		195.98
5'	3.1		196.38
Center of Hawthorne (W. 5th)			
b.	3.0		196.48
2'	3.1		196.38
5'	2.6		196.88
1/4 No. side of Hawthorne (W. 5th)			
b.	2.5		196.98

2'	2.7	199.48	196.78
5'	2.2		197.28
Gutter No. side of Hawthorne (W. 5th)			
b.	1.9		197.58
2'	2.2		197.28
5'	1.7		197.78

7/1/02 Swills on paper line  
 Council at Simon Linn  
 kitchen

+	-	O.H	Red	Blue
5.60	11.52	205.60		300 / antit. account in
0.88	11.48	194.46		194.09
1.32	11.35	184.30		182.98
0.22	11.41	178.17		172.95
0.65	11.71	162.41		161.76
1.78	10.88	152.49		150.70
1.58	11.97	143.18		141.60
1.17	11.34	132.38		131.20
0.31	9.11	121.35		121.04
7.92	1.03	140.16		112.24 first low swails
6.88	8.22	126.01		119.13
3.82	8.22	121.03		117.81 2nd wood paper
7.72	5.65	121.13		113.41
1.45	11.62	116.93		115.48
2.21	10.92	107.52		105.31
1.74	11.95	98.82		96.6
1.38	11.78	87.75		86.37

for Mr Baker

5.22	0.75	81.19	75.97
10.97	0.38	91.41	80.44
11.48		102.51	

77









102.51  
0.81  

---

101.70

89.87  
2.30  

---

92.17  
10.18  

---

81.99  
6.62  

---

88.63  
8.80  

---

92.83  
10.32  

---

93.50  
4.28  

---

89.12  
11.37  

---

100.49

81.19  
8.45  

---

72.74

266.00  
72.74  

---

193.26

80

105.69  
3.55  

---

76.61

96.60  
1.72  

---

98.32  
11.95  

---

86.37  
1.38  

---

87.75  
11.78  

---

75.97  
5.22  

---

81.19  
0.75  

---

80.44  
10.97  

---

91.41  
0.38  

---

91.03  
11.48  

---

102.51

	253.17 248.85	4.32	253.17 249.50	3.67
253.17 247.25	251.21 5.78	9.11	253.17 249.50	3.67
5.92	256.99 7.95			
	249.04 3.71		253.17 247.75	5.42
253.17 247.50	252.75 9.58	249.04 51.2	253.17 247.75	5.42
5.67	243.17 2.50	254.16	253.17 247.10	6
	245.67	6.07 5.58	251.21	
	49.06 11.42	49	249.04 4.13	
253.17 243.50	60.48 1.03		253.17 = 4.11	
9.67	59.45 11.18		248.60	
	70.63 0.78		4.57	
253.17 243.25	69.85 11.66		253.17 249.00	4.17
9.92	81.51 0.88		253.17 248.60	
	80.63 8.80		253.17 249.25	3.92
253.17 242.85	89.43 3.38		5.82	
10.32 8.92	86.05		253.17 247.85	5.32
1.40			5.82	
253.17 247.25	253.17 247.10		253.17 246.70	6.47
5.92	6.07		6.47	
	253.17 244.77		253.17 245.42	7.70
	8.40		8.00	
253.17 245.50			253.17 245.42	7.70
7.67 6.5				
1.17	253.17 245.35			
	7.82 6.1			
	1.7			

81

25.32 8.34	17.10 8.25	18.06 11.21
17.08	13.88	22.27 4.05
		20.22 8.60
	28.82 7.88	28.82 7.88
	20.94	20.94 11.50
12.81 7.90		152.48 18.58
20.71 0.73		141.60 11.58
19.98 11.14	13.88 3.29	143.18 11.97
31.12 2.11	17.17 2.58	131.41 1.17
29.01 5.57	14.89 16.73	132.38 11.35
34.58	25.32 11.17	121.04 5.31
	14.15 0.33	121.35 9.11
253.17 246.	14.48 4.88	117.24 7.92
7.17 5.82	10.00 8.11	120.16 1.03
1.30	18.11 8.18	119.13 6.88
	9.93 8.41	126.01 9.20
	18.34 0.42	117.81 3.82
	17.94 8.21	121.63 5.22
	26.33 2.44	113.41 7.72
	23.89 6.58	121.13 5.65
	30.47 9.54	115.48 1.45
	20.93 2.79	116.93 11.62
	23.72 11.11	105.31 2.21
	14.81	107.52 16.92
		96.60



Return to City Engineers Office

City Hall, San Diego, Cal.

7.97	42.62	4.72	3.43
5.78	3.08	66.49	18
2.21	39.54	50	120 01.00
4.50	4.42	21	184.3
6.71	43.96	59	15.7
6.25			
.46			3.71
4.	5.20		3.31
4.46	4.46	4.05	.40
	-0.74	.74	
53.75		3.31	25.82
11.62		0.88	0.22
65.37		2.73	26.21
1.93		11.51	11.96
63.44	27.2	14.24	14.34
7.77	10	0.37	1.35
71.21	17.12	13.87	15.89
11.61		10.92	11.53
59.60		24.79	4.30
2.17		0.91	1.38
61.77		23.88	5.71
11.67	205.60	9.68	1.98
	11.52	33.56	3.73
50.10	194.28	11.81	5.07
2.12	0.38	32.25	8.50
52.24	194.46	9.95	1.57
1.49	19.48	42.40	7.21
50.75	182.98	1.80	6.35
5.	1.32	40.40	13.56
55.75	184.30	10.80	5.80
11.72	16.33	50.70	5.06
44.03	172.95	10.92	23.12
0.62	0.22	39.78	8.18
44.65	173.17	3.69	2.59
0.13	11.41	43.47	0.59
44.50	161.76	1.09	6.10
1.29	0.65	42.38	6.69
46.39	162.41	11.80	3.25
11.15	150.70	54.23	3.44
35.24	1.78	0.48	10.58
2.23	157.48	53.75	13.98
37.47			0.92
11.65			
25.52			13.06

Return to City Engineers Office

City Hall, San Diego, Cal.

Table showing the difference of latitude and departure in running 80 chains at any course from 1 to 60 minutes.

MINUTES	LKS.	MINUTES	LKS.	MINUTES	LKS.
1	2 1/3	21	49	41	95 2/3
2	4 2/3	22	51 1/3	42	98
3	7	23	53 2/3	43	100 1/3
4	9 1/3	24	56	44	102 2/3
5	11 2/3	25	58 1/3	45	105
6	14	26	60 2/3	46	107 1/3
7	16 1/3	27	63	47	109 2/3
8	18 2/3	28	65 1/3	48	112
9	21	29	67 2/3	49	114 1/3
10	23 1/3	30	70	50	116 2/3
11	25 2/3	31	72 1/3	51	119
12	28	32	74 2/3	52	121 1/3
13	30 1/3	33	77	53	123 2/3
14	32 2/3	34	79 1/3	54	126
15	35	35	81 2/3	55	128 1/3
16	37 1/3	36	84	56	130 2/3
17	39 2/3	37	86 1/3	57	133
18	42	38	88 2/3	58	135 1/3
19	44 1/3	39	91	59	137 2/3
20	46 2/3	40	93 1/3	60	140

Return to City Engineers Office

City Hall, San Diego, Cal.

TABLE FOR RUNNING ON SLOPES.

In the following table the first column shows the angle, the second the number of links to be added to a chain on the slopes, to make one chain, horizontal measurement.

Angle	COR. IN LINKS	Angle	COR. IN LINKS	Angle	COR. IN LINKS	Angle	COR. IN LINKS
0		0		0		0	
4	0.24	11	1.88	18	5.14	25	10.54
5	0.38	12	2.24	19	5.76	26	11.26
6	0.55	13	2.63	20	6.42	27	12.24
7	0.76	14	3.06	21	7.11	28	13.37
8	0.98	15	3.53	22	7.85	29	14.34
9	1.24	16	4.02	23	8.64	30	15.47
10	1.55	17	4.56	24	9.47	35	22.07