

Level Notes.

Pacific Beach.

Book No. 3.

179

F.B. 179

Table showing the difference of latitude and departure in running 80 chains at any course from 1 to 60 minutes.

MINUTES	LKS.	MINUTES	LKS.	MINUTES	LKS.
1	2 1/3	21	49	41	95 2/3
2	4 2/3	22	51 1/3	42	98
3	7	23	53 2/3	43	100 1/3
4	9 1/3	24	56	44	102 2/3
5	11 2/3	25	58 1/3	45	105
6	14	26	60 2/3	46	107 1/3
7	16 1/3	27	63	47	109 2/3
8	18 2/3	28	65 1/3	48	112
9	21	29	67 2/3	49	114 1/3
10	23 1/3	30	70	50	116 2/3
11	25 2/3	31	72 1/3	51	119
12	28	32	74 2/3	52	121 1/3
13	30 1/3	33	77	53	123 2/3
14	32 2/3	34	79 1/3	54	126
15	35	35	81 2/3	55	128 1/3
16	37 1/3	36	84	56	130 2/3
17	39 2/3	37	86 1/3	57	133
18	42	38	88 2/3	58	135 1/3
19	44 1/3	39	91	59	137 2/3
20	46 2/3	40	93 1/3	60	140

Return to City Engineers Office
City Hall, San Diego, Cal.
TABLE FOR RUNNING ON SLOPES.

In the following table the first column shows the angle, the second the number of links to be added to a chain on the slopes, to make one chain, horizontal measurement.

Angle	COR. IN LINKS	Angle	COR. IN LINKS	Angle	COR. IN LINKS	Angle	COR. IN LINKS
0		0		0		0	
4	0.24	11	1.88	18	5.14	25	10.54
5	0.38	12	2.24	19	5.76	26	11.26
6	0.55	13	2.63	20	6.42	27	12.24
7	0.76	14	3.06	21	7.11	28	13.37
8	0.98	15	3.53	22	7.85	29	14.34
9	1.24	16	4.02	23	8.64	30	15.47
10	1.55	17	4.56	24	9.47	35	22.07

See note on Page 41.

179 Book No 3.

Pacific Beach
Levels.

Sept. 1904.

J. F. Carey.

Return to City Engineers Office
City Hall, San Diego, Cal.

INDEX.

		Pages
Broadway	✓	2-6
-Jewel St.	✓	7-11
-Kendall "	✓	12-14
-Lamont "	✓	15-20
Morell "	✓	21-26
Noyes "	✓	26-32
Olney "		33-37
Oliver Ave		38-40

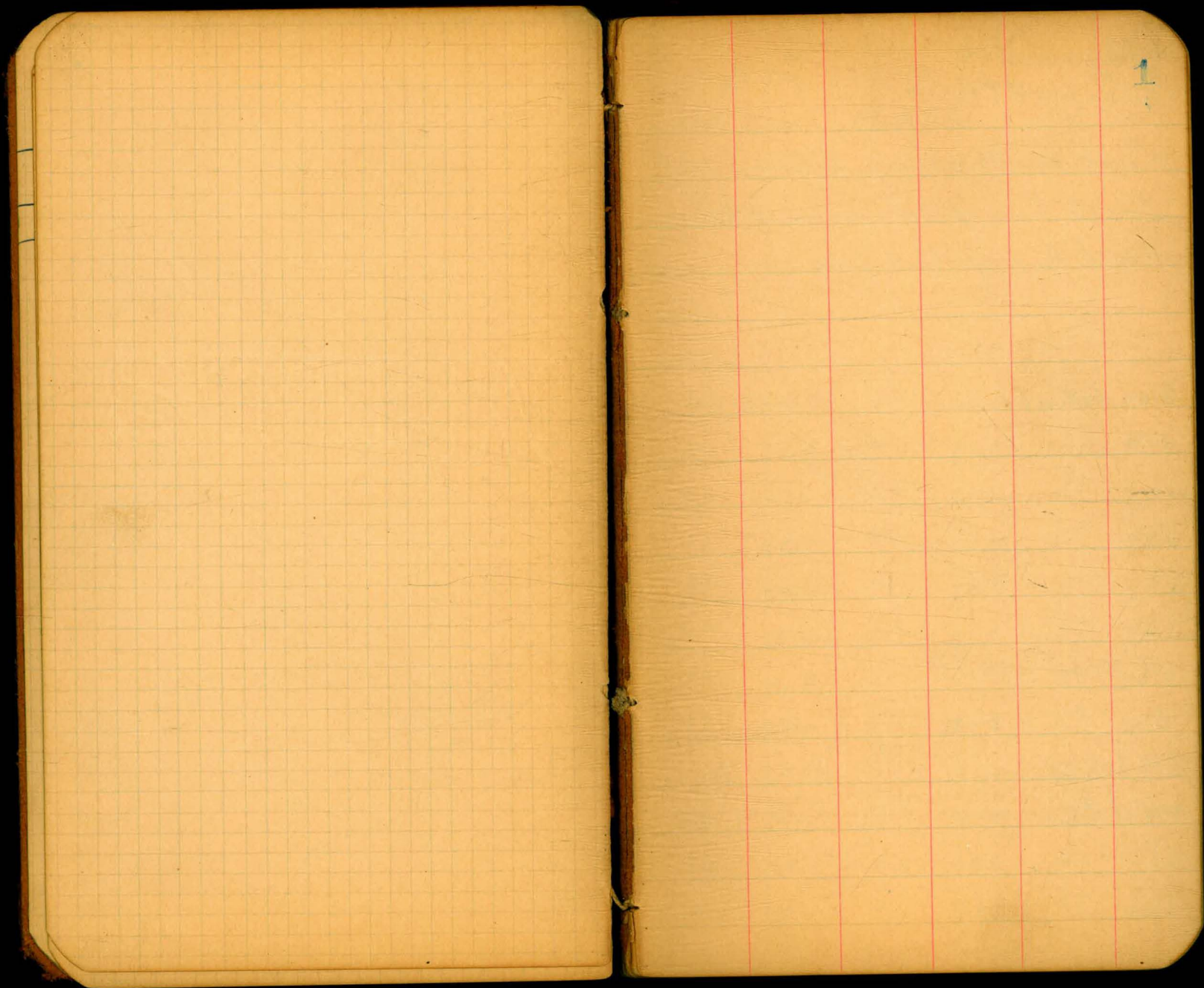

W. Rennie Rod
Lambert Chain Aug 31st 04

Levels on Broadway. Between the
South line of Alabama + the
North line of Red Ave.

0+00	S. line Alabama Ave.	84.36		
+10				
1				
+10				
2				
+10				
+69	No. line Vermont St.			
3				
B.M. S.W. Cor.	" "	-7.67 +0.35	77.07	76.69
+49	S. line	" "		
4				
+10				

This Elev.
reduced from B.M.
S.W. Cor. Broadway +
Garnet Ave.

Broadway.
E Rod Elev c Rod Elev W. 2 Rod Elev.

0.3	84.1	1.3	83.1	2.4	82.0
1.4	83.0	2.6	81.8	3.2	81.2
2.6	81.8	3.7	80.7	4.8	79.6
3.7	80.7	4.5	79.9	5.8	78.6
4.8	79.6	6.0	78.4	6.8	77.6
6.2	78.2	7.1	77.3	8.3	76.1
6.6	77.8			8.5	75.9
7.7	76.7	8.6	75.8	8.9	75.5
1.6	75.5	2.2	74.9	2.3	74.8
3.0	74.1	3.3	73.8	3.3	73.8
4.0	73.1	4.0	73.1	3.9	73.2

G. Kinnin Rod
Lambert Chain

Aug 31st 04
± H.I.

5			77.07	
+50				
6				
+19	N. line Mass. Ave.			
+50				
Peg		-8.66		
		+1.56	69.97	68.41
+99	So. line " "			
7+50				
8				
+50				
9				
+50				
+67.6	N. line Garnet Ave.			
10				
BM. Near S.W. Cor.	" "	-7.28		
		+5.03	67.72	62.69
+47.6	So. line " "			
+50				

Broadway

E		C		W. 3	
Rod	Elw.	Rod	Elw.	Rod	Elw.
5.5	71.6	5.5	71.6	5.1	72.0
6.5	70.6	6.4	70.7	5.7	71.4
7.5	69.6	7.0	70.1	6.3	70.8
7.9	69.2			6.7	70.4
8.6	68.5	8.0	69.1	7.4	69.7
2.3	67.7	1.9	68.1	1.6	68.4
3.4	66.6	3.1	66.9	2.7	67.3
4.7	65.3	4.3	65.7	3.8	66.2
5.8	64.2	5.4	64.6	5.3	64.7
6.8	63.2	6.6	63.4	6.4	63.6
7.3	62.7	7.0	63.0	7.3	62.7
7.5	62.5			7.4	62.6
7.5	62.5	7.4	62.4	7.5	62.5
Quit Aug 31 st 04					
Began Sept 1 "					
5.2	62.5			6.0	61.7
5.1	62.6	5.8	61.9	5.9	61.8

G. J. Runnie Rod
Lambert Chain

Sept 1st 04
± H. I. Elev.

11		67.72	
+50			
12			
+50			
13			
+17.5	No. line Hornblend		
+50			
+97.5	So. " "		
14+50			
B.M. Tel. Pole	" "	-4.24	
15			
Peg		-5.57	
+50		+0.44	62.59 62.15
16			
+50			
+67.5	N. line Grand Ave.		
17			
	Base of Rail Motor line		

Broadway.

	E		C		W	
	Rod Elev		Rod Elev		Rod Elev	
	5.0	62.7	6.0	61.7	6.3	61.4
	4.8	62.9	6.2	61.5	6.5	61.2
	4.2	63.5	5.8	61.9	6.6	61.1
	2.3	65.4	4.4	63.3	6.4	61.3
	2.0	65.7	3.7	64.0	4.9	62.8
	2.3	65.4			4.4	63.3
	3.5	64.2	4.1	63.6	4.5	63.2
	4.6	63.1	4.6	63.1	4.5	63.2
	5.9	61.8	5.5	62.2	4.9	62.8
	7.3	60.4	6.6	61.1	5.6	62.1
	3.1	59.5	2.3	60.3	1.0	61.6
	4.5	58.1	3.8	58.8	1.9	60.7
	5.8	56.8	4.8	57.8	3.0	59.6
	6.6	56.0			4.8	57.8
	7.4	55.2	6.6	56.0	5.5	57.1
			6.3	56.3		

G. R. R. Rod
 Lambert Chain + H.I. Elev.

Sept. 1st 04

17+50

62.59

+92.5 So. line Grand Ave.

18.

+50

19

-9.05

+1.21

54.75

53.54

peg

+50

20

+50

+62.5 N. line Thomas Ave.

Plug N.W. Cor

-3.26

21

+42.5 So line

" "

+50

22

+50

23

+50

Broadway.

	E		c		W. 5
Rod Elev		Rod Elev		Rod Elev	
8.2	54.4	7.1	55.5	6.2	56.4
9.3	53.3			6.5	56.1
9.9	52.7	8.2	54.4	6.5	56.1
11.0	51.6	9.1	53.5	7.0	55.6 54.6
12.2	50.4	10.1	52.5	8.2	54.4
5.2	49.5	3.1	51.6	1.2	53.5
6.0	48.7	4.0	50.7	1.9	52.8
6.8	47.9	4.7	50.1 50.9	2.8	51.9
7.3	47.4			3.3	51.4
7.5	47.1	5.6	49.1	3.4	51.3
8.4	46.3			4.5	50.2
8.5	46.2	6.4	48.3	4.5	50.2
9.2	45.5	7.0	47.7	5.4	49.3
10.2	44.5	7.8	46.9	6.0	48.7
10.7	44.0	8.5	46.3 48.2	6.7	48.0
11.5	43.2	9.4	45.3	7.5	47.2

86	46.2	84	46.4	85	46.3
82	46.6	77	47.1	73	47.5
73	47.5	65	48.3	58	49.0
65	48.3	56	49.2	47	50.1
56	49.2	46	50.2	33	51.5
51	49.7	39	50.9	24	52.4
50	49.8	24	52.4	24	52.4
47	50.1	36	51.2	25	52.3
46	50.2	40	50.8	39	50.9
46	50.2	40	50.8	39	50.9
46	50.2	40	50.8	39	50.9
60	48.8	57	49.1	61	48.7
71	47.7	78	47.0	78	47.0
96	45.2	92	45.6	88	46.0
113	43.5	102	44.6	94	45.4
121	42.7	106	44.2	91	45.7
121	42.7	106	44.2	91	45.7
122	42.6	106	44.2	90	45.8
125	42.2	102	44.5	86	46.1
122	42.5	101	44.6	83	46.4

B Road way.
 F
 Red Blk
 Red Blk
 Red Blk

W 6
 Red Blk

24	57.5
+128	M. Lin Road Ave.
-903	54.82
+410	45.72
45.72	
50	45.0
+92.8	8. Lin " "
25	
+50	
26	
+50	
27	
+50	
28	
+62.8	M. Lin Green Ave.
28	
+42.8	
+50	
29	
+50	
30	
+99.2	M. Lin Pacific Ave.
Blug N.W. Car	

Left lot bet
 I H. J. Eley
 Grandstand Camp
 8. Lin " "

Apr. 3rd 07

G. R. R. Rod
 Lambert Chain Sept 1st of
 ± H.I. Elev

Levels on Jewel St. Beginning
 at the South line of Alabama Ave.
 & running to the north line
 of Reed Ave.

Spikes 2d Post near S.W. C. Cor. Alabama	+0.60	94.64	94.04
0+00 So. line " Ave			
+50			
1			
+50			
2			
+50			
+70 N. line Vermont Ave			
Plug N.E. Cor. "	-11.87 +0.02	82.79	82.77
3			
+50 So. line " "			

Jewel St.

	E.	C	W	7	
	Rod Elev	Rod Elev	Rod Elev		
1.5	93.1	1.9	92.7	2.5	92.1
3.4	91.2	3.4	91.2	3.8	90.8
5.0	89.6	5.3	89.3	5.5	89.1
7.1	87.5	7.0	87.6	7.2	87.4
8.8	85.8	9.2	85.4	9.1	85.5
11.1	83.5	11.2	83.4	11.0	83.6
				11.9	82.7
14	81.4	1.1	81.7	1.0	81.8
3.0	79.8	3.0	79.8	3.0	79.8

G. R. R. Rod
 Lambert Chain Sept 1st 04
 ± H. L. Elev

4		82.79	
+50			
5			
+50			
6			
+19.7 N. line Mass. Ave.			
Beg	-10.04		
	+1.90	74.65	72.75
+50			
+99.7			
+50			
8			
+50			
9			
+50			
+69.3 N. line Garnet Ave.			
B.M. Spk. N.W. Cor. " "	-4.15		70.50
10			
+49.3 S. line " "			

E Jewel St.

	Rod Elev	Rod Elev	Rod Elev	W 8	
4.5	78.3	4.7	78.1	4.6	78.2
6.3	76.5	6.6	76.2	6.4	76.4
7.7	75.1	8.0	74.8	7.7	75.1
8.7	74.1	8.9	73.9	8.9	73.9
9.6	73.2	9.9	72.9	9.3	73.5
9.8	73.0			9.6	73.2
2.4	72.2	2.4	72.2	1.9	72.7
2.9	71.7	3.0	71.6	2.5	72.1
3.6	71.0	4.0	70.6	3.5	71.1
4.6	70.0	4.7	69.9	4.7	69.9
5.0	69.6	5.1	69.5	4.9	69.7
5.2	69.4	5.3	69.3	4.8	69.8
5.4	69.2	5.4	69.2	4.8	69.8
5.9	68.7			5.9	68.7
5.7	68.9	5.2	69.4	5.1	69.5
6.7	67.9	5.9	68.7	5.5	69.1

G. J. Rermin Rod
 Lambert Chain I H. I. Elev

11 74.65
 Peg -7.72
 +1.47 68.40 66.93

+50

12

+50

13

+19 N. line Hornblend

+50

+99 So. " "

14+50

15

Peg -12.48
 +0.93 56.85 55.92

+50

16

+50

+68 N. line Grand Ave.

17

+ Base of Rint Motor-line

Jewel St
 E O W. 9
 Rod Elev Rod Elev Rod Elev

7.6 67.0 6.8 67.8 6.4 68.2

2.6 65.8 1.9 66.5 1.5 66.9

3.8 64.6 3.2 65.2 2.8 65.6

5.3 63.1 4.5 63.9 3.9 64.5

6.4 62.0 5.8 62.6 5.4 63.0

6.8 61.8 5.6 62.8

7.7 60.5 7.2 61.2 7.0 61.4

9.0 59.4 8.6 59.8 8.2 60.2

10.1 58.3 9.7 58.7 9.6 58.8

11.4 57.0 11.3 57.1 11.0 57.4

1.3 55.5 1.1 55.7 0.9 55.9

2.8 54.0 2.9 53.9 2.4 54.4

4.2 52.6 4.1 52.7 3.8 53.0

4.9 51.9 4.5 52.3

5.5 51.3 5.3 51.5 5.5 51.3

4.9 51.9

by Runnie Rod
 Lambert Chain Sept. 1st 04
 + H.I. Elev

17+50		52.85	
+93	So. line Grand Ave.		
18			
Phy S.W. Cor.	" "	-7.47	49.38
+50			
19			
Peg		-11.05 +5.82	51.62 45.80
+50			
20			
+50			
+63	N. line Thomas Ave.		
21			
+43			
Peg		-0.16 +11.75	63.21 51.46
+50			
22			
+50			

E Jewel St. W10

Rod Elev	Rod Elev	Rod Elev	Rod Elev
63	50.5	62	50.6
82	48.6		75
94	47.4	89	47.9
10.7	46.1	10.1	46.7
11.3	45.5	10.9	45.9
6.4	45.2	5.9	45.7
6.3	45.3	6.2	45.4
5.4	46.2	5.5	46.1
4.8	46.8		5.4
3.0	48.6	4.0	47.6
+0.3	51.9 46.1		3.7
10.6	52.6	13.6	49.6
7.0	56.2	9.6	53.6
5.0	58.2	6.4	56.8 46.8

Exp. Rummie Rod
Lumber Co. Chain
Sept. 1st 04
H. E. E. E.

23 63.21

+50

24

+13 N. line Red ave.

28

-11.18

52.014

52.03

52.01

Jewel St.
E @

W 11

Rod Elev Rod Elev Rod Elev

30 60.2 4.3 58.9 6.2 57.0

24 60.8 3.2 60.0 4.6 58.6

24 60.6 3.2 60.0 4.1 59.1

29 60.3 3.1 60.1 4.5 58.7

GPRunner Rod
 Lambert chain Sept 1st out
 ± H.I. Elev.

Levels on Kendall St. Beginning
 at the So. line of Garret Ave. &
 running to the North line of
 Reed Ave.

Bm. +0.07 68.23 68.16

0 So. line Garret Ave.

+50

1

+50

2

+50

+70 N. line Hornblend

Peg.

-12.87

+0.74

56.10

55.36

3

+50 S. line

"

4

+50

Kendall St.
 E
 Rod Elev Rod Elev Rod Elev.

N 12

2.2 66.0 1.3 66.9 1.0 67.2

4.4 63.8 4.0 64.2 4.1 64.1

7.3 60.9 6.8 61.4 7.4 60.8

9.6 58.6 9.2 59.0 9.6 58.6

11.0 57.2 11.1 57.1 11.4 56.8

12.7 55.5 12.5 55.7 12.9 55.3

13.3 54.9 13.5 54.7

2.0 54.1 2.1 54.0 2.0 54.1

3.0 53.1 3.2 52.9 3.3 52.8

3.9 52.2 4.1 52.0 4.0 52.1

4.4 51.7 4.7 51.4 4.9 51.2

13

Kendall St.

W 13
Rutledge Rd. E. Rutledge Rd. W.

46	41	40	38	37	43	50	70	91	109	108	76	72	71	62
55.3	55.8	55.9	56.1	56.2	55.6	57.9	52.9	52.8	49.0	50.5	48.0	48.9	48.9	49.9
53.7	54.6	54.9	54.9	55.1	54.9	54.8	54.1	50.9	50.9	50.7	48.4	49.0	49.0	50.2
53.4	53	53.9	50	48	50	56	58	90	95	92	77	71	71	59
65	62	60	60	57	55	58	67	77	108	92	92	92	92	56
53.7	53.7	53.9	53.9	54.2	54.4	54.1	53.2	52.2	49.1	50.7	48.5	49.4	49.4	50.5

Expenses
Rutledge Rd. H.I. Fly
Rutledge Rd. H.I. Fly

Pay
-5.85
+9.62
59.87
50.25

+197 Milk Grand Am.

+50
7
Barnyard motor fuel

+447 A. King Grand Am.

Play Stu. Con. " " -9.50

+50

8

+50

9

+50

10

+147 Milk Grand Am.

+50

+947.8 " " " "

G. Kinnier Rod.
 Lambert Chain + Sept 1st 114
 H. I. Elev

11 59.87

+50

12

+50

13

+50

+64.7 N. line Red Ave

Peg at N. W. Cor. " " -7.38 52.49

Kendall St.
 E @ W 14
 Rod Elev Rod Elev Rod Elev

6.5 53.4 5.6 54.3 4.6 55.3

6.8 53.1 6.1 53.8 5.5 54.4

7.3 52.6 6.4 53.5 6.0 53.9

7.5 52.4 6.8 53.1 6.5 53.4

8.1 51.8 7.5 52.4 6.7 53.2

8.8 51.1 8.0 51.9 7.1 52.8

8.8 51.1 8.4 51.5 7.4 52.5

G. H. Remick Rod
 Lambert Chain \pm H.I. Elev.

Levels on Lamont St. Beginning at the
 So. line of Alabama Ave & running to
 the North line of Pacific? Ave.

0+00	So. line Alabama Ave.	109.48	
+50			
+			
+50			
Peg		- 8.03 + 3.09	104.54 101.45
2			
+50			
+70	N. line Vermont Ave.		
3			
+50	S. " " "		
Opp. S.E. Cor.	" "	- 4.36	100.18

Lamont St.

	E		C		W 15
	Rod Elev		Rod Elev		Rod Elev
	3.6	105.9	4.0	105.5	3.8 105.7
	4.8	104.7	4.8	104.7	4.8 104.7
	6.3	103.2	5.8	103.7	5.5 104.0
	8.0	101.5	7.3	102.2	6.6 102.9
	3.7	100.8	2.8	101.7	2.2 102.3
	3.7	100.8	2.6	101.9	1.1 103.4
	3.6	100.9			1.4 103.1
	3.7	100.8	2.4	102.1	1.8 102.7
	4.9	99.6	4.0	100.5	2.8 101.7

This Elev. \rightarrow
 reduced from B.M. at
 S.W. Cor. Garnet Ave.

Lyons Rock
Lambert Chain

Sept. 1st 04

± H.I. Elev.

4
+50
5
+50
Peg
-12.64
+0.77 92.67 91.90
6

+20 N. line Mass. Ave.

+50
7 S. " " "
+50
Peg
-12.58
+1.29 81.38 80.09
8

+50

9

+50

+70 N. line Garnet Ave.

14 R. 2d Pk

B.M. Near N.W. Cor. " "
-8.60
-12.61
+0.02 68.79 68.77
72.78

Peg

E Lamont St. W 16

Rod Elev Rod Elev Rod Elev

78 96.7 63 98.2 42 100.3
99 94.6 76 96.9 62 98.3
114 93.1 91 95.4 80 96.5
125 92.0 110 93.5 10.3 94.2

33 89.4 20 90.7 0.8 91.9

47 88.0 20 90.7

62 86.5 53 87.4 44 ~~88.3~~

94 83.3 58 86.9 73 85.4

121 80.6 116 81.1 107 82.0

39 77.5 28 78.6 21 79.3

60 75.4 52 76.2 45 76.9

88 72.6 78 73.6 74 74.0

112 70.2 107 70.7 105 70.9

122 69.2 119 69.5

gg Rennie Rod
Lambert Chain

Sept. 1st or

± H.I. Elev

10 68.79

+50 So. line Garnet Ave.

11

+50

Peg.

-7.08

+4.20

65.91 61.71

12

+50

13

+20 N. line Hornblend

+50

14 S. " "

+50

15

+50

B.M. Spike 2nd Pole

near N.E. Cor. Hornblend -3.91

62.00

Peg.

-10.91

+2.33

57.33 55.00

16

+45 N.E. Cor. Grand

E Lamont St.
C

W 17

Rod Elev

Rod Elev

Rod Elev

12 67.6 0.7 68.1 0.7 68.1

35 65.3 3.2 65.6 3.1 65.7

54 63.4 4.9 63.9 4.8 64.0

61 62.7 6.2 62.6 6.2 62.6

42 61.7 4.0 61.9 4.9 61.0

46 61.3 4.7 61.2 6.3 59.6

46 61.3 5.0 60.9 5.4 60.5

46 61.3 5.8 59.9

43 61.6 4.5 61.4 6.3 59.6

49 61.0 4.0 61.9 4.8 61.1

57 60.2 4.4 61.5 3.7 62.2

7.0 58.9 6.0 59.9 4.2 61.7

10.4 55.5 8.9 57.0 5.9 60.0

4.1 53.2 2.7 54.6 1.1 56.2

6.2 51.1

G. Rennie Rod
 J. Lambert Chain Sept 1st 04
 ± H.I. Elev.

16 +50 57.33

+61 N.W. Cor. Grand Ave.

17

+50

Base of rail motor line

+9.5 So. line Dry Ave.

18

Plng S.E. Cor. Dry Ave. -12.12
 +1.70 46.91 45.21

+50

19

+50

20

+50

+64 N. line Thomas Ave.

Plng N.E. Cor. " " -5.93

21

+44 So. line " "

+50

E. Lamont St.

W18

Rod Elev Rod Elev Rod Elev.

7.9 49.4 5.1 52.2 4.0 53.3

6.4 50.9

8.5 48.8 7.5 49.8 7.0 50.3

9.7 47.6 9.0 48.3 8.5 48.8

7.4 49.9

12.1 45.2 10.2 47.1

12.1 45.2 11.4 45.9 10.2 47.1

Quit Supt. 1st 04
 Began " 2nd "

3.0 43.9 1.8 45.1 +0.1 47.01

4.4 42.5 2.5 44.4 0.6 46.0

4.6 42.3 3.0 43.9 1.2 45.7

5.4 41.5 3.7 43.2 2.0 44.9

5.5 41.4 4.1 42.8 3.0 43.9

5.9 41.0 2.8 44.1

6.3 40.6 4.8 42.1 3.6 43.3

6.6 40.3 3.9 43.0

6.9 40.0 5.1 41.8 4.1 42.8

G. J. Rennie Rod Sept. 2nd 04
 Lambert Chain ± H.I. Elev

22		46.91	
+50			
23			
+50			
24			
+14	N. line Reed Ave.		
+50			
+94	So. " " "		
25			
Plng S.E. Cor. " "	-7.11	44.29	39.80
	+4.49		
+50			
26			
+50			
27			
+50			
+64	N. line Oliver Ave - 2		
Plng N.E. Cor. " "	-4.07		40.20

Lamont St.
 E C W19

Rod Elev	Rod Elev	Rod Elev	Rod Elev
77	39.2	5.8	41.1
8.0	38.9	6.1	40.8
8.4	38.5	6.3	40.6
8.4	38.5	5.9	41.0
8.0	38.9	6.3	40.6
7.9	39.0		5.3
7.8	39.1	6.1	40.8
			5.6
			5.0
7.0	39.9	6.0	40.9
			5.5
4.1	40.2	3.0	41.3
3.3	41.0	3.3	41.0
3.7	40.6	3.4	40.9
3.8	40.5	3.5	40.8
4.1	40.2	3.7	40.6
4.1	40.2		3.6
			3.7

G. J. Remmick Rod
 Lambert Chain
 Sept 2nd '04
 ± H.I. Elev

28	44.29
+44 So line Oliver Ave	
+50	
29	
+50	
30	
+50	
+94 N. line Pacific Ave.	
Plug N.E. Cor. " "	-9.98

+66

Lamont St.

E		C		W20	
Rod	Elev	Rod	Elev	Rod	Elev
44	39.9	38	40.5	39	40.4
48	39.5			43	40.0
49	39.4	44	39.9	44	39.9
52	38.7	51	39.2	49	39.4
63	38.0	60	38.3	60	38.3
75	36.8	74	36.9	70	37.3
87	35.6	86	35.7	83	36.0
100	34.3	98	34.5	95	34.8

G. K. Rod
 Lambert Chain Sept. 2nd 04
 ± H.I. Elev

Levels on Morell St. Begins
 at the So. line of Alabama Ave
 & running to the North line of
 Pacific Ave.

0+00 So. line Alabama Ave.		99.45	
+50	This Elev.		
1	is reduced from B.M. at		
+50	S.W. Cor. Garnet Ave.		
2			
+50			
+70 N. line Vermont			
Peg	-12.64		
	+0.99	87.80	86.81
3			
+50 So. "			
B.M. S.W. Cor.	-2.31		85.49

Morell St.
 E C W 21
 Rod Elev Rod Elev Rod Elev

76	91.9	6.1	93.4	0.7	98.8
79	91.6	3.8	95.7	2.0	97.5
75	92.0	4.6	94.9	4.1	95.4
80	91.5	6.2	93.3	6.9	92.6
82	91.3	8.7	90.8	9.5	90.0
11.3	88.2	11.0	88.5	11.5	88.0
12.6	86.9			12.3	87.2
16	86.2	1.8	86.0	1.6	88.2
30	84.8	3.2	84.6	2.9	84.9

G. Rennie Rod
 Lambert Chain
 Sept 2nd '04
 ± H.I. Elev

4		87.80	
+50			
5			
+50			
Peg	-12.50		
6	+1.41	76.71	75.30
+20			
N. line Mass. Ave.			
+50			
7			
So. " " "			
+50			
8			
+50			
9			
+50			
+70			
N. line Garret Ave.			
10			
+50			
Opp. Sw. Cor. " "	-10.43		66.28
So. line Garret.			
Peg	-12.72		
	+0.19	64.18	63.99

Morell St.
 E C W. 22
 Rod Elev Rod Elev Rod Elev

4.3	83.5	5.6	82.2	5.2	82.3
6.0	81.8	7.9	79.9	7.5	80.3
8.8	79.0	10.0	77.8	9.4	78.4
12.4	75.4	12.2	75.6	10.5	77.3
3.5	73.2	2.4	74.3	0.6	76.1
4.1	72.6			1.2	75.5
5.0	71.7	4.0	72.7	2.4	74.3
7.1	69.6	5.5	71.2	2.9	73.8
8.7	68.0	6.8	69.9	4.1	72.6
9.7	67.0	6.9	69.8	4.1	72.6
10.6	66.1	6.0	70.7	5.1	71.6
12.3	64.4	7.8	68.9	6.4	70.3
12.5	64.2	8.7	68.0	8.3	68.4
12.0	64.7			8.8	67.9
10.7	66.0	10.0	66.7	9.5	67.2
11.7	65.0	11.4	65.3	10.9	65.8

G. J. Kinnic Rod
 Lambert Chain Sept. 2nd '04
 ± H. I. Eley

11		64.18	
+50			
12			
+50			
13			
+20	N. line Horubland Ave		
+50			
14	So. " " "		
P.M.	Near N.E. Cor " "	-8.63	55.55
Peg		-12.46	
+50		+1.22	52.94 51.72
15			
+16.5	N.E. Cor Grand.		
+35.5	N.W. " "		
+50			
16			
+45	So. " "		
+50			

E Morell St.

W. 23

Rod Elev	Rod Elev	Rod Elev	Rod Elev
0.9	63.3	0.7	63.5
2.7	61.5	2.4	61.8
4.7	59.5	4.2	60.0
5.3	58.9	6.0	58.2
7.4	56.8	7.8	56.4
8.4	55.8		8.0
10.3	53.9	9.6	54.6
12.2	52.0	12.0	52.2
3.4	49.5	2.8	50.4
4.6	48.3	4.7	48.2
6.4	46.5		
7.8	45.1	7.9	45.0
8.8	44.1	8.8	44.1
9.6	43.3		
9.3	43.6	9.5	53.4

E of Rennie Rod
 Lambert Chain Sept. 2nd 04

± H.I. Elev
 16+63 S.W. Cor Grand 52.94

+70 N. line Joy Ave.

17
 +50 39.37

Peg. Play S.W. Cor Joy Ave -12.83
 + 1.11 41.22 40.11

+95 So. line Joy Ave

18
 +50

19
 +50
 20
 +50

+65 N. line Thomas Ave.

21
 +45 S. " " "

+50
 22

Peg. - 7.74
 + 2.45 35.93 33.48

Morell St.

E C W 24
 Rod Elev Rod Elev Rod Elev

9.9 43.0 9.6 43.3

10.6 42.3 10.3 42.6 9.7 43.2

12.0 40.9 11.5 41.4 11.3 41.6

1.85 39.37 1.1 40.1

2.0 39.2 1.9 39.3 1.3 39.9

4.0 37.2 3.8 37.4 2.9 38.3

6.8 34.4 5.4 35.8 3.4 37.8

9.0 32.2 6.2 35.0 4.6 36.6

10.8 30.4 7.8 33.4 5.6 35.6

11.0 30.2 8.0 33.2 5.4 35.8

10.55 30.67 4.9 36.3

8.6 32.6 6.2 35.0 4.9 36.3

7.0 34.2 5.2 36.0

7.1 34.1 5.8 35.4 5.1 36.1

7.7 ~~30.7~~ 6.4 33.8 5.7 35.5

33.5

G. Kinnin Rod Sept. 2nd 04
 Lambert Chain ± H.I. Elev

22450		35.93	
23			
+50			
24			
+15.5 N. Lincoln Road Ave.			
+50			
+95.5 So " " "			
25			
+50			
26			
+50			
Peg.	-12.97		
	+2.67	25.63	22.96
27			
+50			
+66 N. Lincoln Ave.			
28			
+44 So " " "			
+50			

Morell St.
 E C W 25
 Rod Elev Rod Elev Rod Elev

2.8	33.1	1.4	34.5	1.0	34.9
3.1	32.8	2.4	33.5	1.7	34.2
4.3	31.6	3.8	32.1	3.0	32.9
5.1	30.8	4.9	31.0	4.3	31.6
5.38	30.55			4.9	31.0
6.1	29.8	5.7	30.2	6.0	29.9
6.8	29.1			6.6	29.3
7.0	28.9	6.3	29.6	6.8	29.1
7.9	28.0	8.0	27.9	9.4	26.5
9.4	26.5	10.0	25.9	11.3	24.6
10.9	25.0	12.3	23.6	13.0	22.9
27	22.9	5.4	20.2	6.3	19.3
7.6	28.0	9.7	15.9	10.3	15.0
8.9	26.7			10.9	14.7
12.5	13.1	12.4	13.2	12.0	13.6
13.5	12.1			8.68	16.95
13.0	12.6	12.2	13.4	8.4	17.2

by Kummer Rod
G. Lambert Chain

Sept. 2nd 02
± H. I. Elev.

29

+50

30

+50

+96 N. line Pacific Am.

Phy. N.W. Cor.

-116

Morell St.

W. 26

E		C		W.	
Rod	Elev.	Rod	Elev.	Rod	Elev.
10.1	15.5	8.1	17.5	6.3	19.3
8.7	16.9	7.0	18.6	5.8	19.8
7.6	18.0	6.2	19.4	4.1	21.5
6.1	19.5	4.6	21.0	1.9	23.7
4.4	21.2	3.1	22.5	1.2	24.4

By Rumie Rod Sept 2nd of
 Lambert Chain ± H.L. Elev.

Levels on Noyes St. Beginning
 at the So. line of Alabama
 Ave. running So. to the North
 line of Pacific Ave.

0+00	So. line Alabama.	94.70	
+50			
1			
By		-12.86	
		+0.58	
		82.42	81.84
+50			
2			
+50			
+70	N. line Vermont.		
By at N.E. Cor. "		-4.07	
3			
+50	So. line Vermont.		
4			
+50			

Use these elevations of
 street intersection
 instead of Vermont
 St. line 78.33

Noyes St
 E C W. 27
 Rod Elev. Rod Elev. Rod Elev.

13	93.4	5.9	88.8	8.3	86.4
8.8	85.9	10.3	84.4	10.6	84.1
12.5	82.2	12.5	82.2	11.8	82.9
17	80.7	14	81.0	0.7	81.7
26	79.8	2.5	79.9	2.0	80.4
27	79.7	3.8	78.6	3.4	79.0
36	78.8			3.8	78.6
55	76.9	5.6	76.8	5.2	77.2
83	78.1	6.8	75.6	6.5	75.9
10.0	72.4	8.6	73.8	8.0	74.4
10.9	71.5	10.3	72.1	9.6	72.8

G. J. Rennie Rod
G. Lambert Chain

Sept. 2nd 09
I H. I. Elev

5		82.42	
Peg	-12.37 + 0.25	70.30	70.05
+50			
6			
+20 N. line Mass. Ave			
+50			
7 So. " " "			
Brn. S.W. Cor. " "	-3.37		66.93
+50			
8			
+50			
9			
+50			
+70 N. line Garnet Ave.			
10			
+50 So " " "			
Brn. N.W. Cor. " "	-5.44 + 11.15		64.86
Peg S.E. Cor. " "	+ 2.89	62.04	59.15
Brn. N.W. Cor. " "	-5.44		64.

E Noyes St

W. 28

Rod Elev.	Rod Elev.	Rod Elev.	Rod Elev.
12.7	69.7	11.9	70.5
2.6	67.7	0.9	69.4
3.0	67.3	1.8	68.5
3.3	67.0		1.5
4.2	66.1	3.0	67.3
5.2	65.1	4.1	66.2
6.2	64.1	5.6	64.7
7.7	62.6	7.1	63.2
9.4	60.9	8.6	61.7
10.7	59.6	9.5	60.8
11.8	58.5	7.2	63.1
11.3	59.0		5.2
12.3	58.0	7.1	63.2
10.2	60.1	7.8	62.5

(+0.3) 70.6

0.9 69.4

1.5 68.8

2.0 68.3

3.6 66.7

4.9 65.4

6.3 64.0

6.9 63.4

4.7 65.6

4.8 65.5

5.2 65.1

6.0 64.3

7.4 62.9

By Rennie Rod
G. Lambert Chain

Sept 2nd 04

± H.I. Elev

11		62.04	
+50			
12			
+50			
13			
+20	N. line Hornblend		
+50			
+88	N.E. Cor Grand		
14	S. line Hornblend		
+07	N.W. Grand		
Peg		-12.57	
		+1.38	50.85 49.47
+50			
15			
+17	S.E. Cor Grand		
+35	S.W. " "		
+50			
16			
+50			

Noyes St

E

C

W 29

Rod Elev		Rod Elev		Rod Elev	
3.0	59.0	1.2	60.8	0.7	61.3
4.8	57.2	3.6	58.4	2.2	59.8
5.9	56.1	4.6	57.4	4.0	58.0
6.2	55.8	5.8	56.2	5.5	56.5
6.7	55.3	7.4	54.6	7.4	54.6
7.3	54.7			8.0	54.0
8.7	53.3	9.3	52.7	9.7	52.3
12.7	49.3				
13.7	48.3	13.8	48.2	11.7	50.3
				14.1	47.9
6.0	44.8	3.1	47.7	4.4	46.4
5.7	45.1	5.6	45.2	6.0	44.8
5.6	45.2				
				6.1	44.7
5.3	45.5	5.4	45.4	5.6	45.2
7.0	43.8	6.7	44.1	6.6	44.2
9.7	41.1	9.6	41.2	9.7	41.1

in water cut

G. P. Ramin Rod
Lambert Chain

Sept. 2nd 04

± H.I. Elev

16+71 N. line Joy Ave.

50.85

17

Pay

-12.89
+1.03

38.99

37.96

+50

+95 S. " " "

18

+50

19

+50

20

+50

+66 N. line Thomas

21

+46 S. " "

+50

Pay S.E. Cor. "

-7.67
+0.59

31.91

31.32

22

+50

Noyes St.

W 30

F Rod Elev

C Rod Elev

W Rod Elev

10.7 40.15

11.10 39.70

12.2 38.6 12.0 38.8

11.9 38.9

3.3 35.7 3.0 36.0

7.2 36.8

4.7 34.3

7.5 31.5

5.0 34.0 6.7 32.3

7.9 31.1

5.3 33.7 8.0 31.0

9.4 29.6

5.2 33.8 7.5 31.5

8.9 30.1

5.4 33.6 6.4 32.6

8.7 30.3

5.3 33.7 6.7 32.3

8.6 30.4

5.8 33.2 7.9 31.1

10.2 28.8

5.9 33.1

10.62 28.37

6.8 32.2 9.0 30.0

11.6 27.4

7.67 31.3

13.1 25.9

7.8 31.2 10.3 28.7

13.3 25.7

1.5 30.4 3.9 28.0

8.0 23.9

2.7 29.2 4.8 27.1

8.6 23.3

89 Runnie Rod
 Lambert Chain
 Sept. 2nd out
 ± H.I. E.Tov

23 31.91

+50

Peg -12.31
 + 0.86 20.46 19.60

24

+16 N. line Red Ave.

+50

+96 S. " " "

25

+50

Peg -12.67
 + 0.17 7.96 7.79

26

+50

27

+50

+66 N. line Oliver

28

+46 S. " "

+50

E Noyes St. W 31
 Rod Elev Rod Elev Rod Elev

5.0 26.9 6.6 25.3 9.9 22.0

9.4 22.5 9.8 22.1 13.1 18.8

0.9 19.6 2.0 18.5 5.1 15.4

2.0 18.46 6.0 14.46

5.1 15.4 6.1 14.4 7.5 13.0

8.1 12.36 10.6 9.86

8.2 12.3 10.0 10.5 11.0 9.5

11.3 9.2 12.6 7.9 13.6 6.9

13 6.7 3.0 5.0 3.6 4.4

4.5 3.5 5.0 3.0 4.1 3.9

6.5 1.5 6.1 1.9 3.4 4.6

8.9 -0.9 6.5 1.5 2.6 5.4

9.0 -1.0 2.6 5.4

9.3 -1.3 6.6 1.4 3.0 5.0

9.9 -1.9 Plus 4.44 3.52

9.8 -1.8 7.6 0.4 4.7 3.3

G. Pennie Rod
 Lambert Chain Left, 2nd 04
 ± H.I. Elev

29

7.96

+50

30

+50

+96 N. line Pacific Av

Noyes St.

32

E		C		Y	
Rod Elev		Rod Elev		Rod Elev	
10.9	-2.9	9.7	-1.2	6.3	+1.7
11.0	-3.0	10.6	-2.6	7.9	0.1
11.4	-3.4	11.2	-3.2	9.3	-1.3
11.5	-3.5	11.2	-3.2	9.6	-1.6
✓ 11.5	-3.5	11.5	-3.5	Plug 9.33	-1.3

G. B. Kenna Rod
 Lambert Chain Sept. 3rd 04
 ± H.I. Elev

Levels on Olney St. Beginning
 at the So. line of Alabama Ave
 & running south to Slough south
 of Reed Ave.

0+00	S. line Alabama Ave	87.85	
+50			
1			
+50			
2			
+50			
Reij		-12.90	
		+ 0.05	
		75.00	74.95
+70	N. line Vermont Ave.		
3			
+50	So. " " "		
4			
+50			

E Olney St. W 33
 Rod Elev Rod Elev Rod Elev

6.3	81.5	3.6	84.2	1.0	86.8
9.1	78.7	7.9	79.9	4.5	83.3
13.0	74.8	9.7	78.1	7.5	80.3
14.1	73.7	11.4	76.4	10.0	77.8
14.8	73.0	12.8	75.0	11.6	76.2
15.5	72.3	14.4	73.4	13.9	73.9
3.7	71.3			1.8	73.2
3.5	71.5	3.1	71.9	2.3	72.7
5.47	69.53	4.5	70.5	2.0	73.0
7.1	67.9	6.1	68.9	3.4	71.6
9.2	65.8	7.8	67.2	6.3	68.7

By Runnie Rod Sept 3rd by
 Lambert Chain ± H.I. Elev

5			75.00	
+50				
6				
+19.4 N. lin Mass. Ave.				
+50				
+99.4 S " " "				
Plug S.E. Cor. " " "	-12.79			
	+1.21	63.24	42.03	
+50				
8				
+50				
9				
+50			42.71	
+69.5 N. lin Garnet Ave.				
+50				
+49.5 So " " "				
Plug S.E. " " "	-9.26			
	+1.14	43.85	42.71	

Olney St

E		C		W. 34	
Rod Elev		Rod Elev		Rod Elev	
10.4	64.6	9.0	66.0	8.7	66.1
11.7	63.3	11.2	63.8	11.8	63.2
2.5	60.7	3.1	60.1	4.7	58.5
4.1	59.1			7.3	55.9
7.2	56.0	9.0	54.2	9.6	53.6
12.8	50.4	13.8	49.4	13.5	49.7
5.5	46.5	5.9	46.1	5.1	46.9
8.1	43.9	7.7	44.3	6.2	45.8
7.9	44.1	7.2	44.8	6.1	45.9
7.9	44.1	7.0	45.0	5.6	46.4
8.8	43.2	6.9	45.1	5.1	46.9
8.9	43.1			5.8	46.2
8.9	43.1	7.5	44.5	6.2	45.8
9.3	42.1	7.9	44.1	7.2	44.8

G. J. Kenna Rod
 G. Lambert Chain Sept 3rd 04
 ± H.I. Elev

11		43.85	
+50			
12			
+50			
+60.8	N.E. Cor. Grand		
+78.8	N.W. " "		
13			
+24.3	N. line through Grand ave.		
+50			
14			
+04.5	N. line "		
+06.8	S.W. Cor. Grand		
+50			
15			
+50			
16			
		- 6.18	
		+ 1.91	
		39.58	37.67
Ply.			
+50			

Olney St

E		C		W 35	
Rod	Elev	Rod	Elev	Rod	Elev
2.5	41.3	1.6	42.2	0.5	43.3
3.9	39.8	2.7	41.1	2.4	41.4
4.8	39.0	3.7	40.1	2.8	41.0
5.7	38.1	4.7	39.1	3.6	40.2
6.1	37.7				
				4.2	39.6
6.1	37.7	5.2	38.6	4.8	39.0
7.1	36.7	6.8	37.0	5.3	38.5
7.4	36.4	6.2	37.6	6.0	37.8
7.3	36.5				
				5.1	38.7
8.3	35.5	6.8	37.0	5.2	38.6
8.8	35.0	7.4	36.4	5.6	38.2
9.3	34.5	7.9	35.9	6.2	37.6
9.8	34.0	8.6	35.2	6.2	37.6
7.3	32.3	4.5	35.1	0.7	38.9

G. Rennie Rod
 Lambert Chain
 Sept. 3rd 04
 H. I. Eter.

16+74.5 N. line Joy Ave. 39.58

17

+50

+99.5

Peg S.W. Plug " " -7.62
 +1.90 31.86 29.96

18+50

19

+50

20

+50

+67.5 N. line Thomas Ave.

Peg N.W. Cor. " " -8.12
 +1.41 25.15 23.74

21

+49.5 So. line " "

22

+50

23

+50

Olney St.

E C W 36
 Rod Elev Rod Elev Rod Elev

8.4 31.2 2.52 37.06

8.8 30.8 6.1 33.5 3.8 35.8

10.7 28.9 9.0 30.6 7.3 32.3

13.0 26.6 11.1 29.5 9.6 30.0

7.2 24.7 5.1 26.8 3.6 28.3

9.1 22.8 6.7 25.2 5.2 26.7

10.6 21.3 8.8 23.1 6.4 25.5

12.7 19.2 9.7 22.2 6.3 25.6

13.7 18.2 10.2 21.7 7.4 24.5

14.1 17.7 8.1 23.8

8.7 16.4 5.2 19.9 2.7 22.1

9.5 15.6 6.5 18.6 4.8 20.3

10.1 15.0 8.2 16.9 6.7 18.4

11.0 14.1 9.1 16.0 7.8 17.3

11.7 13.4 9.4 15.7 6.6 18.5

11.8 13.3 9.0 16.1 6.2 18.9

GJ Runnier Rod

G Lambert Chain

Sept. 3rd 04

± H. I. Elev

24		25.15		
+19 N. line Reed Ave.				
+50				
499 S. " " " "	Sw. 17.00			
		-11.47		
Play St. Cor. " " "		+ 2.35	16.03	13.68
25+50				
26		-10.78		
Pay		+1.86	7.11	5.25
+40				
+55 Edge of Slough				
+60				

Surface water 11.30 Am. Sept. 3rd 04

Olney St

E		C		W 37	
Rod Elev		Rod Elev		Rod Elev	
6.5	18.6	9.1	16.0	12.2	12.9
6.6	18.5			11.5	13.6
6.8	18.3	8.7	16.4	11.8	13.3
11.5	13.6	9.6	15.5	8.22	16.93
5.1	10.9	3.5	12.5	1.8	14.2
9.0	7.0	7.5	8.5	6.7	9.3
1.4	5.7	0.7	6.1	0.6	6.5
		10.8	-3.7		
10.8	-3.7			10.8	-3.7
		12.7	-5.6		

G. J. Kinnis Rock
 Lambert Chain Sept
 ± H.I. Elev

Levels on Oliver Ave. Beginning at the
 west side of slough, where it crosses
 Oliver between Blocks No. 280 + 304
 + running to the East line of
 Lambert St.

S.W. Cor. Noyes St.

6.30 3.52

8+25

8+58

8+75

9

+50

10

+50

11

+50

+59.7 E. line Noyes St.

Oliver Ave
 N. e S 38
 Rod Elev. Rod Elev. Rod Elev.

50 ^{1.30} Edge of slough

		7.3	-1.0		
	" "	" "	-1.0	8.2	-1.9
5.0	1.3	7.4	-1.1	8.2	-1.9
4.4	1.9	7.3	-1.0	8.5	-2.2
4.0	2.3	6.9	-0.3	8.9	-2.6
4.5	1.8	7.8	-1.5	8.9	-2.6
7.1	-0.8	8.3	-2.0	8.8	-2.5
7.4	-1.1	7.9	-1.6	8.1	-1.8
7.3	-1.0			8.1	-1.8

G. Lambert Rod
G. Lambert Chain

Sept 3 '04
± H.I. Elev

12 -6.30
+39.7 W. line Noyes Ave.
+50

Phy. S.W. Cor. " -2.78
+12.03 15.55 3.52

13
+50

14
+50

15
+50

Peg. -2.44
+11.52 24.63 13.11

16
+50

17
+39.4 E. line Morell St.

+50

18
+19.4 W. " " "

Oliver Ave S 39

	N	C	S		
	Rod Elev	Rod Elev.	Rod Elev.		
	4.5	1.8	4.9	1.4	5.7 0.6
	1.0	5.3			
	0.0	6.3	1.0	5.3	2.4 3.9
	6.6	9.0	7.5	8.1	9.3 6.3
	4.1	11.5	5.8	9.8	7.5 8.1
	3.1	12.5	5.1	10.5	6.7 8.9
	2.7	12.9	4.4	11.2	5.7 9.9
	2.0	13.6	3.6	12.0	4.9 10.7
	0.7	14.9	1.8	13.8	3.5 12.1
	8.5	16.1	10.1	14.5	11.5 13.1
	7.4	17.2	9.9	14.7	12.5 12.1
	7.1	17.5	11.0	13.6	13.7 10.9
	7.9	16.7			12.6 12.0
	8.5	16.1	11.8	12.8	12.3 12.3
	10.0	14.6	11.2	13.4	10.1 14.5
	9.9	14.7			7.66 16.97

G. R. R. Rod
Lambert Chain

Sept. 3rd 04

± H.I. Elev.

18+50 24.63

19

Peg -0.41
+11.67 35.89 24.22

+50

20

Peg -0.86
+8.46 43.49 35.03

+50

21

+50

22

+50

23

+19.5 E. line Lamont St.

N Oliver Ave S 40

Rod Elev Rod Elev Rod Elev

9.6 15.0 7.5 17.1 4.7 19.9

4.0 20.6 3.1 21.5 2.0 22.6

11.7 24.2 8.6 27.3 7.0 28.9

4.5 31.4 3.7 32.2 3.3 32.6

8.5 35.0 7.8 35.7 7.5 36.0

5.2 38.3 5.3 38.2 5.9 37.6

4.1 39.4 4.4 39.1 4.3 39.2

4.0 39.5 4.3 39.2 4.9 38.6

3.8 39.8 4.2 39.3 4.6 38.9

3.4 40.1 3.7 39.8 4.2 39.3

3.20 40.29 3.5 40.0 3.7 39.6

In picking up levels or
 transferring to a Bench Book,
 it would be well to take the
 elevations of Benches + Corner
 Plugs from the North + South
 street levels as I think they
 are more accurate than the
 east + west street.

J. F. Carey

Cross Section Logan Hill
43rd St to Hart St.

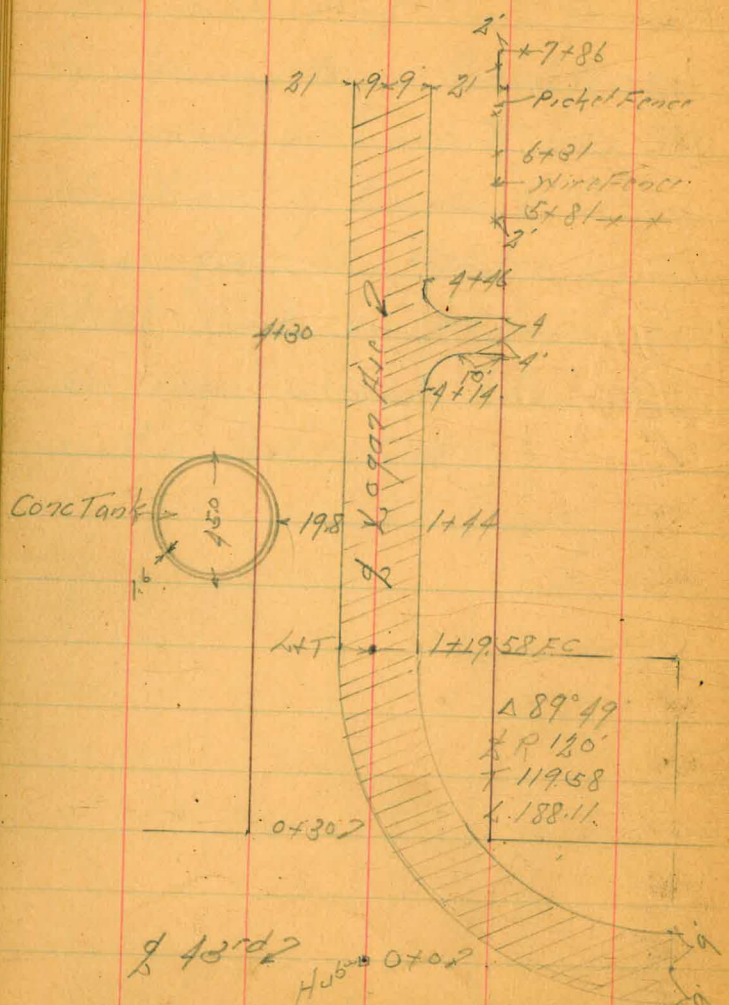

INDEXED
EFB

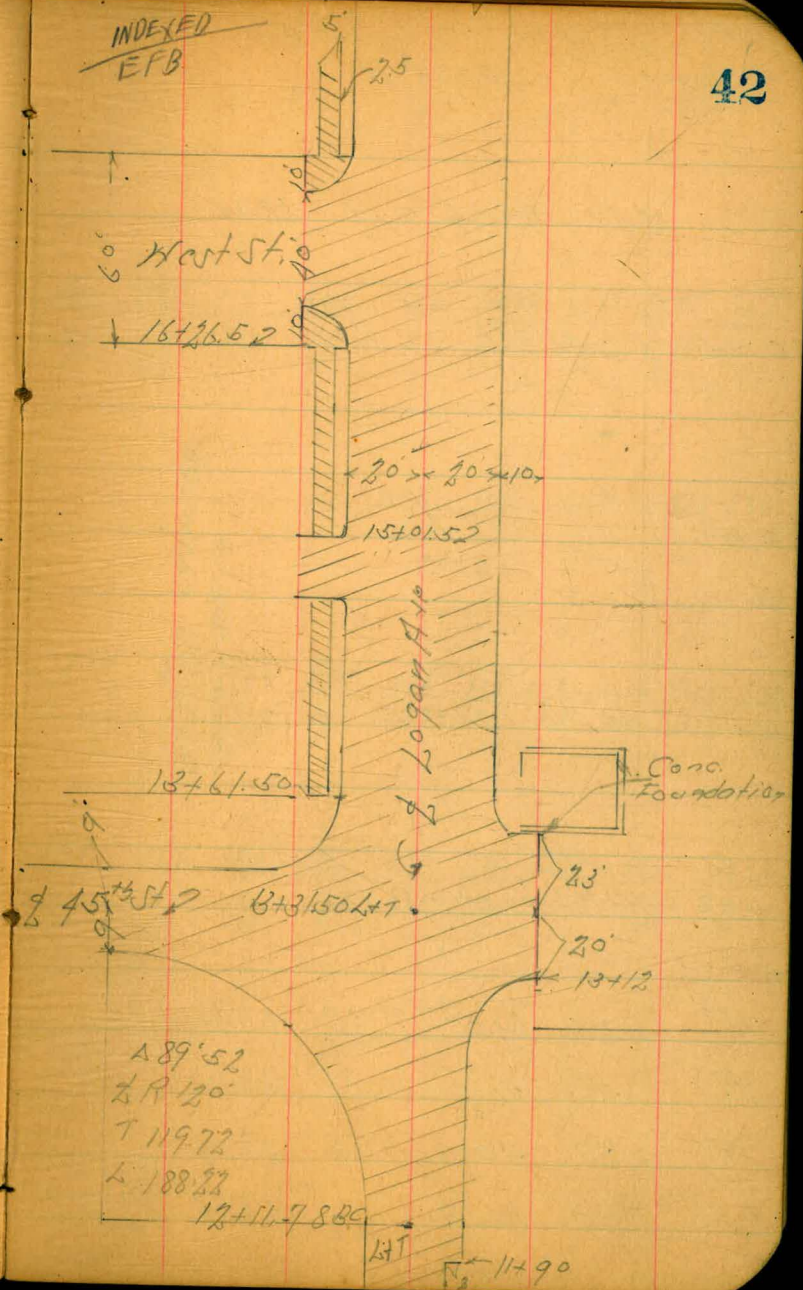

Cross Section Logan Ave
43rd St. to West St.

TP 13.40 75.34 0.13 62.94

0+30 = Fl. 43rd St.

0+9'

0+0 = 43rd St From So.

0-9' = Wly Paving From South

TP 11.84 63.07 0.38 51.23

TP 11.86 51.61 0.38 39.75

TP 11.89 40.13 7.93 28.24

BM 0.92 36.17 35.25

Reduced & Plotted on
New Profile 11/25/40 CCH

N.Y. B.P.
National
41st St.

St. N

2

Nov. 22-40
Sisson
North
11/20/40
43

55.1	56.7	57.2	60.6	62.0	62.28	62.15	59.75	59.1
8.0 40	6.4 30	5.9 28	2.5 18	1.1	0.79	0.92	3.32	4.0
					27=11/2	30=11/2	63=11/2	

60.8	60.8	61.22	58.57	58.01
2.3	2.3	1.85	4.50	5.06
	30	100	119.6	80
		15=11/2		

51.7	53.3	54.8	59.9	60.4	60.5	60.9	60.56	59.19	58.49
11.4 9	9.8 30	8.4 22	3.2 7	2.7	2.6	2.2	2.51	3.88	4.58
					30	50	75=11/2	100	119.6

51.1	52.6	53.8	59.7	60.2	60.2	59.7	59.5	58.75
12.0 40	10.5 30	9.3 28	3.5 7	2.9	2.9	3.4	4.7	4.32
					30	50	100	119.6=119.6

62.07

Logan Ave

2+0

1+70

1+14

1+19.58 = Pav FC

0+71.5 = Nly Pav 199 on 1/2

75.34

Lt

L

Rt

44

66.4	67.2	66.7	67.4	67.57	67.66	67.54	66.5	66.2
89	8.1	8.6	7.9	7.77	7.68	7.80	8.8	9.1
40	30	22	18	9		9	30	40

69.6	68.2	66.4	66.65	66.61	66.96	65.3	65.1
5.7	7.1	8.9	8.69	8.73	8.98	10.0	10.2
40	30	21	9		9	30	40

63.19	70.18	67.1	65.8	66.03	65.74
13.15	5.16	8.2	9.5	9.81	9.60
21.4	19.8	19.8	15	9	
Top	Top	Top			

68.2	67.4	65.2	65.40	65.03	64.38	63.7	64.2	64.0
7.1	7.9	10.1	9.94	10.31	10.96	11.6	11.1	11.3
40	30	17	9	27.57	10.5-54 Pav	19	35	40

60.1	61.1	62.9	63.9	63.87	62.07	62.0	62.3
10.2	14.2	12.4	11.4	11.42	13.77	10.2	10.0
40	30	12	11	11.42	24-54 Pav	30	40

75.34

Logan Hill

St. 2 Pt 45

1+04

73.82 74.63

1.52 0.71
26.6 26.3
20.8 20.7

4+0

73.0	73.4	72.6	74.1	73.97	74.11	74.07	73.6	74.2	74.5
23	19	27	1.2	1.27	1.23	1.27	1.7	1.1	0.8
40	30	21	19	9		9	20	22	30

3+50

70.9	71.2	71.5	72.3	72.49	72.54	72.43	71.9	72.3	72.5
44	41	3.8	3.0	2.85	2.80	2.91	3.4	3.0	2.8
40	30	20	16	9		9	15	30	40

3+24 N. Manscher Pole 22.0 Lt of L
S. Porter Pole 25.0 Pt. 11

3+0

60.6	69.5	69.5	70.6	70.69	70.83	70.72	70.1	70.6	70.8
67.5	5.8	5.8	4.7	4.65	4.51	4.62	5.2	4.7	4.5
40	30	22	16	9		9	20	30	40

2+94

70.42

4.92
31-23 Core Hole

2+47

67.8	67.6	67.6	68.6	69.11	69.16	69.05	68.42	68.57
80	7.7	7.7	6.7	6.23	6.18	6.29	6.92	6.77
40	30	22	18	9		9	30	20

75.34
34

75.34
34

Logan Ave

6+03 = Sly Poon Polc 26.4 RT ✓

6+0

5+50

5+0

4+50 = Sly Poon Polc 25.4 RT ✓

TP 828 83.19 0.43 74.91

4+30 = 1/2 Coco Drive on South

75.81
34

Lt

Z

Rt

46

780	780	768	77.4	77.61	77.74	77.62	77.4	77.3	77.2
5.7	5.2	6.4	5.8	5.58	5.45	5.57	5.8	5.9	6.0
40	30	24	16	9		9	18	30	40

786	79.0	772	76.9	77.03	77.11	77.03	76.9	77.2	77.3
4.6	4.2	6.0	5.3	6.16	6.08	6.16	6.3	6.0	5.9
40	30	24	15	9		9	20	30	40

77.2	77.9	762	76.5	76.33	76.44	76.39	76.2	77.0	77.2
6.0	5.3	7.0	6.7	6.86	6.75	6.80	7.0	6.7	6.0
40	30	22	17	9		9	21	30	40

74.7	75.1	74.5	75.4	75.47	75.54	75.44	75.2	76.5	76.5	76.6
8.5	8.1	8.7	7.8	7.78	7.65	7.75	8.0	6.7	6.7	6.6
40	30	26	18	9		9	18	23	30	40

83.19

74.6	74.8	73.7	74.9	74.80	74.96	75.00	74.43	75.34
0.7	0.5	1.6	0.4	0.57	0.38	0.34	0.91	0.0
10	30	24	18	9		9	30 on Dr.	30 to 80 on Dr.

75.81
34

Logan A/c

47

8+50

79.5	79.3	79.0	80.0	80.05	80.17	80.14	79.9	80.1	79.9
3.7	3.9	4.2	3.2	3.14	3.02	3.05	3.3	3.1	3.3
40	30	22	17	9		9	15	30	40

8+0

78.3	78.4	78.1	79.5	79.62	79.73	79.68	79.0	79.1	78.9
4.9	4.8	5.1	3.7	3.57	3.46	3.51	4.2	4.1	4.3
40	30	22	17	9		9	20	30	40

7+91 = Sly Power Pole 25.8 ft. ✓

7+47

77.2	77.4	77.4	79.0	79.05	79.16	79.10	78.9	79.1	79.09
6.0	5.8	5.8	4.2	4.14	4.03	4.09	4.3	4.1	4.10
40	30	24	17	9		9	17	30	39.5-48 Circled

7+0

77.0	77.9	77.0	78.7	78.64	78.69	78.59	78.6	78.3
6.7	5.3	6.2	4.5	4.55	4.50	4.60	4.6	4.7
40	30	24	15	9		9	19	30

6+50

77.1	78.0	77.2	78.1	78.13	78.21	78.15	78.0	77.9
6.1	5.2	6.0	5.1	5.06	4.98	5.04	5.2	5.3
40	30	24	17	9		9	15	30

83.19

83.19

Logan A10

11+0

10+50

10+0

TP

7.57 88.64 2.12 81.07

9+50

9+0

= Sky Port Polk 25.5 Pt.

80.19

H

A

R

48

82.1	81.7	81.5	82.3	82.57	82.63	82.53	81.6	81.4	81.1
6.5	6.9	7.1	6.2	6.07	6.01	6.11	7.0	7.2	7.5
30	30	22	17	9		9	20	30	40

81.0	80.7	80.7	81.5	82.02	82.11	82.04	81.5	81.2	81.2
7.6	7.9	7.9	7.1	6.62	6.53	6.60	7.1	7.4	7.4
40	30	22	18	9		9	20	30	40

80.7	80.4	80.3	81.2	81.53	81.62	81.61	81.3	81.1	81.2
7.9	8.2	8.3	7.4	7.11	7.02	7.03	7.3	7.5	7.4
40	30	22	17	9		9	20	30	40

88.64

80.2	80.4	80.4	81.1	81.13	81.24	81.24	81.3	81.5
3.0	2.8	2.8	2.1	2.06	1.95	1.95	1.9	1.7
40	30	22	17	9		9	20	30

79.9	80.1	79.6	80.6	80.63	80.75	80.74	80.5	80.3	80.0
3.3	3.1	3.6	2.6	2.56	2.44	2.45	2.7	2.9	2.2
40	30	22	17	9		9	17	30	40

80.19

Logan Ave.

B.M.

3.66

84.98

447 2
Logan Ave.
85.03
#584 P62

13+ 0.15 = 14 L. 45th From N

12+60

12+25

11+90

11+88 = Sly Porter Pole 354 Rt ✓

14+50

88.61

N
H.

A

S
Rt

49

84.90	85.39	85.47	85.68	85.24	84.92	83.9	84.0	83.8
3.74	3.25	3.17	2.96	3.40	3.72	4.7	4.6	4.8
45 th P.M.	30 th P.M.	28 th P.M.	30 th P.M.		11.8 E.P.M.	21	30	40

83.5	83.1	83.27	84.85	84.52	84.14	83.1	83.0
5.1	5.5	5.37	3.79	4.12	4.5	5.5	5.6
40	30	24 E.P.		11.5 E.P.	15	18	30

82.7	82.4	83.1	83.27	83.88	84.23	83.9	82.5	82.2	82.3
5.9	6.2	5.5	5.37	4.76	4.41	4.7	6.1	6.4	6.3
46	30	20	12 E.P.		11.4 E.P.	14	17	36	40

82.8	82.2	82.3	82.8	83.13	83.52	83.68	83.71	83.2	82.4	81.7
5.3	6.4	6.2	5.8	5.51	5.13	4.96	4.93	5.2	6.2	6.9
40	30	22	17	10 E.P.M.		9	11 E.P.M.	15	17	30

82.9	82.2	82.0	82.7	82.98	83.08	83.07	82.8	81.8	81.2	81.2
5.9	6.4	6.6	5.9	5.68	5.56	5.57	5.8	6.8	7.4	7.4
40	30	22	17	9		9	16	20	30	40

88.64

Logan Ave.

14+0

86.29	85.70	86.20	85.77	86.38
2.85 20-Cb	2.94 20-Gut	2.74	2.87 20-Gut	2.86 20-Cb

13+61.5 = E.L. 45th St.

85.59	85.13	85.19	84.88	85.56
3.05 20-Cb Top	3.51 20-Gut	3.45	3.76 20-Gut	3.08 20-Cb

13+54.5

85.5	85.8	85.07	85.00	84.85	85.48	85.05
3.1 30	2.8 25	3.57 30	3.64	3.79 20-Gut	3.16 20-Cb	3.59 30-Sp. Port.

13+131.5 = E.L. 45th St.

85.74	85.64	84.98	84.73	85.02
2.90 30	3.00 20	3.66	3.91 20	3.62 30

13+12

85.74	85.73	85.79	85.16	84.62	84.76
2.90 40	2.91 30	2.85 30	3.48	4.02 12	3.88 30-Sp. Port.

13+10 = S/L Power Pole 25.5 RT

88.64

↓
Lt

L

5
RT

50

88.64

Logan Hill

16+26.5 = W.L. Hart St

16+0

15+50

15+01.5 = F.L. Alley

TP 6.79 94.44 0.99 87.65

14+50

88.64

Lt

S

Rt

51

91.24	90.66	91.09	90.58	91.19
3.20	3.78	3.35	3.86	3.25
20-cl	20-Gut		20-Gut	20-cl

90.67	90.06	90.46	90.03	90.64
3.77	4.38	3.98	4.41	3.80
20-cl	20-Gut		20-Gut	20-cl

89.56	88.95	89.29	88.83	88.49
4.88	5.49	5.15	5.61	4.95
20-cl	20-Gut		20-Gut	20-cl

88.52	87.87	88.33	87.79	87.49
5.97	6.57	6.11	6.65	5.95
20-cl	20-Gut		20-Gut	20-cl

94.44

87.39	86.84	87.21	86.88	87.48
1.75	1.80	1.42	1.76	1.16
20-cl	20-Gut		20-Gut	20-cl

88.64

Cross Section Alley Block 410
 H.C. Skinner's Add.
 From 37th to 38th St. Boston
 Boston Ave & Z St.

Indexed
 LM

BM	1.44	48.33	46.89
TP	0.50	39.30	9.53 38.80
BM		5.65	
TP	6.77	36.67	9.40 29.90

See 8 p
 National
 127th St

SW 7th St
 Boston &
 37th St.

0-10 = F. Corbline 37th St

-15 = cb Top	5.50	31.17
N = cb Top	5.77	30.90
N Ground	7.2	29.5
Z "	7.4	29.3
S "	7.6	29.1
S = cb Top	6.87	30.30
+15 = cb "	6.75	29.92

0+0 = F.L. 37th St

S cb Top	6.14	30.53
S Ground	6.8	29.9
Z	7.2	28.5
N Ground	6.1	30.6
N cb Top	5.67	31.00

Plot. 8-7-41
 C.B.H.

Aug 6-41
 S. May
 Hartberg
 H. Moore

52

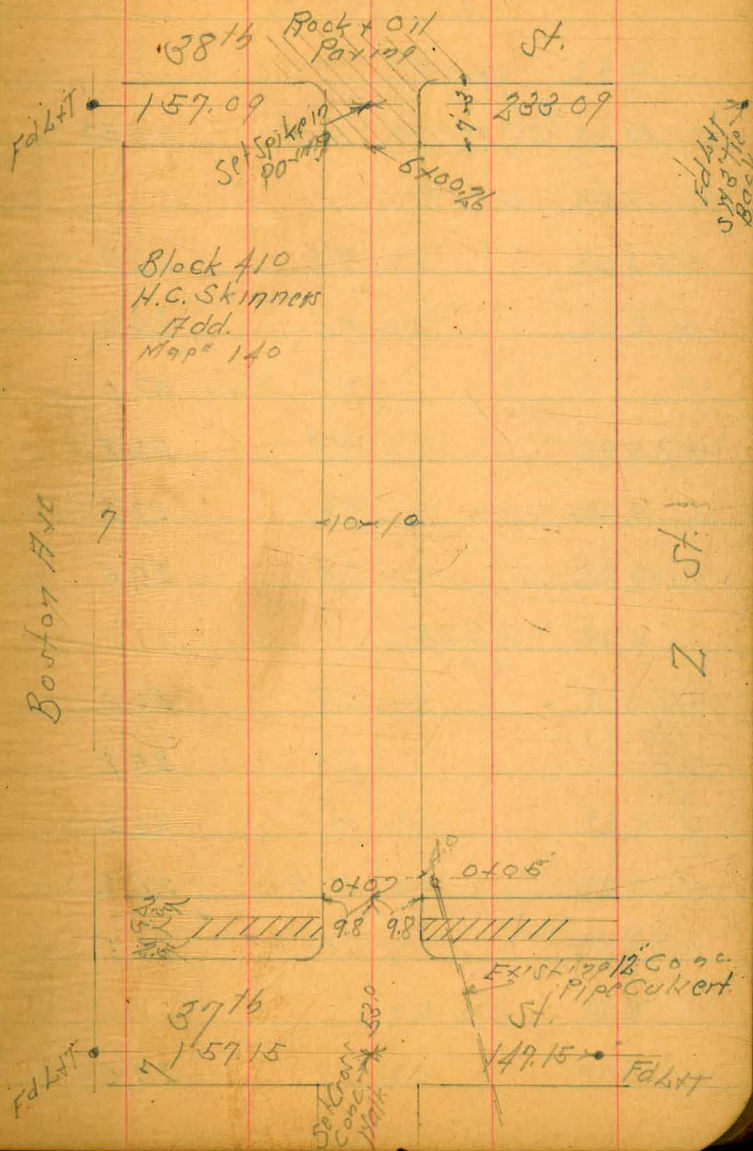

36.67

0+05'
 Existing
 S-40 = 12" Core Pipe
 Culvert Fl. 11.12 2555 /
 0+10

-10	9.8	26.9
N	9.8	26.9
S	9.7	27.0
+8	9.9	26.8
S	9.4	27.3
+10	6.3	30.4

0+35

-10	6.7	30.0
S	9.5	27.2
S	10.1	26.6
N	10.5	26.2
+10	10.6	26.1

0+65

-10	7.7	29.0
-----	-----	------

36.67

N	7.8	28.9
S	8.0	28.7
S	7.5	29.2
+5	6.6	30.1
+10	6.5	30.2

1+0

-10	6.9	29.8
S	6.2	30.5
S	5.8	30.9
N	5.8	30.9
+10	5.7	31.0

1+50

-10	3.0	33.7
N	3.5	33.2
S	3.9	32.8
S	4.2	32.5
+10	4.7	32.0

	36.67		
TP	11.07	47.16	0.58 36.09
	2+0		
-10		12.2	35.0
S		11.4	35.8
$\frac{1}{2}$		10.4	36.8
H		10.6	36.6
+10		10.2	37.0
	2+50		
-10		4.8	42.4
H		5.4	41.8
$\frac{1}{2}$		6.0	41.2
S		6.6	40.6
+10		7.5	39.7
	2+0		
-10		3.6	43.6
S		2.8	44.4
$\frac{1}{2}$		2.2	45.0

	47.16		
H		1.1	46.1
+10		0.2	46.9
TP	11.66	58.54	0.28 46.88
	2+50		
H	SJ Cor Bldg Custs Garage East Entrance	9.9	48.6
$\frac{1}{2}$		10.5	48.0
S		10.8	47.7
+10		11.5	47.0
	2+73		
H	SJ Cor Bldg as Garage	9.1	49.4
+0.2	Wly Lot 3 Fence	✓	
	2+99		
	St o.f. Sby Power Pole	✓	
	4+0		
-10		8.5	50.0
S		8.2	50.3
$\frac{1}{2}$		8.0	50.5

58.54

H 7.5 51.0

+10 7.0 51.5

4+25

-10 5.1 53.4

H = Fly Lat's Fence 5.7 ✓ 52.8

Z 6.5 52.0

S 7.2 51.3

+10 7.5 51.0

4+50

-10 6.0 52.5

S 5.1 53.4

Z 4.7 53.8

H 4.0 54.5

+10 3.4 55.1

54.0

H 0.0 58.5

+2 0.5 58.0

58.54

Z 0.8 57.7

S 1.0 57.5

+10 2.9 55.6

TP 7.39 65.87 0.06 58.48

54.35

-10 8.0 57.9

S 6.1 59.8

+2 5.6 60.3

Z 5.5 60.4

+8 5.1 60.8

H 4.1 61.8

54.90

-3 0.3 65.6

H 2.1 63.8

+3 2.7 63.2

Z 3.3 62.6

S 3.4 62.5

BM	65.87		
+4	5.2	60.7	
+10	6.1	59.8	
13+	5+85		
-10	5.3	60.6	
5	3.7	62.2	
12+	2	62.9	
+7	2.5	63.4	
11	1.4	64.5	
12+2	+2	65.9	
	6+00.26 = 112.38 ^{1/2} ST		
11+9	11 - cbTop	3.48	62.39
11+8	11 Gutter on Pavement	3.94	61.93
	1/2 " " "	5.03	60.84
	5 Gutter " "	6.38	59.39
11+	5 cbTop	6.25	59.62

65.87

	6+10.26 = 112.38 ^{1/2} ST		
5	on Pavement	7.20	58.67
1/2	" " "	5.95	59.92
11	" " "	4.62	61.25
TP	0.64	54.25	12.26
TP	0.57	42.54	12.28
BM		7.09	35.45

5.03
1188.924
35.51
7.09

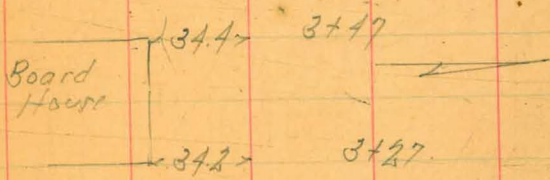

Putton Profile
8-11-41
G.P.H.

8

10

12

12

11

11

11

1323

C

Final Block

Polk

6+00.70

5+50

C WORKS

CONTROLLER

Classification

VENDOR

STORE INV. No.

By

DEPARTMENT OF PUBLIC WORKS

7

Moore
Rand
Swelmo
1-3-uvr.

X sec BRANT ST.
Wash. to 450' N

50' wide
10' cbs
7.5' /u

Indexed
c.s.k.

265.75'

8

↓
NWBP 0.76 277.75 276.99 Wash. - 06 borrow
T.P. 0.21 265.75 12.21 265.54 ✓

13

0-10
E cb 5.28 260.97

E gUT 5.28 260.07

14

cb pav. 6.22 259.53

1/4 " 6.56 259.19

c " 6.89 258.86

12

1/4 " 7.17 258.58

cb " 7.47 258.39

w " 7.57 258.18

11

+3 gUT 7.63 258.12

11

+3 cb 6.76 258.99

+37 4 5' cb in 67 7.97 257.78 grate

+37 7.08 258.67 ab

+81 4 7' " " 6.90 258.85 cb

" " " 8.19 257.56 grate

0+00 NH Wash.

w 6.6 59.2

+7.7 Top end cb 6.53 259.02²⁷

" gUT 7.36 258.49³⁹

w cb pav. 7.25 258.50

1/4 " 6.99 258.76

c 6.65 259.10

1/4 " 6.31 259.44

gUT 6.09 259.66

E cb 5.66 260.09

T.P. 14.93 277.70 5.94 259.83 ✓

0+50

E cb 10.70 262.06

gUT 11.7 61.1

1/4 " 11.1 61.7

c 10.9 61.9

1/4 " 11.3 61.5

cb 11.4 61.2

w 11.5 61.2

Notes Reduced. 1.9.92

27276 ✓

0+80

w-10	14.0	258.8
w	10.5	62.3
cb	9.6	63.2
1/4	9.7	63.1
c	9.3	63.5
1/4	9.5	63.3
qut	10.0	62.8
E cb	9.44	263.32

1+00

E cb	8.84	263.92
qut	9.2	63.5
1/4	9.0	63.8
c	8.8	64.0
1/4	9.1	63.7
cb	8.8	64.0
1/4	8.7	64.1
+10	11.6	61.2

272.76 ✓

1+50

w	7.0	265.8
cb	7.3	65.5
1/4	7.6	65.2
c	7.2	65.6
1/4	7.1	65.7
qut	7.2	65.6
E cb	6.63	266.13

2+00

E cb	4.66	268.10
qut	5.3	67.5
1/4	5.2	67.6
c	5.4	67.4
1/4	5.9	66.9
cb	6.1	66.7
w	5.6	67.2

2+40

w	4.4	268.9
---	-----	-------

60

272.76

cb	4.6	268.2
1/4	4.4	268.4
c	3.9	268.9
1/4	3.9	68.9
gut	3.8	69.0
E cb	3.05	269.71
	2+60	
E cb	2.35	270.41
gut	3.1	69.7
1/4	3.2	69.6
c	3.2	69.6
1/4	3.7	69.1
cb	3.8	69.0
w	3.4	69.9
	2+80	
w	3.1	69.7
cb	3.5	69.3
1/4	3.4	69.9

272.76

61

c	2.8	270.0
1/4	2.8	70.0
gut	2.6	70.2
E cb	1.84	270.90
	3+00	
E cb	1.58	271.18
gut	2.3	70.5
1/4	2.6	70.2
c	2.6	70.2
1/4	3.1	69.7
cb	3.1	69.7
w	2.8	70.0
	3+20	
w	2.6	70.2
cb	3.1	69.7
1/4	3.0	69.8
c	2.6	70.2
1/4	2.5	270.3

27.76

gut	2.4	270.8
E cb	1.64	271.12
3+40		
E cb	1.95	270.81
gut	2.6	70.2
1/4	2.6	70.2
c	2.7	70.1
1/4	3.2	69.6
cb	3.2	69.6
w	2.9	69.9
3+75		
w	3.6	69.2
cb	4.0	68.8
1/4	4.0	68.8
c	3.4	69.7
1/4	3.4	69.4
gut	3.3	69.5
E cb	2.74	270.02

27.76

62

4+00.3 end cb + sdw on E		
E on walk	3.17	269.59
cb	3.38	69.38
gut	3.9	68.9
1/4	4.1	68.7
c	4.1	68.7
1/4	4.5	68.3
cb	4.4	68.8
w	4.1	68.7
4+75		
w	4.7	68.1
cb	4.6	68.2
1/4	4.8	68.0
c	4.6	68.2
1/4	4.4	68.8
cb	4.2	68.6
E	3.7	69.1
on Cobble wall line		

277.76

4+50

E	2.4	270.9
+9	3.1	69.7
cb.	3.7	69.1
1/4	4.0	68.8
c	4.1	68.7
1/4	4.2	68.6
w/ cb = 0.400 for levels to marsh	4.3	68.5
w/	4.4	68.9

Levels for drain

0+00	4.3	268.5
0+10 at guard fence	3.7	69.1
0+21	4.6	68.2
0+25	5.6	67.2
0+41	18.2	59.6
0+54	27.1	45.7
0+67	35.0	37.8
0+93 Bot. Canon	45.7	27.1

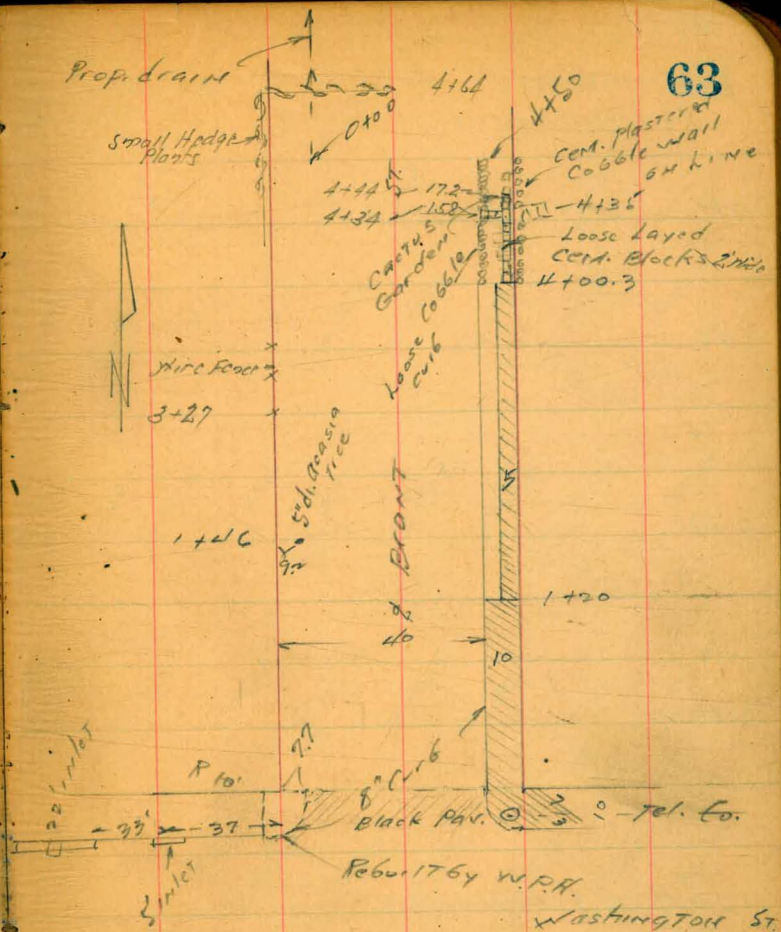

63

T.P	97.2	277.76	47.2	268.04
check to orig. BM	0.76	277.0	276.99	

Re Cross Section Braint St.
 Washington St. to 450 North
 Sketch Page 63

50' wide
 10' curb
 7.5' / 4

Dec. 10-15
 5:55 AM
 Blister
 Osborne
 8:49

Lt. M

2

Rt. E

64

TP 7.32 271.91 0.38 264.59

1+0

0+80

0+50

0+0 = N.L. Washington

BM

TP 0.47 264.97 12.59 264.50

BM

0.10

277.09

276.99

N 51° 47'
 Washington
 + 8' curb

N 11° 8'
 Washington
 + 7' 6" / 10' 5"

259.5
 5.5 / 40
 261.0
 4.0 / 28
 263.0
 1.5 / 25
 263.5
 1.5 / 25
 263.6
 1.4 / 7.0
 263.9
 1.4 / 25
 263.9
 1.4 / 25
 263.9
 1.5 / gutter
 263.87
 1.10 / 15-cb

259.2
 5.8 / 40
 259.7
 5.3 / 27
 262.8
 2.2 / 25
 262.8
 2.2 / 25
 263.2
 1.8 / 7.5
 263.3
 1.7 / 25
 263.4
 1.8 / 7.5
 262.7
 2.2 / gutter
 263.31
 1.66 / 15-cb

259.7
 5.3 / 40
 261.1
 5.2 / 25
 261.3
 5.2 / 25
 261.4
 5.1 / 7.5
 261.8
 5.2 / 25
 261.6
 5.2 / 7.5
 261.1
 5.2 / gutter
 262.05
 2.92 / 15-cb

259.0
 6.0 / 25
 259.14
 5.8 / 25
 258.31
 6.6 / 17.2-gutter
 258.26
 6.7 / 15
 258.71
 6.9 / 7.5
 258.99
 6.9 / 8
 259.38
 5.5 / 7.5
 259.60
 5.3 / gutter
 260.03
 4.9 / 15-cb
 0.9' pos

264.97 ✓

Brant St

3+0

2+80

2+60

2+40

2+0

1+30

27191

Lt. W

Z

Pt. E

65

269.2	269.2	269.7	269.7	270.1	270.2	270.3	271.17
2.5 3.5	2.5 2.5	2.2 1.5	2.2 7.5	1.8	1.7 7.5	1.6 15.5 15.5 15.5 15.5	0.74 15.5

269.1	269.1	269.2	269.4	269.9	270.0	270.1	270.93
2.8 3.5	2.8 2.5	2.7 1.5	2.5 7.5	2.0	1.9 7.5	1.8 1.5	0.98 1.5

268.5	268.8	268.8	269.0	269.4	269.5	269.6	270.41
3.4 3.5	3.1 2.5	3.1 1.5	2.9 7.5	2.5	2.4 7.5	2.3 1.5	1.50 1.5

267.9	268.1	268.0	268.3	268.7	268.8	268.9	269.71
2.0 3.5	2.8 2.5	2.9 1.5	2.6 7.5	2.2	2.1 7.5	2.0 1.5	2.20 1.5

267.0	267.0	266.6	266.8	267.3	267.5	267.4	268.09
1.9 3.5	2.9 2.5	2.5 1.5	2.5 7.5	2.5	2.4 7.5	2.5 1.5	2.20 1.5

265.3	265.3	265.1	265.7	265.5	265.7	265.4	266.11
6.6 3.5	6.4 3.5	6.8 1.5	6.7 7.5	6.4	6.3 7.5	6.5 15.5 15.5 15.5	5.80 15.5

27191 1

Brant St.

1+50

4+25

4+00.3 = 11/4 curb & walk on East

3+75

3+10

3+20

271.91

66

	4+						
267.7	268.5	268.6	268.6	268.7	268.8	268.7	270.3
3.2 3.5	3.4 2.5	3.3 1.5	3.3 1.5	3.2	3.1 1.5	3.2 1.5	3.6 2.5

267.9	268.9	268.7	268.1	268.2	268.3	268.9	269.04	269.1
3.0 3.5	3.5 2.5	3.2 1.5	3.3 1.5	3.2	3.6 1.5	3.5 1.5	2.87 2.1.8	2.8 2.5

8' curb
2' top
walk

267.6	268.6	268.7	268.3	268.5	268.7	268.8	269.37	269.58
3.3 3.5	3.3 2.5	3.2 1.5	3.6 2.5	3.4	3.2 1.5	3.1 1.5	2.5 1.5:cb	2.3 2.5 2' top walk

268.8	268.9	269.0	268.8	269.3	269.3	269.5	270.0
3.2 3.5	3.0 2.5	2.9 1.5	3.1 1.5	2.6	2.6 1.5	2.4 1.5	1.90 1.5

269.7	269.5	269.6	269.5	269.6	270.2	270.2	270.81
3.7 3.5	3.4 2.5	3.0 1.5	3.4 1.5	2.0	1.7 1.5	1.9 1.5	1.0 1.5

268.7	269.6	269.9	269.7	270.1	270.2	270.4	271.11
3.3 3.5	3.3 2.5	2.0 1.5	3.2 1.5	1.8	1.7 1.5	1.5 1.5:cb	0.80 1.5:cb

271.91

Brant St.

88

5+0

4+75

4+60

4+54

BT 4.55 273.92

269.37

00 N4C6
1400.3
Page 66

Dec. 19. 45
Sisson
8151
Osborn
8099

Lt.

Lt.

Pt.

67

246.4	248.0	247.2	248.1	248.4	248.2	248.6	251.6
27.5 50	25.9 38	26.7 25	25.8 15	25.5	25.7 15	25.0 25	22.0 50

255.7	266.8	267.6	268.3	269.2	269.6
18.2 50	7.1 25	6.3 15	5.6	4.7 15	4.5 25

267.9	268.7	269.0	269.3	269.9	270.6
5.0 25	5.8 25	4.9 15	4.6	4.0 15	3.8 25

273.92

270.98
291
248.2
248.2
248.2
248.2
248.2

68

8

10

12

14

16

18

20

8
10
12
11
11
11

ca

8

10

12

14

16

18

20

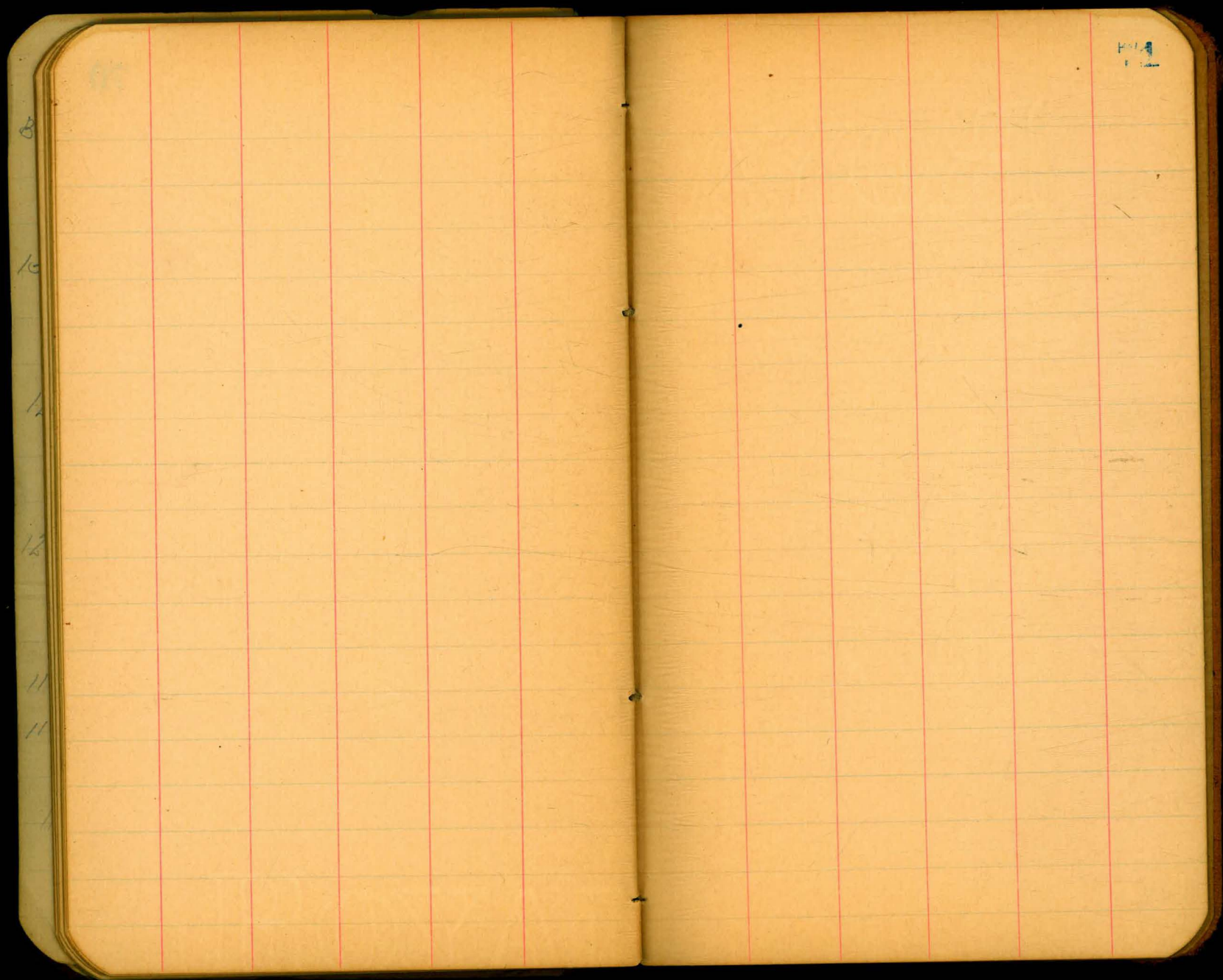

8

10

12

11

11

P. 1

8

10

11

12

11

11

11

8

10

12

12

11

11

11

8

10

12

14

16

18

20

8

10

11

12

11

11

11

۲۷

۸

۱۰

۱۱

۱۲

۱۱

۱۱

78

79

87

80

8

10

12

14

16

18

81

81

82

83

84

TRAVERSE TABLE FOR TRANSIT BOOK.

From 1° to 90° for a distance of 100.

Degrees	DEGREES.		¼ DEGREE.		½ DEGREE.		¾ DEGREE.		Degrees
	Lat.	Dep.	Lat.	Dep.	Lat.	Dep.	Lat.	Dep.	
0			100.00	0.44	100.00	0.87	99.99	1.31	89
1	99.98	1.75	99.98	2.18	99.97	2.62	99.95	3.05	88
2	99.94	3.49	99.92	3.93	99.91	4.36	99.88	4.80	87
3	99.86	5.23	99.84	5.67	99.81	6.10	99.79	6.54	86
4	99.76	6.98	99.73	7.41	99.69	7.85	99.66	8.28	85
5	99.62	8.73	99.58	9.15	99.54	9.58	99.50	10.02	84
6	99.45	10.45	99.41	10.89	99.36	11.32	99.31	11.75	83
7	99.25	12.19	99.20	12.62	99.14	13.05	99.09	13.49	82
8	99.03	13.92	98.97	14.35	98.90	14.78	98.84	15.21	81
9	98.77	15.64	98.70	16.07	98.63	16.50	98.56	16.93	80
10	98.48	17.36	98.40	17.79	98.33	18.22	98.25	18.65	79
11	98.16	19.08	98.08	19.51	97.99	19.94	97.90	20.36	78
12	97.81	20.79	97.72	21.22	97.63	21.64	97.53	22.07	77
13	97.44	22.50	97.34	22.92	97.24	23.34	97.13	23.77	76
14	97.03	24.19	96.92	24.62	96.81	25.04	96.70	25.46	75
15	96.59	25.88	96.48	26.80	96.36	26.72	96.25	27.14	74
16	96.13	27.56	96.00	27.98	95.88	28.40	95.76	28.82	73
17	95.63	29.24	95.50	29.65	95.37	30.07	95.24	30.49	72
18	95.11	30.90	94.97	31.32	94.83	31.73	94.69	32.14	71
19	94.55	32.56	94.41	32.97	94.26	33.38	94.12	33.79	70
20	93.97	34.20	93.82	34.61	93.67	35.02	93.51	35.43	69
21	93.36	35.84	93.20	36.24	93.04	36.65	92.88	37.06	68
22	92.72	37.46	92.55	37.86	92.39	38.27	92.22	38.67	67
23	92.05	39.07	91.88	39.47	91.71	39.87	91.53	40.27	66
24	91.35	40.67	91.18	41.07	91.00	41.47	90.81	41.87	65
25	90.63	42.26	90.45	42.66	90.26	43.05	90.07	43.44	64
26	89.88	43.84	89.69	44.23	89.49	44.62	89.30	45.01	63
27	89.10	45.40	88.90	45.79	88.70	46.17	88.50	46.56	62
28	88.29	46.95	88.09	47.33	87.88	47.72	87.67	48.10	61
29	87.46	48.48	87.25	48.86	87.04	49.24	86.82	49.62	60
30	86.60	50.00	86.38	50.38	86.16	50.75	85.94	51.13	59
31	85.72	51.50	85.49	51.88	85.26	52.25	85.04	52.62	58
32	84.80	52.99	84.57	53.36	84.34	53.73	84.10	54.10	57
33	83.87	54.46	83.63	54.83	83.39	55.19	83.15	55.56	56
34	82.90	55.92	82.66	56.28	82.41	56.64	82.16	57.00	55
35	81.92	57.36	81.68	57.71	81.41	58.07	81.16	58.42	54
36	80.90	58.78	80.64	59.13	80.39	59.48	80.13	59.83	53
37	79.86	60.18	79.60	60.53	79.34	60.88	79.07	61.22	52
38	78.80	61.57	78.53	61.91	78.26	62.25	77.99	62.59	51
39	77.71	62.93	77.44	63.27	77.16	63.61	76.88	63.94	50
40	76.60	64.28	76.32	64.61	76.04	64.94	75.76	65.28	49
41	75.47	65.61	75.18	65.93	74.90	66.26	74.61	66.59	48
42	74.31	66.91	74.02	67.24	73.73	67.56	73.43	67.88	47
43	73.14	68.20	72.84	68.52	72.54	68.84	72.24	69.15	46
44	71.93	69.47	71.63	69.78	71.33	70.09	71.02	70.40	45
45	70.71	70.71							
Degrees.	Dep.	Lat.	Dep.	Lat.	Dep.	Lat.	Dep.	Lat.	Degrees.
DEGREES.	¼ DEGREE.		½ DEGREE.		¾ DEGREE.		DEGREES.		

Published by H. S. CROCKER COMPANY, Stationers, Drawing Materials, Mathematical Instruments, etc., San Francisco.

Handwritten calculations and notes on the left page of the notebook. The text includes various numbers and bearings, such as "179", "10476", "13+17.5", "16+67.6", "20+62.5", "24+12.8", "13+19", "20+93", "17+93", "20+43", "21+42", "24+13", "6+19.7", "10 14.7", "13+64.7", "9+70", "16+45 East", "16+70", "16+61 W.", "17+45 S.", "16+24.5", "20+64", "24+14", "27+64", "20+94", "15+16.5 N.E. Grand.", "16+45 S.E. Grand.", "16+63 S.W.", "15+55 N.W.", "17+95", "16+70", "17+95", "20+65", "16+71", "20+66", "24+16", "13+88 N.E. Grand.", "15+17 S.E. Grand.", "14+07 N.W.", "15+55 S.W.", "30+96", "14+068 S.W. Grand.", "6+19.4", "12+608 N.E.", "12+78.6 N.W.", "9+69.4", "13+24.3 N.W.", "16+71", "17+39.4", "16+71", "23+29.5", "27+62.8", "20+92.5", "160", "270", "250", "680", "24 12 30".

Return to City Engineers Office
City Hall, San Diego, Cal.