

400

LEVEL

F.B. 283

Table showing the difference of latitude and departure in running 80 chains at any course from 1 to 60 minutes.

MINUTES	LKS.	MINUTES	LKS.	MINUTES	LKS.
1	2 1/3	21	49	41	95 2/3
2	4 2/3	22	51 1/3	42	98
3	7	23	53 2/3	43	100 1/3
4	9 1/3	24	56	44	102 2/3
5	11 2/3	25	58 1/3	45	105
6	14	26	60 2/3	46	107 1/3
7	16 1/3	27	63	47	109 2/3
8	18 2/3	28	65 1/3	48	112
9	21	29	67 2/3	49	114 1/3
10	23 1/3	30	70	50	116 2/3
11	25 2/3	31	72 1/3	51	119
12	28	32	74 2/3	52	121 1/3
13	30 1/3	33	77	53	123 2/3
14	32 2/3	34	79 1/3	54	126
15	35	35	81 2/3	55	128 1/3
16	37 1/3	36	84	56	130 2/3
17	39 2/3	37	86 1/3	57	133
18	42	38	88 2/3	58	135 1/3
19	44 1/3	39	91	59	137 2/3
20	46 2/3	40	93 1/3	60	140

TABLE FOR RUNNING ON SLOPES.

In the following table the first column shows the angle, the second the number of links to be added to a chain on the slopes, to make one chain, horizontal measurement.

Angle	COR. IN LINKS	Angle	COR. IN LINKS	Angle	COR. IN LINKS	Angle	COR. IN LINKS
0		0		0		0	
4	0.24	11	1.88	18	5.14	25	10.54
5	0.38	12	2.24	19	5.76	26	11.26
6	0.55	13	2.63	20	6.42	27	12.24
7	0.76	14	3.06	21	7.11	28	13.37
8	0.98	15	3.53	22	7.85	29	14.34
9	1.24	16	4.02	23	8.64	30	15.47
10	1.55	17	4.56	24	9.47	35	22.07

185.98 Rod wood W W Beck Cor

223.67 Ufas S W cor Iron Pin 6' S W Cor

269.26 Washington St N E Cor Spitzene

~~190.95~~ Hub W E Cor Thomas Gold fields

192.95 Hub 100' S of S W Cor, Thom " new

181.86 Hub Center of Rod wood + Gold fields

201.52 " " " " " " " " " "

236.28 SE Cor Hawk + Ufas Iron Pin 6' S

192.37 Same as Hub center Spitzer + Horton

215.60 spike near SW Cor Ufas + Hawk

259.90 pole near SE Cor Willow + Hawk

239.04 rails in fence cor near Brooks "

Eagle

265.94 Spitzene cor Eagle + Washy 28

266.44 Cor 102' 800 Dove St + Wuch

1140

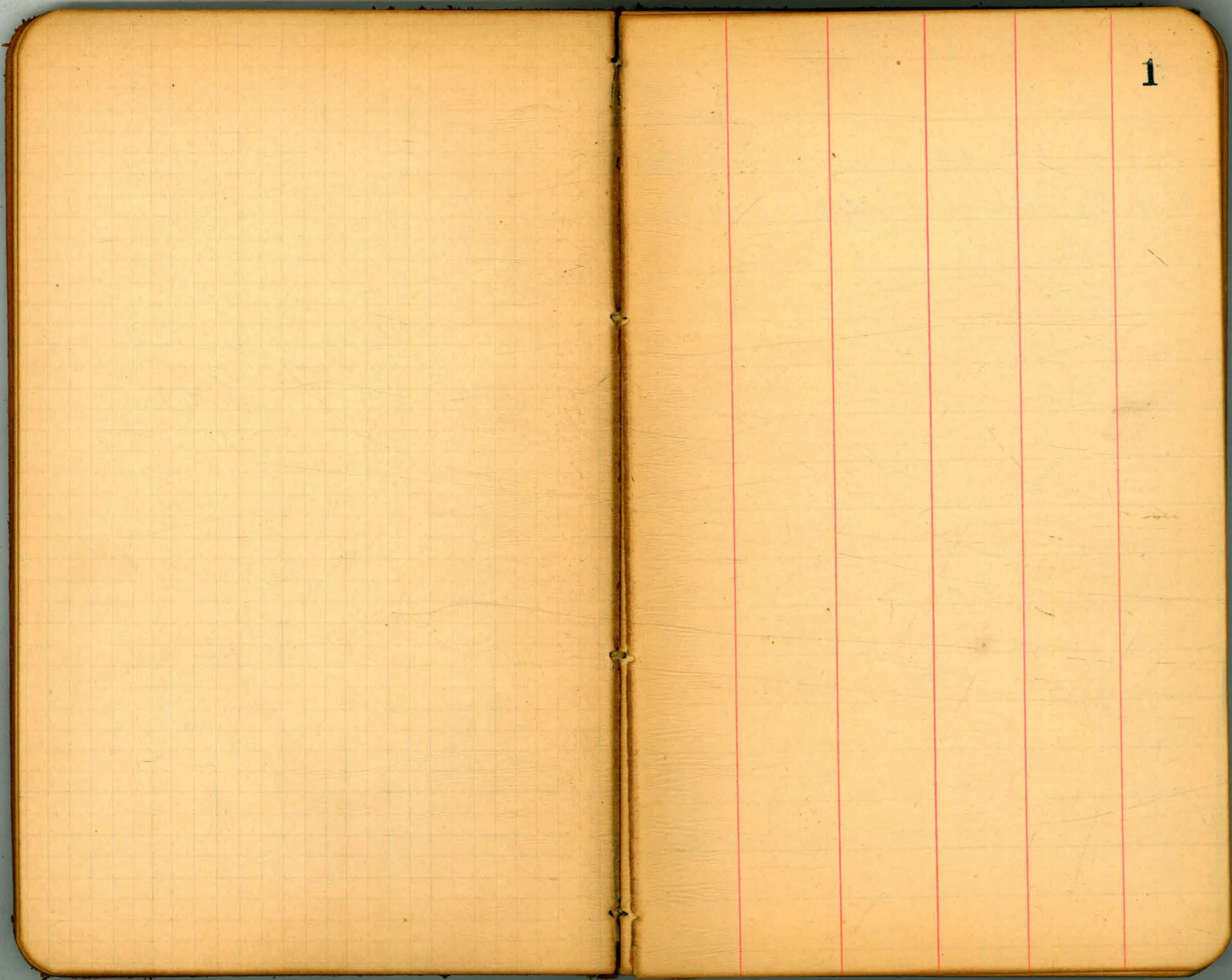

1

POSTED

Levels for Profile on
(80' it) Goldfinch St from
The Bluff St. Hartman
BM on Washington & Goldfinch 69.46 BM

	4.40	273.66		269.26
TP	0.73	270.90	3.49	270.17
				BM 7th St
				North line Lewis 30' wide
WL		270.90	13.00	257.9
b			11.4	259.5
EL			19.4	257.5
			10' S	
WL			7.8	260.1
b			7.6	263.3
			35' S	
EL			9.4	261.5
			S line Lewis	
EL			8.1	262.8
b			6.6	264.3
WL			4.4	266.5

blough } Oct 27/06 } 270.90

Burdle } 27/06

100' S of Lewis

WL		3.4	267.5
b		5.5	265.4
EL		7.3	263.6

100' S of Lewis

EL		6.8	264.1
b		5.4	265.5
WL		3.6	267.3

150' S of Lewis

WL		3.5	267.4
b		4.7	266.2
EL		5.9	265.0

200' S of Lewis

EL		4.4	266.5
b		4.5	266.4
WL		3.0	267.9

		270.90	
		250'	Bob Lewis
Wd		2.3	268.4
b		3.0	267.9
Ed		3.4	267.5
		300'	Bob Lewis (Getti St) Rd.
Ed		2.8	268.1
b		2.5	268.4
Wd		2.1	268.8
		30'	South of Rd in Getti
Wd		1.0	269.9
b		1.3	269.6
			Ed in Getti St
Wd		2.1	268.8
b		2.6	268.3
Ed		2.8	268.1
TP	5.68	274.75 - 1.83	269.07

		274.75		3
		50'	S of Getti	
Ed		6.0	268.8	
b		5.6	269.2	
Wd		5.8	269.0	
		65'	S	
b		4.7	270.1	
		100'	S	
Wd		6.0	268.8	
b		6.0	268.8	
Ed		5.5	269.3	
		120'	S	
b		6.4	268.4	
		150'	S	
Ed		6.4	268.4	
b		5.1	269.7	
Wd		7.2	267.6	
		180'	S	
b		7.4	267.4	

27475

	195'	S	of Getti	
WL			7.6	267.2
	200'	S		
WL			7.1	267.7
b			7.0	267.8
Ed			6.7	268.1
	215'	S		
WL			5.8	269.0
	250'	S	of Getti	
Ed			6.1	268.7
b			7.0	267.8
WL			7.7	267.1
	285'	S		
WL			6.5	268.3
	300'	S	(nd Washington)	
WL			8.2	266.6
b			7.4	267.4
Ed			5.9	268.9

335- 272.61

269.26 13m

S. in Washington (50')

Ed	4.5	268.1
b	5.8	266.8
WL	5.3	267.1
	50' S	
WL	6.3	266.3
b	5.3	267.3
Ed	5.0	267.6
	100' S	
Ed	5.9	266.7
b	5.6	267.0
WL	6.4	266.2
	150' S	
WL	6.2	266.4
b	5.3	267.3
Ed	6.4	266.2

27261

	200'	S	of Washington St	
Ed			5.0	267.6
b			4.9	267.7
WL			5.1	267.5
	250'	S		
WL			4.7	267.9
b			4.7	268.4
Ed			5.0	267.6
	300'	S	(Douglas St 50' wide)	
Ed			4.7	267.9
b			5.3	267.3
WL			5.9	266.7
			leaving Douglas 50' wide	
WL			5.4	267.2
b			5.3	267.3
Ed			4.7	267.9

27261

5

				52	Douglas St	
Ed				5.2		267.4
b				5.9		266.7
WL				6.5		266.1
				TP	335	267.39
				6.57	266.04	266.04
				30'	S	Douglas
WL				4.4		265.0
b				3.7		265.7
Ed				4.0		267.4
				65'	S	
WL				4.4		265.0
				90'	S	
WL				3.9		266.0
				100'	S	
Ed				3.2		266.2
b				3.7		265.7
WL				4.1		265.3

26939				26939			
	115'	S of Douglas		(Pueblodin)	217'	S	
WL		5.6	263.8	WL		74	262.0
	150'	S		b		6.0	263.4
WL		6.3	263.1	EL		6.8	262.6
b		4.6	264.8		30' S of Pueblodin		
EL		4.3	265.1	b		8.0	261.4
	160'	S			35'	S	
b		6.0	263.4	EL		8.0	261.4
	175'	S			50'	S of Pd	
b		5.4	264.0	EL		7.7	261.7
	190'	S		b		8.4	261.0
b		6.8	262.6	WL		8.0	261.4
	200'	S			65'	S	
EL		6.6	262.8	WL		6.6	262.8
G		6.8	262.6		60'	S Pd	
WL		7.5	261.9	EL		8.3	261.1
				EL		7.5	261.9

269.39

85'	S of Pueblo	
b	8.7	260.7
100'	S of Pd	
WL	8.4	261.0
b	7.4	262.0
EL	9.2	260.2
110'	S	
WL	7.6	261.8
120'	S	
b	8.8	260.6
135'	S	
EL	9.2	260.2
150'	S of Pd	
EL	8.3	261.1
b	9.1	260.3
WL	8.0	261.4
175'	S	
b	9.5	259.9

269.39

7

180'	S of Pd	
EL	10.1	259.3
TP	6.43	266.07
	9.75	259.64
200'	S of Pueblo	
WL	5.5	260.6
b	4.8	261.3
EL	7.0	259.1
250'	S of Pueblo	
EL	8.4	259.7
b	6.0	260.1
WL	3.7	262.4
280'	S	
b	6.4	259.7
285'	S	
WL	3.4	260.7
300'	S of Pueblo	
WL	5.4	260.7
b	5.0	261.1
EL	7.4	258.7

main of
Bush at
260.7
261.1

26607

20' S of CK in Bush

b 5.9 260.2

center Bush st (80' wide)

W2 3.7 262.4

b 5.8 260.3

E2 6.0 260.1

(80' S) = Sdm Bush st

E2 6.0 260.1

b 5.2 260.9

W2 3.5 262.6

50' Sof. Bush st

W2 3.4 262.7

b 4.1 262.0

E2 5.6 260.5

70' S

E2 6.0 260.1

26607

100' S of Bush

4.5 261.6

4.6 261.5

3.5 262.6

130' S

4.0 262.1

4.6 261.5

5.2 260.9

150' S

3.8 262.3

200' S

4.2 261.9

4.8 261.3

4.9 261.2

250' S

5.7 260.4

4.9 261.2

4.8 261.3

8

266.07

TP	136	263.12	4.31	261.76
	(300'	(S of Sutter St)		(80')
EL			3.0	260.1
b			3.0	260.1
WL			3.8	259.3
		Sutter St (80')		
WL			5.1	258.0
b			4.5	258.6
EL			3.8	259.3
		S of Sutter St		
EL			4.7	258.4
b			5.5	256.6
WL			7.2	255.9
Bm			4.06	259.06
		mail in fence Sutter		Bm 5E.6m
	30'	S of Sutter		
WL			9.3	252.8

263.12

9

50'	S of Sutter St		
		14.2	248.9
		7.3	256.8
		5.2	257.9
100'	S		
		6.4	256.7
		9.8	253.3
150'	S		
		6.6	256.5
		14.7	251.4
200'	S		
		9.0	254.1
		0.68	257.25
		12.55	250.57
	100' S of Sutter		
		9.2	242.1
135'	S		
		12.4	238.9

25725

		150' S of Sutter		
WL		134		237.9
		200' S		
Levite		113		240.0
		250' S		
Ed		1.0		250.3
b		20.0		231.3
		270		
Ed		0.3		251.0
b		18.0		233.3
		300' S (Market St) (80')		
Ed		5.7		245.6
TP	0.79	239.19	12.85	238.40
		(300' S) S line Market St		
b		11.5		227.7
TP	0.48	227.45	12.22	226.97
		200' S Sutter		
WL		0.0		227.5

22745

10

		250' S of Sutter St		
WL		125		215.0
		270' S of Sutter		
WL		10.7		216.8
		300' S = 2 line of Market St (80')		
WL		12.2		215.3
TP	222	217.50	12.17	215.28
		Ed line Market St		
WL		12.4		205.1
b		4.0		213.5
Ed		+2.8		220.3
		25' S of Market		
WL		19.3		198.2
		30' S of Market		
b		14.7		202.8
		40' S of Market		
Ed		8.2		209.3

21750

50' S of market

Ed 4.1 213.0

b 6.3 211.2

Wd 12.3 205.2

70' S of market

b +1.5 219.0

Wd 8.0 209.5

100' S of market

Wd 8.2 209.3

150' S of market

Wd 2.8 214.7

TP 12.27 229.66 0.11 217.39

100' S of market

b 5.3 224.4

150' S of market

b 0.0 229.7

185' S of market

Wd 4.5 225.2

21966

11

200' S of market

Wd 3.6 226.1

250' S of market

Wd 3.2 226.5

260' S of market

Wd 4.2 225.5

BPA 12.60 217.06

TP 11.67 240.08 1.25 228.41

165' S of market

b 8.7 231.4

185' S of market

b 2.5 239.6

200' S of market

b +1.8 241.9

TP 12.58 251.77 0.89 259.19

100' S of market

Ed 14.2 237.6

251.77

135' S of market

Ed 1.5 250.3

150' S of market

Ed 0.7 251.1

200' S of market

Ed +0.5 252.3

235' S of market

Ed 0.1 257.7

b 8.6 243.2

250' S of market

Ed 7.0 244.8

b 13.6 238.2

6.90 228.96 215.06 ~~7.0~~

300' S = rd. Mission st.

Wd 11.1 212.9

b 6.6 217.4

Ed 1.0 223.0

228.96

12

center Mission (80')

Ed 10.5 213.5

b 15.4 208.6

TP 0.44 219.67 12.73 211.23

center Mission

Wd 10.7 201.0

S. line Mission

Wd 14.7 197.0

b 3.6 208.1

Ed 5.2 206.5

20' S of Mission

b 3.8 207.9

50' S of Mission

Wd 15.0 196.7

b 8.7 203.0

Ed 12.6 199.1

TP 14.09 199.58

Bm 3.71 207.92

Rock

Sandstone
pull

	0.21	199.89	199.58	TP
		65' S of Mission		
WL		16	198.3	
		100' S Mission		
WL		110	188.9	
b		122	187.7	
TP	0.37	187.89	12.51	187.38
		100' S Mission		
EL		8.5	179.4	
TP	0.64	175.84	12.69	175.20
		150' S Mission		
WL		34	172.4	
b		40	171.8	
EL		10.7	165.1	
		200' S		
EL		0.5	175.3	
b		14.6	161.2	
WL		15.4	160.4	

TP		5.10	170.74	④
TP		11.5	164.32	⑤
	4.74	175.78	170.74	④
		235' S of Mission		
EL		0.0	175.5	
		150' S of Mission		
EL		1.0	174.5	
		350' S = Indine Brook (80')		
EL		12.2	163.3	
	0.52	164.88	164.32	⑤
		235' S of Mission		
WS		10.6	154.3	
		250' S of Mission		
WL		8.8	156.1	
b		3.3	161.6	
TP	4.18	150.30	12.76	152.14

61

15630

300' S = rd Brooks st

Ed	7.5	149.8
b	4.4	151.9

15' S of rd Brooks

b	9.4	147.9
---	-----	-------

25' S of rd of Brooks

Wd	1.2	155.1
----	-----	-------

b	8.0	148.3
---	-----	-------

Ed	0.0	156.3
----	-----	-------

1.2

50' S of rd Brooks

Ed	0.0	156.3
----	-----	-------

b	10.0	145.3
---	------	-------

55' S of rd

b	9.4	146.9
---	-----	-------

S line of Brooks

Wd	+2.7	159.0
----	------	-------

b	10.5	145.8
---	------	-------

Ed	4.3	152.0
----	-----	-------

15630

14

50' S of Brooks

Ed	4.3	152.0
----	-----	-------

b	14.5	141.8
---	------	-------

Wd	+6.6	162.9
----	------	-------

75' S of Brooks

Wd	+6.6	162.9
----	------	-------

100' S of Brooks

Ed	7.5	148.8
----	-----	-------

b	13.2	143.1
---	------	-------

Wd	0.5	155.8
----	-----	-------

120' S of Brooks

Wd	7.5	148.8
----	-----	-------

b	13.4	142.9
---	------	-------

Ed	8.2	148.1
----	-----	-------

150' S of Brooks

Ed	19.0	137.3
----	------	-------

b	5.2	151.1
---	-----	-------

154.30

			200' S of Brook		
EL			2.00	154.3	
TP	1237	167.74	0.91	155.39	
			150' S of Brook		
WL			64	161.4	
			200' S of Brook		
b			0.0	167.8	
			250' S of Brook		
EL	277		11.2	156.6	
TP	1207	172.06	2.77	164.99	
			250' S of Brook		
b			4.6	172.5	
			275' S of Brook		
b			7.2	169.9	
			300' S = N line of Willow (80')		
EL			5.8	171.3	
b			2.1	175.0	
TP	1273	188.44	1.15	175.91	

188.64

15

			200' S of Brook		
WL			10.6	178.0	
			225' S of Brook		
WL			4.2	184.4	
			250' S of Brook		
WL			3.9	184.7	
			300' S = N line Willow (80')		
WL			2.4	186.2	
TP	1247	200.85	0.26	188.38	
			Center of Willow		
EL			16.9	194	181.5
			S of Willow		
EL			2.7	198.2	198.2
TP	1254	210.67	2.72	198.13	198.2 + 0.26 = 198.49
			S of Willow		
b			7.6	203.1	203.1
			check on BM	204	207.73

③ 17

	11.94	21986		207.92	From - 1.2	WL	
			Sid of Willow	(50)		b	
WL				.67			213.2
			25' S of Willow			WL	
EL				15.2		b	204.7
			50' S of Willow			EL	
EL				14.0			205.9
			75' S of Willow			EL	
EL				3.5			216.4
TP	11.89	23037	128	218.42		EL	
			100' S of Willow			b	
EL				7.0			220.4
TP	11.46	24099	0.84	229.50		EL	
			50' S of Willow			TP	5.34
WL				5.5			230.5
b				10.5		WL	230.5

			75' S of Willow				
						2.8	238.2
						5.2	235.8
			125' S of Willow				
						+1.0	242.0
						2.2	228.8
						10.0	231.0
			135' S of Willow				
						7.3	233.7
			175' S of Willow				
						11.0	230.0
						0.7	240.3
			225' S of Willow				
						9.3	231.7
						0.44	240.55
			175' S of Willow				
						2.7	243.2

22921

100' Sof Wpas

WL 9.9 219.3

TP 157 218.04 12.74 216.47

center Wpas

Ed 9.8 208.2

S din Wpas

Ed 11.5 206.5

b 9.6 214.4

50' Sof Wpas

b 4.6 213.3

Ed 12.7 205.3

100' S of Wpas

Ed 12.4 205.6

b 7.6 210.4

150' S of Wpas

WL 3.5 214.5

b 9.4 208.6

Ed 14.9 203.1

21804

200' Sof Wpas

WL 6.3 211.7

b 12.1 205.9

TP 0.57 207.66 10.95 207.09

200' Sof Wpas

Ed 7.5 200.2

250' Sof Wpas

Ed 12.5 195.2

b 7.7 200.0

WL 1.4 206.3

300' Sof Riding Throat

WL 5.3 202.4

b 11.3 196.4

S din Throat (80')

WL 9.4 198.3

b 13.5 194.2

50' S of Throat

WL 12.5 195.2

18

207.66

TP

1.47

196.87

12.26

295.40

N line of Thorn

Ed

6.0

190.9

~~201.7~~

S line of Thorn

Ed

10.2

186.7

~~197.5~~

50' S of Thorn

Ed

12.5

184.4

~~195.2~~

190.7

~~201.5~~

b

6.2

Bm

19

387

192.95
193.00

Bm

100' S of Thorn

W2

5.4

191.5

~~202.3~~

187.3

~~198.1~~

b

9.6

Ed

14.6

182.3

193.1

150' S of Thorn

W2

10.0

186.9

~~197.7~~

TP

1.57

187.19

11.25

185.62

187.19

19

150' S of Thorn

b

3.0

184.2

Ed

6.7

180.5

200' S of Thorn

Ed

11.0

176.2

b

8.3

178.9

W2

6.1

181.1

250' S of Thorn

W2

12.5

174.7

Bm

5.33

181.86

Hub at
Center
Reckard

TP

0.37

174.86

12.26

174.43

250' S of Thorn

b

3.3

171.6

Ed

4.9

170.0

300' S = N line Spruce St

Ed

13.7

161.2

b

12.6

162.3

W2

12.7

162.2

17486

		5' S of rd	Spine		
Wd		14.8	160.1		
b		14.7	160.2		
TP	0.55	163.19	12.15	162.64	
TP	1.03	152.86	11.57	151.82	
		Center of Spine at (80')			
Wd		5.0	147.7		
b		6.3	146.4		
Ed		6.7	146.0		
TP	0.30	140.45	12.50	140.15	
		S of Spine			
Wd		2.3	138.2		
b		4.6	135.9		
Ed		5.0	135.5		
		50' S of Spine			
Ed		14.7	125.8		
b		11.2	129.3		
Wd		6.4	134.1		

17045

		65' S of Spine			
Wd		3.9	136.6		
		100' S of Spine			
b		1.9	128.6		
Ed		11.2	129.3		
		150' S of Spine			
Ed		4.7	135.8		
TP	12.17	151.40	1.22	139.23	
		100' S of Spine			
Wd		4.4	147.0		
		115' S of Spine			
Wd		2.0	149.4		
		150' S of Spine			
b		4.0	147.4		
		200' S of Spine			
Ed		5.7	145.7		
TP	12.30	162.94	0.16	150.90	

16299

		150' Sof Spruce			
WL		4.6		158.3	
		200' Sof Spruce			
b		7.8		155.1	
		250' Sof Spruce			
EL		5.0		157.9	
TP	1212	174.86	0.70	162.24	
		200' Sof Spruce			
WL		7.1		167.3	
		250' Sof Spruce			
WL		1.9		172.5	
b		10.5		163.9	
		300' S = Red Redwood (80")			
EL		7.8		166.6	
TP	1217	185.33	1.00	173.36	
		N Lin Redwood			
WL		2.4		183.1	
b		10.5		175.0	

18533

21

		S Lin Redwood			
EL		9.9		175.6	
		BM 11.91	195.77	3.67	181.86
		S Line of Redwood			
		b		5.8	190.0
		50' Sof R-W			179.7
EL		14.7		181.1	
TP	9.00	202.23	0.54	193.23	
		S of Redwood			
		50' Sof Redwood			
b		7.7		194.5	
		100' Sof Redwood			
b		3.5		198.7	
		East Lin Horton Ave			
b		3.7		198.5	
TP		11.20	191.03	⊕	
TP	11.25	211.91	1.53	200.67	

POSTED

211.90

22

		54' S of Redwood		
Wd		5.7	206.8	
	65'S =	East line of Horton an		
Wd		4.5	207.4	
Bm		10.48	201.43	Top of Horton
	187	192.90	191.05	Top of Page 21
		100' S of Redwood		
Ed		10.4	182.5	
		150' S of Redwood		
Ed		7.8	185.1	
		175' S = Ed of Horton		
Ed		5.5	187.4	

POSTED

Levels for Profile on
Hawk St from Horton an
North to Brooks

Bm	Skim Hub Center	Spine +	Horton	Ed	
	10.10	202.47	192.57		
TP	11.07	213.36	0.18	202.29	Ed
TP	13.02	224.82	1.56	211.80	b
Bm	SPik near ^{SW} corner	9.22	215.60	sw cor west side	
TP	12.68	237.27	0.23	224.59	Ed
TP	9.88	247.14	0.01	237.26	
Bm		7.24	239.90	SE cor willow marks a boundary near Brook	Ed
Bm		8.10	239.04		
	(Hawk St	80' wide)		Ed	
	4.25	196.62	192.37	Bm	
	Ed Horton			Wd	
Wd		3.0	193.6		
b		3.1	193.5	Wd	
Ed		2.2	194.4		

196.62

23

	20' n of Horton		3.0	191.6	
	70' n of Horton		10.4	186.2	
			4.4	192.2	
	80' n of Horton		11.8	184.8	
	110' n of Horton		11.8	184.8	
	120' n of Horton		13.0	183.6	
			6.2	190.4	
			3.6	193.0	= 10' n of Horton
	145' n of Horton		7.1	187.5	
	170' S =	Skim Spine	6.2	190.4	
			6.8	189.8	
			13.2	183.4	

1966

23

Center of Spruce (80')

EL 15.3 181.3

b 8.0 188.6

WL 4.8 191.8

80' n of Skin Spruce

WL 37 192.9

N Skin Spruce St

WL 4.6 192.0

b 9.3 187.3

EL 17.0 199.6

50' n of Spruce

EL 17.2 179.4

b 10.6 186.0

WL 5.8 190.8

100' n of Spruce

WL 5.0 191.6

b 8.4 188.2

EL 15.6 183.0

1966

24

150' n of Spruce

EL 8.3 188.3

b 4.6 192.0

WL 2.1 193.5

200' n of Spruce

WL +0.6 197.2

b +0.4 197.0

EL 1.6 195.0

TP 12.30 208.08 0.84 195.28

250' n of Spruce

EL 5.0 203.1

b 5.8 202.3

WL 7.0 201.1

300' n = S of Spruce St

WL 3.0 205.1

b +0.5 208.6

TP 11.86 219.79 0.15

21979

Sd Thorn St

Ed 9.7 210.1

Center of Thorn

Ed 5.0 214.8

b 7.6 212.2

Wd 11.6 208.2

N line Thorn

Wd 11.2 208.6

b 6.5 213.3

Ed 2.3 217.5

50' N of Thorn

Ed 0.2 219.6

b 6.2 213.6

Wd 13.4 206.4

185' N of Thorn

Wd 14.0 205.8

90' N of Thorn

Wd 15.4 204.4

21978

25

100' N of Thorn

14.5 205.5

5.4 214.4

115' N of Thorn

12.7 207.1

150' N of Thorn

15.3 204.5

4.1 215.7

200' N of Thorn

11.3 208.5

0.2 219.5

285' N of Spauld

7.5 212.3

250' N of Thorn

6.5 213.3

300' North = S line Wras

4.20 215.59 215.6

2837 4.20 215.59

68

22837

		100' n of Thon		
EL		69	221.7	
		150' n of Thon		
EL		4.3	224.3	
		200' n of Thon		
EL		1.0	227.6	
		250' n of Thon		
b		5.3	223.3	
		300 = Bd Wpas (80')		
b		1.0	227.6	
TP	11.49	2289.17	0.69	227.68
		250' n of Thon		
EL		64	232.8	
		300' n - S2 Wpas	80'	
EL		2.8	236.4	
		N line Wpas		
EL		1.2	238.0	
b		96	229.6	

23917

26

		50' n of Wpas		
EL		1.2	238.0	
b		11.7	227.5	
		80' n of Wpas = Pueblo line		
EL		2.1	237.1	
b		13.7	225.5	
		75' n of Pueblo		
EL		3.5	235.7	
		38' n of Pueblo		
EL		5.3	233.9	
		63' n of Pueblo		
EL		8.3	230.9	
		88' n of Pueblo line		
EL		6.1	233.1	
		112' n of Pueblo		
EL		1.0	238.2	
	1.86	217.28	215.60	Bm

21728 46

Scout's Upas

WL 4.0 213.5

Wilson Upas

WL 6.2 211.3

50' N of Upas

WL 8.5 209.0

83' N of Upas = Pueblo line

WL 11.5 206.0

38' N of Pueblo line

WL 16.7 200.8

b 0.5 217.0

53' N of Pueblo line

b 6.6 210.9

88' N of Pueblo

WL 6.8 210.7

TP 100' N of Pueblo

WL 1.6 215.9

TP 12.47 228.79 0.96 216.33

22879

27

8.8' N of Pueblo

b 5.0 223.8

138' N of Pueblo

WL 6.4 222.4

TP 12.19 240.23 0.75 228.04

138' N of Pueblo line

EL 0.9 239.3

b 6.5 233.7

163' N of Pueblo

WL 10.9 229.3

188' N of Pueblo

WL 7.1 233.1

b 3.2 237.0

EL 7.09 241.1

TP 6.84 246.96 0.31 239.92

238' N of Pueblo

EL 4.7 242.1

b 5.8 241.0

WL 7.5 239.3

24678

288' n of Rumble line

WL		43	242.5
b		44	242.4
Ed		54	241.4

388' n = S.L. Willow

Ed		76	239.2 240.6
b		62	240.6
WL		48	242.0

TP	095-	24085	686	239.90	137m
----	------	-------	-----	--------	------

bank of Willow (80')

Ed		49	236.0
b		27	238.2
WL		16	239.3

R. Line Willow

WL		59	235.0
b		87	232.2
Ed		103	230.6

TP	135-	22952	7264	228.21
----	------	-------	------	--------

22952

40' n of Willow

Ed		102	219.4
b		+1.0	220.6

50' n of Willow

Ed		1670	212.9
----	--	------	-------

b		122	217.4
---	--	-----	-------

WL		52	224.4
----	--	----	-------

TP	193	218.86	1263	216.93
----	-----	--------	------	--------

90' n of Willow

WL		62	212.7
----	--	----	-------

100' n of Willow

WL		114	207.5
----	--	-----	-------

TP	013	207.59	11.60	207.44
----	-----	--------	-------	--------

100' n Willow

Cont		90	198.4
------	--	----	-------

Ed		139	193.5
----	--	-----	-------

135' n of Willow

WL		121	195.3
----	--	-----	-------

		130' n of Willow		
WL		7.9	199.5	
TP	0.15	194.49	13.05	194.34
		130' n of Willow		
b		5.6	188.9	
EL		13.3	181.2	
		150' n		
EL		11.2	183.0	
b		3.0	191.5	
	9.25	216.57		207.26
		200' n of Willow		
EL		18.5	198.0	
b		5.2	211.0	
TP	11.58	226.33	1.76	214.75
		200' n of Willow		
WL		7.7	218.6	
		250' n of Willow		
EL		12.7	213.6	

7.06	246.60	239.04	BM	
	250' n of Willow			
WL		11.6	234.5	
	280' n of Willow			
WL		4.8	247.3	
	300' n = S line of Brooks (80')			
		2.5	243.6	
b		9.5	236.6	
	Center Brooks (80')			
WL		0.8	245.0	
b		6.5	239.6	
	N line Brooks			
		3.2	242.9	
b		10.2	235.9	
TP	0.61	234.03	12.68	233.42
		250' n of Willow		
EL		20.2	213.8	
b		6.6	227.4	

POSTED

23403

300' N = S line of Brooks

Ed 95 224.5

center of Brooks

Ed 75 226.5

North line of Brooks

Ed 121 221.9

Levels for Profile on Hawk St
from Pueblo line S of Douglas St to Bluff 30

80' short

171 270.97 269.26 ^{pm} _{Excl. bench + waights}

TP 750 270.75 772 269.25

Pueblo line or line between
subdivisions

Ed 5.1 265.7

b 4.5 266.3

W2 4.2 266.6

10' north

W2 3.8 267.0

b 4.2 266.6

Ed 5.6 265.2

20' n

W2 3.0 267.8

35' n

W2 4.2 266.6

60' N of Pueblo

Ed 5.0 265.8

b 4.4 266.4

W2 4.7 266.1

270.75

110' N of Puckett

WL	5.3	265.5
b	4.9	265.9
Ed	4.7	266.1

160' N of Puckett

Ed	4.5	266.3
b	6.2	264.6
WL	4.4	266.4

210' N = S line Douglas (50')

WL	5.0	265.8
b	6.4	264.4
Ed	6.0	264.8

N line of Douglas (50')

Ed	7.5	263.3
b	7.4	263.4
WL	5.9	264.9

270.75

31

50' N of Douglas

WL	7.1	263.7
b	7.5	263.3
Ed	8.7	262.1

100' N of Douglas

Ed	9.5	261.3
b	9.6	261.2
WL	8.7	261.1

122 262.82 9.10 261.60

135' N

WL	2.5	260.3
----	-----	-------

150' N of Douglas

WL	5.7	257.1
b	3.6	259.2
Ed	3.2	259.6

170' N

b	4.6	258.2
---	-----	-------

18

26282

	200' N of Douglas		
EL	3.3	259.5	
b	14.2	248.6	
WL	24.2	238.6	
	225' N		
EL	7.3	253.5	
	230' N		
b	17.3	245.5	
	250' N of Douglas		
WL	6.8	256.0	
b	13.4	249.4	
EL	2.1	260.7	
	265' N		
WL	2.7	260.1	
	300' N - Sdim Washington (50')		
EL	0.0	262.8	
b	4.6	258.2	
WL	2.1	260.7	

26282

32

TP	9.30	270.09	2.03	26079	Bm face SW corner
		Admiral Washington (50')			
			7.7		262.4
			7.5		262.6
			5.7		264.4
		50' N			
			6.0		264.1
			6.0		264.1
			6.4		263.7
		75' N			
			4.2		266.1
			4.0		266.1
		100' N out of Douglas			
			5.0		265.1
			3.5		266.6
			4.4		265.7

38

27089

150' north of Washington

EL 36 266.5

b 38 266.3

WL 24 267.7

1.75' n

WL 35 266.6

200' n

WL 33 266.8

b 34 266.7

EL 29 267.2

220' n

b 26 267.5

250' n of Washington

EL 21 268.0

b 18 268.3

WL 24 267.7

TP 819 275,89 239 267.70

27589

33

275' n

WL 8.1 267.8

200' 290' n

WL 6.8 269.1

300' n - S line of Gillet St (30')

WL 74 268.5

b 76 268.3

EL 70 268.9

15' n of S line

EL 66 269.3

EL 72 268.7

Center of Gillet St (30')

EL 77 270.7

b 62 269.7

N line of Gillet St

EL 55 270.4

b 66 269.3

WL 71 268.8

28

275.89

20' nos beta

6.7

269.2

40' n

5.1

270.8

35' n

6.1

269.8

50' nos beta

5.8

270.1

4.4

271.5

5.2

270.7

70' n

5.4

270.5

100' n & beta

4.7

271.2

5.0

270.9

5.4

270.5

275.89

110' n

4.2

271.7

125' n

4.7

271.2

150' n

5.5

270.4

5.2

270.7

5.4

272.5

170' n

4.6

271.3

5.6

270.3

185' n

4.3

271.6

200' n

5.3

270.6

6.3

269.6

6.9

269.0

POSTED 34

27589

225'm

WL 6.6 269.3

240'm

WL 8.4 267.5

250'm

WL 8.3 267.6

b 8.0 267.9

Ed 5.8 270.1

300'm = Sdin Lewis st

Ed 7.0 268.9

b 11.1 264.8

WL 11.9 264.0

5.74 270.15 Check

TP 3.22 268.45 10.66 265.23 ✓

North line of Lewis st

Ed 3.2 265.3

b 10.7 257.8

WL 13.8 254.7

(Down into a banner 75')

POSTED

Levels for Profile on Eagle St
Broodway South (80' S)

	164	27081		27017	BM on 7' on Broodway 100' S of Level
TP	469	27519	126	27055	on Rock
	118	26497	1140	26379	Hub SE East of Broodway

(Bank of 50')

W.L. of Broodway (50')

WL			15.8	249.2
b			19.0	246.0
EL			23.5	241.5

Sideline Broodway

Ed			5.5	259.5
b			2.3	262.7
WL			1.3	263.7

10.32 27411 26379

25' S of Broodway

WL			7.8	266.3
b			7.8	266.5
EL			8.8	265.3

27411

50' S of Broodway

EL	81	266.0
b	60	268.1
WL	62	267.9

75' S

WL	49	269.2
b	57	268.4
EL	80	266.1

100' S

EL	84	265.7
b	57	268.4
WL	44	269.7

150' S

WL	44	269.7
b	61	268.0
EL	87	265.4

08

274.11

200' S

Ed	8.3	265.8
b	6.0	268.1
Wd	4.2	269.9

250' S

Wd	3.5	270.6
b	5.4	268.7
Ed	6.1	268.0

300' S = N line Lewis

(50)

Ed	5.3	268.8
b	3.9	270.2
Wd	2.8	271.3

TP

2.96

2735-1

270.55

TP
on 274.11

S line Lewis

Wd	2.5	271.0
b	2.2	271.3
Ed	4.2	269.2

2735-1

50' S of Lewis

Ed	3.8	269.7
b	2.6	270.9
Wd	2.9	270.6

100' S

Wd	3.6	269.9
b	2.9	270.6
Ed	5.9	267.6

150' S

Ed	4.4	269.1
b	3.7	269.8
Wd	4.7	268.8

200' S

Wd	5.2	268.3
b	4.6	268.9
Ed	4.7	268.6

37

27351

250' S

Ed	5.8	267.7
b	5.8	267.7
W2	5.7	267.8

300' S = N line Getti (50')

W2	6.5	267.0
b	6.7	266.8
Ed	7.2	265.3

S line Getti st (50')

Ed	9.1	264.4
b	8.1	265.4
W2	7.6	265.9

15' S of S line Getti

b	7.4	266.1
---	-----	-------

35'

W2	7.0	260.5
----	-----	-------

2

27351

50' S of Getti

W2	7.3	266.2
b	9.2	264.3
Ed	10.8	262.7

55' S

Ed	12.2	261.3
----	------	-------

100' S

Ed	13.1	260.4
b	9.5	264.0
W2	7.0	266.5

TP 5.5-6 270.19 8.88 264.63

150' S

W2	3.5	266.7
b	5.8	264.4
Ed	7.3	262.9

180' S

b	3.6	266.6
---	-----	-------

27019

200' S

Ed	5.7	264.5
b	5.0	265.2
W2	3.6	266.6

210' S

b	4.0	266.2
---	-----	-------

220' S

b	4.5	265.9
---	-----	-------

250' S

W2	3.1	267.1
b	4.1	266.1
Ed	4.4	265.8

300' S = N line Washington (50')

Ed	4.7	265.5
b	4.4	265.8
W2	4.7	265.5

27019

center of Washington (80')

W2	5.7	264.5
b	4.5	265.7
Ed	5.2	265.0

40' S of N line

Ed	6.6	263.6
----	-----	-------

S line of Washington

Ed	5.9	264.3
----	-----	-------

b	6.6	263.6
---	-----	-------

W2	6.6	263.6
----	-----	-------

50' S of Washington

W2	7.4	262.8
----	-----	-------

b	7.6	262.6
---	-----	-------

Ed	7.5	262.7
----	-----	-------

100' S

Ed	9.5	260.7
----	-----	-------

b	9.4	260.8
---	-----	-------

	8.6	261.6
--	-----	-------

CB

27019

TP	0.88	261.23	9.84	260.35
		110' S		
WL			1.6	259.6
b			1.6	259.6
Ed			2.7	257.5
		140' S		
WL			11.8	249.4
		150' S		
Ed			15.8	245.4
b			17.6	243.6
WL			9.2	252.0
		160' S		
WL			5.8	255.4
		200' S		
WL			0.5	260.7
b			7.5	253.7
Ed			18.5	242.7

40

		175' S		
Ed			27.0	234.2
		250' S		
Ed			9.8	251.4
b			1.9	259.3
TP	7.74	267.04	1.93	259.00
		250' S		
WL			4.6	262.4
		280' S		
Ed			9.7	257.3
		300' S = N of Pongles (50')		
WL			5.2	261.8
b			6.1	260.9
Ed			8.0	259.0
		40' S of N line		
Ed			9.5	257.5
		25' S of N line		
b			6.7	260.8

	267.04	(50)
	S. line of Douglas St	
Ed	8.9	258.1
b	7.2	259.8
WL	5.9	261.1
	20' S	
WL	5.2	261.8
Ed	9.2	257.8
	30' S	
Ed	10.9	256.1
	50' S	
WL	5.8	261.2
b	7.9	259.1
Ed	11.1	255.9
	70' S	
b	7.2	259.8
	75' S	
Ed	9.9	257.3

	267.04	41
	90' S	
Ed	8.5	258.5
	100' S of Douglas	
Ed	8.6	258.4
b	7.9	259.1
WL	5.8	261.2
	110' S	
b	6.7	260.3
	125' S	
Ed	9.4	257.6
	150' S	
WL	4.8	262.2
b	6.7	260.3
Ed	8.3	258.7
	175	
Ed	7.8	259.2

14

26704

200' S of Douglas St

EQ	8.0	259.9
b	5.7	261.3
W2	5.5	261.5
W2	4.3	262.7
b	5.8	261.2
EQ	6.5	260.5

232' S = Pueblo line

EQ	7.3	259.7
----	-----	-------

POSTED

Levels for Profile on Eagle from 203' on Sutter St - S to 440' 42

80' Street

TP	5.68	264.74	259.06
	4.44	262.25	257.83

Bm
88 bar
Sutter
Gold find
Bm on
Level Eagle

S line of Hall Tract

W2	1	3.4	256.8
b		6.8	255.4
EQ		10.4	251.8

25' S

EQ		6.1	255.1
b		3.4	256.8
W2		4.6	257.6

50' S

W2		4.6	257.6
b		5.6	256.6
EQ		7.8	254.4

65' S

EQ		7.9	254.3
----	--	-----	-------

75' S

EQ		8.8	253.4
----	--	-----	-------

26225		
	100'S	
EL	82	254.0
b	55	256.7
WA	47	259.5
	125'S	
b	35	258.7
EL	64	255.8
	165'S	
b	44	257.8
EL	66	255.6
	175'	
EL	57	256.4
b	46	259.6
WA	40	258.2
	200'S = N lin Sutter (80)	
WA	38	258.4
b	47	259.5
EL	52	257.0

26225			43
	10'S of N lin Sutter		
EL	46	259.6	
	25'S		
WA	38	258.4	
	30'S		
EL	53	256.9	
	Center		
EL	50	257.2	
b	44	257.8	
WA	40	260.2	
	65'S of n 2		
WA	34	258.8	
	S lin Sutter st		
WA	35	258.7	
b	38	258.4	
EL	41	258.1	

~~226.24~~ 262.25

64

50' S of Sutter

Ed 5.2 257.0

b 5.1 257.1

WL 3.8 258.4

65' S

WL 4.3 257.9

75' S

WL 3.6 258.6

b 5.6 256.6

Ed 6.3 255.9

85' S

b 6.6 255.6

WL 3.7 258.5

100' S of Sutter

WL 5.0 257.2

b 9.0 253.2

Ed 14.3 249.9

~~226.24~~ 262.25

44

150' S

8.0 254.2

175' S

9.0 253.2

180' S

10.4 251.8

200' S

7.2 255.0

250' S 12.96 249.29 ⊕

150' S

10.4 239.9

175' S

10.3 239.8

200' S

3.7 246.4

17.8 232.3

225'

9.3 240.8
0.2 249.9

Ed
b

		250.14			
EL		250'S			
EL		9.4		240.7	
		275'S			
EL		5.5		244.6	
		300'S	Wline Market		
EL		1.3		248.8	
TP	0.81	238.81	12.14	238.00	
		150'S			
EL		13.8		225.0	
		175'S			
EL		17.4		219.4	
		190'S			
EL		16.0		222.8	
	8.19	257.48		249.29	TP
		225'S			
WA		1.8		255.7	

		257.48			
		250'S			
WA		0.8		256.7	
b		5.5		252.0	
		300'S	Wline Market		
		+0.2		257.7	
		2.4		255.1	
		Center Market st	(80')		
EL		8.8		248.9	
b		1.5		256.0	
WA		+0.9		258.4	
		Stone Market W			
		+1.2		258.7	
b		2.2		255.3	
EL		17.6		239.9	
		20'S			
b		4.7		252.8	
TP	0.89	246.63	11.74	245.74	

ct

24663

15' S of market

Ed 9.0 287.6

25' S

Ed 11.4 236.2

50' S

Ed 18.5 228.1

b 4.4 242.2

60' S

b 6.5 240.1

Ed 17.3 229.3

100' S

Ed 3.0 243.6

TP 1288 25741 210 244.53

30' S of market

WL 0.6 256.8

257.41

46

100' S of market

WL 0.3 257.1

b 4.9 252.5

115

b 1.5 255.9

Ed 7.2 250.2

150' S of market

Ed 2.6 253.8

TP 657 26327 0.71 25670

150' S

b 5.6 257.7

WL 4.5 258.8

200' S

WL 3.4 257.9

b 4.8 258.5

Ed 7.2 256.1

26327

250'S of Market

EL	5.8	257.5
b	4.8	258.5
WL	3.7	259.6

300'S = N Side Mission St

WL	3.5	259.8
b	4.5	258.8
EL	4.5	258.8

Center Mission St (80')

EL	5.3	259.0
b	5.1	258.2
WL	4.6	258.7

Side Mission

WL	5.5	259.8
b	6.0	257.3
EL	6.3	257.0

TP	2.12	258.98	6.41	256.86	SE corner
Bm			19.3	257.05	Mission

258.98

47

30'S of Mission

EL	3.0	256.0
----	-----	-------

50'S of Mission

WL	2.0	257.0
b	2.4	256.4
EL	1.2	251.8

65'S

b	3.7	255.3
---	-----	-------

80'S

WL	3.3	255.7
----	-----	-------

100'S of Mission

WL	13.0	246.0
----	------	-------

TP	0.87	246.85	13.00	241.98
----	------	--------	-------	--------

100'S

b				
TP	4.01	253.99	12.87	253.98

75'S

b				
EL			+ 3.5	237.5

		23399		
		100'S		
Ed		4.9	229.1	b
		150'S		
Wd		2.0	232.0	b
TP	031	2258 12.72	2227	
		150'S		b
Ed		4.7	216.9	
b		5.0	216.6	b
		175'S		
Wd		0.0	221.6	b
b		11.6	210.0	
Ed		6.0	215.6	b
		200'S		
Ed		2.9	218.9	b
Wd		9.5	212.1	
		220'S		b
Ed		2.0	219.6	
TP	146	21049 12.55	20903	

		21049		
		200'S		
		5.5	205.0	
		215'S		
		14	209.1	
		250'S		
		5.0	205.5	
		290'S		
		10.6	199.9	
		300'S = N in Bricks		
		5.8	204.7	
		10'S of N L		
		4.2	206.3	
		Center of Bricks		
		4.5	206.0	
		55'S of N L		
		1.3	209.2	
TP	044	200.45 10.48	200.01	

20045-

WL	250' S of Mission	82	192.3
WL	275' S of Mission	183	182.2
WL	300' S = Indian Brooks	110	189.5
WL	30' S of Indian Brooks	11.2	189.3
WL	Center Brooks (80')	8.6	191.9
WL	60' S of Indian Brooks	6.4	194.1
WL	Indian Brooks	6.6	193.9
WL	20' S of Brooks	8.9	191.6
WL	25' S of Brooks	7.3	193.2

20045-

WL	50' S of Brooks	6.9	193.6
WL	75' S of Brooks	5.9	194.6
WL	100' S of Brooks	4.2	196.3
WL	105' S of Brooks	3.3	197.2
WL	125' S	2.9	197.6
WL	150' S of Brooks	1.6	198.9
TP		1.26	199.19
	7237	233.54	221.27
EL	240' S of Mission	9.0	224.5
EL	250' S of Mission	7.5	226.0

44

233.64

E2

265' S of Brooks Mission

8.5

225.1

E2

275' S of Brooks Mission

12.3

221.3

E2

280' S of Brooks Mission

14.2

219.4

E2

285' S

12.6

221.6

300' S = End of Brooks

E2

11.0

222.6

E2

20' S of Nelson Brooks

2.3

231.3

E2

30' S of Nelson

0.5

233.1

E2

Center Brooks (80)

1.8

231.8

E2

55' S of Nelson of Brooks

2.8

230.8

233.64

50

E2

70' S of Nelson Brooks

0.0

233.6

E2

Nelson Brooks

4.1

229.5

E2

10' S of Brooks

6.7

227.4

E2

20' S of Brooks

5.8

227.8

E2

25' S of Brooks

+2.0

235.6

E2

50' S of Brooks

+6.5

240.1

TP 6.47

232.85 7.26 236.38

E2

75' S of Brooks

4.8

230.1

E2

100' S of Brooks

1.3

231.6

06

232.85

		125' S of Brooks		
Ed		1.6	231.3	
		135' S of Brooks		
Ed		1.3	231.6	
		150' S of Brooks		
Ed		6.2	226.7	
TP		12.25 ^o	220.60	220.7
	105.4	209.73	199.19	✓
		S of Brooks		
b		0.0	209.7	
		10' S of Brooks		
b		2.00	207.7	
TP	11.38	218.26	2.85	206.88
		50' S of Brooks		
b		5.0	213.3	
		80' S of Brooks		
b		8.7	209.6	

218.26

		100' S of Brooks		
b		6.0	212.3	
		115' S of Brooks		
b		4.1	214.2	
		150' S of Brooks		
b		3.8	214.5	
		175' S		
WL		13.6	204.7	
b		8.7	210.1	
Ed		2.3	216.0	
		185' S		
WL		11.3	206.8	
		200' S of Brooks		
Ed		12.3	206.0	
b		15.8	202.5	
WL		11.8	206.5	
		210' S		
WL		11.6	206.7	

12

21824

TP	0.60	20682	12.04	20629	200 85
		225' S of Brooks			
EL			12.4		194.4
b			12.4		194.4
WL			3.2		203.6
		250' S of Brooks			
WL			10.7		196.1
TP	0.0	19409	12.73	19409	Peak at well
		250' S of Brooks			
EL			9.5		184.6
b			6.8		187.3
		275' S of Brooks			
WL			5.4		188.7
b			15.6		178.5
EL			15.6		178.5
		300' S = N line Willow st (80')			
EL			9.7		184.4
WL			18.5		181.6

18409

52
98.00
N line
185.2

		8.89	185.20		
		Center Willow (80')			
EL			7.3		186.8
		S line Willow			
EL			2.1		191.0
		10' S willow			
EL			3.2		190.9
		25' S			
EL			5.0		189.1
		50' S of willow			
EL			12.2		181.9
		on peak N line willow			
BM	0.62	18230	12.41	181.68	
		N line Willow			
b			11.3		171.0
		10' S of N line			
b			16.6		165.7

WL

Center of Willow (50')

17.0 165.3

b

16.3 166.0

Skine Willow

b

8.3 173.0

25' S of Willow

b

4.8 177.5

50' S of Willow

b

9.7 172.6

75' S of Willow

EL

7.2 175.1

100' S of Willow

EL

12.7 169.6

TP

110

170.87 125.3 169.77

100' S of Willow

b

14.2 156.7

125' S of will-

EL

7.1 163.8

150' S of Willow

EL

14.7 156.2

TP

1.09 15.964 12.32 15.855

Skine of Willow

WL

9.0 150.6

25' S of Willow

WL

4.4 155.2

50' S

WL

3.9 155.7

75' S of Willow

WL

5.0 154.6

100' S

WL

8.3 151.3

150' S

WL

12.8 146.8

175' S

b

15.2 144.4

53

15264

TP	0.51	14788	12.07	147.57
		150' S of willow		
WL			10.6	137.2 149.0
		175' S		
TP	0.01	13607	11.82	136.06
		175' S of willow		
WL			3.4	132.7
		2.00' S of willow		
WL			9.5	126.6
b			4.3	131.8
Ed			+1.5	137.6
		225' S of willow		
Ed			4.6	132.7
b			8.1	128.0
WL			15.0	121.1
		235' S		
WL			17.6	118.5

13607

54

		250' S of willow		
WL			17.3	118.8
b			17.6	118.5
Ed			10.3	125.8
		260' S		
		270' S		
		275' S of willow		
Ed			18.3	119.8
b			19.8	116.3
WL			12.7	123.4
		295' S		
Ed			20.9	115.2
		300' S of willow		
Ed			19.1	119.0
b			12.0	124.1
WL			3.3	132.8

13607

		325' S of Willow			
EL		16.3		119.8	
b		7.3		128.8	
		350' S			
EL		13.2		122.9	
b		0.0		136.1	
		375' S			
EL		9.0		127.1	
		400' S			
EL		4.7		131.4	
		420' S = rd Wpas			
EL		2.6		133.5	
TP	12.11	146.04	2.14	133.93	
		check Bm at Wpas	3.54	140.70	
		375' S of Willow			
b		0.0		146.0	
TP	12.00	157.68	0.36	145.68	

15768

55

		350' S of Brooks			
WL		11.0		146.7	
		365' S			
WL		6.1		151.6	
		375' S			
WL		3.1		154.6	
		390' S			
WL		0.5		157.1	
		400' S of Willow			
b		11.0		146.7	
		425' S rd Wpas			
b		7.5		150.2	
		center Wpas			
b		5.5		152.2	
TP	5.23	162.69	0.22	157.46	
		400' S of Willow			
WL		2.8		159.9	

16269

		420'S = N line of pas		
WL		1.6		161.1
		Center of pas (80')		
WL		4.0		158.7
		S line of pas		
WL		10.4		152.3
TP	0.19	150.81	12.09	150.62
		S line of pas		
b		10.3		140.5
		50'S of pas		
WL		6.5		144.3
		75'S of pas		
WL		11.5		139.3
TP	0.07	139.02	11.86	138.91
		50' S of pas		
b		9.5		129.5

13902

		100' S of pas		
WL		5.9		133.1
b				
		125' S of pas		
WL				
TP	1.04	128.16	11.90	127.12
		Center of pas		
EL		+4.2		134.4
		S line of pas		
EL		0.0		128.2
		25'S of pas		
EL		4.7		123.5
		50'S		
EL		10.0		117.9
		100'S		
b		7.6		120.6
		150' S of pas		
WL		11.4		116.8

12816

	165' S of Wpas		
WL	16.0	112.2	Ed
	175' S of Wpas		b
WL	14.2	114.0	
	200' S		Ed
WL	7.3	120.1	b
	215' S		
WL	6.3	121.9	b
	225' S		
WL	6.9	121.3	b
	250' S		Ed
WL	10.2	118.0	
	275' S		Ed
WL	13.8	114.4	b
TP	0.44	116.40	12.20
		115.96	
	100' S of Wpas		Ed
Ed	6.9	109.5	b
b	+ 3.0	115.5	
		119.4	

11640

	130' S of Wpas		
	11.2	105.4	
	175' S of Wpas		
	7.0	109.4	
	200' S		
	12.2	104.2	
	10.0	106.4	
	190' S		
	12.5	104.1	
	200' S		
	12.9	103.5	
	12.0	104.4	
	225' S		
	12.6	103.8	
	10.0	106.4	
	250' S of Wpas		
	16.20	100.2	
	10.2	106.2	

58

11640

300' S = Rd Thorn st

EL		13.6	100.8
b		11.6	104.8
WL		5.2	111.2
Center Thorn st (80')			
WL		9	107.4
b		13.8	102.6
EL		15.6	100.8

Side of Thorn

EL		17.3	99.1
b		16.0	100.4
WL		12.2	104.2
TP	5-47	109.83	12.04 104.36
EL		20.50	104.4
25' S of Thorn			
WL		7.8	102.0
b		10.5	99.5
EL		8.0	101.8

10983

58

50' S of Thorn

EL		9.0	100.8
b		12.7	97.1
WL		10.2	99.6
55' S 7.5			
EL			102.5
65' S			
b		10.6	99.2
70' S			
WL		12.6	97.2
75' S of Thorn			
WL		15.0	94.8
80' S			
WL		12.7	97.1
100' S of Thorn			
WL		11.8	98.0
b		11.0	98.8
EL		7.7	102.1

88

10983

	170' S of Thom		
Ed	7.0	102.8	
	125' S		
Ed	2.8	107.0	
b	12.3	97.5	
WL	12.0	97.8	
	140' S		
b	9.4	100.4	
	150' S of Thom		
WL	12.3	97.5	
b	9.0	100.8	
Ed	0.0	109.8	
	175' S		
b	7.2	102.6	
WL	12.5	97.3	
	200' S of Thom		
WL	13.2	96.6	
b	8.6	101.2	

10985

59

	225' S of Thom		
WL	13.8	96.0	
	250' S		
WL	14.7	95.1	
b	7.8	102.0	
	275' S		
WL	15.7	94.1	
	300' S = N line Spruce (80')		
WL	14.2	95.6	
b	5.0	104.8	
	Center Spruce		
WL	10.6	99.2	
b	2.2	107.6	
	S line Spruce		
WL	9.7	100.1	
	25' S of Spruce		
WL	12.3	97.5	

		10983	
WL		50' S of Spruce	98.6
TP	12.89	11932 340	106.43
Ed		200' S of 7 horn	
		8.0	111.3
Ed		225' S of 7 horn	
		6.0	113.3
Ed		250' S of 7 horn	
		5.2	114.1
Ed		275' S of 7 horn	
		4.0	115.3
Ed		300' S = 7th Spruce	
		4.9	114.4
Ed		Center Spruce	
		2.5	116.8
b		S Line Spruce	
		7.0	112.3

		11932	60
b		50' S Spruce	117.1
WL		75' S of Spruce	
		7.50	104.3
WL		100' S	
		16.0	103.3
b		2.0	117.3
TP	10.20	129.32 0.20	119.12
Ed		S Line of 7 Spruce	
		6.1	123.2
Ed		25' S of Spruce	
		4.1	125.2
Ed		50' S of Spruce	
		2.0	127.3
b		11.7	116.6
Ed		75' S of Spruce	
		1.3	128.0

11934

	100' S of Shum		
EL	0.5	128.8	
b	10.0	119.3	
	125'S		
EL	0.8	128.5	
	150' S Shum		
EL	0.0	129.3	
b	11.0	118.3	
	200' S		
b	9.2	120.1	
	250' S		
b	9.0	120.3	
	300' S = rd Redwood		
b	7.3	122.0	
TP	7.85	133.61	3.56 125.76
	175' S of Shum		
EL	3.5	130.1	

13361

61

	200' S of Shum		
EL	2.7	130.9	
	225'S		
EL	2.0	131.6	
	250'S		
EL	1.1	132.5	
	300'S = rd Redwood (80')		
EL	1.0	132.6	
	center Redwood		
EL	1.5	132.1	
b	9.3	124.3	
	60' S of rd Redwood		
EL	2.9	130.7	
		0	
	Side Redwood		
EL	7.1	126.5	
b	11.7	122.2	
TP	0.41	121.23	12.79 120.82
TP	1.35	115.46	9.32 111.91

10
POSTED

11346

WL	100' S of Spruce	98	100.7
WL	125' S of Spruce	141	99.4
WL	150' S	148	98.7
WL	165' S	124	101.1
WL	175' S of Spruce	134	100.1
WL	200' S	142	99.3
WL	225' S of Spruce	145	99.0
WL	250' S	161	97.4
	275' 150		98.5

11346

62

WL	300' = N line	112	102.3
WL	Center Redwood (80)	2.0	111.5
WL	S Line Redwood	12	112.3
TD		1.27	112.19

SW Huh
on RW

Profile Levels of Curlew
Juniper to Thompson

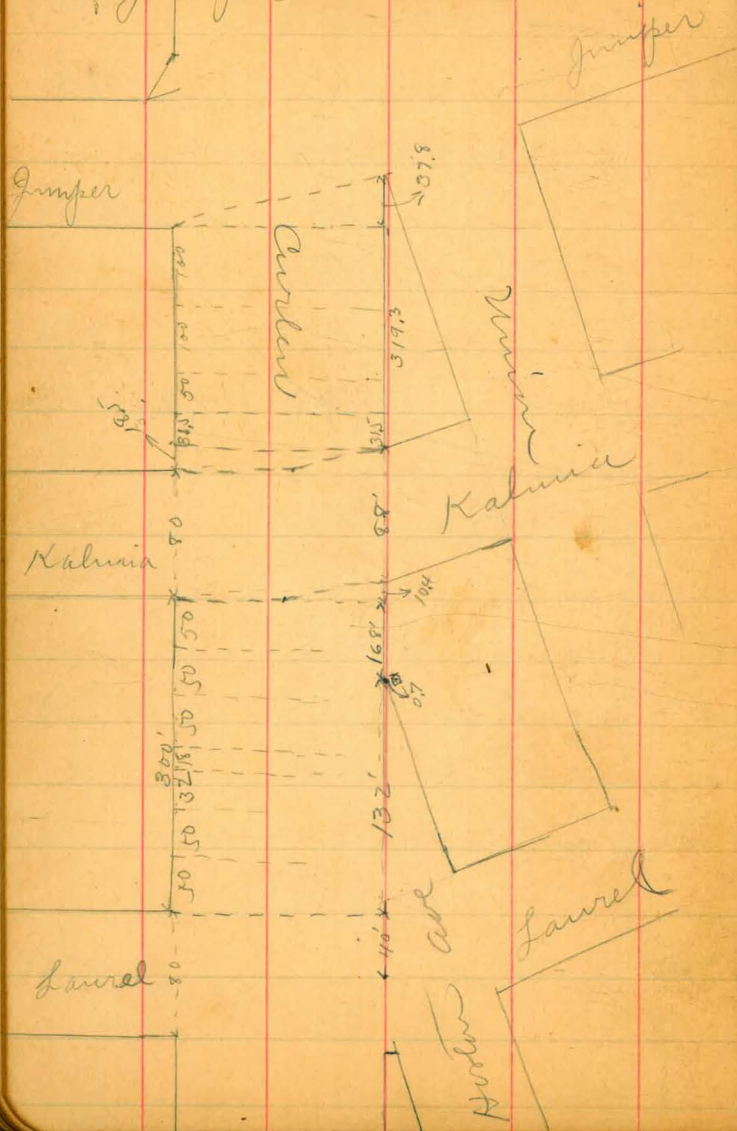

POSTED

Nov. 17, 1906

Builds
Evans 63
Bell

2.99 H.I. 155.66 152.67 B.M.

West line Curlew

Center Laurel 4.6 151.1
Sodire " 9.0 146.7

Center Curlew

Center Laurel 5.4 150.3
Sodire " 10.2 145.5

East line Curlew

Center Laurel 6.6 149.1
C+15 9.1 146.6
Sodire " 10.5 145.2

J.P. 0.75 H.I. 143.64 12.77 142.89

50' so Laurel 1.7 141.9

100' so " 5.1 138.5

132' " " with Curlew 7.8 135.8

150' " " 9.6 134.0

Center Curlew

50' So Laurel	3.0	140.6
100' So. "	6.8	136.8
132' " "	8.9	134.7
150' " "	10.5	133.1

200' " " West line Curlew

50' So Laurel	3.0	140.6
100' " "	7.8	135.8
132' " "	9.7	133.9
150' " "	10.6	133.0

J.P. 1.10 ^{H.I.} 132.35 12.39 131.25

200' " "	1.9	130.5
250' " "	5.5	126.9
300' " "	10.0	122.4
3104' " " Maise Kalunia	10.3	122.1

Center Curlew

200' So Laurel	2.9	129.5
250' So "	7.1	125.3
300' So. "	11.1	121.3

East line Curlew

200' So Laurel	1.8	130.6
250' " "	6.4	126.0
300' So. " Maise Kalunia	10.9	121.5
J.P. -0.05 ^{H.I.} 120.78	11.52	120.83

West line Curlew

Center Kalunia	3.5	117.3
So. line "	11.2	109.6

Center Curlew

Center Kalunia	6.4	114.4
----------------	-----	-------

East line Curlew

5' So. M. hite Kalunia	4.7	116.1
15' " " "	9.6	111.2
Center "	11.3	109.5

Nov. 30. 1906

120.78

 Childs
 Evans
 Bell

East line Curlew

20' So. Center Kalumia	11.8	109.0
So. line	7.4	113.4
18.5' So. Kalumia	6.9	113.9
40' " "	7.9	112.9
50' " "	9.2	111.6
75' " "	12.1	108.7
J.P. 0.54	H.I. 108.53	12.79 107.99

Center Curlew

So. line Kalumia	3.9	104.6
18.5' So. "	5.6	102.9
50' " "	8.1	100.4
75' " "	5.7	102.8
100' " "	7.7	100.8
125' " "	11.1	97.4
130' " "	16.1	92.4
135' " "	11.1	97.4
150' " "	7.5	101.0

Center Curlew

160' So. Kalumia	5.4	103.1
200' " "	3.6	104.9
250' " "	4.2	104.3
300' " "	6.4	102.1

West line Curlew

31.5' So. Kalumia	3.9	104.6
56.5' " "	8.5	100.0
86.5' " "	11.4	97.1
99' " "	13.7	94.8
109' " "	21.3	87.2
119' " "	15.3	93.2
131.5' " "	15.3	93.2
156.5' " "	11.3	97.2
181.5' " "	9.0	99.5
231.5' " "	8.2	100.3
281.5' " "	9.4	99.1
319.3 No. line Juniper	10.2	98.3

65

68

108,53

East line Curlew

100' So. Kalmia	5.8	102.7
107' " "	6.4	102.1
112' " "	11.2	97.3
118' " "	5.7	102.8
125' " "	4.7	103.8
150' " "	1.5	107.0
J.P.	4.55	H.I. 112.31
	0.77	107.76

East line Curlew

175' So. Kalmia	1.7	110.6
200' " "	2.7	109.6
250' " "	4.1	108.2
300' " No. live Juniper	6.1	106.2

Center Curlew

J.P.	6.07	H.I. 158.74	6	152.67	B.M.
No. live Laurel			4.3	154.4	
50' " "			1.0	157.7	
90' " "			1.8	156.9	
100' " "			4.1	154.6	
110' " "			6.0	152.7	
122' " "			11.8	146.9	
134' " "			14.3	144.4	

West line Curlew

No. live Laurel	3.9	154.8
50' " "	2.8	155.9
100' " "	5.7	153.0
110' " "	7.0	151.7
134' " "	16.7	142.0

East line Curlew

No. live Laurel	5.2	153.5
50' " "	1.5	157.2
100' " "	0.9	157.8

66

158.74

East line Curlew

112' N Laurel	3.0	155.7
130' " "	8.6	150.1
150' " "	14.0	144.7
J.P. 0.33	H.I. 146.13	12.94 145.80

East line Curlew

160' N Laurel	2.7	143.4
180' " "	11.0	135.1

Center Curlew

150' N Laurel	9.0	137.1
---------------	-----	-------

West line Curlew

150' N Laurel	12.5	133.6
---------------	------	-------

E. line Curlew

150' N maple	9.1	137.0
200' " "	3.6	142.5
235' " "	1.4	144.7
250' " "	2.6	143.5

Center Curlew

235' N maple	11.8	134.3
--------------	------	-------

67

146.13

200' N maple 10.3 135.8

J.P. 1.24 H.I. 134.53 12.84 133.29 blow road

Center Curlew

150' N maple	2.3	132.2
100' N " "	9.0	125.5

East line Curlew

100' N maple	8.5	126.0
--------------	-----	-------

West line Curlew

235' N maple	10.7	123.8
--------------	------	-------

200' " "	7.2	126.3
150' " "	8.8	125.7

100' " "	13.8	120.7
----------	------	-------

East line Curlew

200' N Laurel	7.0	127.5
---------------	-----	-------

212' " "	10.0	124.5
J.P. 0.15	H.I. 121.95	12.75 121.80

East line Curlew

237' N Laurel	9.9	112.0
---------------	-----	-------

121.95

Center Curlew

200' N Laurel 6.5 115.4

West line Curlew

200' N Laurel 11.2 110.7

East line Curlew

50' N. maple 12.0 109.9

Center Curlew

75' N. maple 2.0 119.9

50' " " 9.7 112.2

West line Curlew

50' N. maple 10.6 111.3

J.P. 0.45 ^{H.I.} 109.72 12.68 109.27

East line Curlew

250' N. Laurel 5.3 104.4

263' " " 13.0 96.7

Center Curlew

225' N Laurel 2.4 107.3

250' " " 12.1 97.6

68

109.72

260' N Laurel 13.8 95.9

West line Curlew

237' N Laurel 13.0 96.7

J.P. 0.13 ^{H.I.} 97.05 12.80 96.92

East line Curlew

285' N Laurel 8.4 88.7

So. line Maple (300' N. Laurel) 12.5 84.6

Center Curlew

270' N. Laurel 7.8 89.3

East line Curlew

No. line maple 10.0 87.1

Center Curlew

No. line maple 6.3 90.8

West line Curlew

No. line maple 3.1 94.0

J.P. 0.32 ^{H.I.} 84.57 12.80 84.25

8457

East line Curlew				
Center maple	10.6	74.0		
Center Curlew				
Center maple (B.M. ashub)	6.13	78.44	B.M.	
19' So. Center maple	10.8	73.8		
23' " " "	15.0	66.6		
32' " " "	8.4	76.2		
30' " " "	19.4	65.2		
34' " " "	7.5	77.1		
So. line maple.	7.2	77.4		
290' No. Laurel	9.2	75.4		
J.P.	7.07	^{H.I.} 78.94	12.70	71.87
West line Curlew				
Center maple	-0.7	79.6		
32' So. Center maple	8.9	70.0		
38' " " "	5.4	73.5		
So. line maple	11.7	67.2		
285' N. Laurel	11.2	67.7		

Dec. 1. 1906

Lehido
Evans
Bell 69

263' N. Laurel.	-0.4	79.3		
J.P.	6.56	^{H.I.} 85.00		78.44
West line Curlew				
250' N. Laurel	0.0	85.0		
J.P.	3.71	^{H.I.} 137.00		133.29
East line Curlew				
So. line Nutmeg	5.4	131.6		
15' So. center "	6.2	130.8		
Center "	7.5	129.5		
No. line "	8.3	128.7		
50' N. "	8.0	129.0		
75' N. "	9.8	127.2		
Center Curlew				
250' N. maple	6.4	130.6		
West line Curlew				
150' N. olive	6.6	130.4		
200' N. "	1.1	135.9		
J.P.	1.22	135.78		High turn

Center Curlew

250' N. Olive	8.3	128.7
300' " So. line Palm	3.6	133.4

East line Curlew

Center Palm	9.1	127.9
J.P.	0.13	124.21
H.T.	12.92	124.08

West line Curlew

100' N. Olive	3.3	120.9
50' " "	15.3	108.9

Center Curlew

150' N Olive	5.9	118.3
200' " "	-0.3	124.5

East line Curlew

So. line Palm	5.2	119.0
250' N. Olive	12.8	111.4

Center Curlew

So. line Nutmeg	6.0	118.2
26' So. center "	8.7	115.5

Center Nutmeg

200. line "	9.9	114.3
25' N "	8.7	115.5
50' N "	11.3	112.9
70' " "	12.1	112.1

East line Curlew

100' N. Nutmeg	3.4	120.8
150' N "	11.6	112.6
170' N "	14.4	109.8

West line Curlew

250' N. Maple	2.0	122.2
J.P.	0.12	111.51
H.T.	12.82	111.39
So. line Nutmeg	5.0	106.5
Center "	15.6	95.9
90. line "	12.9	98.6
50' N "	15.2	96.3

B.M. on knob

111.51

Center Curlew

100' N Nutmeg 6.0 105.5

East line curlew

200' N Nutmeg 9.1 102.4

249' " " 14.3 97.2

150' N Olive 10.7 100.8

200' " " 5.2 106.3

Center Curlew

100' N Olive 3.9 107.6

West line Curlew

No. line Olive 12.7 98.8

J.P. 0.39 ^{H.I.} 99.11 12.79 98.72

Center Olive 6.2 92.9

So. line " 11.2 87.9

Center Curlew

50' N. Olive 3.7 95.4

N. line Olive 9.8 89.3

99.11

East line Curlew

108' N Olive 3.6 95.5

100' " " 7.1 92.0

50' " " 10.8 88.3

45' " " 11.3 87.8

250' N Nutmeg 4.5 94.6

Center Curlew

130' N. Nutmeg 3.6 95.5

150' N. Nutmeg 4.6 94.5

154' " " 6.8 92.3

157' " " 4.2 87.9

West line curlew

100' N. Nutmeg 8.9 90.2

130' " " 14.6 84.5

J.P. 1.14 ^{H.I.} 87.27 12.98 86.13

133' " " 5.5 81.8

150' " " 6.3 81.0

200' " " 6.8 80.5

250' " " 4.5 82.8

87,27

Center Curlew

167' N. Nutmeg	7.3	80.0
200' " "	10.0	77.3
250' " "	10.0	77.3
280' " "	8.4	78.9
286' " "	5.1	82.2
So. line Olive	4.6	82.7
Center Olive	3.4	83.9

East line Curlew

So. line Olive	3.6	83.7
Center "	7.8	79.5
No. line "	7.3	80.0
43' N. Olive	5.5	81.8
J.P. 12.50	^{H.F.} 148.28	[¢] 135.78

West line Curlew

250' N Olive	7.8	140.5
So. line Palm	2.7	145.6

148,28

72

Center Curlew

Center Palm	9.22	139.06	B.M. on hub.
No. line Palm	1.8	146.5	
East line Palm			
No. line Palm	9.6	138.7	
J.P. 12.91	^{H.F.} 160.90	0.29	147.99
50' N. Palm	11.5	149.4	
100' " "	3.2	157.7	

Center Curlew

50' N. Palm	4.7	156.2
-------------	-----	-------

West line Curlew

Center Palm	10.6	150.3	
No. line Palm	6.8	154.1	
50' N "	0.7	160.2	
J.P. 11.08	^{H.F.} 171.71	0.27	160.63
100' N. Palm	6.1	165.6	

Center Curlew

100' N. Palm	9.2	162.5
150' " "	1.7	170.0

171.71

East line Curlew

150' N. Palm 4.9 166.8

J.P. 12.76 ^{H.I.} 184.29 0.18 171.53

200' " " 8.8 175.5

250' " " 1.4 182.9

275' " " 0.4 183.9

So. line Quince 9.7 174.6

Center Curlew

200' N. Palm 4.7 179.6

West line Curlew

150' N. Palm 13.7 170.6

200' " " 7.1 177.2

J.P. 11.12 ^{H.I.} 195.14 0.27 184.02

250' " " 10.4 184.7

So. line Quince 2.5 192.6

Center Curlew

250' N. Palm 7.9 187.2

So. line Quince 2.2 192.9

Dec. 10, 1956
1951#

Billings
Evans
Bell 73

23' So. Center Quince 2.9 192.2

Center Quince 9.70 185.44 BM on Hub

J.P. 1.85 193.29 BM near

J.P. 1.45 ^{H.I.} 186.89 185.44
S.W. Cor. on Hub

Center Curlew

No. line Quince 5.0 181.9

50' " " 7.7 179.2

100' " " 4.5 182.4

120' " " 0.2 186.7

East line Curlew

100' N. Quince 8.2 178.7

85' " " 13.3 173.6

J.P. 0.82 ^{H.I.} 175.10 12.61 174.29

Center Quince 9.8 165.3

No. line Quince 10.4 164.7

50' " " 8.0 167.1

J.P. 12.98 ^{H.I.} 206.27 - 193.29 B.M.

West line curlew

Center Quince	8.3	198.0
No. line "	4.4	201.9
35' N. "	2.6	203.7
50' N. "	5.1	201.2
100 " "	8.8	197.5
150 " "	5.1	201.2
160 " "	2.2	204.1
200' " "	1.9	204.4
250' " "	8.4	197.9

Center Curlew

150' N. Quince	9.7	196.6
170' " "	2.2	204.1

East line Curlew

150' N. Quince	4.1	202.2
J.P.	7.72	^{H.I.} 213.67 0.32 205.95

Center Curlew

195' N. Quince	0.90	212.8
200' " "	0.2	213.5
218' " "	-0.2	213.9
250' " "	3.4	210.3
So. line Redwood	8.9	204.8

East line Curlew

Center Redwood	1.0	212.7
No. line "	2.4	211.3
50' N. "	3.6	210.1
100' " "	3.3	210.4
150' " "	2.2	211.5

Center Curlew

150' N. Redwood	14.0	199.7
200' " "	9.9	203.8
250' " "	6.4	207.3
So. line Spruce	1.8	211.9

213.67

West line Curlew

So. line Spruce	10.6	203.1
Center "	5.6	208.1
No. line "	0.4	213.3
J.P.	^{H.F.} 12.98	226.00 0.65 213.02

East line Curlew

200' N Spruce	1.5	224.5
210' " "	0.7	225.3
250' " "	4.3	221.7
So. line Redwood	9.0	217.0
J.P.	2	206.27 12.76 193.57

J.P. 10.91 ^{H.F.} 204.42

West line Curlew

So. line Redwood	11.8	192.6
Center "	14.1	190.3
No. line "	16.4	188.0
50' N "	15.6	188.8
100' N "	15.0	189.4

204.42

75

150' N Redwood	13.7	190.7
200' " "	11.5	192.9
250' " "	7.2	197.2

Center Curlew

Center Redwood	3.97	200.45	B.M. on hub
No. line "	6.0	198.4	
50' N "	4.4	200.0	
100' " "	5.1	199.3	
J.P.	213.67	1.33	212.34
J.P.	^{H.F.} 12.79	225.13	

East line Curlew

200' N Redwood	10.7	214.4
250' " "	5.8	219.3
So. line Spruce	1.8	223.3

Center Curlew

Center Spruce	7.67	217.46	B.M. on hub
No. line "	3.8	221.3	

225.13

West line Curlew

50' N. Spruce 5.4 219.7

J.P. ^{H.I.} 12.63 237.74 0.02 225.11

East line Curlew

Center Spruce 10.8 226.9

No. line " 7.6 230.1

50' N " 4.1 233.6

100' " " 2.2 235.5

Center Curlew

50' N. Spruce 10.9 226.8

100' " " 6.9 230.8

150' " " 2.4 235.3

West line Curlew

100' N. Spruce 11.7 226.0

150' " " 6.7 231.0

200' " " 2.2 235.5

J.P. ^{H.I.} 10.77 247.60 0.91 236.83

247.60

POSTED

76

West line Curlew

250' N. Spruce 9.8 237.8

So. line Thom 8.6 239.0

Center " 8.1 239.5

No. line " 7.8 239.8

Center Curlew

200' N. Spruce 9.2 238.4

250' " " 7.3 240.3

So. line Thom 5.6 242.0

Center " 4.5.9 243.01

No. line " 3.7 243.9

East line Curlew

150' N. Spruce 9.0 238.6

200' " " 5.9 241.7

250' " " 4.2 243.4

So. line Thom 2.9 244.7

Center " 2.4 245.2

No. line " 1.6 246.0

B.M.
on limb

Cross-section of Hawk St
Sd Wpas to rd Wilefu (80)'

	11.46	20.25		19.95	B.M. 100' 5" 8" 4" 1/2
TP	10.57	21.44	0.48	20.37	
TP	12.11	22.34	3.11	21.33	check on B.M. 215.60
			7.84	215.61	
		22344			

Sd Wpas (80)'

Wd		7.8	
leb		3.8	
1/4		0.0	

S 1/2 of Wpas

Wd		7.2	
leb		2.7	
1/4		0.0	

S 1/4 of Wpas

Wd		6.8	
leb		2.2	

In Book 244

Clayton
Fogel
Bel Feb 5

22344
Center of Wpas

Wd		10.5
leb		3.0

N 1/4 Wpas

Wd		10.1
leb		3.7

N 1/2 Wpas

Wd		10.0
leb		2.8

Nd Wpas

Wd		12.1
leb		5.6

TP	12.95	235.56	0.83	22261
----	-------	--------	------	-------

Sd Wpas

Center		8.0
E 1/4		5.1
E leb		1.8

S 1/4 of upas

center	7.5
E 1/4	3.9
E 1/2	1.7

S 1/4 upas

W 1/4	11.4
center	7.6
E 1/4	3.7
E 1/2	0.8

center upas

W 1/4	11.0
center	7.2
E 1/4	3.2
E 1/2	0.8

W 1/4 of upas

W 1/4	10.6
center	6.3
E 1/4	3.0
E 1/2	0.8

S 1/4 of upas

W 1/4	10.9
center	6.0
E 1/4	2.5
E 1/2	0.6

N 1/4 upas

W 1/4	10.4
center	5.6
E 1/4	2.5
E 1/2	0.5

10.65 240.00 5.93 229.63

S 1/2 upas

E 1/2	4.05
-------	------

S 1/4 upas

E 1/2	3.4
-------	-----

S 1/4 upas

E 1/2	3.0
-------	-----

Grand
upascheck
Bm

240.30

center of upas

E2 2.5

N 1/4 upas

E2 2.5

N 1/4 upas

E2 2.8

N 1/4 upas

E2 2.2

25' N of upas

E2 1.7

1/4 4.7

1/4 8.1

1/4 11.7

W 1/4 16.6

50' N of upas

W 1/4 18.4

1/4 12.4

E 1/4 7.8

240.30

50' N of upas

E 1/4 5.5

E 1/4 2.2

75' N of upas

E 1/4 3.1

1/4 6.0

1/4 8.4

1/4 13.4

85' N of upas = Ruckles line

center 14.5

E 1/4 8.6

E 1/4 6.2

E 1/4 3.7

325' S of William = 15' N of Ruckles line

E 1/4 3.1

1/4 6.4

1/4 8.7

center 15.1

87

80

2
2
1
1
1
1
2

3779
3193
58.5

182
315
590

11.3
29.6
44.9
43.2
46.1

315
58.5
90.0

287.8 193.29

181
114

12.92

195.17

1.22

1.85

193.32

206.27

12.76 x lower

213.67

133 x upper

TRAVERSE TABLE FOR TRANSIT BOOK.

From 1° to 90° for a distance of 100.

Degrees.	DEGREES.		¼ DEGREE.		½ DEGREE.		¾ DEGREE.		Degrees.
	Lat.	Dep.	Lat.	Dep.	Lat.	Dep.	Lat.	Dep.	
0			100.00	0.44	100.00	0.87	99.99	1.31	89
1	99.98	1.75	99.98	2.18	99.97	2.62	99.95	3.05	88
2	99.94	3.49	99.92	3.93	99.91	4.36	99.88	4.80	87
3	99.86	5.23	99.84	5.67	99.81	6.10	99.79	6.54	86
4	99.76	6.98	99.73	7.41	99.69	7.85	99.66	8.28	85
5	99.62	8.72	99.58	9.15	99.54	9.58	99.50	10.02	84
6	99.45	10.45	99.41	10.89	99.36	11.32	99.31	11.75	83
7	99.25	12.19	99.20	12.62	99.14	13.05	99.09	13.49	82
8	99.03	13.92	98.97	14.85	98.90	14.78	98.84	15.21	81
9	98.77	15.64	98.70	16.07	98.63	16.50	98.56	16.93	80
10	98.48	17.36	98.40	17.79	98.33	18.22	98.25	18.65	79
11	98.16	19.08	98.08	19.51	97.99	19.94	97.90	20.36	78
12	97.81	20.79	97.72	21.22	97.63	21.64	97.53	22.07	77
13	97.44	22.50	97.34	22.92	97.24	23.34	97.13	23.77	76
14	97.03	24.19	96.92	24.62	96.81	25.04	96.70	25.46	75
15	96.59	25.88	96.48	26.30	96.36	26.72	96.25	27.14	74
16	96.13	27.56	96.00	27.98	95.88	28.40	95.76	28.82	73
17	95.63	29.24	95.50	29.05	95.37	30.07	95.24	30.49	72
18	95.11	30.90	94.97	31.32	94.83	31.73	94.69	32.14	71
19	94.55	32.56	94.41	32.97	94.26	33.38	94.12	33.79	70
20	93.97	34.20	93.82	34.61	93.67	35.02	93.51	35.43	69
21	93.36	35.84	93.20	36.24	93.04	36.65	92.88	37.06	68
22	92.72	37.46	92.55	37.86	92.39	38.27	92.22	38.67	67
23	92.05	39.07	91.88	39.47	91.71	39.87	91.53	40.27	66
24	91.35	40.67	91.18	41.07	91.00	41.47	90.81	41.87	65
25	90.63	42.26	90.45	42.66	90.26	43.05	90.07	43.44	64
26	89.88	43.84	89.69	44.23	89.49	44.62	89.30	45.01	63
27	89.10	45.40	88.90	45.79	88.70	46.17	88.50	46.56	62
28	88.29	46.95	88.09	47.33	87.88	47.72	87.67	48.10	61
29	87.46	48.48	87.25	48.86	87.04	49.24	86.82	49.62	60
30	86.60	50.00	86.38	50.38	86.16	50.75	85.94	51.13	59
31	85.72	51.50	85.49	51.88	85.26	52.25	85.04	52.62	58
32	84.80	52.99	84.57	53.36	84.34	53.73	84.10	54.10	57
33	83.87	54.46	83.63	54.83	83.39	55.19	83.15	55.56	56
34	82.90	55.92	82.66	56.28	82.41	56.64	82.16	57.00	55
35	81.92	57.36	81.66	57.71	81.41	58.07	81.16	58.42	54
36	80.90	58.78	80.64	59.13	80.39	59.48	80.13	59.83	53
37	79.86	60.18	79.60	60.53	79.34	60.88	79.07	61.23	52
38	78.80	61.57	78.53	61.91	78.26	62.25	77.99	62.59	51
39	77.71	62.93	77.44	63.27	77.16	63.61	76.88	63.94	50
40	76.60	64.28	76.32	64.61	76.04	64.94	75.76	65.28	49
41	75.47	65.61	75.18	65.93	74.90	66.26	74.61	66.59	48
42	74.31	66.91	74.02	67.24	73.73	67.56	73.43	67.88	47
43	73.14	68.20	72.84	68.52	72.54	68.84	72.24	69.15	46
44	71.93	69.47	71.63	69.78	71.33	70.09	71.02	70.40	45
45	70.71	70.71							
Degrees.	Dep.	Lat.	Dep.	Lat.	Dep.	Lat.	Dep.	Lat.	Degrees.
	DEGREES.		¼ DEGREE.		½ DEGREE.		¾ DEGREE.		

Published by H. S. CROCKER COMPANY, Stationers, Drawing Materials, Mathematical Instruments, etc., San Francisco.