

San Diego & Colorado
Water Notes.

Lower Notes

2

F.B. 69

Small white label at the bottom left corner.

X May 3rd X

Levels on new line -

1

Sta	B.S.	H of I	Int.	I.S.	Elev.
135+30	12.25	185.58			173.33
T.P.				0.57	185.11
	6.83	191.794			
137+50				2.91	189.03
735				9.8	182.14
T.P.	2.95	182.25		12.64	179.3
+50				4.1	178.1
136				8.25	174.0
+50				9.25	173.0
T.P.				13.03	169.11
	1.48	170.65			
137				11.65	159.0
T.P.				12.62	158.3
	0.55	158.85			
137+50				9.05	149.8
T.P.				12.55	146.3
	0.26	146.56			
138				7.52	142.04
+50				10.75	135.81
T.P.				12.8	133.76

Sta	B.S. +	H of Icm.	Int.	I.S. -	elev.
	0.37	137.13			
139				4.40	129.73
T.S.O.				9.60	127.53
T.P.				12.73	121.40
	0.14	121.57			
140				4.15	117.39
+40	T.P.			13.14	108.7
	1.22	109.62			
+50				4.50	105.12
T.P.				12.30	97.32
	0.16	97.48			
T.P.				12.92	84.56
	-0.1	87.46			
141				4.60	79.86
T.P.				12.85	71.61
	0.40	72.01			
+50				12.71	59.6
T.P.				11.97	60.07
	0.17	60.27			
T.P.				12.25	47.99

Sta	B.S.	H.I.P.	I.S.	elev.
	0.44	48.43		
172			3.57	47.86
+50			9.1	39.33
172+50	T.P.		8.70	39.73

Sta	BS	H.I.P.	Int	I.S.	Elev.
142+50	2.69	42.42			39.72
	.05	30.20		14.27	30.15
			14.22		17.98

on Cape of Pinstle (17.93)

The image shows an open notebook with two blank pages. The pages are cream-colored and feature light blue horizontal ruling. The left page has a vertical red margin line on the left side, and the right page has a vertical red margin line on the right side. The notebook is bound in the center, and the pages are slightly aged. A small blue number '7' is written in the top right corner of the right page.

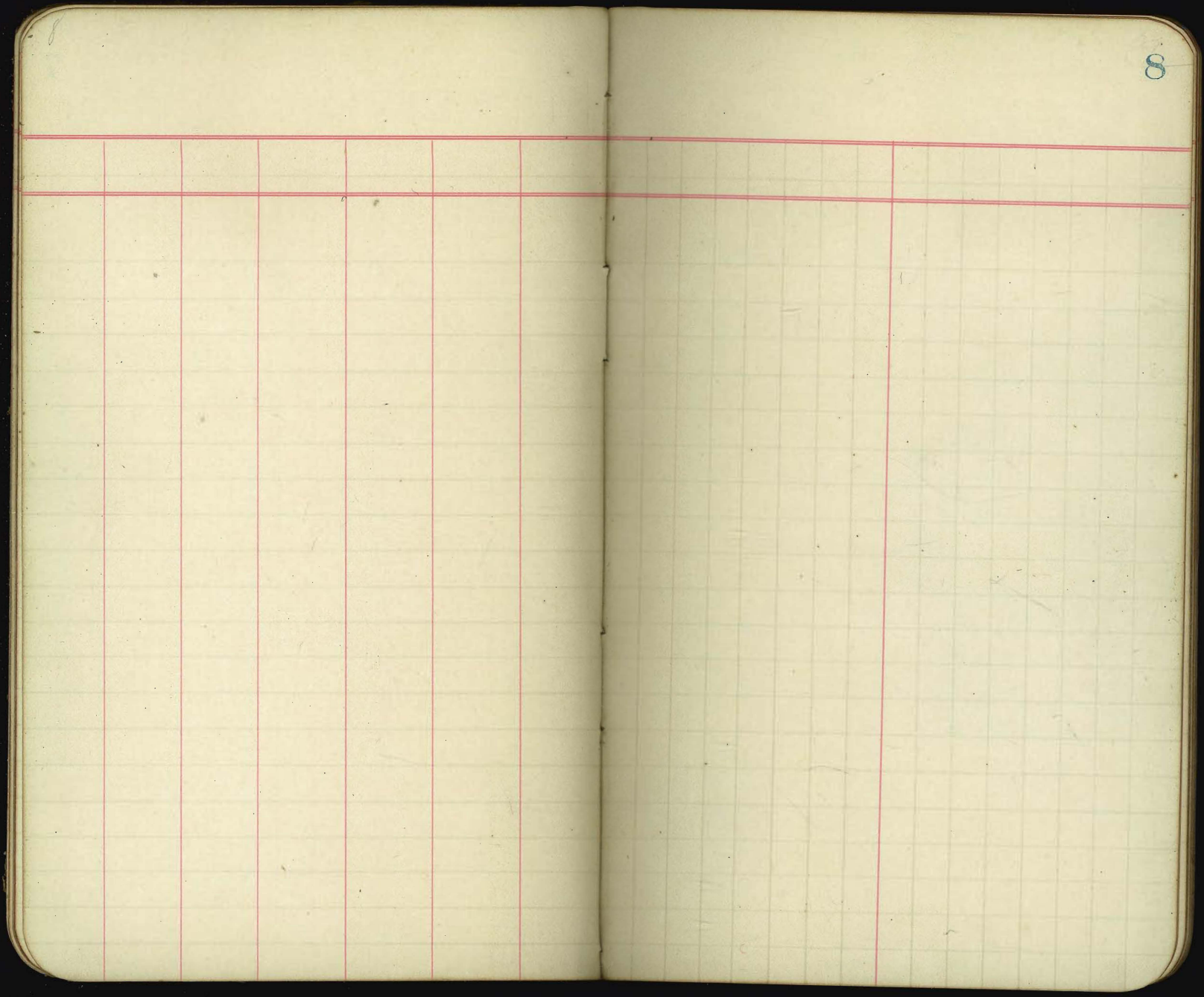

Levels carried from
 Ugas 5th to connect with
 pipe line

Δ	+	KB	-	FW	BM
					288.48
	2.86	291.34			
TP			3.88	287.46	
	4.56	286.02			
TP			6.25	279.77	
	10.96	275.06			
TP			2.73	282.33	
	6.25	298.58			
TP, BM			5.86	282.72	
	11.10	289.07			
TP			2.27	286.80	
	4.62	296.22			
TP			1.73	294.49	
	12.75	307.24			

Top of stake NE leg 5th Ugas.

Sp in the pole (key) near E.C.

10 Levels of pipe line starting
 1047.7 feet E of Pueblo Cor. ¹¹¹⁷ ~~1123~~ ¹¹²⁴ ~~1124~~ ¹¹²³ ~~1124~~ West.

+	Stk	-	Ev	Apr	+ m. In
	287.62		280.84		
		1.05	286.57		
1		4.50	288.12	280.0	3-1
0		4.22	284.50	280.0	2-9
1		5.12	282.50	280.0	2-6
2		5.80	282.32	280.0	2-6
3		4.70	282.92	280.0	2-11
4		3.20	283.82	280.0	3-9
IP		0.81	280.81		
	2.95	287.76			
5		0.75	284.01	280.0	4-1
6		1.05	283.71	280.0	3-8
7		1.15	284.51	280.0	2-9
8		5.70	282.46	280.0	2-11
9		4.75	282.51	280.0	2-9
10		5.40	282.06	280.0	2-5
	7.29	288.10	280.84		
+10		6.25	281.98	280.0	1-0
+20		0.19	283.8	280.0	2-8
+47.7		0.00	283.88	280.0	4-5

PI plug at 3114 ✓
 End on cut Boulevard

G. Rank

For continuation see page 11

4-10-72

S	I	HS	-	EW	4rd	+
13.11	9.60	190.44		280.84		
+70			2.20	283.04	280.7	+ 2.5
11			4.70	287.74	281.7	+ 4.0
+24			4.70	292.44	287.7	+ 3.0
+20			5.70	298.14	288.0	+ 1.0
+24			2.60	300.74	288.0	+ 3.5
70			0.80	301.54		
	3.20	192.87				
12			1.10	302.67	285.0	6.5
-50			3.40	299.27		
13			3.10	296.17	285.0	
+50			3.20	299.37		
14			4.20	303.57		
15			4.50	308.07		
16			5.40	313.47		
17) IPBM			5.20	318.67		

Abandoned

Abandoned

plus of PI 61172. del 3

Abandoned

For Continuation
See Page 13

S	+	HL	-	EW
Bm	5.40	486.24		480.84
+50			1.20	485.01
+50			3.77	481.24
"			4.98	486.22
+50			2.77	479.97
"			7.84	478.92
TD			8.82	477.42
	4.70	482.12		
+50			9.17	472.95
"			4.65	477.67
+50 TD			11.05	480.07
	6.54	486.60		
"			6.10	482.50
+50			5.71	480.90
"			6.74	479.87
+50			4.98	481.60
"			4.47	484.12
+50 TD			4.85	481.70

Hawkins

L. L. L. L. L.

S	+	Sub	-	EV	Ind	±	± to inches
Bm	5.05	192.62		287.57			
14+0.5 BP			2.97	289.60	285.0	+4.6	4-6
+50			3.20	289.40	285.0	+4.4	4-5
+75			2.60	290.00	285.0	+5.0	5-0
10			2.65	290.17	285.0	+5.17	5-2
+25			3.05	289.57	285.0	+4.57	4-7
+50			3.70	288.92	285.0	+3.9	3-11
+50.1 BP			3.71	288.91	285.0	+3.9	3-11
+61.4 BP			3.80	288.82	285.0	+3.8	3-10
+75			3.88	288.74	285.0	+3.7	3-8
12			3.70	288.92	285.0	+3.9	3-11
+25			2.05	290.57	285.0	+5.57	5-7
+50			3.87	288.75	285.0	+3.7	3-10
+75.1 BP			3.20	289.37	285.0	+4.3	4-4
15			4.47	288.10	285.0	+3.1	3-11
+50			4.40	287.72	285.0	+2.7	2-11
16			5.37	287.20	285.0	+2.2	2-4
+50.1 BP			5.76	286.86	285.0	+1.8	1-11
17			5.76	286.86	285.0	+1.8	1-11
18			5.50	287.12	285.0	+2.1	2-1

Handwritten note: *Handwritten*

(Remarks)

S	+	Stk	-	Est	And	=	± In Inches
		29262					
19			2.90	287.72	285.0	2.7	2-11/2
20			4.80	288.02	285.0	3.0	3-0
		4.07	29259				
+60			4.40	288.19			
+80			3.00	289.59			
21			5.30	288.29	285.16	3.1	3-11/2
22			3.70	288.89	285.26	3.6	3-7"
+60			3.40	289.19			
+75			2.60	289.99			
23			3.28	289.31	285.42	3.9	3-11"
+16.2			3.13	289.46			
+50					285.5		
+60			3.20	289.10			
+80			1.80	290.79			
24			2.80	289.79	285.63	4.1	4-5"
+20			3.60	289.99			
+35			2.70	289.89			
+50			3.90	288.69			
+75			3.90	288.69			
+90			3.50	289.09			

(Cont. Road.)

D	-	HS	-	EW	4rd	=	In Books
		198.59					
75			4.24	486.35	285.3	3.0	3-0
75			4.50	488.89			
7+60			3.50	489.39			
7-60			4.20	487.39			
76			4.78	482.61	285.4	2.7	2-14
75			5.10	487.49			
750			3.60	485.99			
770			4.20	487.39			
77			4.51	482.48	285.6	3.1	3-1
775			3.40	489.19			
+60			4.80	487.79			
78			5.21	482.21			
	4.31	198.59					
78			4.28	487.31	286.0	3.3	3-4
775			3.00	486.59			
+60			4.40	487.19			
79			5.60	485.79	283.0	2.1	2-10
780			5.00	486.59			
+50			2.00	484.59			
80			5.60	485.99	282.0	2.0	4-0

S	+	SB	-	EW	Grade	+	-	Inches
		291.59						
+20			7.90	283.69				
+25			5.90	285.69				
+60			6.90	284.69				
31			7.30	284.79	281.0	3.3	2-4	
+45			8.00	283.59				
+45			7.80	283.79				
+60			6.80	284.79				
+75			8.80	284.79				
32			7.30	284.79	280.2	4.3	2-4	
+40			9.50	282.09				
+40			8.40	283.19				
+60			10.60	280.99				
33			9.20	282.79	279.0	3.3	2-4	
+10			10.90	280.59				
+45			9.90	281.65				
TD			11.51	280.08				
		231 227.39						
24			3.50	278.89				
+20			7.20	274.99				

Abandoned

cut Road

D	+	HB	—	RW
		287.29		
+30			15.00	267.29
+40			10.60	271.79
+60			6.00	276.29
+95			3.00	279.29
35			2.50	279.89
+5			3.40	278.99
+35			3.40	278.99
+50			2.30	280.09
36			3.91	278.48
+50			5.80	276.59
+75			4.60	277.79
37 IP			5.81	276.58
BMI (8)	8.20	284.39		276.09
+35			2.60	276.79
+50			7.00	277.29
+75			8.20	276.19
38			8.20	276.19
+30			7.90	276.49
+90 PI			9.40	274.99

Aut Road

2.21

Aut Road

D	+	HB	-	EW
		286.39		
39			10.25	276.14
TR			11.72	272.67
	5122	278.39		
40			7.80	270.59
40				268.9
41			8.80	269.59
42			6.60	271.99
43			7.00	271.39
44			5.10	273.79
44			5.40	277.99
46			7.00	271.39
48			9.65	269.74
		271.98		
45			2.70	269.28
45			2.70	268.28
46			4.10	267.88
45			2.20	268.68
47			6.40	265.58
48			7.60	264.38
48			8.90	263.08

Along Douglass St. Int. P.C.B.

19

11/13/18

D	+	JHS	-	EW	
		271.98			
+45	77		6.60	268.28	
	6.77	270.17			
+760	PI		8.25	261.92	
49			7.20	254.72	
+20			7.1	247.62	
+40			5.20	242.42	
+60			5.40	237.02	
+75			4.20	232.82	
50			4.20	228.62	
+10			5.40	223.22	
+20			3.80	219.42	
+50			4.80	214.62	
100			3.10	211.52	
51			4.10	207.42	
+45			4.10	203.32	
52			3.50	199.82	
+27	PI		2.65	197.17	
650			2.42	194.75	
50	v		4.00	190.75	262.0

Along Dove St

Leut Road

Along Washington St

42

43

1/2/55

Δ	+	HS	-	EW	
		270.7			
705			3.10	267.27	
750	✓		4.70	265.47	
57	✓		5.40	264.77	262.0
710	✓		4.70	265.47	
725	✓		6.10	264.07	
775	✓		5.60	264.57	
55	✓		5.70	263.47	262.0
Brig	5.70	273.95		269.25	
709 PI			9.60	264.35	
56			8.40	265.95	
715			8.60	265.35	
720			8.10	265.85	
750			9.60	264.35	
770			8.20	265.65	
57			9.40	263.55	
715			9.50	264.45	
725			11.20	262.75	
775			9.80	264.15	
58			10.50	263.65	262.0

2.8 2.9

1.5 1.6

See page 39 for Continuation

Along Eagle St

1/13/88

Δ	+	HB	-	EV		
		270.53				
+40	✓		5.60	467.90		
+45	✓		4.50	468.90		
65	✓		4.90	468.60	264.3	4.3
+40	✓		3.60	469.90		4.4
66	✓		4.40	469.80	265.0	4.3
67	✓		5.20	468.40	265.4	2.8
+50	✓		5.60	467.90		
+75	✓		4.60	468.90		
68	✓		5.90	467.60	265.8	1.8
+50	✓		5.70	467.80		1.9
+75	✓		4.80	468.70		
69	✓		5.40	468.30	266.2	2.1
70	✓		3.80	469.70	266.6	3.1
TD			3.00	470.50		
	5.79	273.22				
+35	✓		4.80	471.50		
71	✓		4.80	471.50	267.0	4.5
72	✓		4.80	471.50	267.0	5.3
+75	✓		4.70	471.60		5.4

A	+	MS	-	SH			
		276.54					
+90	✓		7.50	168.82			cut Road
93	✓		7.70	168.62	267.0	1.6	1.7
+80	✓		7.10	169.22			
+75	✓		5.70	170.62			
74	✓		6.50	170.82	267.0	3.8	3.9
+75	✓		4.50	171.52			
+60	✓		4.80	171.52			
75	✓		4.20	171.72	268.7	3.0	3.0
+90.5	✓		2.40	172.92			
76	✓		2.20	174.12	270.3	5.8	3.9
78			2.45	173.52			
		5.80	179.40				
Bm (0)		4.60	179.06		274.46		
77	✓		2.15	176.91	272.0	4.9	4.11
78	✓		5.10	172.16	270.3	2.9	2.11
+75	✓		8.10	170.96			cut cut Road
79	✓		8.30	170.76	268.7	2.1	2.1
+60	✓		8.00	171.06			
80	✓		9.40	169.66	267.0	2.7	2.8

Δ	+	NS	-	EW		
		179.06				
TP			9.31	469.75		
	5.19	475.64				
+50	✓		5.11	470.54		
-41	✓		6.10	469.49		
+60	✓		5.60	470.44		
51	✓		6.50	469.44	267.25	2.9 2.11
+50	✓		4.60	471.44		
52	✓		4.20	471.44	267.30	3.9 3.11
80	✓		7.00	468.44	267.75	0.9 1.1
+50	✓		8.00	467.44		
54	✓		6.20	469.34	266.0	3.3 3.4
85	✓		1.20	474.34	267.55	6.8 6.9 1/2
TP			11.00	474.44		
	6.55	481.19				
+20	✓		6.50	474.79		
+75	✓		6.30	474.89		
56	✓		6.90	474.79	269.11	5.2 5.2
57	✓		6.10	474.99	270.67	4.3 4.4
+50	✓		5.90	475.79		
58	✓		8.00	477.39	272.22	5.2 5.2

East Road

A	+	Stb	—	Elk	Prds		
		201.19					
+50	✓		2.90	478.49	273.0	5.3	5.4
TP			3.15	478.07			
		0.78	276.5				
89	✓		1.70	477.15	272.28	4.9	4.11
90	✓		2.50	476.35	270.86	5.5	5.6
+50	✓		3.20	475.55			
91	✓		5.20	473.65	269.43	4.2	4.2
+50	✓		6.70	472.15			
92	✓		6.60	472.25	268.0	4.25	4.3
+50	✓		6.20	474.65			
93	✓		7.80	471.05	268.8	2.25	2.3
+50	✓		8.20	470.65			
94	✓		6.60	472.45	269.0	2.65	2.8
+50	✓		5.10	473.85			
+50	✓		4.10	474.65	270.0	4.45	4.6
95	✓		4.80	474.05	269.28	4.8	4.9
+50	✓		4.70	474.15			
96	✓		5.40	475.65	267.86	7.6	7.7
+50	✓		2.20	476.55			
TP			2.71	476.15			

cut Road

Δ	+	HS	-	EW		
TP				276.14		
	0.90	277.07				
BM	5.45	276.59		271.14		
97 Δ			2.25	274.64	266.43	8.2
+50 \checkmark			5.80	271.09		
98 \checkmark			8.40	268.49	265.0	3.5
+25 \checkmark			9.20	267.59		
+50 \checkmark			8.40	268.49		
99 \checkmark			6.20	270.69	264.8	5.9
+50 Δ \checkmark			5.50	271.29	264.7	6.7
100 \checkmark			6.60	270.29	264.6	5.7
+50 \checkmark			7.90	268.99		
101 \checkmark			7.70	269.19	264.4	4.9
+75 \checkmark			5.90	270.99		
102 \checkmark			7.80	269.09	264.2	4.9
TP			7.00	269.89		
	5.90	275.79				
+20 \checkmark			6.60	269.19		
+50 \checkmark			8.20	267.49		
75 \checkmark			10.00	265.79		

Leut Road

	+	MB		EM
		275.79		
103	✓		9.60	✓66.19 264.0
+20	✓		10.20	✓65.49
+75	✓		9.40	✓66.39
104	✓		9.20	✓66.69 263.67
+50	✓		8.90	✓66.57
+70	✓		7.80	✓69.99
105	✓		7.90	✓67.59 263.33
+50			7.00	✓68.79
+85			6.50	✓69.29
106			7.80	✓69.99
+25			6.70	✓69.09
+50			8.50	✓69.29
107			8.60	✓69.19
108			9.70	✓66.09
+50			10.10	✓65.49
109			9.00	✓66.79 262.0
Bm(2)	3.70	270.75		✓67.05
+50			3.60	✓67.15
110			5.10	✓65.65
+60			6.90	✓65.85

+ 2.2 2.2³

+ 3.0 3.0

+ 4.6 4.7

From stores use other part.

Ant Road

Δ	+	HB	—	EW
		270.75		
111			6.50	764.45
+50			5.80	764.95
112 Δ			5.30	765.45
113			6.30	764.45
+70			5.90	764.85
114			6.70	764.05
+50			6.10	764.60
115			5.60	765.15
+75			5.20	765.55
TD			5.00	765.75
	9.60	775.35		
+40			9.70	765.65
+60			9.40	765.95
116			9.10	766.45
+40			7.40	767.95
+50			8.60	766.75
+75			7.10	768.45
117 Δ			7.20	768.15

d	+	NB	-	EW
		275.35		
+50			7.60	267.75
118			6.00	269.35
+95			6.70	268.65
+50			5.20	270.15
+70			4.70	270.65
119			5.80	269.55
<u>271/100</u>	1.49	270.65		269.16
+70			1.40	269.45
170			0.10	270.55
+15			1.90	268.75
141			4.50	268.15
+40			2.90	267.75
+60			1.80	268.85
+85			2.80	266.75
122.5			3.60	267.05
+15			3.20	267.45
+20			4.90	265.75
+70			5.20	265.45
120			7.70	267.95

A	+	KB	-	EW
		270.65		
+50			9.90	460.75
124			11.10	459.65
+10			10.40	460.05
+35			11.70	458.35
TP			12.80	459.55
	2.15	464.07		
+65			1.50	462.57
145			11.14	459.77
+50			7.50	454.77
TP			11.20	450.77
	4.15	454.95		
+75			3.60	449.05
146			5.60	447.05
+122			7.20	445.95
+20			7.70	445.25
+80			11.50	441.95
127			10.50	442.45
+50			5.60	447.05
TP			11.50	451.95

Δ	+	Sub	-	EW
TP				254.95
	10.80	464.75		
+80			11.2	454.55
145			6.00	456.75
+25			1.10	461.65
TP			1.21	461.54
	2.09	465.63		
134.50			3.59	464.74
			4.90	466.70
144.80	100 E			433.5
" "	180 E			432.8

in plug

Δ	+	SB	-	EW	hd	\pm	in inches
BML	5.09	486.70		280.04			PI at arrival (See page 10)
10.00			2.90	483.80	280.0	+3.8	3-10
+50	✓		5.00	481.70	280.0	+1.7	1-8
11	✓		2.30	484.40	280.0	+4.4	1-5
+50	✓		5.00	481.40	280.0	+1.4	1-5
12	✓		6.70	480.00	280.0	+0.0	0-0
+50	✓		7.00	479.70	280.0	-0.8	-0-10
13	✓		7.62	479.11	280.0	-0.9	-0-11
+50	✓		7.10	479.60	280.0	-0.6	-0-5
14	✓		5.44	481.29	280.0	+1.3	+1-4
+50	✓		4.92	481.90	280.0	+1.9	+2.0
15	✓		5.00	481.40	280.0	+1.4	+1.5
+50	✓		5.02	481.38	280.0	+1.4	1-5
16	✓		4.90	481.50	280.0	+1.5	1-10
+50	✓		5.00	481.40	280.0	+1.4	1-5
TP			5.48	481.40			
	6.50	487.70					
+50	✓		6.00	481.70	280.0	+1.8	1-10
17	✓		6.60	481.10	280.0	+1.1	1-8
+50	✓		7.00	479.90	280.0	+0.0	0-0
18	✓		7.40	480.50	280.0	+0.5	0-5

Δ	+	HB	-	RH	hd		
		287.78					
+35	✓		6.20	281.28	280.0	1.5	
+50	✓		6.35	281.63	280.0	1.6	1-5
+75	✓		6.40	281.88	280.0	1.6	
19	✓		7.10	280.68	280.0	0.9	0-8
+35	✓		8.80	278.98	280.0	-1.0	-1-0
+50	✓		8.02	279.78	280.0	-0.2	-0-2
+70	✓		4.90	282.88	280.0	2.8	2-11
90	✓		4.40	283.28	280.0	3.2	3-5
105	✓		4.50	283.48			
+35	✓		2.80	284.98			
+50	✓		2.40	285.38	281.16	4.2	4-2
TP			0.79	286.99			
		7.40	291.19				
21	✓		5.25	288.74	282.22	6.5	6-5
+50	✓		4.90	289.20	283.48	5.7	5-10
26	✓		4.20	289.89	284.62	5.3	5-4
+50	✓		3.10	290.49	285.80	4.7	5-2
30	✓		5.00	289.19	287.0	2.2	2-2
+20	✓		5.10	289.29			

D	+	MS	—	EM			
		292.19					
+50	✓		3.60	490.59	286.75	3.84	3.10 2
+75	✓		5.1	489.09	285		
44	✓		4.5	489.69	286.50	3.2	3.2 2
+50	✓		5.6	488.59	286.25	2.4	2.5
25	✓		6.1	488.09	286.00	2.1	2.1 4
+55	✓		5.9	488.29			
+50	✓		5.2	489.59	285.75	2.9	2.11
26	✓		6.2	487.47	285.50	2.0	2.0
		3.08	29085				
+25	✓		2.5	487.35			
+50	✓		2.4	488.75	285.25	3.5	3.6
27	✓		2.2	487.65	285.00	2.7	2.8 2
+40	✓		2.7	488.15			
+50	✓		2.2	487.65	284.4	3.3	3.4
28	✓		2.0	486.85	283.8	3.1	3.2
+50	✓		2.0	485.85	283.3	2.3	2.4
+65	✓		2.4	487.45			
29	✓		2.9	485.95	282.7	3.3	3.4
+45	✓		6.00	484.05			
-50	✓		6.2	484.65	282.1	2.6	2.8

16486.2
 13.20
 30.06

Δ	+	HL	-	EW
---	---	----	---	----

290.55

+80	✓		7.20	480.55
20	✓		6.7	484.15 281.5
+20	✓		5.7	485.15
+50	✓		6.5	484.00 280.9
01	✓		6.9	480.95 280.3
-15	✓		6.5	484.35
+50	✓		7.9	481.95 279.7
27			7.70	480.15

2.4 480.49

+75	✓		2.00	481.29
24	✓		2.10	480.19 279.2
+20	✓		3.80	481.49
+50	✓		4.20	480.99 278.6
+70	✓		4.50	480.79
33	✓		2.20	482.09 278.00
+50	✓		4.80	480.49
+50	✓		5.70	479.59 277.2
+90	✓		8.50	477.29
24	✓		11.80	470.49
TP			10.24	478.90

27	29
32	32
37	39
33	34

Red Road

Forest

Δ	+	MB	—	EW	
TP	slaf	150.24		274.90	} Freatti
+10	✓		11.50	168.44	
+15	✓		15.00	165.74	
+20	✓		11.00	162.74	
+35	✓		5.40	175.34	
+50	✓		3.10	177.64	
+64	✓		1.00	179.14	
36 TP			2.29	178.85	

on plug.

Levels from 264+2

Sta						
Sta 8	10.20	286.29		276.09		m/plus
34+64?		7.08		279.21	275.3	3 9 3.11
35	✓	6.5		279.8	274.7	5 1 5.1
+50	✓	8.9		277.4		
36	✓	9.9		276.4	273.0	3 4 3.5
+25	✓	8.6		277.7		
+40	✓	9.7		276.6		
37	✓	8.9		277.4	271.3	6 1 6.1
37.0	✓	10.1		276.2		

Pln	B.S.	Hgt	Sub	T.S.	Res		
37+35	✓	286.29	9.4		276.9		
+50	✓		10.4		275.9		
38	✓		11.1		275.2	269.7	5.5 5.6
+25	✓ 4.01	279.10		11.20	275.09	268.8	6.3 6.4
39	✓		6.5		272.6	268.0	4.6 4.8
+50	✓		9.3		269.8	268.0	
+70	✓		8.4		270.7		
40	✓		10.3		268.8	268.0	0.8 0.9
+40	✓		9.1		270.0		
+70	✓		6.6		272.5		
41	✓		6.9		272.2	268.0	4.2 4.3
+20	✓		5.6		273.5		
42	✓		6.4		272.7	268.00	4.7 4.9
43	✓		9.9		269.2	266.7	2.5 2.6
44	✓		10.7		268.4	265.3	3.1 3.1
+40	✓		10.0		269.1		
45	✓		10.3		268.8	264.0	4.8 4.9
+50	✓		10.9		268.2		
T.P.	✓ 4.27	270.20		11.27	267.83		
46	✓		3.8		266.4	262.7	3.7 3.8

45+40 on rock

Sta	F.S.	Hgt	Int.	F.S.	Red. lev.
46+30	✓	270.20	4.2		266.0
+45	✓		6.1		264.1
47	✓		6.9		263.3 261.3
48	✓		7.7		262.5 260.00
+11.6	✓		7.9		262.3 260.1
T.P.	4.0 ✓	267.39		6.83	263.37
+45	✓	267.39	3.9		263.49
+60	✓		4.1		263.29
49	✓		4.3		265.09 260.7
	4.16	269.55		2.00	265.39
+25	✓		3.6		266.0
+50	✓		4.8		264.8
+70	✓		3.3		266.3
50	✓		4.0		265.6 261.3
+25	✓		2.3		267.3
+50	✓		4.3		265.3
51	✓		3.6		266.0 262.00
+65.2	3.70	271.15		2.1	267.45 262.0

to 55 See page 19 for Contin-

2.0 2.0
2.5 2.6
2.2 2.3

4.4 4.5

4.3 4.4

4.0 4.0

5.5 5.6

Road

= 52 + 26.1

55+12	271.15	6.5	264.7	262.00
56		5.3	265.9	262.00
+40		5.3	265.9	
+50		6.5	264.7	
+70		5.3	265.9	
57		7.5	263.7	262.00
58		7.4	263.8	262.00
+61.8		6.15	265.0	262.3

see page 21 for sta 59

27	2.9
----	-----

39	3.11
----	------

1.7	1.8
-----	-----

1.8	1.9
-----	-----

2.7	2.8
-----	-----

= 58 + 59

BM 14	1.22			266.71
	2.73	267.93	7.93	260.00
	0.31	262.73	11.17	251.62
128		251.93	5.5	246.4
129			11.0	240.9
130			11.0	240.9
+50			7.8	244.1
131	2.02	196		249.97
+63.4		251.99	2.9	249.0
132			6.4	245.6
133				233.9
+39.5				225.1
+60				218.9
134				205.4
+25				196.0

134+50 def L. 27°36'
 142+45 " R 57°09' 426.5 ft N
 cor. of Pump house

	NS	EW	BM
	7.27 292.50		
TP	5.28 299.71	1.10 291.48	
TP	9.57 306.88	2.70 297.01	
BM		1.76 305.12	
TP	10.84 315.61	1.61 305.27	
TP	11.76 327.18	0.19 315.42	
TP	12.75 339.00	0.65 326.55	
TP BM	3.20 341.65	0.85 338.40	347.57
BM		5.77 335.81	345.00
BM		4.44	346.33

no plug,

Sp. in next hole

Highest Pt.

11 W for Lamp post - Van Buren Ave on plug
 11 SE for " " " " " " " " " " " "

A.	+	Stk	-	Flw.	Bin
					280.54
	10.67	291.51			
TP			3.30	288.21	
	4.85	292.66			
TP			8.95	283.71	
	3.83	287.54			
TP BM (1)			11.45	276.09	
	2.23	278.32			
TP			9.88	268.44	
	1.65	270.09			
TP BM (2)			1.87	268.27	
	3.24	272.12			
TP			4.43	267.70	
	7.26	275.69			
TP BM (3)			1.20	274.46	
	6.15	280.61			
TP			3.07	277.54	
	2.10	278.37			
TP BM (4)			6.90	271.44	
	11.35	282.79			
		286.65	4.85	277.90	

PI plug at 611472

Spine ground about 100' E of Stake ^{marked II cut in stake} Sp. surrounded by 4 large rock X on each rock

Top of stake NE for Wash. Ball 8 1/2

611. Set to SE near Road. on plug

near Road on plug small nucleus stake

Δ	+	Sub	-	LH	BM
		272.79			
Bm(7) TP			5.72	✓67.05	
	3.43	✓70.42			
Bm(6) TP			1.82	✓69.16	
	2.71	✓71.87			
Bm(5)			5.0	✓66.71	

on highest point. Knoll

S	IK	IK	IK	IK	IK
BMU				338.25	342.5
	0.61	339.06		341.11	
TP			11.04	347.72	356.14
	3.27	330.97		340.09	
TP			11.09	319.88	349.00
	3.54	323.42		324.24	
TP			11.05	311.74	340.86
	4.95	310.69		344.81	
TP			11.88	301.81	319.90
	11.16	302.95		314.07	
BM(6)			6.95	494.00	305.14 305.12
	0.99	496.99		306.11	
BM(5) 2			9.70	487.24	496.24
	1.95	489.44		498.36	
BM(4) 2			9.64	479.62	488.94
	3.07	482.90		494.44	
BM(5)			7.20	475.71	477.80

Highest pt

Sp in West pole

E 90° West

plug in lpr. near R. 18

S	+	NS	-	EH	BM
B.M. 10					347.57
	0.61	348.18			
TP			11.24	336.94	
	3.25	340.09			
			11.09	329.00	
	3.24	334.54			
			11.27	340.86	
	11.95	342.81			
			11.88	310.93	
	11.4	314.07			
B.M. 11			6.75	305.10	
	1.79	306.11			
3			9.70	196.51	
	11.95	198.06			
4			9.65	188.74	
	3.27	192.11			
5			7.28	184.80	284.72

Reduct pt. University Heights

amt BM

Q		MS	—	EN	BM
BM (6)					280.00
	9.72	290.56			
TP			4.73	285.83	
	2.70	291.53			
TP (7) BM			4.68	286.85	
	0.58	287.43			
BM (8) TP			12.00	275.40	276.09
	1.80	277.59			
TP			14.10	266.79	
	2.59	269.38			
BM (9) TP			4.15	268.43	268.24
	4.02	272.45			
TP			4.05	270.69	
	6.21	276.90			
BM (10) TP			2.41	274.49	274.46
	5.45	279.94			
TP			2.50	277.53	
	4.26	278.59			
BM (11)			2.08	275.56	271.44
	0.91	274.35			

PT at 6:15 PM

Sp in 41.

in 15 large stakes and 4 large stakes

✓ Top of stake NE 1/4. Mark road near Road

S 1/2 Sec 16. in piny near Road

in piny near Road

Re Running Bunches

<u>S</u>	<u>+</u>	<u>MB</u>	<u>-</u>	<u>EW</u>	<u>BM</u>
		272.35			
Bm(14)	5.29			467.06	467.25
	3.37	270.37			
Bm(15)	4.23			469.14	469.16
	4.42	471.56			
Bm(16)	4.39			466.67	466.71

plug in or near Road

limit pts

(Benches)

B.M. E.W.

- 1 347.57 Highest pt. N. side St. to.
- ✓ 305.12 Sp. in Elect. pole
- 3 296.41 " " " "
- 4 288.74 " " " "
- 5 284.70 Plug in gr. near R.R.
- 6 280.84 P.I. at 611.72
- 7 286.85 Sp. in gr.
- 8 276.09 " " " about 100' E of stake
- 9 268.22 Top of stake marked
- ✓ 10 274.46 " " plug SE for Lat. 6.
- 11 271.44 " " " near road
- 12 267.05
- 13 269.16
- 14 266.71
- B.M. 306.78
- B.M.A 351.09

with II cut on it and surrounded with
NE for March and Fall ^{4 stones} ~~St.~~

on Highest pt near Old Town

Cor. Block 190, R. of Sta 20+50

nail in side of Water Tank Municipality Heights

12.91 4 4.25

10000
810
1500
1275
2250
2125

BN
1
2
3
4
5
6
7
8
9
10
11
12
13
14
BN
BN

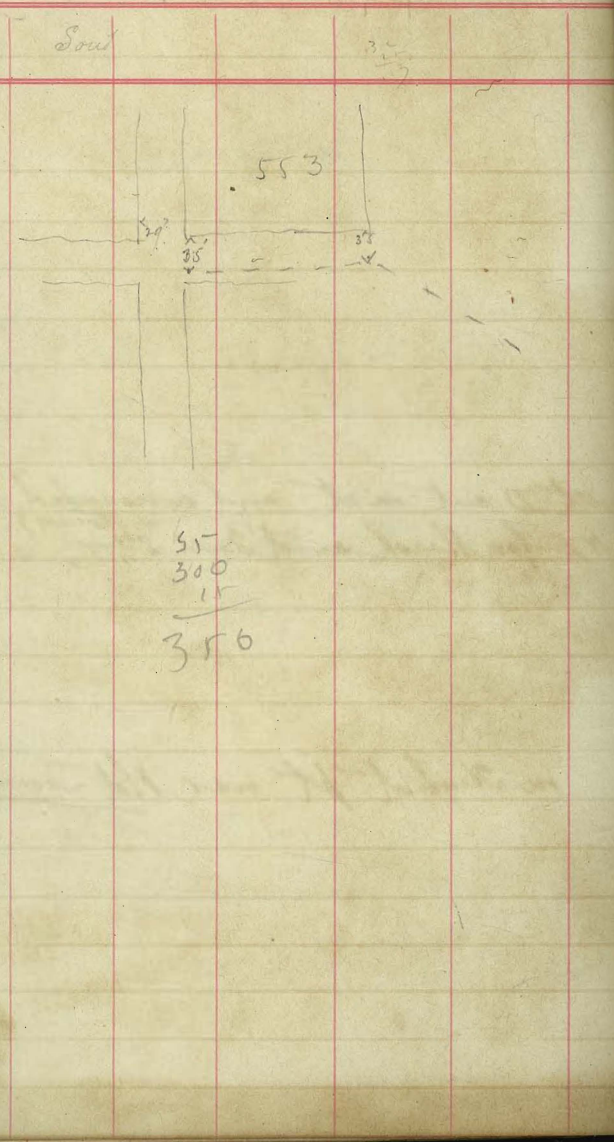

276.50
9.47
269.86
2.62
271.98
5.20
266.78 = 40

250.77
0.6
251.07 = 48
7.90
243.47 at 100
10.70
252.77 at 150
931.27

276.04
276
278.85 = 119
2.80
275.15
4.7
270.1
8.2
270.6
9.9
268.9
20.2
269.6
6.7
272.1
5.9
272.9
7.00
271.00

9.999987

9.999987
2.969090
21.969077
43
471340

Return to City Engineers Office
City Hall, San Diego, Cal.

Return to City Engineers Office
City Hall, San Diego, Cal.
TRAVERSE TABLE FOR TRANSIT BOOK,
From 1° to 90° for a distance of 100.

Degrees.	DEGREES.		¼ DEGREE.		½ DEGREE.		¾ DEGREE.		Degrees.
	Lat.	Dep.	Lat.	Dep.	Lat.	Dep.	Lat.	Dep.	
0			100.00	0.44	100.00	0.87	99.99	1.81	85
1	99.98	1.75	99.98	2.18	99.97	2.62	99.95	3.05	84
2	99.94	3.49	99.92	3.93	99.91	4.36	99.88	4.80	83
3	99.86	5.23	99.84	5.67	99.81	6.10	99.79	6.54	82
4	99.76	6.98	99.73	7.41	99.69	7.85	99.66	8.28	81
5	99.62	8.72	99.58	9.15	99.54	9.58	99.50	10.02	80
6	99.45	10.45	99.41	10.89	99.36	11.32	99.31	11.75	79
7	99.25	12.19	99.20	12.62	99.14	13.05	99.09	13.49	78
8	99.03	13.92	98.97	14.35	98.90	14.78	98.84	15.21	77
9	98.77	15.64	98.70	16.07	98.63	16.50	98.56	16.93	76
10	98.48	17.36	98.40	17.79	98.33	18.22	98.25	18.65	75
11	98.16	19.08	98.08	19.51	97.99	19.94	97.90	20.36	74
12	97.81	20.79	97.72	21.22	97.63	21.64	97.53	22.07	73
13	97.44	22.50	97.34	22.92	97.24	23.34	97.13	23.77	72
14	97.03	24.19	96.92	24.62	96.81	25.04	96.70	25.46	71
15	96.59	25.88	96.48	26.30	96.36	26.72	96.25	27.14	70
16	96.13	27.56	96.00	27.98	95.88	28.40	95.76	28.82	69
17	95.63	29.24	95.50	29.65	95.37	30.07	95.24	30.49	68
18	95.11	30.90	94.97	31.32	94.83	31.73	94.69	32.14	67
19	94.55	32.56	94.41	32.97	94.26	33.38	94.12	33.79	7
20	93.97	34.20	93.82	34.61	93.67	35.02	93.51	35.43	66
21	93.36	35.84	93.20	36.24	93.04	36.65	92.88	37.06	65
22	92.72	37.46	92.55	37.86	92.39	38.27	92.22	38.67	64
23	92.05	39.07	91.88	39.47	91.71	39.87	91.53	40.27	63
24	91.35	40.67	91.18	41.07	91.00	41.47	90.81	41.87	62
25	90.63	42.26	90.45	42.66	90.26	43.05	90.07	43.44	61
26	89.88	43.84	89.69	44.23	89.49	44.62	89.30	45.01	60
27	89.10	45.40	88.90	45.79	88.70	46.17	88.50	46.56	59
28	88.29	46.95	88.09	47.33	87.88	47.72	87.67	48.10	58
29	87.46	48.48	87.25	48.86	87.04	49.24	86.82	49.62	57
30	86.60	50.00	86.38	50.38	86.16	50.75	85.94	51.13	56
31	85.72	51.50	85.49	51.88	85.26	52.25	85.04	52.62	55
32	84.80	52.99	84.57	53.36	84.34	53.73	84.10	54.10	54
33	83.87	54.46	83.63	54.83	83.39	55.19	83.15	55.56	53
34	82.90	55.92	82.66	56.28	82.41	56.64	82.16	57.00	52
35	81.92	57.36	81.66	57.71	81.41	58.07	81.16	58.42	51
36	80.90	58.78	80.64	59.13	80.39	59.48	80.13	59.83	50
37	79.86	60.18	79.60	60.53	79.34	60.88	79.07	61.22	49
38	78.80	61.57	78.53	61.91	78.26	62.25	77.99	62.59	48
39	77.71	62.93	77.44	63.27	77.16	63.61	76.88	63.94	47
40	76.60	64.28	76.32	64.61	76.04	64.94	75.76	65.28	46
41	75.47	65.61	75.18	65.93	74.90	66.26	74.61	66.59	45
42	74.31	66.91	74.02	67.24	73.73	67.56	73.43	67.88	44
43	73.14	68.20	72.84	68.52	72.54	68.84	72.24	69.15	43
44	71.93	69.47	71.63	69.78	71.33	70.09	71.02	70.40	42
45	70.71	70.71							41
Degrees.	DEGREES.		¼ DEGREE.		½ DEGREE.		¾ DEGREE.		Degrees.
	Dep.	Lat.	Dep.	Lat.	Dep.	Lat.	Dep.	Lat.	

Published by Edward Denny & Co., Stationers, Drawing Materials,
Mathematical Instruments, Etc., San Francisco.