

City of San Diego Commission for Arts and Culture

PUBLIC ART COMMITTEE

AGENDA

Hyperlink to attend the meeting at its scheduled time available [here](#)

Friday, February 4, 2022

9:30 a.m. – 11:30 a.m.

9:30 a.m.	I.	Call to Order	Vernon Franck, Chair
9:35 a.m.	II.	Non-agenda Public Comment	
9:45 a.m.	III.	Chair's Reports	
		A. Commission Business	
		B. ACTION – December 8, 2021 Minutes	
		C. Other Reports	
10:00 a.m.	IV.	ACTION – Final Artwork Proposal for Mira Mesa Community Park by Kate Clark	Charles G. Miller, Senior Public Art Manager
11:00 a.m.	V.	Reports	Christine E. Jones, Chief of Civic Art Strategies
		A. Staff Reports	
		B. Committee Member Reports	
11:30 a.m.	VI.	Adjourn	

Meeting will be live and recorded. PUBLIC COMMENT: Any member of the public may address the Committee on any subject in its area of responsibility on any matter not presently pending or previously discussed at the Committee. Pursuant to the provisions California Executive Order 29-20, Committee meetings will be held via teleconference until further notice. In lieu of in-person attendance, members of the public may submit their comments via a public comment [webform](#), or they may join the meeting as a “webinar attendee” at the link provided in the [Commission or Committee meeting website](#). For members of the public wishing to address the Committee under Public Comment via the [webform](#) prior to the meeting, instructions for word limitations and deadlines will be noted on the [webform](#). Pursuant to open meeting laws, no discussion or action, other than a referral, shall be taken by the Committee on any issue brought forth under non-agenda public comment. As required by the Americans with Disabilities Act (ADA), requests for agenda information to be made available in alternative formats, and any requests for disability-related modifications or accommodations required to facilitate meeting participation, including requests for alternatives to observing meetings and offering public comment as noted above, may be made by contacting the City Clerk at (619) 533-4000 or <mailto:cityclerk@sandiego.gov>. The City is committed to resolving accessibility requests swiftly in order to maximize accessibility.



City of San Diego Commission for Arts and Culture

PUBLIC ART COMMITTEE (PAC)

MINUTES

Wednesday, December 8, 2021

Members Present

Jason Whooper, Chair
Linda Caballero Sotelo
Anthony Graham
Melinda Guillen
Larry Herzog
Eun Jung Park
Doreen Schonbrun
Tiffany Wai-Ying Beres
Janet Poutré, Ex Officio

Members Absent

Staff Present

Lara Bullock
Christine E. Jones
Charles G. Miller

-
- I. Call to Order | [View Here](#) – Commissioner Jason Whooper called the City of San Diego (City) Commission for Arts and Culture’s Public Art Committee (PAC) to order at 9:38 a.m. via an online meeting platform pursuant to the provisions of California Executive Order 29-20.
- II. Non-agenda Public Comment – None
- III. Chair’s Reports
- A. Commission Business – [View Here](#)
- B. **ACTION** – November 5, 2021 Minutes | [View Here](#) – Commissioner Jason Whooper introduced the item. **Tiffany Wai-Ying Beres made a motion to approve the PAC minutes of November 5, 2021. Larry Herzog seconded the motion. The vote was 8-0-0; the motion passed.**
- Yea: Caballero-Sotelo, Graham, Guillen, Herzog, Park, Schonbrun, Wai-Ying Beres, and Whooper (8)
- Nay: (0)
- Abstention: (0)
- Recusal: (0)
- C. Other Reports – None
- IV. **ACTION**: Artist Selection Panelists for Fire Station 48 Black Mountain Ranch | [View Here](#) – Anthony Graham made a motion to advise the City’s Commission for Arts and Culture to recommend the following panelists for the Fire Station 48 Black Mountain Ranch Public Art Project: Eun Jung Park with Tiffany Wai-Ying Beres as an alternate for the seat of the PAC member, and Jessica McCambly for the seat of the Visual Art/Design Professional, with recommended alternates, in no particular order, to serve as two of the five ad hoc artist selection

panelists. Anthony Graham seconded the motion. The vote was 8-0-0; the motion passed.

Yea: Caballero-Sotelo, Graham, Guillen, Herzog, Park, Schonbrun, Wai-Ying Beres, and Whooper (8)

Nay: (0)

Abstention: (0)

Recusal: (0)

IV. Presentation – Summary of Temporary Projects for the Park Social initiative | [View Here](#)

V. Reports

A. Staff Reports – [View Here](#)

B. Committee Member Reports – None

VI. Adjourn – Commissioner Jason Whooper adjourned the meeting at 10:59 a.m.



Commission for Arts and Culture

STAFF REPORT

DATE ISSUED: February 1, 2022

ATTENTION: Public Art Committee

SUBJECT: Final Artwork Proposal by Kate Clark: Mira Mesa Community Park

REFERENCES: 1) [Commission for Arts and Culture Department Instruction 1.00 – Collection Management Policy for the Civic Art Collection](#)
2) Final Artwork Proposal Package

STAFF CONTACT: Charles G. Miller, Senior Public Art Manager

STAFF RECOMMENDATION:

Recommend to the City of San Diego Commission for Arts and Culture (Commission) that the Executive Director of the Commission accept the final artwork proposal by Kate Clark in fulfillment of the City of San Diego's (City) collecting mission, collection scope and accession criteria as established in Section 5 – Collecting Mission, Section 6 – Scope of the Collection and Section 8.2 – Accession Criteria of the Commission for Arts and Culture Department Instruction 1.00 – *Collection Management Policy for the Civic Art Collection*.

SUMMARY:

Artist Kate Clark was commissioned to design, fabricate and transport permanent, site-specific artwork for the Mira Mesa Community Park Phase II improvements and consult during installation of artwork at the site by the City. The Mira Mesa Community Park Phase II project involves major improvements to the existing park on New Salem Street in Mira Mesa. The improvements include a re-design of the central plaza and new landscaping, a new aquatic center and swimming pool, skate park and playgrounds. Platt Whitelaw Architects is the lead designer for the park improvements. The artist has collaborated closely with Platt Whitelaw Architects.

On July 10, 2020, Clark presented her preliminary artwork idea to the Public Art Committee (PAC) for feedback. PAC also provided feedback on the artist's schematic artwork proposal on December 4, 2020. In addition to PAC's feedback, the final artwork proposal is informed by suggestions from the public, the City's Parks and Recreation Department, and other various City departments.

FISCAL CONSIDERATIONS:

This project is funded by the City as set forth in *City of San Diego Council Policy 900-11 – Inclusion of Public Art in Selected Capital Improvements program Projects*.



Parkeology
Final Proposal: Mira Mesa Community Park Phase II

Lead Artist: Kate Clark
January 31, 2022

Mira Mesa Community Park



Phase II Site Plan

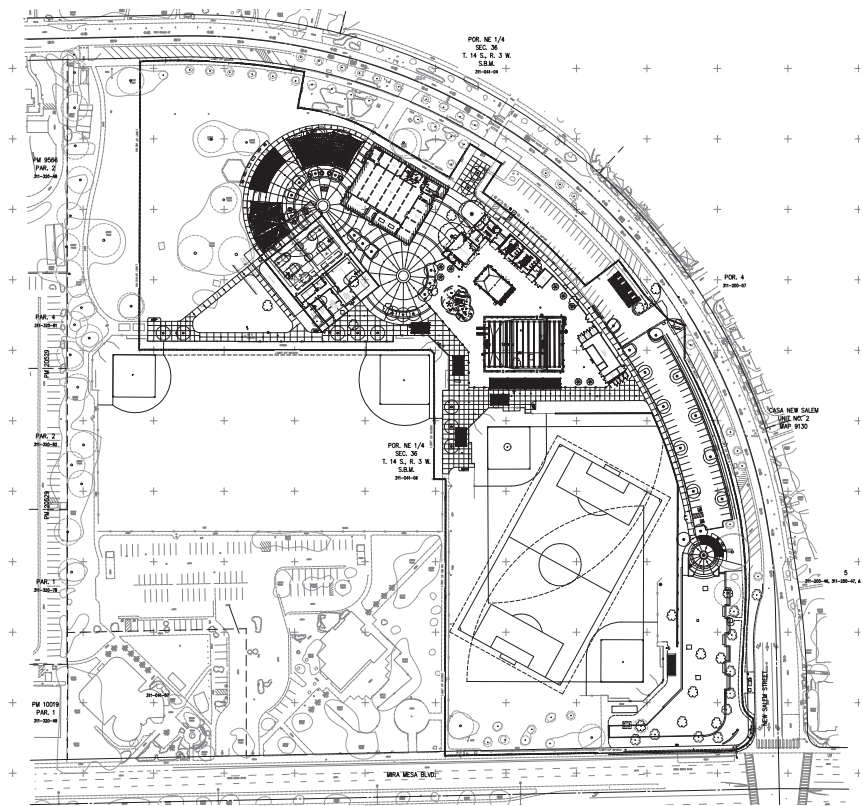

Phase II Site Plan & Original proposed shade structure

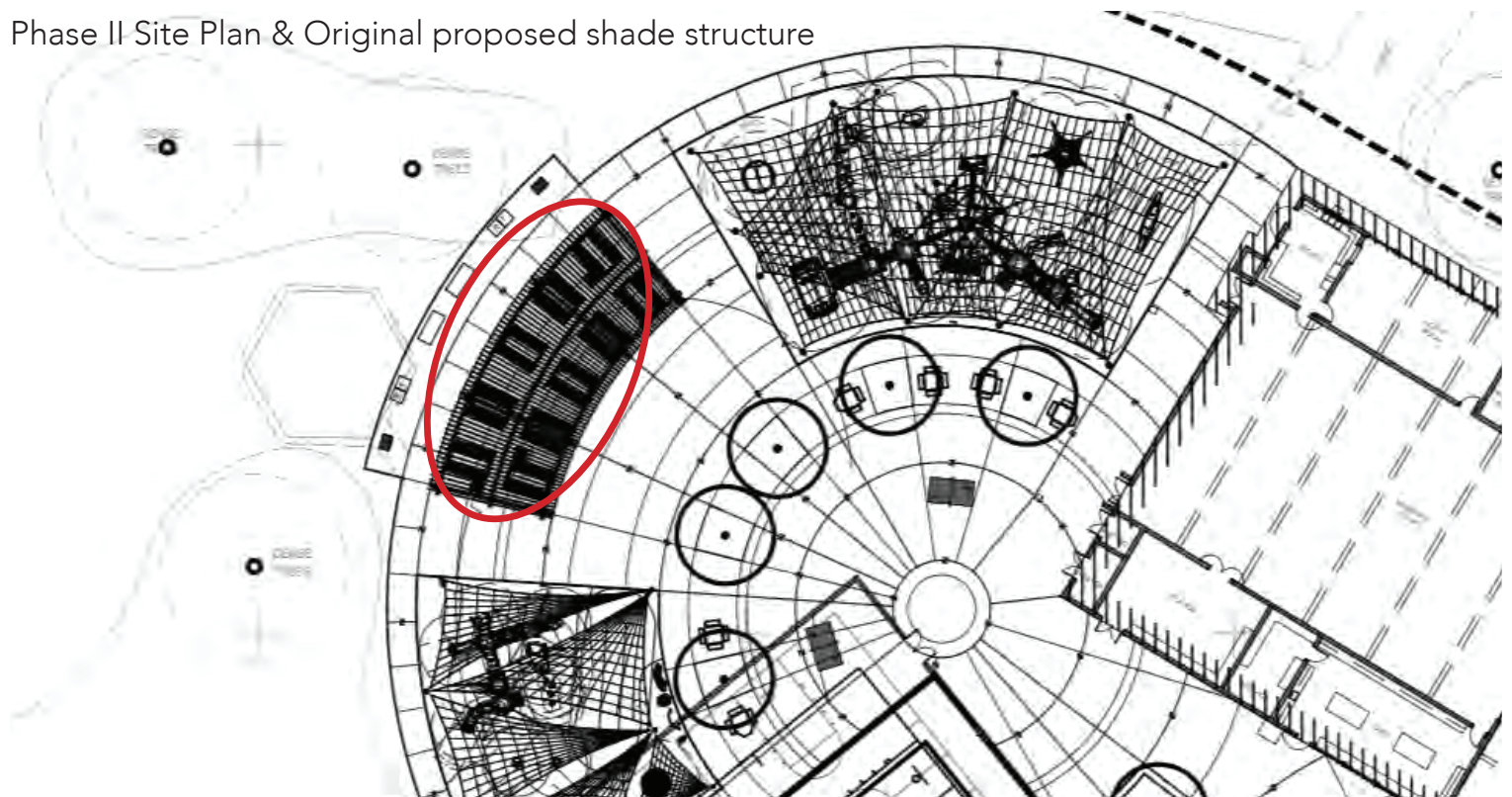

Local research influences: Mira Mesa festival culture



Diwali Mela



Tet



Chinese New Year



Halloween



Fourth of July



Filipino Sun Festival

Local research influences: Tracking seasons and time with festival culture



Chinese Lunisolar calendar

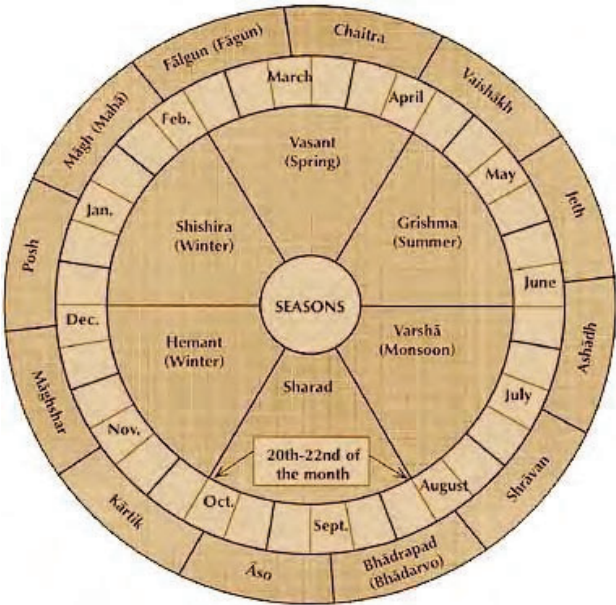

Hindu Lunisolar calendar

The Chinese, Vietnamese, and Hebrew lunisolar calendars track more or less the tropical year, and give an idea of the seasons. Buddhist and Hindu lunisolar calendars track the year based on fixed stars and give an idea of the position among the constellations of the full moon.



Final Shadow Grotto Sketch

Phase II Site Plan & with Shadow Grotto orientation

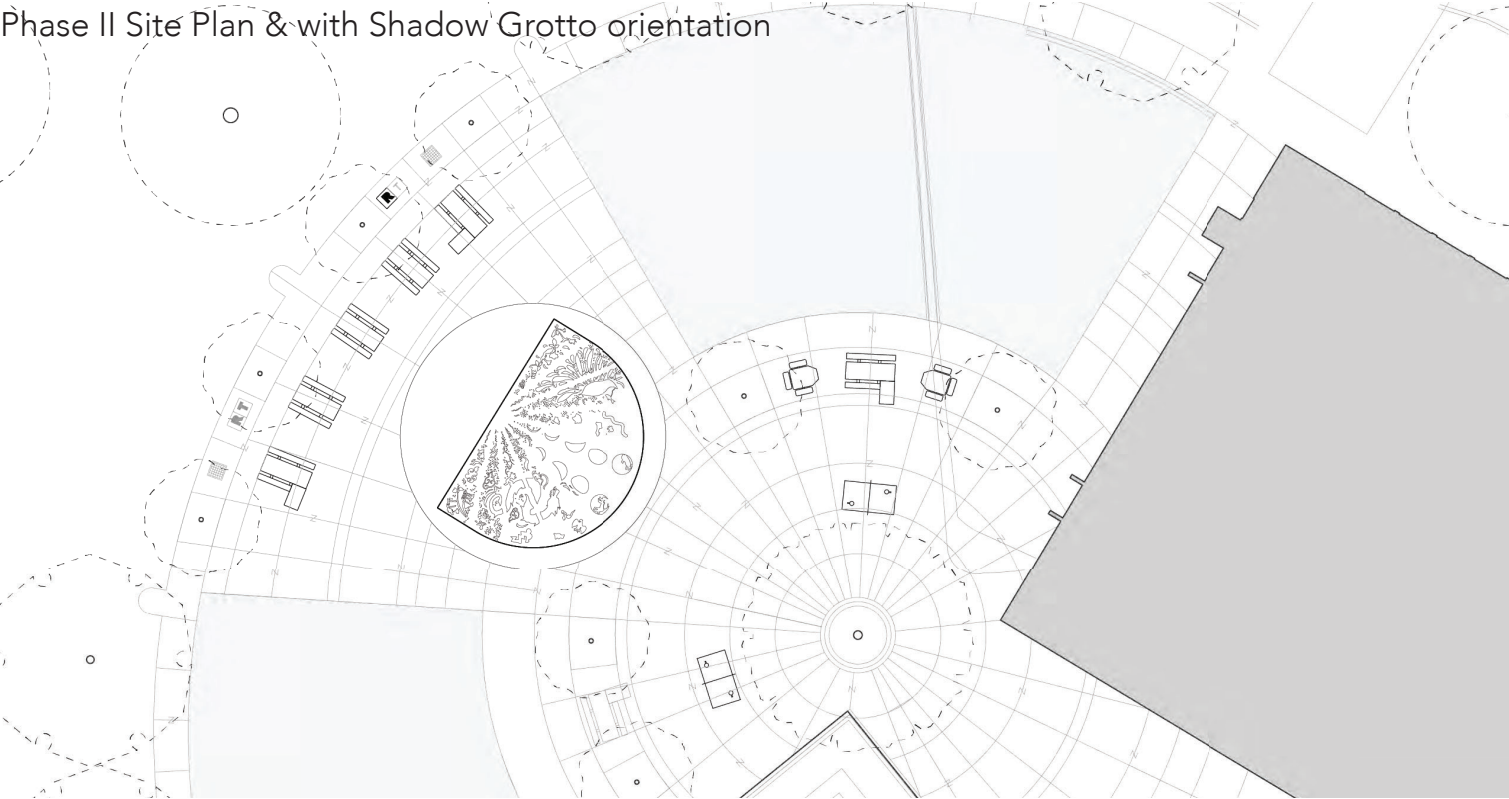

Local research influences: site quality

"The baseball dugouts in the park were the one semi-private place we could go to hang out as teenagers in the park."

"When I was in a Mira Mesa high school dance group, we would take turns to dance under the gazebo so we could have shade."

-Artist, Educator, and Mira Mesa local Rizzhel Javier
June 11, 2020 conversation

Documentation of community and design team input, feedback, and outcomes

Key Public Art Committee recommendations:

Research community uses of the space
Work with a Feng Shui consultant

Results: discussed community uses of park at length with Mira Mesa Rec Center Staff, online research and discussion on Mira Mesa Community Facebook page. Ongoing discussions with Mira Mesa locals and artists Rizzhel Javier and Maria Rios-Mathiodaikis. Background reading: Images of America: Mira Mesa. Met with Feng Shui consultants Jessie Kim & Helen Keating, who advised about color treatment, material, orientation, and shape of the installation.

Key Community feedback:

Mira Mesa Community Park is used by families, stargazers, line dancers, meditation groups, basketball players, tai chi and yoga practitioners. Ongoing workshops at the Rec Center include cooking and ceramics, tea parties, a peewee sports program, 3-5 year old daycare (sources: Mira Mesa Community facebook page, Mira Mesa Rec Center Staff, San Diego Parks staff, Mira Mesa local Rizzhel Javier, Mira Mesa High School Drill team instagram)

The project needs to honor and celebrate the diverse community and neighborhood of Mira Mesa (feedback at Dec. 2019 Meet the Artist event)

Shaded space is a key need for Mira Mesa Community park (community members, Parks Admin, Mira Mesa Rec center staff)

Gazebo replacement: the shade structure will be replacing the gazebo.

The gazebo is often used by dj's, meditation groups, picnics, work parties, birthday parties. The new structure will need to serve these users. (source: Christian Haupt, Mira Mesa Rec Center staff, Mira Mesa local Rizzhel Javier)

There already is a shaded area in the Phase I area of Mira Mesa Community Park that provides a large area of shaded space that large dance groups use, so the square footage does not need to be huge (source: Christian Haupt, Mira Mesa Rec Center staff)

The paint treatment needs to be simple enough for regular maintenance by parks staff (source: Christian Haupt, Mira Mesa Rec Center staff)

Key Design Team input:

Choose the site between the playgrounds, as compared to the skate park, to concentrate social energy (source: Parks Dept., Schmidt Design, Platt-Whitelaw)

The site needs to be flexible, providing seating opportunities and open space. (source: Parks Dept.)

Rentable space: The shade structure site will be rentable space, so groups can reserve it in advance (source: Parks Dept.)

Maintain at least 6' clearance between structure and playground (source: Schmidt Design, Platt-Whitelaw)

Trees, BBQs, and picnic tables will be placed on the outer ring of the plaza, to back the structure (source: Schmidt Design, Platt-Whitelaw)

Mira Mesa Community Art Fellowship, July 12-16 2021

MIRA MESA COMMUNITY ART TEEN FELLOWSHIP

\$500 stipend!

A new amphitheater-like sculpture is planned for Mira Mesa Community Park! The steel sculpture will serve as a shaded festival stage, a picnic area, a location for events and classes, and a beautiful space for all to enjoy.

Local artists are seeking Mira Mesa students for a paid fellowship to co-design this new permanent landmark in Mira Mesa Community Park!

Students interested in wildlife, environmental studies, history, art, architecture, urban planning, and journalism are encouraged to apply.

Who: Mira Mesa students entering grades 9-12 or recently graduated from grade 12

When: July 12-16, 2021, 10am - 4pm and 7:00-8:30pm each day plus one online team meeting Wednesday, July 28 1:00-2:30pm

Fellows must be able to commit the entire week to receive the stipend (We understand that emergencies arise and we are flexible, however we ask for commitment.)

Where: Hybrid schedule including required in-person at Mira Mesa Community Park activities and meetings on Zoom. Lunch will be provided.

Fellowship stipend: \$500. All fellows will also be credited for their contributions in this permanent public art commission by the City of San Diego.

Application deadline: July 1st

Apply: www.theajaproject.org/parkeology



Conceptual rendering



Conceptual rendering



Join The Mira Mesa Community Art Teen Fellowship

Co-Design a permanent amphitheater-like sculpture in Mira Mesa Community Park and receive a \$500 fellowship stipend

APPLY TODAY

MIRA MESA COMMUNITY ART WEEK

Mira Mesa Community Art Fellows Final Design Concept

Sky dwellers

Earth dwellers

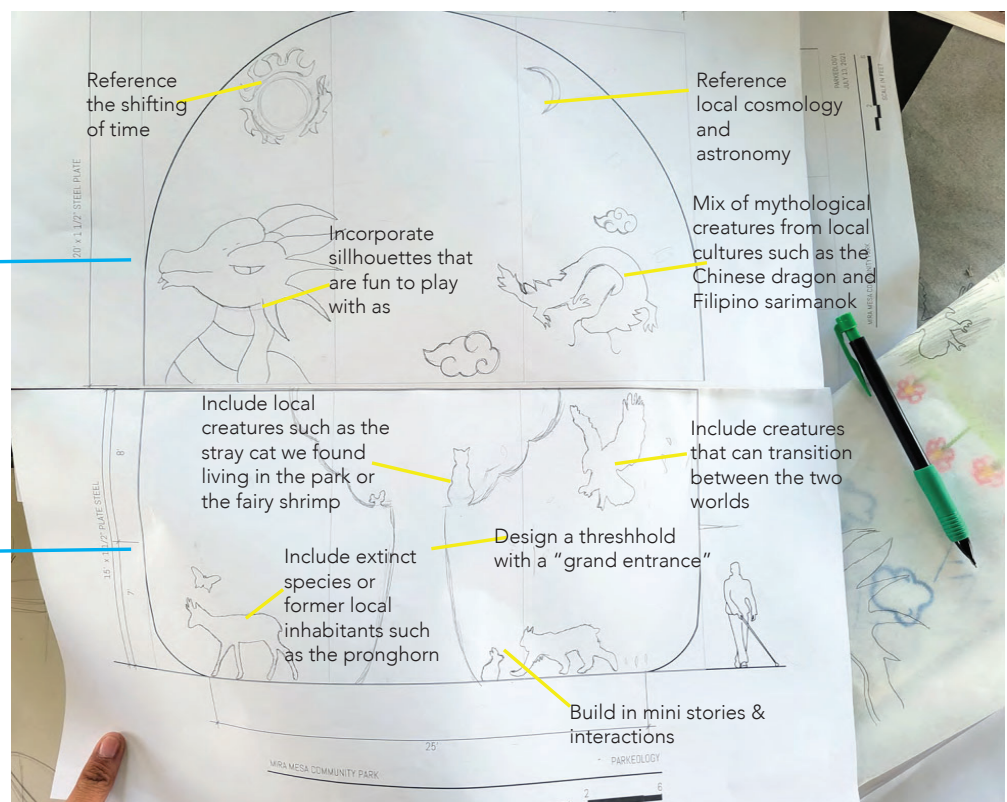

Mira Mesa Shade
Structure
Final Design



Shadow Grotto Sketch:
noon



12 PM

Shadow Grotto lighting rendering



Shadow Grotto Project Description

Mira Mesa Community Park has an abundance of sun and flat space. These innate physical characteristics of the park provide the core material for the Shadow Grotto: both a shelter and a projecting device, casting drawings upon visitors and surfaces alike.

Mira Mesa Community park also has an abundance of festivals and social gatherings that reflect the diverse culture of Mira Mesa including Diwali, Tet, and The Filipino Sun Festival. Fourth of July crowds the park for days, and Halloween also draws many families. The Shadow Grotto will serve as another site to host casual, private, and public gatherings, as well as casual play. This project transforms the initially proposed Phase II shade structure from a simple structure into a dynamic, playful, and engaging environment.

Proposed content

Mira Mesa as a neighborhood is relatively young- and the land itself has gone through many transformations, from Kumeyaay territory to the Californio ranchos, to the grazing land of pronghorns. The silhouette imagery that will be featured on the Shadow Grotto will be a part of the various layers of life that have physically or metaphorically touched the land that Mira Mesa Community Park is a part of, whether it is visible: flora, fauna, astronomy, or the invisible to the naked eye: cosmology and mythology. Collaged and combined, these silhouette images waterjet cut into the 1" plate steel pavilion ceiling and wall combine to cast shadows on the park and its users.

Pavilion imagery has been cultivated over the course of six months in design development workshops led in collaboration with the AjA project, Mira Mesa High School students, and Mira Mesa community members. Local educators and leaders were invited to attend these workshops as special guests, lending thematic insight and specificity, and feedback to project design.

Location

Located between the two playgrounds, and next to the community center, basketball courts, and game tables, the Shadow Grotto will be at the center of activity in Mira Mesa Community Park. This placement will serve as a magnifier for interaction and play, a positive dynamic emphasized by Feng Shui consultant Jessie Kim. The vertical plane of the pavilion, arrayed with cut out imagery, will also serve as a mural backdrop to surrounding activity.

DJ's, dancers, meditation groups, tai chi, & yoga practitioners who relied on casual use of the former gazebo will also have free range of the space for open use.

Scale

The shadow pavilion is 40' wide, 15' high, and 28' deep, offering a focal point to the plaza mixing zone. The pavilion will be the largest mass in the area, providing material grounding to the varied activities and structures in the plaza. Only one structure will be taller- an 18' netted play structure. An intrepid net climber will have the special opportunity to look down at the pavilion and view the roof imagery from an unusual vantage. Both ceiling and wall of the structure will be made of 3/8 waterjet" plate steel mounted to a radial 6" steel beam structure.

Surface area within the shadow pavilion will provide 950 square feet. This is enough space for 9 performing or practicing dancers, or 160 people for a group dance (4 sf/person minimum).

Context

Feng Shui consultant Helen Keating described the pavilion location as having a good "turtle" or "mountain" aspect when opening to landscaping and extra tree

Shadow Grotto Project Description

plantings beyond. Painted in cool lavender and blue hues the pavilion will offer a “cooling oasis” during a hot day. These color choices will also provide cooling, grounding, feminine yin energy, balancing the strong yang energy of the surrounding environment (Feng Shui consultant Jessie Kim).

As rentable space, the plaza will have an open floor plan and ring seating- providing flexibility for events. People who reserve the site can bring their own tables, or use it for performance or dj’ing. Meditation, tai chi, yoga, and dance groups who use Mira Mesa Community Park, and particularly the groups that used the former gazebo, will also have free range of the space for open use.

Benches that circle the outer perimeter of the pavilion will provide seating for visitors to spend time with the work, as well as caretakers to sit and keep an eye on their kids who are using the nearby playground.

Relation of the components

The Shadow Grotto shape is essentially a 3/8” plate steel circle folded in half, supported by columns and beams. The columns in turn provide structure for bench seating. The semi circle plate steel roof will be tilted at 95 degrees, creating a raised arc/lip viewable from the ground, transforming the vertical wall into a multi-dimensional object with a domed plane.

Feng Shui consultant Jessie Kim confirmed that by tilting the pavilion roof to 95 degrees deflects “poison arrows” - sharp angles that direct unwanted energy at neighboring structures.

With a sheltering wall and roof, the pavilion will create a “cooling oasis” effect- a space for people to chat privately, tucked into a dynamic and relaxing environment, and protected from sun exposure.

The pavilion will be placed on the plaza concrete. Completing the semicircle shape of the pavilion roof, the concrete pad will form a circle of pavement around the pavilion. The circular concrete pad will be tinted to a similar warm hue as the pavilion, separating the space from the tan hues of the surrounding plaza concrete.

Benches that circle the outer perimeter of the pavilion will provide seating for visitors to spend time with the installation, as well as family/caretakers to sit and keep an eye on their kids who are using the nearby playground.



Artist model sketch, 2020