

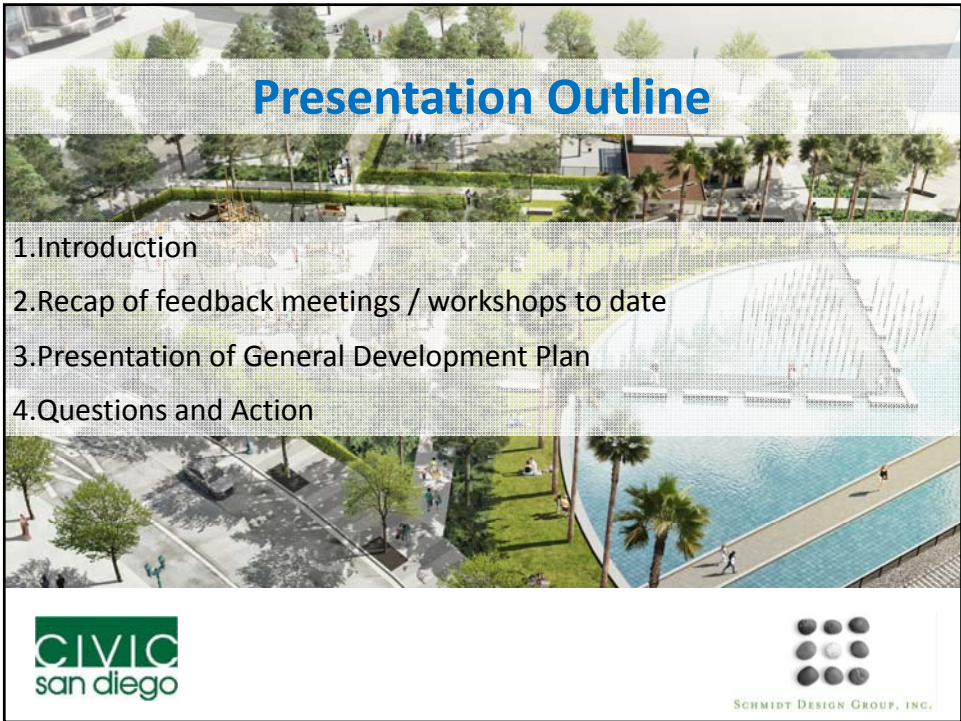

# Children's Park Re-Visioning

**Park & Recreation Board**

July 20, 2017



## Presentation Outline

- 1. Introduction
- 2. Recap of feedback meetings / workshops to date
- 3. Presentation of General Development Plan
- 4. Questions and Action



SCHMIDT DESIGN GROUP, INC.

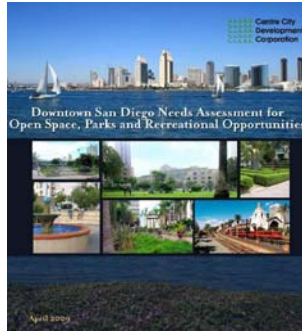

## Marina Neighborhood

“Children’s Park,....should be redesigned to be more functional and include multi-purpose open space, outdoor seating areas, a playground, an interactive water element, a dog park or dog run and picnic areas.”

Downtown Needs Assessment for Open Space, Parks and Recreation, 2009.

*Children’s Park Existing Conditions and Observations*

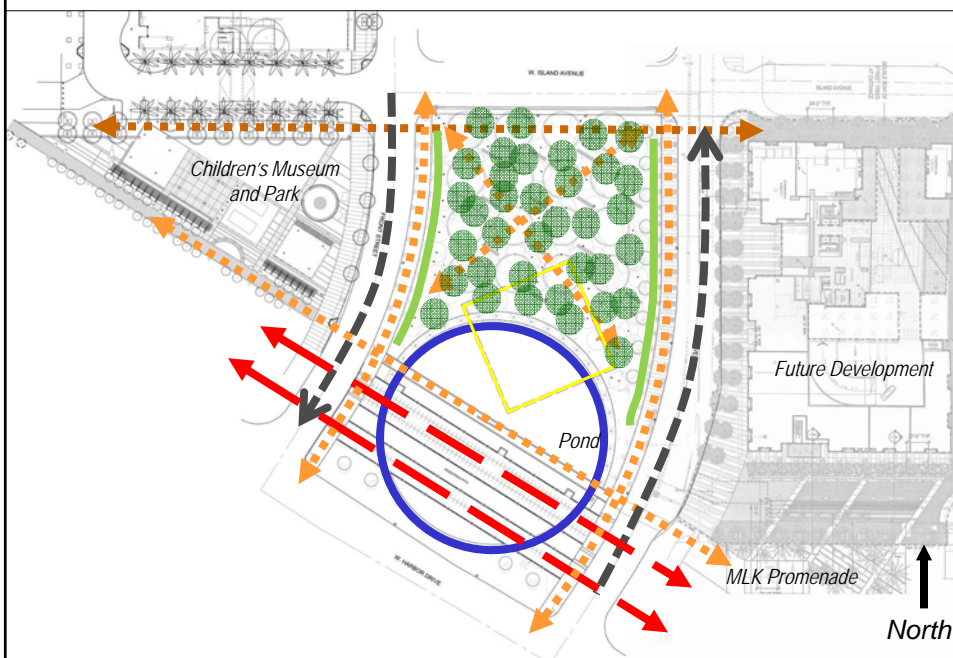



## Workshop #1 November 16, 2016 Summary



## Workshop #1 November 16, 2016 Summary

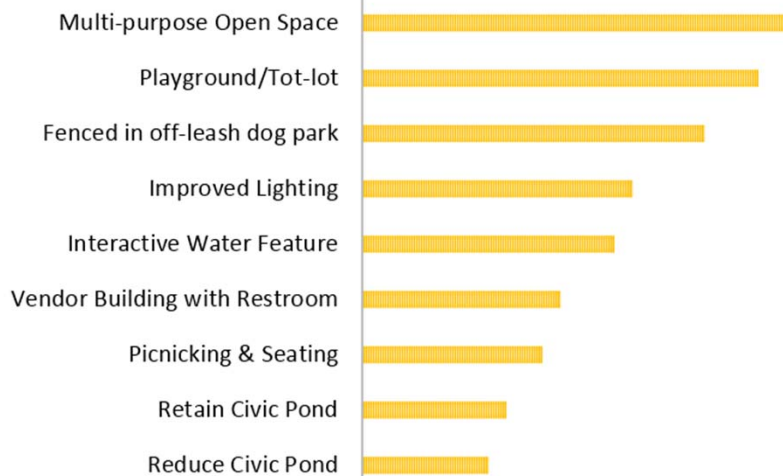

Program prioritization results

## Workshop #1 November 16, 2016 Summary

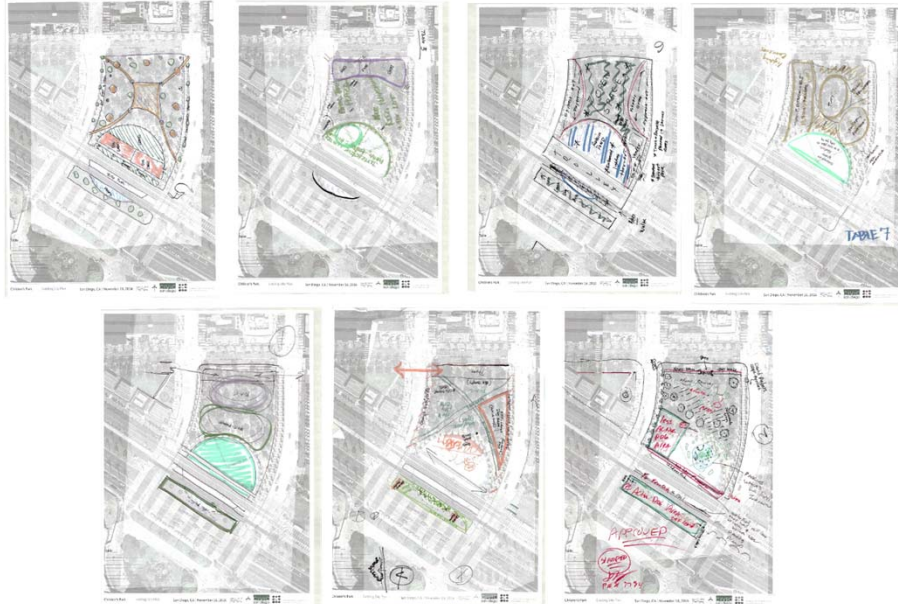

Community Workshop 1 - Design Exercise Results

## Workshop #2 February 28, 2017



Concept One

Concept Two

## Workshop #2 February 28, 2017 Summary

- Two General Development Plan Alternatives were presented
- 4 stations were set up to receive and document community feedback
- 47 comment cards were received and documented



## Workshop #3 April 25, 2017

One Draft General  
Development Plan  
was presented



## Workshop #3 April 25, 2017 Summary

Received and noted numerous comments with general support for the design with continued concerns raised regarding maintenance and security



May 17, 2017  
Downtown Community  
Planning Council  
Vote 16-3

May 24, 2017  
Civic San Diego Board of  
Directors  
Vote 6-2

Draft General Development  
Plan was recommended for  
approval

# Children's Park General Development Plan



Children's Park General Development Plan

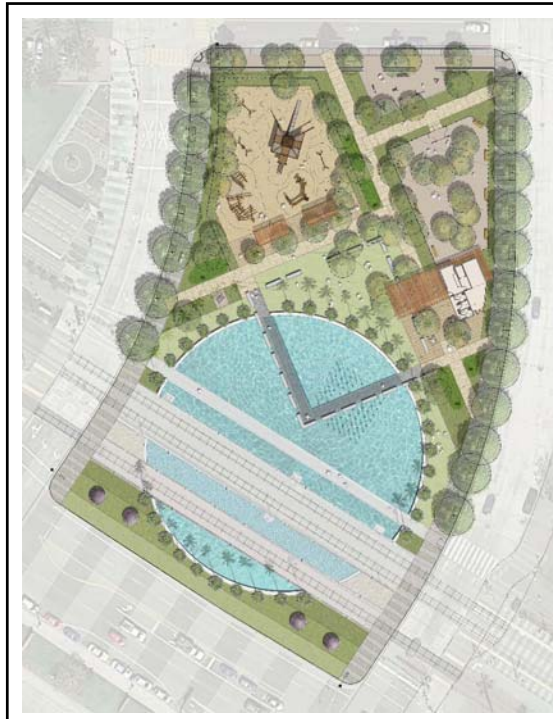

## Children's Park General Development Plan

- Retains civic pond
- Retains but thins the urban forest
- Replaces Cypress trees with canopy street trees
- Improves lighting
- Public art will be included, artist selection is underway

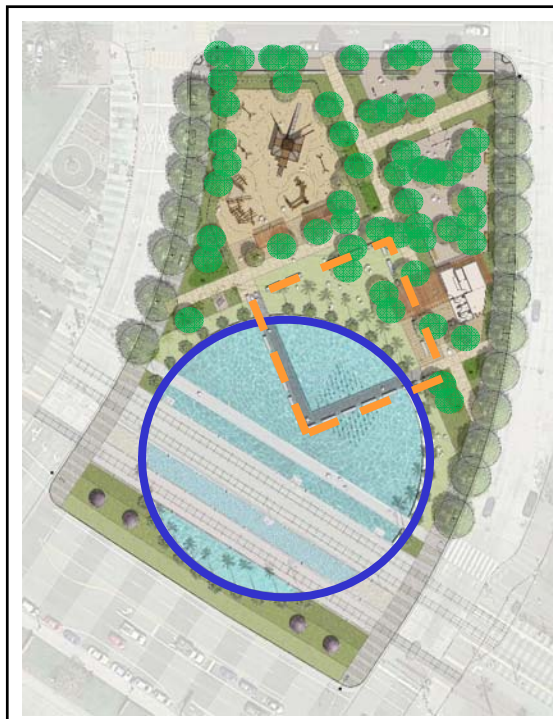

## Children's Park General Development Plan

Structure of original design retained with civic pond, stone benches and urban forest (thinned)



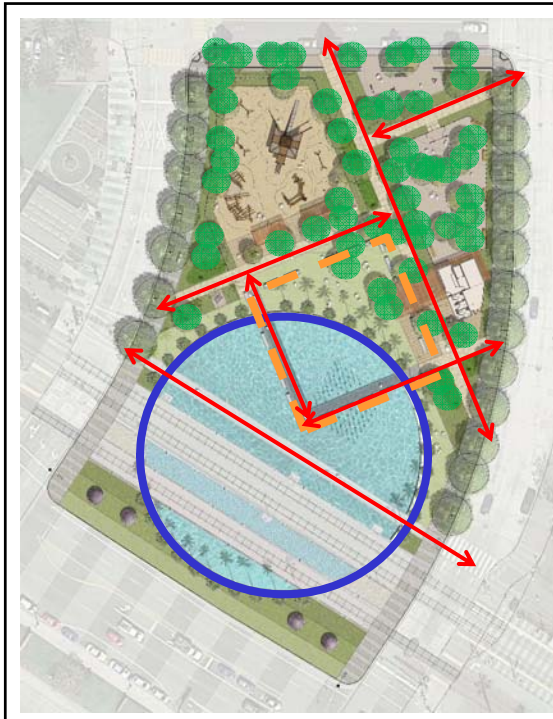

Children's Park General Development Plan

Structure of original design retained with civic pond, stone benches and urban forest (thinned)

Pedestrian Access and Circulation

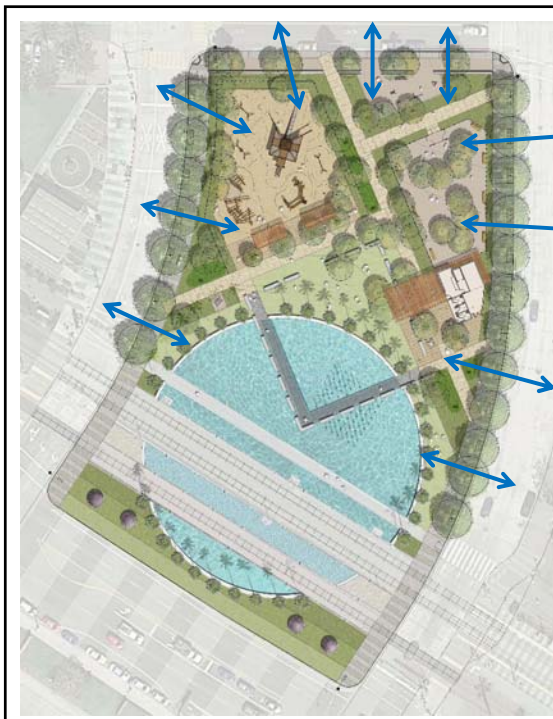

Children's Park General Development Plan

Open views for surveillance

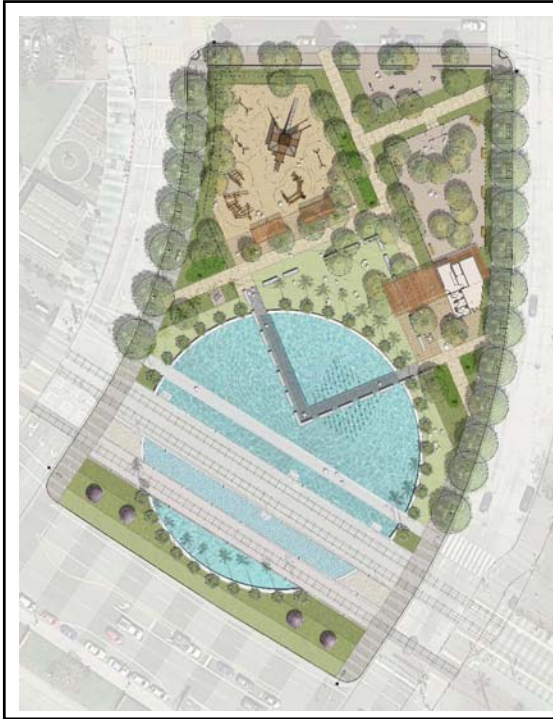

Children's Park General  
Development Plan

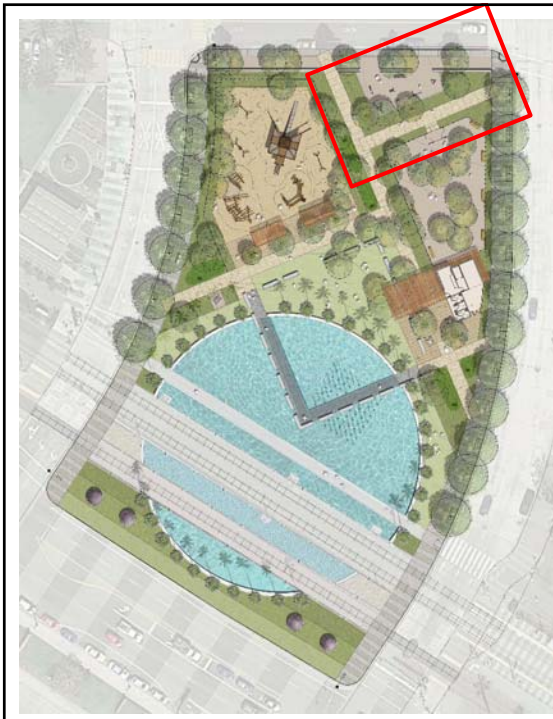

Children's Park General  
Development Plan



### Children's Park General Development Plan

58' x 28' Fitness Area,  
Decomposed Granite (DG)

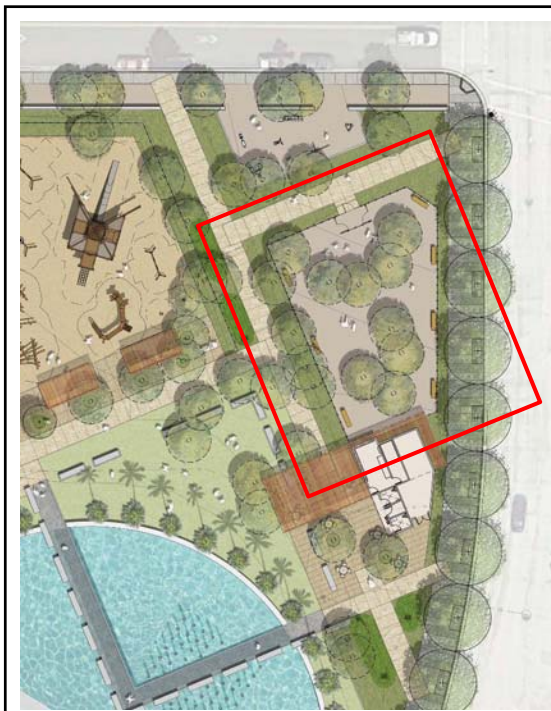
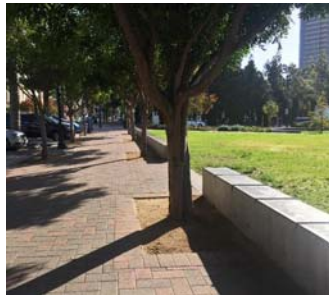

### Children's Park General Development Plan

6,000 s.f. (98' x 65')  
Off-Leash Dog Run,  
screened DG







Children's Park General Development Plan

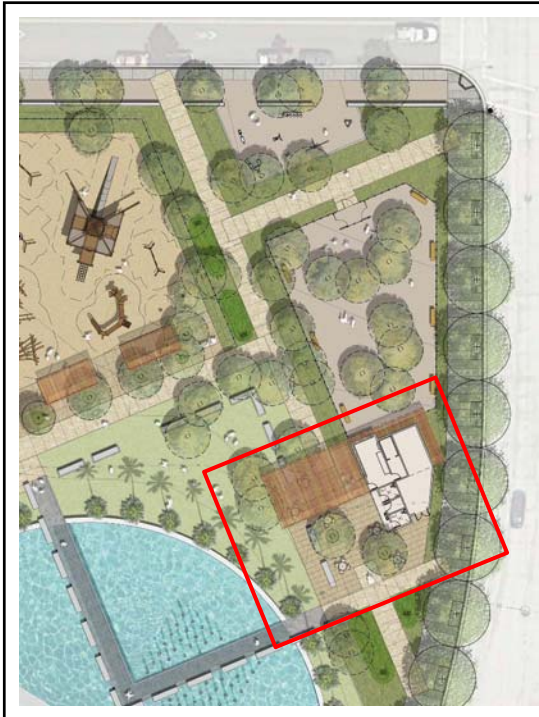

Children's Park General Development Plan

Vendor / Restroom Building



## Children's Park General Development Plan

1,085 s.f. Vendor / Restroom Building

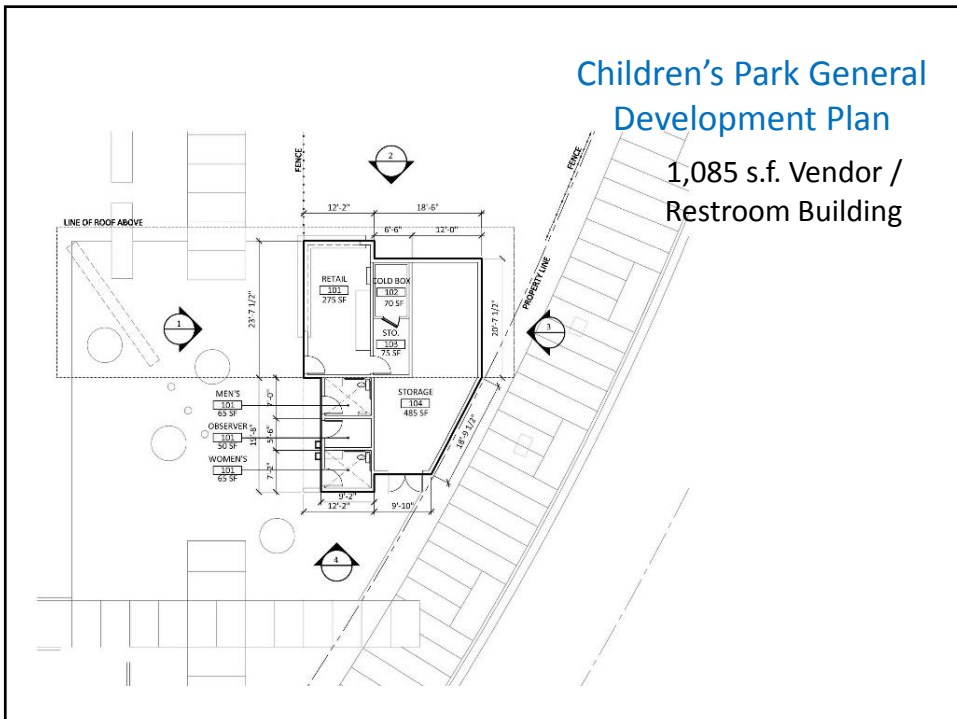

## Children's Park General Development Plan

1,085 s.f. Vendor / Restroom Building

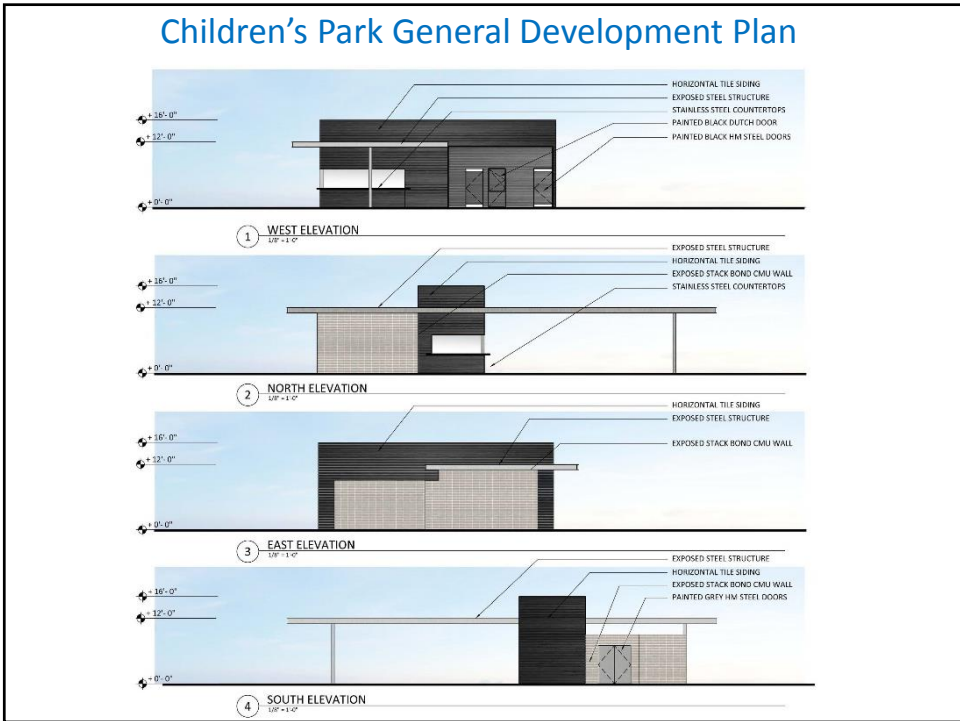
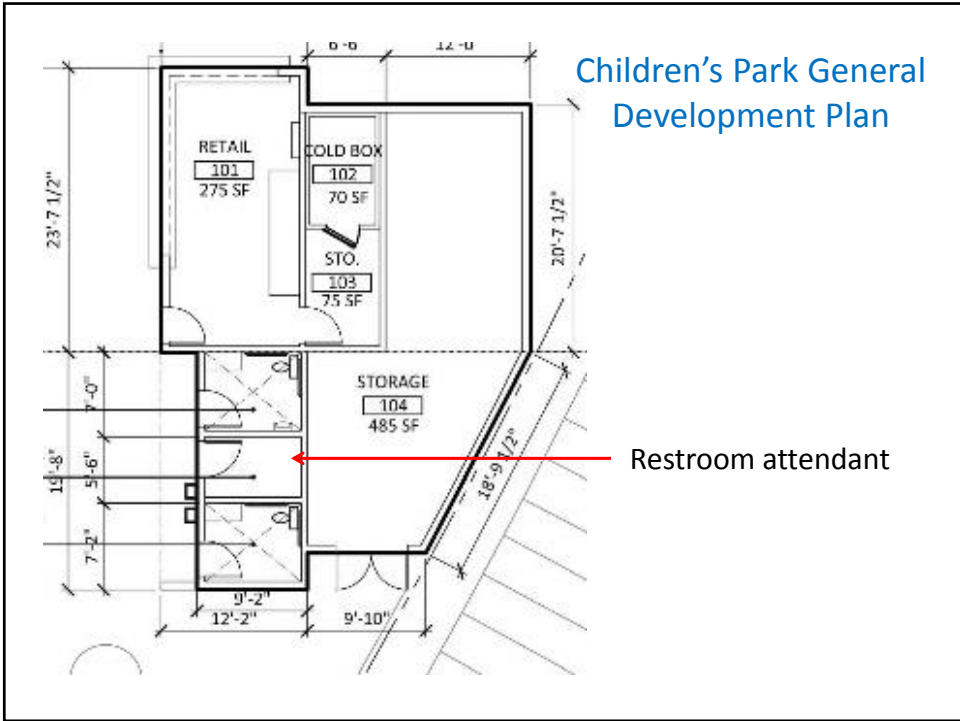



## Children's Park General Development Plan

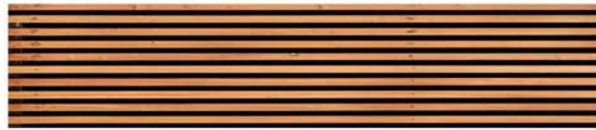

CEILING TREATMENT



EXTERIOR TILE WALL TREATMENT



EXTERIOR EXPOSED CMU WALLS



EXPOSED STEEL

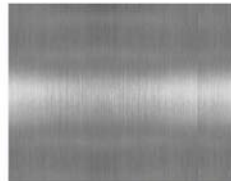

COUNTERTOPS

Vendor / Restroom  
Building Materials



Vendor / Restroom Building

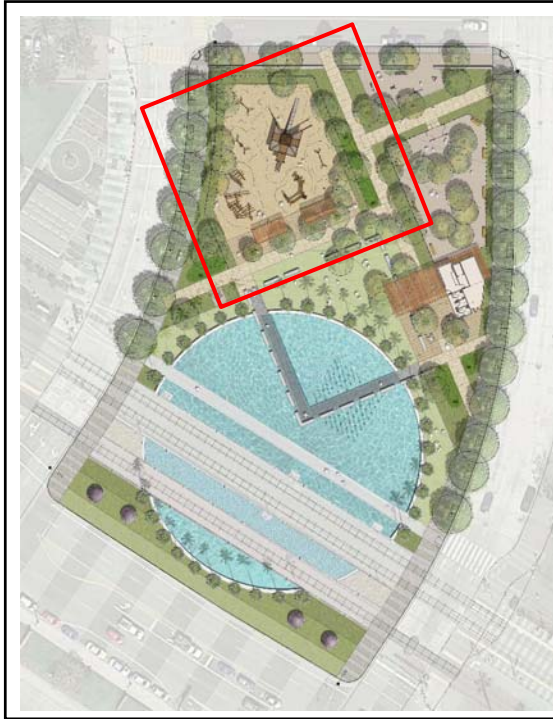

**Children's Park General  
Development Plan**

8,640 s.f., 104' x 90'  
Children's Play Area



**Children's Park General  
Development Plan**

(2) 12' x 25' Shade  
Pavilions



**Children's Park General Development Plan**



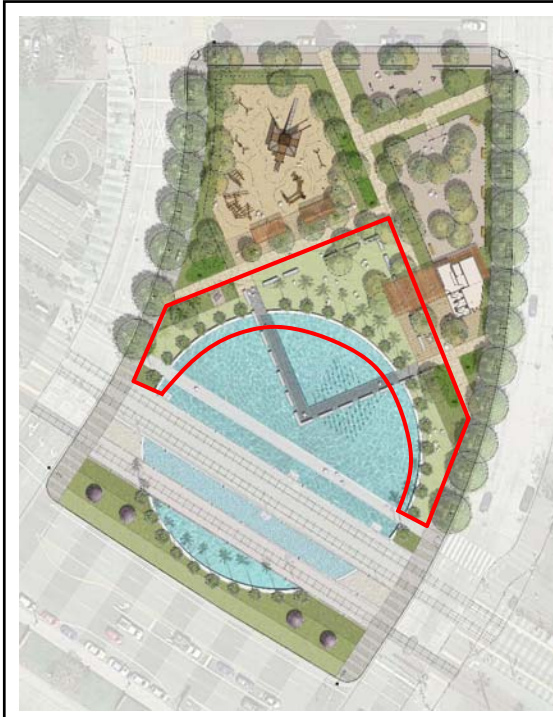

Children's Park General Development Plan  
10,000 s.f. Open Play Turf



Children's Park General Development Plan





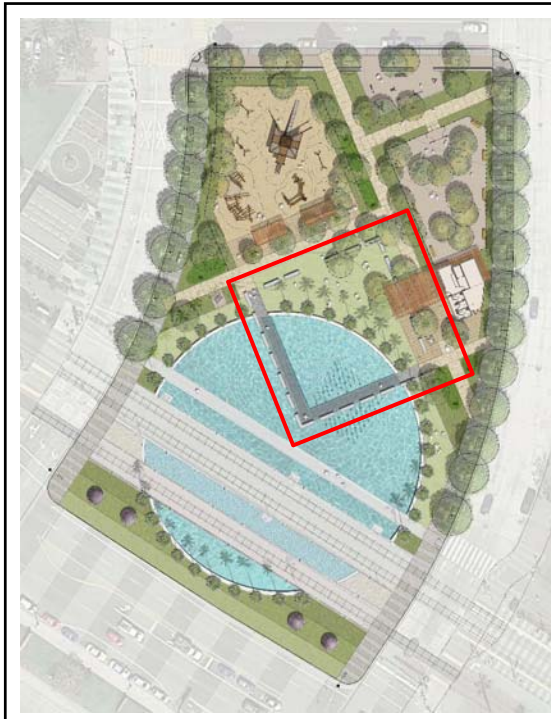

## Children's Park General Development Plan

Restore stone and construct new elevated walk



## Children's Park General Development Plan



## Children's Park General Development Plan

Re-landscape area adjacent to Harbor Drive with drought tolerant low plantings

## Children's Park General Development Plan



Plant Palette



## Children's Park General Development Plan



Potential site furnishing and features



Children's Park General Development Plan



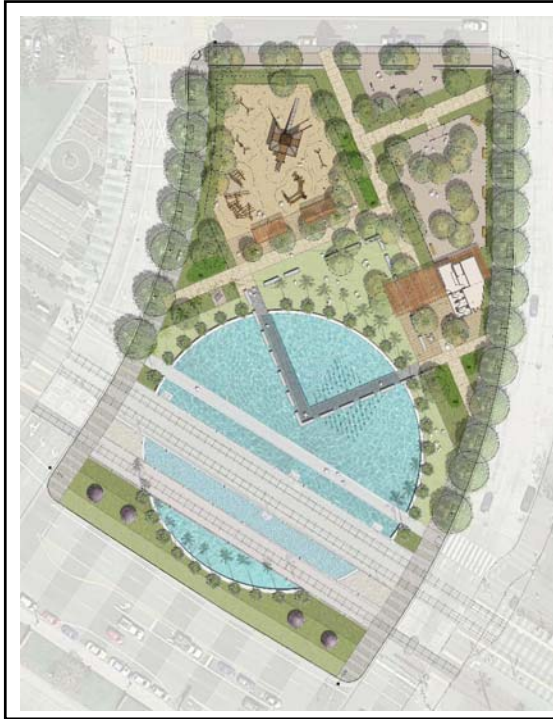

Children's Park General  
Development Plan