

Parks and Recreation Department

Emerson Elementary School Joint Use Facility General Development Plan

Park and Recreation Board

May 19, 2022

Action Item 103

Introduction

Play All Day Parks Program

- Expansion of JU Program to add over 45 new joint use facilities in the next 5-10 years.
- To date, 21 Play All Day JU facilities have been opened to the public.
- 6 JUF's are in construction
- 1 JUF's in bidding
- 12 JUF's are in design

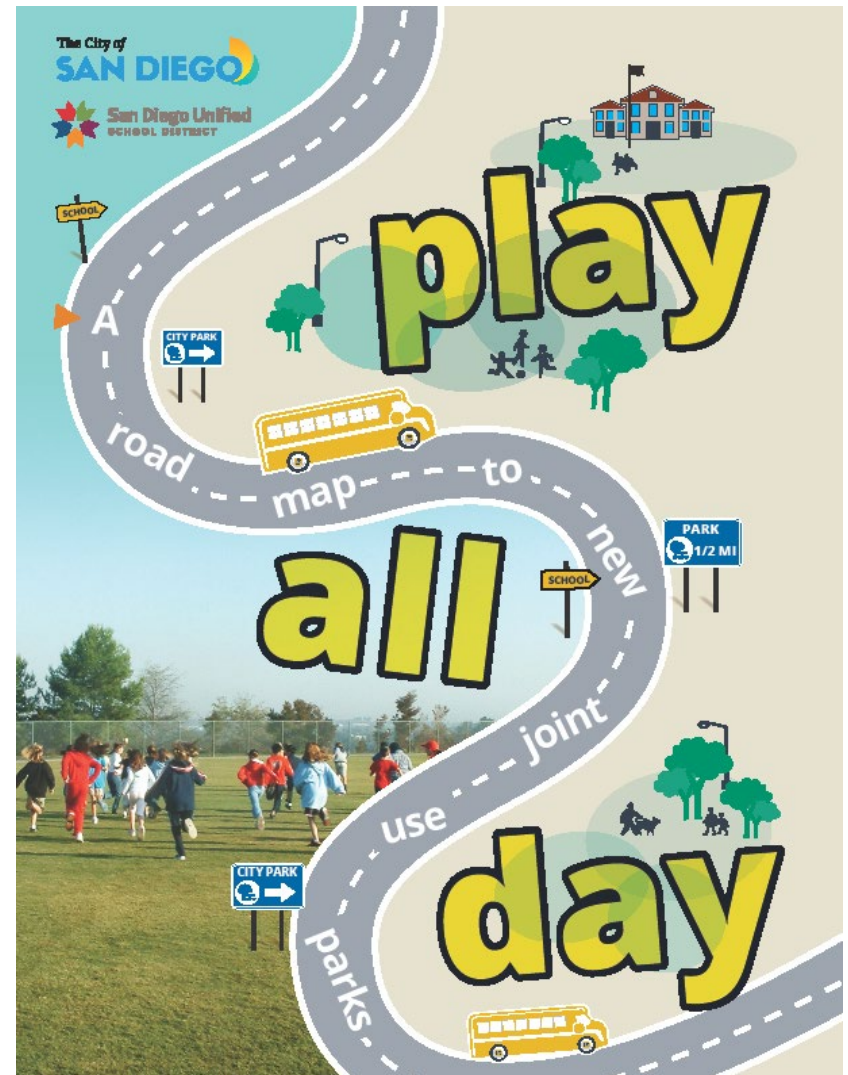

Joint Use Facilities Webpage



- Tracking sheet of existing and future joint use sites located within SDUSD
- Links to the SDUSD Construction Project Public Portal
- Updated joint use agreements
- General information and Frequently Asked Questions about the Play All Day Program

<https://www.sandiego.gov/park-and-recreation/parks/jointusefacilities>

Background

Emerson Elementary School

This project provides for the design and construction of a new joint use facility at Emerson Elementary School.

Located at 1100 S. 36th Street within the Southeastern Community, Council District 9.

Will provide approx. 1.6 acres of population-based park land and 49 recreation value points.

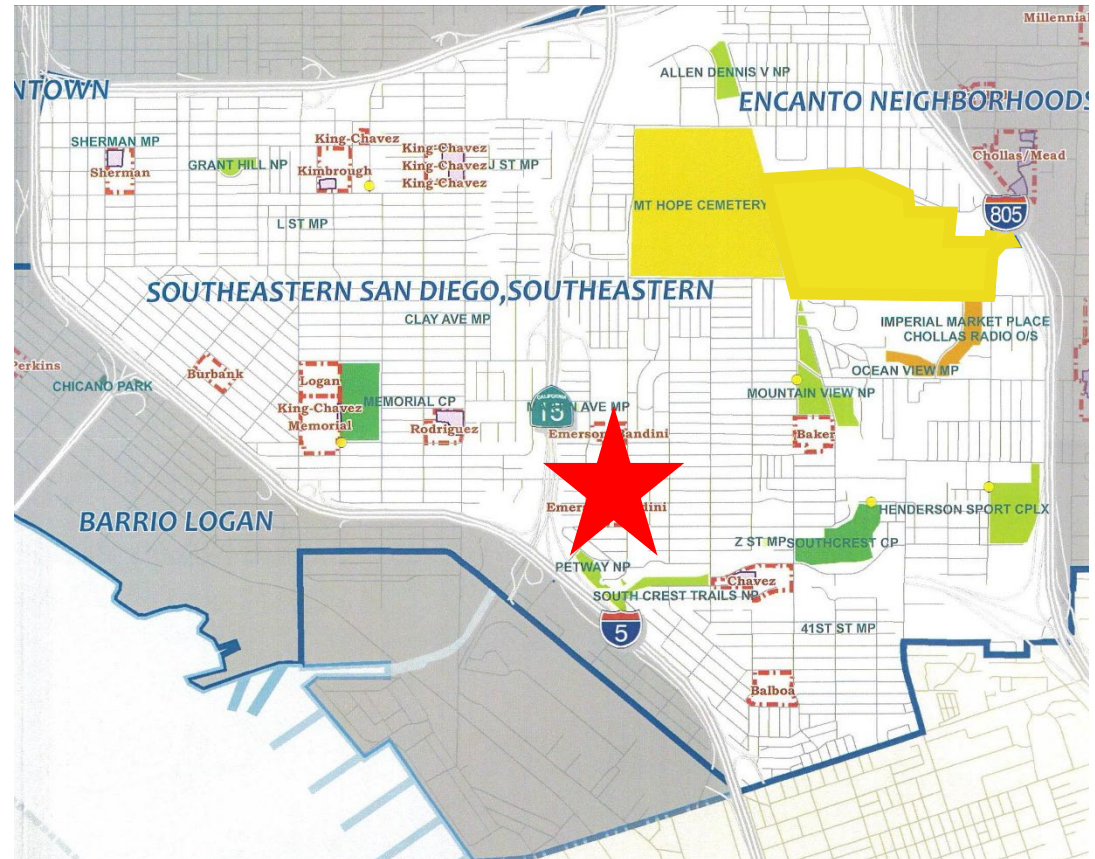

Project Scope

Design and construction of a multi-purpose synthetic turf field, walking track, parking lot, drinking fountain, fencing and trees.

Funding for Design and Construction:

San Diego Unified School District various Capital Improvement Bond Program measures.



Site Location, Aerial Map



Discussion

Community Concerns

- Impacts to neighborhood parking and congestion
- Joint use field hours
- Provision of a public restroom

Community Recreation Group (CRG) Recommendation

On February 14, 2022, the Southeastern San Diego Planning Group voted (7-0-0) to recommend approval of the General Development Plan for Emerson Elementary School Joint Use Facility

General Development Plan

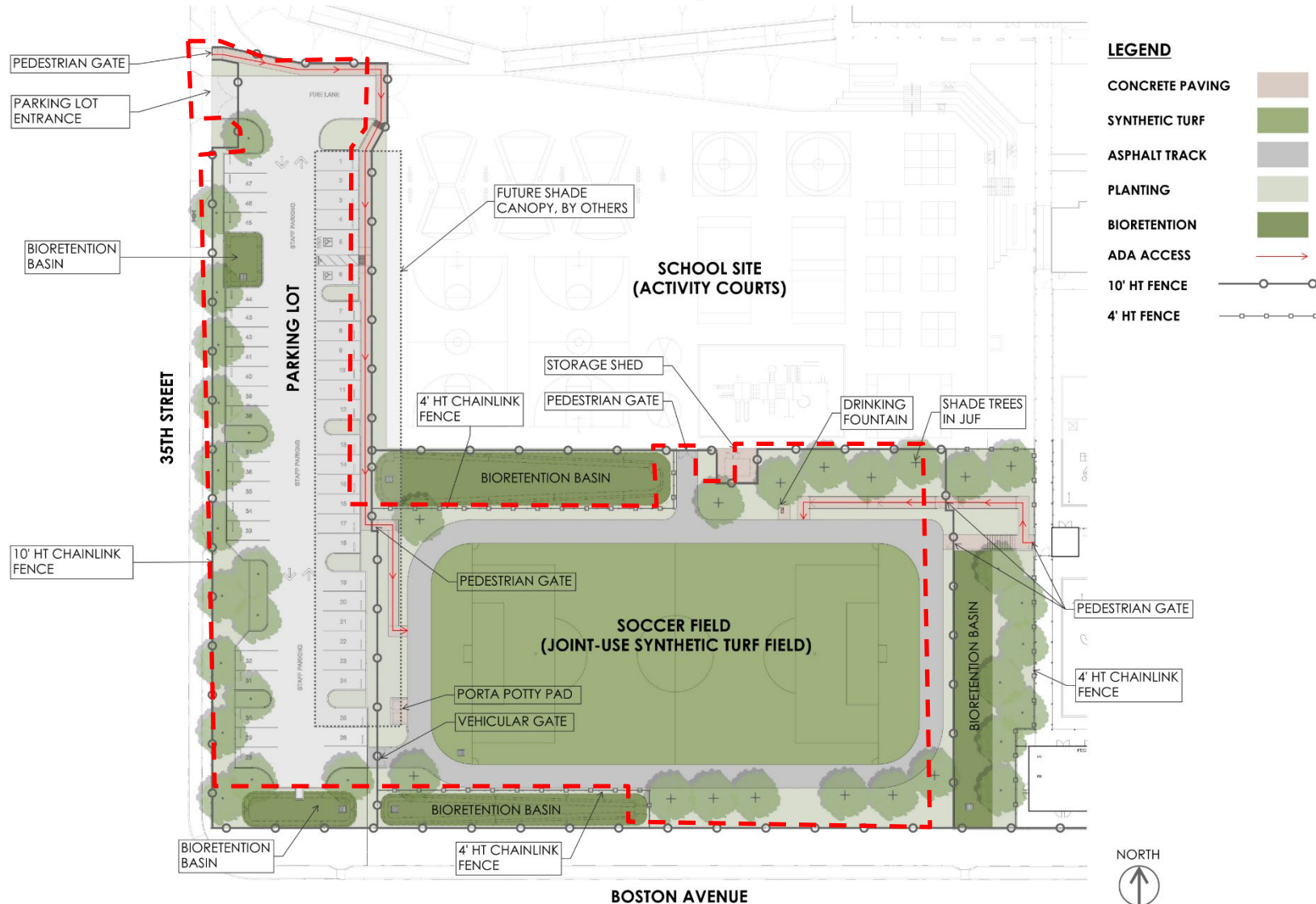



Recommendation

Recommend approval of the proposed General Development Plan (GDP) for the Emerson Elementary School Joint Use Facility