



2020 Master Plan Review

Parks & Recreation Board

November 17, 2022

2020 SeaWorld Master Plan Update

As with the 2002 Master Plan, the 2020 Master Plan serves as the “Development Plan” described in the lease between SeaWorld and the City of San Diego.

Where we started...
(2002 Master Plan)

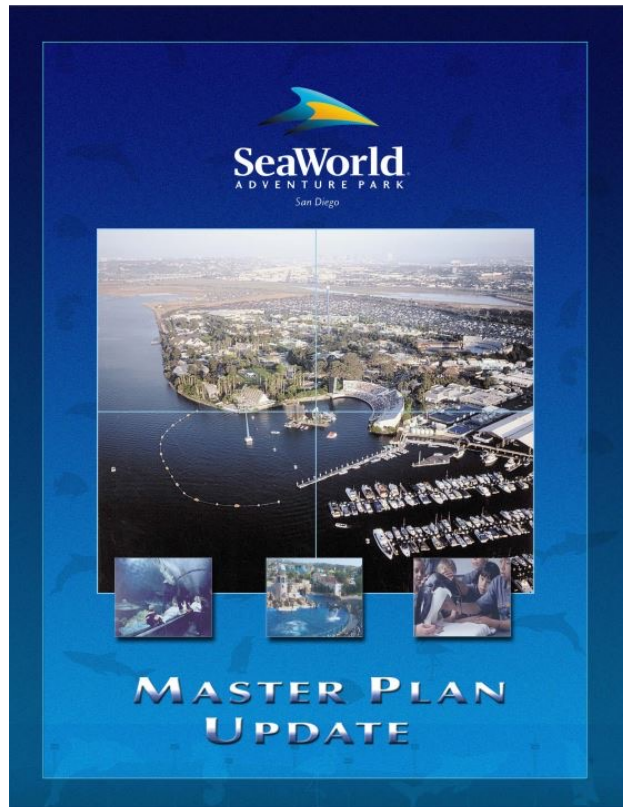

Where we're going
(2020 Master Plan)

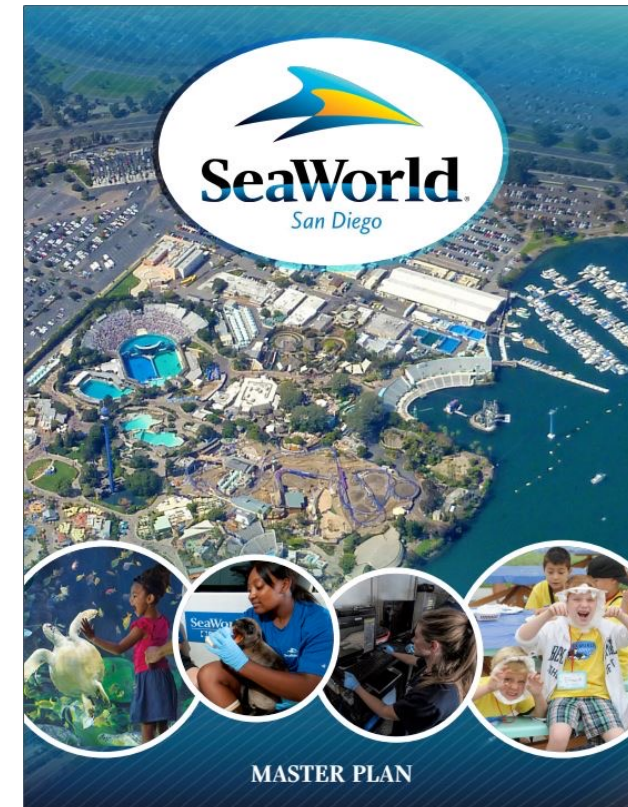

2020 SeaWorld Master Plan Update

The key distinction of the 2020 Master Plan is to transition from a “site-specific” development plan to an “area-specific” development plan that more closely matches SeaWorld’s future renovation needs and because the park is now mostly built out.

2002 Master Plan

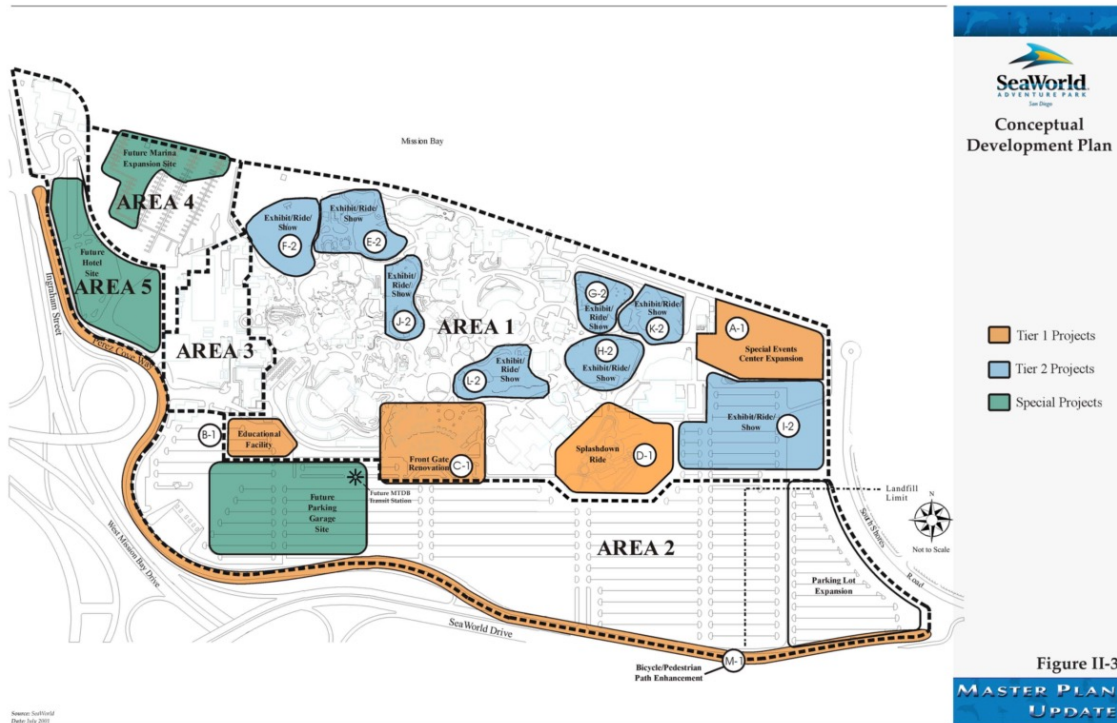

2020 Master Plan

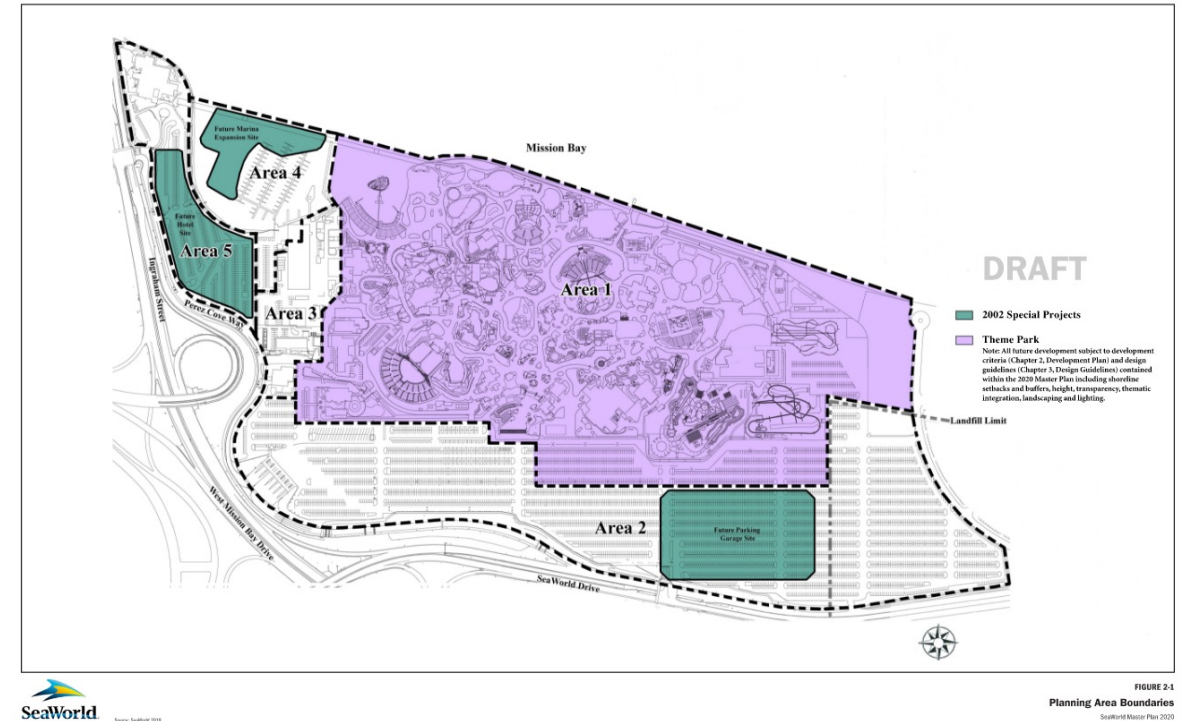

2020 SeaWorld Master Plan Update



This chart displays a high-level comparison of the 2002 Master Plan to the 2020 Master Plan

2002 Master Plan

2020 Master Plan

• City of San Diego approvals for projects	—————>	No Change
• Coastal Commission approval of projects	—————>	No Change
• 5 Planning Areas	—————>	Area 1 slightly larger; Area 2 slightly smaller
• 4 Attractions over 100'	—————>	No Change
• 150 Fireworks Events per year	—————>	No Change to fireworks; add drone shows
• Annual Parking Monitoring	—————>	No Change
• Established Noise Thresholds	—————>	No Change
• Development Criteria	—————>	No Change, some clarifications

Bike, Walk, and Ride to SeaWorld



Pedestrian and Bicycle Improvements along SeaWorld Drive
Bicycle Racks for Guests, Employees, and Marina



Plug in stations for EV bikes and cars at various locations



Bus stop transit improvements



Employee communication to support CAP friendly alternatives for transportation

Coastal Act Consistency Part 1



Public Access

Off-site mobility improvements, ongoing maintenance of trails and bike paths around SeaWorld perimeter and the development setback from the water.



Visual Quality

Design Guidelines and regulations to ensure long-term protection of Mission Bay's scenic qualities by reducing any visual impacts from future SeaWorld development



Marine Environment/Sensitive Habitat

Stringent water quality control procedures and compliance with all federal, state and local environmental laws and agency permits

Coastal Act Consistency Part 2



Sea Level Rise

Comprehensive Sea Level Rise studies in connection with the Master Plan as well as its NPDES Discharge Order from the Regional Water Quality Control Board. SeaWorld will implement the recommendations of those studies.



Recreation

SeaWorld is a visitor serving recreational use – one of the Coastal Act's highest priorities.

Approval Process

Unanimous approval
11/1/22

1

Mission Bay Park Committee

2

Park and Recreation Board

3

Planning Commission

4

San Diego City Council

5

California Coastal Commission

THANK
YOU!

