

Parks and Recreation Department

**Clay Neighborhood Park
General Development Plan Amendment**

Parks and Recreation Board
Action Item # 102
October 19, 2023





Introductions

- **Kathleen Brand** – Project Officer II, Parks and Recreation Department
- **Shamli Tarbell** – Landscape Architect, Parks and Recreation Department



Requested Action:

Should the Parks and Recreation Board recommend approval of the proposed General Development Plan (GDP) Amendment for Clay Neighborhood Park?



Public Input Process

Community Input

- On May 17, 2023, a Workshop was held with the Colina Del Sol Recreation Group (CRG).
- On July 19, 2023, the Colina Del Sol Community Recreation Group approved the Clay Neighborhood Park GDP Amendment.
- The motion passed with the *"stipulation of looking for a larger space for the dog park in the area."* The vote was unanimous (7-0-0).



Existing General Development Plan

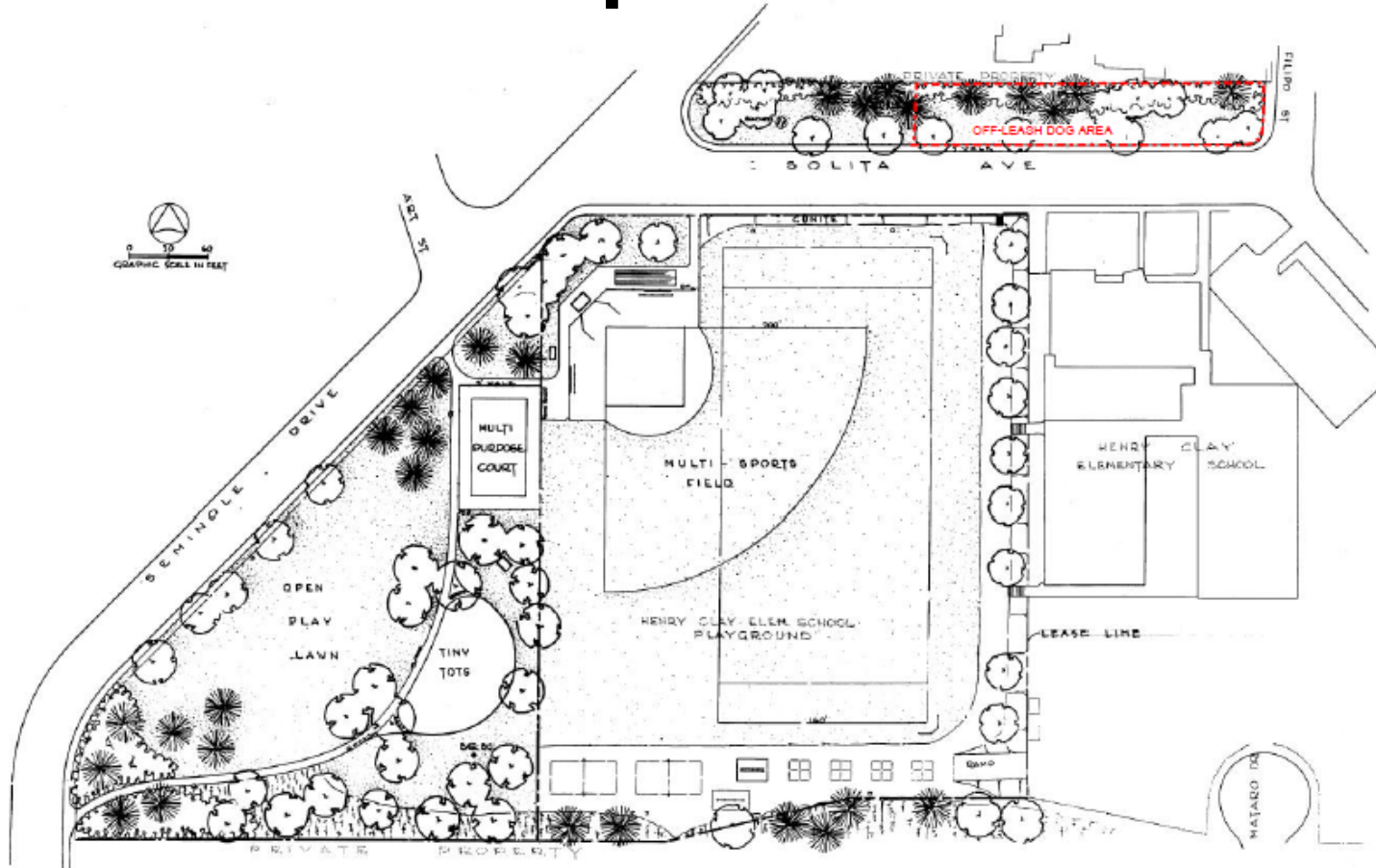

DATE	ACTION	REFERENCE DOCUMENTS
1976	SITE ACQUIRED	REC. NO. R-2162-76
1981	SITE DESIGNATED	DDP NO. D-11281
1916	DDP CONSULTANT Hired	REC. NO. D-11267
	P&S DESIGN APPROVAL	PP & S APPROVAL
3-12-19	INITIAL DEVELOPMENT	CIP NO. JS NO. 117524 DRIVE NO. 11881-D
		CIP NO. JS NO. DRIVE NO.
		CIP NO. JS NO. DRIVE NO.
		CIP NO. JS NO. DRIVE NO.
		CIP NO. JS NO. DRIVE NO.
2-77	SCHOOL LEASE	25 YES. DEP. NY 2567 2.5 ACS.

IMPROVEMENTS SUMMARY (DATA FROM AS-BUILT DRAWINGS)			
ITEM	QUANTITY	ITEM	QUANTITY
TOTAL SITE	2.71 AC	PARK AREA	5,994 SF
IMPROVED AREA	5.02 AC	MULTI-PURPOSE CT	5,070 SF
TURF	2.15 AC	TENNIS CT	57
SHRUB BED	50 AC	RESTROOM	57
NATURAL	50 AC	SEC. BLDG	57
OTHER LANDSCAPING	AS	POOL BLDG	57
DRY INFIELDS	AS	REST. SIGN. AREA	57
		WATER	57
		LAWN SPRINK	3,195 LF
		SECURITY LTS	9
		BALL FIELD LTS	578
		TENNIS CT LTS	578
		MULTI-PURPOSE CT	4
		BOSSARDIA	64
		TENNIS CT	64

CITY OF SAN DIEGO PARK and RECREATION DEPARTMENT

THE GENERAL DEVELOPMENT PLAN

CLAY PARK

COUNCIL DIST. NO. 7 COMM. PLAN AREA MID-CITY - 14 4787 SEMINOLE DR. P.S.D.

LANBERT COORDINATES 218-1781 THOMAS BRG. PG. 81 P-8 615



Most Preferred Community Park Program



Playground

Asphalt Walking Track

Shade Shelter

Dog Off-Leash Area



Most Preferred Solita Ave Strip Program



Strolling Path

Drought Tolerant
Planting with
Bench Seating

Nature Area with
Boulder Seating

Fitness



Preferred Playground Style



Modern Style

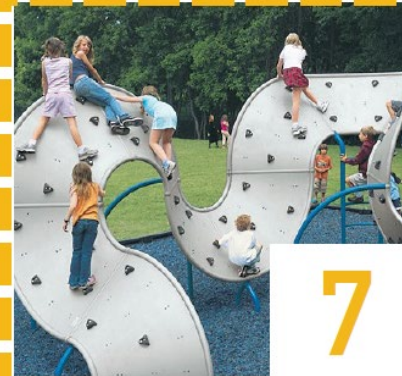

Mobius Climber



Spinner



Swings



Rollerslide



Site Amenities



8

Comfort Station



21

Shade Structure



Site Amenities



12

Fitness



3



3



Parks and Recreation Department



- ### Improvements Legend
- 1 Community Park Entry Plaza
 - 2 Fenced Dog Park
 - 3 Existing Basketball Court to Remain
 - 4 Comfort Station
 - 5 5-12 yr Play Areas
 - 6 2-5yr Play Areas
 - 7 Shelter With Picnic Tables
 - 8 Picnic Area
 - 9 Seat Wall
 - 10 Bench Seating
 - 11 Wellness Path
 - 12 Entry Plaza With Arbor And Sign
 - 13 Boulder Seating
 - 14 Existing Game Area
 - 15 Existing Multi-Use Lawn
 - 16 Entry Plaza
 - 17 Plaza With Relocated Rolando Women's Club Seating
 - 18 Fitness Station
 - 19 Existing Entry Monument Sign To Remain
 - 20 Chess Table
 - 21 Drinking Fountain
 - 22 Light Pole
 - 23 Bioretention basin

- ### Hardscape Legend
- Concrete Paving
 - Enhanced Concrete Paving
 - Rubber Surfacing
 - Artificial Turf

- ### Planting Legend
- Canopy Tree
 - Accent Tree
 - Specimen Tree
 - Existing Tree
 - Existing Pines
 - Turf
 - Buffer
 - Drought Tolerant Planting

<p>COUNCIL DISTRICT: _____</p> <p>COMMUNITY PLAN AREA: _____</p>				<p>IMPROVEMENTS SUMMARY (DATA FROM AS-BUILT DRAWINGS)</p> <table border="1"> <thead> <tr> <th>ITEM</th> <th>QUANTITY</th> <th>ITEM</th> <th>QUANTITY</th> <th>ITEM</th> <th>QUANTITY</th> </tr> </thead> <tbody> <tr> <td>TOTAL SITE</td> <td>AC</td> <td>TOT LOT</td> <td>SP</td> <td>PAVED WALKWAYS</td> <td>SP</td> </tr> <tr> <td>IMPROVED AREA</td> <td>AC</td> <td>MULTIPURPOSE CT</td> <td>SP</td> <td>PARK ROADS</td> <td>SP</td> </tr> <tr> <td>TURF</td> <td>AC</td> <td>TENNIS CTR</td> <td>SP</td> <td>PARKING LOT</td> <td>SP</td> </tr> <tr> <td>ARTIFICIAL TURF</td> <td>AC</td> <td>RESTROOM</td> <td>SP</td> <td>PARKING STALLS/SPOTS</td> <td>SP</td> </tr> <tr> <td>SOFT PLAY</td> <td>AC</td> <td>POOL BLDG</td> <td>SP</td> <td>PARKING STALLS/SPOTS</td> <td>SP</td> </tr> <tr> <td>DRINKING FOUNTAIN</td> <td>AC</td> <td>POOL DECK</td> <td>SP</td> <td>COURT DRAG AREA</td> <td>SP</td> </tr> <tr> <td>POOL MIXER</td> <td>SP</td> <td>POOL MIXER</td> <td>SP</td> <td>LAWN EDGEING</td> <td>SP</td> </tr> <tr> <td></td> <td></td> <td></td> <td></td> <td>BENCHES</td> <td>EA</td> </tr> <tr> <td></td> <td></td> <td></td> <td></td> <td>TRASH RECEPTACLES</td> <td>EA</td> </tr> <tr> <td></td> <td></td> <td></td> <td></td> <td>REVISION</td> <td></td> </tr> </tbody> </table>				ITEM	QUANTITY	ITEM	QUANTITY	ITEM	QUANTITY	TOTAL SITE	AC	TOT LOT	SP	PAVED WALKWAYS	SP	IMPROVED AREA	AC	MULTIPURPOSE CT	SP	PARK ROADS	SP	TURF	AC	TENNIS CTR	SP	PARKING LOT	SP	ARTIFICIAL TURF	AC	RESTROOM	SP	PARKING STALLS/SPOTS	SP	SOFT PLAY	AC	POOL BLDG	SP	PARKING STALLS/SPOTS	SP	DRINKING FOUNTAIN	AC	POOL DECK	SP	COURT DRAG AREA	SP	POOL MIXER	SP	POOL MIXER	SP	LAWN EDGEING	SP					BENCHES	EA					TRASH RECEPTACLES	EA					REVISION		<p>CITY OF SAN DIEGO PARK AND RECREATION DEPARTMENT</p> <p>THE GENERAL DEVELOPMENT PLAN</p> <h2>CLAY NEIGHBORHOOD PARK</h2> <p>NEIGHBORHOOD PARK</p> <p>PSD _____</p> <p>(PSD #)</p> <p>LAMBERT COORDINATES: _____ THOMAS BROTHERS PAGE: _____</p>			
ITEM	QUANTITY	ITEM	QUANTITY	ITEM	QUANTITY																																																																								
TOTAL SITE	AC	TOT LOT	SP	PAVED WALKWAYS	SP																																																																								
IMPROVED AREA	AC	MULTIPURPOSE CT	SP	PARK ROADS	SP																																																																								
TURF	AC	TENNIS CTR	SP	PARKING LOT	SP																																																																								
ARTIFICIAL TURF	AC	RESTROOM	SP	PARKING STALLS/SPOTS	SP																																																																								
SOFT PLAY	AC	POOL BLDG	SP	PARKING STALLS/SPOTS	SP																																																																								
DRINKING FOUNTAIN	AC	POOL DECK	SP	COURT DRAG AREA	SP																																																																								
POOL MIXER	SP	POOL MIXER	SP	LAWN EDGEING	SP																																																																								
				BENCHES	EA																																																																								
				TRASH RECEPTACLES	EA																																																																								
				REVISION																																																																									
<p>DATE: _____</p> <p>PROJECT # _____</p> <p>DRAWN BY: _____</p>				<table border="1"> <thead> <tr> <th>DATE</th> <th>ACTION</th> <th>REFERENCE DOCUMENTS</th> <th>ACRES</th> <th>DATE</th> <th>ACRES</th> </tr> </thead> <tbody> <tr> <td></td> <td>SITE ACQUIRED</td> <td>RESO. NO. _____</td> <td>ACRES</td> <td></td> <td></td> </tr> <tr> <td></td> <td>SITE DESIGN/CT</td> <td>RESO. NO. _____</td> <td>ACRES</td> <td></td> <td></td> </tr> <tr> <td></td> <td>DEP CONSULTANT WRD</td> <td>RESO. NO. _____</td> <td>ACRES</td> <td></td> <td></td> </tr> <tr> <td></td> <td>FINAL DEVELOPMENT</td> <td>CPHD _____</td> <td>J.O. NO. _____</td> <td>DRIVE NO. _____</td> <td></td> </tr> <tr> <td></td> <td></td> <td>CPHD _____</td> <td>J.O. NO. _____</td> <td>DRIVE NO. _____</td> <td></td> </tr> <tr> <td></td> <td></td> <td>CPHD _____</td> <td>J.O. NO. _____</td> <td>DRIVE NO. _____</td> <td></td> </tr> <tr> <td></td> <td></td> <td>CPHD _____</td> <td>J.O. NO. _____</td> <td>DRIVE NO. _____</td> <td></td> </tr> <tr> <td></td> <td></td> <td>CPHD _____</td> <td>J.O. NO. _____</td> <td>DRIVE NO. _____</td> <td></td> </tr> </tbody> </table>				DATE	ACTION	REFERENCE DOCUMENTS	ACRES	DATE	ACRES		SITE ACQUIRED	RESO. NO. _____	ACRES				SITE DESIGN/CT	RESO. NO. _____	ACRES				DEP CONSULTANT WRD	RESO. NO. _____	ACRES				FINAL DEVELOPMENT	CPHD _____	J.O. NO. _____	DRIVE NO. _____				CPHD _____	J.O. NO. _____	DRIVE NO. _____				CPHD _____	J.O. NO. _____	DRIVE NO. _____				CPHD _____	J.O. NO. _____	DRIVE NO. _____				CPHD _____	J.O. NO. _____	DRIVE NO. _____																	
DATE	ACTION	REFERENCE DOCUMENTS	ACRES	DATE	ACRES																																																																								
	SITE ACQUIRED	RESO. NO. _____	ACRES																																																																										
	SITE DESIGN/CT	RESO. NO. _____	ACRES																																																																										
	DEP CONSULTANT WRD	RESO. NO. _____	ACRES																																																																										
	FINAL DEVELOPMENT	CPHD _____	J.O. NO. _____	DRIVE NO. _____																																																																									
		CPHD _____	J.O. NO. _____	DRIVE NO. _____																																																																									
		CPHD _____	J.O. NO. _____	DRIVE NO. _____																																																																									
		CPHD _____	J.O. NO. _____	DRIVE NO. _____																																																																									
		CPHD _____	J.O. NO. _____	DRIVE NO. _____																																																																									

Main Park Enlargement





Solita Avenue Enlargement

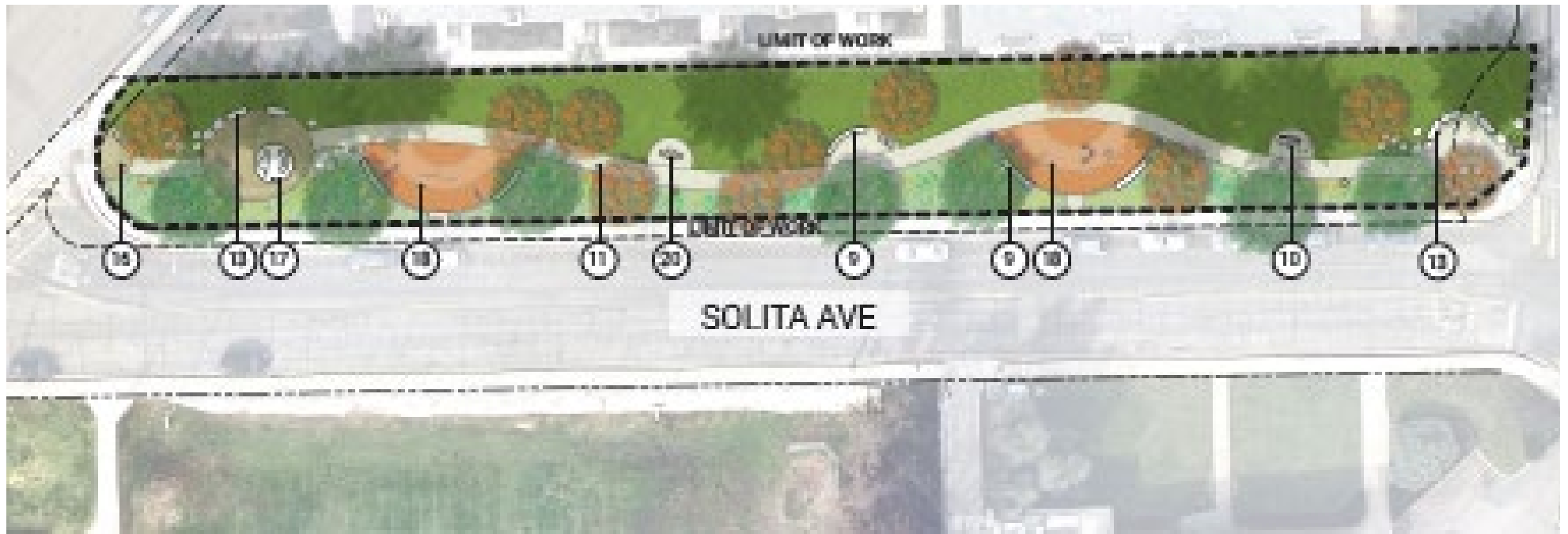



Possible Dog-Off-Leash-Area Expansion





Possible Dog-Off-Leash-Area Expansion

- The alternate option will surround the north entrance and basketball court with dog activity.
- The alternate option is very close to the playground area.
- The alternate option would locate the dog-off-leash-area directly across the street from residents.
- The alternate option comes at the expense of limited open turf area for human recreation.



Department Recommendation

- Recommend approval of the proposed General Development Plan (GDP) Amendment for the Clay Neighborhood Park as presented without the additional Dog-Off-Leash-Area.



Questions

