

LOCATION MAP

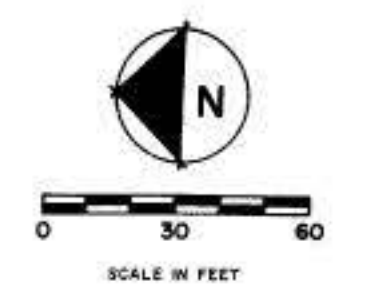
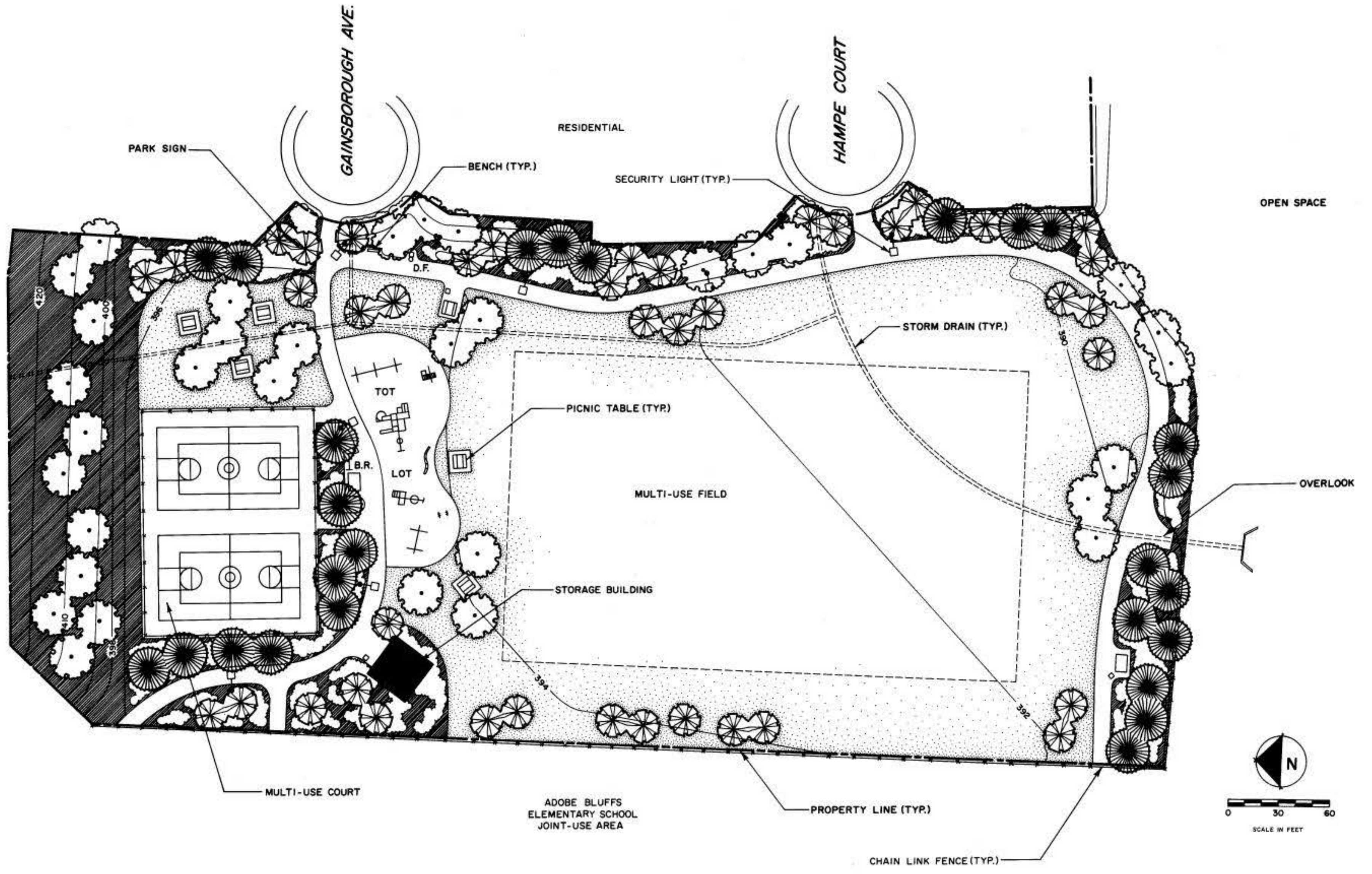

DATA LOG FOR:				
DATE	ACTION	REFERENCE DOCUMENTS		
	SITE ACQUIRED	RESO. NO.	COST 1	ACRES:
	SITE DEDICATED	ORD. NO.		ACRES:
	GDP CONSULTANT HIRED	RESO. NO.	NAME NORDQUIST ASSOC.	
	P&R BOARD APPROVAL	PF&R APPROVAL		
5-24-93	INITIAL DEVELOPMENT	CIP NO.	JO NO. 870115	DRWG. NO. 26053-D
		CIP NO.	JO NO.	DRWG. NO.
		CIP NO.	JO NO.	DRWG. NO.
		CIP NO.	JO NO.	DRWG. NO.
		CIP NO.	JO NO.	DRWG. NO.
		CIP NO.	JO NO.	DRWG. NO.

IMPROVEMENTS SUMMARY (DATA FROM AS-BUILT DRAWINGS)					
ITEM	QUANTITY	ITEM	QUANTITY	ITEM	QUANTITY
TOTAL SITE	AC	PLAY AREA	6,237 SF	PAVED WALKS	13,380 SF
IMPROVED AREA	4.83 AC	MULTI PURPOSE CT	14,040 SF	PARK ROADS	SF
TURF	2.80 AC	TENNIS CTS	SF	PARKING LOT	SF
SHRUB BED	1.25 AC	RESTROOM	576 SF	" " STALLS STD	
NATURAL	AC	REC. BLDG.	SF	" " STALLS HDGP	
OTHER LANDSCAPING	AC	POOL BLDG.	SF	COURT GAME AREA	SF
DIRT INFIELDS	AC	" " DECK	SF	BACKSTOPS	EA
		" " WATER	SF	TENNIS CTS.	EA
				LAWN EDGING	LF

CITY OF SAN DIEGO PARK and RECREATION DEPARTMENT

THE GENERAL DEVELOPMENT PLAN

ADOBE BLUFFS

NEIGHBORHOOD PARK

COUNCIL DIST. NO. 1 COMM. PLAN AREA PENASQUITOS EAST P.S.D. NO. 141

LAMBERT COORDINATES 294-1727 THOMAS BROS. PG. 1189,C-2

REVISION T.R. 11-5-96