

Pershing Bikeway - North Park to Downtown

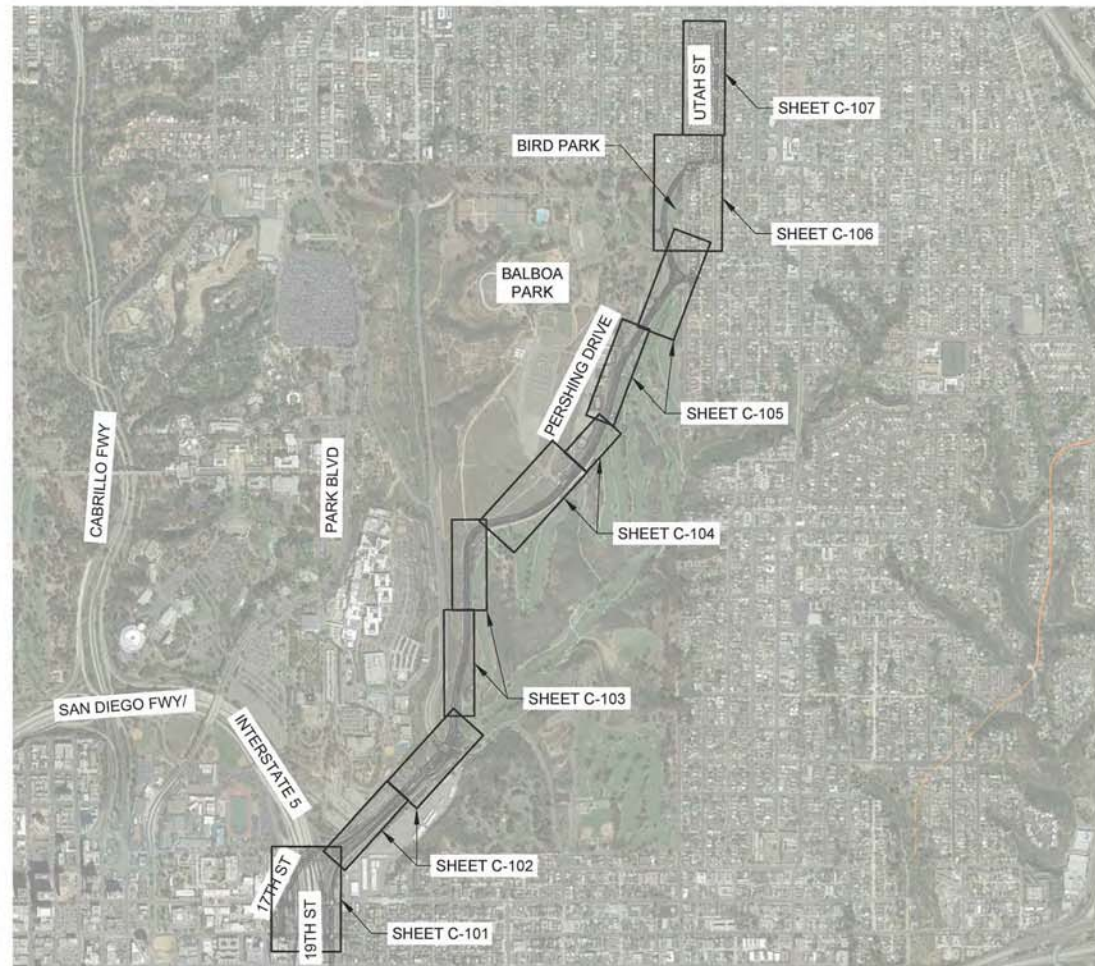







CIP 1223057

San Diego, California



LOCATION MAP
SCALE: 1"=1000'

LEGEND

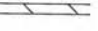
-  TWO-WAY SEPARATED BIKEWAY
-  D.G. PATH
-  CONCRETE PAVING
-  LANDSCAPING / BIO-FILTRATION AREA
-  RRFB
-  SIDEWALK
-  CURBLIN
-  RETAINING WALL
-  BIKE LANE BUFFER

DRAWING INDEX:

PLAN	SHEET NUMBER	#
TITLE SHEET	G-001	01
LAYOUT SHEETS	C-101 to C-107	02 to 08
TYPICAL SECTIONS	C-201 to C-202	09 to 10
PLANTING LEGEND	L-501	11

CLIENT:

SANDAG
401 B Street, Suite 800
San Diego, CA 92101
619.699.1900

PREPARED BY:



233 A Street, Suite 703
San Diego, California 92101
p.619.269.5982



NOT FOR CONSTRUCTION

DESIGNED:	JJC	REVISIONS
REVIEWED:	LD, BJ	NO DATE ITEM
DRAWN:	JJC, LD	
2015-109	AUGUST 19, 2016	
PROJECT NO.	DATE	
SCALE	FILE	

alta
PLANNING + DESIGN
www.altaplanning.com

233 A Street, Suite 703
San Diego, California 92101
p.619.269.5982



Pershing Bikeway

San Diego, CA

GENERAL DEVELOPMENT PLAN
FOR PERSHING DRIVE
TITLE SHEET

SHEET NO.
G-001
1 OF 11

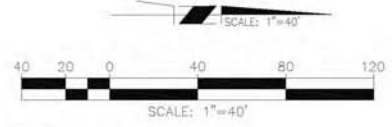
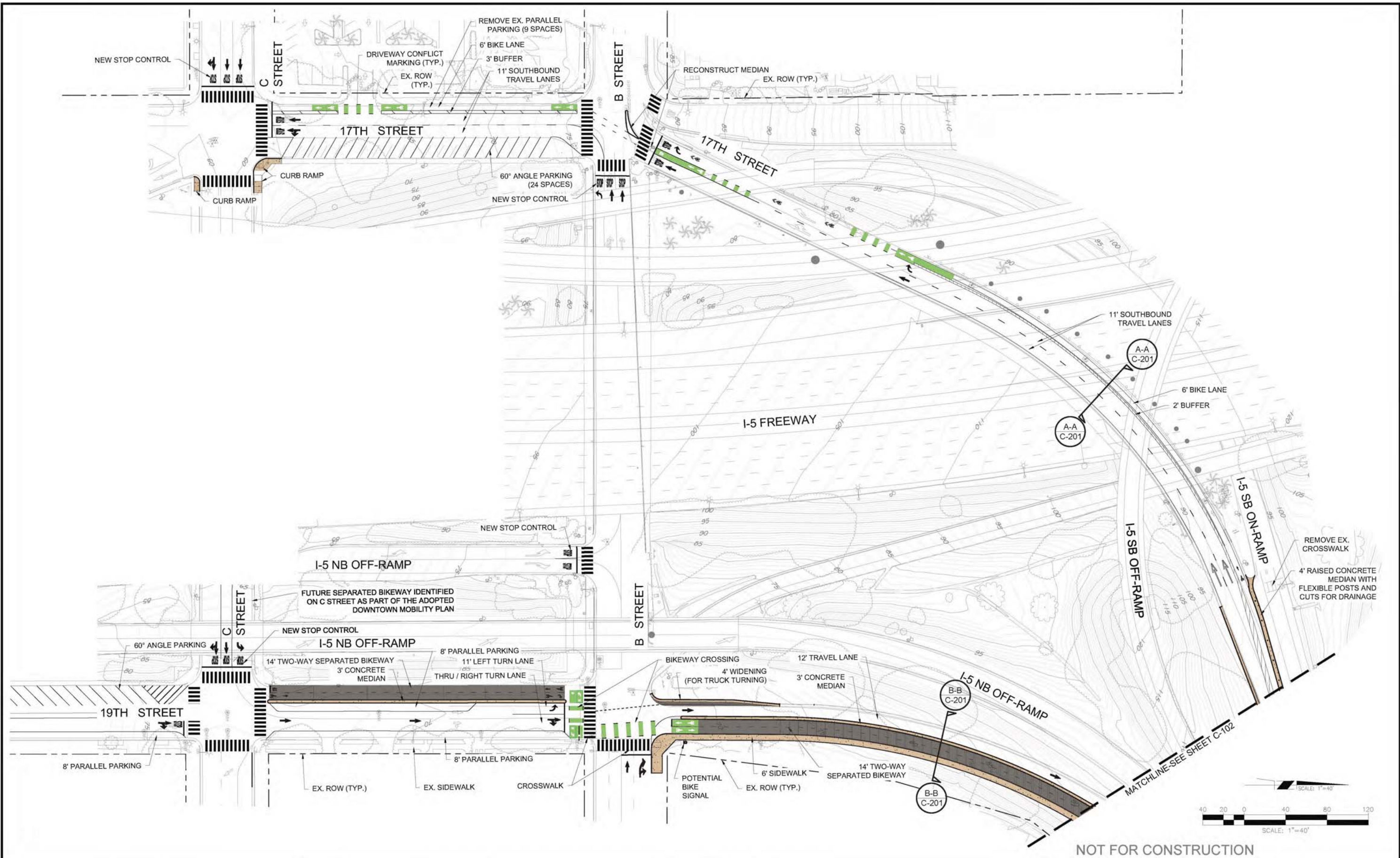

NOT FOR CONSTRUCTION

DESIGNED:	JJC	REVISIONS	
REVIEWED:	LD, BJ	NO	DATE
DRAWN:	JJC, LD	ITEM	
PROJECT NO.	2015-109	DATE	AUGUST 19, 2016
SCALE	FILE		

alta
 PLANNING + DESIGN
 www.altaplanning.com

233 A Street, Suite 703
 San Diego, California 92101
 p.619.269.5962

SANDAG

GO byBIKE

Pershing Bikeway

San Diego, CA

GENERAL DEVELOPMENT PLAN
 FOR PERSHING DRIVE
 LAYOUT1

SHEET NO.
C-101
 2 OF 11

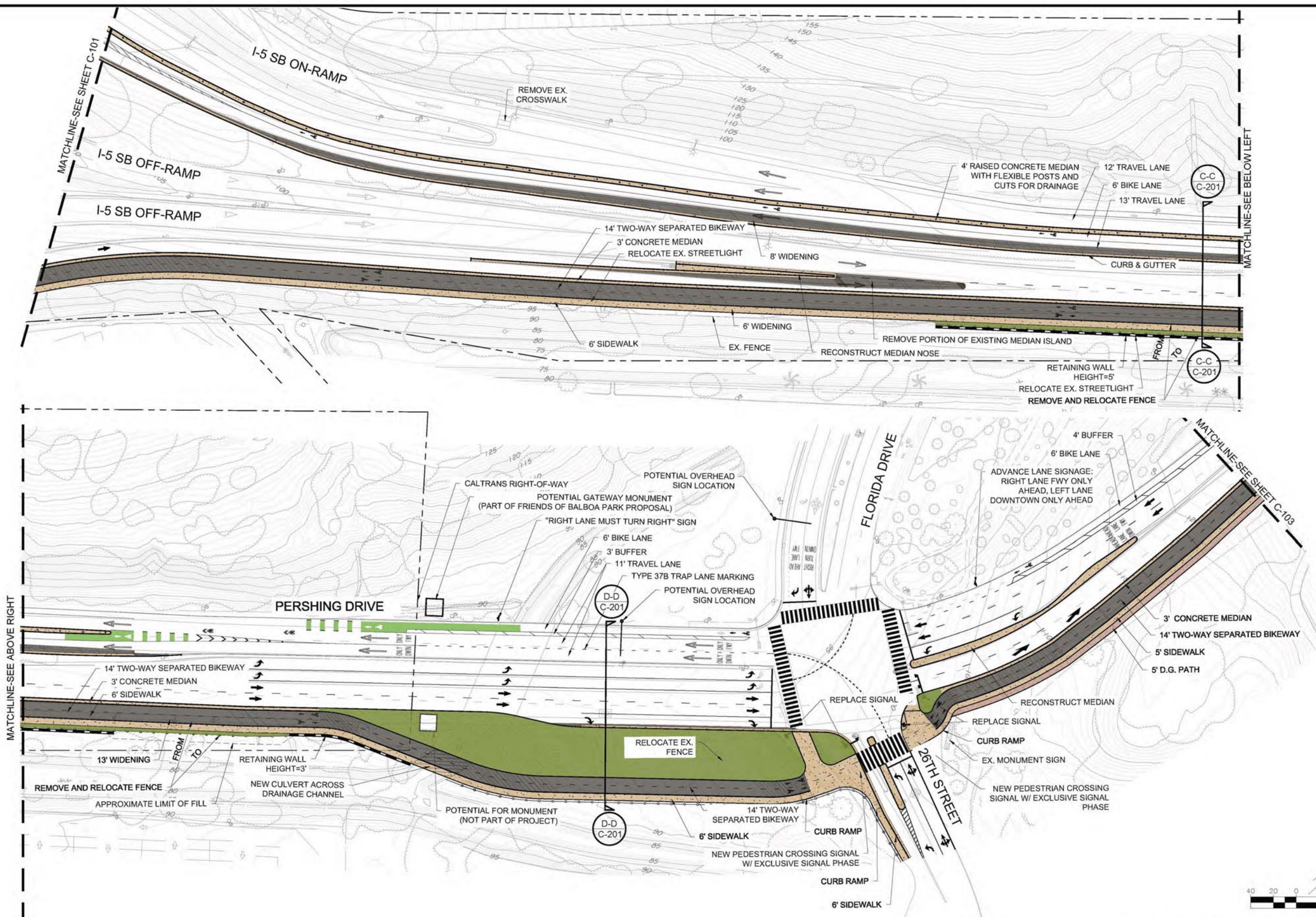

MATCHLINE-SEE ABOVE RIGHT

MATCHLINE-SEE SHEET C-101

MATCHLINE-SEE BELOW LEFT

MATCHLINE-SEE SHEET C-103

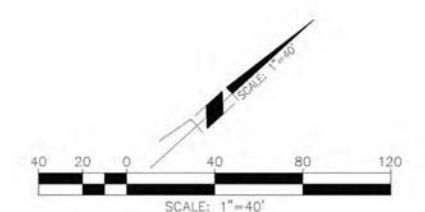

NOT FOR CONSTRUCTION

DESIGNED:	JJC	REVISIONS	
REVIEWED:	LD, BJ	NO	DATE
DRAWN:	JJC, LD	ITEM	
PROJECT NO.	2015-109		
DATE	AUGUST 19, 2016		
SCALE	FILE		

alta
PLANNING + DESIGN
www.altaplanning.com

233 A Street, Suite 703
San Diego, California 92101
p.619.299.5962

SANDAG

GO byBIKE

Pershing Bikeway

San Diego, CA

GENERAL DEVELOPMENT PLAN
FOR PERSHING DRIVE

LAYOUT 2

SHEET NO.
C-102

3 OF **11**

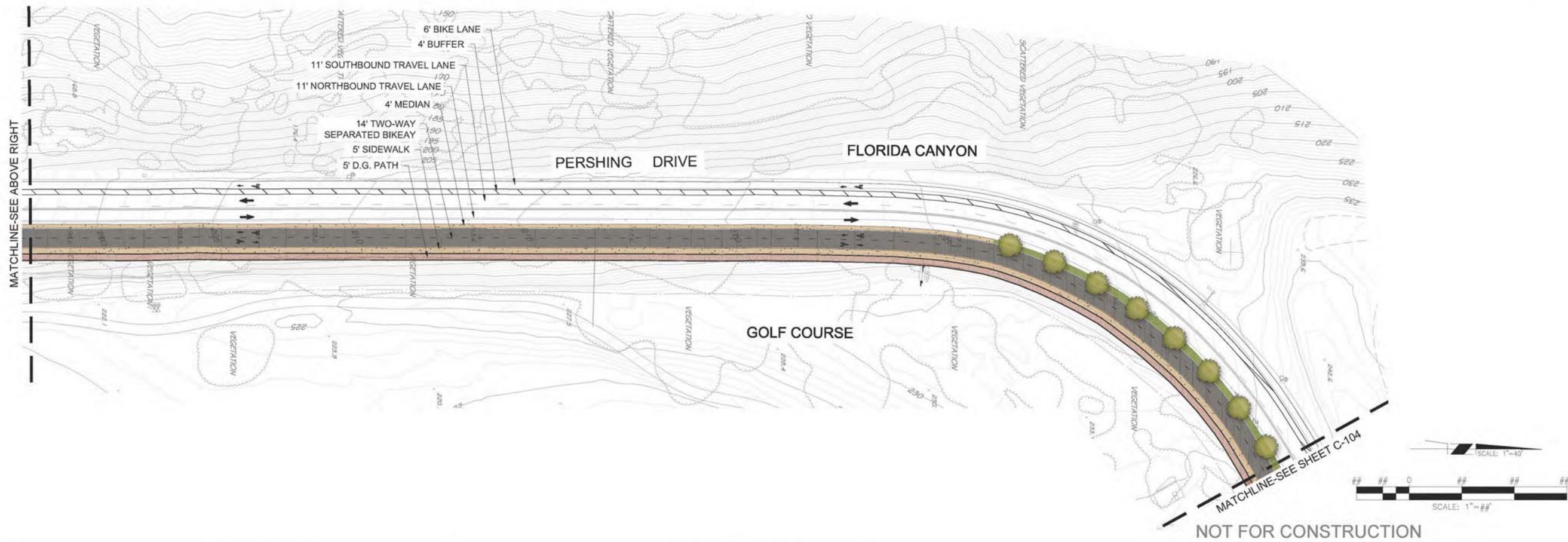
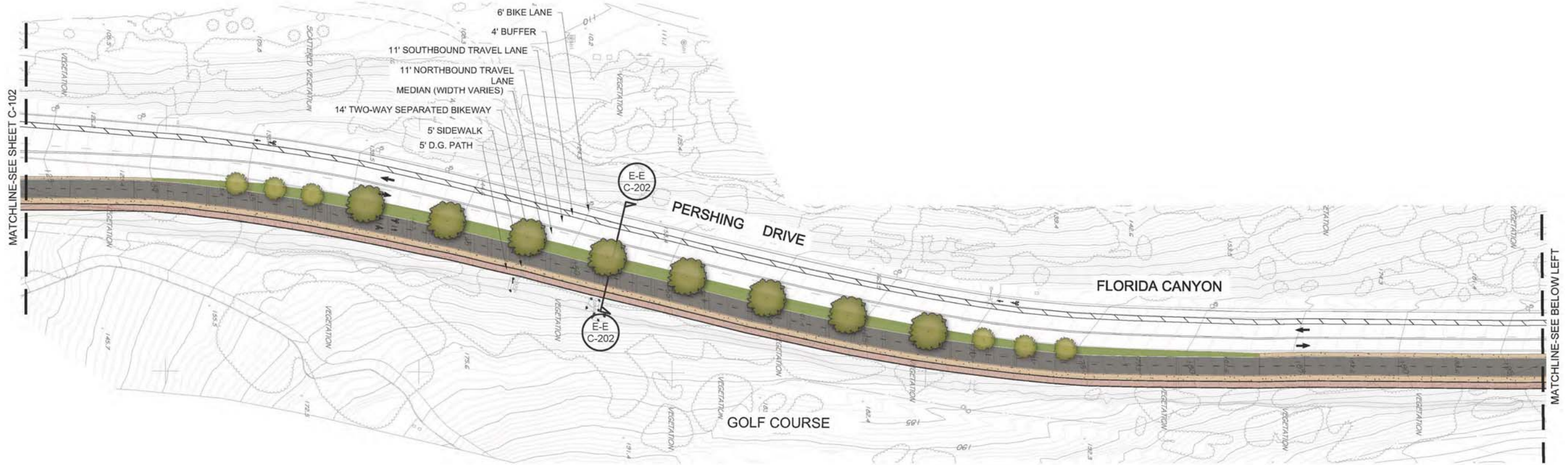

DESIGNED:	JJC
REVIEWED:	LD, BJ
DRAWN:	JJC, LD
PROJECT NO.:	2015-109
DATE:	AUGUST 19, 2016
SCALE:	FILE

REVISIONS		
NO.	DATE	ITEM



233 A Street, Suite 703
San Diego, California 92101
p 619.269.5982



Pershing Bikeway

San Diego, CA

GENERAL DEVELOPMENT PLAN
FOR PERSHING DRIVE

LAYOUT 3

SHEET NO.

C-103

4 of 11

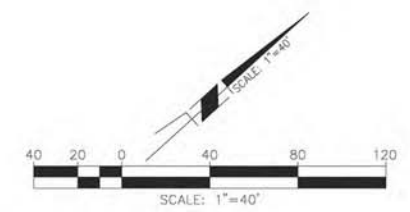

NOT FOR CONSTRUCTION

DESIGNED:	JJC	REVISIONS	
REVIEWED:	LD, BJ	NO	DATE
DRAWN:	JJC, LD	ITEM	
PROJECT NO.	2015-109		
DATE	AUGUST 19, 2016		
SCALE	FILE		



233 A Street, Suite 703
San Diego, California 92101
p 619.269.5982



Pershing Bikeway

San Diego, CA

GENERAL DEVELOPMENT PLAN
FOR PERSHING DRIVE

LAYOUT 4

SHEET NO.
C-104
5 OF 11

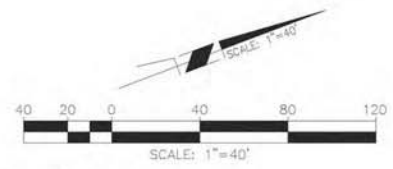
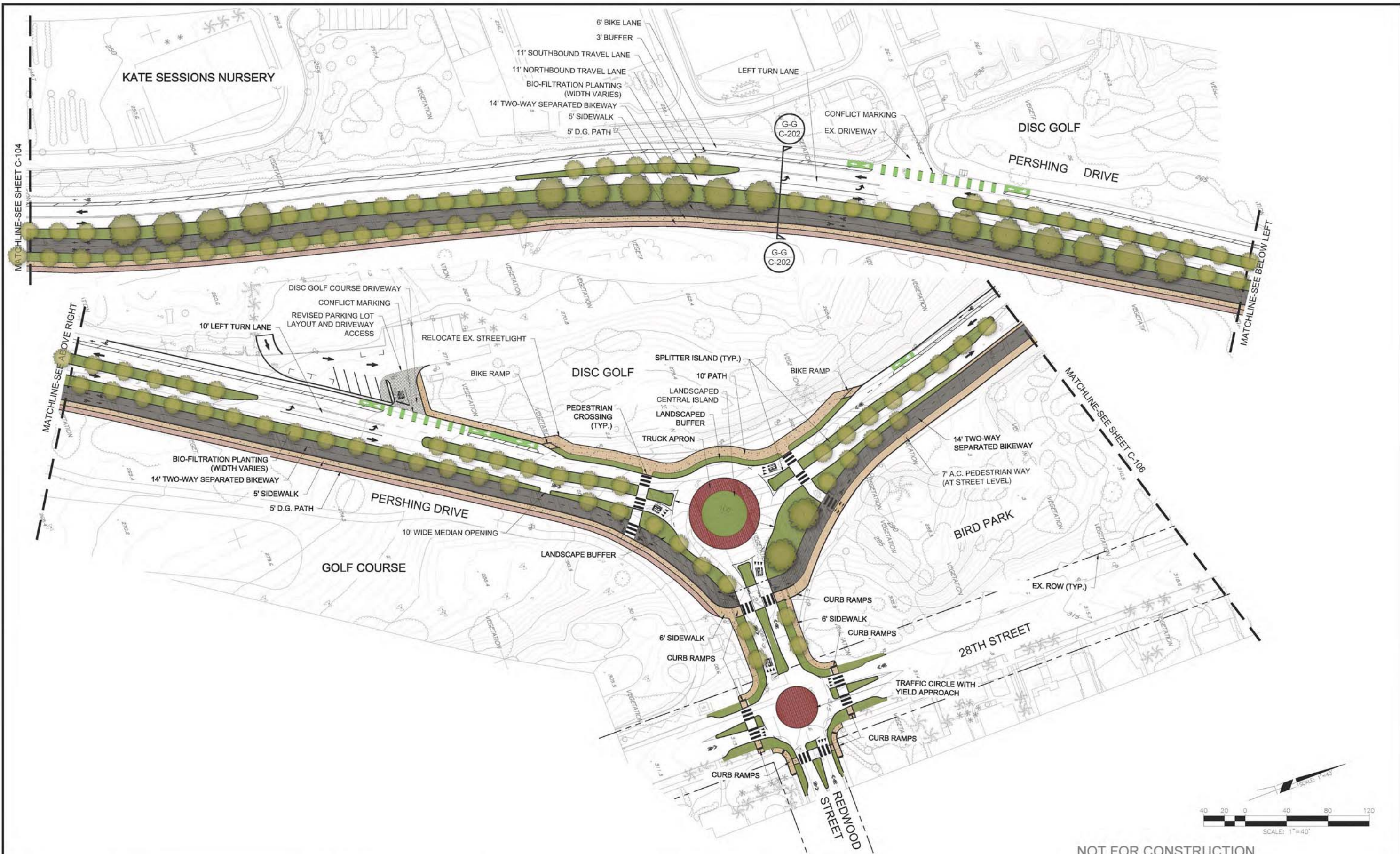

NOT FOR CONSTRUCTION

DESIGNED:	JJC	REVISIONS	
REVIEWED:	LD, BJ	NO	DATE
DRAWN:	JJC, LD	DATE	ITEM
PROJECT NO.	2015-109	DATE	
SCALE	FILE		

alta
 PLANNING + DESIGN
 www.altaplanning.com

233 A Street, Suite 703
 San Diego, California 92101
 p.619.269.5982



Pershing Bikeway

San Diego, CA

GENERAL DEVELOPMENT PLAN
 FOR PERSHING DRIVE

LAYOUT 5

SHEET NO.
C-105

6 of 11

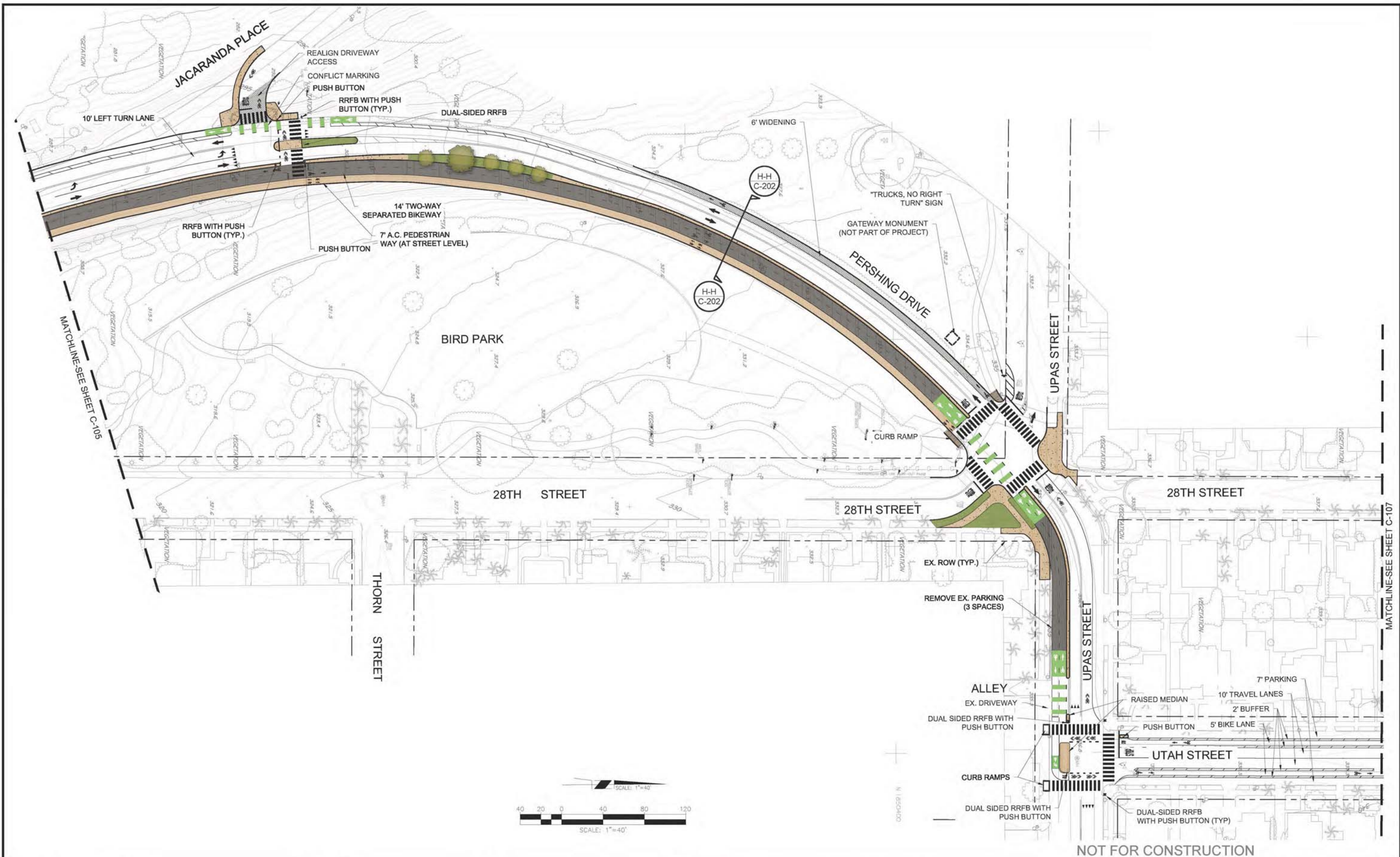

MATCHLINE-SEE SHEET C-105

MATCHLINE-SEE SHEET C-107

DESIGNED:	JJC
REVIEWED:	LD, BJ
DRAWN:	JJC, LD
PROJECT NO.:	2015-108
DATE:	AUGUST 18, 2016
SCALE:	FILE

REVISIONS			
NO.	DATE	ITEM	



233 A Street, Suite 703
San Diego, California 92101
p 619.269.5982



Pershing Bikeway

San Diego, CA

GENERAL DEVELOPMENT PLAN
FOR PERSHING DRIVE

LAYOUT 6

SHEET NO.
C-106
7 OF 11

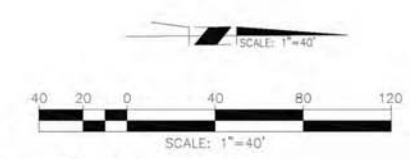
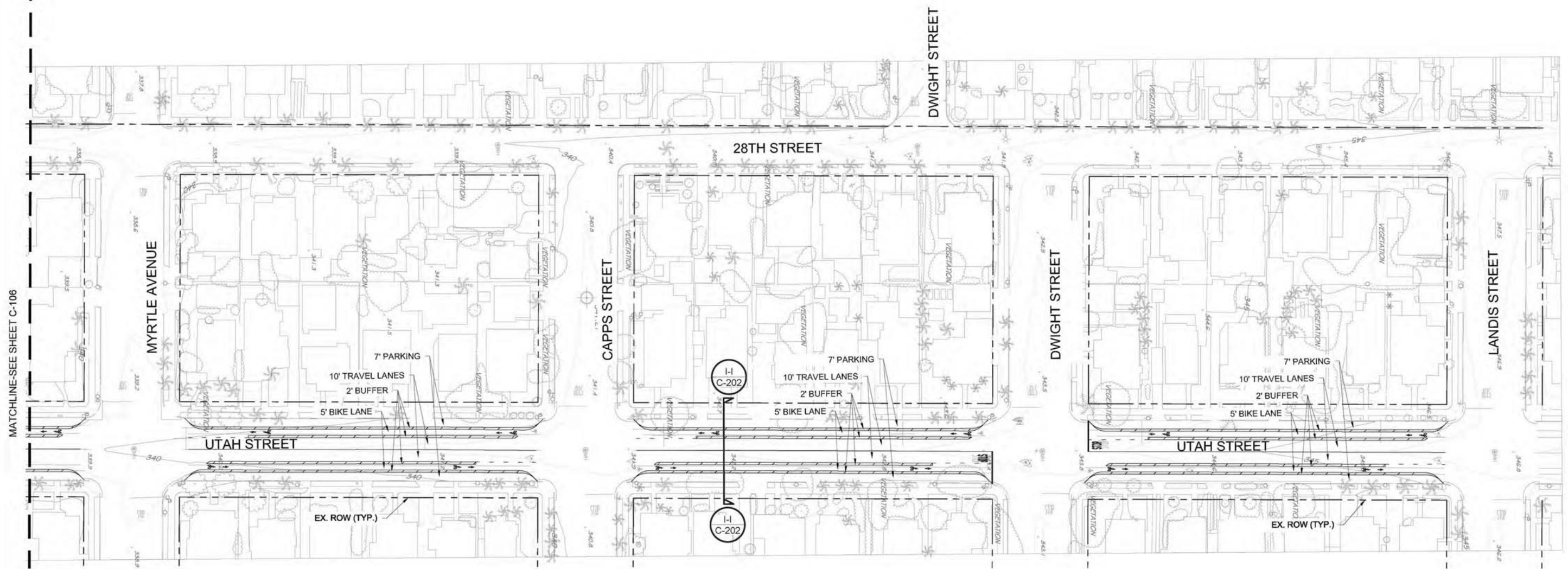

NOT FOR CONSTRUCTION

DESIGNED:	JJC	REVISIONS
REVIEWED:	LD, BJ	NO DATE ITEM
DRAWN:	JJC, LD	
PROJECT NO.:	2015-109	DATE
SCALE:	FILE	

alta
PLANNING + DESIGN
www.altaplanning.com

233 A Street, Suite 703
San Diego, California 92101
p 619.269.5992

SANDAG

GO byBIKE

Pershing Bikeway

San Diego, CA

GENERAL DEVELOPMENT PLAN
FOR PERSHING DRIVE

LAYOUT 7

SHEET NO.
C-107

8 of **11**

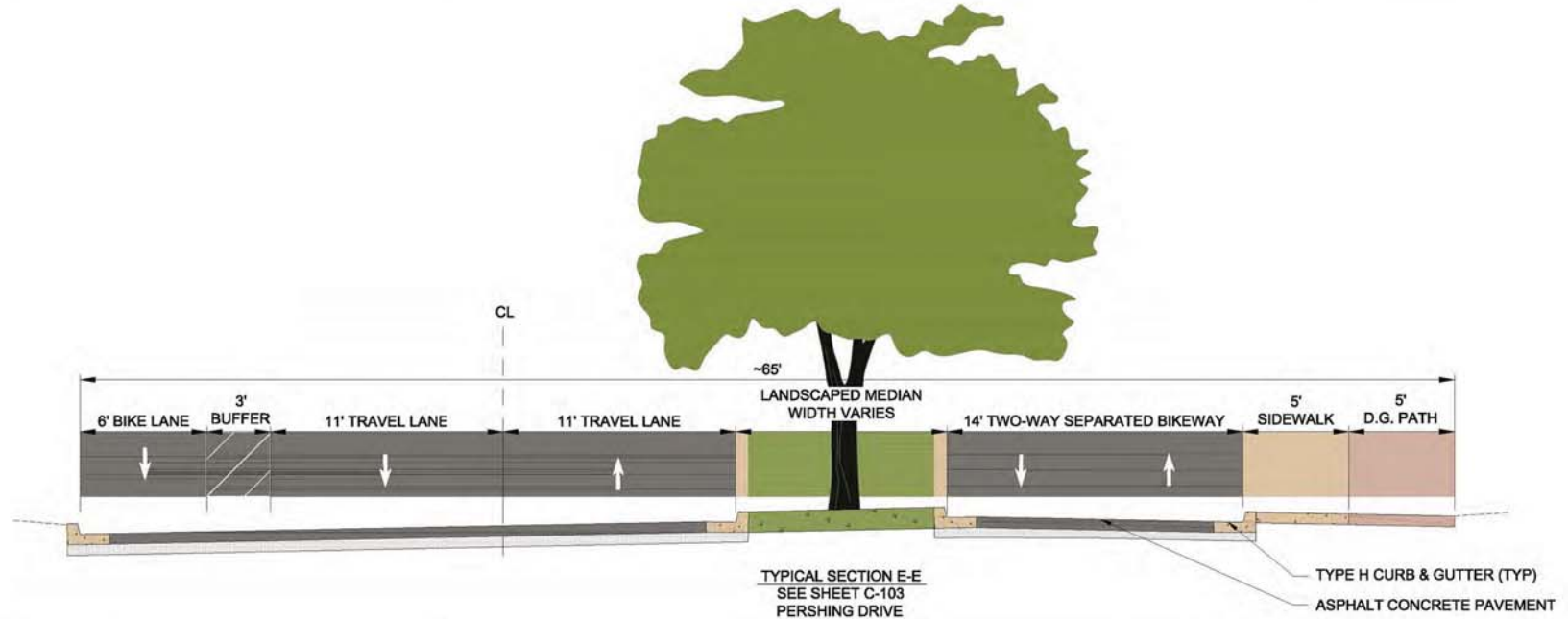
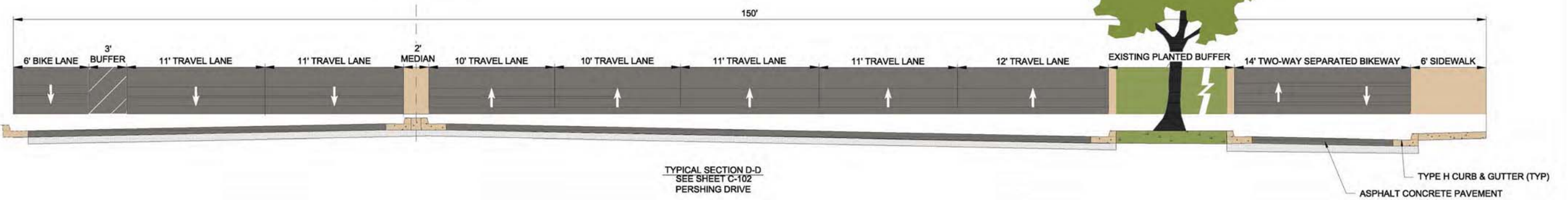
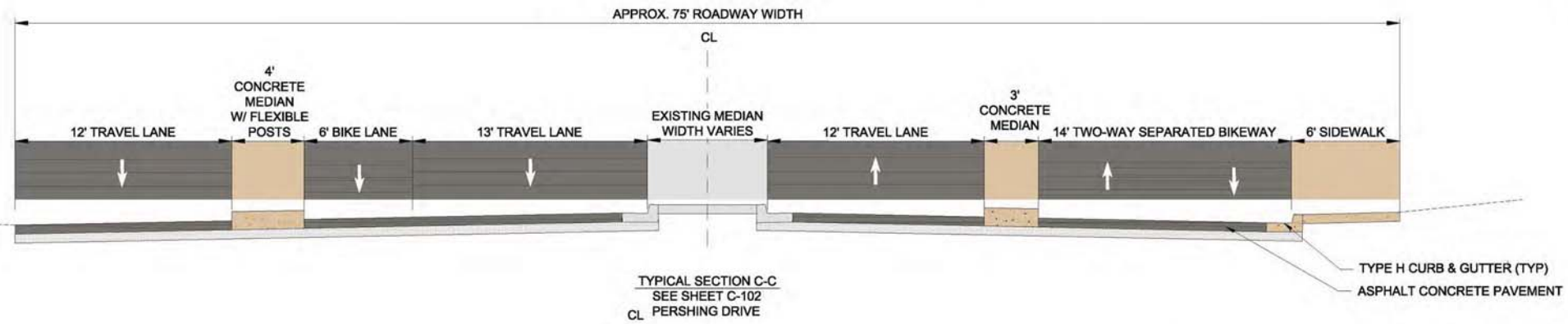
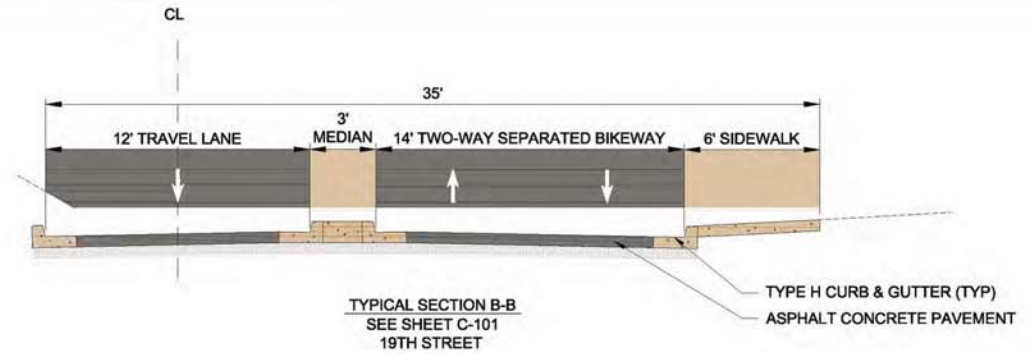
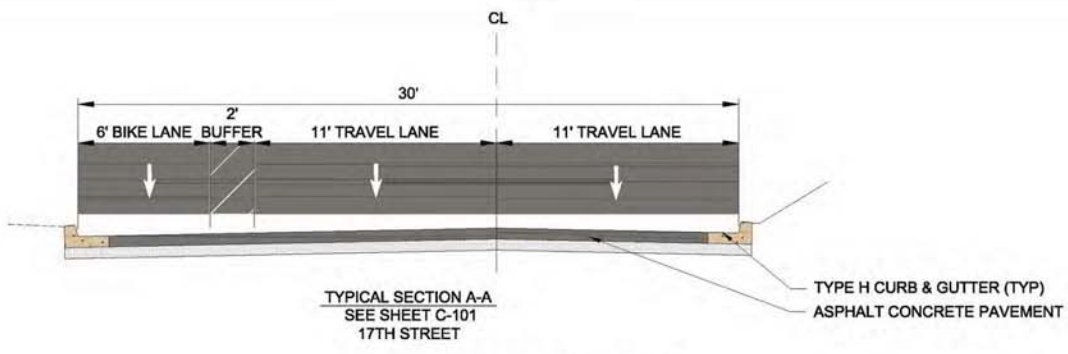

NOT FOR CONSTRUCTION

DESIGNED: JJC	REVISIONS
REVIEWED: LD, BJ	NO DATE ITEM
DRAWN: JJC, LD	
PROJECT NO. 2015-109	DATE AUGUST 19, 2016
SCALE	FILE



233 A Street, Suite 703
San Diego, California 92101
p. 619.269.5982



Pershing Bikeway

San Diego, CA

GENERAL DEVELOPMENT PLAN
FOR PERSHING DRIVE
TYPICAL SECTIONS

SHEET NO.
C-201
09 OF 11

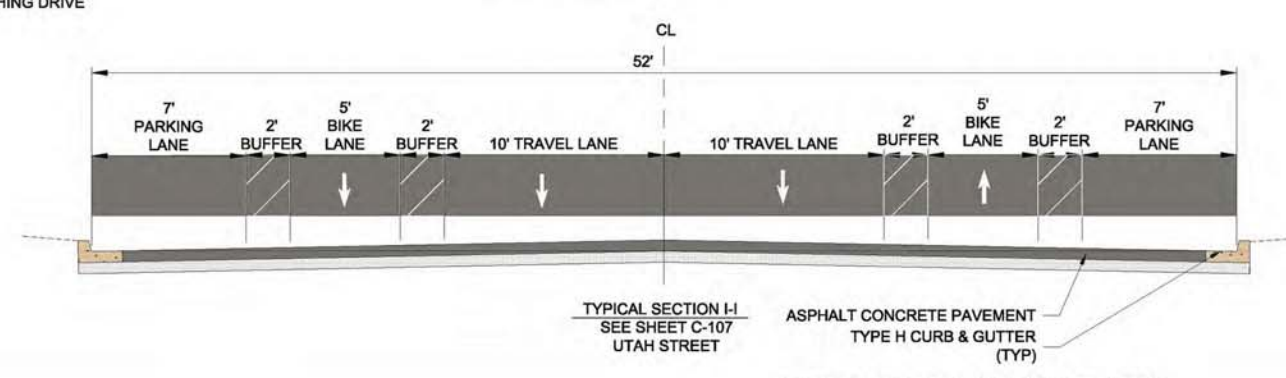
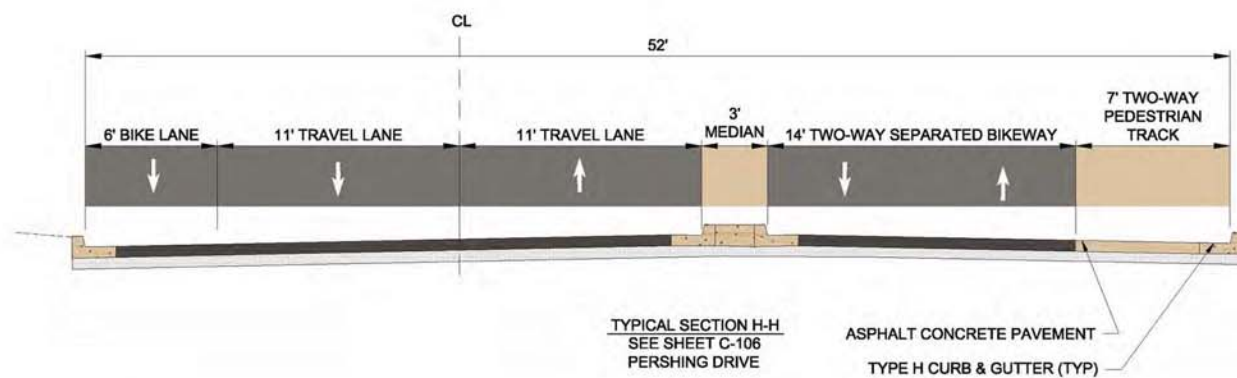
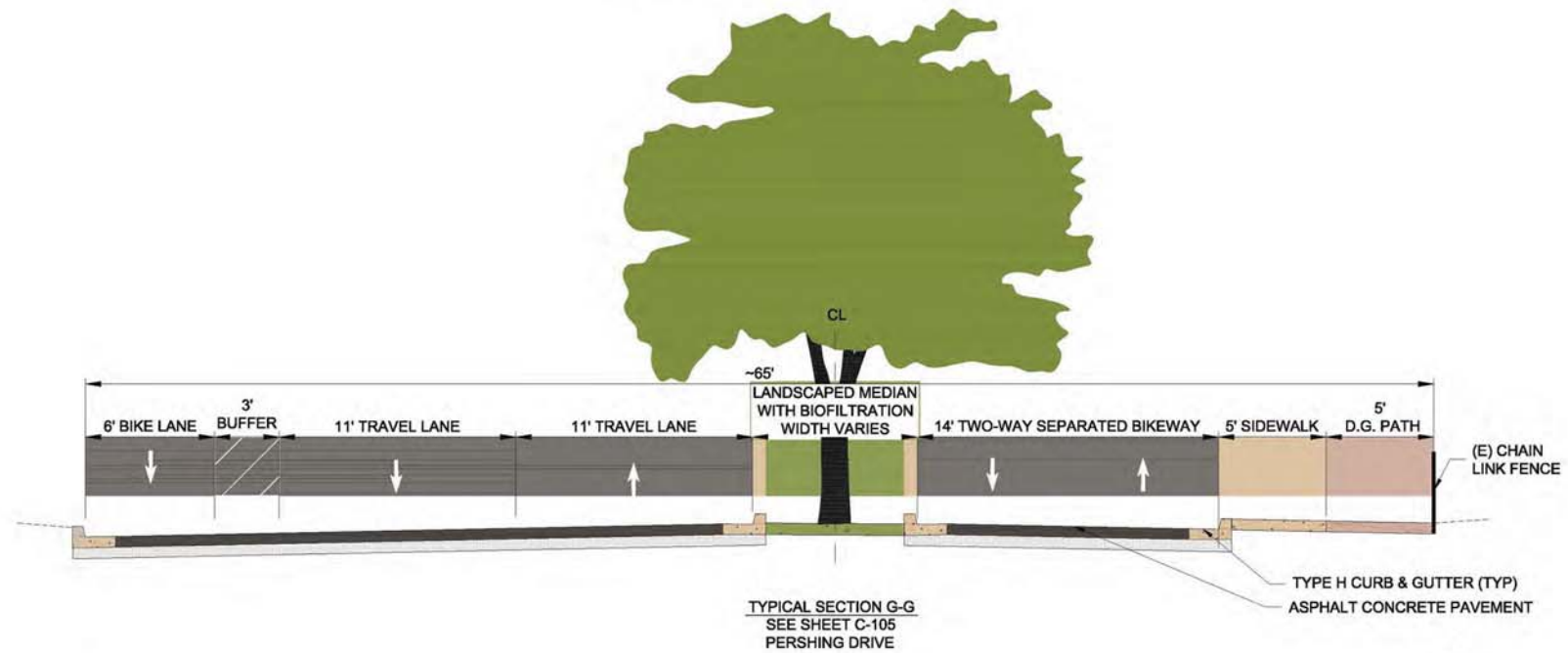
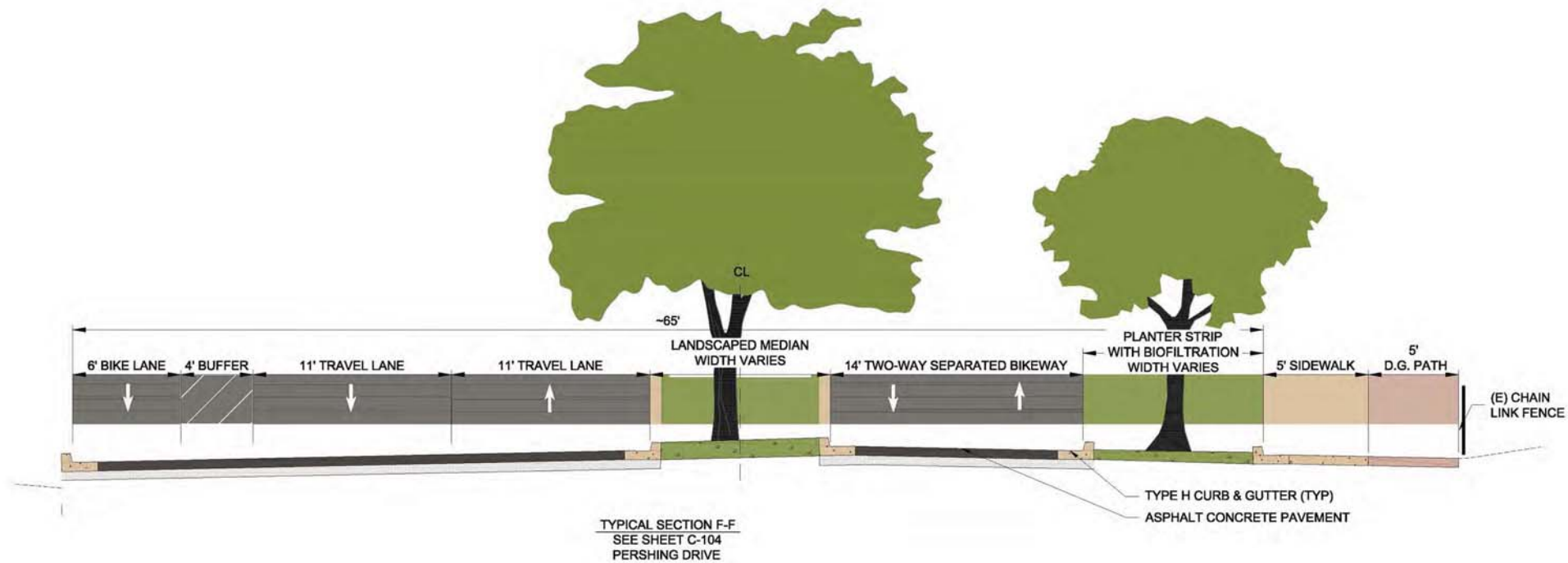

NOT FOR CONSTRUCTION

DESIGNED: JJC	REVISIONS
REVIEWED: LD_BJ	NO. DATE ITEM
DRAWN: JJC_LD	
2015-109 AUGUST 19, 2016	
PROJECT NO. DATE	
SCALE FILE	

alta
PLANNING + DESIGN
www.altaplanning.com

233 A Street, Suite 703
San Diego, California 92101
p. 619.269.5982



Pershing Bikeway

San Diego, CA

GENERAL DEVELOPMENT PLAN
FOR PERSHING DRIVE
TYPICAL SECTIONS

SHEET NO.
C-202
10 OF 11

POTENTIAL TREE LIST

Botanical Name	Common Name	Litter	Drought	Native	Flower Color	Type
Median Width 5'-7'						
<i>Cercis occidentalis</i>	Western Redbud	Medium	Yes	Yes	Pink	D/F
<i>Melaleuca quinquenervia</i>	Cajuput Tree	Medium	Yes	No	White	E/F
<i>Metrosideros excelsus</i>	New Zealand Christmas	Medium	Yes	No	Red	E/F
<i>Quercus ilex</i>	Holly Oak	Medium	Yes	No	No	E
<i>Tabebuia ipi</i>	Pink Trumpet	High	Yes	No	Pink	D/F
Median width 7'-10'						
<i>Arbutus 'Marina'</i>	Marina Madrone	High	Yes	Yes		E
<i>Calocedrus decurrens</i>	Incense Cedar	Low	Yes	Yes		E
<i>Platanus 'Columbia'</i>	London Plane Tree	High		No		D
Median Width 12'-18'						
<i>Pinus torreyana</i>	Torrey Pine	Medium	Yes	Yes		E
<i>Quercus agrifolia</i>	Coast live Oak	Medium	Yes	Yes		E

POTENTIAL PLANT LIST

Botanical Name	Common Name	Zone: A (Above ponding area) or B (ponds in storm events)	Native	Flower Color	Height	Width
Biofiltration plantings						
<i>Achillea millefolium</i>	Common Yarrow	B	Yes	White	2'	2'
<i>Carex pansa</i>	California Meadow Sedge	A,B	Yes	Tan	8"	1"
<i>Carex spissa</i>	San Diego Sedge	A	Yes	Tan	3-4'	2-3'
<i>Chondropetalum lectorum</i>	Small Cape Rush	A,B	No	Brown	2-3'	3-4'
<i>Fragaria chiloensis</i>	Beach Strawberry	B	Yes	White	4"	1"
<i>Juncus patens</i>	California Grey Rush	A,B	Yes	Brown	2'	2'
<i>Leymus condensatus</i>						
'Canyon Prince'	Canyon Prince Wild Rye	B	Yes	Wheat	2-3'	2-3'
<i>Muhlenbergia dubia</i>	Mexican Muhly	B	No		1-3'	1-3'
Native shrubs and perennials						
<i>Achillea millefolium</i>	Common Yarrow		Yes	White	2'	2'
<i>Arctostaphylos densiflora</i>			Yes	White	6-10'	6-12'
'Howard McMinn'	Howard McMinn Manzanita		Yes	White	6-8'	4-5'
<i>Carpenteria californica</i>	Bush Anemone		Yes	Purple	5-6'	6'
<i>Ceanothus 'Concha'</i>	Concha' California Lilac		Yes	Yellow	8'	6'
<i>Dendromecon harfordii</i>	Channel Island Bush Poppy		Yes	White to Pink	1-3'	5'
<i>Eriogonum fasciculatum</i>			Yes			
'Dana Point'	Dana Point Buckwheat		Yes			
<i>Frangula californica</i>			Yes			
'Mound San Bruno'	Coffee Berry		Yes		2-4'	10'
<i>Viguiera laciniata</i>	San Diego Sunflower		Yes	Yellow	2'	2'
<i>Cistus species</i>	Rockrose		Yes	Pink		
<i>Grevillea species and hybrids</i>	Grevillea		Yes	Pink		
<i>Leucophyllum species</i>	Texas Ranger		Yes	Purple		
<i>Mahonia aquifolium N</i>	Oregon Grape		Yes	Yellow		
<i>Myrtus communis</i>			Yes	White		
'Compacta'	Dwarf Myrtle		Yes	Blue		
<i>Rosmarinus officinalis</i>	Rosemary		Yes	Blue		
<i>Westringia fruticosa</i>	Coast Rosemary		Yes	Pink		
<i>Muhlenbergia capillaris</i>	Pink Muhly Grass		Yes	Pink		
<i>Phormium tenax and some species and hybrids</i>	New Zealand Flax		Yes	Varies		
<i>Anigozanthos species and hybrids</i>	Kangaroo Paw		Yes	Varies		
<i>Encelia californica, N</i>	California Sunflower		Yes	Yellow		
<i>Osteospermum fruticosum</i>	Trail African Daisy		Yes	Pink		
<i>Mimulus, Native species and hybrids</i>	Monkey Flower		Yes	Orange		
<i>Penstemon heterophyllus, N</i>			Yes	Blue		
<i>Penstemon parryi, N</i>	Foothill Penstemon		Yes	Pink		
<i>Penstemon spectabilis, N</i>	Parry's Beardtongue		Yes	Pink		
	Showy Penstemon		Yes	Orange/Red		
<i>Salvia Africana lutea</i>	Dune Sage		Yes	Blue		
<i>Salvia chamaedryoides</i>	Germander Sage		Yes	Blue		
<i>Salvia clevelandii, N</i>	Cleveland Sage		Yes	Blue		
<i>Salvia leucantha</i>	Mexican Bush Sage		Yes	Pink		
<i>Salvia greggii</i>	Autumn Sage		Yes	Pink		
<i>Lavandula dentata</i>	French Lavender		Yes	Purple		
<i>Verbena peruviana</i>	Peruvian Verbena		Yes	Purple		
<i>Lavandula stoechas</i>	Spanish Lavender		Yes	Purple		
Groundcovers						
<i>Arctostaphylos glandulosa ssp. crassifolia</i>	Del Mar Manzanita		Yes	Purple	1'	
<i>Fragaria chiloensis</i>	Beach Strawberry		Yes	White	4"	
<i>Ceanothus Griseus</i>			Yes	Purple	2-3'	1'
'Yankee Point'	Yankee Point Ceanothus		Yes	Rose	2-3'	
<i>Salvia leucophylla 'Point Sal'</i>	Point Sal Purple Sage		Yes	Pink	2-3'	2'
<i>Ceanothus griseus horizontalis species and hybrids, N</i>	Carmel Creeper		Yes	Blue	8-10'	
<i>Lantana montevidensis</i>	Trailing Lantana		Yes	Pink	8-10'	
<i>Rosmarinus officinalis</i>			Yes	Blue		
'Huntington Carpet'	Huntington Carpet Rosemary		Yes	Blue		
<i>Rosmarinus officinalis</i>			Yes	Blue		
'Lockwood de Forest'	Lockwood de Forest		Yes	Blue		
<i>Thymus pseudolanuginosus</i>	Woolly Thyme		Yes	Pink		

SMALL WIDTH MEDIAN TREES

CERCIS OCCIDENTALIS



MELALEUCA QUINQUENERVIA



METROSIDEROS EXCELSUS



TABEBUIA IPE



GROUNDCOVERS

ARCTOSTAPHYLOS GLANDULOSA SSP. CRASSIFOLIA



MEDIUM WIDTH MEDIAN TREES

ARUBUTUS 'MARINA'



CALOCEDRUS DECURRENS



PLATANUS 'COLUMBIA'



CEANOTHUS GRISEUS 'YANKEE POINT'



LARGE WIDTH MEDIAN TREES

PINUS TORREYANA



QUERCUS AGRIFOLIA



SALVIA LEUCOPHYLLA 'POINT SAL'



BIOFILTRATION PLANTING

CAREX SPISSA



ACHILLEA MILLEFOLIUM



NATIVE SHRUB AND GRASS MIX

CEANOTHUS 'CONCHA'



FRANGULA CALIFORNICA 'MOUND SAN BRUNO'



VIGUIERA LACINIATA



NOT FOR CONSTRUCTION

DESIGNED: JJC	REVISIONS:
REVIEWED: LD, BJ	NO. DATE ITEM
DRAWN: JJC, LD	
2015-109 AUGUST 19, 2016	
PROJECT NO. DATE	
SCALE FILE	



233 A Street, Suite 703
San Diego, California 92101
p.619.269.5982



Pershing Bikeway

San Diego, CA

GENERAL DEVELOPMENT PLAN
FOR PERSHING DRIVE

PLANTING LEGEND

SHEET NO.

L-501

11 OF 11