

C A L U M E T

A V E N U E

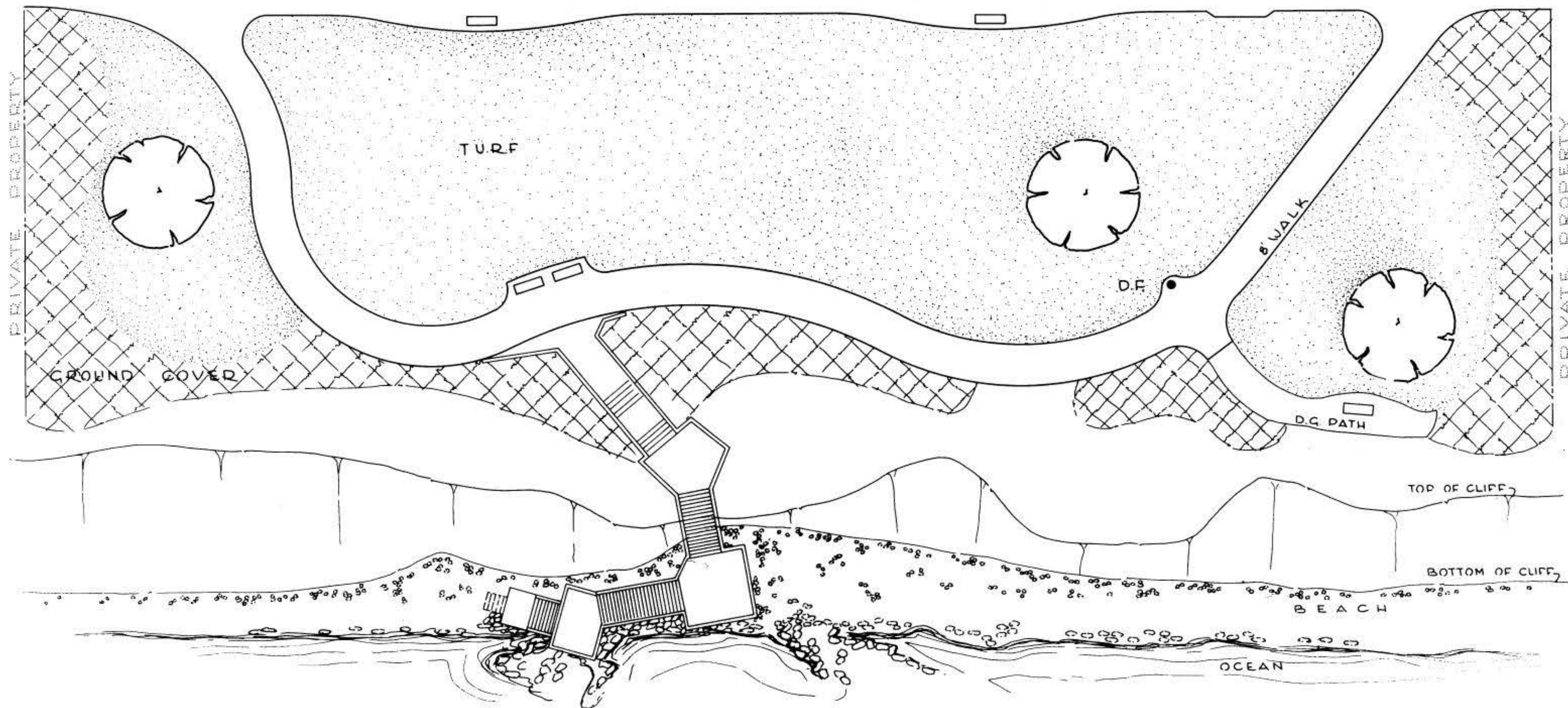

COUNCIL DISTR. 1 COMM. PLAN AREA, LA JOLLA 10 P.S.D. 511

DATE		ACTION		REFERENCE DOCUMENTS		
DATE	ACTION	RESO. NO.	COST 1	ACRES	ACRES	ACRES
10-75	SITE ACQUIRED			.70		
9-76	SITE DEDICATED	ORD. NO. 0-11919		.70		
	GDP CONSULTANT HIRED	RESO. NO.	NAME			
	P&R BOARD APPROVAL	PF&R APPROVAL	DATE			
5-7-79	INITIAL DEVELOPMENT	CIP NO.	JO. NO. 11759B	DRWG. NO. 17893-D		
		CIP NO.	JO. NO.	DRWG. NO.		
		CIP NO.	JO. NO.	DRWG. NO.		
		CIP NO.	JO. NO.	DRWG. NO.		
		CIP NO.	JO. NO.	DRWG. NO.		
		CIP NO.	JO. NO.	DRWG. NO.		

IMPROVEMENTS SUMMARY (DATA FROM AS-BUILT DRAWINGS)								
ITEM	QUANTITY	UNIT	ITEM	QUANTITY	UNIT	ITEM	QUANTITY	
TOTAL SITE	.70	AC.	PLAY AREA	SF	PAVED WALKS	4,096	SF	
IMPROVED AREA	.70	AC.	MULTI PURPOSE CT	SF	PARK ROADS	SF	SECURITY LTS	STDS
TURF	.35	AC.	TENNIS CTS	SF	PARKING LOT	SF	BALL FIELD LTS	STDS
SHRUB BED		AC.	RESTROOM	SF	" " STALLS STD.		TENNIS CT LTS	STDS
NATURAL	.13	AC.	REC. BLDG.	SF	" " STALLS HOCP		MULTI PURPOSE CT.	STDS
OTHER LANDSCAPING	.12	AC.	POOL BLDG	SF	COURT GAME AREA	SF	BACKSTOPS	EA
DIRT INFIELDS		AC	" " DECK	SF	" " WATER		TENNIS CTS.	EA
			" " WATER	SF	LAWN EDGING	1,140	LF	

CITY OF SAN DIEGO PARK and RECREATION DEPARTMENT

THE GENERAL DEVELOPMENT PLAN

CALUMET PARK

COUNCIL DIST. NO. 1 COMM. PLAN AREA LA JOLLA - 10 5430 CALUMET AVE. P.S.D. 511

LAMBERT COORDINATES 234-1067 THOMAS BROS. PG. 43A P. 5