

LOCATION MAP

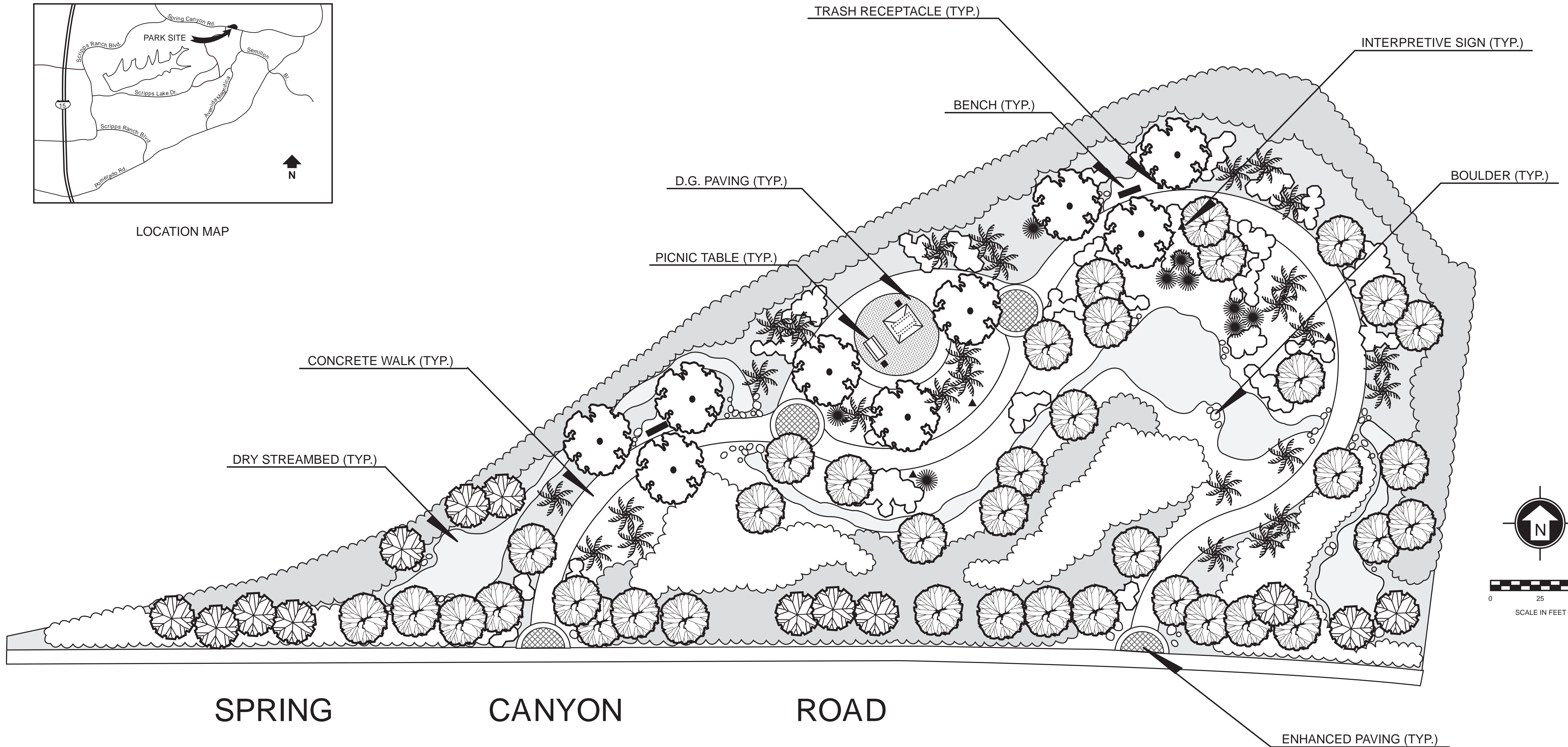

SPRING CANYON ROAD

COUNCIL DISTRICT: 5 COMMUNITY PLAN AREA: MIRAMAR RANCH NORTH

DATE	ACTION	REFERENCE DOCUMENTS
4-11-83	SITE ACQUIRED	RESO. NO. 0-15942 COST \$ DONATED ACRES: 1.50
4-11-83	SITE DEDICATED	ORD. NO. 0-15942 ACRES: .45
1981	GDP CONSULTANT HIRED	RESO. NO. 253487 NAME: O.N.A.
4-21-81	P&R BOARD APPROVAL	PF&R APPROVAL DATE: 5-20-81
11-30-82	INITIAL DEVELOPMENT	CIP NO. 20-007 J.O. NO. 117905 DRWG. NO. 19815-D
		CIP NO. J.O. NO. DRWG. NO.
		CIP NO. J.O. NO. DRWG. NO.
		CIP NO. J.O. NO. DRWG. NO.
		CIP NO. J.O. NO. DRWG. NO.

IMPROVEMENTS SUMMARY (DATA FROM AS-BUILT DRAWINGS)							
ITEM	QUANTITY	ITEM	QUANTITY	ITEM	QUANTITY	ITEM	QUANTITY
TOTAL SITE	1.50 AC.	TOT LOT	SF	PAVED WALKS	6,420 SF	SECURITY LTS.	STDS.
IMPROVED AREA	AC.	MULTI PURPOSE CT.	SF	PARK ROADS	SF	BALLFIELD LTS.	STDS.
TURF	AC.	TENNIS CTS.	SF	PARKING LOT	SF	TENNIS COURT LTS.	STDS.
SHRUB BED	AC.	RESTROOM	SF	PARKING STALLS STANDARD		MULTI-PURPOSE CT.	STDS.
NATURAL	AC.	REC. BLDG.	SF	PARKING STALLS DISABLED		BACKSTOPS	EA.
D.G. PAVING	.15 AC.	POOL BLDG.	SF	COURT GAME AREA	SF	BENCHES	2 EA.
DIRT INFIELDS	AC.	POOL DECK	SF	LAWN EDGING	LF	PICNIC TABLES	2 EA.
		POOL WATER	SF			TRASH RECEPTACLES	3 EA.

CITY OF SAN DIEGO PARK AND RECREATION DEPARTMENT

THE GENERAL DEVELOPMENT PLAN

CANYON VIEW

MINI - PARK

PSD
230

LAMBERT COORDINATES: 276-1745 THOMAS BROTHERS PAGE: 1210, A-2

REVISION 2/23/01 T.R.